

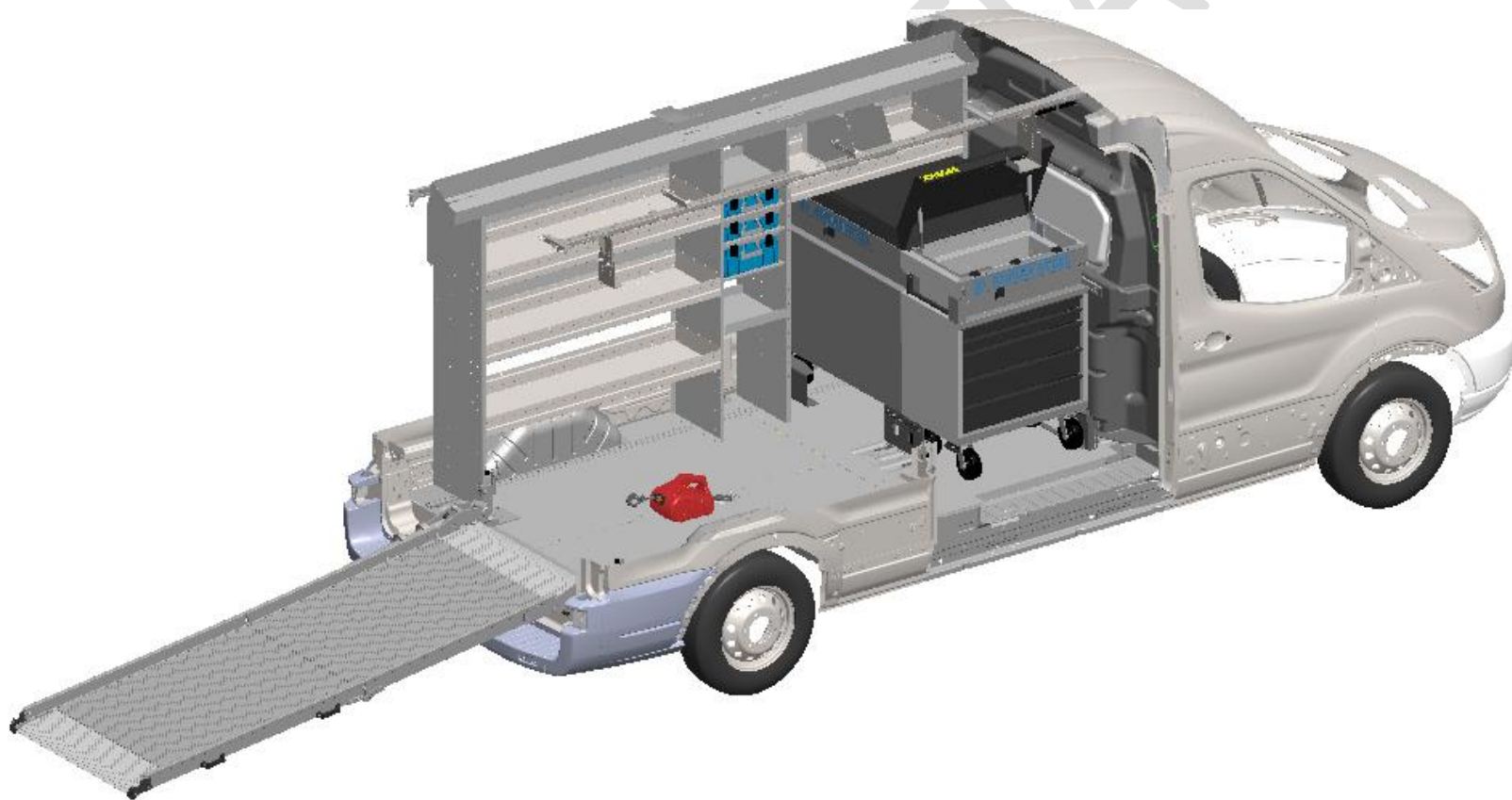

CONCEPT FOR THYSSEN KRUPP VAN/WORKSITE STORAGE SOLUTION



07/26/2017, ALL DESIGNS AND DESIGN CONCEPTS ARE THE INTELLECTUAL PROPERTY OF ADRIAN STEEL COMPANY AND ARE NOT TO BE COPIED, DISTRIBUTED OR COMMUNICATED TO OUTSIDE PARTIES WITHOUT THE EXPRESSED WRITTEN PERMISSION OF ADRIAN STEEL COMPANY. THE MATERIAL/CONCEPTS/DESIGNS CONTAINED WITHIN THIS DOCUMENT ARE FOR THE PURPOSE OF QUOTING/SUPPLYING PRODUCT TO POTENTIAL ADRIAN STEEL CUSTOMERS ONLY.



THYSSEN KRUPP VAN/WORKSITE STORAGE SOLUTION

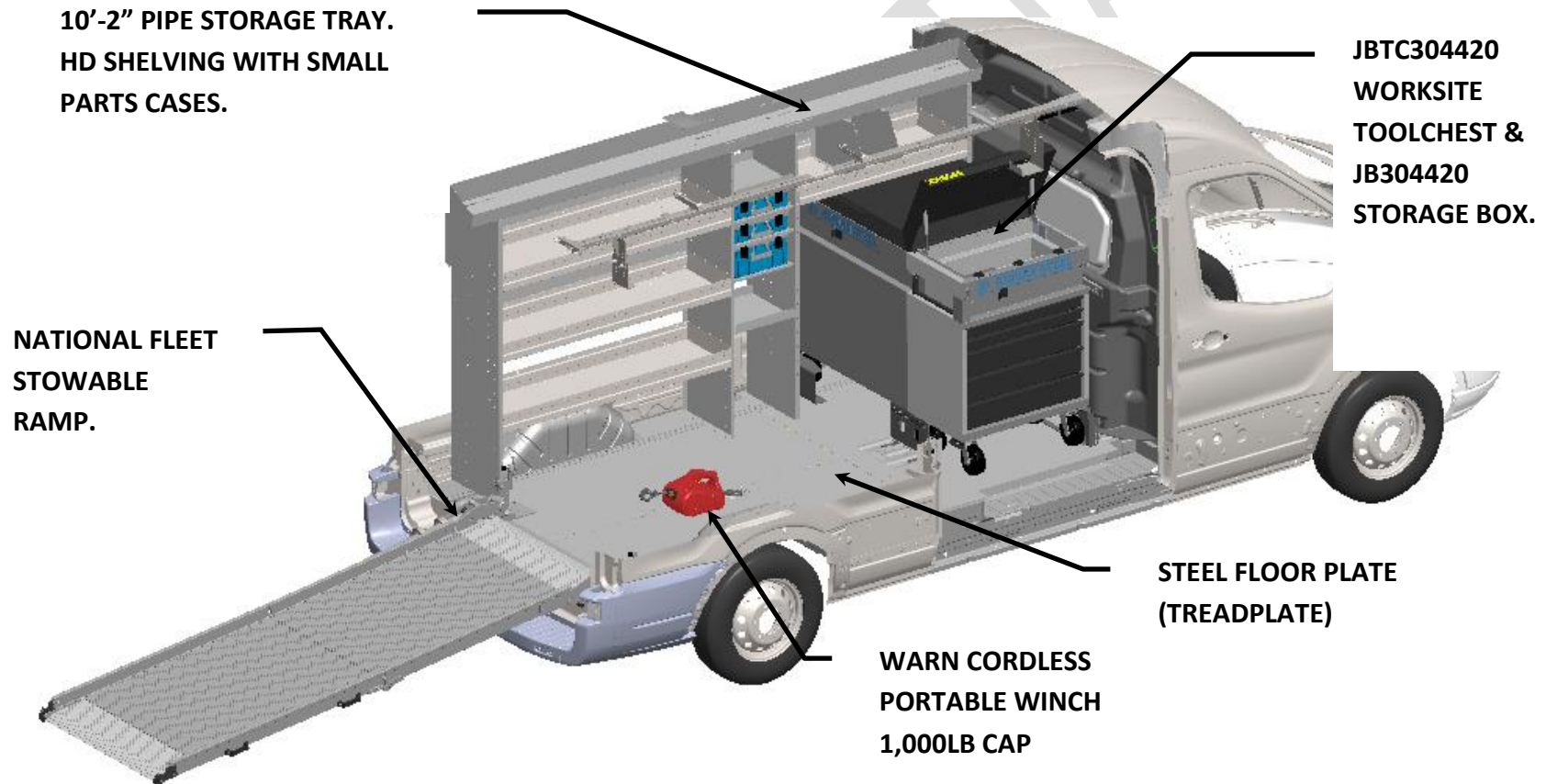

07/26/2017, ALL DESIGNS AND DESIGN CONCEPTS ARE THE INTELLECTUAL PROPERTY OF ADRIAN STEEL COMPANY AND ARE NOT TO BE COPIED, DISTRIBUTED OR COMMUNICATED TO OUTSIDE PARTIES WITHOUT THE EXPRESSED WRITTEN PERMISSION OF ADRIAN STEEL COMPANY. THE MATERIAL/CONCEPTS/DESIGNS CONTAINED WITHIN THIS DOCUMENT ARE FOR THE PURPOSE OF QUOTING/SUPPLYING PRODUCT TO POTENTIAL ADRIAN STEEL CUSTOMERS ONLY.



THYSSEN KRUPP VAN/WORKSITE STORAGE SOLUTION

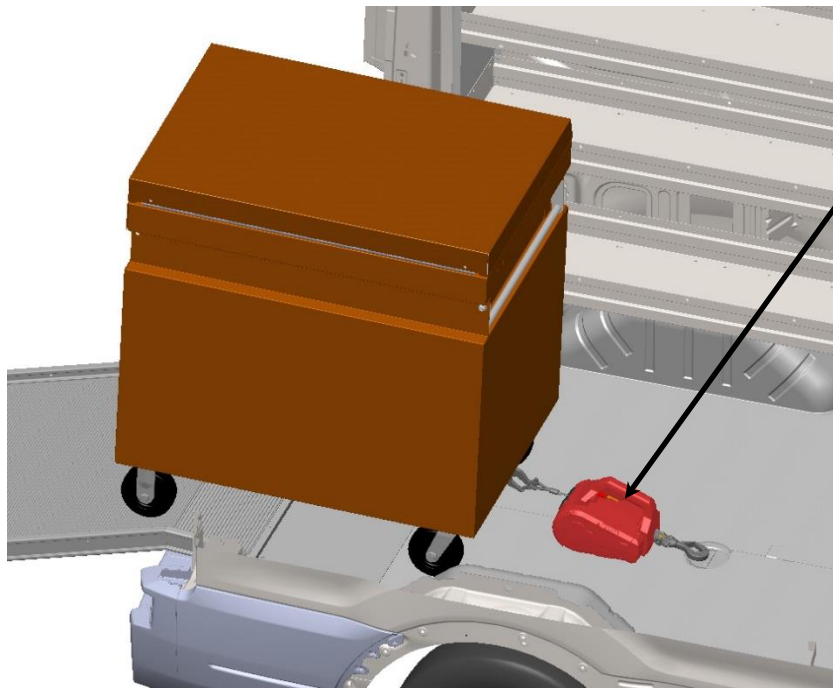

**WARN CORDLESS 24VDC
PORTABLE WINCH
P.N. 885030
15FT LEAD OUT
1,000LB CAP**

**RECESSED 2,000 LB CAPACITY
D-RING**

JOB CHEST STORAGE UNIT.

07/26/2017, ALL DESIGNS AND DESIGN CONCEPTS ARE THE INTELLECTUAL PROPERTY OF ADRIAN STEEL COMPANY AND ARE NOT TO BE COPIED, DISTRIBUTED OR COMMUNICATED TO OUTSIDE PARTIES WITHOUT THE EXPRESSED WRITTEN PERMISSION OF ADRIAN STEEL COMPANY. THE MATERIAL/CONCEPTS/DESIGNS CONTAINED WITHIN THIS DOCUMENT ARE FOR THE PURPOSE OF QUOTING/SUPPLYING PRODUCT TO POTENTIAL ADRIAN STEEL CUSTOMERS ONLY.

OVERALL
42" TALL
44" WIDE
30" DEPTH

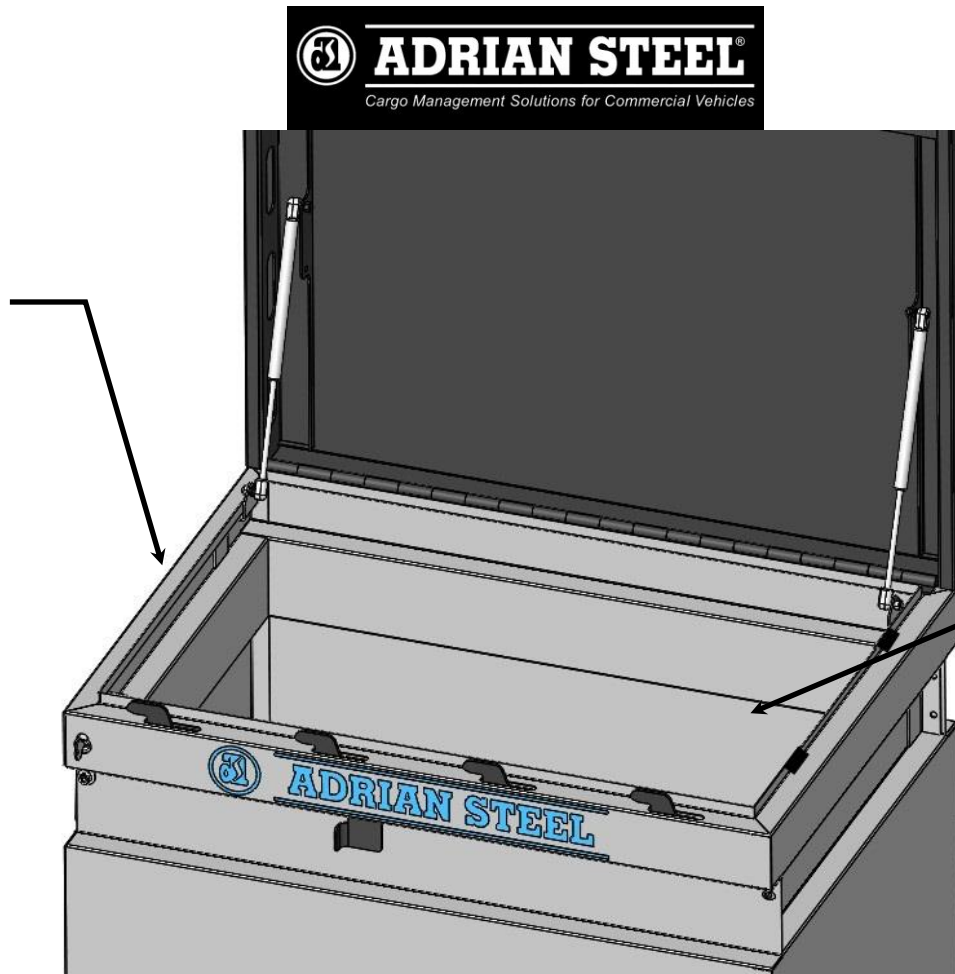

STORAGE AREA
33-1/2" TALL
41-7/8" WIDE
29-7/8" DEPTH

TOOL CHEST STORAGE UNIT.

07/26/2017, ALL DESIGNS AND DESIGN CONCEPTS ARE THE INTELLECTUAL PROPERTY OF ADRIAN STEEL COMPANY AND ARE NOT TO BE COPIED, DISTRIBUTED OR COMMUNICATED TO OUTSIDE PARTIES WITHOUT THE EXPRESSED WRITTEN PERMISSION OF ADRIAN STEEL COMPANY. THE MATERIAL/CONCEPTS/DESIGNS CONTAINED WITHIN THIS DOCUMENT ARE FOR THE PURPOSE OF QUOTING/SUPPLYING PRODUCT TO POTENTIAL ADRIAN STEEL CUSTOMERS ONLY.



**STORAGE
DRAWERS**
26-1/2" WIDE
18-1/8" DEPTH

2 EACH
2-7/16" DEPTH

3 EACH
5-3/16" DEPTH

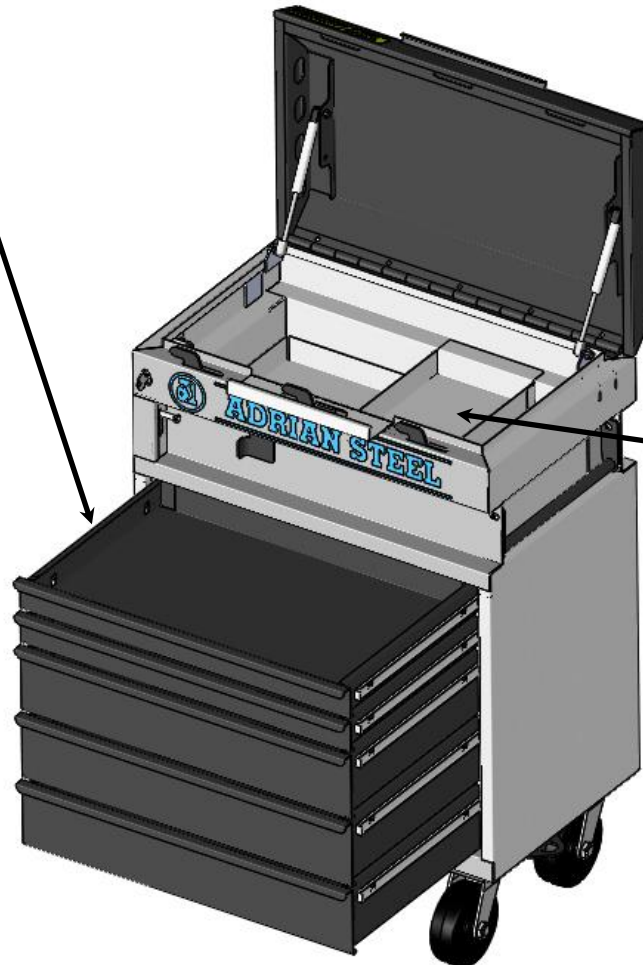

**UPPER STORAGE AREA
WITH TOOL TRAY**
9-1/8" TALL
26-1/2" WIDE
16-1/4" DEPTH

07/26/2017, ALL DESIGNS AND DESIGN CONCEPTS ARE THE INTELLECTUAL PROPERTY OF ADRIAN STEEL COMPANY AND ARE NOT TO BE COPIED, DISTRIBUTED OR COMMUNICATED TO OUTSIDE PARTIES WITHOUT THE EXPRESSED WRITTEN PERMISSION OF ADRIAN STEEL COMPANY. THE MATERIAL/CONCEPTS/DESIGNS CONTAINED WITHIN THIS DOCUMENT ARE FOR THE PURPOSE OF QUOTING/SUPPLYING PRODUCT TO POTENTIAL ADRIAN STEEL CUSTOMERS ONLY.



TOOL CHEST ACCESS IN STOWED POSITION AT CARGO SIDE DOOR

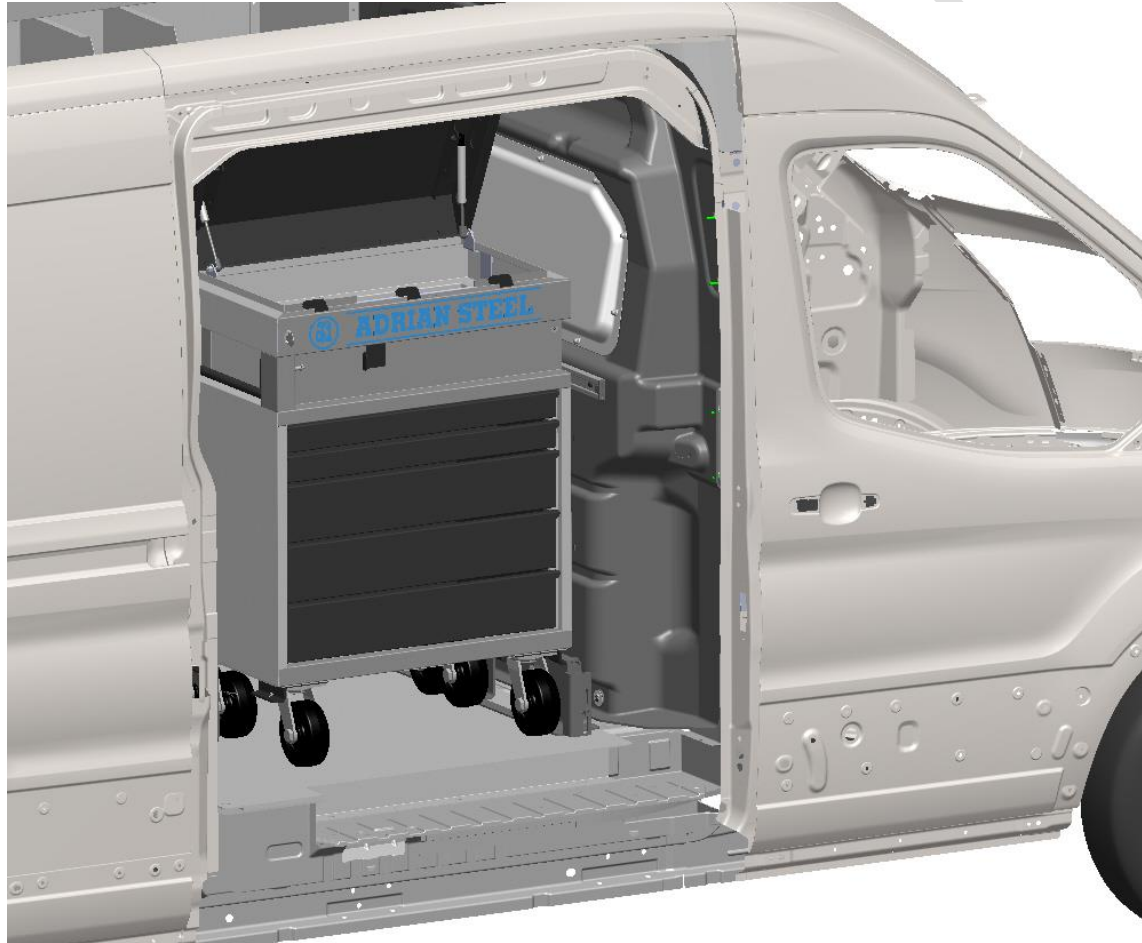

07/26/2017, ALL DESIGNS AND DESIGN CONCEPTS ARE THE INTELLECTUAL PROPERTY OF ADRIAN STEEL COMPANY AND ARE NOT TO BE COPIED, DISTRIBUTED OR COMMUNICATED TO OUTSIDE PARTIES WITHOUT THE EXPRESSED WRITTEN PERMISSION OF ADRIAN STEEL COMPANY. THE MATERIAL/CONCEPTS/DESIGNS CONTAINED WITHIN THIS DOCUMENT ARE FOR THE PURPOSE OF QUOTING/SUPPLYING PRODUCT TO POTENTIAL ADRIAN STEEL CUSTOMERS ONLY.



TOOL CHEST JOINING METHOD

JOINING
BRACKET
PLACED ONTO
TOOLCHEST
FLANGE

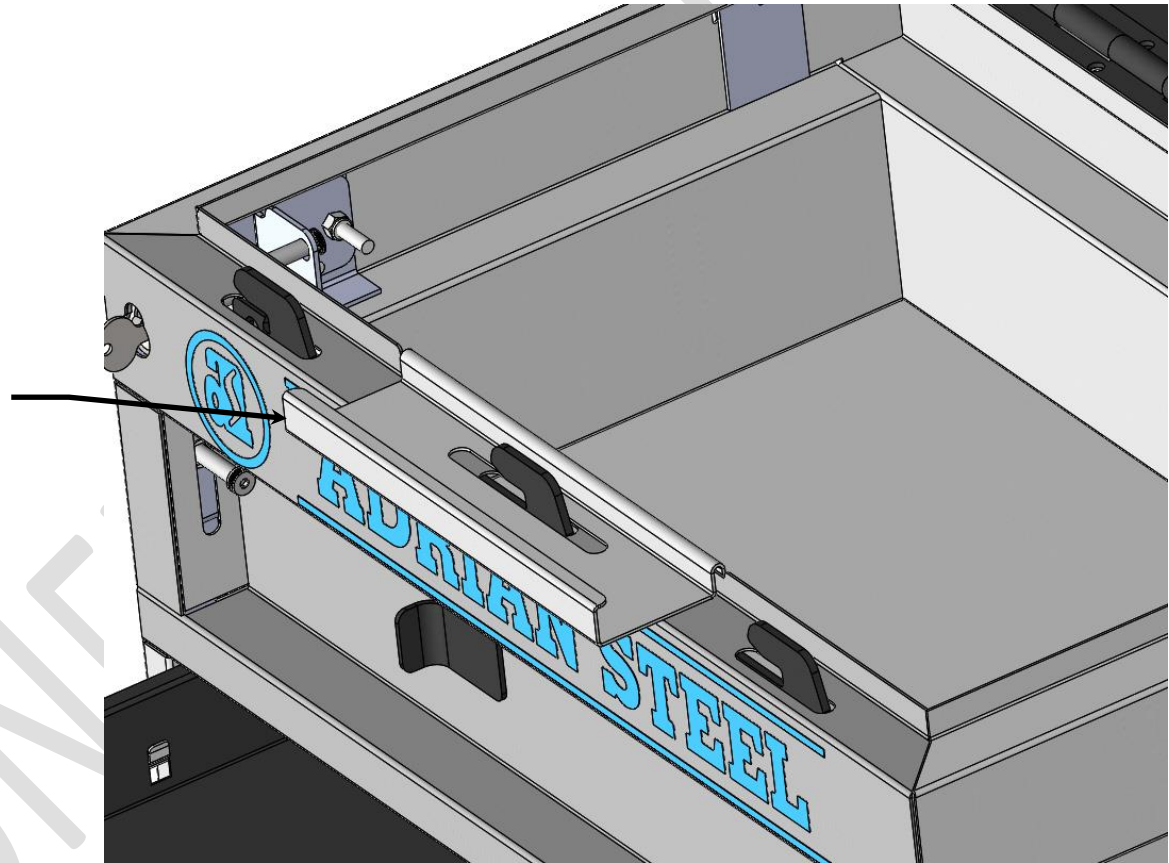

07/26/2017, ALL DESIGNS AND DESIGN CONCEPTS ARE THE INTELLECTUAL PROPERTY OF ADRIAN STEEL COMPANY AND ARE NOT TO BE COPIED, DISTRIBUTED OR COMMUNICATED TO OUTSIDE PARTIES WITHOUT THE EXPRESSED WRITTEN PERMISSION OF ADRIAN STEEL COMPANY. THE MATERIAL/CONCEPTS/DESIGNS CONTAINED WITHIN THIS DOCUMENT ARE FOR THE PURPOSE OF QUOTING/SUPPLYING PRODUCT TO POTENTIAL ADRIAN STEEL CUSTOMERS ONLY.



TOOL CHEST JOINING METHOD

TOOLCHEST LID
CLOSED AND LOCKED
WITH JOINING
BRACKET IN PLACE.

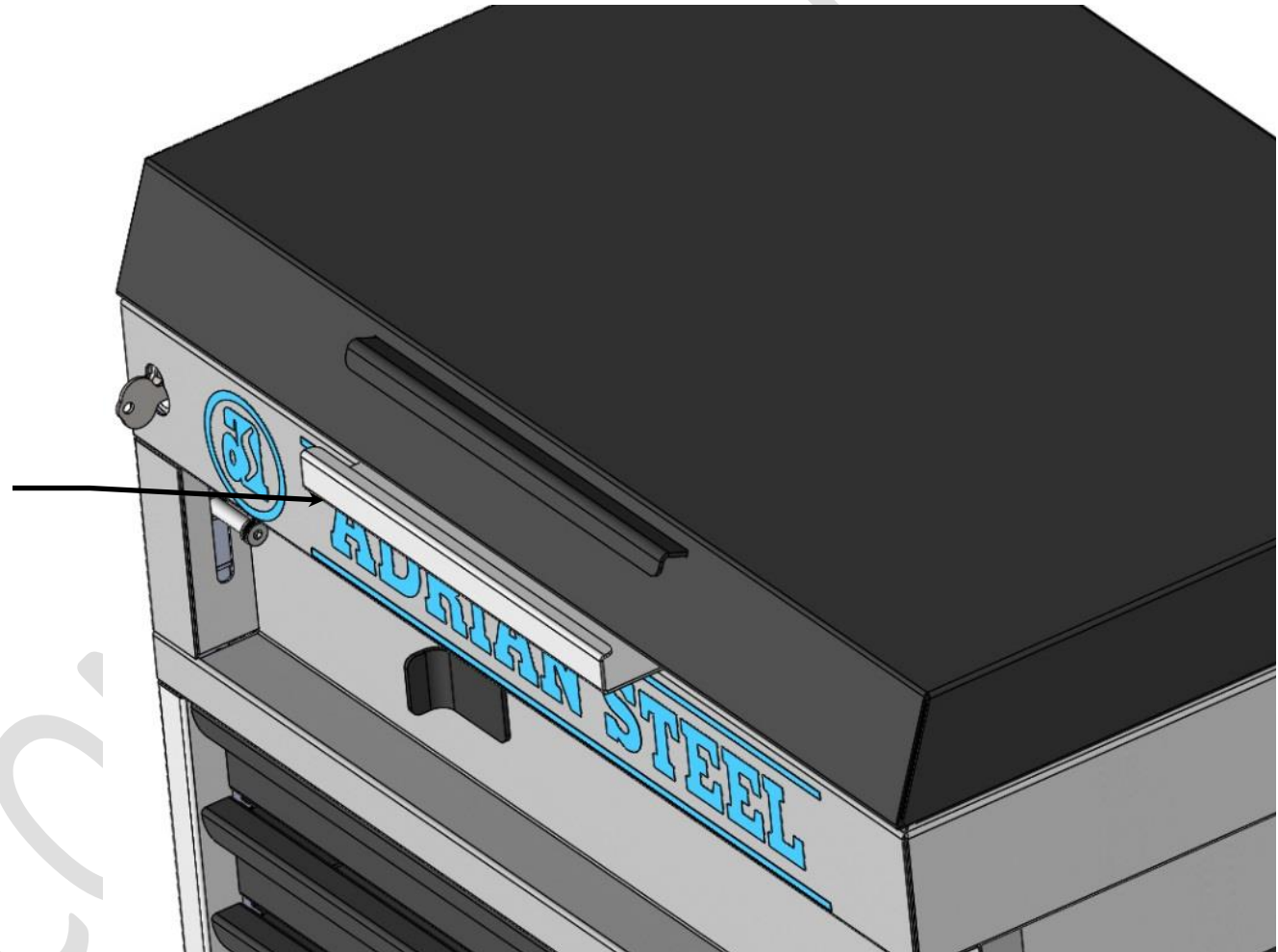

07/26/2017, ALL DESIGNS AND DESIGN CONCEPTS ARE THE INTELLECTUAL PROPERTY OF ADRIAN STEEL COMPANY AND ARE NOT TO BE COPIED, DISTRIBUTED OR COMMUNICATED TO OUTSIDE PARTIES WITHOUT THE EXPRESSED WRITTEN PERMISSION OF ADRIAN STEEL COMPANY. THE MATERIAL/CONCEPTS/DESIGNS CONTAINED WITHIN THIS DOCUMENT ARE FOR THE PURPOSE OF QUOTING/SUPPLYING PRODUCT TO POTENTIAL ADRIAN STEEL CUSTOMERS ONLY.



TOOL CHEST JOINING METHOD

TOOLCHEST
MOVED INTO
POSITION
AGAINST END
OF STORAGE
BOX.

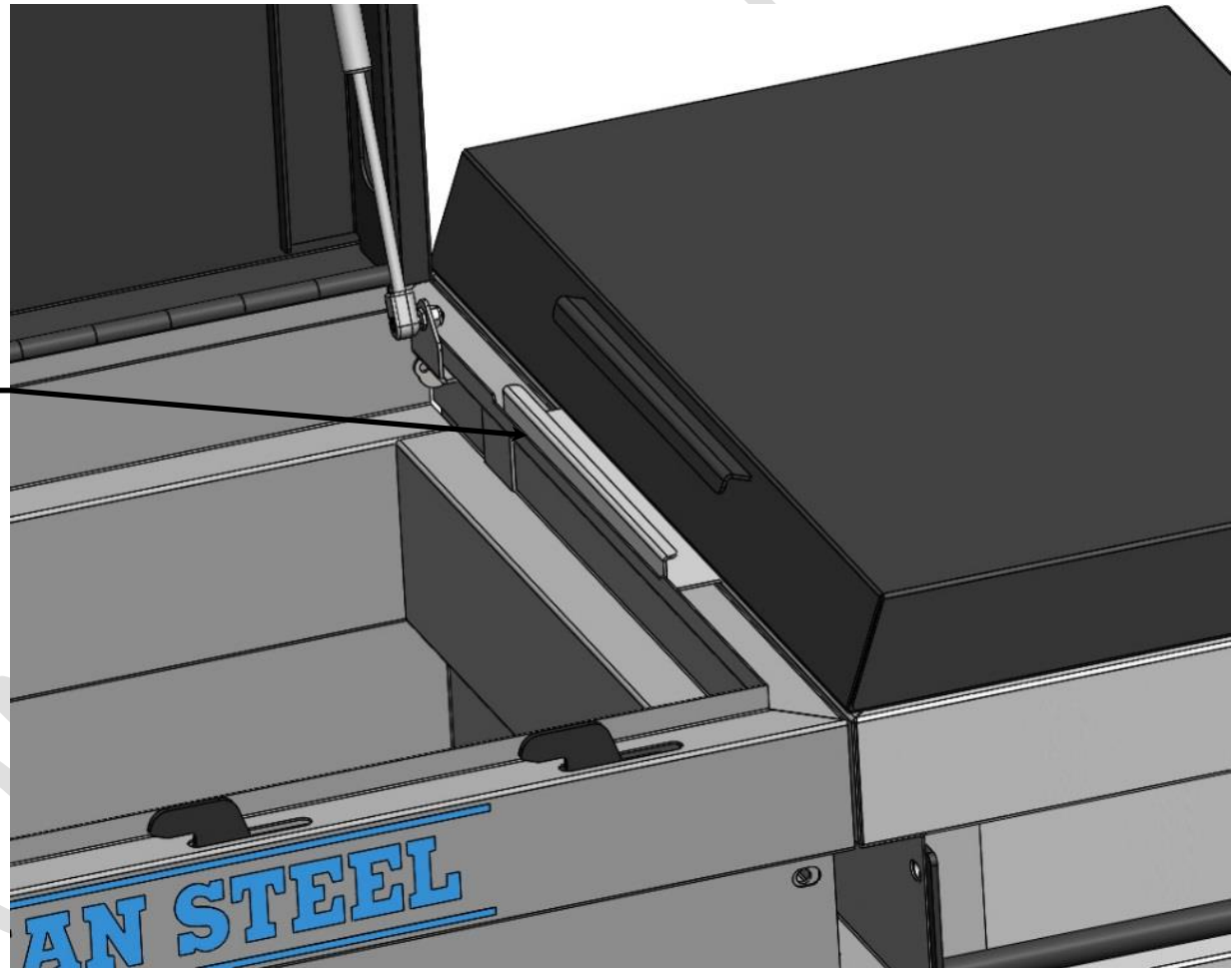

TOOL CHEST JOINING METHOD

07/26/2017, ALL DESIGNS AND DESIGN CONCEPTS ARE THE INTELLECTUAL PROPERTY OF ADRIAN STEEL COMPANY AND ARE NOT TO BE COPIED, DISTRIBUTED OR COMMUNICATED TO OUTSIDE PARTIES WITHOUT THE EXPRESSED WRITTEN PERMISSION OF ADRIAN STEEL COMPANY. THE MATERIAL/CONCEPTS/DESIGNS CONTAINED WITHIN THIS DOCUMENT ARE FOR THE PURPOSE OF QUOTING/SUPPLYING PRODUCT TO POTENTIAL ADRIAN STEEL CUSTOMERS ONLY.

**WITH STORAGE
BOX LID CLOSED
AND LOCKED
BOTH UNITS
ARE TIED
SECURED
TOGETHER.**

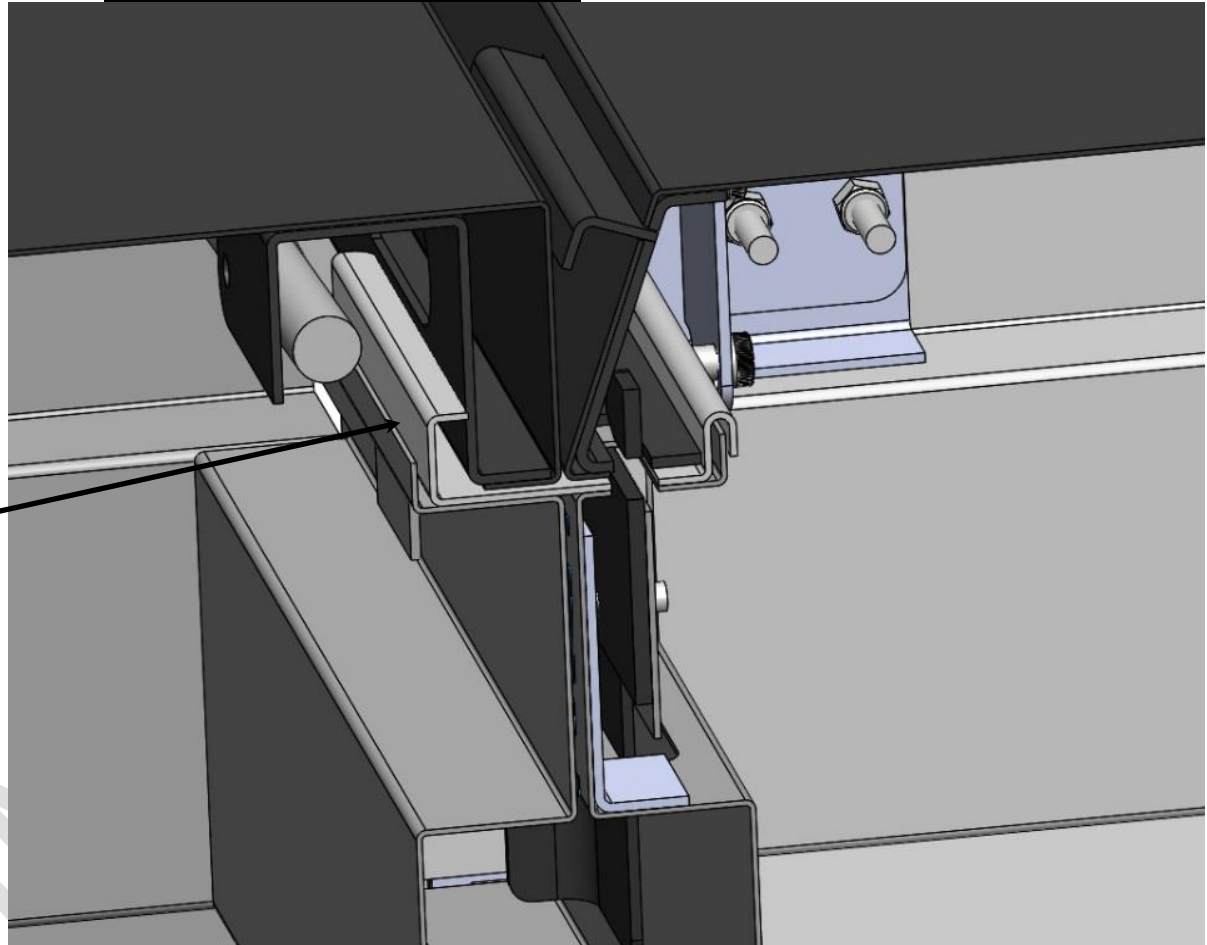



THYSSEN KRUPP VAN/WORKSITE STORAGE SOLUTION

**STREETSIDE
RETENTION CHANNEL
BRACKET**

**RETENTION PLATE IN
STOWED POSITION,
FLUSH TO FLOOR**

**STEEL FLOOR PLATE
(TREADPLATE)
INTERLOCK SYSTEM
ELIMINATES EXPOSED
FASTENER HEADS IN
WORKING AREA.**

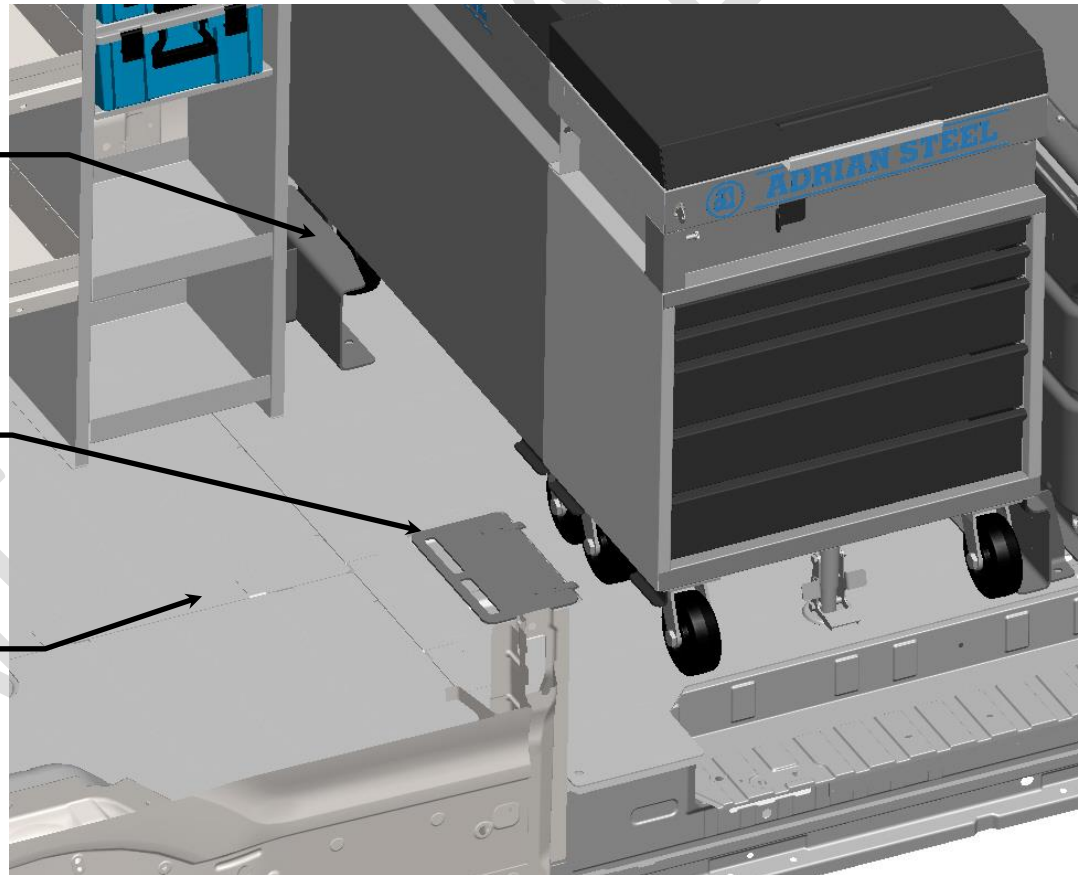

07/26/2017, ALL DESIGNS AND DESIGN CONCEPTS ARE THE INTELLECTUAL PROPERTY OF ADRIAN STEEL COMPANY AND ARE NOT TO BE COPIED, DISTRIBUTED OR COMMUNICATED TO OUTSIDE PARTIES WITHOUT THE EXPRESSED WRITTEN PERMISSION OF ADRIAN STEEL COMPANY. THE MATERIAL/CONCEPTS/DESIGNS CONTAINED WITHIN THIS DOCUMENT ARE FOR THE PURPOSE OF QUOTING/SUPPLYING PRODUCT TO POTENTIAL ADRIAN STEEL CUSTOMERS ONLY.



THYSSEN KRUPP VAN/WORKSITE STORAGE SOLUTION

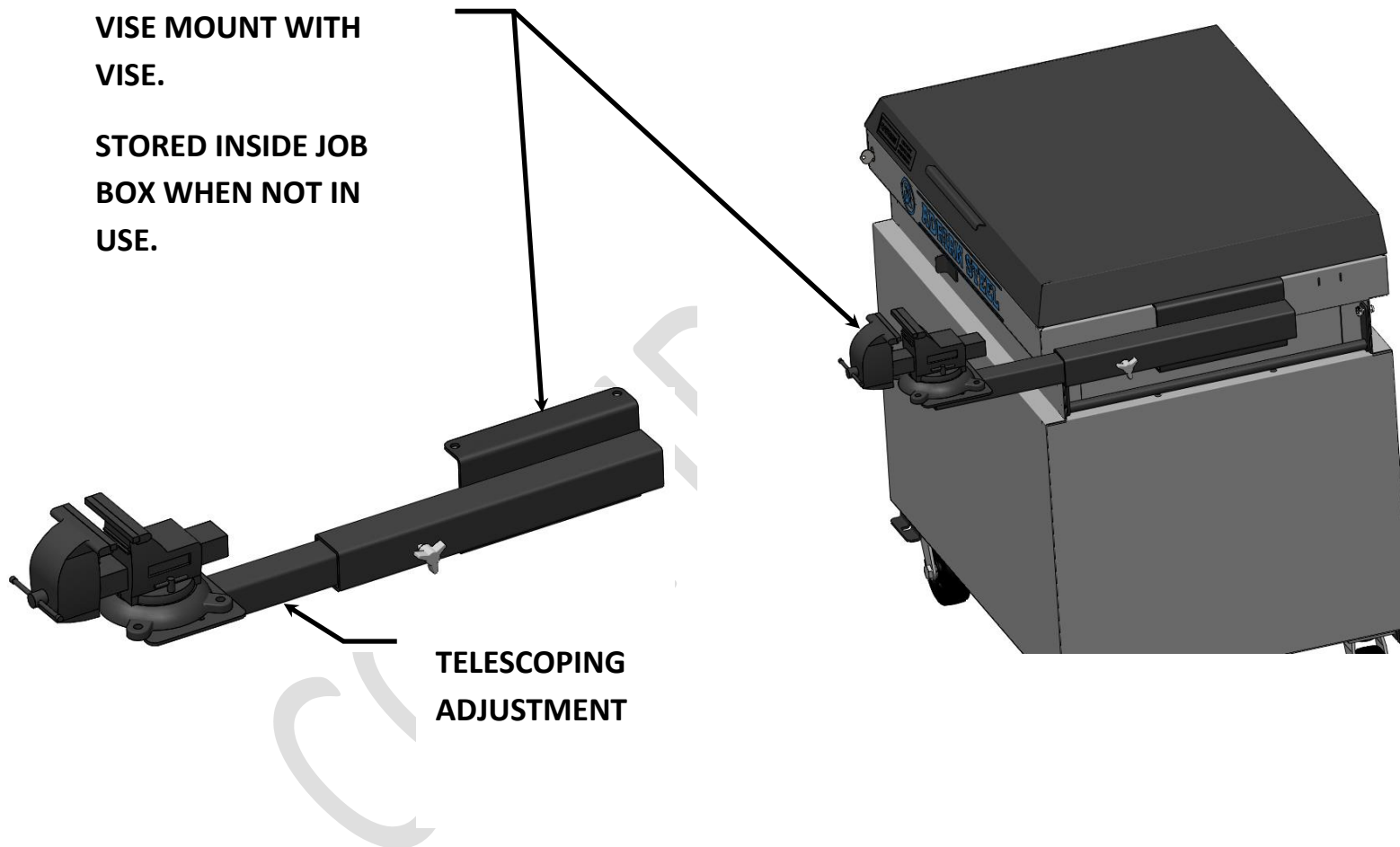

07/26/2017, ALL DESIGNS AND DESIGN CONCEPTS ARE THE INTELLECTUAL PROPERTY OF ADRIAN STEEL COMPANY AND ARE NOT TO BE COPIED, DISTRIBUTED OR COMMUNICATED TO OUTSIDE PARTIES WITHOUT THE EXPRESSED WRITTEN PERMISSION OF ADRIAN STEEL COMPANY. THE MATERIAL/CONCEPTS/DESIGNS CONTAINED WITHIN THIS DOCUMENT ARE FOR THE PURPOSE OF QUOTING/SUPPLYING PRODUCT TO POTENTIAL ADRIAN STEEL CUSTOMERS ONLY.



THYSSEN KRUPP VAN/WORKSITE STORAGE SOLUTION

HD LADDER KEEPER
LK8FT148HD
SAFETY YELLOW
PLASTISOL COATED
RETENTION BRACKETS

DESIGN FOR: WERNER 27FT. LADDER
MODEL: D6224-3 (MK1)
CAPACITY: 300lb
MAX EXTENSION: 23'
SECTIONS: 3 SECTIONS

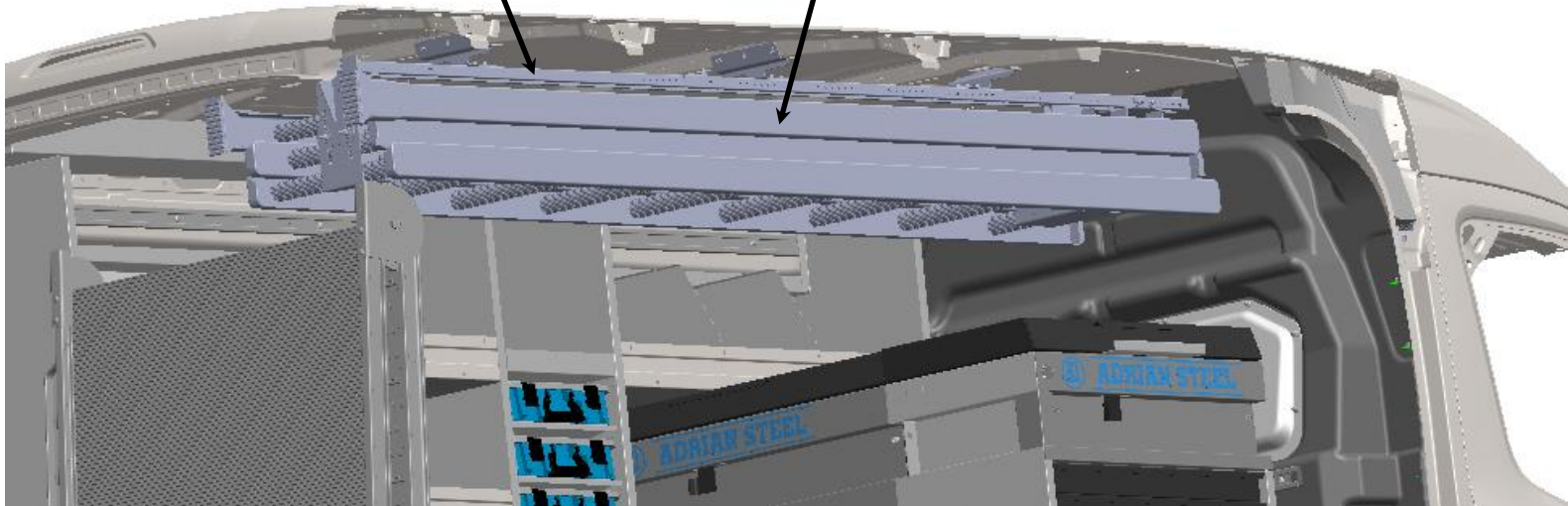

07/26/2017, ALL DESIGNS AND DESIGN CONCEPTS ARE THE INTELLECTUAL PROPERTY OF ADRIAN STEEL COMPANY AND ARE NOT TO BE COPIED, DISTRIBUTED OR COMMUNICATED TO OUTSIDE PARTIES WITHOUT THE EXPRESSED WRITTEN PERMISSION OF ADRIAN STEEL COMPANY. THE MATERIAL/CONCEPTS/DESIGNS CONTAINED WITHIN THIS DOCUMENT ARE FOR THE PURPOSE OF QUOTING/SUPPLYING PRODUCT TO POTENTIAL ADRIAN STEEL CUSTOMERS ONLY.



THYSSEN KRUPP VAN/WORKSITE STORAGE SOLUTION

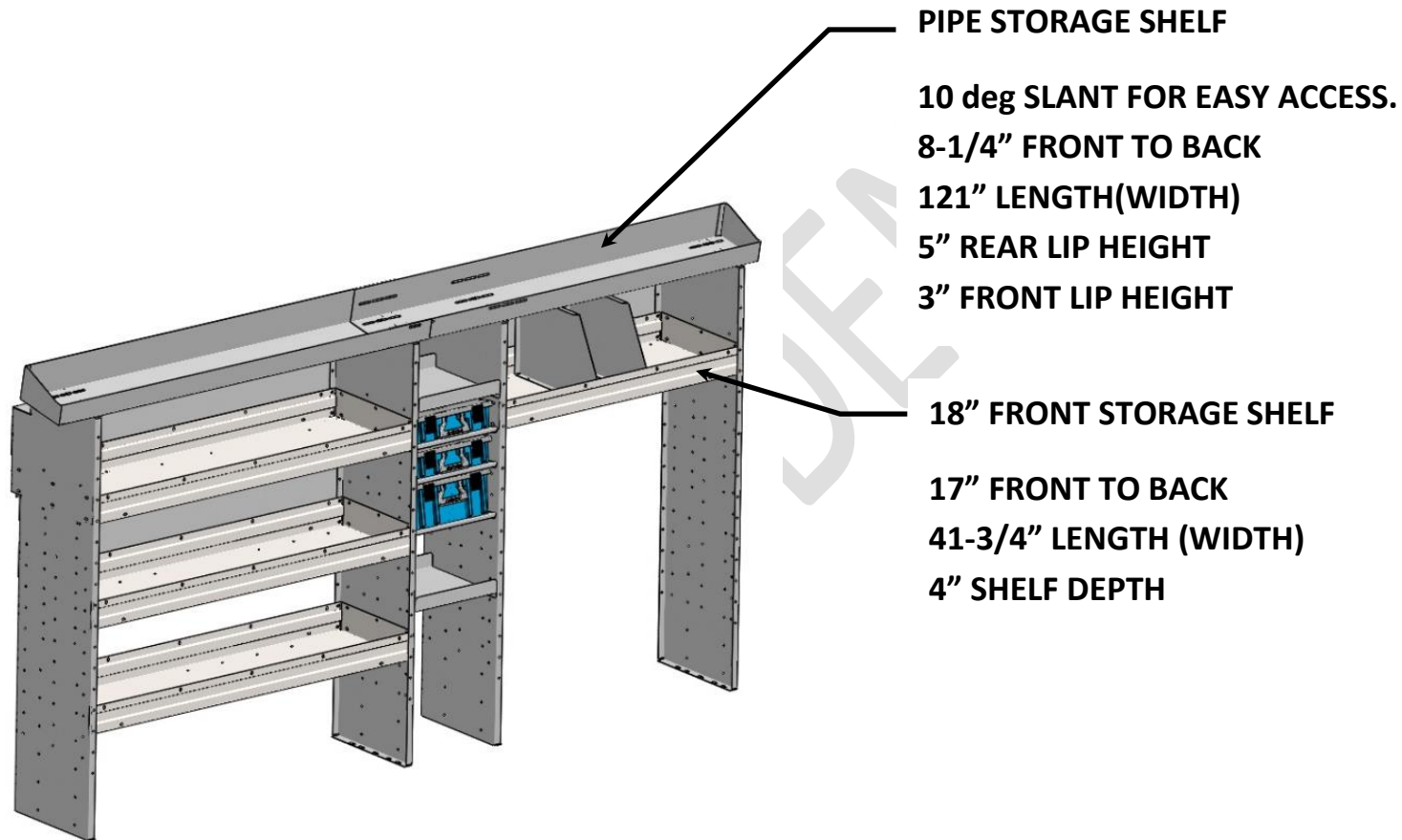

07/26/2017, ALL DESIGNS AND DESIGN CONCEPTS ARE THE INTELLECTUAL PROPERTY OF ADRIAN STEEL COMPANY AND ARE NOT TO BE COPIED, DISTRIBUTED OR COMMUNICATED TO OUTSIDE PARTIES WITHOUT THE EXPRESSED WRITTEN PERMISSION OF ADRIAN STEEL COMPANY. THE MATERIAL/CONCEPTS/DESIGNS CONTAINED WITHIN THIS DOCUMENT ARE FOR THE PURPOSE OF QUOTING/SUPPLYING PRODUCT TO POTENTIAL ADRIAN STEEL CUSTOMERS ONLY.



THYSSEN KRUPP VAN/WORKSITE STORAGE SOLUTION

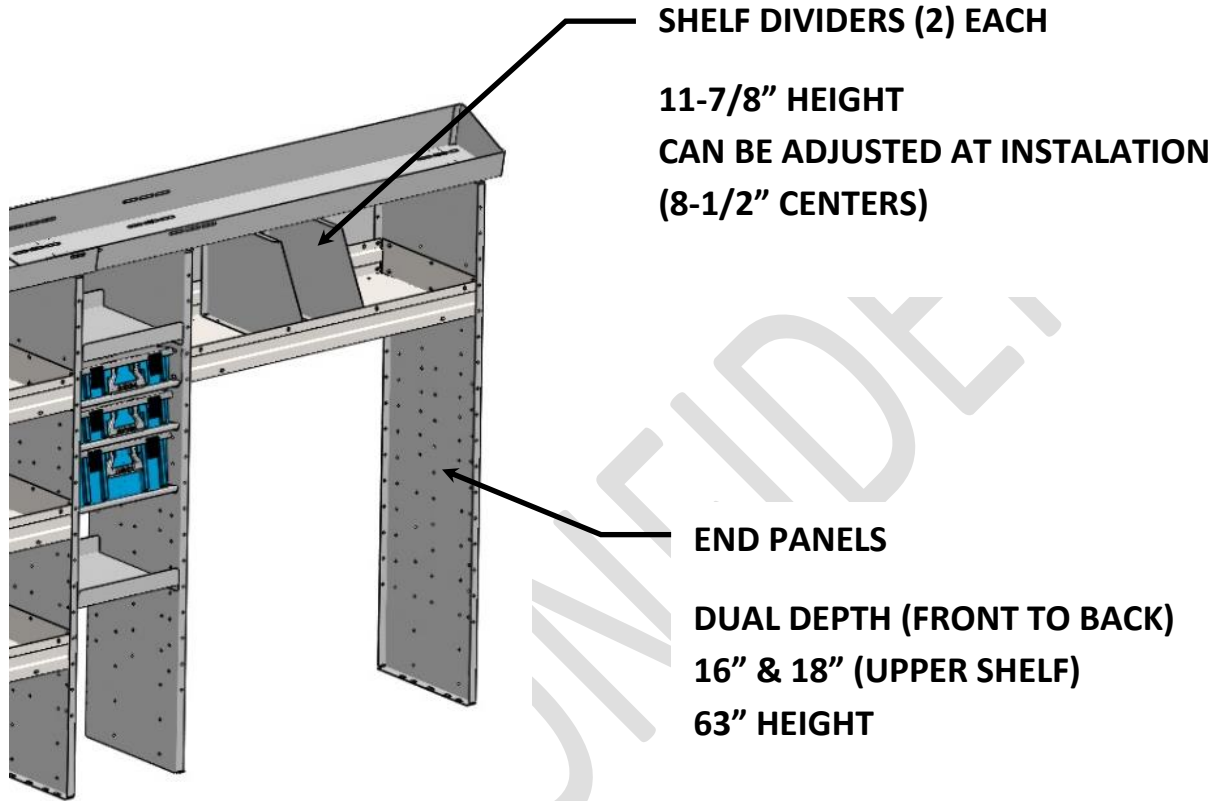

07/26/2017, ALL DESIGNS AND DESIGN CONCEPTS ARE THE INTELLECTUAL PROPERTY OF ADRIAN STEEL COMPANY AND ARE NOT TO BE COPIED, DISTRIBUTED OR COMMUNICATED TO OUTSIDE PARTIES WITHOUT THE EXPRESSED WRITTEN PERMISSION OF ADRIAN STEEL COMPANY. THE MATERIAL/CONCEPTS/DESIGNS CONTAINED WITHIN THIS DOCUMENT ARE FOR THE PURPOSE OF QUOTING/SUPPLYING PRODUCT TO POTENTIAL ADRIAN STEEL CUSTOMERS ONLY.

THYSSEN KRUPP VAN/WORKSITE STORAGE SOLUTION

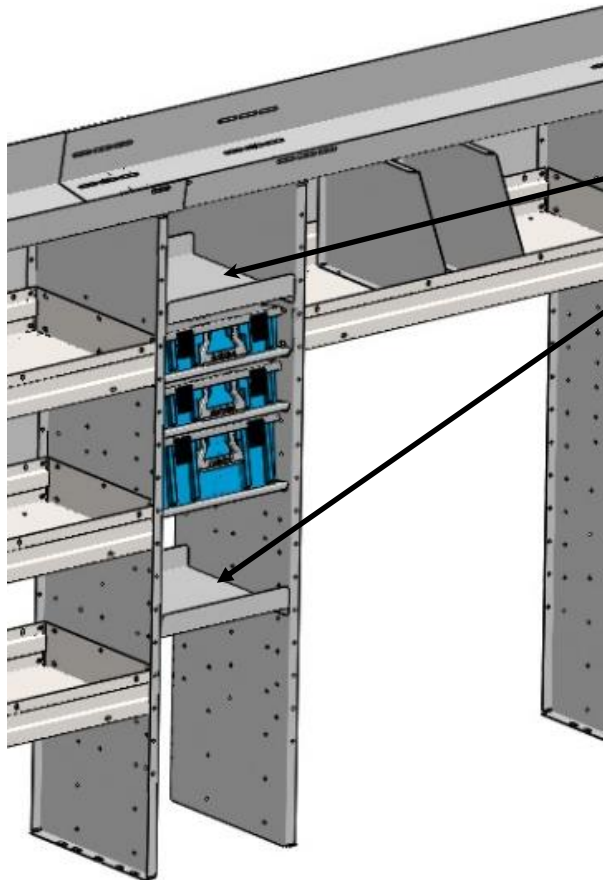

MID SHELF (2) EACH

14" FRONT TO BACK

14" WIDTH

2" SHELF LIPS

07/26/2017, ALL DESIGNS AND DESIGN CONCEPTS ARE THE INTELLECTUAL PROPERTY OF ADRIAN STEEL COMPANY AND ARE NOT TO BE COPIED, DISTRIBUTED OR COMMUNICATED TO OUTSIDE PARTIES WITHOUT THE EXPRESSED WRITTEN PERMISSION OF ADRIAN STEEL COMPANY. THE MATERIAL/CONCEPTS/DESIGNS CONTAINED WITHIN THIS DOCUMENT ARE FOR THE PURPOSE OF QUOTING/SUPPLYING PRODUCT TO POTENTIAL ADRIAN STEEL CUSTOMERS ONLY.



THYSSEN KRUPP VAN/WORKSITE STORAGE SOLUTION

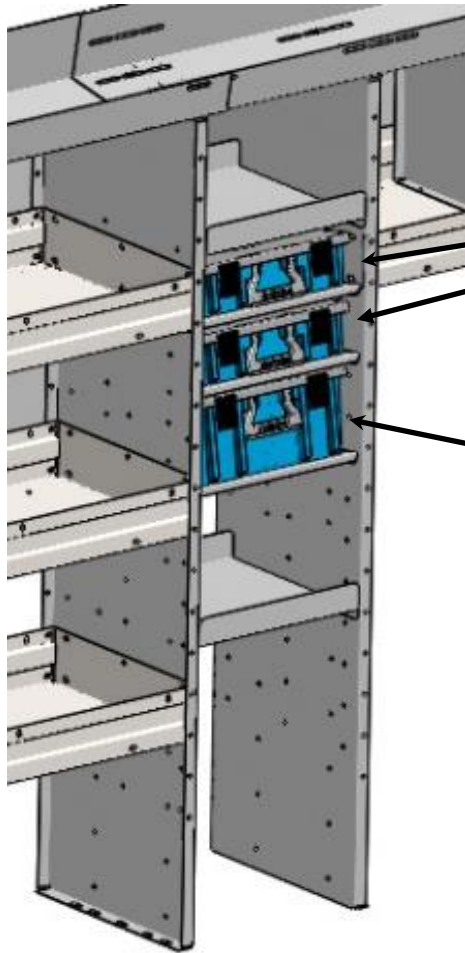

PORTABLE PARTS CASES
PPCS (2) EACH

OUTSIDE DIM: 13-7/8" x 14" X 3-5/8"
INSIDE DIM: 12-1/2" x 12-1/2" X 3-1/4"

PORTABLE PARTS CASE
PPCL (1) EACH

OUTSIDE DIM: 13-7/8" x 14" X 6-1/4"
INSIDE DIM: 12-1/2" x 12-1/2" X 5-7/8"

07/26/2017, ALL DESIGNS AND DESIGN CONCEPTS ARE THE INTELLECTUAL PROPERTY OF ADRIAN STEEL COMPANY AND ARE NOT TO BE COPIED, DISTRIBUTED OR COMMUNICATED TO OUTSIDE PARTIES WITHOUT THE EXPRESSED WRITTEN PERMISSION OF ADRIAN STEEL COMPANY. THE MATERIAL/CONCEPTS/DESIGNS CONTAINED WITHIN THIS DOCUMENT ARE FOR THE PURPOSE OF QUOTING/SUPPLYING PRODUCT TO POTENTIAL ADRIAN STEEL CUSTOMERS ONLY.



THYSSEN KRUPP VAN/WORKSITE STORAGE SOLUTION

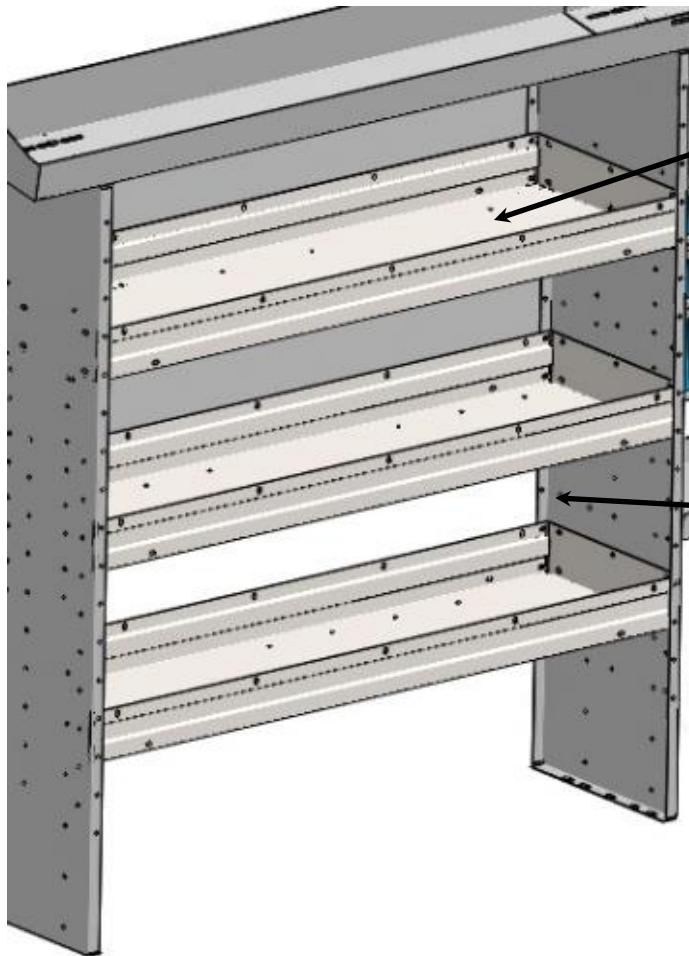

18" REAR UPPER STORAGE SHELF

17" FRONT TO BACK

55-3/4" LENGTH (WIDTH)

4" SHELF DEPTH

**16" REAR LOWER STORAGE SHELVES
(2) EACH**

15" FRONT TO BACK

55-3/4" LENGTH (WIDTH)

4" SHELF DEPTH

07/26/2017, ALL DESIGNS AND DESIGN CONCEPTS ARE THE INTELLECTUAL PROPERTY OF ADRIAN STEEL COMPANY AND ARE NOT TO BE COPIED, DISTRIBUTED OR COMMUNICATED TO OUTSIDE PARTIES WITHOUT THE EXPRESSED WRITTEN PERMISSION OF ADRIAN STEEL COMPANY. THE MATERIAL/CONCEPTS/DESIGNS CONTAINED WITHIN THIS DOCUMENT ARE FOR THE PURPOSE OF QUOTING/SUPPLYING PRODUCT TO POTENTIAL ADRIAN STEEL CUSTOMERS ONLY.



THYSSEN KRUPP VAN/WORKSITE STORAGE SOLUTION

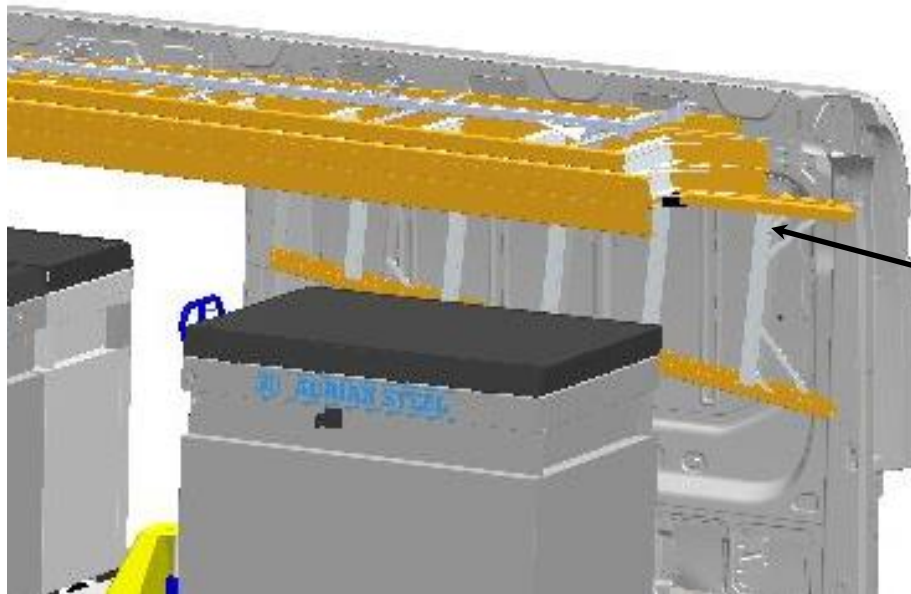

**CURBSIDE LADDER STORAGE HOOKS
DESIGNED FOR A 5 FT STEP LADDER**

07/26/2017, ALL DESIGNS AND DESIGN CONCEPTS ARE THE INTELLECTUAL PROPERTY OF ADRIAN STEEL COMPANY AND ARE NOT TO BE COPIED, DISTRIBUTED OR COMMUNICATED TO OUTSIDE PARTIES WITHOUT THE EXPRESSED WRITTEN PERMISSION OF ADRIAN STEEL COMPANY. THE MATERIAL/CONCEPTS/DESIGNS CONTAINED WITHIN THIS DOCUMENT ARE FOR THE PURPOSE OF QUOTING/SUPPLYING PRODUCT TO POTENTIAL ADRIAN STEEL CUSTOMERS ONLY.



THYSSEN KRUPP VAN/WORKSITE STORAGE SOLUTION

NATIONAL FLEET
STOWABLE RAMP.

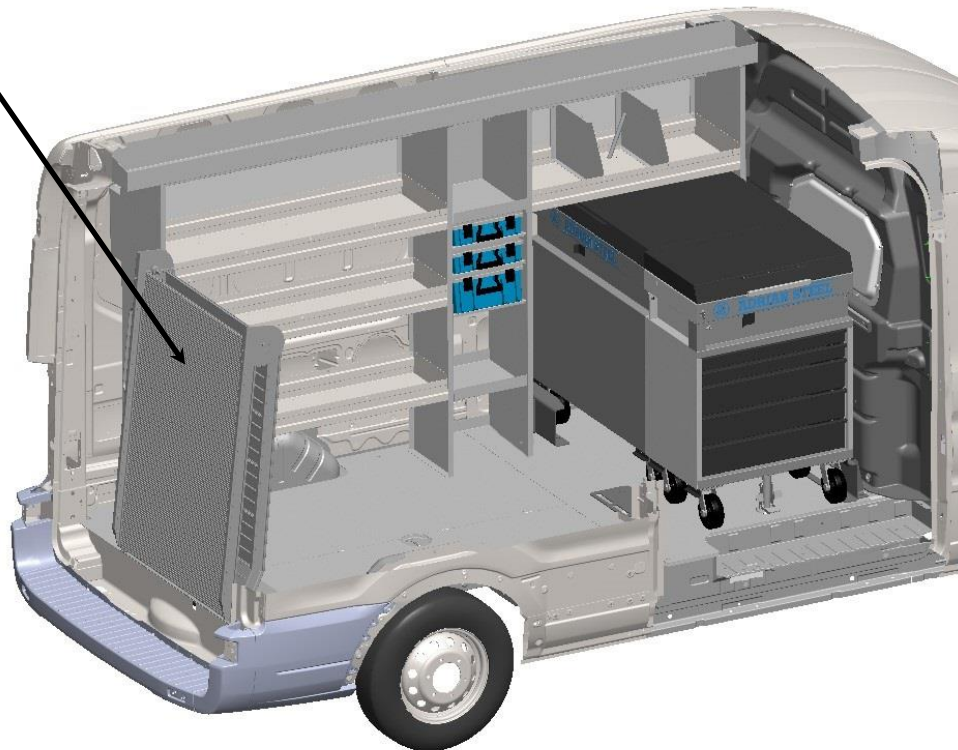

07/26/2017, ALL DESIGNS AND DESIGN CONCEPTS ARE THE INTELLECTUAL PROPERTY OF ADRIAN STEEL COMPANY AND ARE NOT TO BE COPIED, DISTRIBUTED OR COMMUNICATED TO OUTSIDE PARTIES WITHOUT THE EXPRESSED WRITTEN PERMISSION OF ADRIAN STEEL COMPANY. THE MATERIAL/CONCEPTS/DESIGNS CONTAINED WITHIN THIS DOCUMENT ARE FOR THE PURPOSE OF QUOTING/SUPPLYING PRODUCT TO POTENTIAL ADRIAN STEEL CUSTOMERS ONLY.