

WKC1PM3 WING KIT PROMASTER

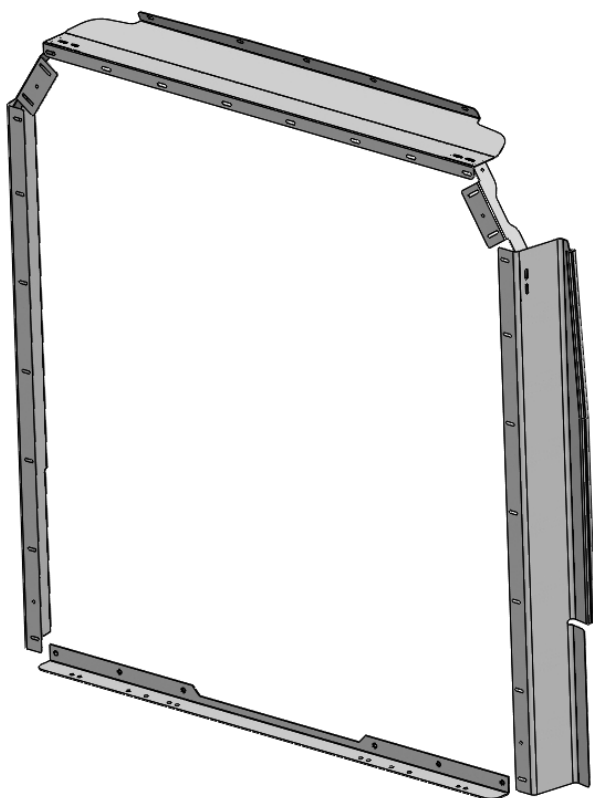

PRODUCT WEIGHT

36.95 LBS

WIDTH x DEPTH x HEIGHT

71" x 9.75" x 65.8"

CAPACITY

N/A

COLOR

GRAY

CATALOG NUMBER

WKC1PM3

Partition panels are sold separately.

PRODUCT FEATURES

Steel partition wing kit (using appropriate panel kit) for Pro Master FSV standard roof provides a solution for separating the cab area from the cargo area. The steel partition features the use of OEM attachment points for a clean installation.

FLEET ONLY!

SEE PAGE 2 FOR APPLICATION NOTES AND ACCESSORIES, OTHER PRODUCTS THAT WORK WITH THIS UNIT.

PAGE 1 of 2

The information contained in this document is the sole property of ADRIAN STEEL COMPANY. ADRIAN STEEL COMPANY retains the right to modify and/or change the product of its design at any time without prior notification.

Accessory Chart

	Cargo Side	Cab Side
	Base Partition BAGRKA1 REQUIRED (1 BAGRKA1 will allow for one accessory to be added)	None available
Available Accessories	-	-
PA7: Reflector kit	x	-
PA8: Fire ext.	x	-
PA9: First aid tray	x	-
PA10: Practice holder	-	-
PA11: Cab file	-	-
PA11NL: Catalog box	-	-
TA1: Four hook bar	-	-
TH30: 30lb tank holder	-	-
TH50: 50lb tank holder	-	-
UH50RM1: Rail mount kit	-	-
UH10: 1" hook	-	-
UH25: 2.5" hook	-	-
UH25CP-G: 2.5' hook comp	-	-
UH50: 5" hook	x	-



**WKC1PM, WING KIT PRO-MASTER STD.
WKC1PM3, WING KIT PRO-MASTER +3
S_M_C_PM, PARTITION PANEL KITS**

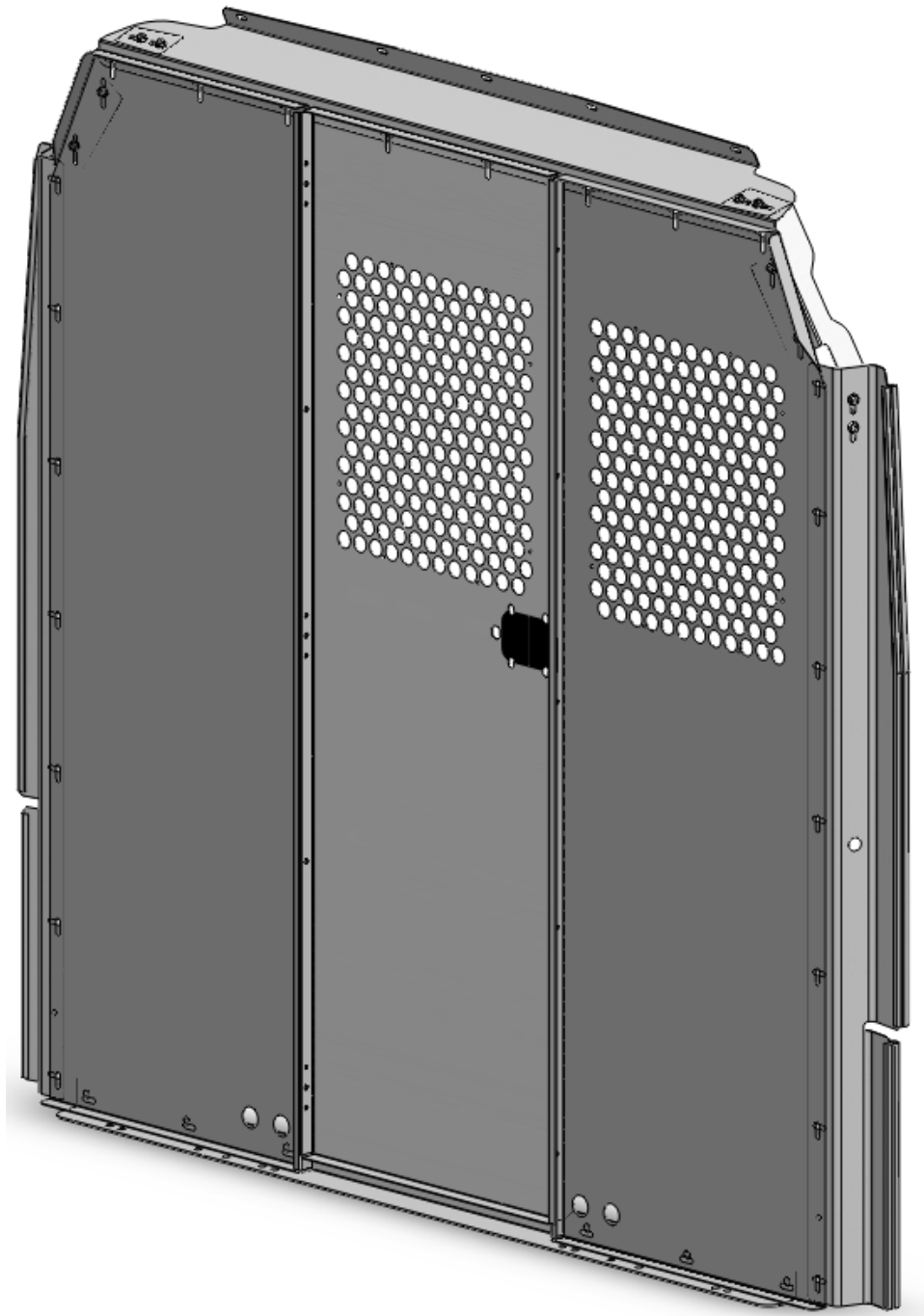

- PRECAUTIONS -





 **CAUTION** 
**THE USE OF AIR IMPACT TOOLS CAN
OVER-TORQUE FASTENERS AND
CAUSE FASTENER FAILURE!**



 **CAUTION** 
**ALL INSTALLATION HOLES SHOULD BE SEALED
WITH SILICON OR BUTYL SEALANT TO PREVENT
EXHAUST FUMES FROM ENTERING THE VEHICLE!**



 **DANGER** 
**INSPECT FOR FUEL TANK, FUEL LINES, BRAKE LINES, HIGH
VOLTAGE BATTERIES AND ELECTRICAL LINES PRIOR TO
DRILLING TO AVOID DAMAGING CRITICAL VEHICLE SYSTEMS
OR INJURY TO INSTALLER DURING INSTALLATION PROCESS!**



 **CAUTION** 
**TO AVOID DAMAGING THE VEHICLE ALWAYS
USE DRILL STOPS WHEN DRILLING ANY IN-
STALLATION HOLES!**



- IMPORTANT WARRANTY REQUIREMENTS -

1. SUBSTITUTING ADRIAN STEEL SPECIFIED FASTENERS FOR ASSEMBLY AND/OR INSTALLATION WILL VOID YOUR PRODUCT WARRANTY.
2. ALL HOLES DRILLED INTO VEHICLE SHOULD HAVE THE RAW METAL EDGES SEALED WITH A SELF-ETCHING PRIMER TO RESIST CORROSION AND POTENTIAL FASTENER POINT FAILURE.
3. ALL FASTENERS USED IN THE INSTALLATION OF THIS PRODUCT SHOULD BE TIGHTENED TO THE TORQUE(S) SPECIFIED IN THESE INSTRUCTIONS.
4. THESE INSTRUCTIONS SHOULD BE KEPT WITH THE VEHICLE.

THE BASIC TOOLS NEEDED FOR MOST INSTALLATIONS



DRILL



DRILL BIT WITH
STOP



RATCHET, SOCKETS
AND/OR WRENCHES



SCREWDRIVERS



MEASURING TAPE

ADDITIONAL TOOLS MAY BE NEEDED FOR THIS INSTALLATION AND THEY WILL BE IDENTIFIED IN THE STEPS THAT FOLLOW.

If your vehicle contains carpet or a rubber floor mat you will need to prepare the mounting location. Position the product to be installed into the vehicle and once you are satisfied with the mounting locations, mark the mounting locations. Using a 1-3/16" diameter carpet cutter (P/N: 31183-0). Select the appropriate floor spacers as shown in the illustration. Set those aside for use later into the installation process.

Using the correct drill bit size for the selected plusnut, drill the mounting holes in the vehicle sheet metal to prepare for installing the plusnuts.

If you are thru-bolting at any of the locations simply drill a hole that is 1/16" larger than the bolt size(s) for those locations.

Once you have drilled the holes into the vehicle, the raw metal edges should be sealed using a self-etching primer to resist corrosion and potential fastener point failure.

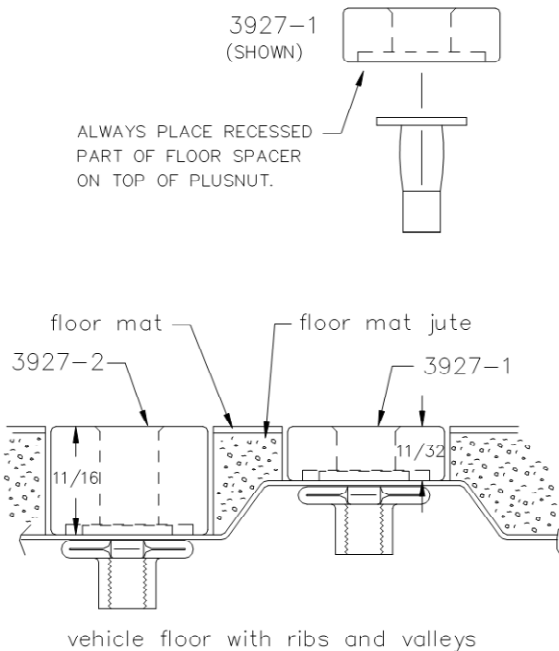

A PLUSNUT (RIVNUT) SETTING TOOL IS REQUIRED FOR PLUSNUT (RIVNUT) INSTALLATION AND IS SUPPLIED WITH THIS KIT. OR USE AN AIR POWERED PLUSNUT SETTING GUN.

1/4-20UNC Plusnut (FAS0052) Use 3/8" dia. drill w/stop

FAS0080 SCREW, HXHD, 1/4-20UNCx2.00", G8
FAS0067 WASHER, FLAT, 1/4"ID
22200-0 PLUSNUT TOOL

5/16-18UNC Plusnut (FAS0091) Use 1/2" dia. drill w/stop

FAS0095 SCREW, HXHD, 5/16-18UNCx2.00", G8
FAS0086 WASHER, FLAT, 5/16"ID
22200-0 PLUSNUT TOOL

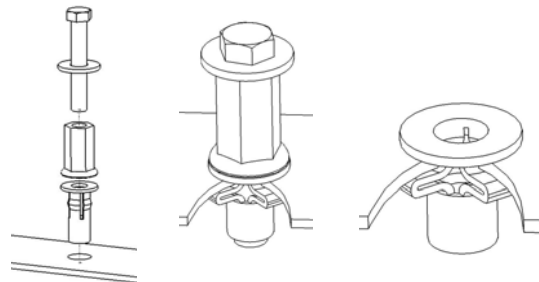

Place barrel of the plusnut body in sheet metal thru hole until flange is flush with sheet metal.

Using a 9/16" combination wrench of plusnut tool body and a second hand wrench, ratchet, or air tool, rotate the hex bolt head CW to draw plus nut flanges up (set the plusnut).

Assembly and Installation Fastener Identification Sheet

ITEM NO.	PART NUMBER	DESCRIPTION	BAG44683/QTY.
1	03927-1	Floor Spacer Short	6
2	FAS0086	WASHER,FLAT USS 5/16 ZP	6
3	FAS0098	Washer, Lock, Split, 5/16, Zinc Plate	6
4	FAS0018	SCREW,HH SFLNG 1/4-20X.62 ZP	56
5	FAS0055	NUT,HEX NLK FLG 1/4-20 ZP	46
6	FAS0557	WASHER, RET 5/16, NY	6
7	FAS0091	Plusnut, 5/16	6
8	FAS0095	Screw, Hex Hd, 5/16-18x2.00 , Grade 8	6
9	FAS0187	SCR,HH,M6-1.0X22	15
10	FAS 0066	Washer, Lock, Ext. Tooth, 1/4	15
11	FAS0234	Washer, Flat, 1/4, SST	15
12	FAS0052	PLUSNUT, 1/4-20 PB DC	6
13	BAG0710-A	7" X 10" 4MIL AUTOBAG	1
14	36096-0	GROMMET,RUBBER,7/8 ID	4

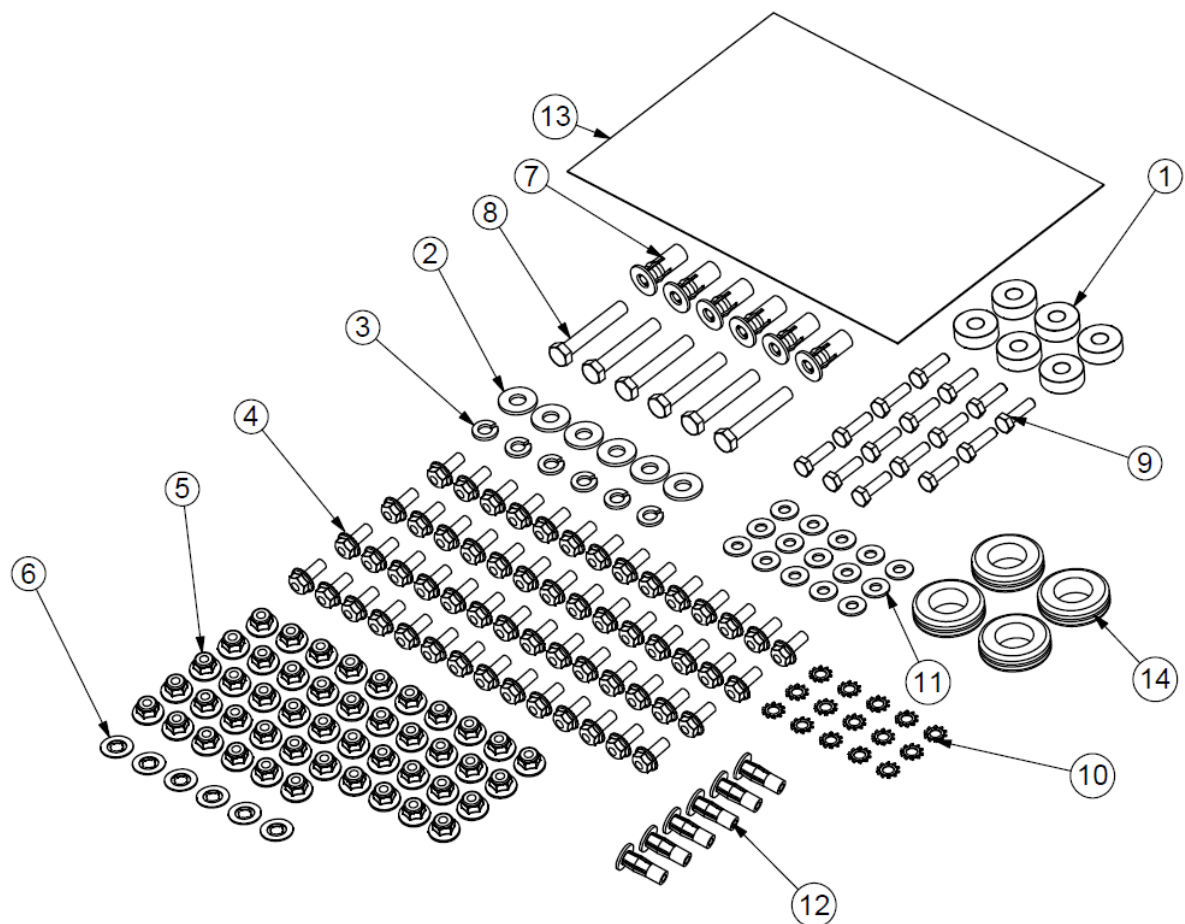

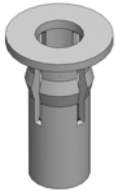
PARTS YOU WILL USE FOR STEP 01	COMMON PART FAS0091, PLUSNUT 1/4 (5) REQUIRED			
				

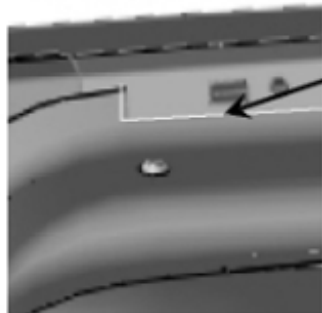
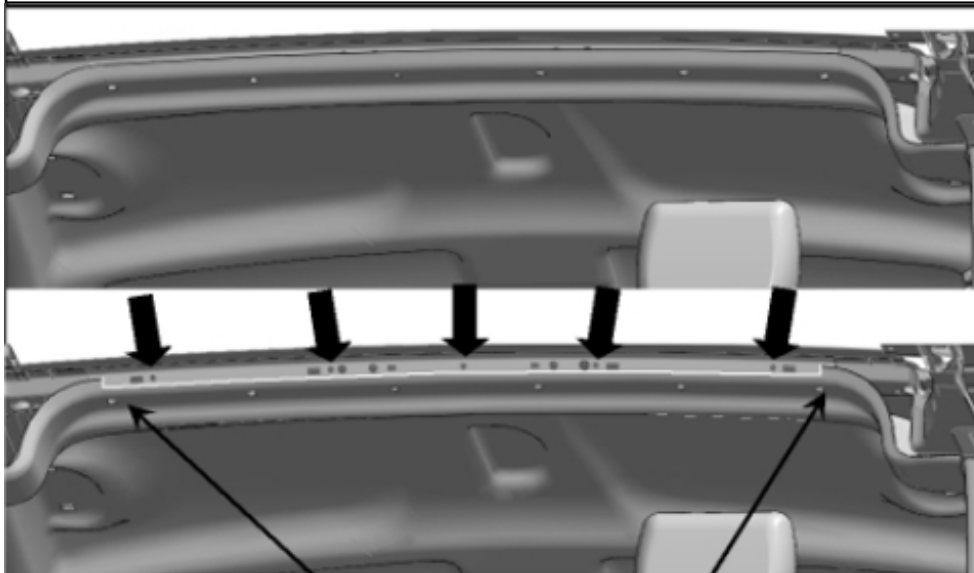

Instructions for Step 01



**TRIM AWAY AREA 45-1/2"
WIDE DOWN TO BEGINNING
OF RADIUS OF HEADLINER
FLANGE AS SHOWN.**

USING A UTILITY KNIFE CAREFULLY TRIM AWAY THE BACK EDGE OF THE HEADLINER AS SHOWN TO EXPOSE THE ROOF BOW MOUNTING AREA FOR THE PARTITION HEADER.

INSERT AND SET FIVE(5) 1/4" PLUSNITES IN THE VEHICLE ROOFBOW HOLES INDICATED.

PARTS YOU WILL USE FOR STEP 02	COMMON PART 44674-G, FLOOR RAIL (1) REQUIRED	COMMON PART FAS0091, PLUSNUT 5/16 (6) REQUIRED		
				

Instructions for Step 02

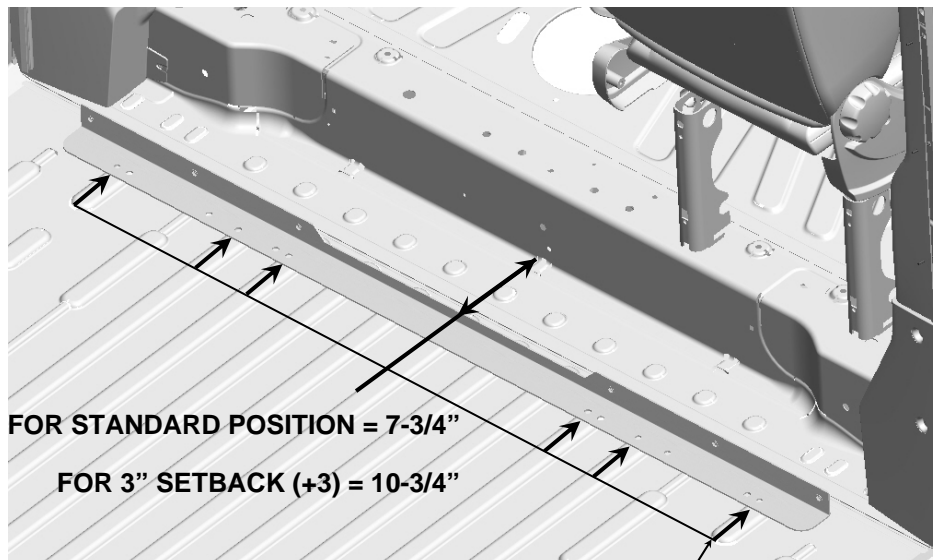

MARK LOCATIONS AND SET PLUSNUTS AT EACH FLOOR RIB AS SHOWN

POSITION FLOOR RAIL AS SHOWN;







FOR STANDARD POSITION = 7-3/4" BACK FROM THE CAB AREA STEP TO THE FRONT FACE (TOWARD CAB) OF THE FLOOR RAIL.

FOR 3" SETBACK (+3) POSITION = 10-3/4" BACK FROM THE CAB AREA STEP TO THE FRONT FACE (TOWARD CAB) OF THE FLOOR RAIL.

MAKE SURE THAT FLOOR RAIL IS CENTERED LEFT-TO-RIGHT. FLOOR RAIL MOUNTING HOLES (6) HOLES) ALIGN WITH THE FLOOR RIBS AS SHOWN. MARK THE LOCATIONS, DRILL AND SET PLUSNUTS FOR FLOOR RAIL.

PLACE FLOOR RAIL ASIDE TO BE ASSEMBLED TO PARTITION PANELS.



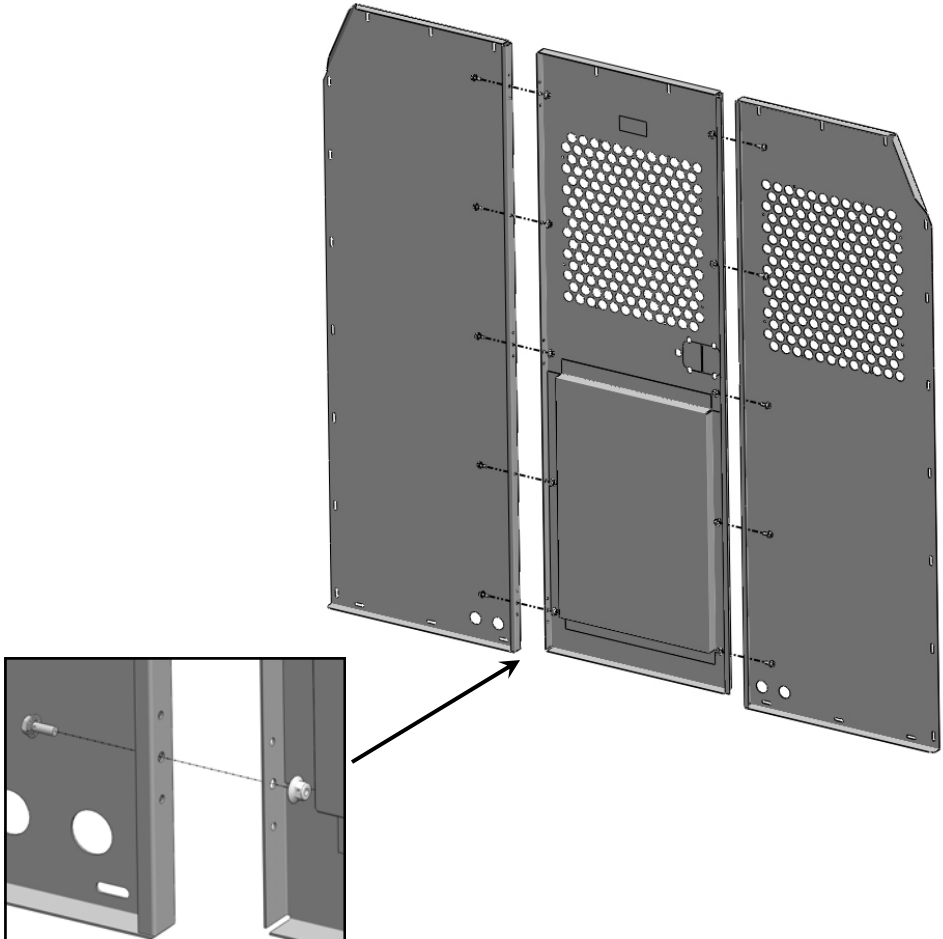

PARTS YOU WILL USE FOR STEP 03	COMMON PART 44688-G, S1 PANEL (1) REQUIRED	COMMON PART FAS0018, SCREW,HH 1/4 (10) REQUIRED	SOLID PANEL 44700-G, M1 PANEL (1) REQUIRED	SOLID PANEL 44686, C1 PANEL (1) REQUIRED
				
		COMMON PART FAS0055, NUT,HEX 1/4 (10) REQUIRED	PERFORATED PANEL 44701-G, M2 PANEL (1) REQUIRED	PERFORATED PANEL 44687-G, C2 PANEL (1) REQUIRED
				

Instructions for Step 03



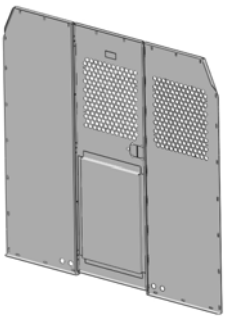



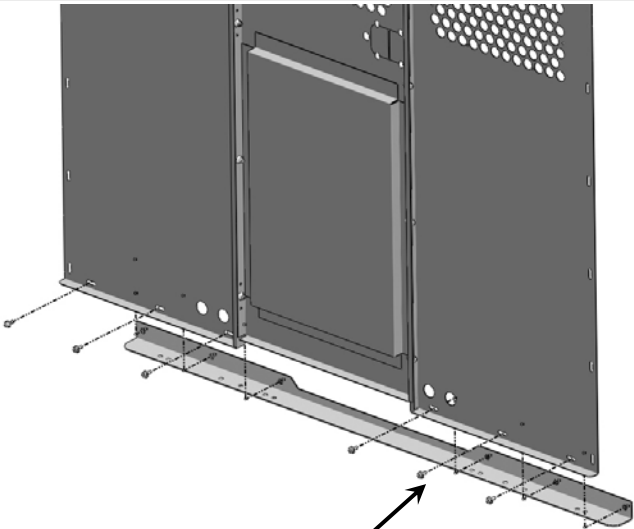
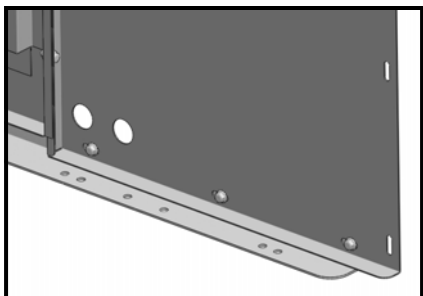

ASSEMBLE THE APPROPRIATE S-M-C PANEL TOGETHER AS SHOWN USING THE ABOVE LISTED FASTENERS

PARTS YOU WILL USE FOR STEP 04	ASSEMBLY FROM PREVIOUS STEP	COMMON PART FAS0018, SCREW,HH 1/4 (6) REQUIRED	COMMON PART 44674-G, FOOTER RAIL (1) REQUIRED	
				

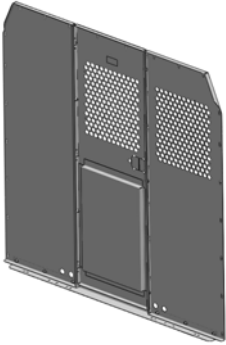
Instructions for Step 04





ATTACH FOOTER RAIL TO BOTTOM OF THE PARTITION PANELS AS SHOWN USING THE FASTENERS SHOWN ABOVE. DO NOT FULLY TIGHTEN THESE FASTENERS. ADJUSTMENT MAY BE NEEDED DURING FINAL STEPS.

PARTS YOU WILL USE FOR STEP 05	ASSEMBLY FROM PREVIOUS STEP	COMMON PART FAS0018, SCREW, HH 1/4 (14) REQUIRED	FOR STANDARD POS. 44685-G, WING, SS (1) REQUIRED	FOR STANDARD POS. 44684-G, WING, CS (1) REQUIRED
				
		COMMON PART FAS0055, NUT, HEX 1/4 (14) REQUIRED	FOR 3" SETBACK POS. 44707-G SS +3 (1) REQUIRED	FOR 3" SETBACK POS. 44706-G, CS +3 (1) REQUIRED
				

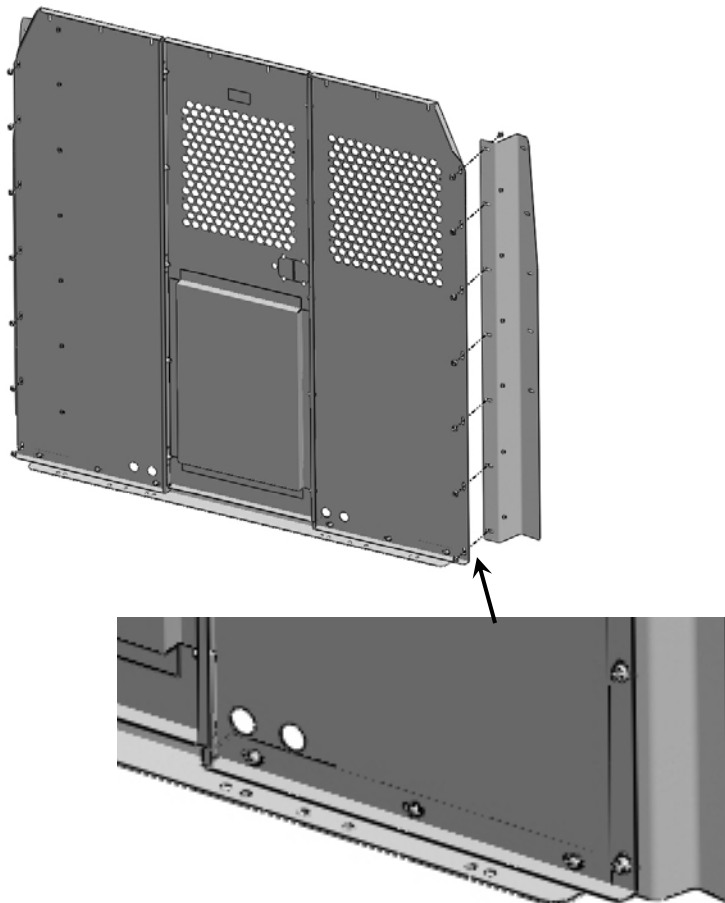
Instructions for Step 05



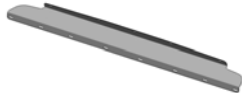

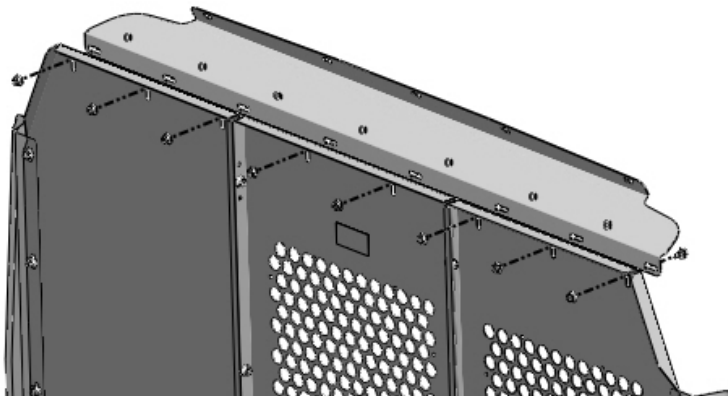

ATTACH THE APPROPRIATE WINGS TO THE PARTITION PANELS AS SHOWN USING THE FASTENERS SHOWN ABOVE. DO NOT FULLY TIGHTEN THESE FASTENERS. ADJUSTMENT MAY BE NEEDED DURING FINAL STEPS.

PARTS YOU WILL USE FOR STEP 06	ASSEMBLY FROM PREVIOUS STEP	COMMON PART FAS0018, SCREW,HH 1/4 (8) REQUIRED	FOR STANDARD POS. 44675-G, HDR PNL (1) REQUIRED	FOR 3" SETBACK POS. 44708-G, HDR PNL +3 (1) REQUIRED
				
		COMMON PART FAS0055, NUT,HEX 1/4 (8) REQUIRED 		

Instructions for Step 06

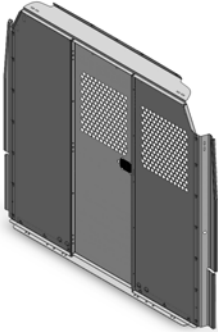

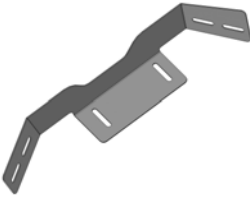
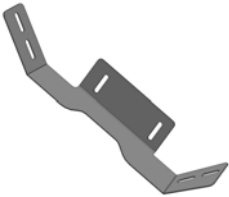
ATTACH THE APPROPRIATE HEADER PANEL TO THE PARTITION PANELS AS SHOWN USING THE FASTENERS SHOWN ABOVE. DO NOT FULLY TIGHTEN THESE FASTENERS. ADJUSTMENT MAY BE NEEDED DURING FINAL STEPS.

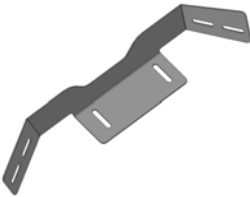
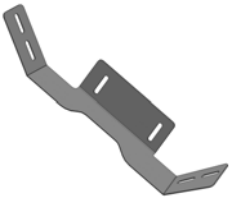

PARTS YOU WILL USE FOR STEP 07	ASSEMBLY FROM PREVIOUS STEP	COMMON PART FAS0018, SCREW, HH 1/4 (12) REQUIRED	FOR STANDARD POS. 46824-G, WING BRAC. (1) REQUIRED	FOR STANDARD POS. 46825-G, WING BRAC. (1) REQUIRED
				
		COMMON PART FAS0055, NUT, HEX 1/4 (12) REQUIRED	FOR 3" SETBACK POS. 46838-G WING BRAC. (1) REQUIRED	FOR 3" SETBACK POS. 46839-G WING BRAC. (1) REQUIRED
				

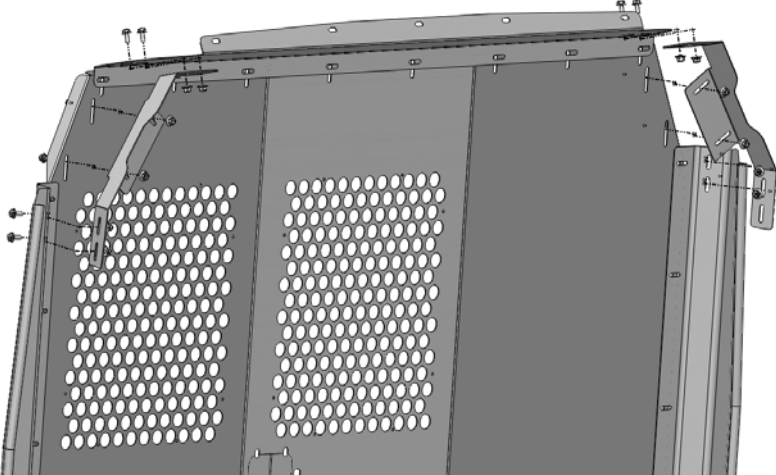
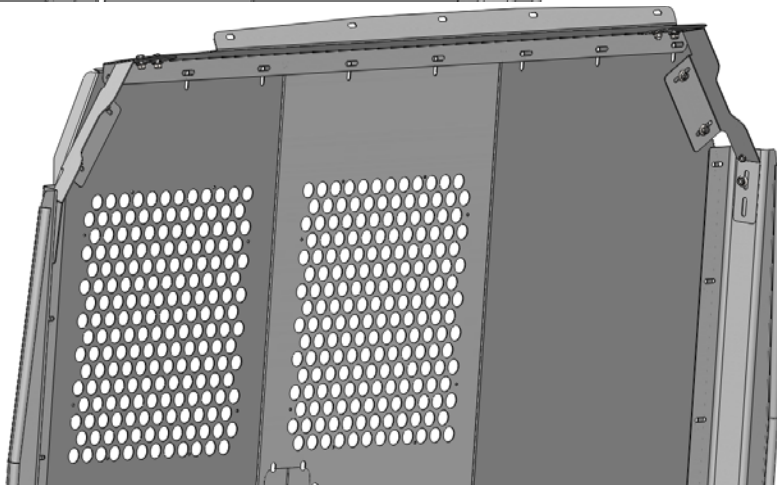
Instructions for Step 07



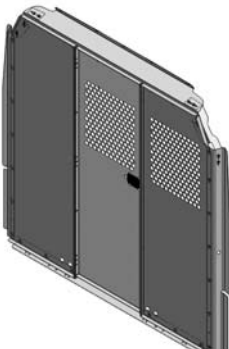

ATTACH THE APPROPRIATE WING BRACKET TO THE PARTITION PANELS AND WING AS SHOWN USING THE FASTENERS SHOWN ABOVE. DO NOT FULLY TIGHTEN THESE FASTENERS. BEGIN BY LOOSELY FASTENING EACH BOLT AND NUT COMBINATION UNTIL ALL FASTENERS ARE IN PLACE.

SEE NEXT PAGE FOR RELIEF CUTS IF NEEDED.

PARTS YOU WILL USE FOR STEP 08	ASSEMBLY FROM PREVIOUS STEP	COMMON PART 39808, HDR PNL SEAL (2) REQUIRED	COMMON PART 40126, HDR PNL SEAL (2) REQUIRED	
				

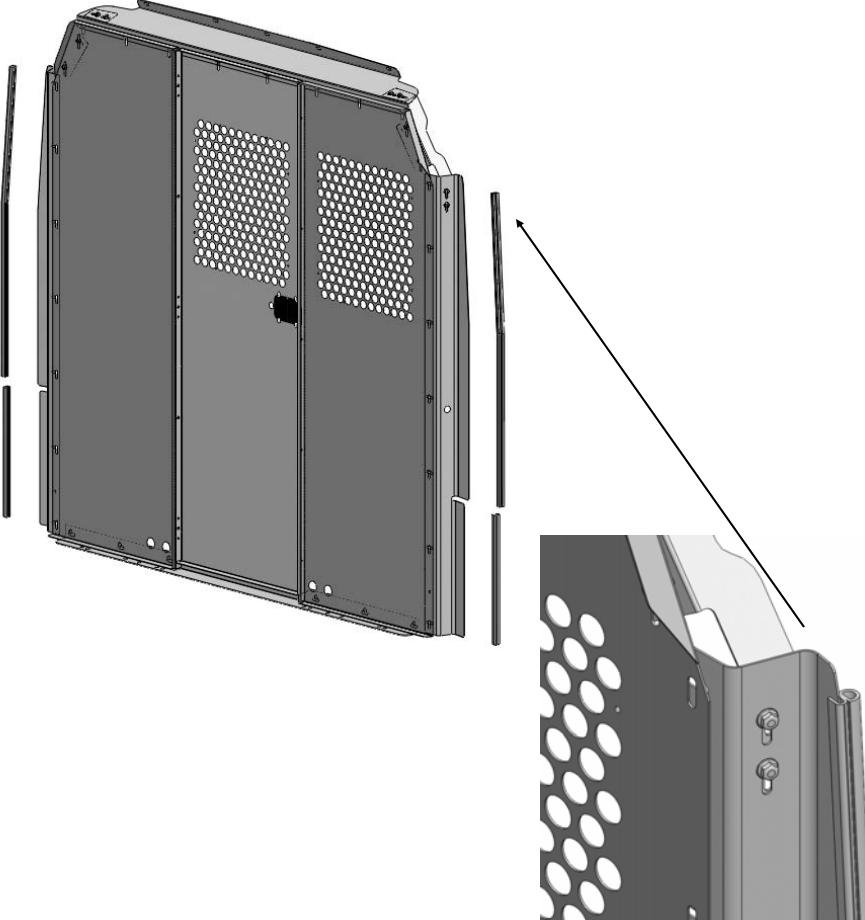
Instructions for Step 08







**ATTACH THE HEADER
PANEL SEALS TO THE
PARTITION WINGS AS
SHOWN TO THE OUTER
EDGES OF THE WINGS.
THE LOWER SEALS NEED
TO BE CUT TO 16" USING
SCISSORS OR HAND
SHEARS.**

STEP 8 CONTINUED
RELIEVE FOAM IF NEEDED

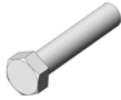
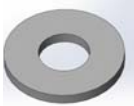

RELIEF CUTS MAY NEED
TO BE PERFORMED IN
STREET AND CURB SIDE
FOAM FOR PROPER FIT
FOR WING SUPPORT
BRACKETS.

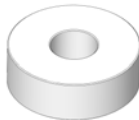

PARTS YOU WILL USE FOR STEP 09	ASSEMBLY FROM PREVIOUS STEP	FLOOR FASTENER FAS0095, SCRW,HH 5/16 (6) REQUIRED	COMMON PART FAS0086, WASHER 5/16 (6) REQUIRED	COMMON PART FAS0098, LCK WASHER (6) REQUIRED
				
	OPTIONAL PART 03927-1 SPACER (6) OPTIONAL	HEADER FASTENER FAS0052 PLUSNUT (5) REQUIRED	HEADER FASTENER FAS0018 SCRW,HH 1/4 (5) REQUIRED	
				

Instructions for Step 09

USE: FAS0018 FAS0052

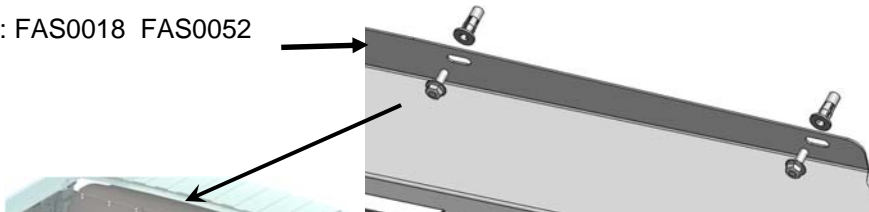

USE: FAS0095 FAS0098
FAS0086

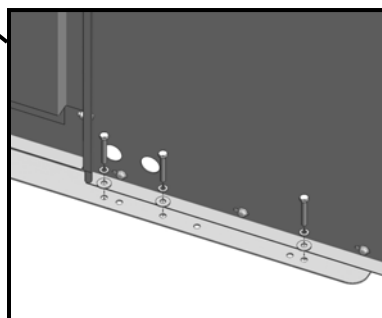
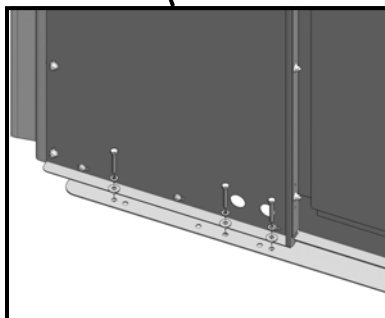

MOVE PARTITION ASSEMBLY INTO THE VEHICLE AND ATTACH THE HEADER PANEL TO THE VEHICLE ROOF BOW USING THE FAS0018 SCREWS.

ATTACH THE PARTITION TO THE FLOOR OF THE VEHICLE USING THE 5/16" HH SCREWS AND WASHERS SHOWN ABOVE. (USE OPTIONAL SPACERS UNDER FOOTER RAIL IF NEEDED FOR INSTALLED FLOORING MATERIALS)

FINISH INSTALLATION BY NOW TIGHTENING THE FASTENERS THAT ATTACH THE PANELS TO THE WINGS, FOOTER RAIL AND HEADER PANEL.

THIS COMPLETES THE INSTALLATION.