

PRODUCT WEIGHT
33.21 LBS

WIDTH x DEPTH x HEIGHT
68.2" x 13.4" x 54.5"

CAPACITY
N/A

COLOR
GRAY

CATALOG NUMBER
WKC1FDTS2

**Compatible with S#M#C#FSV
Partition Panels**

PRODUCT FEATURES

Steel partition wing kit (using appropriate panel kit) for Ford transit low roof provides a solution for separating the cab area from the cargo area. The steel partition features the use of OEM attachment points for a clean installation. This wing kit is “No-Drill”, meaning it is also compatible with the E-Transit lineup.

SEE PAGE 2 FOR APPLICATION NOTES AND ACCESSORIES, OTHER PRODUCTS THAT WORK WITH THIS UNIT.

Accessory Chart

	Cargo Side	Cab Side
	Base Partition BAGRKA1 REQUIRED (1 BAGRKA1 will allow for one accessory to be added)	None available
Available Accessories	-	-
PA7: Reflector kit	x	-
PA8: Fire ext.	x	-
PA9: First aid tray	x	-
PA10: Practice holder		-
PA11: Cab file		-
PA11NL: Catalog box		-
TA1: Four hook bar		-
TH30: 30lb tank holder		-
TH50: 50lb tank holder		-
UH50RM1: Rail mount kit		-
UH10: 1" hook		-
UH25: 2.5" hook		-
UH25CP-G: 2.5' hook comp		-
UH50: 5" hook	x	-

<i>INSTR. NUMBER</i> : 66990		<i>PG:</i> 1	<i>REV:</i> B	ITEM NO.	PART NUMBER	DESCRIPTION	QTY.
<i>PART NUMBER</i> : WKC1FDTS2				1	45849	WING CLOSEOUT SEAL,ZML-6702-25.75"	2
				2	46808-G	WING BRACKET,TRANSIT,UPR	1
<i>PART DESC.</i> : WING KIT, FDTS, ICE/EV				3	47061-G	HOOP ASM, TRANSIT, STD ROOF	1
				4	47380-G	WING BRKT, SS, TRANSIT STD, NO RAIL KIT	1
NOTE: S_M_C_FSV PARTITION PANELS NEEDED FOR THIS INSTALLATION. SHOWN LATER IN INSTRUCTIONS.				5	47381-G	WING BRACKET RETAINER BAR, TRANSIT	1
				6	47397	Tape, 2 Side Adhesive, 3/4 X 4	2
				7	50725-G	WING BRACKET,TRANSIT,LWR	1
				8	59088-G	CLOSEOUT PANEL, LOWER, FT	2
				9	67244-G	FOOTER ASM, FDTS, NO-DRILL	1

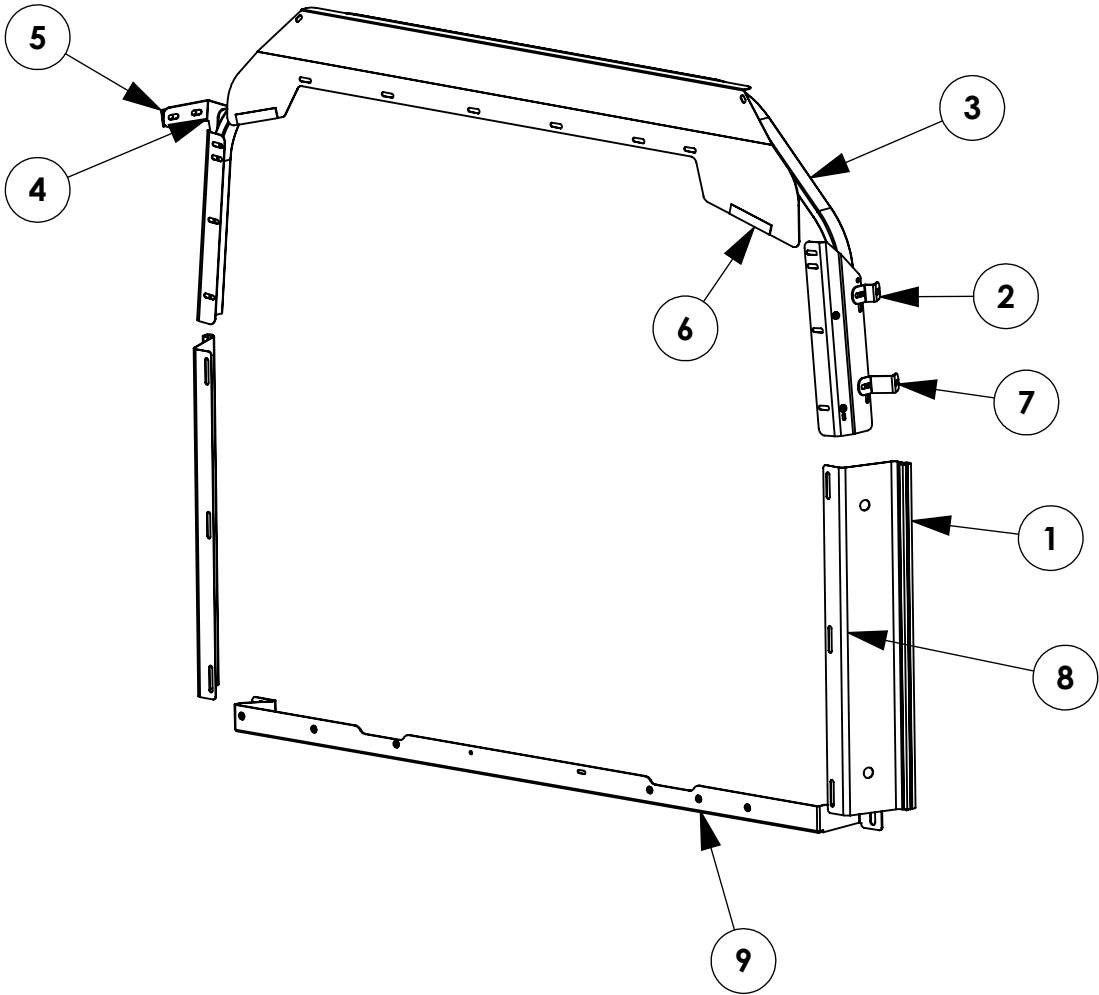

GET TO KNOW THE VEHICLE - AT THE BEGINNING OF ANY INSTALLATION, CHECK THE LOCATION OF THE FUEL TANK, FUEL LINES, BRAKE LINES, HIGH VOLTAGE BATTERIES AND WIRING HARNESSSES TO AVOID INJURY OR PROPERTY DAMAGE FROM TOOL CONTACT.

SEAL ALL EXTERIOR HOLES - ALL INSTALLATION HOLES SHOULD BE SEALED WITH BUTYL TAPE OR SILICON TO PREVENT WATER AND EXHAUST GASES FROM ENTERING THE VEHICLE.

CONTROL DRILL DEPTH - TO AVOID DAMAGE TO THE VEHICLE, USE A DRILL STOP OR CLEARED STEP BIT WHEN DRILLING INSTALLATION HOLES.

ALWAYS ADD PRIMER - WHEN ADDING INSTALLATION HOLES BE SURE TO USE A SELF-ETCHING PRIMER TO PREVENT CORROSION, FASTENER FAILURE AND INJURY.

MOUNTING POINTS MUST HAVE METAL-TO-METAL CONTACT - USE PROVIDED MOUNTING SPACERS TO ACCOMMODATE FOR VEHICLE FEATURES, CARPET OR SUBFLOORS.

PROVIDE CLEARANCE FOR SPACERS - IF THE INSTALLATION VEHICLE CONTAINS A CARPET OR SUBFLOOR, USE A 1-3/16" DIAMETER CARPET CUTTER (P/N: 31183-0) AT ALL MOUNTING LOCATIONS TO OPEN UP ROOM FOR SPACERS.

CHECK SPACER ORIENTATION - BE SURE THAT THE INDENT IN THE SPACER COVERS THE PLUSNUT HEAD; THIS ENSURES THE MOST METAL-TO-METAL CONTACT AND REDUCES VIBRATION.

PLUSNUT INSTALLATION - A PLUSNUT GUN IS RECOMMENDED FOR PLUSNUT INSTALLATION FOR ITS PRODUCTION SPEED. HOWEVER, A PLUSNUT SETTING TOOL CAN ALSO BE USED (P/N: 22200-0).

THRU-BOLT CLEARANCE - WHEN USING A THRU-BOLT AT ANY MOUNTING LOCATION, BE SURE THAT YOUR HOLE HAS 1/16" CLEARANCE.

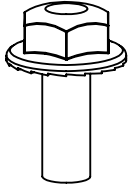
FASTENERS USED

FAS0018
1/4-20X.62 ZP
HFLNG SCREW
QTY: 43

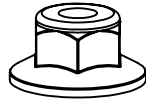

FAS0055
1/4-20 ZP
HFLG NLK NUT
QTY: 37



FAS0060
1/4 ZP
SPL LCK WASHER
QTY: 2



FAS0067
1/4 ZP
FLAT WASHER
QTY: 4

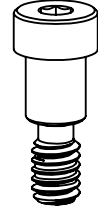

FAS0089
.312X.37 NYLK
SHLDR SCREW
QTY: 2

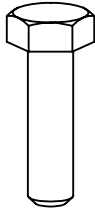

FAS0187
M6-1.0X22 SS
HH SCREW
QTY: 2

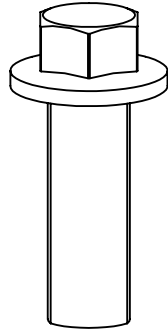

FAS0408
7/16-20 X 1.632
HH SCREW
QTY: 2



FAS0482
7/16
FLAT WASHER
QTY: 2

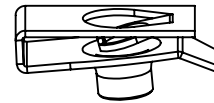

FAS0711
1/4-20 BK PH
SPRING CLIP
QTY: 6

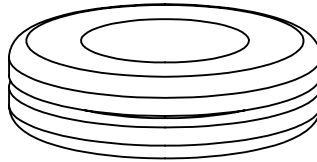

36096-0
1" ID
RUBBER GROMMET
QTY: 4

PREP VEHICLE**STEP 1 - REMOVE OPTIONAL OEM GRAB HANDLE**

CAREFULLY REMOVE THE ACCESS COVERS WITH A FLAT BLADE SCREWDRIVER (02 PLACES).

REMOVE THE PASSENGER SIDE CARGO DOOR GRAB HANDLE USING A 10MM SOCKET (02 PLACES).

SET PARTS ON PASSENGER SEAT FOR LATER USE.

NOTE: OEM FASTENERS CAN BE DISCARDED.

BEGIN ASSEMBLY**STEP 2 - ASSEMBLE THE PARTITION PANELS**

FAS0018, FAS005
(5 PLACES ON DRIVER'S SIDE)
7/16 SOCKET
7/16 WRENCH

ON BOTH SIDES:
START AT TOP HOLE AND
INSTALL IN EVERY-OTHER
UNTIL BOTTOM OF PANEL

BOLT HEADS FACE OUTWARD

FAS0018, FAS005
(4 PLACES ON PASSENGER'S SIDE)
7/16 SOCKET
7/16 WRENCH

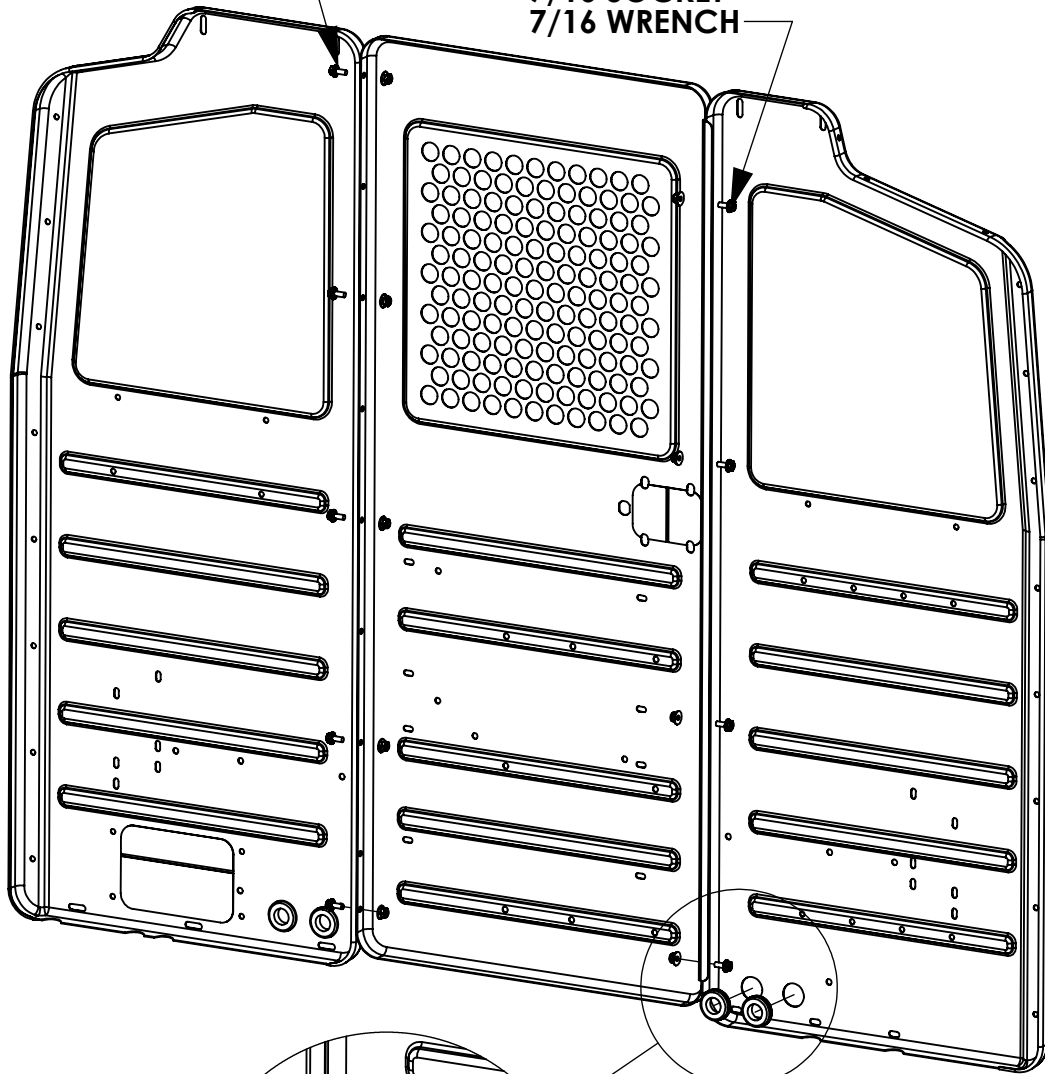

36096-0
(4 PLACES, 2 PER OUTER PANEL)

STEP 3 - PREP HEADER

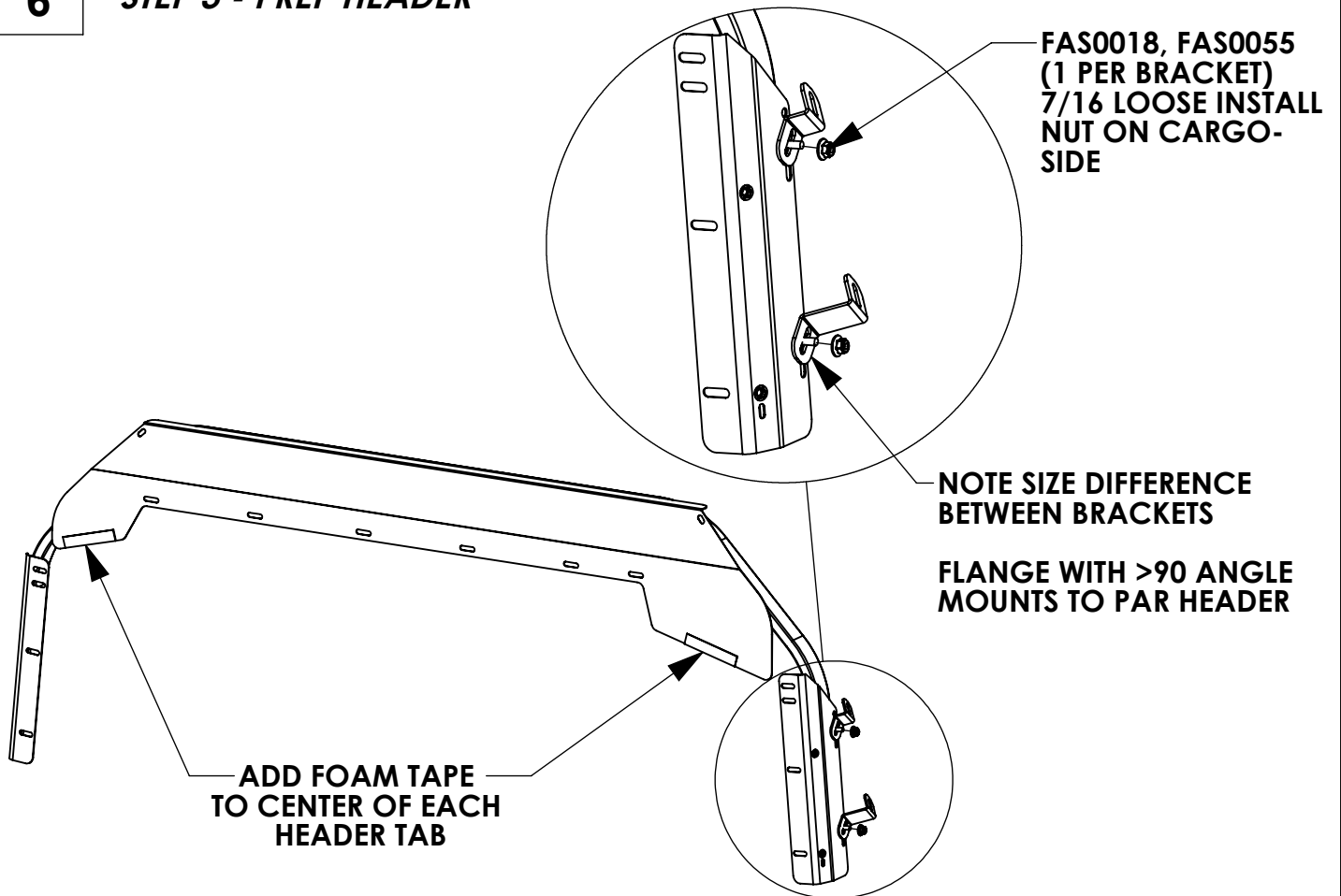

STEP 4 - ASSEMBLE WINGS

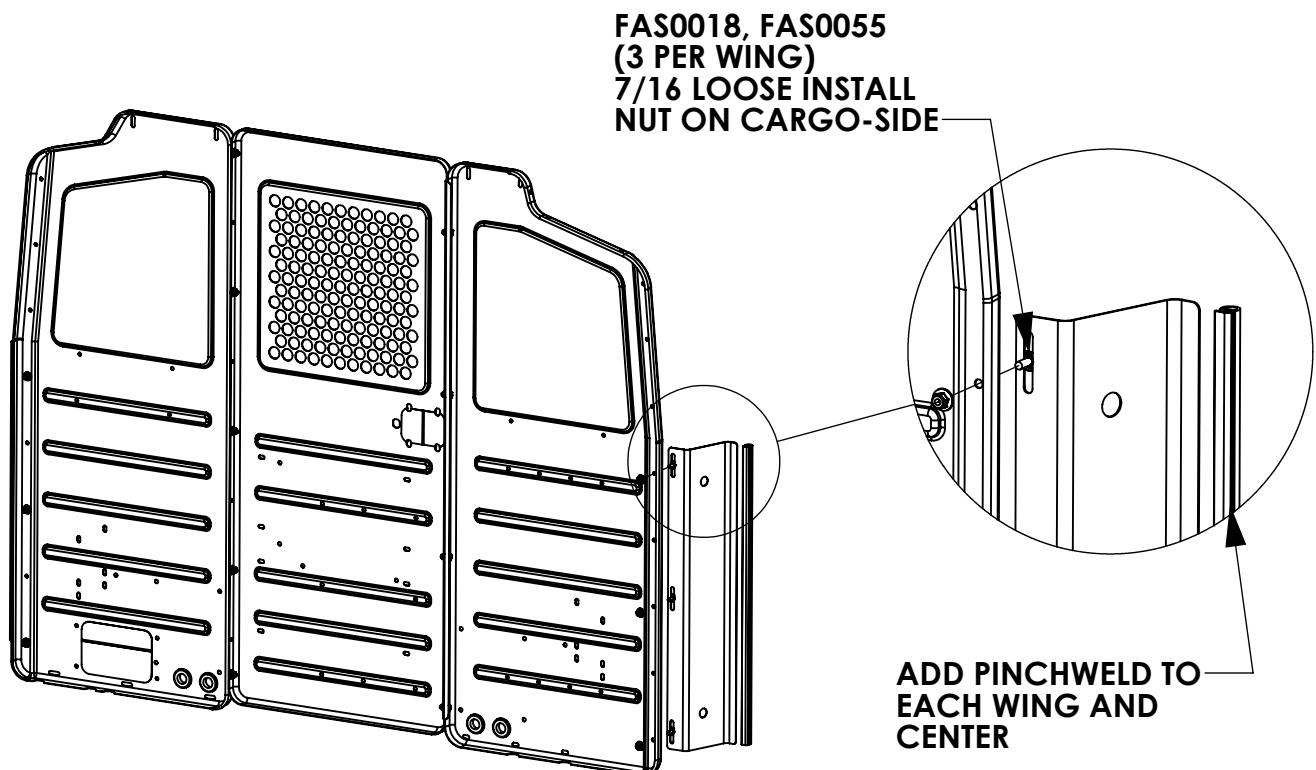

STEP 5 - ASSEMBLE HEADER

FAS0018, FAS0055
(10 PLACES)
7/16 LOOSE INSTALL
NUT ON CARGO-SIDE

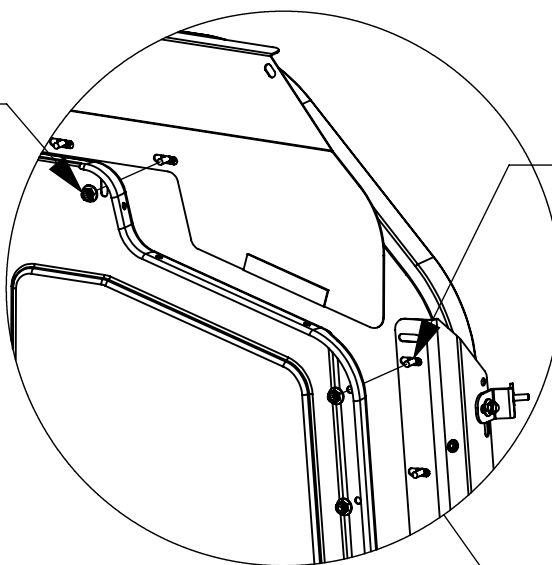

NOTE PASSENGER
SIDE MOUNTING SLOT

NOTE DRIVER SIDE
MOUNTING SLOT

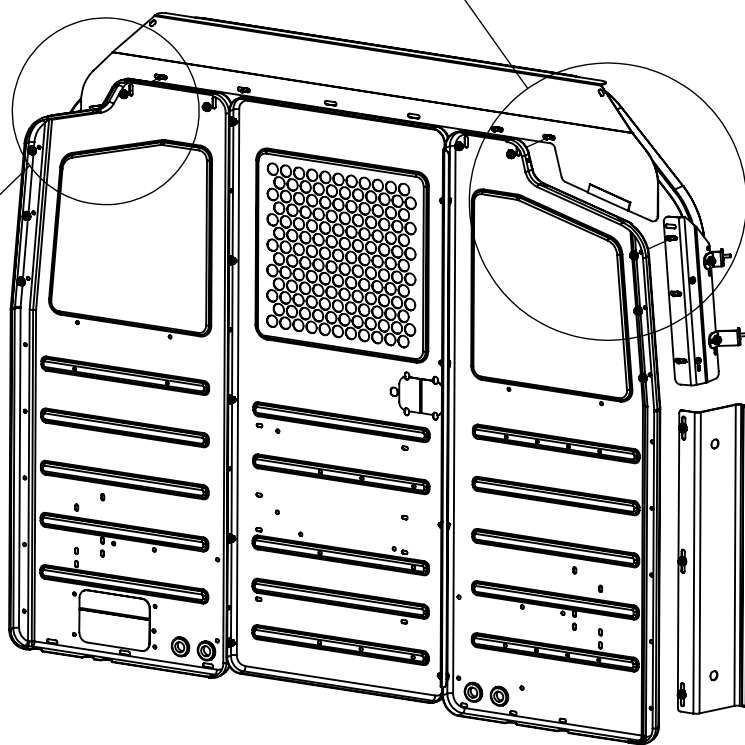
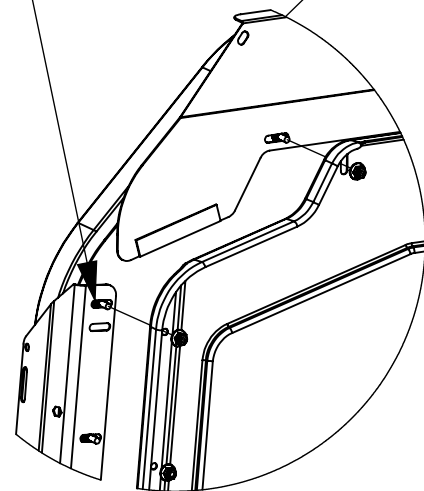

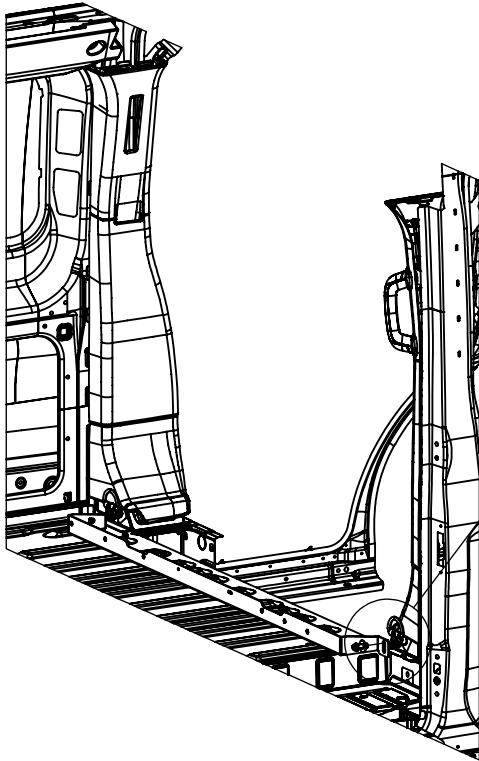
STEP 6 - INSTALL FOOTER

NOTE: IF A FLOOR PLATE KIT IS INCLUDED IN THIS UPFIT, INSTALL THE FLOOR PLATE BEFORE THIS PARTITION FOOTER

REMOVE OEM
D-RING & REPLACE

- OR -

FAS0408, FAS0482
(2 PLACES)
1/2 SOCKET

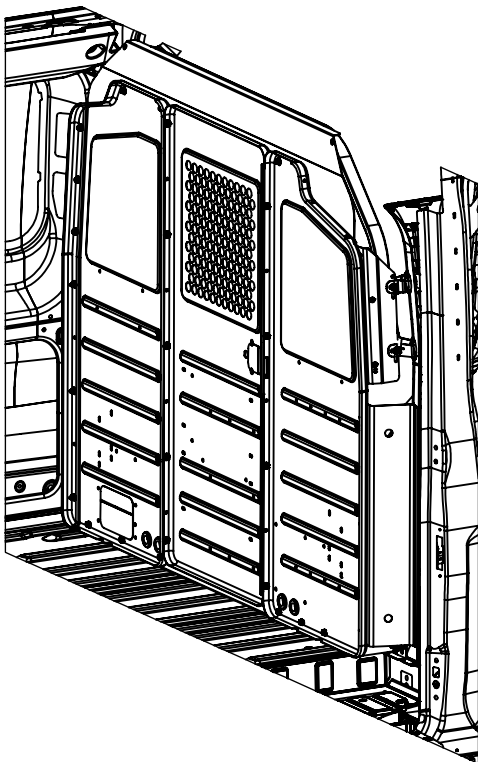
STEP 7 - PLACE PAR IN VEHICLE

PLACE PARTITION AND WING ASSEMBLY
IN THE VAN. LEAN THE TOP OF THE
PARTITION AGAINST THE SEATS OR B-PILLAR
TO KEEP FROM TIPPING BACKWARD.

NOTE THIS IS ADVISED TO BE A 2-PERSON
LIFT TO KEEP THE PRODUCT AND VEHICLE
FROM BEING SCUFFED.

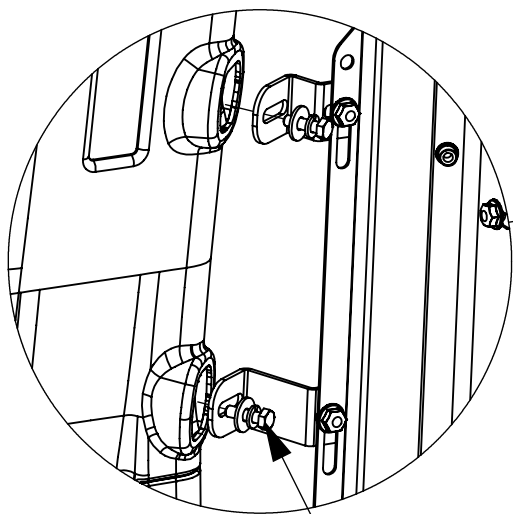
STEP 8 - INSTALL PASSENGER SIDE UPPER MOUNTING

FAS0187, FAS0067
FAS0060
(1 PER BRACKET)
MOUNT TO OEM HANDLE HOLES
10mm LOOSE INSTALL

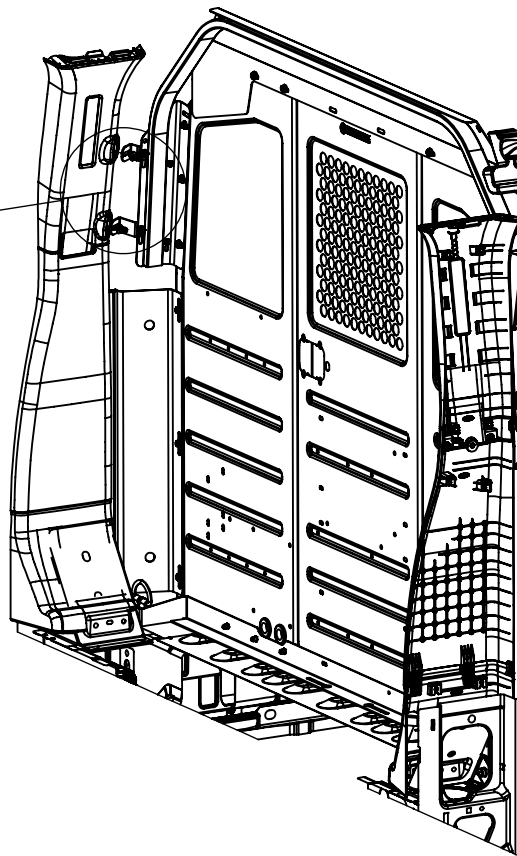
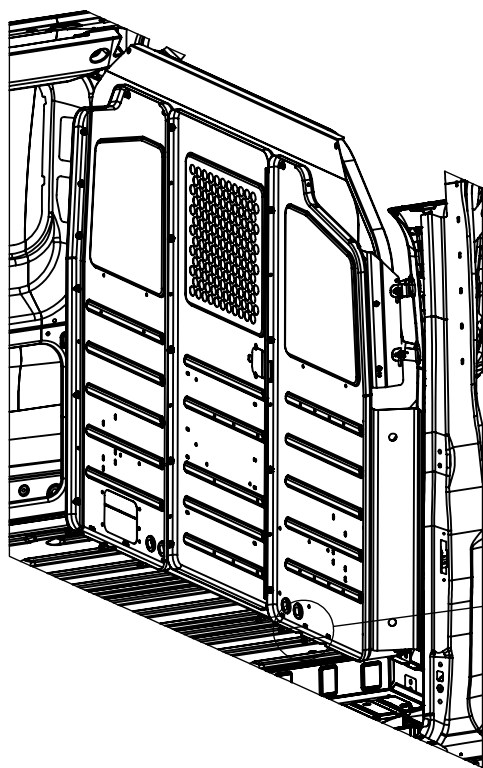
**STEP 9 - MOUNT FOOTER**

FAS0018
(6 IN FOOTER)
7/16 LOOSE INSTALL

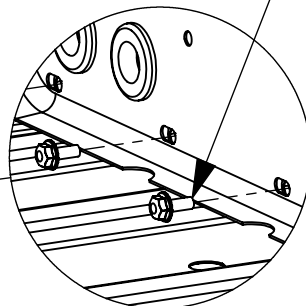

STEP 10 - INSTALL DRIVER'S SIDE MOUNTING BRACKET

STEP 10.1 - CABSIDE VIEW

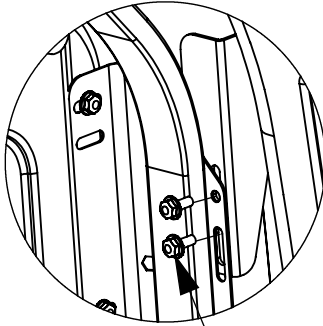

FAS0018, FAS0055
(2 IN BRACKET)
7/16 LOOSE INSTALL

STEP 10.2

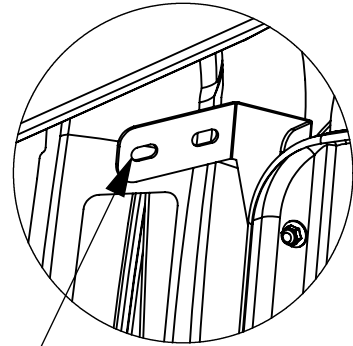

USE BRACKET TO MARK
MOUNTING LOCATIONS.

REMOVE BRACKET AND
DRILL OUT.
1/4" DRILL BIT

STEP 10.3

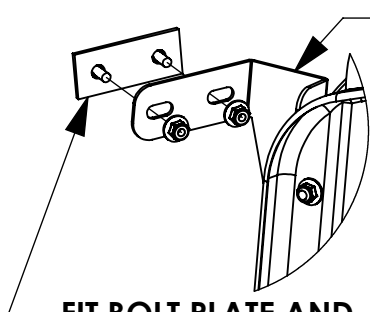

REPEAT STEP 1 AND REPLACE
MOUNTING BRACKET

FIT BOLT PLATE AND
MOUNTING BOLTS
INTO BODYSIDE AND
THROUGH HOLES FROM
STEP 2.

STEP 10.4

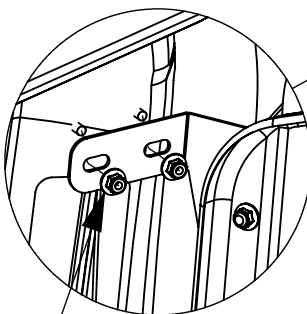

MEET BOLT PLATE AND
FAS0018 WITH FAS0055
7/16 LOOSE INSTALL

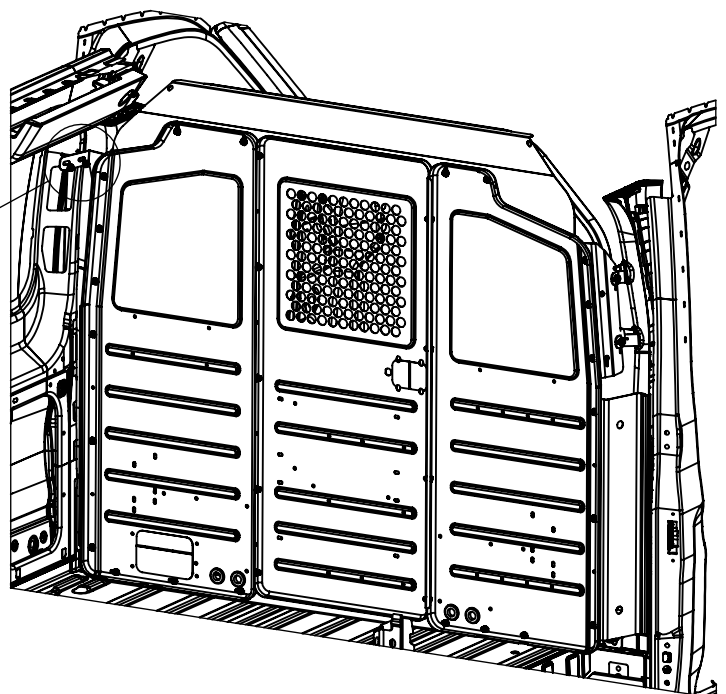

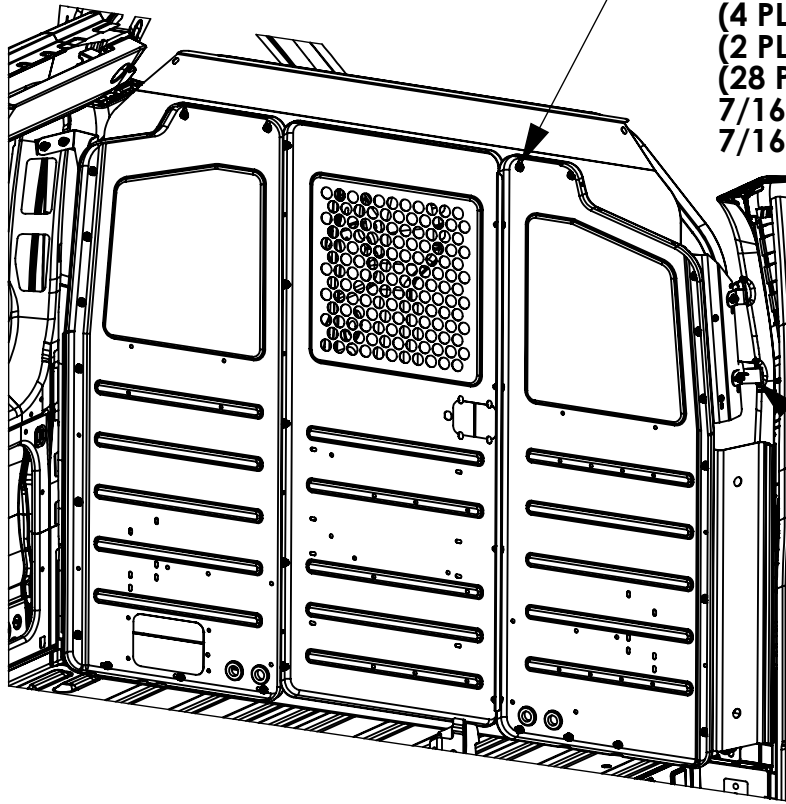
STEP 11 - TIGHTEN ALL FAS

TIGHTEN ALL FAS0018, FAS0055
 (10 PLACES IN HEADER)
 (3 PER LOWER WING)
 (6 PLACES IN FOOTER)
 (4 PLACES IN UPPER DRIVER'S SIDE BRACKET)
 (2 PLACES IN UPPER PASS. SIDE BRACKET)
 (28 PLACES TOTAL)
 7/16 SOCKET
 7/16 WRENCHES

TIGHTEN ALL FAS0187
 INTO OEM HOLES
 (2 PLACES)
 10mm SOCKET

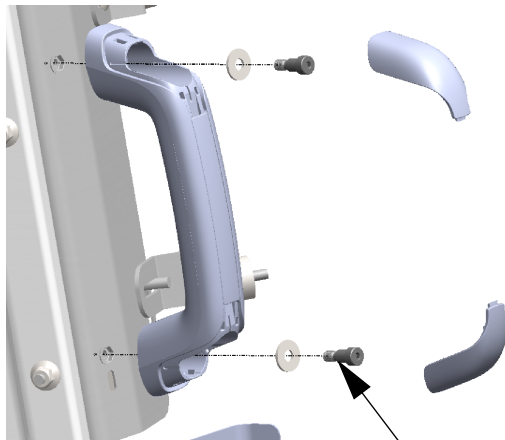
STEP 12 - REPLACE OEM HANDLE (OPTIONAL)

IF OEM GRAB HANDLE
 IS TO BE RE-INSTALLED:

FAS0089, FAS0067
 (2 PLACES)
 5/32 ALLEN WRENCH