

Partition panels shown for illustrations purposes only. Panels are sold separately.

PRODUCT WEIGHT
35.57 LBS

WIDTH x DEPTH x HEIGHT
68.4" x 6.9" x 68.9"

CAPACITY
N/A

COLOR
GRAY

CATALOG NUMBER
WKC1FDTM2

PRODUCT FEATURES

Steel partition wing kit (using appropriate panel kit) for Ford E-Transit medium roof electric van provides a solution for separating the cab area from the cargo area. The steel partition footer features the use of OEM attachment points for floor no drill installation. Also compatible with ICE Ford Transits.

SEE PAGE 2 FOR APPLICATION NOTES AND ACCESSORIES, OTHER PRODUCTS THAT WORK WITH THIS UNIT.

Accessory Chart

	Cargo Side	Cab Side
	Base Partition BAGRKA1 REQUIRED (1 BAGRKA1 will allow for one accessory to be added)	None available
Available Accessories	-	-
PA7: Reflector kit	x	-
PA8: Fire ext.	x	-
PA9: First aid tray	x	-
PA10: Practice holder		-
PA11: Cab file		-
PA11NL: Catalog box		-
TA1: Four hook bar		-
TH30: 30lb tank holder		-
TH50: 50lb tank holder		-
UH50RM1: Rail mount kit		-
UH10: 1" hook		-
UH25: 2.5" hook		-
UH25CP-G: 2.5' hook comp		-
UH50: 5" hook	x	-

Introduction / Comments:

This wing kit is designed to fit in your Ford E-Transit medium roof, shown with the example S1M2C2PM partition panel kit, which is ordered separately.

Note:

It is advised that all fasteners used in this assembly and installation should be checked for tightness at the following intervals: @ 2-weeks and again @ 6-weeks of operation. This preventive maintenance step must be completed to ensure your Partition gives you long service life.

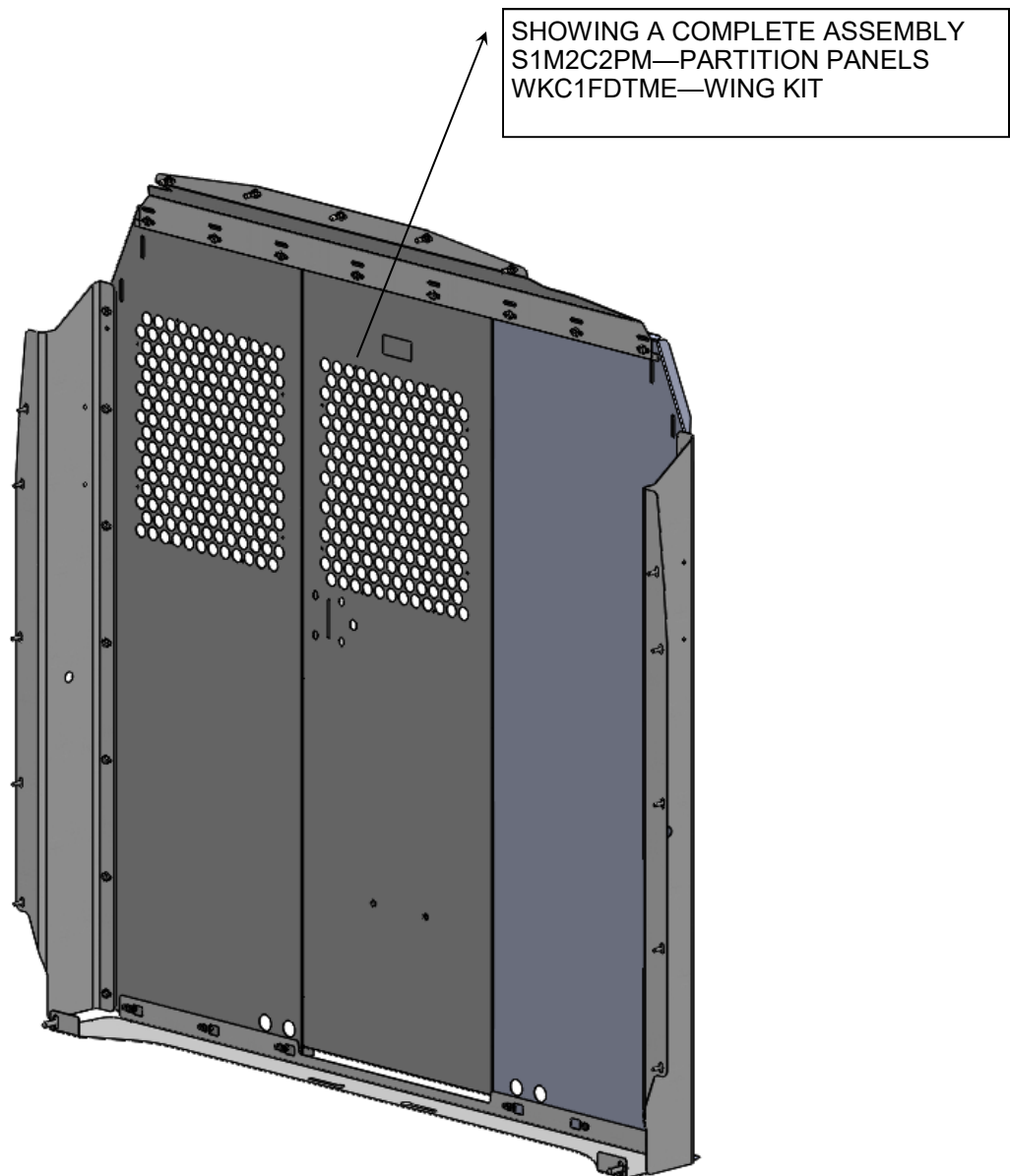

**WKC1FDTM2
WING KIT, MID ROOF
FORD E-TRANSIT**

- PRECAUTIONS -





 **CAUTION** 
**THE USE OF AIR IMPACT TOOLS CAN
OVER-TORQUE FASTENERS AND
CAUSE FASTENER FAILURE!**





 **CAUTION** 
**ALL INSTALLATION HOLES SHOULD BE SEALED
WITH SILICON OR BUTYL SEALANT TO PREVENT
EXHAUST FUMES FROM ENTERING THE VEHICLE!**



 **DANGER** 
**INSPECT FOR FUEL TANK, FUEL LINES, BRAKE LINES, HIGH
VOLTAGE BATTERIES AND ELECTRICAL LINES PRIOR TO
DRILLING TO AVOID DAMAGING CRITICAL VEHICLE SYSTEMS
OR INJURY TO INSTALLER DURING INSTALLATION PROCESS!**



 **CAUTION** 
**TO AVOID DAMAGING THE VEHICLE ALWAYS USE DRILL
STOPS WHEN DRILLING ANY INSTALLATION HOLES!
ADRIAN AVAILABLE PART #'S 31121-0 (1/2" DEEP),
31122-0 (3/4" DEEP)**



- IMPORTANT WARRANTY REQUIREMENTS -

1. SUBSTITUTING ADRIAN STEEL SPECIFIED FASTENERS FOR ASSEMBLY AND/OR INSTALLATION WILL VOID YOUR PRODUCT WARRANTY.
2. ALL HOLES DRILLED INTO VEHICLE SHOULD HAVE THE RAW METAL EDGES SEALED WITH A SELF-ETCHING PRIMER TO RESIST CORROSION AND POTENTIAL FASTENER POINT FAILURE.
3. ALL FASTENERS USED IN THE INSTALLATION OF THIS PRODUCT SHOULD BE TIGHTENED TO THE TORQUE(S) SPECIFIED IN THESE INSTRUCTIONS.
4. THESE INSTRUCTIONS SHOULD BE KEPT WITH THE VEHICLE.

THE BASIC TOOLS NEEDED FOR MOST INSTALLATIONS



DRILL



DRILL BIT WITH
STOP

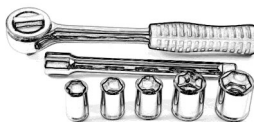

RATCHET, SOCKETS
AND/OR WRENCHES



SCREWDRIVERS



MEASURING TAPE

ADDITIONAL TOOLS MAY BE NEEDED FOR THIS INSTALLATION AND THEY WILL BE IDENTIFIED IN THE STEPS THAT FOLLOW.

Assembly and Installation Fastener Identification Sheet (BAG65515)

ITEM NO.	PART NUMBER	DESCRIPTION	QTY.
1	BAG0509-A	5"X9" 4MIL AUTOBAG	1
2	FAS0018	SCREW,HH SFLNG 1/4-20X.62 ZP	44
3	FAS0055	NUT,HEX NLK FLG 1/4-20 ZP	32
4	FAS0052	PLUSNUT, 1/4-20 PB DC	15
5	FAS 0066	Washer, Lock, Ext. Tooth, 1/4	12
6	FAS0187	SCR,HH,M6-1.0X22	12
7	FAS0234	Washer, Flat, 1/4, SST	12
8	FAS0408	SCREW,HH 7/16-20 X 1.25	2
9	FAS0711	SPRING,CLIP 1/4-20 BK PH	6

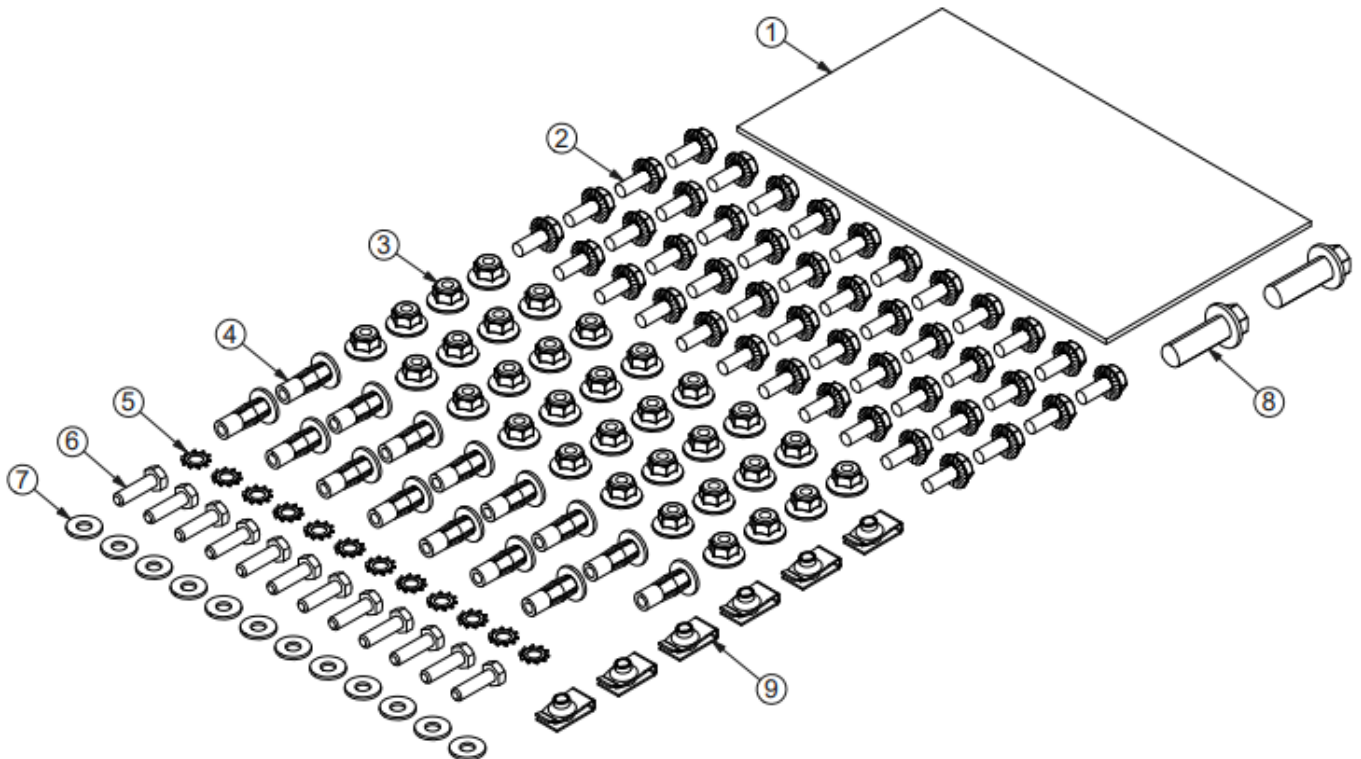

STEP 1 ASSEMBLE S-M-C PANELS

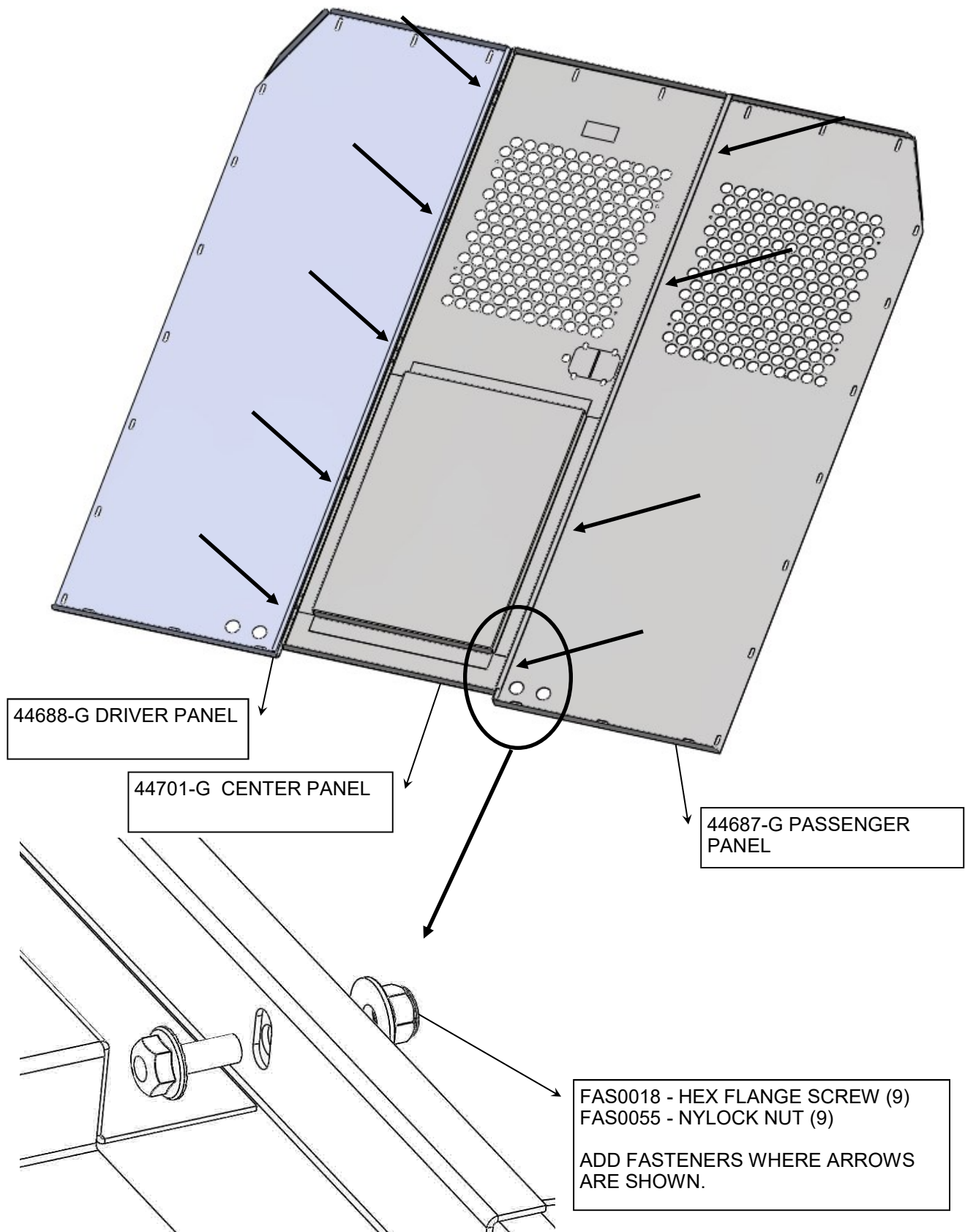

STEP 2 INSTALL FOOTER RAIL—DO NOT FULLY TIGHTEN AT THIS STEP

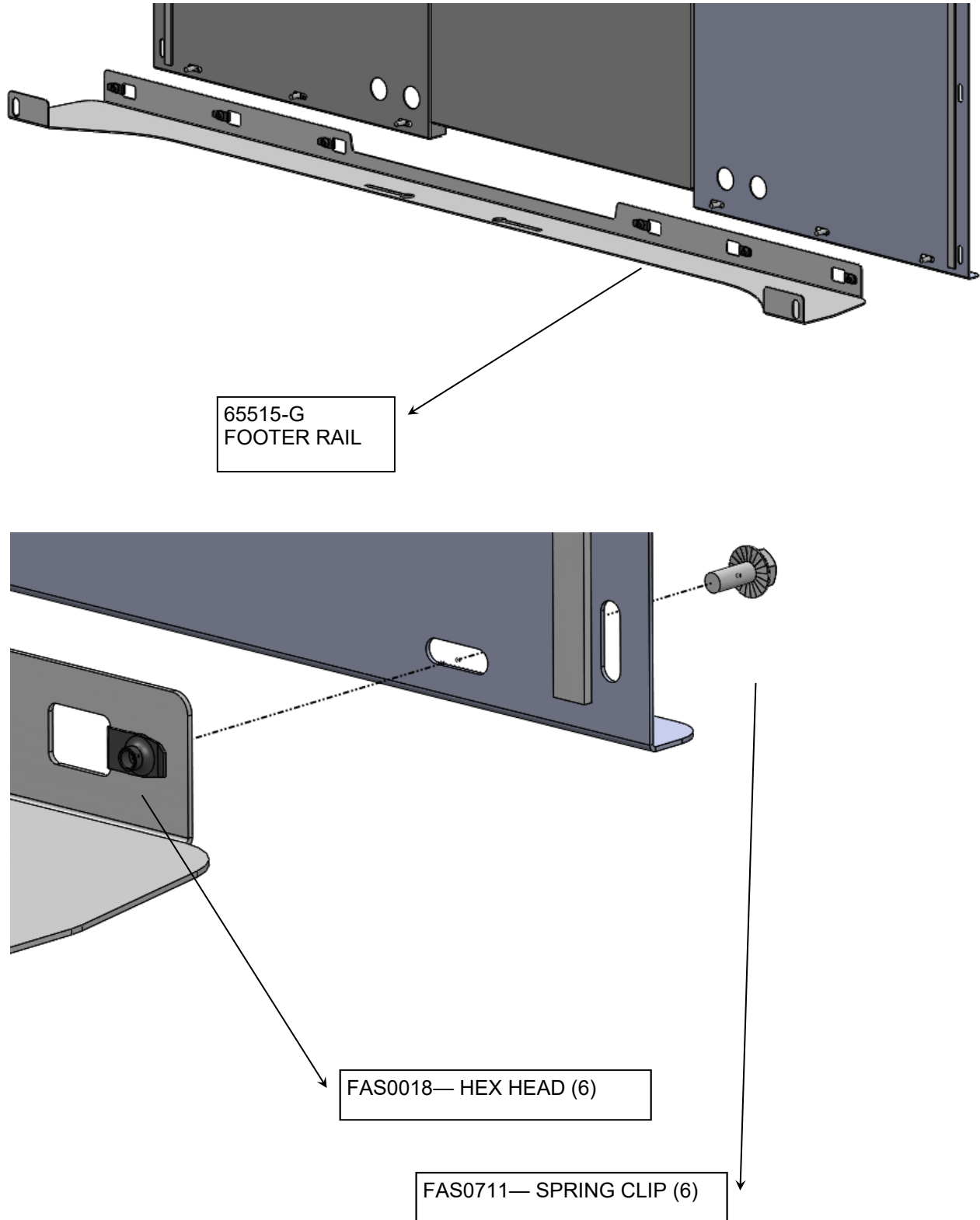

STEP 3 INSTALL PASSENGER WING WITH RUBBER STRIP—DO NOT FULLY TIGHTEN AT THIS STEP

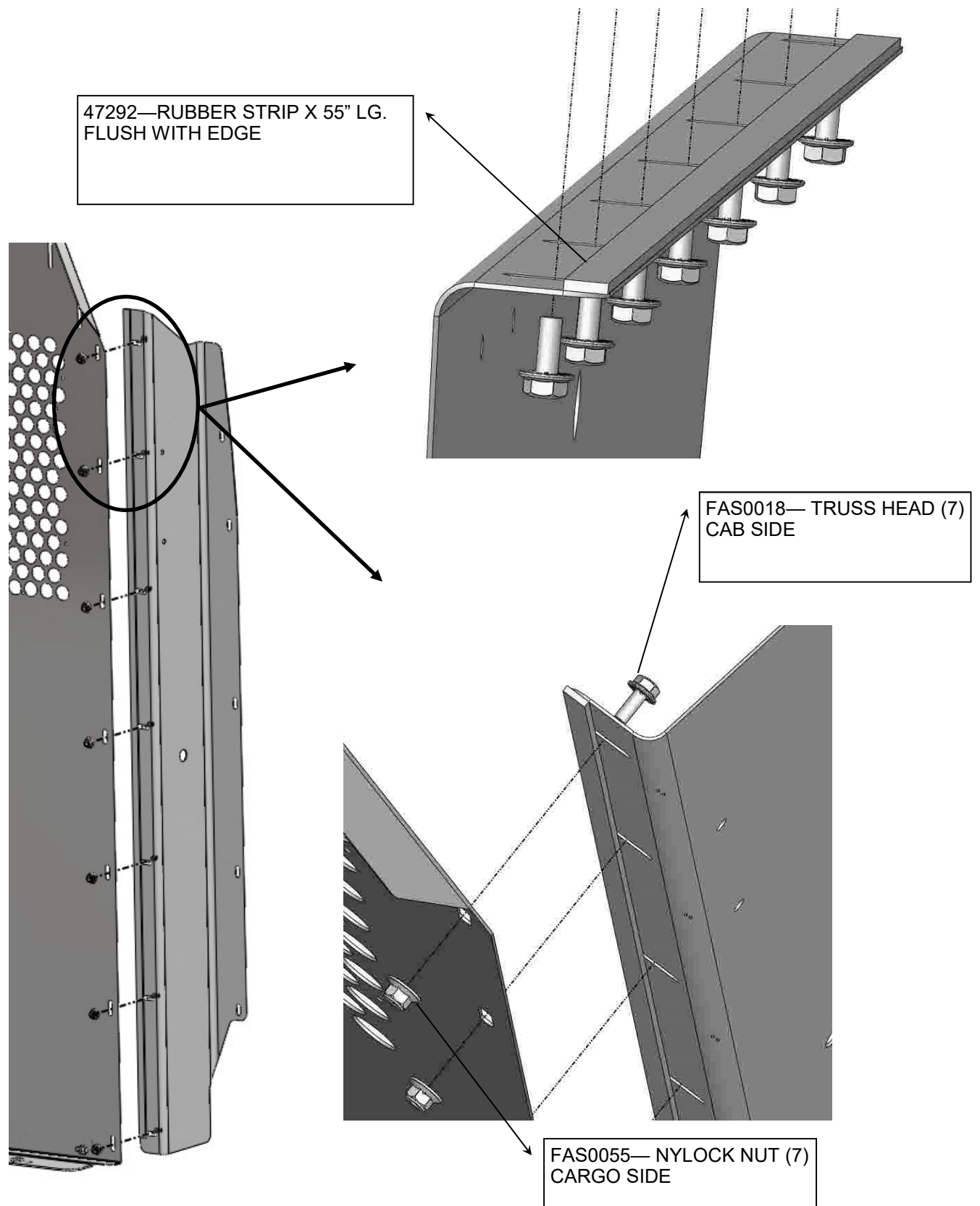

STEP 4 INSTALL DRIVER WING WITH RUBBER STRIP—DO NOT FULLY TIGHTEN AT THIS STEP

47292—RUBBER STRIP X 55" LG.
FLUSH WITH EDGE

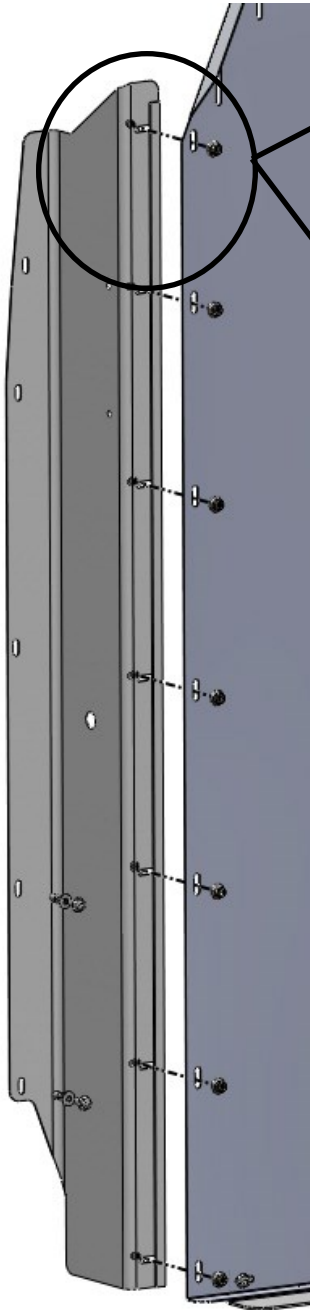
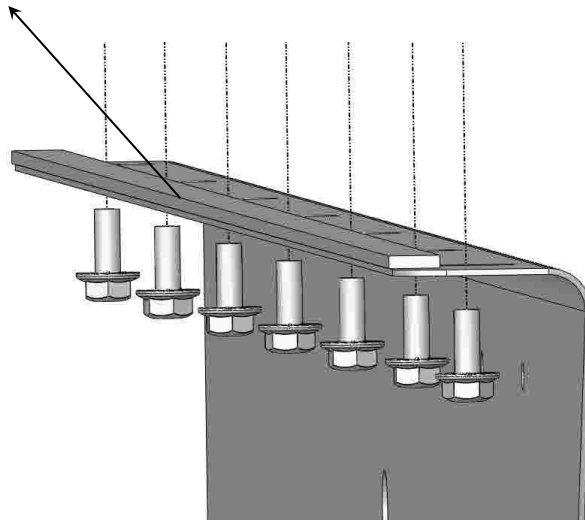

FAS0018— TRUSS HEAD (7)
CAB SIDE

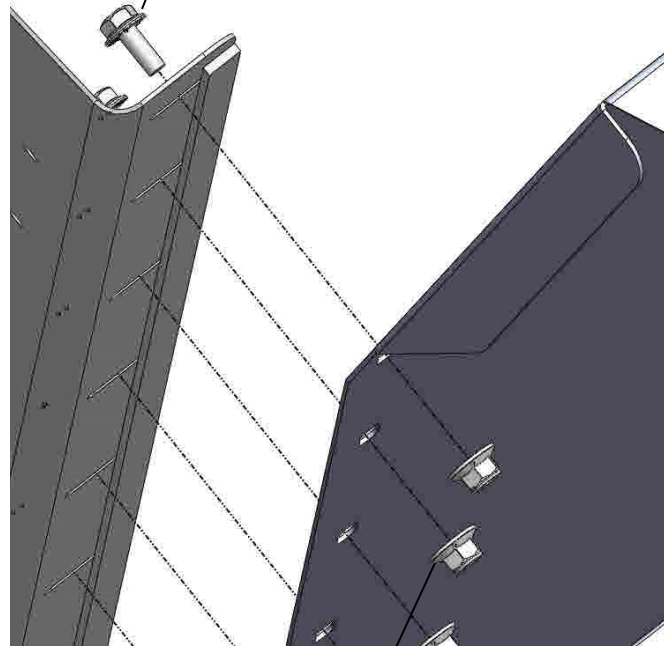

FAS0055— NYLOCK NUT (7)
CARGO SIDE

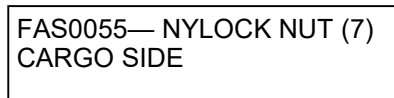

STEP 5 INSTALL HEADER PANEL WITH RUBBER STRIP

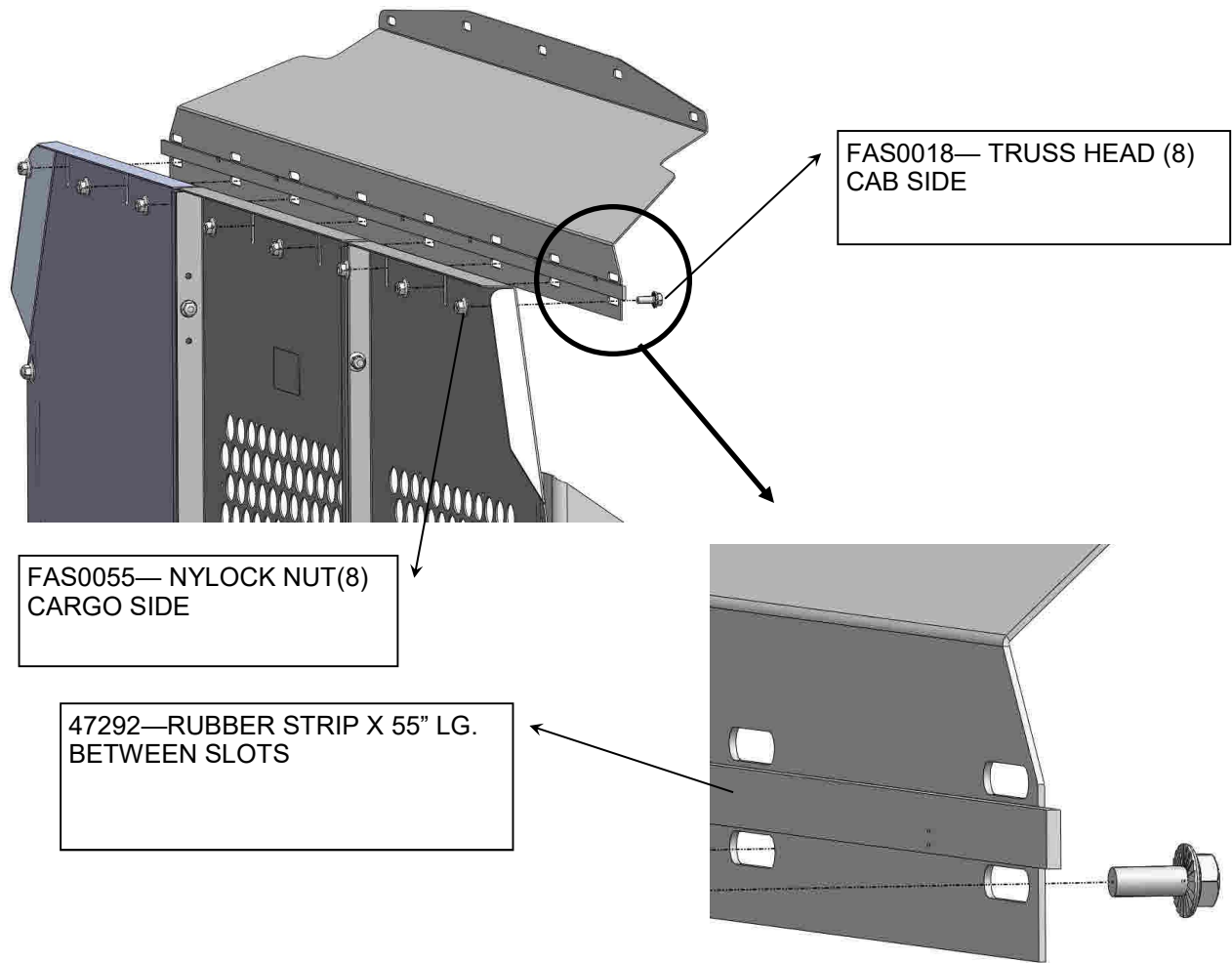

STEP 6 REMOVE GRAB HANDLE FROM VEHICLE TO BE RELOCATED LATER



STEP 7 REMOVE DS LINER AND BRACKET FOR PARTITION INSTALLATION



REMOVE ALL REUSABLE PUSH PINS, EXCEPT THESES THREE SHOWN, FROM DS LINER PANEL TO EXPOSE BRACKET

REMOVE BRACKET FROM DS B-PILLAR (2 BOLTS).

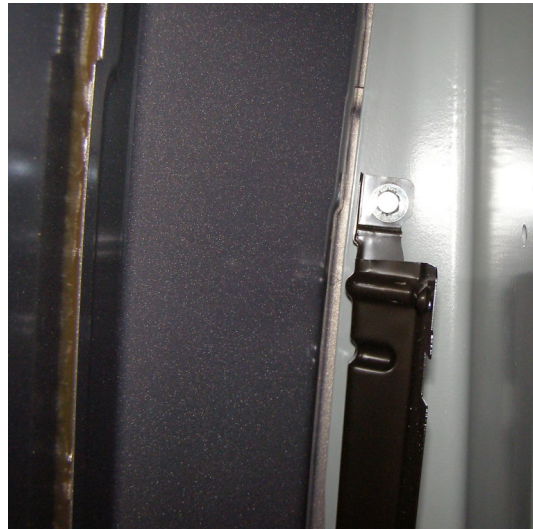

STEP 8 CAREFULLY PLACE IN VEHICLE, TRANSFER MTG HOLES AND REMOVE.

TRANSFER HEADER MTG HOLES (5)
OPEN HOLE UP TO 3/8" DIA WITH
DRILL STOP.
ADD PLUSNUTS
FAS0052—1/4 PLUSNUTS (5)

CHECK DRIVER SIDE HOLE LOCATIONS
FOR OEM M6 THREADED INSERTS, (5)
LOCATIONS.
IF NO THREADED INSERTS, MARK HOLES
OPEN HOLE UP TO 3/8" DIA WITH
DRILL STOP. (5) PLACES
ADD PLUSNUTS
FAS0052—1/4 PLUSNUTS (5)

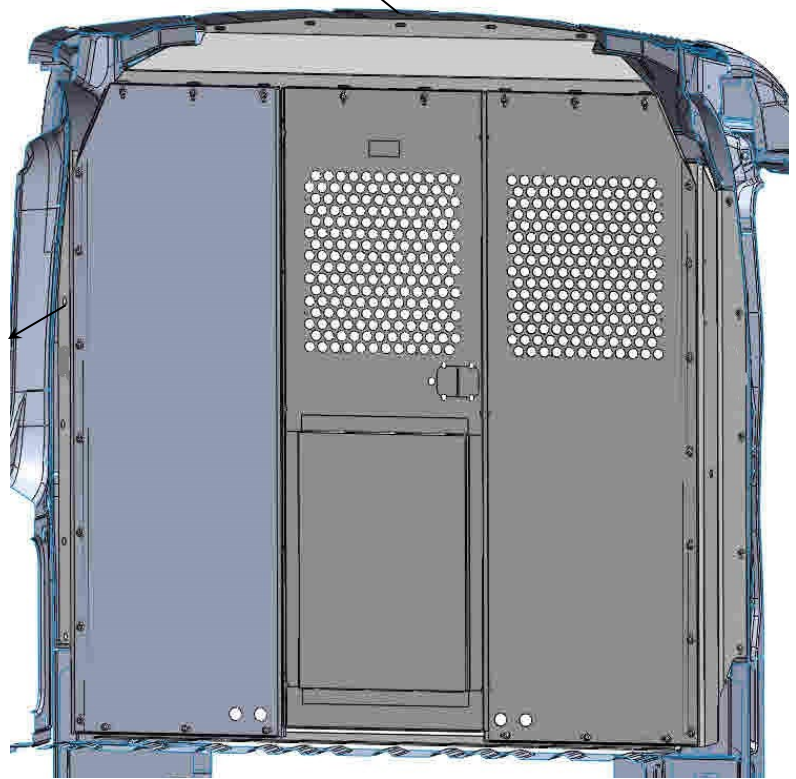

STEP 9 CAREFULLY PLACE PARTITION BACK IN VEHICLE

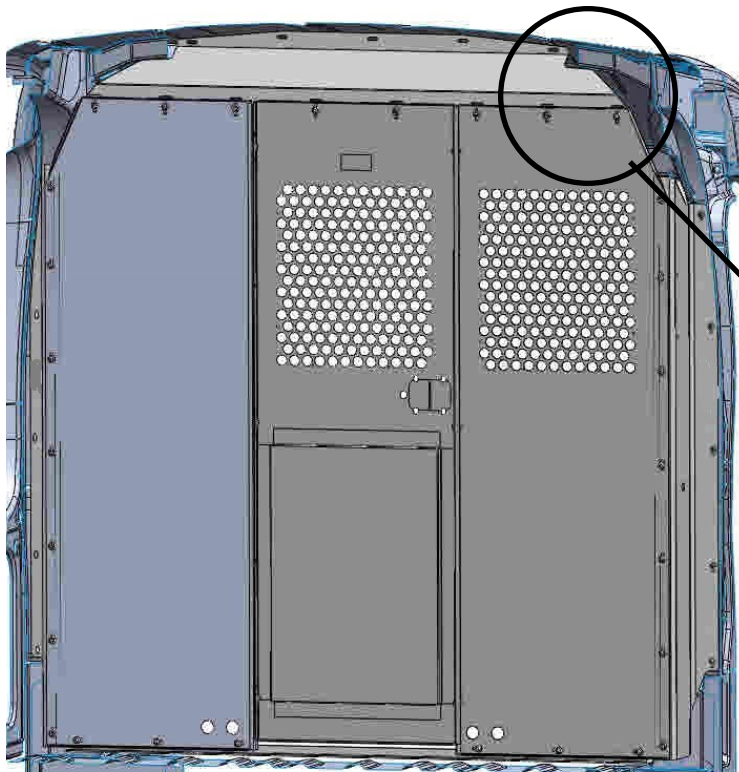

NOTE: IF A FLOOR PLATE KIT IS INCLUDED IN THIS UPFIT, INSTALL THE FLOOR PLATE BEFORE THIS PARTITION

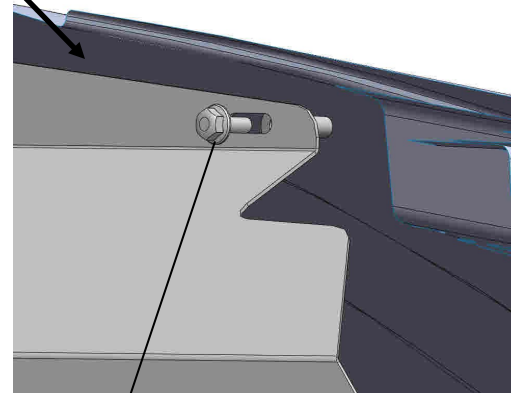

FAS0018— SCREW, HH FLANGE (5)

FAS0408— TRILOBULAR BOLT (2)

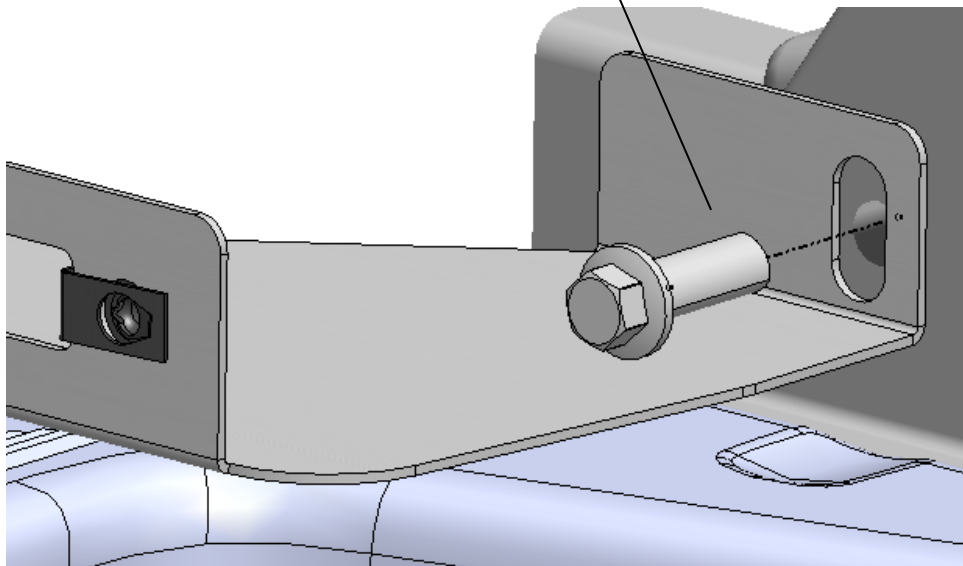

STEP 10 ATTACH WINGS TO VEHICLE WITH OEM INSERTS

EXISTING M6 X 1 INSERTS
FAS0187— SCREW, HH M6-1X22 SS (5)
FAS0066—STAR WASHER (5)
FAS0234—FLAT WASHER (5)

NOTE: VEHICLE MAY BE SUPPLIED WITHOUT OEM FASTENERS. 1/4-20 PLUSNUTS AND FASTENERS MAY BE USED AS ALTERNATE FASTENING METHOD. (INSTALLER SUPPLIED FASTENERS).

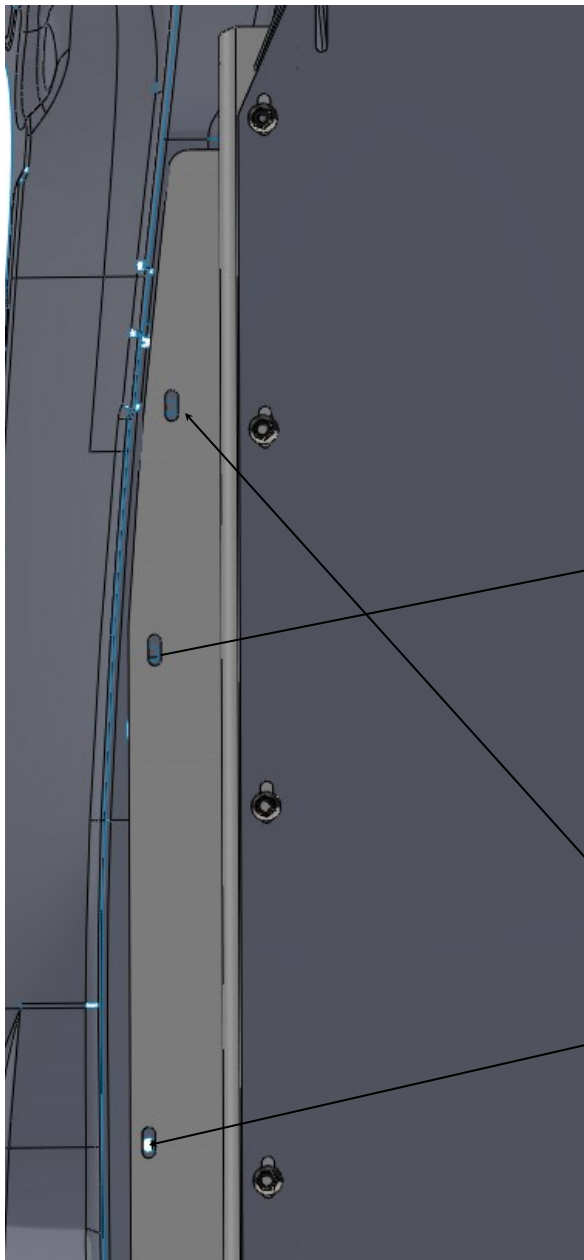
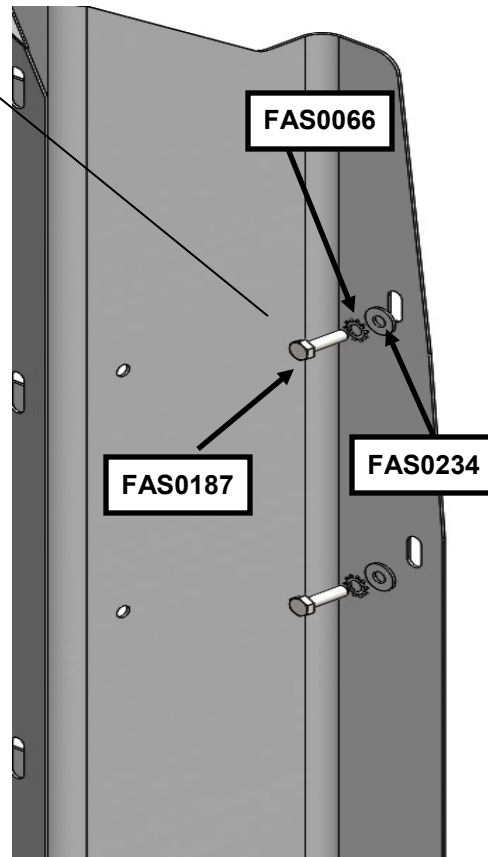

DRIVER SIDE WING
EXISTING M6 X 1 INSERTS
FAS0187— SCREW, HH M6-1X22 SS (5)
FAS0066—STAR WASHER (5)
FAS0234—FLAT WASHER (5)

NOTE: VEHICLE MAY BE SUPPLIED WITHOUT OEM FASTENERS. 1/4-20 PLUSNUTS AND FASTENERS MAY BE USED AS ALTERNATE FASTENING METHOD. (INSTALLER SUPPLIED FASTENERS).

FOR VEHICLES WITH LINER AND BRACKET WORK WITH STEP 12 BEFORE PUTTING BOLTS IN THESE TWO HOLES.

STEP 11 ALTERNATE: ATTACH WINGS BY INSTALLING PLUSNUTS

NOTE: VEHICLE MAY BE SUPPLIED WITHOUT OEM FASTENERS. 1/4-20 PLUSNUTS (FAS0052) AND FASTENERS MAY BE USED AS ALTERNATE FASTENING METHOD. (FAS0018).

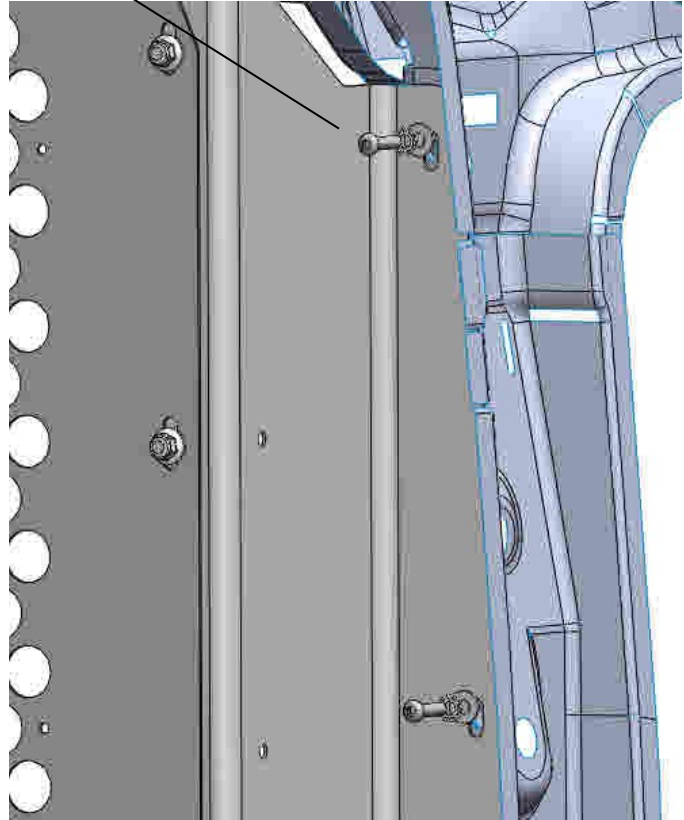
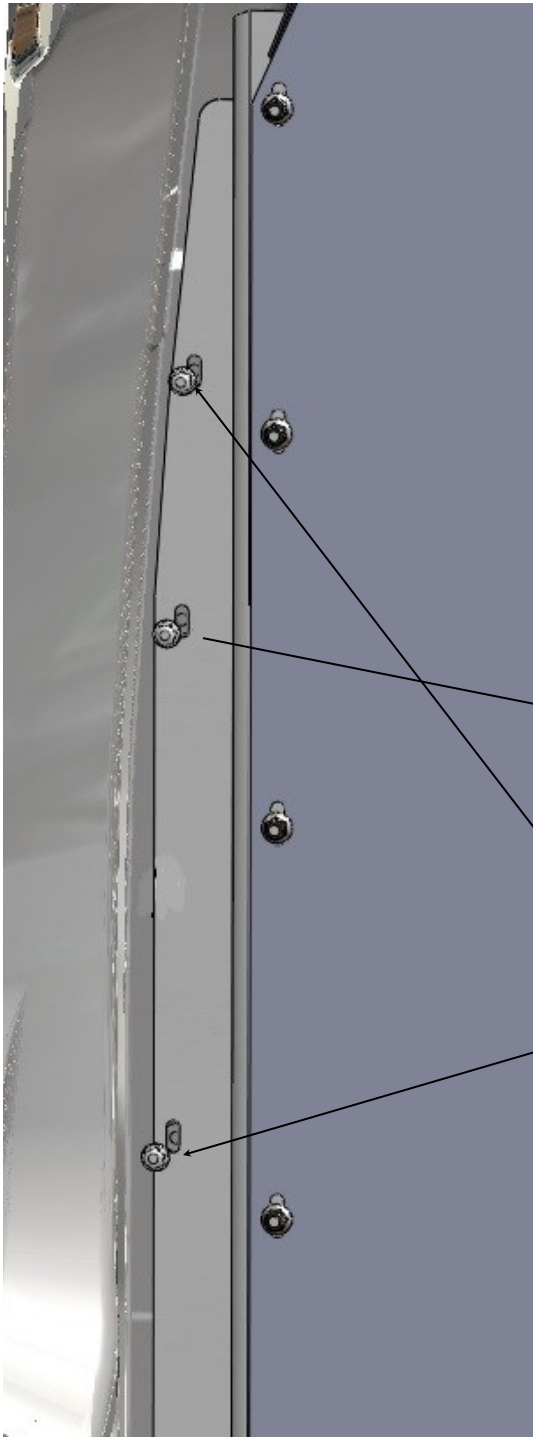

WITH INSTALLED PLUSNUTS
FAS0018— FLANGE HEAD (5)

FOR VEHICLES WITH LINER AND
BRACKET WORK WITH STEP 12
BEFORE PUTTING BOLTS IN
THESE TWO HOLES.

STEP 12 PLACE DS BRACKET AND LINER BACK INTO THE VEHICLE

REPLACE BRACKET FROM DS
B-PILLAR (2 BOLTS).

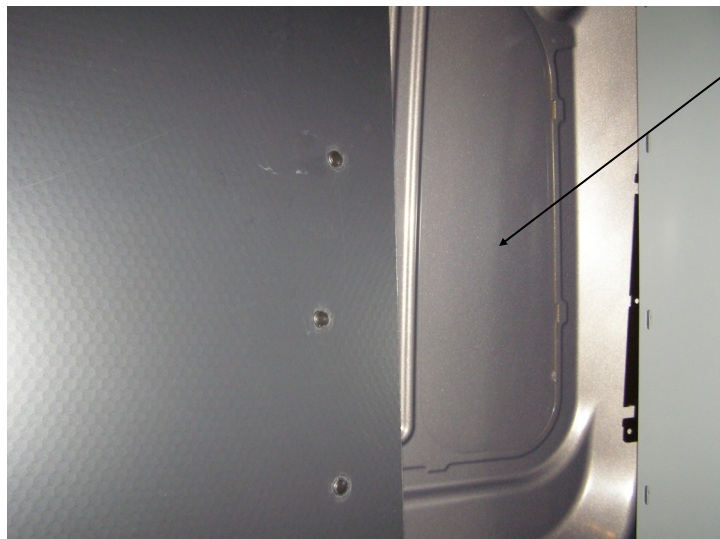

REPLACE ALL REUSABLE PUSH
PINS INTO DS LINER PANEL.

STEP 13 ATTACH GRAB HANDLE TO WING

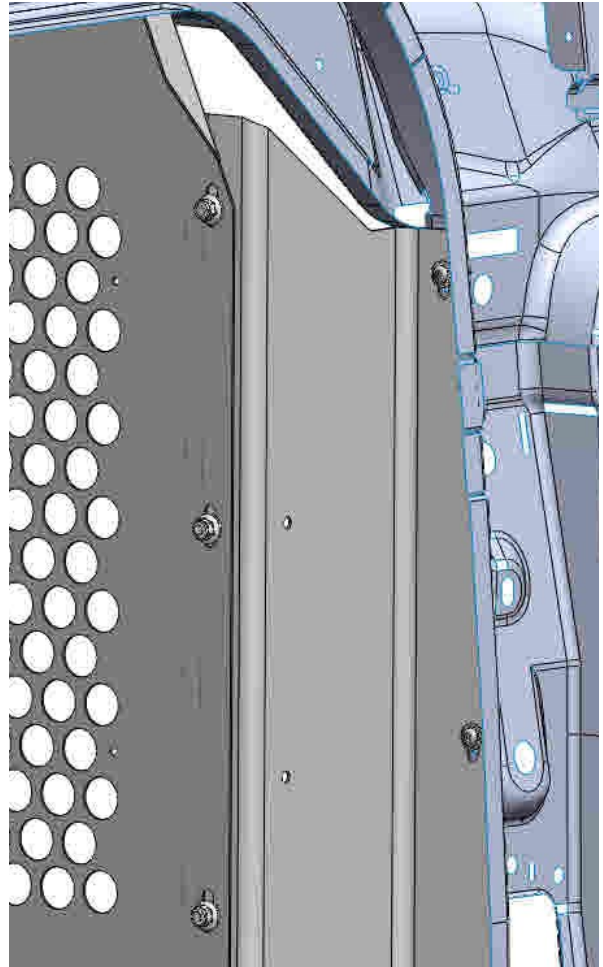

FAS0018 - HEX FLANGE SCREW (2) CAB SIDE
FAS0055 - NYLOCK NUT (2) CARGO SIDE

YOUR INSTALLATION IS NOW COMPLETE

**DOUBLE CHECK ALL FASTENERS LOCATIONS TO BE SURE THAT ALL
FASTENERS ARE TIGHTENED TO SPECIFICATIONS.
YOUR INSTALLATION IS NOW COMPLETE!
STOW THIS COPY IN THE VEHICLE FOR FUTURE REFERENCES!**