



**ADRIAN STEEL®**

Cargo Management Solutions for Commercial Vehicles

## ***TOPPER GRAB HANDLE, KIT OF 3***

*PRODUCT WEIGHT*

**1.03 LBS**

*WIDTH X DEPTH X HEIGHT*

**2W X 9L**

*CAPACITY*

**N/A**

*COLOR*

**BLACK**

*CATALOG NUMBER*

**TGHK3**

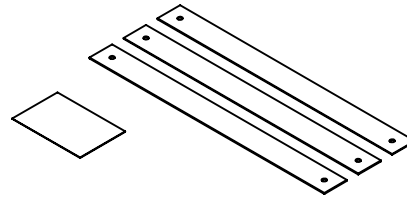

### **PRODUCT FEATURES**

***THIS IS AN ACCESSORY GRAB HANDLE FOR THE ADRIAN STEEL TOPPER LINE, OFFERING AN APPROXIMATELY 9" DROP FROM THE DOOR .***

**KIT OFFERS 3 HANDLES, MEANING 1 PACKAGE WILL OUTFIT ALL TOPPER DOORS.**

**SEE PAGE 2 FOR APPLICATION NOTES, ACCESSORIES AND OTHER PRODUCTS THAT WORK WITH THIS UNIT.**



<i>INSTR. NUMBER</i> : <b>73082</b>	<i>PG:</i> <b>1</b>	<i>REV:</i> <b>B</b>	ITEM NO.	PART NUMBER	DESCRIPTION	QTY.
			1	79221	STRAP, NYLON, 15.75"	3
<i>PART NUMBER</i> : <b>TGHK3</b>			2	BAGTGHK3	BAG FOR TGHK3	1
<i>PART DESC.</i> : TOP GRAB HANDLE, KIT OF 3						

**NOTE: THIS HANDLE IS AN  
OPTIONAL KIT FOR ALL ASCO  
TOPPERS**

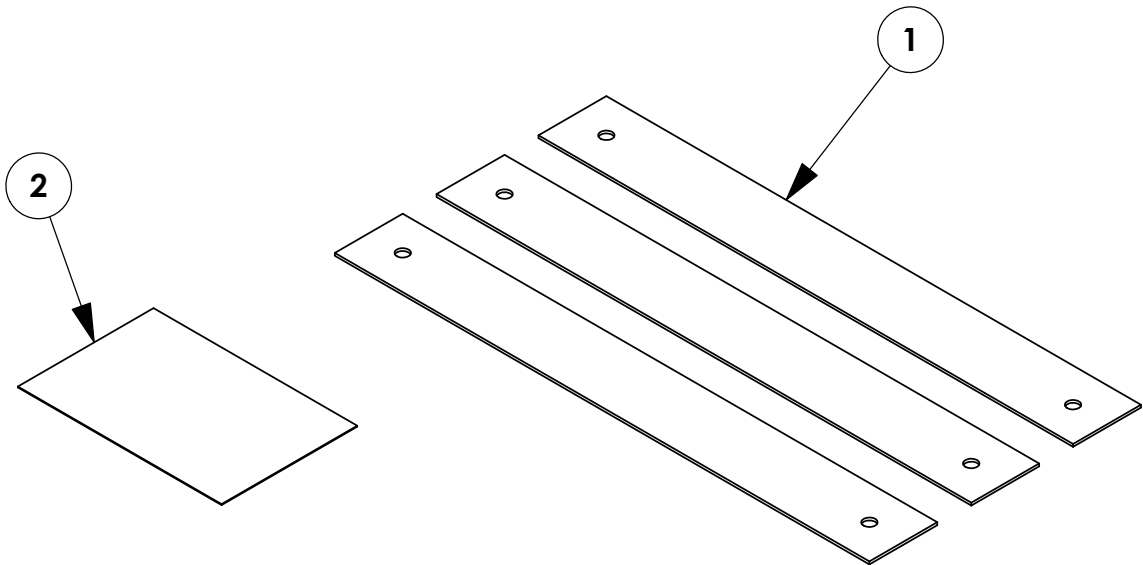

**TOOLS NEEDED:**

- 7/16" SOCKET
- 7/16" WRENCH

**GET TO KNOW THE VEHICLE** - AT THE BEGINNING OF ANY INSTALLATION, CHECK THE LOCATION OF THE FUEL TANK, FUEL LINES, BRAKE LINES, HIGH VOLTAGE BATTERIES AND WIRING HARNESES TO AVOID INJURY OR PROPERTY DAMAGE FROM TOOL CONTACT.

**SEAL ALL EXTERIOR HOLES** - ALL INSTALLATION HOLES SHOULD BE SEALED WITH BUTYL TAPE OR SILICON TO PREVENT WATER AND EXHAUST GASES FROM ENTERING THE VEHICLE.

**CONTROL DRILL DEPTH** - TO AVOID DAMAGE TO THE VEHICLE, USE A DRILL STOP OR CLEARED STEP BIT WHEN DRILLING INSTALLATION HOLES.

**ALWAYS ADD PRIMER** - WHEN ADDING INSTALLATION HOLES BE SURE TO USE A SELF-ETCHING PRIMER TO PREVENT CORROSION, FASTENER FAILURE AND INJURY.

**MOUNTING POINTS MUST HAVE METAL-TO-METAL CONTACT** - USE PROVIDED MOUNTING SPACERS TO ACCOMMODATE FOR VEHICLE FEATURES, CARPET OR SUBFLOORS.

**PROVIDE CLEARANCE FOR SPACERS** - IF THE INSTALLATION VEHICLE CONTAINS A CARPET OR SUBFLOOR, USE A 1-3/16" DIAMETER CARPET CUTTER (P/N: 31183-0) AT ALL MOUNTING LOCATIONS TO OPEN UP ROOM FOR SPACERS.

**CHECK SPACER ORIENTATION** - BE SURE THAT THE INDENT IN THE SPACER COVERS THE PLUSNUT HEAD; THIS ENSURES THE MOST METAL-TO-METAL CONTACT AND REDUCES VIBRATION.

**PLUSNUT INSTALLATION** - A PLUSNUT GUN IS RECOMMENDED FOR PLUSNUT INSTALLATION FOR ITS PRODUCTION SPEED. HOWEVER, A PLUSNUT SETTING TOOL CAN ALSO BE USED (P/N: 22200-0).

**THRU-BOLT CLEARANCE** - WHEN USING A THRU-BOLT AT ANY MOUNTING LOCATION, BE SURE THAT YOUR HOLE HAS 1/16" CLEARANCE.

**FASTENERS USED**

**BAG REFERENCE: BAGTGHK3**

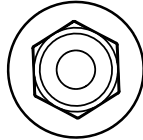

**FAS0055  
1/4-20 ZP  
HFLNG NLK NUT  
QTY: 3**

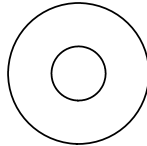

**FAS0067  
1/4-20 ZP  
FLAT WASHER  
QTY: 3**

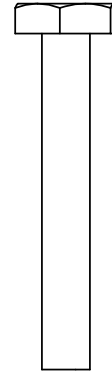

**FAS0521  
1/4-20 X 1.75 ZP  
HH SCREW  
QTY: 3**

**INTENTIONALLY LEFT BLANK**

**STEP 1 - INSTALL DOOR HANDLES**

**Step 1.1  
INSTALL DOOR  
HANDLES TO  
TUBE STRUCTURE  
ON REAR AND  
SIDE DOORS.**

**FULLY TIGHTEN  
FAS0521,  
FAS0067,  
FAS0055  
(3 PLACES)  
7/16" WRENCH  
7/16" SOCKET**

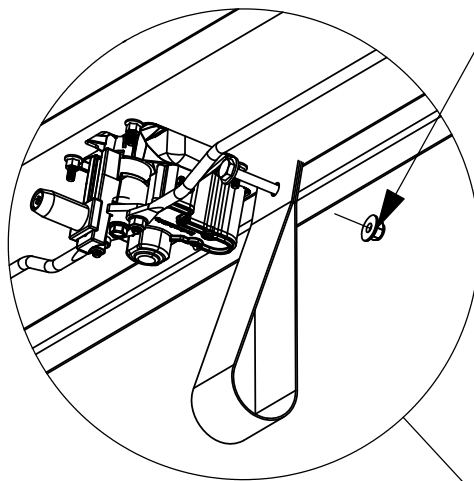

**Step 1.1**

**NOTE: HANDLE GOES ON OUTSIDE  
OF DOOR SUPPORT TUBE!**

