

PRODUCT WEIGHT
108 LBS

WIDTH x DEPTH x HEIGHT
FORD TRANSIT MR

CAPACITY
N/A

COLOR
GRAY

CATALOG NUMBER
SPARFTM

PRODUCT FEATURES

THE SLIDING PARTITION FOR THE FORD TRANSIT MID ROOF VAN. PARTITION ALLOWS FOR FULL SEAT TRAVEL AND PARTIAL DECLINE OF BOTH THE DRIVER AND PASSANGER SEATS. PARTITION WIL WORK WITH BOTH SINGLE AND DUAL SLIDING DOOR MODELS. ACCESSORIES CAN BE MOUNTED TO THE PASSANGER SIDE PANEL WITH EXISTING HOLES OR DRILLED HOLES. SEE NEXT PAGES FOR ACCESSORIES.

SEE PAGE 2 FOR APPLICATION NOTES AND ACCESSORIES, OTHER PRODUCTS THAT WORK WITH THIS UNIT.



CATALOG NUMBER SPARFTM

PRODUCT APPLICATION

This product is designed to be installed into the Ford Transit Mid Roof Cargo Van

ACCESSORIES THAT WILL WORK WITH THIS PRODUCT

| <i>CATALOG NUMBER</i> | <i>DESCRIPTION</i> |
|------------------------------|---|
| PA7 | REFLECTOR KIT (EXISTING HOLES FOR MOUNTING) |
| PA8 | FIRE EXT.1A:10BC 2.5# (DRILLING REQUIRED TO MOUNT) |
| PA9 | FIRST AID TRAY (EXISTING HOLES FOR MOUNTING) |
| SPARLHK | SLIDING PARTITION, LOCKING HANDLE KIT |

SPECIAL APPLICATION NOTES

Introduction / Comments:

ASSEMBLY INSTALLATION INSTRUCTIONS FOR THE SPARFTM—SLIDING PARTITION, FT MID ROOF

Note:

It is advised that all fasteners used in this assembly and installation should be checked for tightness at the following intervals: @ 2-weeks and again @ 6-weeks of operation. This preventive maintenance step must be completed to ensure your Partition gives you long service life.

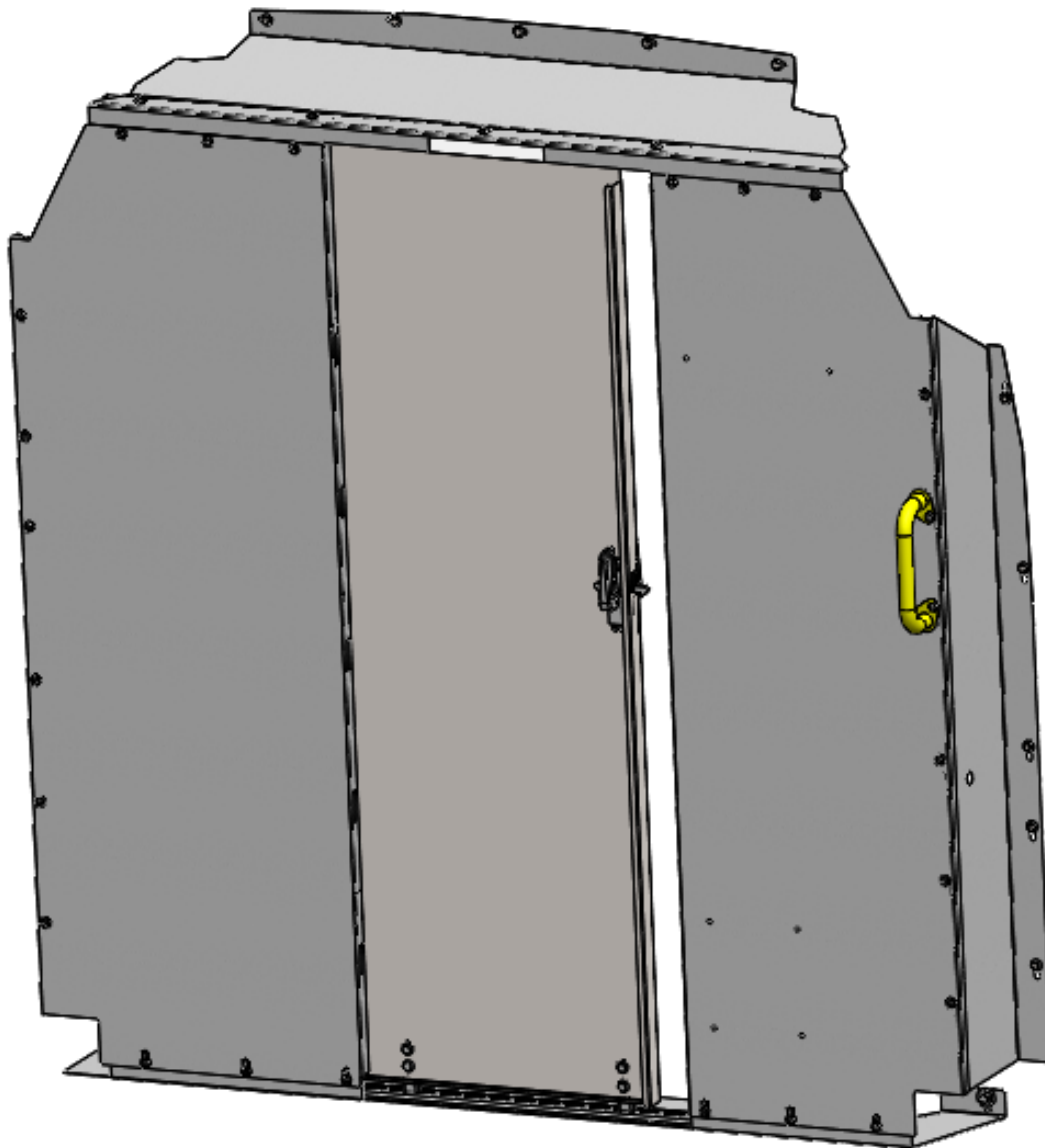

**SPARFTM
SLIDING PARTITION, FORD
TRANSIT MID ROOF**

- PRECAUTIONS -





 **CAUTION** 
**THE USE OF AIR IMPACT TOOLS CAN
OVER-TORQUE FASTENERS AND
CAUSE FASTENER FAILURE!**



 **CAUTION** 
**ALL INSTALLATION HOLES SHOULD BE SEALED
WITH SILICON OR BUTYL SEALANT TO PREVENT
EXHAUST FUMES FROM ENTERING THE VEHICLE!**



 **DANGER** 
**INSPECT FOR FUEL TANK, FUEL LINES, BRAKE LINES, HIGH
VOLTAGE BATTERIES AND ELECTRICAL LINES PRIOR TO
DRILLING TO AVOID DAMAGING CRITICAL VEHICLE SYSTEMS
OR INJURY TO INSTALLER DURING INSTALLATION PROCESS!**



 **CAUTION** 
**TO AVOID DAMAGING THE VEHICLE ALWAYS
USE DRILL STOPS WHEN DRILLING ANY IN-
STALLATION HOLES!**



- IMPORTANT WARRANTY REQUIREMENTS -

1. SUBSTITUTING ADRIAN STEEL SPECIFIED FASTENERS FOR ASSEMBLY AND/OR INSTALLATION WILL VOID YOUR PRODUCT WARRANTY.
2. ALL HOLES DRILLED INTO VEHICLE SHOULD HAVE THE RAW METAL EDGES SEALED WITH A SELF-ETCHING PRIMER TO RESIST CORROSION AND POTENTIAL FASTENER POINT FAILURE.
3. ALL FASTENERS USED IN THE INSTALLATION OF THIS PRODUCT SHOULD BE TIGHTENED TO THE TORQUE(S) SPECIFIED IN THESE INSTRUCTIONS.
4. THESE INSTRUCTIONS SHOULD BE KEPT WITH THE VEHICLE.

THE BASIC TOOLS NEEDED FOR MOST INSTALLATIONS



DRILL



DRILL BIT WITH
STOP

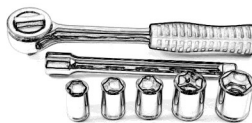

RATCHET, SOCKETS
AND/OR WRENCHES



SCREWDRIVERS



MEASURING TAPE

ADDITIONAL TOOLS MAY BE NEEDED FOR THIS INSTALLATION AND THEY WILL BE IDENTIFIED IN THE STEPS THAT FOLLOW.

If your vehicle contains carpet or a rubber floor mat you will need to prepare the mounting location. Position the product to be installed into the vehicle and once you are satisfied with the mounting locations, mark the mounting locations. Using a 1-3/16" diameter carpet cutter (P/N: 31183-0). Select the appropriate floor spacers as shown in the illustration. Set those aside for use later into the installation process.

Using the correct drill bit size for the selected plusnut, drill the mounting holes in the vehicle sheet metal to prepare for installing the plusnuts.

If you are thru-bolting at any of the locations simply drill a hole that is 1/16" larger than the bolt size(s) for those locations.

Once you have drilled the holes into the vehicle, the raw metal edges should be sealed using a self-etching primer to resist corrosion and potential fastener point failure.

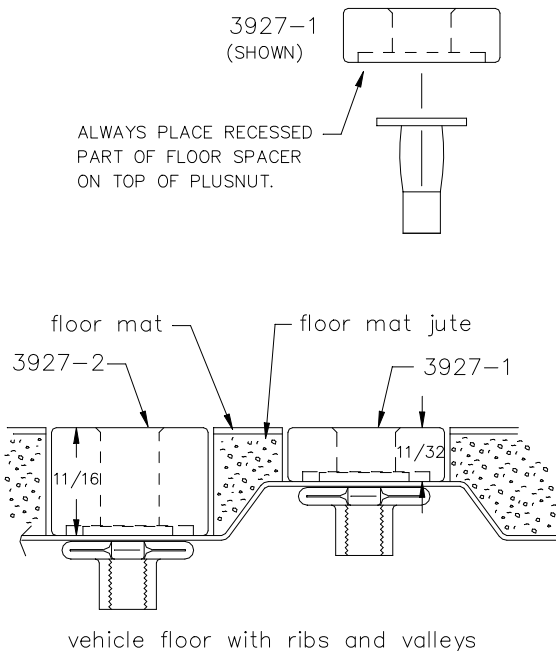

A PLUSNUT (RIVNUT) SETTING TOOL IS REQUIRED FOR PLUSNUT (RIVNUT) INSTALLATION AND IS SUPPLIED WITH THIS KIT. OR USE AN AIR POWERED PLUSNUT SETTING GUN.

1/4-20UNC Plusnut (FAS0052) Use 3/8" dia. drill w/stop

FAS0080 SCREW, HXHD, 1/4-20UNCx2.00", G8

FAS0067 WASHER, FLAT, 1/4"ID

22200-0 PLUSNUT TOOL

5/16-18UNC Plusnut (FAS0091) Use 1/2" dia. drill w/stop

FAS0095 SCREW, HXHD, 5/16-18UNCx2.00", G8

FAS0086 WASHER, FLAT, 5/16"ID

22200-0 PLUSNUT TOOL

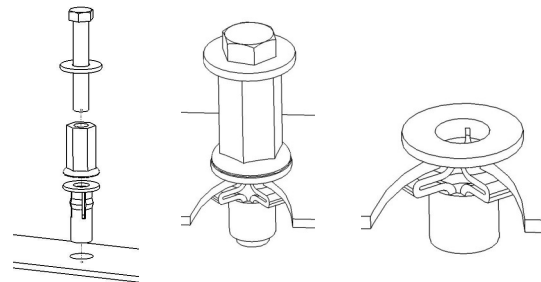

Place barrel of the plusnut body in sheet metal thru hole until flange is flush with sheet metal.

Using a 9/16" combination wrench of plusnut tool body and a second hand wrench, ratchet, or air tool, rotate the hex bolt head CW to draw plus nut flanges up (set the plusnut).

Assembly and Installation Fastener Identification Sheet (BAG62570)

| ITEM NO. | PART NUMBER | DESCRIPTION | |
|----------|-------------|----------------------------------|----|
| 1 | BAG0507-A | 5" x 7" 3MIL AUTOBAG | 1 |
| 2 | FAS0052 | PLUSNUT, 1/4-20 PB DC | 10 |
| 3 | FAS0124 | WASHER,FLAT USS 1/4 ZN | 27 |
| 4 | FAS0060 | WASHER,LCK SPLIT 1/4 ZP | 15 |
| 5 | FAS0078 | SCREW,HH 1/4-20X1 G8 ZP | 10 |
| 6 | FAS0274 | NUT, CLIP-ON, U-STYLE, 1/4-20UNC | 28 |
| 7 | FAS0018 | SCREW,HH SFLNG 1/4-20X.62 ZP | 28 |
| 8 | FAS0029 | NUT,HEX NLK 10-24 ZP | 4 |
| 9 | FAS0674 | SCREW,BHCS 10-24X.75 SS | 4 |
| 10 | FAS0187 | SCR,HH,M6-1.0X22 | 10 |
| 11 | FAS0090 | NUT,HEX NLK 5/16-18 ZP | 8 |
| 12 | FAS0587 | SCREW,HH 5/16-18X1.25G5ZN | 4 |
| 13 | FAS0482 | Washer, Flat 7/16 | 2 |
| 14 | FAS0408 | SCREW,HH 7/16-20 X 1.25 | 2 |
| 15 | FAS0557 | WASHER, RET 5/16, NY | 4 |

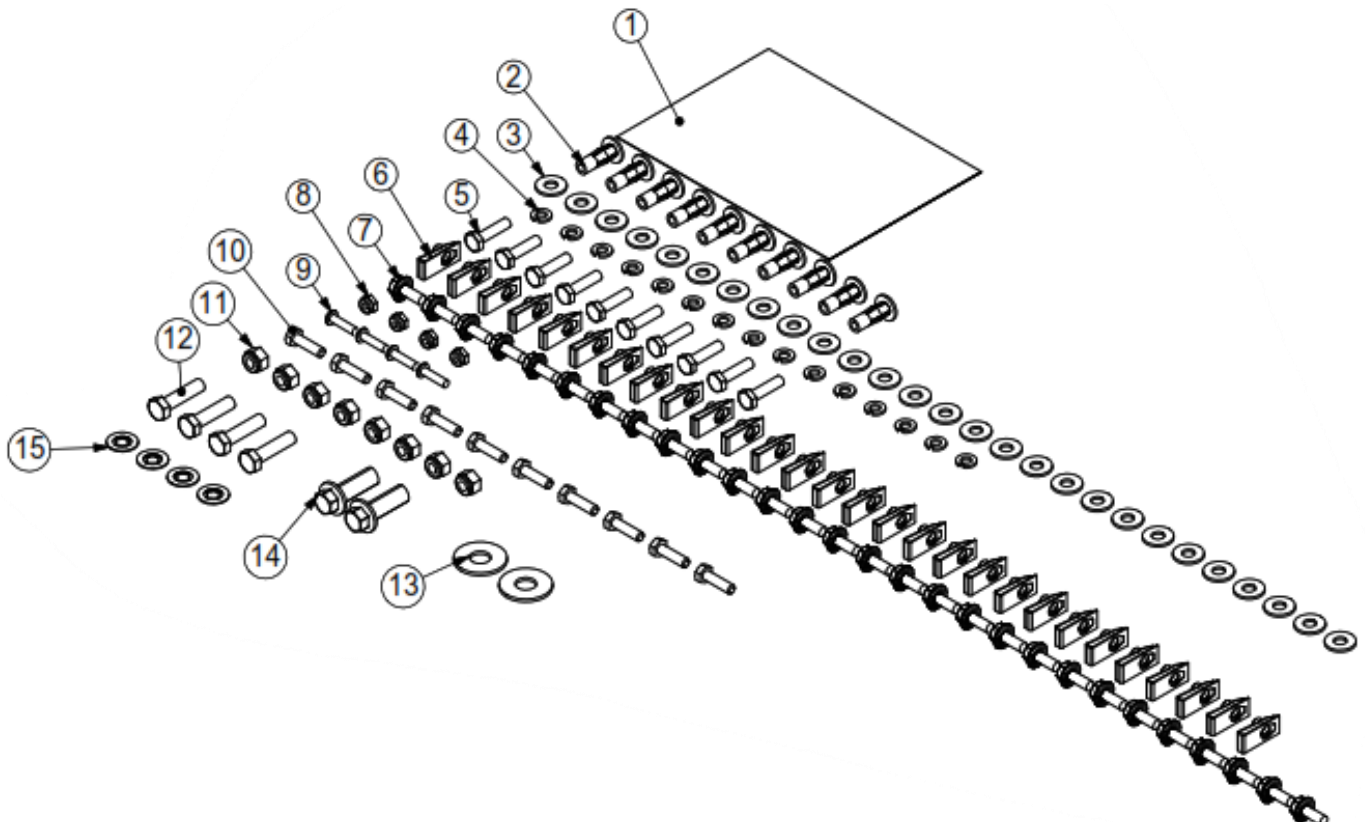

Assembly and Installation HARWARE KIT (HDW62569)

| ITEM NO. | PART NUMBER | DESCRIPTION | QTY. |
|----------|-------------|---------------------------|------|
| 1 | 30245-0 | GLIDE-LK8 | 2 |
| 2 | 59180 | BUSHING, 0.750 x .419 LG | 2 |
| 3 | 58084-0 | LATCH ASSEMBLY | 1 |
| 4 | 58084-1 | HANDLE AND SHAFT ASSEMBLY | 1 |
| 5 | 58084-2 | HANDLE ASSEMBLY | 1 |
| 6 | 53865 | GLIDE SUPPORT ASM, LK | 2 |
| 7 | 59183 | GUIDE BLOCK | 2 |
| 8 | 59182-G | GUIDE BAR BACKER, GRAY | 2 |
| 9 | CRT06987-A | CARTON HARDWARE FOR KD | 1 |
| 10 | 59288 | LATCH SPACER | 1 |
| 11 | FA50688 | WASHER, FLAT .36X.81 BK | 3 |
| 12 | 52666 | GASKET, D-SECTION, 8"LG | 4 |
| 13 | 60991 | FOAM STRIP 1/2"X1.0"X2.0" | 3 |
| 14 | 51401 | CONSPICUITY TAPE, 1 X 8 | 2 |

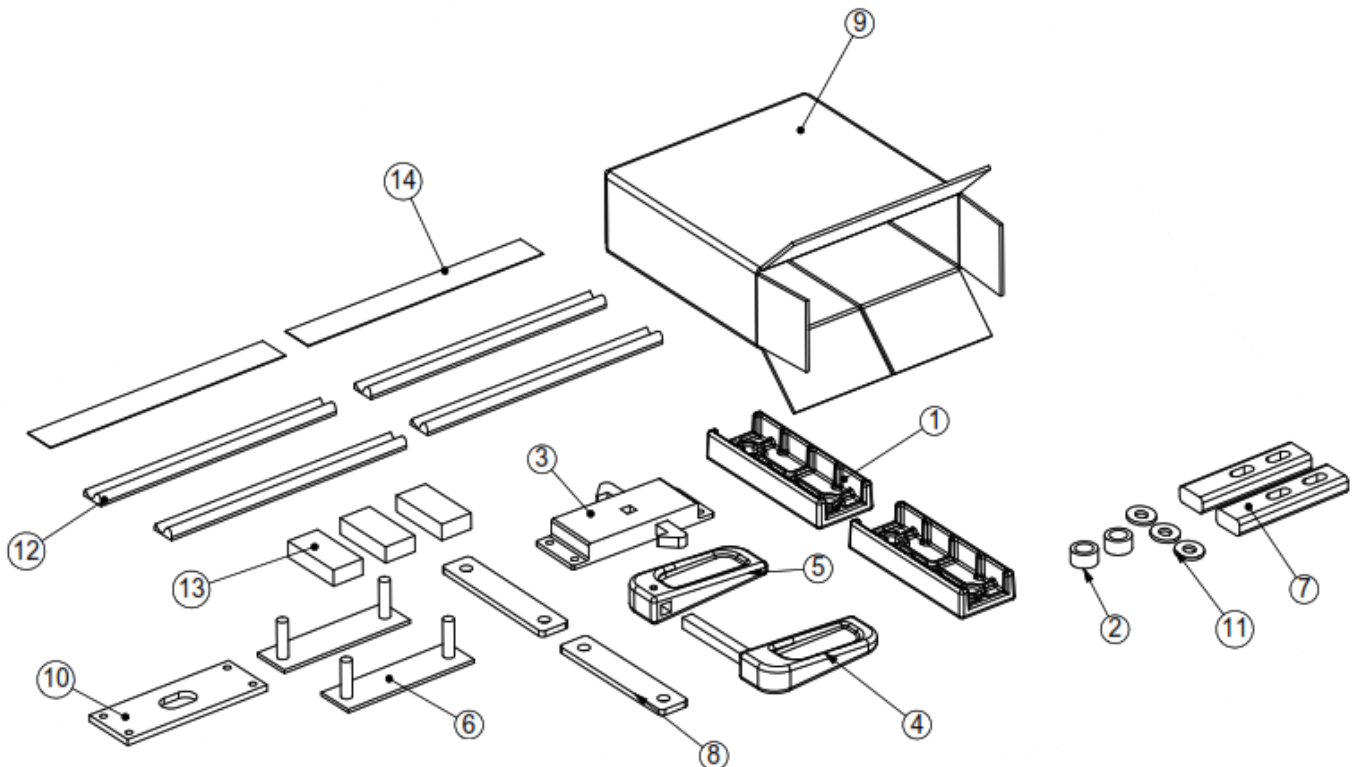

NOTE: REMOVE GRAB HANDLE FROM THE PASSANGER SIDE SLIDER DOOR BEFORE STARTING THIS INSTALL. GRAB HANDLE WILL BE RELOCATED ONTO THE INSTALLED PARTITION. (REMOVE DRIVER SIDE HANDLE IF THE VAN IS A DUAL DOORED VAN.

STEP 1 - MARK AND DRILL HOLES TO MOUNT HEADER. (3/8" SIZE HOLE)

USE THE HEADER TO MARK THE DRILL LOCATIONS (USE THE CENTER OF THE SLOTS). CENTER THE HEADER ON THE B PILLAR ROOF BOW AND BRING IT DOWN ABOUT 1" FROM THE TOP SEAM. ONCE THE HOLES ARE DRILLED MOUNT THE (FAS0052) - 1/4-20 PLUSNUTS TO THE ROOF BOW. (5 HOLES AND PLUSNUTS)

NOTE: DO NOT INSTALL HEADER YET, PICTURE BELOW IF FOR REFERENCE



STEP 2 - PRE-ASSEMBLE HEADER AND HEADER RAIL.

USE THE (FAS0274) 1/4-20 U NUT CLIPS (10 PLACES) INTO THE HEADER AND HEADER RAIL. THEN USE (FAS0018) 1/4-20 FLANGED BOLT (4 PLACES) TO JOIN THE HEADER AND HEADER RAIL TOGETHER. ***DO NOT OVER TIGHTEN FASTENERS***

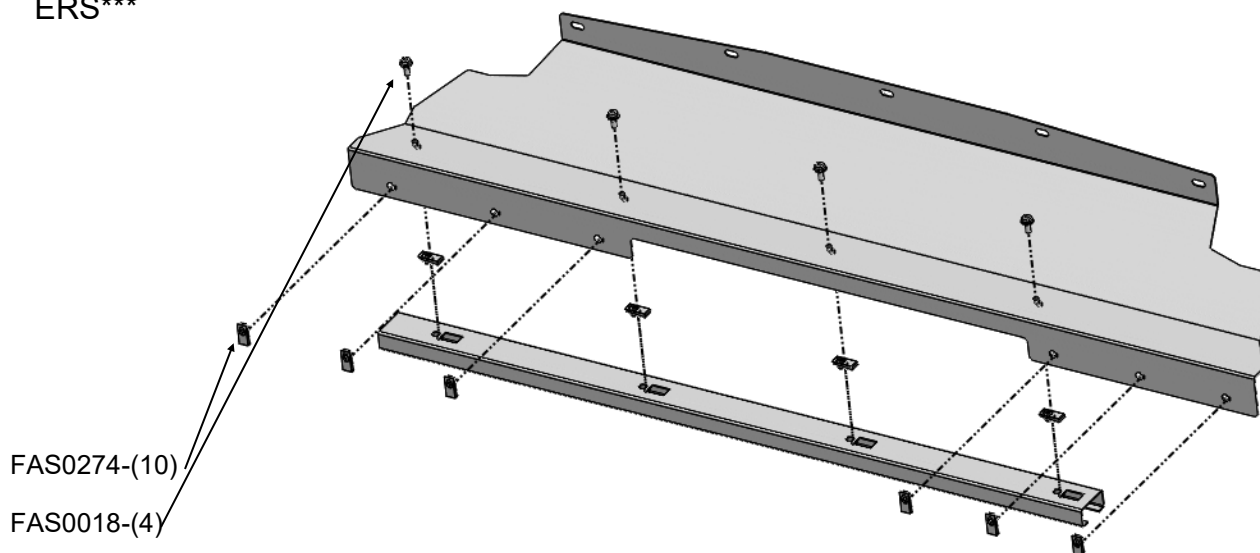

STEP 3 - FASTEN ASSEMBLED HEADER TO THE ROOF BOW.

MOUNT THE HEADER USING THE 1/4-20 PLUSNUTS ALREAD SET FROM STEP 1. USE (5) OF EACH OF THE FOLLOWING FASTENERS; FAS0124 (WASHER), FAS0060 (LOCK WASHER) , AND FAS0078 (1/4-20 1" LONG BOLT)

NOTE: LEAVE THESE FASTENERS LOOSE SO THE HEADER CAN BE SHIFTED LEFT AND RIGHT.

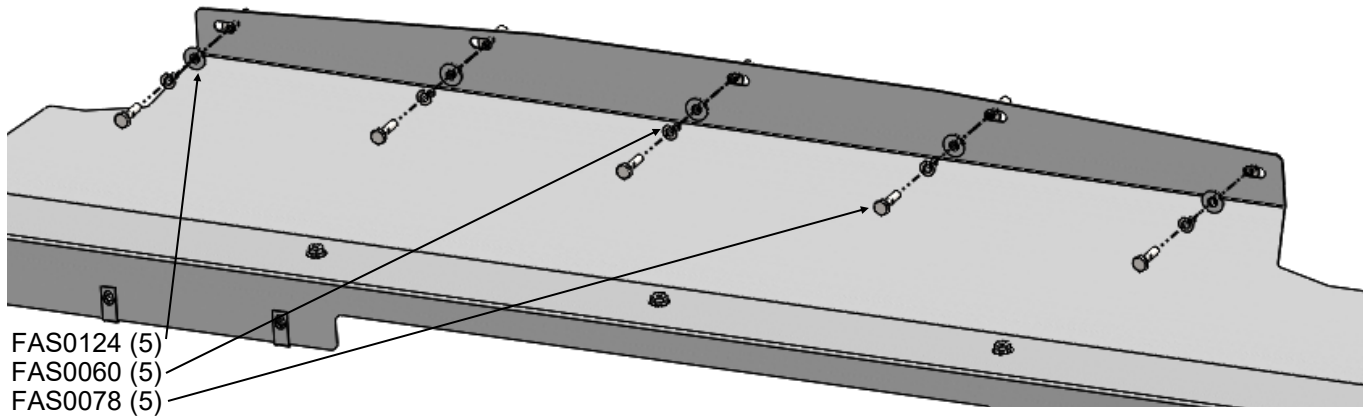

STEP 4 - ASSEMBLE AND INSTALL FOOTER.

INSERT (FAS0274) 1/4-20 U NUT CLIPS INTO THE FOOTER (6 PLACES) AND THEN INSTALL THE FOOTER TO THE VAN USING THE OEM D-RING HOLES. RE-USE THE OEM D-RINGS OR THE PROVIDED FAS0408 BOLT (2) AND FAS0482 WASHER (2) TO MOUNT THE FOOTER.

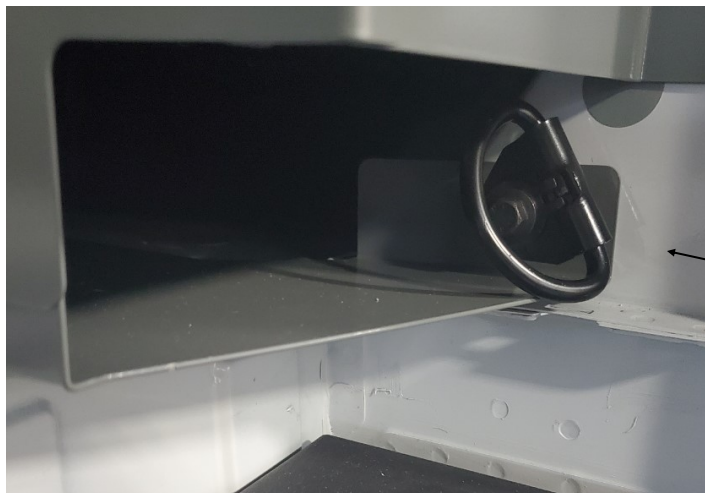
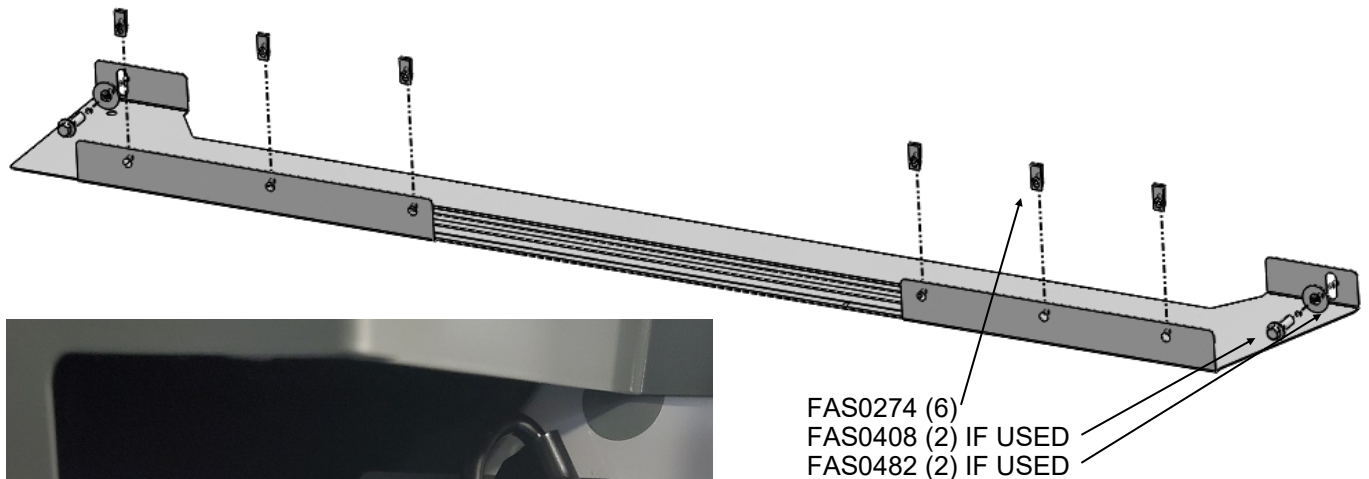
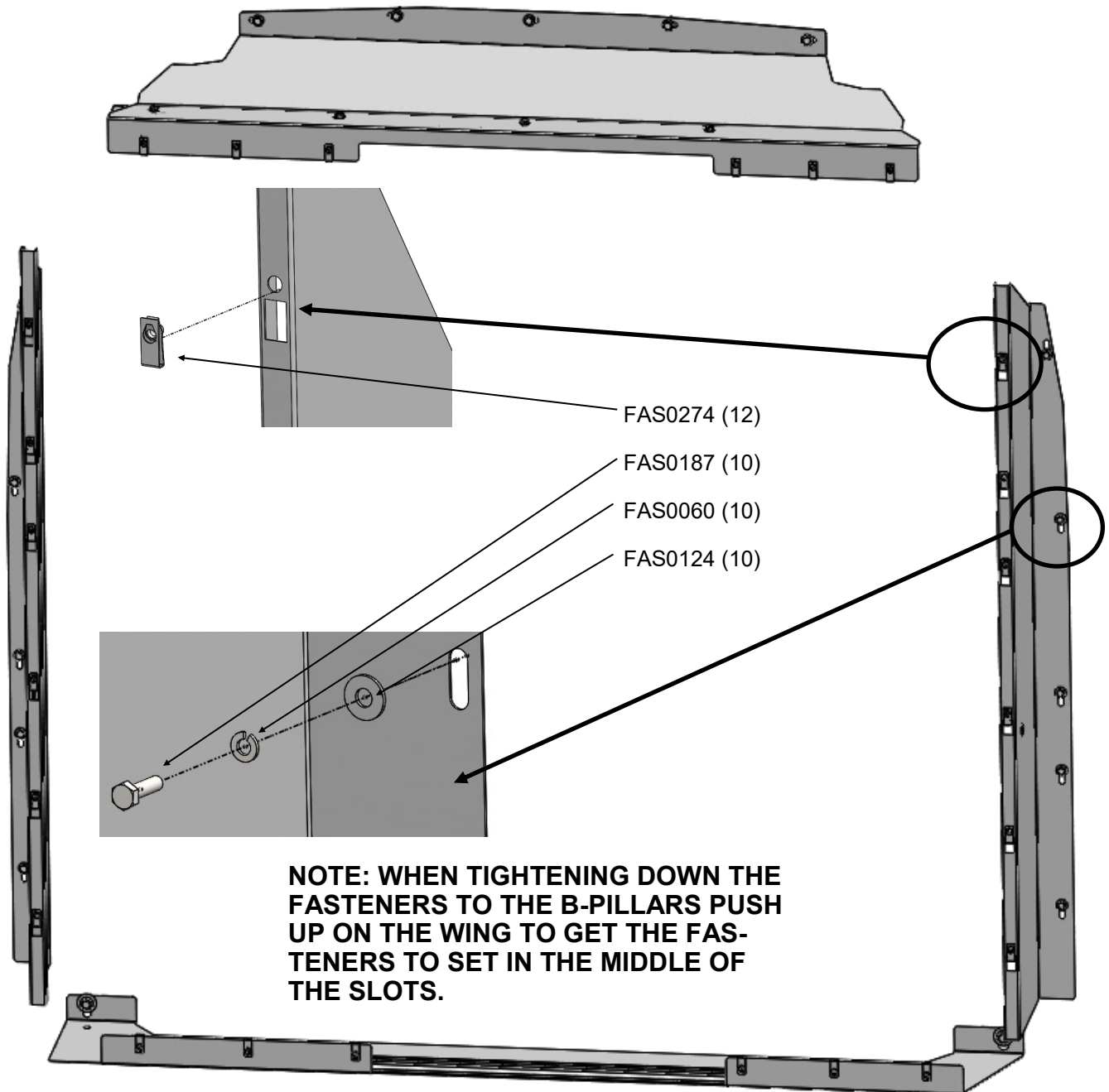

IMAGE SHOW THE FOOTER
INSTALLED WITH THE OEM D
-RINGS.

STEP 5 - ASSEMBLY AND INSTALL DRIVER AND PASSANGER SIDE WINGS.

INSERT THE (FAS0274) 1/4-20 U NUT CLIPS INTO THE WINGS (12 PLACES). USE FAS0124 WASHER (10), FAS0060 LOCK WASHER (10), AND FAS0187 M6 BOLT (10) TO ATTACH THE WINGS TO THE B-PILLAR OF THE VAN.



NOTE: IF THERE ARE NO OEM M6 INSERTS ON THE DRIVER'S SIDE B-PILLAR THE EXISTING HOLES MUST BE DRILLED OUT TO 3/8" HOLE AND THE FAS0052 1/4-20 PLUSNUT INSTALLED. USE THE FAS0078 1/4-20 BOLT INSTEAD OF THE M6 BOLT.

STEP 6A - MOUNT THE DRIVER SIDE PANEL.

MOUNT THE DRIVER SIDE WING WITH FAS0018 FLANG BOLTS (12 PLACES). ONCE THE PANEL IS MOUNTED STICK THE FOAM STRIPS (60991) FROM THE HARDWARE BOX TO THE CHANNEL ON THE CAB SIDE OF THE PARTITION AS SHOWN (3 PLACES)

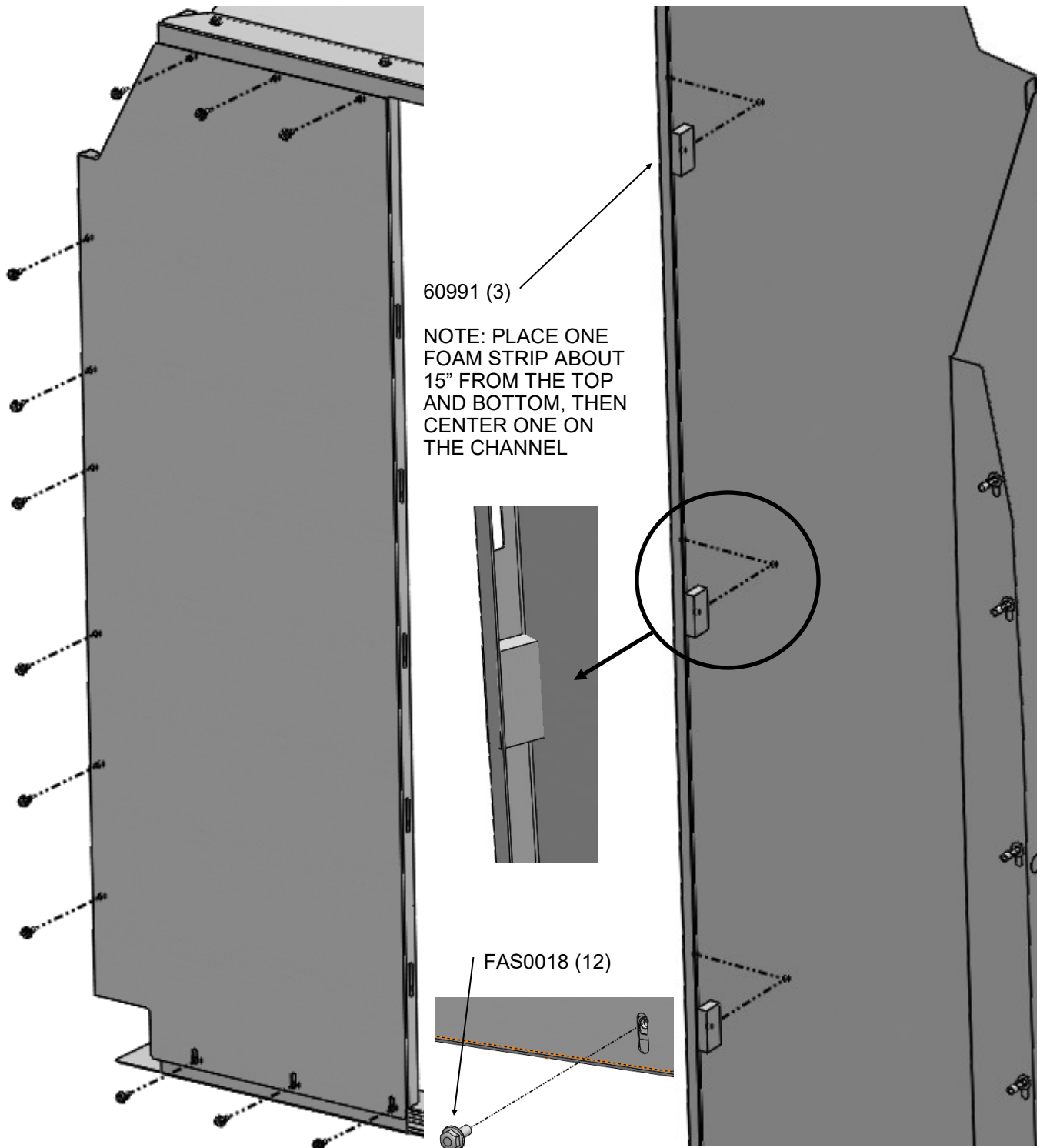

STEP 6B - MOUNT THE PASSANGER SIDE PANEL.

MOUNT THE PASSANGER SIDE WING WITH FAS0018 FLANG BOLTS (12 PLACES). ALSO RE-MOUNT THE OEM GRAB HANDLE IN THE POSITION SHOWN. ONCE THE PANEL IS MOUNTED STICK THE FOAM GASKETS (52666) FROM THE HARDWARE BOX TO THE DOOR OPENING OF THE PARTITION AS SHOWN (2 PLACES)

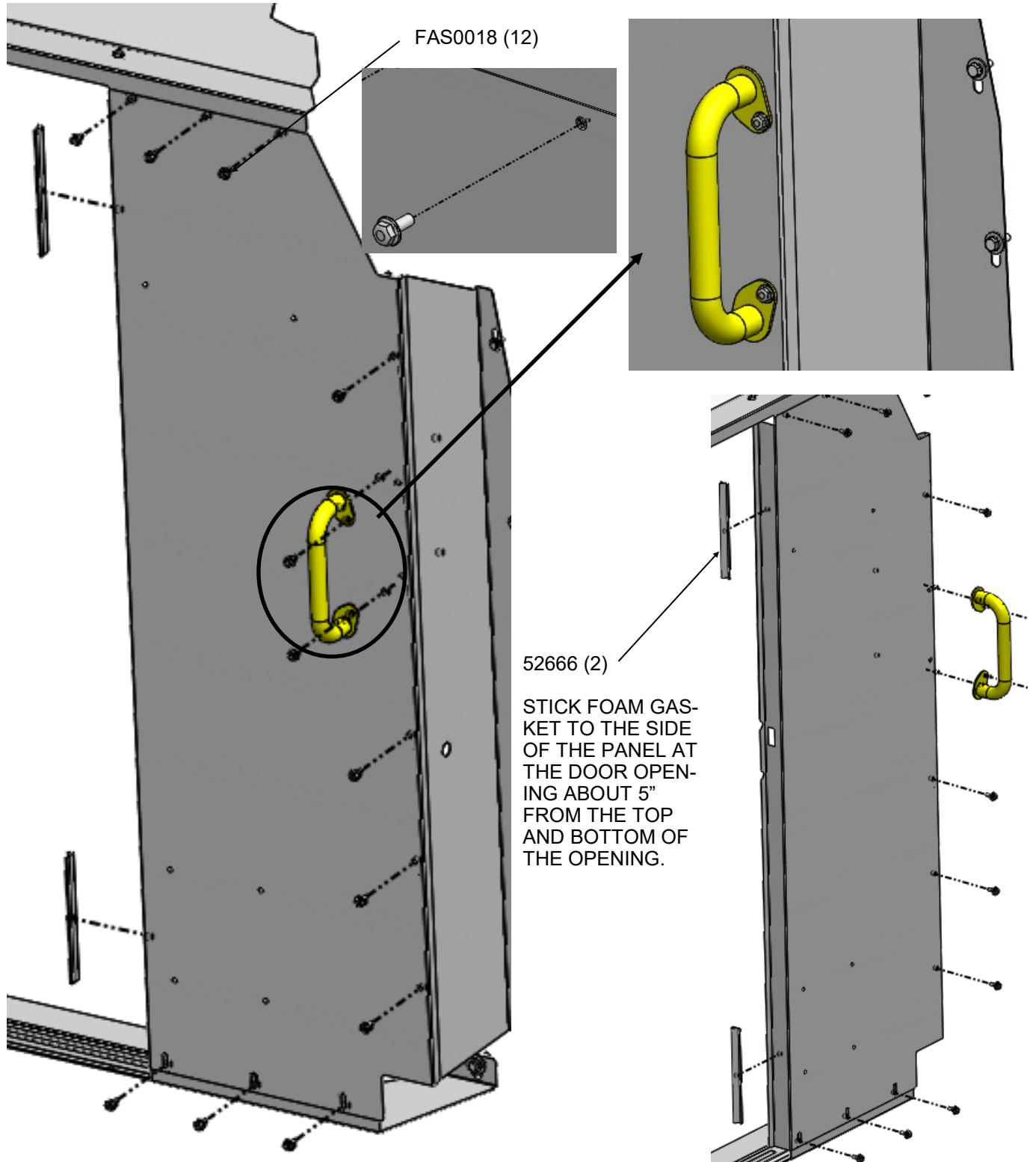

STEP 7 - ASSEMBLE TOP GLIDES AND INSERT THEM IN THE HEADER RAIL

ASSEMBLE THE TOP GLIDES AND INSERT THEM IN THE HEADER RAIL. PARTS 53865 (SUPPORT ASM), 30245-0 (GLIDE), AND 59182-G (GUIDE BAR) CAN BE FOUND IN THE HARDWARE KIT WHILE FAS0557 (RETAINING WASHER) CAN BE FOUND IN THE FASTENER BAG.

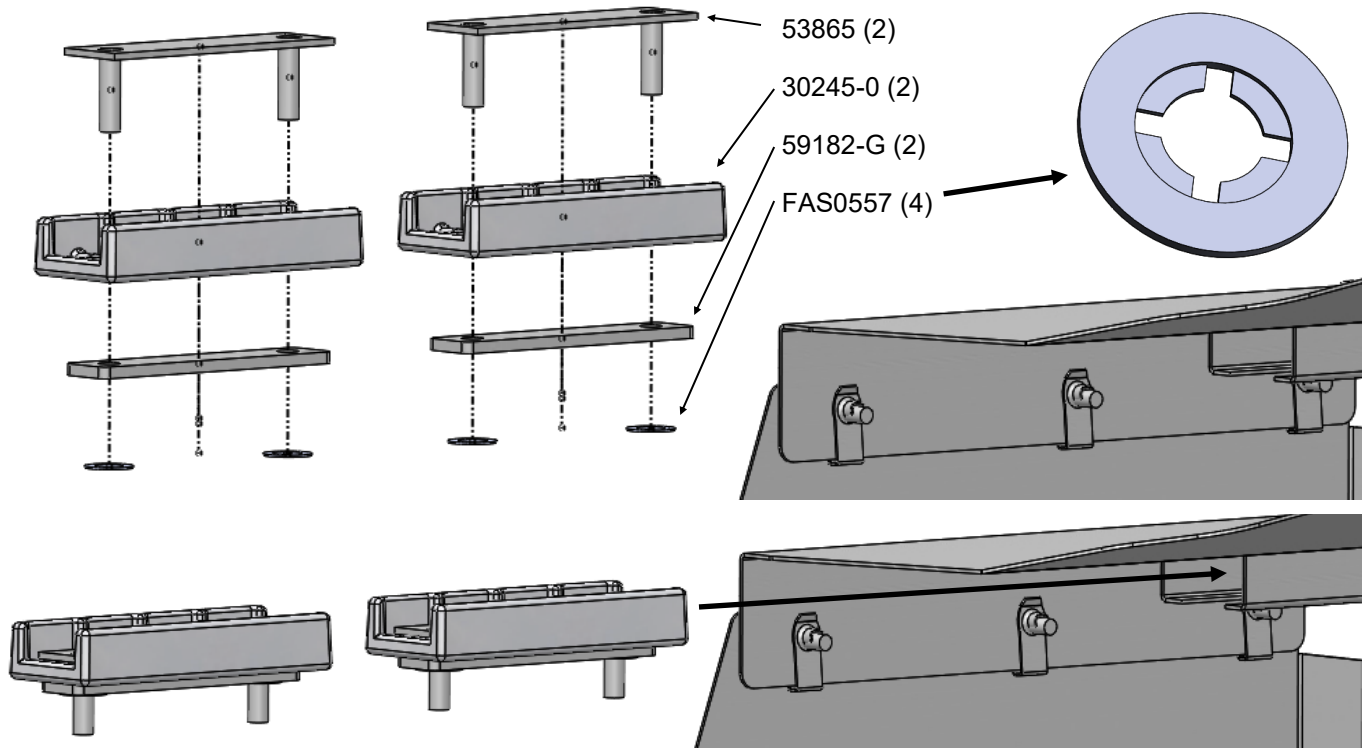

STEP 8A - ASSEMBLE DOOR LATCH

ASSEMBLE THE DOOR LATCH USING THE FOLLOWING HARDWARE AND FASTENERS.

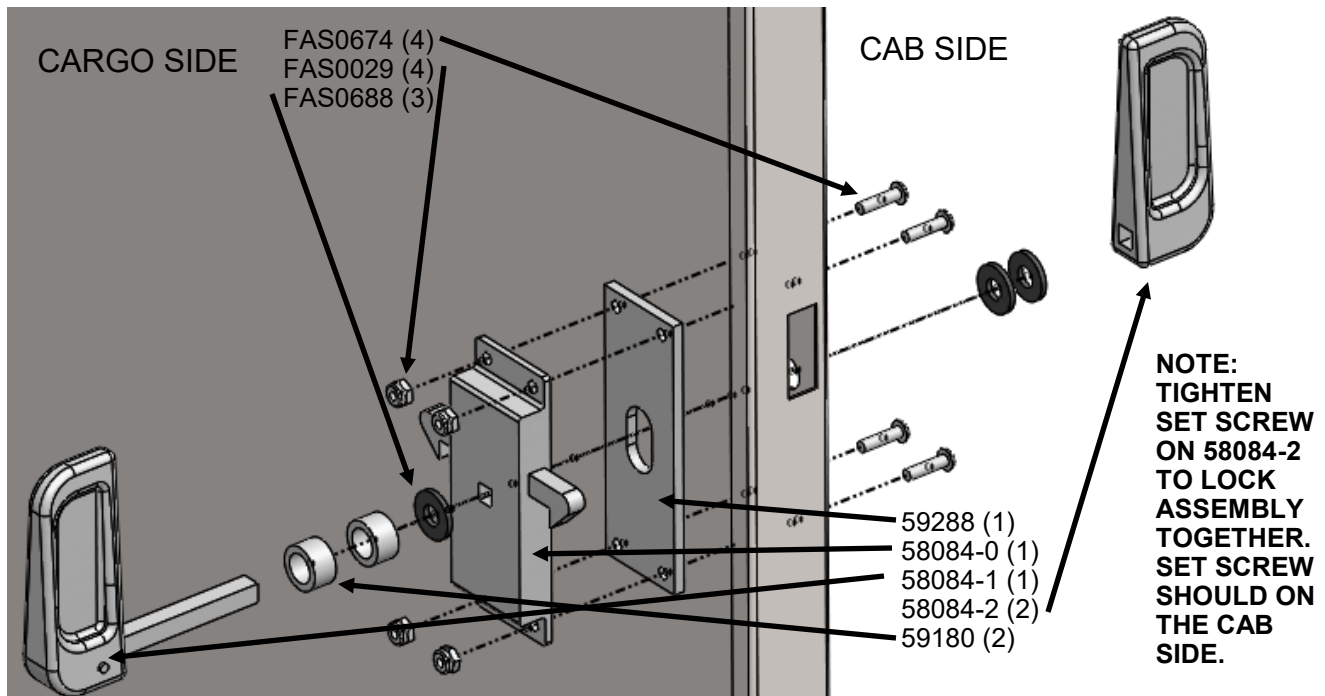

STEP 8B - MOUNT THE DOOR TO THE GLIDES.

MOUNT THE DOOR TO THE GLIDES USING FAS0124 WASHER (4) AND FAS0090 NY-LOCK NUT (4).

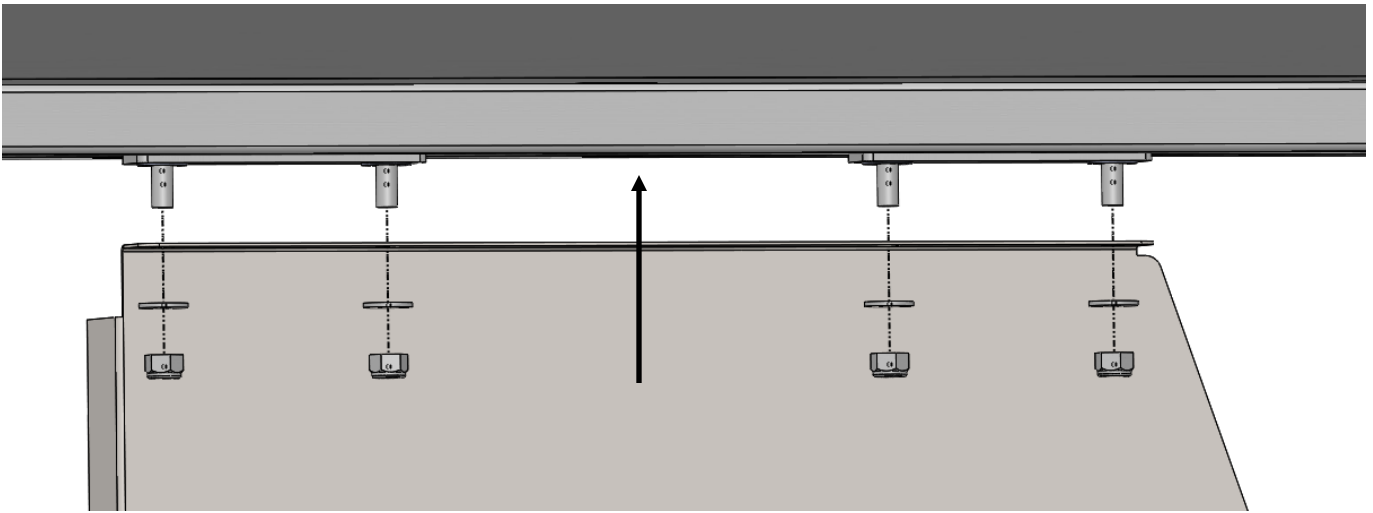

STEP 8C - MOUNT THE BOTTOM GLIDES TO THE DOOR AND ADJUST.

MOUNT THE BOTTOM GLIDES (59183) TO THE DOOR WITH FAS0587 5/16 BOLT (4), FAS0124 WASHER (8), AND FAS0090 NYLOCK NUT (4).

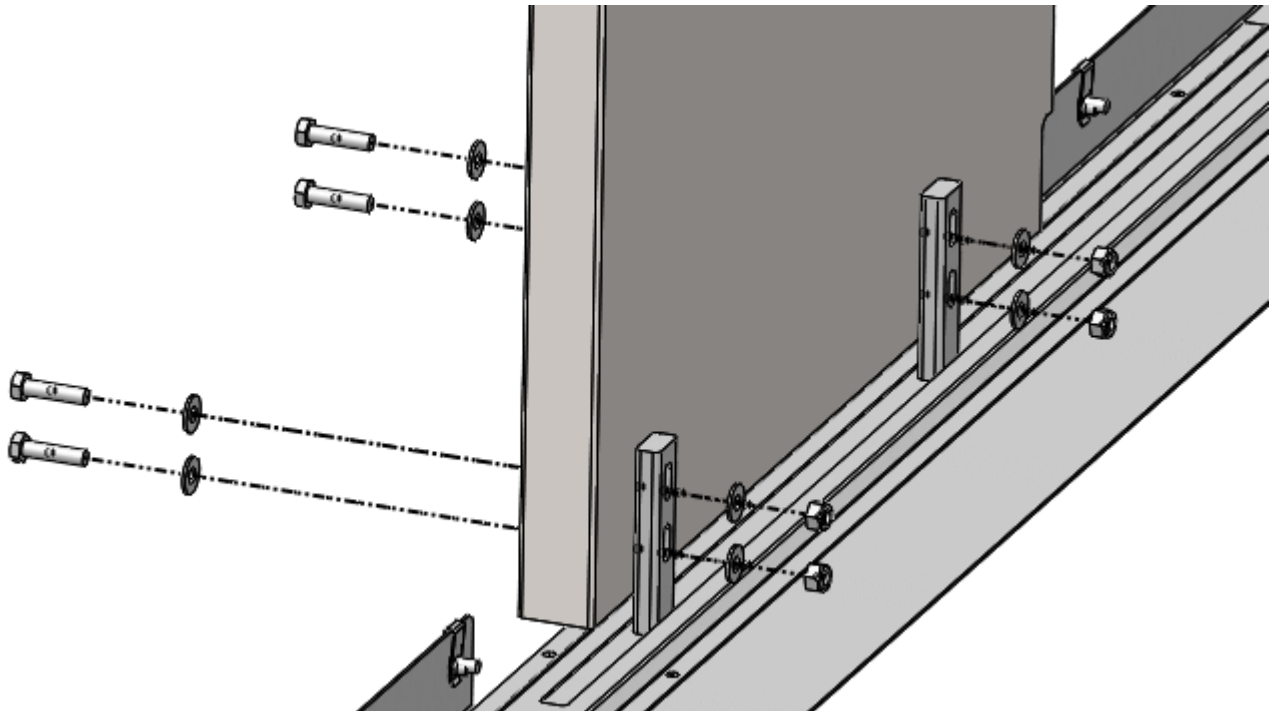

NOTE:

ADJUST THE BOTTOM GLIDES UPWARD ABOUT 1/16" OFF THE FOOTER SO THE DOOR CAN SLIDE FREELY BUT STILL BE CONTAINED BY THE FOOT CHANNEL.

STEP 9 - STICK ON 51401 CONSPICUITY TAPE ON BOTH SIDES OF THE HEADER RAIL. CENTER THE TAPE OVER THE MIDDLE OF THE DOOR OPENING.

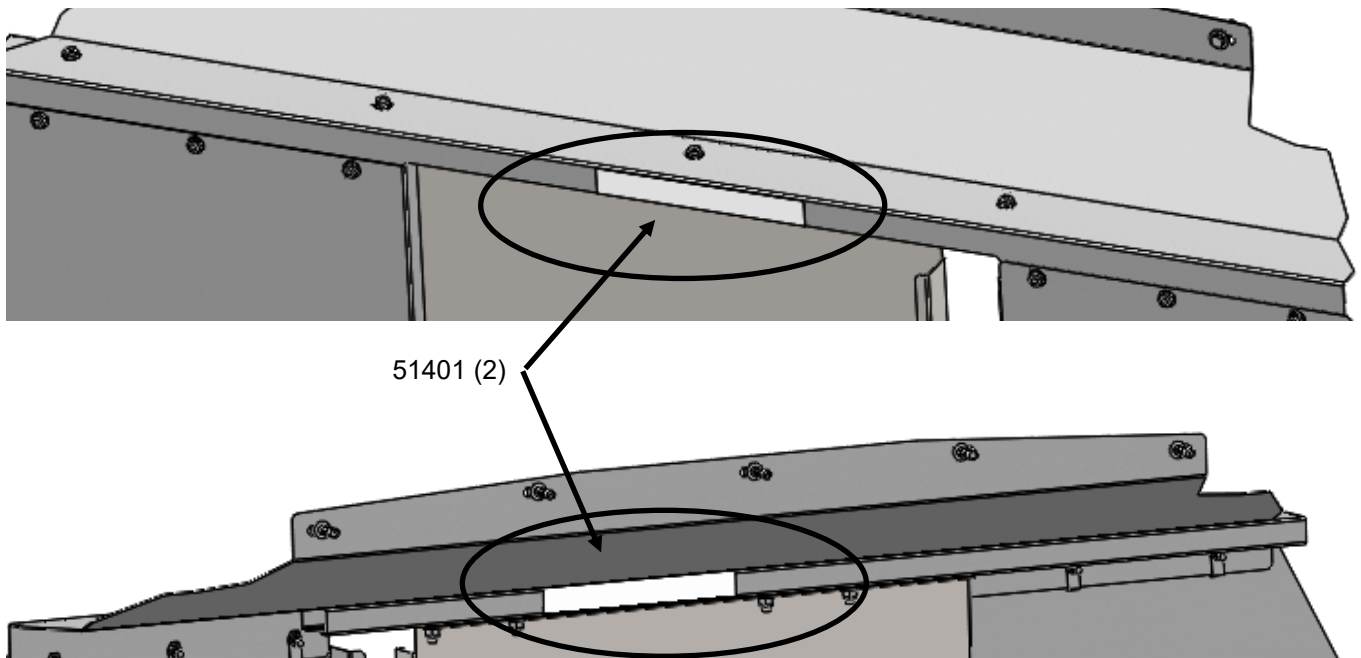

STEP 10 - STICK FOAM GASKET, 52666 (2) TO SIDE OF THE DRIVER'S SIDE WING AND PANEL. ABOUT 12" FROM THE TOP AND BOTTOM. THIS HELPS TO DOOR FROM SLAMMING OPEN.

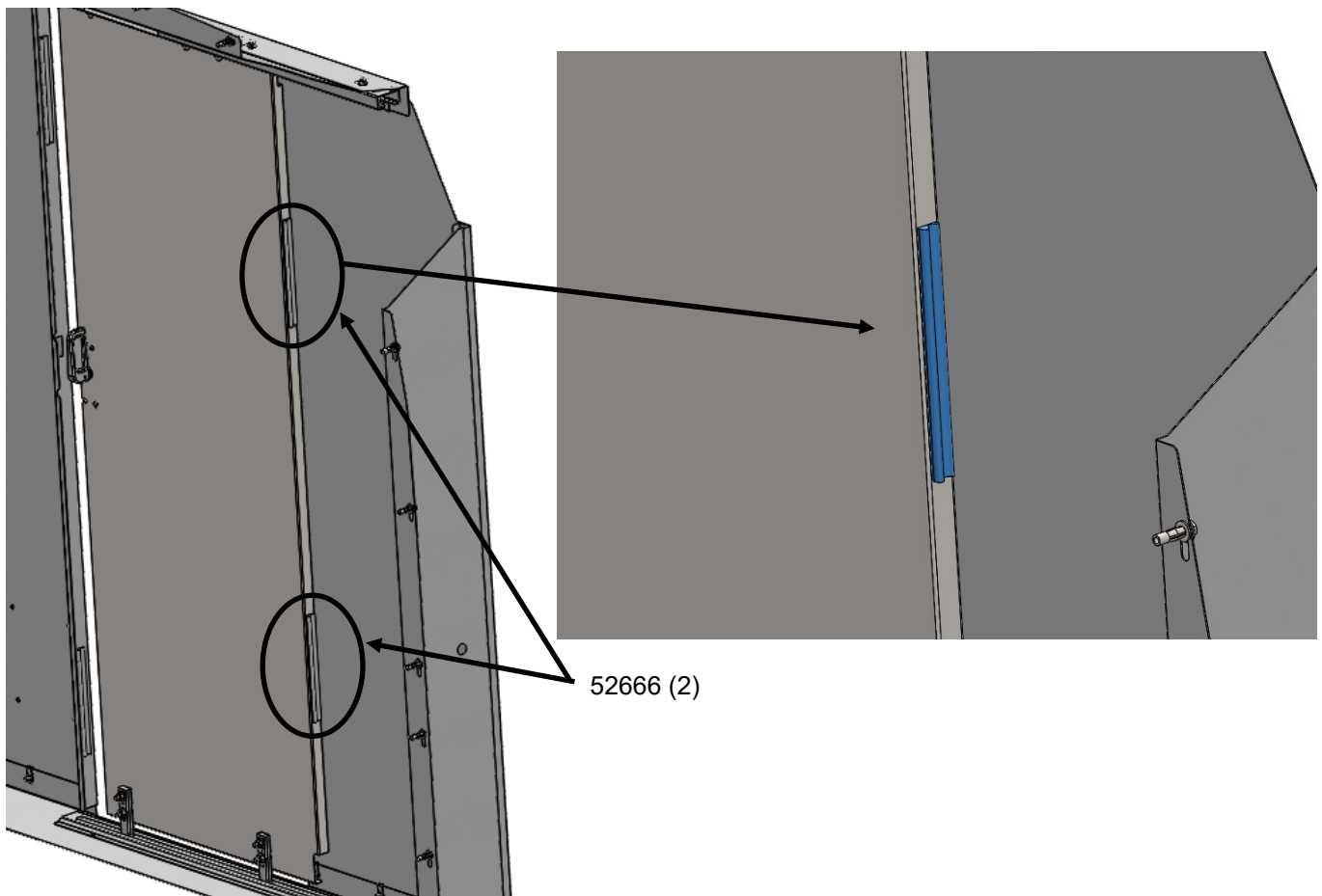



INSTALLATION IS COMPLETE! MAKE SURE THAT ALL FASTENERS THAT WERE LEFT LOOSE FOR THE INSTALL ARE NOW TIGHTED.

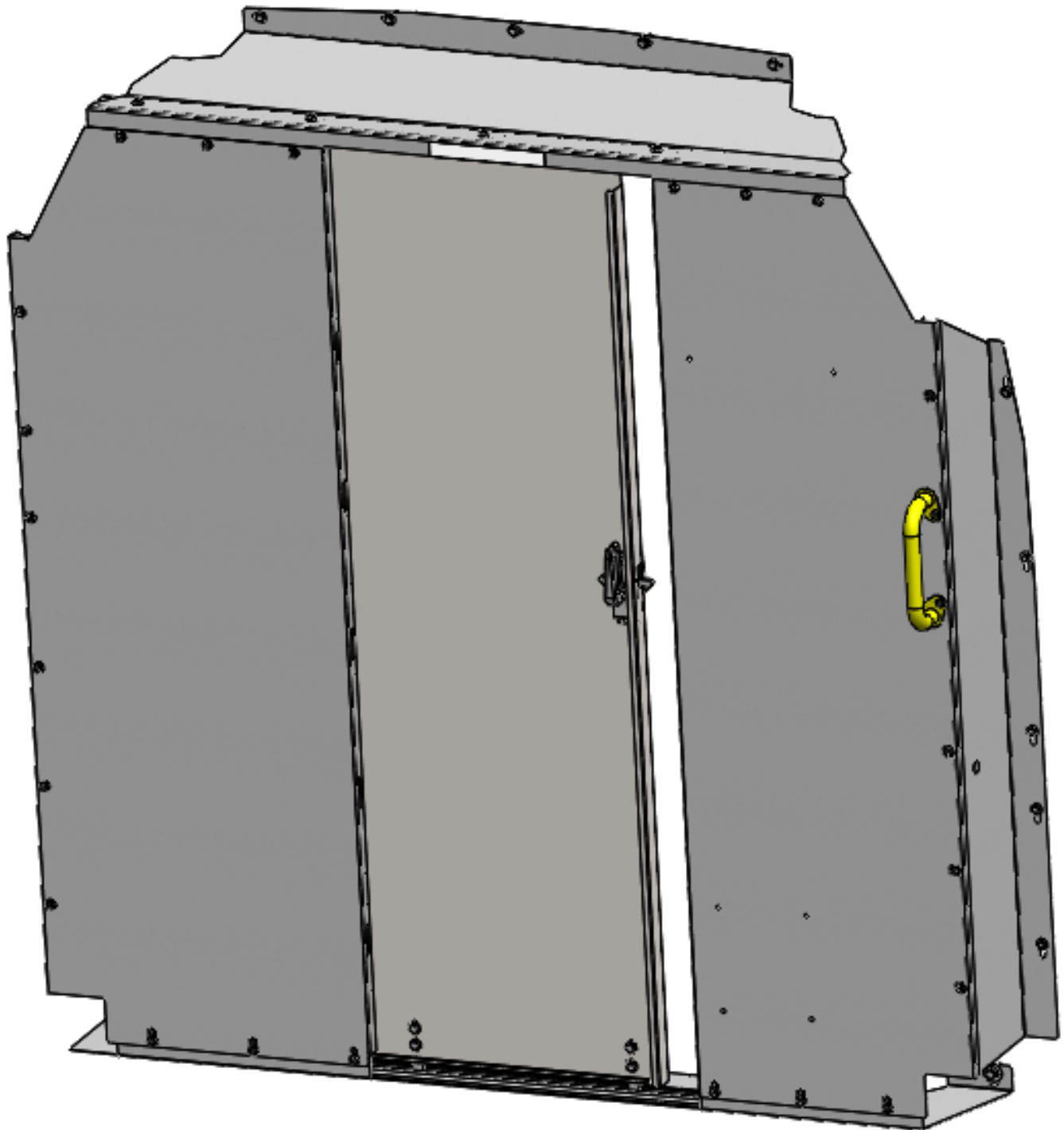

INSTALLATION IS COMPLETE! MAKE SURE THAT ALL FASTENERS THAT WERE LEFT LOOSE FOR THE INSTALL ARE NOW TIGHTED.