

130 LBS

69"W x 8.5"D x 73.9"T

N/A

GRAY

SPARFTH2

PRODUCT FEATURES

Steel sliding partition for FORD TRANSIT HIGH-ROOF provides an easy access solution for separating the cab area from the cargo area. The sliding partition features a sliding pass thru door that provides a 20" wide door opening for quick and easy access to the cargo area. ** This will NOT work with dual side sliding door option **

Driver Comfort Details

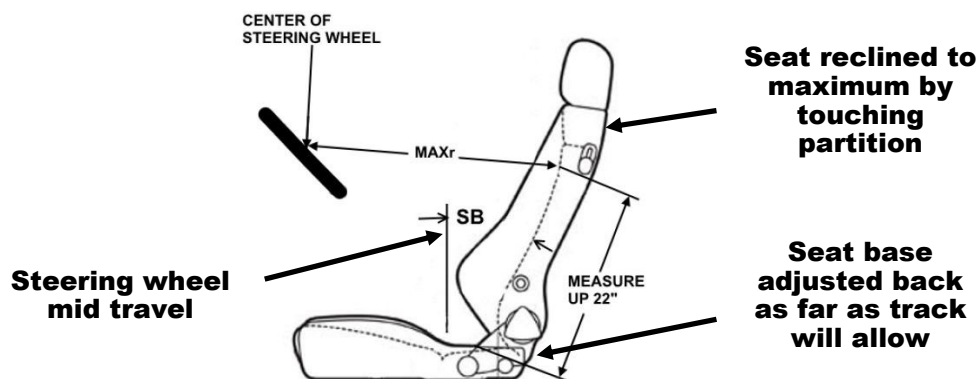

	DESCRIPTION	DIMENSION
SB	SEAT BACK ANGLE	11 degrees
MAXr	MAXIMUM DRIVER REACH	30"

Accessory Chart

	Cab Side	Cargo Side
Available Accessories	-	-
PA7: Reflector kit	x	x
PA8: Fire ext.	x	x
PA9: First aid tray	x	x
PA10: Practice holder	x	x
PA11: Cab file	x	x
PA11NL: Catalog box	x	x
TA1: Four hook bar	x	x
CCD6: Center console 6"		
TDC6: Tech desk 6"		
TH30: 30lb tank holder		x
TH50: 50lb tank holder		x
UH10: 1" hook	x	x
UH25: 2.5" hook	x	x
UH25CP-G: 2.5' hook comp	x	x
UH50: 5" hook	x	x
SPARLHK Locking Handle		

INSTR. NUMBER : 65004	PG: 1	REV: C	ITEM NO.	PART NUMBER	DESCRIPTION	QTY
	PART NUMBER : SPARFTH2			1	64972-G	SPARFTH2, HEADER, G
2				64973-G	SPARFTH2, FOOTER ASM, G	1
PART DESC. : SLIDING PARTITION, FTH			3	64974-G	SPARFTH2, PS WING, G	1
			4	64975-G	SPARFTH2, DS WING, G	1
NOTE: THIS INSTRUCTION IS ALSO VALID FOR FLEET INSTALLATIONS. FLEET PART NUMBER 65012			5	64976-G	SPARFTH2, DS PANEL, G	1
			6	64977-G	SPARFTH2, PS PANEL, G	1
			7	64978-G	SPARFTH2, SLD DOOR, G	1
			8	64980-G	SPAR2 IMPACT BRACKET, LONG, G	1
			9	776-1300	SLIDE, 20" PAIR, NON-LOCK	2

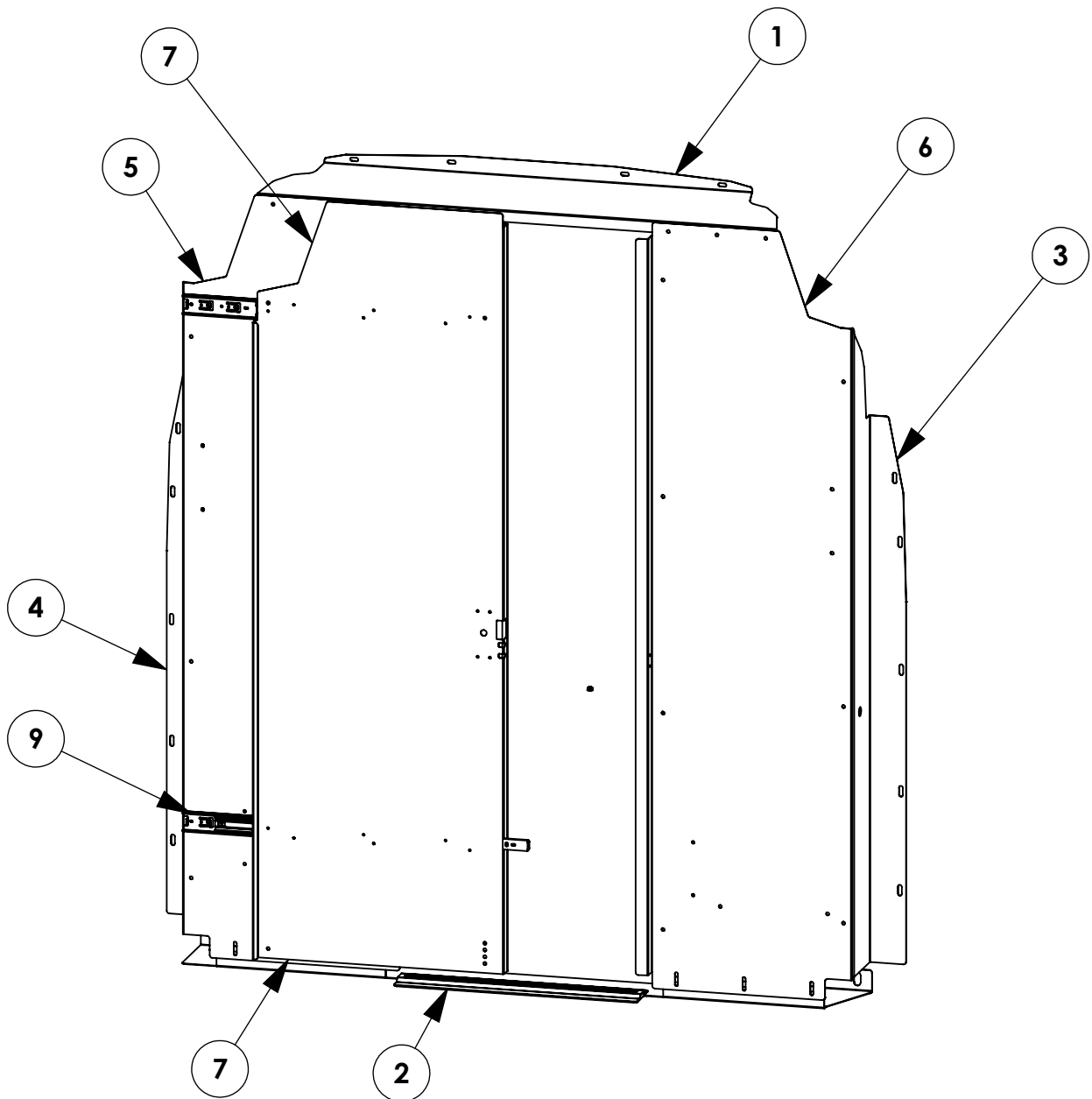

GET TO KNOW THE VEHICLE - AT THE BEGINNING OF ANY INSTALLATION, CHECK THE LOCATION OF THE FUEL TANK, FUEL LINES, BRAKE LINES, HIGH VOLTAGE BATTERIES AND WIRING HARNESSES TO AVOID INJURY OR PROPERTY DAMAGE FROM TOOL CONTACT.

SEAL ALL EXTERIOR HOLES - ALL INSTALLATION HOLES SHOULD BE SEALED WITH BUTYL TAPE OR SILICON TO PREVENT WATER AND EXHAUST GASES FROM ENTERING THE VEHICLE.

CONTROL DRILL DEPTH - TO AVOID DAMAGE TO THE VEHICLE, USE A DRILL STOP OR CLEARED STEP BIT WHEN DRILLING INSTALLATION HOLES.

ALWAYS ADD PRIMER - WHEN ADDING INSTALLATION HOLES BE SURE TO USE A SELF-ETCHING PRIMER TO PREVENT CORROSION, FASTENER FAILURE AND INJURY.

MOUNTING POINTS MUST HAVE METAL-TO-METAL CONTACT - USE PROVIDED MOUNTING SPACERS TO ACCOMMODATE FOR VEHICLE FEATURES, CARPET OR SUBFLOORS.

PROVIDE CLEARANCE FOR SPACERS - IF THE INSTALLATION VEHICLE CONTAINS A CARPET OR SUBFLOOR, USE A 1-3/16" DIAMETER CARPET CUTTER (P/N: 31183-0) AT ALL MOUNTING LOCATIONS TO OPEN UP ROOM FOR SPACERS.

CHECK SPACER ORIENTATION - BE SURE THAT THE INDENT IN THE SPACER COVERS THE PLUSNUT HEAD; THIS ENSURES THE MOST METAL-TO-METAL CONTACT AND REDUCES VIBRATION.

PLUSNUT INSTALLATION - A PLUSNUT GUN IS RECOMMENDED FOR PLUSNUT INSTALLATION FOR ITS PRODUCTION SPEED. HOWEVER, A PLUSNUT SETTING TOOL CAN ALSO BE USED (P/N: 22200-0).

THRU-BOLT CLEARANCE - WHEN USING A THRU-BOLT AT ANY MOUNTING LOCATION, BE SURE THAT YOUR HOLE HAS 1/16" CLEARANCE.

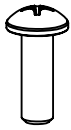
FASTENERS USED

FAS0967
#8-32X.500 ZP
PHP SCREW
QTY: 6



FAS0923
#8-32 ZP NLK
HFLNG NUT
QTY: 6

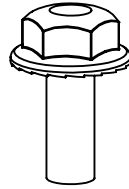

FAS0018
1/4-20X.625 ZP
HFLNG SCREW
QTY: 26

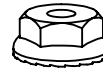

FAS0020
#10-24 ZP
HFLNG NUT
QTY: 4

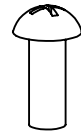

FAS0021
#10-24X.50 ZP
RHP SCREW
QTY: 4

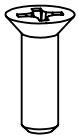

FAS0338
#10-24X.625 ZP
FHP SCREW
QTY: 6



FAS0029
#10-24 ZP
HEX NLK NUT
QTY: 4

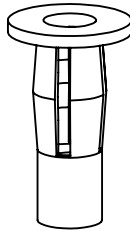

FAS0052
1/4-20 PB
PLUSNUT
QTY: 4

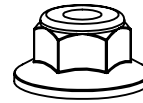

FAS0055
1/4-20 ZP
HFLNG NLK NUT
QTY: 10



FAS0060
1/4 ZP
SPLT LCK WASHER
QTY: 14

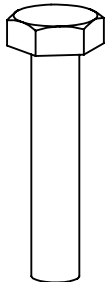

FAS0073
1/4-20X1.25 ZP
HH SCREW
QTY: 2

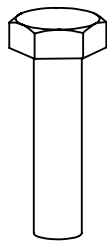

FAS0078
1/4-20X1 ZP
HH SCREW
QTY: 4



FAS0124
1/4 ZN
FLAT WASHER
QTY: 16

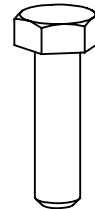

FAS0187
M6-1.0X22
HH SCREW
QTY: 10

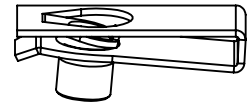

FAS0274
1/4-20
U-CLIP NUT
QTY: 18

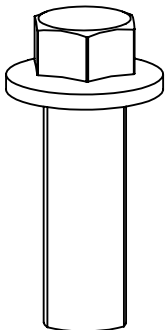

FAS0408
7/16-20X1.25
HFLNG TRI SCREW
QTY: 2



FAS0482
7/16 ZP
FLAT WASHER
QTY: 2

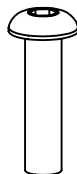

FAS0674
10-24X.75 SS
BHC SCREW
QTY: 4



FAS0688
3/8 EPDM
FLAT WASHER
QTY: 3

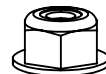

FAS0918
#10-24 ZP NLK
HFLNG NUT
QTY: 6

BEGIN INSTALLATION

STEP 1 - INSTALL HEADER

USE HEADER JIG 59763 FOR
HOLE LOCATIONS

-OR-

USE HEADER TO MARK DRILL
LOCATIONS AND DRILL PLUSNUT
HOLES IN CENTER OF SLOTS

FAS0078, FAS0060,
FAS0124, FAS0052
(4 PLACES)
7/16 SOCKET

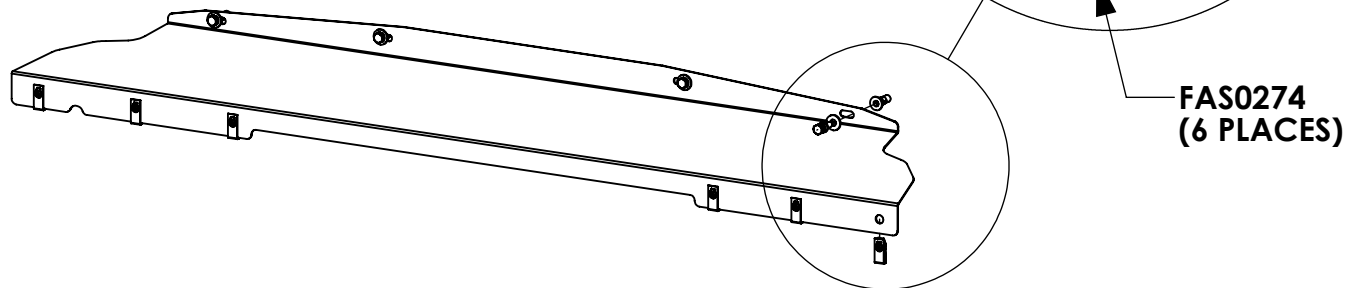

STEP 2 - INSTALL HEADER

FAS0274
(6 PLACES)

REMOVE OEM D-RINGS,
REPLACE WITH

FAS0408, FAS0482
(2 PLACES)
1/2 SOCKET

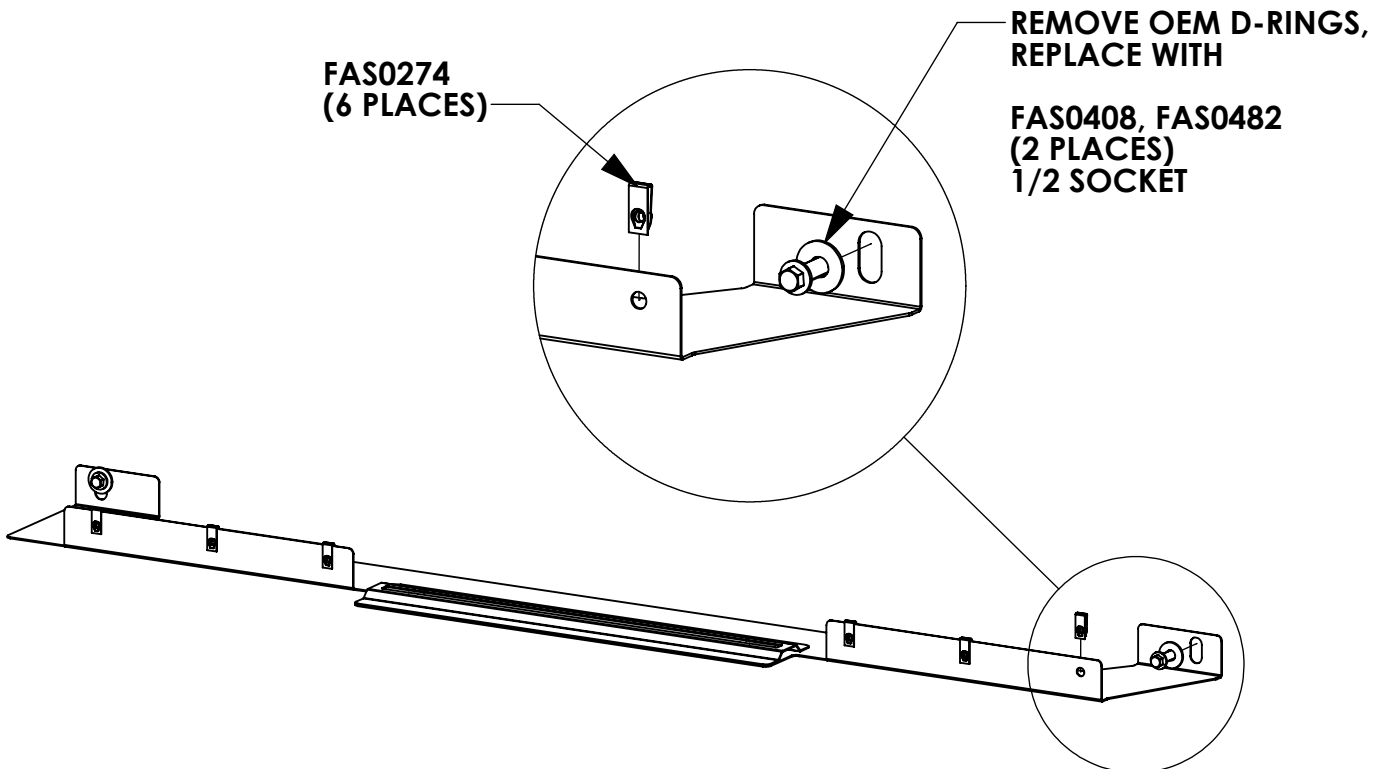

STEP 3 - INSTALL WINGS

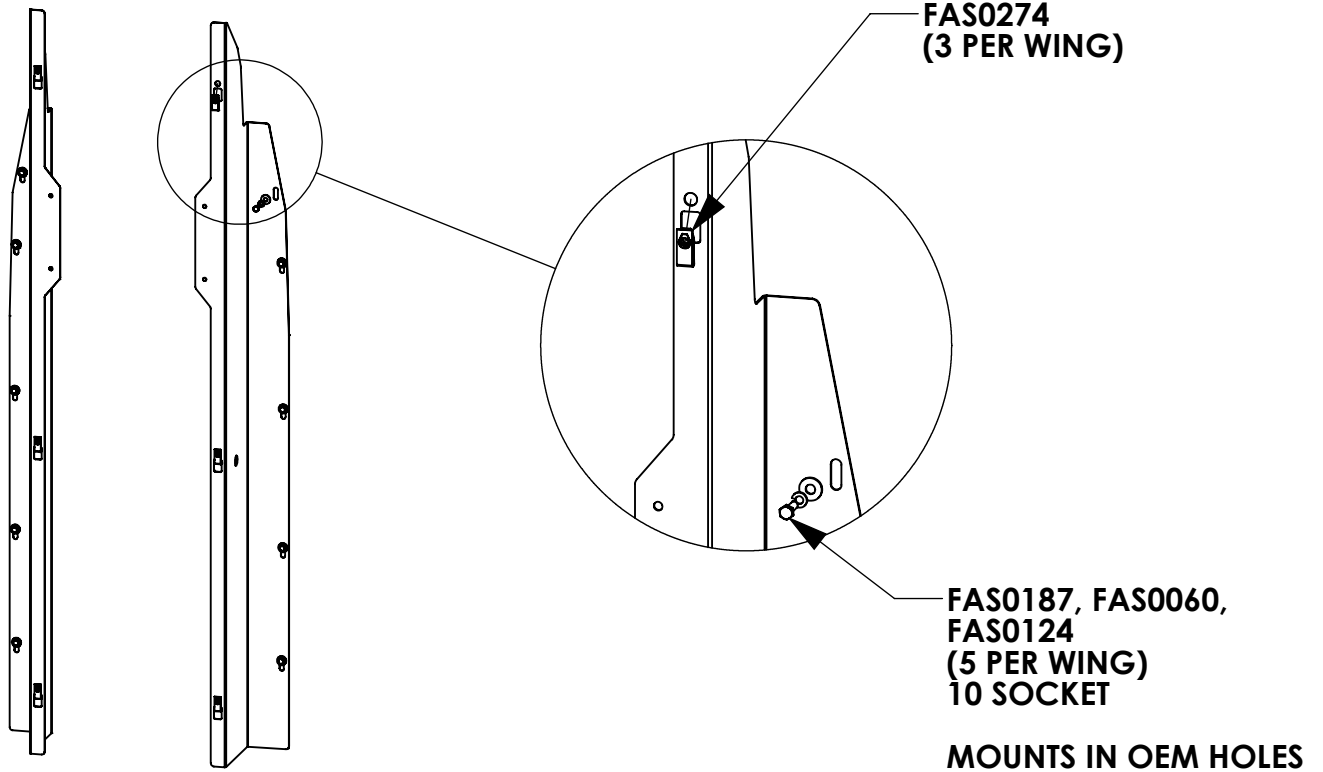

STEP 4 - ASSEMBLE PS PANEL

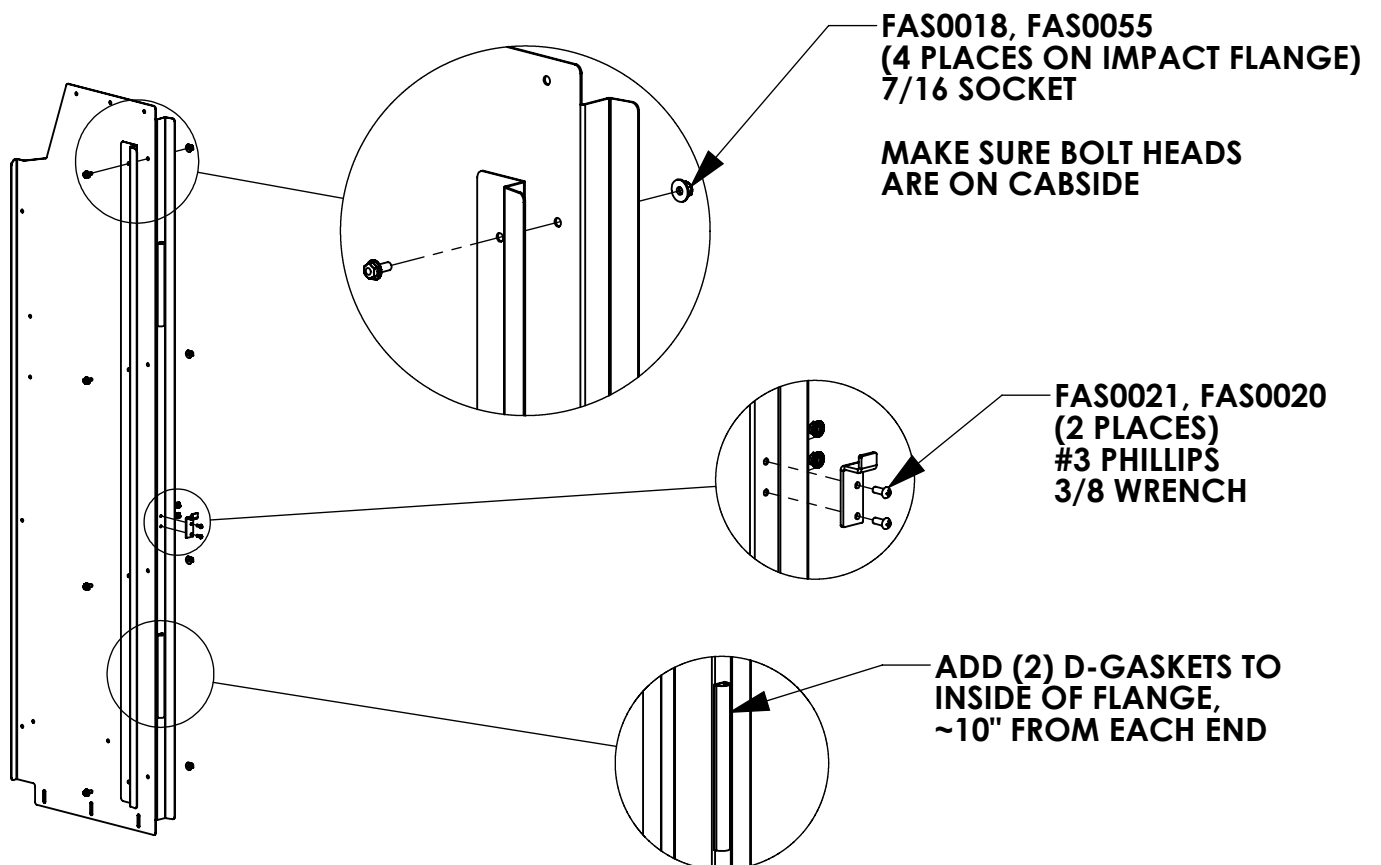

STEP 5 - IDENTIFY AND ASSEMBLE SLIDES AND OPEN LATCH

THERE ARE 2 POTENTIAL SLIDE SUPPLIERS WITH DIFFERENT HOLE PATTERNS.

USE THE IMAGE TO IDENTIFY YOUR SLIDE STYLE, THEN USE THE CORRESPONDING HOLE PATTERN SHOWN BELOW.

-SLIDE STYLE 1: INNER HOLES

-SLIDE STYLE 2: OUTER HOLES

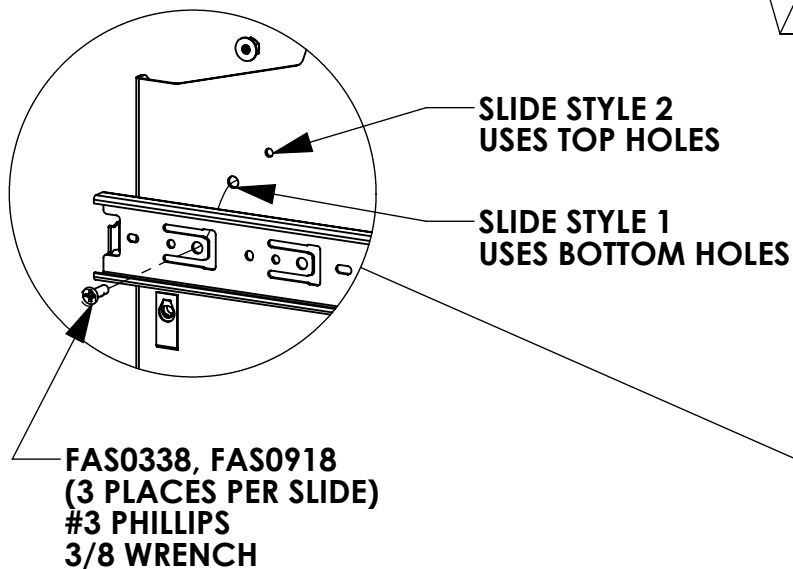
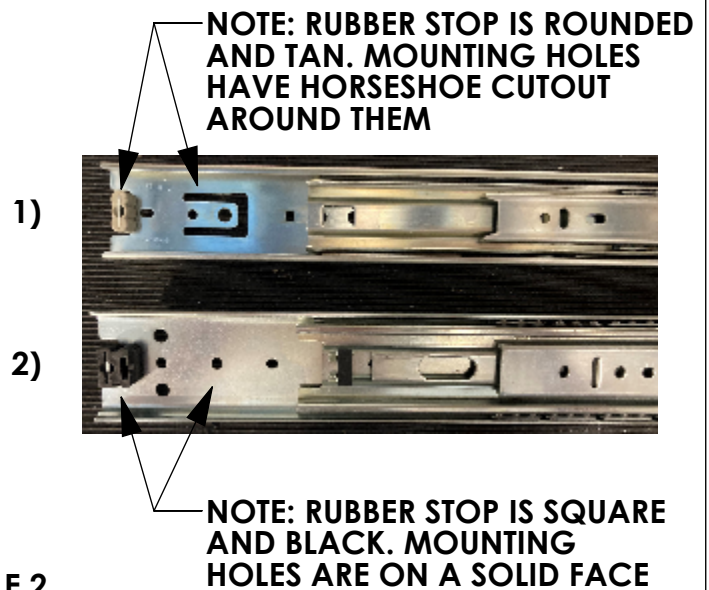

FAS0021, FAS0020
(2 PLACES)
#3 PHILLIPS
3/8 WRENCH

SLIDE STYLE 1
USES TOP HOLES

SLIDE STYLE 2
USES BOTTOM HOLES

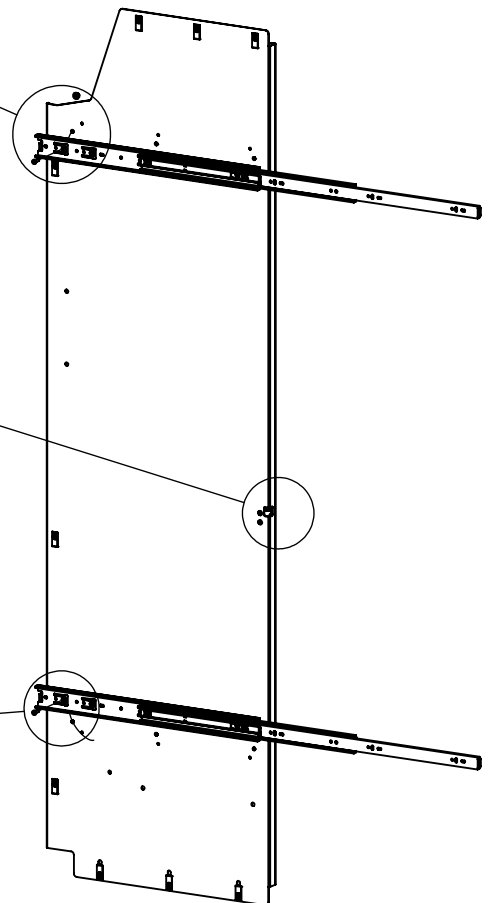

STEP 6 - INSTALL DS DOOR

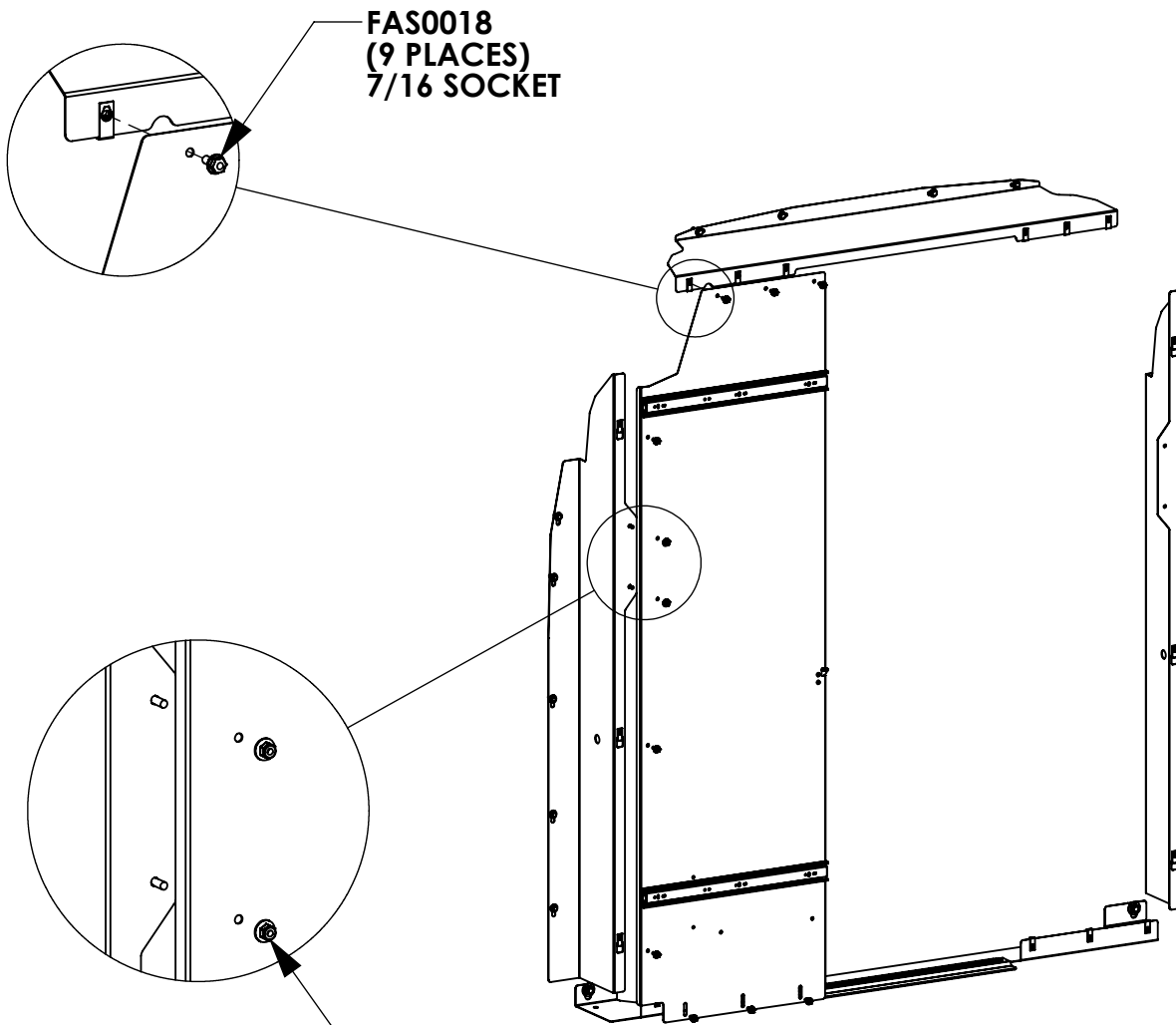

**FAS0018
(9 PLACES)
7/16 SOCKET**

**FAS0018, FAS0055
(2 PLACES WITHOUT U-NUT ACCESS)
7/16 SOCKET
7/16 WRENCH**

**MAKE SURE BOLT HEADS
ARE ON CABSIDE**

STEP 7 - INSTALL SLD DOOR AND HANDLE

FAS0967, FAS0923
(3 PLACES PER SLIDE)
#3 PHILLIPS
11/32 WRENCH

USE THE BOTTOM ROW OF HOLES
FOR THE BOTTOM SLIDE

WHEN INSTALLING SLIDING
DOOR, LIFT TO TOP END OF
HOLE CLEARANCE WHEN
TIGHTENING FASTENERS

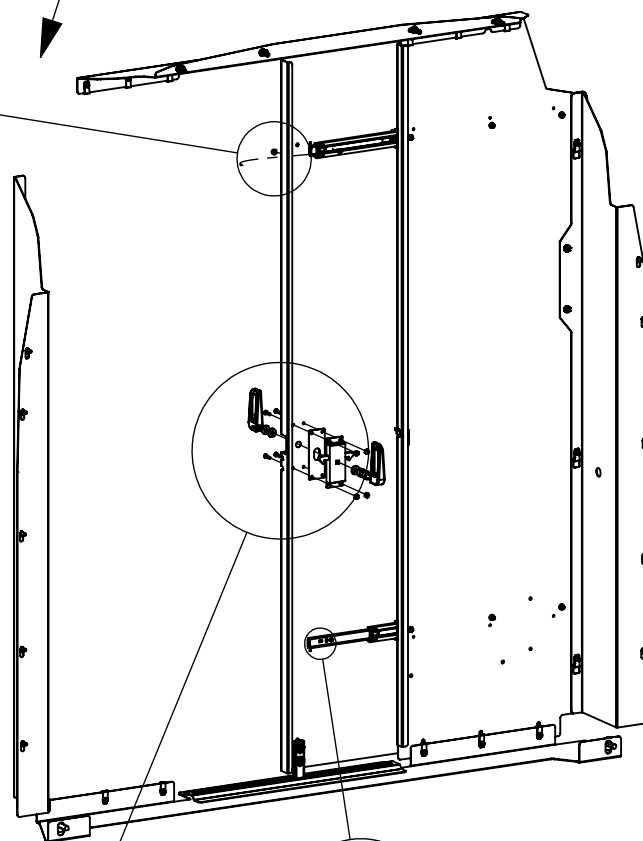

CAB-TO-CARGO
HANDLE STACKUP:

FEMALE HANDLE
(2) FAS0688
DOOR
LATCH PLATE
LATCH
(1) FAS0688
(2) 59180
HANDLE W/SHANK

TIGHTEN SET SCREW
WHEN ASSEMBLED.
1/8 ALLEN

USE THE TOP ROW
OF HOLES FOR THE
BOTTOM SLIDE

FAS0674, FAS0029
(4 PLACES)
#3 PHILLIPS
3/8 WRENCH

NUT MUST BE
CABSIDE

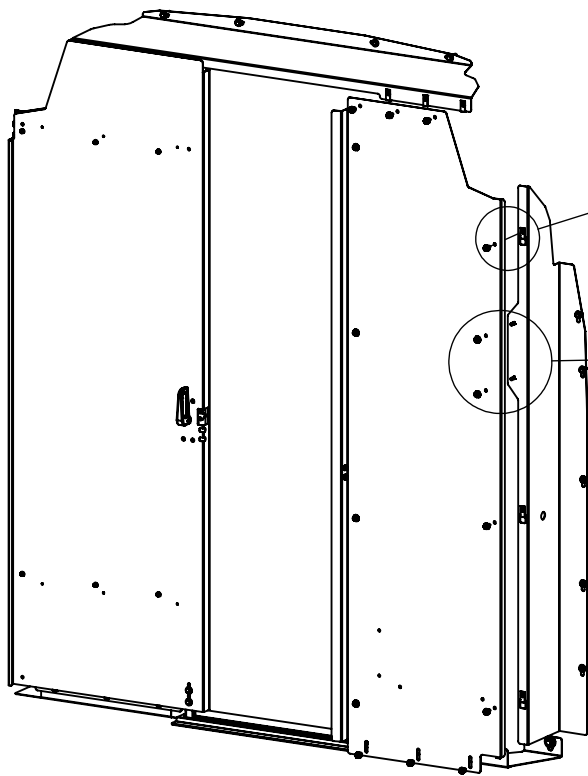
STEP 8 - INSTALL PS PANEL

FAS0018
(9 PLACES)
7/16 WRENCH

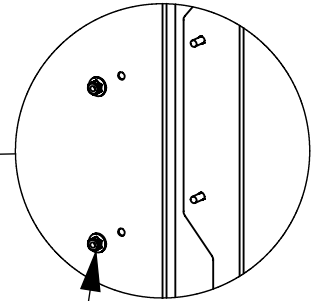
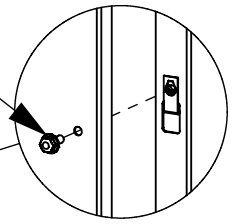

FAS0018, FAS0055
(2 PLACES WITHOUT U-NUT ACCESS)
7/16 SOCKET
7/16 WRENCH

MAKE SURE BOLT HEADS
ARE ON CABSIDE

STEP 9 - INSTALL SAFETY EQUIPMENT

INSTALL GUIDE BAR
ON CABSIDE OF DOOR
AND IN FOOTER SLOT.

FAS0073, FAS0124,
FAS0055
(2 PLACES)
7/16 SOCKET
7/16 WRENCH

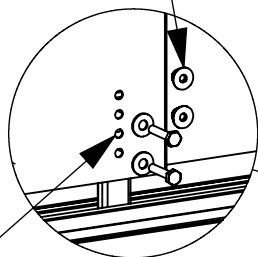

CHOOSE HOLES
BASED ON FLOOR
HEIGHT

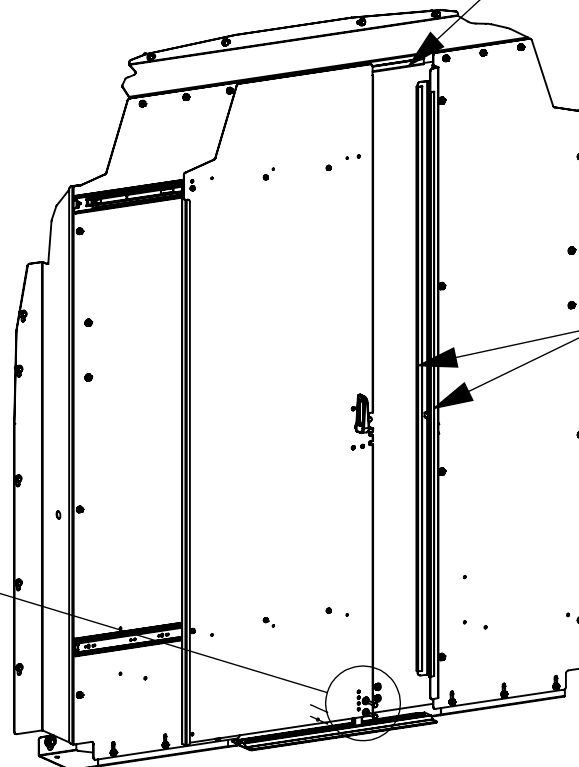

INSTALL SHORT
PINCHWELD,
CENTERED ON
HEADER

INSTALL (2) LONG
PINCHWELD
SECTIONS.
CENTERED ON
THESE FLANGS