

<i>INSTR. NUMBER</i> : 67276	<i>PG:</i> 1	<i>REV:</i> A	<i>ITEM NO.</i>	<i>PART NUMBER</i>	<i>DESCRIPTION</i>	<i>QTY.</i>
			<i>PART NUMBER</i> • SDPLPS <i>SDPLDS </i>	1	SDPLDS	SINGLE DROP PROLIFT DRIVER SIDE
<i>PART DESC.</i> • INSTALL INSTR. FOR SDPL			2	SDPLPS	SINGLE DROP PROLIFT PASSENGER SIDE	1

DRIVER AND PASSENGER SIDE SINGLE DROP PROLIFT
THESE INSTRUCTIONS CAN BE USED FOR A SINGLE OR DOUBLE SINGLE DROP DOWN ON
VARIOUS LOW ROOF VEHICLES

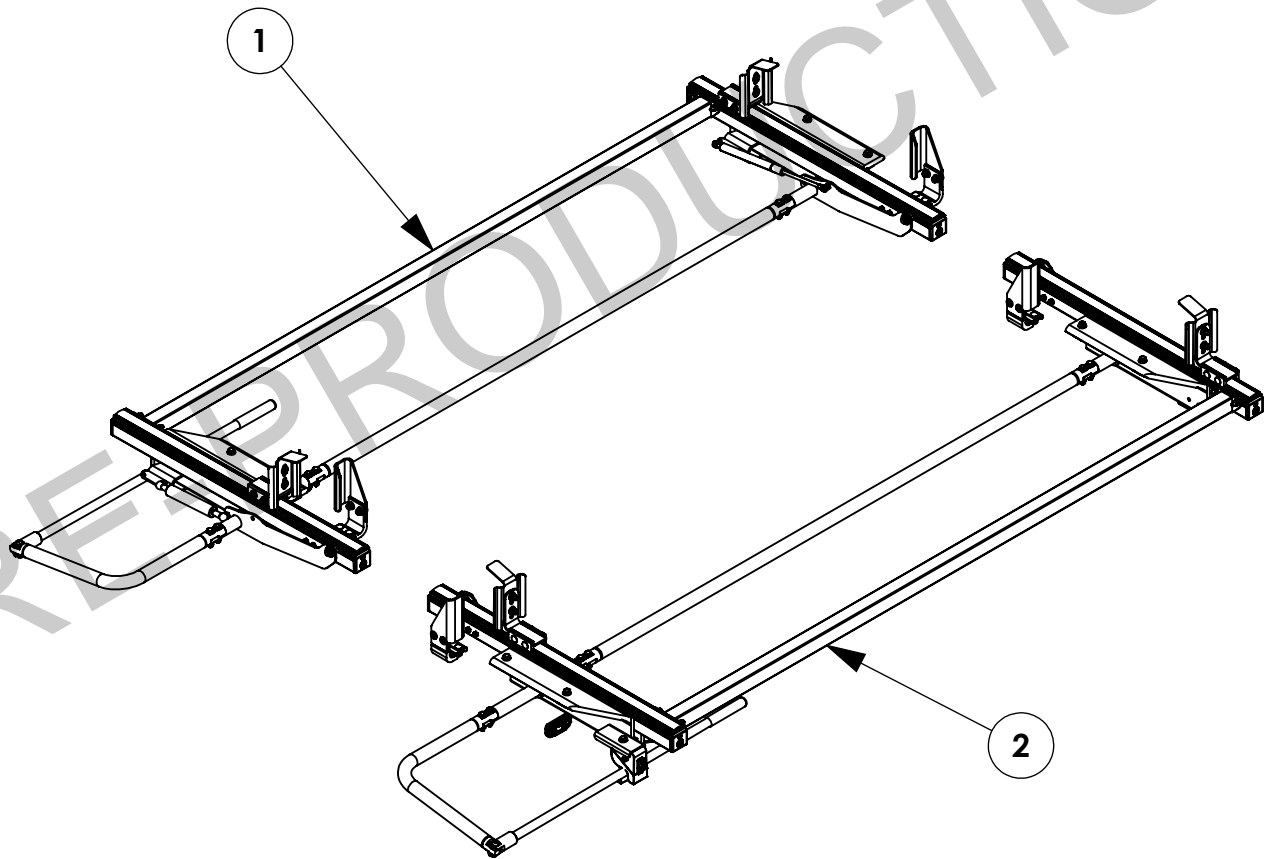

GET TO KNOW THE VEHICLE - AT THE BEGINNING OF ANY INSTALLATION, CHECK THE LOCATION OF THE FUEL TANK, FUEL LINES, BRAKE LINES, HIGH VOLTAGE BATTERIES AND WIRING HARNESSSES TO AVOID INJURY OR PROPERTY DAMAGE FROM TOOL CONTACT.

SEAL ALL EXTERIOR HOLES - ALL INSTALLATION HOLES SHOULD BE SEALED WITH BUTYL TAPE OR SILICON TO PREVENT WATER AND EXHAUST GASES FROM ENTERING THE VEHICLE.

CONTROL DRILL DEPTH - TO AVOID DAMAGE TO THE VEHICLE, USE A DRILL STOP OR CLEARED STEP BIT WHEN DRILLING INSTALLATION HOLES.

ALWAYS ADD PRIMER - WHEN ADDING INSTALLATION HOLES BE SURE TO USE A SELF-ETCHING PRIMER TO PREVENT CORROSION, FASTENER FAILURE AND INJURY.

MOUNTING POINTS MUST HAVE METAL-TO-METAL CONTACT - USE PROVIDED MOUNTING SPACERS TO ACCOMMODATE FOR VEHICLE FEATURES, CARPET OR SUBFLOORS.

PROVIDE CLEARANCE FOR SPACERS - IF THE INSTALLATION VEHICLE CONTAINS A CARPET OR SUBFLOOR, USE A 1-3/16" DIAMETER CARPET CUTTER (P/N: 31183-0) AT ALL MOUNTING LOCATIONS TO OPEN UP ROOM FOR SPACERS.

CHECK SPACER ORIENTATION - BE SURE THAT THE INDENT IN THE SPACER COVERS THE PLUSNUT HEAD; THIS ENSURES THE MOST METAL-TO-METAL CONTACT AND REDUCES VIBRATION.

PLUSNUT INSTALLATION - A PLUSNUT GUN IS RECOMMENDED FOR PLUSNUT INSTALLATION FOR ITS PRODUCTION SPEED. HOWEVER, A PLUSNUT SETTING TOOL CAN ALSO BE USED (P/N: 22200-0).

THRU-BOLT CLEARANCE - WHEN USING A THRU-BOLT AT ANY MOUNTING LOCATION, BE SURE THAT YOUR HOLE HAS 1/16" CLEARANCE.

FASTENERS USED

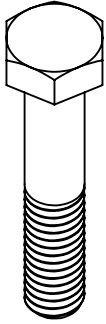

FAS0436
SHORT DESC.
QTY: 6

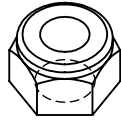

FAS0248
SHORT DESC.
QTY: 18

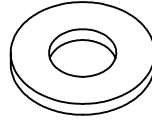

FAS0552
SHORT DESC.
QTY: 26

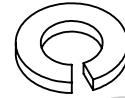

FAS0588
SHORT DESC.
QTY: 2

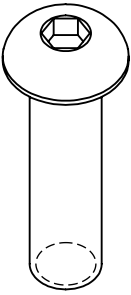

FAS0819
SHORT DESC.
QTY: 1



FAS0399
SHORT DESC.
QTY: 1



FAS0813
SHORT DESC.
QTY: 4

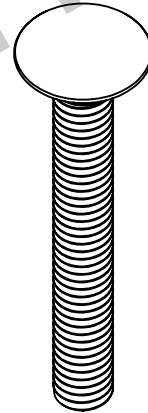

FAS0838
SHORT DESC.
QTY: 4

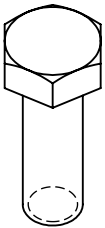

FAS0597
SHORT DESC.
QTY: 2

FOR DOUBLE SIDED RACK DOUBLE FASTENER QUANTITY

BEGIN ASSEMBLY

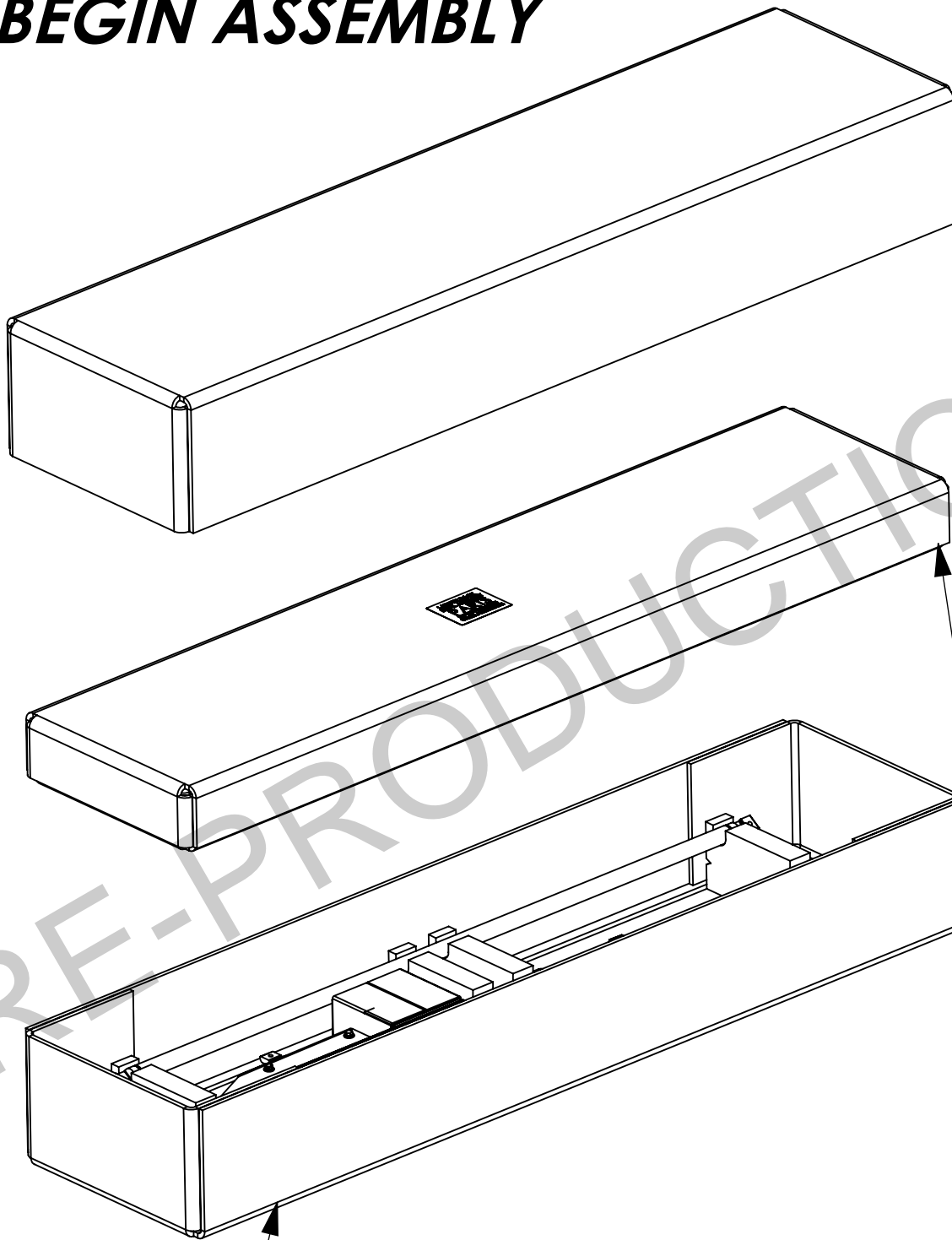

START ASSEMBLY WITH OUTER BOX
(CRT67161,CRT67161-1)

FOR SHIP THRU:

REMOVE INNER BOX (CRT67160, CRT67160-1) FROM OUTER
BOX & STOW IN VEHICLE FOR FINAL INSTALL AT DEALER

BEGIN ASSEMBLY

STEP 1 - ASSEMBLE FRONT AND REAR ASSEMBLY TO DRIVELINE & HANDLE

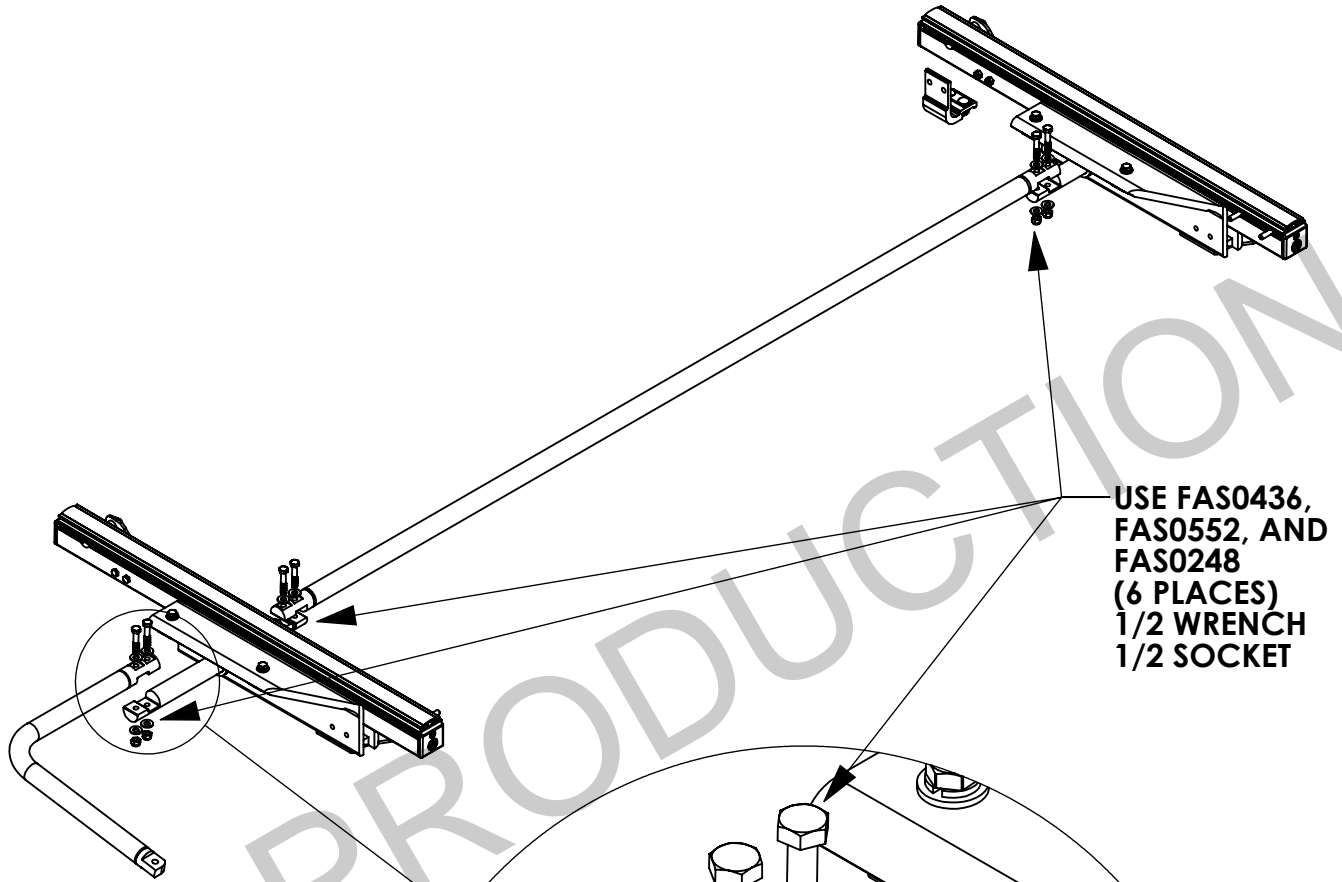

USE FAS0436,
FAS0552, AND
FAS0248
(6 PLACES)
1/2 WRENCH
1/2 SOCKET

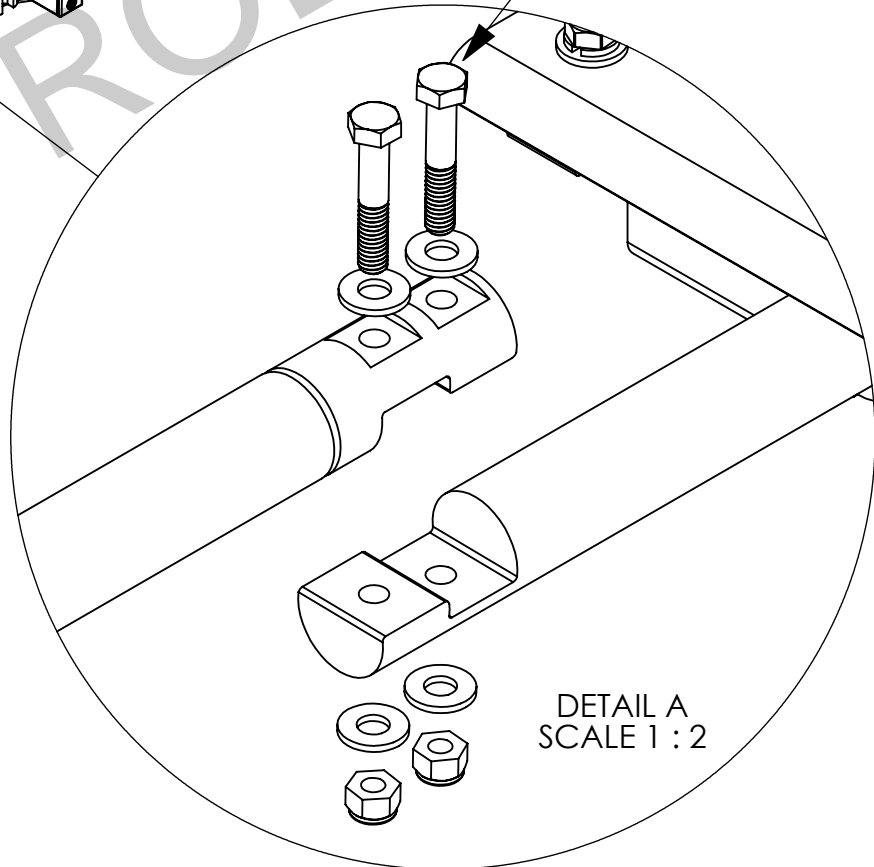

DETAIL A
SCALE 1 : 2

STEP 2 - INSTALL DUAL STAGE DROP DOWN INTO CROSSBARS

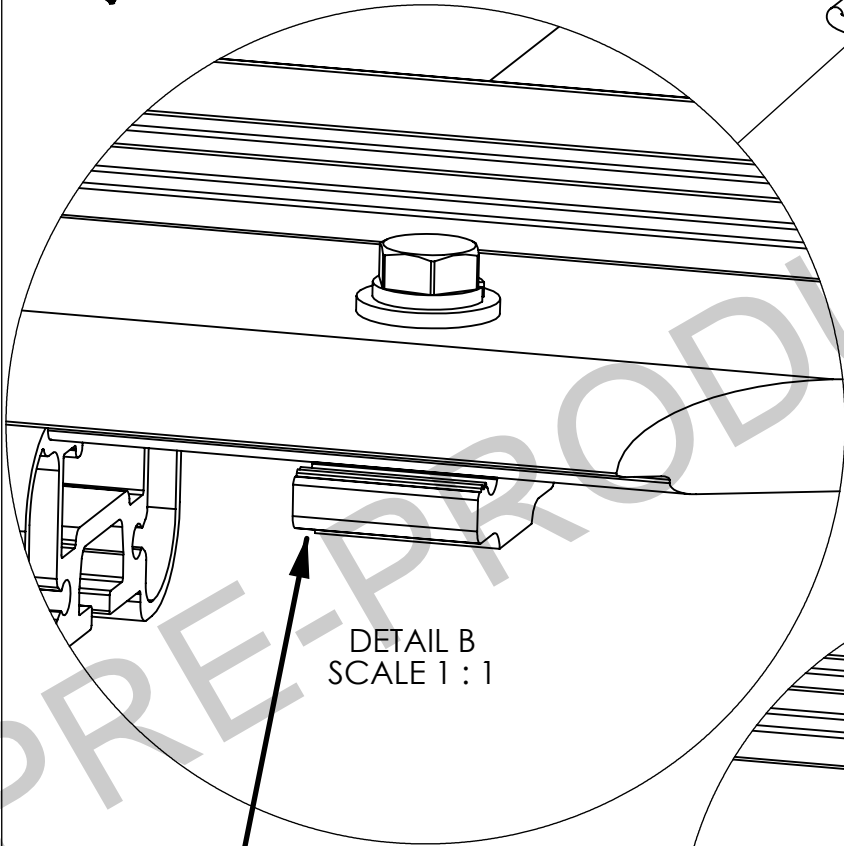
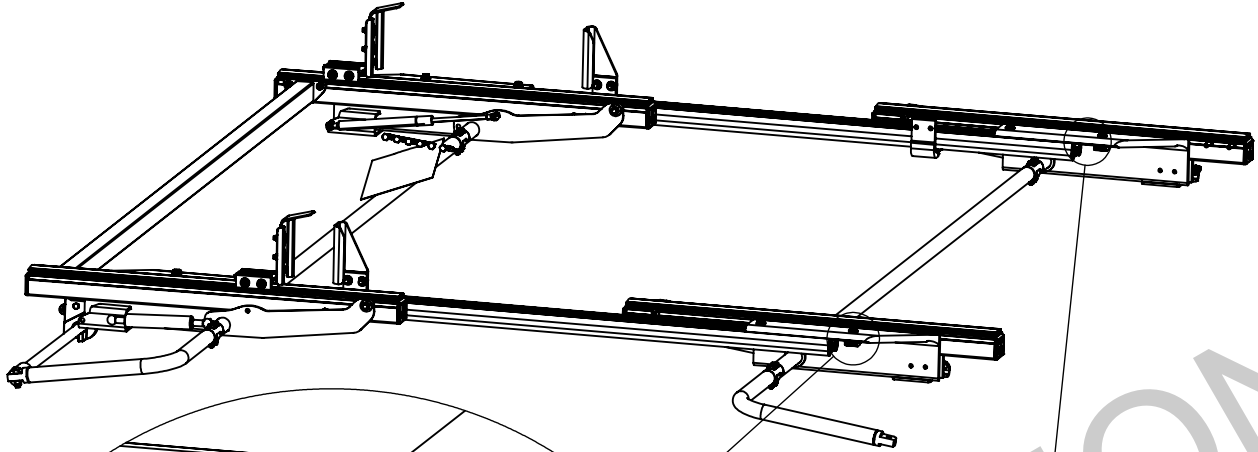

DETAIL B
SCALE 1 : 1

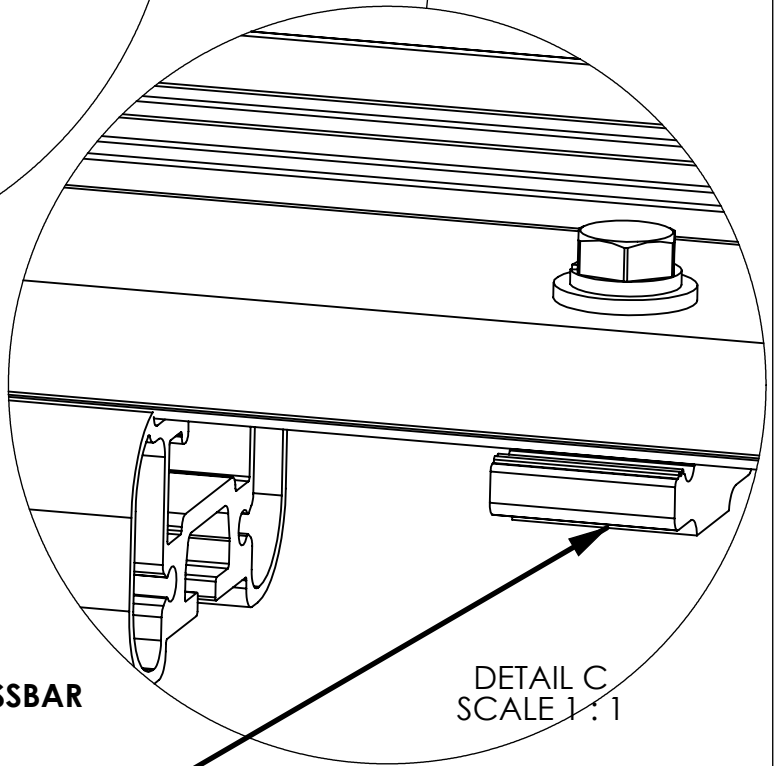

DETAIL C
SCALE 1 : 1

SLIDE DROP DOWN INTO CROSSBAR

**LEAVE FASTENERS LOOSE FOR
ADJUSTING RACK ONCE ON VEHICLE**

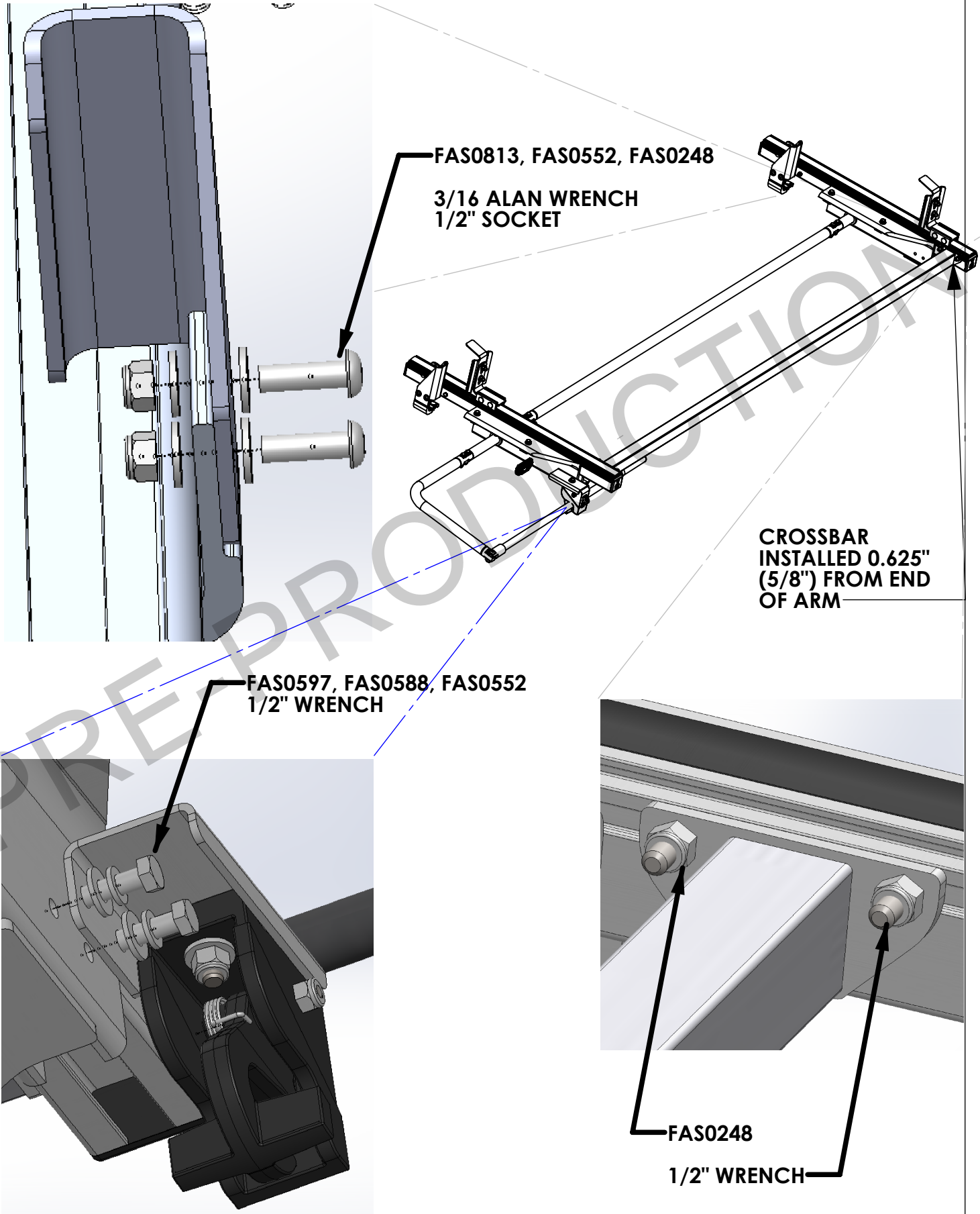

FOR SHIP THRU SKIP TO PAGE 10
STEP 4 - INSTALL LADDER CLAMPS, HANDLE, & END CAPS

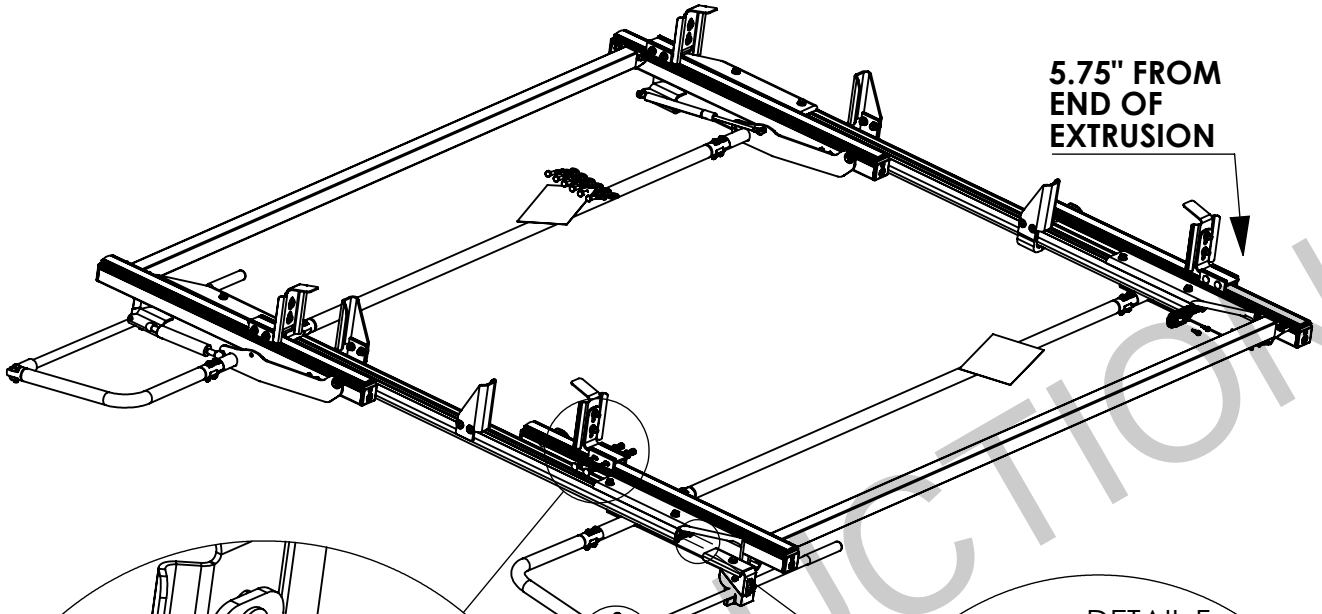

5.75" FROM
END OF
EXTRUSION

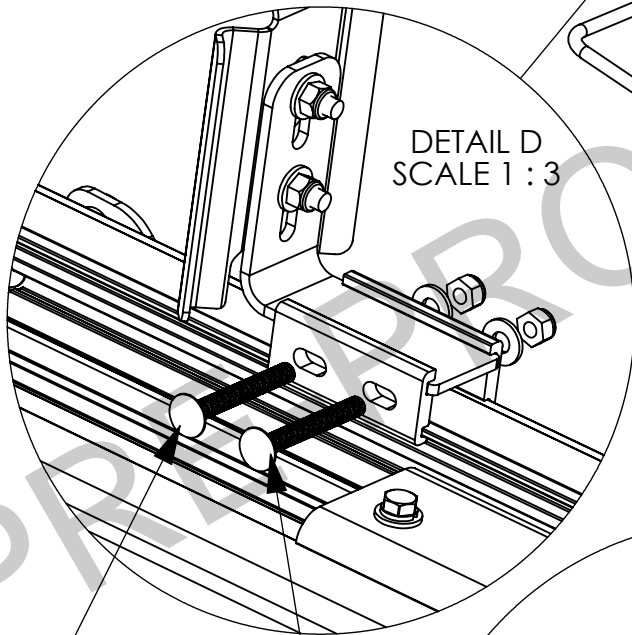

DETAIL D
SCALE 1 : 3

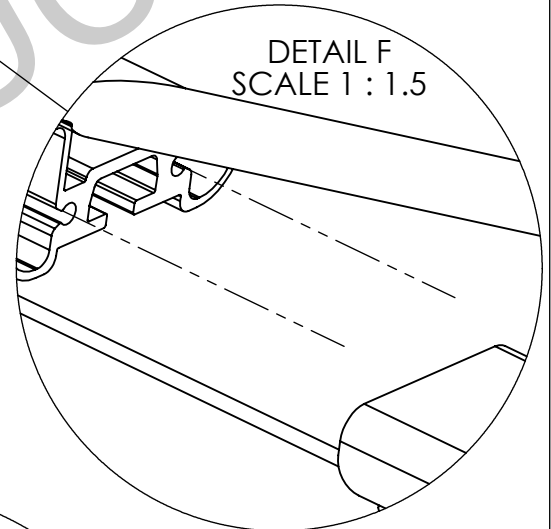

DETAIL F
SCALE 1 : 1.5

FAS0838
FAS0552
FAS0248
(3 PLACES)

1/2" WRENCH

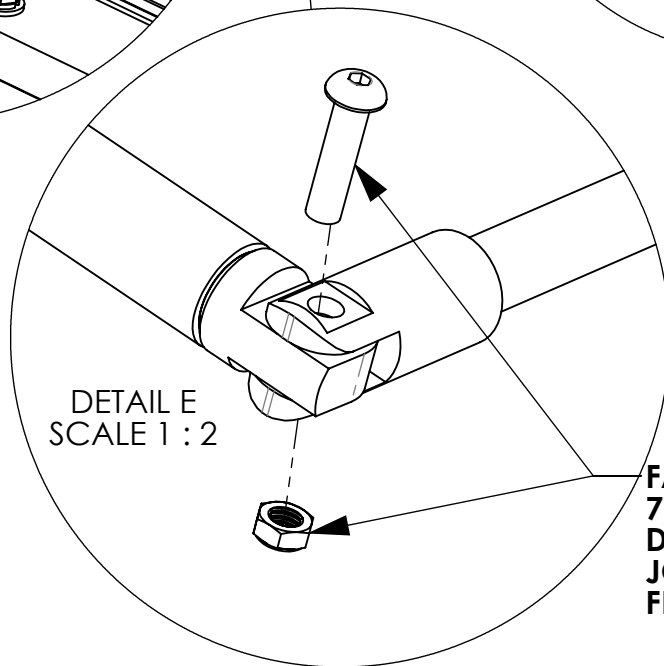

DETAIL E
SCALE 1 : 2

FAS0819 & FAS0399
7/32 ALLEN WRENCH
DO NOT OVERTIGHTEN
JOINT SHOULD MOVE
FREELY

**INSTALL FOOT KIT (URMBK4W) FOLLOW INSTRUCTIONS PROVIDED
THEN INSTALL ON ROOF RAILS ON VEHICLE ROOF**

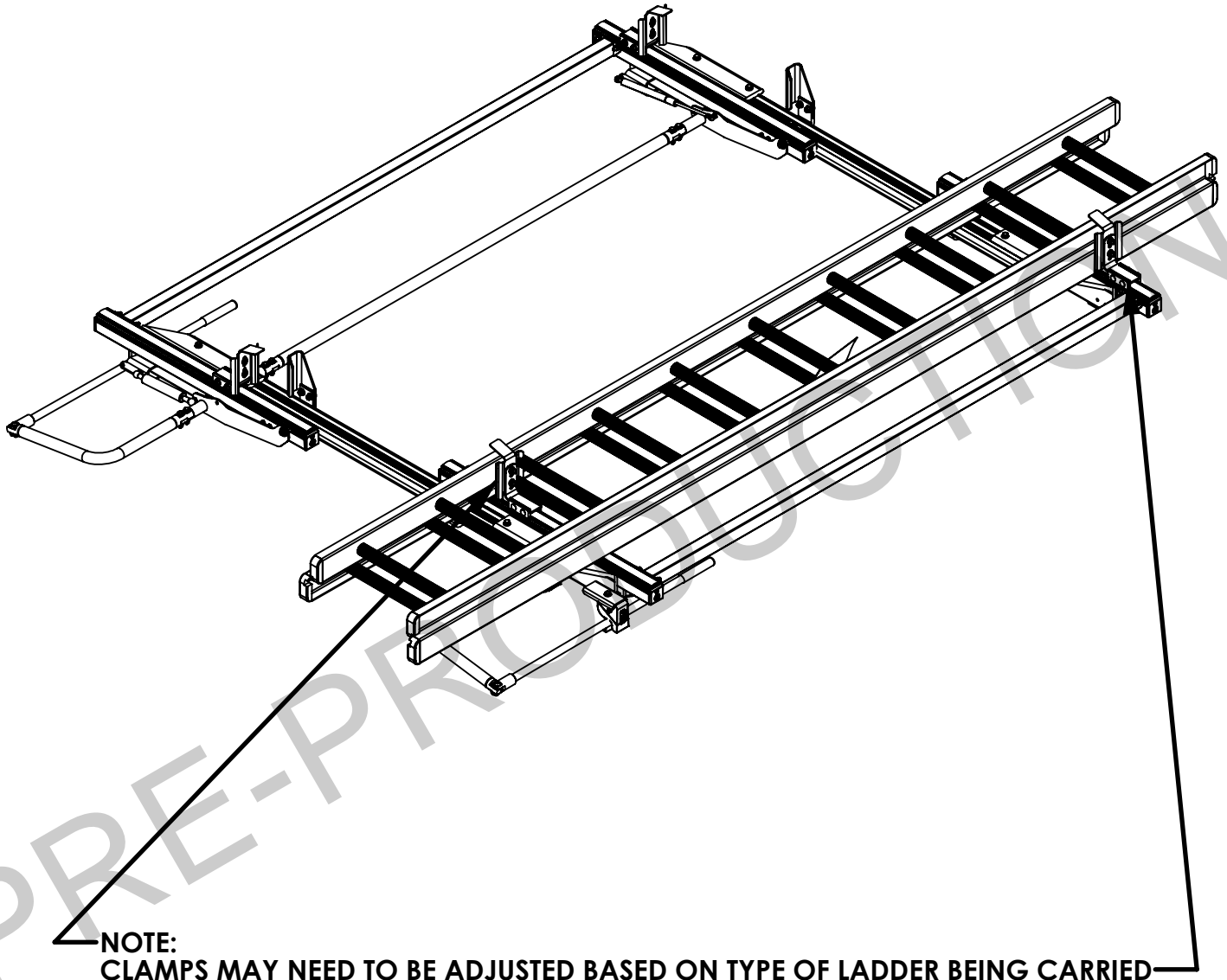

**NOTE:
CLAMPS MAY NEED TO BE ADJUSTED BASED ON TYPE OF LADDER BEING CARRIED**

INSTALLATION IS COMPLETE

FOR SHIP THRU SLIDE RACK INTO CENTER OF CROSSBOW & TIGHTEN BOLTS

**TIGHTEN BOLTS
4 BOLTS ON TOP & 4 BOLTS ON BOTTOM OF
EACH CROSSBOW**

1/2" WRENCH

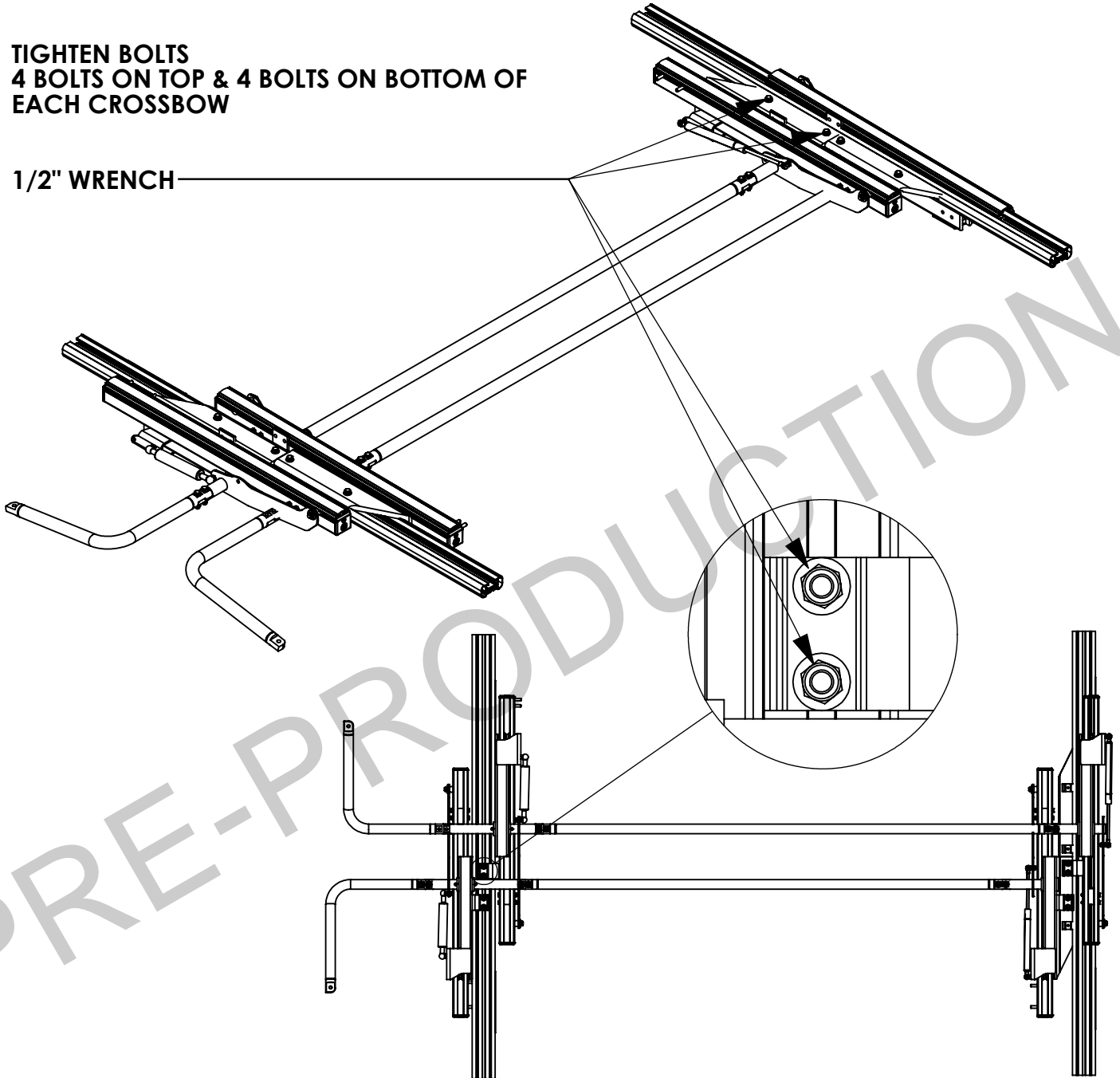

13.00 FROM END OF CROSSBOW TO OUTSIDE END OF BASE EXTRUSION (LARGE THICK EXTRUSION)

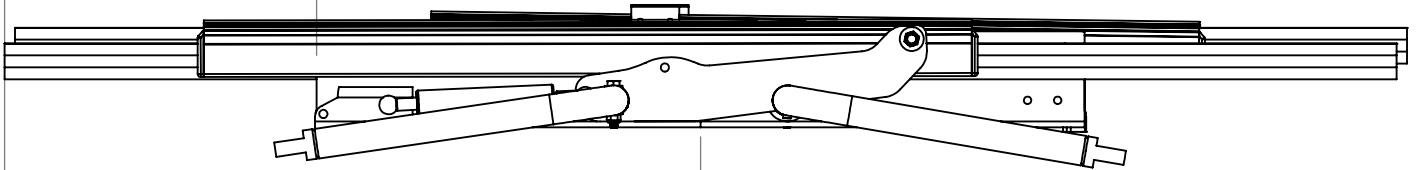

(29.00 FROM END OF CROSSBOW TO END OF BASE EXTRUSION)

INSTALL FOOT KIT (URMBK4W) FOLLOW INSTRUCTIONS PROVIDED THEN INSTALL ON VEHICLE ROOF