

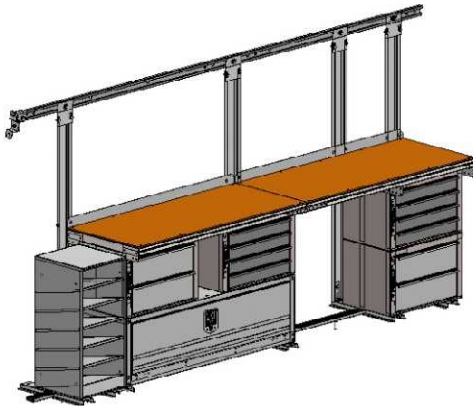

ADRIAN STEEL®

Cargo Management Solutions for Commercial Vehicles

RAIL ADAPTER KIT FOR NISSAN NV



PRODUCT WEIGHT

20 Lbs

WIDTH x DEPTH x HEIGHT

CAPACITY

N/A

COLOR

GRAY

CATALOG NUMBER

RKALCV

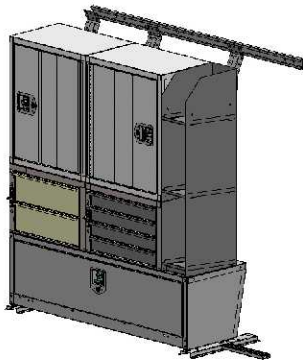

PRODUCT FEATURES

ADAPTER KIT FOR MOUNTING OUR 2255 LOCK SMITH PACKAGE TO OUR RKLCV NISSAN RAIL KIT PACKAGE WITH OUT DRILLING INTO THE VEHICLE

PRODUCT APPLICATION

THIS PRODUCT IS DESIGNED FOR USE IN THE NISSAN NV VAN, HIGH OR LOW ROOF. WITH AN RKLCV NISSAN RAIL KIT

The information contained in this document is the sole property of ADRIAN STEEL COMPANY. ADRIAN STEEL COMPANY retains the right to modify and/or change the product of its design at any time without prior notification.

Introduction / Comments:

This adapter rail kit is designed for the standard and high roof models of the Nissan LCV.

The adapter rail kit will mount to the Nissan rail kit RKLCV.

These two rail kits will be included into the Nissan Lock Smith Packages 2255NS and 2255NH high roof. These packages will be installed without drilling any holes into the van.

Note:

It is advised that all fasteners used in this assembly and installation of these kits should be checked for tightness at the following intervals: @ 2-weeks and again @ 6-weeks of operation. This preventive maintenance step must be completed to ensure your package gives you long service life.

ITEM NO.	PART NUMBER	DESCRIPTION	QTY.
1	40910-G	FLOOR RAIL ASS'Y,PAINTED	6
2	40907-G	UPPER MNTG BRKT	4
3	40911-G	WALL POST ASS'Y.,PAINTED	4
4	40912-G	DOUBLE FLOOR RAIL ASS'Y,PAINTED	1

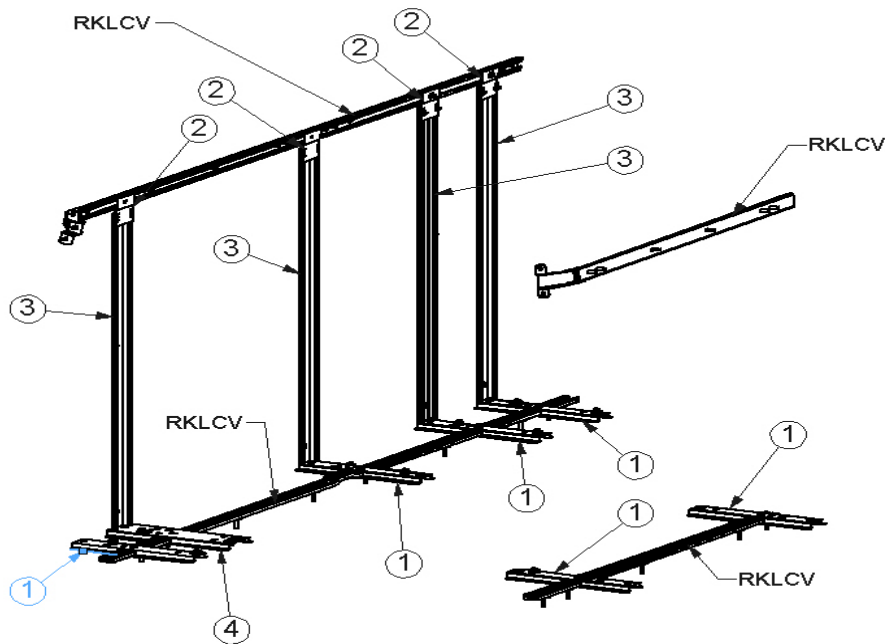

**RKALCV
RAIL KIT ADAPTER
NISSAN NV HIGH AND LOW ROOF**

- PRECAUTIONS -





 **CAUTION** 
**THE USE OF AIR IMPACT TOOLS CAN
OVER-TORQUE FASTENERS AND
CAUSE FASTENER FAILURE!**



 **CAUTION** 
**ALL INSTALLATION HOLES SHOULD BE SEALED
WITH SILICON OR BUTYL SEALANT TO PREVENT
EXHAUST FUMES FROM ENTERING THE VEHICLE!**



 **DANGER** 
**INSPECT FOR FUEL TANK, FUEL LINES, BRAKE LINES, HIGH
VOLTAGE BATTERIES AND ELECTRICAL LINES PRIOR TO
DRILLING TO AVOID DAMAGING CRITICAL VEHICLE SYSTEMS
OR INJURY TO INSTALLER DURING INSTALLATION PROCESS!**



 **CAUTION** 
**TO AVOID DAMAGING THE VEHICLE ALWAYS
USE DRILL STOPS WHEN DRILLING ANY IN-
STALLATION HOLES!**



- IMPORTANT WARRANTY REQUIREMENTS -

1. SUBSTITUTING ADRIAN STEEL SPECIFIED FASTENERS FOR ASSEMBLY AND/OR INSTALLATION WILL VOID YOUR PRODUCT WARRANTY.
2. ALL HOLES DRILLED INTO VEHICLE SHOULD HAVE THE RAW METAL EDGES SEALED WITH A SELF-ETCHING PRIMER TO RESIST CORROSION AND POTENTIAL FASTENER POINT FAILURE.
3. ALL FASTENERS USED IN THE INSTALLATION OF THIS PRODUCT SHOULD BE TIGHTENED TO THE TORQUE(S) SPECIFIED IN THESE INSTRUCTIONS.
4. THESE INSTRUCTIONS SHOULD BE KEPT WITH THE VEHICLE.

THE BASIC TOOLS NEEDED FOR MOST INSTALLATIONS



DRILL



DRILL BIT WITH
STOP



RATCHET, SOCKETS
AND/OR WRENCHES



SCREWDRIVERS



MEASURING TAPE

ADDITIONAL TOOLS MAY BE NEEDED FOR THIS INSTALLATION AND THEY WILL BE IDENTIFIED IN THE STEPS THAT FOLLOW.

**BAGRKALCV
FASTENER BAG FOR RKALCV**

ITEM NO.	PART NUMBER	DESCRIPTION	BAGRKALCV/QTY.
1	BAG41003	FASTENER BAG	1
2	BAGRKA1	BAG, HDW, RKA1	1
3	BAGRKA1-4	BAG, HDW, RKA1 SET OF 4	1
4	BAG0710-A	7" X 10" 4MIL AUTOBAG	1

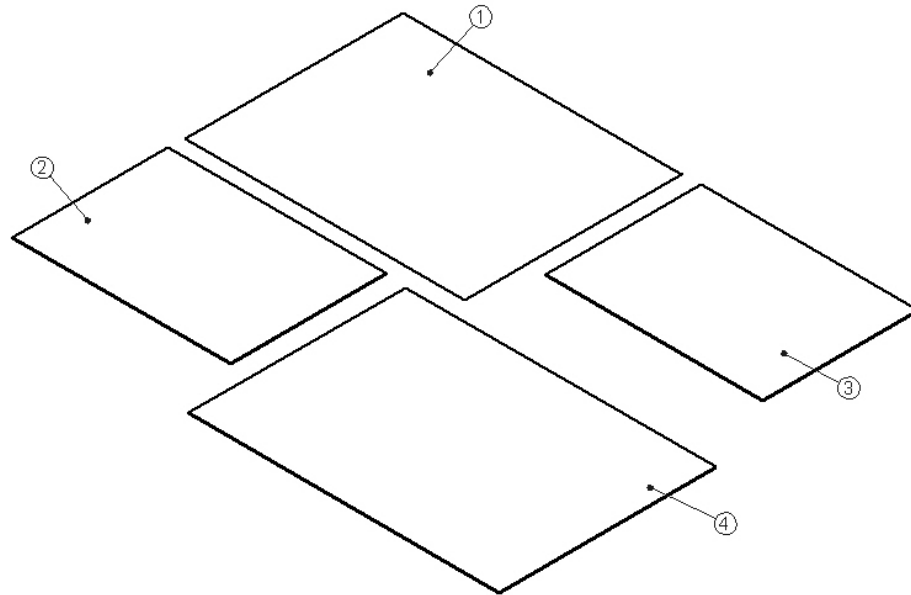

BAGRKA1-4

ITEM NO.	PART NUMBER	DESCRIPTION	BAGRKA1-4/QTY.
1	35335-0	SLIDE	4
2	FAS0165	Screw, Hex Hd, 5/16-18x.625	4
3	FAS0086	WASHER, FLAT USS 5/16 ZP	4
4	FAS0098	Washer, Lock, Split, 5/16, Zinc Plate	4
5	BAG0507-A	5" x 7" 3MIL AUTOBAG	1
6	36793-0	INSTR. AD ACC MTG. RKA1	1

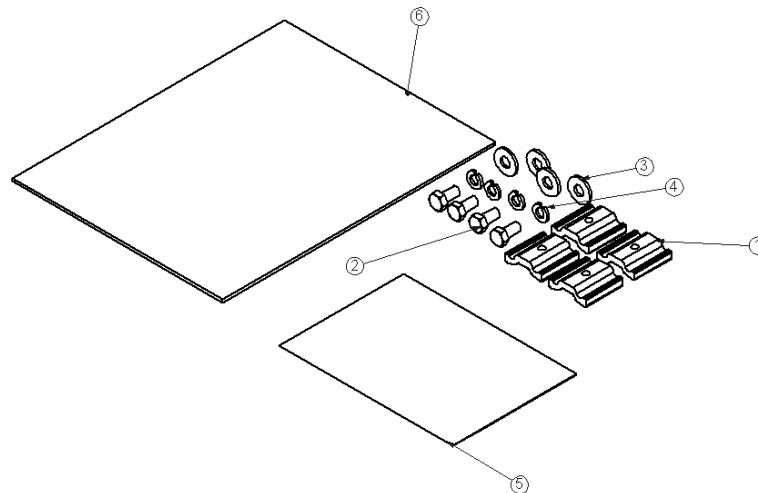

**BAG41003
FASTENER BAG FOR RKALCV**

ITEM NO.	PART NUMBER	DESCRIPTION	BAG41003/ QTY.
1	FAS0061	Screw, Truss Hd. Ph, 1/4-20x0.50	7
2	03927-1	Floor Spacer Short	23
3	FAS0078	Screw, Hex Hd, 1/4-20x1.00 Zn Plate, Grade 8	16
4	FAS0063	Screw, Hex Hd, 1/4-20x0.75 Zn Plate, Grade 5	16
5	FAS0067	Washer, Flat, 1/4	32
6	FAS 0060	Washer, Lock, Split, 1/4	32
7	BAG0709-A	7" x 9" 3MIL AUTOBAG	1
8	FAS0081	Screw, Hex Hd, 5/16-18x0.75 Zn Plate	7
9	FAS0082	Screw, Hex Hd, 5/16-18x1.00 ZN, YELLOW G8	7
10	FAS0098	Washer, Lock, Split, 5/16, Zinc Plate	14

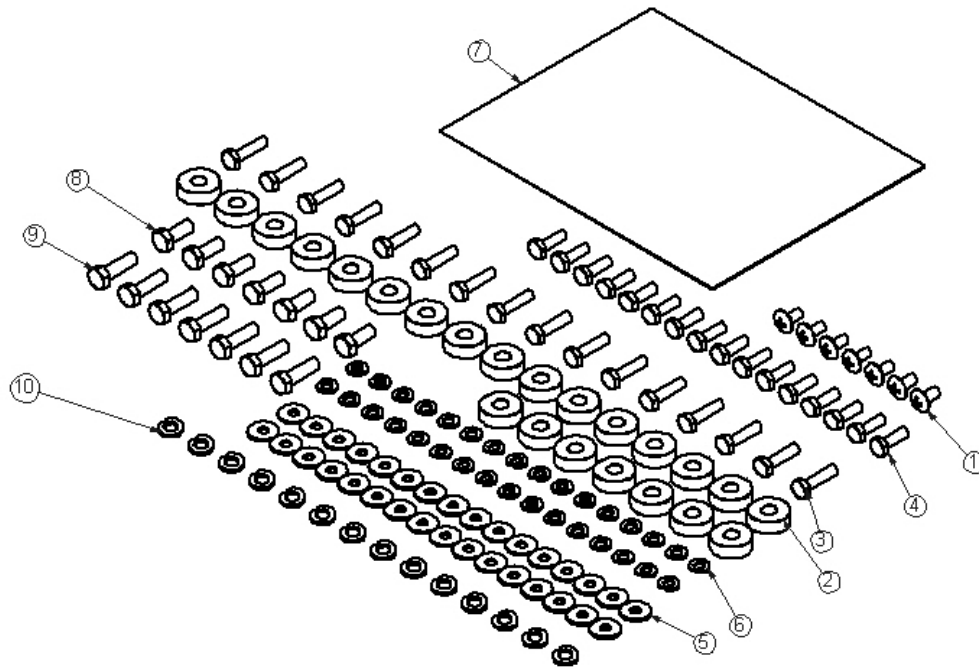

**BAGRKA1
HDW BAG, RKA1**

ITEM NO.	PART NUMBER	DESCRIPTION	BAGRKA1/QTY
1	35335-0	SLIDE	1
2	FAS0165	Screw, Hex Hd, 5/16-18x.625	1
3	FAS0086	Washer, Flat, 5/16, ZN	1
4	FAS0098	Washer, Lock, Split, 5/16, Zinc Plate	1
5	BAG0507-A	5" x 7" 3MIL AUTOBAG	1
6	36793-0	INSTR, AD ACC MTG, RKA1	1

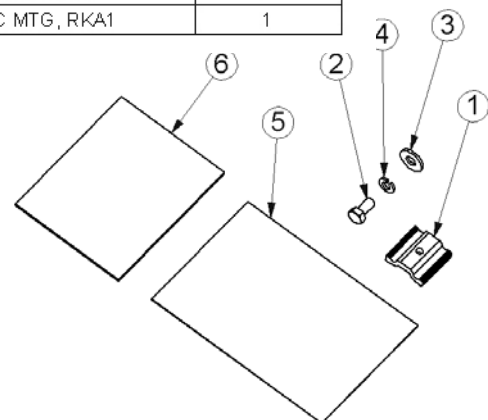



FAS0061

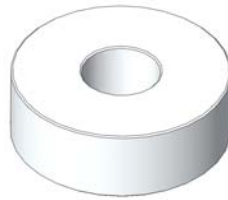

03927-1

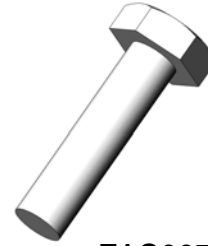

FAS0078



FAS0063

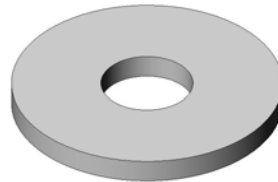

FAS0067



FAS0060



FAS0081



FAS0082



FAS0098

FAS0165, FAS0086 AND 35335-0 SLIDES WILL BE IN THE RKLCV RAIL KIT

BAGRKA1-4 FASTENER BAGS SUPPLIED WILL HAVE (4) OF EACH ALONG WITH INSTRUCTIONS SEE BELOW

BAGRKA1 FASTENER BAGS SUPPLIED WILL HAVE (1) OF EACH ALONG WITH INSTRUCTIONS SEE BELOW



FAS0098



35335-0

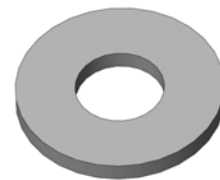

FAS0086

Dimensions are reference only

DRIVERS SIDE

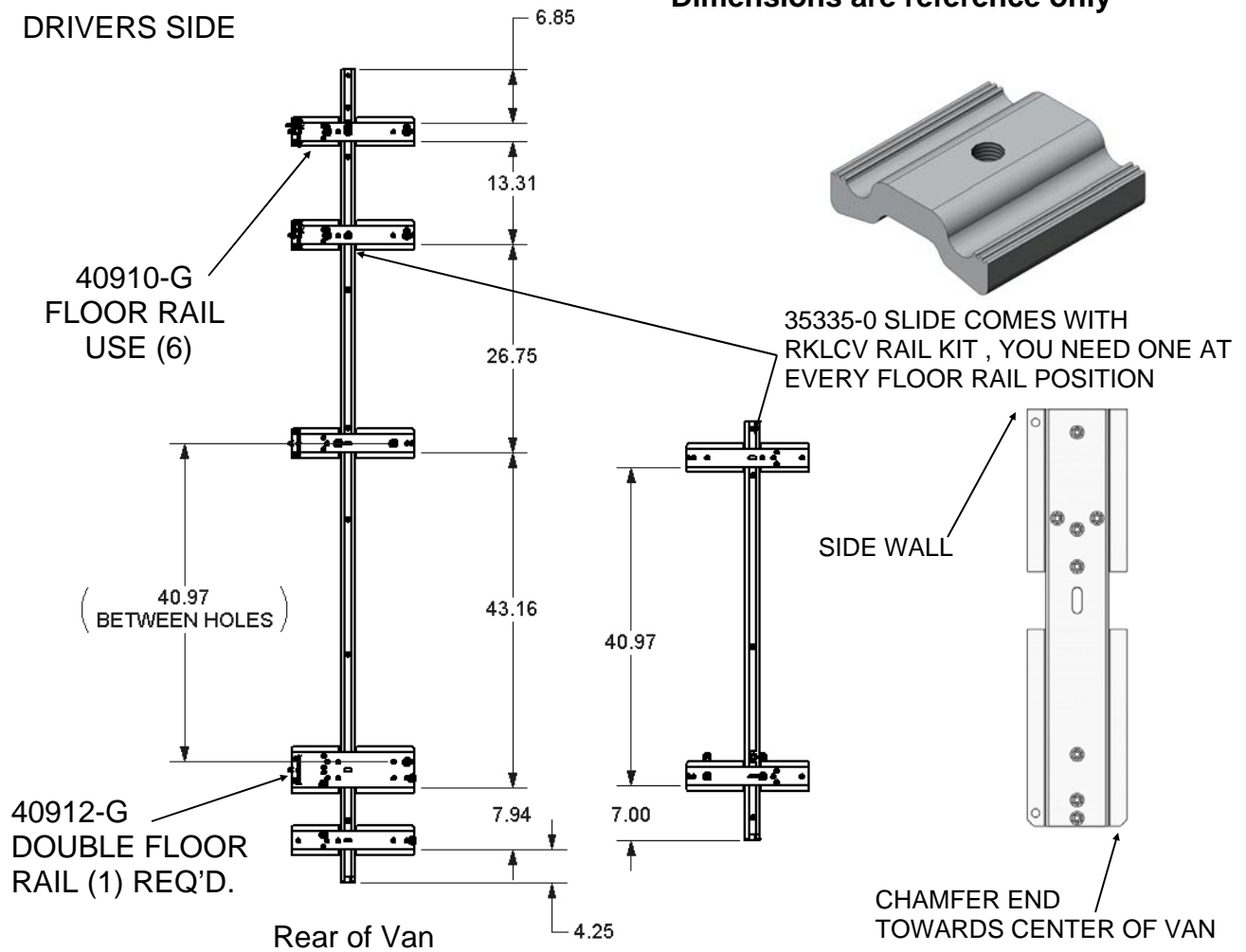

STEP 1 FASTEN ADAPTER FLOOR RAILS TO RKLCV FLOOR RAILS

USE SPACER UNDER FLOOR RAIL IF MAT IS INSTALLED, USE 1/2 SOCKET OR WRENCH

LINE UP FLOOR RAILS WITH ABOVE REF DIMENSIONS CENTER SLIDE 35335-0 WITH BRACKET, FAS0098, FAS0086 AND FAS0081 WITHOUT FLOOR MAT OR FAS0082 WITH FLOOR MAT. INSTALL ALL (7) FLOOR RAILS DO NOT COMPLETELY TIGHTEN, LEAVE FASTENERS LOOSE FOR ADJUSTMENT

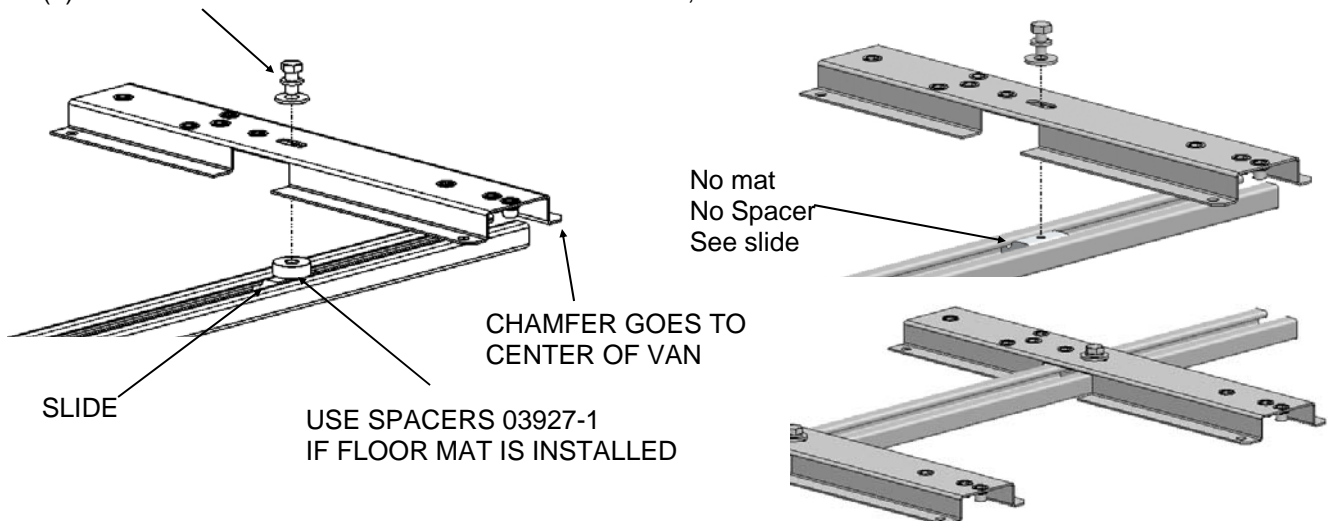

STEP 2: STREET SIDE, MOUNT UPPER MOUNT BRKT (40907-G) TO SLIDE IN RKLCV RAIL KITS. SLIDES AND FASTENER COME WITH RKLCV RAIL

**MOUNT WALL POST 40911-G TO UPPER MOUNT BRKT SEE BELOW
DO NOT FULLY TIGHTEN, USE 7/6 SOCKET OR WRENCH**

REPEAT (4) PLACES SEE COVER SHEET, ONCE FASTENED LINE UP WITH FLOOR RAIL

FASTEN FAS0165,FAS0098,FAS0086 THRU UPPER MOUNT BRKT, INTO SLIDE 35335-0 DO NOT FULLY TIGHTEN LEAVE LOOSE FOR ADJUSTMENT

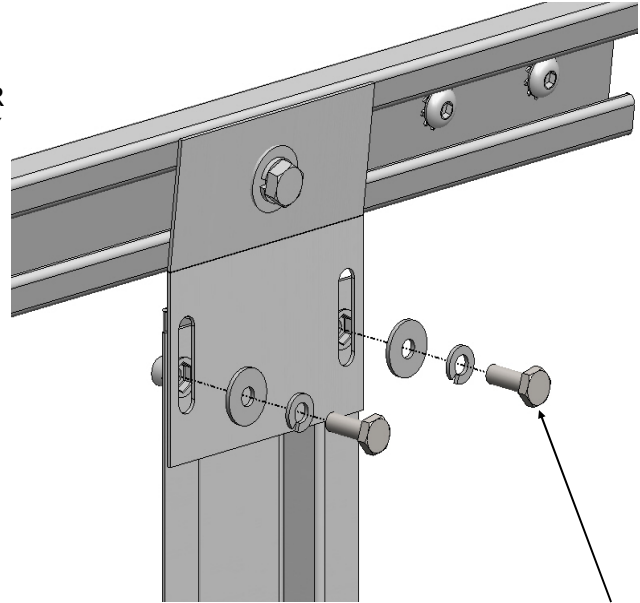
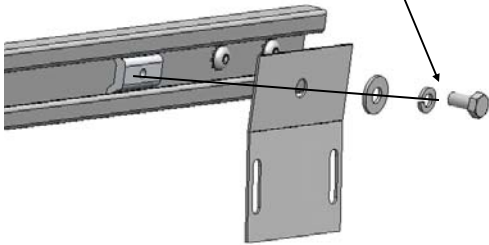

FASTEN WALL POST (40911-G) TO UPPER MOUNT BRKT (40907-G) USING (2) FAS0063,FAS0060, AND FAS0067 TORQUE 8 FT/LBS +/- 3 FT'LBS REPEAT (4) PLACES ON DRIVER SIDE(TIGHTEN FULLY)



06665-1

FASTEN 06665-1 TO WALL POST AND FLOOR RAIL INTO RIVNUTS AS SHOWN,USING SAME FASTENERS AS ABOVE REPEAT (4) PLACES ON DRIVER SIDE SEE COVER SHEET TIGHTEN FULLY

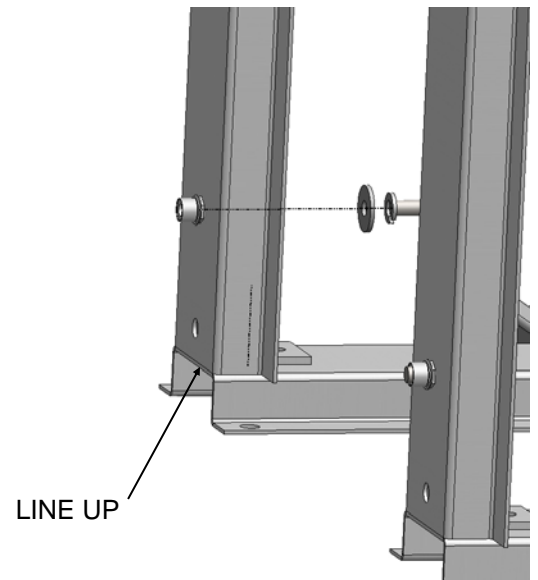
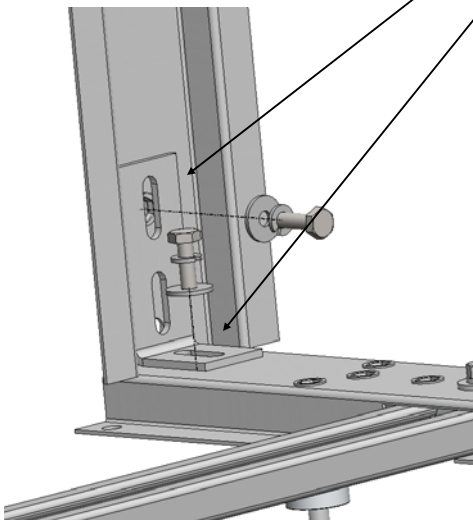

Step 03 LINE UP FLOOR RAILS TO #19 CABINET USING (4) OF EACH FAS0078,FAS0067,FAS0060,AND 03927-1 SPACER ,REMOVE BOTTOM DRAWER ON 19 SET SPACER ON RAIL SET CAB ON SPACER. SECURE AS SHOWN ADD #9 CAB ON TOP OF 19 PER 2255NS OR 2255NH LOCK SMITH PACKAGE, USE 7/16 SOCKET OR WRENCH

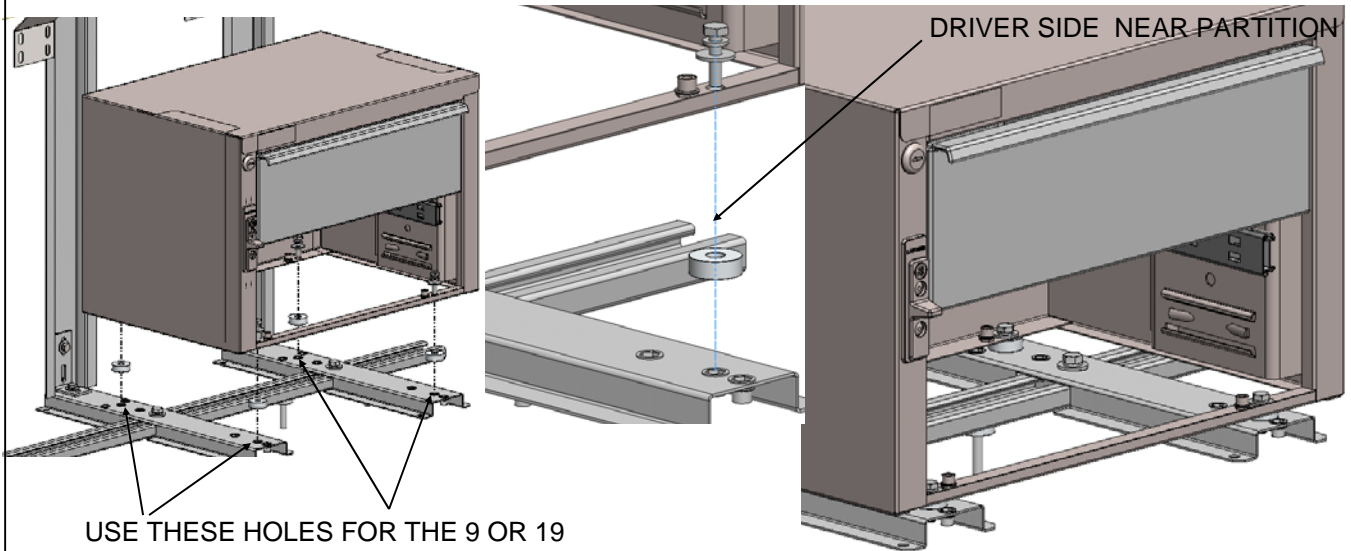

STEP 04 LINE UP FLOOR RAILS WITH # 40 CAB USE SAME FASTENERS . NOTE HOLE LOCATIONS ADJUST TO CLEAR WHEEL WELL BOTH SIDES, USE 7/16 SOCKET OR WRENCH TORQUE TO 8 FT/LBS +/- 3 FT /LBS

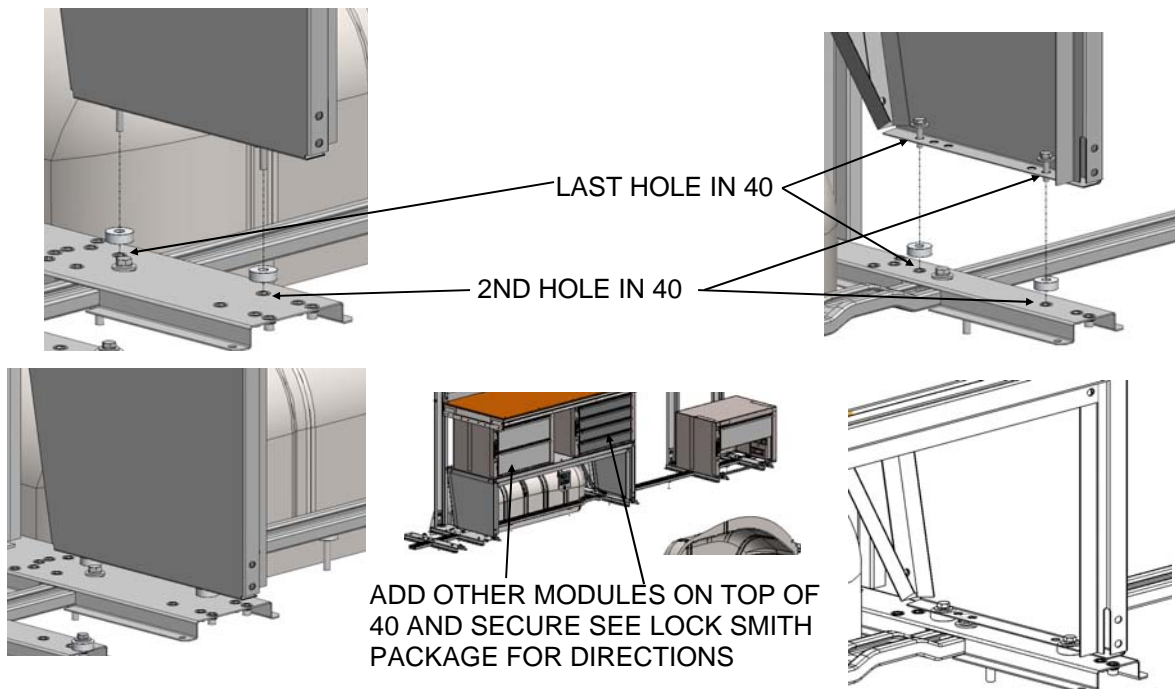

**STEP 05 LINE UP 17A IN FLOOR RAILS AND SECURE USING SAME FASTENERS AS OTHERS
USE 7/16 SOCKET OR WRENCH, TORQUE TO 8 FT/LBS +/- .3 FT/LBS
AFTER 17A IS ATTACHED TO RAILS FASTEN IT TO THE #40 PER LOCK SMITH PACKAGE**

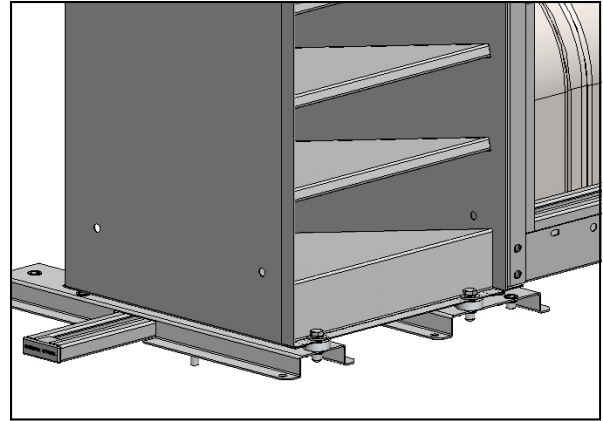
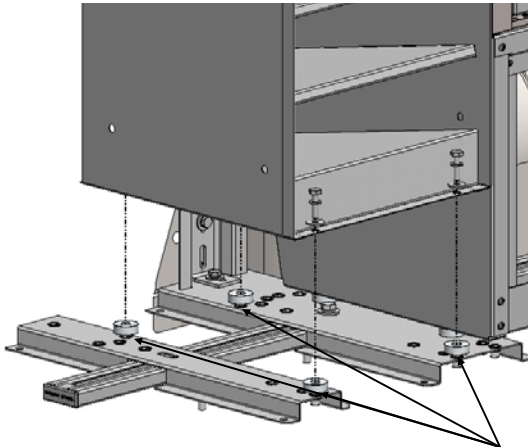

HOLE LOCATIONS

SECURE 17A TO 40 USING LOCK SMITH PACKAGE INSTRUCTIONS, PLACE #54 WORK BENCHES ON TOP ADJUST AND SECURE. LINE UP WALL POST AND TIGHTEN UPPER MOUNTING BRKT TO SLIDE.

USING AN 1/2 INCH OPEN END WRENCH, REACH UNDER 17A,19,#40 UNITS AND DO FINAL TIGHTENING ON FLOOR ADAPTER TO RKLCV FLOOR RAILS, TORQUE TO 12 FT/LBS +/- 3 FT/LBS

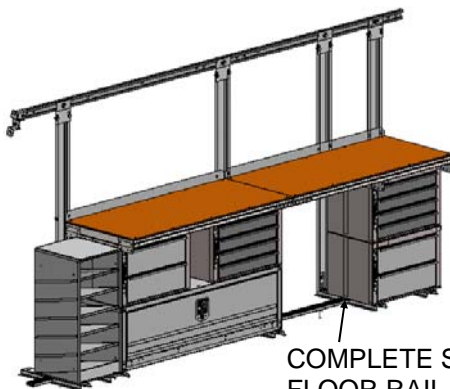
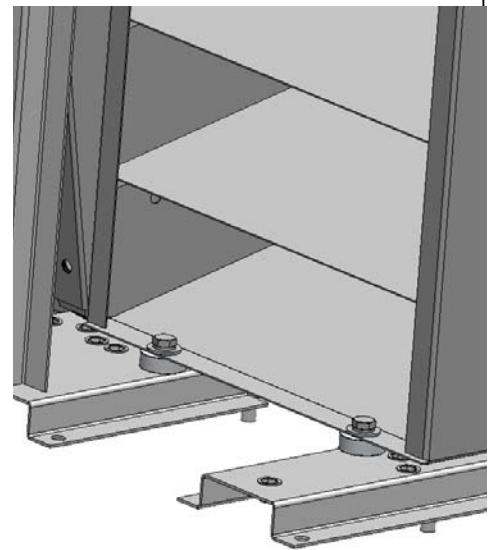

COMPLETE SECURING ADAPTER FLOOR RAIL TO RKLCV FLOOR RAIL (5) PLACES

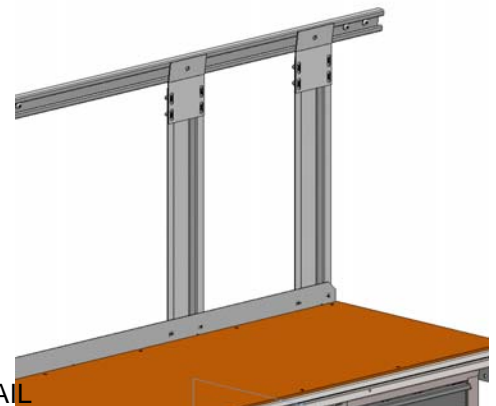



**STEP 06 : SECURE WALL POST TO WORK BENCH TOP USING PHILLIPS SCREW DRIVER
USING THE RIVNUTS AS A LOCATION DRILL .312 THRU BACK PLATE
ATTACH USING FAS0061 SCREWS (7) PLACES; TORQUE TO 8 FT/LBS +/- FT/LB**

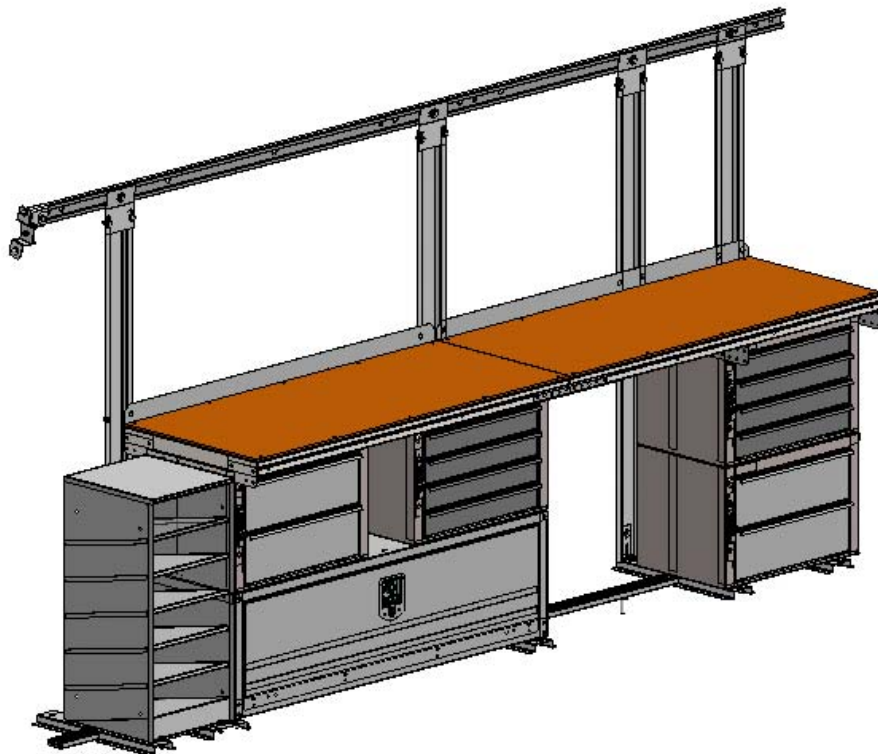
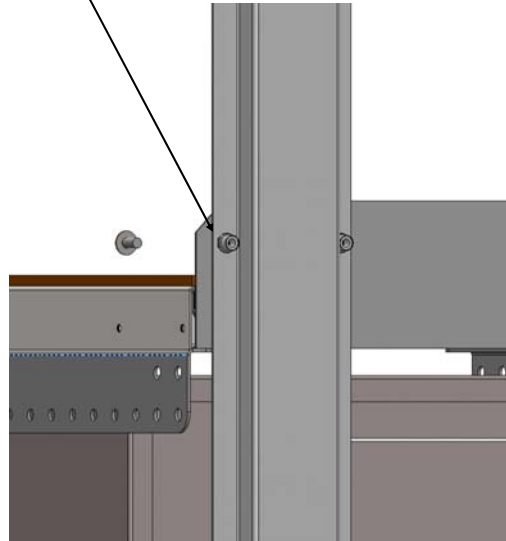
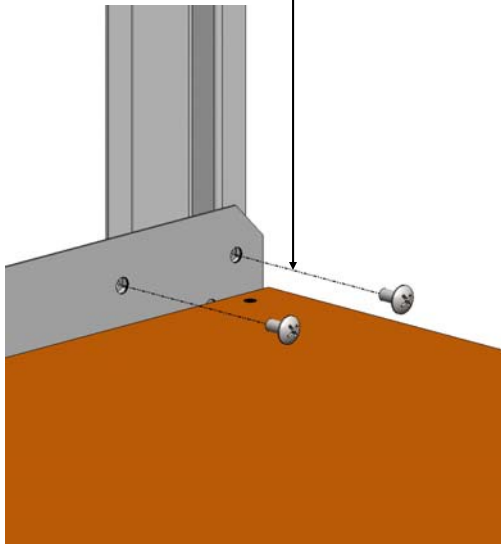



STEP 07: PLACE #40 CAB ON FLOOR MOUNT BRKTS, ADJUST TO CLEAR WHEEL WELLS, SAME AS OTHER SIDE SEE STEP 04, WHEN CLEAR OF WHEEL WELL USE 7/16 OPEN END WRENCH TO TIGHTEN, TORQUE TO 8 FT/LBS +/- 3 FT/LBS

INSERT 6 SLIDES (35335-0) INTO UPPER TRACK

MOUNT TO WALL USING BRKT'S FROM 2255NS OR 2255NH LOCK SMITH PACKAGE, DRILLING MAY BE REQUIRED INTO BACK OF UNITS SHOWN



FASTEN FAS0165, FAS0098, FAS0086 THRU UPPER MOUNT BRKT

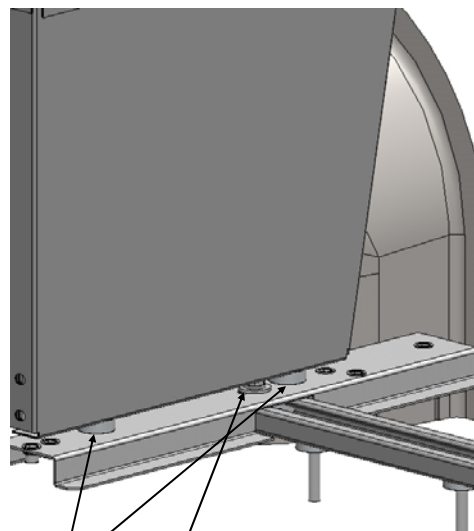
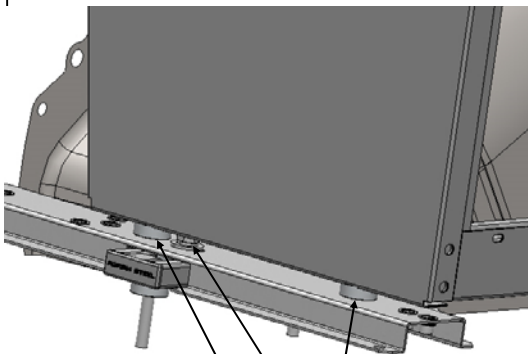
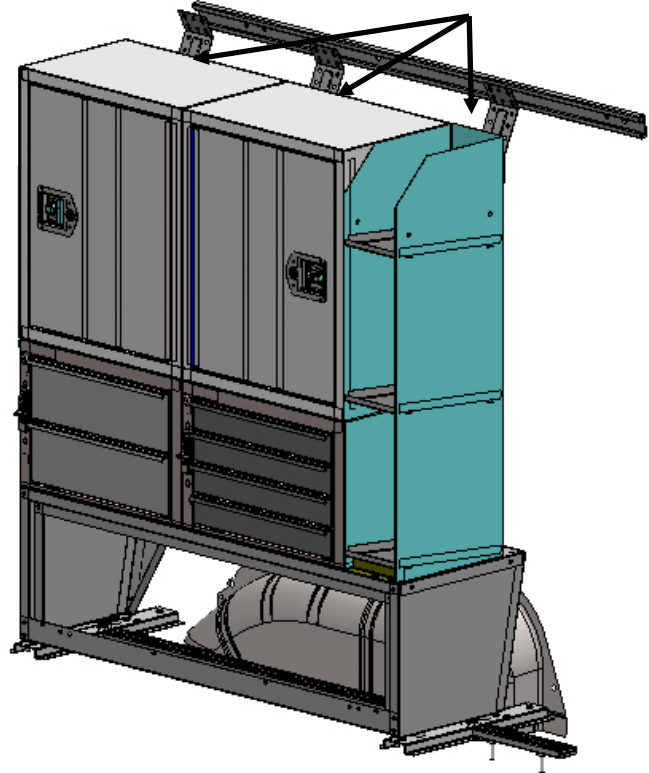
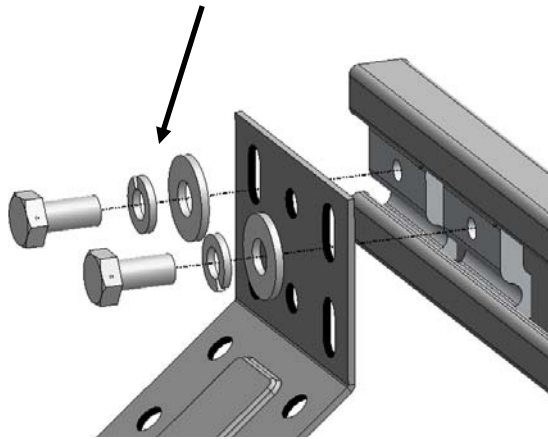

USE 1/2 OPEN END WRENCH TO SECURE ADAPTER FLOOR RAIL TO RKLCV FLOOR RAIL; TORQUE TO 12 FT/LBS +/- 3 FT/LBS

INSTALL ANY DRAWERS, DOORS OR ANYTHING ELSE THAT BELONGS TO THE 2255NS OR 2255NH LOCK SMITH PACKAGE

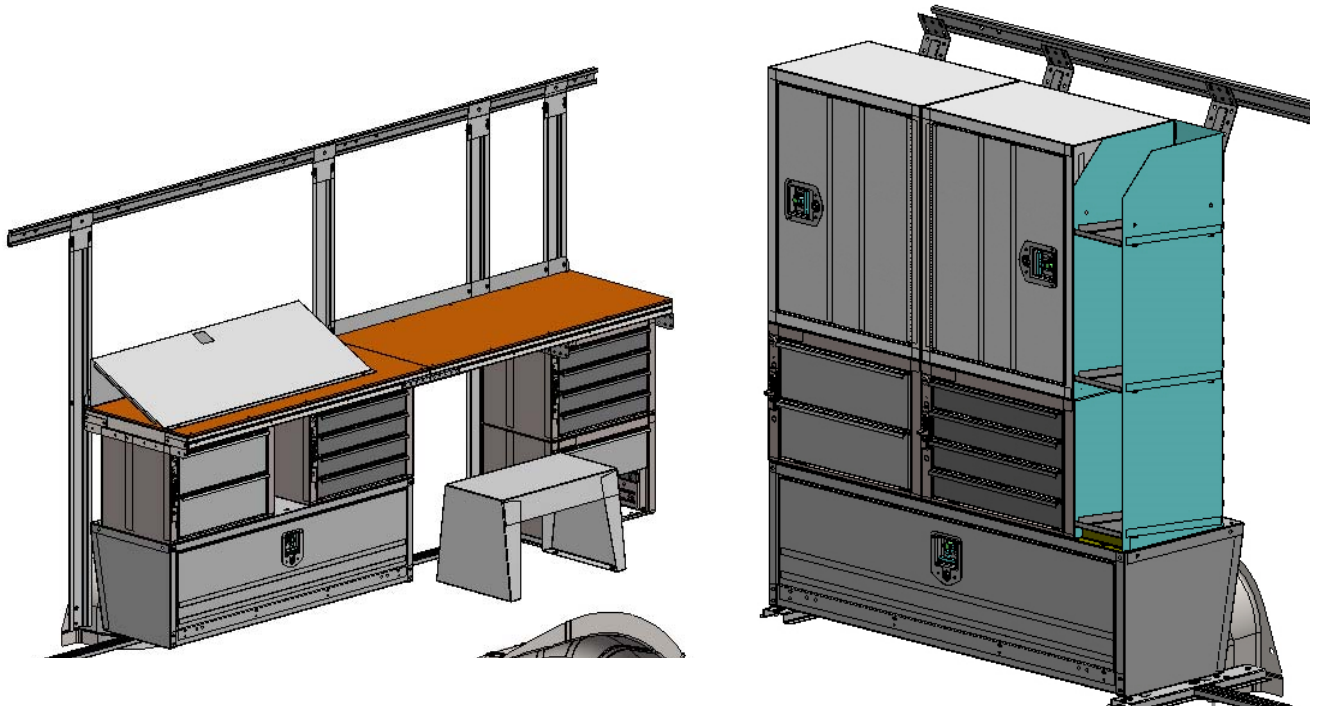

DOUBLE-CHECK ALL FASTENER LOCATIONS TO BE SURE THAT ALL FASTENERS ARE TIGHTENED TO SPECIFICATIONS!



YOUR INSTALLATION IS NOW COMPLETE! STOW THIS COPY IN THE VEHICLE FOR FUTURE REFERENCE!