

INSTR. NUMBER	PG:	REV:	ITEM NO.	PART NUMBER	DESCRIPTION	QTY.
: 68737	1	A	1	68733-W	SLK,PL,FSV,O/S BAR, WHITE	1
			2	68729-W	SLK,PL,LOWER SLIDE CLAMP, WHITE	2
PART NUMBER : PLSLKM			3	68728	SLK,PL,WEAR STRIP,23" LONG	1
	PART DESC. : PROLIFT,SLK,FSV,MAX		4	68725-W	SLK,PL,CROSS SLIDE,MAX, WHITE	1
NOTE: THIS INSTRUCTION IS VALID FOR THE FOLLOWING KITS:			5	68730-W	SLK,PL,INNER STOP POST, WHITE	1
			6	68732-W	SLK,PL,LOWER CLAM CLAMP, WHITE	1

-PART NUMBERS WITH "-W" SUFFIX ARE PAINTED WHITE
 -FOR BLACK KITS, REPLACE "-W" PARTS WITH "-B" PARTS

- PLSLKMW
- PLSLKMB

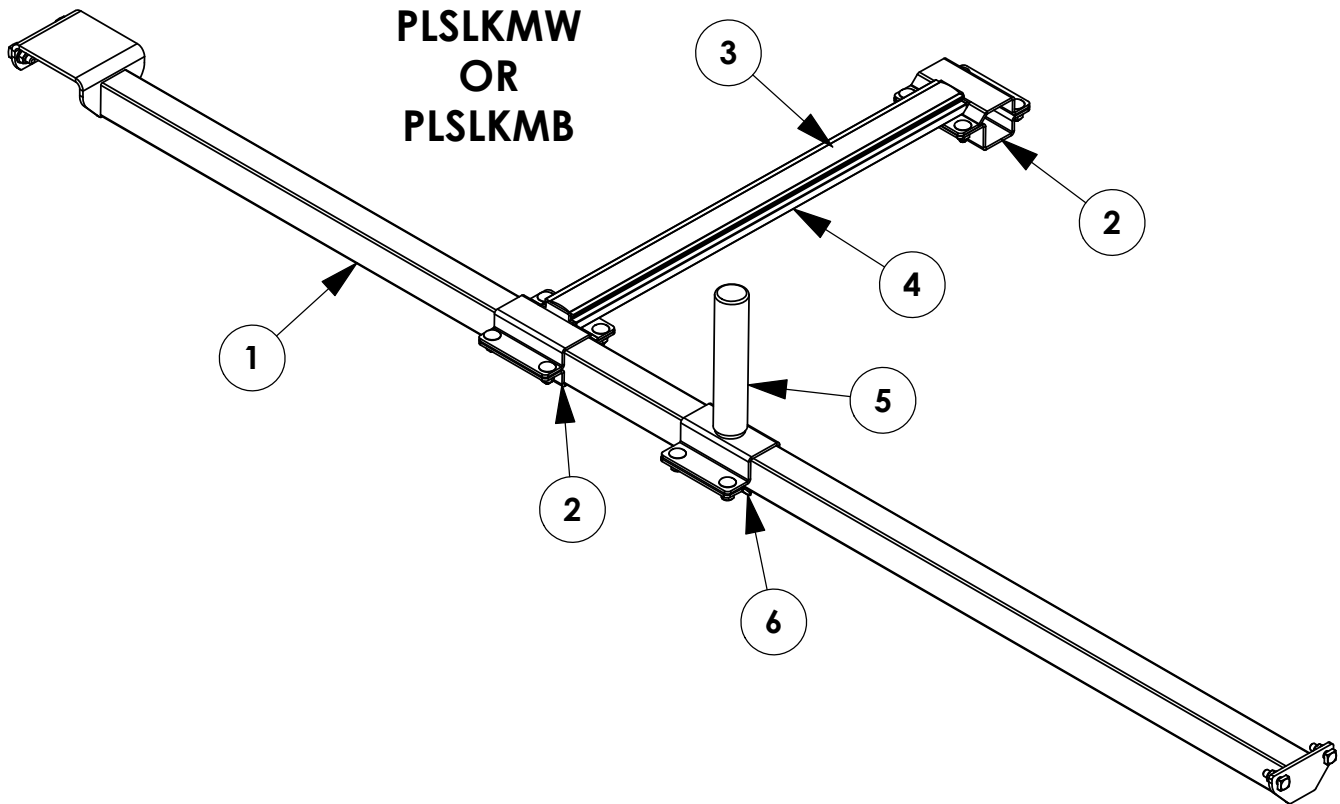

GET TO KNOW THE VEHICLE - AT THE BEGINNING OF ANY INSTALLATION, CHECK THE LOCATION OF THE FUEL TANK, FUEL LINES, BRAKE LINES, HIGH VOLTAGE BATTERIES AND WIRING HARNESSSES TO AVOID INJURY OR PROPERTY DAMAGE FROM TOOL CONTACT.

SEAL ALL EXTERIOR HOLES - ALL INSTALLATION HOLES SHOULD BE SEALED WITH BUTYL TAPE OR SILICON TO PREVENT WATER AND EXHAUST GASES FROM ENTERING THE VEHICLE.

CONTROL DRILL DEPTH - TO AVOID DAMAGE TO THE VEHICLE, USE A DRILL STOP OR CLEARED STEP BIT WHEN DRILLING INSTALLATION HOLES.

ALWAYS ADD PRIMER - WHEN ADDING INSTALLATION HOLES BE SURE TO USE A SELF-ETCHING PRIMER TO PREVENT CORROSION, FASTENER FAILURE AND INJURY.

MOUNTING POINTS MUST HAVE METAL-TO-METAL CONTACT - USE PROVIDED MOUNTING SPACERS TO ACCOMMODATE FOR VEHICLE FEATURES, CARPET OR SUBFLOORS.

PROVIDE CLEARANCE FOR SPACERS - IF THE INSTALLATION VEHICLE CONTAINS A CARPET OR SUBFLOOR, USE A 1-3/16" DIAMETER CARPET CUTTER (P/N: 31183-0) AT ALL MOUNTING LOCATIONS TO OPEN UP ROOM FOR SPACERS.

CHECK SPACER ORIENTATION - BE SURE THAT THE INDENT IN THE SPACER COVERS THE PLUSNUT HEAD; THIS ENSURES THE MOST METAL-TO-METAL CONTACT AND REDUCES VIBRATION.

PLUSNUT INSTALLATION - A PLUSNUT GUN IS RECOMMENDED FOR PLUSNUT INSTALLATION FOR ITS PRODUCTION SPEED. HOWEVER, A PLUSNUT SETTING TOOL CAN ALSO BE USED (P/N: 22200-0).

THRU-BOLT CLEARANCE - WHEN USING A THRU-BOLT AT ANY MOUNTING LOCATION, BE SURE THAT YOUR HOLE HAS 1/16" CLEARANCE.

FASTENERS USED

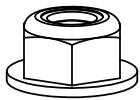

FAS0861
NUT,HEX NLK FLG
5/16-18SS
QTY: 14

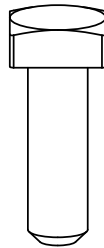

FAS0035
BOLT,SQ HD
5/16-18X1.0 SS
QTY: 04

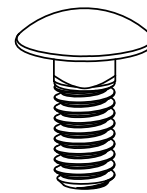

FAS0866
BOLT,CRG
5/16-18X.75 SS
QTY: 10

STEP 1A - INSERT BOLTS INTO CARTRIDGES

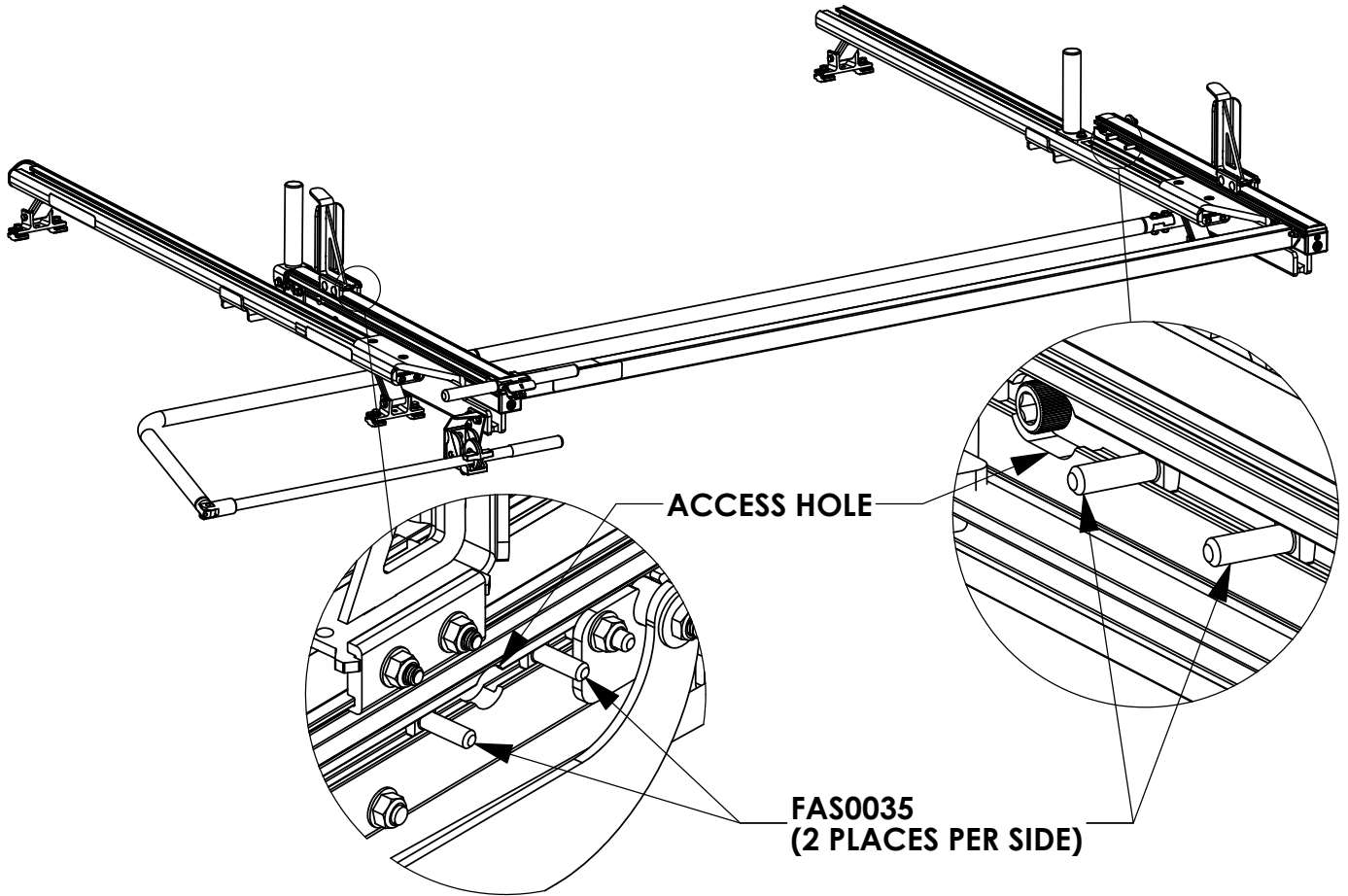

STEP 1B - INSTALL INNER SUPPORT BAR

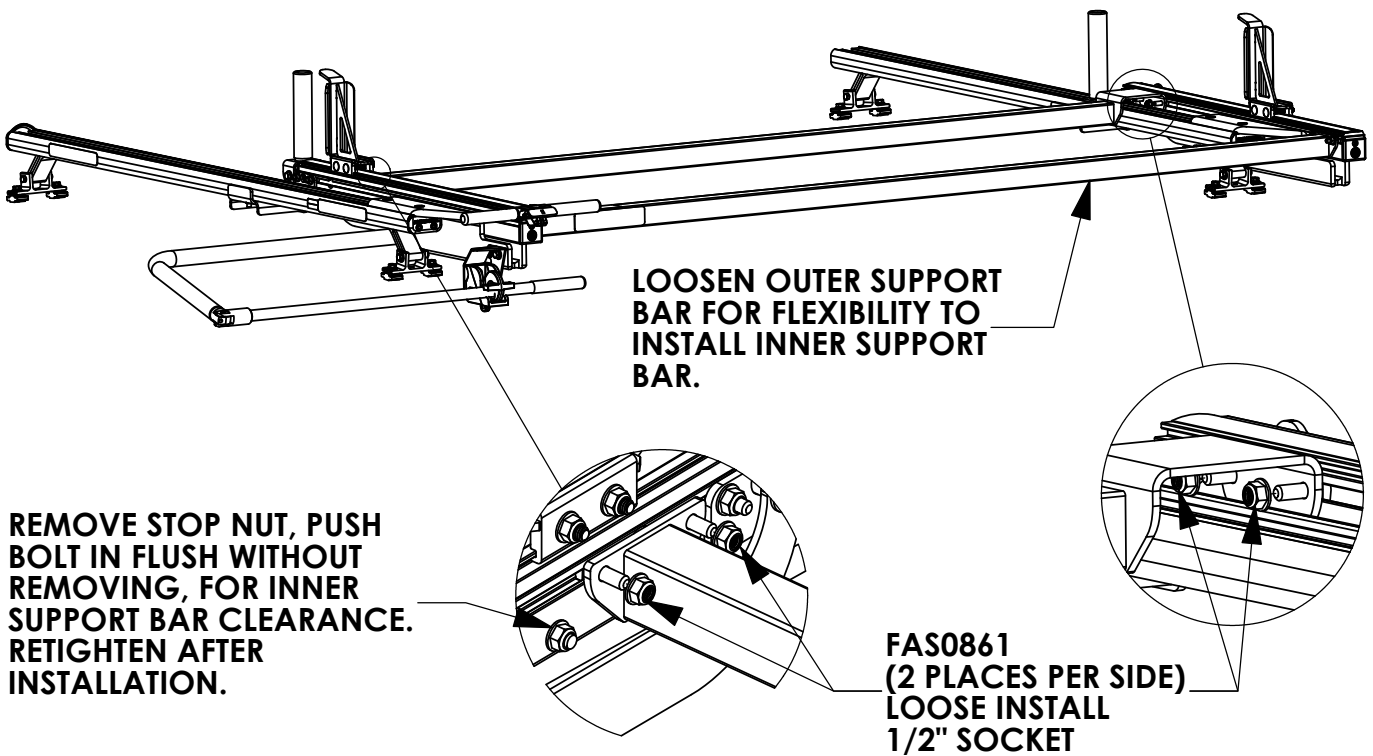

STEP 2A - SET CROSS SLIDE DOWN SPANNING BOTH SUPPORT BARS

INSERT WEAR STRIP INTO SLIDE EXTRUSION

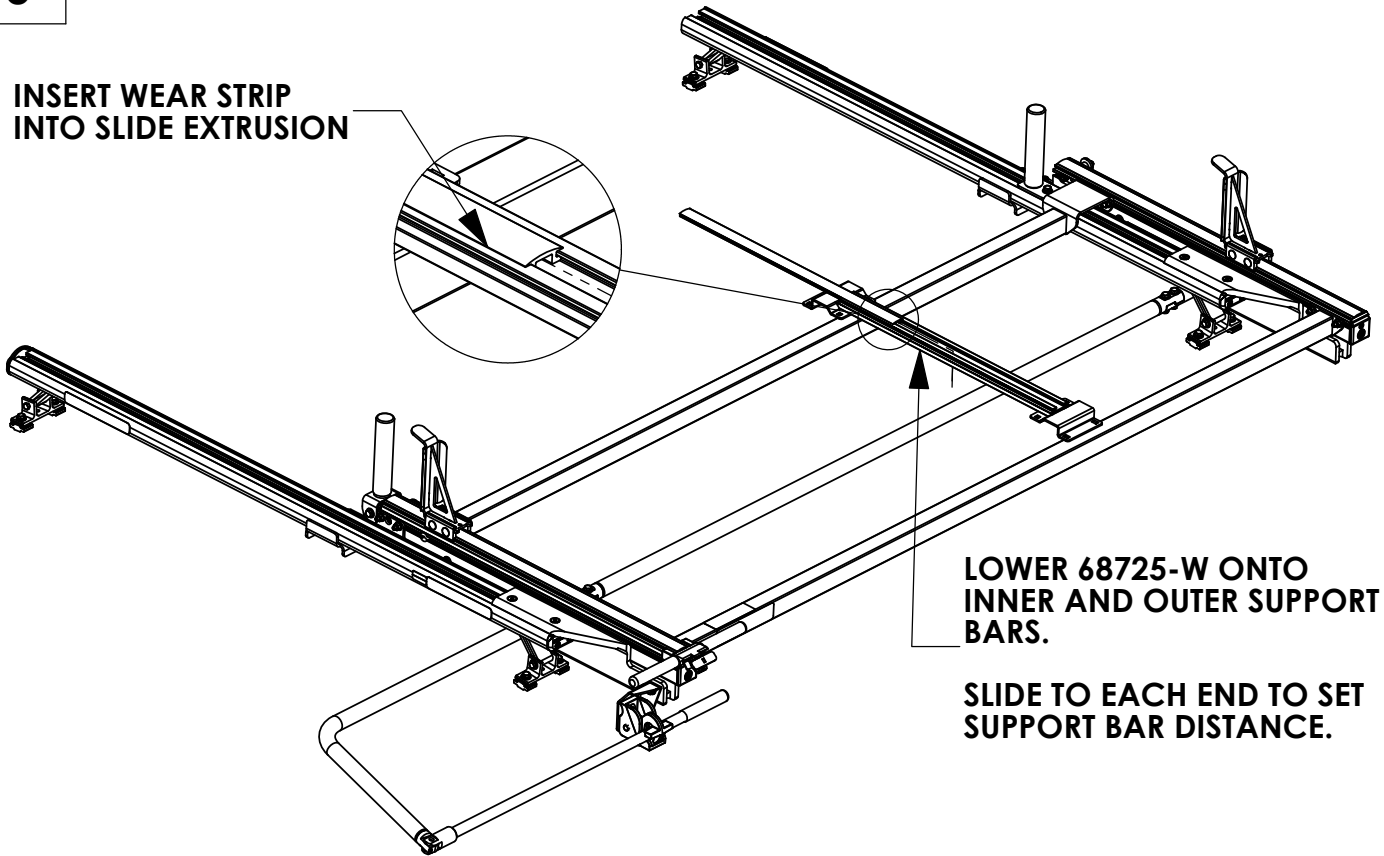
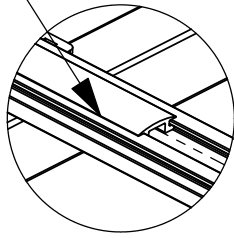

LOWER 68725-W ONTO INNER AND OUTER SUPPORT BARS.

SLIDE TO EACH END TO SET SUPPORT BAR DISTANCE.

STEP 2B - INSTALL LOWER CLAMP BOTH ENDS

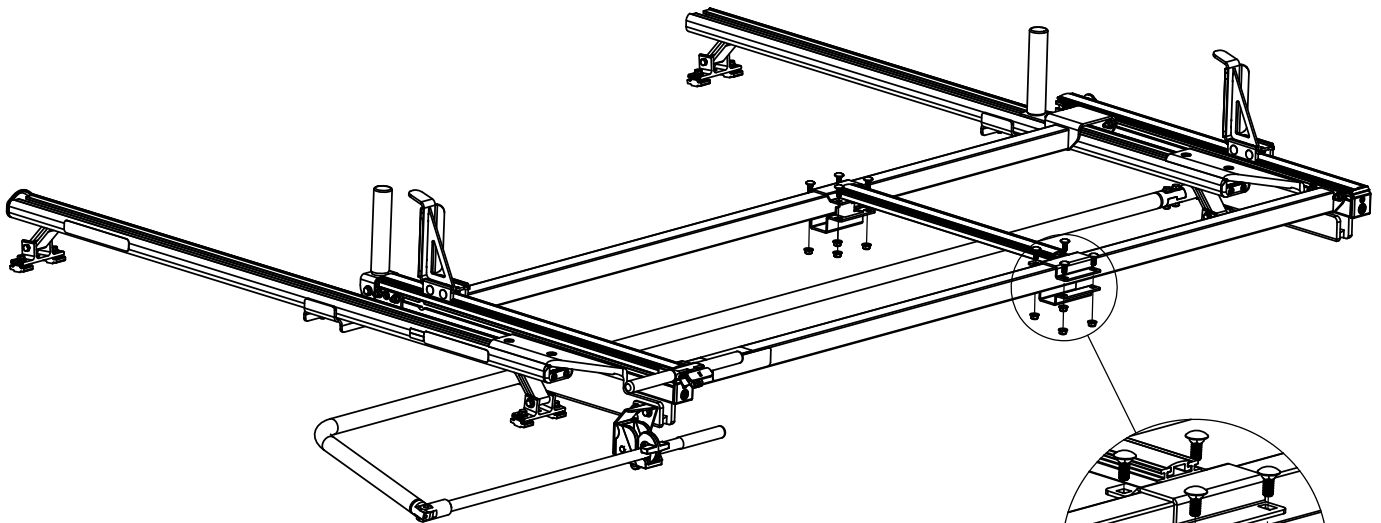

**FAS0866, FAS0861
(4 PLACES PER SIDE)
1/2" SOCKET**

!! TIGHTEN ALL FASTENERS NOW !!

STEP 3 - INSTALL INNER STOP POST

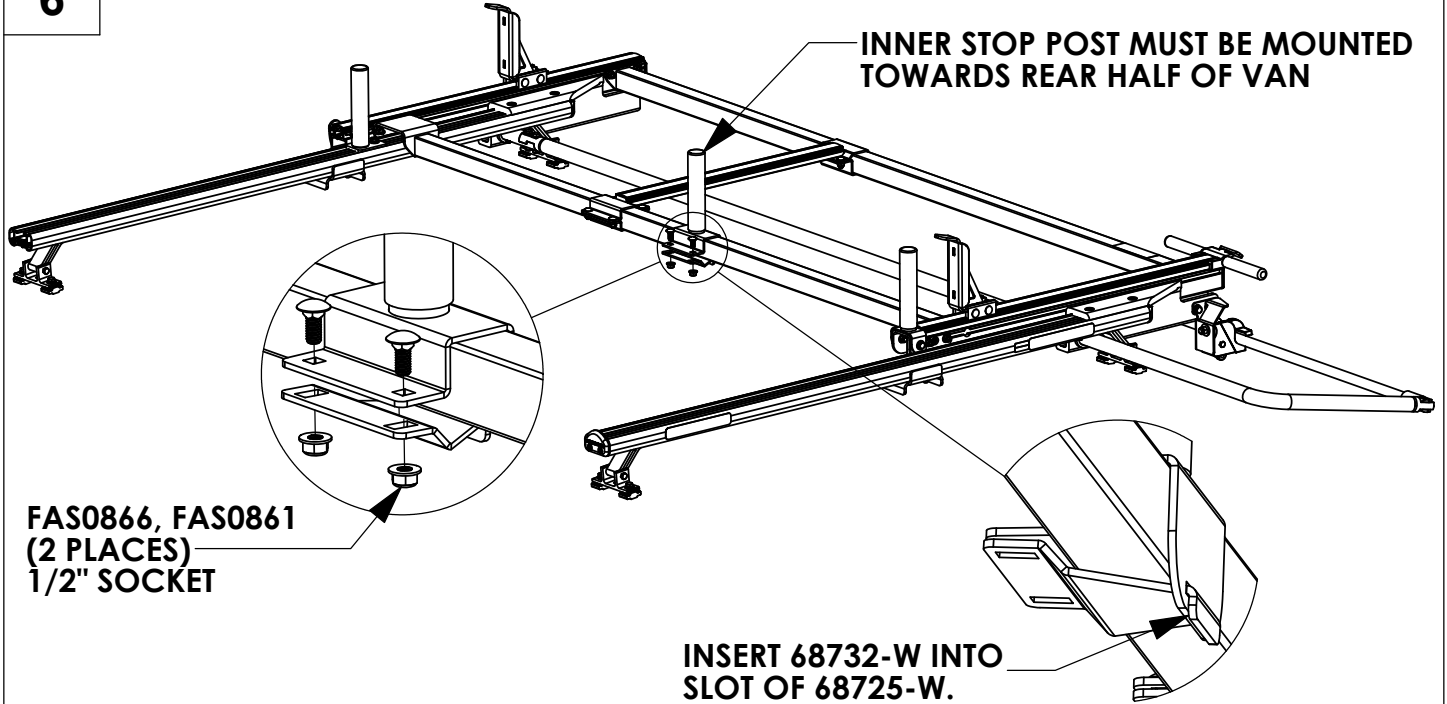

STEP 4 - CLAMP RELOCATION

REMOVE 68037-B CLAMP FROM DRIVER SIDE REAR CARTRIDGE AND REINSTALL ON STEP LADDER KIT AS SHOWN.
1/2" SOCKET

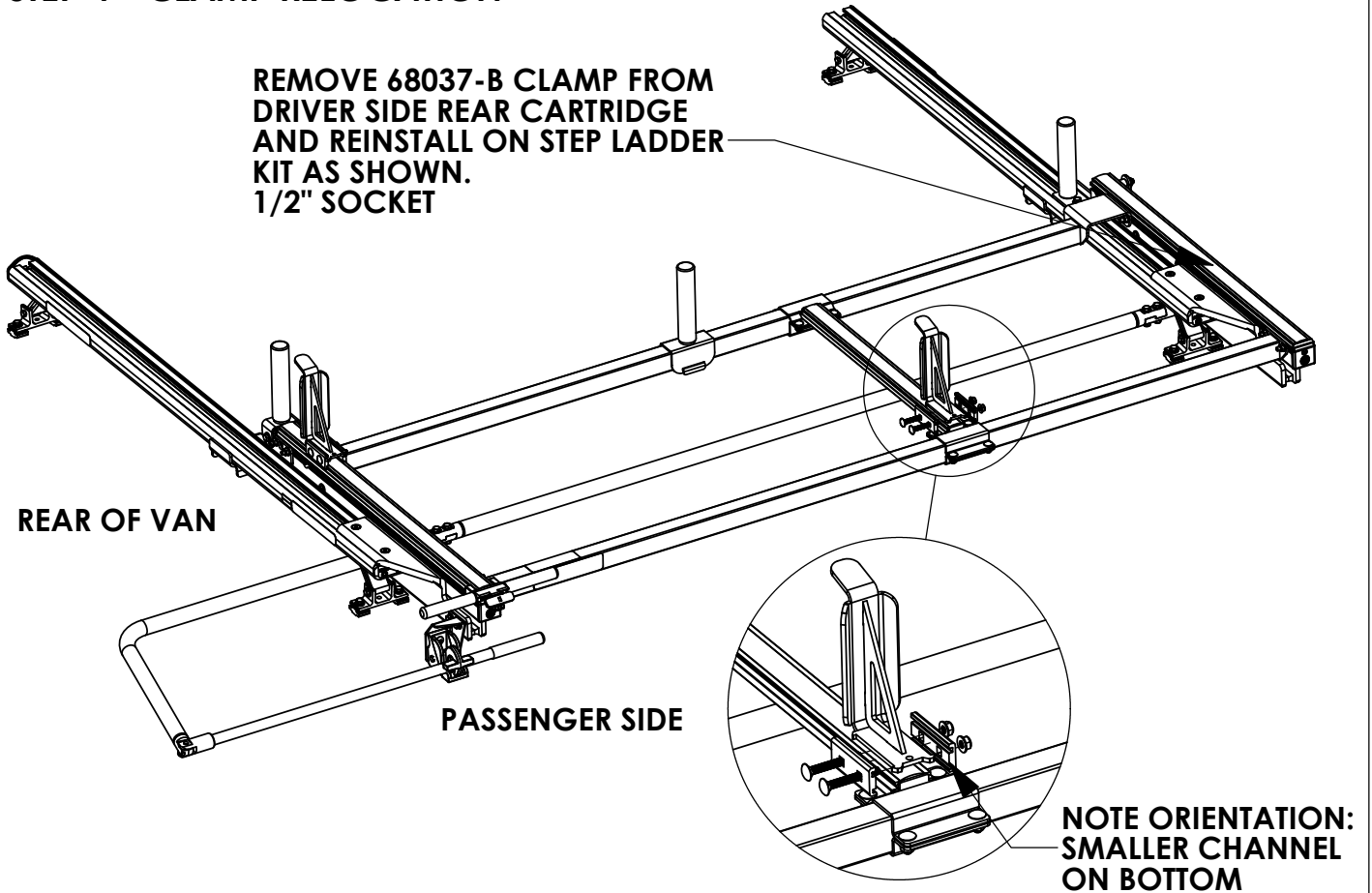

ENSURE ALL FASTENERS HAVE BEEN TIGHTENED.

INSTALLATION COMPLETE. REFER TO END USER INSTRUCTIONS FOR FINAL ADJUSTMENT.

INSTR. NUMBER	: 69501	PG: 1	REV: A
PART NUMBER	. ProLift Max Drop • Step Ladder		
PART DESC.	• ProLift Max Drop Step Ladder • Kit		

Step 1: With 1/2" socket loosen nuts (X4), Slide step ladder forward or rearward on rack to accomodate step ladder length. Tighten nuts. (X4)

Step 3: With 1/2" Socket loosen nuts (X2), Slide Post so that it provides a snug fit for the ladder. Tighten nuts. (X2)

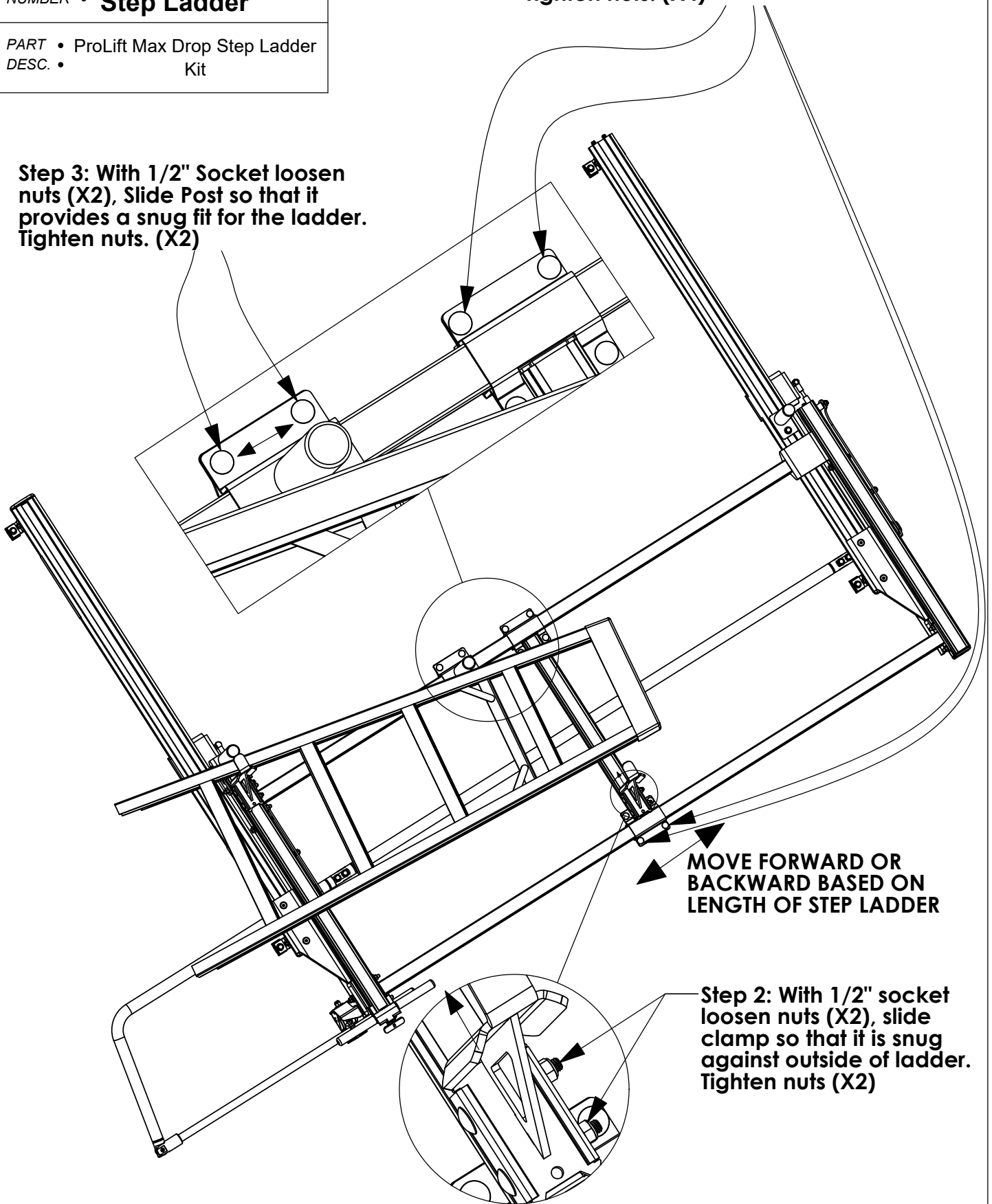

MOVE FORWARD OR
BACKWARD BASED ON
LENGTH OF STEP LADDER

Step 2: With 1/2" socket
loosen nuts (X2), slide
clamp so that it is snug
against outside of ladder.
Tighten nuts (X2)