

INSTR. : 69484
NUMBER

PG: 1
REV: A

PART • Standard Drop ProLift
NUMBER • Low & Compact Vans

PART ProLift Adjustment Instructions -
DESC. • Standard Drop
• Low Roof & Compact Vans

Step 3: With 1/2" Socket loosen nut, slide post so that it is snug against the ladder. Tighten nut

Step 1: With 1/2" Socket loosen nut, slide post so that it is snug against the ladder. Tighten nut

SLIDE FORWARD

SLIDE FORWARD

Step 4: With 1/2" Socket loosen nuts (X2) slide clamp so that it is snug against the ladder. Tighten nuts (X2)

Step 2: With 1/2" Socket loosen nuts (X2) slide clamp so that it is snug against the ladder. Tighten nuts (X2)

Once all brackets are adjusted operate rack to make sure clamps are not too tight

| | | | | | | | |
|--|--|----------|-----------|----------|-------------|--------------------------------------|------|
| INSTR. : 68497 NUMBER : | | PG: 1 | REV: C | ITEM NO. | PART NUMBER | DESCRIPTION | QTY. |
| | | | | 1 | 68298-W | STD DROP CARTRIDGE, LR DS, WHITE | 1 |
| | | | | 2 | 68013-W | DROP DOWN FRONT ARM ASM DS, WHITE | 1 |
| PART : PLSDPSL & PLSDDSL NUMBER : | | | | 3 | 66563-B | DROP DOWN, SS CENTER DRIVELINE, BLK | 1 |
| | | | | 4 | 66959-W | DROP DOWN OUTER BAR, WELDMENT, WHITE | 1 |
| | | | | 5 | 66611-B | DROP DOWN, PIVOT HANDLE, BLK | 1 |
| PART • PROLIFT,STD,PS,LR DESC. • & PROLIFT,STD,DS,LR | | | | 6 | 58239 | COMPRESSION DAMPER | 1 |
| | | | | 7 | 48265 | DAMPER ASSEMBLY | 1 |
| | | | | 8 | 68186-W | PROLIFT INNER POST, WHITE | 2 |
| PLSDDSLW | | | | 9 | 68180-W | DROP DOWN LATCH BRACKET, WHITE | 1 |
| | | | | 10 | 25340-0 | HANDLE LATCH-STD | 1 |
| | | | | 11 | 68037-B | CLAMP PAD, 6.5", BLACK | 2 |
| | | | | 12 | 68045-W | PROLIFT DAMPER MOUNT, WHITE | 2 |
| | | | | | | | |

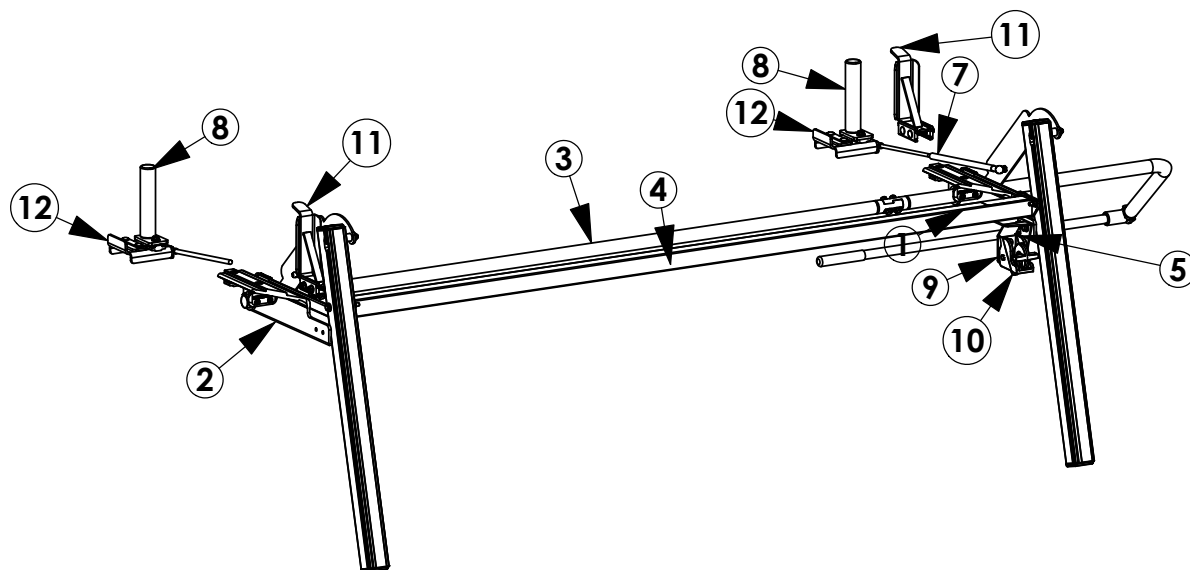

| ITEM NO. | PART NUMBER | DESCRIPTION | QTY. |
|----------|-------------|--------------------------------------|------|
| 1 | 68297-W | STD DROP CARTRIDGE, LR PS, WHITE | 1 |
| 2 | 68031-W | DROP DOWN FRONT ARM ASSM PS, WHITE | 1 |
| 3 | 66572-B | DROP DOWN, CS CENTER DRIVELINE, BLK | 1 |
| 4 | 66959-W | DROP DOWN OUTER BAR, WELDMENT, WHITE | 1 |
| 5 | 66611-B | DROP DOWN, PIVOT HANDLE, BLK | 1 |
| 6 | 58239 | COMPRESSION DAMPER | 1 |
| 7 | 48265 | DAMPER ASSEMBLY | 1 |
| 8 | 68045-W | PROLIFT DAMPER MOUNT, WHITE | 2 |
| 9 | 68186-W | PROLIFT INNER POST, WHITE | 2 |
| 10 | 68180-W | DROP DOWN LATCH BRACKET, WHITE | 1 |
| 11 | 25340-0 | HANDLE LATCH-STD | 1 |
| 12 | 68037-B | CLAMP PAD, 6.5", BLACK | 2 |

PLSDPSLW

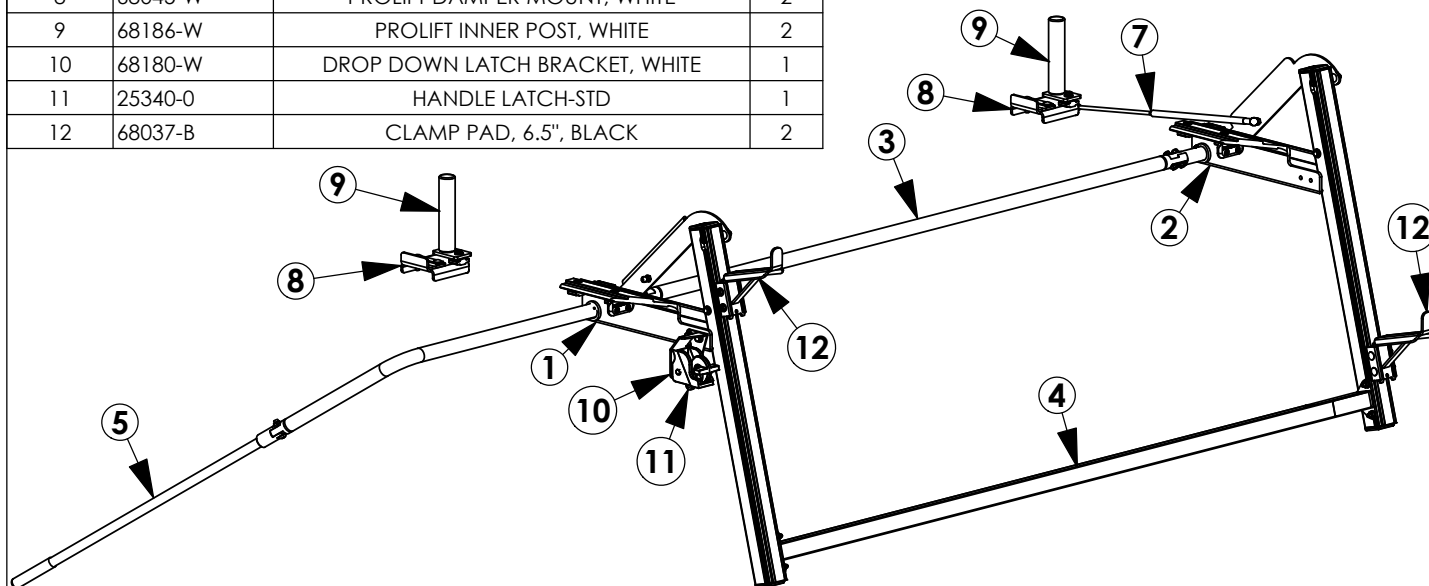

GET TO KNOW THE VEHICLE - AT THE BEGINNING OF ANY INSTALLATION, CHECK THE LOCATION OF THE FUEL TANK, FUEL LINES, BRAKE LINES, HIGH VOLTAGE BATTERIES AND WIRING HARNESSSES TO AVOID INJURY OR PROPERTY DAMAGE FROM TOOL CONTACT.

SEAL ALL EXTERIOR HOLES - ALL INSTALLATION HOLES SHOULD BE SEALED WITH BUTYL TAPE OR SILICON TO PREVENT WATER AND EXHAUST GASES FROM ENTERING THE VEHICLE.

CONTROL DRILL DEPTH - TO AVOID DAMAGE TO THE VEHICLE, USE A DRILL STOP OR CLEARED STEP BIT WHEN DRILLING INSTALLATION HOLES.

ALWAYS ADD PRIMER - WHEN ADDING INSTALLATION HOLES BE SURE TO USE A SELF-ETCHING PRIMER TO PREVENT CORROSION, FASTENER FAILURE AND INJURY.

MOUNTING POINTS MUST HAVE METAL-TO-METAL CONTACT - USE PROVIDED MOUNTING SPACERS TO ACCOMMODATE FOR VEHICLE FEATURES, CARPET OR SUBFLOORS.

PROVIDE CLEARANCE FOR SPACERS - IF THE INSTALLATION VEHICLE CONTAINS A CARPET OR SUBFLOOR, USE A 1-3/16" DIAMETER CARPET CUTTER (P/N: 31183-0) AT ALL MOUNTING LOCATIONS TO OPEN UP ROOM FOR SPACERS.

CHECK SPACER ORIENTATION - BE SURE THAT THE INDENT IN THE SPACER COVERS THE PLUSNUT HEAD; THIS ENSURES THE MOST METAL-TO-METAL CONTACT AND REDUCES VIBRATION.

PLUSNUT INSTALLATION - A PLUSNUT GUN IS RECOMMENDED FOR PLUSNUT INSTALLATION FOR ITS PRODUCTION SPEED. HOWEVER, A PLUSNUT SETTING TOOL CAN ALSO BE USED (P/N: 22200-0).

THRU-BOLT CLEARANCE - WHEN USING A THRU-BOLT AT ANY MOUNTING LOCATION, BE SURE THAT YOUR HOLE HAS 1/16" CLEARANCE.

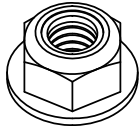
FASTENERS AND HARDWARE USED

FAS0861
NUT,HEX NLK FLG 5/16-18
QTY: 18



FAS0110
NUT,HEX NLK 3/8-16
QTY: 01

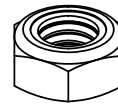

FAS0399
NUT,HEX NLK LT 3/8-16
QTY: 01

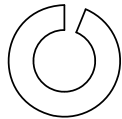

FAS0588
WASHER,LCK SPLIT 5/16
QTY: 03

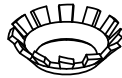

FAS0857
WASHER,LCK EXT CS 5/16
QTY: 04

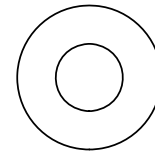

FAS0552
WASHER,FLAT USS 5/16
QTY: 09

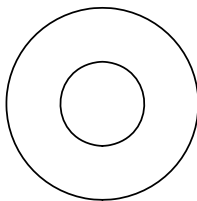

FAS0720
WASHER,FLAT USS 3/8
QTY: 01

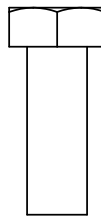

FAS0283
SCREW,HH 5/16-18X.875
QTY: 02

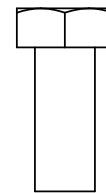

FAS0799
SCREW,HH 5/16-18X.75
QTY: 02

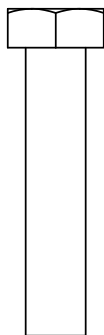

FAS0242
SCREW,HH 5/16-18X1.5
QTY: 04

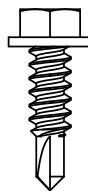

FAS0473
SCREW,HH TEK #12X.75
QTY: 04



FAS0856
SCREW,FHH 5/16-18X1.13
QTY: 04

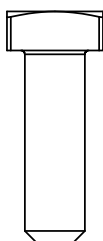

FAS0035
BOLT,SQ HD 5/16-18X1.0
QTY: 08

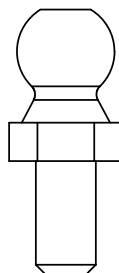

34927-0
BALL STUD 13MM X 5/16-18
QTY: 02

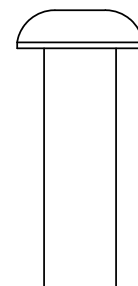

FAS0701
SCREW,BHCS 3/8-16X1.25
QTY: 01

FASTENERS AND HARDWARE USED

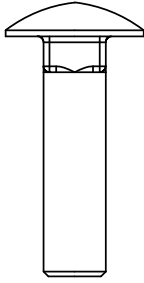

FAS0812
BOLT,CRG 5/16-18X1.25
QTY: 04

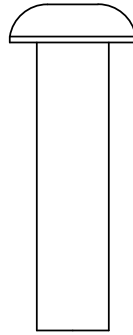

FAS0819
SCREW,BHCS 3/8-16X1.5
QTY: 01

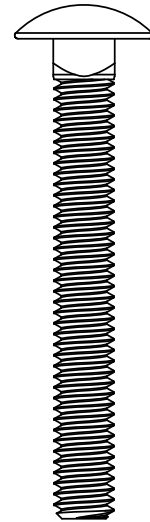

FAS0838
BOLT,CRG 5/16-18X2.5
QTY: 04

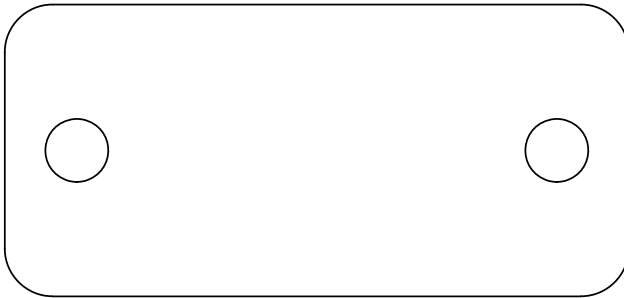

64831
REAR ROLLER, SPACER
QTY: 02

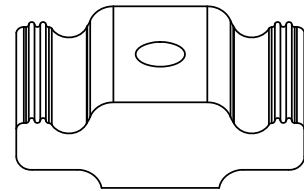

63490
RAIL SLIDE, 1"
QTY: 06



64830
REAR ROLLER, BOLT PLATE
QTY: 02

DISCARD

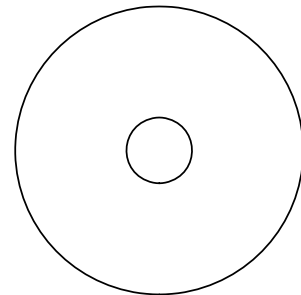

FAS0603
SCREW,HH 5/16-18X.875
QTY: 02

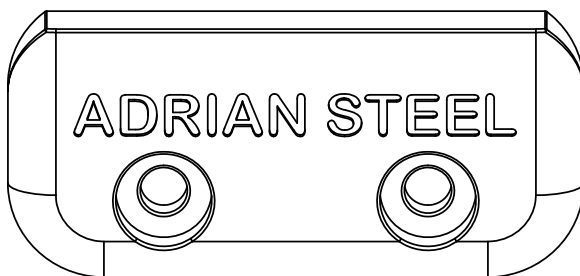

65961
DROP DOWN END CAP
QTY: 02

BEGIN ASSEMBLY**STEP 1 - INSTALL CLAMPS AND HARDWARE ON DROP DOWN CARTRIDGES****PASSENGER SIDE
CARTRIDGES****MUST BE THIS ORIENTATION!****FRONT SUB-
ASSEMBLY**LEAVE LOOSEUSE FAS0856,
FAS0857, & 63490
(02 PLACES)
3/16" ALLENLEAVE LOOSEUSE FAS0856,
FAS0857, & 63490
(02 PLACES)
3/16" ALLENUSE FAS0838 & FAS0861
(02 PLACES)
1/2" SOCKETFAS0035
SLIDE INTO SLOT
(02 PLACES)USE FAS0838 & FAS0861
(02 PLACES)
1/2" SOCKETFAS0035
SLIDE INTO SLOT
(02 PLACES)USE FAS0799,
FAS0552, & FAS0588
(02 PLACES)
1/2" SOCKETUSE FAS0701,
FAS0720, & FAS0110
(02 PLACES)
7/32" ALLEN
9/16" SOCKET**REAR SUB-
ASSEMBLY****DRIVER SIDE
CARTRIDGES****REAR SUB-
ASSEMBLY****MUST BE THIS ORIENTATION!**USE FAS0838 & FAS0861
(02 PLACES)
1/2" SOCKETLEAVE LOOSEUSE FAS0856,
FAS0857, & 63490
(02 PLACES)
3/16" ALLENLEAVE LOOSEUSE FAS0856,
FAS0857, & 63490
(02 PLACES)
3/16" ALLENUSE FAS0838 & FAS0861
(02 PLACES)
1/2" SOCKETFAS0035
SLIDE INTO SLOT
(02 PLACES)**FRONT SUB-
ASSEMBLY**FAS0035
SLIDE INTO SLOT
(02 PLACES)USE FAS0799,
FAS0552, & FAS0588
(02 PLACES)
1/2" SOCKETUSE FAS0701,
FAS0720, & FAS0110
(02 PLACES)
7/32" ALLEN
9/16" SOCKET

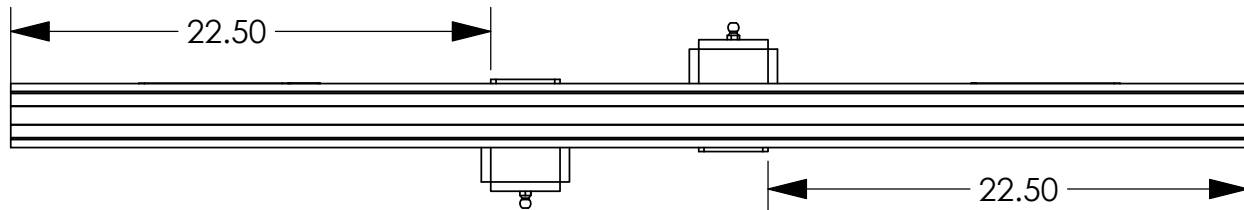
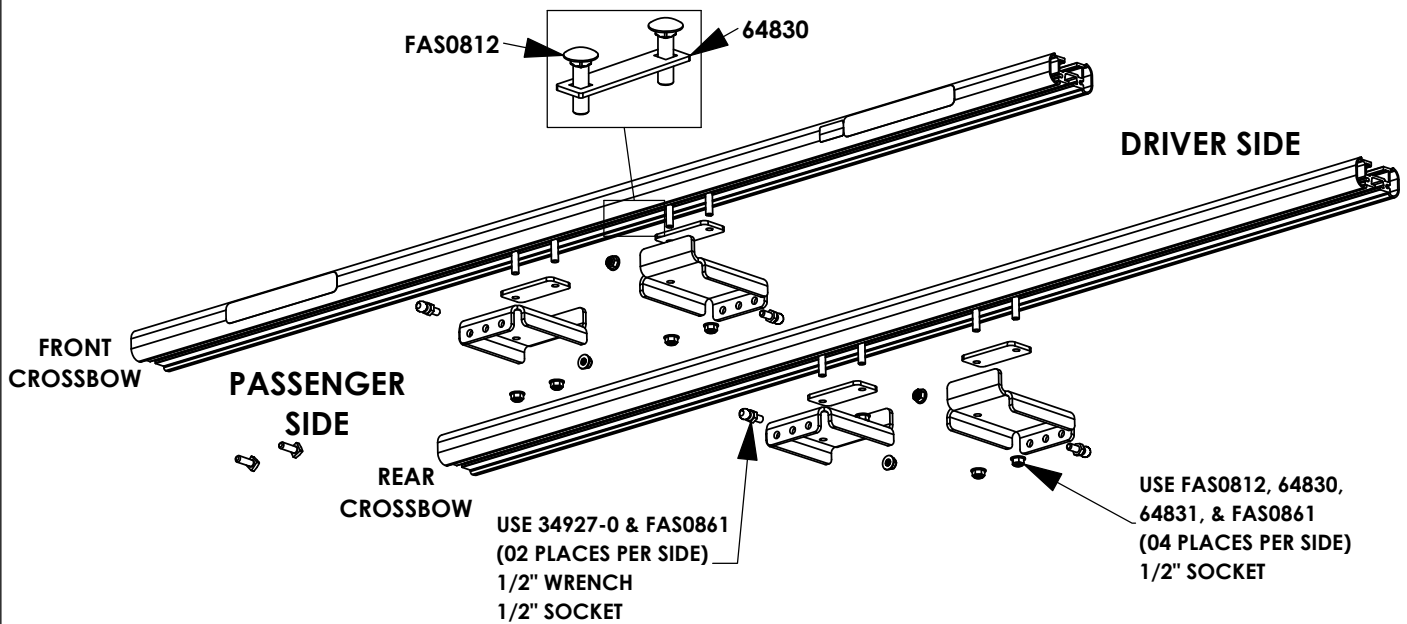
STEP 2 - MOUNT DAMPER BRACKETS AND INNER STOPS TO CROSSBOWS

**MOUNT 22" FROM THE
END OF THE CROSSBOW**

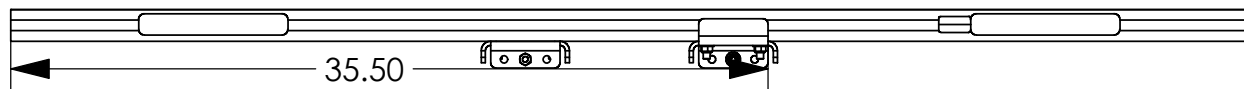

**USE FAS0283,
FAS0552, & 63490
(02 PLACES PER SIDE)
1/2" SOCKET**

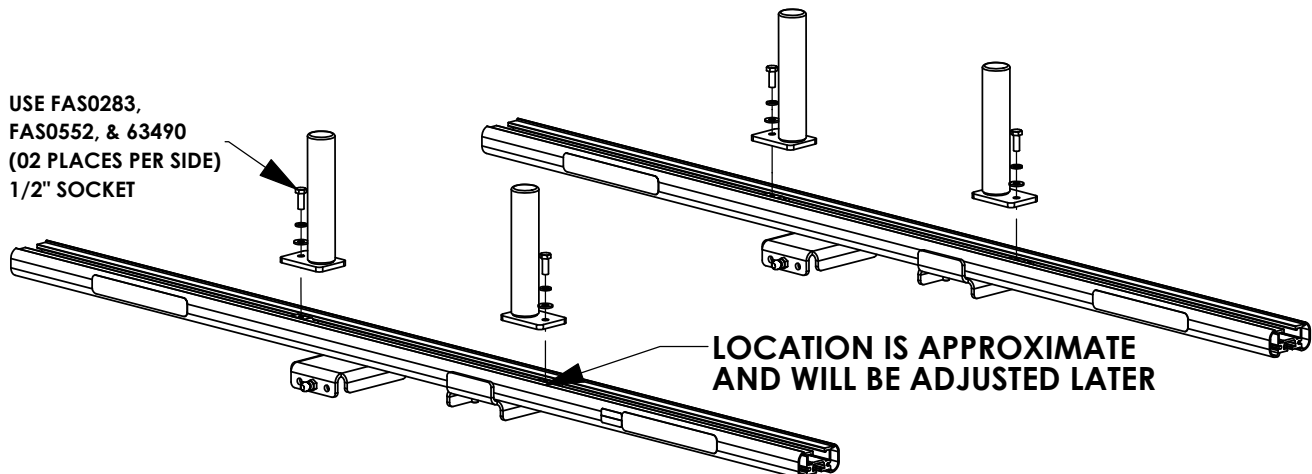

STEP 3 - INSTALL CARTRIDGES ON CROSSBOWS

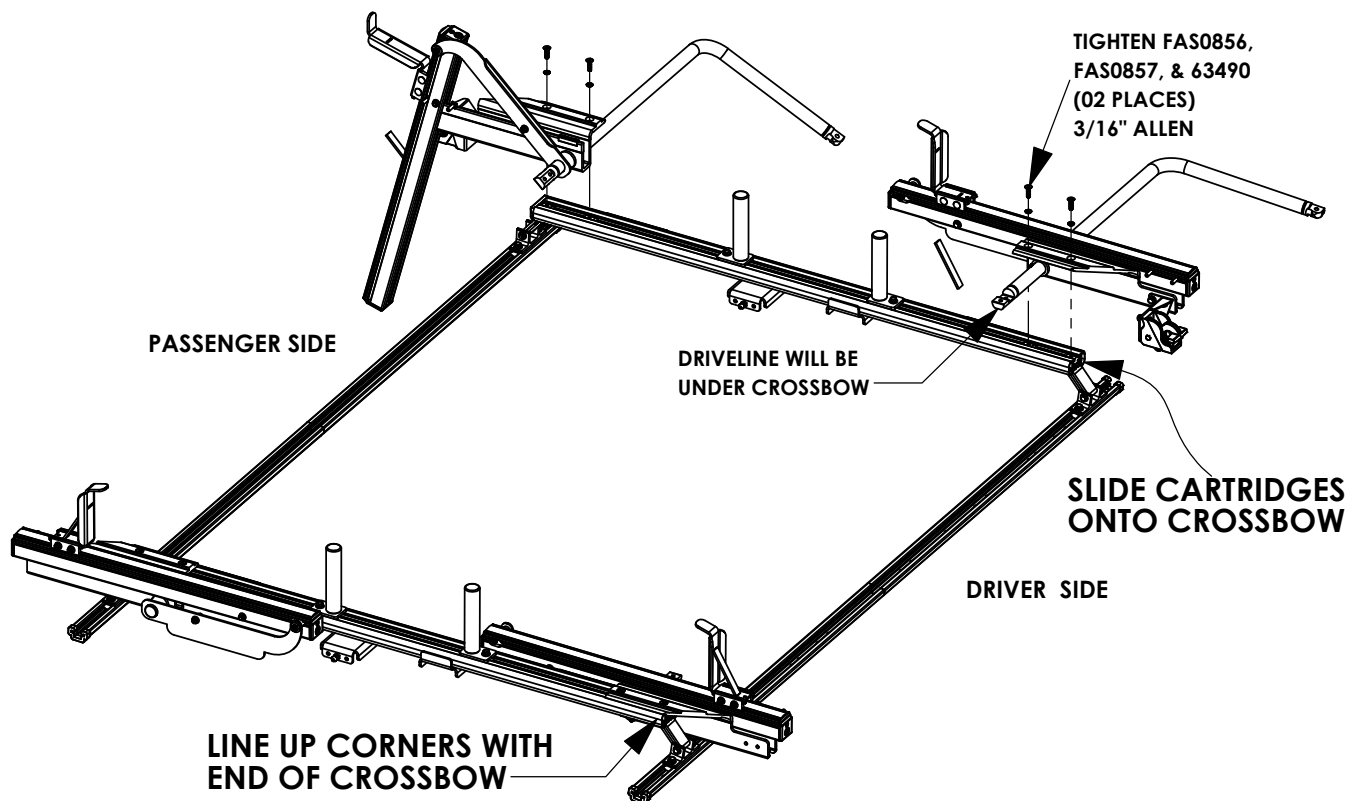

STEP 4 - INSTALL CROSSBOW END CAPS

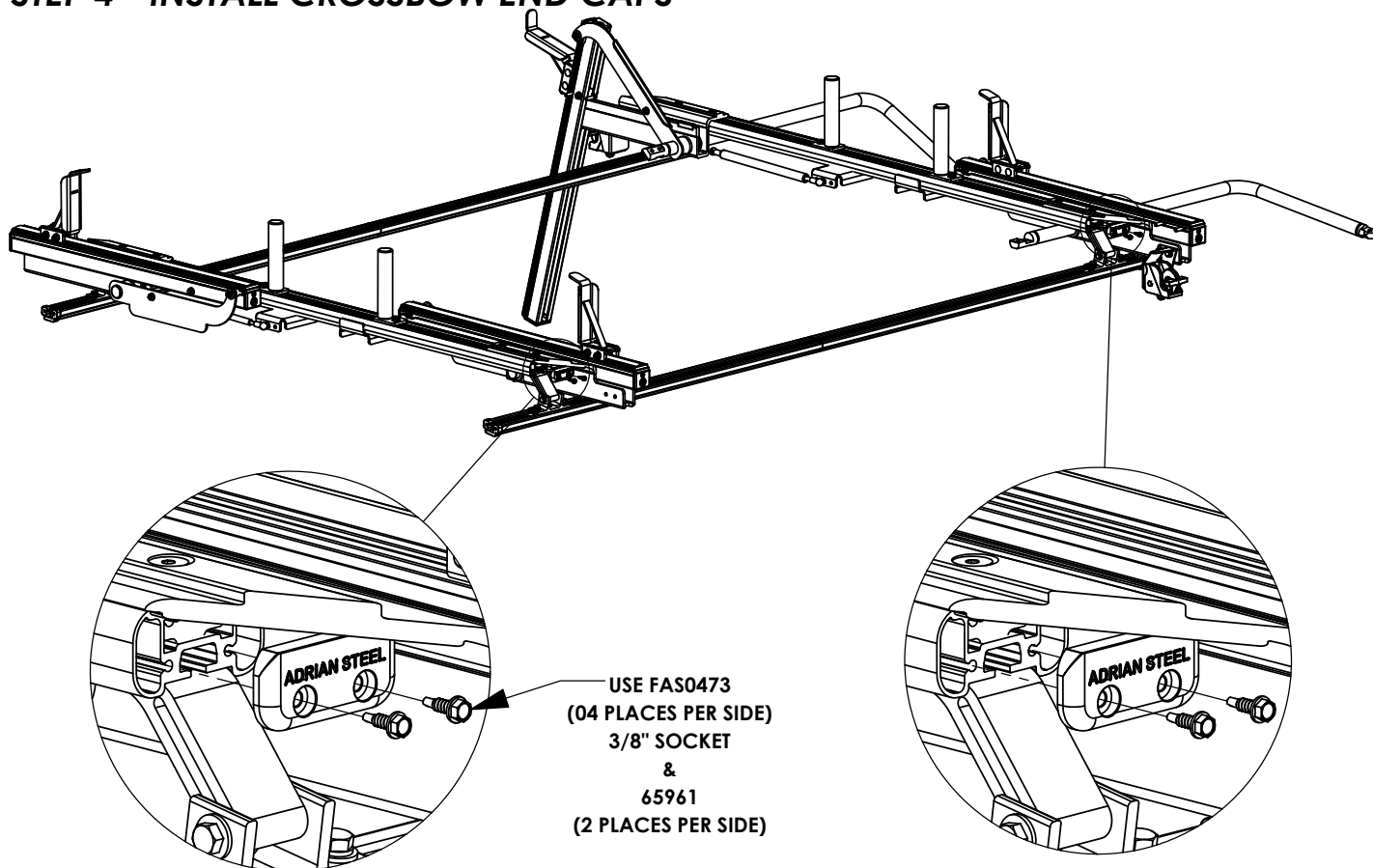

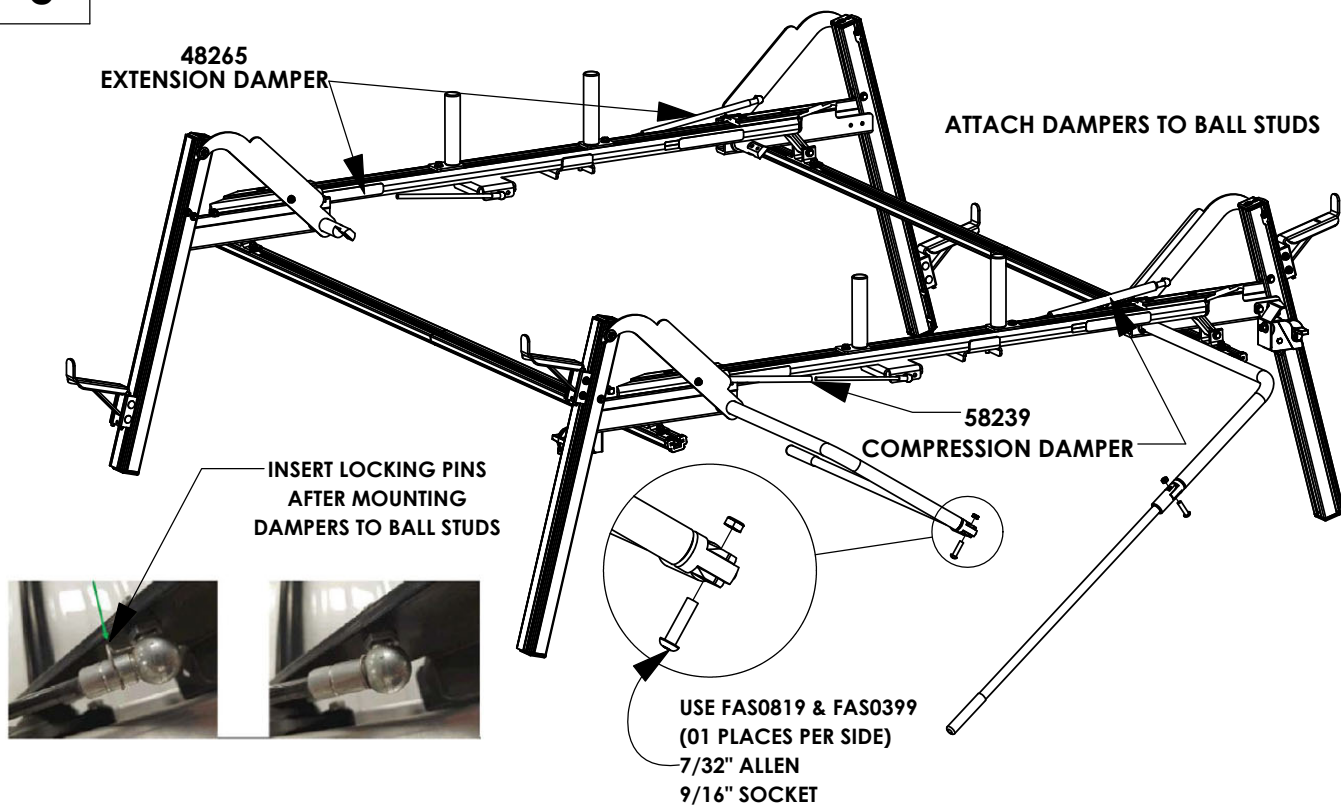
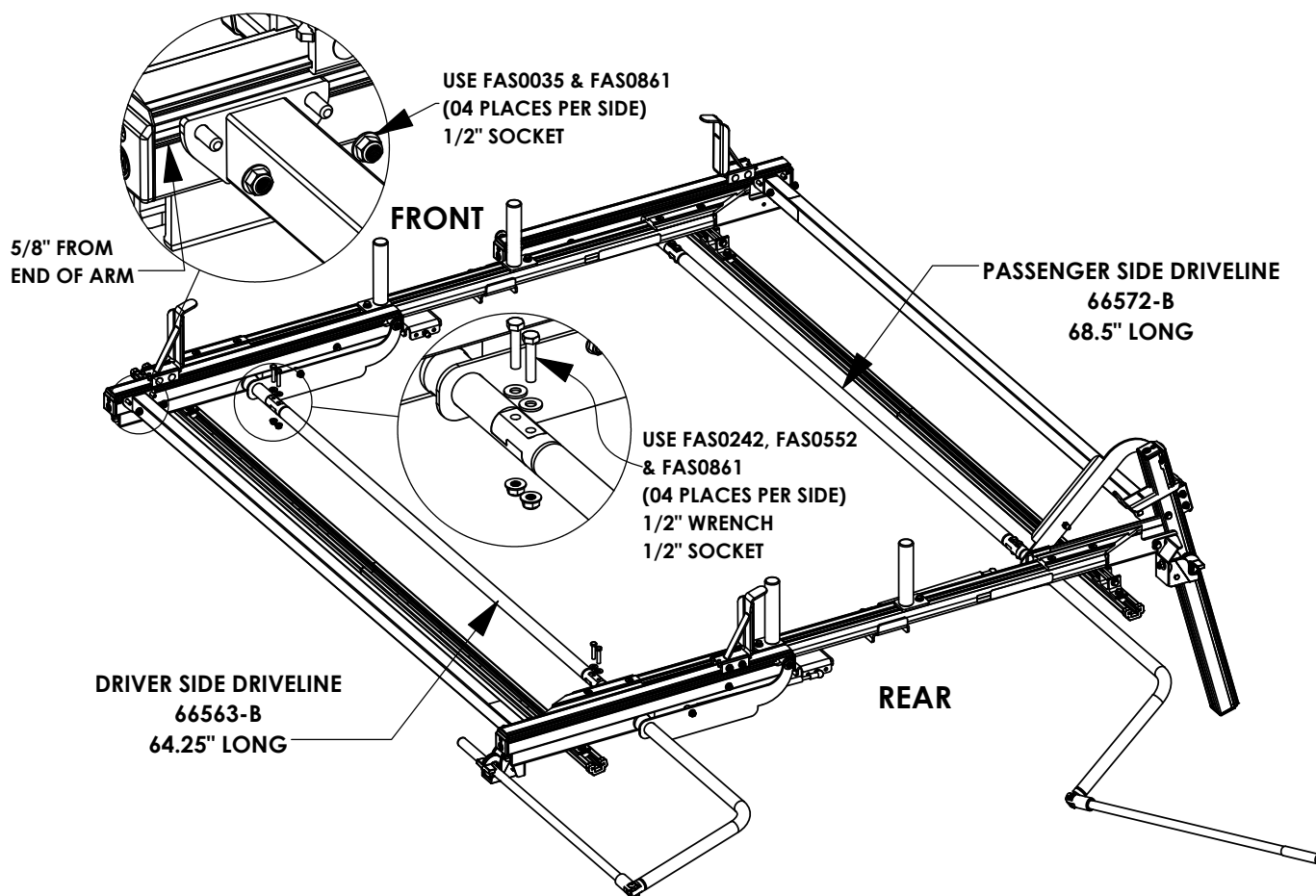
STEP 5 - INSTALL DAMPERS AND DROP DOWN HANDLE**STEP 6 - INSTALL DRIVELINE AND O.S. BAR**

Mounting Roof Rail Kit, Transit



PRODUCT WEIGHT
7.2 LBS

HEIGHT OFF ROOF
SEE TABLE BELOW

CAPACITY
**REFER TO OEM'S
RECOMMENDED LOAD
RATING**
COLOR

RAW

CATALOG NUMBER

RRKFT

PRODUCT FEATURES

Ford Transit aluminum mounting roof rail kit for the PROFILE™ HD Utility, Grip-Lock, ProLift, and combo ladder racks. Mounting kit works on all roof height and wheelbase combinations for Ford Transit vans.

Utility and Grip-Lock racks are not recommended for medium or high roof vehicles!

SEE PAGES 2 & 3 FOR APPLICATION NOTES AND ACCESSORIES, OTHER PRODUCTS THAT WORK WITH THIS UNIT.



CATALOG NUMBER **RRKFT**

PRODUCT APPLICATION

This product is designed to be installed Ford Transit vans. HD Utility and Grip-Lock racks are not recommended for medium or high roof vehicles!

ACCESSORIES THAT WILL WORK WITH THIS PRODUCT

| CATALOG NUMBER | DESCRIPTION | CATALOG NUMBER | DESCRIPTION |
|----------------------------|--|------------------------|--|
| White Kit Part Numbers | | Black Kit Part Numbers | |
| Crossbow Kits | | | |
| 2BARW | 2-Crossbar Kit, 68", White, Full Size Van | 2BARB | 2-Crossbar Kit, 68", Black, Full Size Van |
| 1BARW | 2-Crossbar Kit, 48", White, Full Size Van | 1BARB | 2-Crossbar Kit, 48", Black, Full Size Van |
| 2BARCW | 2-Crossbar Kit, 48", White, Minivan | 2BARCB | 2-Crossbar Kit, 48", Black, Minivan |
| 1BARCW | Single Crossbar Kit, 48", White, Minivan | 1BARCB | Single Crossbar Kit, 48", Black, Minivan |
| Mounting Bracket Kits | | | |
| URMBK4W | Mounting Bracket Kit, 4-Pack, White, Multiple Vehicles | URMBK4B | Mounting Bracket Kit, 4-Pack, Black, Multiple Vehicles |
| URMBK2W | Mounting Bracket Kit, 2-Pack, White, Multiple Vehicles | URMBK2B | Mounting Bracket Kit, 2-Pack, Black, Multiple Vehicles |
| Ladder Stop & Upright Kits | | | |
| ULSKB | Single Ladder Stop Kit, Black | ULSKAB | Single Ladder Stop Kit, Black |
| 4UPK4B | 4" Upright Kit, 4-Pack, Black | 4UPK4AB | 4" Upright Kit, 4-Pack, Black |
| 4UPK2B | 4" Upright Kit, 2-Pack, Black | 4UPK2AB | 4" Upright Kit, 2-Pack, Black |
| 6UPK4B | 6" Upright Kit, 4-Pack, Black | 6UPK4AB | 6" Upright Kit, 4-Pack, Black |
| 6UPK2B | 6" Upright Kit, 2-Pack, Black | 6UPK2AB | 6" Upright Kit, 2-Pack, Black |
| 9UPK4B | 9" Upright Kit, 4-Pack, Black | 9UPK4AB | 9" Upright Kit, 4-Pack, Black |
| 9UPK2B | 9" Upright Kit, 2-Pack, Black | 9UPK2AB | 9" Upright Kit, 2-Pack, Black |
| RSK1B | Single Ratchet Upright Kit, 9", Black | RSK1AB | Single Ratchet Upright Kit, 9", Black |

Continued on Page 3

PAGE 2 of 4

The information contained in this document is the sole property of ADRIAN STEEL COMPANY. ADRIAN STEEL COMPANY retains the right to modify and/or change the product of its design at any time without prior notification.



CATALOG NUMBER **RRKFT**

PRODUCT APPLICATION

This product is designed to be installed Ford Transit vans. HD Utility and Grip-Lock racks are not recommended for medium or high roof vehicles!

ACCESSORIES THAT WILL WORK WITH THIS PRODUCT

| CATALOG NUMBER | | DESCRIPTION | | CATALOG NUMBER | | DESCRIPTION | |
|----------------------------|---|-------------|--|------------------------|--|-------------|--|
| White Kit Part Numbers | | | | Black Kit Part Numbers | | | |
| Grip-Lock Kits | | | | | | | |
| GL-FSVDS | Driver Side Grip-Lock Kit, Full Size Van | | | GL-FSVDS-B | Driver Side Grip-Lock Kit, Full Size Van, Black | | |
| GL-FSVPS | Passenger Side Grip-Lock Kit, Full Size Van | | | GL-FSVPS-B | Passenger Side Grip-Lock Kit, Full Size Van, Black | | |
| Standard Drop ProLift Kits | | | | | | | |
| SDPLDS | Driver Side Standard Drop ProLift Kit, Full Size Van | | | SDPLDS-B | Driver Side Standard Drop Pro-Lift Kit, Full Size Van, Black | | |
| SDPLPS | Passenger Side Standard Drop ProLift Kit, Full Size Van | | | SDPLPS-B | Passenger Side Standard Drop ProLift Kit, Full Size Van, Black | | |
| Max Drop ProLift Kits | | | | | | | |
| DDPLDS | Driver Side Max Drop ProLift Kit, Full Size Van | | | DDPLDS-B | Driver Side Max Drop ProLift Kit, Full Size Van, Black | | |
| DDPLPS | Passenger Side Max Drop ProLift Kit, Full Size Van | | | DDPLPS-B | Passenger Side Max Drop Pro-Lift Kit, Full Size Van, Black | | |
| DDPLDSM | Driver Side Max Drop ProLift Kit, Full Size Van, Mid Roof | | | DDPLDSM-B | Driver Side Max Drop ProLift Kit, Full Size Van, Mid Roof, Black | | |
| DDPLPSM | Passenger Side Max Drop ProLift Kit, Full Size Van, Mid Roof | | | DDPLPSM-B | Passenger Side Max Drop ProLift Kit, Full Size Van, Mid Roof, Black | | |
| DDPLDSH | Driver Side Max Drop ProLift Kit, Full Size Van, High Roof | | | DDPLDSH-B | Driver Side Max Drop ProLift Kit, Full Size Van, High Roof, Black | | |
| DDPLPSH | Passenger Side Max Drop ProLift Kit, Full Size Van, High Roof | | | DDPLPSH-B | Passenger Side Max Drop ProLift Kit, Full Size Van, High Roof, Black | | |
| Double Stack ProLift Kits | | | | | | | |
| DSPLDS | Driver Side Double Stack ProLift Kit, Full Size Van | | | DSPLDS-B | Driver Side Double Stack ProLift Kit, Full Size Van, Black | | |
| DSPLPS | Passenger Side Double Stack ProLift Kit, Full Size Van | | | DSPLPS-B | Passenger Side Double Stack ProLift Kit, Full Size Van, Black | | |



CATALOG NUMBER RRKFT

PRODUCT APPLICATION

This product is designed to be installed Ford Transit vans. HD Utility and Grip-Lock racks are not recommended for medium or high roof vehicles!

LADDER RACK HEIGHTS MEASURED FROM ROOF OF VEHICLE

| CONFIGURATION | RACK HEIGHT |
|---------------------------------|-----------------------|
| | LOW / MED / HIGH ROOF |
| Base Rack | 5.5" / 4.6" / 4.6" |
| Base + Ladder Stop | 11.0" / 10.1" / 10.1" |
| Base + 4" Uprights | 9.0" / 8.1" / 8.1" |
| Base + 6" Uprights | 11.0" / 10.1" / 10.1" |
| Base + 9"/Ratchet Uprights | 14.0" / 13.1" / 13.1" |
| Base + 4" PVC Conduit Kit | 9.9" / 9.0" / 9.0" |
| Base + 6" PVC Conduit Kit | 11.9" / 11.0" / 11.0" |
| Base + Aluminum Box Conduit Kit | 12.0" / 11.2" / 11.2" |
| Base + Grip-Lock | 12.2" / (N/A) / (N/A) |
| Base + Standard Drop ProLift | 12.5" / (N/A) / (N/A) |
| Base + Max Drop ProLift | 14.0" / 13.1" / 13.1" |
| Base + Double Stack ProLift | Coming Soon! |

| | | | | | | |
|--|--------------|---------------|----------|-------------|--------------------------------|------|
| INSTR. NUMBER : 67267 | PG: 1 | REV: E | ITEM NO. | PART NUMBER | DESCRIPTION | QTY. |
| PART NUMBER : RRKFT | | | 1 | 63477 | ROOF RAIL, FORD TRNST FSV | 4 |
| PART : DESC. : ROOF RAIL KIT FT FSV | | | 2 | 52709 | SPACER-PAD .25 TRANSIT LR LDRK | 6 |

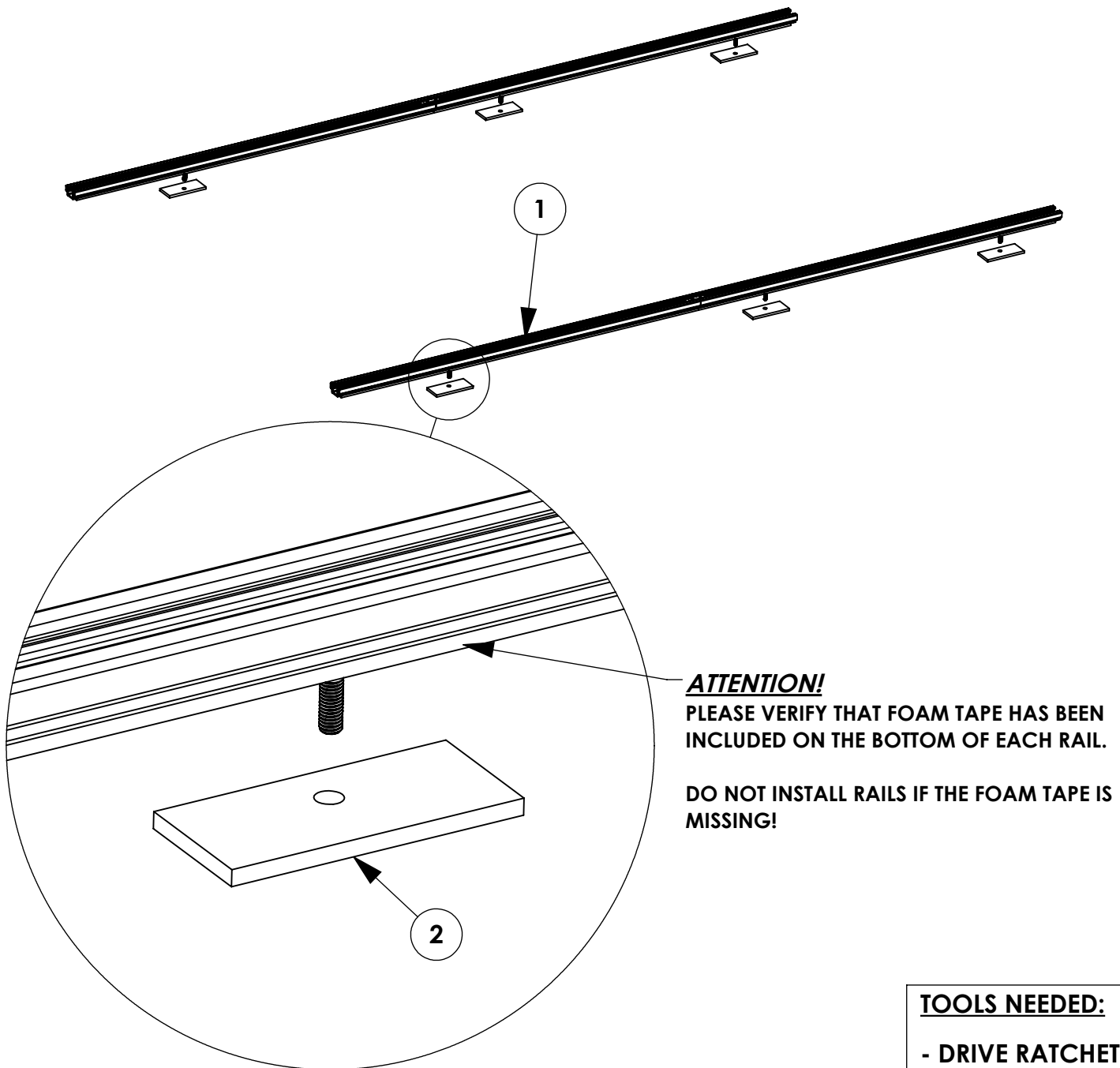

- TOOLS NEEDED:**
- DRIVE RATCHET
 - IMPACT DRIVER
 - 13mm SOCKET
 - 5/32" HEX DRIVE
 - M8-1.25 TAP
 - TAPE MEASURE

GET TO KNOW THE VEHICLE - AT THE BEGINNING OF ANY INSTALLATION, CHECK THE LOCATION OF THE FUEL TANK, FUEL LINES, BRAKE LINES, HIGH VOLTAGE BATTERIES AND WIRING HARNESSSES TO AVOID INJURY OR PROPERTY DAMAGE FROM TOOL CONTACT.

SEAL ALL EXTERIOR HOLES - ALL INSTALLATION HOLES SHOULD BE SEALED WITH BUTYL TAPE OR SILICON TO PREVENT WATER AND EXHAUST GASES FROM ENTERING THE VEHICLE.

CONTROL DRILL DEPTH - TO AVOID DAMAGE TO THE VEHICLE, USE A DRILL STOP OR CLEARED STEP BIT WHEN DRILLING INSTALLATION HOLES.

ALWAYS ADD PRIMER - WHEN ADDING INSTALLATION HOLES BE SURE TO USE A SELF-ETCHING PRIMER TO PREVENT CORROSION, FASTENER FAILURE AND INJURY.

MOUNTING POINTS MUST HAVE METAL-TO-METAL CONTACT - USE PROVIDED MOUNTING SPACERS TO ACCOMMODATE FOR VEHICLE FEATURES, CARPET OR SUBFLOORS.

PROVIDE CLEARANCE FOR SPACERS - IF THE INSTALLATION VEHICLE CONTAINS A CARPET OR SUBFLOOR, USE A 1-3/16" DIAMETER CARPET CUTTER (P/N: 31183-0) AT ALL MOUNTING LOCATIONS TO OPEN UP ROOM FOR SPACERS.

CHECK SPACER ORIENTATION - BE SURE THAT THE INDENT IN THE SPACER COVERS THE PLUSNUT HEAD; THIS ENSURES THE MOST METAL-TO-METAL CONTACT AND REDUCES VIBRATION.

PLUSNUT INSTALLATION - A PLUSNUT GUN IS RECOMMENDED FOR PLUSNUT INSTALLATION FOR ITS PRODUCTION SPEED. HOWEVER, A PLUSNUT SETTING TOOL CAN ALSO BE USED (P/N: 22200-0).

THRU-BOLT CLEARANCE - WHEN USING A THRU-BOLT AT ANY MOUNTING LOCATION, BE SURE THAT YOUR HOLE HAS 1/16" CLEARANCE.

FASTENERS AND HARDWARE USED

BAG REFERENCE: BAGRRKFTM & BAG63411

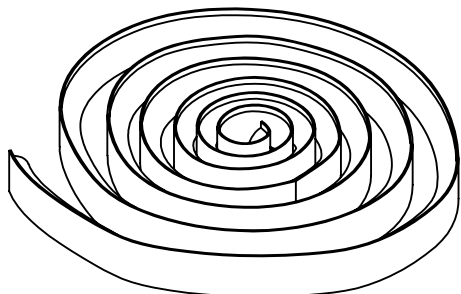

05586-0
BUTYL TAPE
1FT ROLL
QTY: 1

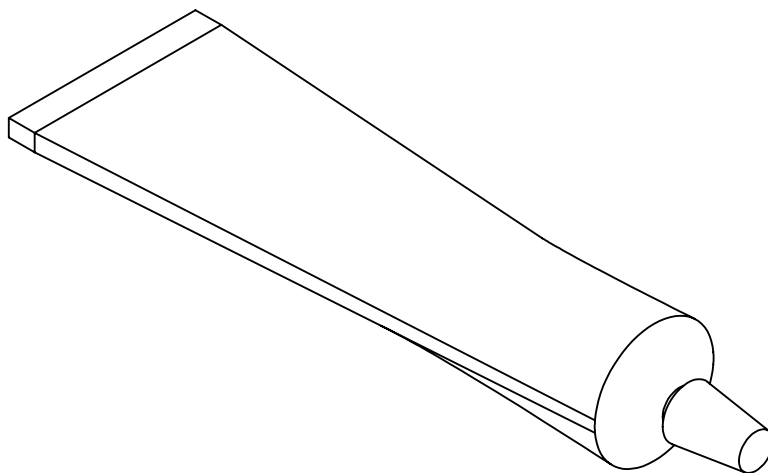

26618-0
SILICONE
1OZ TUBE
QTY: 1

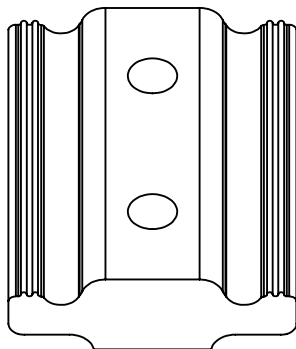

63491
RAIL CONNECTOR, 2"
QTY: 2

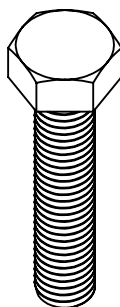

FAS0351
SCREW, HH SS
M8-1.25X40
QTY: 6

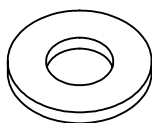

FAS0552
WASHER, FLAT
5/16 SS
QTY: 6



FAS0497
SCREW, SET
5/16-18X.75 SS
QTY: 4

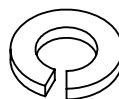

FAS0588
WASHER, LCK
SPLIT 5/16 SS
QTY: 6

PAGE INTENTIONALLY LEFT BLANK

STEP 1 - ASSEMBLE ROOF RAILS

STEP 1.1
FULLY TIGHTEN
63491, (02) FAS0497
(02 PLACES)
5/32" HEX DRIVE

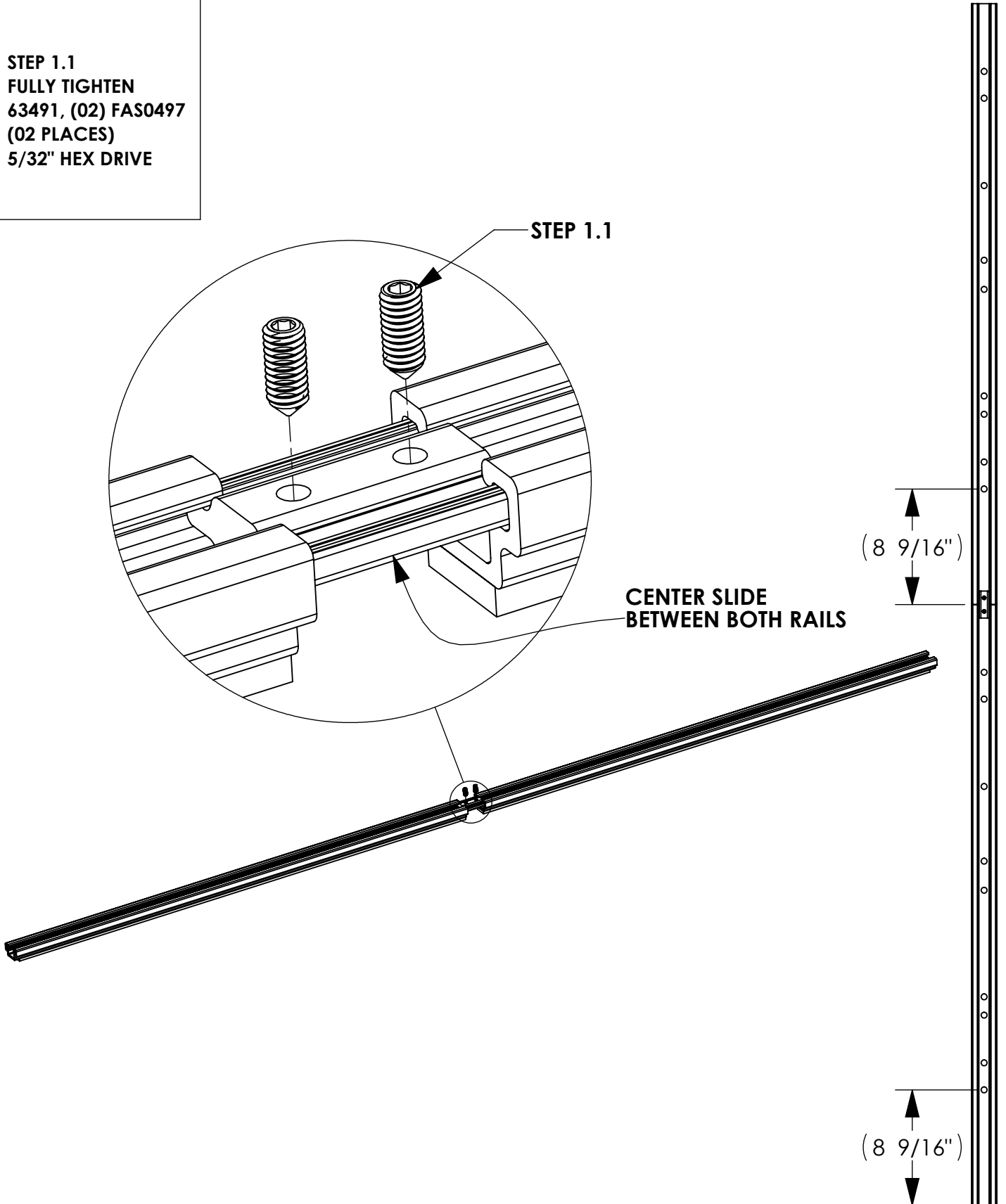
STEP 1.1**CENTER SLIDE
BETWEEN BOTH RAILS** $(8 \frac{9}{16}')$ $(8 \frac{9}{16}')$ 

STEP 2 - INSTALL ROOF RAILS ONTO VEHICLE ROOF**STEP 2.1
REMOVE OEM
PLASTIC PLUG**

USE M8-1.25 TAP
TO CLEAR THREAD
OF OEM WELD NUT
(IF NECESSARY)

ROOF HOLE
CLEARANCING
MAY BE
NECESSARY DO TO
OEM ROOF
TOLERANCE

STEP 2.2
FULLY TIGHTEN
FAS0351, FAS0552,
FAS0588
(06 PLACES)
13mm SOCKET

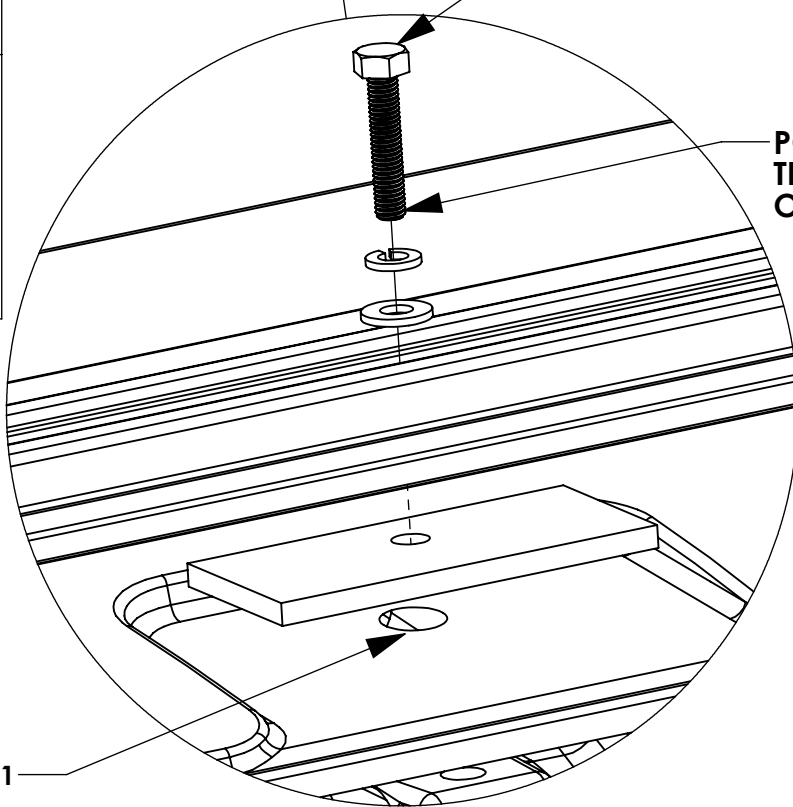
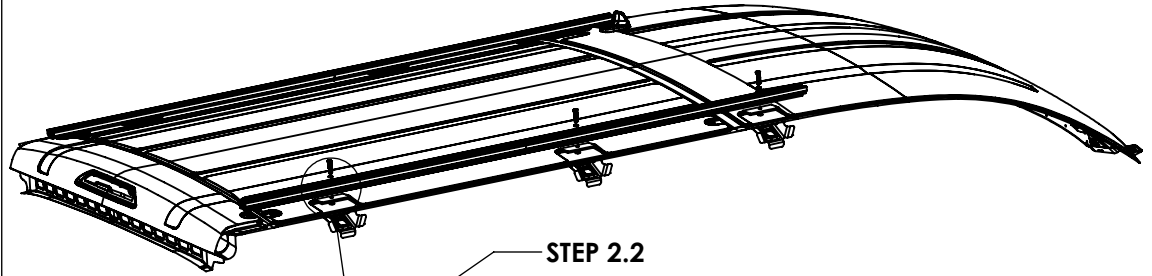

**POKE FASTENER
THROUGH FOAM TAPE
ON RAIL**

**ADD SILICONE TO FILL CAVITY OF EACH OEM WELD NUT IN
VEHICLE ROOF AND BUTYL TAPE UNDER WASHERS ON BOLT**



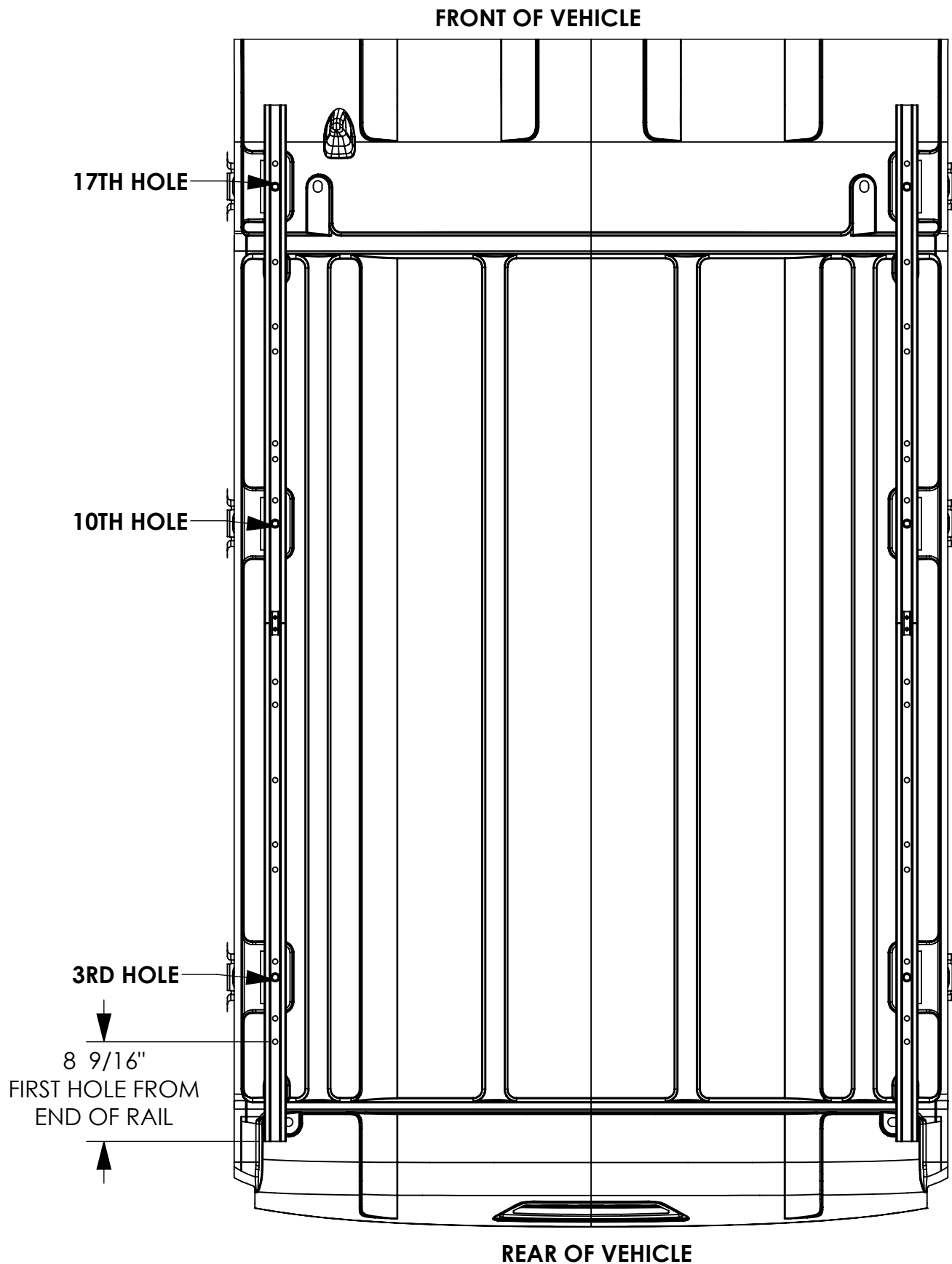

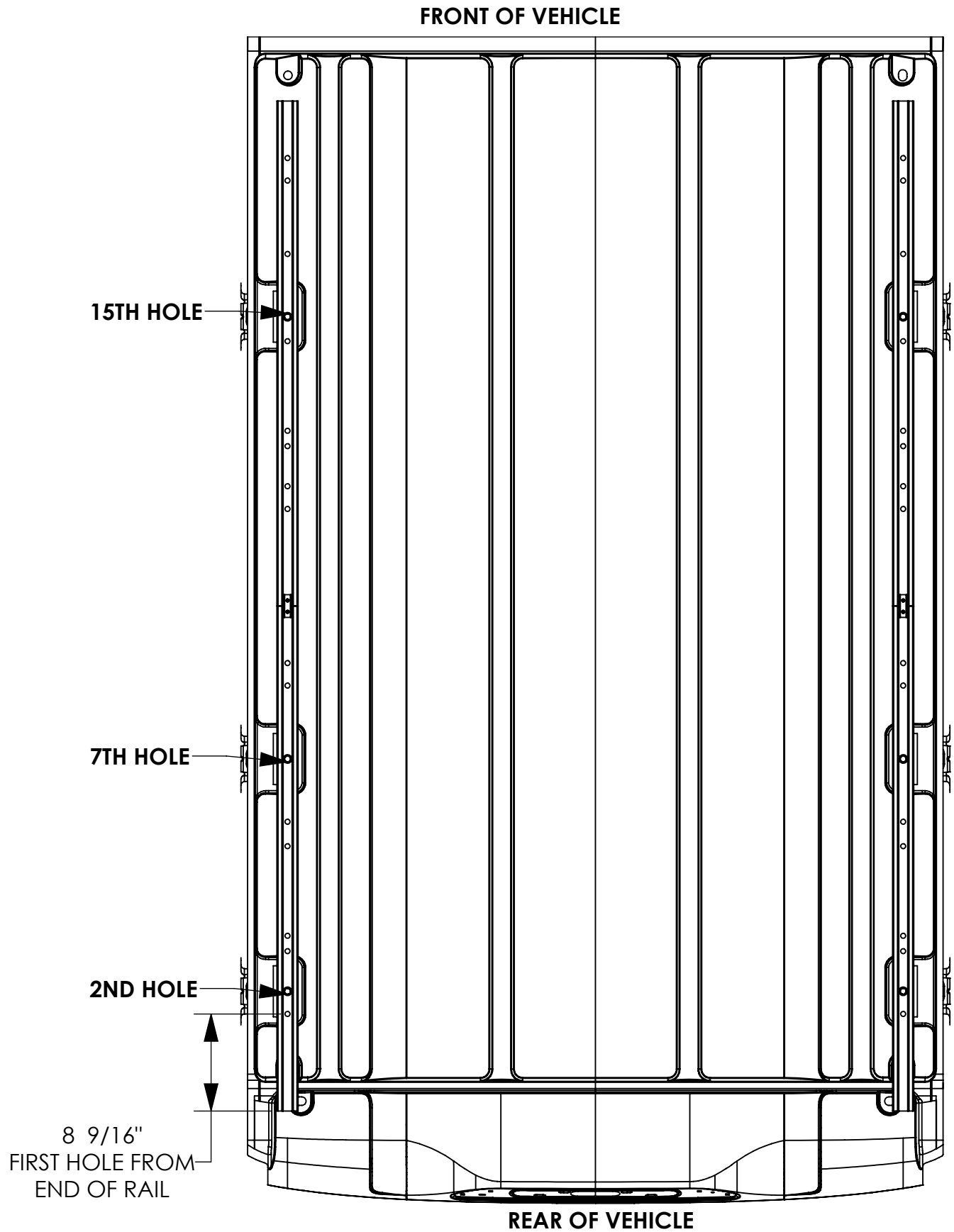
ROOF RAIL INSTALL LOCATION - 148" WHEELBASE

FRONT OF VEHICLE

13TH HOLE

9TH HOLE

5TH HOLE

8 9/16"
FIRST HOLE FROM
END OF RAIL

REAR OF VEHICLE

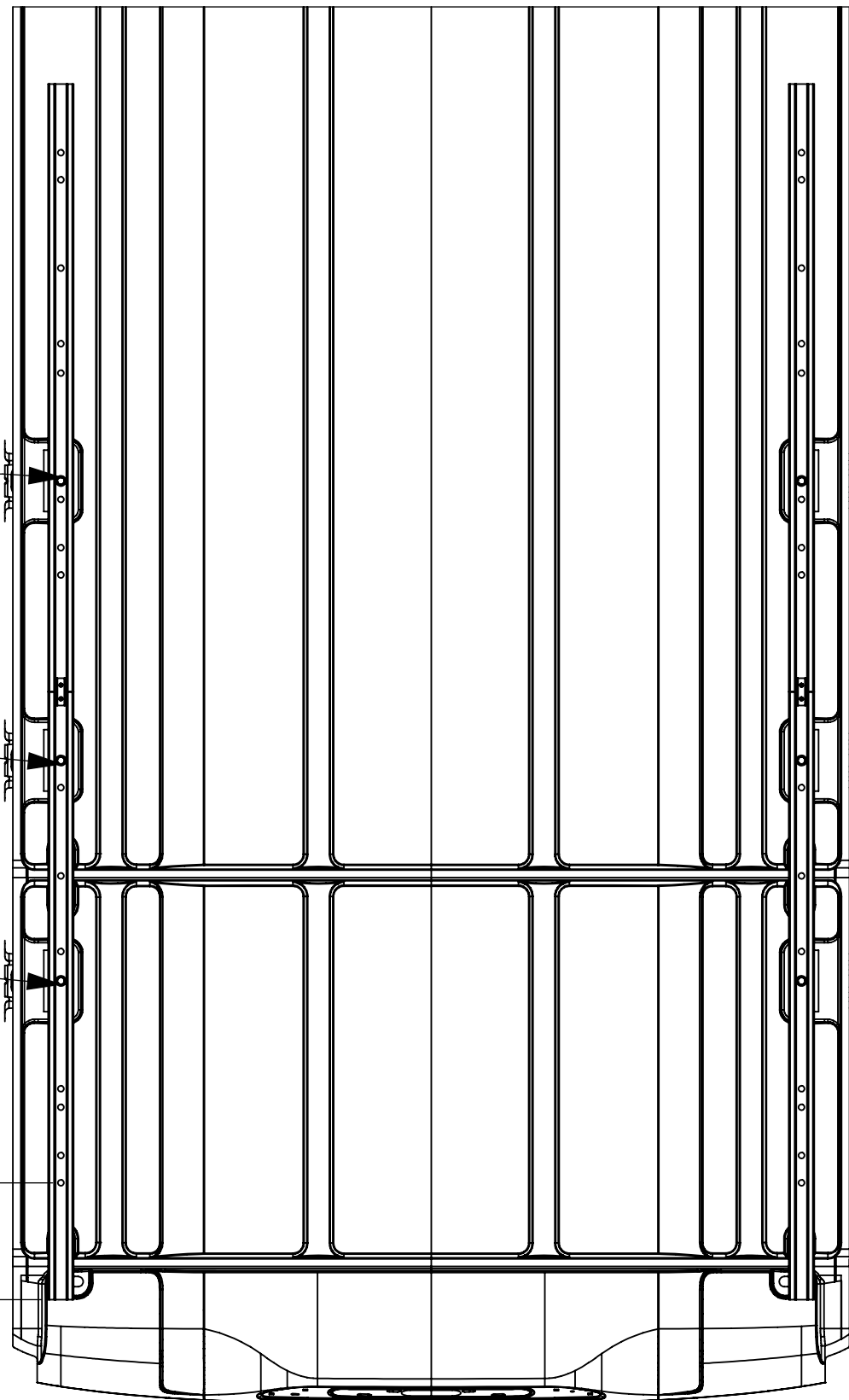



Mounting Bracket Kit, 4-Pack, White, Multiple Pickups

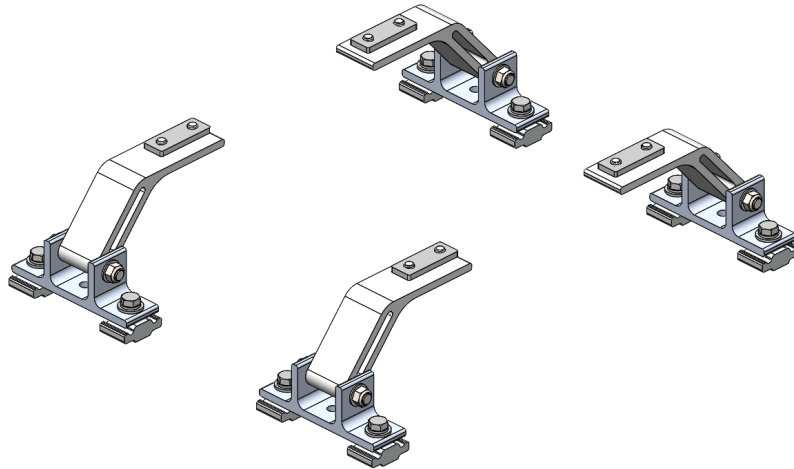

PRODUCT WEIGHT
4.0 LBS

HEIGHT OFF ROOF
SEE TABLE BELOW

CAPACITY
**REFER TO OEM'S
RECOMMENDED LOAD
RATING**
COLOR

WHITE

CATALOG NUMBER

URMBK4W

PRODUCT FEATURES

Aluminum mounting bracket kit for the PROFILE™ HD Utility, Grip-Lock, and/or ProLift ladder racks. Only works with the OEM specific, Adrian Steel supplied roof rail kit.

Utility and Grip-Lock racks are not recommended for medium or high roof vehicles!

Reference respective OEM specific roof rail kit for more detailed list of compatible accessories.

SEE PAGE 2 FOR APPLICATION NOTES AND ACCESSORIES, OTHER PRODUCTS THAT WORK WITH THIS UNIT.

PAGE 1 of 2

The information contained in this document is the sole property of ADRIAN STEEL COMPANY. ADRIAN STEEL COMPANY retains the right to modify and/or change the product of its design at any time without prior notification.



CATALOG NUMBER

URMBK4W

PRODUCT APPLICATION

This product is designed to work with OEM specific rail kit for HD Utility, Grip-Lock, and/or ProLift racks. HD Utility and Grip-Lock racks are not recommended for medium or high roof vehicles!

ACCESSORIES THAT WILL WORK WITH THIS PRODUCT

| CATALOG NUMBER | DESCRIPTION | CATALOG NUMBER | DESCRIPTION |
|----------------|--|----------------|---|
| RRKFT | Mounting Roof Rail Kit, Transit | RRKNVFSV | Mounting Roof Rail Kit, NV |
| RRKSP | Mounting Roof Rail Kit, Sprinter | RRKPM | Mounting Roof Rail Kit, ProMaster, 118" WB, 159" WB, 159" WB Extended |
| RRKPM136WB | Mounting Roof Rail Kit, ProMaster, 136" WB | RRKSBTOP | Mounting Roof Rail Kit, Multiple Pickups |
| RRKLBTOP | Mounting Roof Rail Kit, Multiple Pickups | | |

Reference respective OEM specific roof rail kit for more detailed list of compatible accessories.

| | | | | | | | |
|---|--------------|---------------|-----------------|--------------------|---------------------------|----------------|----------------|
| INSTR. NUMBER : 66850 PART NUMBER : URGBK PART • DESC. • UTILITY,MNT BKT KT,RAIL | PG: 1 | REV: E | ITEM NO. | PART NUMBER | DESCRIPTION | URMBK4W | URMBK2W |
| | | | 1 | 65123-W | UTILITY,FT MOUNT ARM,ST,W | 4 | 2 |
| | | | 2 | 63852-W | UTILITY, MOUNTING BRKT, W | 4 | 2 |

-PART NUMBERS WITH "-W" SUFFIX ARE PAINTED WHITE
-FOR BLACK MOUNTING KITS, REPLACE "-W" PARTS WITH "-B" PARTS

NOTE: THIS INSTRUCTION IS VALID FOR THE FOLLOWING KITS:

- URMBK4W
- URMBK4B
- URMBK2W
- URMBK2B

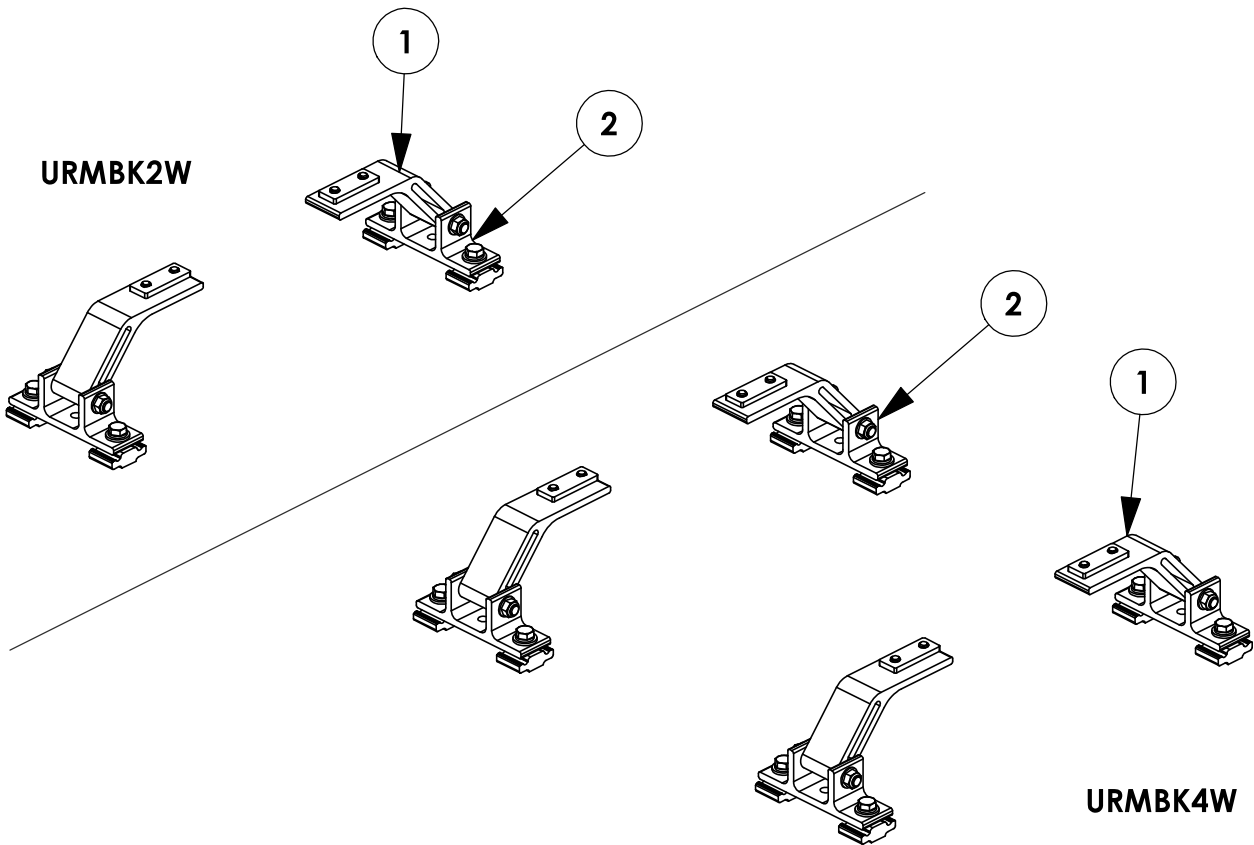

TOOLS NEEDED:

- DRIVE RATCHET
- IMPACT DRIVER
- 3/16" SOCKET
- 1/2" SOCKET
- 1/2" WRENCH
- TAPE MEASURE

GET TO KNOW THE VEHICLE - AT THE BEGINNING OF ANY INSTALLATION, CHECK THE LOCATION OF THE FUEL TANK, FUEL LINES, BRAKE LINES, HIGH VOLTAGE BATTERIES AND WIRING HARNESSSES TO AVOID INJURY OR PROPERTY DAMAGE FROM TOOL CONTACT.

SEAL ALL EXTERIOR HOLES - ALL INSTALLATION HOLES SHOULD BE SEALED WITH BUTYL TAPE OR SILICON TO PREVENT WATER AND EXHAUST GASES FROM ENTERING THE VEHICLE.

CONTROL DRILL DEPTH - TO AVOID DAMAGE TO THE VEHICLE, USE A DRILL STOP OR CLEARED STEP BIT WHEN DRILLING INSTALLATION HOLES.

ALWAYS ADD PRIMER - WHEN ADDING INSTALLATION HOLES BE SURE TO USE A SELF-ETCHING PRIMER TO PREVENT CORROSION, FASTENER FAILURE AND INJURY.

MOUNTING POINTS MUST HAVE METAL-TO-METAL CONTACT - USE PROVIDED MOUNTING SPACERS TO ACCOMMODATE FOR VEHICLE FEATURES, CARPET OR SUBFLOORS.

PROVIDE CLEARANCE FOR SPACERS - IF THE INSTALLATION VEHICLE CONTAINS A CARPET OR SUBFLOOR, USE A 1-3/16" DIAMETER CARPET CUTTER (P/N: 31183-0) AT ALL MOUNTING LOCATIONS TO OPEN UP ROOM FOR SPACERS.

CHECK SPACER ORIENTATION - BE SURE THAT THE INDENT IN THE SPACER COVERS THE PLUSNUT HEAD; THIS ENSURES THE MOST METAL-TO-METAL CONTACT AND REDUCES VIBRATION.

PLUSNUT INSTALLATION - A PLUSNUT GUN IS RECOMMENDED FOR PLUSNUT INSTALLATION FOR ITS PRODUCTION SPEED. HOWEVER, A PLUSNUT SETTING TOOL CAN ALSO BE USED (P/N: 22200-0).

THRU-BOLT CLEARANCE - WHEN USING A THRU-BOLT AT ANY MOUNTING LOCATION, BE SURE THAT YOUR HOLE HAS 1/16" CLEARANCE.

PAGE:

3

FASTENERS AND HARDWARE USED

BAG REFERENCE: BAG66848

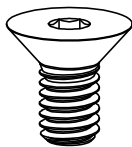

FAS0858
5/16-18X.63
FHH SCREW
QTY: 8

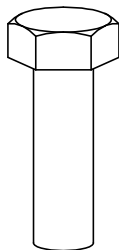

FAS0597
5/16-18X1.0 SS
HH SCREW
QTY: 8

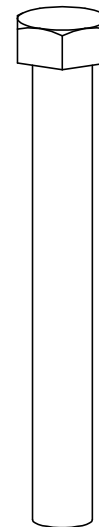

FAS0243
5/16-18X2.5 SS
HH SCREW
QTY: 4



FAS0857
5/16 SS WASHER,
LOCK EXT CS
QTY: 8



FAS0588
5/16 SS
SPLIT WASHER
QTY: 8



FAS0552
5/16 SS
FLAT WASHER
QTY: 12



FAS0861
5/16-18 SS
HH FLG NUT
QTY: 4

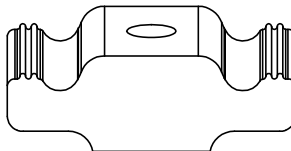

63490
RAIL SLIDE,
1"
QTY: 8

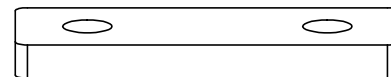

68042
PROFILE FOOT
MOUNTING PLATE
QTY: 4

PAGE INTENTIONALLY LEFT BLANK

STEP 1 - ASSEMBLE MOUNTING ARMS TO CROSSBOW

CHECK TABLE 1-3 IN INSTRUCTION 68895 FOR ADDITIONAL ACCESSORY SLIDE INSTALLATION BEFORE INSTALLING MOUNTING BRACKETS (ALL A.2 ITEMS SHOULD BE COMPLETELY ASSEMBLED FIRST!)

STEP 1.1

**LOOSELY ASSEMBLE
UNTIL AFTER STEP 3**

(2) FAS0857, (2)
FAS0858, 68042

(02 PLACES PER
CROSSBOW)
3/16" ALLEN

ATTENTION!

IF INSTALLING A GRIP-LOCK ON A PICKUP TRUCK TOPPER, ASSEMBLE MOUNTING ARMS FACING OUTWARD FOR THAT SIDE OF THE RACK

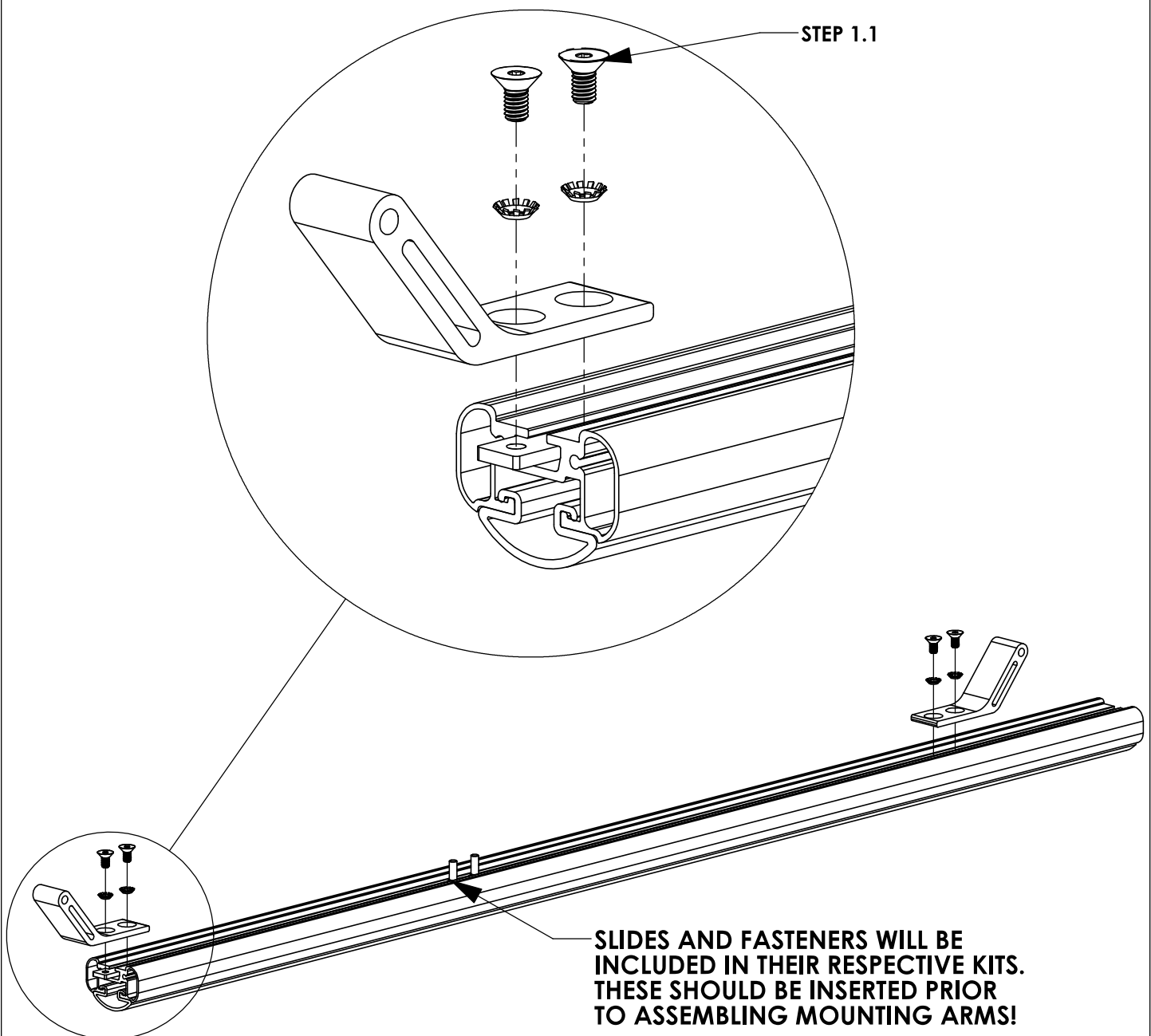

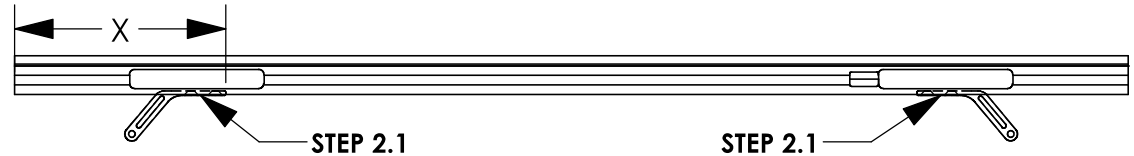
STEP 2 - SECURE CROSSBOW**STEP 2.1
FULLY TIGHTEN
FROM STEP 1.1****(04 PLACES PER
CROSSBOW)
3/16" ALLEN****FULL SIZE VANS****CENTER CROSSBOW ON MOUNTING BRACKETS****VEHICLE PLATFORM****DIMENSION "X" (in.) -
58" CROSSBOW****DIMENSION "X" (in.) -
68" CROSSBOW****FORD TRANSIT**

6 5/8"

11 5/8"

RAM PROMASTER

6"

11"

NISSAN NV

4 7/8"

9 7/8"

**MERCEDES SPRINTER
(LOW ROOF)**

4 5/8"

9 5/8"

**MERCEDES SPRINTER
(HIGH ROOF)**

8 1/8"

13 1/8"

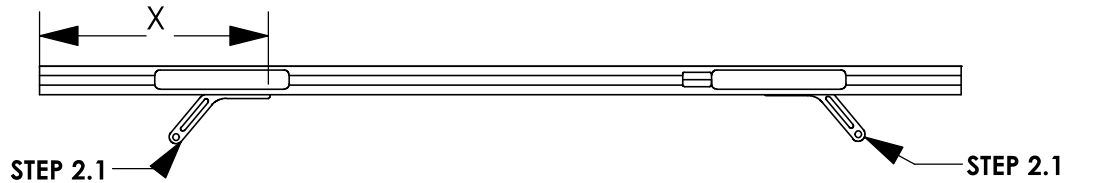
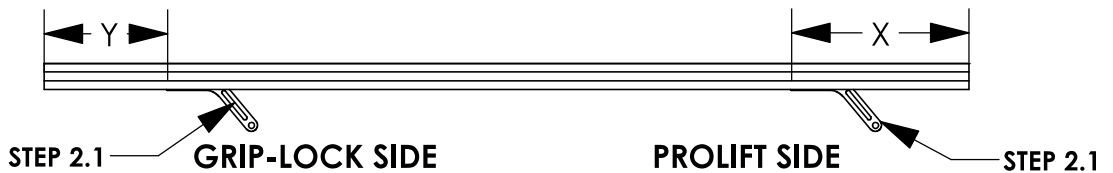
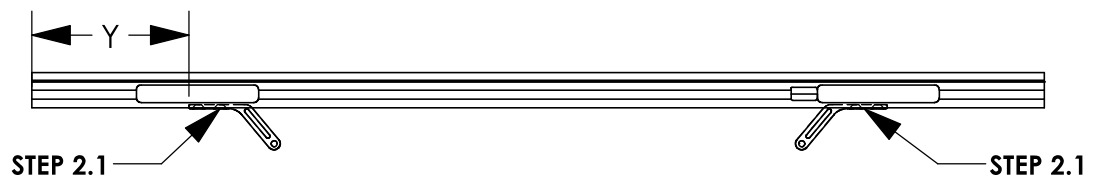
**DIMENSION WILL
VARY BASED ON
ROOF RAIL
PLACEMENT ON
TOPPER****PICKUP TRUCK TOPPERS****FEET ORIENTATION FOR DUAL PROLIFT SHOWN****FEET ORIENTATION FOR COMBO RACK SHOWN****FEET ORIENTATION FOR DUAL GRIP-LOCK SHOWN****MOUNTING FEET
FOR GRIP LOCK SIDE
OF COMBO RACK
WILL FACE
OUTWARD FROM
ROOF CENTERLINE
ON TOPPER****CROSSBOW LENGTH****DIMENSION "X" (in.)
- PROLIFT****DIMENSION "Y" (in.)
- GRIPLOCK****48" (PROLIFT)**

MINIMUM 10 1/8"

N/A

53" (COMBO)

MINIMUM 10 1/8"

MAX 7 1/8"

58" (GRIP-LOCK)

N/A

MAX 7 1/8"

**NOTE - THESE DIMENSIONS ARE APPROXIMATE AND WILL VARY
SLIGHTLY WITH ANY TOLERANCE IN THE BUILD OF THE VEHICLE**

STEP 3 - ASSEMBLE LOWER MOUNTING FOOT TO ROOF RAIL**STEP 3.1****FULLY TIGHTEN**

FAS0597, FAS0552,
FAS0588, 63490 ON
REAR MOUNTING FEET

(02 PLACES PER
MOUNTING FOOT)
1/2" SOCKET

STEP 3.2**LEAVE LOOSE UNTIL
AFTER STEP 4**

FAS0597, FAS0552,
FAS0588, 63490 ON
FRONT MOUNTING FEET

(02 PLACES PER
MOUNTING FOOT)
1/2" SOCKET

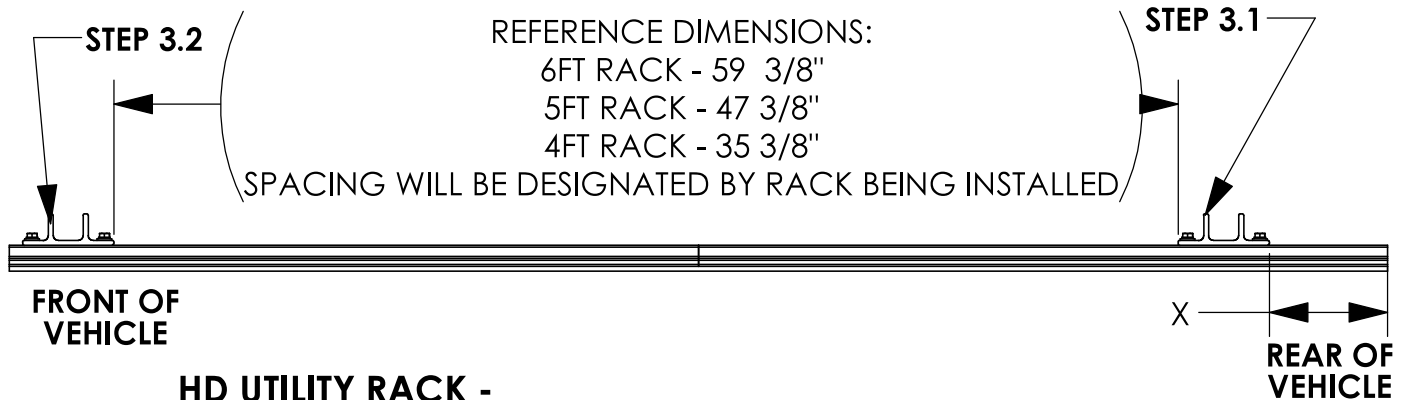
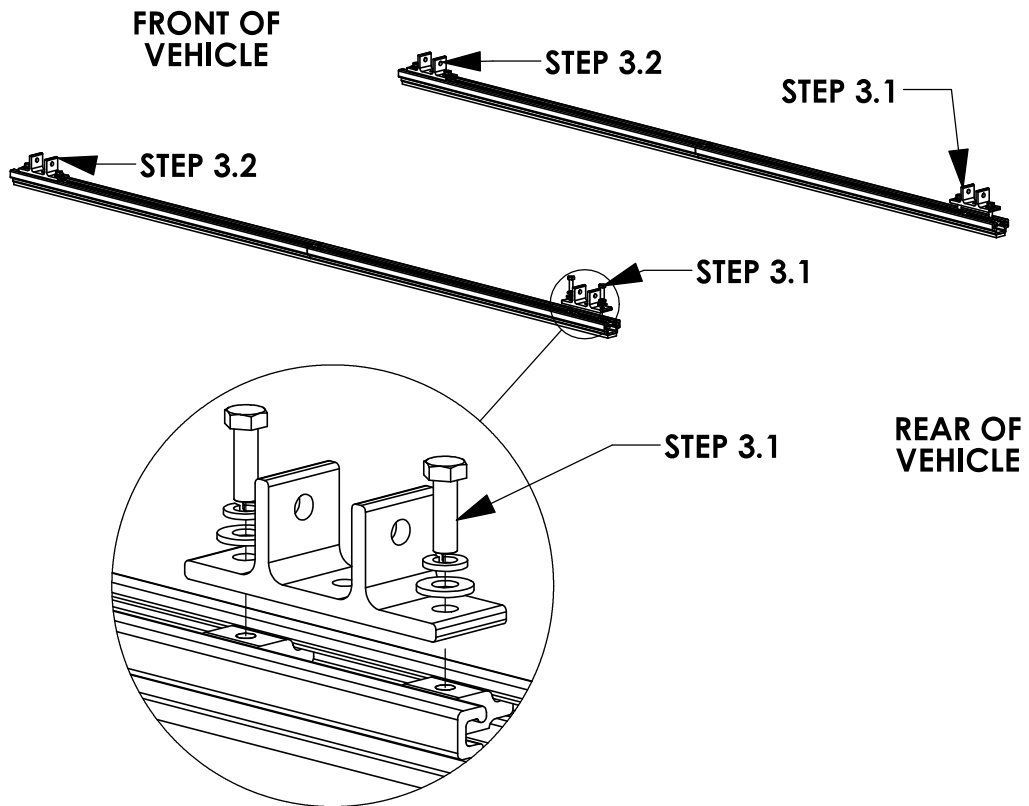
**HD UTILITY RACK -**

REAR CROSSBOW - REARWARD AS POSSIBLE

FRONT CROSSBOW- POSITION TO BEST FIT END USER'S PRODUCT

| FORD TRANSIT | | RAM PROMASTER | | MERCEDES SPRINTER | |
|---------------------------|--------------------|---------------------------|--------------------|---------------------------|--------------------|
| ROOF HEIGHT/ WHEELBASE | POSITION X (IN) | ROOF HEIGHT/ WHEELBASE | POSITION X (IN) | ROOF HEIGHT/ WHEELBASE | POSITION X (IN) |
| LOW ROOF | 7.5 | LR 118 | 10 | LR 144 | 10.5 |
| MID ROOF | 7.5 | LR 136 | 10 | HR 144 | 12.5 |
| HIGH ROOF | 7.5 | HR 136 | 10 | HR 170 | 12.5 |
| HIGH ROOF EXT | 7.5 | HR 159/159 EXT | 10 | HR 170 EXT | 12.5 |

STEP 4 - ASSEMBLE MOUNTING BRACKETS TO MOUNTING ARMS

BEFORE PROCEEDING WITH THIS STEP FINISH ASSEMBLING ACCESSORIES ONTO RACK. (IE GRIP LOCK, PROLIFT, ETC)

STEP 4.1**FULLY TIGHTEN**

FAS0243, FAS0552,
FAS0861

(02 PLACES PER
CROSSBOW)

1/2" SOCKET
1/2" WRENCH

STEP 4.2**FULLY TIGHTEN**

FAS0597, FAS0552,
FAS0588, 63490 ON
FRONT MOUNTING
FEET

(02 PLACES PER
MOUNTING FOOT)

1/2" SOCKET

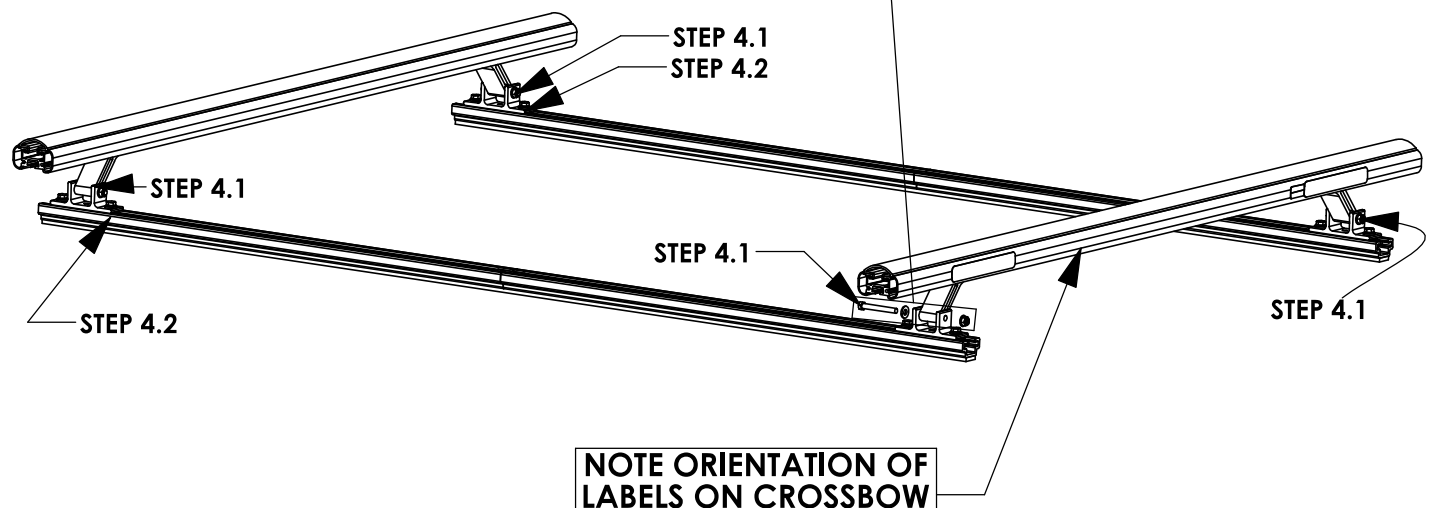
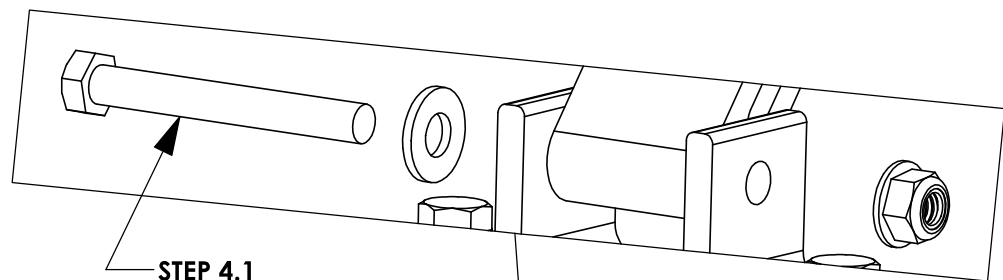

REFERENCE - NO ACCESSORIES SHOWN

STEP 5 - ADJUST MOUNTING BRACKET LOCATION IF NECESSARY

CROSSBOW POSITIONING NOTES:

HD UTILITY RACK -

REAR CROSSBOW - REARWARD AS POSSIBLE

FRONT CROSSBOW- POSITION TO BEST FIT END USER'S PRODUCT

GRIP LOCK/PROLIFT LADDER RACKS -

1/2" FROM END OF RAIL UNLESS OTHERWISE STATED IN RESPECTIVE INSTRUCTION FOR CROSSBOW PLACEMENT.

6' ARE TOPPER / 8' LEER TOPPER

A OPTIMAL RAIL KIT POSITION:
TOPPER ROOF RAIL KIT END TO BE
A-DIM FROM BLACK TOPPER TRIM

B UTILITY MOUNTING BRACKET:
REAR MOUNTING BRACKETS WILL
BE B-DIM FROM THE END OF THE
ROOF RAIL KIT

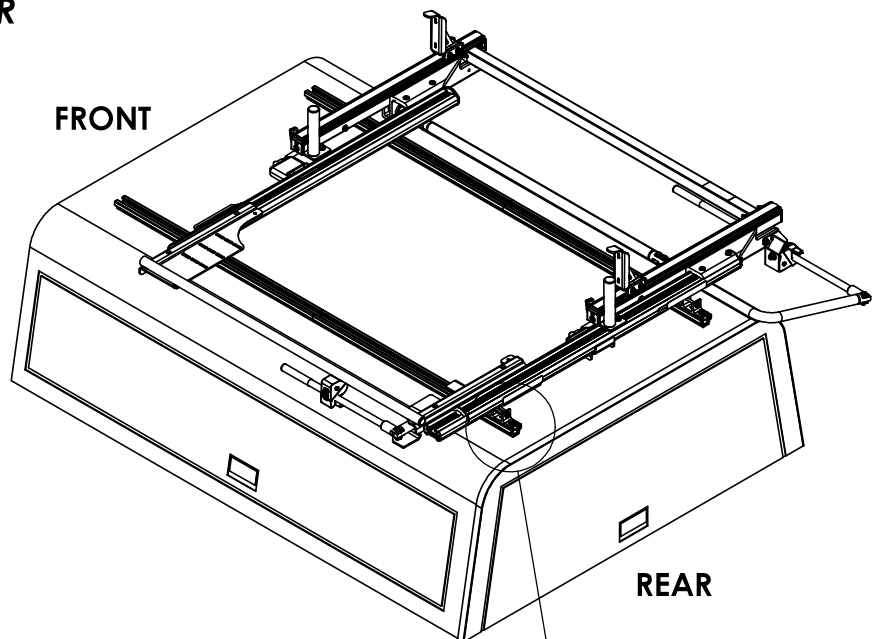

| TOPPER/ DIMENSION | 6' ARE TOPPER | 8' LEER TOPPER |
|----------------------|------------------|-------------------|
| A-DIM | 3.00" | 1.00" |
| B-DIM | 0.50" | 0.50" |

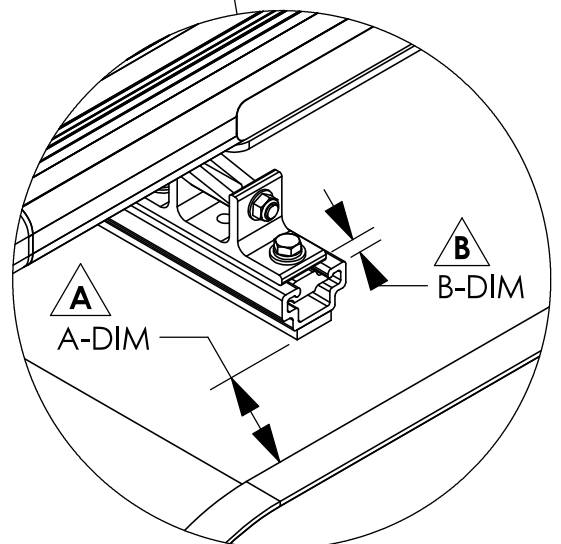

NOTE:

IF RAILS HAVE BEEN PREVOIUSLY INSTALLED, LOOSEN TOPPER RAIL BRACKET RAIL SLIDES AND ADJUST TO MEET DESIRED POSITIONING

INSTALLATION IS COMPLETE!! MAKE SURE ALL FASTENERS ARE TIGHTENED



2-Crossbar Kit, 58", White, Minivan



PRODUCT WEIGHT

16.1 LBS

CROSSBOW LENGTH X
HEIGHT

59" x 2"

CAPACITY

**REFER TO OEM'S
RECOMMENDED LOAD
RATING**

COLOR

WHITE

CATALOG NUMBER

2BARCW

PRODUCT FEATURES

Aluminum base 2-crossbow kit for PROFILE™ HD Utility, grip lock, drop down, or combo ladder racks. Works with all compact van platforms for each respective wheelbase and Ford Transit Ship Thru. Works with and without OEM specific rail kit and generic mounting bracket kits.

Optional uprights and conduit kits available.

Please refer to OEM specific mounting kit or rail kit for additional information on compatible accessories.

INSTALLATION GUIDE FOR PROFILE™ SERIES LADDER RACKS

INSTRUCTION #:
68895

REV:
C



THIS INSTRUCTION PROVIDES A GENERAL GUIDE OF INSTALLATION SEQUENCE FOR ALL PROFILE™ SERIES LADDER RACKS. PLEASE ENSURE ALL ACCESSORIES ARE INSTALLED PER TYPE OF RACK BEFORE PROCEEDING TO NEXT PAGE.

REFERENCE THIS INSTRUCTION THROUGHOUT THE ENTIRETY OF YOUR INSTALL TO PREVENT ACCESSORIES BEING INSTALLED INCORRECTLY/OUT OF SEQUENCE!

STEPS 2T - 8T ON PAGE 3 IS THE RECOMMENDED ASSEMBLY SEQUENCE FOR A FULL TABLE ASSEMBLY BEFORE INSTALLING ON THE ROOF OF THE VEHICLE.

STEPS 2R - 8R ON PAGE 4 IS AN ALTERNATE ASSEMBLY SEQUENCE TO INSTALL THE RACK ON THE VEHICLE ROOF AS IT IS BUILT.

PLEASE SELECT THE ASSEMBLY SEQUENCE THAT BEST WORKS FOR YOU!

ASSEMBLY STEPS:

STEP 1A. SUB-ASSEMBLE EACH CROSSBOW WITH DESIRED ACCESSORIES FOR SECTIONS A.1 & A.2.

INSTRUCTIONS FOR EACH KIT CAN BE FOUND IN THEIR RESPECTIVE CARTON!

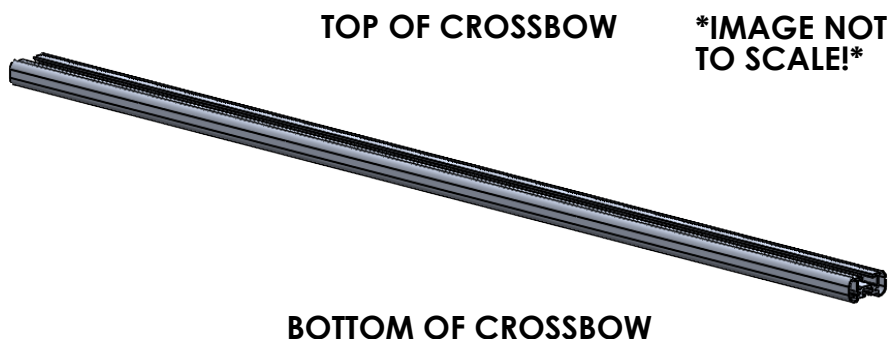

TABLE 1

TOP OF CROSSBOW

COMPONENTS TO INSTALL

| | | |
|-----|------------|-------------------------|
| A.1 | HD UTILITY | - CONDUIT KIT OR BEACON |
| | Grip-Lock | - CONDUIT KIT OR BEACON |
| | ProLift | - CONDUIT KIT OR BEACON |

BOTTOM OF CROSSBOW

COMPONENTS TO INSTALL

| | | |
|-----|------------|---|
| A.2 | HD UTILITY | - LADDER STOP, STROBE BRACKET, AND/OR REAR ROLLER |
| | Grip-Lock | - Grip-Lock SUB-ASSEMBLY |
| | ProLift | - DAMPER BRACKET |

STEP 1B. SUB-ASSEMBLE EACH CROSSBOW WITH DESIRED ACCESSORIES FOR SECTIONS B.1 & B.2.

INSTRUCTIONS FOR EACH KIT CAN BE FOUND IN THEIR RESPECTIVE CARTON!

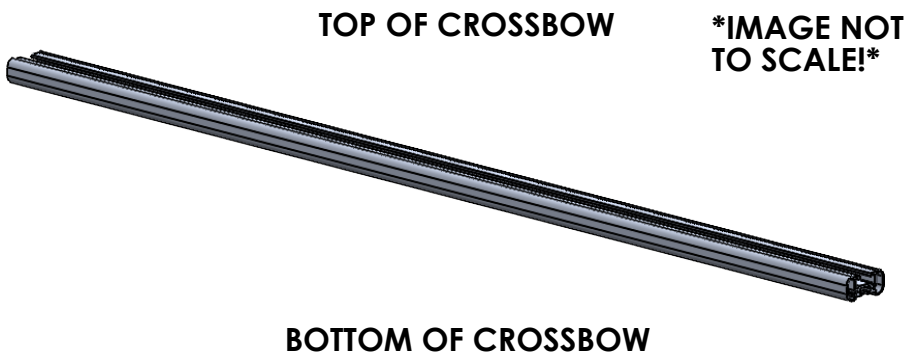

TABLE 2

| TOP OF CROSSBOW | | |
|--------------------|-----------------------|---|
| | COMPONENTS TO INSTALL | |
| B.1 | <u>HD UTILITY</u> | - WEAR STRIP (MODIFY IF NECESSARY, TABLE 3) |
| | <u>Grip-Lock</u> | - WEAR STRIP (MODIFY IF NECESSARY, TABLE 3) |
| | <u>ProLift</u> | - INNER STOP POST |
| BOTTOM OF CROSSBOW | | |
| | COMPONENTS TO INSTALL | |
| B.2 | <u>HD UTILITY</u> | - MOUNTING BRACKETS |
| | <u>Grip-Lock</u> | - MOUNTING BRACKETS |
| | <u>ProLift</u> | - MOUNTING BRACKETS |

ALTER WEAR STRIP AND INSTALL ON CROSSBOW (IF APPLICABLE)! REFERENCE TABLE 3 BELOW FOR WEAR STRIP ALTERATION INSTRUCTIONS!

TABLE 3

| ADDED ACCESSORIES | ALTERATION FOR WEAR STRIP |
|--------------------------|--|
| 4" UPRIGHT*** | REMOVE 2" FROM END OF WEAR STRIP |
| 4" PVC CONDUIT KIT | REMOVE 7.25" FROM CENTER OF WEAR STRIP |
| 6" PVC CONDUIT KIT | REMOVE 9.50" FROM CENTER OF WEAR STRIP |
| ALUMINUM BOX CONDUIT KIT | REMOVE 13.25" FROM CENTER OF WEAR STRIP |
| BEACON | REMOVE 4" FROM CENTER OF WEAR STRIP |
| ProLift (SINGLE SIDE) | CUT WEAR STRIP IN HALF, DO NOT INSTALL ON ProLift SIDE |
| ProLift (DUAL SIDE) | DO NOT INSTALL WEAR STRIP |

SLIDE WEAR STRIP INTO RAIL AND CENTER (1 PER CROSSBOW)

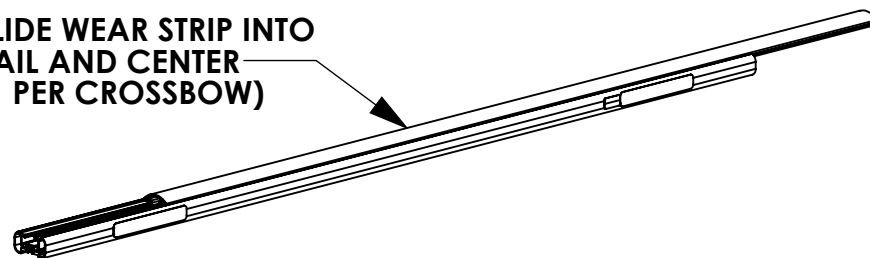

SLIDE ONE SIDE OF WEAR STRIP INTO CROSSBOW, THEN ROLL OTHER SIDE TO SNAP STRIP INTO PLACE



**STEP 1C SUB-ASSEMBLE EACH CROSSBOW WITH
DESIRED ACCESSORIES FOR SECTIONS C.1 & C.2**



TABLE 4

| TOP OF CROSSBOW | | |
|--------------------|-----------------------|------------------------------|
| | COMPONENTS TO INSTALL | |
| C.1 | HD UTILITY | - 4" UPRIGHT |
| | Grip-Lock | - N/A |
| | ProLift | - SLIDES FOR BASE EXTRUSION |
| BOTTOM OF CROSSBOW | | |
| | COMPONENTS TO INSTALL | |
| C.2 | HD UTILITY | - UPRIGHTS (6", 9", RATCHET) |
| | Grip-Lock | - STROBES |
| | ProLift | - STROBES |

ASSEMBLY STEPS (FULL BENCH ASSEMBLY):

- 2T. ADD DRIVELINES (IF INSTALLING ProLift)
- 3T. ADD HANDLES (IF INSTALLING Grip-Lock OR ProLift) AND DAMPERS (IF INSTALLING ProLift)
- 4T. ADD OUTER SUPPORT BARS (IF INSTALLING Grip-Lock OR ProLift)
- 5T. ADD STEP LADDER KIT (Grip-Lock OR ProLift ONLY!)

6T. ASSEMBLE ENDS CAPS TO CROSSBOW

USED FOR HD UTILITY &
Grip-Lock RACKS

LOCATED IN CROSSBOW KIT

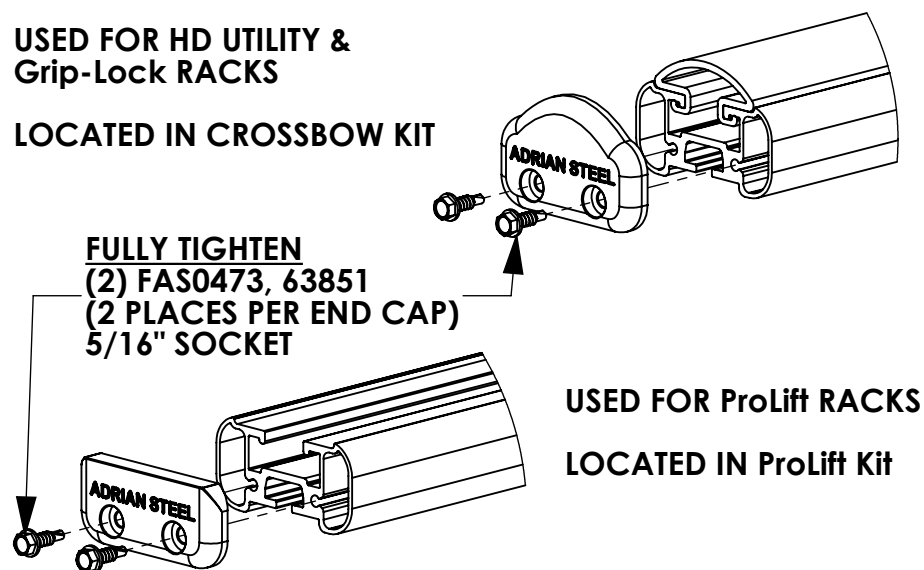

7T. INSTALL ROOF RAIL KIT ON VEHICLE ROOF OR BOTTOM MOUNTING BRACKETS

(ROOF RAIL KIT REQUIRED FOR Grip-Lock & ProLift
OPTIONAL FOR HD UTILITY, NOT NEEDED FOR GM LADDER
RACKS)

**8T. MOUNT CROSSBOW SUB-ASSEMBLIES FROM STEP 1 TO
VEHICLE/MOUNTING BRACKET, OR ROOF RAIL
(LOOSE INSTALL)**

ALTERNATE ASSEMBLY METHOD!
(ASSEMBLE ON VEHICLE ROOF):

2R. INSTALL ROOF RAIL KIT ON VEHICLE ROOF OR BOTTOM MOUNTING BRACKETS

(ROOF RAIL KIT REQUIRED FOR Grip-Lock & ProLift, OPTIONAL FOR HD UTILITY, NOT NEEDED FOR GM LADDER RACKS)

3R. MOUNT CROSSBOW SUB-ASSEMBLIES FROM STEP 1 TO VEHICLE/MOUNTING BRACKET, OR ROOF RAIL (LOOSE INSTALL)

4R. ADD DRIVELINES (IF INSTALLING ProLift)

5R. ADD HANDLES (IF INSTALLING Grip-Lock OR ProLift) AND DAMPERS (IF INSTALLING ProLift)

6R. ADD OUTER SUPPORT BARS (IF INSTALLING Grip-Lock OR ProLift)

7R. ADD STEP LADDER KIT (Grip-Lock OR ProLift ONLY!)

8R. ASSEMBLE END CAPS TO CROSSBOW

USED FOR HD UTILITY &
Grip-Lock RACKS

LOCATED IN CROSSBOW KIT

FULLY TIGHTEN
(2) FAS0473, 63851
(2 PLACES PER END CAP)
5/16" SOCKET

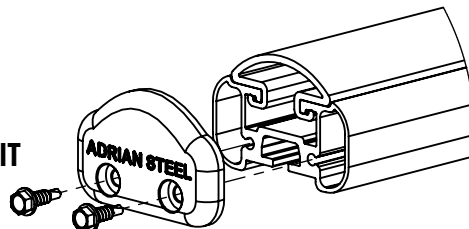

USED FOR ProLift RACKS
LOCATED IN ProLift Kit

