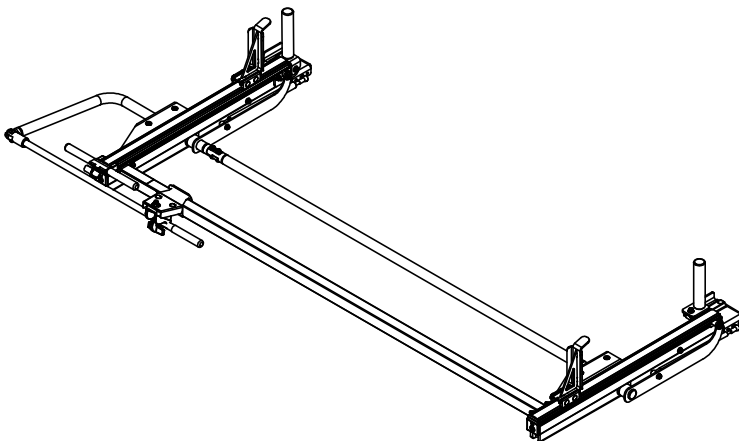

**ADRIAN STEEL®**

Cargo Management Solutions for Commercial Vehicles

## **PROLIFT MAX DROP 6' PASSENGERS SIDE LOW TOPPER LADDER RACKS**

**PRODUCT WEIGHT****68.0 LBS****WIDTH X DEPTH X HEIGHT****82.00" X 32.00" X4.00"****CAPACITY****SINGLE LADDER****COLOR****WHITE/BLACK****CATALOG NUMBER****PLMDPSLT6W, PLMDPSLT6B**

### **PRODUCT FEATURES**

ProLift™ Max Drop LOW Topper racks can be used on ADRIAN STEEL BIFF, LEER, UNICOVER and ARE truck toppers with bed lengths 8'+ with appropriate rail kit, crossbow kit and mounting bracket kit. Use rail kits, crossbow kits, and mounting bracket kits listed in the table below to create new rack combinations. These racks include an attached handle.

The Max-Drop ProLift™ has a single function that lowers the ladder to a single set height and a secondary function that lowers the rear of the ladder even further to a safer more ergonomic height. Most similar to our previous DDLR drop-down series.

Unicover Toppers will use roof rail kits ending in UC (Ex. 4'6" Unicvoer topper would use RRKTOP55UC)

Ignore the roof rail kit when ordering racks for ASC BIFF toppers as they ship with pre-installed rails.

Commercial Part Numbers							
Vehicle Platform	Bed Length	Bed Length (in)	Roof Rail Kit	Crossbow kit	Mounting Bracket Kit	Pro-Lift (Passenger Side)	Pro-Lift (Drivers Side)
All	8'+	96"+	RRKTOP96/UC	2BARTOPW	URMBK4W	PLSDPSLT6	PLSDDSLT6

**NOTE: CROSSBAR KIT IS DIFFERENT FOR COMBO WITH GRIPLOCK. IN THIS CASE, USE 2BAR53W/B**

SEE PAGE 2 FOR APPLICATION NOTES, ACCESSORIES AND OTHER PRODUCTS THAT WORK WITH THIS UNIT.



# **PROLIFT MAX DROP 6' PASSENGERS SIDE LOW TOPPER LADDER RACKS**

## **CATALOG NUMBER**

**PLMDPSLT6W, PLMDPSLT6B**

## **PRODUCT APPLICATION**

**TOPPER PROLIFT LADDER RACKS ARE FOR USE ON PICKUP TRUCK BED TOPPERS, AVAILABLE IN 4 FT, 5 FT, AND 6 FT LENGTHS FOR ALL DIFFERENT SIZE TRUCK BEDS.**

**Reduce back and shoulder injuries while loading/unloading ladders by eliminating the need to climb on bumpers and tires to reach the cargo on the roof of your vehicle.**

**The ProLift™ uses unique, patent-pending, mechanical advantages, and high-performing spring assist struts to raise and lower ladders with an almost effortless pull.**

## **ACCESSORIES THAT WILL WORK WITH THIS PRODUCT**

CATALOG NUMBER	DESCRIPTION (smart)
RRKTOP96	ROOF RAIL KIT,TOPPER,96"
RRKTOP96UC	ROOF RAIL KIT,TOPPER,96" UNICOVER
2BARTOPW / B	2BAR UTILITY RACK, TOP
2BAR53W / B	2BAR, CROSSBOW,53"
URMBK4W / B	UTILTY,MNT BKT KT,RAIL
GL-FSVDSW / B	GRIP-LOCK,FSV DS
PLMDDSLT6W/B	PROLIFT,MAX,DS,LOW T,6

**The information contained in this document is the sole property of ADRIAN STEEL COMPANY. ADRIAN STEEL COMPANY retains the right to modify and/or change the product of its design at any time with prior notification.**

INSTR. : 69483  
NUMBER

PG: 1  
REV: A

PART • Max Drop ProLift -  
NUMBER • Low & Mid-Roof

PART • ProLift Low & Mid-Roof  
DESC. • Adjustment Instructions

Step 2: With 1/2" Socket loosen  
nut, slide post so that it is snug  
against ladder  
Tighten nut

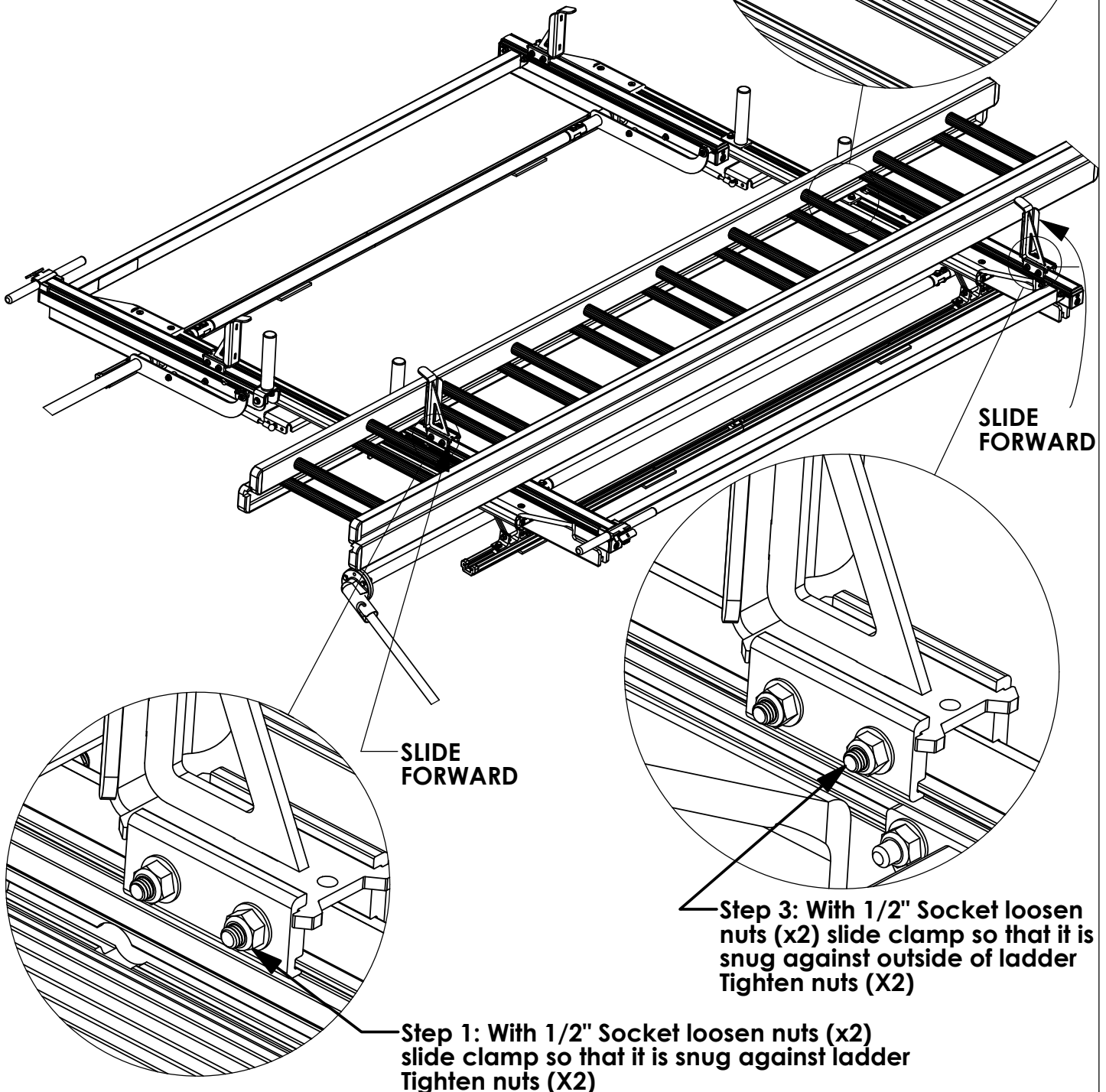

Once all brackets are adjusted operate rack to make sure clamps are not too tight

INSTR. : <b>70119</b>		PG: <b>1</b>	REV: <b>C</b>	ITEM NO.	PART NUMBER	DESCRIPTION	PLMDPSLT	PLMDDSLT
PART : <b>PLMDPSLT &amp; PLMDDSLT</b>				1	68037-B	CLAMP PAD, 6.5", BLACK	2	2
				2	66611-B	DROP DOWN, PIVOT HANDLE, BLK	1	1
				3	48265	DAMPER ASSEMBLY	1	1
PART • PROLIFT,MAX,PS,LT DESC. • & PROLIFT,MAX,DS,LT				4	58239	COMPRESSION DAMPER	1	1
				5	65963-W	STOP CLAMP, WHITE	4	4
<b>NOTE: DRIVE LINE LIST</b>				6	68186-W	PROLIFT INNER POST, WHITE	1	1
				7	68196-W	PROLIFT MAX DROP STOP, WHITE	1	1
				8	68628-W	PROLIFT HR DAMPER MOUNT, WHITE	2	2
				9	25340-0	HANDLE LATCH-STD	1	1
				10	72698-W	PL, 6' PS, OS BAR W/ LATCH CLAMP, WHITE	1	1
				11	70107-W	PROLIFT,LMT,DR ASM,PS,R,W	-	1
				12	68031-W	DROP DOWN FRONT ARM ASSM DS, WHITE	-	1
				13	6563-B	DROP DOWN, CS CENTER DRIVELINE, BLK	-	1

- PART NUMBERS WITH "-W" SUFFIX ARE PAINTED WHITE  
- FOR BLACK MOUNTING KITS, REPLACE "-W" PARTS WITH "-B" PARTS

#### NOTE: FRONT DROP DOWN CART.

<b>15</b>	
KIT PART NO.	FRONT ASSEM.
PLMDDSLT4	68013
PLMDPSLT4	68031
PLMDDSLT5	68013
PLMDPSLT5	68031
PLMDDSLT6	68013
PLMDPSLT6	68031

#### NOTE: REAR DROP DOWN CART.

<b>14</b>	
KIT PART NO.	REAR ASSEM.
PLMDDSLT4	70107
PLMDPSLT4	71016
PLMDDSLT5	70107
PLMDPSLT5	71016
PLMDDSLT6	70107
PLMDPSLT6	71016

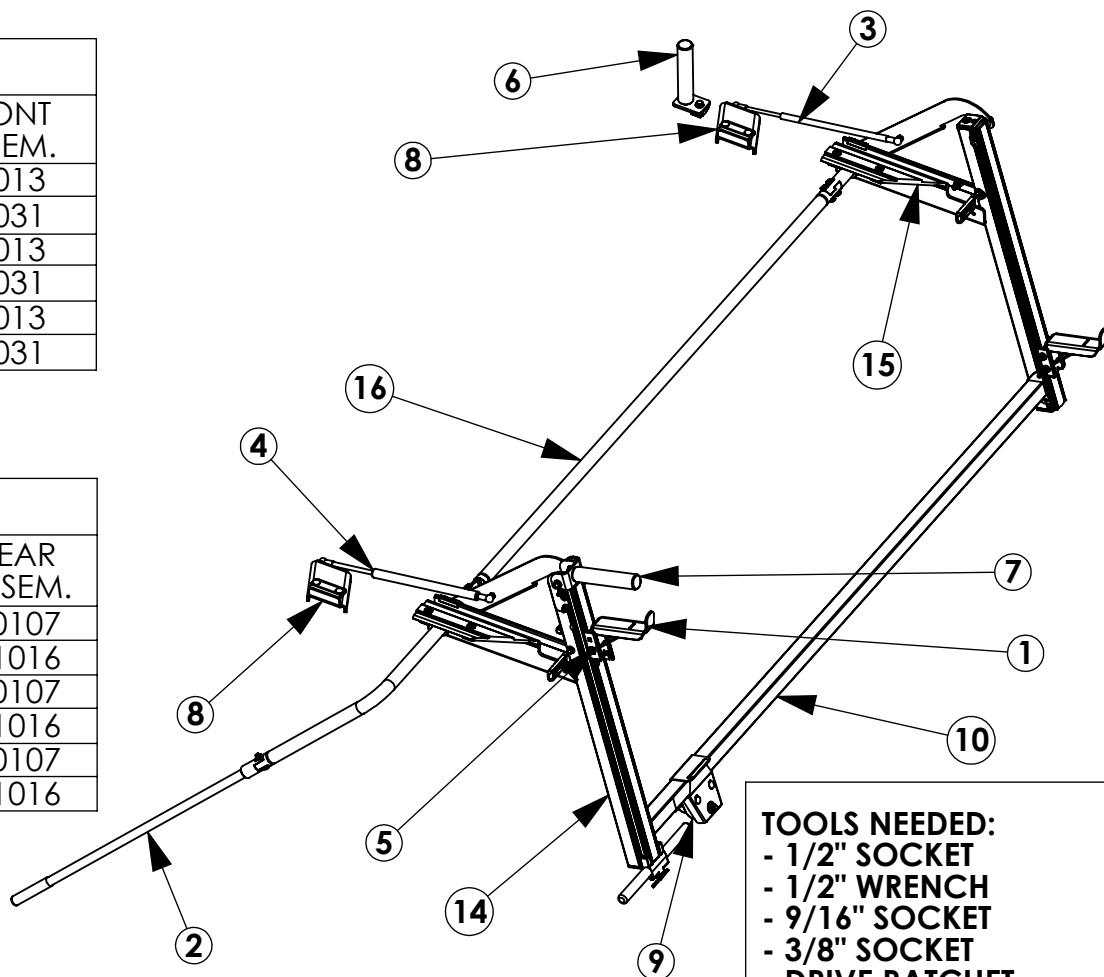

**TOOLS NEEDED:**  
- 1/2" SOCKET  
- 1/2" WRENCH  
- 9/16" SOCKET  
- 3/8" SOCKET  
- DRIVE RATCHET  
- 7/32" ALLEN WRENCH  
- 3/16" ALLEN WRENCH  
- 13mm WRENCH  
- TAPE MEASURE  
- RUBBER Mallet  
- IMPACT DRIVER

**\*\*IF BUILDING A DUAL SIDED RACK BUILD BOTH SIDES IN PARALLEL FOR EACH STEP. IF BUILDING SINGLE SIDED REFERENCE ONLY THAT SIDE WHEN BUILDING.\*\***

**GET TO KNOW THE VEHICLE** - AT THE BEGINNING OF ANY INSTALLATION, CHECK THE LOCATION OF THE FUEL TANK, FUEL LINES, BRAKE LINES, HIGH VOLTAGE BATTERIES AND WIRING HARNESSSES TO AVOID INJURY OR PROPERTY DAMAGE FROM TOOL CONTACT.

**SEAL ALL EXTERIOR HOLES** - ALL INSTALLATION HOLES SHOULD BE SEALED WITH BUTYL TAPE OR SILICON TO PREVENT WATER AND EXHAUST GASES FROM ENTERING THE VEHICLE.

**CONTROL DRILL DEPTH** - TO AVOID DAMAGE TO THE VEHICLE, USE A DRILL STOP OR CLEARED STEP BIT WHEN DRILLING INSTALLATION HOLES.

**ALWAYS ADD PRIMER** - WHEN ADDING INSTALLATION HOLES BE SURE TO USE A SELF-ETCHING PRIMER TO PREVENT CORROSION, FASTENER FAILURE AND INJURY.

**MOUNTING POINTS MUST HAVE METAL-TO-METAL CONTACT** - USE PROVIDED MOUNTING SPACERS TO ACCOMMODATE FOR VEHICLE FEATURES, CARPET OR SUBFLOORS.

**PROVIDE CLEARANCE FOR SPACERS** - IF THE INSTALLATION VEHICLE CONTAINS A CARPET OR SUBFLOOR, USE A 1-3/16" DIAMETER CARPET CUTTER (P/N: 31183-0) AT ALL MOUNTING LOCATIONS TO OPEN UP ROOM FOR SPACERS.

**CHECK SPACER ORIENTATION** - BE SURE THAT THE INDENT IN THE SPACER COVERS THE PLUSNUT HEAD; THIS ENSURES THE MOST METAL-TO-METAL CONTACT AND REDUCES VIBRATION.

**PLUSNUT INSTALLATION** - A PLUSNUT GUN IS RECOMMENDED FOR PLUSNUT INSTALLATION FOR ITS PRODUCTION SPEED. HOWEVER, A PLUSNUT SETTING TOOL CAN ALSO BE USED (P/N: 22200-0).

**THRU-BOLT CLEARANCE** - WHEN USING A THRU-BOLT AT ANY MOUNTING LOCATION, BE SURE THAT YOUR HOLE HAS 1/16" CLEARANCE.

**FASTENERS AND HARDWARE USED**

**BAG REFERENCE: BAG68181 & BAG68182**

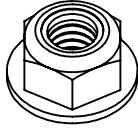

FAS0861  
NUT,HEX NLK FLG 5/16-18  
QTY: 20



FAS0110  
NUT,HEX NLK 3/8-16  
QTY: 01

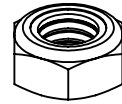

FAS0399  
NUT,HEX NLK LT 3/8-16  
QTY: 01

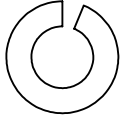

FAS0588  
WASHER,LCK SPLIT 5/16  
QTY: 03

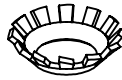

FAS0857  
WASHER,LCK EXT CS 5/16  
QTY: 04

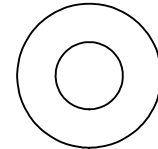

FAS0552  
WASHER,FLAT USS 5/16  
QTY: 09

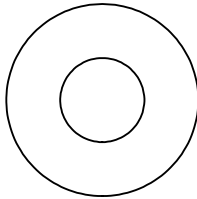

FAS0720  
WASHER,FLAT USS 3/8  
QTY: 01

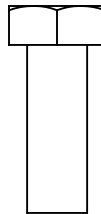

FAS0283  
SCREW,HH 5/16-18X.875  
QTY: 03

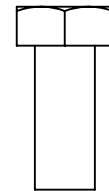

FAS0799  
SCREW,HH 5/16-18X.75  
QTY: 02

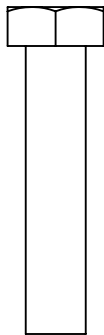

FAS0242  
SCREW,HH 5/16-18X1.5  
QTY: 04

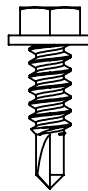

FAS0473  
SCREW,HH TEK #12X.75  
QTY: 04

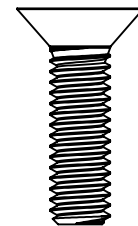

FAS0856  
SCREW,FHH 5/16-18X1.13  
QTY: 04

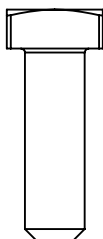

FAS0035  
BOLT,SQ HD 5/16-18X1.0  
QTY: 02

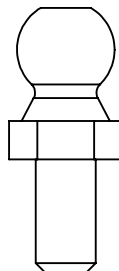

34927-0  
BALL STUD 13MM X 5/16-18  
QTY: 02

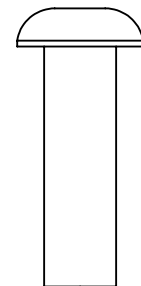

FAS0701  
SCREW,BHCS 3/8-16X1.25  
QTY: 01

INTENTIONALLY LEFT BLANK

***FASTENERS AND HARDWARE USED***

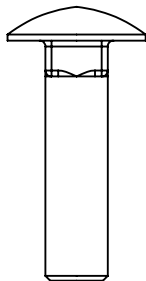

FAS0812  
BOLT,CRG 5/16-18X1.25  
QTY: 04

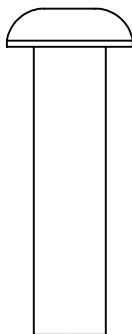

FAS0819  
SCREW,BHCS 3/8-16X1.5  
QTY: 01

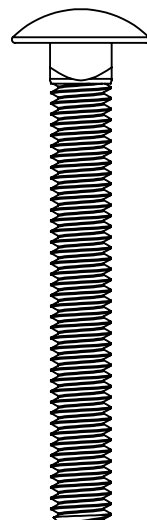

FAS0838  
BOLT,CRG 5/16-18X2.5  
QTY: 04



64831  
REAR ROLLER, SPACER  
QTY: 02

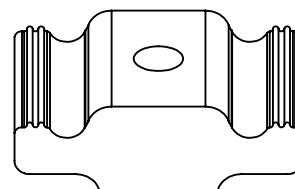

63490  
RAIL SLIDE, 1"  
QTY: 05

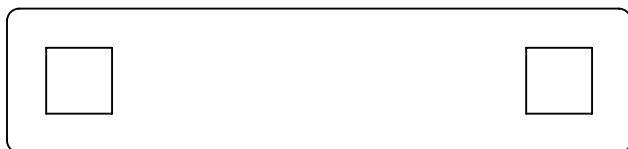

64830  
REAR ROLLER, BOLT PLATE  
QTY: 02



34928-0  
CLIP, SPRING, RETAINER, 13MM  
QTY: 04

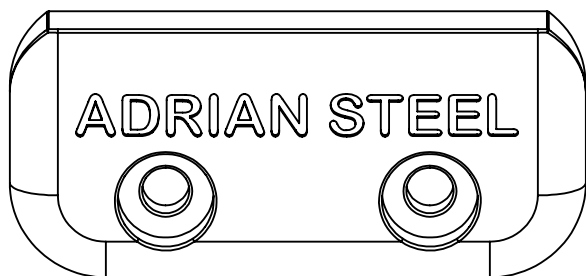

65961  
DROP DOWN END CAP  
QTY: 02

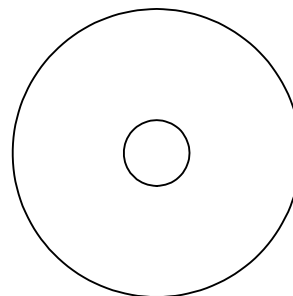

**DISCARD** FAS0603  
SCREW,HH 5/16-18X.875  
QTY: 01



**INTENTIONALLY LEFT BLANK**

**STEP 1 - MOUNT DAMPER BRACKETS****A.2**

**Step 1.1**  
**FULLY TIGHTEN**  
**34927-0 & FAS0861**  
**(02 PLACES PER**  
**SIDE)**  
**13mm WRENCH**  
**1/2" SOCKET**

**STEP 1.2**  
**FULLY TIGHTEN**  
**(02) FAS0812,**  
**64830, 64831, &**  
**(02) FAS0861**  
**(02 PLACES PER**  
**SIDE)**  
**1/2" SOCKET**

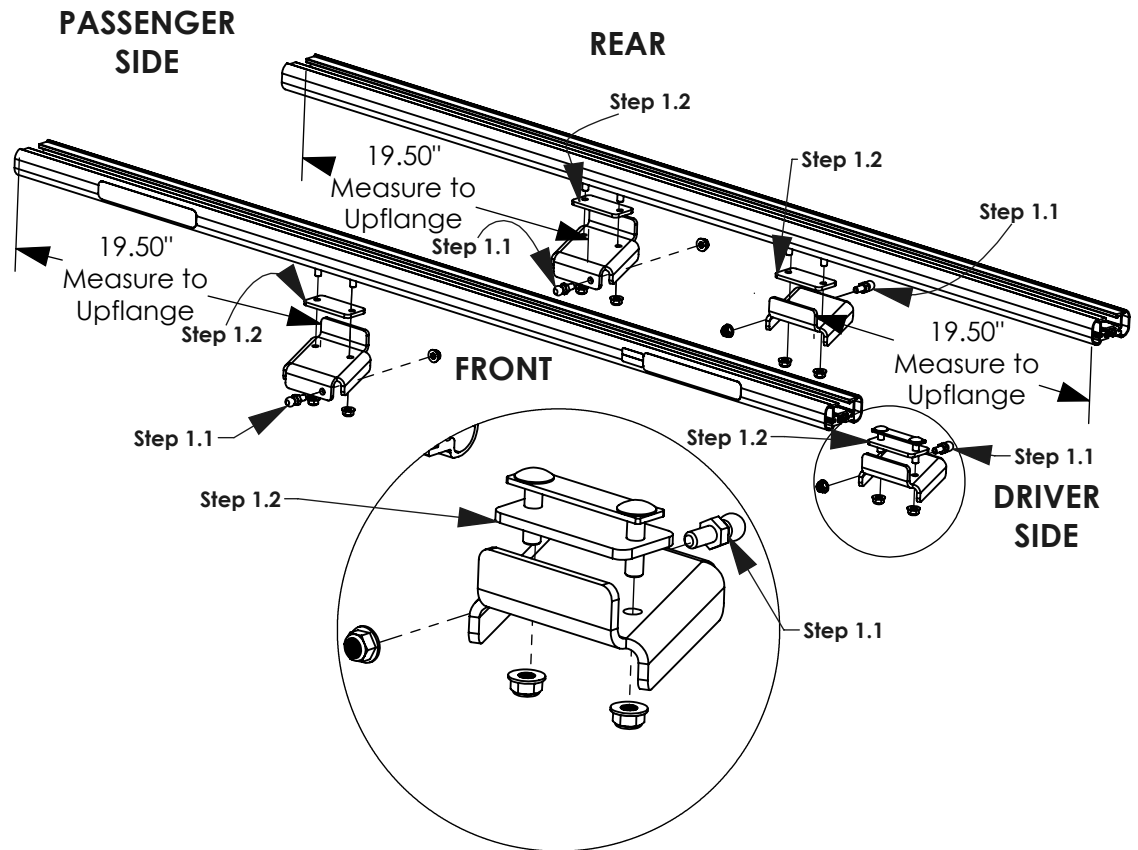
**STEP 2 - MOUNT INNER STOPS TO FRONT CROSSBOW****B.1**

**STEP 2.1**  
**FULLY TIGHTEN**  
**FAS0283, FAS0552,**  
**& FAS0588, 63490**  
**(01 PLACE PER**  
**SIDE)**  
**1/2" SOCKET**

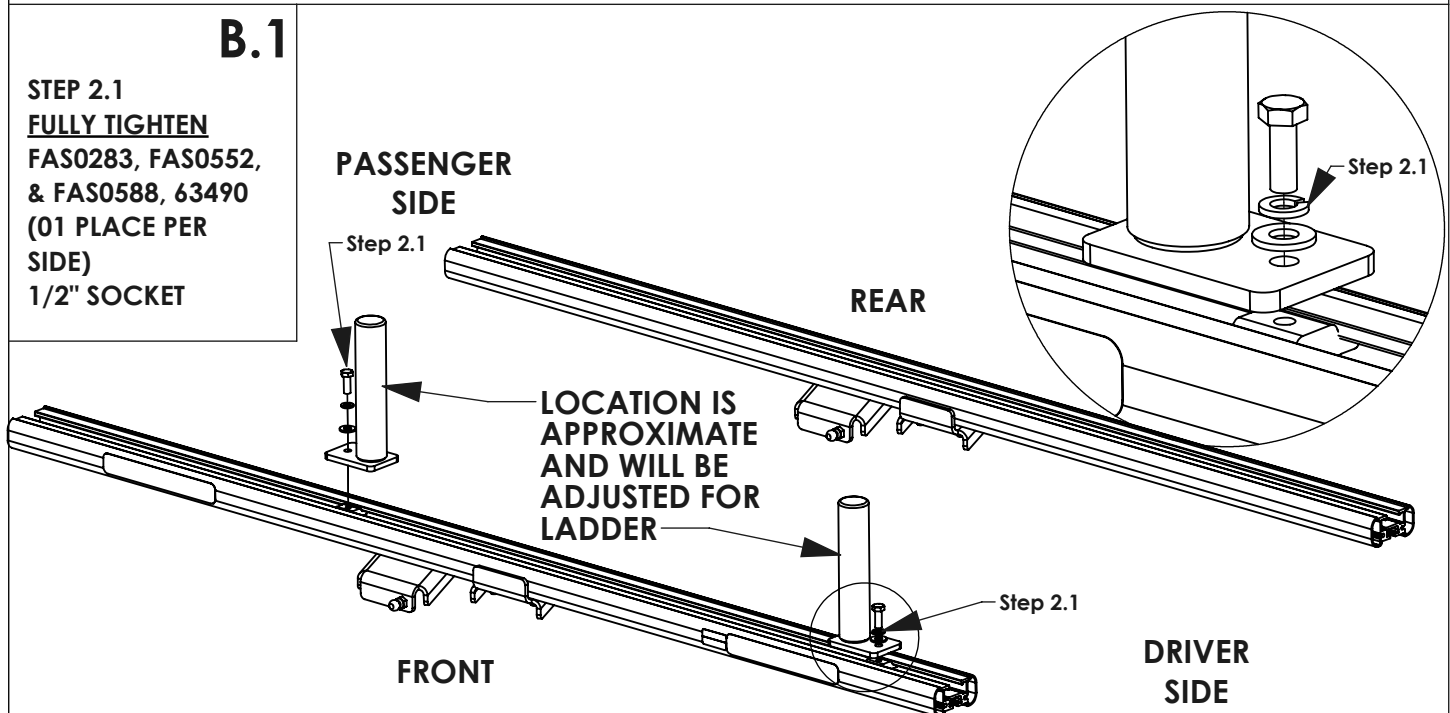

# STEP 3 - INSTALL CLAMPS AND HARDWARE ON DROP DOWN CARTRIDGES

## REAR SUB-ASSEMBLY

### STEP 3.1

#### FULLY TIGHTEN

FAS0283, FAS0552,  
& FAS0861

(02 PLACES)

1/2" WRENCH

1/2" SOCKET

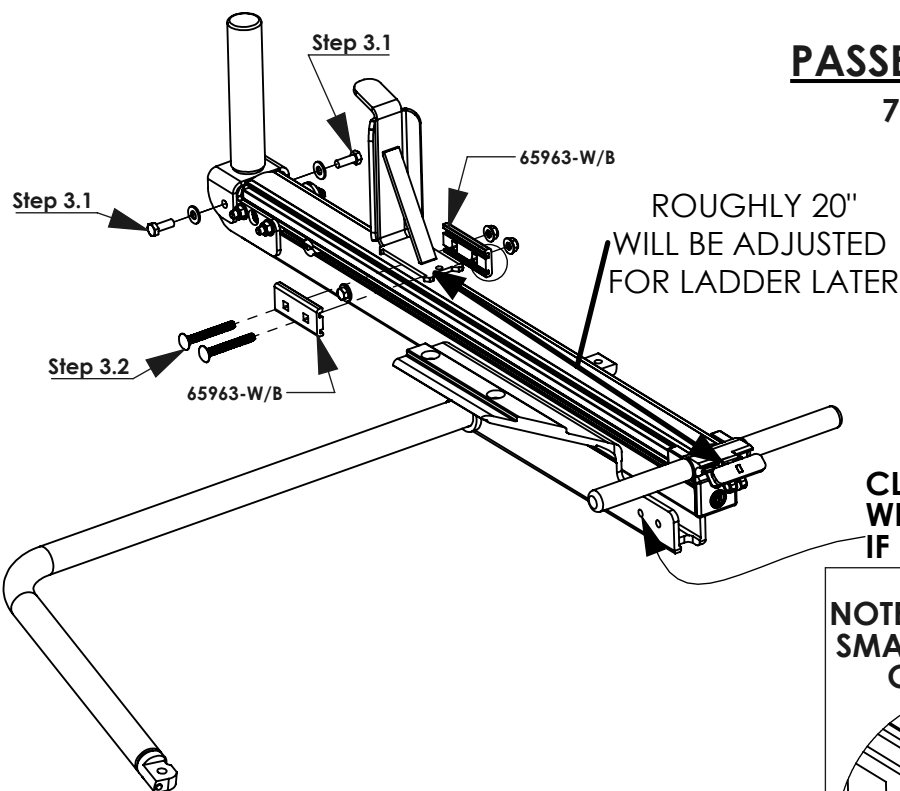

### PASSENGER SIDE

70106-W/B

### STEP 3.2

#### FULLY TIGHTEN

FAS0838 &  
FAS0861

(02 PLACES)

1/2" SOCKET

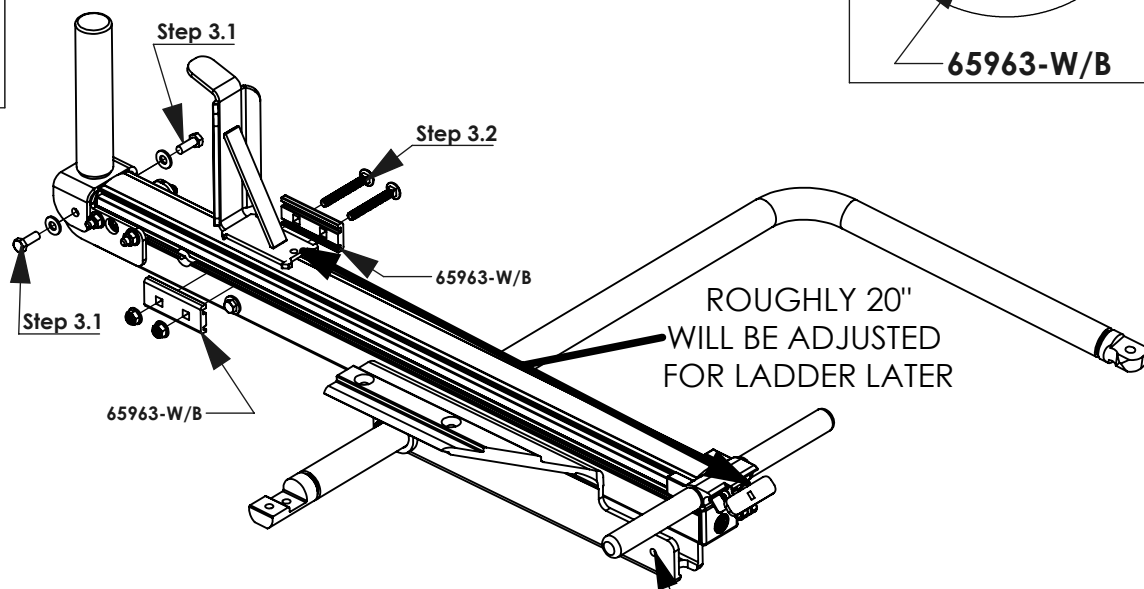

### DRIVER SIDE

70107-W/B

**FRONT SUB-ASSEMBLY****PASSENGER SIDE**

68031-W/B

**STEP 3.3**  
**FULLY TIGHTEN**  
**FAS0838 &**  
**FAS0861**  
**(02 PLACES)**  
**1/2" SOCKET**

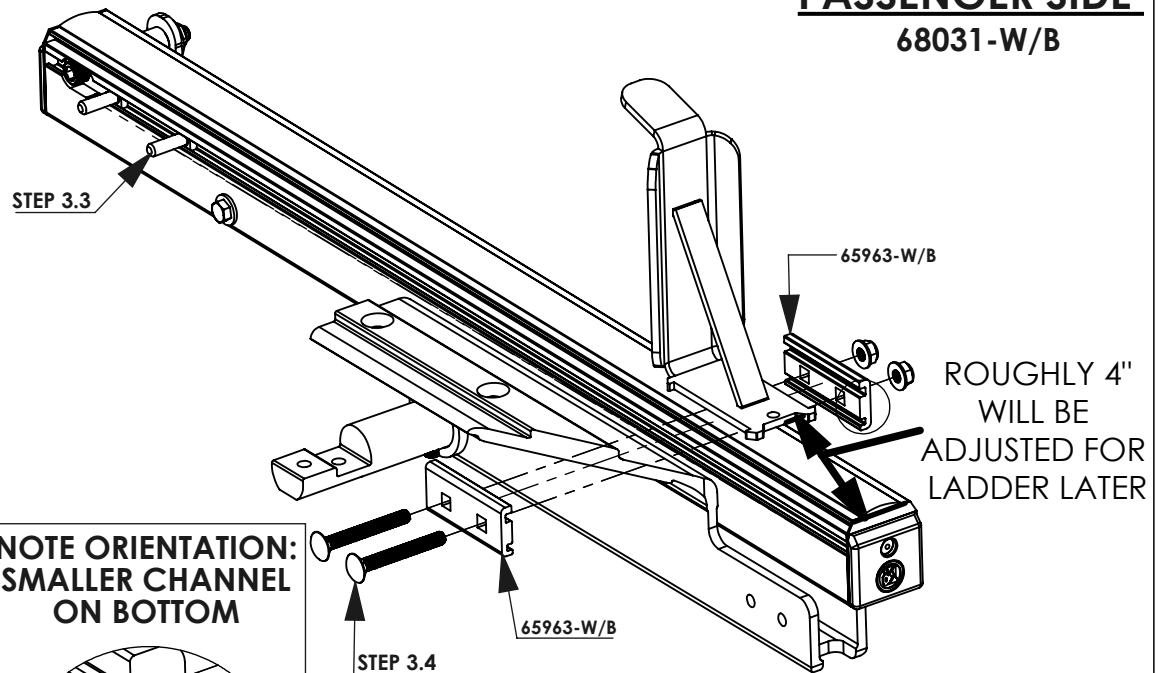
**DRIVER SIDE**

68013-W/B

**STEP 3.4**  
**FAS0035**  
**SLIDE INTO SLOT**  
**(02 PLACES)**

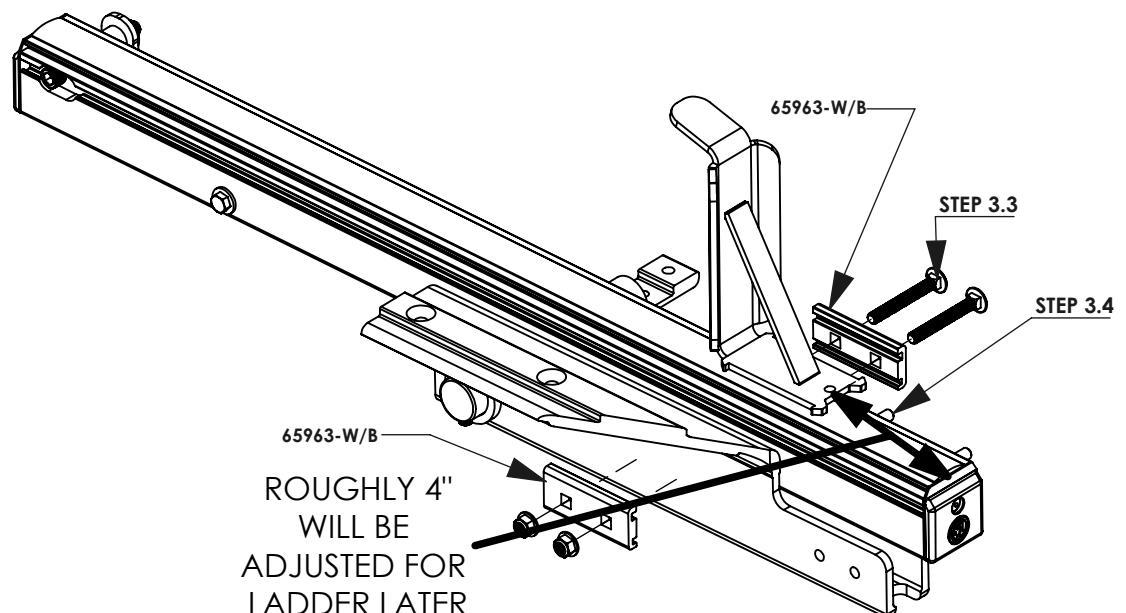



# REFERENCE INSTALLATION GUIDE 68895 TABLES 1-3 INSTALLATION OF A.1, A.2, B.1, & B.2 SHOULD BE COMPLETE BEFORE PROCEEDING TO STEP 4

## STEP 4 - INSTALL CARTRIDGES ON CROSSBOWS

### STEP 4.1

SLIDE 63490 INTO  
END OF  
CROSSBOWS

C.1

### STEP 4.2

LINE UP CORNERS  
WITH END OF  
CROSSBOW

### STEP 4.3

FULLY TIGHTEN  
(02) FAS0856,  
(02) FAS0857, &  
(02) 63490  
(02 PLACES PER  
SIDE)  
3/16" ALLEN

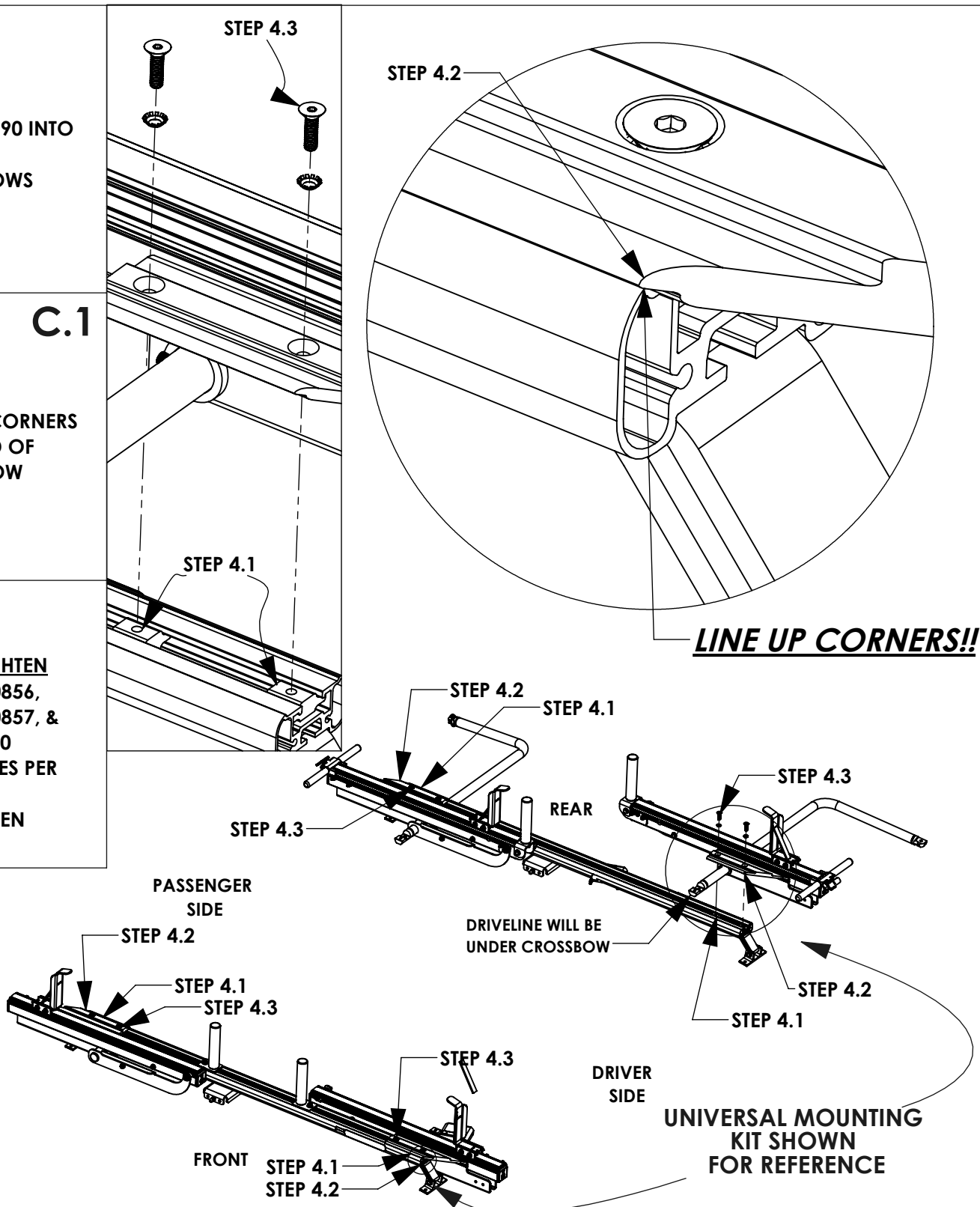

**STEP 5 - INSTALL DRIVELINE**

**STEP 5.1**  
**FULLY TIGHTEN**  
**FAS0242, FAS0552**  
**& FAS0861**  
**(04 PLACES PER**  
**SIDE)**  
**1/2" WRENCH**  
**1/2" SOCKET**

**BEST PRACTICE:**  
**WHEN INSTALLING**  
**BOLTS OPEN RACK**  
**ROUGHLY 45**  
**DEGREES FOR**  
**EASIER ACCESS &**  
**INSTALLATION**

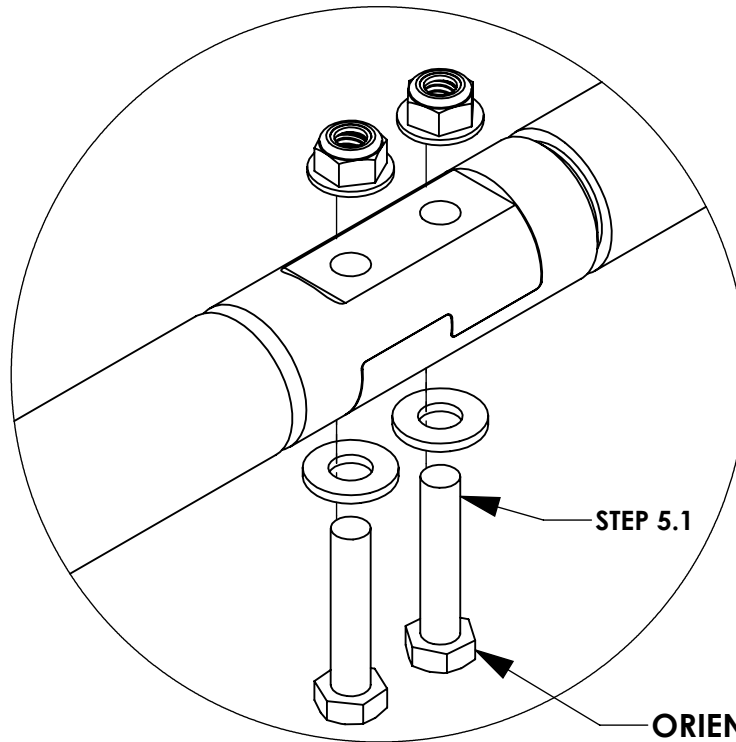

**ORIENTATION OF BOLTS IS**  
**UPWARDS FOR ASSEMBLY**

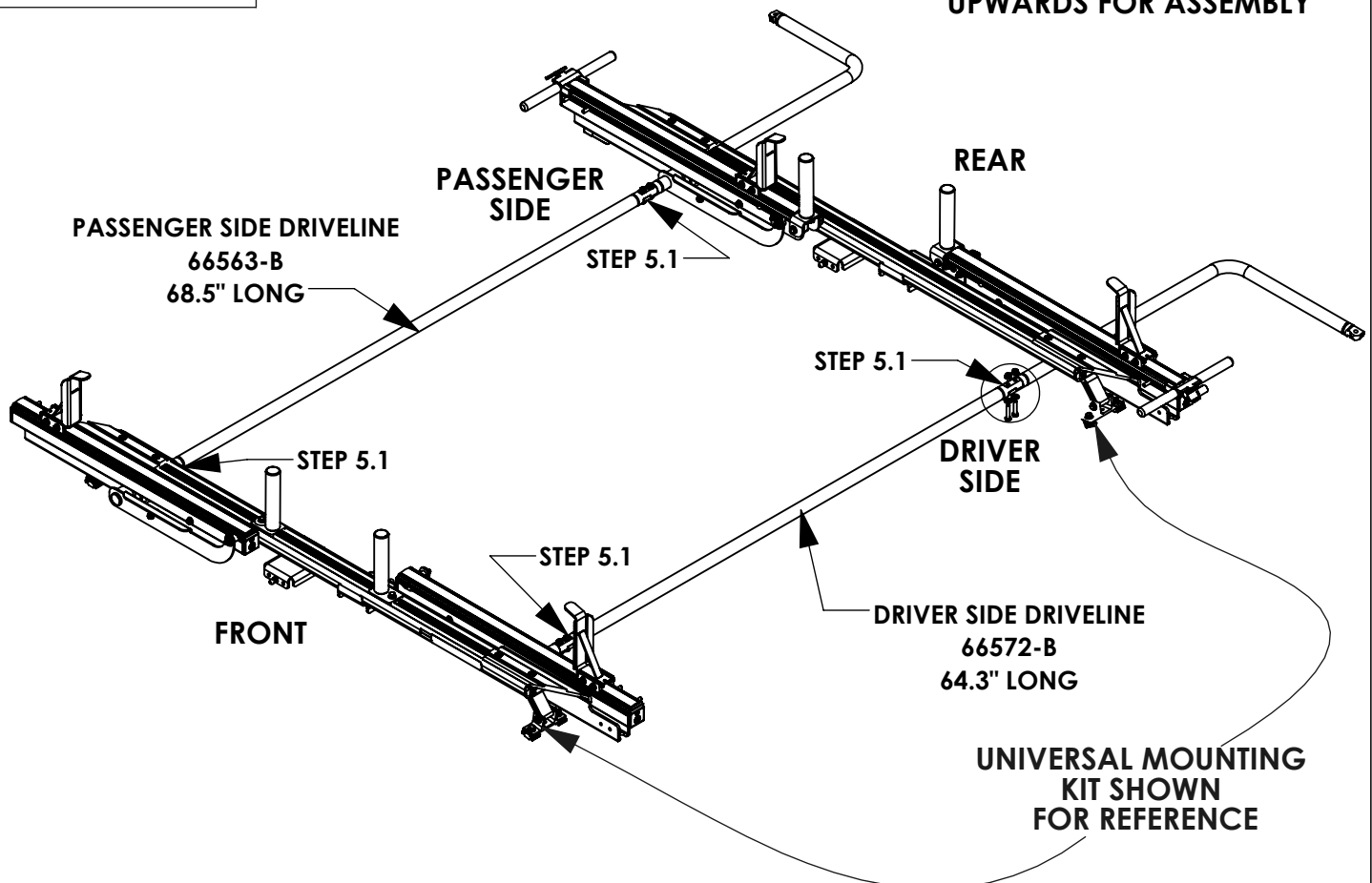

## STEP 6 - DEPLOY RACK & INSTALL DAMPERS AND DROP DOWN HANDLE

**Step 6.1**  
ATTACH EXTENSION  
DAMPERS (48625) TO  
BALL STUDS.

**ORIENTATION OF  
DAMPER MATTERS!!!**  
(01 PLACE PER SIDE)

**Step 6.2**  
ATTACH  
COMPRESSION  
DAMPERS (58239) TO  
BALL STUDS.

**ORIENTATION OF  
DAMPER MATTERS!!!**  
(01 PLACE PER SIDE)

**Step 6.3**  
INSERT LOCKING  
PINS (34928-0)  
AFTER MOUNTING  
DAMPERS TO BALL  
STUDS  
(04 PLACES PER SIDE)

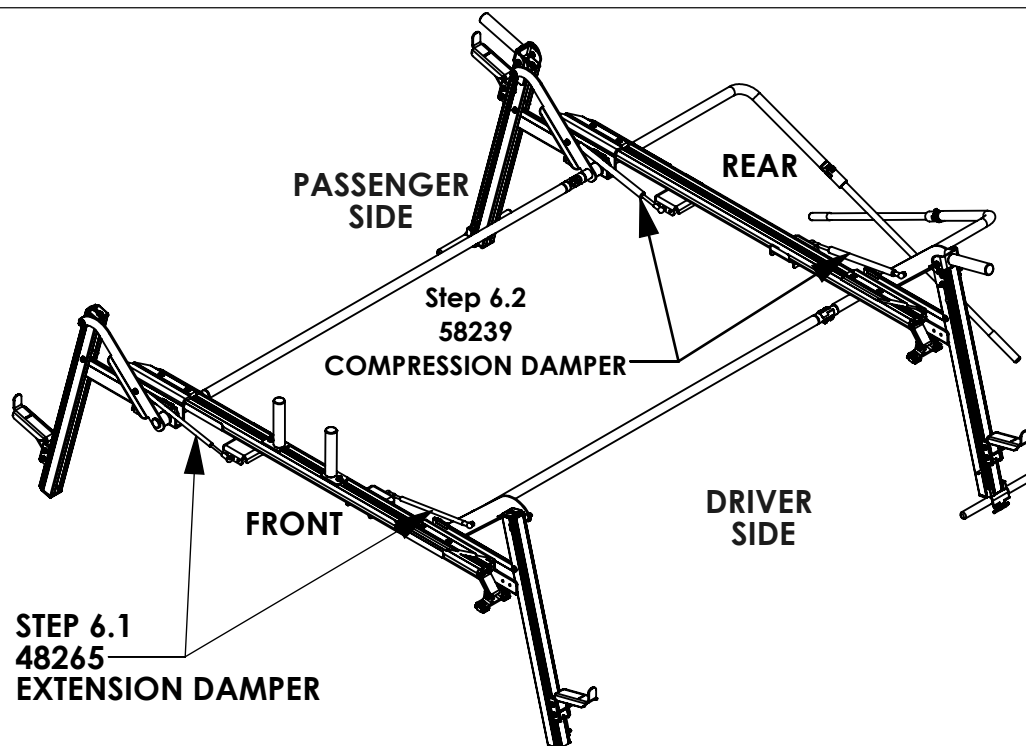

### ORIENTATION OF DAMPER MATTERS!!!!

LARGE CYLINDER OF DAMPER ATTACHES TO ARM  
SMALL ROD END ATTACHES TO DAMPER BRACKET

**Step 6.3**  
34928-0

Step 6.1 & 6.2

58239 REAR OF RACK  
48265 FRONT OF RACK

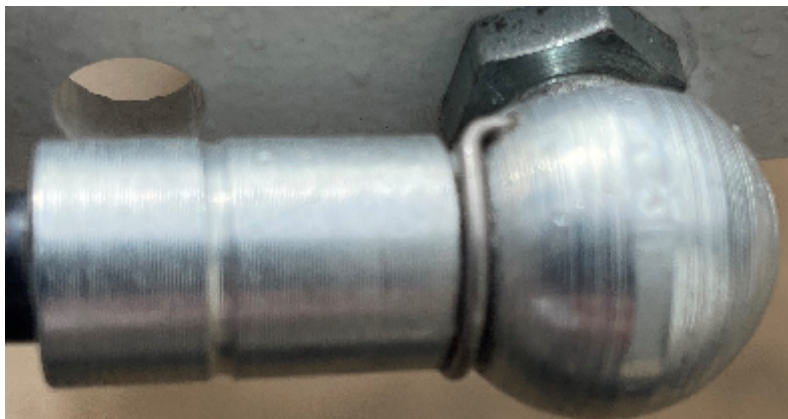
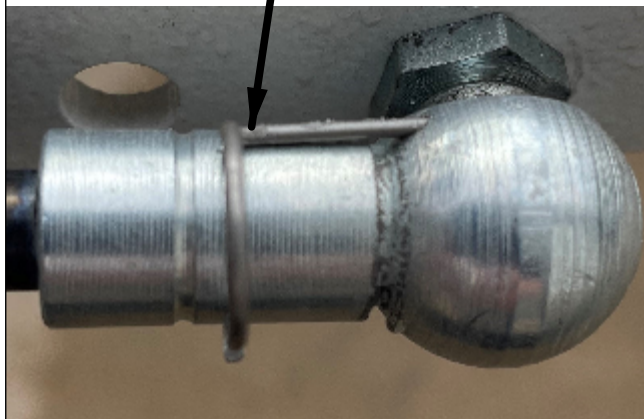
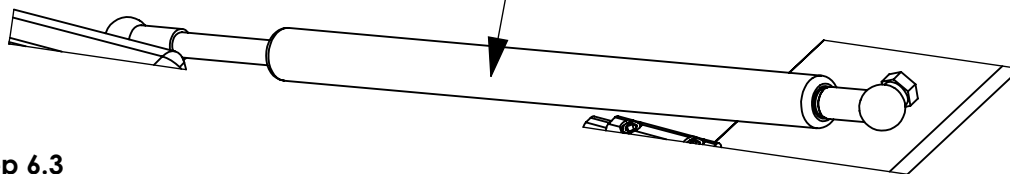

**STEP 7 - WHILE RACK DEPLOYED INSTALL O.S. BAR**

**Step 7.1**  
**FULLY TIGHTEN**  
**FAS0861**  
**(04 PLACES PER**  
**SIDE)**  
**1/2" SOCKET**

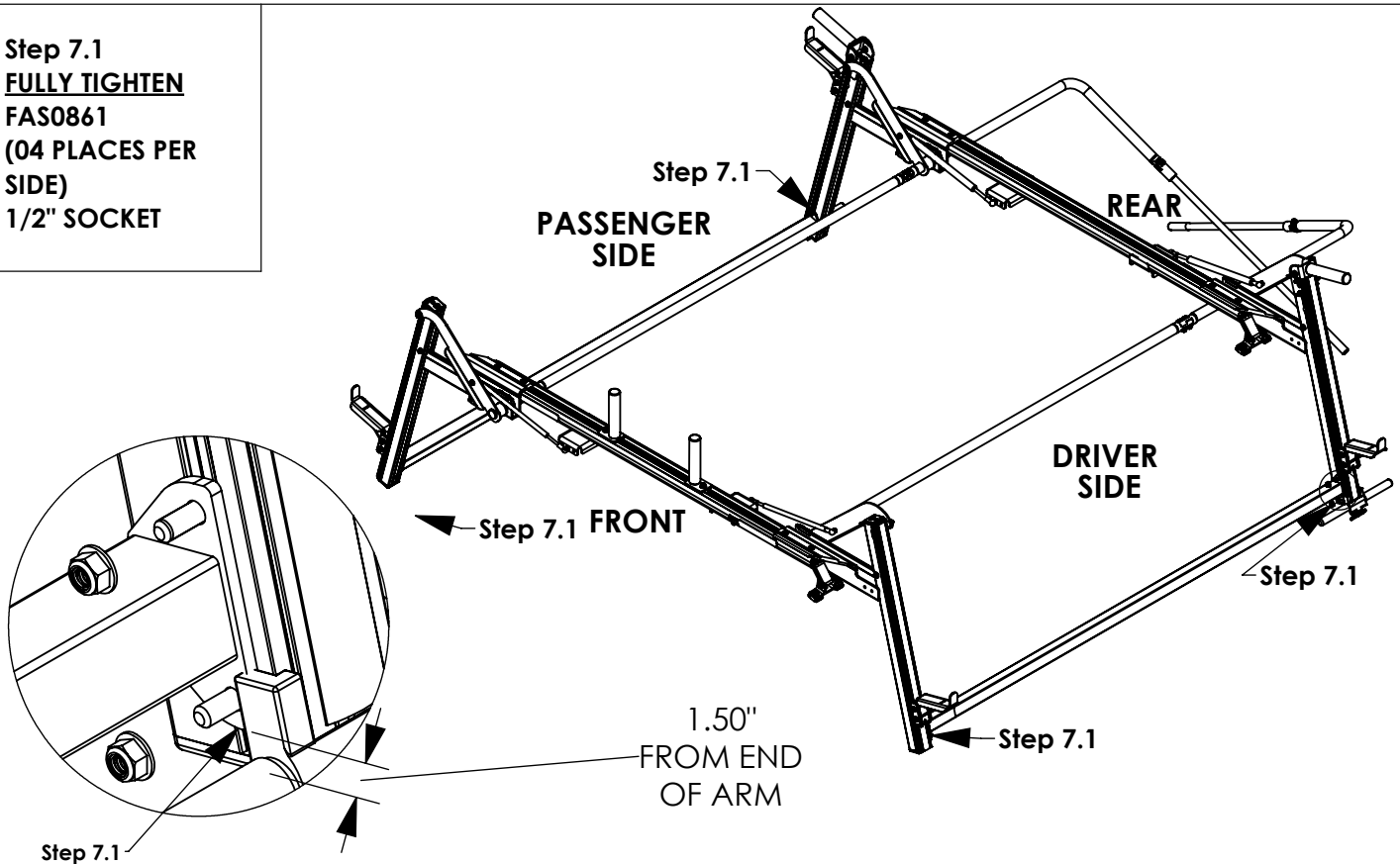
**STEP 8 - INSTALL DROP DOWN HANDLE**

**Step 8.1**  
**FULLY TIGHTEN**  
**FAS0819 & FAS0399**  
**(01 PLACES PER**  
**SIDE)**  
**7/32" ALLEN**  
**9/16" SOCKET**

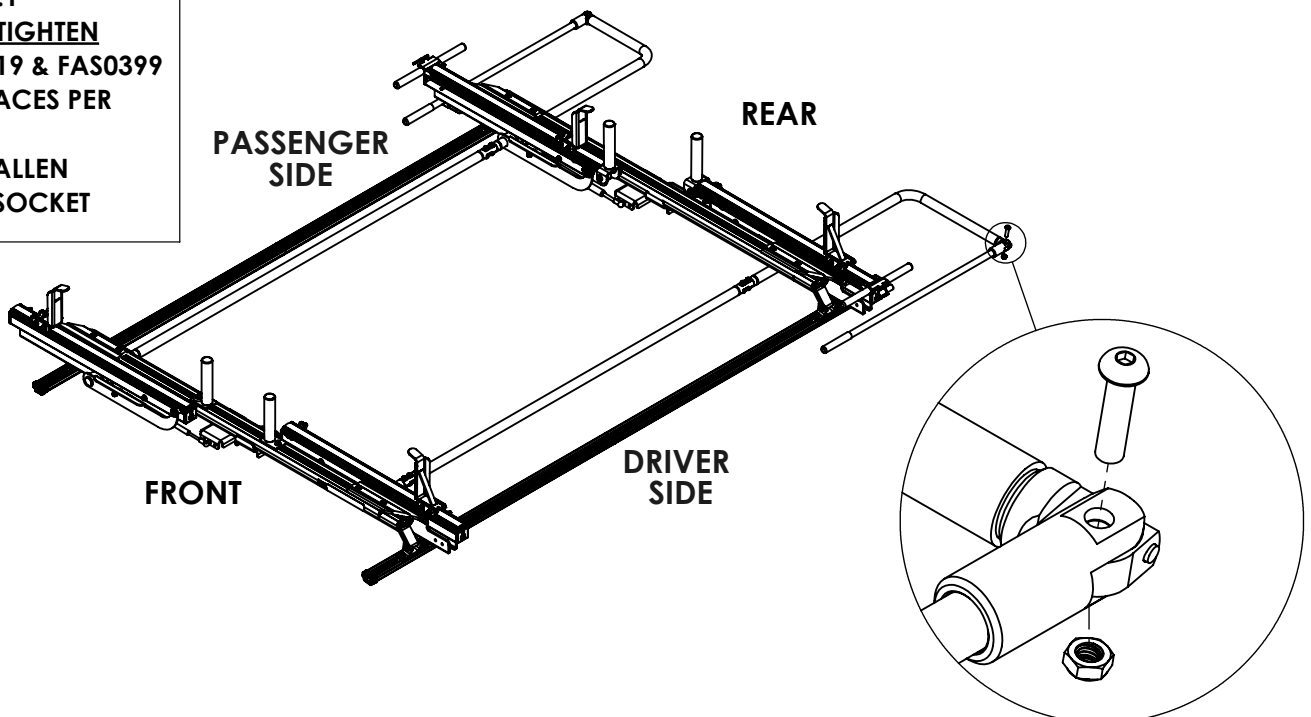

**MAKE SURE ALL FASTENERS ARE TIGHTENED!!! INSTALLATION IS COMPLETE**



**STEP 9 - INSTALL CROSSBOW END CAPS****Step 9.1****FULLY TIGHTEN**

(02) FAS0473, 65961

(02 PLACES PER SIDE)

3/8" SOCKET

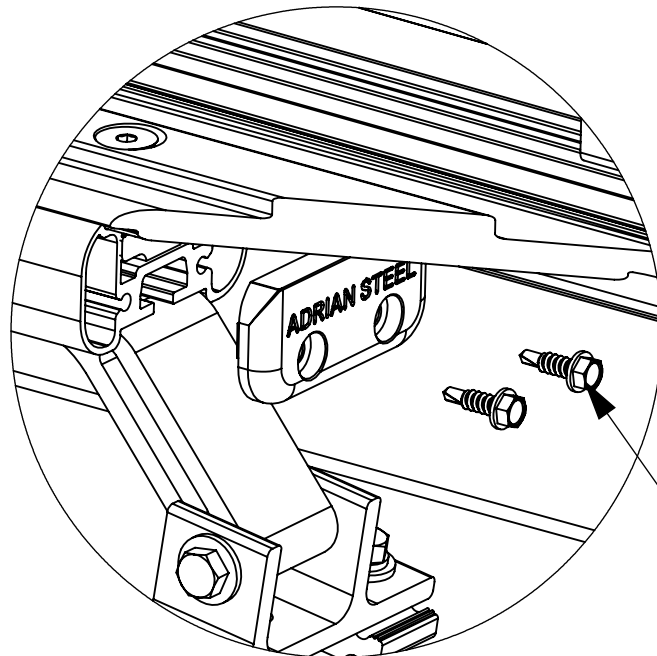

Step 9.1

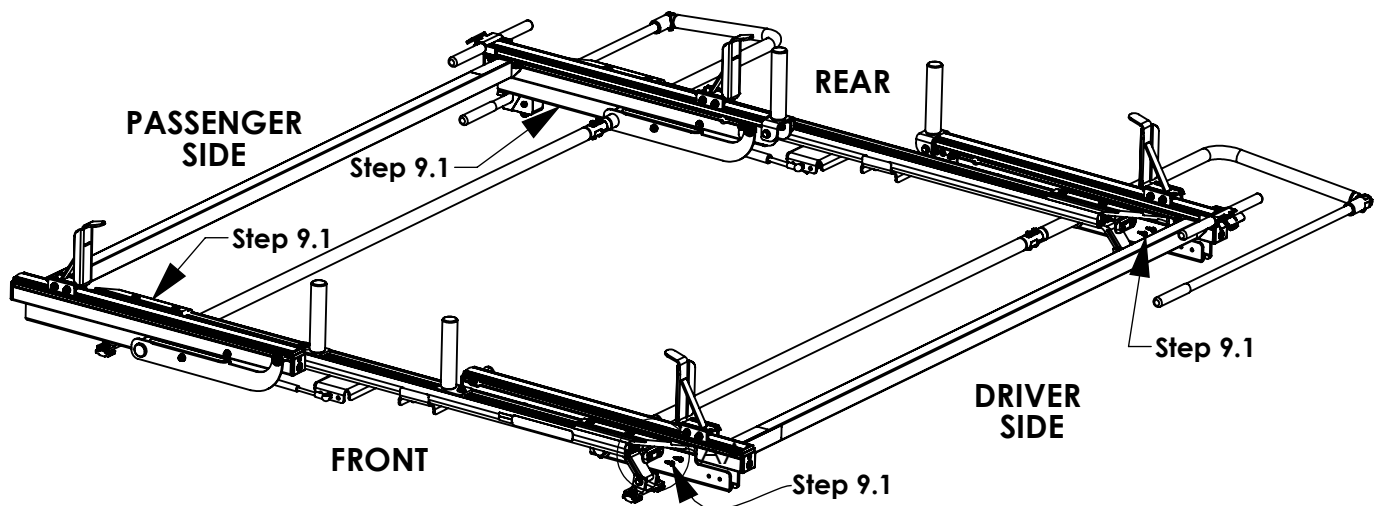
**MAKE SURE ALL FASTENERS ARE TIGHTENED!!! INSTALLATION IS COMPLETE**

**STEP 10 - INSTALL HANDLE LATCH**

**Step 10.1**  
**FULLY TIGHTEN**  
**FAS0819, FAS0399,**  
**(01 PLACE)**  
**7/32" ALLEN**  
**9/16" SOCKET**

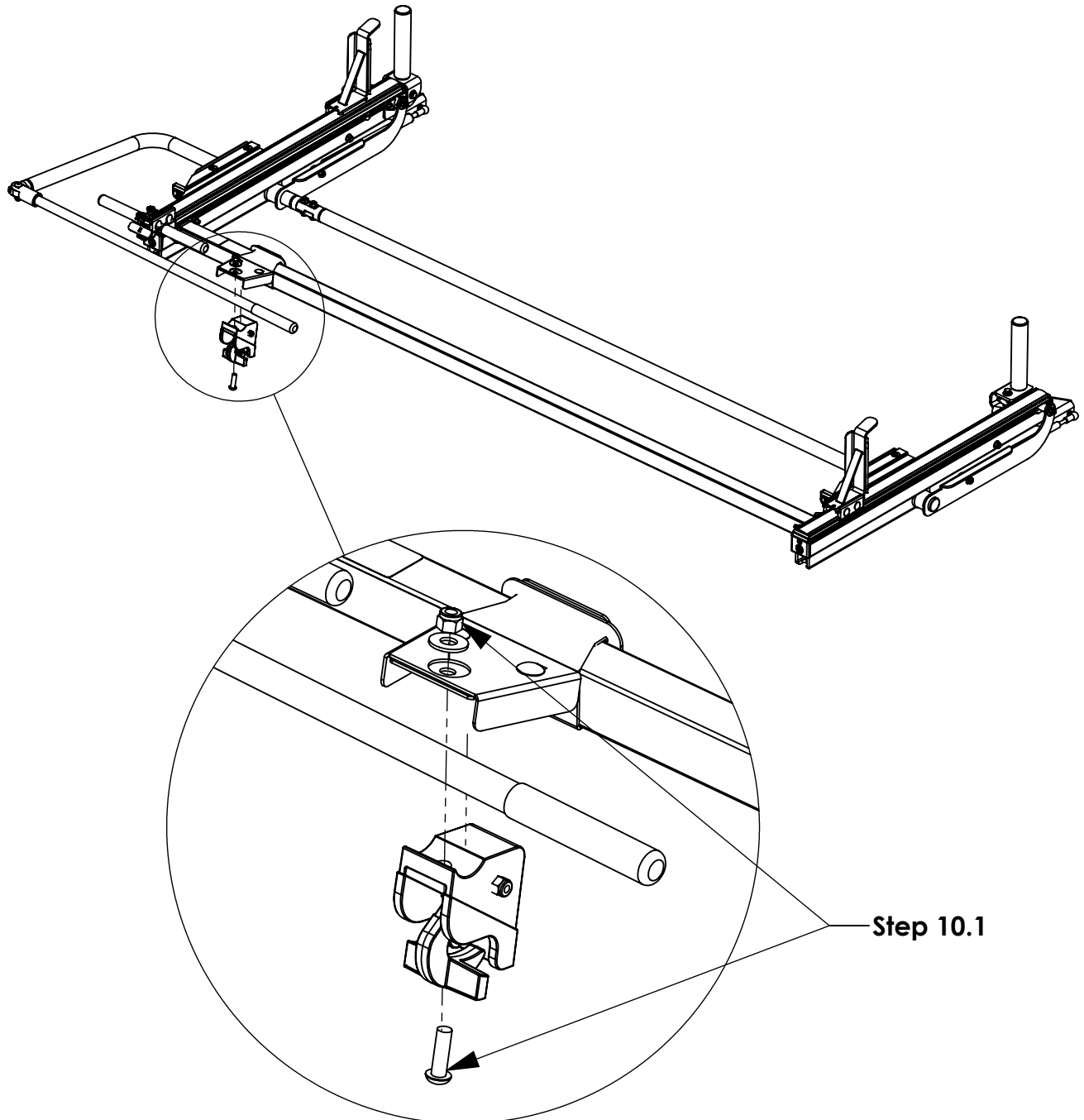

**MAKE SURE ALL FASTENERS ARE TIGHTENED!!! INSTALLATION IS COMPLETE**