

Introduction / Comments:

Assembly / Installation Instructions for Sprinter Low / High Roof Van Composite Partition

Note:

It is advised that all fasteners used in this assembly and installation should be checked for tightness at the following intervals: @ 2-weeks and again @ 6-weeks of operation. This preventive maintenance step must be completed to ensure your Product gives you long service life.

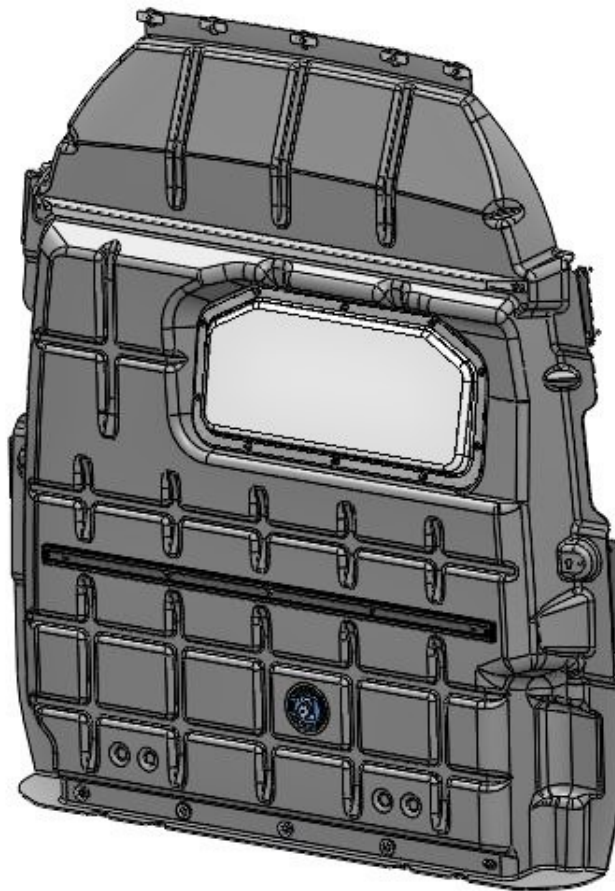

(PARSPH SHOWN)

Composite Partitions
PARSPH & PARSPH-NW
PARSPL & PARSPL-NW

FOR MERCEDES SPRINTER LOW OR HIGH ROOF
VANS

- PRECAUTIONS -





 **CAUTION** 
**THE USE OF AIR IMPACT TOOLS CAN
OVER-TORQUE FASTENERS AND
CAUSE FASTENER FAILURE!**





 **CAUTION** 
**ALL INSTALLATION HOLES SHOULD BE SEALED
WITH SILICON OR BUTYL SEALANT TO PREVENT
EXHAUST FUMES FROM ENTERING THE VEHICLE!**



 **DANGER** 
**INSPECT FOR FUEL TANK, FUEL LINES, BRAKE LINES, HIGH
VOLTAGE BATTERIES AND ELECTRICAL LINES PRIOR TO
DRILLING TO AVOID DAMAGING CRITICAL VEHICLE SYSTEMS
OR INJURY TO INSTALLER DURING INSTALLATION PROCESS!**



 **CAUTION** 
**TO AVOID DAMAGING THE VEHICLE ALWAYS USE DRILL
STOPS WHEN DRILLING ANY INSTALLATION HOLES!
ADRIAN AVAILABLE PART #'S 31119-0 (3/8" X 1/2"
DEEP), 31121-0 (1/2" x 1/2" DEEP)**



- IMPORTANT WARRANTY REQUIREMENTS -

1. SUBSTITUTING ADRIAN STEEL SPECIFIED FASTENERS FOR ASSEMBLY AND/OR INSTALLATION WILL VOID YOUR PRODUCT WARRANTY.
2. ALL HOLES DRILLED INTO VEHICLE SHOULD HAVE THE RAW METAL EDGES SEALED WITH A SELF-ETCHING PRIMER TO RESIST CORROSION AND POTENTIAL FASTENER POINT FAILURE.
3. ALL FASTENERS USED IN THE INSTALLATION OF THIS PRODUCT SHOULD BE TIGHTENED TO THE TORQUE(S) SPECIFIED IN THESE INSTRUCTIONS.
4. THESE INSTRUCTIONS SHOULD BE KEPT WITH THE VEHICLE.

THE BASIC TOOLS NEEDED FOR MOST INSTALLATIONS



DRILL



DRILL BIT WITH
STOP



RATCHET, SOCKETS
AND/OR WRENCHES



SCREWDRIVERS



MEASURING TAPE

ADDITIONAL TOOLS MAY BE NEEDED FOR THIS INSTALLATION AND THEY WILL BE IDENTIFIED IN THE STEPS THAT FOLLOW.

If your vehicle contains carpet or a rubber floor mat you will need to prepare the mounting location. Position the product to be installed into the vehicle and once you are satisfied with the mounting locations, mark the mounting locations. Using a 1-3/16" diameter carpet cutter (P/N: 31183-0). Select the appropriate floor spacers as shown in the illustration. Set those aside for use later into the installation process. Using the correct drill bit size for the selected plusnut, drill the mounting holes in the vehicle sheet metal to prepare for installing the plusnuts.

If you are thru-bolting at any of the locations simply drill a hole that is 1/16" larger than the bolt size(s) for those locations.

Once you have drilled the holes into the vehicle, the raw metal edges should be sealed using a self-etching primer to resist corrosion and potential fastener point failure.

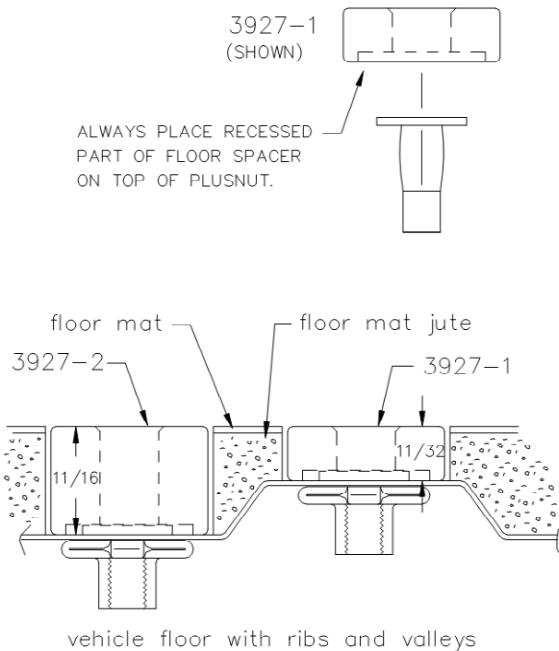

A PLUSNUT (RIVNUT) SETTING TOOL IS REQUIRED FOR PLUSNUT (RIVNUT) INSTALLATION . PLUS NUT SETTING TOOL CAN BE ORDERED THROUGH ADRIAN STEEL, OR USE AN AIR POWERED PLUSNUT SETTING GUN.

1/4-20UNC Plusnut (FAS0052) Use 3/8" dia. drill w/stop

FAS0080 SCREW, HXHD, 1/4-20UNCx2.00", G8
FAS0067 WASHER, FLAT, 1/4"ID
22200-0 PLUSNUT TOOL

5/16-18UNC Plusnut (FAS0091) Use 1/2" dia. drill w/stop

FAS0095 SCREW, HXHD, 5/16-18UNCx2.00", G8
FAS0086 WASHER, FLAT, 5/16"ID
22200-0 PLUSNUT TOOL

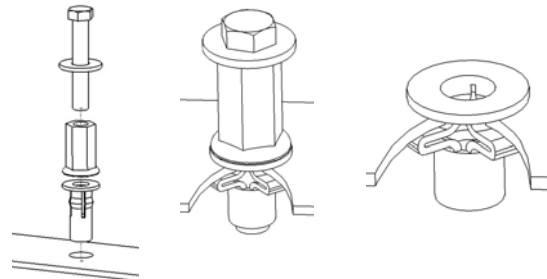

Place barrel of the plusnut body in sheet metal thru hole until flange is flush with sheet metal.

Using a 9/16" combination wrench of plusnut tool body and a second hand wrench, ratchet, or air tool, rotate the hex bolt head CW to draw plus nut flanges up (set the plusnut).

**Installation and/or Assembly Fasteners
BAGPARSPH**

ITEM NO.	PART NUMBER	DESCRIPTION	QTY.
1	BAG0709-A	7" x 9" 3MIL AUTOBAG	1
2	55691	WASHER, 3" X 0.875" X 12GA SS	5
3	FAS0018	SCREW, HH SFLNG 1/4-20X.62 ZP	4
4	FAS0052	PLUSNUT, 1/4-20 PB DC	5
5	FAS0078	SCREW, HH 1/4-20X1 G8 ZP	5
6	FAS0085	WASHER, LCK EXT 5/16 ZP	13
7	FAS0098	Washer, Lock, Split, 5/16, Zinc Plate	14
8	FAS0248	Nut, Nylon Insert Lock, 5/16-18 SST	6
9	FAS0253	WASHER, FOAM RUBBER, 1.50X0.375X0.5	12
10	FAS0552	Washer, Flat, 5/16, SST	14
11	FAS0708	SCREW, BHCS 5/16-18X1.25ZN	12
12	FAS0711	SPRING CLIP	4
13	FAS0833	WASHER, CUP FLANGED 1.5"	7
14	36496-0	END CAP	2
15	FAS0759	U-NUT, 5/16-18 ZP	7
16	FAS0042	Screw, Truss Hd Phillips Tapping, #14-10x1.00 (A)	8

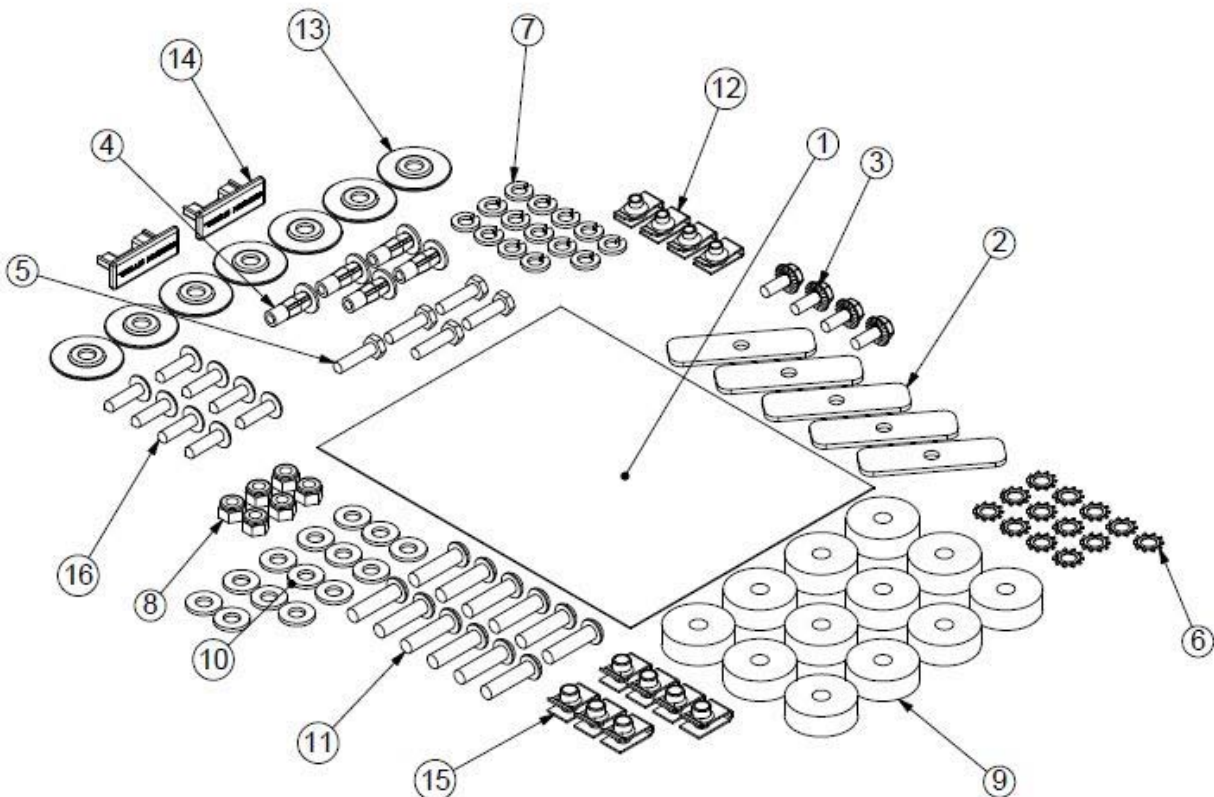

Step 01 VEHICLE PREP: HEAD IMPACT FOAM INSERT AND B PILLAR MODIFICATIONS

NOTE: If your 2007 Sprinter, either Standard or High Roof models, comes with a factory installed partition and you plan on installing an Adrian Steel Composite partition you **MUST** order from your Dodge dealership the head impact foam inserts for your particular Sprinter van model.

NOTE: The standard roof 2007 Sprinter vans **DO NOT REQUIRE** Head Impact Foam Insert modifications.

NOTE: The high roof 2007 Sprinter vans **REQUIRE** Head Impact Foam Insert modifications. Rework involves removing inserts from the vehicle, removing foam material (as shown below), and then re-installing inserts back into the vehicle. In addition, reworking of the Street side foam insert results in exposing of the wire harness running along the top street side wall section.

2007 SPRINTER HIGH ROOF HEAD IMPACT FOAM INSERT MODIFICATIONS:

STEP 01A: For the street side measure 6.25" from the cab area headliner and mark foam as shown in the left side photo below. Repeat procedure for the curb side foam insert.



STEP 01B: Next remove the inserts by pulling down on the inserts removing the Velcro attachment pads. The molded foam inserts have features that partial wrap around each "B" pillar, these features will break off during removal, discard this broken off section.

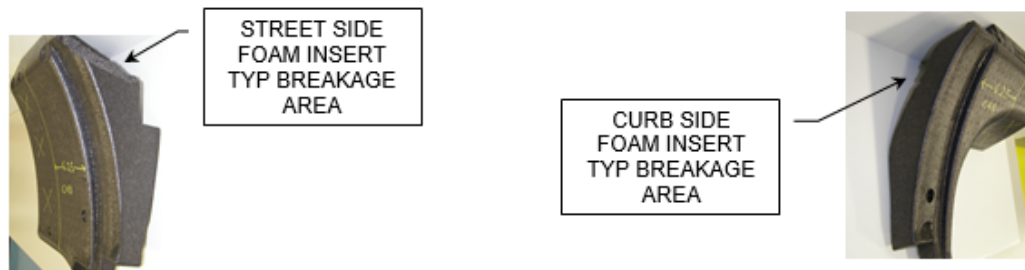

STEP 01C: Cut foam along previously marked lines (from STEP 01A) and re-install modified foam insert back in vehicle as shown below. Photographs below show inserts reinstalled in vehicle.



2007 SPRINTER HIGH ROOF B-PILLAR MODIFICATIONS:

NOTE: On 2019 and newer Sprinter models, the B-Pillar trim will need to be modified by removing the rear portion on both sides of the van. This will allow access to sheet metal underneath the trim and a stable mounting point for the Mounting Hardware of the partition.

See YouTube videos for process instructions:

<https://vimeo.com/390504035/4b1156f73a>



Step 02A: Remove D-Rings located at the bottom of the B-Pillar using a power drill and a torque bit. Save as these will be used later.

Step 02B: Using masking tape, create a cutting line ensuring one side of the tape is along the edge before it transitions to a radius. Tape will contour and follow the radius all the way down the B-Pillar.



Step 02C: Cut along tape using a high speed oscillating tool. It is recommended using a circular saw blade for minimal debris. After cut is made, the rear portion of the B-Pillar can easily be removed.



Picture is for reference. Once rear portion is removed it will look similar to this.

Carbide Circular Saw Blade for minimal debris



Step 02D: Using a box cutter or deburring tool, cut away the excess plastic pieces and use a vacuum to clean them from the floor of the van. It is important the plastic debris is never cleaned with an air hose, this could lead to plastic lodged into the seatbelt mechanism and cause safety issues.

Step 03 Remove OEM “D” Rings from the bottom of the “B” Pillar, Use a T-45 Torx Bit.

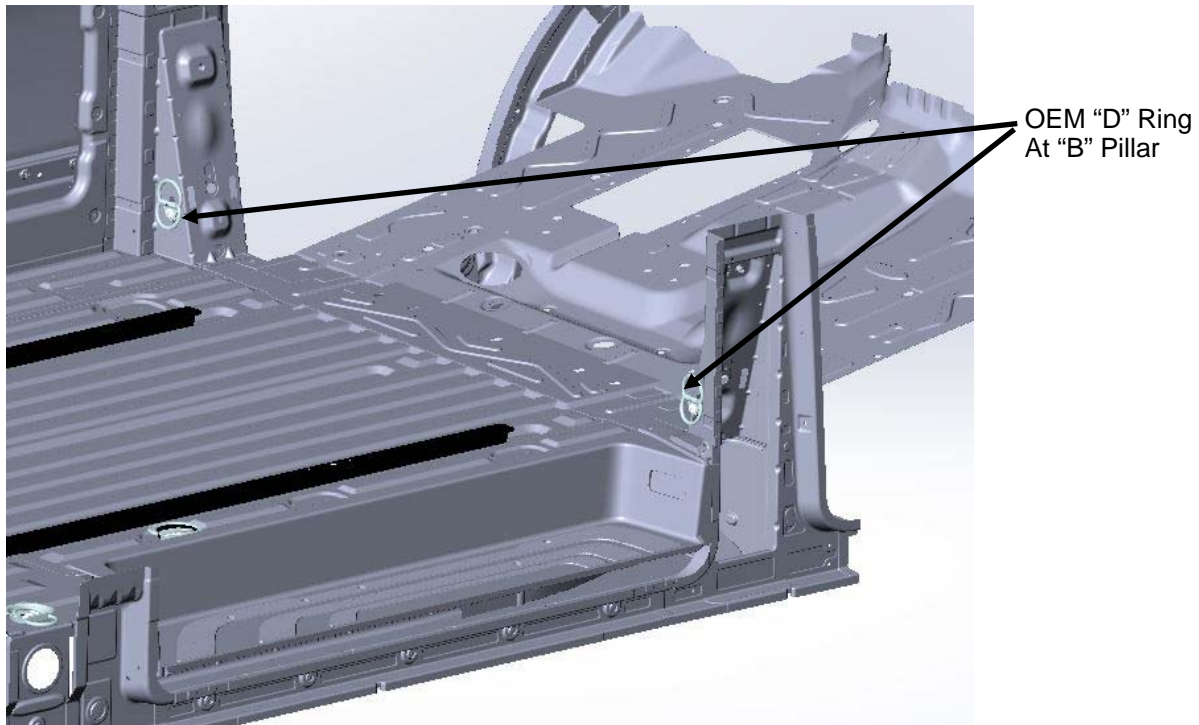

Step 04 Mount Footer Rail to Vehicle using OEM D-Rings.

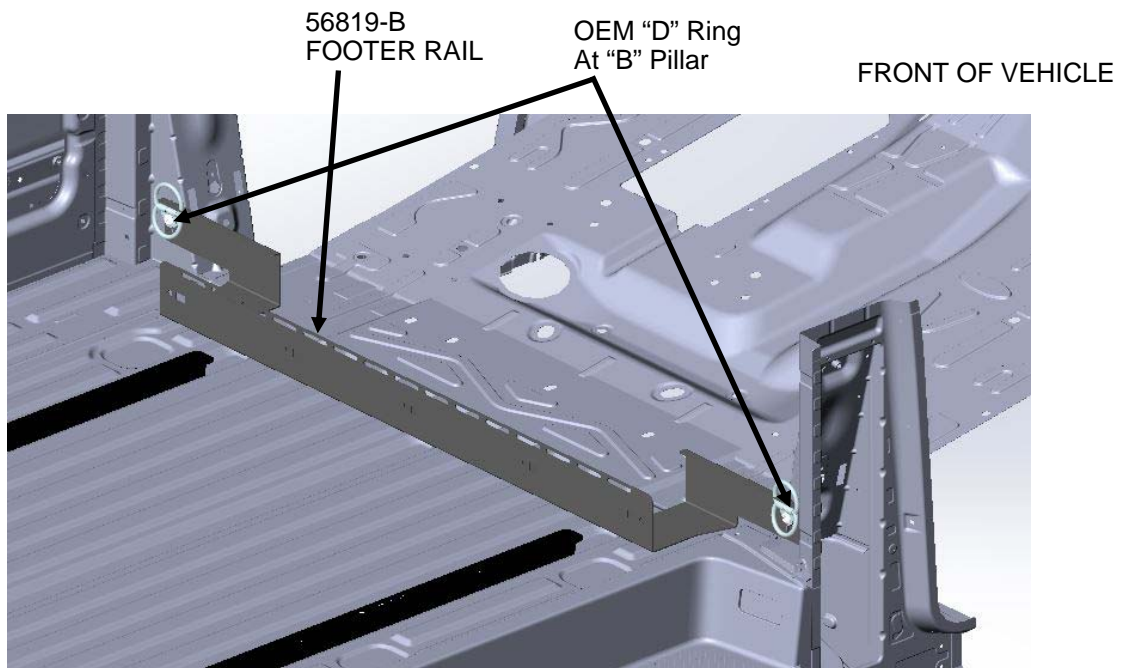

Step 05 Add Spring Clips to Footer Rail. (5) will install with the threaded portion towards the front of the van and (2) will install with the threaded portion facing towards the rear of the vehicle in the 5th and 9th slots from the passenger side as shown.

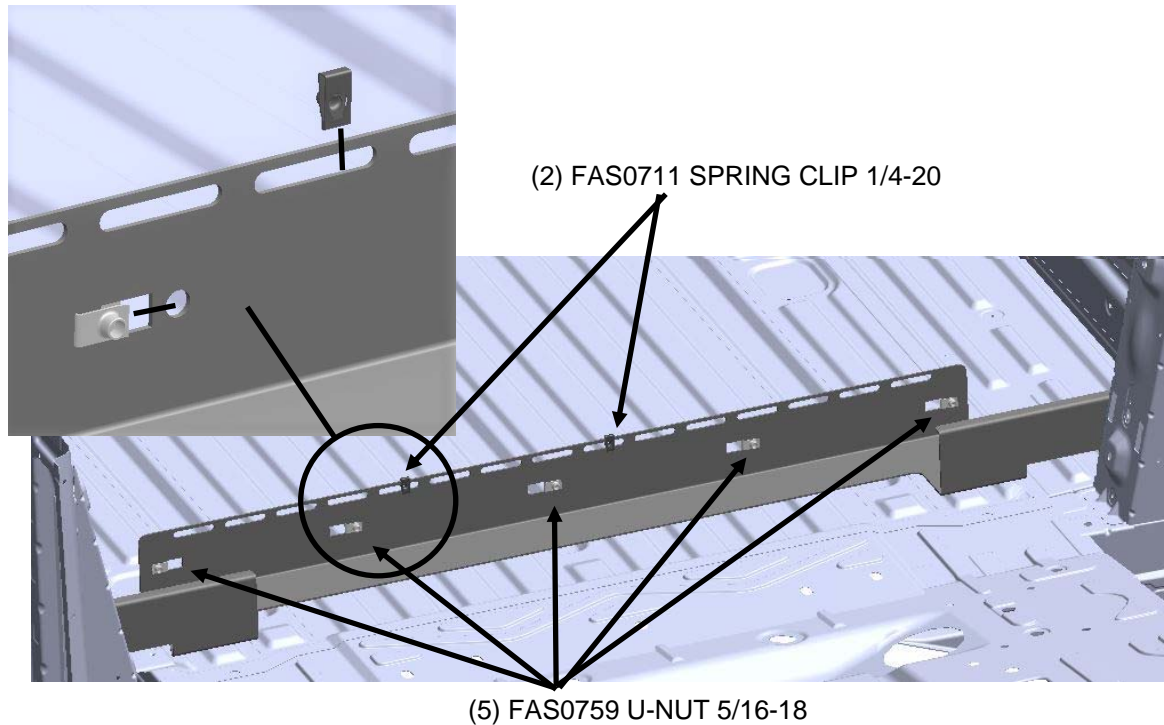

Step 06 Mount the Mounting Bracket as shown below using the existing OEM holes on Driver Side "B" Pillar.

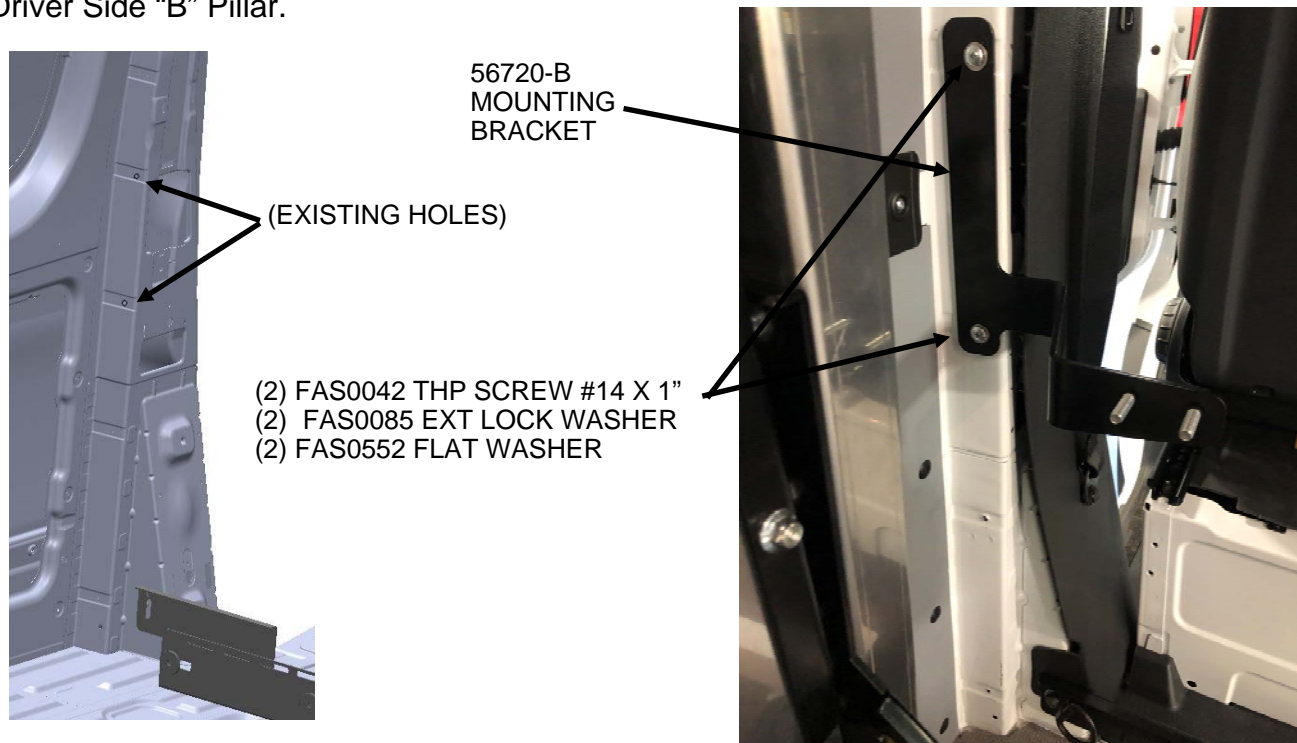

Step 07 Mount the Mounting Bracket as shown below using the existing OEM holes on Passenger Side "B" Pillar.

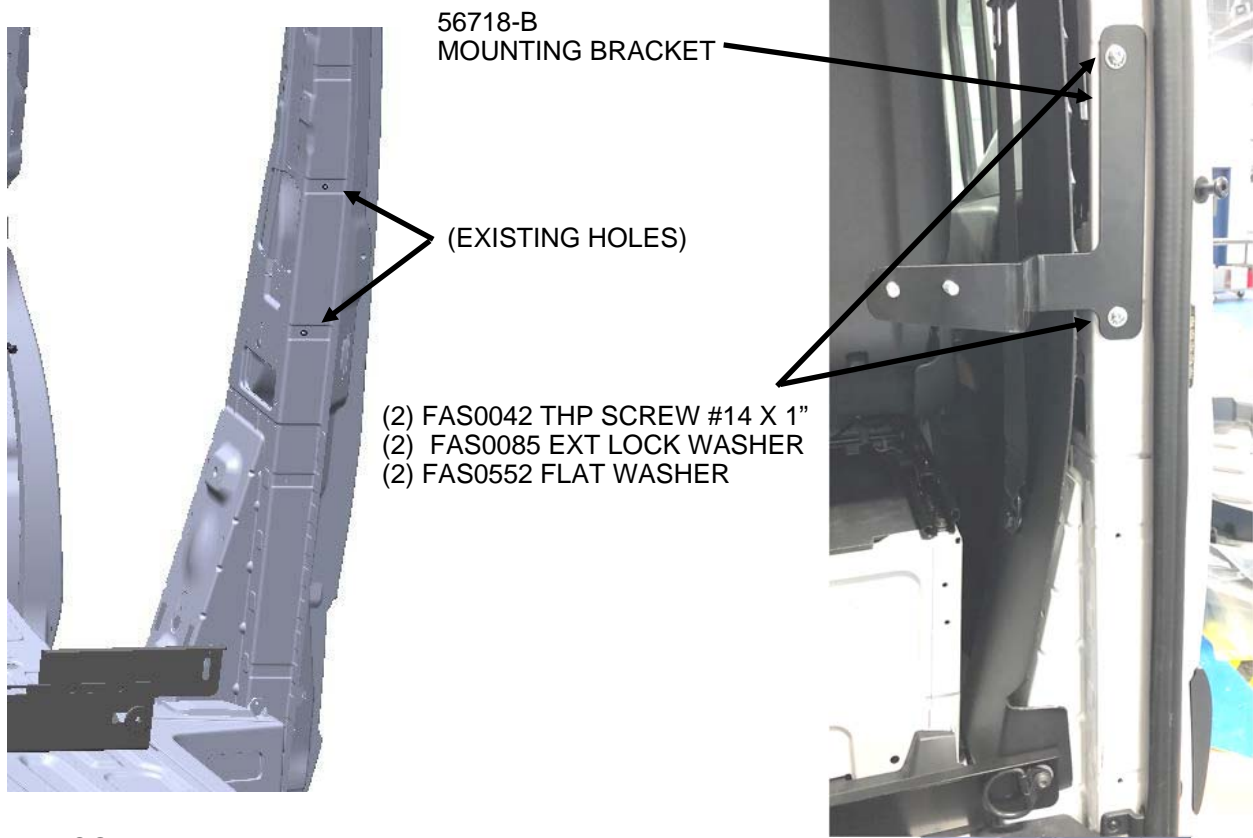

Step 08 Attach Cross Channel to Brackets. The end of the Cross Channel with Holes instead of slots will mount to the Drivers Side Bracket as shown.

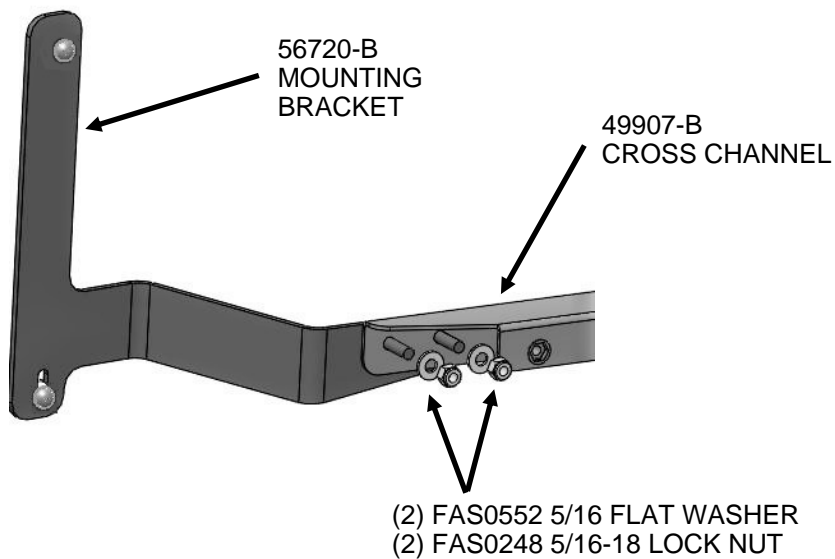

Step 09 Attach Cross Channel to Brackets. The end of the Cross Channel with Slots will mount to the Passengers Side Bracket as shown.

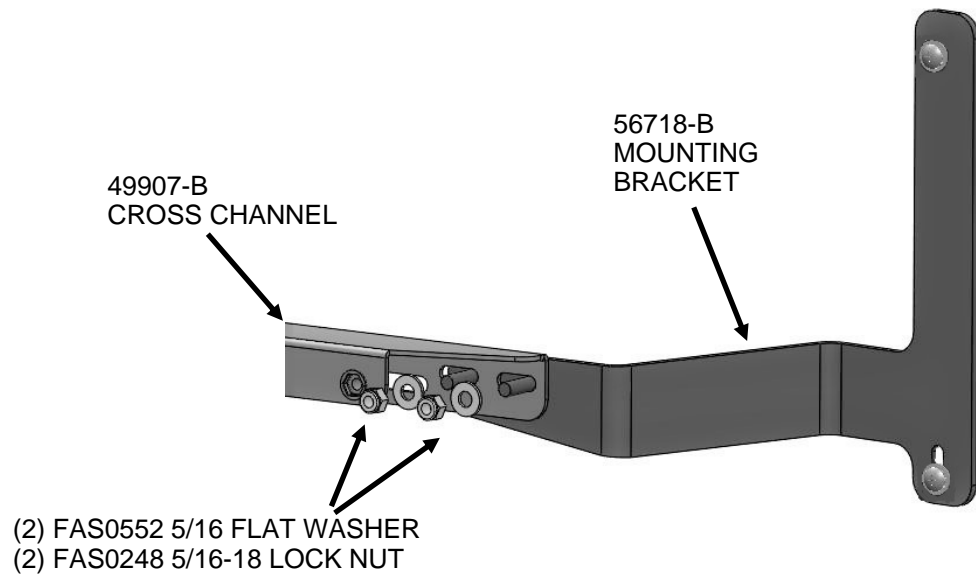

Step 10 Add Spring Clips to Cross Channel with the threaded portion facing towards the rear of the vehicle in the 6th and 10th slots from the Passenger Side as shown.

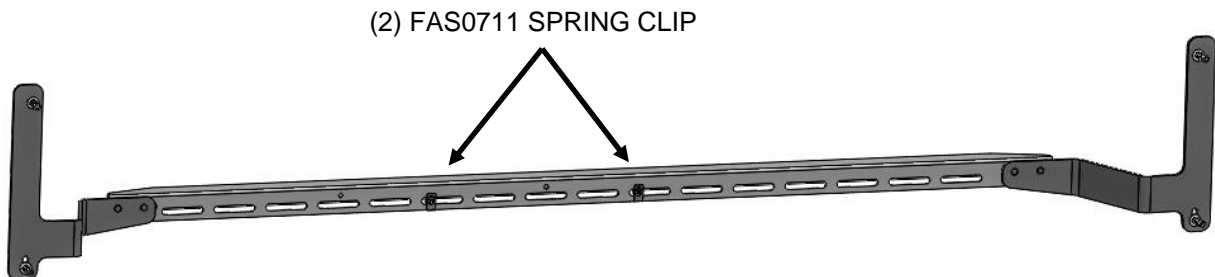

Step 11 Attach Accessory Mounting Channels as shown.

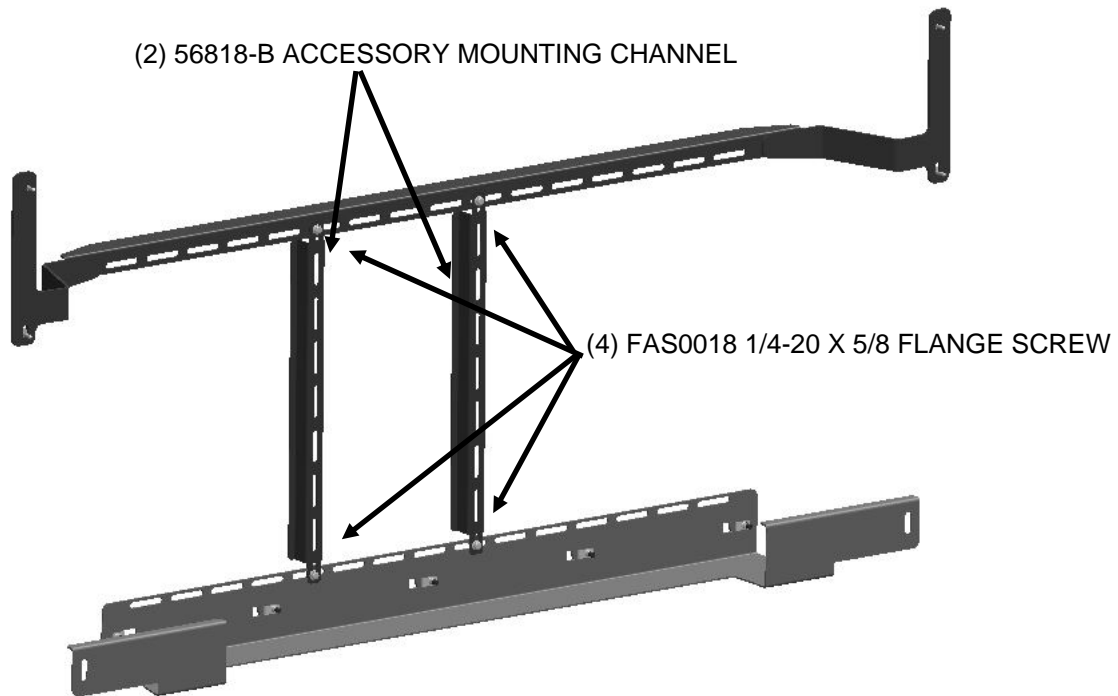

Step 12 The Next few steps are for High Roof Vans Only! If you have a Low Roof Van you can Skip to STEP 14. Mount the Header Bracket as shown below using the existing OEM holes on Passenger Side "B" Pillar.

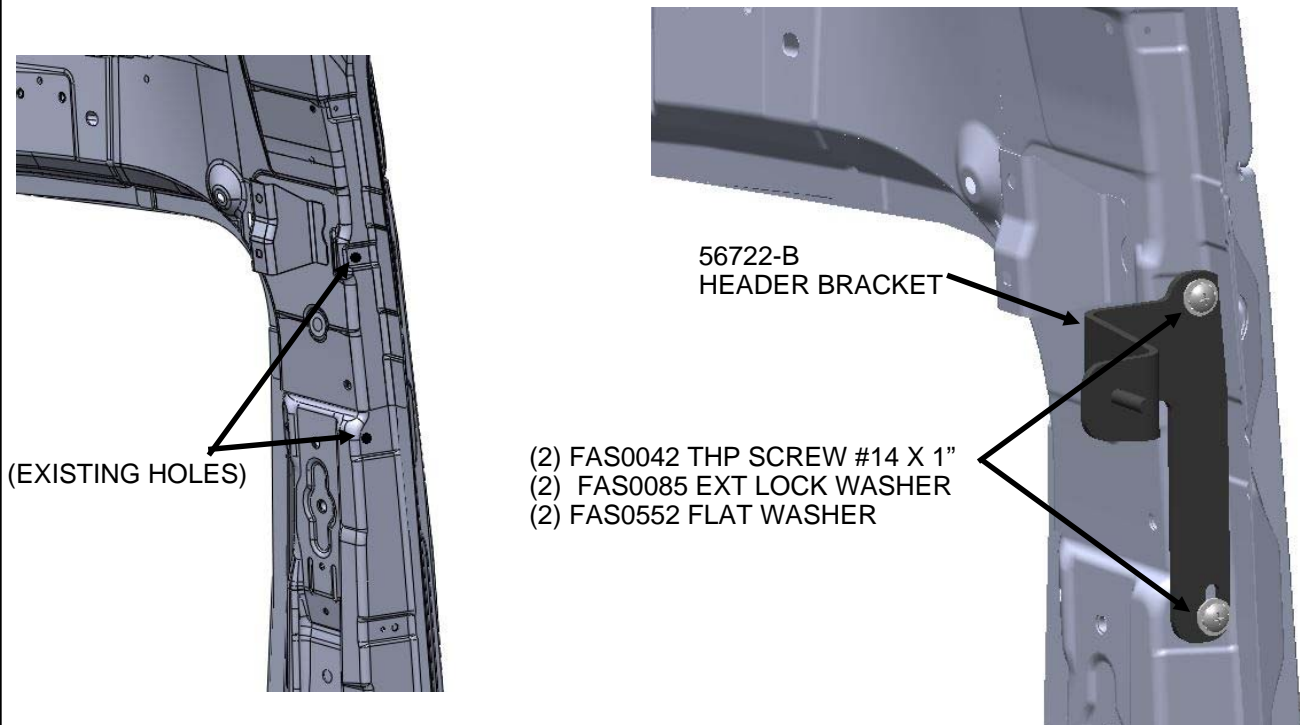

Step 13 Mount the Header Bracket as shown below using the existing OEM holes on Drivers Side "B" Pillar.

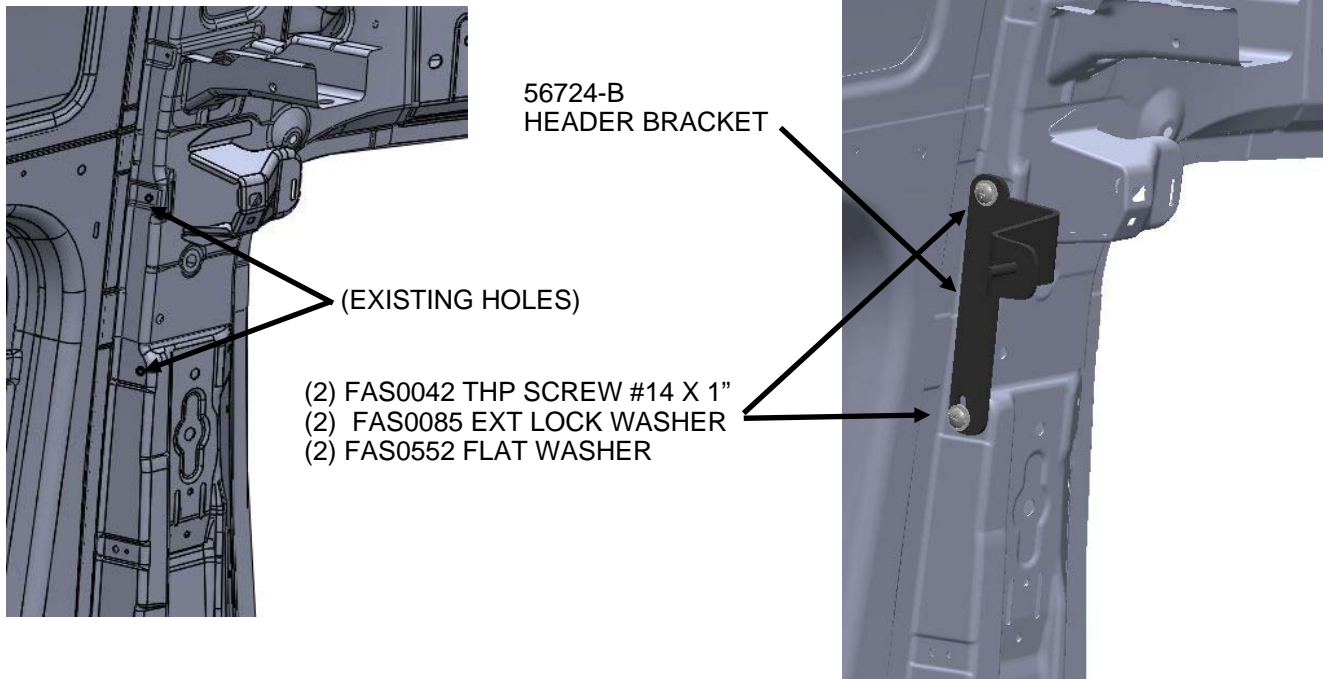

Step 14 Set Composite Panel in Place against the Footer Rail and Cross Channel, Push the upper section up against the roof bow.

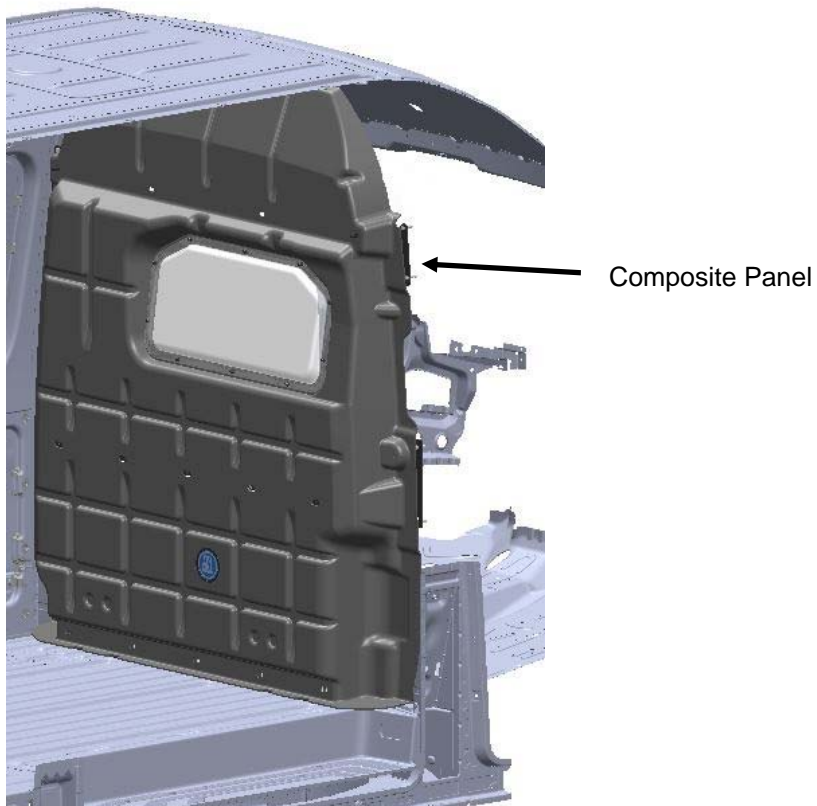

Step 15 For High Roof Make sure the Threaded Studs from the Header Brackets come through the Mounting Slots. For Low Roof Align the Center Slots with the holes in the Cross Channel. Mark (5) locations, Remove the Panel and Drill 3/8" Dia. Holes using a Drill with Drill Stop, and Set (5) 1/4-20 Plusnuts in these locations.

(5) FAS0052 1/4-20 PLUSNUT

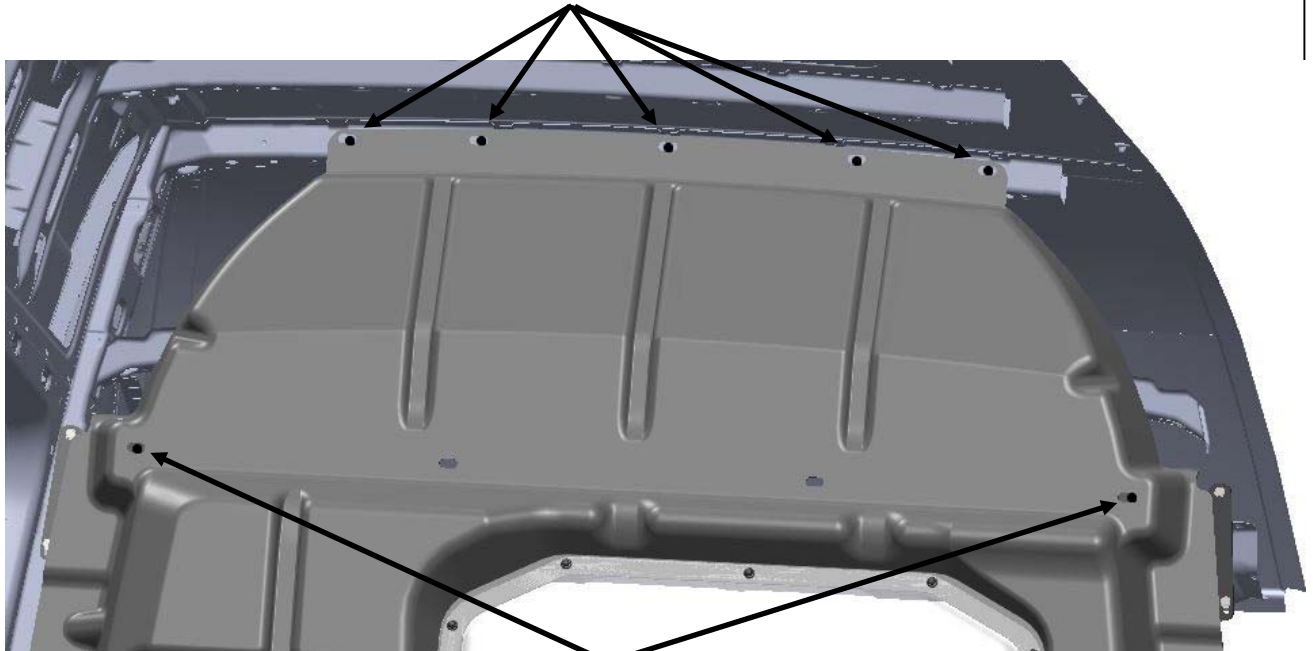

THREADED STUDS

Step 16 Attach Bulb seal to Partition Panel as Shown down one side of the partition. Cut the Excess Seal off and attach the rest of it to the other edge as shown.

49913 BULB SEAL

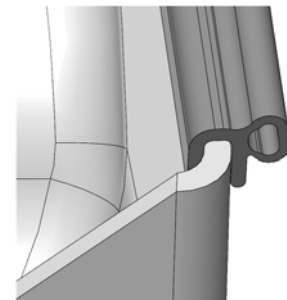
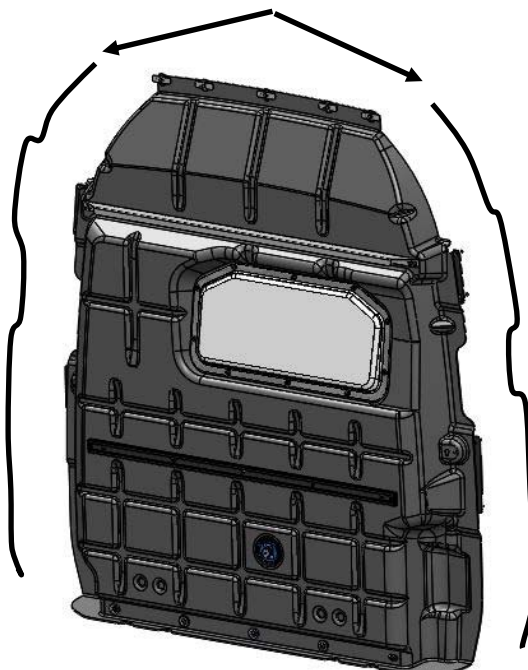

**BULB FACING
THIS DIRECTION
TOWARDS
B-PILLAR TRIM.**

Step 17 For High Roof Vans Only, Attach Threaded clips to Upper Cross Channel on the center 2 holes only, with the threaded portion towards the inside of the channel as shown.

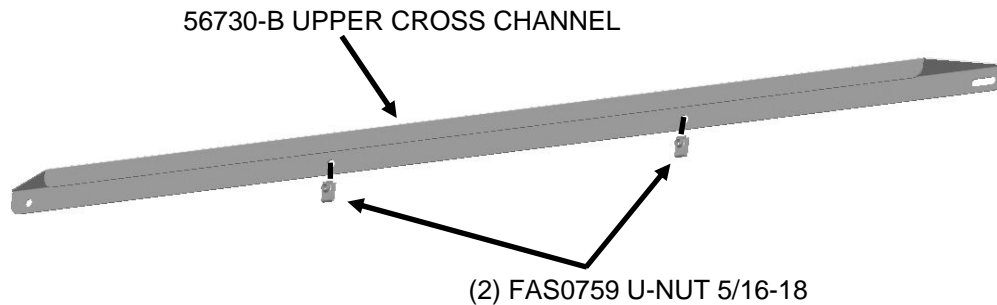

Step 18 Place Composite Panel back in vehicle and up against the Cross Channel and Footer Rail. For High Roof Vans make sure the threaded studs come through the two slots and fasten as shown below.

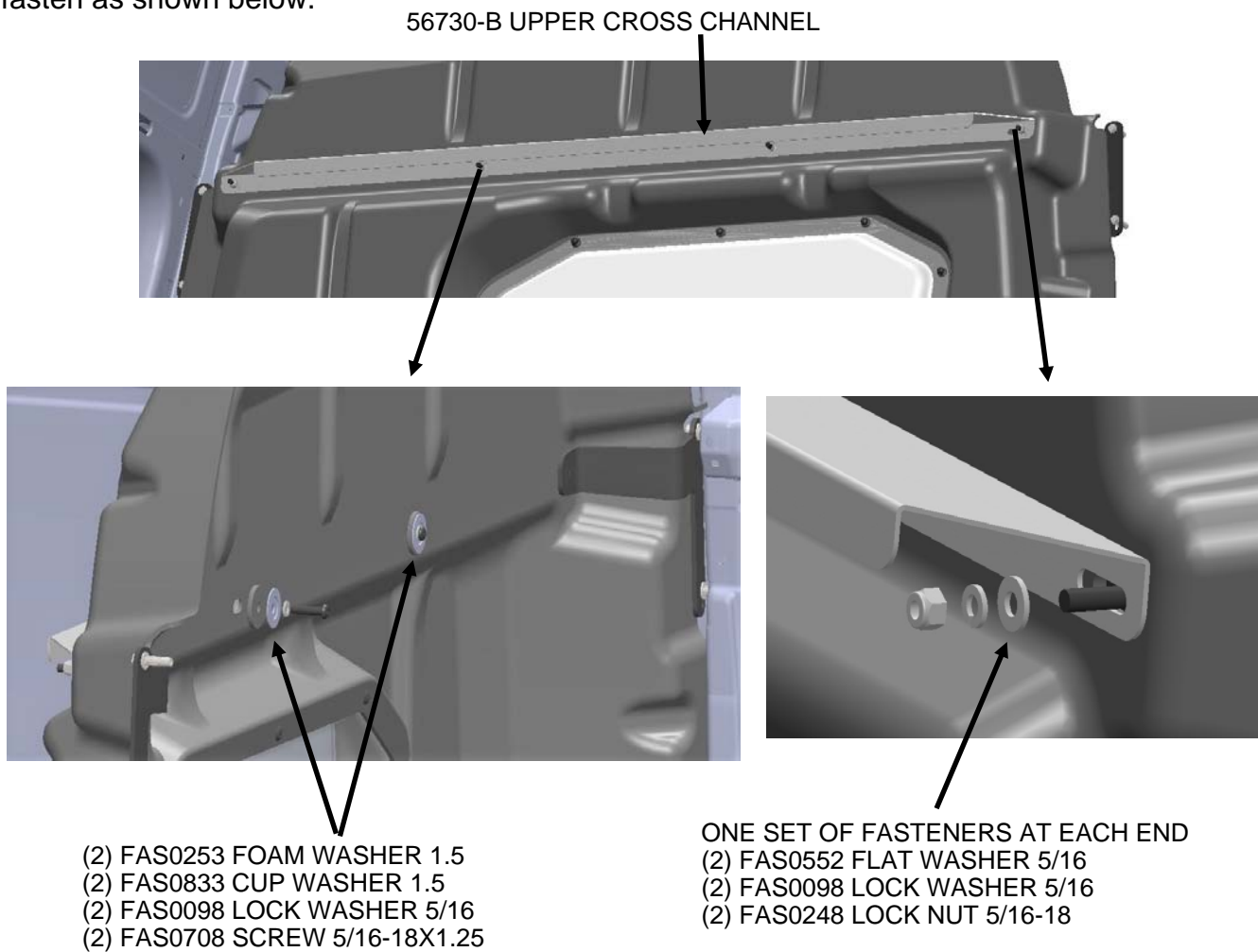

Step 19 Attach Composite Panel to the Cross Channel with the AD Rail.

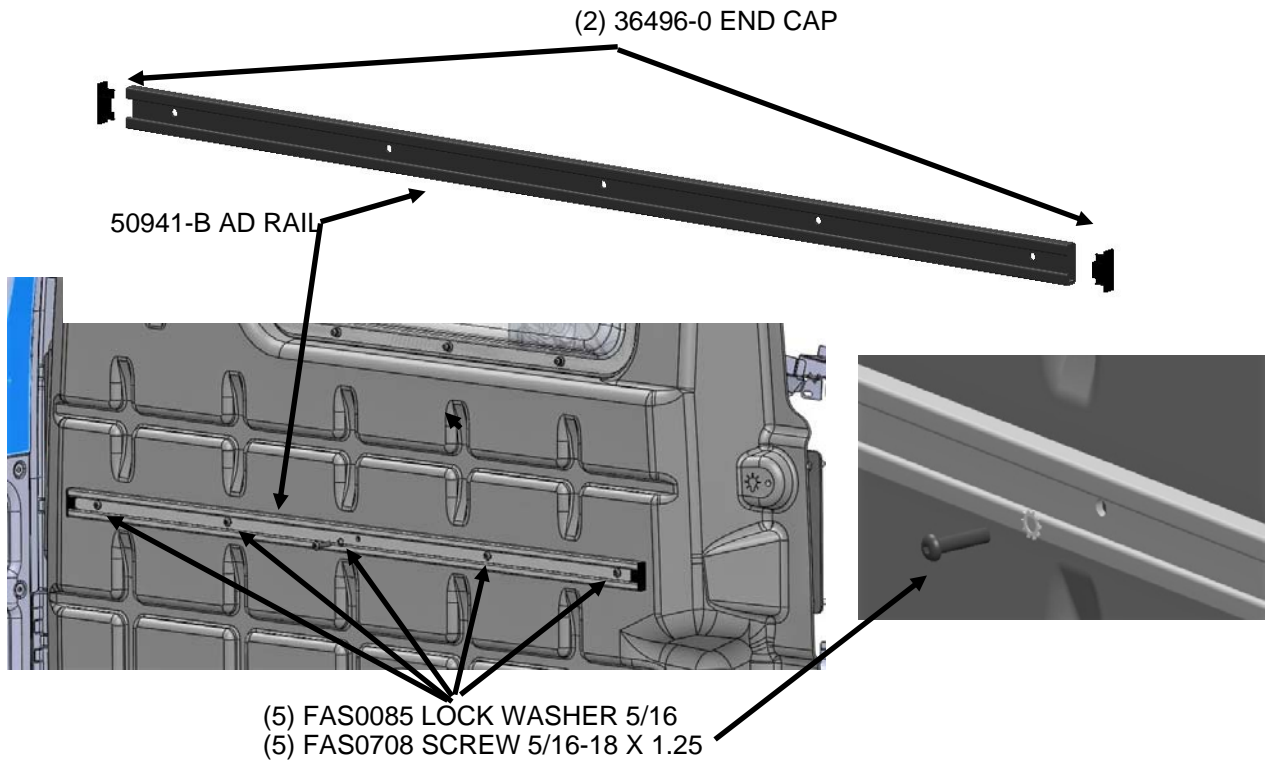

Step 20 Attach the Composite Panel to the Roof Bow with the Plusnuts that you previously set.

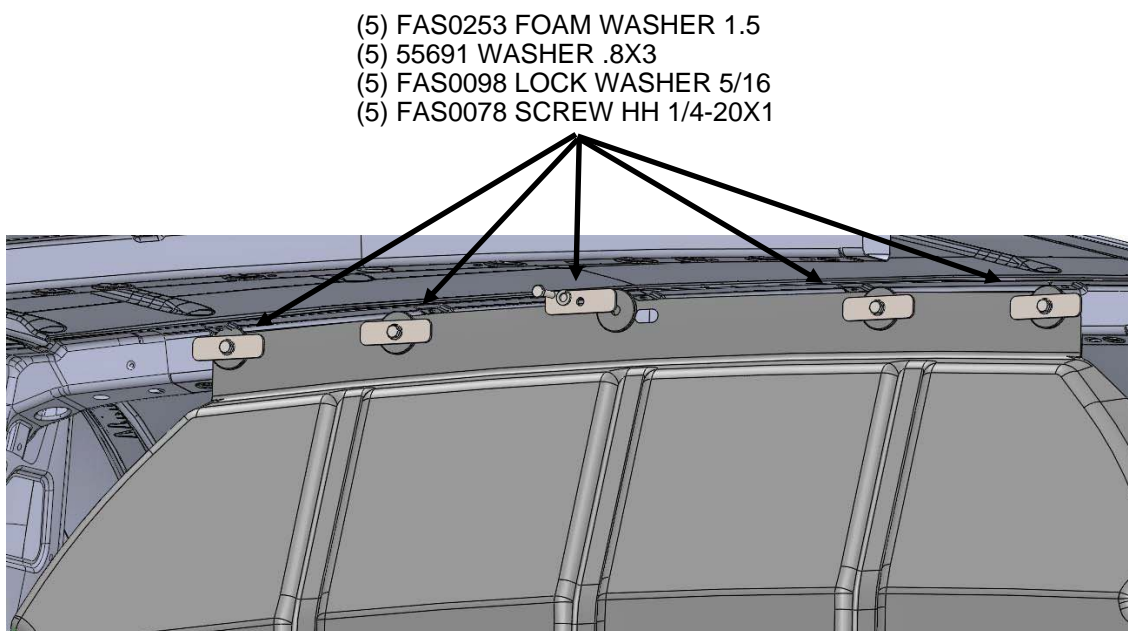

Step 21 Attach the Composite Panel to the Footer Rail as shown below.

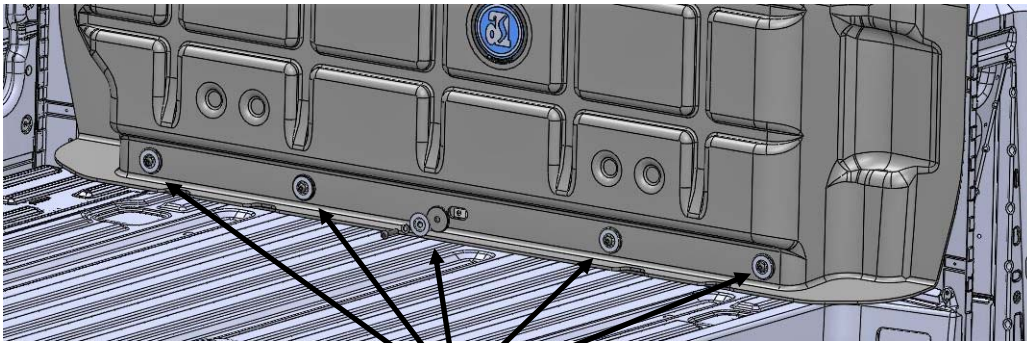

- (5) FAS0253 FOAM WASHER 1.5
- (5) FAS0833 CUP WASHER 1.5
- (5) FAS0098 LOCK WASHER 5/16
- (5) FAS0708 SCREW 5/16-18X1.25

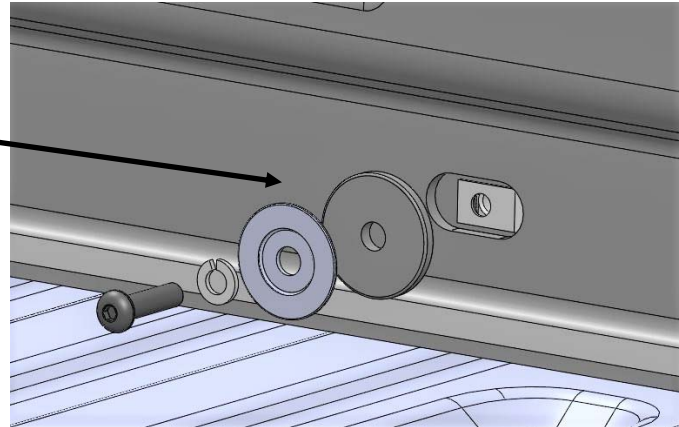

**DOUBLE CHECK ALL FASTENER LOCATIONS TO BE SURE THAT ALL
FASTENERS ARE TIGHTENED.
YOUR INSTALLATION IS NOW COMPLETE!
STOW THIS COPY IN THE VEHICLE FOR FUTURE REFERENCES!**