

## PROMASTER PARTITION LOW AND HIGH ROOF

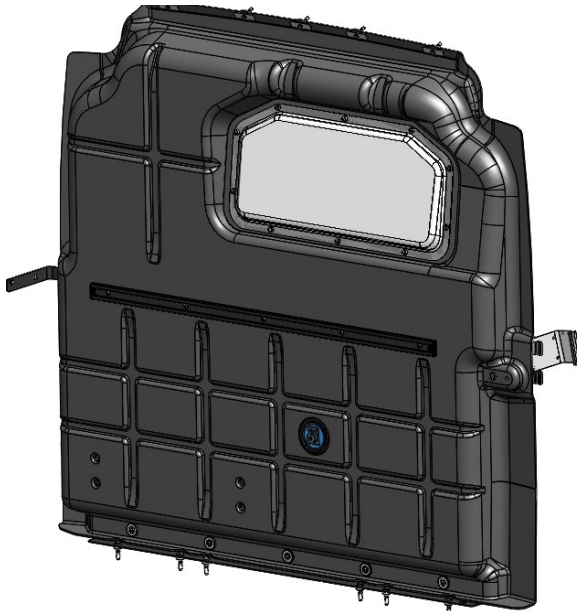

PRODUCT WEIGHT

**109 LBS**

WIDTH x DEPTH x HEIGHT

**70.5" X 6.75" X 66"**

CAPACITY

**N/A**

COLOR

**BLACK**

CATALOG NUMBER

### PRODUCT FEATURES

### PARPM

Composite partition for Promaster low, high and super roofs provides a semi-sealed solution for separating the cab area from the cargo area. The composite partition features a full perimeter bulb seal that seals off the majority of the airflow from the cab area to the cargo area. This feature provides better climate control for the cab area and reduces noise transfer from the cargo area to the cab area.

\*\* This will NOT work with the High Headliner Option \*\*

\*\* This will NOT work with dual side sliding door option \*\*

### Driver Comfort Details

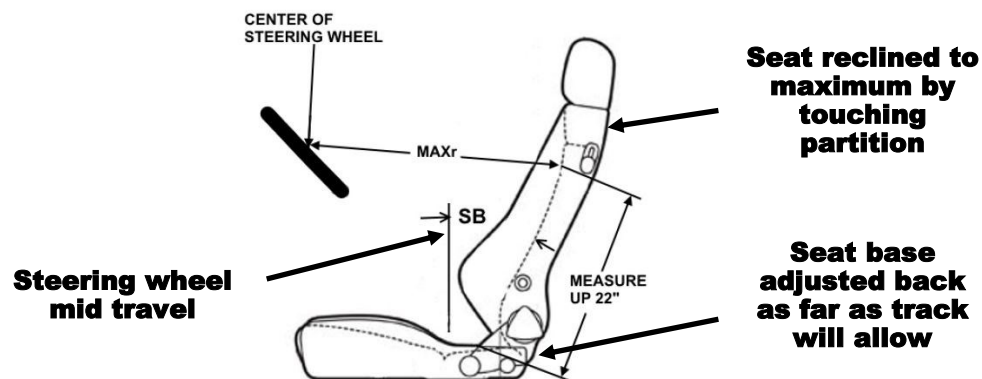

	DESCRIPTION	DIMENSION
SB	SEAT BACK ANGLE	<b>16 degrees</b>
MAXr	MAXIMUM DRIVER REACH	<b>30"</b>

SEE PAGE 2 FOR APPLICATION NOTES AND ACCESSORIES, OTHER PRODUCTS THAT WORK WITH THIS UNIT.

## Accessory Chart

	Cargo Side			Cab Side		
	<b>Base Partition</b> BAGRKA1 REQUIRED (1 BAGRKA1 will allow for one accessory to be added)	<b>PARHDW Fastener Kit</b> Allow accessories to be added directly mounted to partition	<b>PARFTMCRG</b> (mounting kit cargo side)	<b>Base Partition</b> 1/4" nuts and bolts REQUIRED	<b>PARHDW Fastener Kit</b> Allow accessories to be added directly mounted to partition	<b>PARFTMCAB</b> (mounting kit cab side)
<b>Available Accessories</b>	-	-	-	-	-	-
PA7: Reflector kit	X	X	X	X	X	X
PA8: Fire ext.	X	X	X	X	X	X
PA9: First aid tray	X	X	X	X	X	X
PA10: Practice holder			X			X
PA11: Cab file			X	X		X
PA11NL: Catalog box			X	X		X
TA1: Four hook bar			X			X
CCD10: Center console 10"						X
TDC10: Tech desk 10"						X
TH30: 30lb tank holder			X			
TH50: 50lb tank holder			X			
UH50RM1: Rail mount kit			X			X
UH10: 1" hook			X			
UH25: 2.5" hook			X			
UH25CP-G: 2.5' hook comp			X			
UH50: 5" hook	X		X			

**PARFTMCRG (shown in yellow)**  
 Cargo side hardware mounting kit installed

**PARFTMCAB (shown below in yellow)**  
 Cab side hardware mounting kit installed

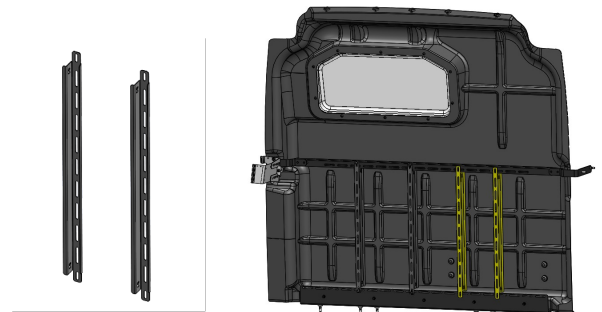

### PARHDW Fastener Kit

Fastener kits allow for installation of smaller and lighter (up to 12 lbs.) Allows accessories to be directly mounted to the partition, such as: fire extinguisher, flare kit, first aid kits, acc.

**Introduction / Comments:**

Composite partition for Promaster High and Low Roof provides a semi-sealed solution for separating the cab area from the cargo area. The composite partition features a semi-full perimeter bulb seal that seals off the majority of the airflow from the cab area to the cargo area. This feature provides better climate control for the cab area and reduces noise transfer from the cargo area to the cab area.

**Note:**

It is advised that all fasteners used in this assembly and installation should be checked for tightness at the following intervals: @ 2-weeks and again @ 6-weeks of operation. This preventive maintenance step must be completed to ensure your product gives you long service life.

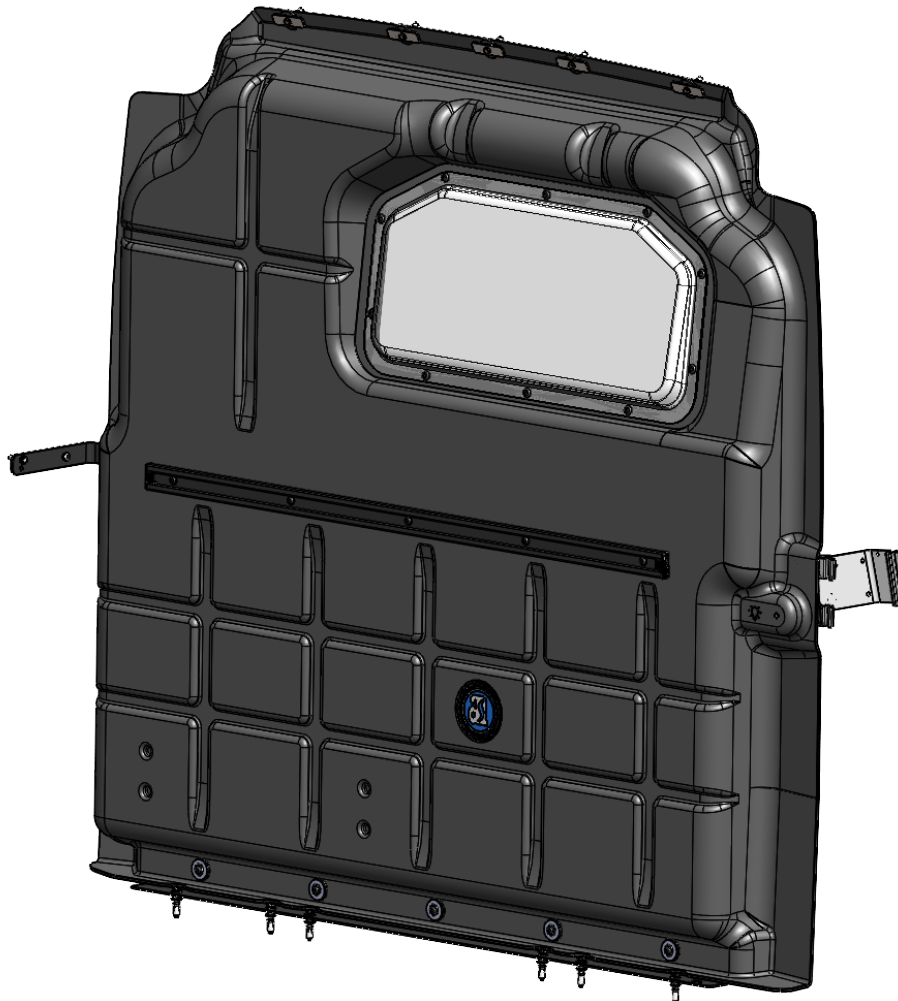

**COMP PAR, W/WDO, PM  
PARPM & PARPM-NW**

ADRIAN STEEL COMPANY • [WWW.ADRIANSTEEL.COM](http://WWW.ADRIANSTEEL.COM) • 906 JAMES STREET • ADRIAN, MI 49221 • 800-677-2726

## - PRECAUTIONS -



CAUTION



THE USE OF AIR IMPACT TOOLS CAN OVER-TORQUE FASTENERS AND CAUSE FASTENER FAILURE!



CAUTION



ALL INSTALLATION HOLES SHOULD BE SEALED WITH SILICON OR BUTYL SEALANT TO PREVENT EXHAUST FUMES FROM ENTERING THE VEHICLE!



DANGER



INSPECT FOR FUEL TANK, FUEL LINES, BRAKE LINES, HIGH VOLTAGE BATTERIES AND ELECTRICAL LINES PRIOR TO DRILLING TO AVOID DAMAGING CRITICAL VEHICLE SYSTEMS OR INJURY TO INSTALLER DURING INSTALLATION PROCESS!



CAUTION



TO AVOID DAMAGING THE VEHICLE ALWAYS USE DRILL STOPS WHEN DRILLING ANY INSTALLATION HOLES!  
ADRIAN AVAILABLE PART #'S 31119-0 (3/8" X 1/2" DEEP), 31121-0 (1/2" X 1/2" DEEP)



## - IMPORTANT WARRANTY REQUIREMENTS -

1. SUBSTITUTING ADRIAN STEEL SPECIFIED FASTENERS FOR ASSEMBLY AND/OR INSTALLATION WILL VOID YOUR PRODUCT WARRANTY.
2. ALL HOLES DRILLED INTO VEHICLE SHOULD HAVE THE RAW METAL EDGES SEALED WITH A SELF- ETCHING PRIMER TO RESIST CORROSION AND POTENTIAL FASTENER POINT FAILURE.
3. ALL FASTENERS USED IN THE INSTALLATION OF THIS PRODUCT SHOULD BE TIGHTENED TO THE TORQUE(S) SPECIFIED IN THESE INSTRUCTIONS.
4. THESE INSTRUCTIONS SHOULD BE KEPT WITH THE VEHICLE.

### THE BASIC TOOLS NEEDED FOR MOST INSTALLATIONS



DRILL



DRILL BIT WITH STOP



RATCHET, SOCKETS AND/OR WRENCHES



MEASURING TAPE



SCREWDRIVERS

ADDITIONAL TOOLS MAY BE NEEDED FOR THIS INSTALLATION AND THEY WILL BE IDENTIFIED IN THE STEPS THAT FOLLOW.

ADRIAN STEEL COMPANY • WWW.ADRIANSTEEL.COM • 906 JAMES STREET • ADRIAN, MI 49221 • 800-677-2726

If your vehicle contains carpet or a rubber floor mat you will need to prepare the mounting location. Position the product to be installed into the vehicle and once you are satisfied with the mounting locations, mark the mounting locations. Using a 1-3/16" diameter carpet cutter (P/N: 31183-0). Select the appropriate floor spacers as shown in the illustration. Set those aside for use later into the installation process. Using the correct drill bit size for the selected plusnut, drill the mounting holes in the vehicle sheet metal to prepare for installing the plusnuts. If you are thru-bolting at any of the locations simply drill a hole that is 1/16" larger than the bolt size(s) for those locations. Once you have drilled the holes into the vehicle, the raw metal edges should be sealed using a self-etching primer to resist corrosion and potential fastener point failure.

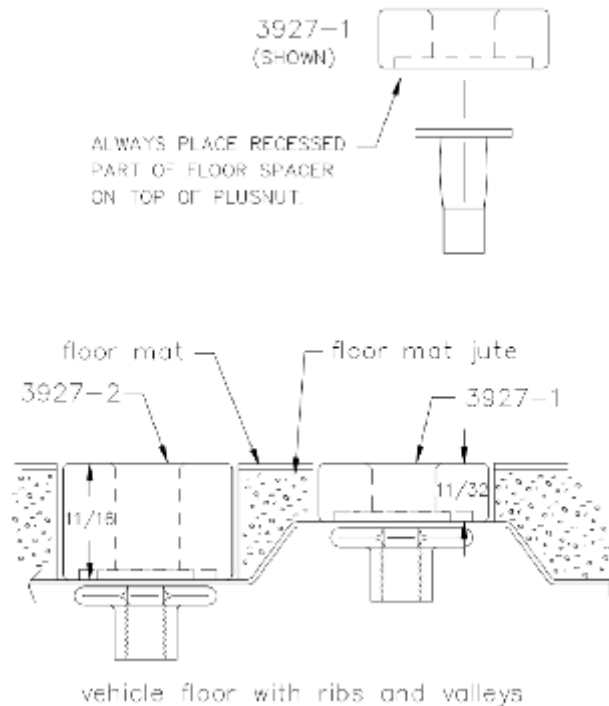

A PLUSNUT (RIVNUT) SETTING TOOL IS REQUIRED FOR PLUSNUT (RIVNUT) INSTALLATION . PLUS NUT SETTING TOOL CAN BE ORDERED THROUGH ADRIAN STEEL, OR USE AN AIR POWERED PLUSNUT SETTING GUN.

1/4-20UNC Plusnut (FAS0052) Use 3/8" dia. drill w/stop

FAS0080 SCREW, HXHD, 1/4-20UNCx2.00", G8

FAS0067 WASHER, FLAT, 1/4"ID

22200-0 PLUSNUT TOOL

5/16-18UNC Plusnut (FAS0091) Use 1/2" dia. drill w/stop

FAS0095 SCREW, HXHD, 5/16-18UNCx2.00", G8

FAS0086 WASHER, FLAT, 5/16"ID

22200-0 PLUSNUT TOOL

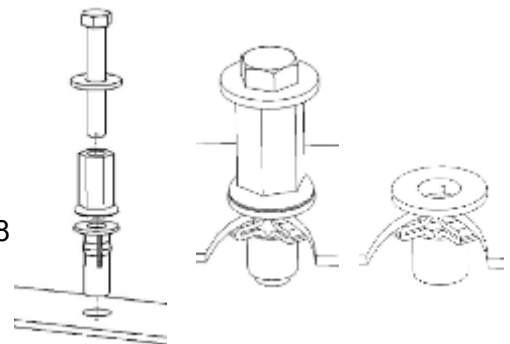

Place barrel of the plusnut body in sheet metal thru hole until flange is flush with sheet metal.

Using a 9/16" combination wrench of plusnut tool body and a second hand wrench, ratchet, or air tool, rotate the hex bolt head CW to draw plus nut flanges up (set the plusnut).

**Installation and / or Assembly Fasteners**  
**BAG54296**

ITEM NO.	PART NUMBER	DESCRIPTION	QTY.
1	BAG0709-A	7" x 9" 3MIL AUTOBAG	1
2	FAS0018	SCREW,HH SFLNG 1/4-20X.62 ZP	4
3	FAS0052	PLUSNUT, 1/4-20 PB DC	6
4	FAS0078	SCREW,HH 1/4-20X1 G8 ZP	1
5	FAS0079	Screw, Hex Hd, 1/4-20x1.50 Zn Plate, Grade 8	5
6	FAS0091	Plusnut, 5/16	6
7	FAS0095	Screw, Hex Hd, 5/16-18x2.00 , Grade 8	6
8	FAS0098	Washer, Lock, Split, 5/16, Zinc Plate	8
9	FAS0248	Nut, Nylon Insert Lock, 5/16-18 SST	6
10	FAS0253	WASHER, FOAM RUBBER, 1.50X0.375X0.5	10
11	FAS0552	Washer, Flat, 5/16, SST	12
12	FAS0575	Washer, Lock Split 3/8 SS	1
13	FAS0577	Screw, Button Hd Hex Soc, 3/8-16x1.50 NI-ZN	1
14	FAS0668	Screw, Button Hd Hex Soc, 5/16-18X.75, SS	2
15	FAS0708	SCREW,BHCS 5/16-18X1.25ZN	10
16	FAS0711	SPRING,CLIP 1/4-20 BK PH	4
17	FAS0741	Screw, Button Hd Hex Soc, M8-1.25 X 30	1
18	FAS0833	WASHER, CUP FLANGED 1.5"	5
19	FAS0085	WASHER,LCK EXT 5/16 ZP	5
20	FAS0123	Washer, Lock, Ext. Tooth, 1/4, NI ZN	5
21	55691	WASHER,3" X 0.875" X 12GA SS	5
22	36496-0	END CAP, RAIL EXTR #2	2
23	03927-1	SPACER,FLR,1010,11/32 ZP	6

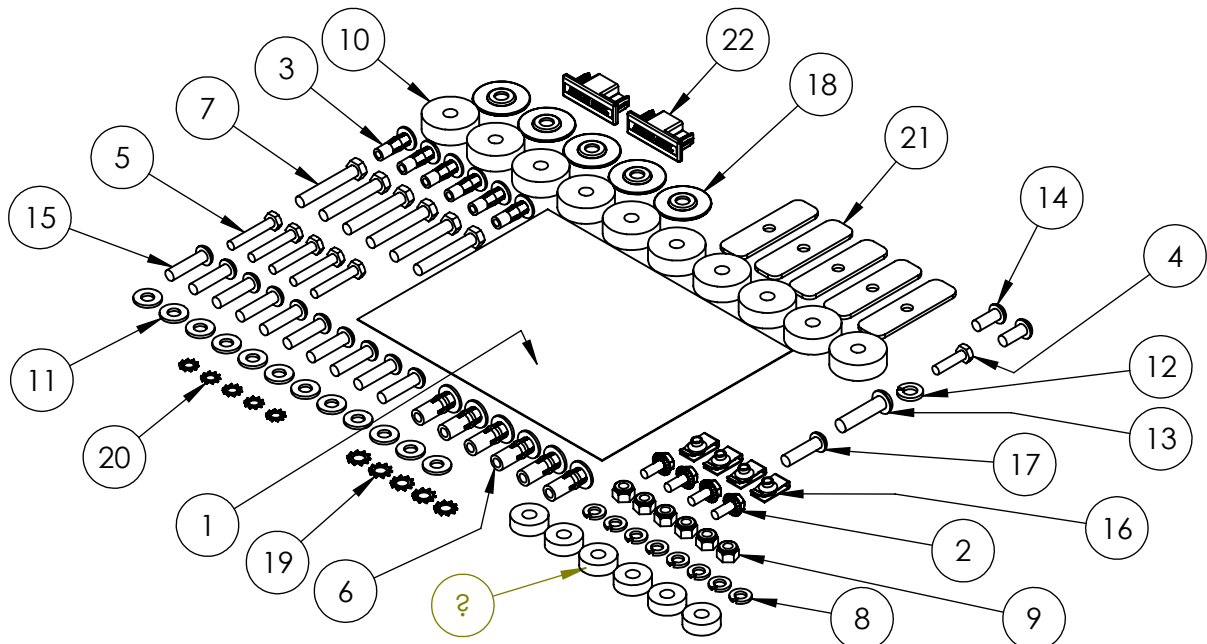

ADRIAN STEEL COMPANY • WWW.ADRIANSTEEL.COM • 906 JAMES STREET • ADRIAN, MI 49221 • 800-677-2726



## Step 01

If your vehicle contains carpet or a rubber floor mat. Place footer rail in place shown and mark six (6) hole locations. Use a 1-3/16" hole saw (part # 31183-0) at the marked locations. Cut through the floor mat, but NOT the floor. (Or use previously validated drill jig)

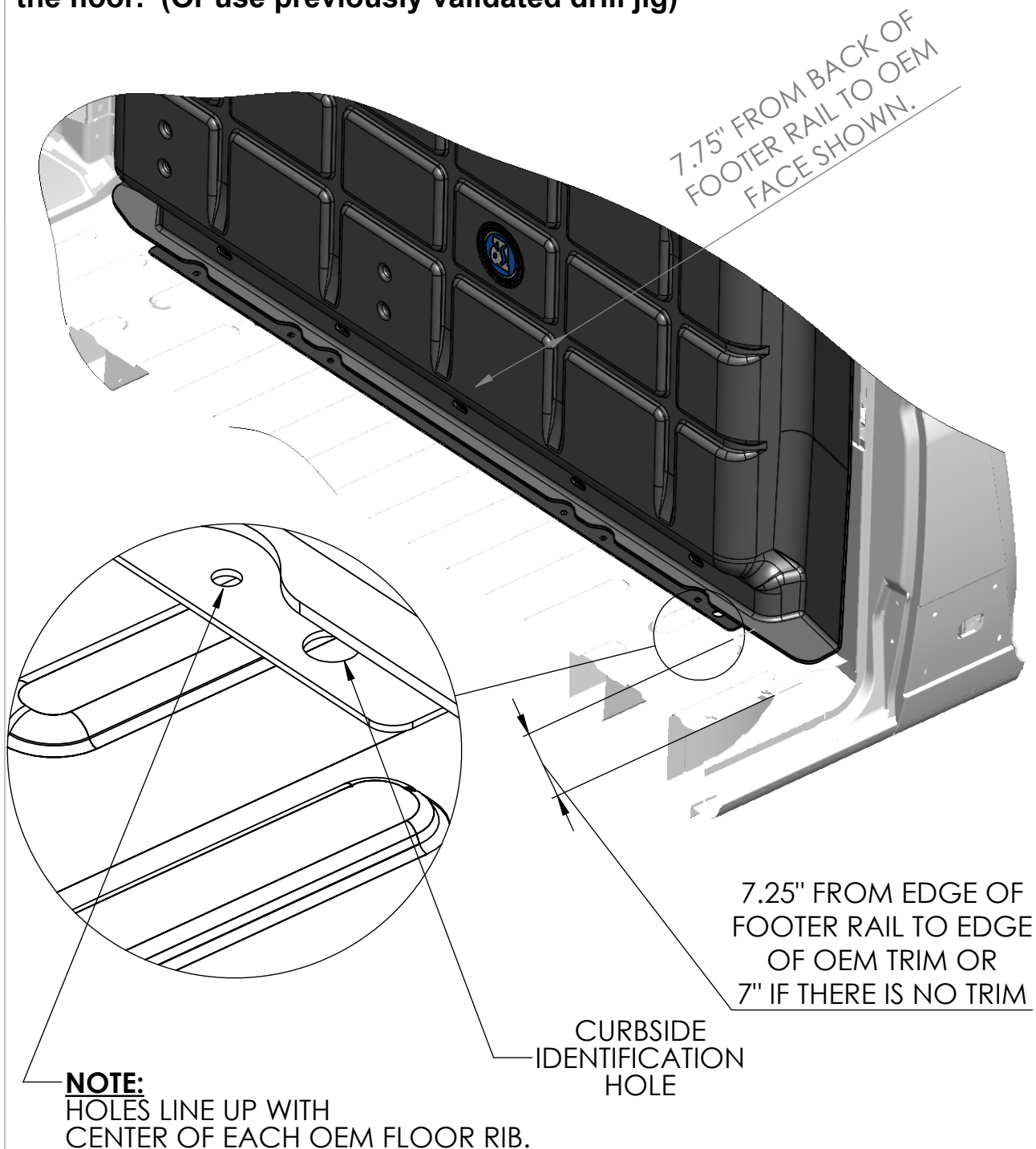

## Step 02

Place footer rail in place shown and mark six (6) hole locations. Use a 1/2" drill bit with a stop at each marked locations. (Or use previously validated drill jig) Apply primer to all drilled holes and set all six (6) plusnuts.

HOLE MUST BE  
CENTERED IN  
FLOOR RIB.

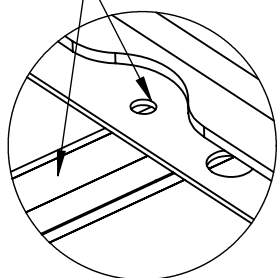

7.25" FROM EDGE OF  
FOOTER RAIL TO EDGE  
OF OEM TRIM OR  
7" IF THERE IS NO TRIM

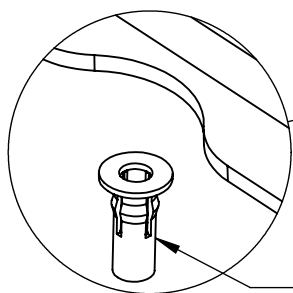

FAS0091  
x 6

7.75" FROM BACK OF  
FOOTER RAIL TO OEM  
FACE SHOWN.



### Step 03

Place six (6) spacers over plusnuts. Fasten the footer rail to the vehicle as shown. Attach two spring clips to the footer rail in the 5th and 9th slots from the curbside. Threaded portion facing the flange side of the footer rail as shown.

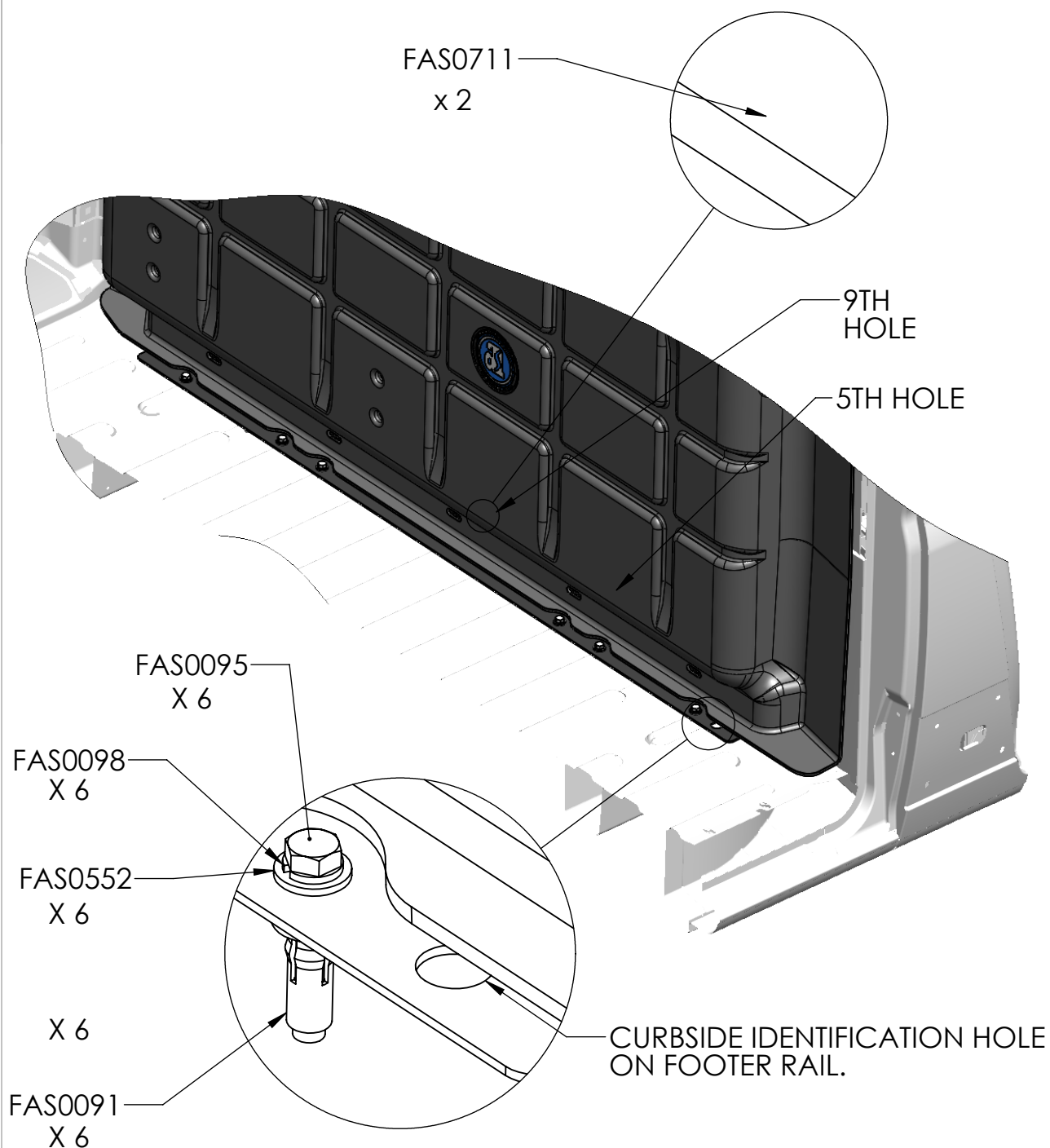

## Step 04

Using a utility knife carefully trim away the back edge of the headliner as shown to expose the roof bow mounting area for the partition header.

**BEFORE**

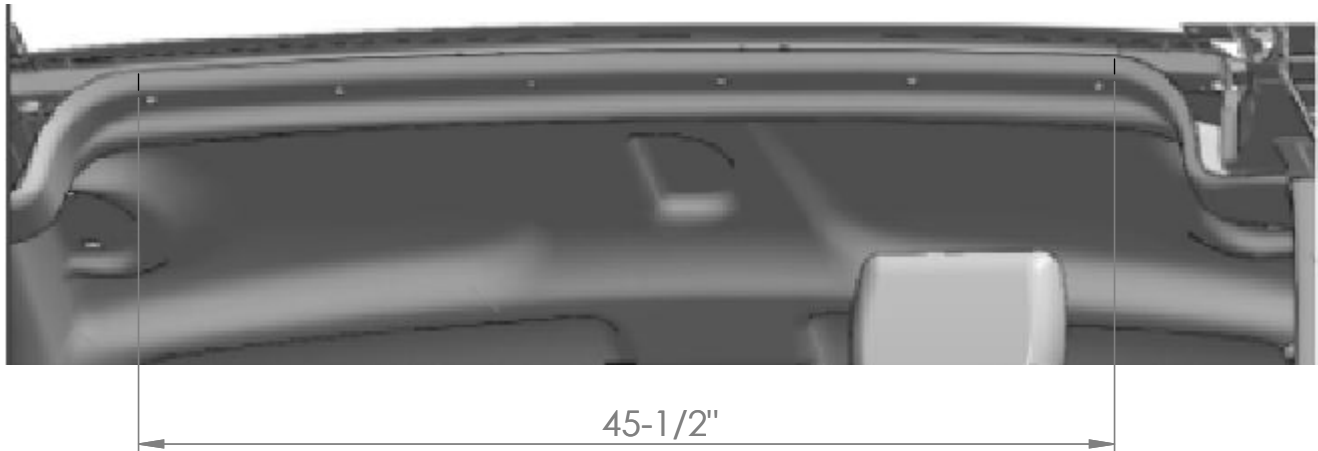

**AFTER**

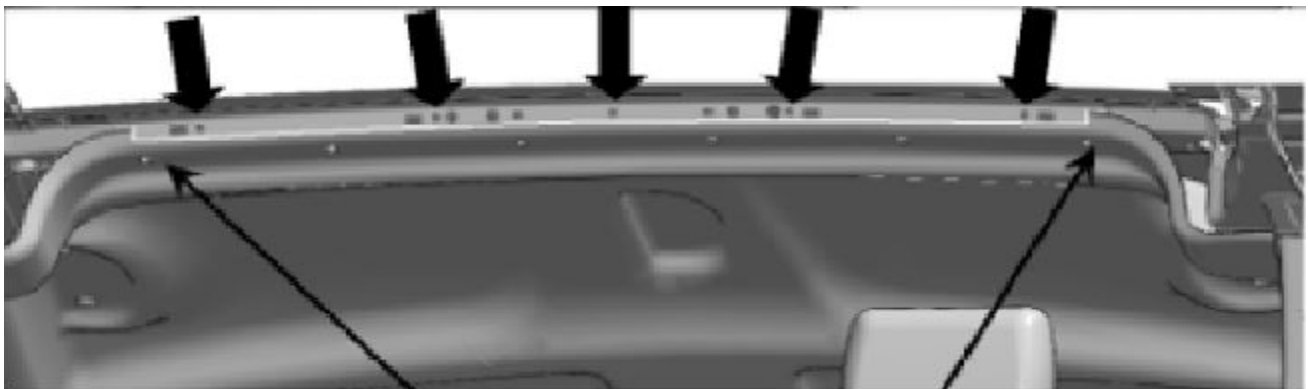

TRIM AWAY AREA 45-1/2" WIDE.  
FROM HEADLINER RADIUS TO RADIUS  
AS SHOWN.

## Step 05

Temporarily position the partition panel into the vehicle and mark the center of the slots as shown on the B-pillar roof bow. (Or use a previously validated drill jig)

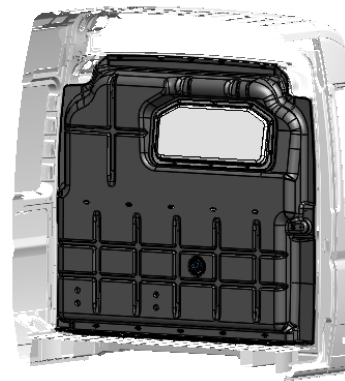
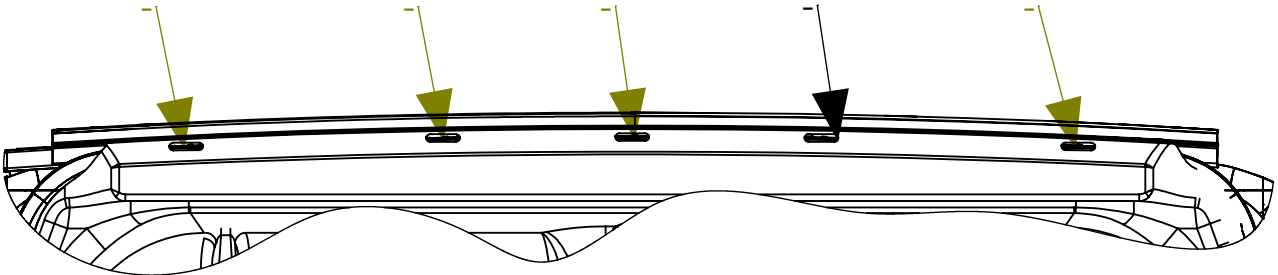

## Step 06

Take partition out and using a 3/8" drill bit with a stop, drill out marked locations. Apply primer and insert plusnuts and set.

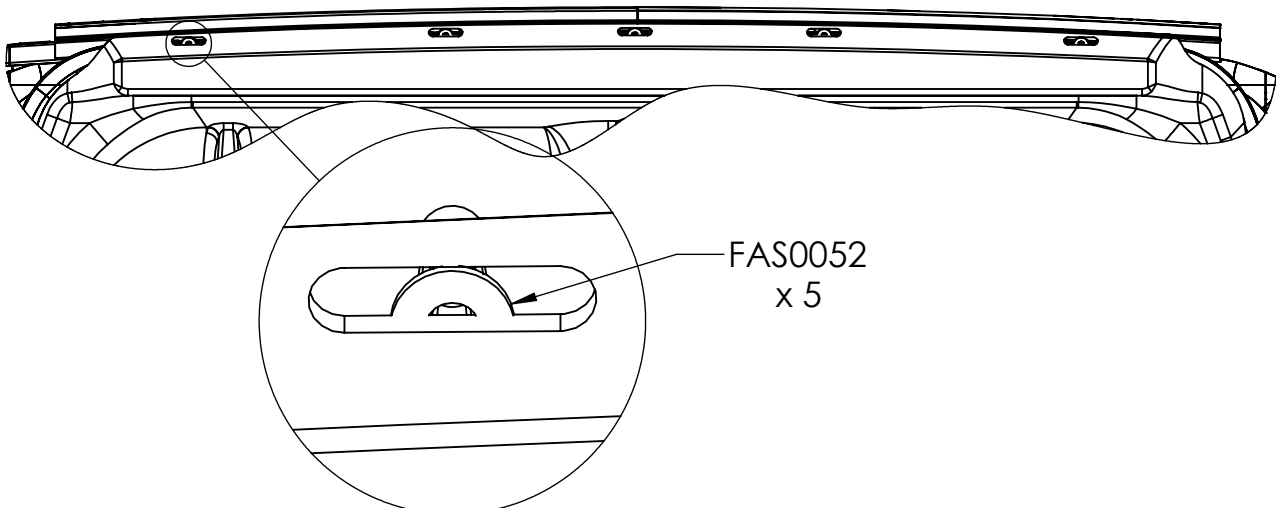

## Step 07

**Attach StreetSide bracket as shown.  
You may need to remove the OEM D-  
ring and discard.**

OEM MOUNTING HOLE

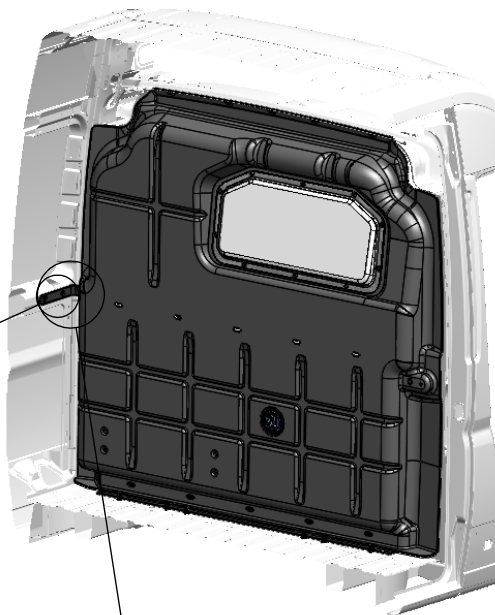
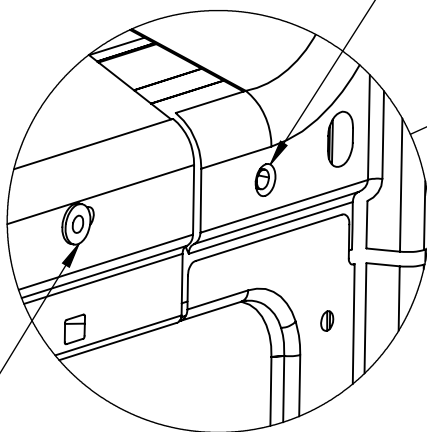

DRILL OUT LEFT OEM HOLE FOR PLUSNUT.  
USE A 3/8" DRILL BIT WITH STOP THEN  
APPLY PRIMER. INSERT PLUSNUT  
AND SET.

FAS0052  
X 1

FAS0098  
X 2

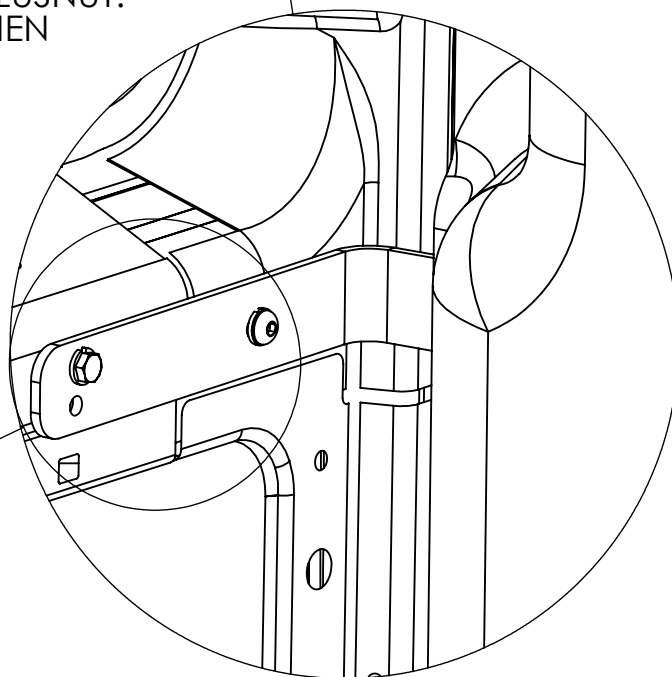
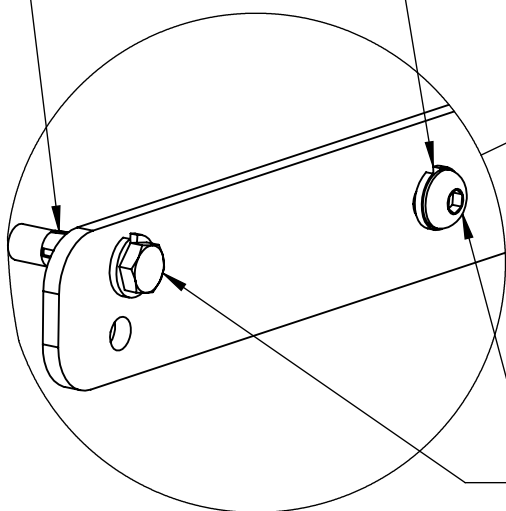

FAS0741 X 1 THIS FASTENER GOES DIRECTLY  
INTO OEM HOLE

FAS0078  
X 1  
USE UPPER HOLE

**Step 08**

**Assemble StreetSide brackets  
as shown.**

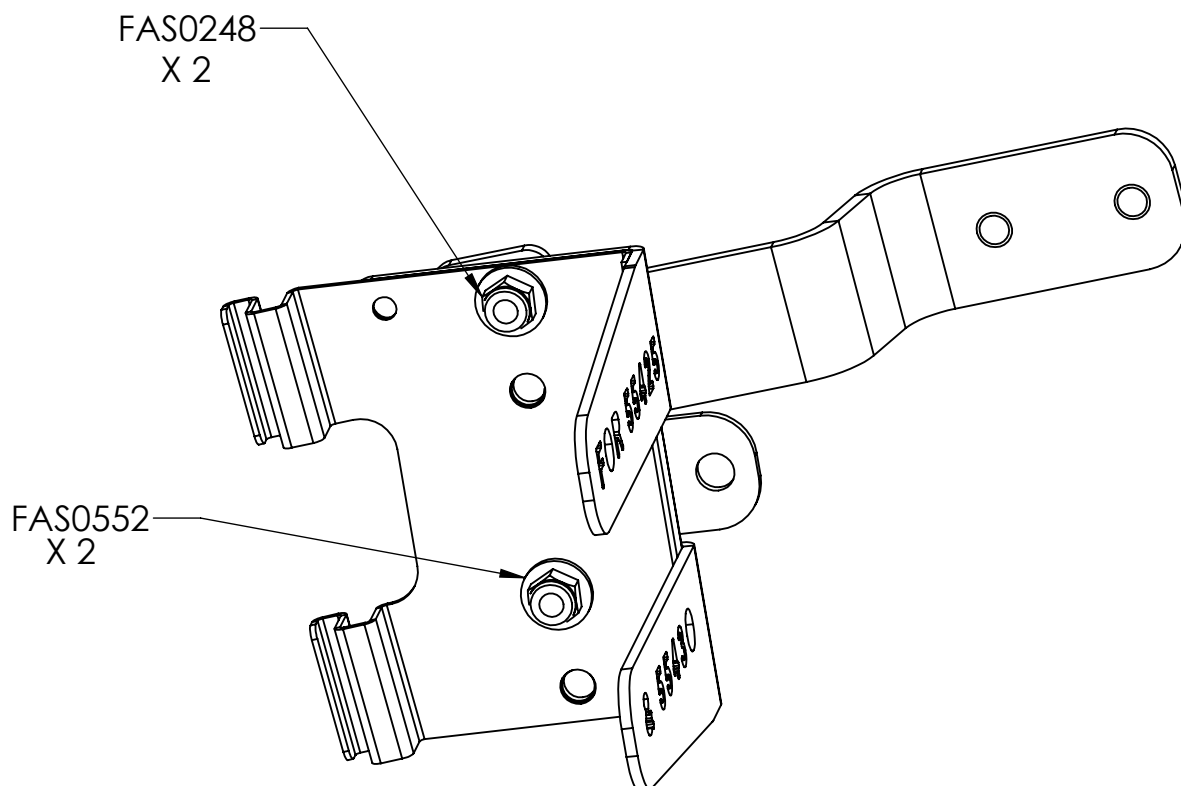
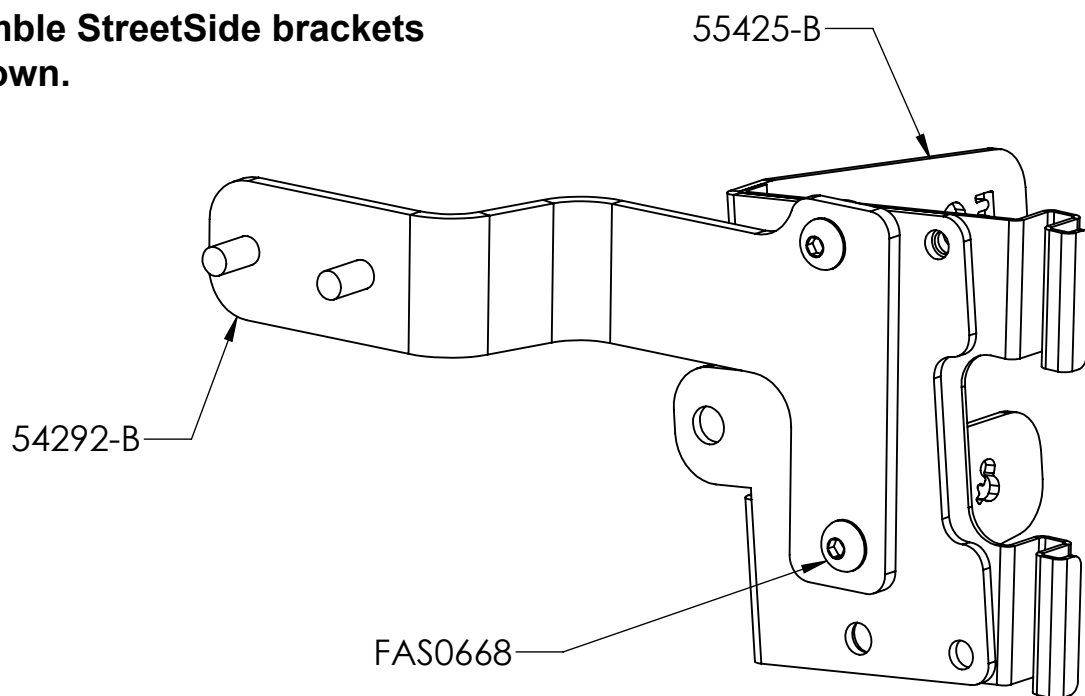

## Step 09

Attach curbside brackets as shown. Pull OEM weather stripping back out of the way to have access to secure brackets. You'll need to do this from passanger side door and curb side sliding door.

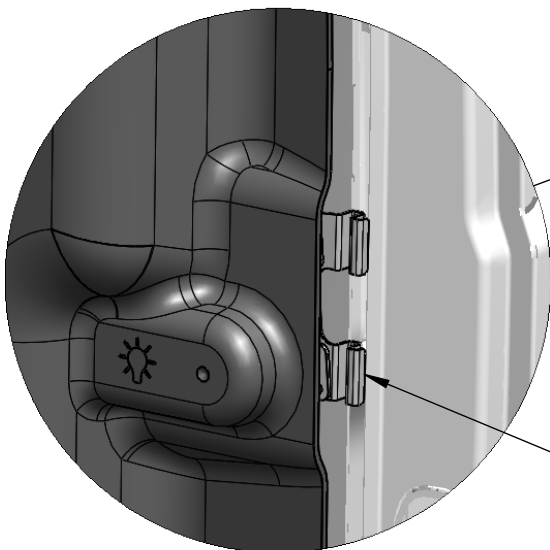
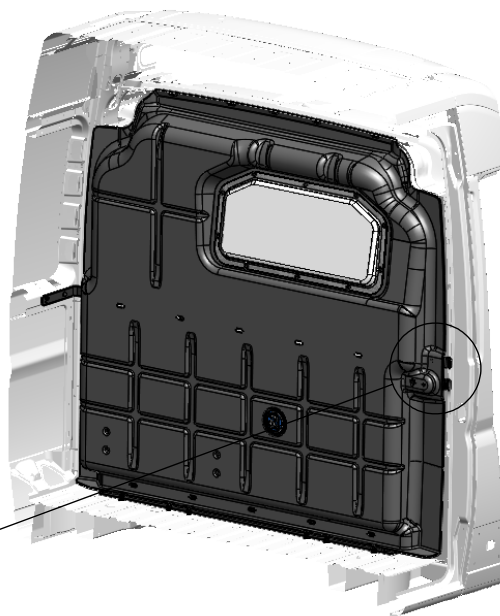

SLIDE DOOR VIEW

GRIPS ON OEM EDGE FLANGE

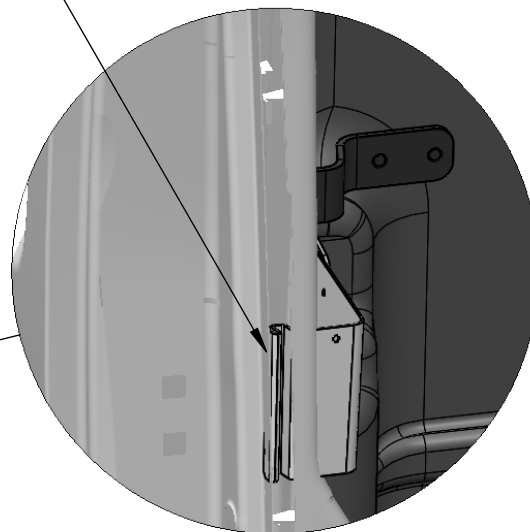

PASSANGER SIDE VIEW

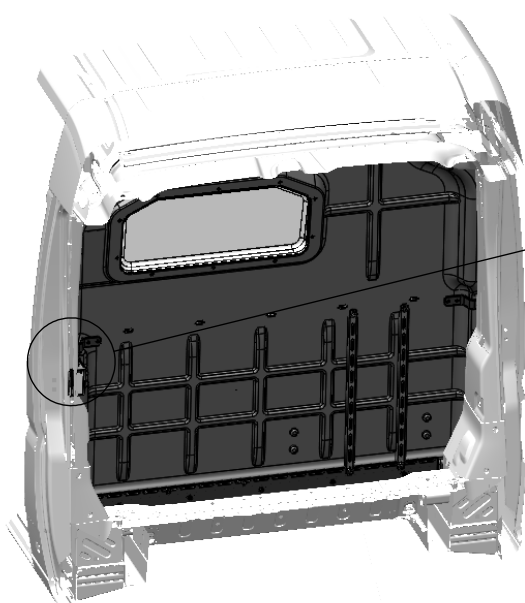



**Step 09 CONTINUED**

**Slide brackets together and fasten as shown. Place OEM weather stripping back into place.**

**:IMPORTANT:**

SEAT BELT NEEDS TO BE BEHIND BRACKET AND FREE FROM TOUCHING ANY PART OF BRACKETS.

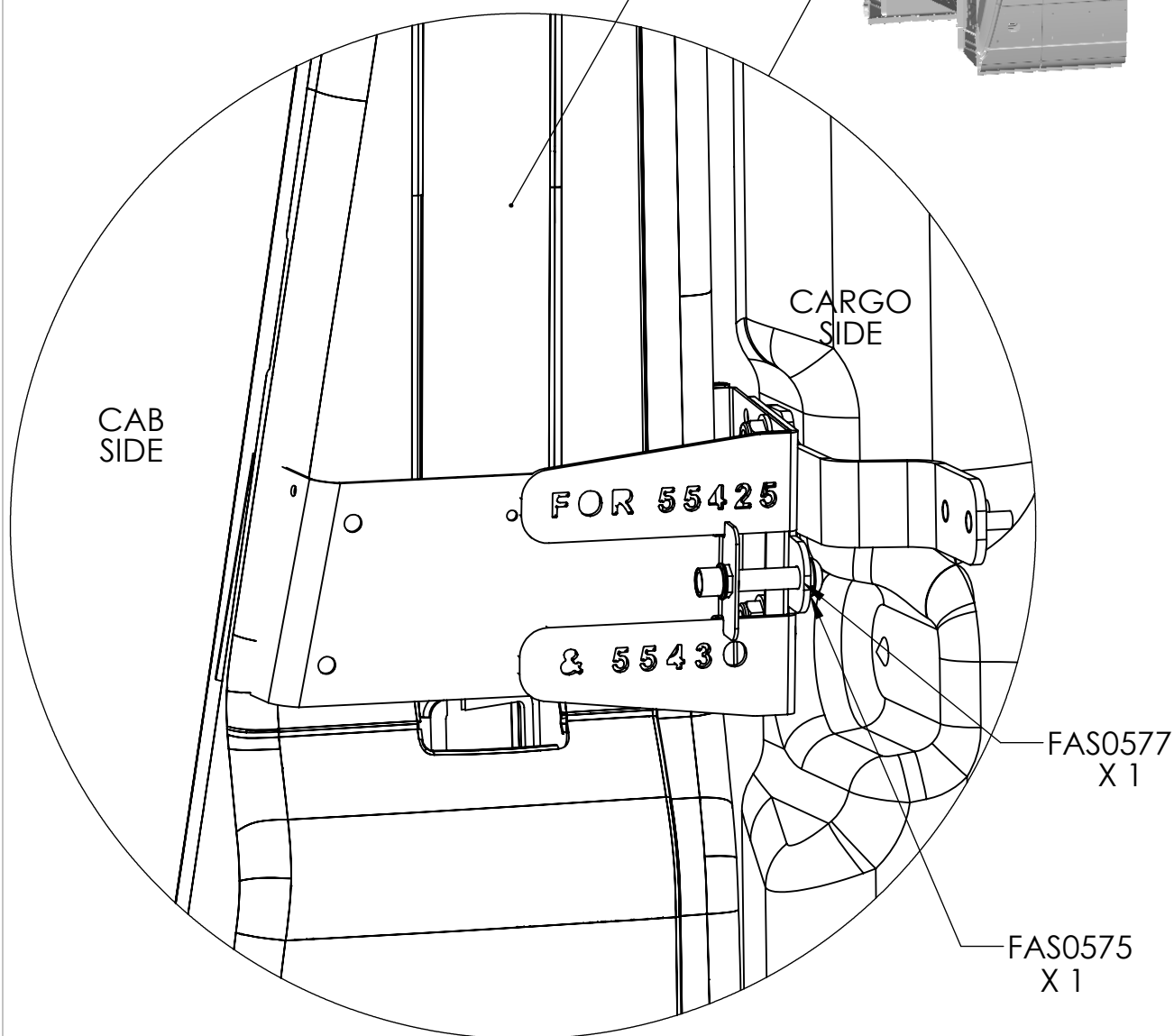
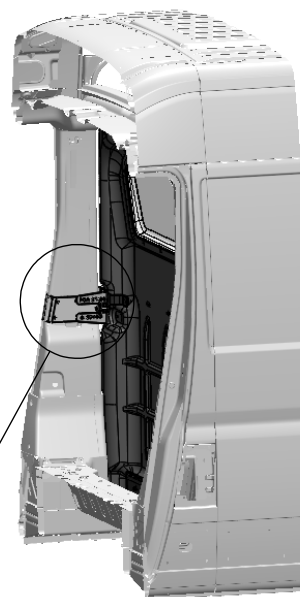

**Step 10**

**Attach cross support to clinch studs as shown.**

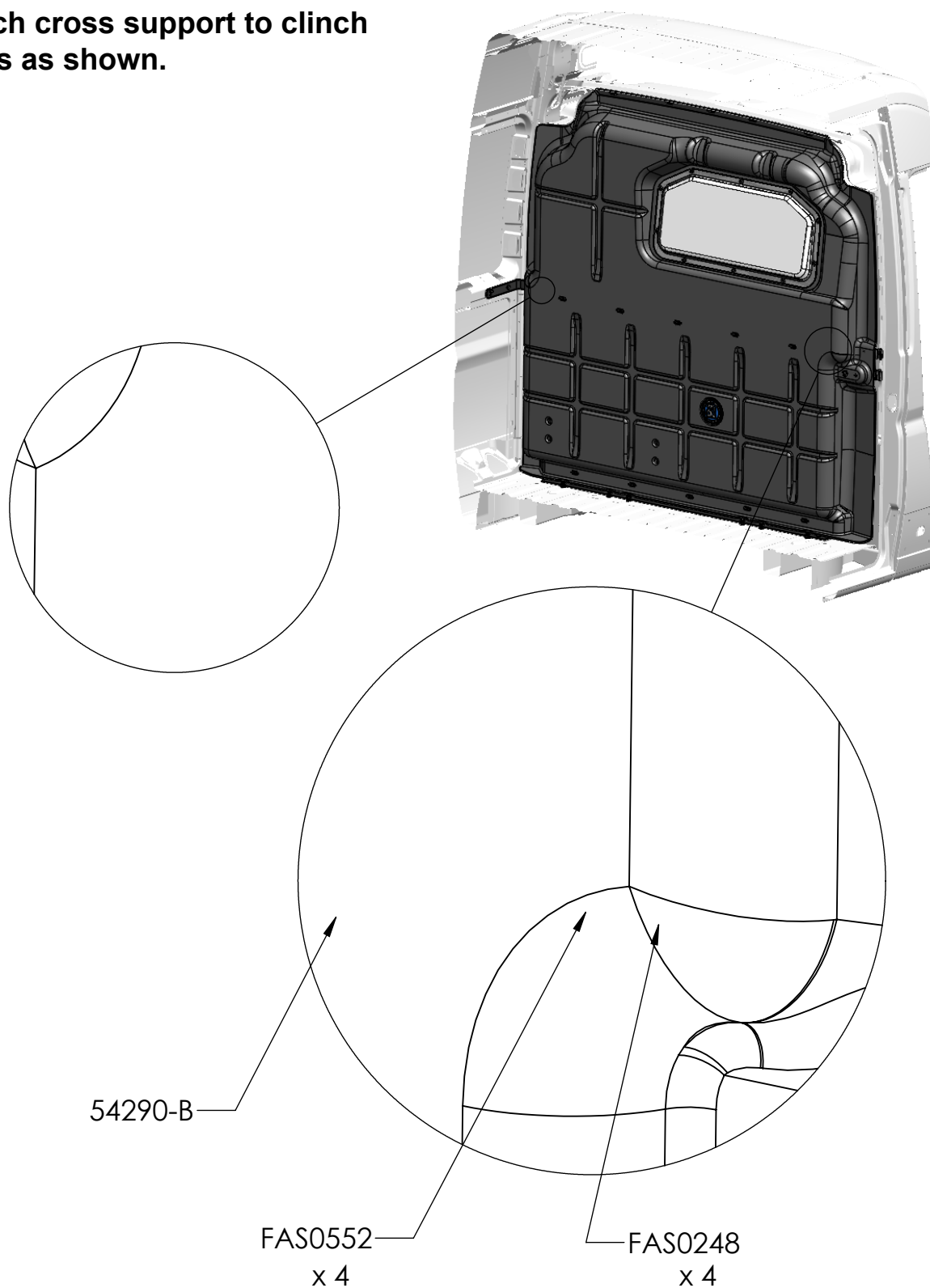

## Step 11

Attach two spring clips to the cross support bracket in the 3rd and 7th slots from the curbside. Threaded portion facing towards the cargo area as shown.

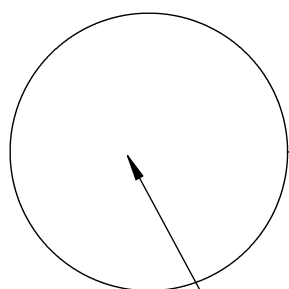

FAS0711  
x 2

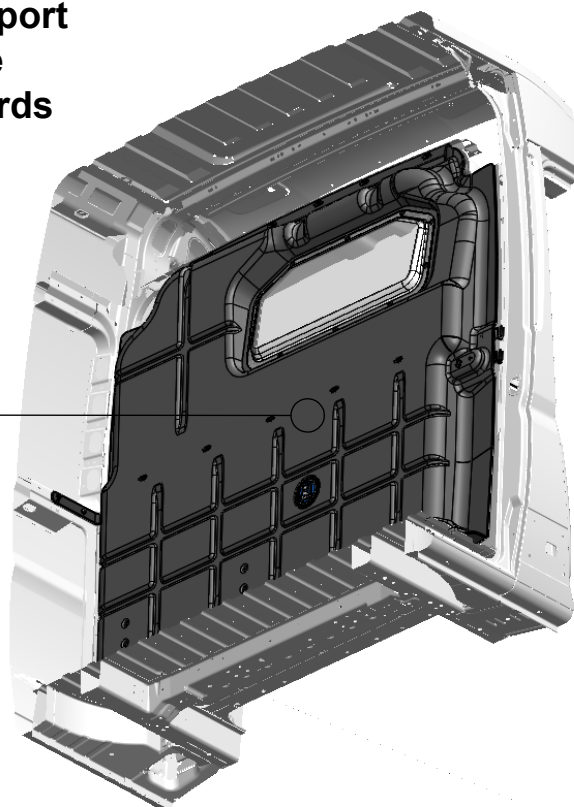

## Step 12

Attach vertical brackets as shown.

NOTE: FLANG FACES OUT TOWARDS SIDE OF VEHICLE.

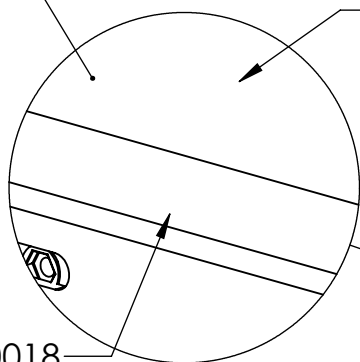

FAS0018  
x 4

51782-B  
x 2

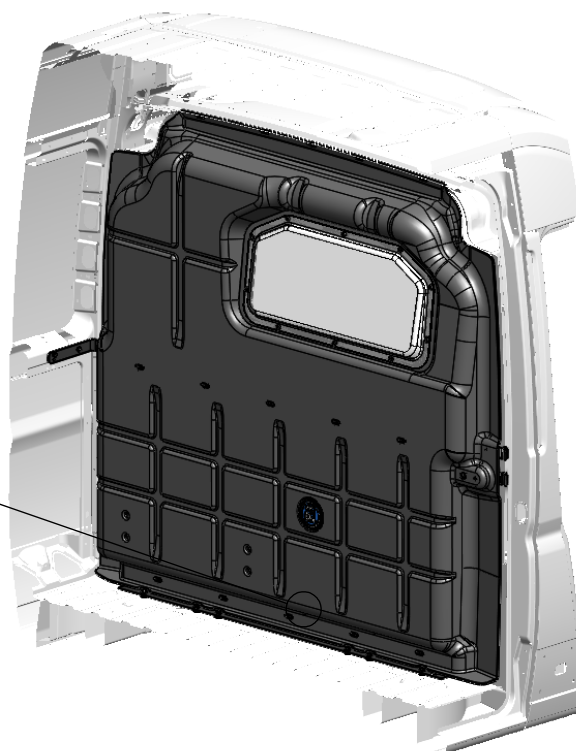

## Step 13

**Cut bulb seal in half. Place bulb seal to both sides of the partition as shown. Starting at the bottom corner and work up. Trim excess and discard.**

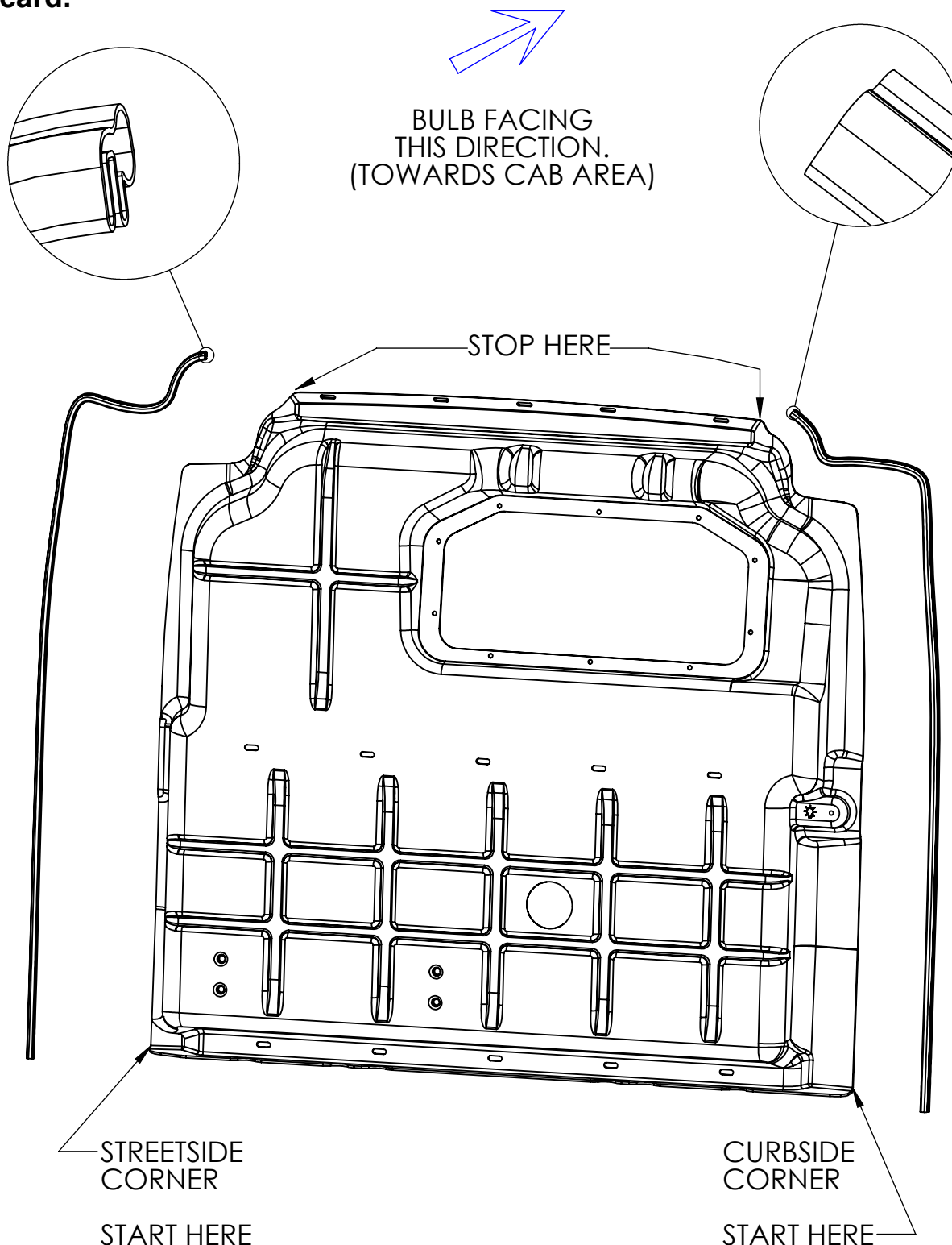

## Step 14

**Place partition into vehicle and fasten the 5 bottom slots into footer rail.**

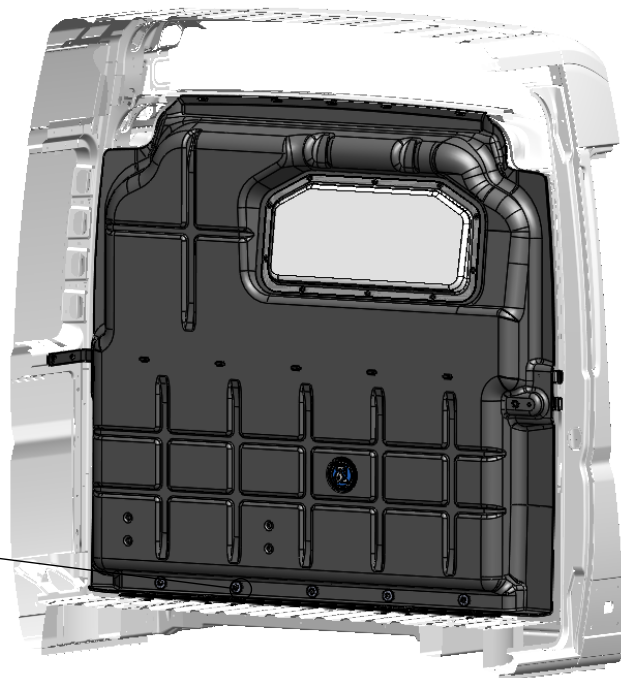
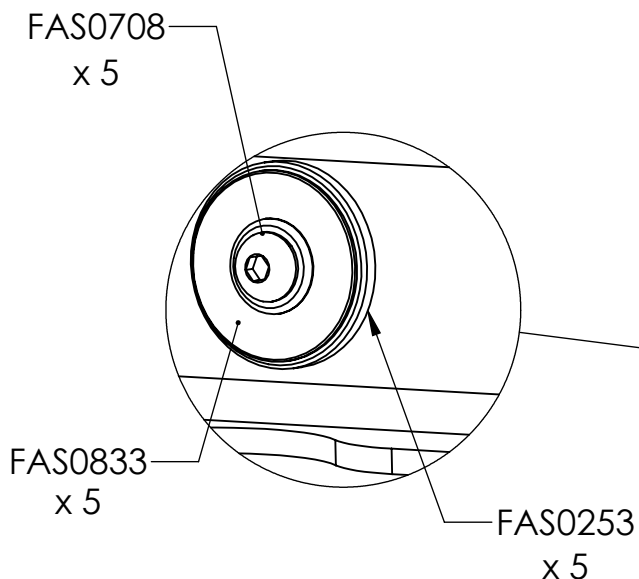

## Step 15

**Fasten to the 5 top slots into plusnuts.**

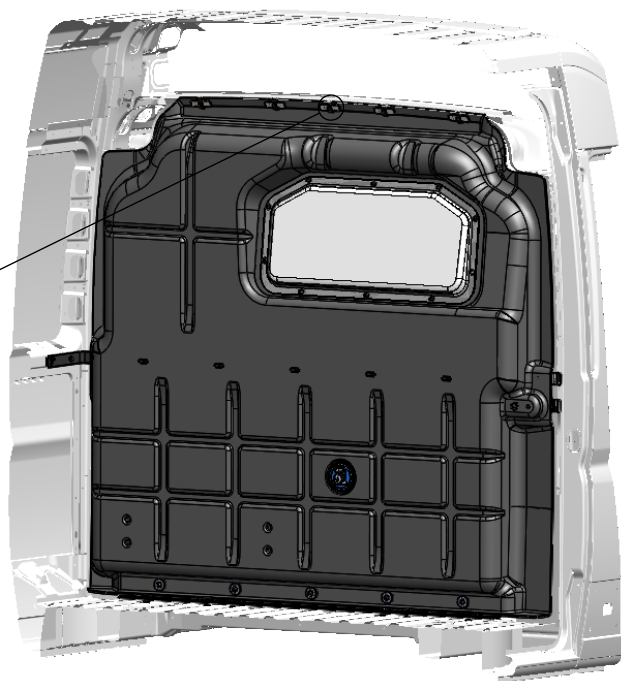
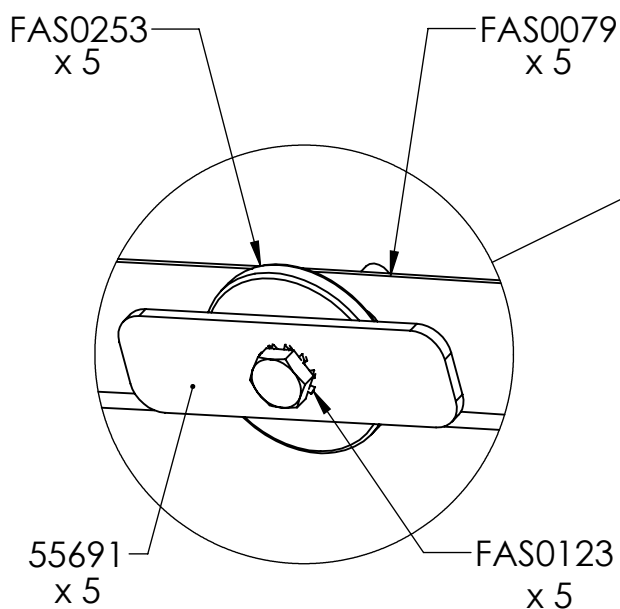

## Step 16

Attach end caps to AD rail as shown.

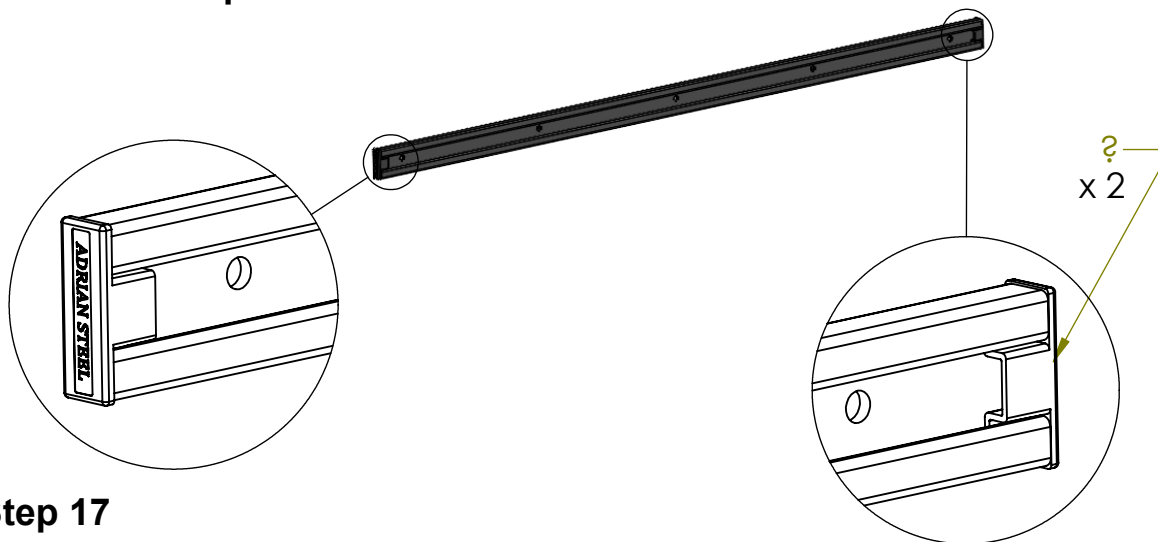

## Step 17

Attach AD rail as shown.

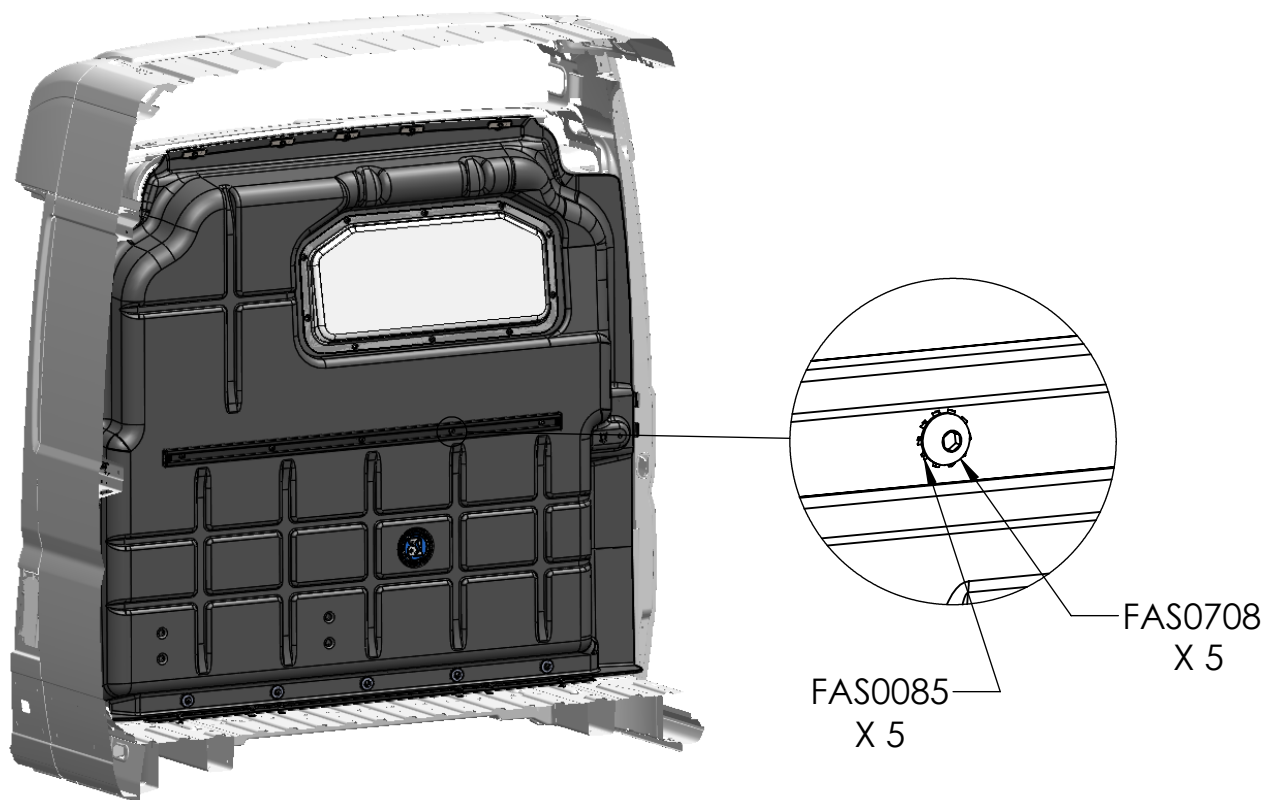

**YOUR INSTALLATION IS NOW COMPLETE.**

**DOUBLE CHECK ALL FASTENER LOCATIONS TO BE SURE THAT ALL  
FASTENERS ARE TIGHTENED TO SPECIFICATIONS.**

**YOUR INSTALLATION IS NOW COMPLETE!**

**STOW THIS COPY IN THE VEHICLE FOR FUTURE REFERENCES!**





**Individual Fastener Images & Descriptions**