

## NISSAN HIGH ROOF PARTITION

PRODUCT WEIGHT

**79 LBS**

WIDTH x DEPTH x HEIGHT

**67.25" x 5" x 75.5"**

CAPACITY

**N/A**

COLOR

**BLACK**

CATALOG NUMBER

**PARNH-NW**

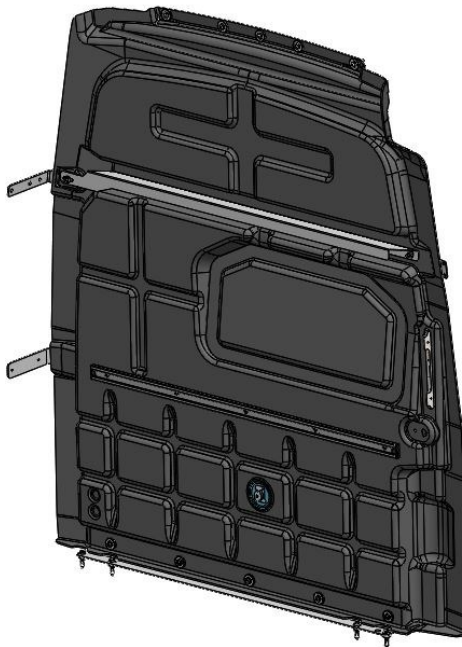

### PRODUCT FEATURES

Composite partition for Nissan High Roof provides a semi-sealed solution for separating the cab area from the cargo area. The composite partition features a full perimeter bulb seal that seals off the majority of the airflow from the cab area to the cargo area. This feature provides better climate control for the cab area and reduces noise transfer from the cargo area to the cab area.

### Driver Comfort Details

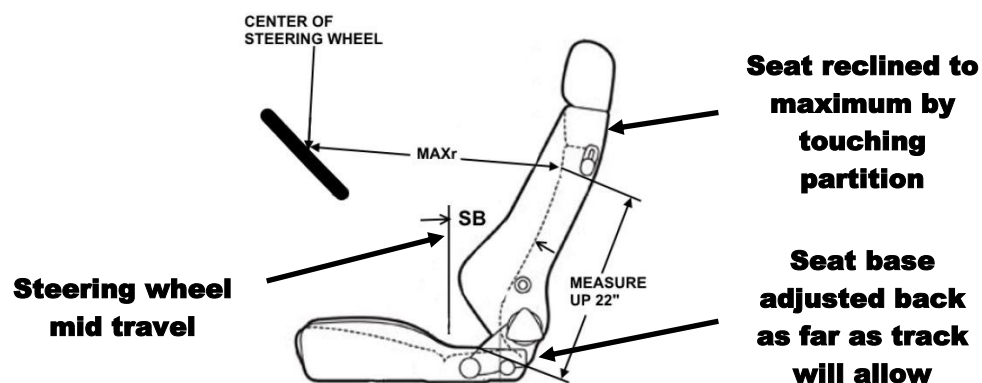

|      | DESCRIPTION          | DIMENSION  |
|------|----------------------|------------|
| SB   | SEAT BACK ANGLE      | 11 degrees |
| MAXr | MAXIMUM DRIVER REACH | 24-3/4"    |

SEE PAGE 2 FOR APPLICATION NOTES AND ACCESSORIES, OTHER PRODUCTS THAT WORK WITH THIS UNIT.

PAGE 1 of 2

The information contained in this document is the sole property of ADRIAN STEEL COMPANY. ADRIAN STEEL COMPANY retains the right to modify and/or change the product of its design at any time without prior notification.

## Accessory Chart

|                              | Cargo Side                                                                                           |                                                                                           |                                              | Cab Side                                                 |                                                                                           |                                            |
|------------------------------|------------------------------------------------------------------------------------------------------|-------------------------------------------------------------------------------------------|----------------------------------------------|----------------------------------------------------------|-------------------------------------------------------------------------------------------|--------------------------------------------|
|                              | <b>Base Partition</b><br>BAGRKA1<br>REQUIRED<br>(1 BAGRKA1 will allow for one accessory to be added) | <b>PARHDW Fastener Kit</b><br>Allow accessories to be added directly mounted to partition | <b>PARNHCRG</b><br>(mounting kit cargo side) | <b>Base Partition</b><br>1/4" nuts and bolts<br>REQUIRED | <b>PARHDW Fastener Kit</b><br>Allow accessories to be added directly mounted to partition | <b>PARNHCAB</b><br>(mounting kit cab side) |
| <b>Available Accessories</b> | -                                                                                                    | -                                                                                         | -                                            | -                                                        | -                                                                                         | -                                          |
| PA7: Reflector kit           | X                                                                                                    | X                                                                                         | X                                            | X                                                        | X                                                                                         | X                                          |
| PA8: Fire ext.               | X                                                                                                    | X                                                                                         | X                                            | X                                                        | X                                                                                         | X                                          |
| PA9: First aid tray          | X                                                                                                    | X                                                                                         | X                                            | X                                                        | X                                                                                         | X                                          |
| PA10: Practice holder        |                                                                                                      |                                                                                           | X                                            |                                                          |                                                                                           | X                                          |
| PA11: Cab file               |                                                                                                      |                                                                                           | X                                            | X                                                        |                                                                                           | X                                          |
| PA11NL: Catalog box          |                                                                                                      |                                                                                           | X                                            | X                                                        |                                                                                           | X                                          |
| TA1: Four hook bar           |                                                                                                      |                                                                                           | X                                            |                                                          |                                                                                           | X                                          |
| TH30: 30lb tank holder       |                                                                                                      |                                                                                           | X                                            |                                                          |                                                                                           |                                            |
| TH50: 50lb tank holder       |                                                                                                      |                                                                                           | X                                            |                                                          |                                                                                           |                                            |
| UH50RM1: Rail mount kit      |                                                                                                      |                                                                                           | X                                            |                                                          |                                                                                           | X                                          |
| UH10: 1" hook                |                                                                                                      |                                                                                           | X                                            |                                                          |                                                                                           |                                            |
| UH25: 2.5" hook              |                                                                                                      |                                                                                           | X                                            |                                                          |                                                                                           |                                            |
| UH25CP-G: 2.5' hook comp     |                                                                                                      |                                                                                           | X                                            |                                                          |                                                                                           |                                            |
| UH50: 5" hook                | X                                                                                                    |                                                                                           | X                                            |                                                          |                                                                                           |                                            |

**PARNHCRG (shown in yellow)**  
 Cargo side hardware mounting kit installed

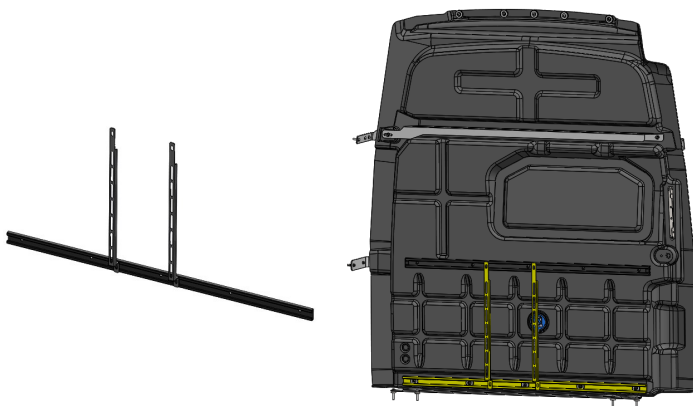

**PARNHCAB (shown below in yellow)**  
 Cab side hardware mounting kit installed

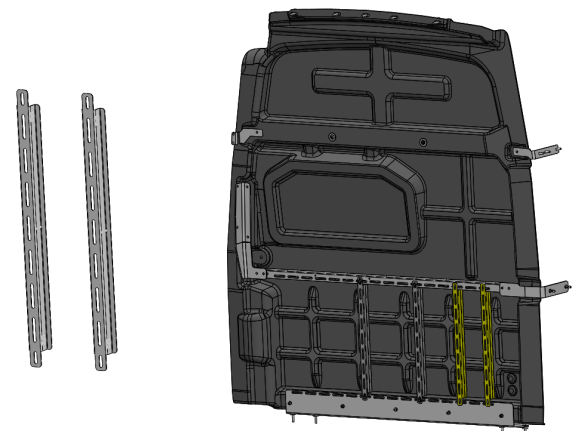

### PARHDW Fastener Kit

Fastener kits allow for installation of smaller and lighter (up to 12 lbs.) Allows accessories to be directly mounted to the partition, such as: fire extinguisher, flare kit, first aid kits, acc.

### Introduction / Comments:

Composite partition for Nissan High Roof provides a semi-sealed solution for separating the cab area from the cargo area. The composite partition features a semi-full perimeter bulb seal that seals off the majority of the airflow from the cab area to the cargo area. This feature provides better climate control for the cab area and reduces noise transfer from the cargo area to the cab area.

#### **Note:**

It is advised that all fasteners used in this assembly and installation should be checked for tightness at the following intervals: @ 2-weeks and again @ 6-weeks of operation. This preventive maintenance step must be completed to ensure your product gives you long service life.

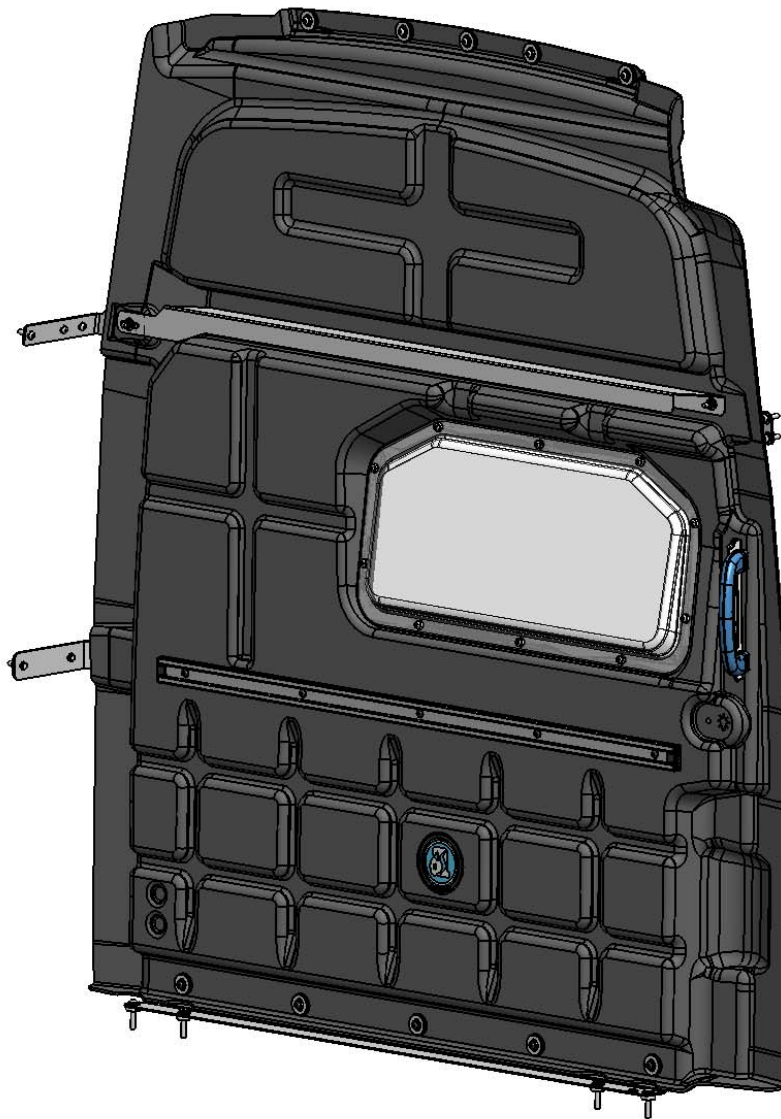

**COMP PAR, W/WDO, NHR  
PARNH & PARNH-NW**

## - PRECAUTIONS -



CAUTION



THE USE OF AIR IMPACT TOOLS CAN OVER-TORQUE FASTENERS AND CAUSE FASTENER FAILURE!



CAUTION



ALL INSTALLATION HOLES SHOULD BE SEALED WITH SILICON OR BUTYL SEALANT TO PREVENT EXHAUST FUMES FROM ENTERING THE VEHICLE!



DANGER



INSPECT FOR FUEL TANK, FUEL LINES, BRAKE LINES, HIGH VOLTAGE BATTERIES AND ELECTRICAL LINES PRIOR TO DRILLING TO AVOID DAMAGING CRITICAL VEHICLE SYSTEMS OR INJURY TO INSTALLER DURING INSTALLATION PROCESS!



CAUTION



TO AVOID DAMAGING THE VEHICLE ALWAYS USE DRILL STOPS WHEN DRILLING ANY INSTALLATION HOLES!  
ADRIAN AVAILABLE PART #'S 31119-0 (3/8" X 1/2" DEEP), 31121-0 (1/2" X 1/2" DEEP)



## - IMPORTANT WARRANTY REQUIREMENTS -

1. SUBSTITUTING ADRIAN STEEL SPECIFIED FASTENERS FOR ASSEMBLY AND/OR INSTALLATION WILL VOID YOUR PRODUCT WARRANTY.
2. ALL HOLES DRILLED INTO VEHICLE SHOULD HAVE THE RAW METAL EDGES SEALED WITH A SELF- ETCHING PRIMER TO RESIST CORROSION AND POTENTIAL FASTENER POINT FAILURE.
3. ALL FASTENERS USED IN THE INSTALLATION OF THIS PRODUCT SHOULD BE TIGHTENED TO THE TORQUE(S) SPECIFIED IN THESE INSTRUCTIONS.
4. THESE INSTRUCTIONS SHOULD BE KEPT WITH THE VEHICLE.

### THE BASIC TOOLS NEEDED FOR MOST INSTALLATIONS



DRILL



DRILL BIT WITH STOP



RATCHET, SOCKETS AND/OR WRENCHES



MEASURING TAPE



SCREWDRIVERS

ADDITIONAL TOOLS MAY BE NEEDED FOR THIS INSTALLATION AND THEY WILL BE IDENTIFIED IN THE STEPS THAT FOLLOW.

ADRIAN STEEL COMPANY • WWW.ADRIANSTEEL.COM • 906 JAMES STREET • ADRIAN, MI 49221 • 800-677-2726

If your vehicle contains carpet or a rubber floor mat you will need to prepare the mounting location. Position the product to be installed into the vehicle and once you are satisfied with the mounting locations, mark the mounting locations. Using a 1-3/16" diameter carpet cutter (P/N: 31183-0). Select the appropriate floor spacers as shown in the illustration. Set those aside for use later into the installation process. Using the correct drill bit size for the selected plusnut, drill the mounting holes in the vehicle sheet metal to prepare for installing the plusnuts. If you are thru-bolting at any of the locations simply drill a hole that is 1/16" larger than the bolt size(s) for those locations. Once you have drilled the holes into the vehicle, the raw metal edges should be sealed using a self-etching primer to resist corrosion and potential fastener point failure.

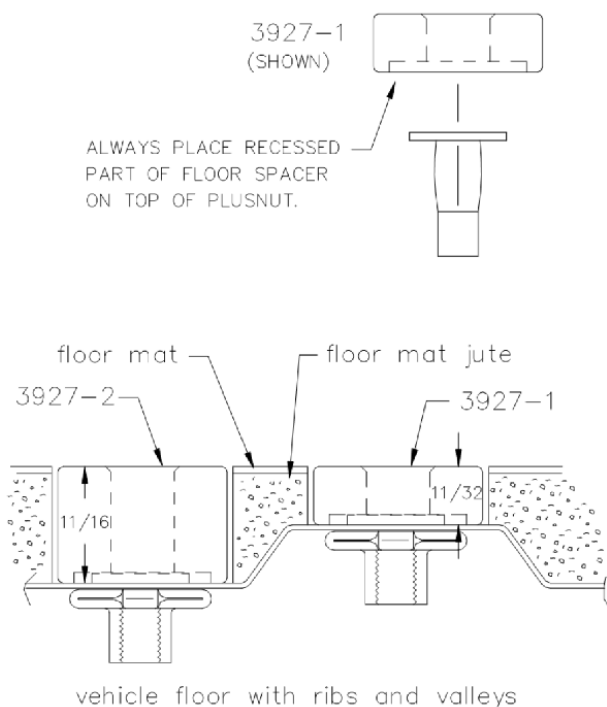

A PLUSNUT (RIVNUT) SETTING TOOL IS REQUIRED FOR PLUSNUT (RIVNUT) INSTALLATION . PLUS NUT SETTING TOOL CAN BE ORDERED THROUGH ADRIAN STEEL, OR USE AN AIR POWERED PLUSNUT SETTING GUN.

1/4-20UNC Plusnut (FAS0052) Use 3/8" dia. drill w/stop

FAS0080 SCREW, HXHD, 1/4-20UNCx2.00", G8  
FAS0067 WASHER, FLAT, 1/4"ID  
22200-0 PLUSNUT TOOL

5/16-18UNC Plusnut (FAS0091) Use 1/2" dia. drill w/stop

FAS0095 SCREW, HXHD, 5/16-18UNCx2.00", G8  
FAS0086 WASHER, FLAT, 5/16"ID  
22200-0 PLUSNUT TOOL

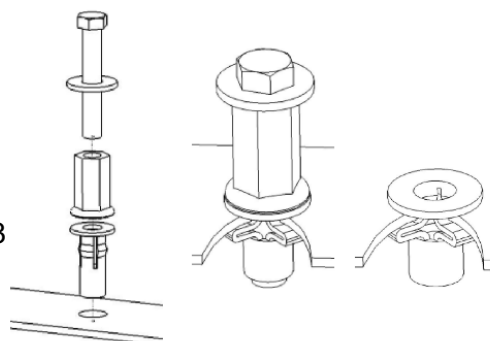

Place barrel of the plusnut body in sheet metal thru hole until flange is flush with sheet metal.

Using a 9/16" combination wrench of plusnut tool body and a second hand wrench, ratchet, or air tool, rotate the hex bolt head CW to draw plus nut flanges up (set the plusnut).

## Installation and / or Assembly Fasteners **BAGPARNHR**

| ITEM NO. | PART NUMBER | DESCRIPTION                                       | QTY. |
|----------|-------------|---------------------------------------------------|------|
| 1        | BAG0709-A   | 7" x 9" 3MIL AUTOBAG                              | 1    |
| 2        | 03927-1     | Floor Spacer Short                                | 4    |
| 3        | FAS0018     | SCREW,HH SFLNG 1/4-20X.62 ZP                      | 4    |
| 4        | FAS0052     | Plusnut, 1/4                                      | 2    |
| 5        | FAS0078     | Screw, Hex Hd, 1/4-20x1.00 Zn Plate, Grade 8      | 4    |
| 6        | FAS0098     | Washer, Lock, Split, 5/16, Zinc Plate             | 29   |
| 7        | FAS0187     | SCR,HH,M6-1.0X22                                  | 2    |
| 8        | FAS0248     | Nut, Nylon Insert Lock, 5/16-18 SST               | 8    |
| 9        | FAS0253     | WASHER, FOAM RUBBER, 1.50X0.375X0.5               | 12   |
| 10       | FAS0552     | Washer, Flat, 5/16, SST                           | 12   |
| 11       | FAS0708     | Screw, Button Hd Hex Soc, 5/16-18X1.25, BLK OXIDE | 12   |
| 12       | FAS0711     | SPRING CLIP                                       | 4    |
| 13       | FAS0727     | Screw, Button Hd Hex Soc, M8-1.25 X 30            | 5    |
| 14       | FAS0742     | Screw, Button Hd Hex Soc, M8-1.25 X 50            | 9    |
| 15       | FAS0833     | WASHER, CUP FLANGED 1.5"                          | 12   |
| 16       | FAS0067     | Washer, Flat, 1/4                                 | 2    |
| 17       | FAS0055     | Nut, Hex Flange,Nylock 1/4-20                     | 2    |
| 18       | FAS0085     | Washer, Lock, Ext. Tooth, 5/16                    | 5    |
| 19       | 36496-0     | END CAP                                           | 2    |

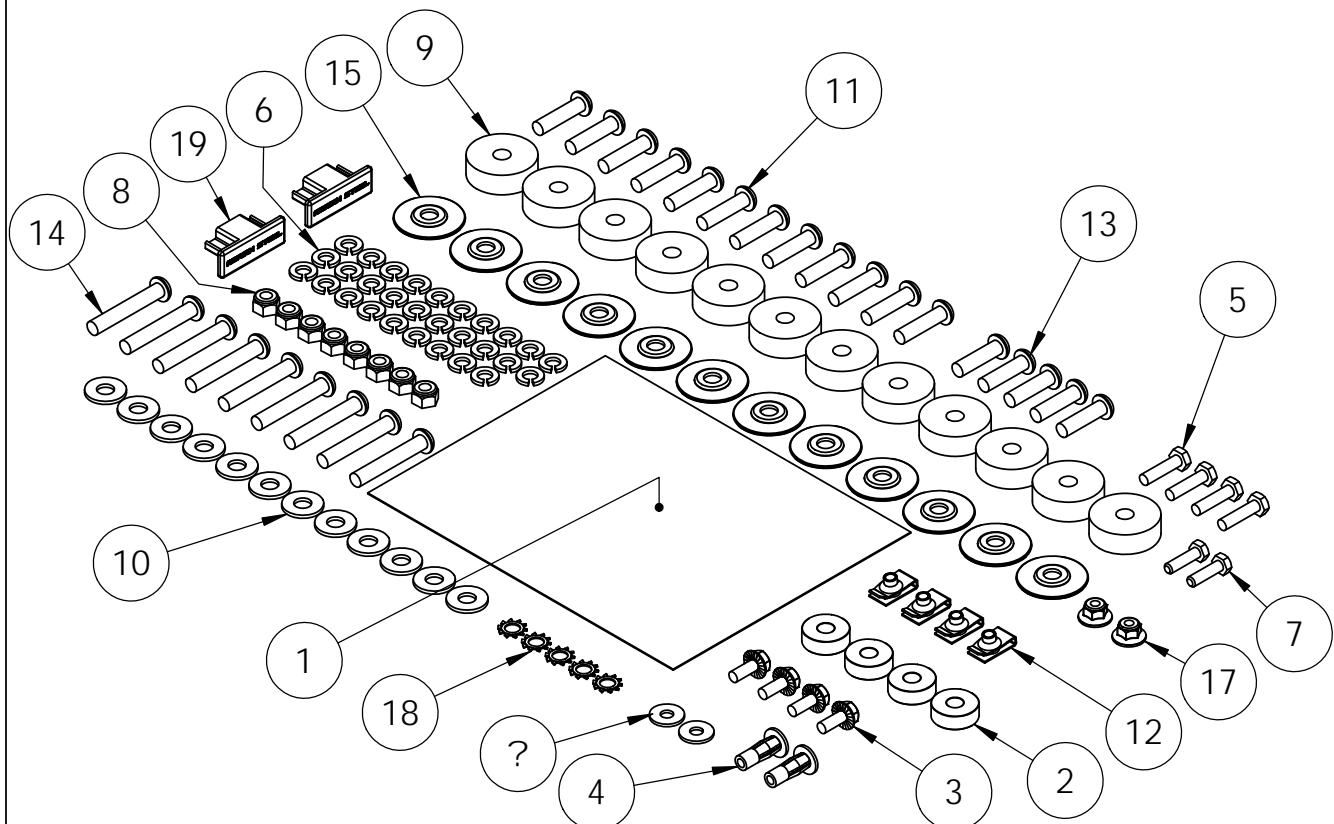

ADRIAN STEEL COMPANY • WWW.ADRIANSTEEL.COM • 906 JAMES STREET • ADRIAN, MI 49221 • 800-677-2726

## Step 01

If your vehicle contains carpet or a rubber floor mat. Place footer rail in approximate place shown and mark four hole locations. Use a 1-3/16" hole saw (part # 31183-0) at the marked locations. Cut through the floor mat, but NOT the floor. (Or use previously validated drill jig) You should now see the OEM mounting holes.

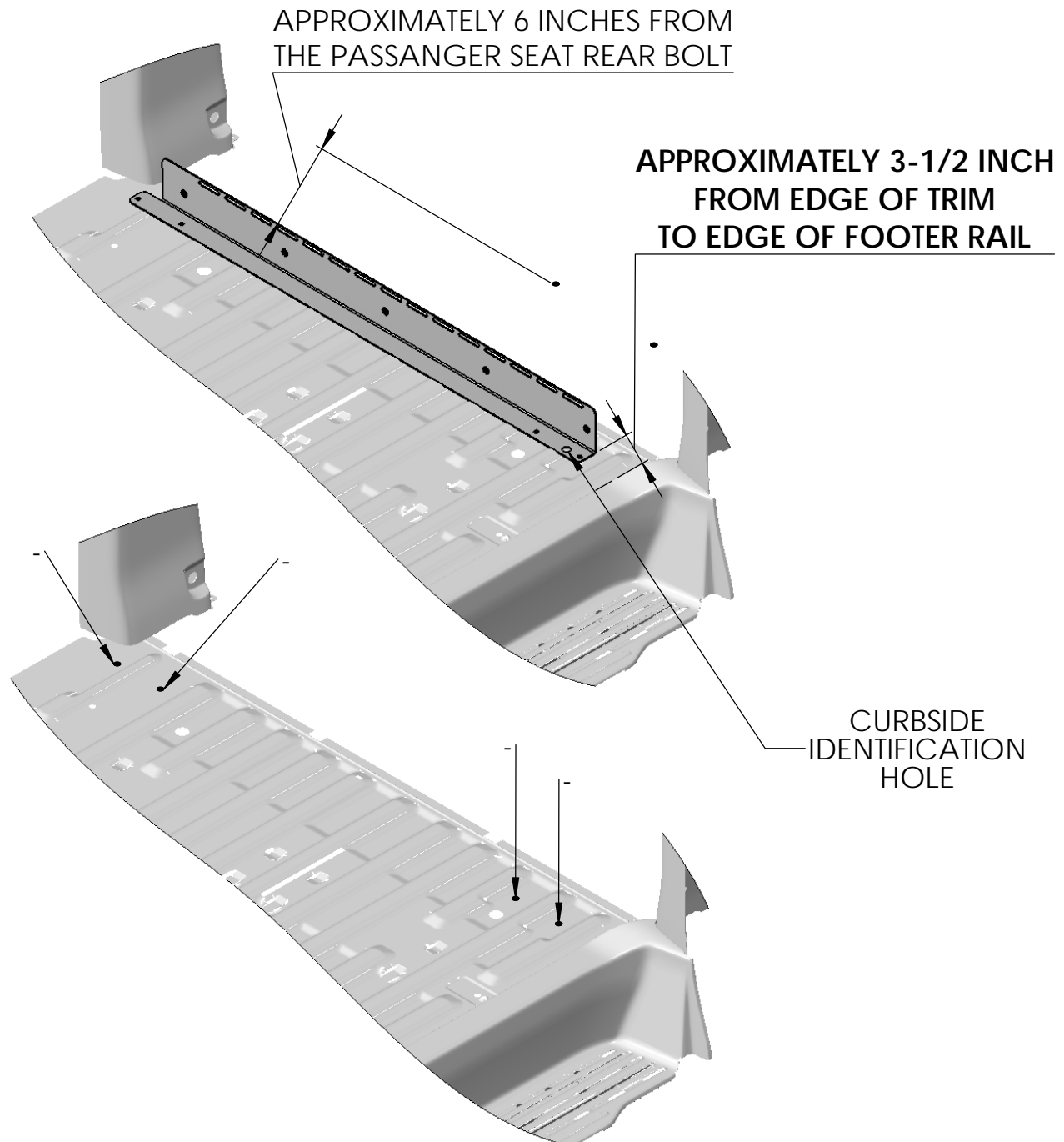



## Step 02

Place four (4) short spacers over OEM mounting holes. Fasten the footer rail to the vehicle as shown. Attach two spring clips to the footer rail in the 6th and 10th slots from the curbside. Threaded portion facing on the flange side of the footer rail as shown.

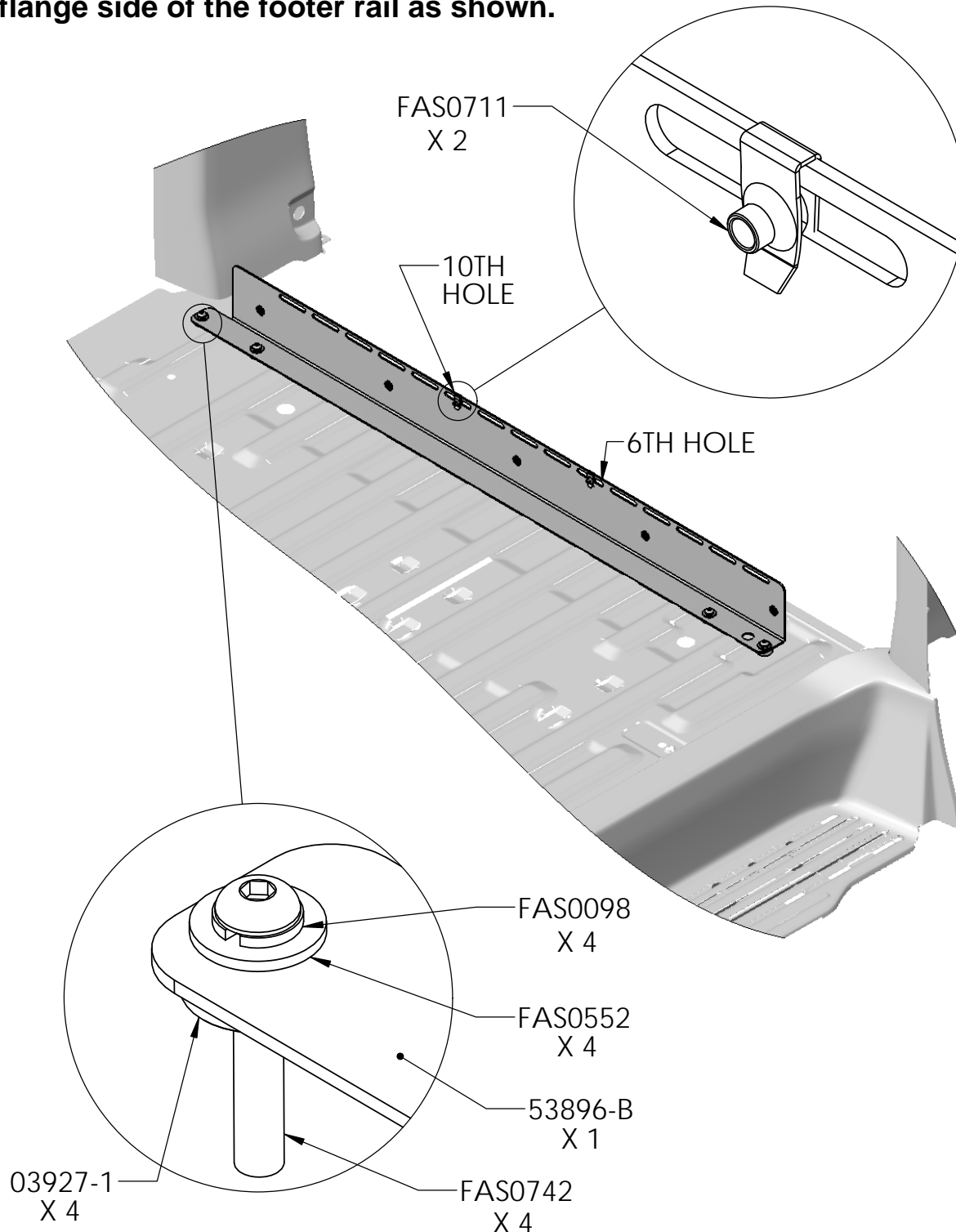



### Step 03

Attach StreetSide brackets as shown. Top bracket attaches directly to OEM mounting holes. Bottom bracket will need to be drilled for plusnuts. Use a 3/8" drill bit with stop then apply primer to the drilled holes. Insert plusnuts and set. Attach brackets.

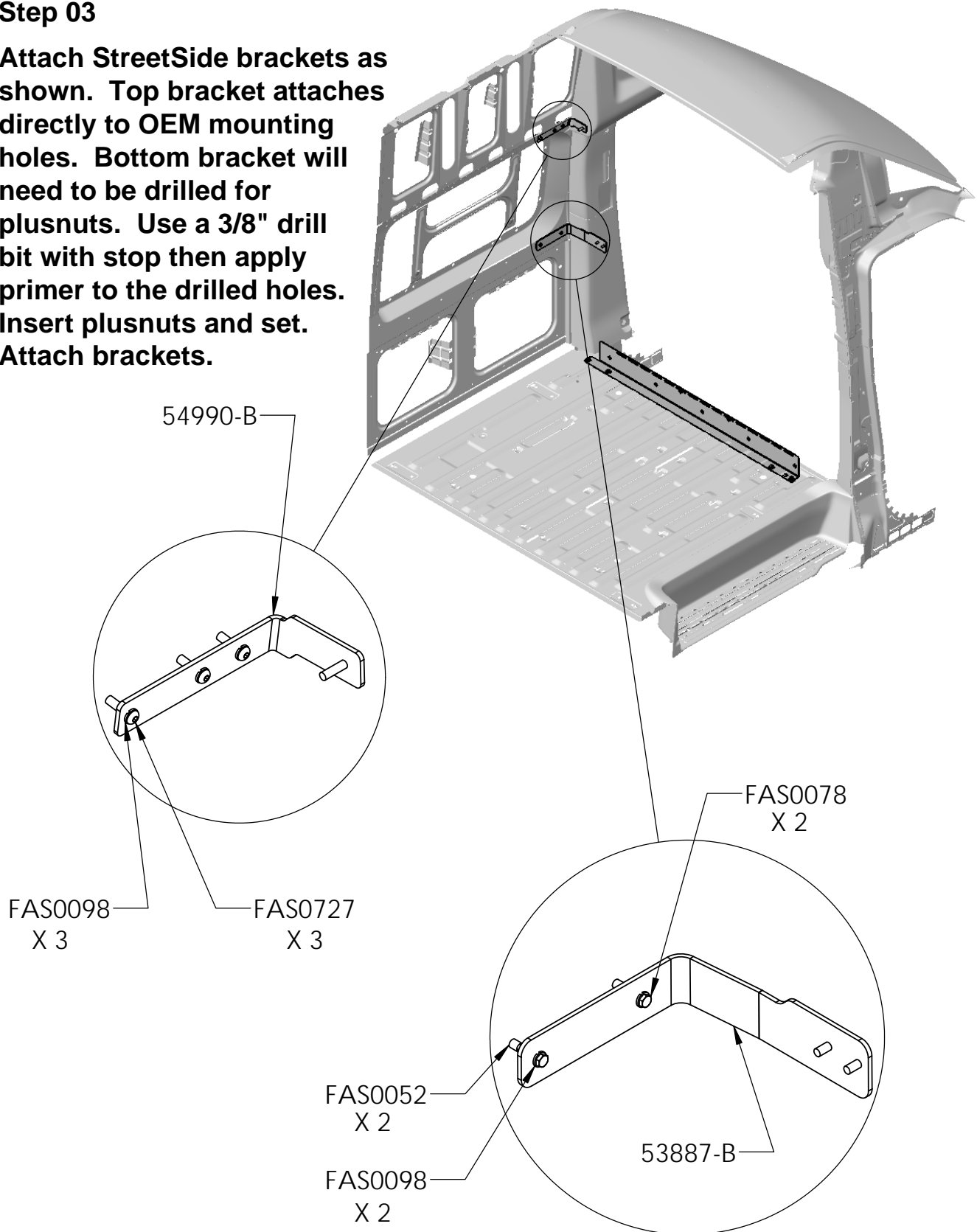

## Step 04

**Attach curbside brackets as shown. Remove: OEM grab handle, trim plug, and head impact foam on curbside. (Discard all fasteners) Secure brackets by fastening directly to OEM holes.**

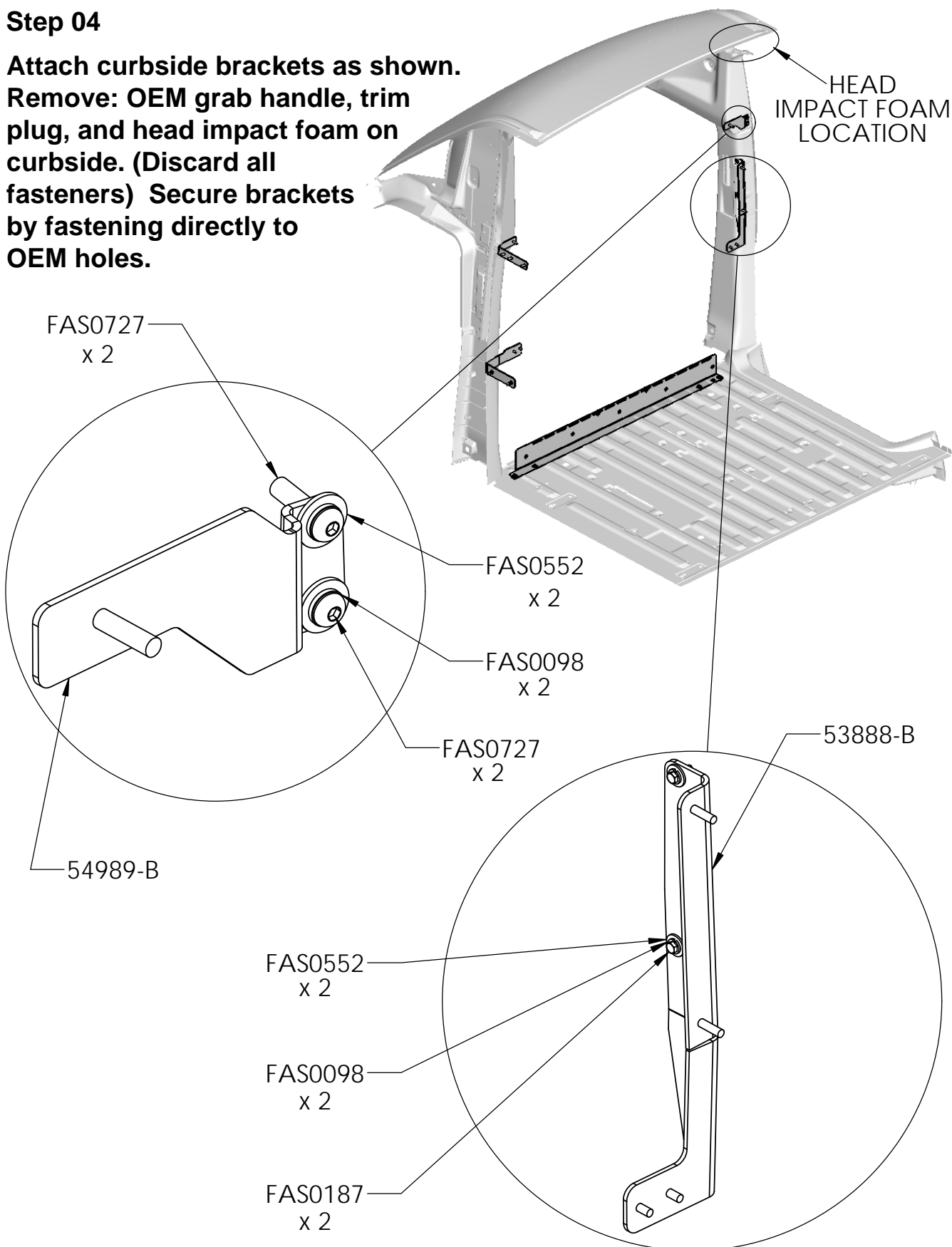

## Step 05

Attach cross support to clinch studs as shown.

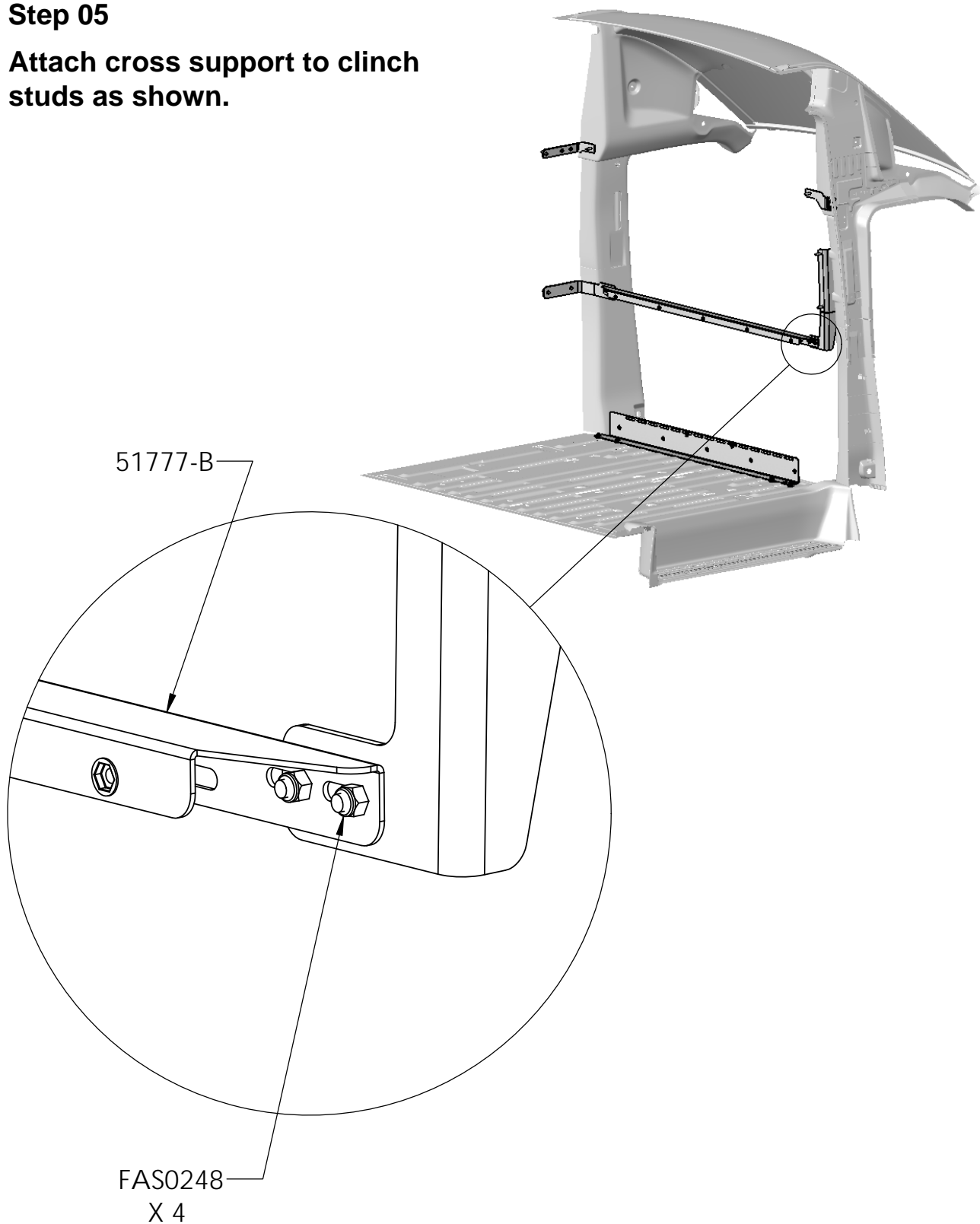

## Step 06

Attach two spring clips to the cross support bracket in the 7th and 11th slots from the curbside. Threaded portion facing towards the cargo area as shown.

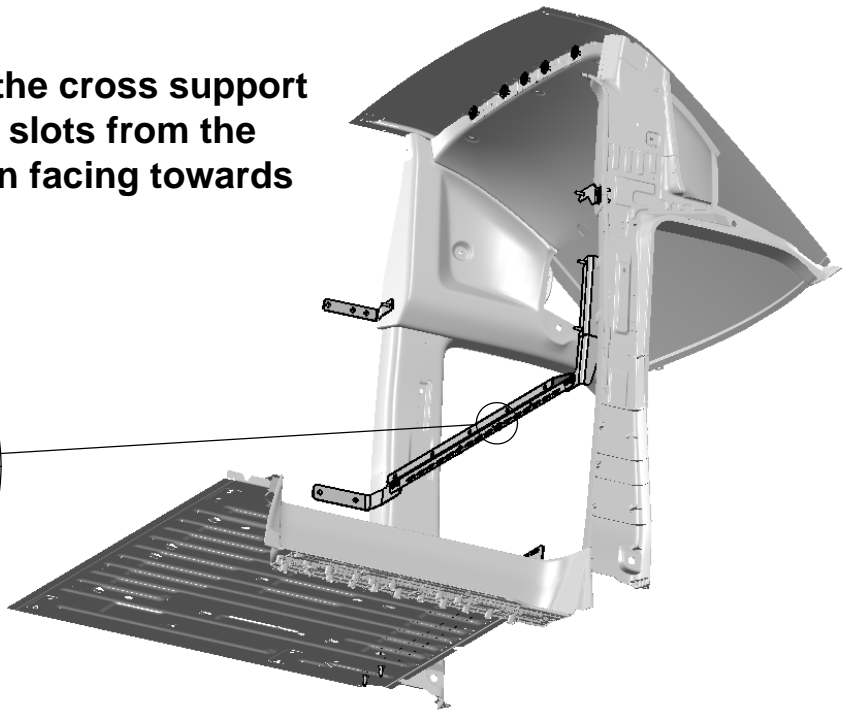
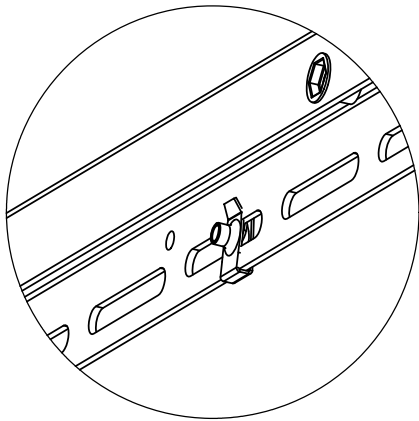

## Step 07

Attach vertical brackets as shown.

NOTE: FLANG FACES OUT TOWARDS SIDE OF VEHICLE.

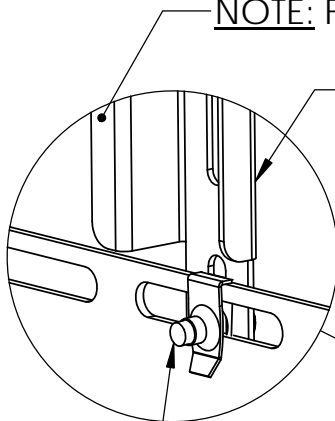

53885-B  
x 2

FAS0018  
x 4

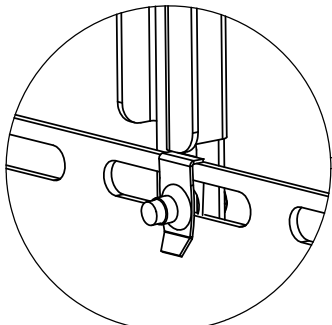

## Step 08

Cut bulb seal in half. Place bulb seal to both sides of the partition as shown. Starting at the bottom corner and working up.

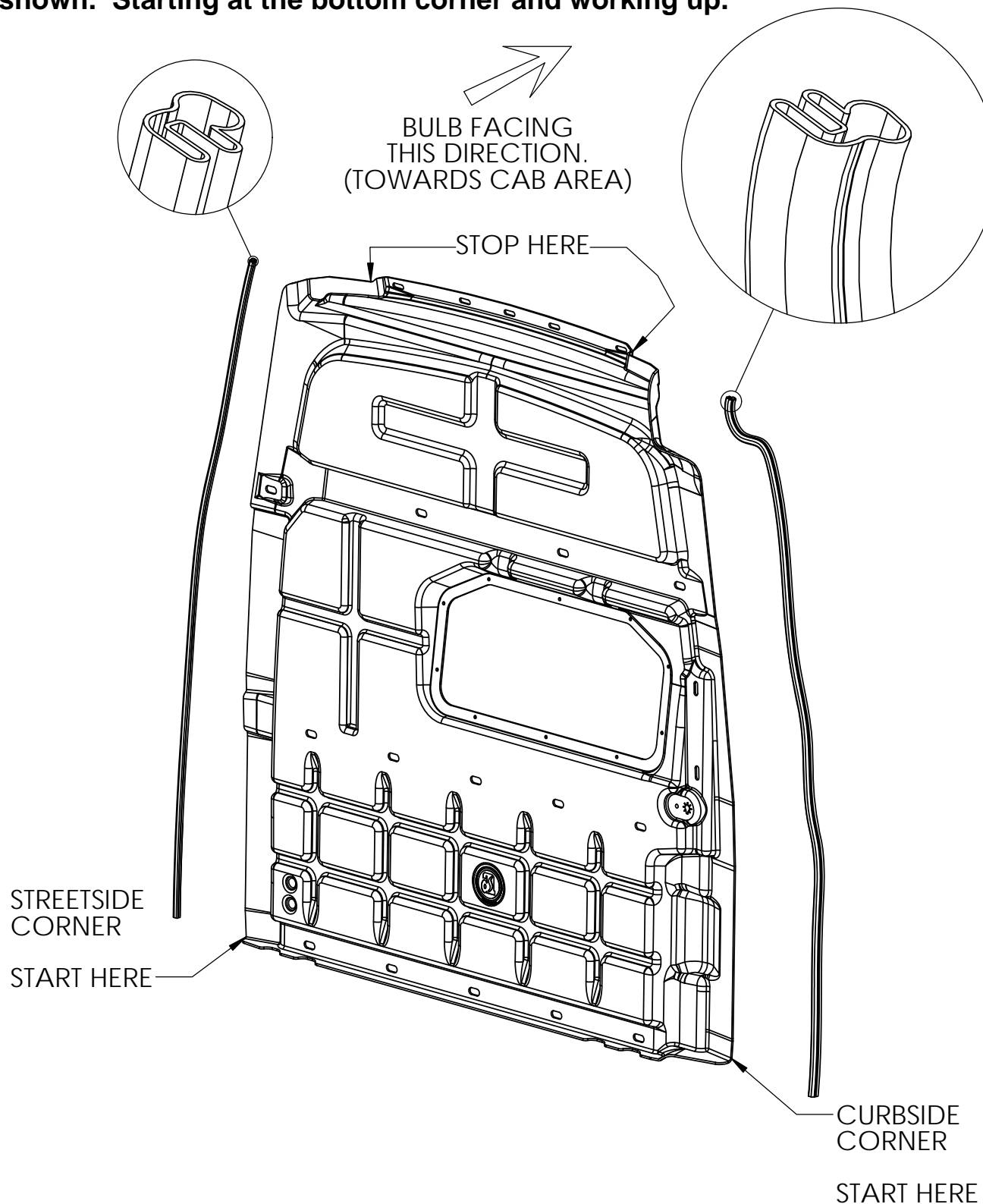

## Step 09

Place partition into vehicle and fasten the 5 bottom slots into footer rail.

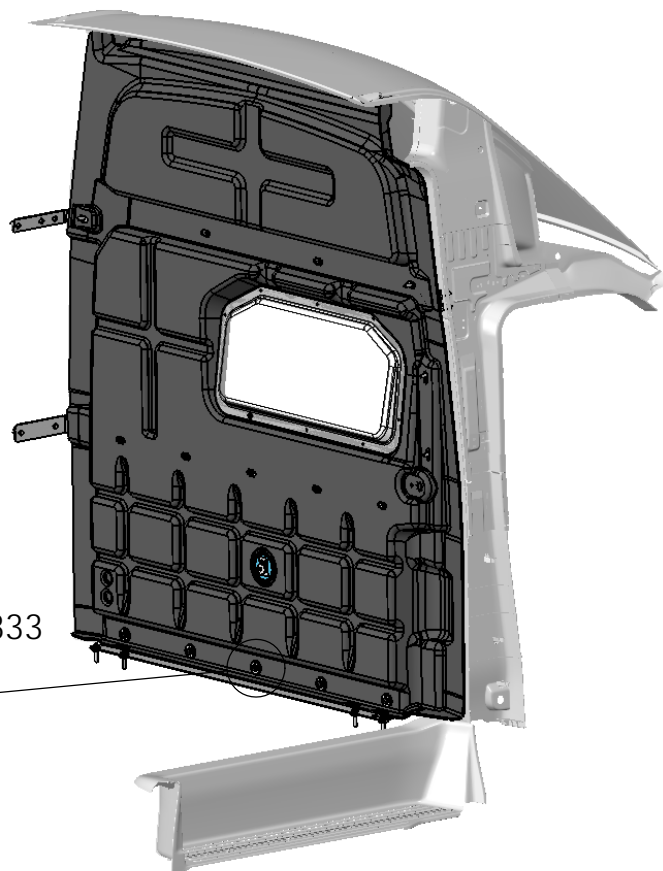
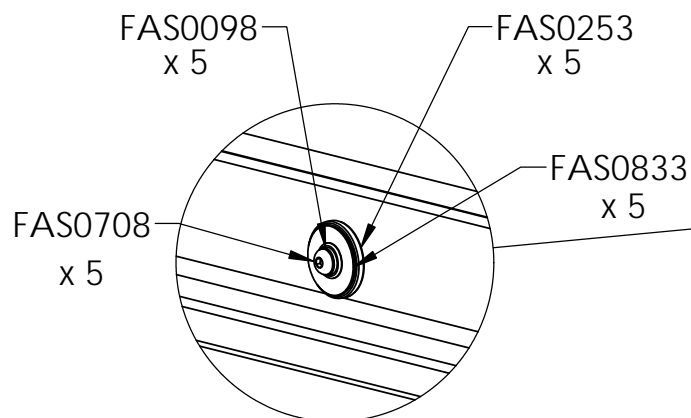

## Step 10

Fasten the 5 top slots into OEM holes.

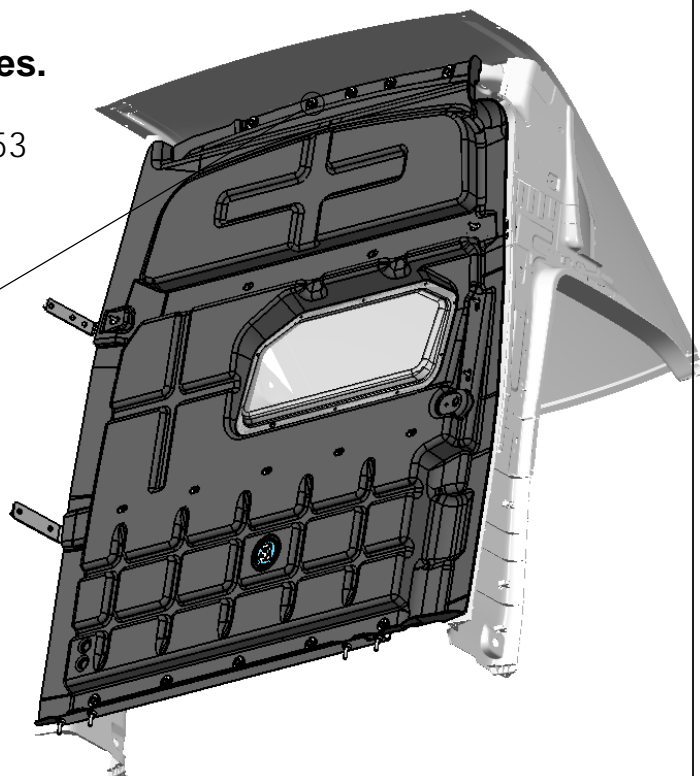
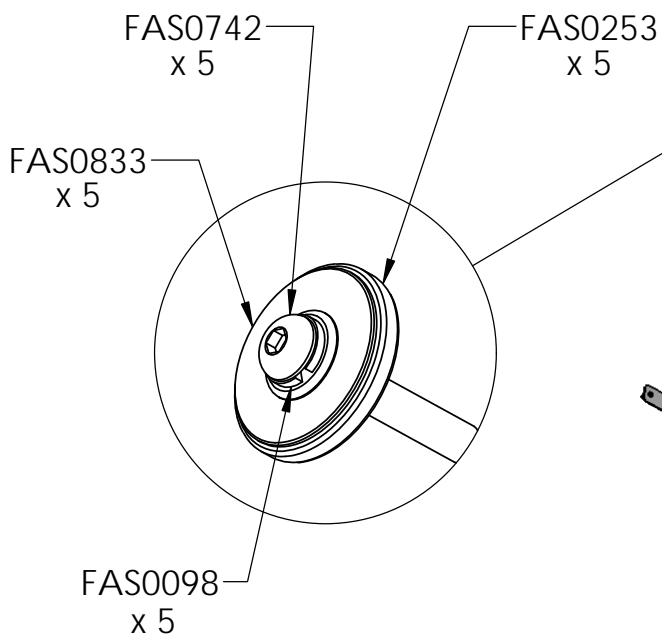

## Step 11

Place top support bracket into place and attach to the curbside and StreetSide as shown.

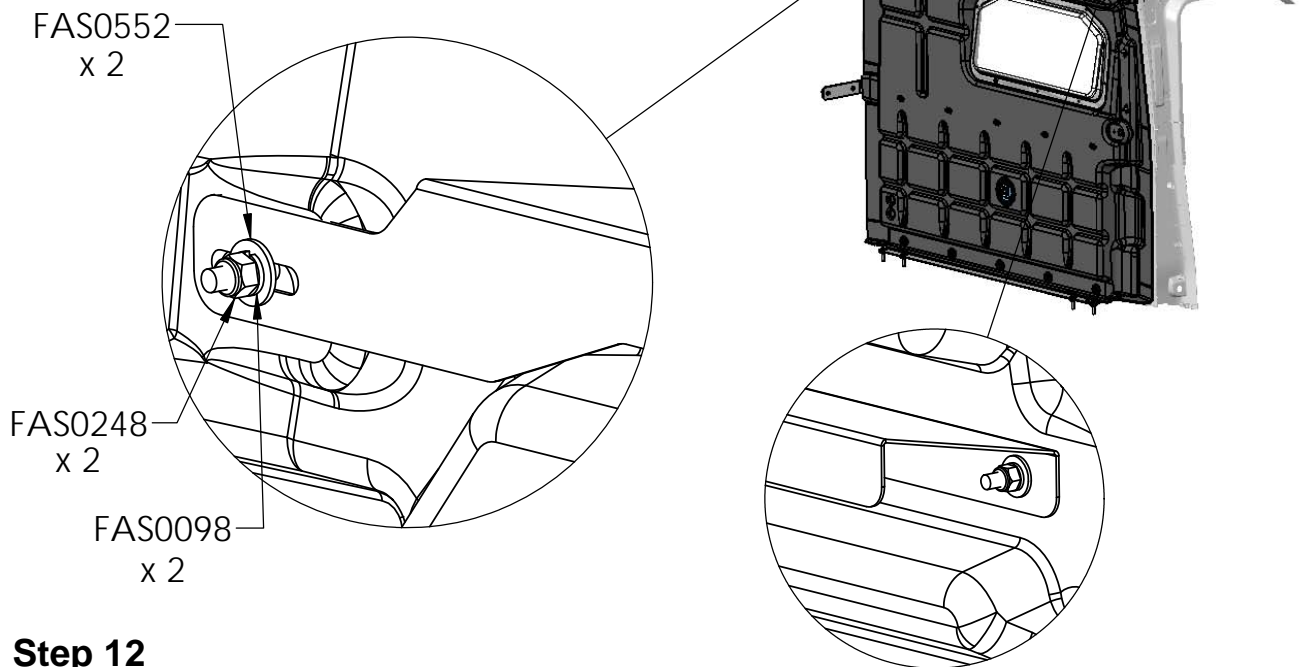

## Step 12

From the cab side, fasten the center upper bracket to the partition as shown.

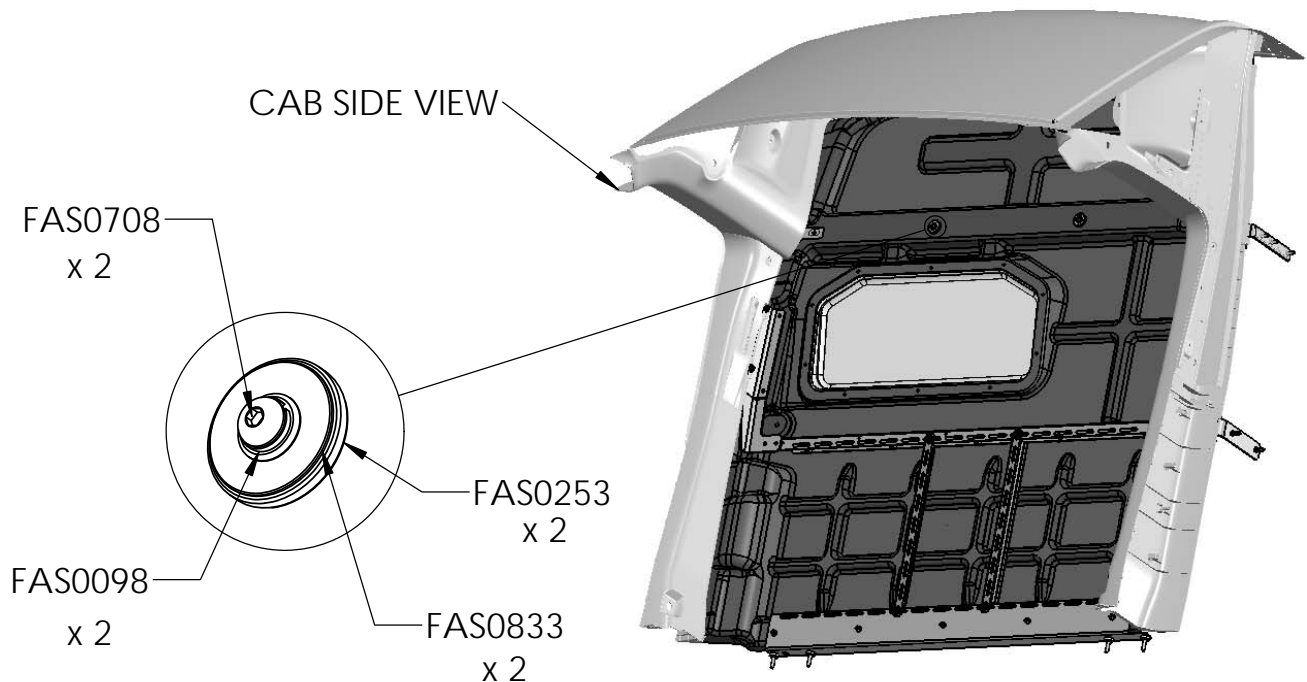



### Step 13

Attach and fasten grab handle bracket as shown.

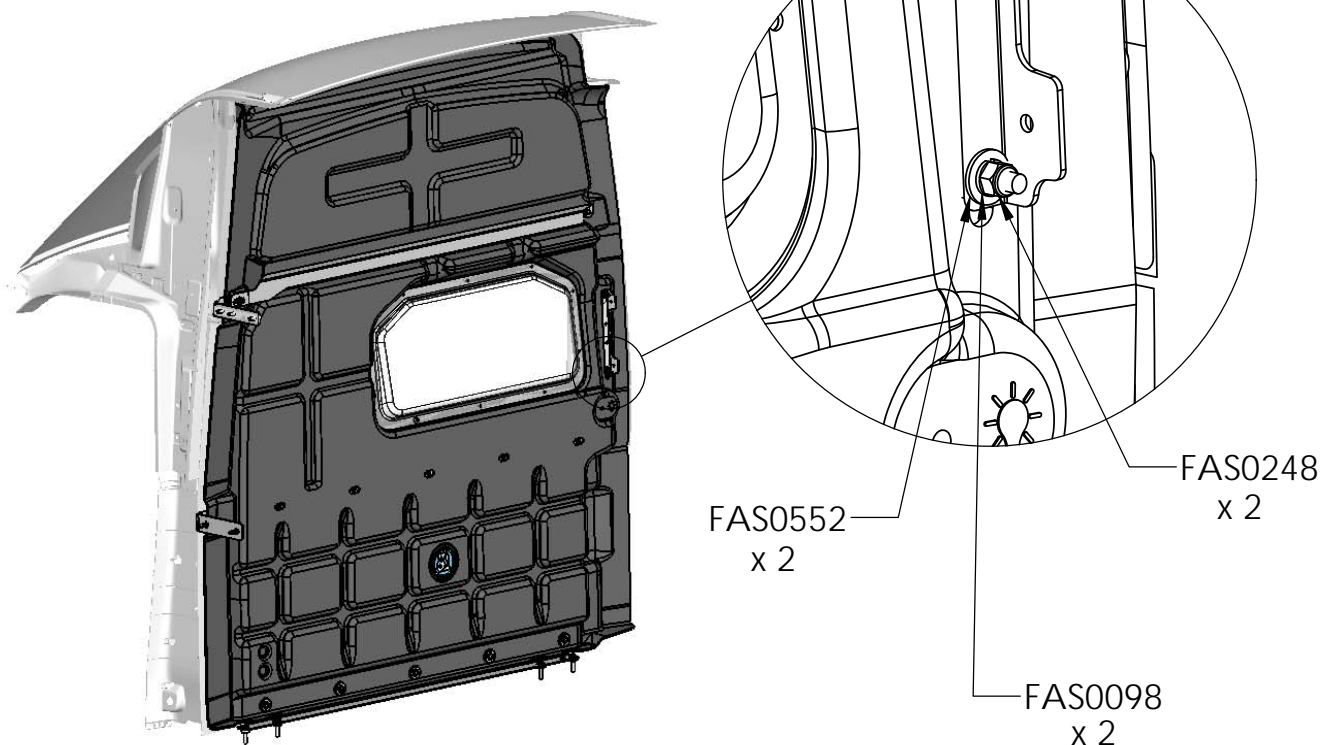

### Step 14

Attach and fasten OEM grab handle back on using the fasteners shown.

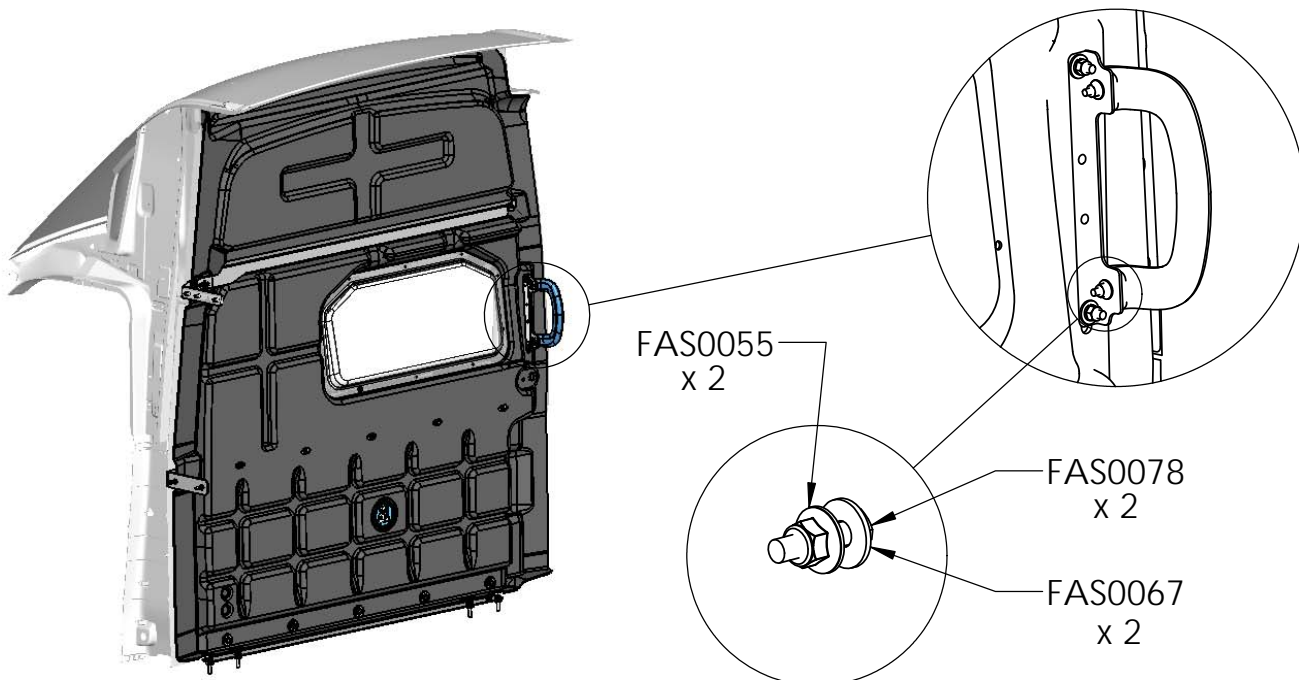

**Step 15**

**Attach end caps to AD rail as shown.**

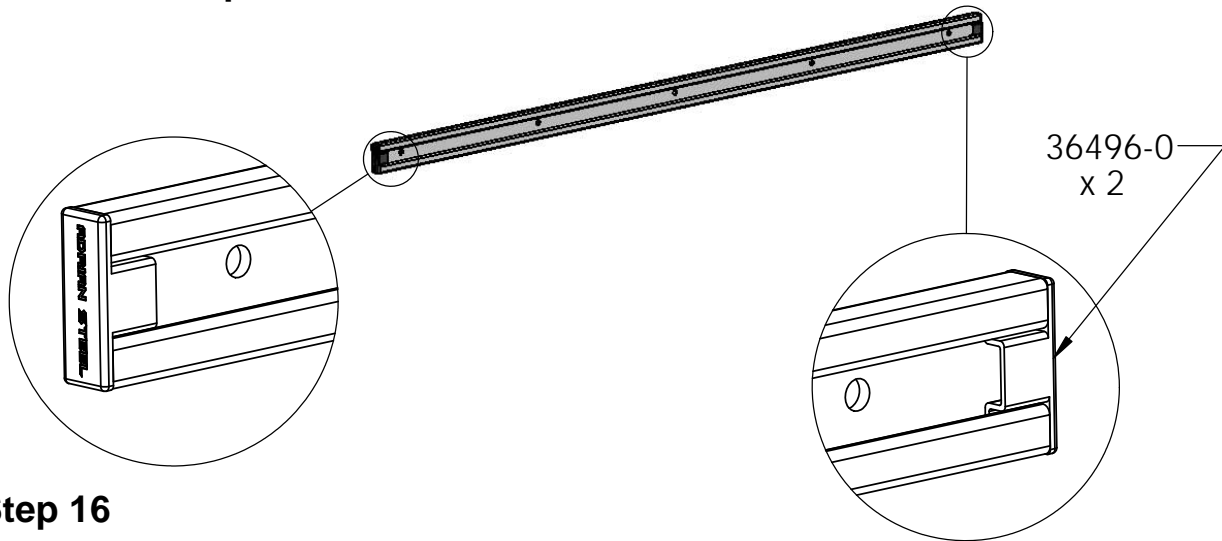

**Step 16**

**Attach AD rail as shown.**

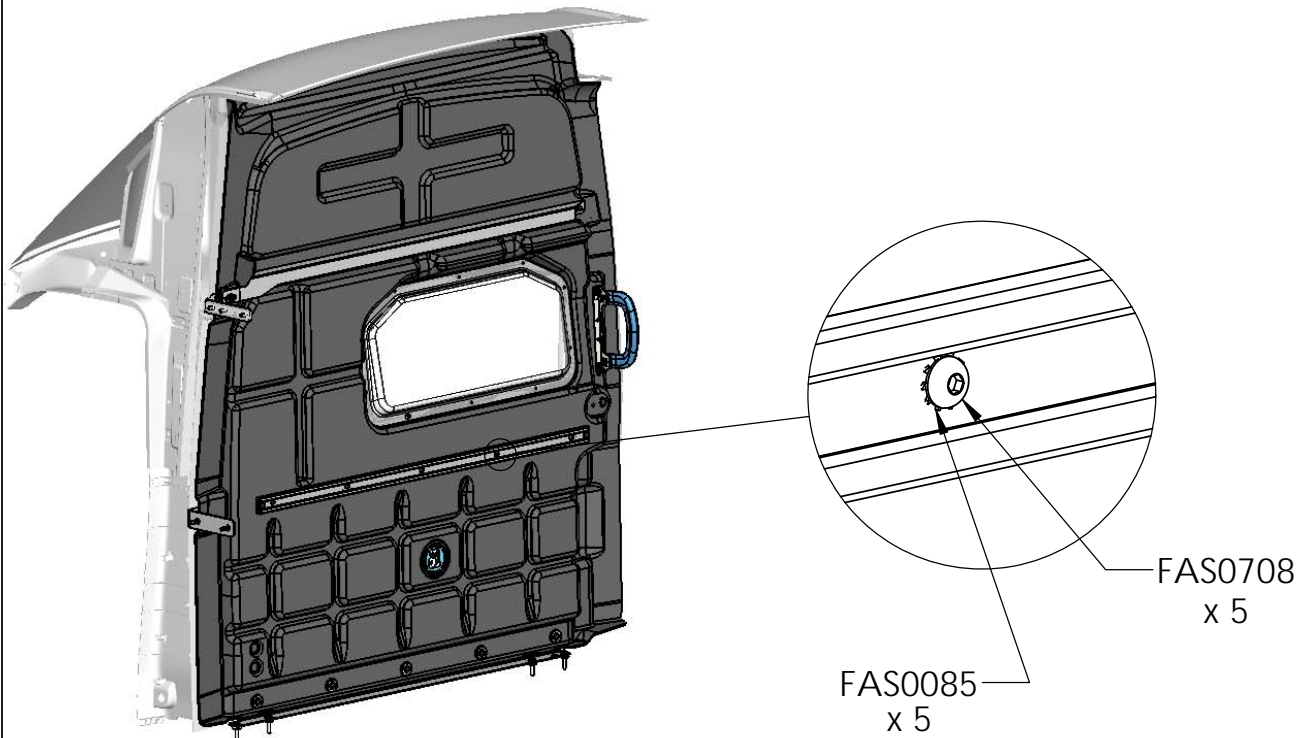

**YOUR INSTALLATION IS NOW COMPLETE.**

**DOUBLE CHECK ALL FASTENER LOCATIONS TO BE SURE THAT ALL  
FASTENERS ARE TIGHTENED TO SPECIFICATIONS.**

**YOUR INSTALLATION IS NOW COMPLETE!**

**STOW THIS COPY IN THE VEHICLE FOR FUTURE REFERENCES!**