



FORD TRANSIT MID-ROOF CREW VAN PARTITION



PRODUCT WEIGHT
91 LBS

WIDTH x DEPTH x HEIGHT
68.3" x 8.25" x 69.5"

CAPACITY
N/A

COLOR
BLACK

CATALOG NUMBER
PARFTMC-NW

PRODUCT FEATURES

Composite partition for FORD TRANSIT MID ROOF CREW VAN provides a semi-sealed solution for separating the crew area from the cargo area. The composite partition features a full perimeter bulb seal that seals off the majority of the airflow from the crew area to the cargo area. This feature provides better climate control for the crew area and reduces noise transfer from the cargo area to the crew area.

SEE PAGE 2 FOR APPLICATION NOTES AND ACCESSORIES, OTHER PRODUCTS THAT WORK WITH THIS UNIT.

PAGE 1 of 2

The information contained in this document is the sole property of ADRIAN STEEL COMPANY. ADRIAN STEEL COMPANY retains the right to modify and/or change the product of its design at any time without prior notification.

Accessory Chart

	Cargo Side			Cab Side		
	Base Partition BAGRKA1 REQUIRED (1 BAGRKA1 will allow for one accessory to be added)	PARHDW Fastener Kit Allow accessories to be added directly mounted to partition	PARFTMCRG (mounting kit cargo side)	Base Partition 1/4" nuts and bolts REQUIRED	PARHDW Fastener Kit Allow accessories to be added directly mounted to partition	PARFTMCAB (mounting kit cab side)
Available Accessories	-	-	-	-	-	-
PA7: Reflector kit	X	X	X	X	X	X
PA8: Fire ext.	X	X	X	X	X	X
PA9: First aid tray	X	X	X	X	X	X
PA10: Practice holder			X			X
PA11: Cab file			X	X		X
PA11NL: Catalog box			X	X		X
TA1: Four hook bar			X			X
CCD6: Center console 6"						X
TDC6: Tech desk 6"						X
TH30: 30lb tank holder			X			
TH50: 50lb tank holder			X			
UH50RM1: Rail mount kit			X			X
UH10: 1" hook			X			
UH25: 2.5" hook			X			
UH25CP-G: 2.5' hook comp			X			
UH50: 5" hook	X		X			

PARFTMCRG (shown in yellow)
 Cargo side hardware mounting kit installed

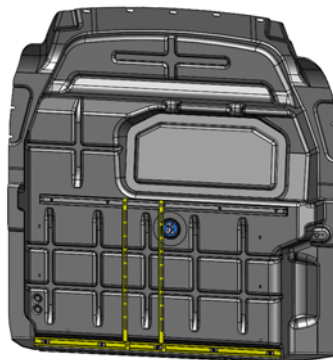

PARFTMCAB (shown below in yellow)
 Cab side hardware mounting kit installed

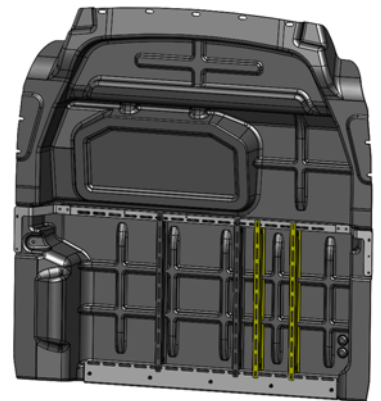
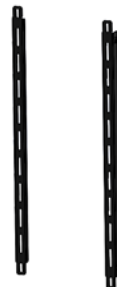

PARHDW Fastener Kit

Fastener kits allow for installation of smaller and lighter (up to 12 lbs.) Allows accessories to be directly mounted to the partition, such as: fire extinguisher, flare kit, first aid kits, acc.

Introduction / Comments:

Assembly/ Installation Instructions for Transit Mid/High Roof Crew Van Composite Partition

Note:

It is advised that all fasteners used in this assembly and installation should be checked for tightness at the following intervals: @ 2-weeks and again @ 6-weeks of operation. This preventive maintenance step must be completed to ensure your Product gives you long service life.



(PARFTMC SHOWN)

Composite Partitions
PARFTMC & PARFTMC-NW
PARFTHC & PARFTHC-NW
FOR FORD TRANSIT MID AND HIGH ROOF CREW
VANS

- PRECAUTIONS -



CAUTION
THE USE OF AIR IMPACT TOOLS CAN
OVER-TORQUE FASTENERS AND
CAUSE FASTENER FAILURE!



CAUTION
ALL INSTALLATION HOLES SHOULD BE SEALED
WITH SILICON OR BUTYL SEALANT TO PREVENT
EXHAUST FUMES FROM ENTERING THE VEHICLE!



DANGER
INSPECT FOR FUEL TANK, FUEL LINES, BRAKE LINES, HIGH
VOLTAGE BATTERIES AND ELECTRICAL LINES PRIOR TO
DRILLING TO AVOID DAMAGING CRITICAL VEHICLE SYSTEMS
OR INJURY TO INSTALLER DURING INSTALLATION PROCESS!

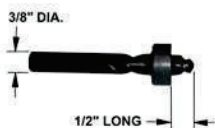

CAUTION
TO AVOID DAMAGING THE VEHICLE ALWAYS USE DRILL
STOPS WHEN DRILLING ANY INSTALLATION HOLES!
ADRIAN AVAILABLE PART #'S 31119-0 (3/8" X 1/2"
DEEP), 31121-0 (1/2" x 1/2" DEEP)



- IMPORTANT WARRANTY REQUIREMENTS -

1. SUBSTITUTING ADRIAN STEEL SPECIFIED FASTENERS FOR ASSEMBLY AND/OR INSTALLATION WILL VOID YOUR PRODUCT WARRANTY.
2. ALL HOLES DRILLED INTO VEHICLE SHOULD HAVE THE RAW METAL EDGES SEALED WITH A SELF-ETCHING PRIMER TO RESIST CORROSION AND POTENTIAL FASTENER POINT FAILURE.
3. ALL FASTENERS USED IN THE INSTALLATION OF THIS PRODUCT SHOULD BE TIGHTENED TO THE TORQUE(S) SPECIFIED IN THESE INSTRUCTIONS.
4. THESE INSTRUCTIONS SHOULD BE KEPT WITH THE VEHICLE.

THE BASIC TOOLS NEEDED FOR MOST INSTALLATIONS



DRILL

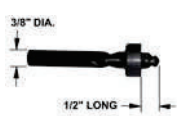

DRILL BIT WITH
STOP

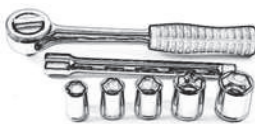

RATCHET, SOCKETS
AND/OR WRENCHES



SCREWDRIVERS



MEASURING TAPE

ADDITIONAL TOOLS MAY BE NEEDED FOR THIS INSTALLATION AND THEY WILL BE IDENTIFIED IN THE STEPS THAT FOLLOW.

If your vehicle contains carpet or a rubber floor mat you will need to prepare the mounting location. Position the product to be installed into the vehicle and once you are satisfied with the mounting locations, mark the mounting locations. Using a 1-3/16" diameter carpet cutter (P/N: 31183-0). Select the appropriate floor spacers as shown in the illustration. Set those aside for use later into the installation process.

Using the correct drill bit size for the selected plusnut, drill the mounting holes in the vehicle sheet metal to prepare for installing the plusnuts.

If you are thru-bolting at any of the locations simply drill a hole that is 1/16" larger than the bolt size(s) for those locations.

Once you have drilled the holes into the vehicle, the raw metal edges should be sealed using a self-etching primer to resist corrosion and potential fastener point failure.

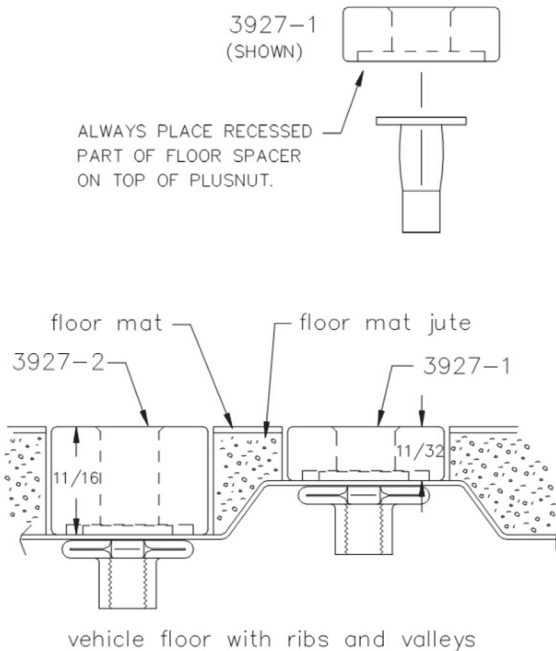

A PLUSNUT (RIVNUT) SETTING TOOL IS REQUIRED FOR PLUSNUT (RIVNUT) INSTALLATION . PLUS NUT SETTING TOOL CAN BE ORDERED THROUGH ADRIAN STEEL, OR USE AN AIR POWERED PLUSNUT SETTING GUN.

1/4-20UNC Plusnut (FAS0052) Use 3/8" dia. drill w/stop
FAS0080 SCREW, HXHD, 1/4-20UNCx2.00", G8
FAS0067 WASHER, FLAT, 1/4"ID
22200-0 PLUSNUT TOOL

5/16-18UNC Plusnut (FAS0091) Use 1/2" dia. drill w/stop
FAS0095 SCREW, HXHD, 5/16-18UNCx2.00", G8
FAS0086 WASHER, FLAT, 5/16"ID
22200-0 PLUSNUT TOOL

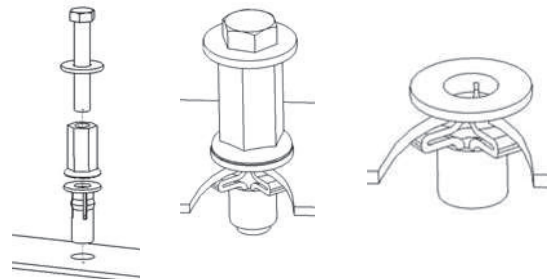

Place barrel of the plusnut body in sheet metal thru hole until flange is flush with sheet metal.

Using a 9/16" combination wrench of plusnut tool body and a second hand wrench, ratchet, or air tool, rotate the hex bolt head CW to draw plus nut flanges up (set the plusnut).

Installation and/or Assembly Fasteners
BAG61454

ITEM NO.	PART NUMBER	DESCRIPTION	QTY.
1	BAG0709-A	7" x 9" 3MIL AUTOBAG	1
2	FAS0018	SCREW,HH SFLNG 1/4-20X.62 ZP	4
3	36496-0	END CAP	2
4	FAS0833	WASHER, CUP FLANGED 1.5"	10
5	FAS0085	WASHER,LCK EXT 5/16 ZP	22
6	FAS0708	SCREW,BHCS 5/16-18X1.25ZN	22
7	FAS0711	SPRING,CLIP 1/4-20 BK PH	4
8	FAS0248	Nut, Nylon Insert Lock, 5/16-18 SST	13
9	FAS0552	Washer, Flat, 5/16, SST	21
10	FAS0091	Plusnut, 5/16	8
11	FAS0253	WASHER, FOAM RUBBER, 1.50X0.375X0.5	10
12	FAS0408	SCREW,HH 7/16-20 X 1.25	2

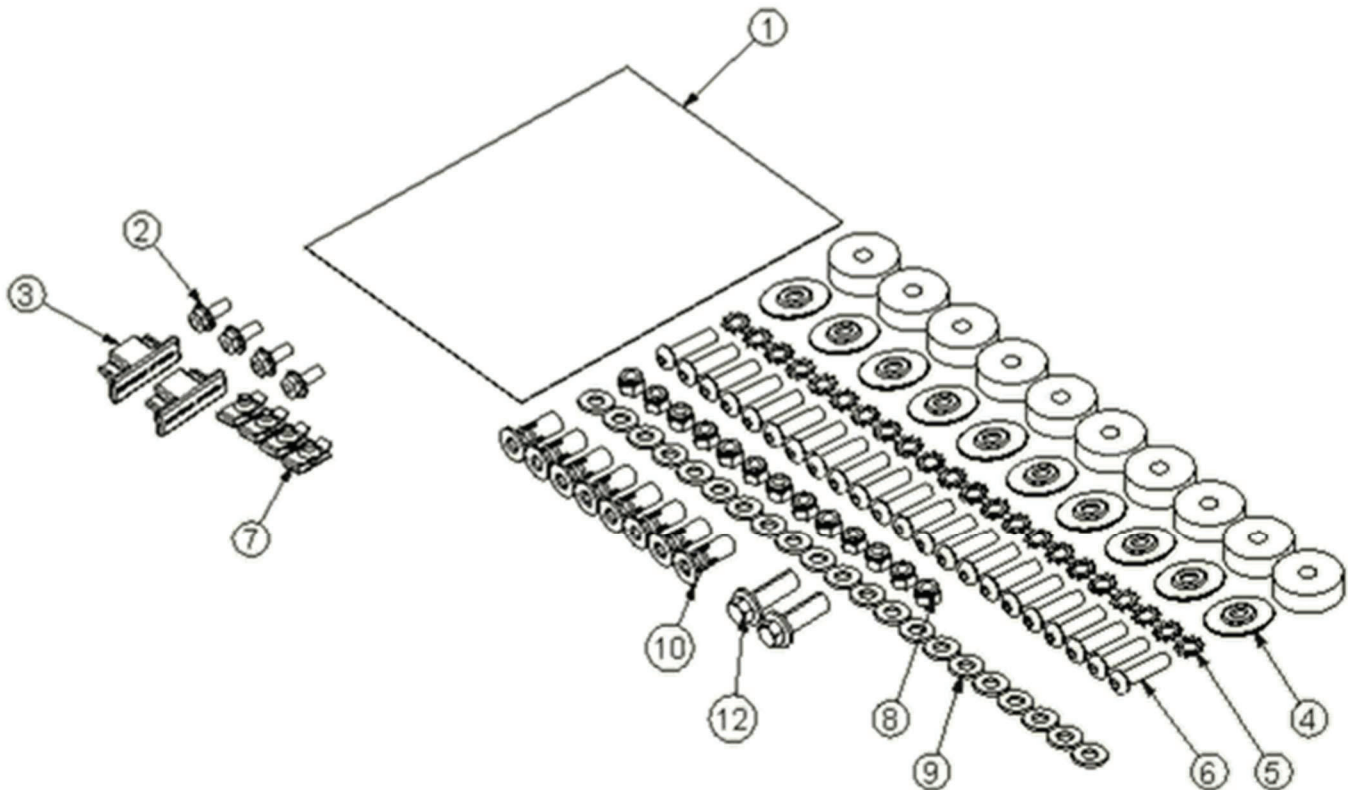

Step 01 Remove OEM “D” Rings from the bottom of the “C” Pillar. Use a T-50 Torx Bit.

NOTE: Disregard if your vehicle did NOT come with optional “D”-Rings

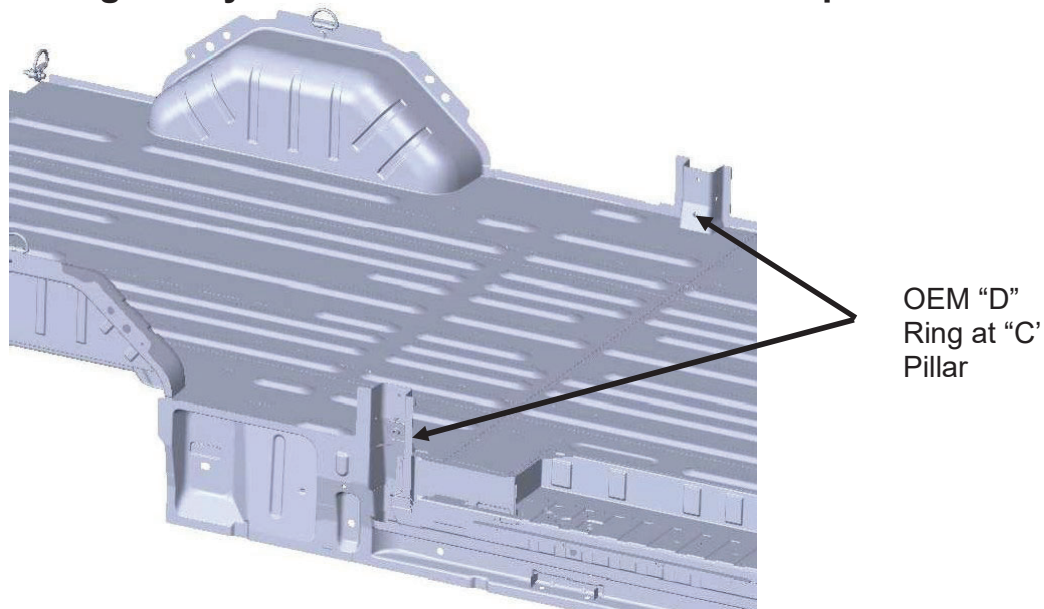

Step 02 Mount Footer Bracket to Vehicle using OEM D-Rings, (You may have to slide the footer bracket under the sub floor.

NOTE: Use FAS0408 if ‘D’-Rings are not present

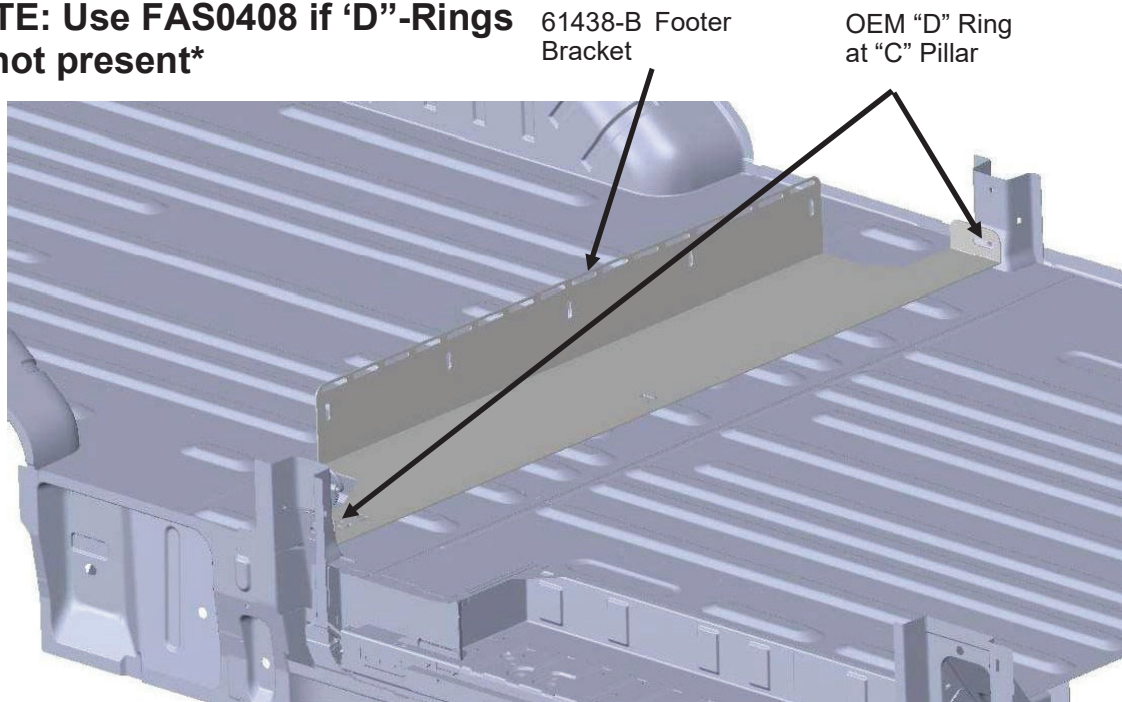

Step 03 Add Spring Clips to Footer Bracket with the threaded portion facing towards the rear of the vehicle in the 5th and 12th slots from the curbside end as shown.

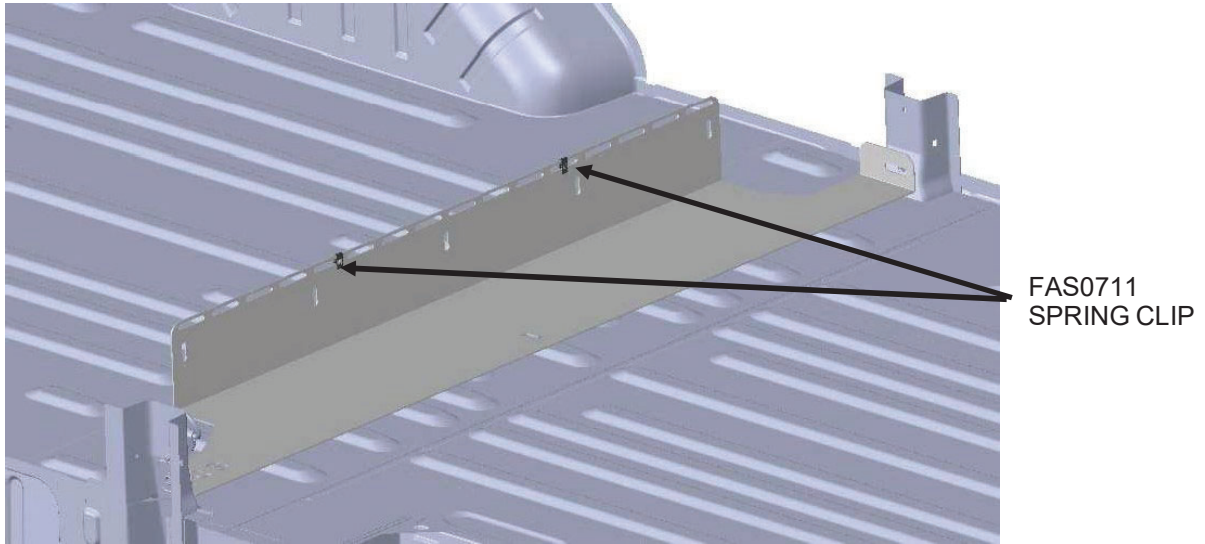

Step 04 Enlarge existing hole using a 1/2" Dia. Drill Bit with Drill Stop and set 5/16-18 Plusnut for "C"-Pillar Bracket.

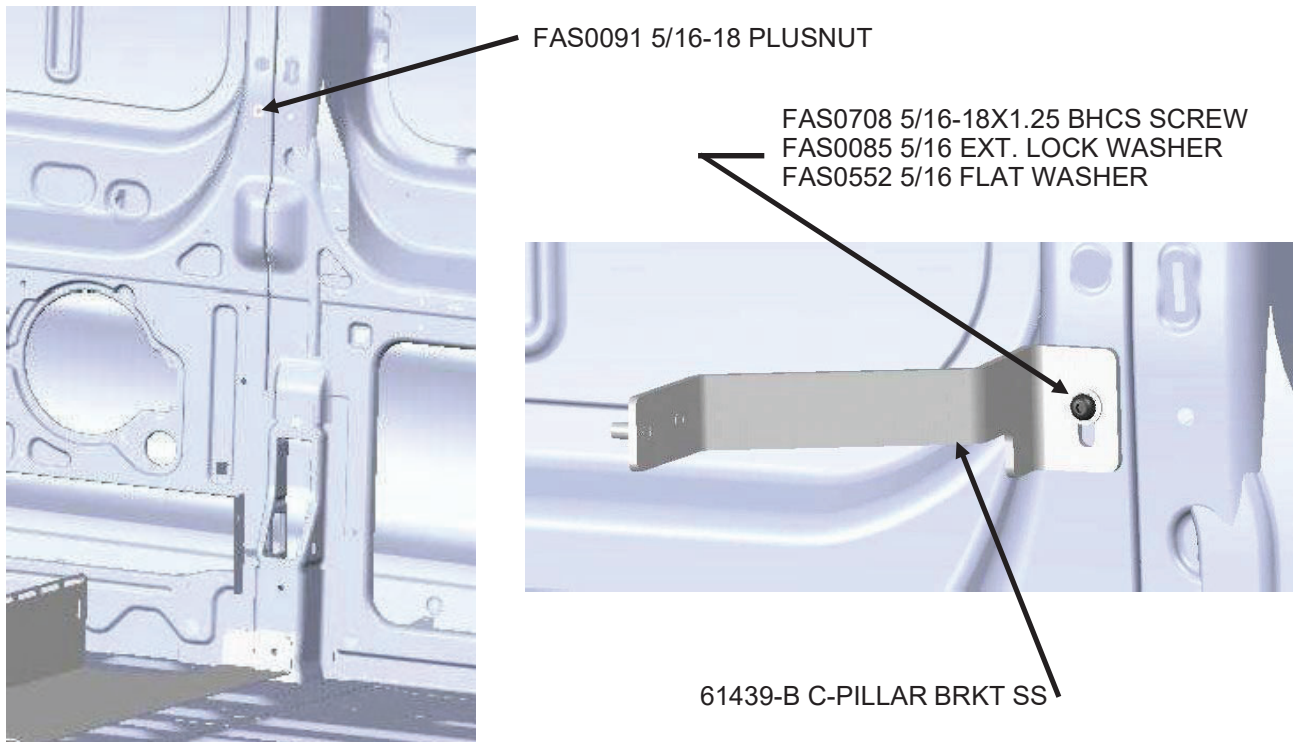

Step 05 Enlarge existing hole using a 1/2" Dia. Drill Bit with Drill Stop and set 5/16-18 Plusnut for "C"-Pillar Bracket.

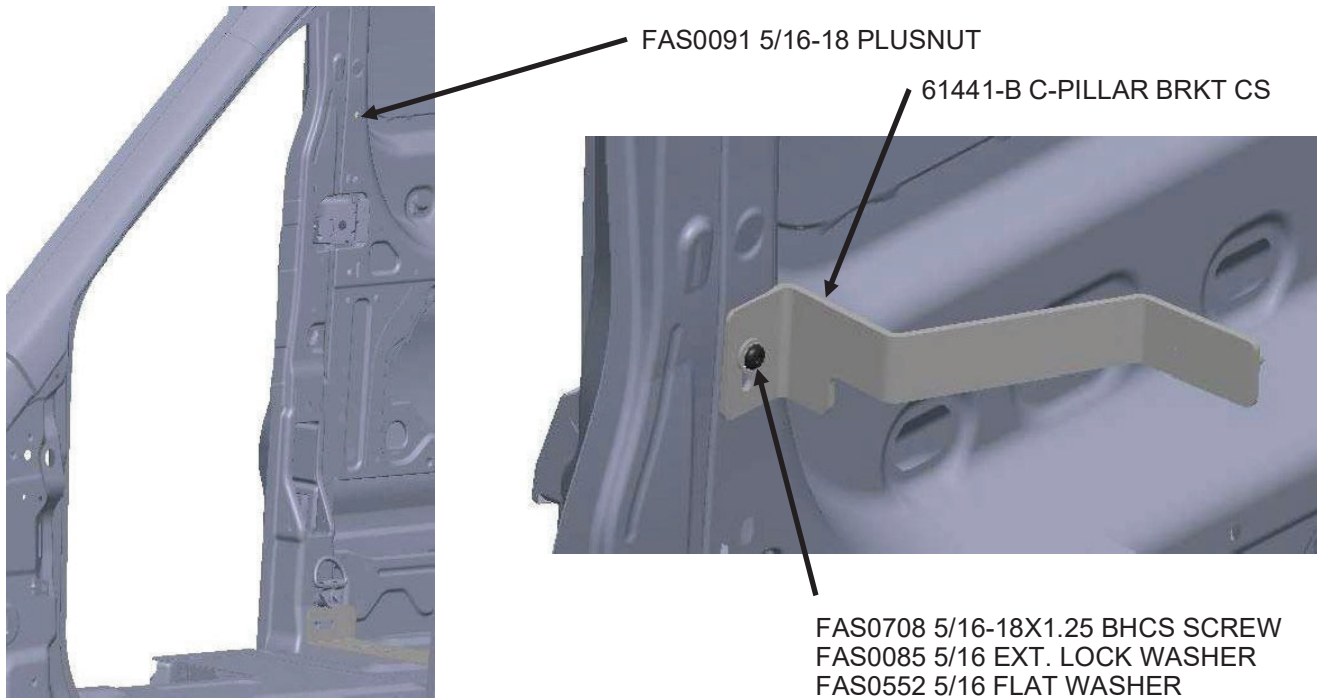

Step 06 Attach Cross Channel to "C" Pillar SS Bracket. The end of the Cross Channel with Holes instead of slots is going to mount to the Street Side Bracket.

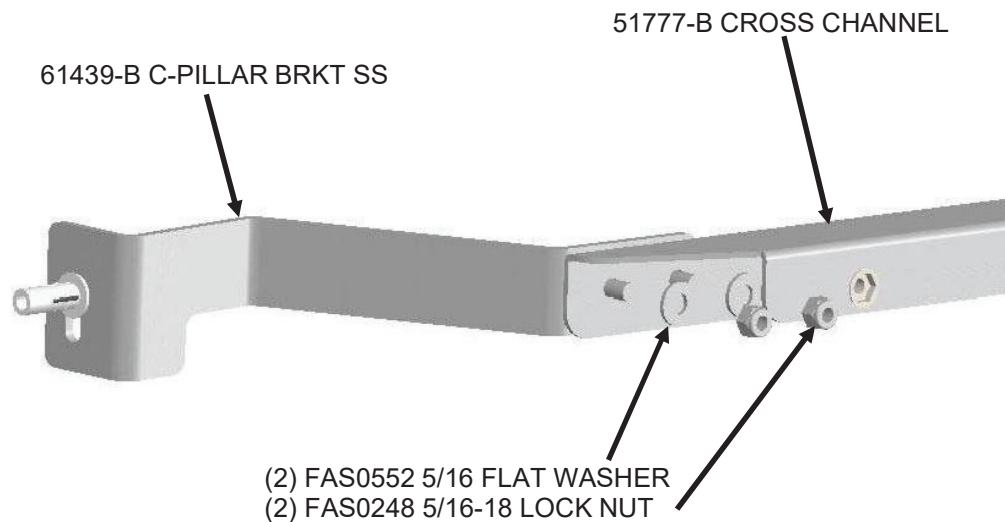

Step 07 Attach Cross Channel to "C" Pillar CS Bracket. The end of the Cross Channel with Slots will mount to the Curb Side Bracket.

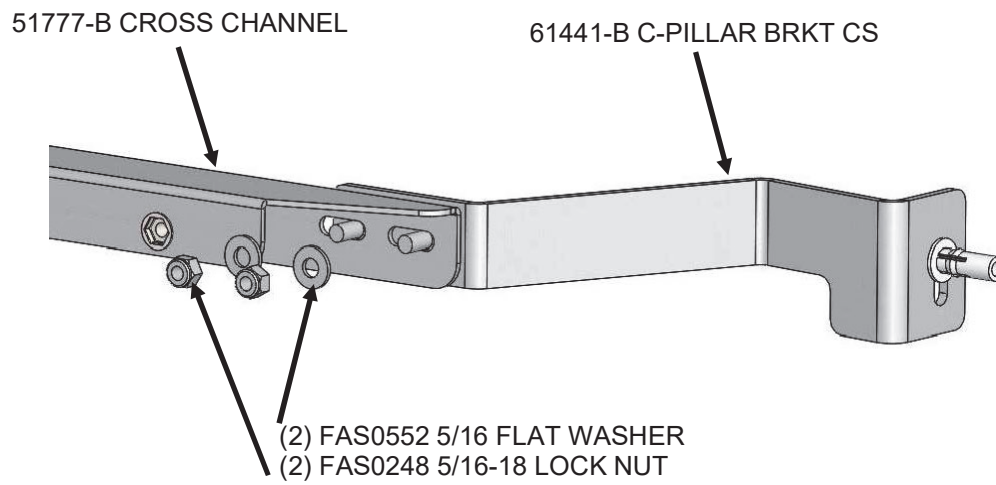

Step 08 Add Spring Clips to Cross Channel with the threaded portion facing towards the rear of the vehicle in the 6th and 13th slots from the curbside end as shown.

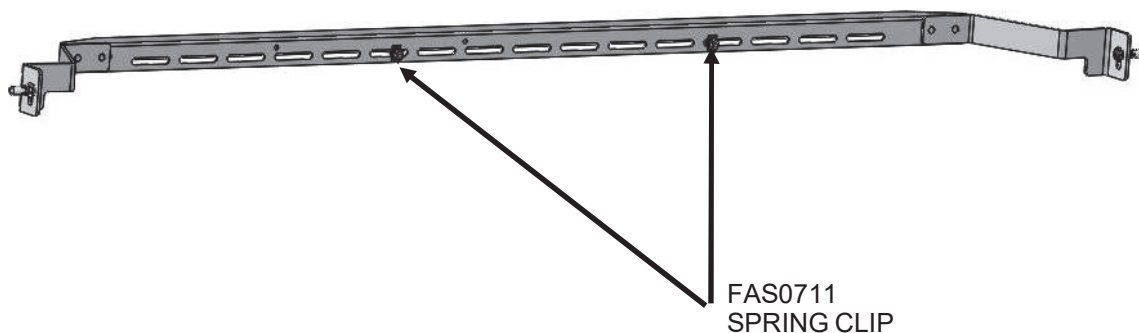

Step 09 Attach accessory mounting channels as shown.

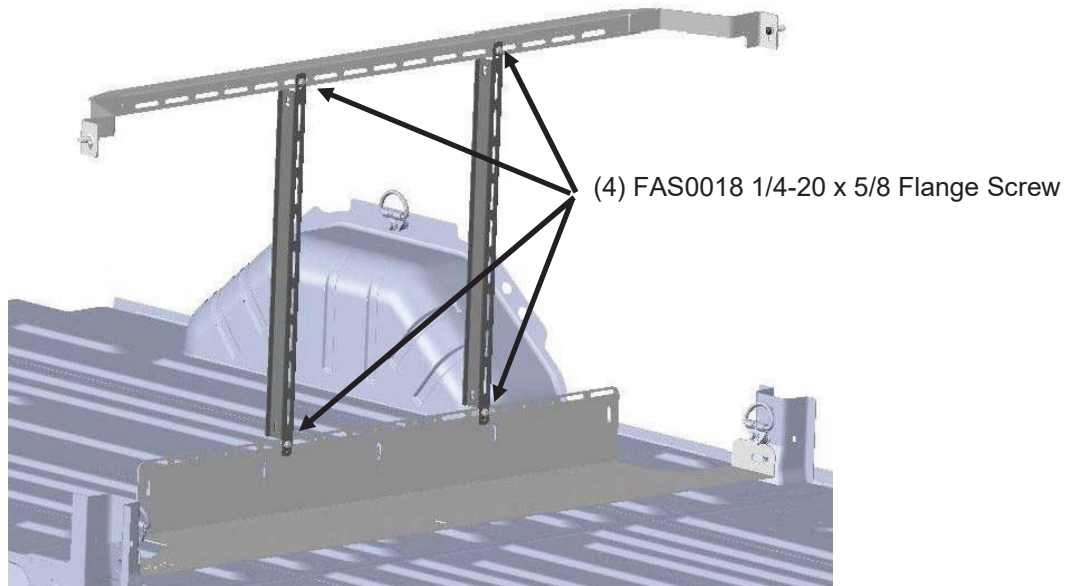

Step 10 Attach Bulb Seal to Partition panel as shown.

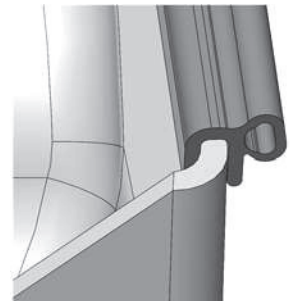

**BULB FACING
THIS DIRECTION
TOWARDS
FRONT OF
VEHICLE.**

Step 11 For 130"WB Vans you will need to trim off a small Section of the Composite Partition on the Drivers Side. See Panel Below. **THIS STEP IS ONLY FOR 130"WHEELBASE.**

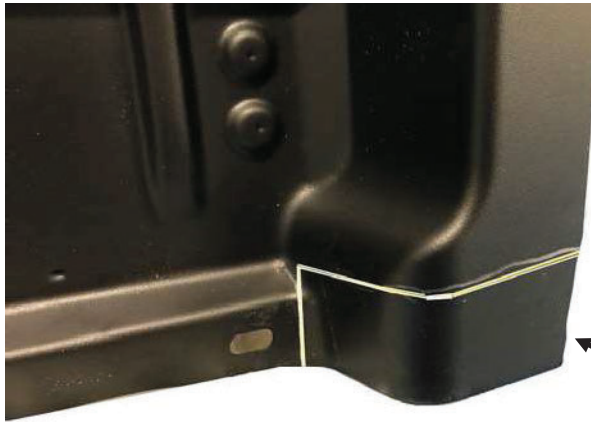

Mark a Line 4" Up, from the edge of the partition over to the flat area where the partition will mount to the Footer Bracket as shown above. This will allow the panel to fit over the Wheel well.



Step 12 There will be an Upper Trim Piece that will need to be removed and Cut to allow the partition to mount to the Roof Bow. Cut a Section 40.5" Wide, Leaving 2.5" as shown for Mounting to the Roof Bow. Watch for Electrical Wires that may need to be re-located to the forward side of the roof bow.



Step 13a For Mid Roof Vans; Position Panel in place and Mark the Roof Bow Mounting Holes Using the Partition Panel as a jig. Drill 1/2" Dia. Hole and set Plusnuts



FAS0091 5/16-18 PLUSNUT
(5) FOR MID ROOF
(6) FOR HIGH ROOF



Step 13b For High Roof Vans; Attach Header Panel to Front of Partition as shown below, Then Using the Header Panel as a jig, Mark and Drill 1/2" Dia. Hole and set Plusnuts

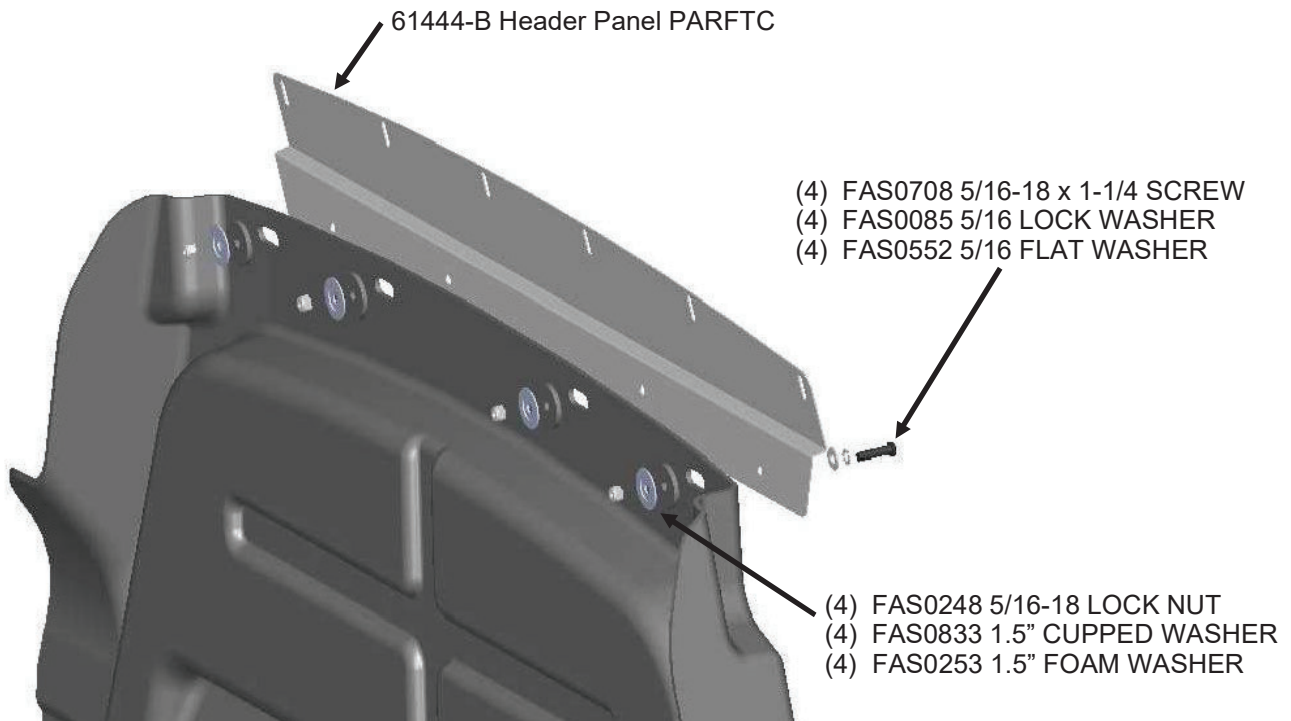

Step 14 Insert a Plastic end cap into each end of the AD Rail and Attach AD Rail to Partition as shown below. Do Not Fully Tighten at this time.

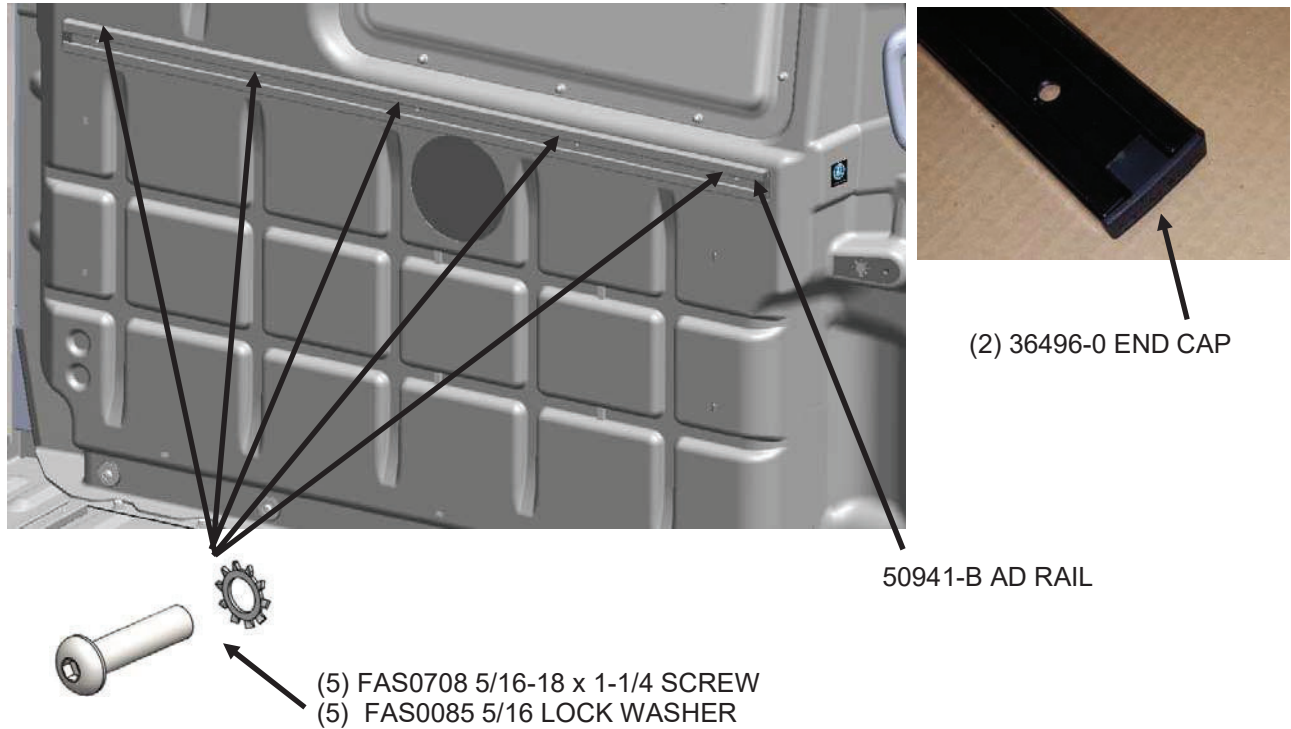

Step 15 Attach Partition Panel to Roof Bow as shown.

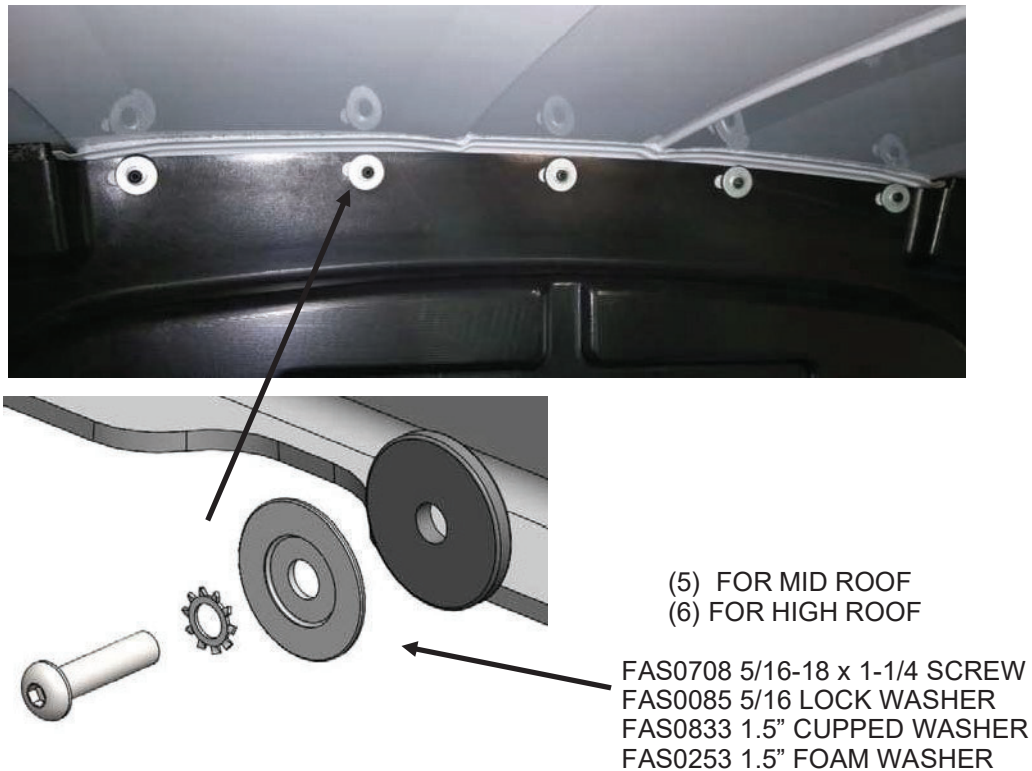

Step 16 Attach Partition Panel to Footer Bracket as shown.

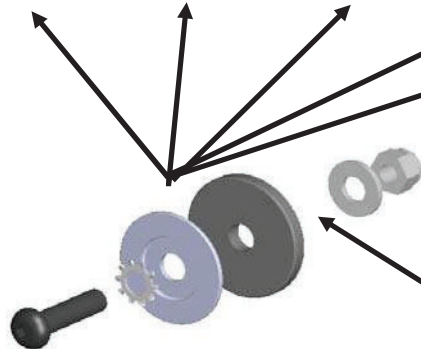

- (5) FAS0708 5/16-18 x 1-1/4 SCREW
- (5) FAS0085 5/16 LOCK WASHER
- (5) FAS0833 1.5" CUPPED WASHER
- (5) FAS0253 1.5" FOAM WASHER
- (5) FAS0552 5/16 FLAT WASHER
- (5) FAS0248 5/16-18 LOCK NUT

Partition Panel and Footer Bracket are between the foam washer and flat washer

Step 16 Tighten all Fasteners

DOUBLE CHECK ALL FASTENER LOCATIONS TO BE SURE THAT ALL FASTENERS ARE TIGHTENED TO SPECIFICATIONS.
YOUR INSTALLATION IS NOW COMPLETE!
STOW THIS COPY IN THE VEHICLE FOR FUTURE REFERENCES!