

FORD TRANSIT MID-ROOF PARTITION

PRODUCT WEIGHT

73 LBS

WIDTH x DEPTH x HEIGHT

68.3" x 8.25" x 69.5"

CAPACITY

N/A

COLOR

BLACK

CATALOG NUMBER

PARFTM2



PRODUCT FEATURES

Composite partition for FORD TRANSIT MID ROOF provides a semi-sealed solution for separating the cab area from the cargo area. The composite partition features a full perimeter bulb seal that seals off the majority of the airflow from the cab area to the cargo area. This feature provides better climate control for the cab area and reduces noise transfer from the cargo area to the cab area. This product is "No-Drill" and is compatible with the E-Transit model lineup.

**** This WILL work with dual side sliding door option ****

Driver Comfort Details

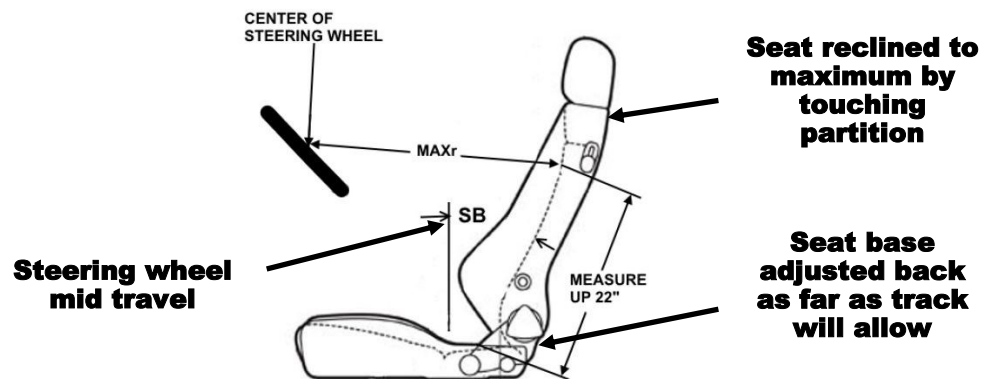

| | DESCRIPTION | DIMENSION |
|------|----------------------|-------------------|
| SB | SEAT BACK ANGLE | 12 degrees |
| MAXr | MAXIMUM DRIVER REACH | 31" |

SEE PAGE 2 FOR APPLICATION NOTES AND ACCESSORIES, OTHER PRODUCTS THAT WORK WITH THIS UNIT.

PAGE 1 of 2

The information contained in this document is the sole property of ADRIAN STEEL COMPANY. ADRIAN STEEL COMPANY retains the right to modify and/or change the product of its design at any time without prior notification.

Accessory Chart

| | Cargo Side | | | Cab Side | | |
|------------------------------|--|---|---|--|---|---|
| | Base Partition BAGRKA1 REQUIRED (1 BAGRKA1 will allow for one accessory to be added) | PARHDW Fastener Kit Allow accessories to be added directly mounted to partition | PARFTMCRG (mounting kit cargo side) | Base Partition 1/4" nuts and bolts REQUIRED | PARHDW Fastener Kit Allow accessories to be added directly mounted to partition | PARFTMCAB (mounting kit cab side) |
| Available Accessories | - | - | - | - | - | - |
| PA7: Reflector kit | X | X | X | X | X | X |
| PA8: Fire ext. | X | X | X | X | X | X |
| PA9: First aid tray | X | X | X | X | X | X |
| PA10: Practice holder | | | X | | | X |
| PA11: Cab file | | | X | X | | X |
| PA11NL: Catalog box | | | X | X | | X |
| TA1: Four hook bar | | | X | | | X |
| CCD6: Center console 6" | | | | | | X |
| TDC6: Tech desk 6" | | | | | | X |
| TH30: 30lb tank holder | | | X | | | |
| TH50: 50lb tank holder | | | X | | | |
| UH50RM1: Rail mount kit | | | X | | | X |
| UH10: 1" hook | | | X | | | |
| UH25: 2.5" hook | | | X | | | |
| UH25CP-G: 2.5' hook comp | | | X | | | |
| UH50: 5" hook | X | | X | | | |

PARFTMCRG (shown in yellow)
 Cargo side hardware mounting kit installed

PARFTMCAB (shown below in yellow)
 Cab side hardware mounting kit installed

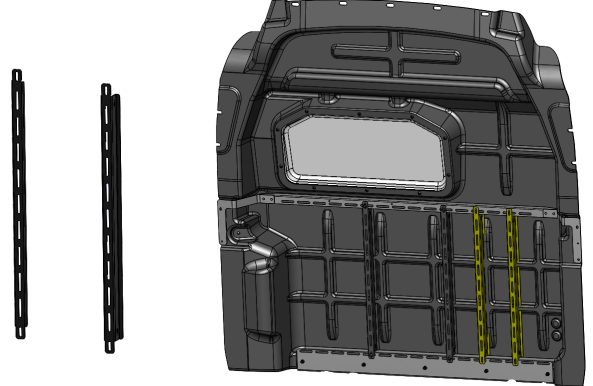
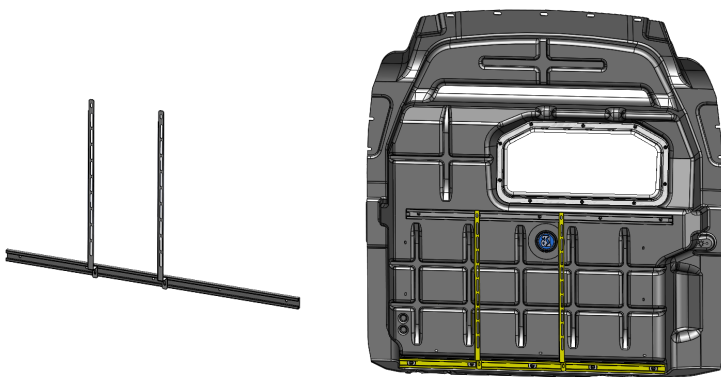

PARHDW Fastener Kit

Fastener kits allow for installation of smaller and lighter (up to 12 lbs.) Allows accessories to be directly mounted to the partition, such as: fire extinguisher, flare kit, first aid kits, acc.

| | | | | | | |
|---|-------|--------|----------|-------------|-------------------------------|------|
| INSTR. NUMBER : 66992 | PG: 1 | REV: B | ITEM NO. | PART NUMBER | DESCRIPTION | QTY. |
| | | | 1 | 50941 | RAIL AD, PARFTL | 1 |
| PART NUMBER : PARFTM2 | | | 2 | 51774 | PAR ASSM, W/WDO, FTM | 1 |
| PART : COMP PAR, W/WDO, FTM2 DESC. : | | | 3 | 51777-B | CROSS CHANNEL ASSM | 1 |
| | | | 4 | 51778-B | B-PILLAR BRKT ASSM, CS FTMR | 1 |
| NOTE: THIS INSTRUCTION IS ALSO VALID FOR PARFTM2-NW, PARFTH2, | | | 5 | 51779-B | B-PILLAR BRKT ASSM, SS FTMR | 1 |
| | | | 6 | 51782-B | ACC. MTG. CHANNEL, PARFTM | 2 |
| | | | 7 | 66915-B | FOOTER, FTM, NO DRILL COMP, B | 1 |

① IS NOT SHOWN IN THIS VIEW

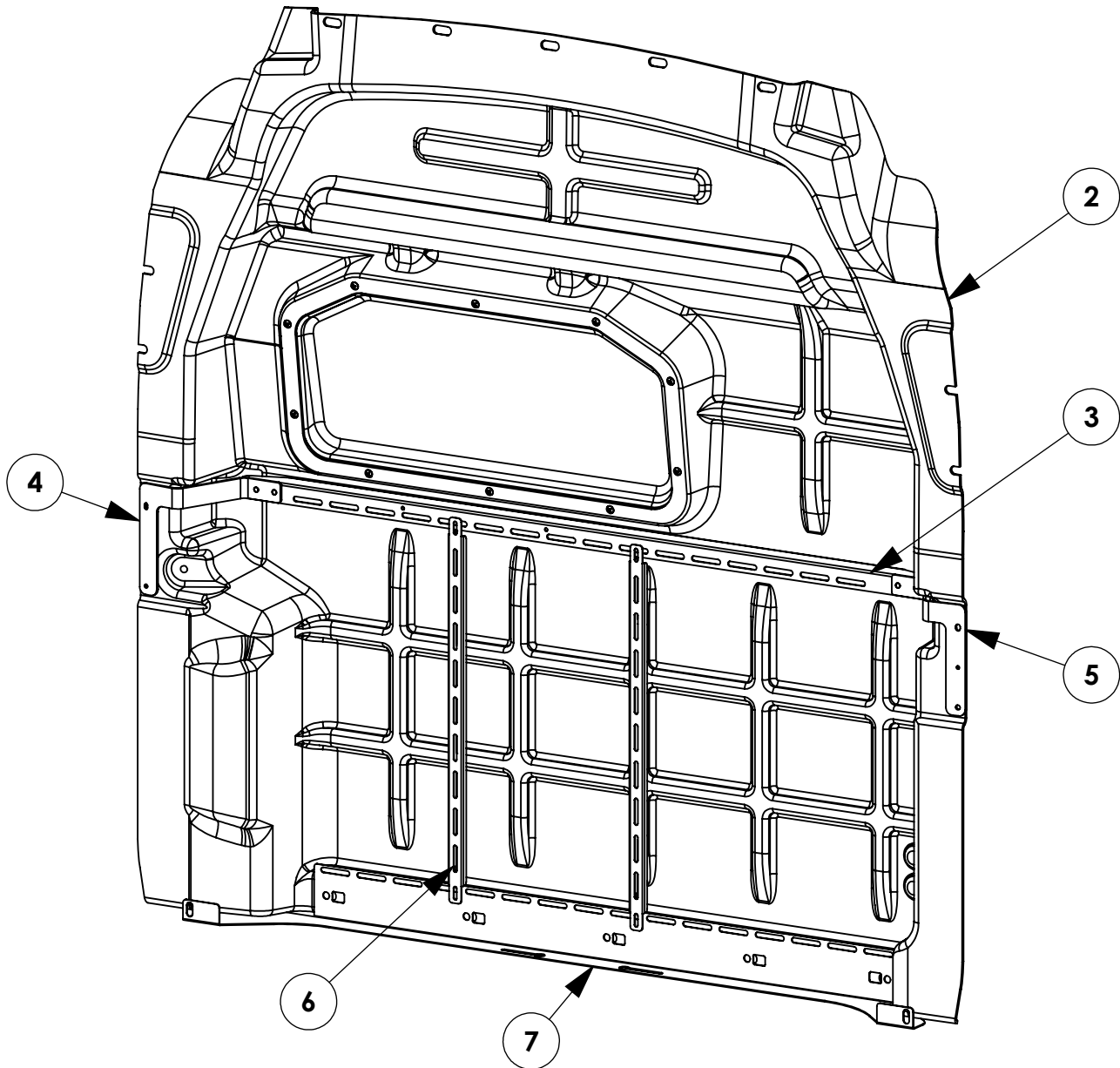

GET TO KNOW THE VEHICLE - AT THE BEGINNING OF ANY INSTALLATION, CHECK THE LOCATION OF THE FUEL TANK, FUEL LINES, BRAKE LINES, HIGH VOLTAGE BATTERIES AND WIRING HARNESSSES TO AVOID INJURY OR PROPERTY DAMAGE FROM TOOL CONTACT.

SEAL ALL EXTERIOR HOLES - ALL INSTALLATION HOLES SHOULD BE SEALED WITH BUTYL TAPE OR SILICON TO PREVENT WATER AND EXHAUST GASES FROM ENTERING THE VEHICLE.

CONTROL DRILL DEPTH - TO AVOID DAMAGE TO THE VEHICLE, USE A DRILL STOP OR CLEARED STEP BIT WHEN DRILLING INSTALLATION HOLES.

ALWAYS ADD PRIMER - WHEN ADDING INSTALLATION HOLES BE SURE TO USE A SELF-ETCHING PRIMER TO PREVENT CORROSION, FASTENER FAILURE AND INJURY.

MOUNTING POINTS MUST HAVE METAL-TO-METAL CONTACT - USE PROVIDED MOUNTING SPACERS TO ACCOMMODATE FOR VEHICLE FEATURES, CARPET OR SUBFLOORS.

PROVIDE CLEARANCE FOR SPACERS - IF THE INSTALLATION VEHICLE CONTAINS A CARPET OR SUBFLOOR, USE A 1-3/16" DIAMETER CARPET CUTTER (P/N: 31183-0) AT ALL MOUNTING LOCATIONS TO OPEN UP ROOM FOR SPACERS.

CHECK SPACER ORIENTATION - BE SURE THAT THE INDENT IN THE SPACER COVERS THE PLUSNUT HEAD; THIS ENSURES THE MOST METAL-TO-METAL CONTACT AND REDUCES VIBRATION.

PLUSNUT INSTALLATION - A PLUSNUT GUN IS RECOMMENDED FOR PLUSNUT INSTALLATION FOR ITS PRODUCTION SPEED. HOWEVER, A PLUSNUT SETTING TOOL CAN ALSO BE USED (P/N: 22200-0).

THRU-BOLT CLEARANCE - WHEN USING A THRU-BOLT AT ANY MOUNTING LOCATION, BE SURE THAT YOUR HOLE HAS 1/16" CLEARANCE.

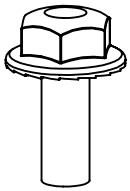
FASTENERS USED

FAS0018
1/4-20X.62 ZP
HFLNG SCREW
QTY: 4



FAS0066
1/4 ZP
EXT LCK WASHER
QTY: 4



FAS0085
5/16 ZP
EXT LCK WASHER
QTY: 17

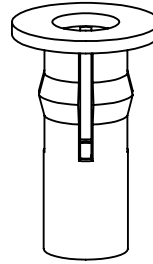

FAS0091
5/16-18 PB
PLUSNUT
QTY: 7

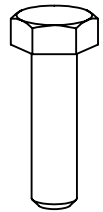

FAS0187
M6-1.0X22 SS
HH SCREW
QTY: 4

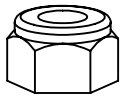

FAS0248
5/16-18 SS
NLK HEX NUT
QTY: 4

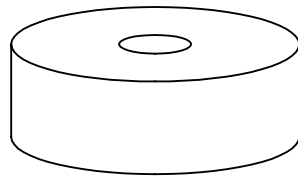

FAS0253
1.50X0.375X0.5
IV-2 WASHER
QTY: 10

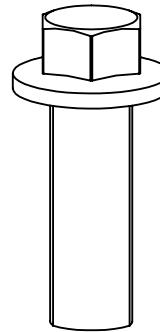

FAS0408
7/16-20X1.63
HH SCREW
QTY: 2



FAS0482
7/16 ZP
FLAT WASHER
QTY: 2



FAS0552
1/4-20X.62 ZP
HFLNG SCREW
QTY: 6

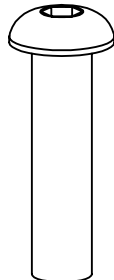

FAS0708
5/16-18X1.25 ZP
BHC SCREW
QTY: 17

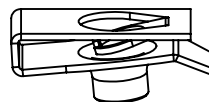

FAS0711
1/4-20 PH
SPRING CLIP
QTY: 4

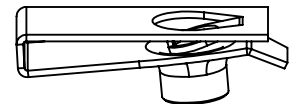

FAS0752
5/16-18 PH
SPRING CLIP
QTY: 5



FAS0833
1.5" FLANGED
CUP WASHER
QTY: 10



36496-0
#2 EXTRA RAIL
END CAP
QTY: 2

PREP VEHICLE

STEP 1 - REMOVE OEM GRAB HANDLE



REMOVE OEM FASTENERS



HANDLE CAN BE SAVED FOR LATER RE-ASSEMBLY

STEP 2 - PREPARE DRIVER'S SIDE MOUNTING LOCATIONS



CHECK THESE (2) OEM HOLE LOCATIONS.

IF IT COMES WITH M6 WELD NUTS, SKIP THIS STEP.

- OR -

IF THE HOLES ARE EMPTY, INSTALL FAS0091

**BEGIN INSTALLATION
STEP 3 - INSTALL FOOTER**

NOTE: IF A FLOOR PLATE KIT IS INCLUDED IN THIS UPFIT, INSTALL THE FLOOR PLATE BEFORE THIS PARTITION FOOTER

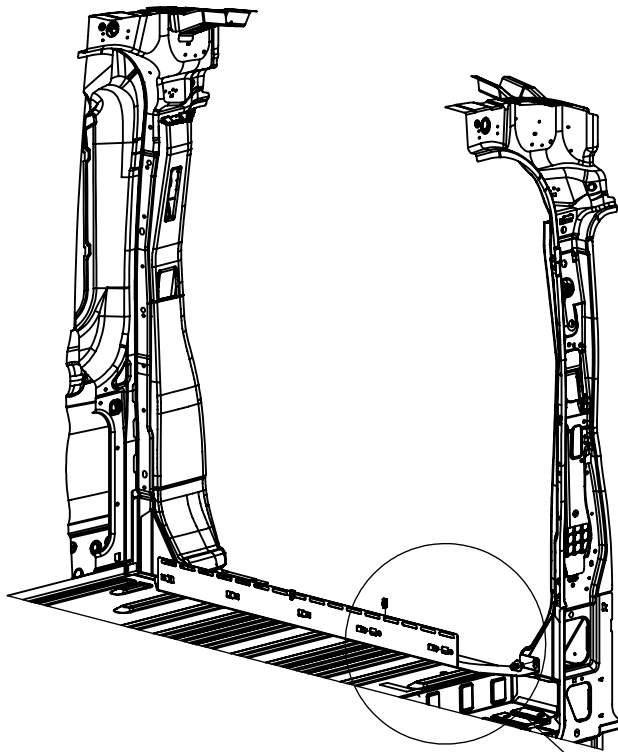

FAS0711 (SMALLER)
(2 PLACES, FACING CABSIDE)
4TH AND 9TH SLOT FROM
PASSENGER SIDE

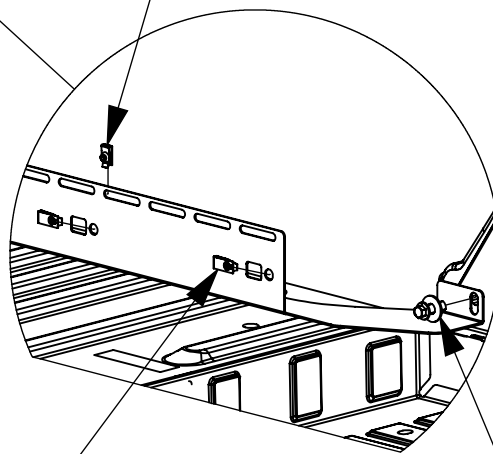

FAS0752 (LARGER)
(5 PLACES FACING CARGOSIDE)

REMOVE OEM
D-RING & REPLACE

- OR -

FAS0482, FAS0408
(2 PLACES)
1/2 SOCKET

STEP 4 - JIG HEADER HOLES**4A - MID ROOF**

**SET PARTITION PANEL AGAINST THE FOOTER AND
MARK (5) HEADER HOLES FOR MOUNTING
REMOVE AND DRILL OUT WITH 1/2" DRILL BIT**

4B - HIGH ROOF

**SET PARTITION PANEL AGAINST THE FOOTER AND
MARK (4) HEADER HOLES FOR MOUNTING
REMOVE AND DRILL OUT WITH 1/2" DRILL BIT**

STEP 5 - INSTALL PASSENGER'S SIDE MOUNTING BRACKET

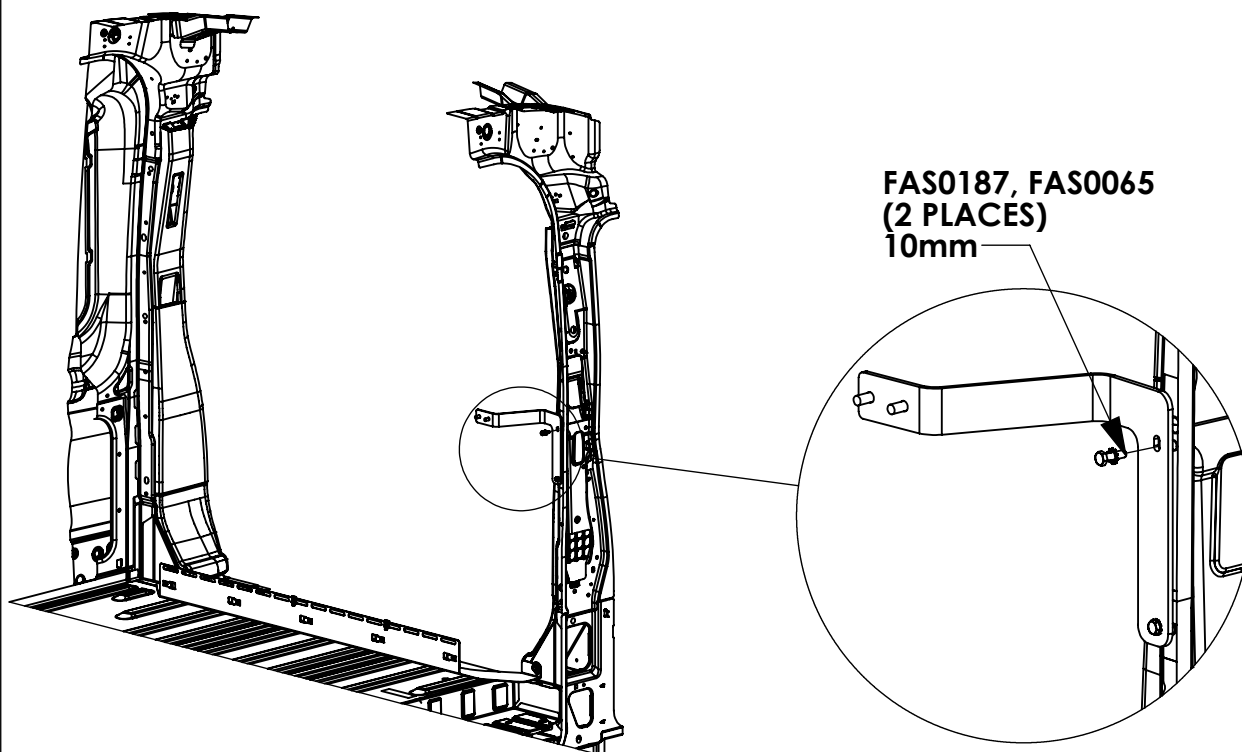

STEP 6 - INSTALL DRIVER'S SIDE MOUNTING BRACKET

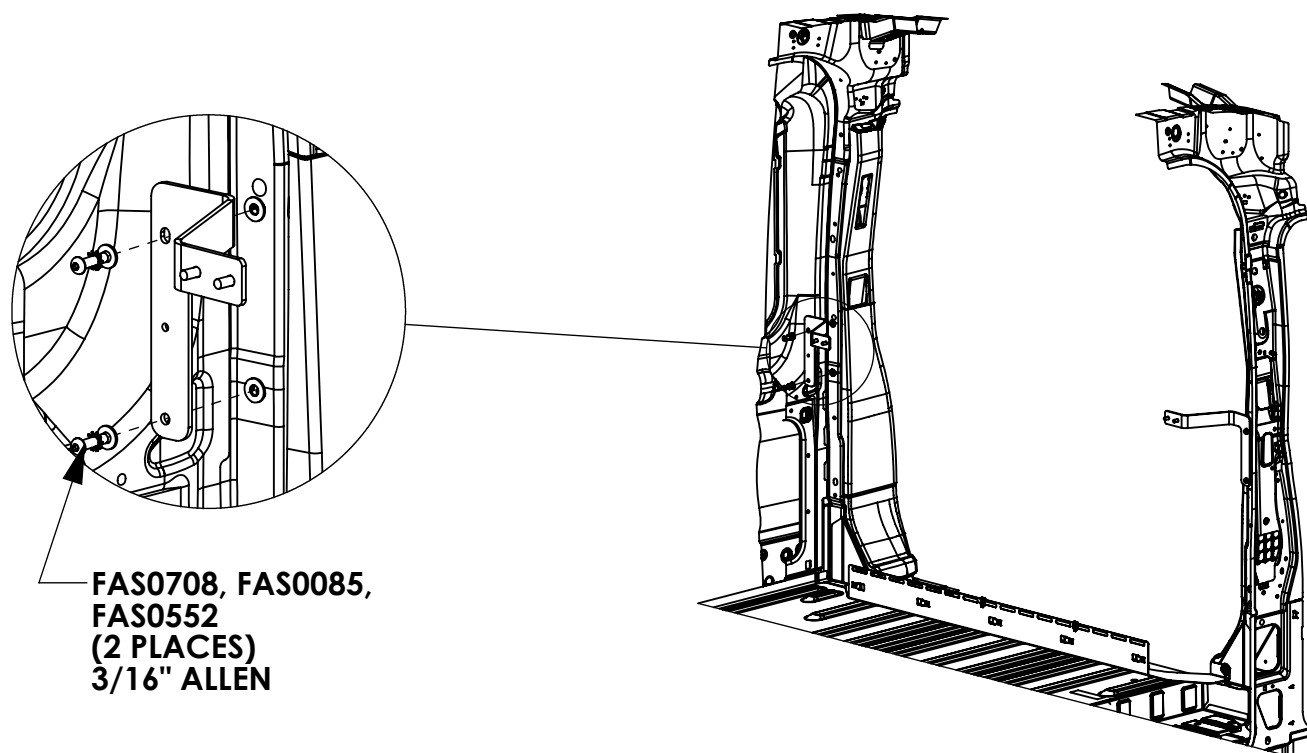

STEP 7 - INSTALL CROSS CHANNEL

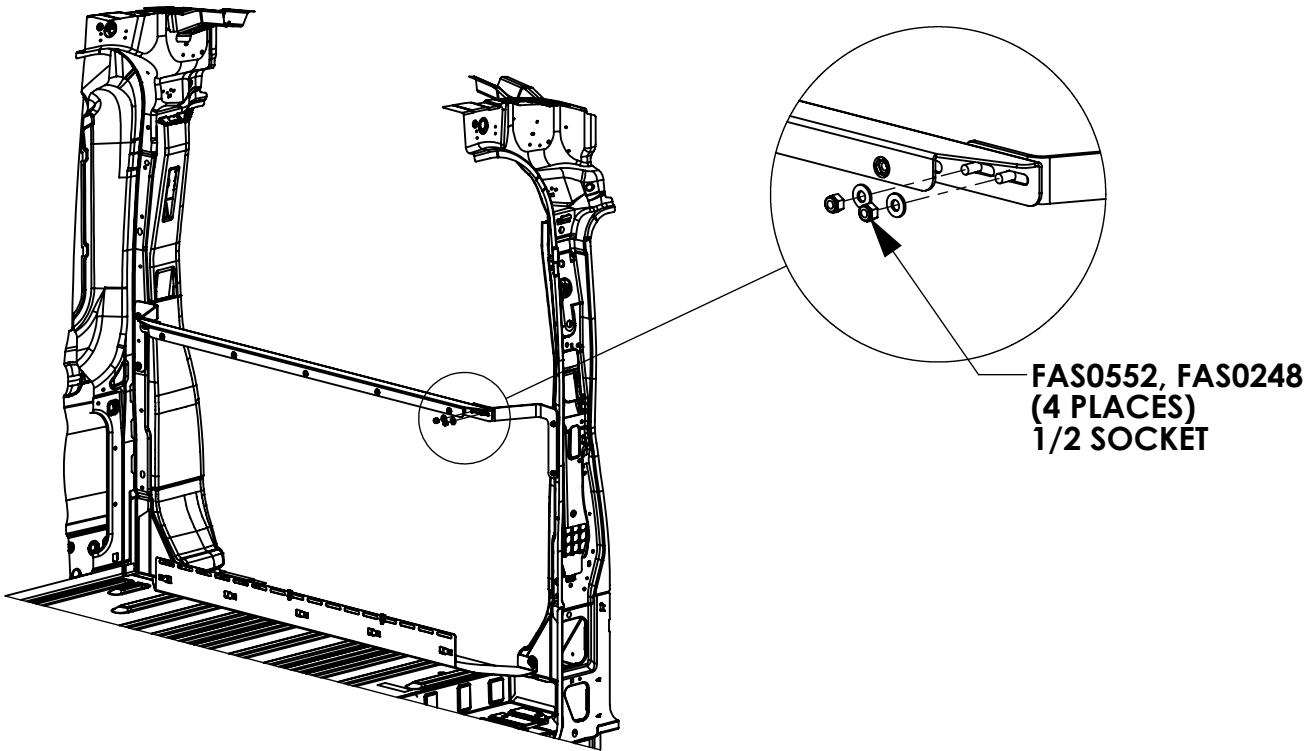

STEP 8 - INSTALL ACCESSORY MOUNTING CHANNELS

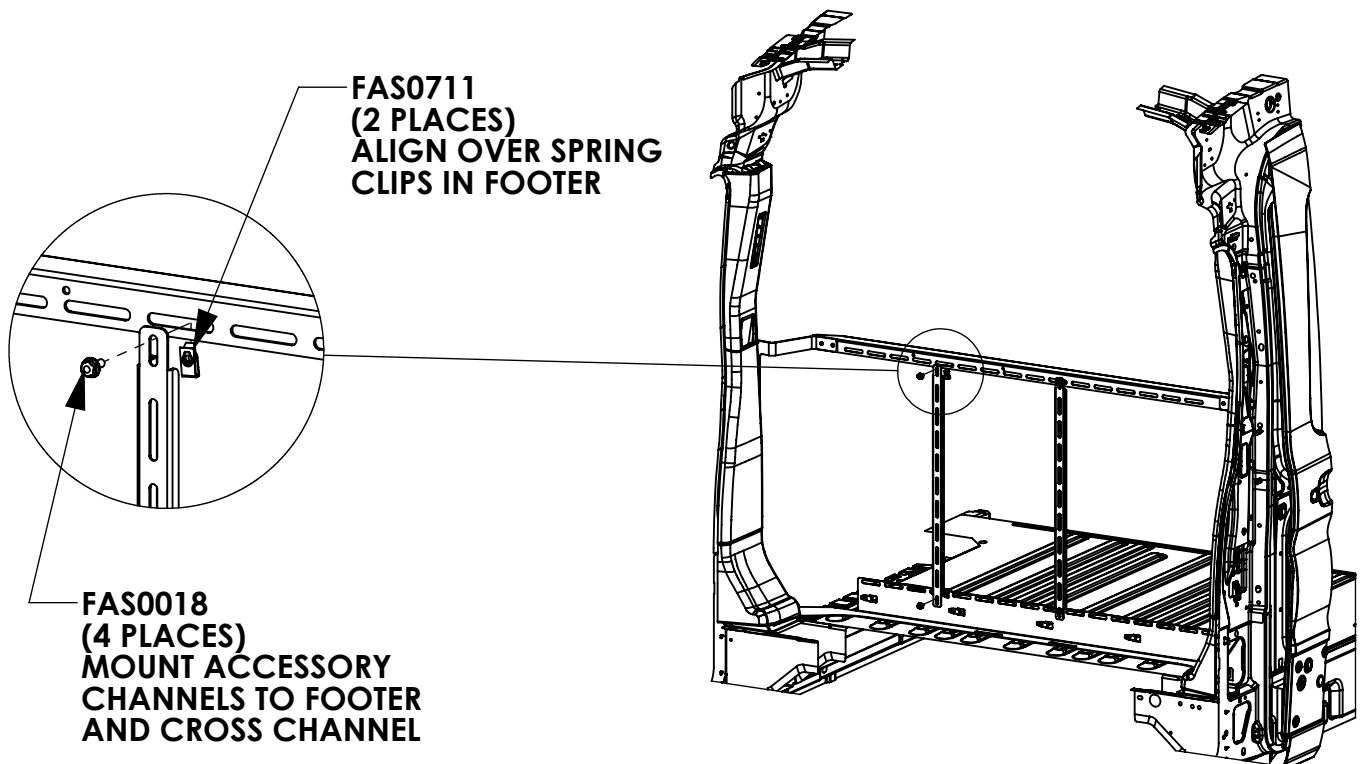

STEP 9 - ASSEMBLE PINCHWELD

USE SMALL SEAL ON BOTH
SIDES OF TOP

USE LARGE SEAL ON BOTH
SIDES OF BOTTOM



STEP 10 - PLANE PANEL INTO VEHICLE

WHEN PUTTING PANEL IN VEHICLE,
POSITION THE TOP FIRST TO PROVIDE
BETTER FIT

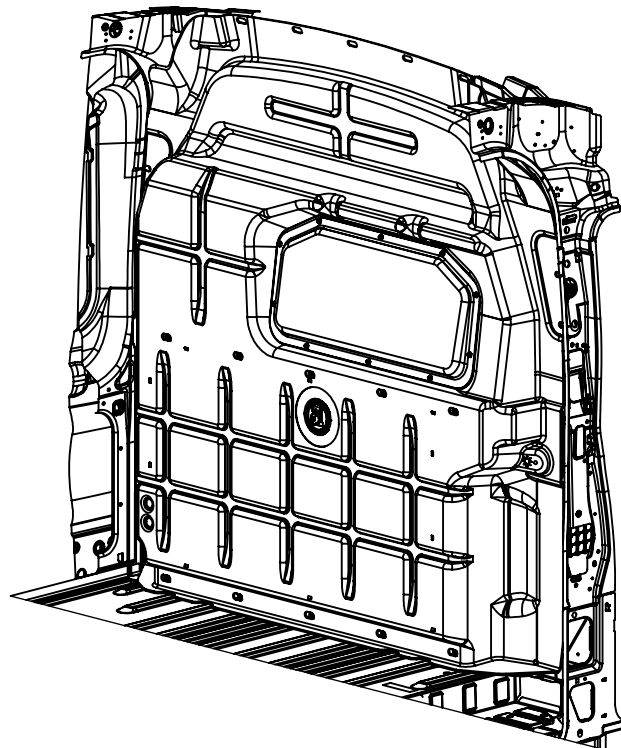

STEP 11 - REPLACE OEM GRAB HANDLE



FIND GRAB HANDLE AND
FASTENERS THAT WERE SAVED
FROM BEGINING OF BUILD

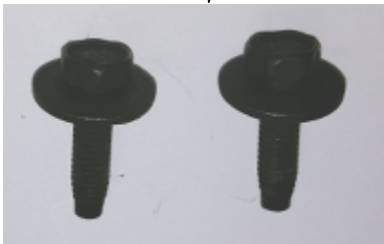

TIGHTEN FASTENERS
DOWN IN OEM
MOUNTING HOLES

STEP 12 - INSTALL RETENTION RAIL

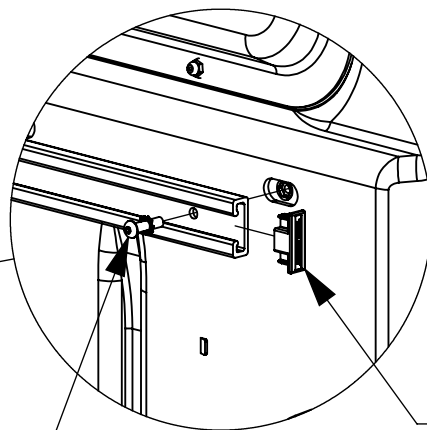
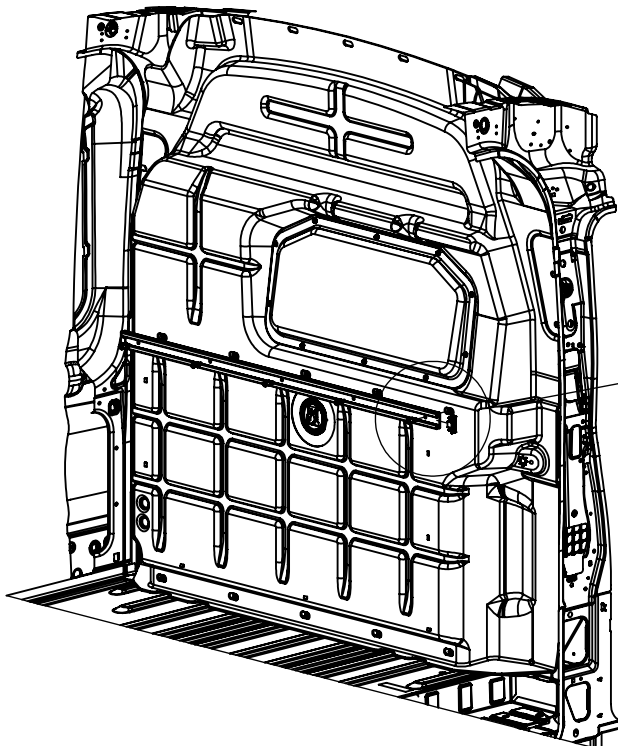

FAS0708, FAS0085
(5 PLACES)
3/16" ALLEN

36496-0
(2 PLACES)

STEP 13 - MOUNT FOOTER FASTENERS

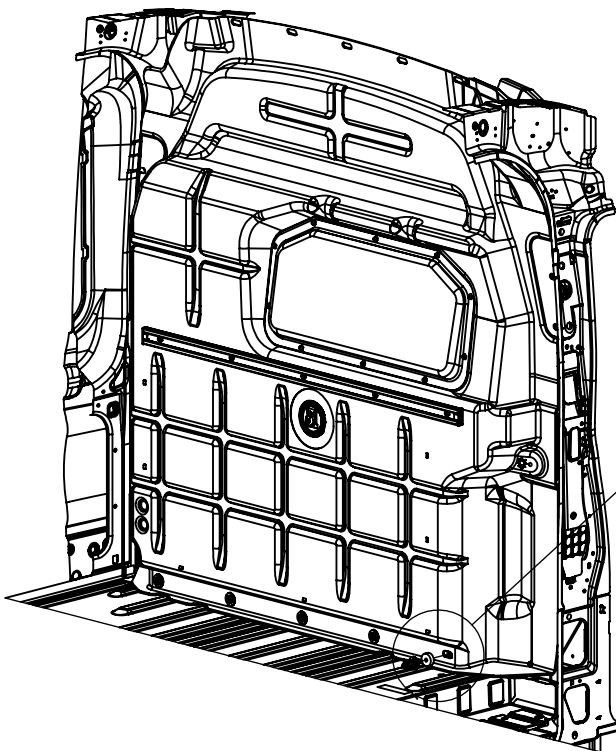

**FAS0708, FAS0085,
FAS0833, FAS0253
(5 PLACES)
3/16" ALLEN**

STEP 14 - MOUNT HEADER FASTENERS

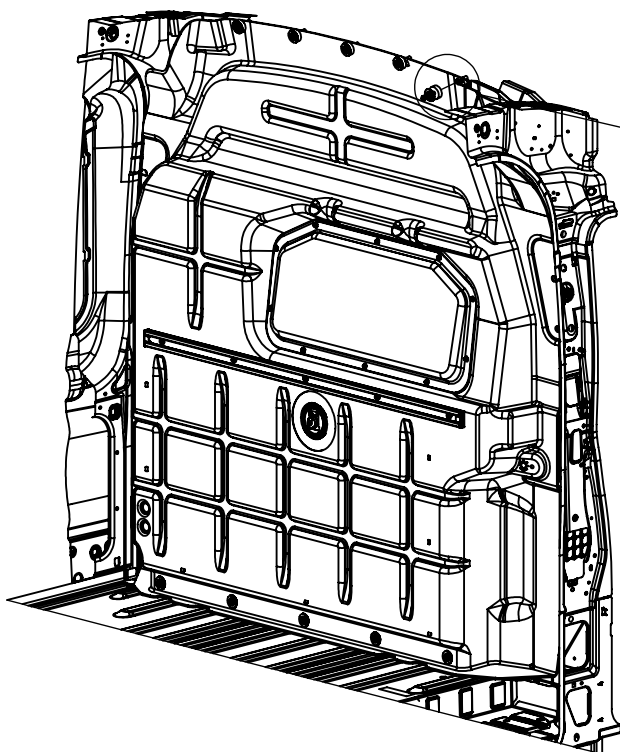

**FAS0708, FAS0085,
FAS0833, FAS0253
(5 PLACES)
3/16" ALLEN**