

Partition, 2014 Ford Transit Connect

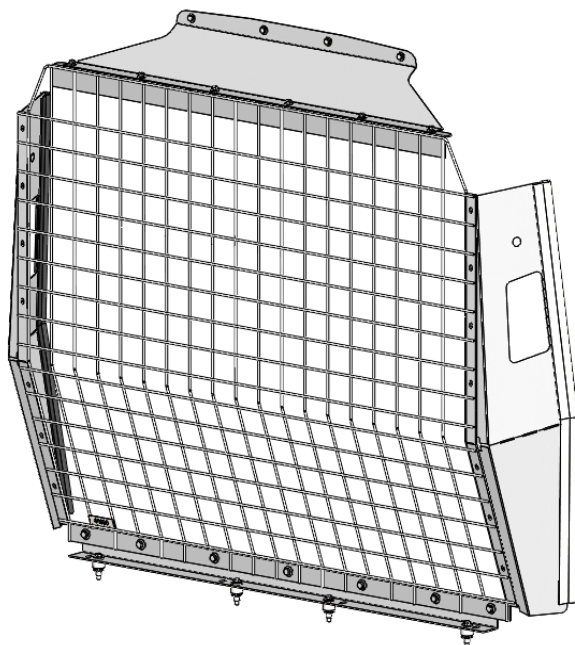

PRODUCT WEIGHT
43 LBS

WIDTH x DEPTH x HEIGHT
48" X 10" X 59"

CAPACITY
N/A

COLOR
GRAY

CATALOG NUMBER
P2TCFW14

PRODUCT FEATURES

This partition is compatible with side curtain airbags systems. It will be installed behind the 1st row seating out of the head impact zone. Partition design provides maximum front row seat travel with Unobstructed view for the driver and passenger.

This product is designed for installation into the 2014 Ford Transit Connect.

SEE PAGE 2 FOR APPLICATION NOTES AND ACCESSORIES, OTHER PRODUCTS THAT WORK WITH THIS UNIT.

Accessory Chart

	Cargo Side	Cab Side
	None available	None available
Available Accessories	-	-

Introduction / Comments:

This product (P2TCFW14) is designed to provide a barrier between the driver and the cargo area in the 2014 Ford Transit Connect (SWB/LWB) vehicle.

Note:

It is advised that all fasteners used in this assembly and installation should be checked for tightness at the following intervals: @ 2-weeks and again @ 6-weeks of operation. This preventive maintenance step must be completed to ensure your Product gives you long service life.

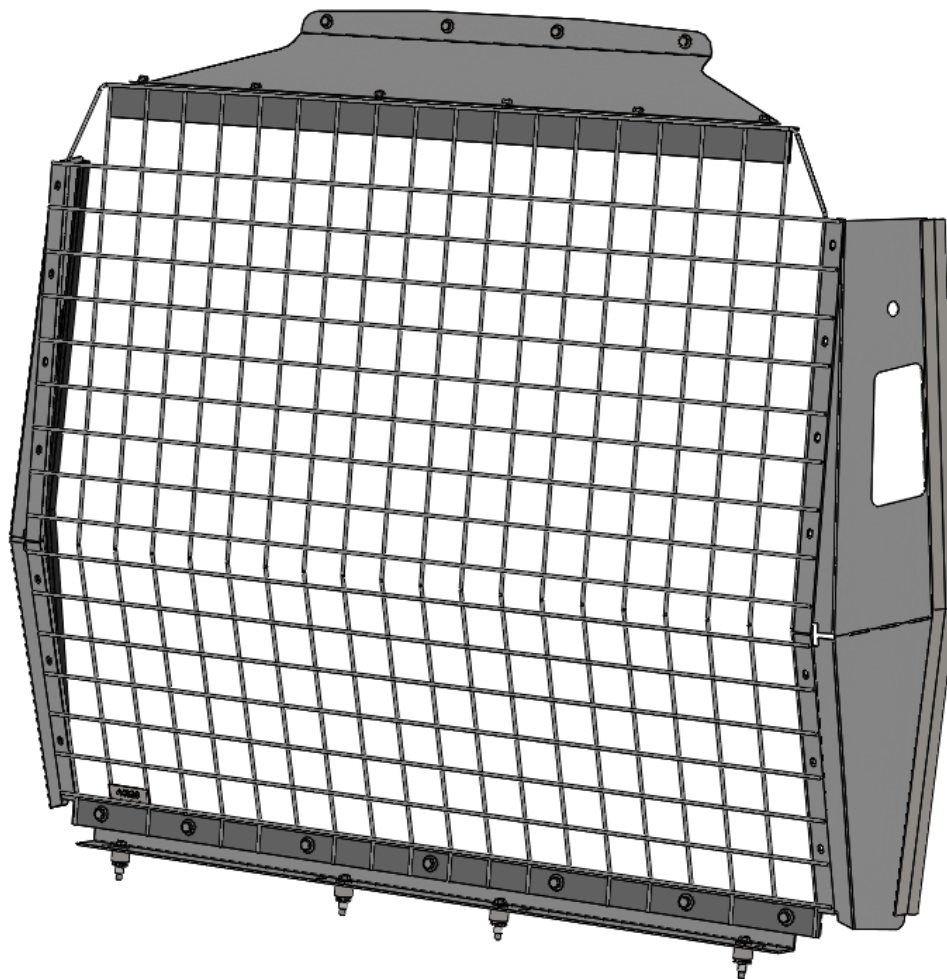

P2TCFW14
2014 Ford Transit Connect
Full Wire Mesh Fixed Partition

- PRECAUTIONS -



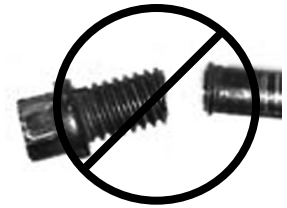

 **CAUTION** 
**THE USE OF AIR IMPACT TOOLS CAN
OVER-TORQUE FASTENERS AND
CAUSE FASTENER FAILURE!**



 **CAUTION** 
**ALL INSTALLATION HOLES SHOULD BE SEALED
WITH SILICON OR BUTYL SEALANT TO PREVENT
EXHAUST FUMES FROM ENTERING THE VEHICLE!**



 **DANGER** 
**INSPECT FOR FUEL TANK, FUEL LINES, BRAKE LINES, HIGH
VOLTAGE BATTERIES AND ELECTRICAL LINES PRIOR TO
DRILLING TO AVOID DAMAGING CRITICAL VEHICLE SYSTEMS
OR INJURY TO INSTALLER DURING INSTALLATION PROCESS!**



 **CAUTION** 
**TO AVOID DAMAGING THE VEHICLE ALWAYS
USE DRILL STOPS WHEN DRILLING ANY IN-
STALLATION HOLES!**



- IMPORTANT WARRANTY REQUIREMENTS -

1. SUBSTITUTING ADRIAN STEEL SPECIFIED FASTENERS FOR ASSEMBLY AND/OR INSTALLATION WILL VOID YOUR PRODUCT WARRANTY.
2. ALL HOLES DRILLED INTO VEHICLE SHOULD HAVE THE RAW METAL EDGES SEALED WITH A SELF-ETCHING PRIMER TO RESIST CORROSION AND POTENTIAL FASTENER POINT FAILURE.
3. ALL FASTENERS USED IN THE INSTALLATION OF THIS PRODUCT SHOULD BE TIGHTENED TO THE TORQUE(S) SPECIFIED IN THESE INSTRUCTIONS.
4. THESE INSTRUCTIONS SHOULD BE KEPT WITH THE VEHICLE.

THE BASIC TOOLS NEEDED FOR MOST INSTALLATIONS



DRILL



DRILL BIT WITH
STOP

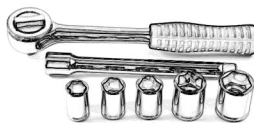

RATCHET, SOCKETS
AND/OR WRENCHES



SCREWDRIVERS



MEASURING TAPE

ADDITIONAL TOOLS MAY BE NEEDED FOR THIS INSTALLATION AND THEY WILL BE IDENTIFIED IN THE STEPS THAT FOLLOW.

If your vehicle contains carpet or a rubber floor mat you will need to prepare the mounting location. Position the product to be installed into the vehicle and once you are satisfied with the mounting locations, mark the mounting locations. Using a 1-3/16" diameter carpet cutter (P/N: 31183-0). Select the appropriate floor spacers as shown in the illustration. Set those aside for use later into the installation process. Using the correct drill bit size for the selected plusnut, drill the mounting holes in the vehicle sheet metal to prepare for installing the plusnuts. If you are thru-bolting at any of the locations simply drill a hole that is 1/16" larger than the bolt size(s) for those locations. Once you have drilled the holes into the vehicle, the raw metal edges should be sealed using a self-etching primer to resist corrosion and potential fastener point failure.

Spacer Use and Installation

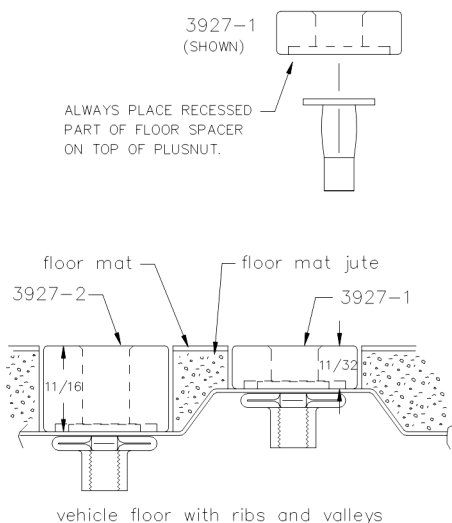

Placing the properly sized spacer on top of the vehicle floor pan will make your Adrian interior level, square, and sound. The view below shows the proper sized spacer for the different heights of the vehicle floor. Make sure to place the spacers with the plusnut relief surface down as shown.

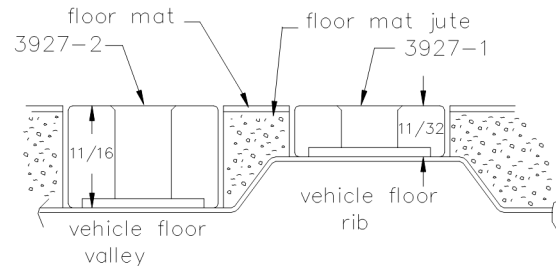

A PLUSNUT (RIVNUT) SETTING TOOL IS REQUIRED FOR PLUSNUT (RIVNUT) INSTALLATION AND IS SUPPLIED WITH THIS KIT. OR USE AN AIR POWERED PLUSNUT SETTING GUN.

1/4-20UNC Plusnut (FAS0052) Use 3/8" dia. drill w/stop

FAS0080 SCREW, HXHD, 1/4-20UNCx2.00", G8
FAS0067 WASHER, FLAT, 1/4"ID
22200-0 PLUSNUT TOOL

5/16-18UNC Plusnut (FAS0091) Use 1/2" dia. drill w/stop

FAS0095 SCREW, HXHD, 5/16-18UNCx2.00", G8
FAS0086 WASHER, FLAT, 5/16"ID
22200-0 PLUSNUT TOOL

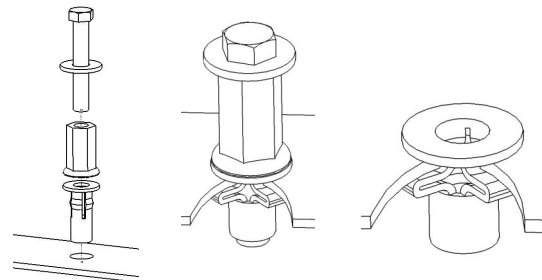

Place barrel of the plusnut body in sheet metal thru hole until flange is flush with sheet metal.

Using a 9/16" combination wrench of plusnut tool body and a second hand wrench, ratchet, or air tool, rotate the hex bolt head CW to draw plus nut flanges up (set the plusnut).

Installation and/or Assembly Fasteners
BAG44645

ITEM NO.	PART NUMBER	DESCRIPTION	QTY.
1	BAG0509-A	5" x 9" 4MIL AUTOBAG	1
2	FAS0086	Washer, Flat, 5/16, ZN	11
3	FAS0098	Washer, Lock, Split, 5/16, Zinc Plate	11
4	FAS0018	SCREW,HH SFLNG 1/4-20X.62 ZP	28
5	FAS0055	Nut, Hex Flange,Nylock 1/4-20	22
6	FAS0081	Screw, Hex Hd, 5/16-18x0.75 Zn Plate	7
7	FAS0602	Screw, Hex Hd, 5/16-18x2.00 Zn-Ni (1000 hour) Grade 8	4
8	FAS0091	Plusnut, 5/16	4
9	03927-2	Tall Floor Spacer	4
10	FAS0052	Plusnut, 1/4	4
11	FAS0060	Washer, Lock, Split, 1/4	4
12	FAS0067	Washer, Flat, 1/4	4
13	FAS0078	Screw, Hex Hd, 1/4-20x1.00 Zn Plate, Grade 8	4

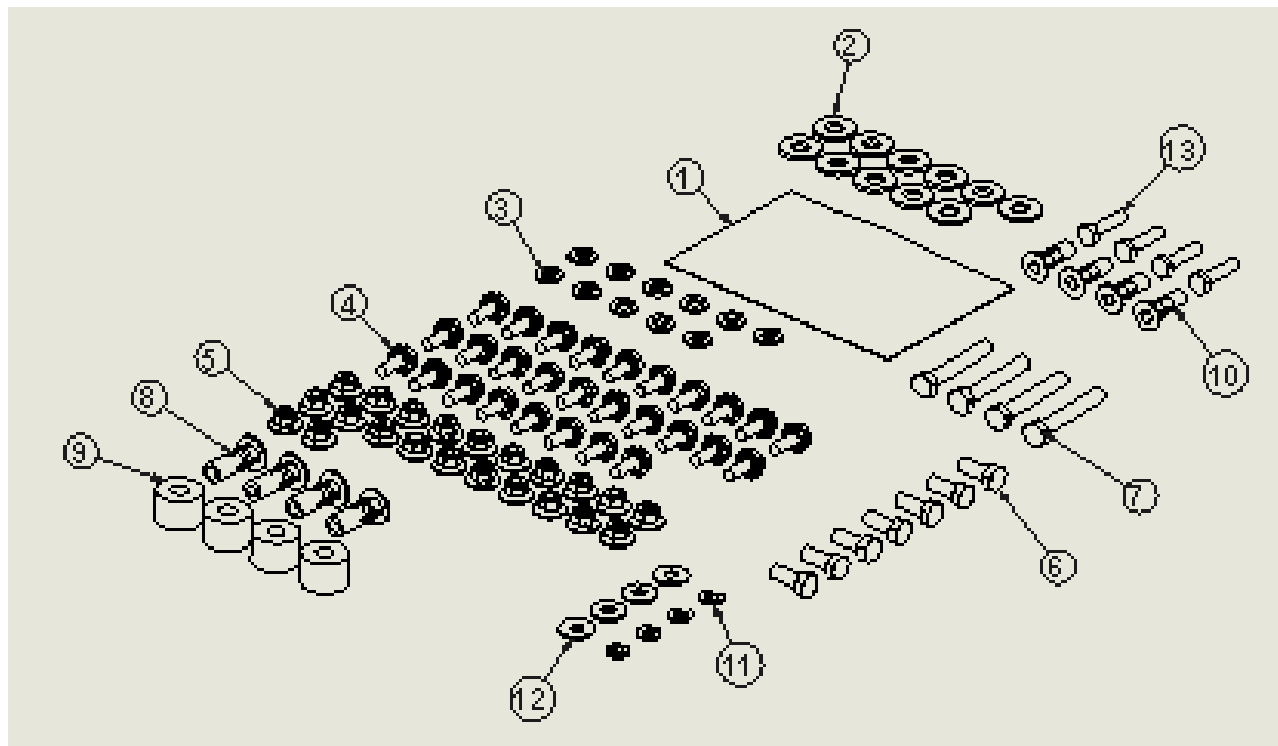

Assembly and Installation
Hardware Identification Sheet
(HDW44645)

ITEM NO.	PART NUMBER	DESCRIPTION	QTY.
1	42889	KNOB, 1/4-20X4.25 FLSTZNC	1
2	47675	JACK RELOCATED LABEL	1
3	FAS0052	Plusnut, 1/4	1
4	BAG0507-A	5" x 7" 3MIL AUTOBAG	1

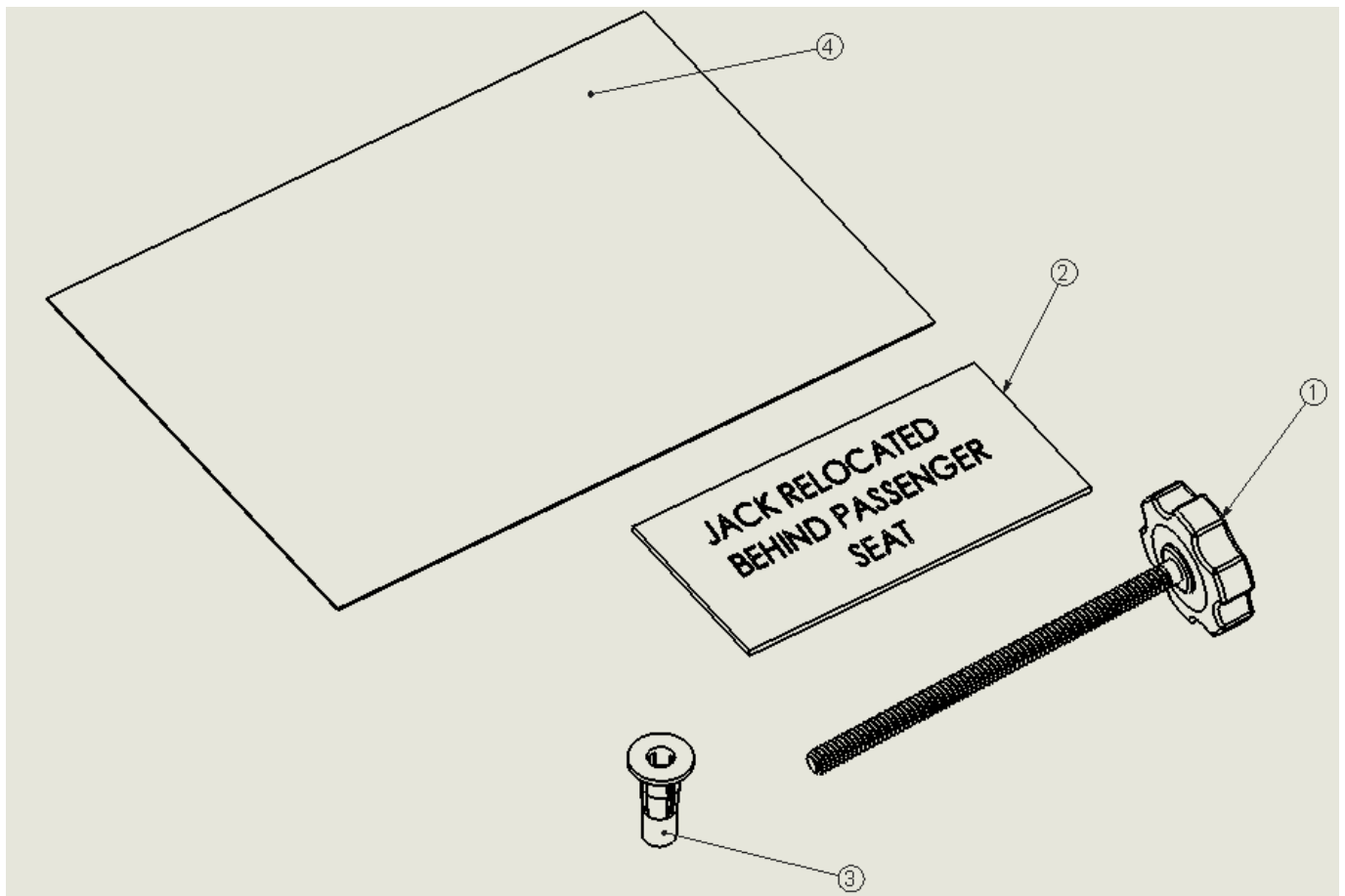

***** IF THE VEHICLE JACK NEEDS TO BE MOVED FROM FACTORY POSITION
CONTINUE WITH INSTRUCTION, IF ALREADY RELOCATED PROCEED TO STEP 2 *****

STEP 1A—REMOVE THE JACK FROM ITS CURRENT LOCATION

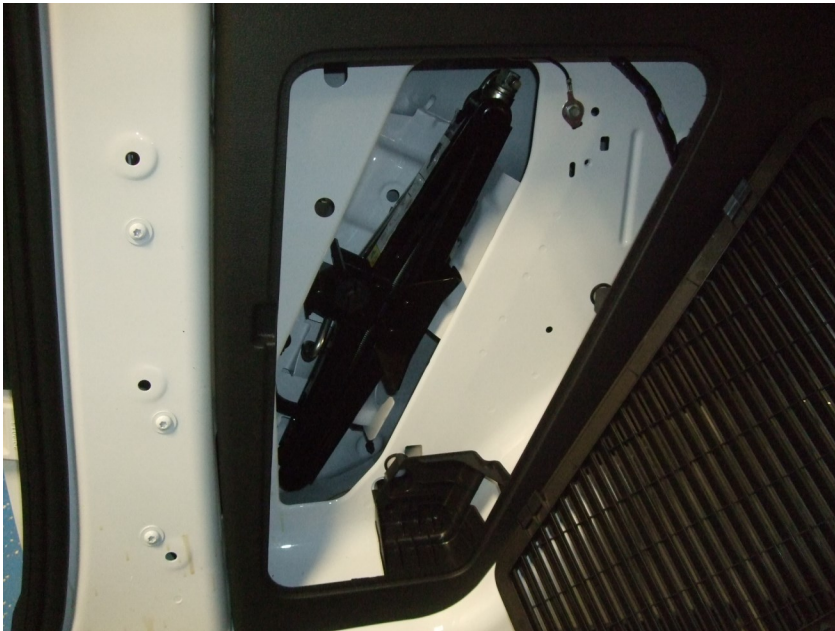

STEP 1B—SET THE JACK BEHIND THE PASSENGER SEAT. WHILE THE JACK IS IN THE NEW POSITION USE THE KNOB (42889) TO MARK THE PLUS NUT HOLE AND DRILL THE HOLE (3/8" DRILL WITH DRILL STOP).



STEP 1C—SET THE 1/4-20 PLUS NUT (FAS0052) IN THE NEWLY DRILLED HOLE. FASTEN DOWN THE JACK WITH THE KNOB (42889). MAKE SURE THAT BOTH PIECES (JACK/HANDLE) ARE TIGHTLY FASTENED TO PREVENT ANY RATTLING.



HANDLE

JACK



**STEP 1D- APPLY JACK RELOCATED LABEL TO WHERE THE JACK USE TO BE
LOCATED**

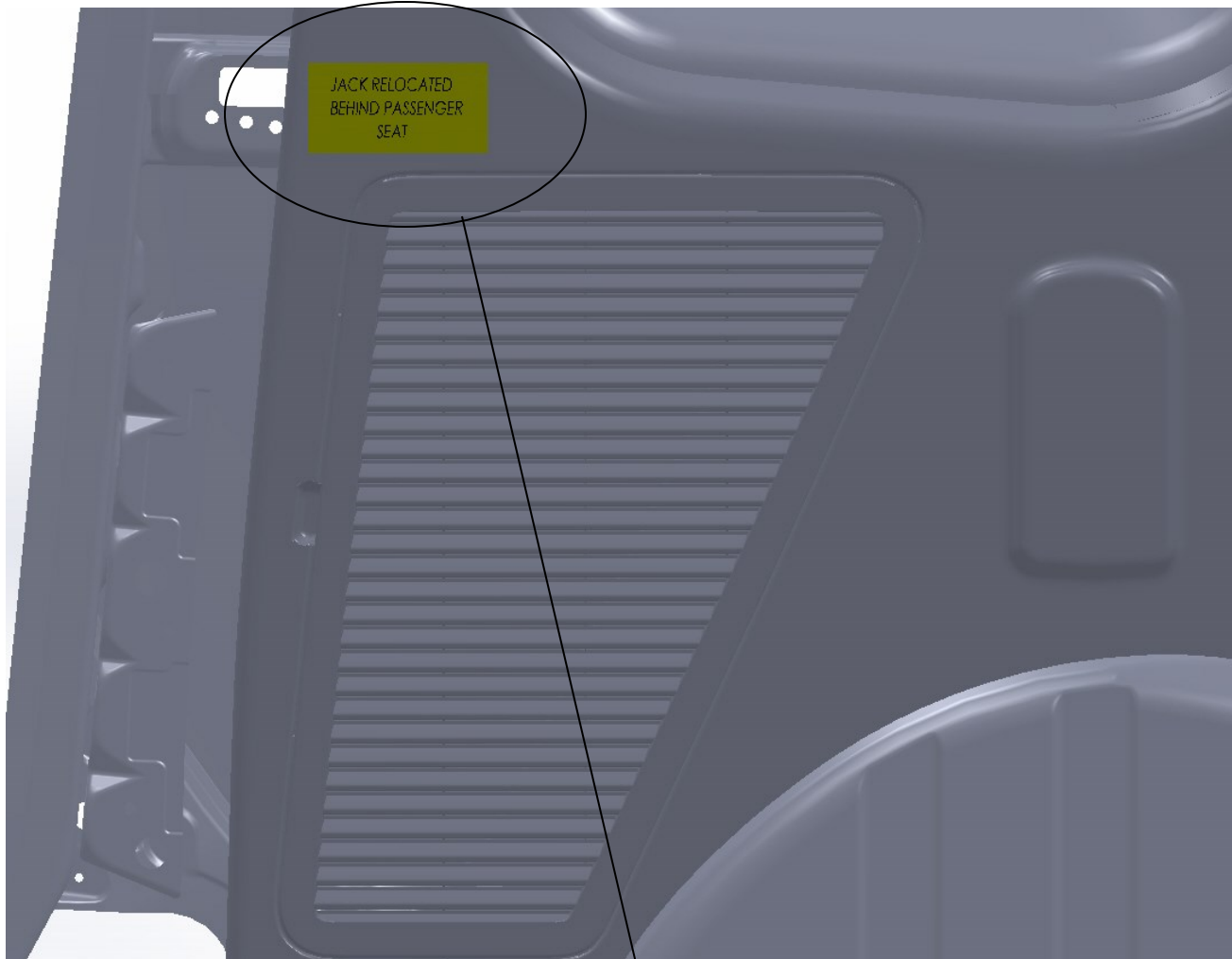

JACK RELOCATED
LABEL (47675)



Component Images & Descriptions

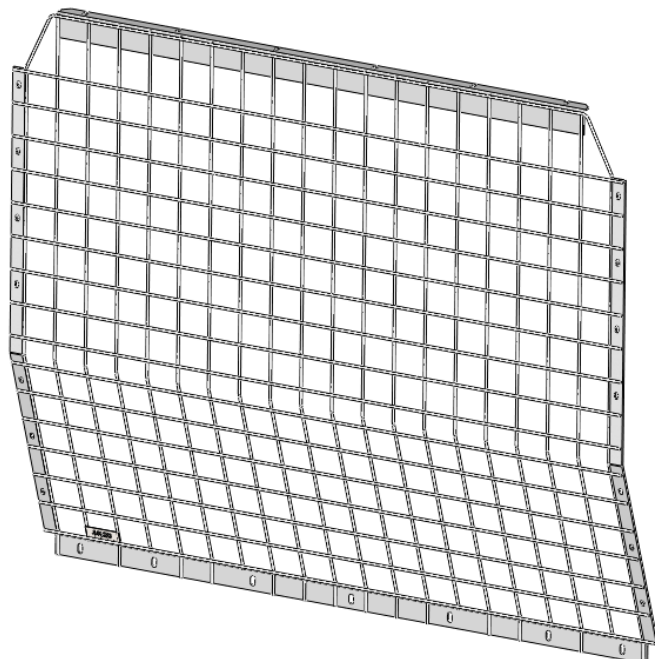
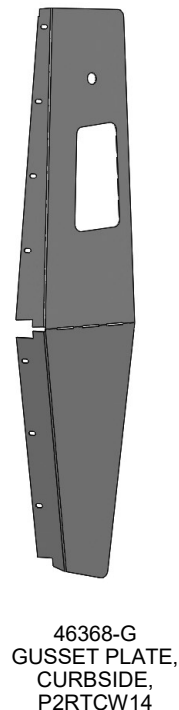
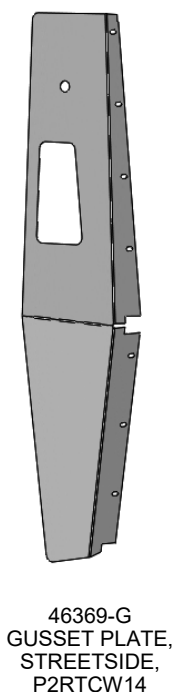
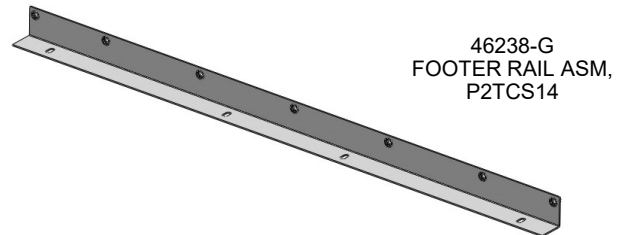
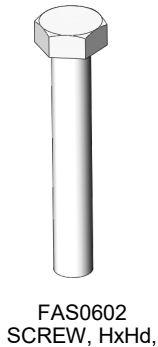
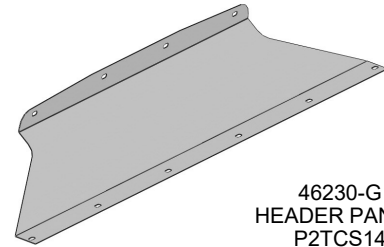

STEP 01 Cab Area Headliner Panel Modifications.

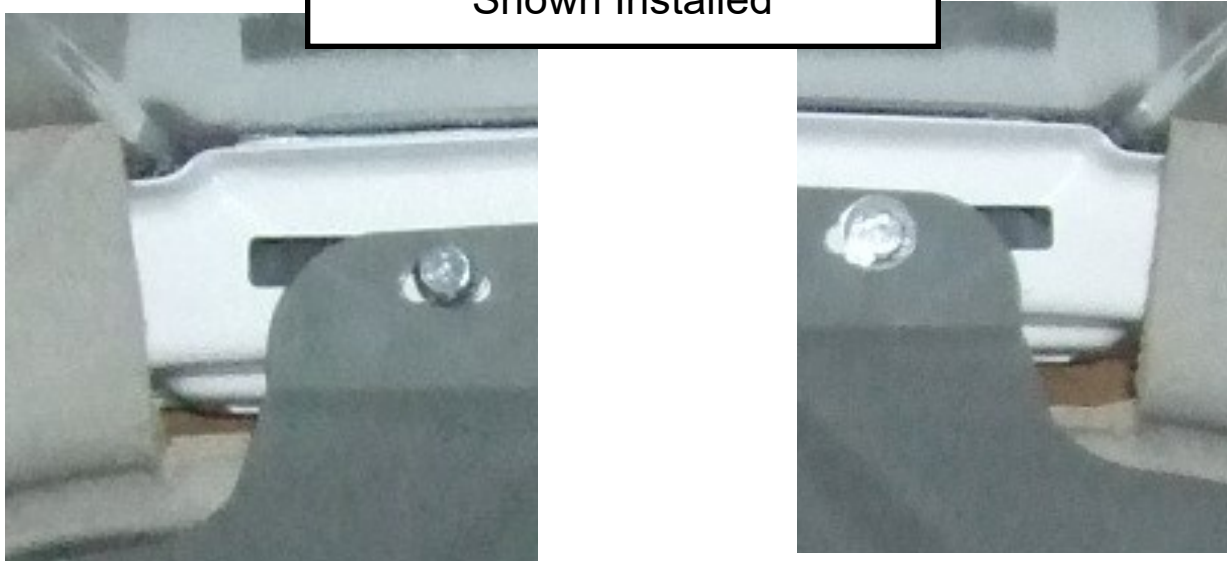
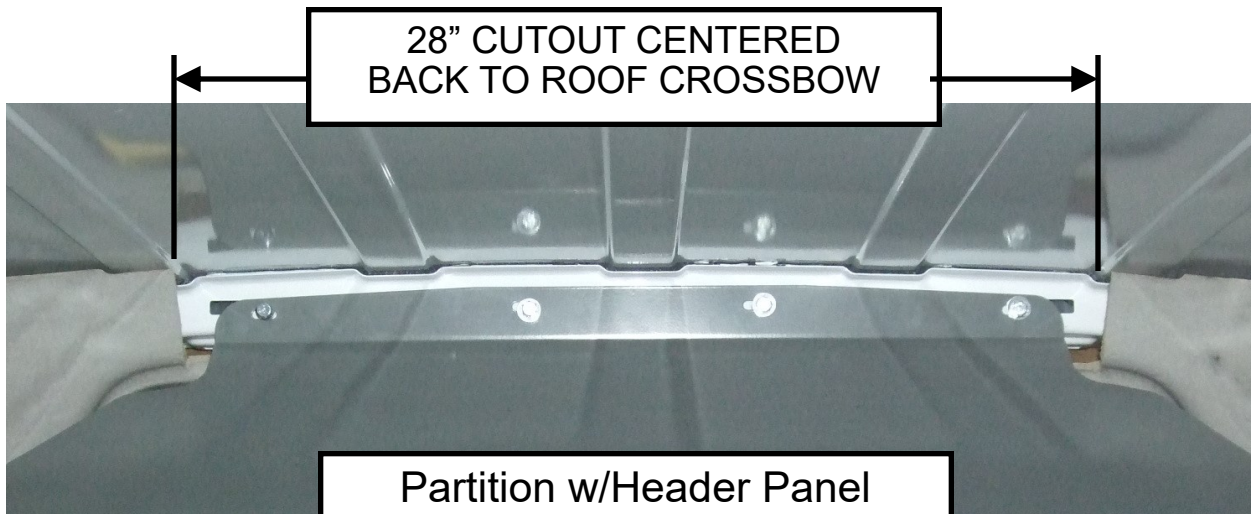

STEP 02 Header Panel & Footer Panel to Wire Partition

Secure Header Panel (46230-G) and Footer Rail Asm (46238-G) to the Full Screen Wire Mesh Partition Weldment (44620-G) using fasteners listed below. (Hand Tight Only!)

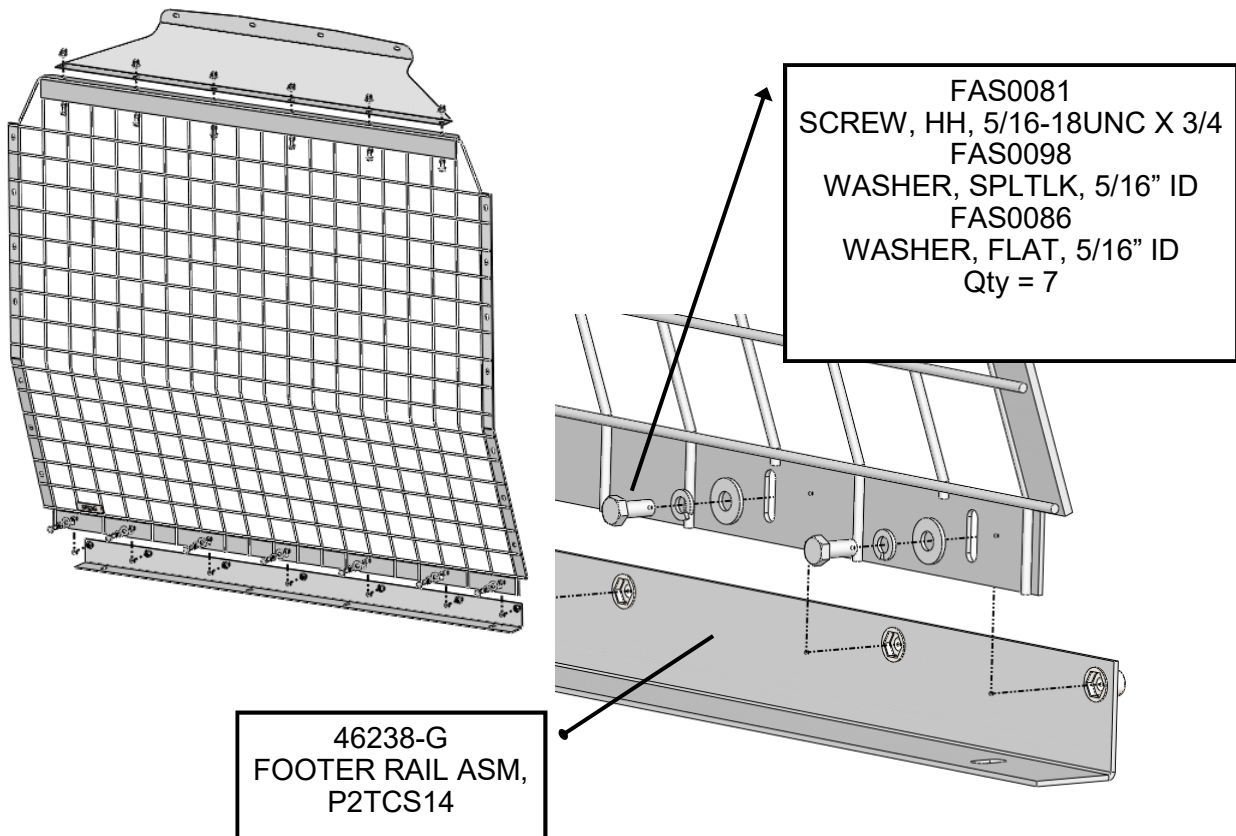
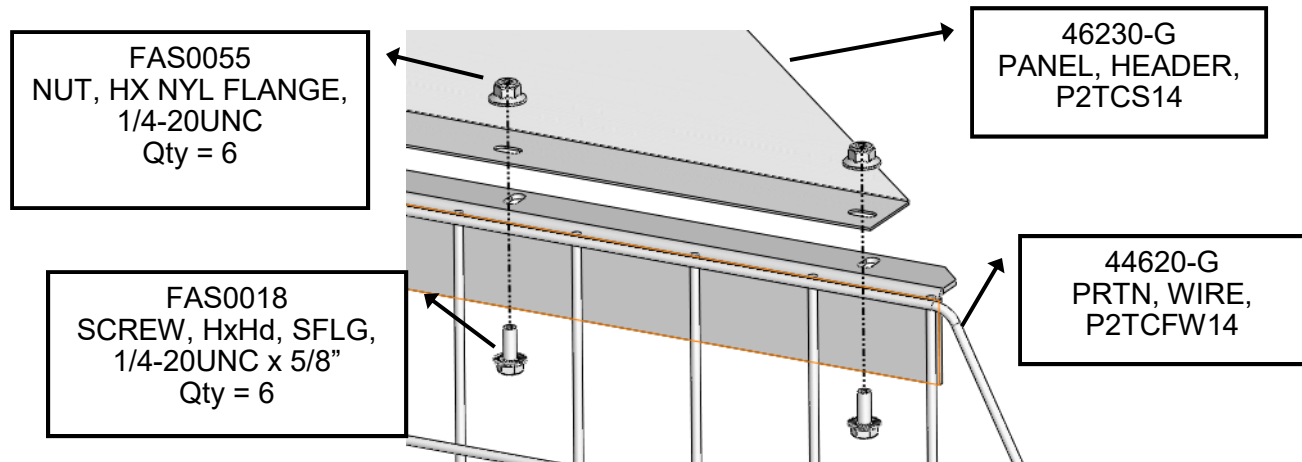

STEP 03 Curb and Street Side B-Pillar Gussets Installation

Secure Header Panel (46230-G) and Footer Rail Asm (46238-G) to the Full Screen Wire Mesh Partition Weldment (44620-G) using fasteners listed below. (Hand Tight Only!)

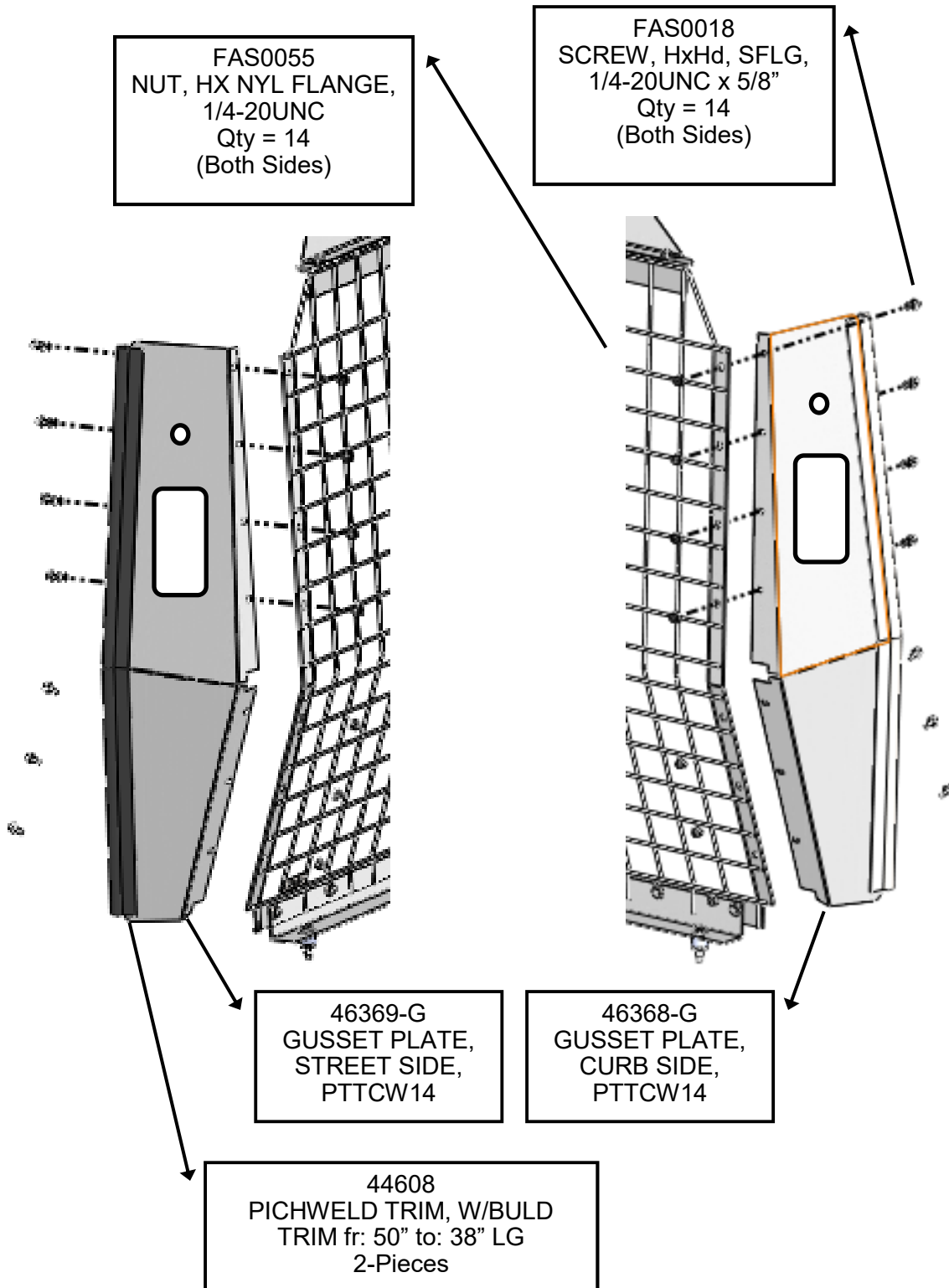

STEP 04 Wire Partition to Vehicle Fastener Mounting Locations

Position the wire screen partition assembly (from Step 02) into the vehicle as shown below. Once you are satisfied with the mounting locations, mark the four mounting locations of the Footer Rail Assembly (46238-G) and the Header Panel (46230-G). Remove the partition from the vehicle and proceed with plusnut installation per standard procedures outlined at beginning of these instructions. Please note that the OEM floor matt, the curb side and street side step well trim may require enlarged thru holes to accommodate the floor spacers.

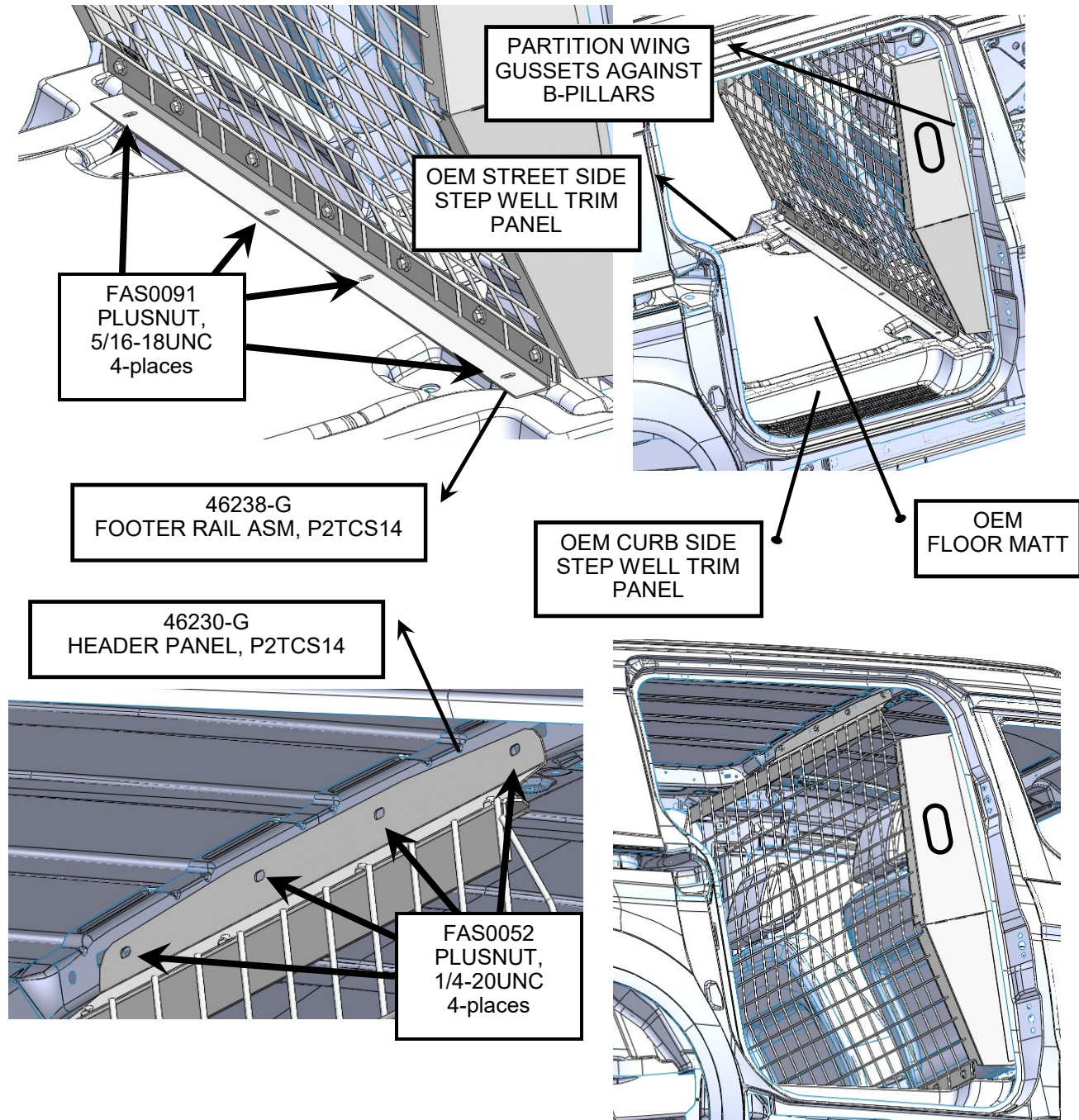

STEP 05 Wire Screen Partition (44620-G) Installation in Vehicle

Reposition the wire partition assembly in the vehicle. Align the eight plusnuts with the matching mounting slots in the header panel and footer rail assembly. Secure the components using the fasteners listed below.

FAS0602
SCREW, HH, 5/16-18UNCx2
FAS0098
WASHER, SPLITLOCK, 5/16 ID
FAS0086
WASHER, FLAT, 5/16 ID
Qty = 4

46238G
FOOTER RAIL ASM,
P2TCS14

03927-2
SPACER, FLOOR, 11/16"
FAS0557
WASHER, RETAINER, 5/16 ID
Qty = 4

NOTE:
FAS0091 FROM
STEP 03 (pp 7)

NOTE:
FAS0052 FROM
STEP 02 (pp 7)

FAS0078
SCREW, HH, 1/4-20UNC X 1.0
FAS0060
WASHER, SPLITLOCK, 1/4" ID
FAS0067
WASHER, FLAT, 1/4" ID
Qty = 4

46230-G
HEADER PANEL,
P2TCS14

NOTE:
PINCHWELD TRIM TO BE
FLUSH AGAINST THE
B-PILLAR TRIM

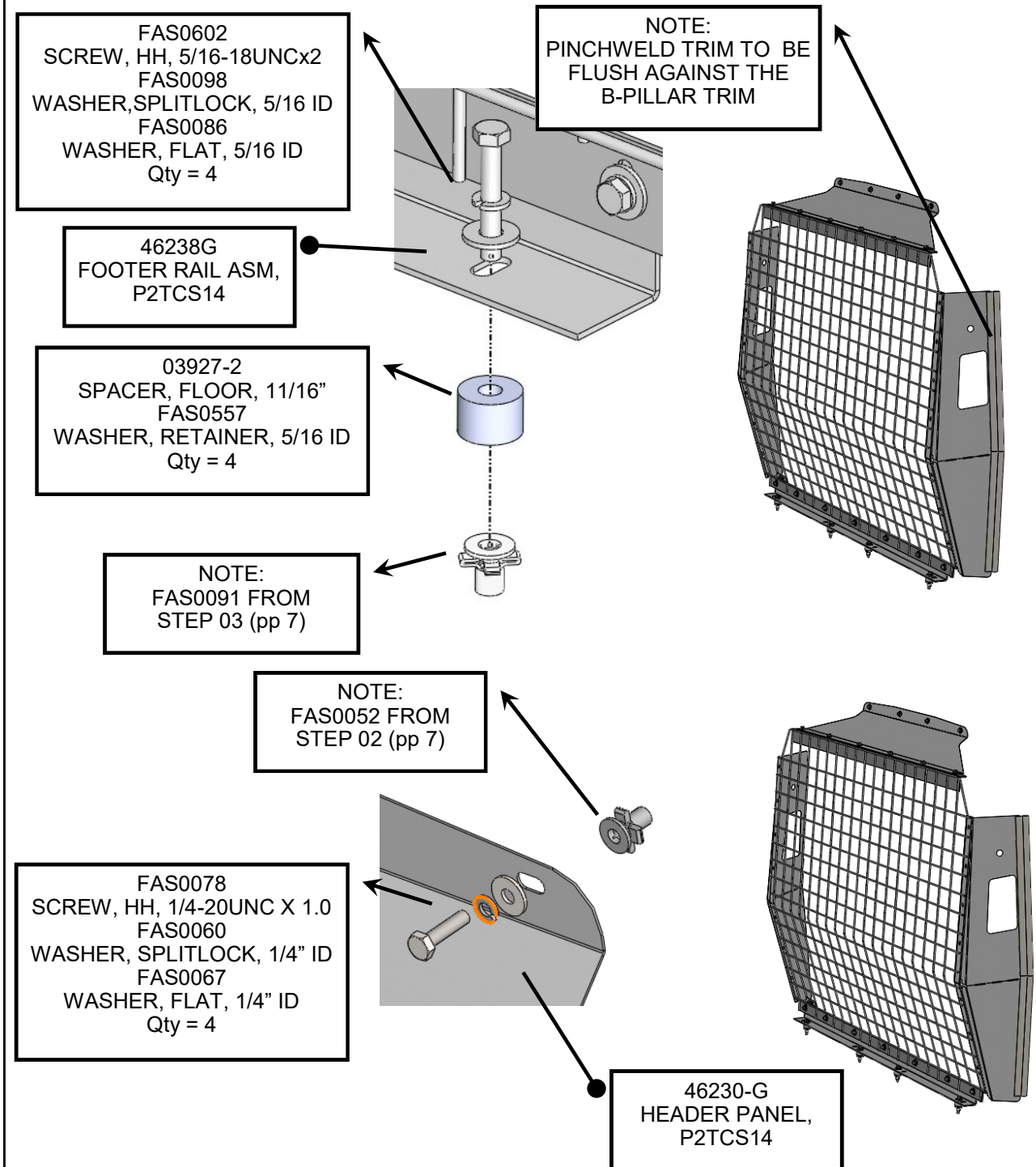

STEP 06 Final Tightening of all fasteners.

Visually inspect alignment of the wire screen partition (44620-G) to the header panel (44603-G) and the floor rail assembly (43699-G). Adjust position as required and tighten all fasteners. Several detail views below showing the installed wire partition in the 2014 Ford Transit Connect for reference.

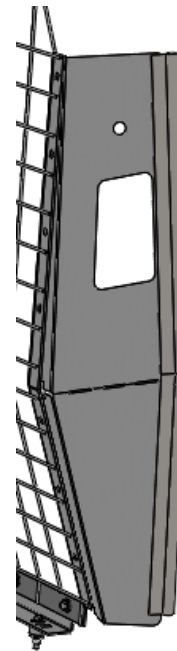
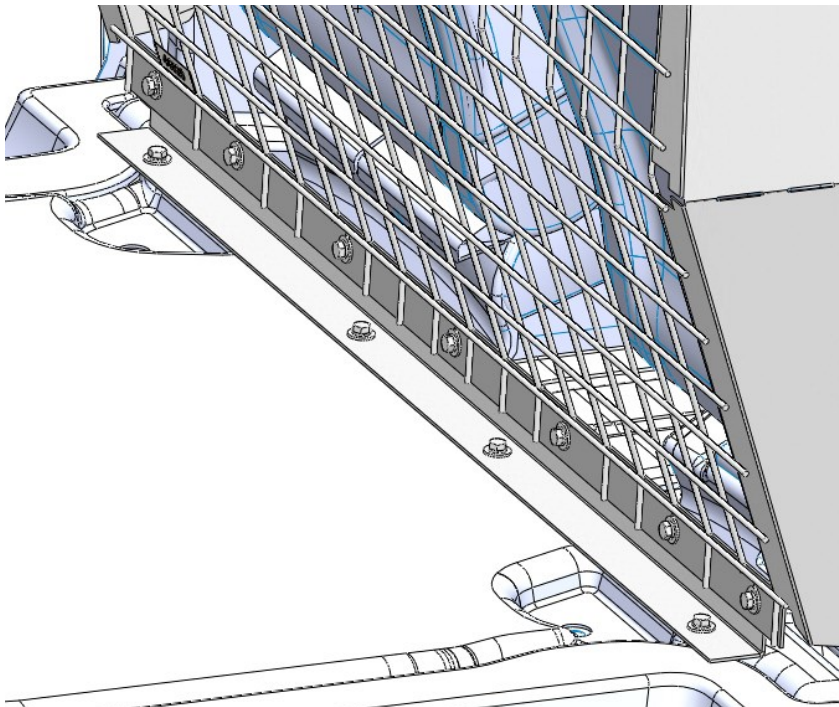
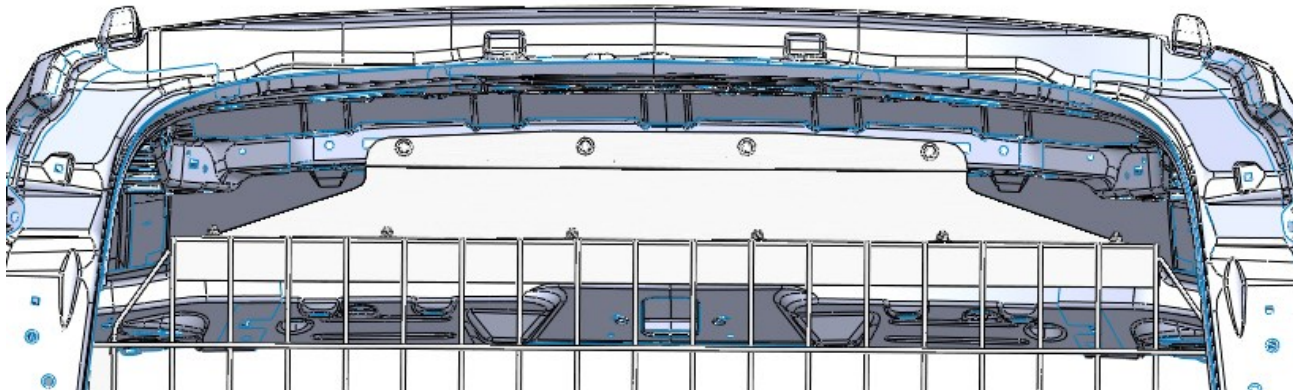



P2TCFW14 IS NOW COMPLETE

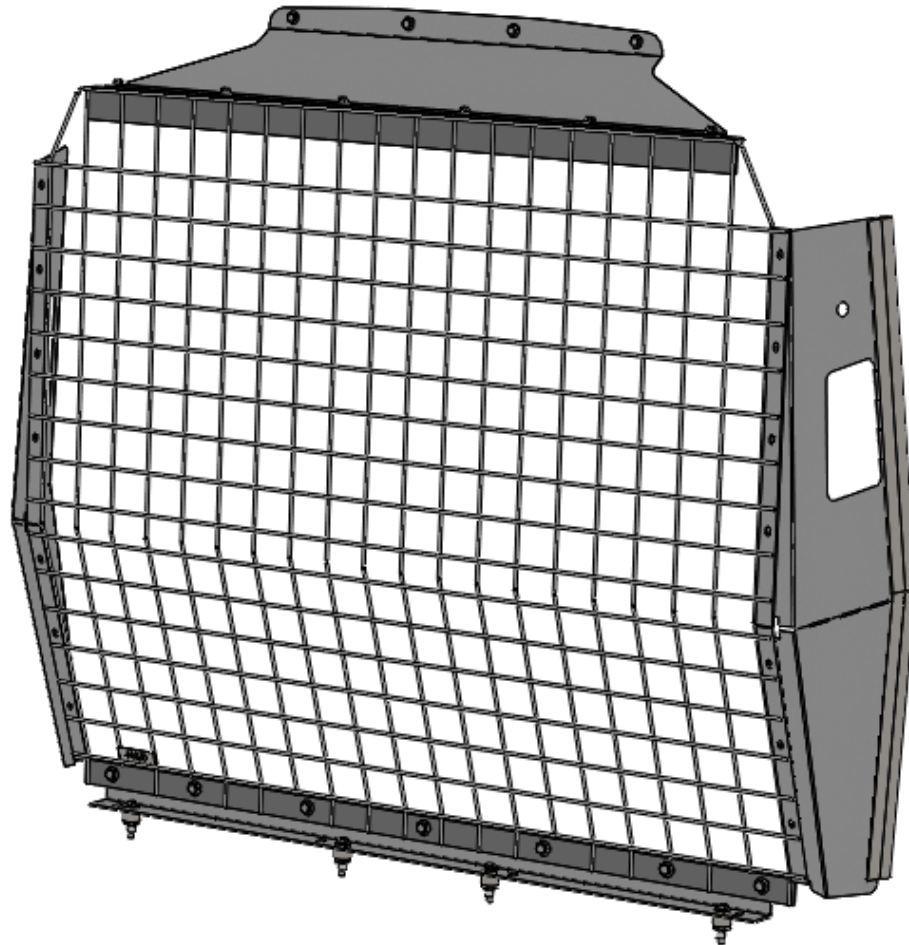

**DOUBLE CHECK ALL FASTENERS LOCATIONS TO BE SURE
THAT ALL FASTENERS ARE TIGHTENED TO SPECIFICATIONS.**

**YOUR INSTALLATION IS NOW COMPLETE!
STOW THIS COPY IN THE VEHICLE FOR
FUTURE REFERENCES!**