

PARTITION, MERCEDES METRIS

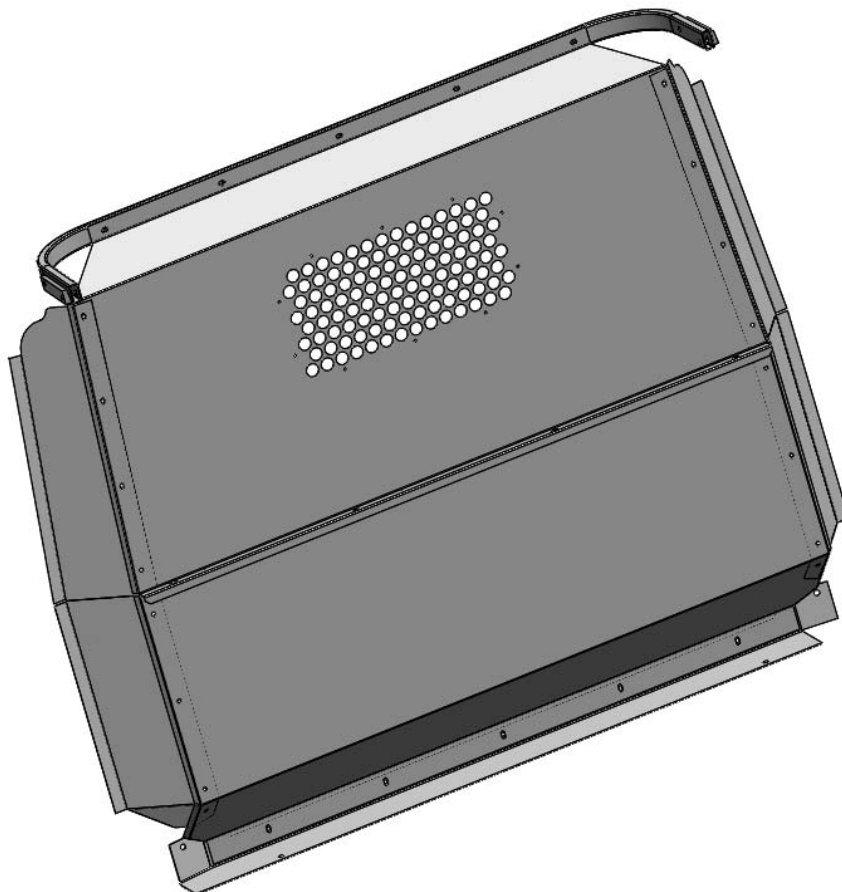

PRODUCT WEIGHT
67 LBS

WIDTH x DEPTH x HEIGHT
63" x 13" x 53"

CAPACITY
N/A

COLOR
GRAY

CATALOG NUMBER
P2MMS

PRODUCT FEATURES

**PAINTED STEEL PARTITION FOR THE MERCEDES METRIS
VAN. INSTALLS TO FACTORY ATTACHMENTS, NO DRILLING
OR SETTING PLUSNUTS REQUIRED!!**

**SEE PAGE 2 FOR APPLICATION NOTES AND ACCESSORIES, OTHER PRODUCTS THAT
WORK WITH THIS UNIT.**



CATALOG NUMBER P2MMS

PRODUCT APPLICATION

This product is designed to be installed in the Mercedes Metris van

ACCESSORIES THAT WILL WORK WITH THIS PRODUCT

CATALOG NUMBER	DESCRIPTION
-----------------------	--------------------

N/A	
-----	--

SPECIAL APPLICATION NOTES

Introduction / Comments:

THIS PARTITION IS DESIGNED FOR THE 2016 MERCEDES METRIS VAN.

IT UTILIZES FACTORY MOUNTING POINTS SO THERE IS NO DRILLING OR SETTING PLUSNUTS REQUIRED.

Note:

It is advised that all fasteners used in this assembly and installation of this Rack should be checked for tightness at the following intervals: @ 2-weeks and again @ 6-weeks of operation. This preventive maintenance step must be completed to ensure your package gives you long service life.

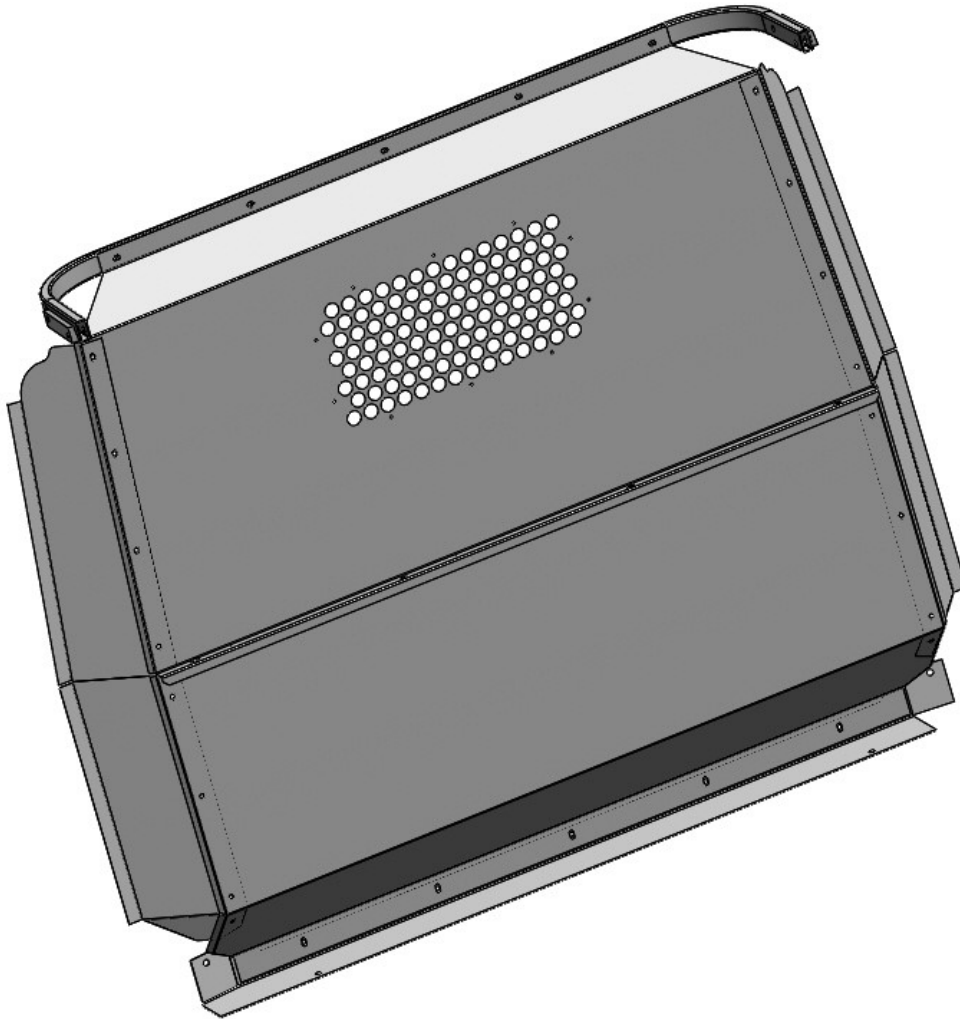

P2MMS MERCEDES METRIS PARTITION

- PRECAUTIONS -





 **CAUTION** 
**THE USE OF AIR IMPACT TOOLS CAN
OVER-TORQUE FASTENERS AND
CAUSE FASTENER FAILURE!**



 **CAUTION** 
**ALL INSTALLATION HOLES SHOULD BE SEALED
WITH SILICON OR BUTYL SEALANT TO PREVENT
EXHAUST FUMES FROM ENTERING THE VEHICLE!**



 **DANGER** 
**INSPECT FOR FUEL TANK, FUEL LINES, BRAKE LINES, HIGH
VOLTAGE BATTERIES AND ELECTRICAL LINES PRIOR TO
DRILLING TO AVOID DAMAGING CRITICAL VEHICLE SYSTEMS
OR INJURY TO INSTALLER DURING INSTALLATION PROCESS!**



 **CAUTION** 
**TO AVOID DAMAGING THE VEHICLE ALWAYS
USE DRILL STOPS WHEN DRILLING ANY IN-
STALLATION HOLES!**



- IMPORTANT WARRANTY REQUIREMENTS -

1. SUBSTITUTING ADRIAN STEEL SPECIFIED FASTENERS FOR ASSEMBLY AND/OR INSTALLATION WILL VOID YOUR PRODUCT WARRANTY.
2. ALL HOLES DRILLED INTO VEHICLE SHOULD HAVE THE RAW METAL EDGES SEALED WITH A SELF-ETCHING PRIMER TO RESIST CORROSION AND POTENTIAL FASTENER POINT FAILURE.
3. ALL FASTENERS USED IN THE INSTALLATION OF THIS PRODUCT SHOULD BE TIGHTENED TO THE TORQUE(S) SPECIFIED IN THESE INSTRUCTIONS.
4. THESE INSTRUCTIONS SHOULD BE KEPT WITH THE VEHICLE.

THE BASIC TOOLS NEEDED FOR MOST INSTALLATIONS



DRILL



DRILL BIT WITH
STOP

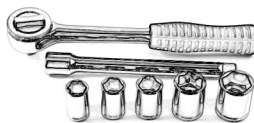

RATCHET, SOCKETS
AND/OR WRENCHES



SCREWDRIVERS



MEASURING TAPE

ADDITIONAL TOOLS MAY BE NEEDED FOR THIS INSTALLATION AND THEY WILL BE IDENTIFIED IN THE STEPS THAT FOLLOW.

P2MMS

ITEM NO.	PART NUMBER	DESCRIPTION	P2MMS/QTY.
1	51194-G	LOWER PANEL , METRIS PARTITION	1
2	51190-G	Floor Rail, Metris Partition	1
3	51191-G	Header Tube Asm, Metris Par.	1
4	51193-G	UPPER PANEL, Metris	1
5	BAGP2MMS	Fas Bag, P2MMS	1
6	51196-G	CS Wing	1
7	51195-G	Wing, SS	1
8	51197	Spacer, Par Tube	2
9	51199	Seal, Edge Bulb 37.5" Lg	2

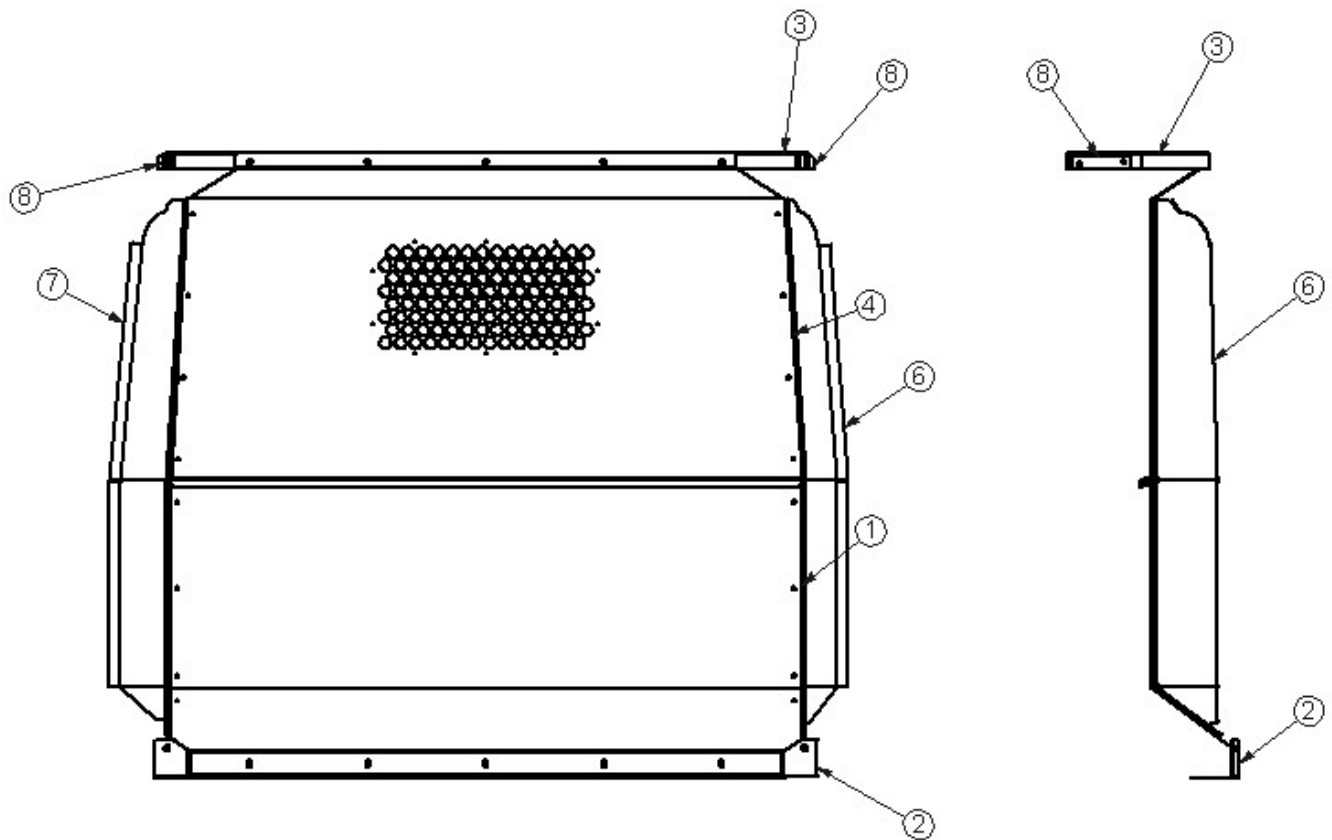

**BAGP2MMS
FASTENER BAG FOR P2MMS PARTITION**

ITEM NO.	PART NUMBER	DESCRIPTION	BAGP2MMS/QTY.																
1	BAG0507-A	5" x 7" 3MIL AUTOBAG	1																
2	FAS0018	SCREW,HH SFLNG 1/4-20X.62 ZP	25																
3	FAS0055	Nut, Hex Flange,Nylock 1/4-20	25																
4	FAS0787	Screw, Hex Hd, M6x1X 40mm lg, Zn Plate, Grade 8	4 <tr> <td>5</td><td>FAS0124</td><td>Washer, Flat, 1/4, NI ZN</td><td>9</td></tr> <tr> <td>6</td><td>FAS0060</td><td>Washer, Lock, Split, 1/4</td><td>9</td></tr> <tr> <td>7</td><td>03927-0</td><td>FLOOR SPACER</td><td>2</td></tr> <tr> <td>8</td><td>FAS0078</td><td>Screw, Hex Hd, 1/4-20x1.00 Zn Plate, Grade 8</td><td>5</td></tr>	5	FAS0124	Washer, Flat, 1/4, NI ZN	9	6	FAS0060	Washer, Lock, Split, 1/4	9	7	03927-0	FLOOR SPACER	2	8	FAS0078	Screw, Hex Hd, 1/4-20x1.00 Zn Plate, Grade 8	5
5	FAS0124	Washer, Flat, 1/4, NI ZN	9																
6	FAS0060	Washer, Lock, Split, 1/4	9																
7	03927-0	FLOOR SPACER	2																
8	FAS0078	Screw, Hex Hd, 1/4-20x1.00 Zn Plate, Grade 8	5																

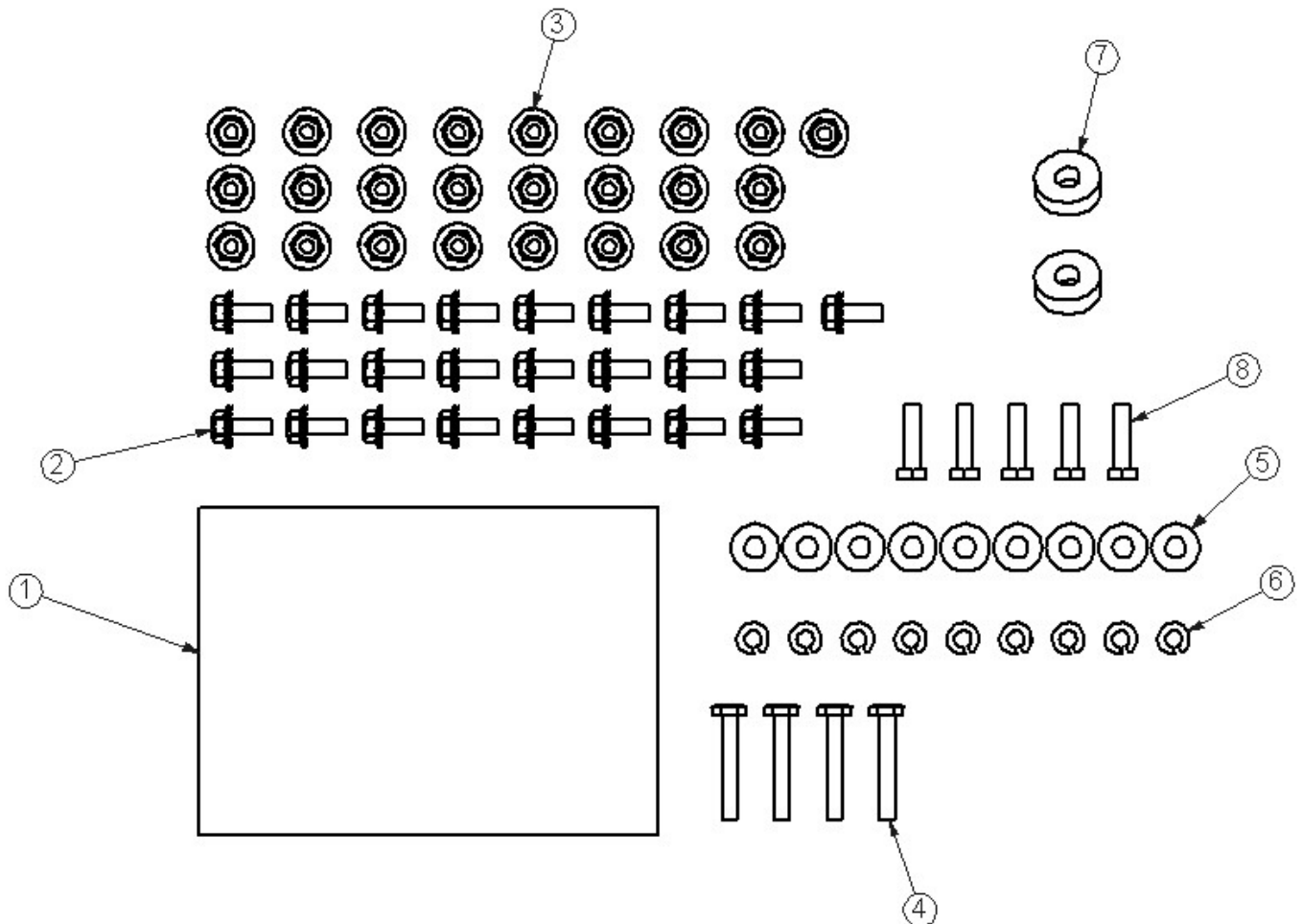

STEP 01 : REMOVE THE 2 FLOOR MOUNTING SCREWS AND THE LOWER D-RINGS ON THE B-PILLARS. SEE PICTURE BELOW. PLACE SPACERS IN FLOOR RECESSES AND POSITION FLOOR RAIL. ATTACH FLOOR RAIL RE-USING FACTORY FASTENERS AND D-RINGS AS SHOWN. SAME WITH WOOD FLOOR OR NO WOOD FLOOR



DRIVER'S SIDE



PASSENGER SIDE

**PASSENGER SIDE
WITH FASTENERS
REMOVED AND
SPACER IN PLACE**

**NOTE: USE SPACER
WITH WOOD FLOOR
OR
NO WOOD FLOOR**

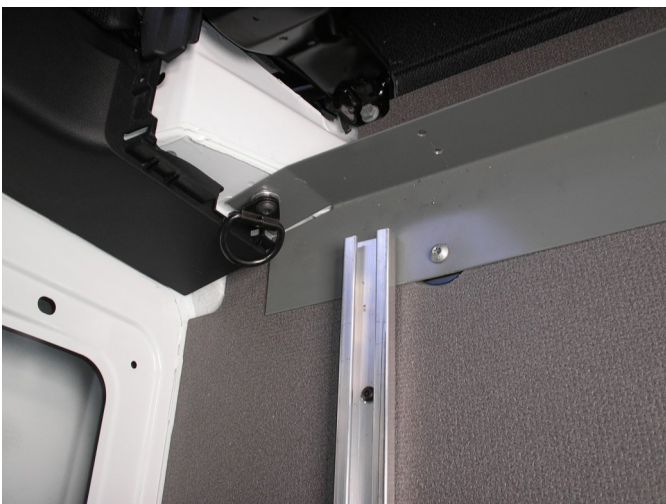

DRIVER'S SIDE INSTALLED



PASSENGER SIDE INSTALLED

STEP 02 : REMOVE THE 2 STYROFOAM PADS FROM CEILING AT "B" PILLAR. YOU WILL HAVE TO REACH IN ABOVE THE HEADLINER. THEY WRAP AROUND THE ROOF BOW. HEADLINER IS HELD UP BY MAGNETIC STRIPS. PADS ARE ALSO SCREWED TO BRACKETS MOUNTED TO VEHICLE AT TOP OF WALLS. THEN REMOVE THE BRACKETS THAT THE FOAM PADS WERE SCREWED TO. SEE PICTURES BELOW. NOW MOUNT THE HEADER TUBE USING THE 50MM LONG M6 SCREWS AND SPACERS INTO THE SAME THREADED HOLES AS THE FOAM PAD BRACKETS WERE MOUNTED TO AS SHOWN. TIE WRAP WIRE HARNESSES TO TUBE.



**FOAM PAD, PASS SIDE
REMOVE SCREW AND PULL OUT
FROM ABOVE HEADLINER**



**FOAM PAD REMOVED. NOW
REMOVE BRACKET.**



**DRIVER SIDE WITH HEADER TUBE
INSTALLED**



**PASS SIDE WITH HEADER TUBE
INSTALLED**

STEP 03: ASSEMBLE MAIN PARTITION BODY USING 20 EACH OF FAS0018 HEX SCREW AND FAS0055 HEX FLANGE NUT

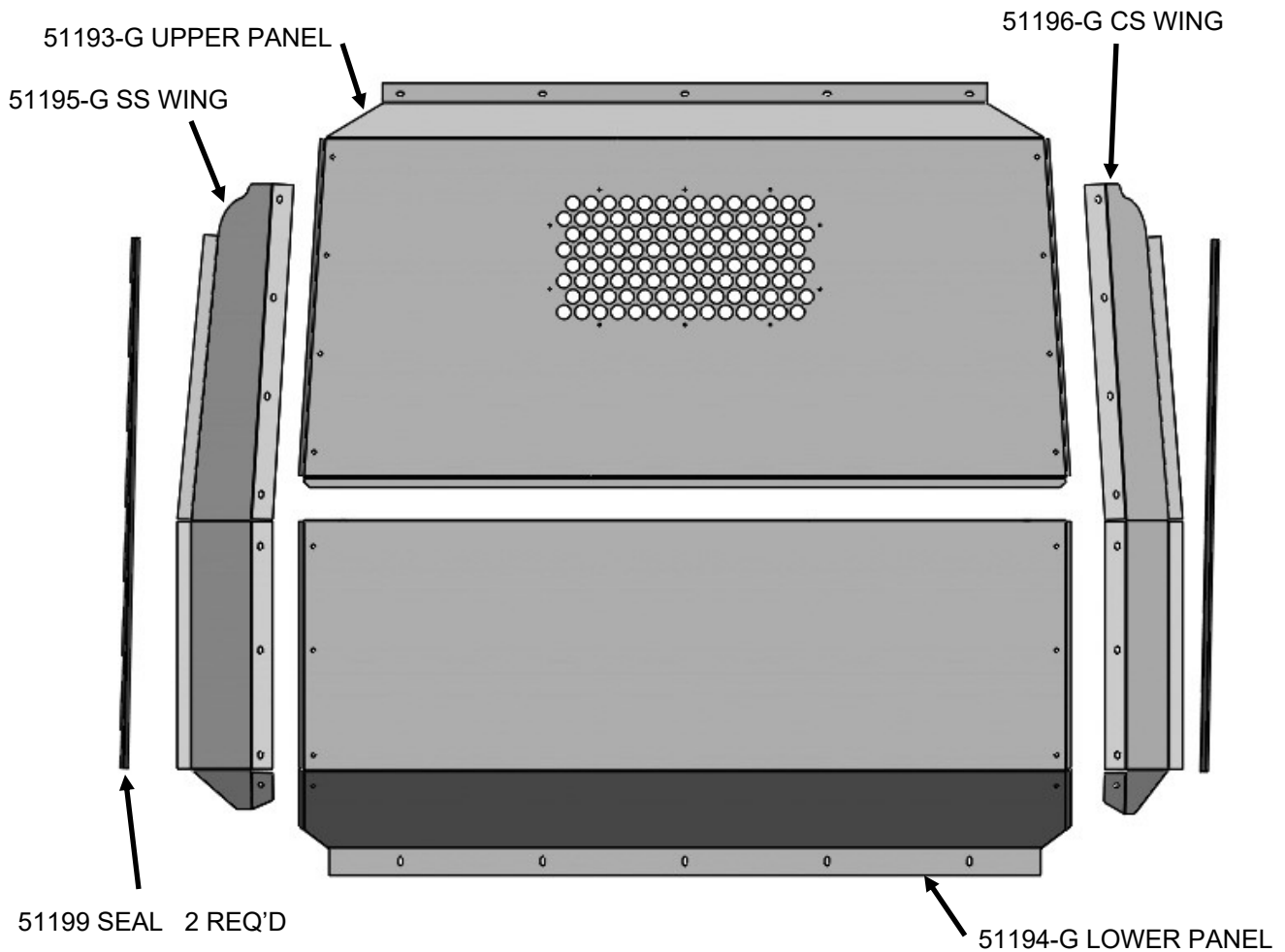

**VIEW OF SEAL ON
PARTITION WING.
BULB TOWARD FRONT.**

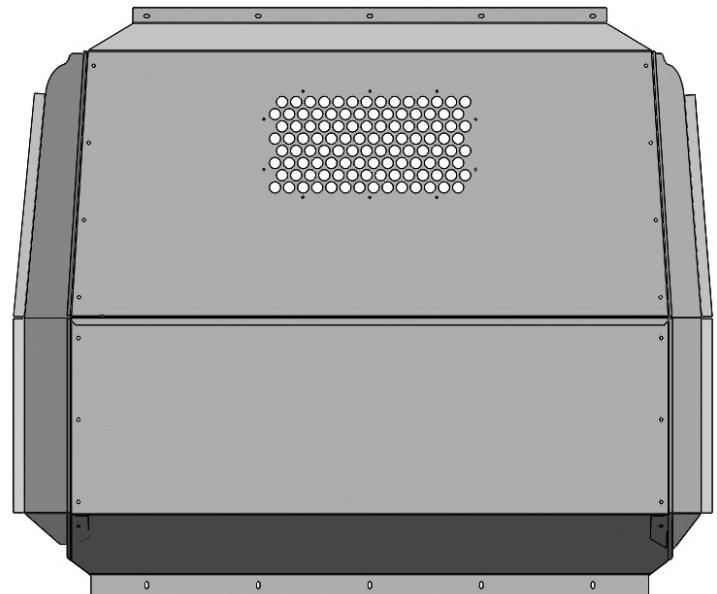

PARTITION ASSEMBLED

STEP #04 : MOUNT PARTITION IN VEHICLE

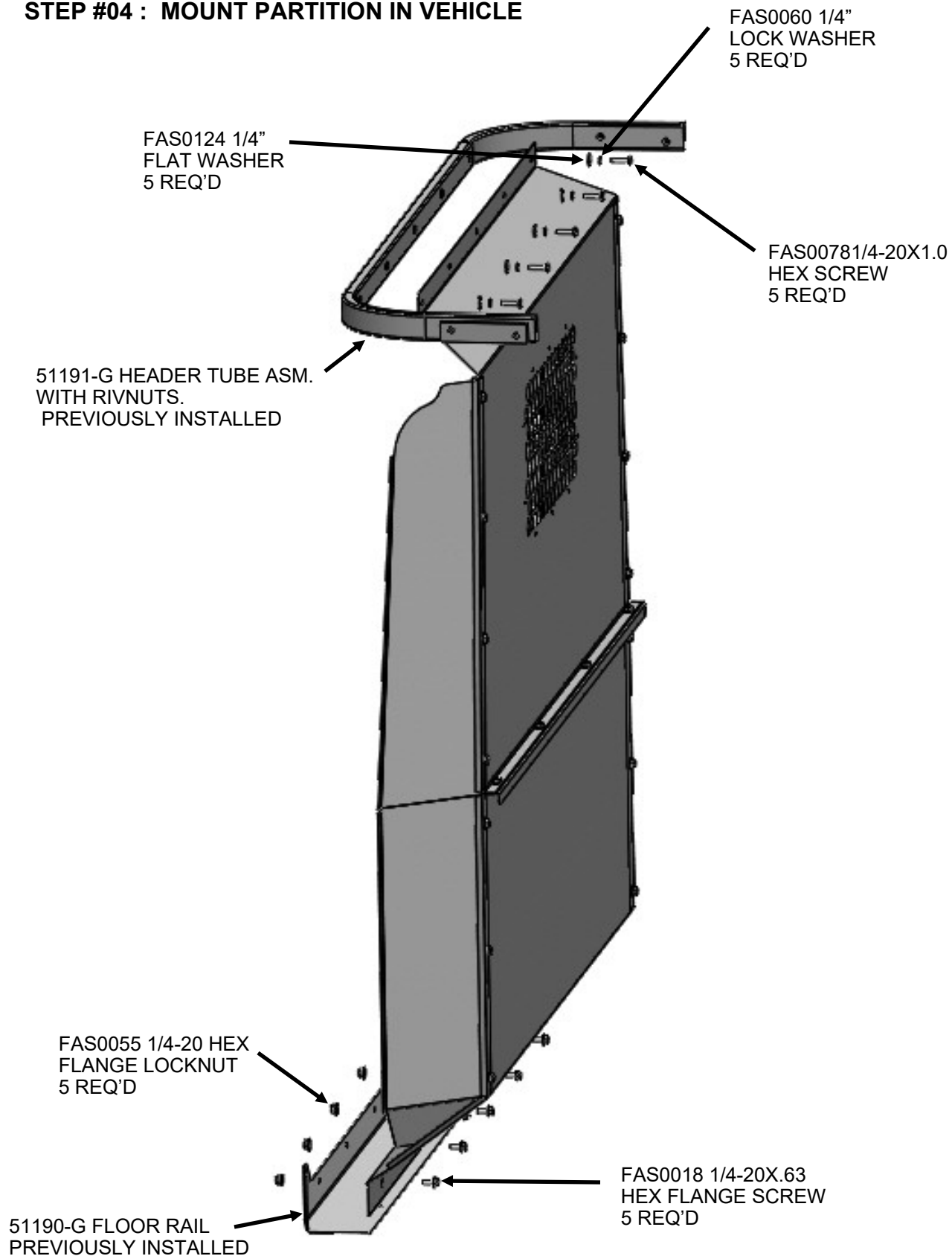



**VIEW OF FINISHED INSTALL
FROM INSIDE CAB**

**VIEW OF FINISHED INSTALL
THRU SIDE DOOR**



**VIEW OF FINISHED INSTALL
FROM CARGO AREA**



***DOUBLE-CHECK ALL FASTENER LOCATIONS TO
BE SURE THAT ALL FASTENERS ARE TIGHTENED
TO SPECIFICATIONS!***



**YOUR INSTALLATION IS NOW COMPLETE! STOW THIS COPY IN THE
VEHICLE FOR FUTURE REFERENCE.**