

FORD TRANSIT CONNECT PARTITION

PRODUCT WEIGHT

56 LBS

WIDTH x DEPTH x HEIGHT

57.25" x 9.75" x 48.5"

CAPACITY

N/A

COLOR

GRAY

CATALOG NUMBER

P1TCS14

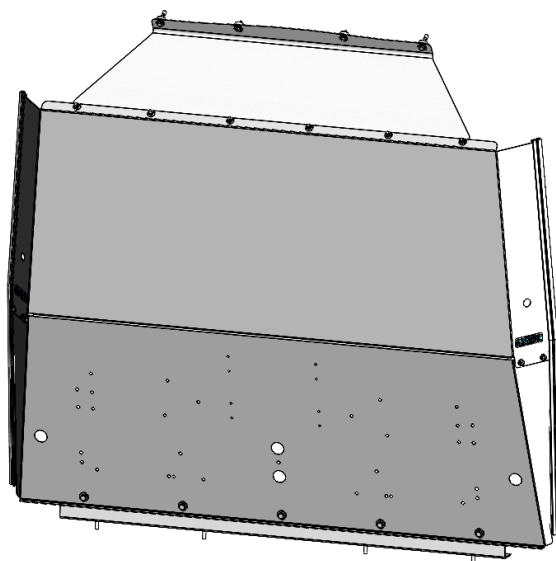

PRODUCT FEATURES

Steel partitions (using appropriate panel kit) for Ford Transit Connect standard roof provides a solution for separating the cab area from the cargo area. The steel partition features the use of OEM attachment points for a clean installation.

SEE PAGE 2 FOR APPLICATION NOTES AND ACCESSORIES, OTHER PRODUCTS THAT WORK WITH THIS UNIT.

PAGE 1 of 2

The information contained in this document is the sole property of ADRIAN STEEL COMPANY. ADRIAN STEEL COMPANY retains the right to modify and/or change the product of its design at any time without prior notification.

Accessory Chart

	Cargo Side	Cab Side
	Base Partition BAGRKA1 REQUIRED (1 BAGRKA1 will allow for one accessory to be added)	None available
Available Accessories	-	-
PA7: Reflector kit	x	-
PA8: Fire ext.	x	-
PA9: First aid tray	x	-
PA10: Practice holder	-	-
PA11: Cab file	-	-
PA11NL: Catalog box	-	-
TA1: Four hook bar	-	-
TH30: 30lb tank holder	-	-
TH50: 50lb tank holder	-	-
UH50RM1: Rail mount kit	-	-
UH10: 1" hook	-	-
UH25: 2.5" hook	-	-
UH25CP-G: 2.5' hook comp	-	-
UH50: 5" hook	x	-

Introduction / Comments:

This Partition is designed to fit in your 2014-Newer Transit Connect vehicle. This instruction covers the P1TCS14 and P2TCS14. Assembly is identical for the solid partition to the perforated. Only difference are the perforations on Upper Panel.

Note:

It is advised that all fasteners used in this assembly and installation should be checked for tightness at the following intervals: @ 2-weeks and again @ 6-weeks of operation. This preventive maintenance step must be completed to ensure your Partition gives you long service life.

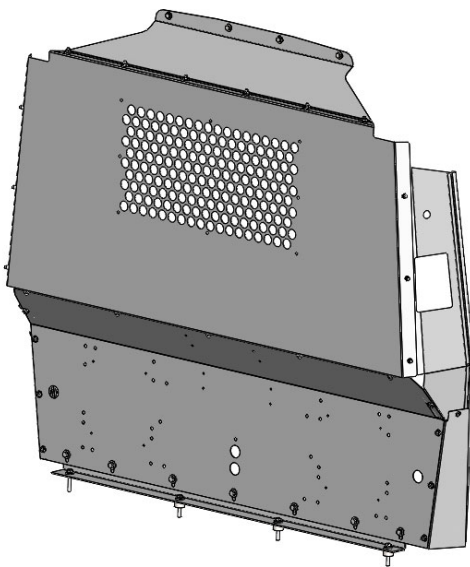

P2TCS14

P1TCS14

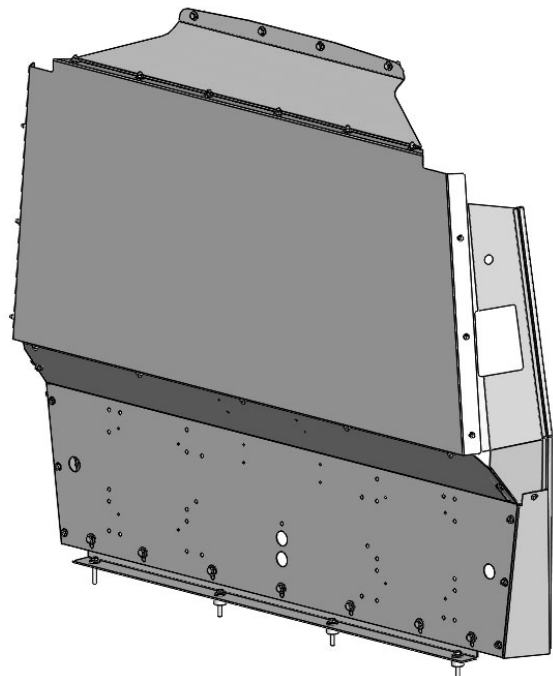

P1TCS14 / P2TCS14 FIXED PARTITION, 2014-NEWER TRANSIT CONNECT

- PRECAUTIONS -





 **CAUTION** 
**THE USE OF AIR IMPACT TOOLS CAN
OVER-TORQUE FASTENERS AND
CAUSE FASTENER FAILURE!**



 **CAUTION** 
**ALL INSTALLATION HOLES SHOULD BE SEALED
WITH SILICON OR BUTYL SEALANT TO PREVENT
EXHAUST FUMES FROM ENTERING THE VEHICLE!**



 **DANGER** 
**INSPECT FOR FUEL TANK, FUEL LINES, BRAKE LINES, HIGH
VOLTAGE BATTERIES AND ELECTRICAL LINES PRIOR TO
DRILLING TO AVOID DAMAGING CRITICAL VEHICLE SYSTEMS
OR INJURY TO INSTALLER DURING INSTALLATION PROCESS!**



 **CAUTION** 
**TO AVOID DAMAGING THE VEHICLE ALWAYS
USE DRILL STOPS WHEN DRILLING ANY IN-
STALLATION HOLES!**



- IMPORTANT WARRANTY REQUIREMENTS -

1. SUBSTITUTING ADRIAN STEEL SPECIFIED FASTENERS FOR ASSEMBLY AND/OR INSTALLATION WILL VOID YOUR PRODUCT WARRANTY.
2. ALL HOLES DRILLED INTO VEHICLE SHOULD HAVE THE RAW METAL EDGES SEALED WITH A SELF-ETCHING PRIMER TO RESIST CORROSION AND POTENTIAL FASTENER POINT FAILURE.
3. ALL FASTENERS USED IN THE INSTALLATION OF THIS PRODUCT SHOULD BE TIGHTENED TO THE TORQUE(S) SPECIFIED IN THESE INSTRUCTIONS.
4. THESE INSTRUCTIONS SHOULD BE KEPT WITH THE VEHICLE.

THE BASIC TOOLS NEEDED FOR MOST INSTALLATIONS



DRILL



DRILL BIT WITH
STOP

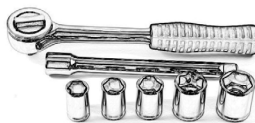

RATCHET, SOCKETS
AND/OR WRENCHES



SCREWDRIVERS



MEASURING TAPE

ADDITIONAL TOOLS MAY BE NEEDED FOR THIS INSTALLATION AND THEY WILL BE IDENTIFIED IN THE STEPS THAT FOLLOW.

If your vehicle contains carpet or a rubber floor mat you will need to prepare the mounting location. Position the product to be installed into the vehicle and once you are satisfied with the mounting locations, mark the mounting locations. Using a 1-3/16" diameter carpet cutter (P/N: 31183-0). Select the appropriate floor spacers as shown in the illustration. Set those aside for use later into the installation process. Using the correct drill bit size for the selected plusnut, drill the mounting holes in the vehicle sheet metal to prepare for installing the plusnuts.

If you are thru-bolting at any of the locations simply drill a hole that is 1/16" larger than the bolt size(s) for those locations.

Once you have drilled the holes into the vehicle, the raw metal edges should be sealed using a self-etching primer to resist corrosion and potential fastener point failure.

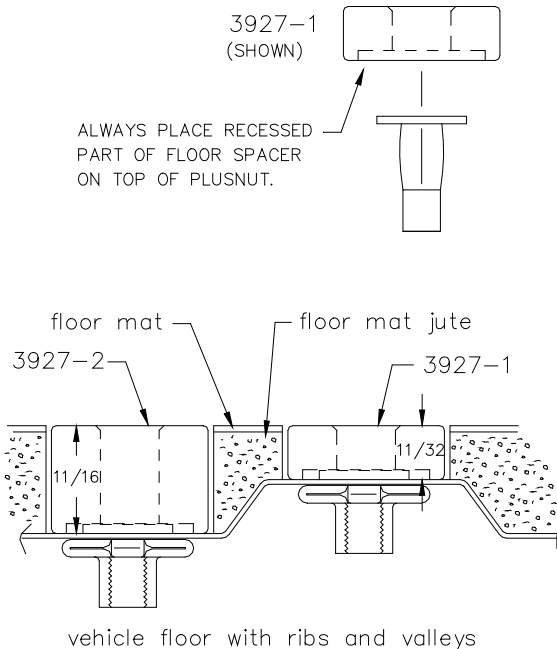

A PLUSNUT (RIVNUT) SETTING TOOL IS REQUIRED FOR PLUSNUT (RIVNUT) INSTALLATION AND IS SUPPLIED WITH THIS KIT. OR USE AN AIR POWERED PLUSNUT SETTING GUN.

1/4-20UNC Plusnut (FAS0052) Use 3/8" dia. drill w/stop

FAS0080 SCREW, HXHD, 1/4-20UNCx2.00", G8
FAS0067 WASHER, FLAT, 1/4"ID
22200-0 PLUSNUT TOOL

5/16-18UNC Plusnut (FAS0091) Use 1/2" dia. drill w/stop

FAS0095 SCREW, HXHD, 5/16-18UNCx2.00", G8
FAS0086 WASHER, FLAT, 5/16"ID
22200-0 PLUSNUT TOOL

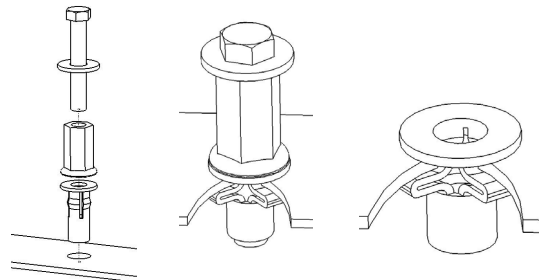

Place barrel of the plusnut body in sheet metal thru hole until flange is flush with sheet metal.

Using a 9/16" combination wrench of plusnut tool body and a second hand wrench, ratchet, or air tool, rotate the hex bolt head CW to draw plus nut flanges up (set the plusnut).

Assembly and Installation Fastener Identification Sheet (BAG44645)

ITEM NO.	PART NUMBER	DESCRIPTION	QTY.
1	BAG0509-A	5" x 9" 4MIL AUTOBAG	1
2	FAS0086	Washer, Flat, 5/16, ZN	11
3	FAS0098	Washer, Lock, Split, 5/16, Zinc Plate	11
4	FAS0018	SCREW,HH SFLNG 1/4-20X.62 ZP	28
5	FAS0055	Nut, Hex Flange,Nylock 1/4-20	22
6	FAS0081	Screw, Hex Hd, 5/16-18x0.75 Zn Plate	7
7	FAS0602	Screw, Hex Hd, 5/16-18x2.00 Zn-Ni (1000 hour) Grade 8	4
8	FAS0091	Plusnut, 5/16	4
9	03927-2	Tall Floor Spacer	4
10	FAS0052	Plusnut, 1/4	4
11	FAS0060	Washer, Lock, Split, 1/4	4
12	FAS0067	Washer, Flat, 1/4	4
13	FAS0078	Screw, Hex Hd, 1/4-20x1.00 Zn Plate, Grade 8	4

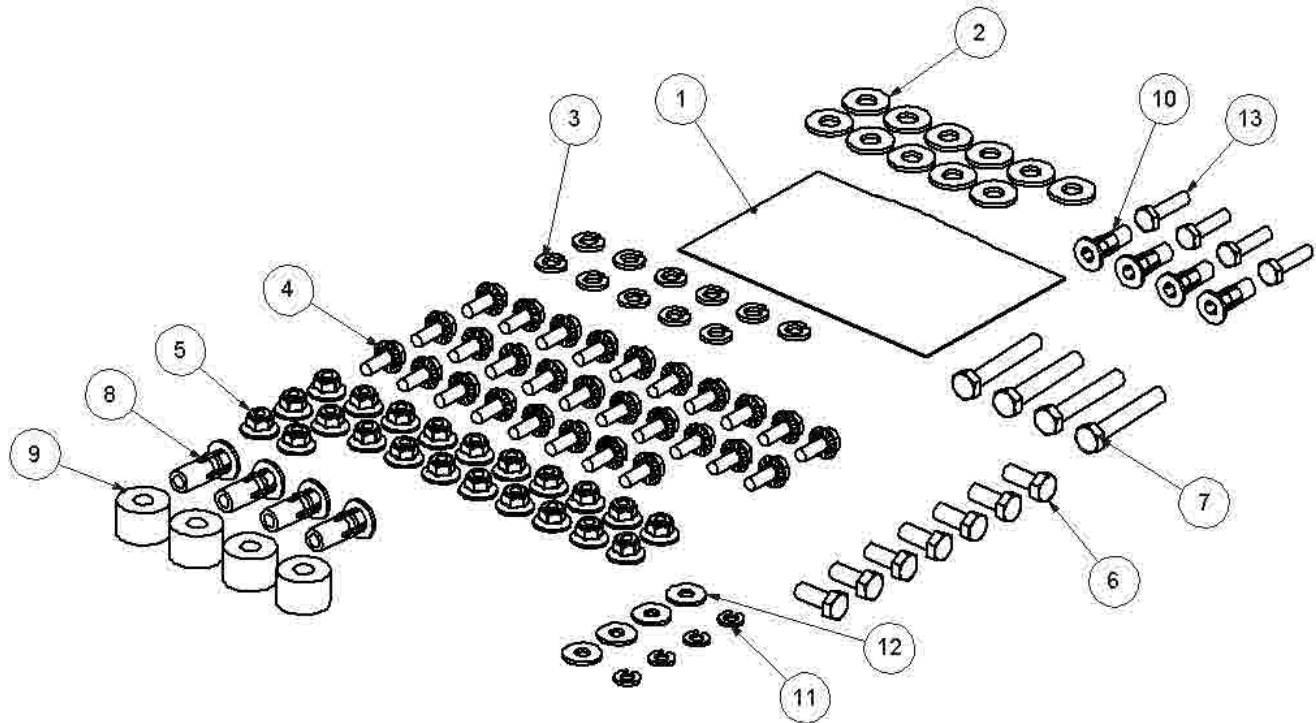

Assembly and Installation Hardware Identification Sheet (HDW44645)

ITEM NO.	PART NUMBER	DESCRIPTION	QTY.
1	42889	KNOB, 1/4-20X4.25 FLSTZNC	1
2	47675	JACK RELOCATED LABEL	1
3	FAS0052	Plusnut, 1/4	1
4	BAG0507-A	5" x 7" 3MIL AUTOBAG	1

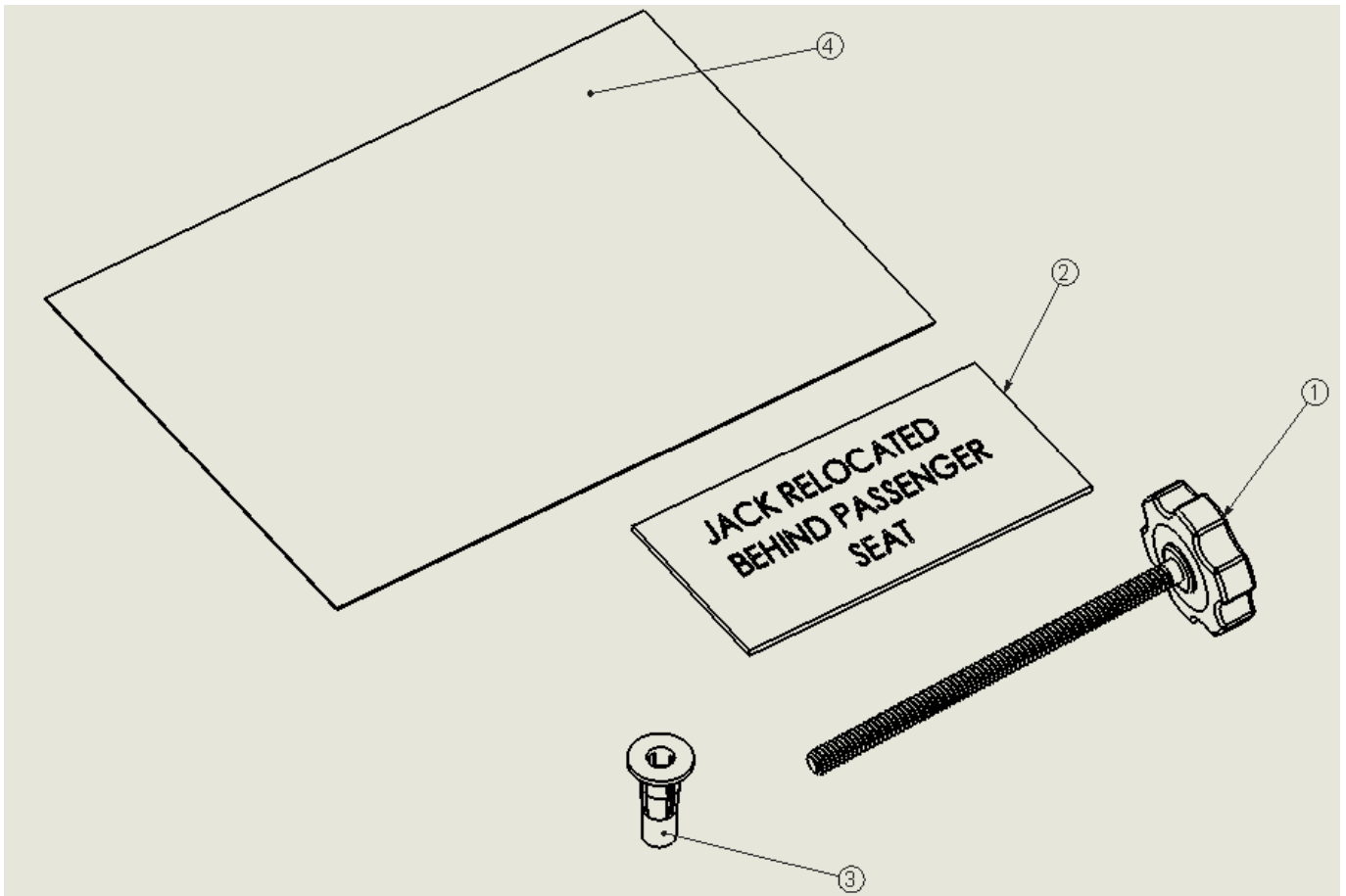

***** IF THE VEHICLE JACK NEEDS TO BE MOVED FROM FACTORY POSITION
CONTINUE WITH INSTRUCTION, IF ALREADY RELOCATED PROCEED TO STEP 2 *****

STEP 1A - REMOVE THE JACK FROM ITS CURRENT LOCATION

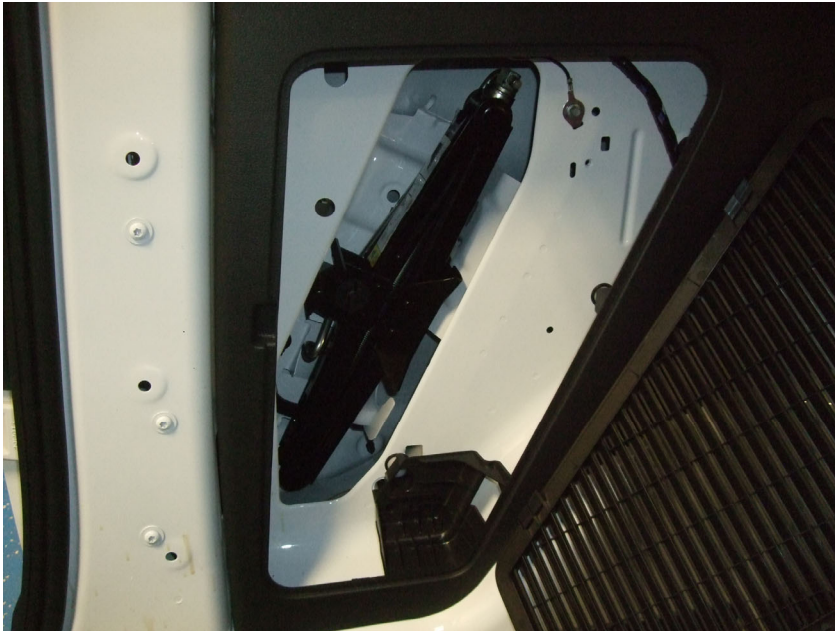

STEP 1B - SET THE JACK BEHIND THE PASSENGER SEAT. WHILE THE JACK IS IN THE NEW POSITION USE THE KNOB (42889) TO MARK THE PLUS NUT HOLE AND DRILL THE HOLE (3/8" DRILL WITH DRILL STOP).



STEP 1C - SET THE 1/4-20 PLUS NUT (FAS0052) IN THE NEWLY DRILLED HOLE. FASTEN DOWN THE JACK WITH THE KNOB (42889). MAKE SURE THAT BOTH PIECES (JACK/HANDLE) ARE TIGHTLY FASTENED TO PREVENT ANY RATTLING.

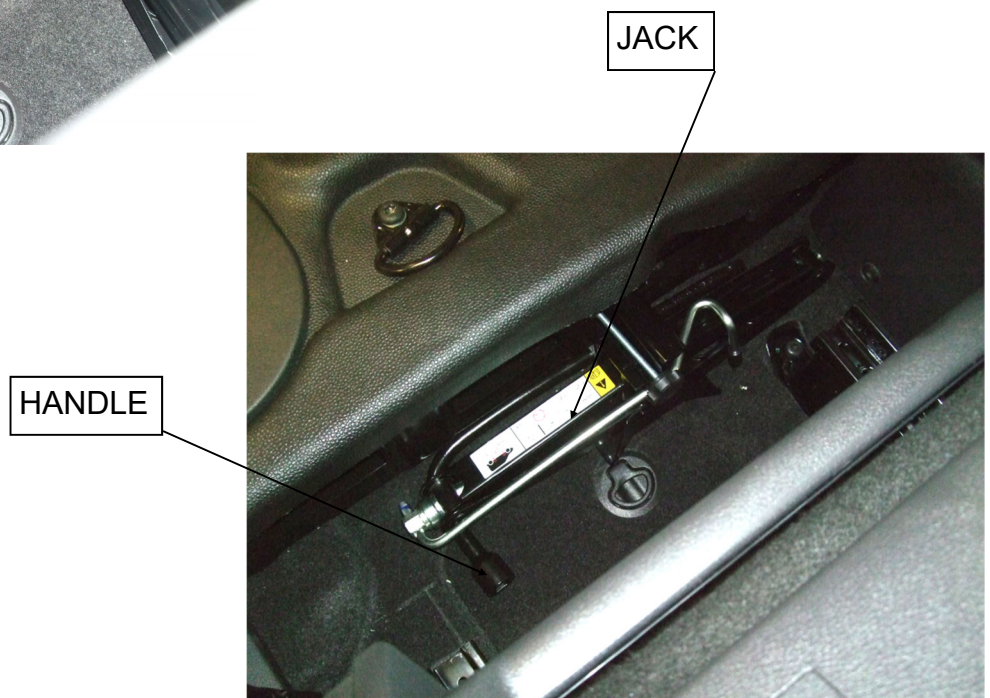

STEP 1D - APPLY JACK RELOCATED LABEL TO WHERE THE JACK USE TO BE LOCATED

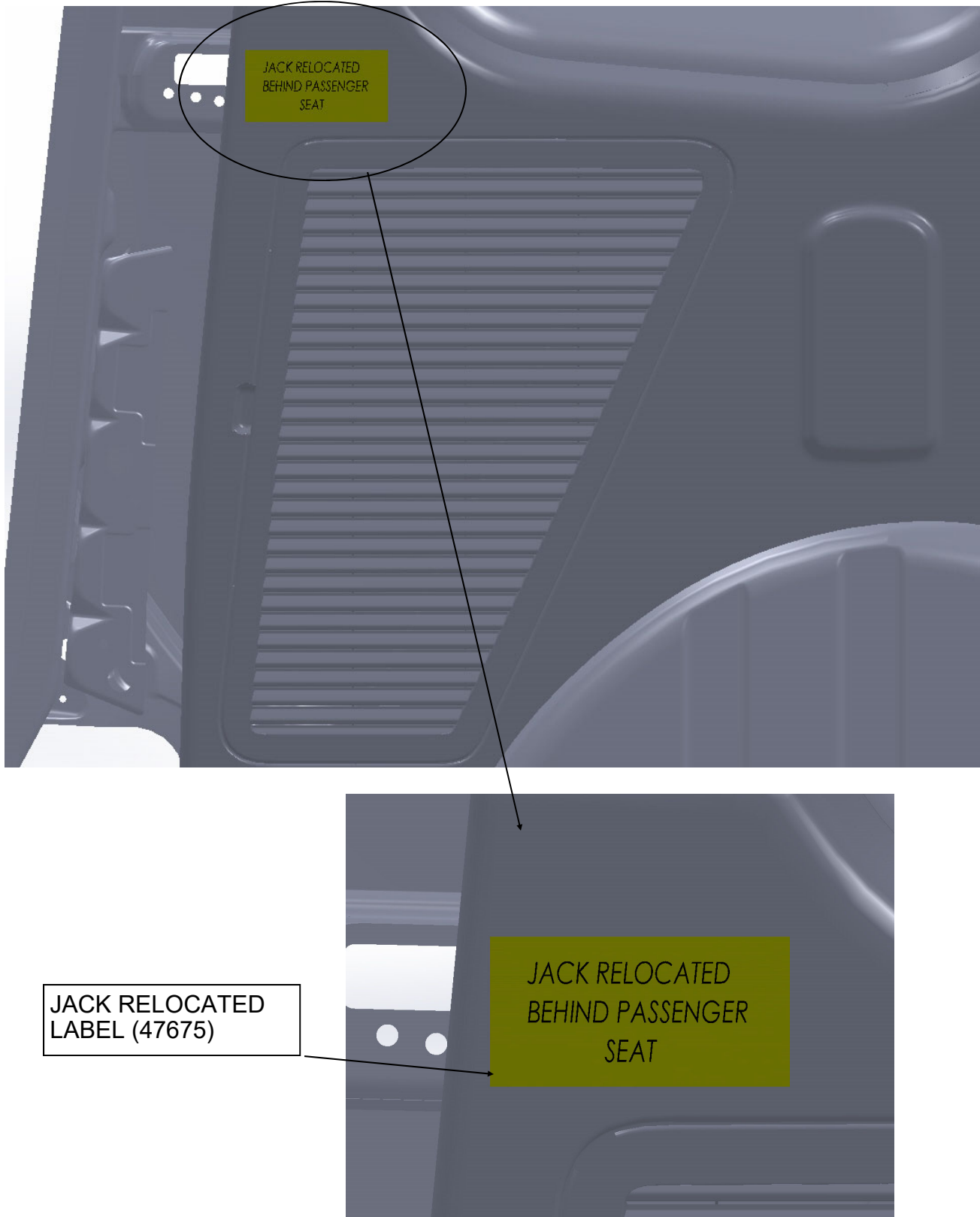

STEP 2 - ASSEMBLE THE PARTITION (PERFORATED OR SOLID UPPER PANEL)

SOLID (47228-G) OR
PERFORATED (46229-G)

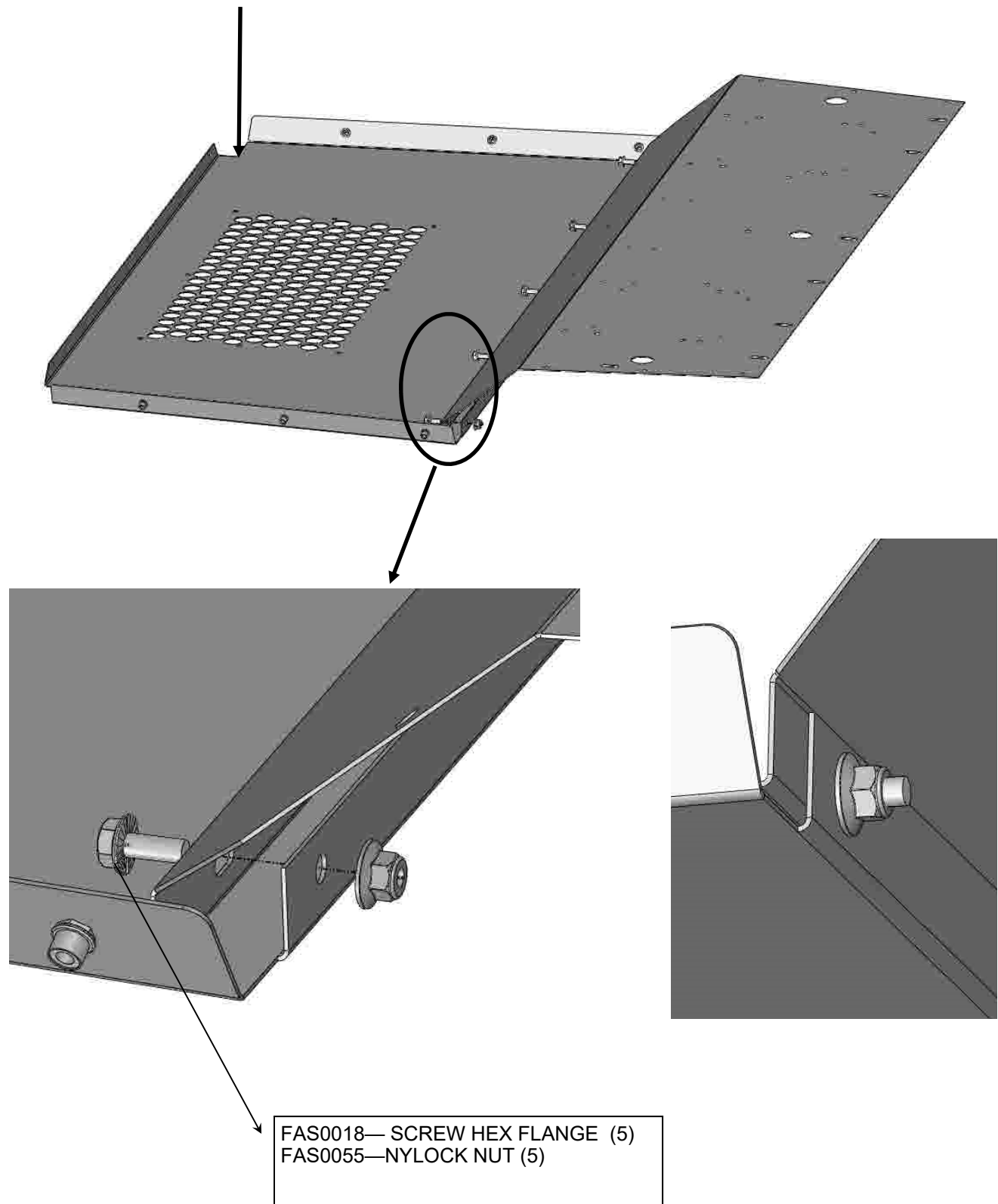

STEP 3 - ADD CURB SIDE WINGS

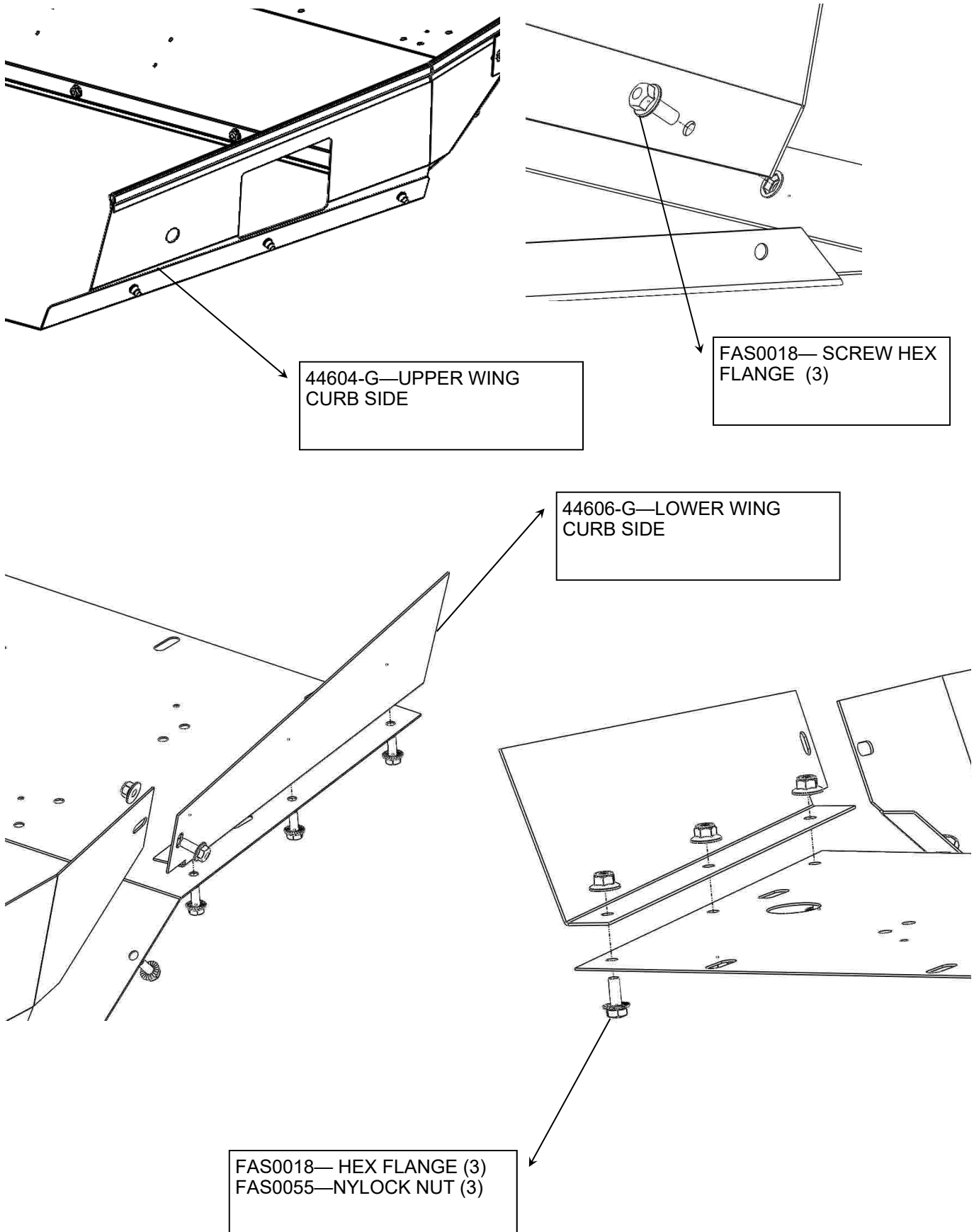

STEP 3 CONTINUED - ADD CURB SIDE WINGS

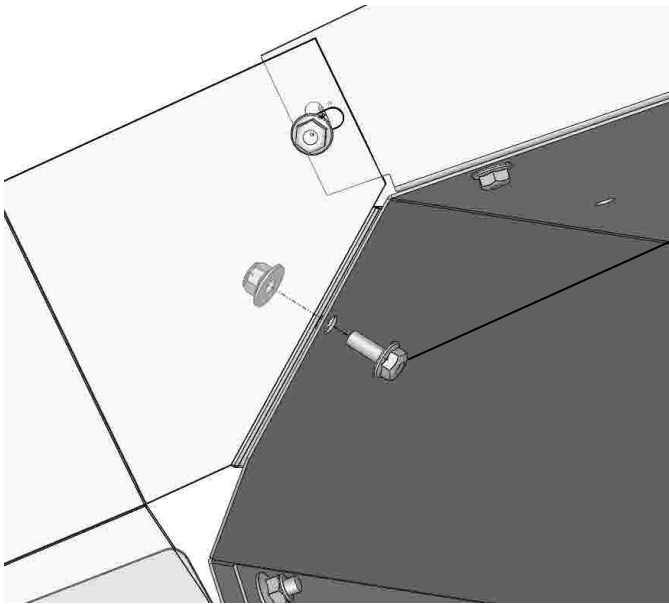

FAS0018— HEX FLANGE
FAS0055—NYLOCK NUT

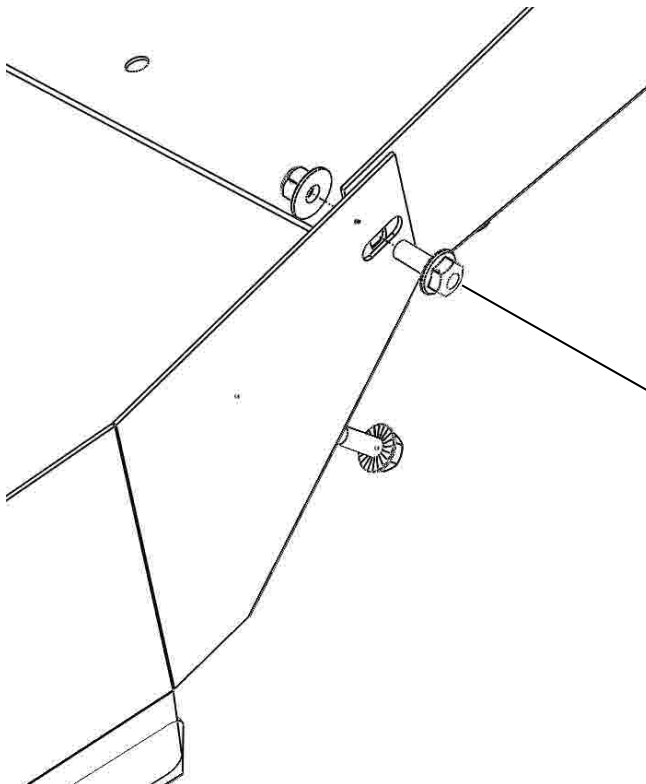

**DO NOT FULLY TIGHTEN
AT THIS STEP !**

FAS0018— HEX FLANGE
FAS0055—NYLOCK NUT

STEP 4 - ADD STREET SIDE WINGS

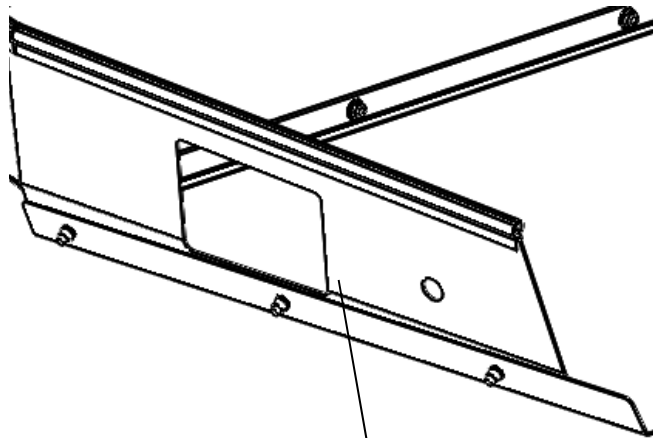

44605-G—UPPER WING
STREET SIDE

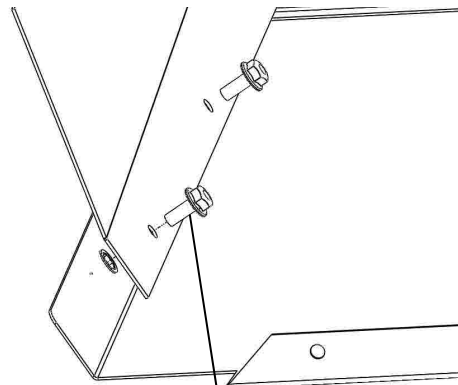

FAS0018— SCREW HEX
FLANGE (3)

44607-G—LOWER WING
STREET SIDE

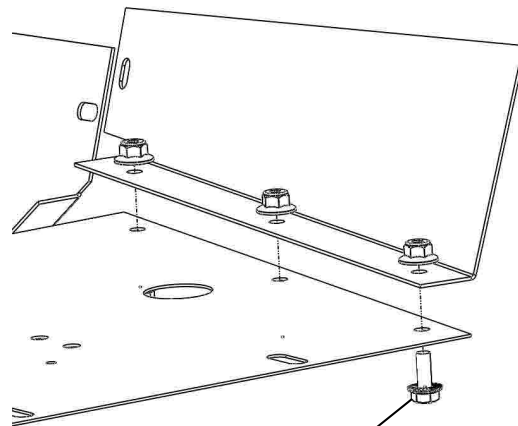
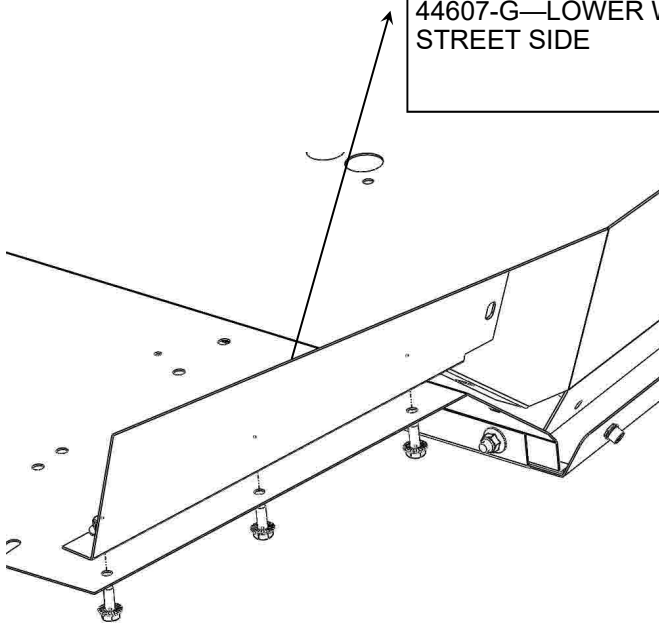

FAS0018— HEX FLANGE (3)
FAS0055—NYLOCK NUT (3)

STEP 4 CONTINUED - ADD STREET SIDE WINGS

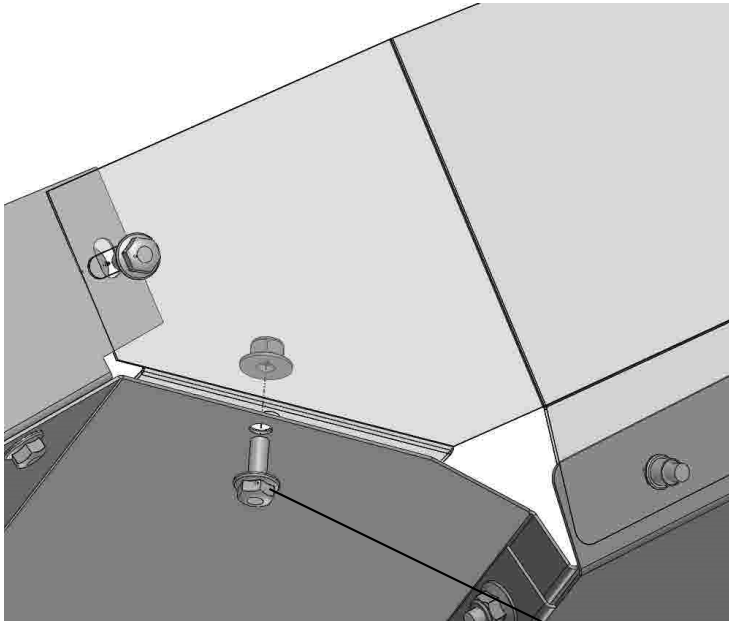

FAS0018— HEX FLANGE
FAS0055—NYLOCK NUT

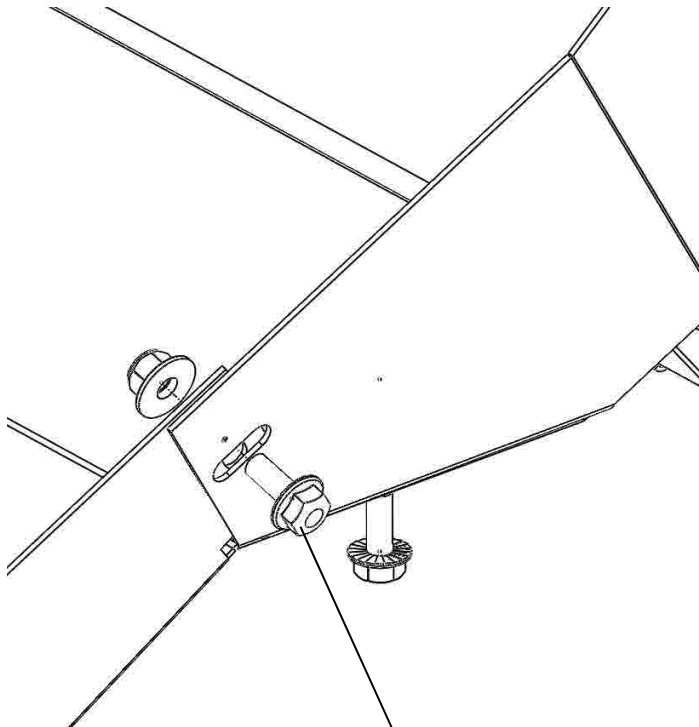

**DO NOT FULLY TIGHTEN
AT THIS STEP !**
FAS0018— HEX FLANGE
FAS0055—NYLOCK NUT

STEP 5 - ADD HEADER PANEL

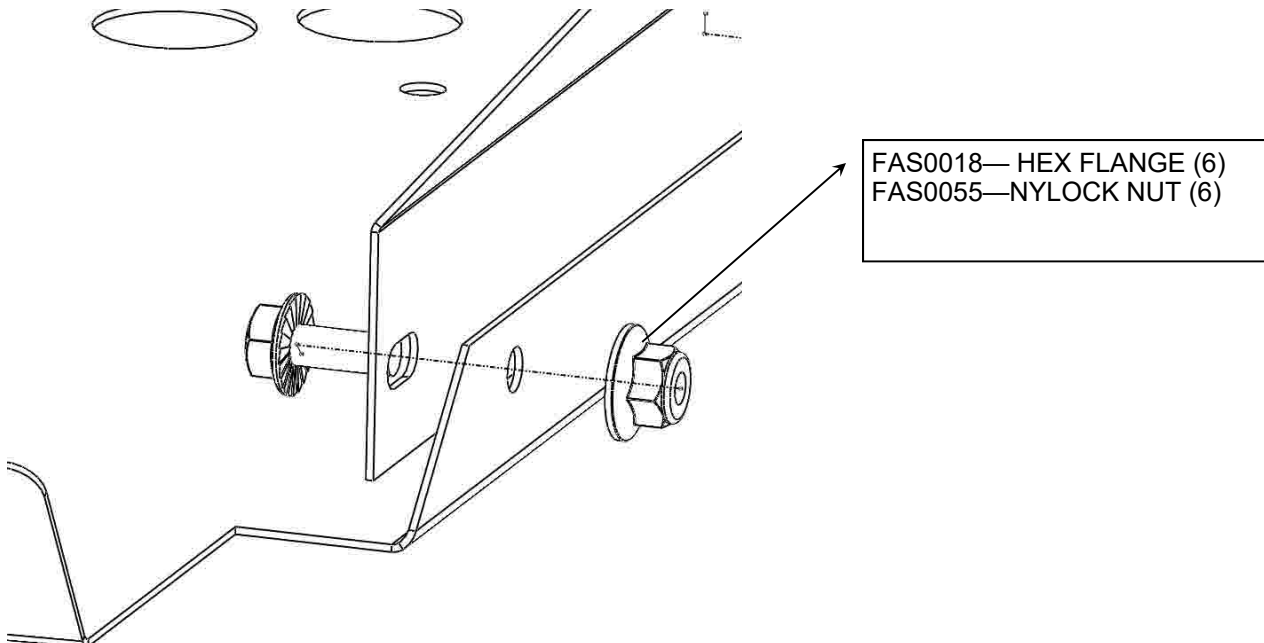
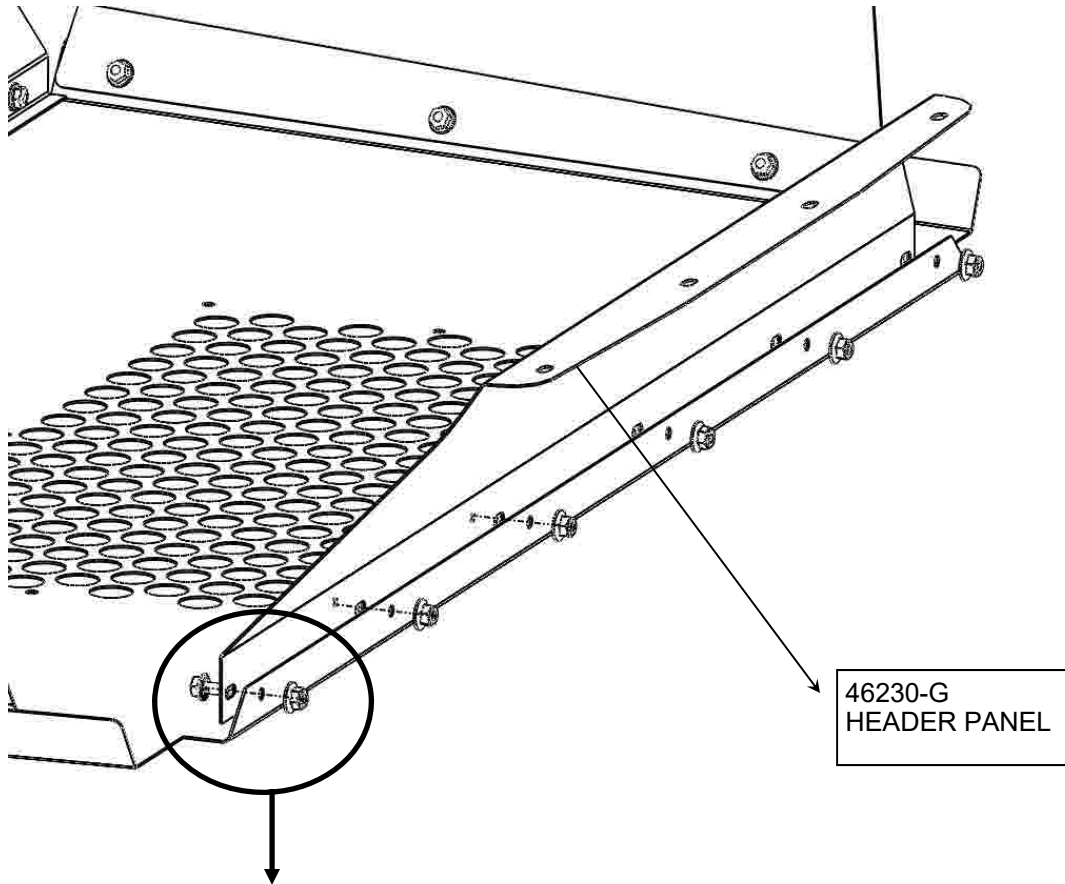

STEP 6 - ADD FLOOR RAIL

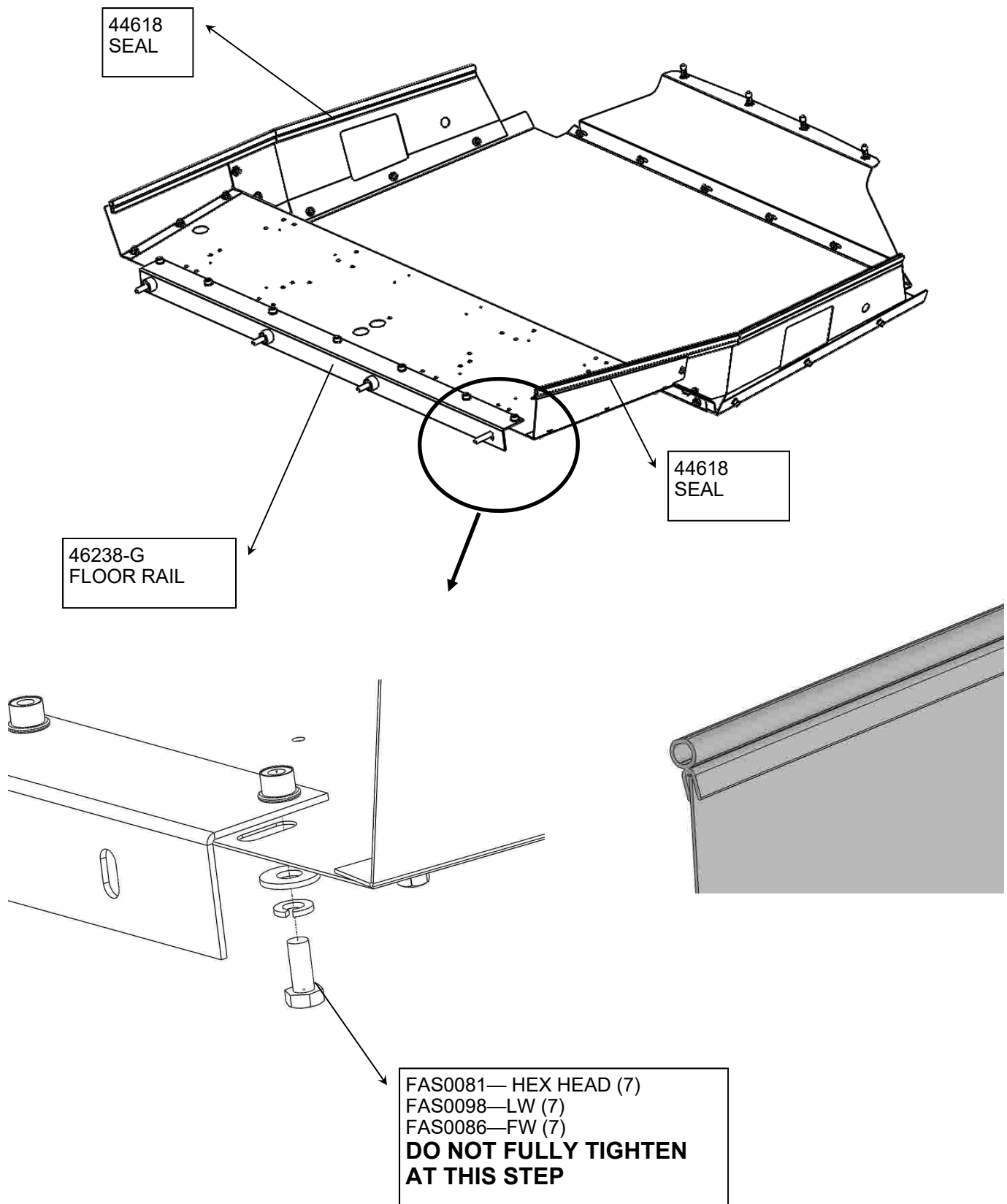

STEP 7 - FOR 2014-2017 VEHICLES ONLY! MODIFY YOUR TRANSIT CONNECT HEADLINER

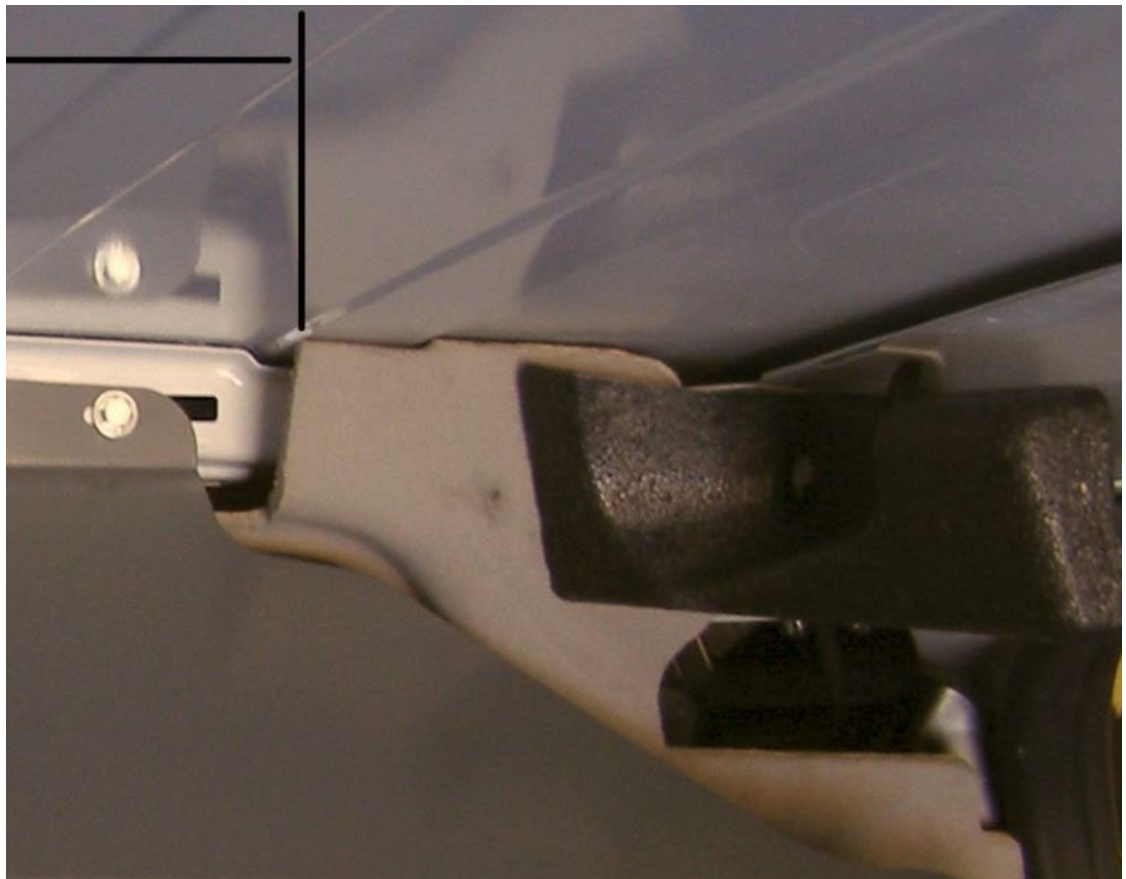
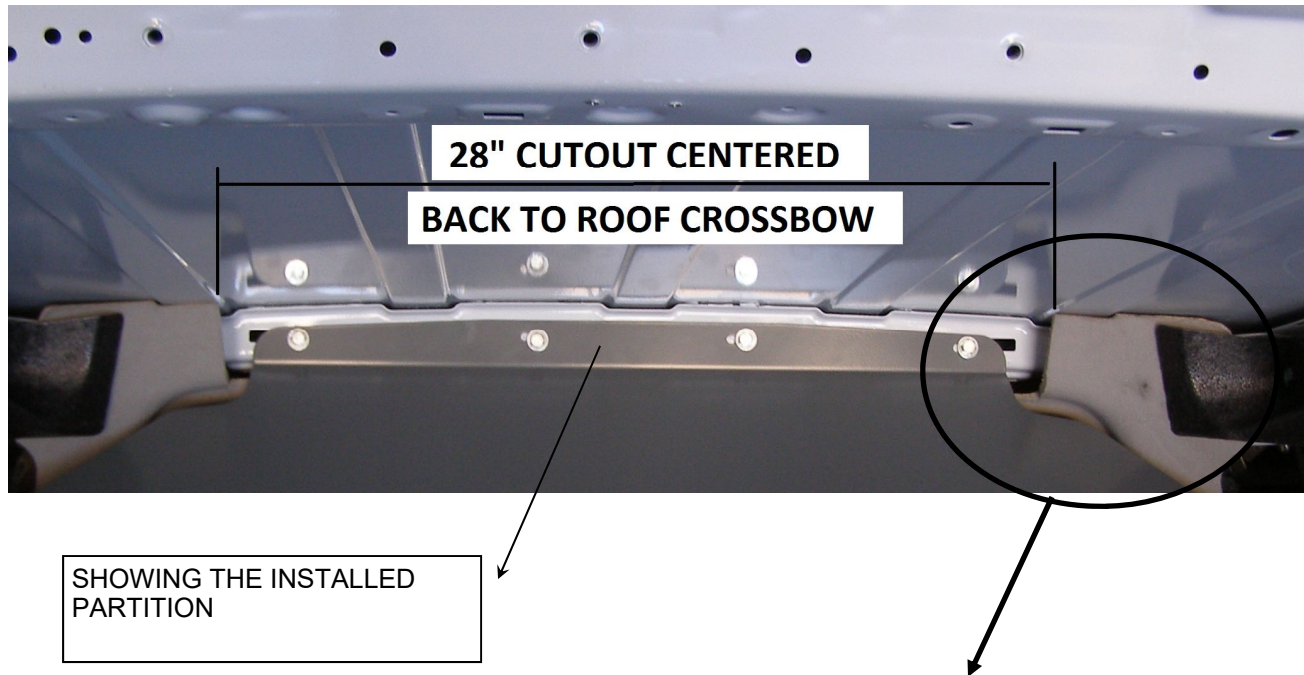

**FOR 2018-2021 MODEL YEAR VEHICLES WITH FABRIC HEADLINER SHOWN
BELOW, PROCEED TO STEP 8 AND SKIP STEP 9**

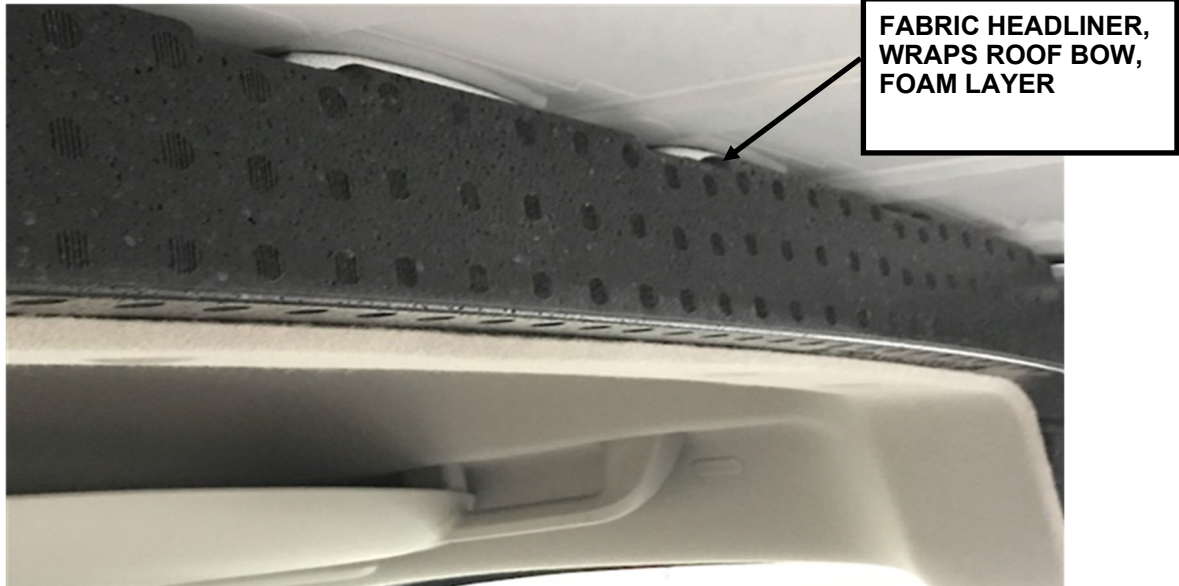

**FOR 2021-NEWER MODEL YEAR VEHICLES WITH PLASTIC HEADLINER SHOWN
BELOW, SKIP STEP 8 AND PROCEED TO STEP 9**



STEP 8 - FOR 2018-2021 VEHICLES ONLY! MODIFY HEADLINER FOAM

HEADLINER
FOAM INSERT

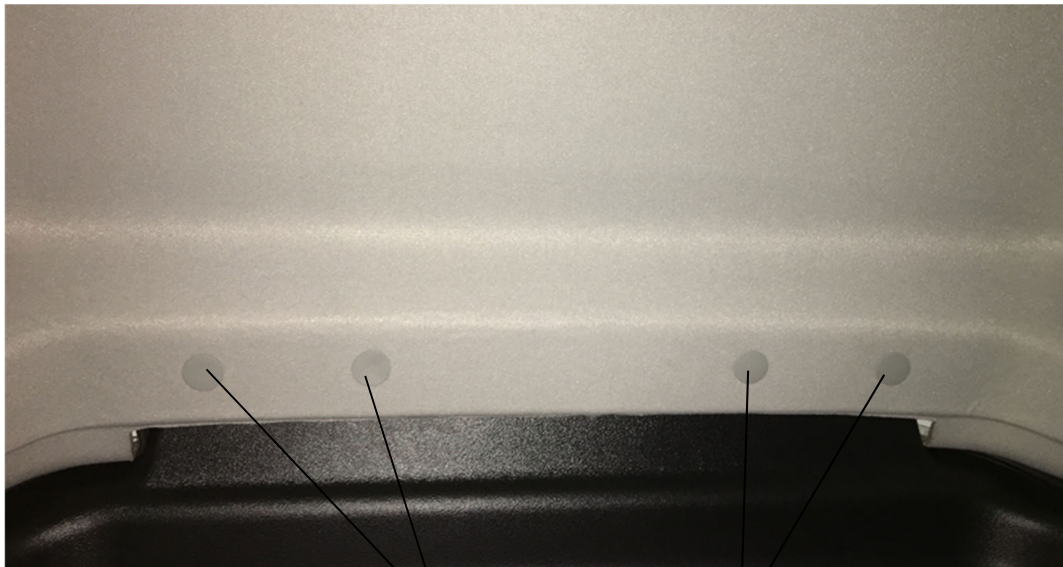

REMOVE PUSH-
PINS FROM HEAD-
LINER

STEP 8 CONTINUED - FOR 2018-2021 VEHICLES ONLY! MODIFY HEADLINER FOAM

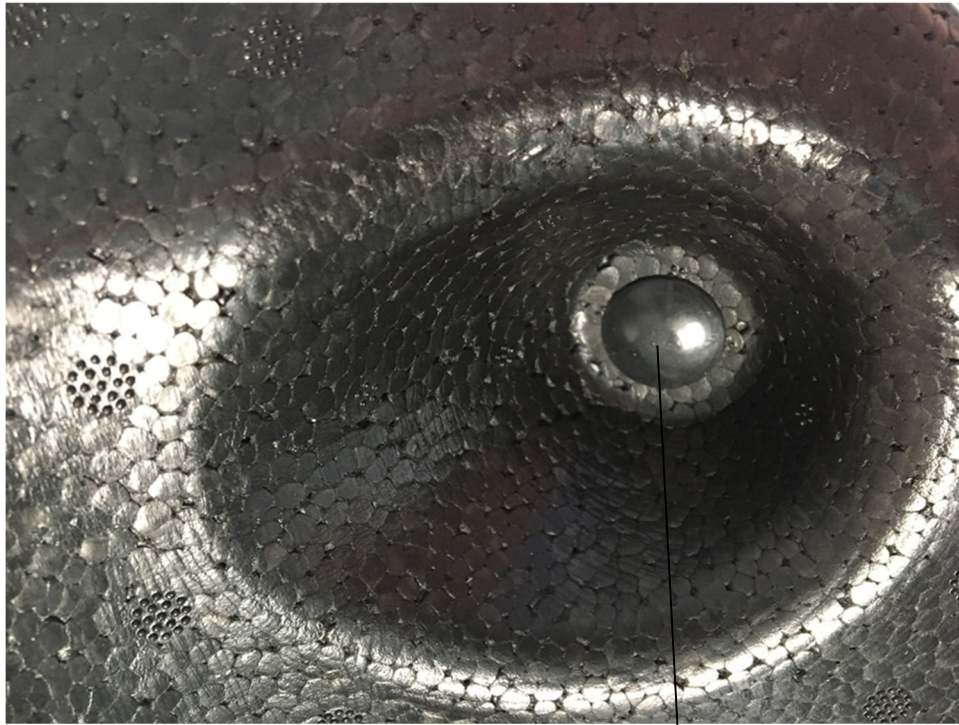

REMOVE PASSENGER
SIDE FOAM INSERT

CUT DOWN THE RED LINE.
LEAVE ROOM FOR THE
HOLE THAT IS CIRCLED.
DISCARD THE RIGHT SIDE
OF THE CUT. DRIVER-SIDE
IS MIRRORED.

REMOVE PUSHINS
FROM PASSENGER
SIDE FOAM INSERT

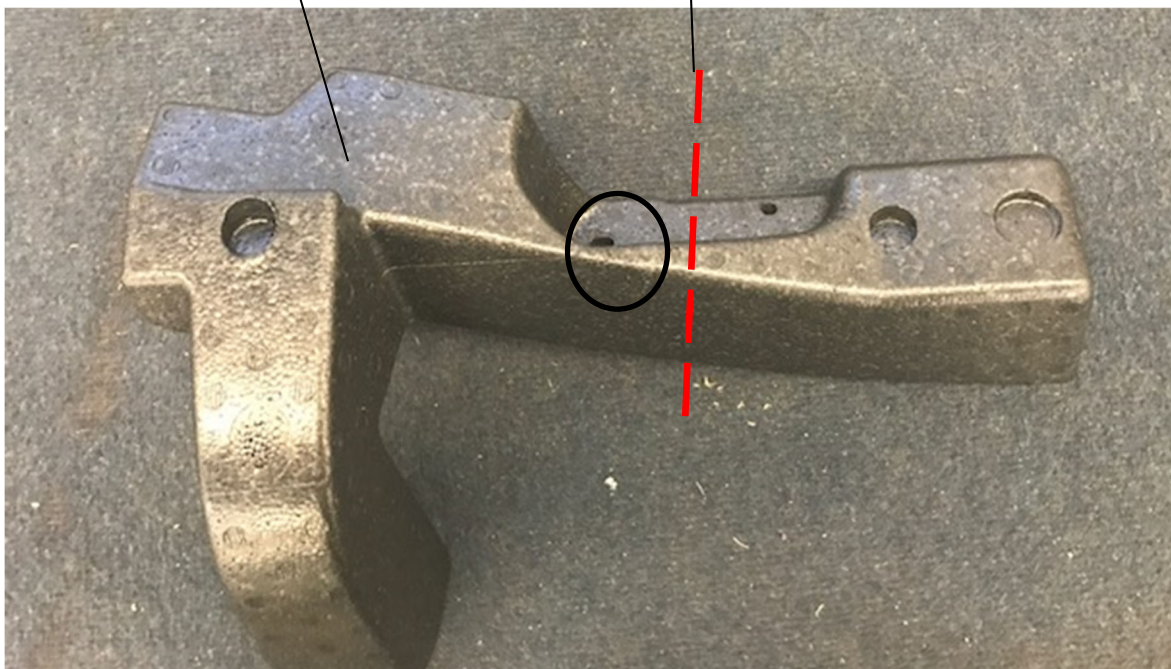

STEP 8 CONTINUED - FOR 2018-2021 VEHICLES ONLY! MODIFY HEADLINER FOAM



THE PUSHPIN IS USED IN
THE HOLE THAT WAS LEFT
AFTER CUTTING.

THIS IS THE FOAM REINSTALLED

THIS IS THE STREETSIDE WITH
THE CUT

THIS IS THE CURBSIDE WITH THE
CUT



STEP 8 CONTINUED - FOR 2018-2021 VEHICLES ONLY! MODIFY HEADLINER FOAM



HEADLINER AFTER REMOVAL
OF PASSENGER SIDE AND
HEADLINER FOAM INSERTS

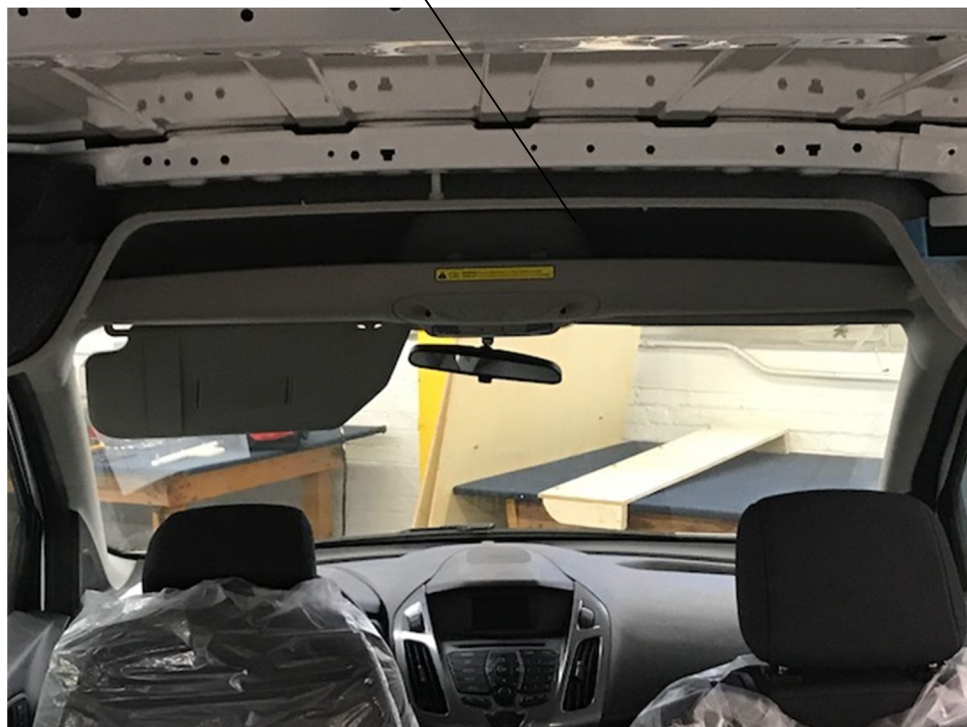

STEP 8 CONTINUED - FOR 2018-2021 VEHICLES ONLY! MODIFY HEADLINER FOAM



HEADLINER FOAM
INSERT AFTER
CUT

CUT HEADLINER FOAM INSERT
ALONG RED DOTTED LINE

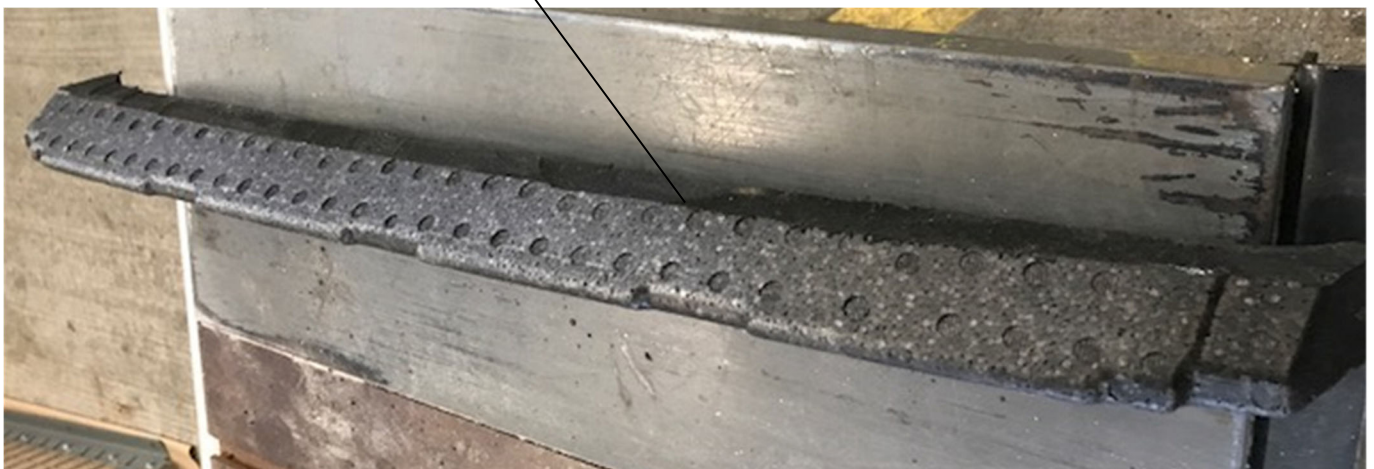

STEP 8 CONTINUED - FOR 2018-2021 VEHICLES ONLY! MODIFY HEADLINER FOAM



RE-INSTALL HEADLINER
AND PASSENGER SIDE
PUSH-PINS

RE-INSTALL FOAM INSERTS

**AFTER RE-INSTALLING THE HEADLINER PINS, CONTINUE TO STEP 10 FOR PARTITION
INSTALLATION**

STEP 9 - FOR 2021-NEWER VEHICLES ONLY! MODIFY PLASTIC HEADLINER

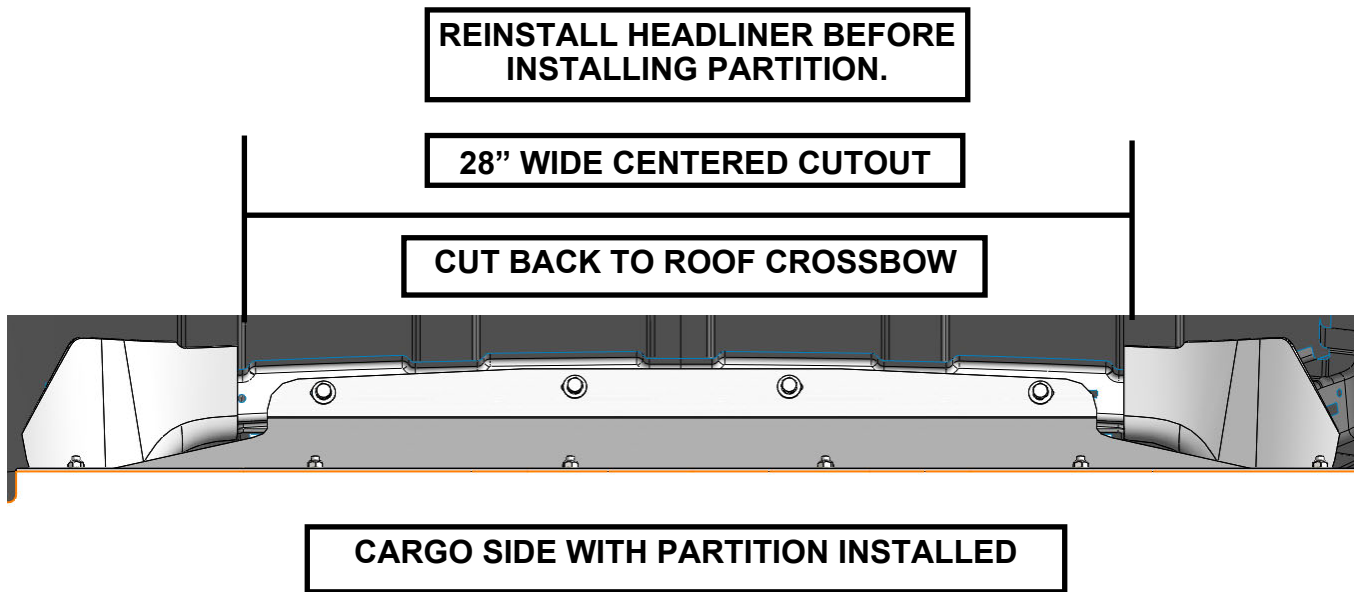
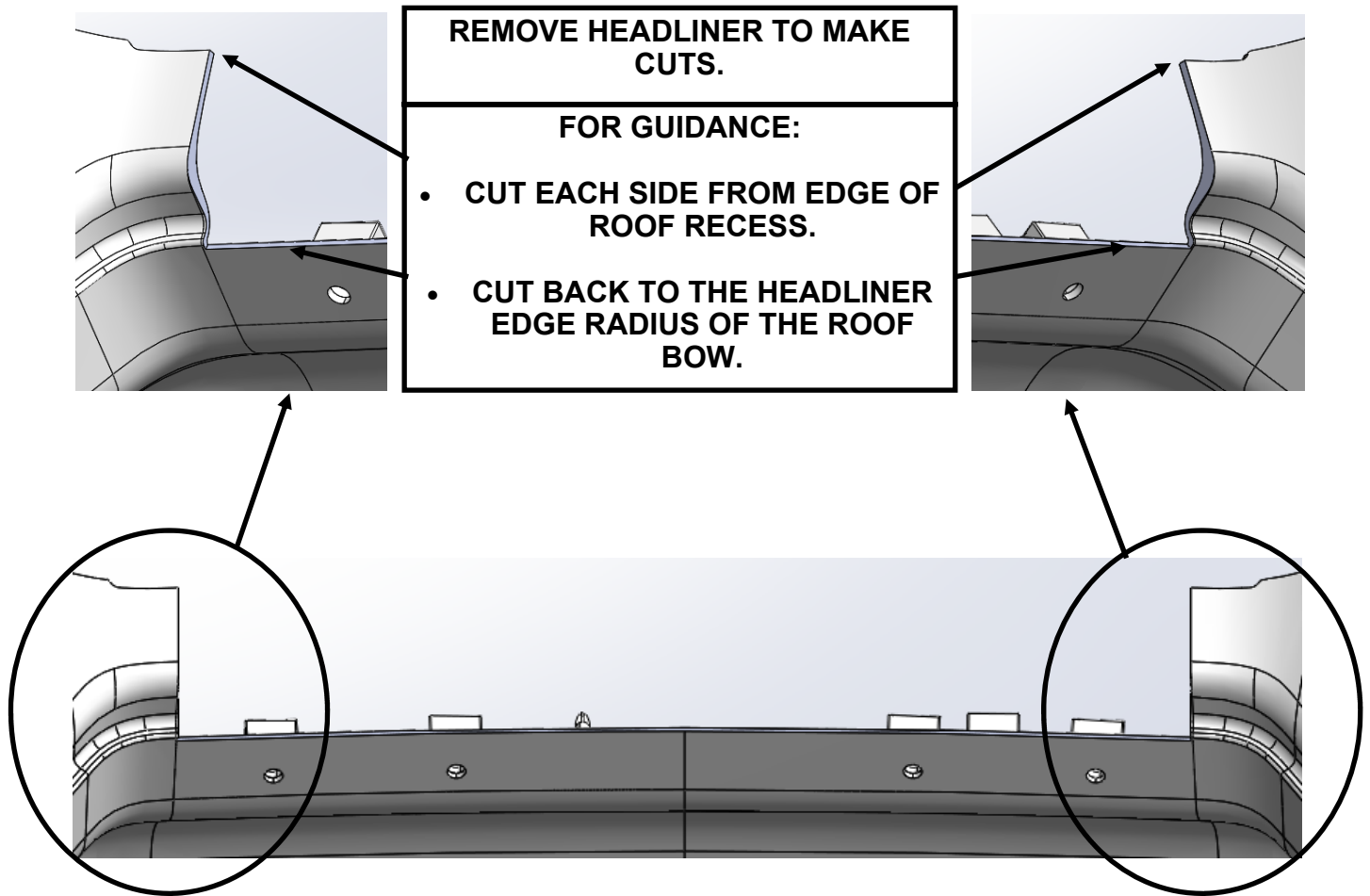

STEP 10 - CAREFULLY PLACE IN VEHICLE AND TRANSFER HOLES

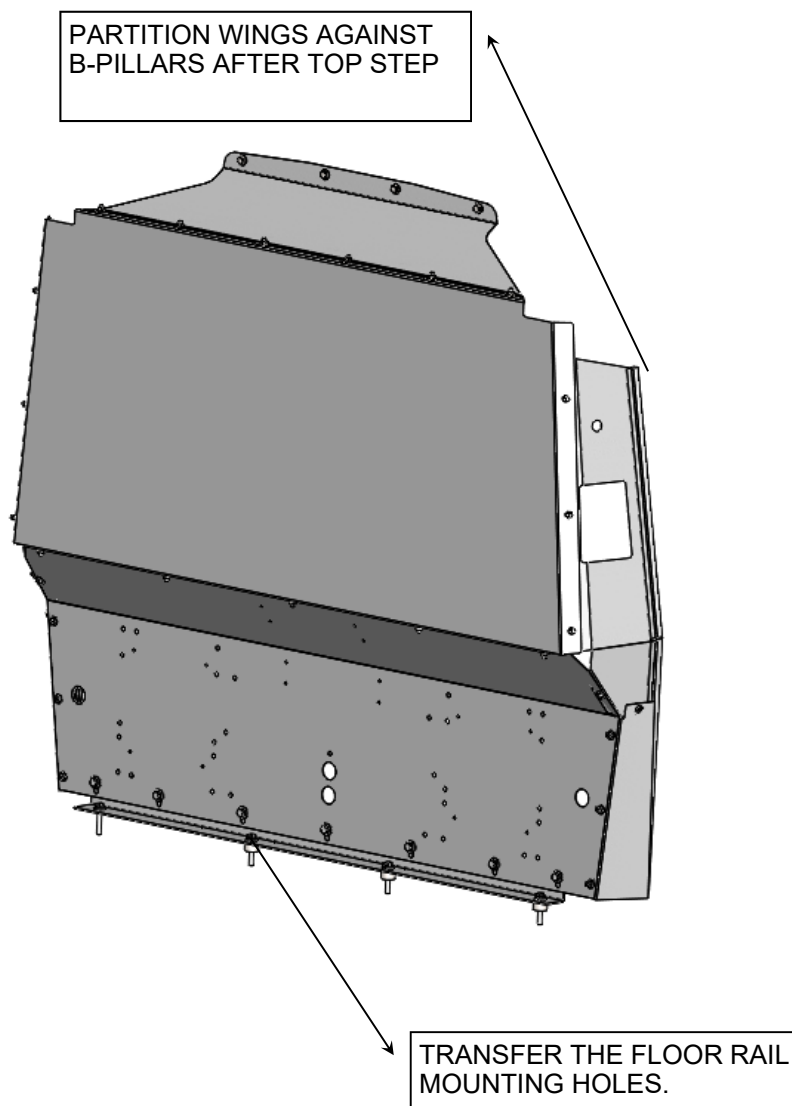
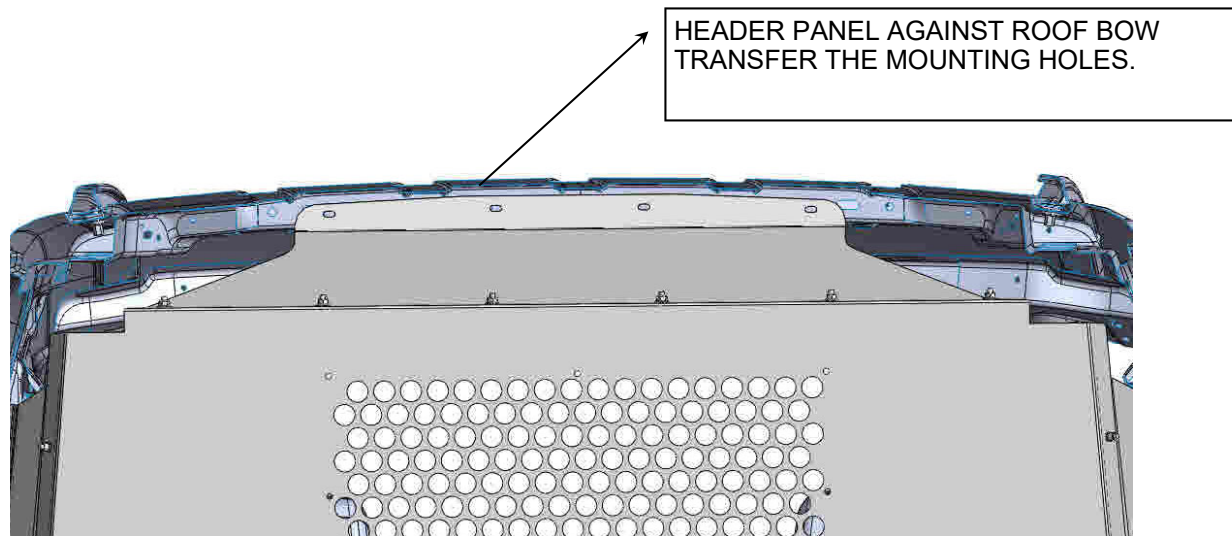

STEP 11 - SET PLUSNUTS AND SECURELY PARTITION IN PLACE

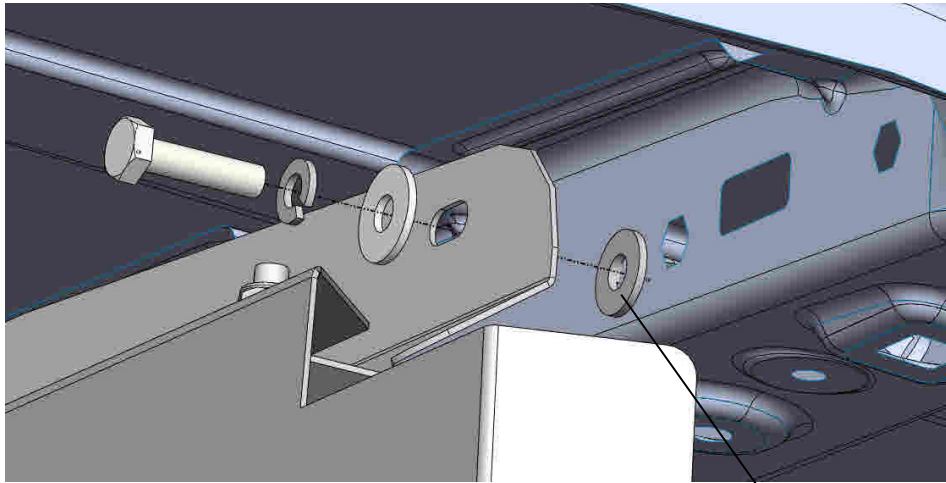

FAS0091—5/16 PLUSNUT (4)
FAS0086—FW (4)
FAS0098—LW (4)
FAS0602—5/16 HH X 2" LG (4)

FAS0052—1/4-20 PLUSNUT (4)
FAS0067—FW (4)
FAS0060—LW (4)
FAS0078—1/4-20 HH X 1" LG (4)

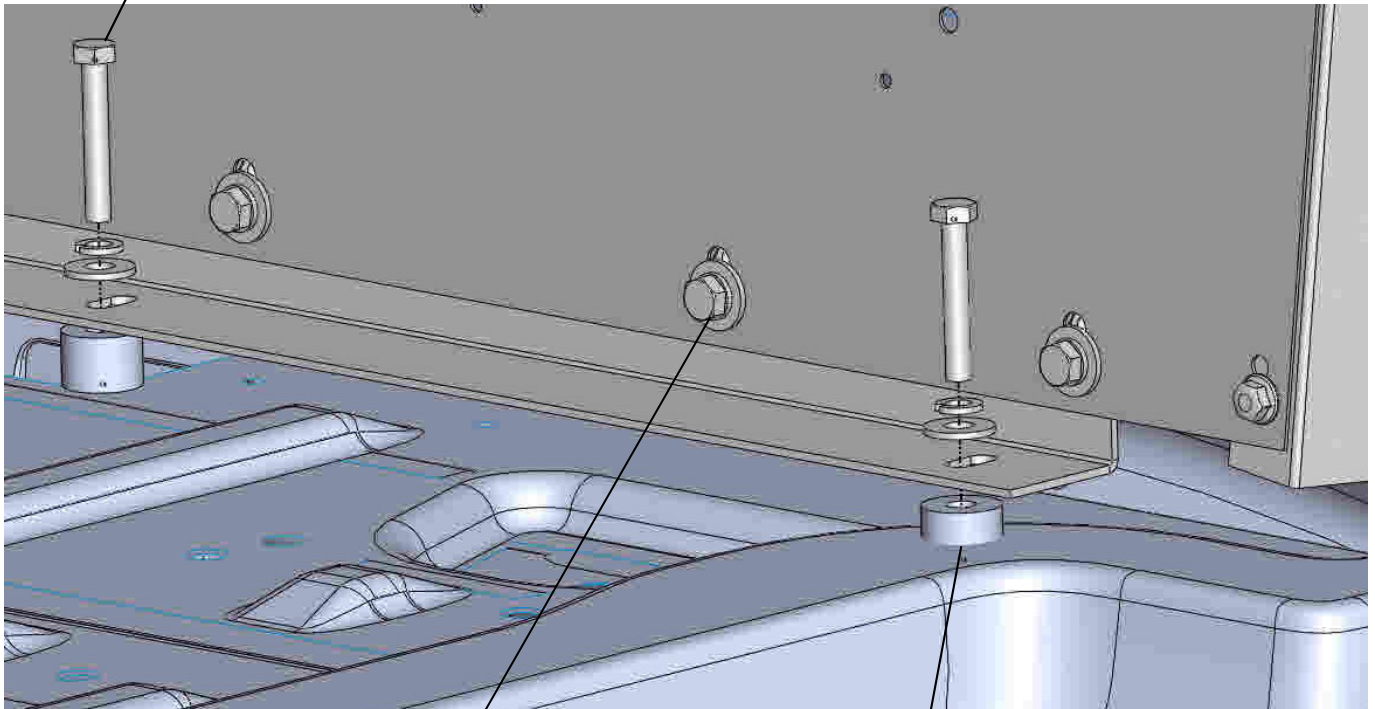

FROM STEP 6
**FULLY TIGHTEN AT
THIS STEP
(7) PLACES**

WILL GO THRU
STEPWELL TRIM

STEP 12 - FULLY TIGHTEN THE PARTITION WING FASTENERS

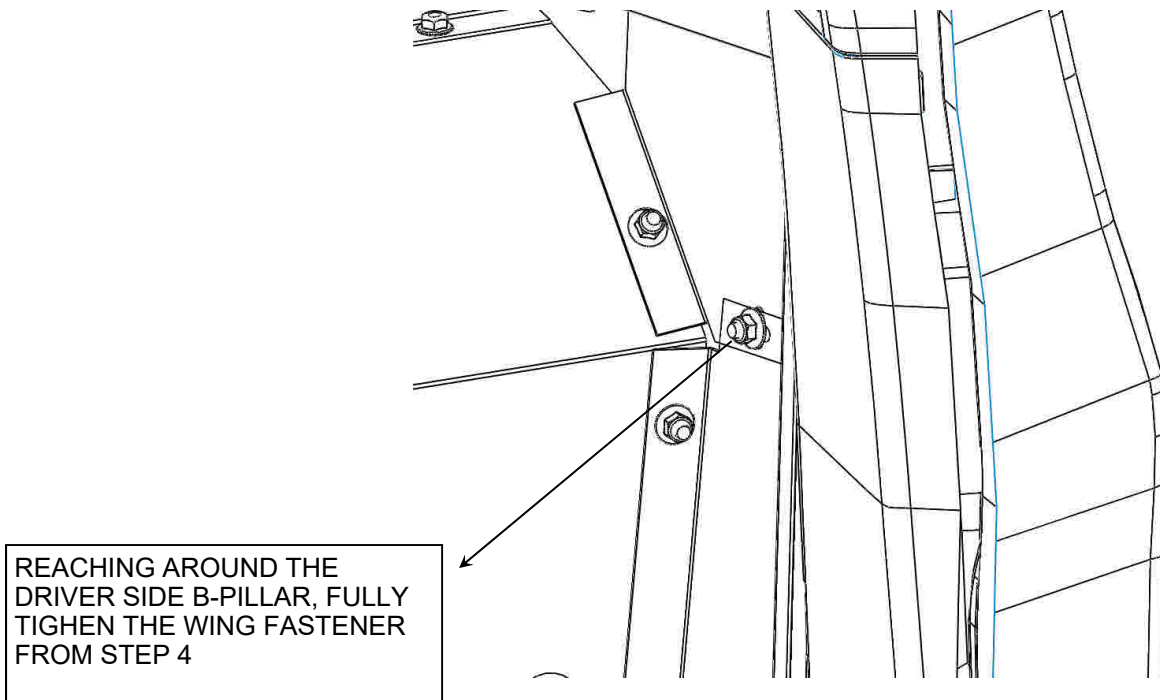
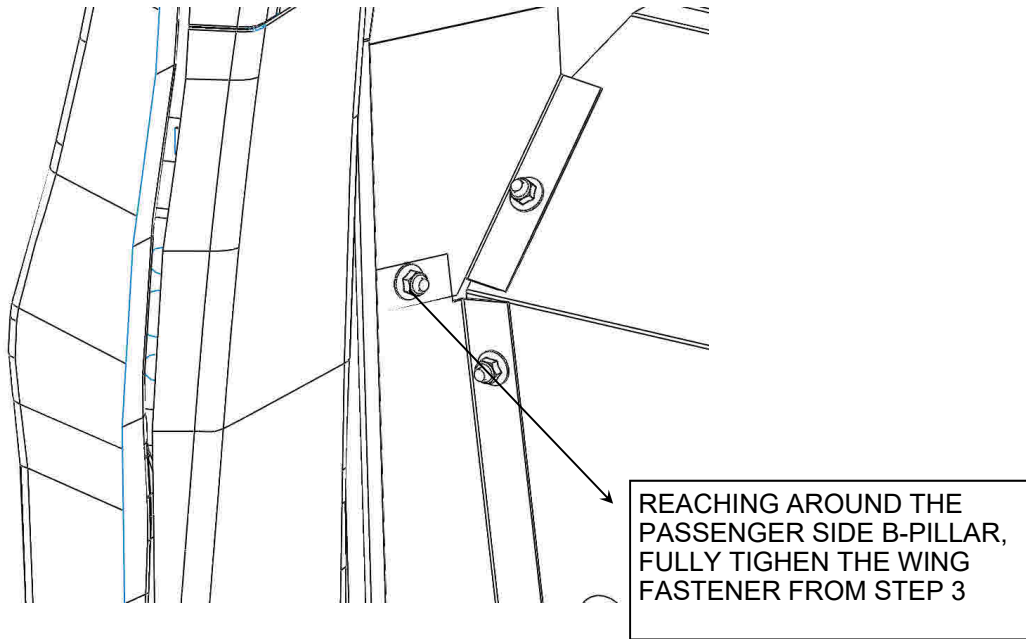

YOUR INSTALLATION IS NOW COMPLETE

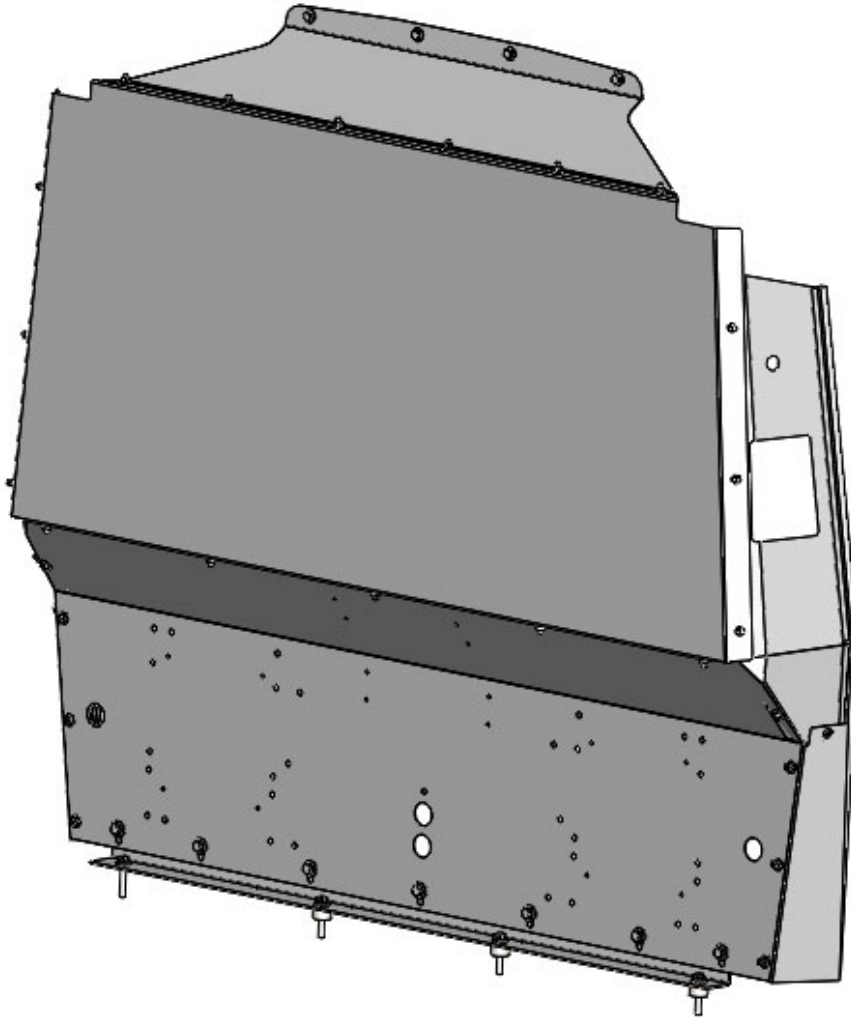

**DOUBLE CHECK ALL FASTENERS LOCATIONS TO BE SURE THAT ALL
FASTENERS ARE TIGHTENED TO SPECIFICATIONS.
YOUR INSTALLATION IS NOW COMPLETE!
STOW THIS COPY IN THE VEHICLE FOR FUTURE REFERENCES!**