



ADRIAN STEEL®

Cargo Management Solutions for Commercial Vehicles

MAVERICK LOAD RUNNER

PRODUCT WEIGHT

62.24 LBS

WIDTH X DEPTH X HEIGHT

48.79" X 93.63" X 22.75"

CAPACITY

SEE BELOW

COLOR

BLACK

CATALOG NUMBER

MSLR2-MAV

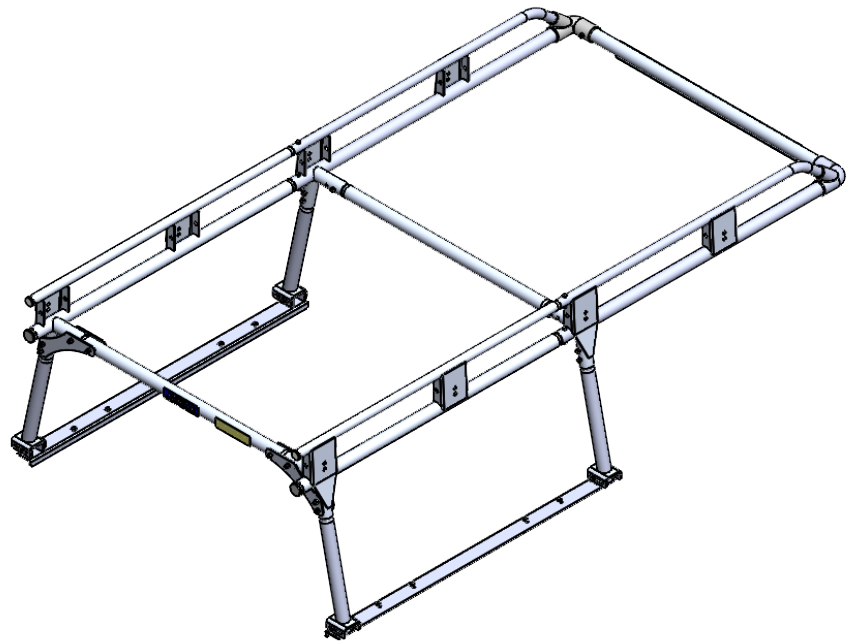

PRODUCT FEATURES

This Loadrunner is designed to fit on the 2022 to current Ford Maverick 4.5' bed platforms. It features 2" aluminum tubing. The capacity of the rack exceeds the truck bed wall load rating. Consult your vehicle manufacturer for their recommended rating. Be advised that placing loads above the vehicle bed increases the vehicle's tendency to overturn. Always load with caution.

SEE PAGE 2 FOR APPLICATION NOTES, ACCESSORIES AND OTHER PRODUCTS THAT WORK WITH THIS UNIT.

Introduction / Comments:

This load runner is manufactured for install fitment on Ford Maverick

***Small antenna located in hardware kit, OEM antenna needs removed and replaced by the small antenna for this install.**

Note:

It is advised that all fasteners used in this assembly and installation should be checked for tightness at the following intervals: @ 2-weeks and again @ 6-weeks of operation. This preventive maintenance step must be completed to en-sure your Product gives you long service life.

ITEM NO.	PART NUMBER	DESCRIPTION	QTY.
1	63286	MSLR2, REAR GUSSET	4
2	HDW69573	HDW KIT FOR MSLR2	1
3	69574-B	MAVERICK LOAD RUNNER TRUSS WLDMNT, BLK	1
4	69575-B	MAVERICK LOAD RUNNER TRUSS WLDMNT, BLK	1
5	69196-B	MAVERICK LR, FRONT CONNECTOR TRUSS, BLK	1
6	69191-B	MAVERICK LR CENTER CONNECTOR TRUSS, BLK	1
7	69201-B	LEG WLDMNT, MAVERICK LOAD RUNNER, BLK	4
8	63278-B	MSLR2, WIND DEFLECTOR	1
9	69577-B	MAVERICK LOAD RUNNER, REAR TRUSS WLDMNT, BLK	1
10	69578-B	MAVERICK LOAD RUNNER REAR TRUSS WLDMNT, BLK	1
11	69202-B	MAVERICK, REAR CONNECTOR TRUSS, BLK	1
12	69513-B	LOAD RUNNER FOOT WELDMENT, BLK	2
13	25689-0	DCL " LOAD RUNNER" PLR	1
14	25637-0	DECAL, KKDLR, "WARNING STATEMENT"	1

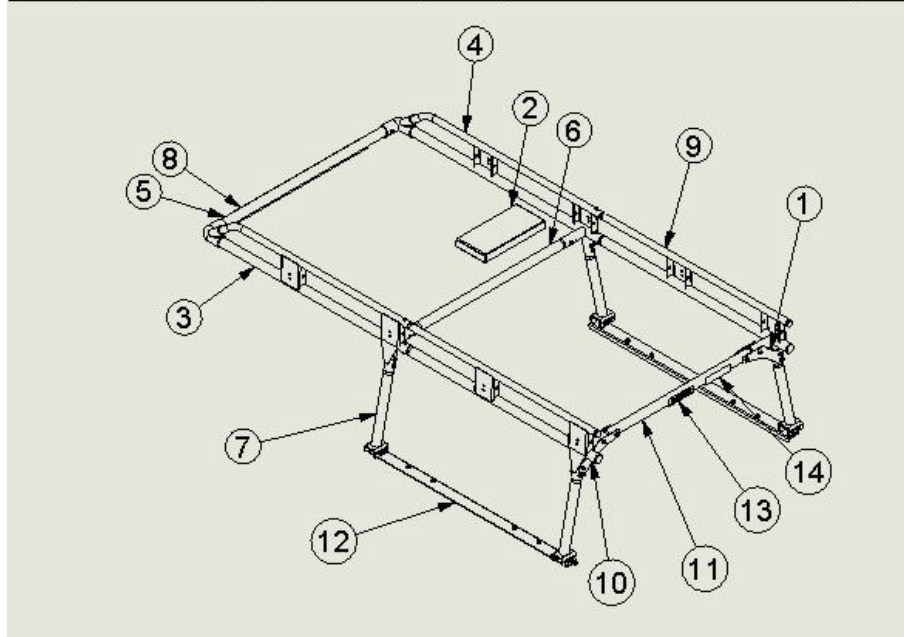

MSLR2-MAV

- PRECAUTIONS -



CAUTION
THE USE OF AIR IMPACT TOOLS CAN OVER-TORQUE FASTENERS AND CAUSE FASTENER FAILURE!

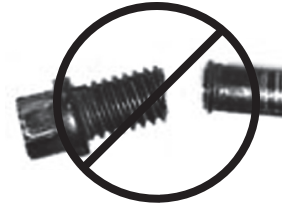

CAUTION
ALL INSTALLATION HOLES SHOULD BE SEALED WITH SILICON OR BUTYL SEALANT TO PREVENT EXHAUST FUMES FROM ENTERING THE VEHICLE!



DANGER
INSPECT FOR FUEL TANK, FUEL LINES, BRAKE LINES, HIGH VOLTAGE BATTERIES AND ELECTRICAL LINES PRIOR TO DRILLING TO AVOID DAMAGING CRITICAL VEHICLE SYSTEMS OR INJURY TO INSTALLER DURING INSTALLATION PROCESS!

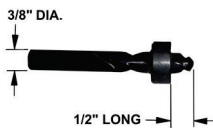

CAUTION
TO AVOID DAMAGING THE VEHICLE ALWAYS USE DRILL STOPS WHEN DRILLING ANY INSTALLATION HOLES!
ADRIAN AVAILABLE PART #'S 31119-0 (3/8" X 1/2" DEEP), 31121-0 (1/2" x 1/2" DEEP)

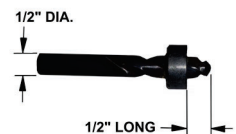

- IMPORTANT WARRANTY REQUIREMENTS -

1. SUBSTITUTING ADRIAN STEEL SPECIFIED FASTENERS FOR ASSEMBLY AND/OR INSTALLATION WILL VOID YOUR PRODUCT WARRANTY.
2. ALL HOLES DRILLED INTO VEHICLE SHOULD HAVE THE RAW METAL EDGES SEALED WITH A SELF-ETCHING PRIMER TO RESIST CORROSION AND POTENTIAL FASTENER POINT FAILURE.
3. ALL FASTENERS USED IN THE INSTALLATION OF THIS PRODUCT SHOULD BE TIGHTENED TO THE TORQUE(S) SPECIFIED IN THESE INSTRUCTIONS.
4. THESE INSTRUCTIONS SHOULD BE KEPT WITH THE VEHICLE.

THE BASIC TOOLS NEEDED FOR MOST INSTALLATIONS



DRILL

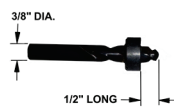

DRILL BIT WITH STOP



RATCHET, SOCKETS AND/OR WRENCHES



SCREWDRIVERS



MEASURING TAPE

ADDITIONAL TOOLS MAY BE NEEDED FOR THIS INSTALLATION AND THEY WILL BE IDENTIFIED IN THE STEPS THAT FOLLOW.

**Installation and/or Assembly
Fasteners BAG69573**

ITEM NO.	PART NUMBER	DESCRIPTION	QTY.
1	BAG0709-A	7" x 9" 3MIL AUTOBAG	1
2	FAS0552	Washer, Flat, 5/16, SST	44
3	FAS0248	Nut, Nylon Insert Lock, 5/16-18 SST	24
4	FAS0427	SCREW,HH 5/16-18X2.75 SS	10
5	FAS0426	SCREW,HH 5/16-18X2.25 SS	8
6	FAS0436	SCREW,HH 5/16-18X1.75 SS	10
7	05586-0	Butyl Tape, T224 - 1/2" X 1' Roll	2
8	26618-0	Silicone Sealant	2
9	FAS0242	Screw, Hex Hd, 5/16-18x1.50 Stainless Steel	8
10	FAS0123	Washer, Lock, Ext. Tooth, 1/4, NI ZN	3
11	FAS0360	SCREW,ST,THP 14-10X.75 SS	3
12	FAS0433	Screw, Hex Hd, 5/16-18x3.50, SS Grade 5	4
13	FAS0091	Plusnut, 5/16	8
14	FAS0588	Washer, Lock, Split, 5/16, SS	8
15	FAS0831	1/2" SHORT SPACER	8

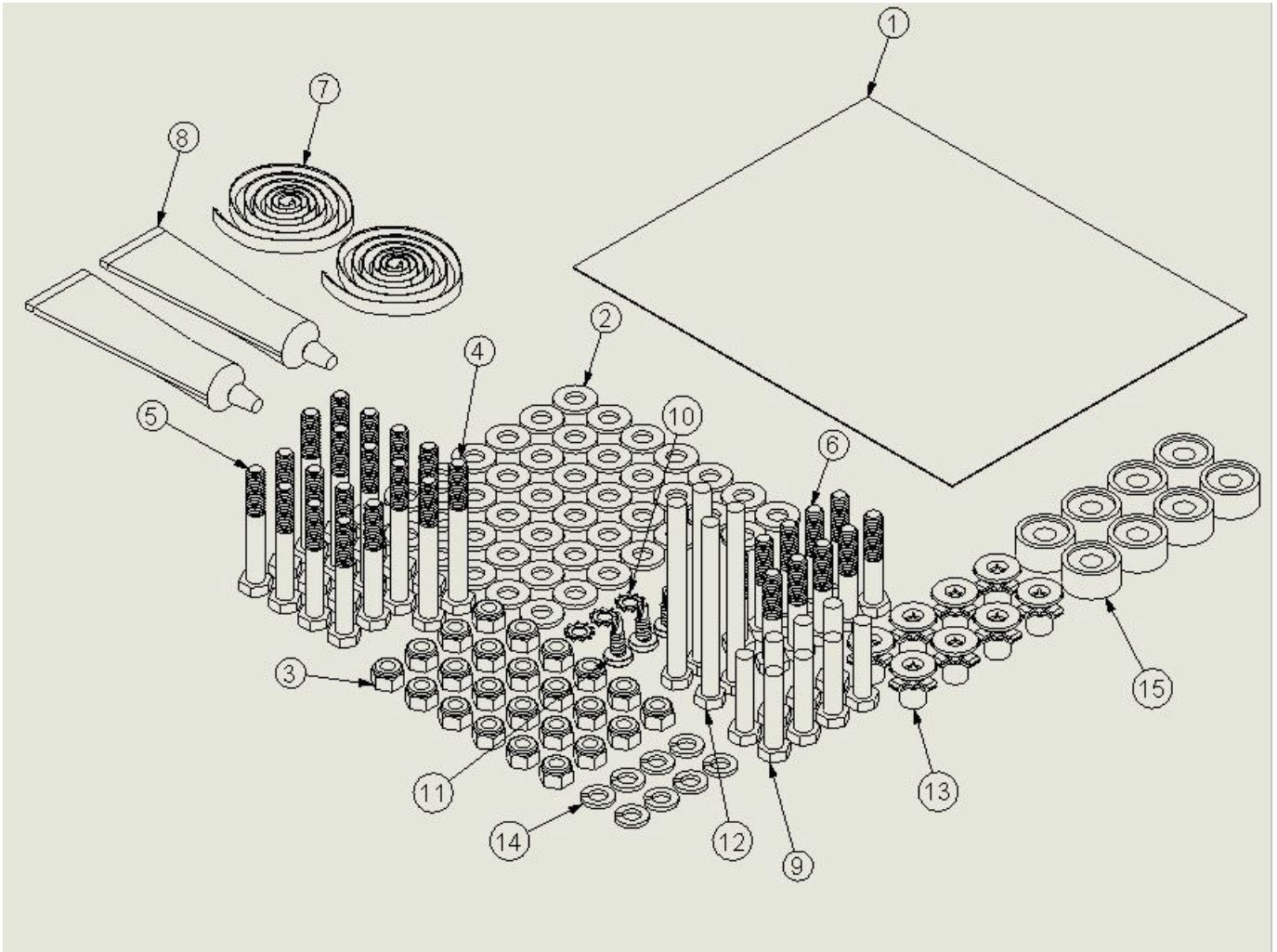

Step 01 Assembling the front half of the load runner.

NOTE: APPLY 05586-0 BUTYL TAPE AROUND BOTH ENDS OF EVERY FASTENER BEFORE TIGHTENING!

- A) Using the silicone sealant 26618-0, run a bead around each end of the tube before inserting.
- B) Push tubing onto the ends of casting, ensuring both of the holes line up while also pushing swedged tubing into cross member on other end.
- C) Insert each (2) FAS0427 bolt through each of the casting holes and (2)FAS0426 each of the swedged end holes.
- D) Place (1) FAS0552 washer on each (4) bolt and thread (1) FAS0248 lock nut on each (4) bolt and tighten using a 1/2" & 9/16" socket.

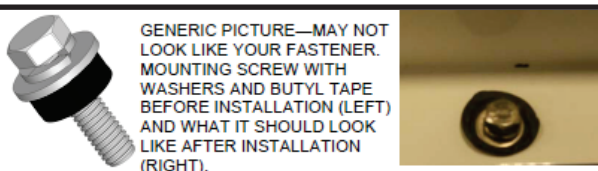
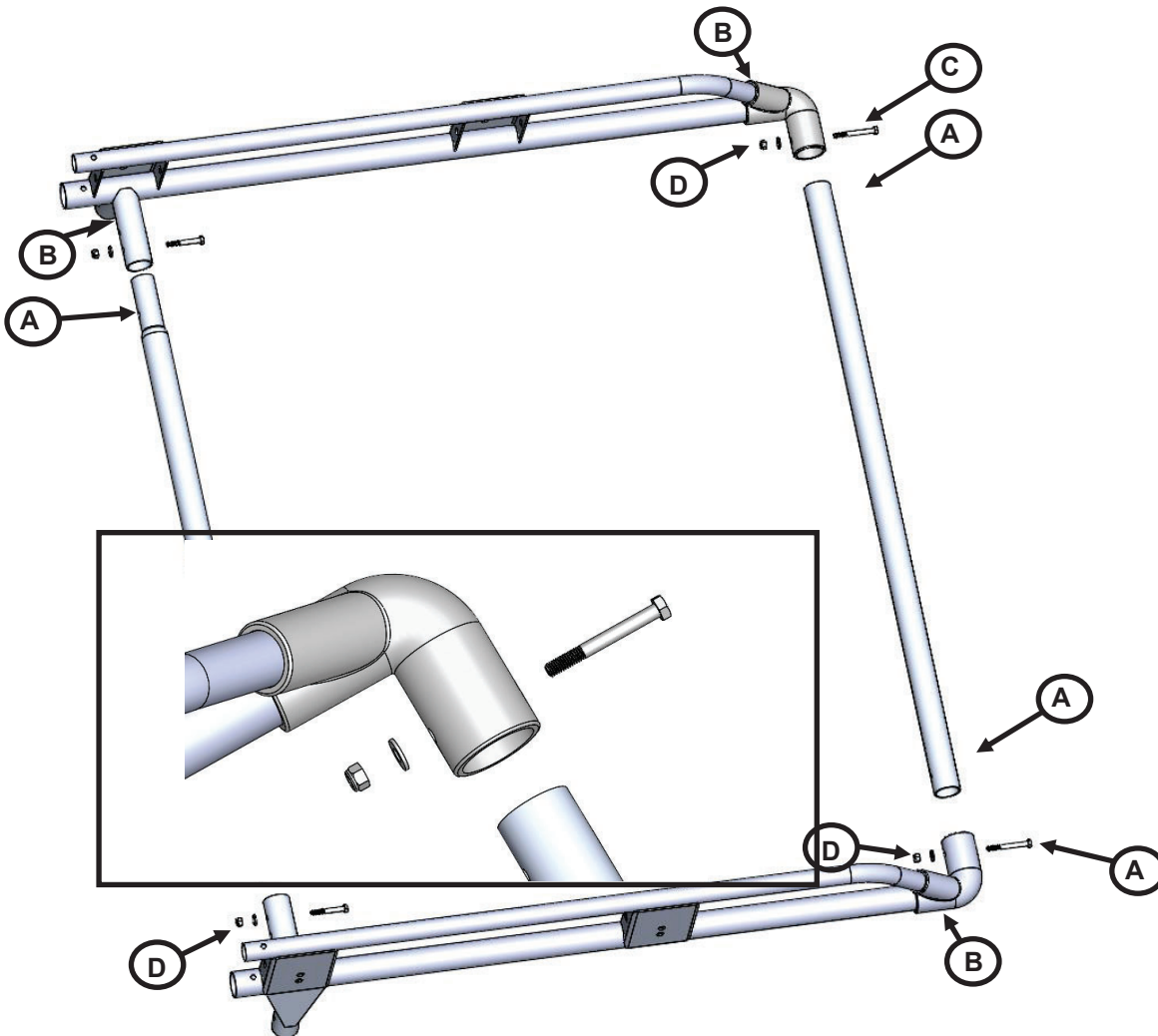

GENERIC PICTURE—MAY NOT LOOK LIKE YOUR FASTENER. MOUNTING SCREW WITH WASHERS AND BUTYL TAPE BEFORE INSTALLATION (LEFT) AND WHAT IT SHOULD LOOK LIKE AFTER INSTALLATION (RIGHT).

NOTE:
Components may be difficult to be joined together and can be tapped together with a rubber mallet to assist with assembly. For assistance with aligning holes, a 10" drift punch may be used.

Step 02 Assembling the rear half of the load runner.

NOTE: APPLY 05586-0 BUTYL TAPE AROUND BOTH ENDS OF EVERY FASTENER BEFORE TIGHTENING!

A) Using the silicone sealant 26618-0, run a bead around each end of both the tube and the tube before inserting.

B) Push tube into the ends of tube weldments ensuring all of the holes line up.

C) Place (1) FAS0552 washer on each (4) FAS0427 bolt.

D) Position (2) of 63286 on each side of rear of, lining up the (4) holes, and insert bolts through the top (2) holes per side.

E) Place (1) FAS0552 washer on each (4) bolt and thread (1) FAS0248 lock nut on each (4) bolt and tighten front (2) using a 1/2" & 9/16" socket, leaving rear (4) loose until step 4G.

F) Push (1) 37516-0 tube plug on rear of each (2) top small tube, and (1) 30892-0 tube plug on rear of each (2) bottom large tube.

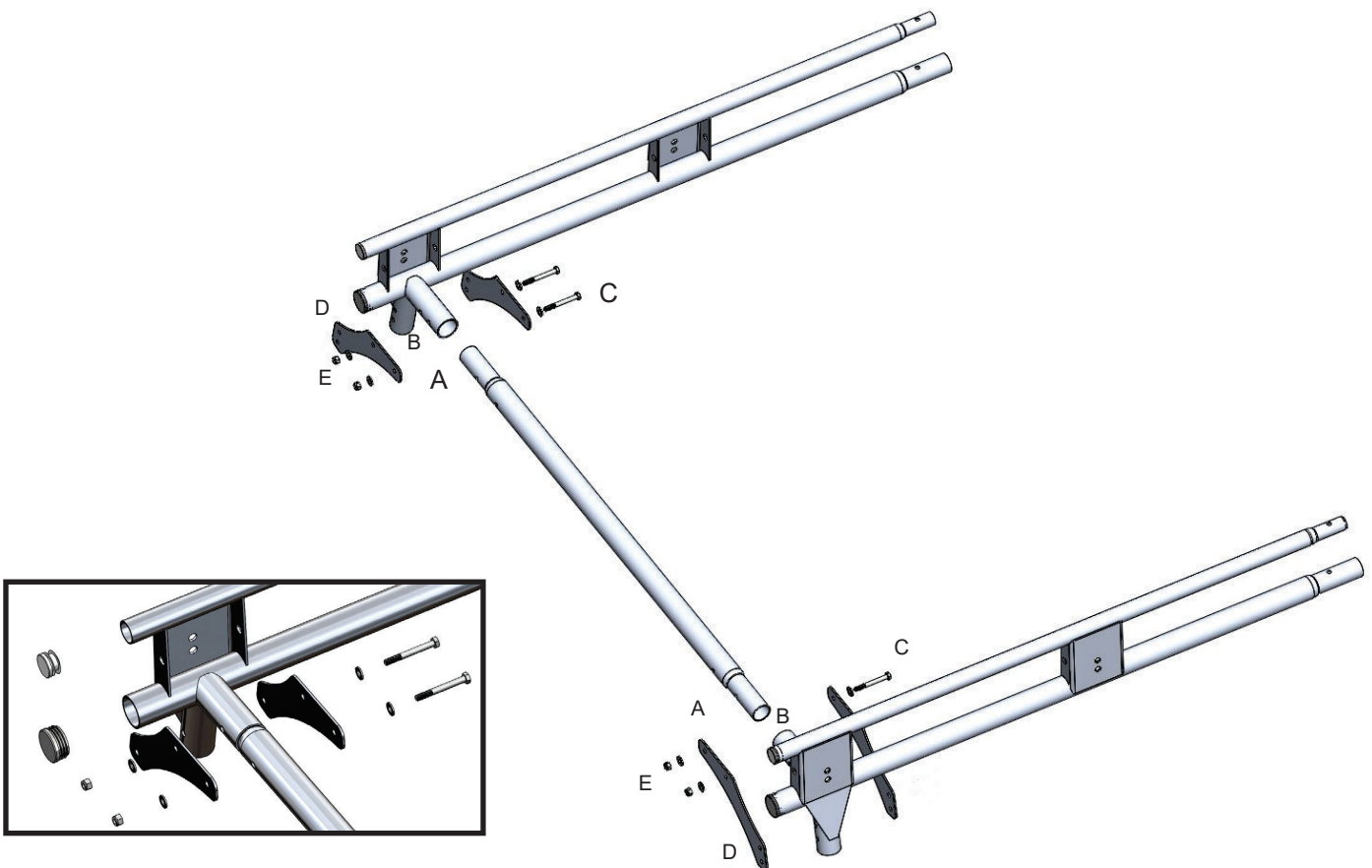

Step 03 Joining the front half and the rear half of the load runner together.

NOTE: APPLY 05586-0 BUTYL TAPE AROUND BOTH ENDS OF EVERY FASTENER BEFORE TIGHTENING!

- A) Using the silicone sealant 26618-0, run a bead around the end of both the top and bottom tube of before inserting into .
- B) Push the front half and rear half of the ladder rack together ensuring that the holes are lined up on both sides.
- C) Insert each (2) FAS0436 bolt through the holes.
- D) Insert each (2) FAS0426 bolt through the holes.
- E) Place (1) FAS0552 washer on each (4) bolt and thread (1) FAS0248 lock nut on each (4) bolt and tighten using a 1/2" & 9/16" socket.

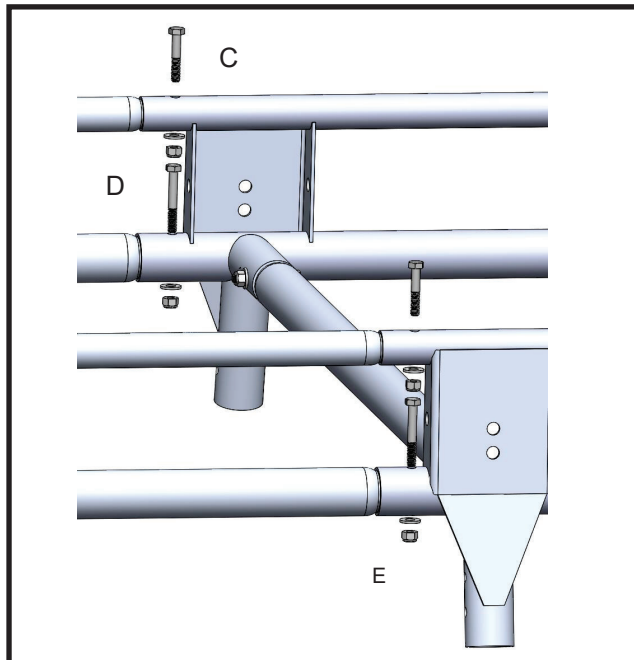
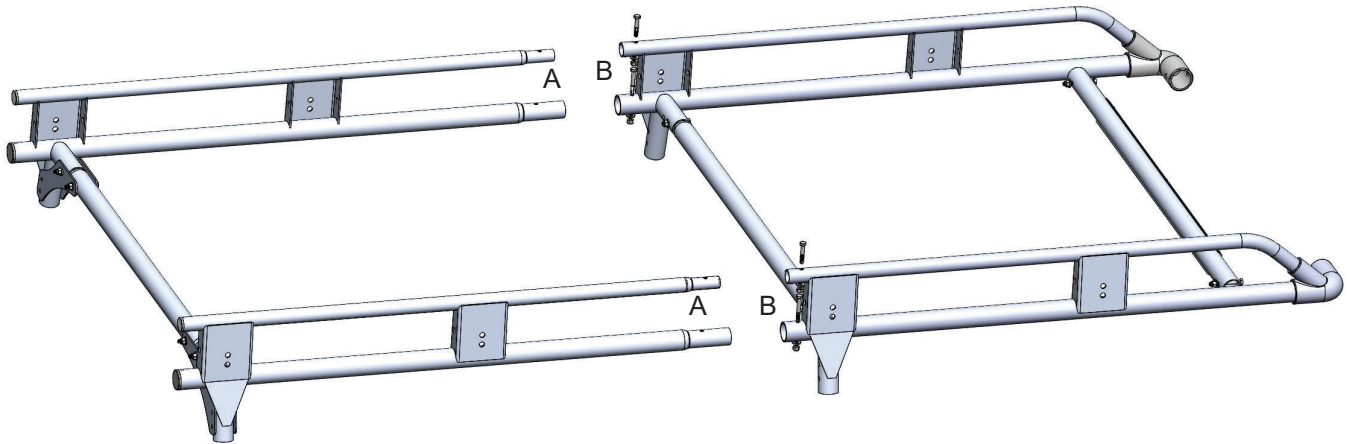

Step 04 Attaching the corner posts to the load runner.

NOTE: APPLY 05586-0 BUTYL TAPE AROUND BOTH ENDS OF EVERY FASTENER BEFORE TIGHTENING!

- A) Using the silicone sealant 26618-0, run a bead around the top of the front tubes and the rear tubes before inserting.
- B) Push into A into connecting tubes with them angling outwards to street side and curbside ensuring all of the holes line up.
- C) Insert each (2) FAS0426 bolt through the holes.
- D) Place (1) FAS0552 washer on each (2) FAS0427 bolt.
- E) Insert bolts through the bottom hole of each.
- F) Place (1) FAS0552 washer on each (8) bolt and thread (1) FAS0248 lock nut on each (4) bolt and tighten using a 1/2" & 9/16" socket. Also, tighten the other (8) fasteners on 63286.2F.

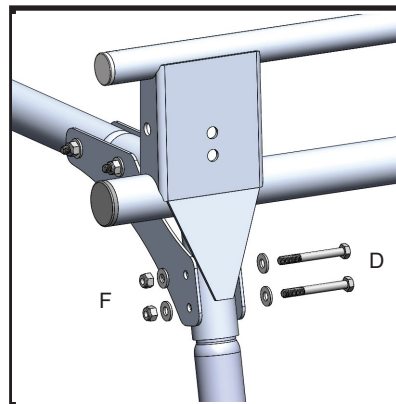
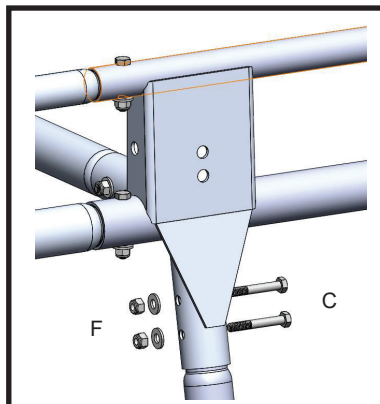
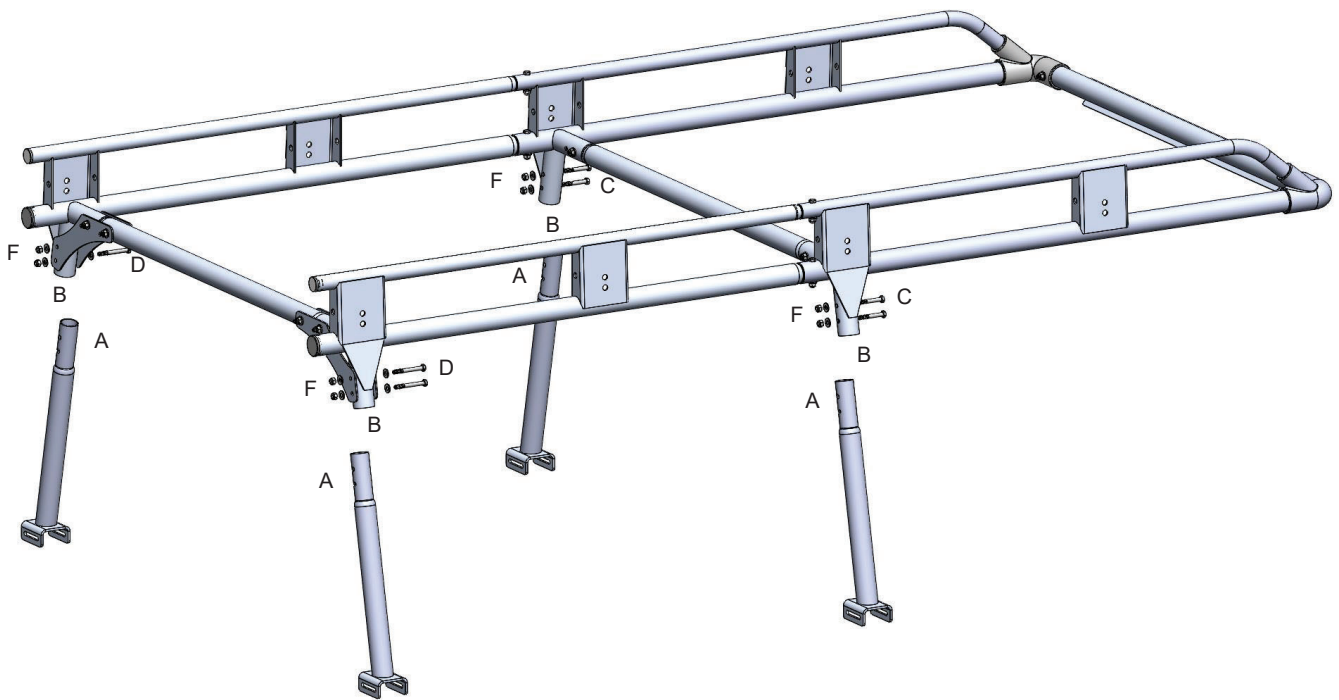

Step 05 Attaching the wind deflector.

NOTE: APPLY 05586-0 BUTYL TAPE AROUND BOTH ENDS OF EVERY FASTENER BEFORE TIGHTENING!

- A) Position 63278 against and centered. The center flat of 63278 should be perpendicular to the ground, with the longer flat towards ground.
- B) While holding in place, center punch the (3) hole locations on 63287, set aside, then pilot drill the (3) holes with a 3/16" diameter drill bit on 63287.
- C) Place (1) FAS0123 lock tooth washer on each (3) FAS0360 screw.
- D) Position 63278 against 63287 with holes lined up in orientation listed in 5A, and tighten each (3) screw using a Phillip's driver.

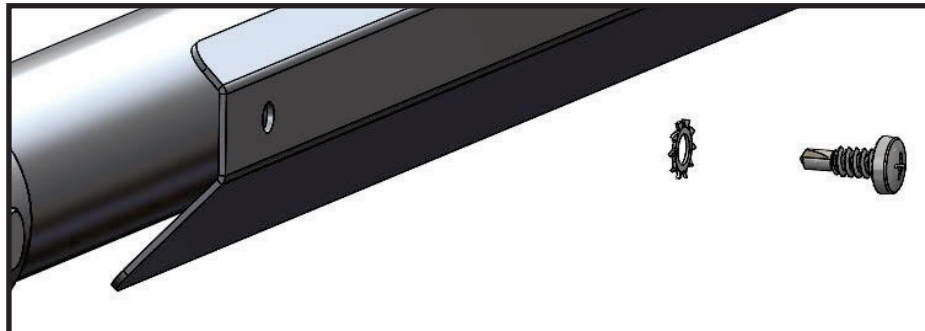
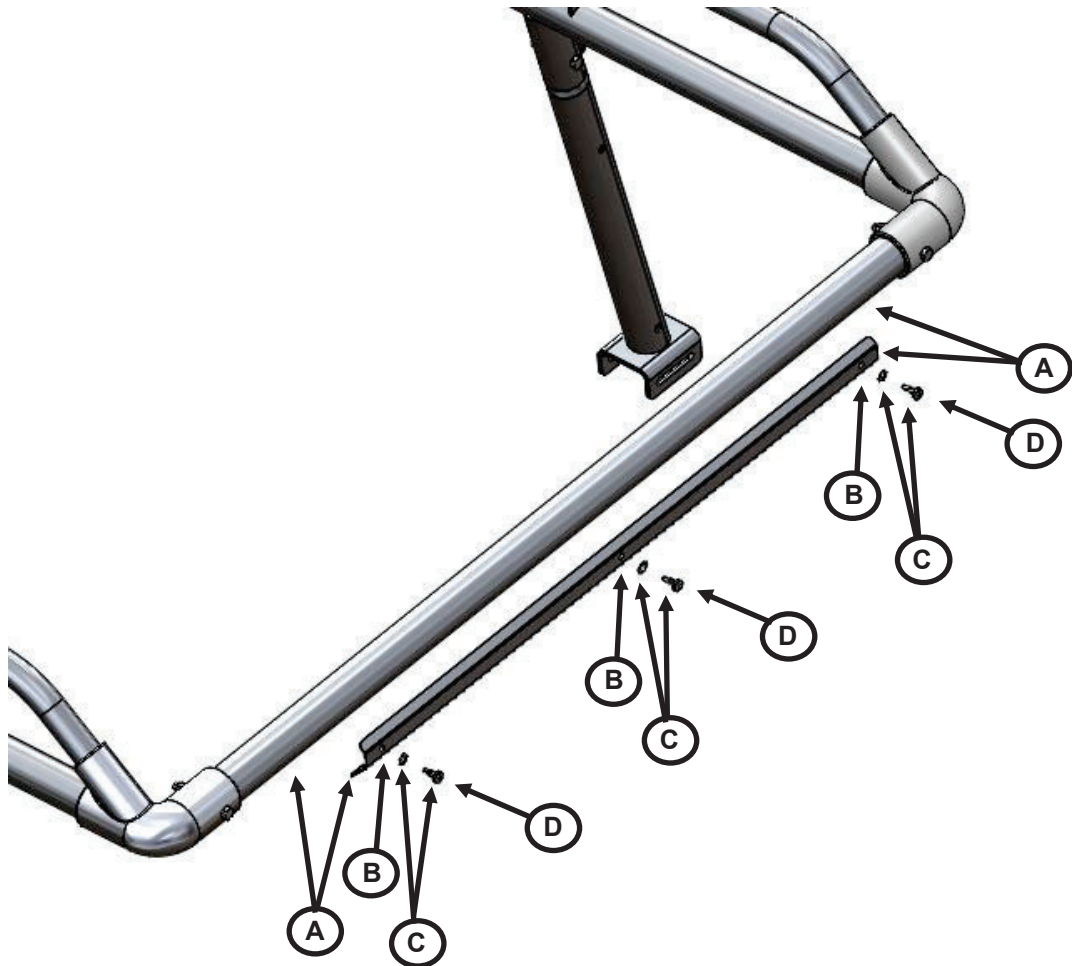

Step 06 Build complete, ensure all fasteners have been tightened before mounting.

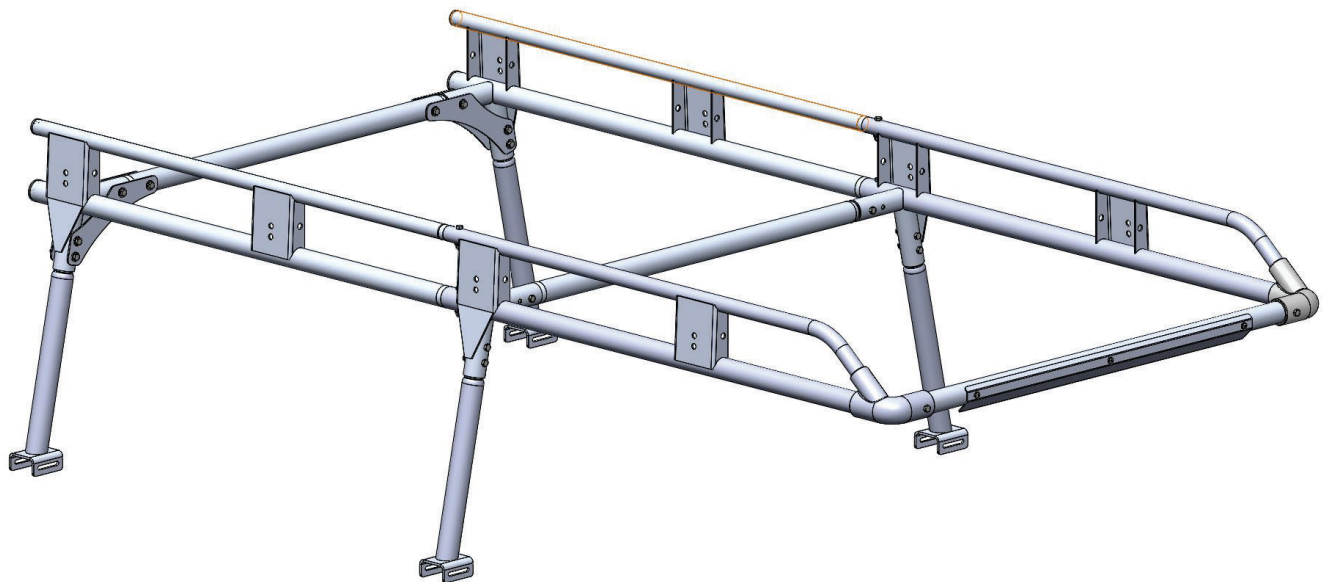

MOUNTING FOOT FASTENER LAYOUT

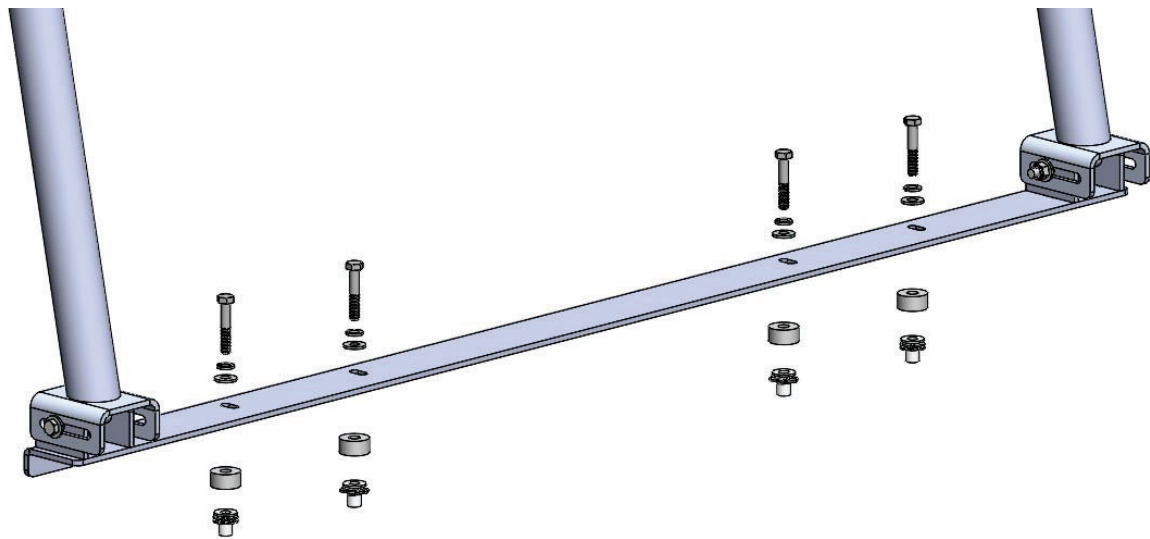

Step 08 Positioning each mounting foot on the bed rails of MAVERICK

A) Measuring from the inner face of the tailgate trim to the front end edge of 63279 on SS, position 1.21" away on SS bed rail and stick down.

B) Repeat these steps for the CS bed rail.

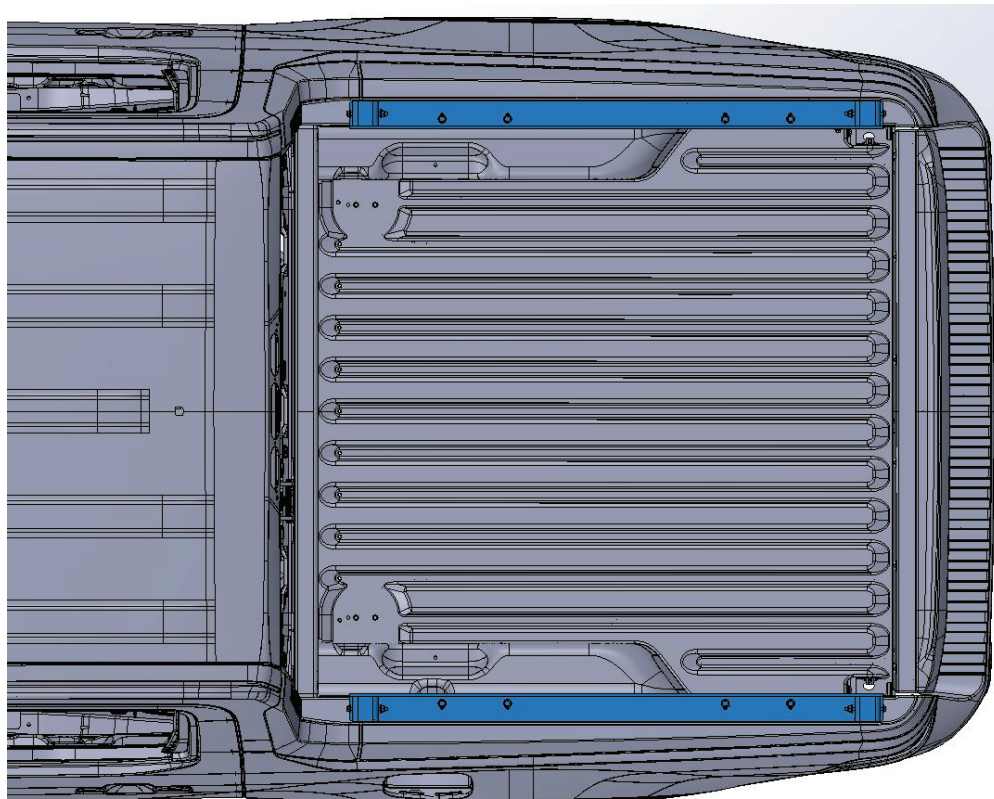
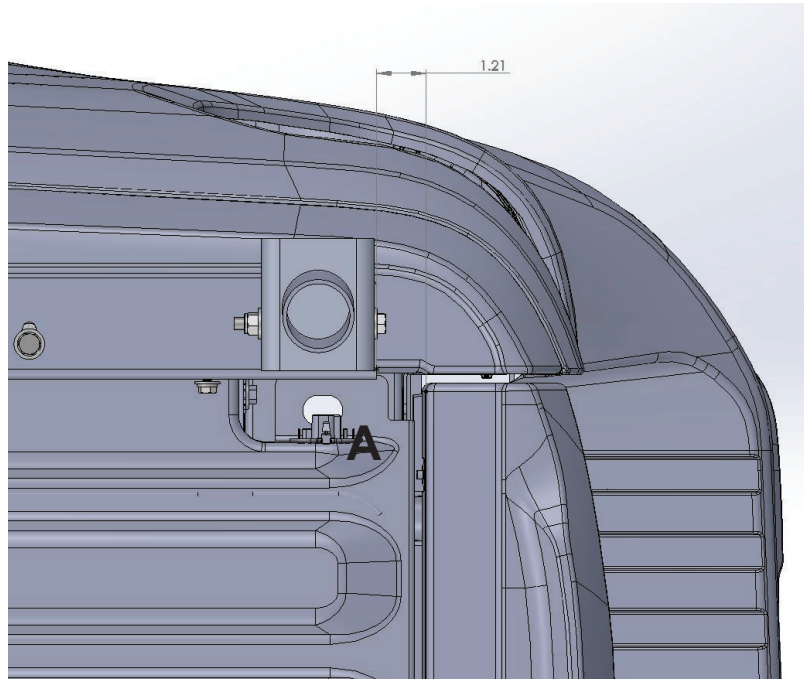

Step 09 Drilling the mounting holes through the bed rails of **MAVERICK**

A) Using a 1.00" diameter hole drill, drill a clearance hole in the bed rail trim centered in each of the slots on each mounting foot.

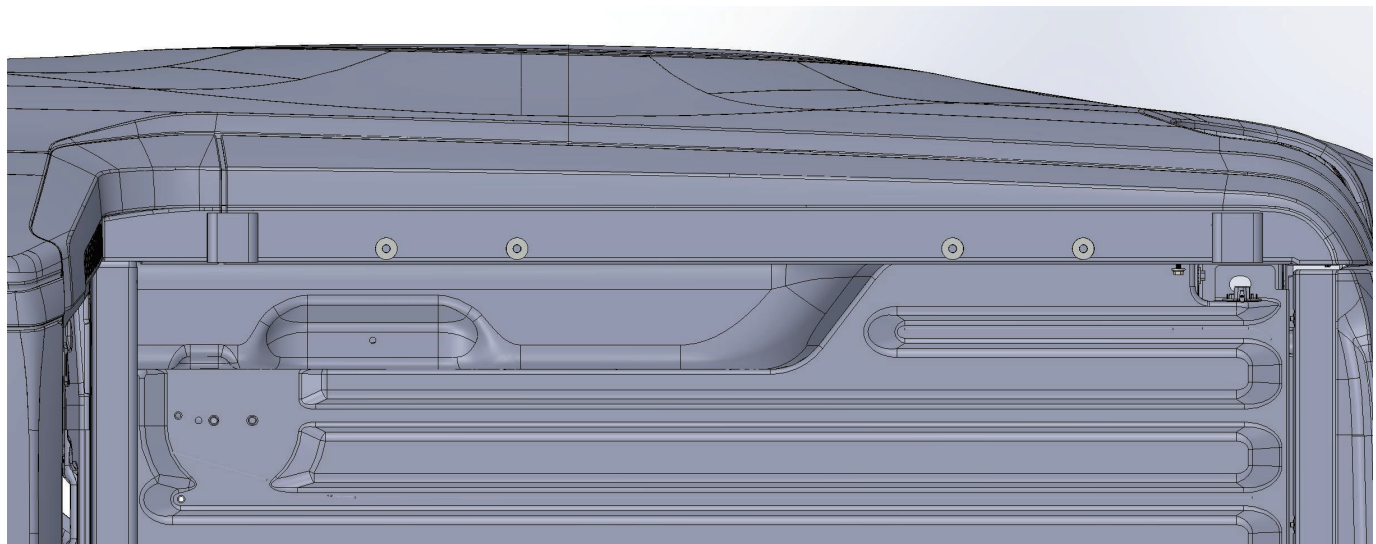
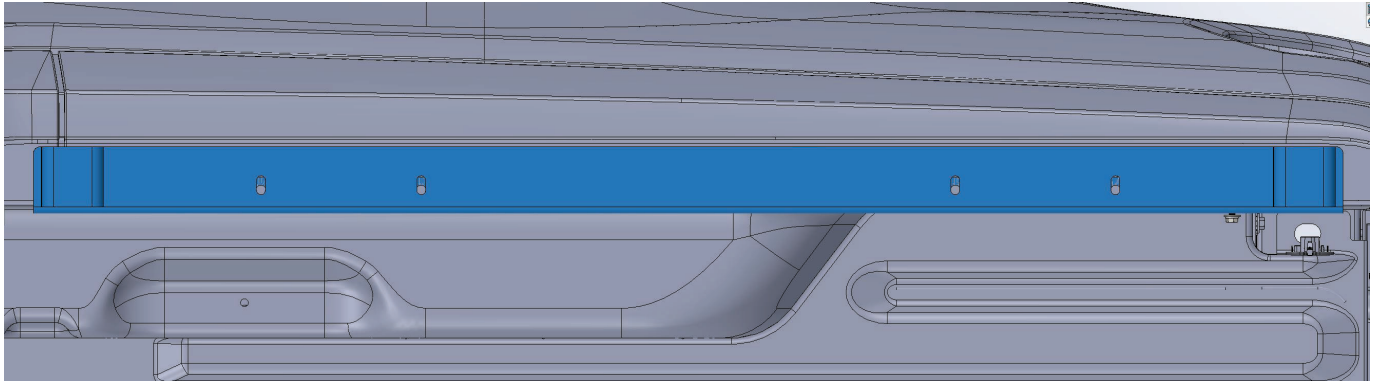

Step 10 Bolting the mounting feet to the bed rails of **MAVERICK**.

A) Drill holes to install FAS0091 centered in the newly drilled bed rail trim

B) Install (1) FAS0091 plus nut in each (8) bed rail holes. Place (1) FAS0831 spacer into each of the trim clearance holes on top of the installed plus nuts.

C) replace the rail mounts and fasten to the plus nuts using (1) FAS0436, (1) FAS0588, and (1) FAS0552 at each hole.

D) Attach main assembly to rail mounts using (1) FAS0433, (2) FAS0552, (1) FAS0248, and (1) 59269 spacer at all 4 places.

