

FASTENER GROUPS LISTED BELOW ARE USED FOR ASSEMBLY AND INSTALLATION. **SOME ASSEMBLY DRILLING IS REQUIRED.** PARTITION INSTRUCTIONS & FASTENERS ARE WITH THAT UNIT. USE 40 UNIT DRAWINGS TO IDENTIFY THEIR SEPARATE PARTS. CUSTOMER SPECIFIED SHELF DIMENSIONS ARE SHOWN HERE.

SYM.	FASTENERS	QTY	DRILL
<b>ASSEMBLY FASTENERS</b>			
●	{ 1/4-20 x 1/2" THP.SCW. (20) }	(20)	3/16
●	{ 1/4-20 HX. FLANGE NUT (20) }	(20)	
●	{ 1/4-20 x 1/2" THP.SCW. (28) }	(28)	9/32
●	{ 1/4-20 HX. FLANGE NUT (28) }	(28)	
●	{ 1/4-20 x 3/4" HX.HD.SCW. (4) }	(4)	9/32
●	{ 1/4-20 HX. FLANGE NUT (8) }	(8)	
<b>INSTALLATION FASTENERS</b>			
●	{ 1/4-20 PLUSNUT "PB" (4) }	(4)	
●	{ 1/4-20 x 1" HH.SCW.FT (4) }	(4)	3/8
●	{ 1/4 PLN WASH (4) }	(4)	
●	{ 1/4 SPLIT RING L'WASHER (4) }	(4)	
●	{ 5/16-18 PLUSNUT "PB" (3) }	(3)	1/2
●	{ 5/16-18 x 1-1/2" HH.SCW.FT (3) }	(3)	
●	{ 5/16 PLN WASH (3) }	(3)	
●	{ 5/16 SPLIT RING L'WASHER (3) }	(3)	
●	{ 5/16 PLN. WASHER (6) }	(6)	
●	{ 5/16-18 HX.STOP NUT (3) }	(3)	11/32
●	{ 5/16-18 x 1-1/2" HH.SCW.FT (3) }	(3)	
●	{ 1/2 PLN. WASHER (3) }	(3)	
●	22200 PLUSNUT TOOL N/C	(1)	

**ADRIAN STEEL CO.**  
908 JAMES STREET  
ADRIAN, MI 49221  
517/265-6194

**SPRINTER**  
**HD KD SHELF UNIT**  
14 x 56 x 52

DWG BY	ECN#	DATE	CHK'D. BY	PACKAGE#	SC
JLC	7293	7/07/04	PLD	MD 609	A
PACKAGE WEIGHT- 118.82 #					HORIZONTAL & VERTICAL
HCG=26.00 VCG=28.00					

ITEM	PART NO.	DESCRIPTION	QTY.
1	DK552	DOOR KIT #50/30-52	1
2	DVI4	DIVIDER/PNTD: #50K0	6
3	HD-52SWP	KD UNIT 14x56x52 HD	1

HEIGHT FROM FLOOR TO LOWEST SHELF WILL VARY DEPENDING ON THE HEIGHT OF YOUR VEHICLES WHEELHOUSE.  
PLEASE REFER TO THE INTERIOR INSTALLATION SHEET FOR CORRECT SHELF HEIGHT BEFORE ASSEMBLY.

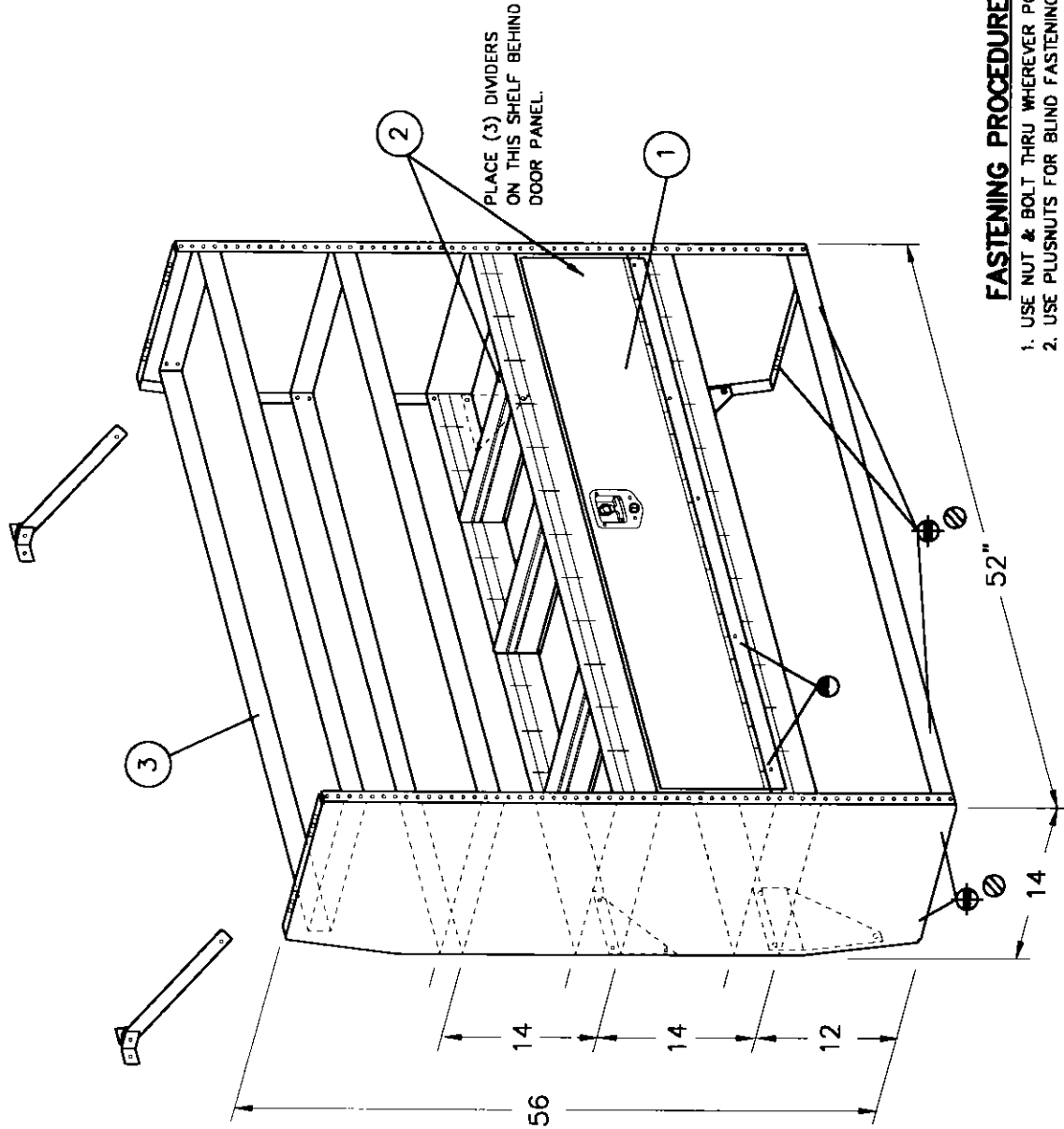

### FASTENING PROCEDURES

1. USE NUT & BOLT THRU WHEREVER POSSIBLE.
2. USE PLUSNUTS FOR BLIND FASTENING.
3. USE SHEET METAL SCREWS IN SHEAR ONLY.

**CAUTION:**  
DRILL THRU FLOOR WITH CARE  
WATCH FOR GAS TANK, CONTROL  
LINES, & ELECTRICAL WIRING.

FASTENER GROUPS LISTED BELOW ARE USED FOR ASSEMBLY AND INSTALLATION. **SOME ASSEMBLY DRILLING IS REQUIRED.** PARTITION INSTRUCTIONS & FASTENERS ARE WITH THAT UNIT. USE KD UNIT DRAWINGS TO IDENTIFY THEIR SEPARATE PARTS. CUSTOMER SPECIFIED SHELF DIMENSIONS ARE SHOWN HERE.

SYM.	FASTENERS	QTY	DRILL
●	ASSEMBLY FASTENERS		
	{ 1/4-20 x 1/2" THP.SCW.	{ (16)	{ 9/32
	{ 1/4-20 HX. FLANGE NUT	{ (16)	
●	{ 10-24 x 1/2 RHP.SCW.	{ (8)	{ 3/16
	{ 10-24 HX. FLANGE NUT	{ (8)	
ⓔ	{ 10-24 x 1/2 RHP.SCW.	{ (4)	{ 3/16
	{ 10-24 ELASTIC L'NUT	{ (4)	

**ADRIAN STEEL CO.**  
906 JAMES STREET  
ADRIAN, MI 49221  
517/265-6194

**DOOR KIT**  
for #50/30-52  
WITH BACK

DWG BY: BGS  
ECN#: 6071  
DATE: 6/6/02  
CHK BY: [Signature]  
PACKAGE WEIGHT: 17.94 #  
REF: 16594  
HCG: 00  
VCG: 00

ITEM	PART NO.	DESCRIPTION	QTY.
1	16362	DOOR ASM. 52" (49-5/8)	1
2	16366	DOOR STOP 51"	1
3	BP1252	BACK PANEL, 12 x 52	1
4	21000	LOCKING T HNDL W/KEY ASCO	1

BAG00032-0 FAS FOR MISC DR KITS  
CRT00003-0 CARTON

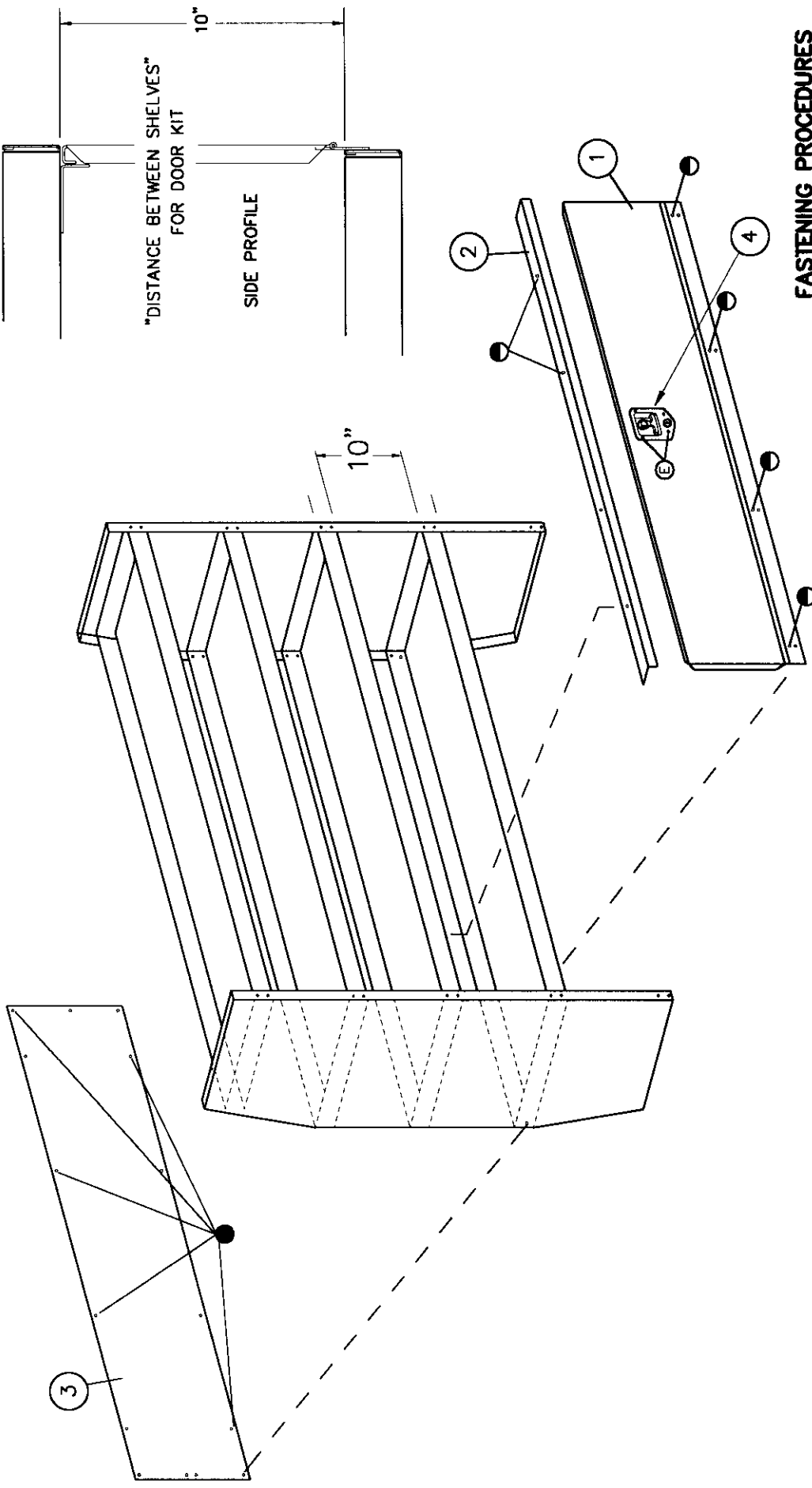

**CAUTION:**  
DRILL THRU FLOOR WITH CARE  
WATCH FOR GAS TANK, CONTROL  
LINES, & ELECTRICAL WIRING.

**FASTENING PROCEDURES**  
1. USE NUT & BOLT THRU WHEREVER POSSIBLE.  
2. USE PLUSNUTS FOR BLIND FASTENING.  
3. USE SHEET METAL SCREWS IN SHEAR ONLY.

## Introduction / Comments:

### DV12 / DV14 Slip-In / Bolt In Divider Install Instructions

#### **Note:**

It is advised that all fasteners used in this assembly and installation should be checked for tightness at the following intervals: @ 2-weeks and again @ 6-weeks of operation. This preventive maintenance step must be completed to ensure your Product gives you long service life.

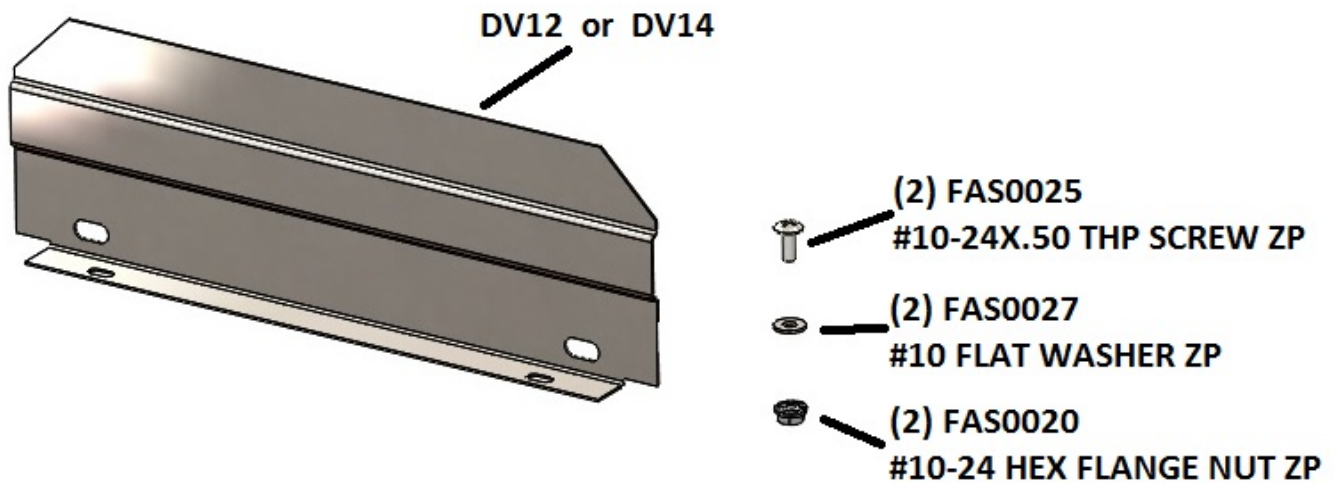

DV12 / DV14

## - PRECAUTIONS -



**CAUTION**



**THE USE OF AIR IMPACT TOOLS CAN  
OVER-TORQUE FASTENERS AND  
CAUSE FASTENER FAILURE!**



**CAUTION**



**ALL INSTALLATION HOLES SHOULD BE SEALED  
WITH SILICON OR BUTYL SEALANT TO PREVENT  
EXHAUST FUMES FROM ENTERING THE VEHICLE!**



**DANGER**



**INSPECT FOR FUEL TANK, FUEL LINES, BRAKE LINES, HIGH  
VOLTAGE BATTERIES AND ELECTRICAL LINES PRIOR TO  
DRILLING TO AVOID DAMAGING CRITICAL VEHICLE SYSTEMS  
OR INJURY TO INSTALLER DURING INSTALLATION PROCESS!**



**CAUTION**



**TO AVOID DAMAGING THE VEHICLE ALWAYS USE DRILL  
STOPS WHEN DRILLING ANY INSTALLATION HOLES!  
ADRIAN AVAILABLE PART #'S 31121-0 (3/8" X 1/2"  
DEEP), 31121-0 (1/2" x 1/2" DEEP)**



## - IMPORTANT WARRANTY REQUIREMENTS -

1. SUBSTITUTING ADRIAN STEEL SPECIFIED FASTENERS FOR ASSEMBLY AND/OR INSTALLATION WILL VOID YOUR PRODUCT WARRANTY.
2. ALL HOLES DRILLED INTO VEHICLE SHOULD HAVE THE RAW METAL EDGES SEALED WITH A SELF-ETCHING PRIMER TO RESIST CORROSION AND POTENTIAL FASTENER POINT FAILURE.
3. ALL FASTENERS USED IN THE INSTALLATION OF THIS PRODUCT SHOULD BE TIGHTENED TO THE TORQUE(S) SPECIFIED IN THESE INSTRUCTIONS.
4. THESE INSTRUCTIONS SHOULD BE KEPT WITH THE VEHICLE.

### THE BASIC TOOLS NEEDED FOR MOST INSTALLATIONS



DRILL



DRILL BIT WITH  
STOP



RATCHET, SOCKETS  
AND/OR WRENCHES



SCREWDRIVERS



MEASURING TAPE

ADDITIONAL TOOLS MAY BE NEEDED FOR THIS INSTALLATION AND THEY WILL BE IDENTIFIED IN THE STEPS THAT FOLLOW.

**Step 01** For Shelves with Embossed Sides, Slip Dividers into Shelf Embossments Evenly Spaced in Shelf as shown, unless otherwise specified by Customer. The Number of Dividers may vary per customer.

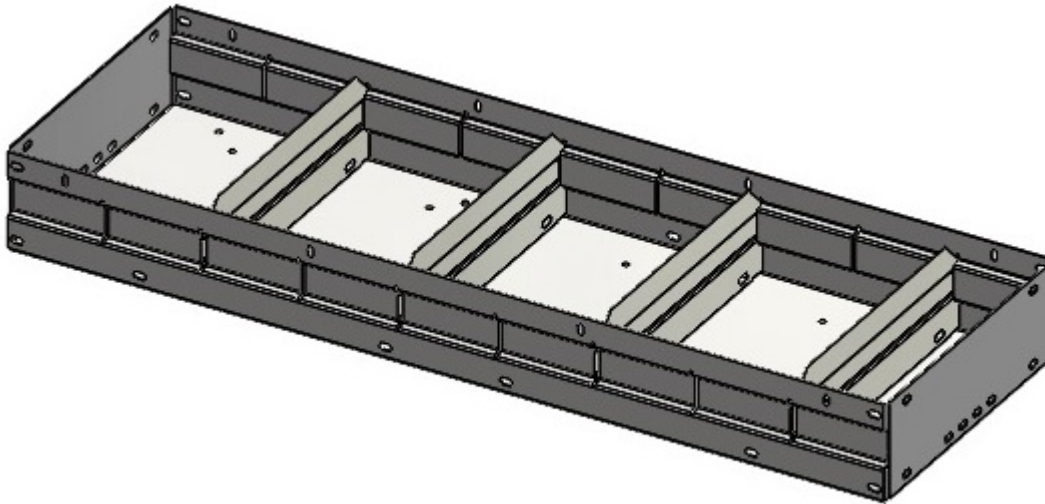

**Step 02** For Shelves where the Dividers will need to be Bolted in, Use (2) #10-24x.50 THP Screw, Flat Washer, and Hex Flange Nut to bolt each divider to shelf  
Evenly Spaced as shown unless otherwise specified by customer.  
The number of dividers may vary per customer

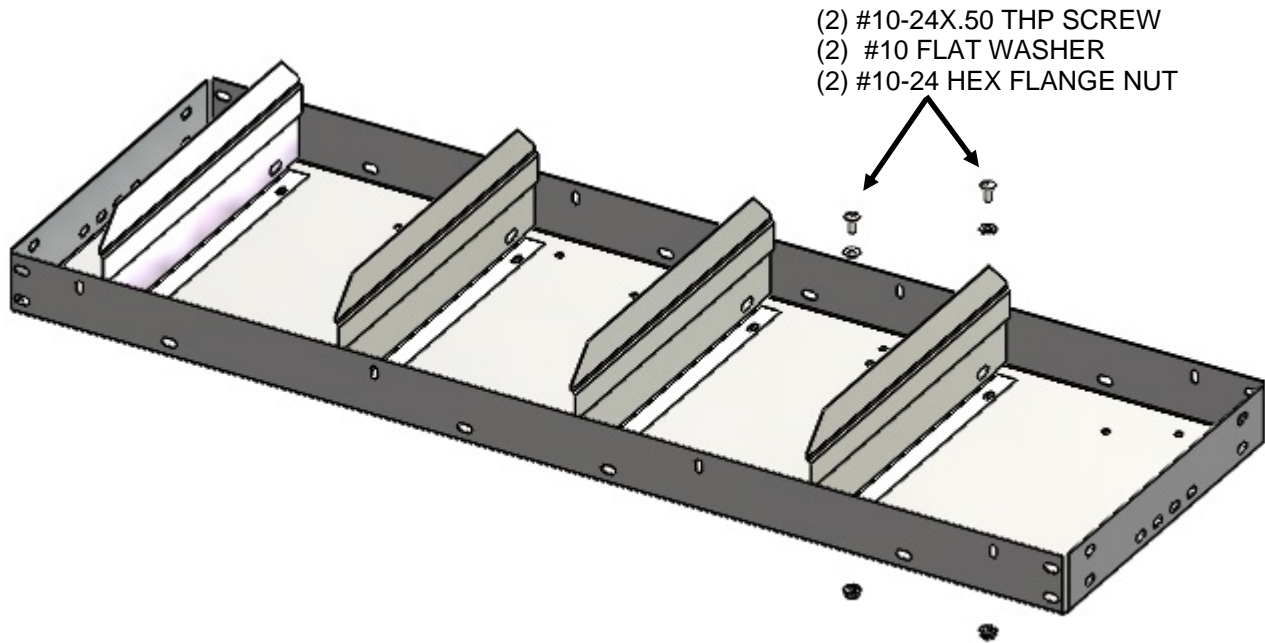

**DOUBLE CHECK ALL FASTENERS LOCATIONS TO BE SURE THAT ALL  
FASTENERS ARE TIGHTENED TO SPECIFICATIONS.  
YOUR INSTALLATION IS NOW COMPLETE!  
STOW THIS COPY IN THE VEHICLE FOR FUTURE REFERENCES!**

## Introduction / Comments:

### **Note:**

It is advised that all fasteners used in this assembly and installation should be checked for tightness at the following intervals: @ 2-weeks and again @ 6-weeks of operation. This preventive maintenance step must be completed to ensure your Product gives you long service life.

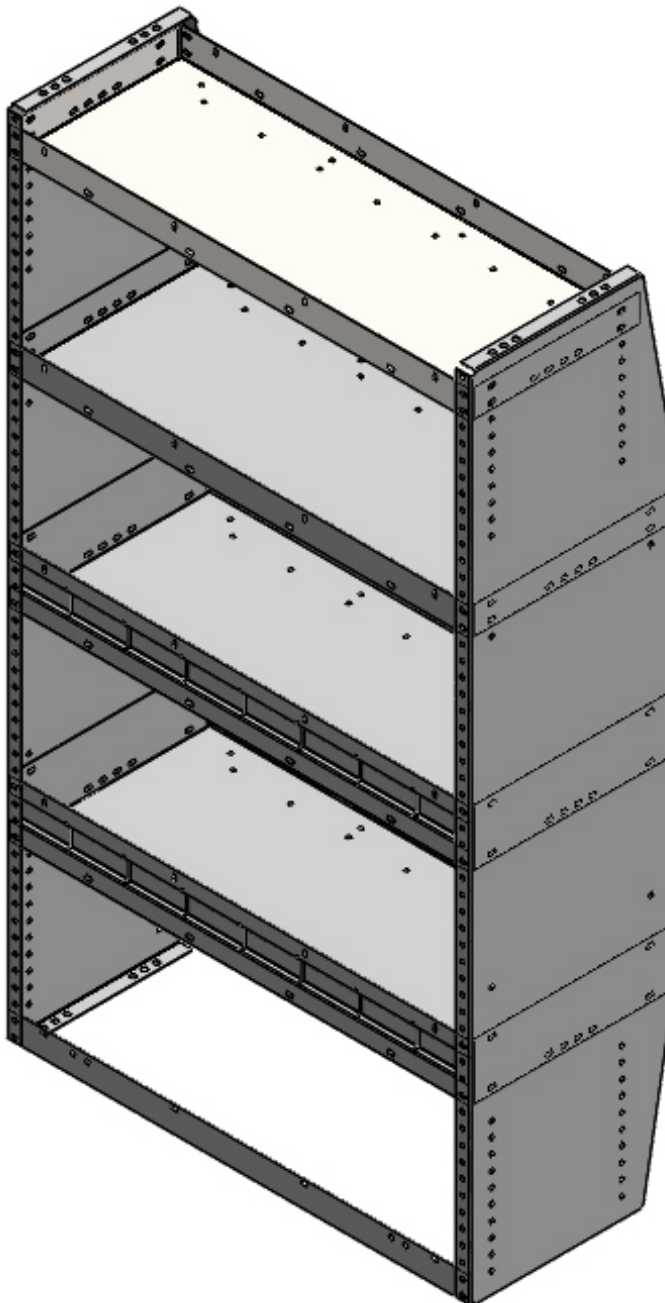

HD-32SWP  
HD-42SWP  
HD-52SWP



## - PRECAUTIONS -



**CAUTION**



**THE USE OF AIR IMPACT TOOLS CAN  
OVER-TORQUE FASTENERS AND  
CAUSE FASTENER FAILURE!**



**CAUTION**



**ALL INSTALLATION HOLES SHOULD BE SEALED  
WITH SILICON OR BUTYL SEALANT TO PREVENT  
EXHAUST FUMES FROM ENTERING THE VEHICLE!**



**DANGER**



**INSPECT FOR FUEL TANK, FUEL LINES, BRAKE LINES, HIGH  
VOLTAGE BATTERIES AND ELECTRICAL LINES PRIOR TO  
DRILLING TO AVOID DAMAGING CRITICAL VEHICLE SYSTEMS  
OR INJURY TO INSTALLER DURING INSTALLATION PROCESS!**



**CAUTION**



**TO AVOID DAMAGING THE VEHICLE ALWAYS USE DRILL  
STOPS WHEN DRILLING ANY INSTALLATION HOLES!  
ADRIAN AVAILABLE PART #'S 31121-0 (3/8" X 1/2"  
DEEP), 31121-0 (1/2" x 1/2" DEEP)**



## - IMPORTANT WARRANTY REQUIREMENTS -

1. SUBSTITUTING ADRIAN STEEL SPECIFIED FASTENERS FOR ASSEMBLY AND/OR INSTALLATION WILL VOID YOUR PRODUCT WARRANTY.
2. ALL HOLES DRILLED INTO VEHICLE SHOULD HAVE THE RAW METAL EDGES SEALED WITH A SELF-ETCHING PRIMER TO RESIST CORROSION AND POTENTIAL FASTENER POINT FAILURE.
3. ALL FASTENERS USED IN THE INSTALLATION OF THIS PRODUCT SHOULD BE TIGHTENED TO THE TORQUE(S) SPECIFIED IN THESE INSTRUCTIONS.
4. THESE INSTRUCTIONS SHOULD BE KEPT WITH THE VEHICLE.

### THE BASIC TOOLS NEEDED FOR MOST INSTALLATIONS



DRILL



DRILL BIT WITH  
STOP



RATCHET, SOCKETS  
AND/OR WRENCHES



SCREWDRIVERS



MEASURING TAPE

ADDITIONAL TOOLS MAY BE NEEDED FOR THIS INSTALLATION AND THEY WILL BE IDENTIFIED IN THE STEPS THAT FOLLOW.



If your vehicle contains carpet or a rubber floor mat you will need to prepare the mounting location. Position the product to be installed into the vehicle and once you are satisfied with the mounting locations, mark the mounting locations. Using a 1-3/16" diameter carpet cutter (P/N: 31183-0). Select the appropriate floor spacers as shown in the illustration. Set those aside for use later into the installation process.

Using the correct drill bit size for the selected plusnut, drill the mounting holes in the vehicle sheet metal to prepare for installing the plusnuts.

If you are thru-bolting at any of the locations simply drill a hole that is 1/16" larger than the bolt size(s) for those locations.

Once you have drilled the holes into the vehicle, the raw metal edges should be sealed using a self-etching primer to resist corrosion and potential fastener point failure.

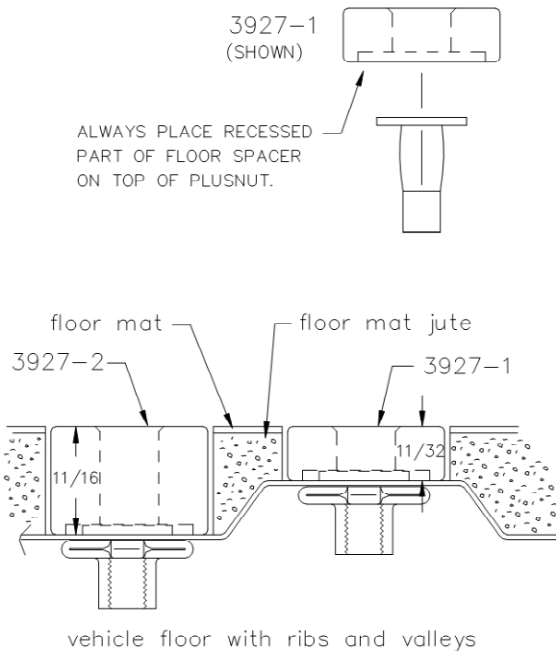

A PLUSNUT (RIVNUT) SETTING TOOL IS REQUIRED FOR PLUSNUT (RIVNUT) INSTALLATION . PLUS NUT SETTING TOOL CAN BE ORDERED THROUGH ADRIAN STEEL, OR USE AN AIR POWERED PLUSNUT SETTING GUN.

1/4-20UNC Plusnut (FAS0052) Use 3/8" dia. drill w/stop

FAS0080 SCREW, HXHD, 1/4-20UNCx2.00", G8  
FAS0067 WASHER, FLAT, 1/4"ID  
22200-0 PLUSNUT TOOL

5/16-18UNC Plusnut (FAS0091) Use 1/2" dia. drill w/stop

FAS0095 SCREW, HXHD, 5/16-18UNCx2.00", G8  
FAS0086 WASHER, FLAT, 5/16"ID  
22200-0 PLUSNUT TOOL

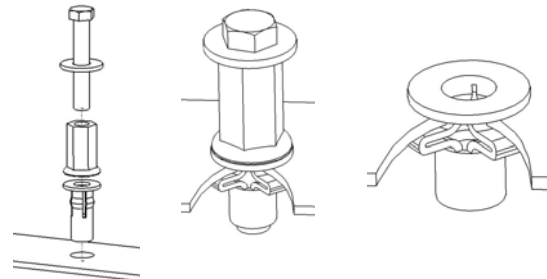

Place barrel of the plusnut body in sheet metal thru hole until flange is flush with sheet metal.

Using a 9/16" combination wrench of plusnut tool body and a second hand wrench, ratchet, or air tool, rotate the hex bolt head CW to draw plus nut flanges up (set the plusnut).

**Installation and/or Assembly Fasteners**  
**BAGINSTL-D**

ITEM NO.	PART NUMBER	DESCRIPTION	QTY.
1	BAG0507-A	5" x 7" 3MIL AUTOBAG	1
2	FAS0055	Nut, Hex Flange, Nylock 1/4-20	6
3	FAS0063	Screw, Hex Hd, 1/4-20x0.75 Zn Plate, Grade 5	2
4	FAS0086	WASHER, FLAT USS 5/16 ZP	10
5	FAS0091	Plusnut, 5/16	10
6	FAS0098	Washer, Lock, Split, 5/16, Zinc Plate	6
7	03927-2	Tall Floor Spacer	3
8	FAS0061	Screw, Truss Hd. Ph, 1/4-20x0.50	4
9	FAS0082	Screw, Hex Hd, 5/16-18x1.00 ZN, YELLOW G8	6
10	FAS0090	Nut, Nylon Insert Lock, 5/16-18, Zi	4
11	FAS0095	Screw, Hex Hd, 5/16-18x2.00, Grade 8	4
12	03927-1	Floor Spacer Short	3
13	34255-0	PLATE, REINFORCEMENT, 07SPR FLR	4
14	22200-0	Plus Nut tool	1
15	21166-0	ECCENTRIC WASHER	4

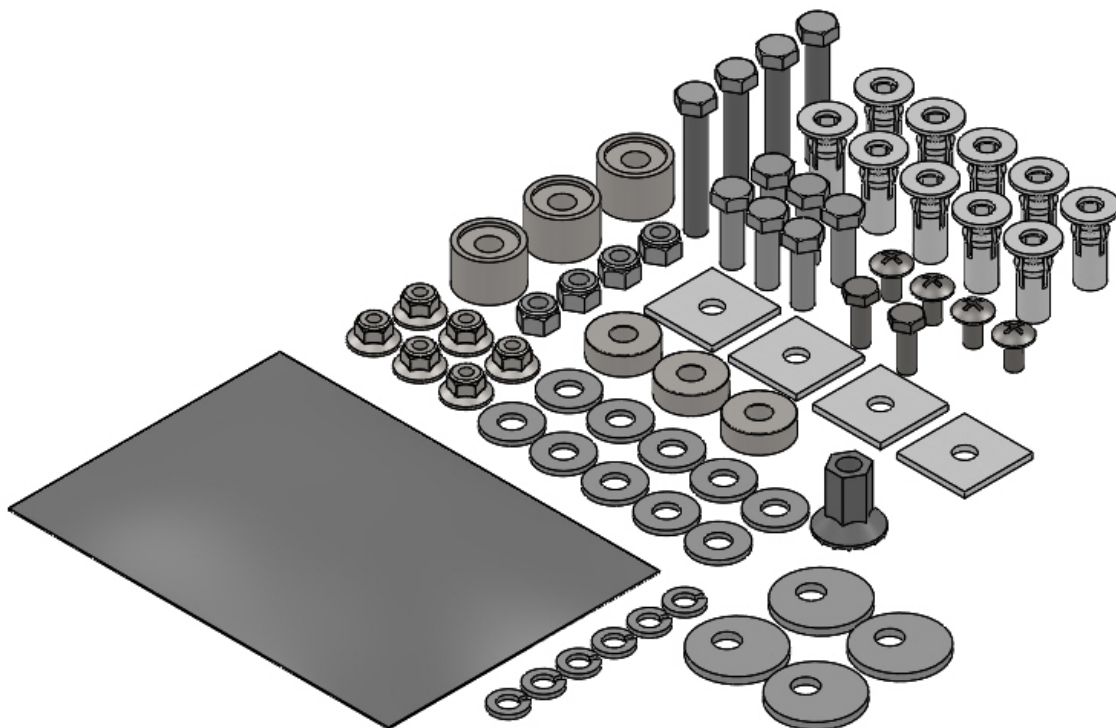

**Installation and/or Assembly Fasteners**  
**BAG00022-0**

ITEM NO.	PART NUMBER	DESCRIPTION	BAG00022-0/QTY.
1	BAG0507-A	5" x 7" 3MIL AUTOBAG	1
2	FAS0055	Nut, Hex Flange, Nylock 1/4-20	52
3	FAS0061	Screw, Truss Hd. Ph, 1/4-20x0.50	52

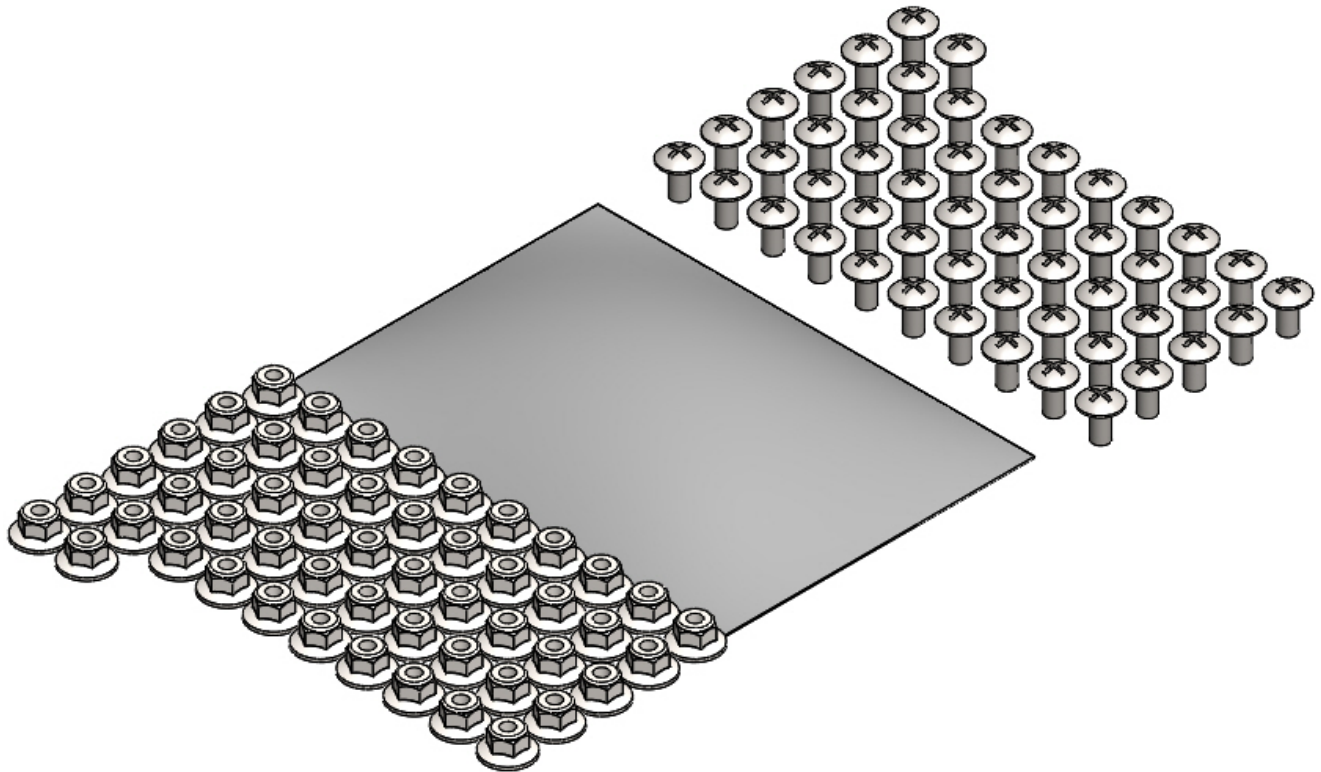

**Step 01** ASSEMBLE AND INSTALL SHELVING USING THE IMAGE BELOW

