

FASTENER GROUPS LISTED BELOW ARE USED FOR ASSEMBLY AND INSTALLATION. **SOME ASSEMBLY DRILLING IS REQUIRED.** PARTITION INSTRUCTIONS & FASTENERS ARE WITH THAT UNIT. USE KD UNIT DRAWINGS TO IDENTIFY THEIR SEPARATE PARTS. CUSTOMER SPECIFIED SHELF DIMENSIONS ARE SHOWN HERE.

SYM.	FASTENERS	QTY	DRILL
------	-----------	-----	-------

ASSEMBLY FASTENERS

⊖	{ #14 x 3/4 THP. SCW.	(12)	{ }
⊖	{ 1/4 EXT. TOOTH L'WASHER	(12)	{ }
●	{ 1/4-20 x 1/2" THP SCW.	(26)	{ }
●	{ 1/4-20 HX. FLANGE NUT	(26)	{ }
●	{ 1/4-20 x 3/4" HX.HD.SCW.	(2)	{ }
●	{ 1/4-20 HX. FLANGE NUT	(4)	{ }
●	{ 1/4-20 x 3/8" THP SCW.	(8)	{ }
●	{ 1/4 EXT. TOOTH L'WASHER	(8)	{ }

INSTALLATION FASTENERS

⊖	{ 1/4-20 PLUSNUT "PB"	(2)	{ }
⊖	{ 1/4-20 x 1" HH.SCW.FT	(2)	{ }
⊖	{ 1/4 PLN WASH	(2)	{ }
⊖	{ 1/4 SPLIT RING L'WASHER	(2)	{ }
⊖	{ 5/16-18 PLUSNUT "PB"	(3)	{ }
⊖	{ 5/16-18 x 1-1/2" HH.SCW.FT	(3)	{ }
⊖	{ 5/16 PLN WASH	(3)	{ }
⊖	{ 5/16 SPLIT RING L'WASHER	(3)	{ }
⊖	{ 5/16 PLN. WASHER	(6)	{ }
⊖	{ 5/16-18 HX.STOP NUT	(3)	{ }
⊖	{ 5/16-18 x 1-1/2" HH.SCW.FT	(3)	{ }
⊖	{ 1/2 PLN. WASHER	(3)	{ }
⊖	{ 22200 PLUSNUT TOOL N/C	(1)	{ }



ADRIAN STEEL CO.
906 JAMES STREET
ADRIAN, MI 49221
517/265-6184

MD605 DWR/CAB MOD

DWG BY	ECN#	DATE	CHK'D BY	PACKAGE #	ISS.
BTS	8329	8/23/05	RLD	MD 605	B
PACKAGE WEIGHT-		169.79 #	HORIZONTAL & VERTICAL		
			HCG=18.00 VCG=28.00		
ITEM	PART NO.	DESCRIPTION	QTY.		
1	10388-1	MOUNT BRACKET W/O FAS	2		
2	12	CABINET 12x22x18	2		
3	19	2-DRAWER MEDIUM	2		
4	4A	PARTS TRAY (2x12x36)	1		
5	8	3-DRAWER MEDIUM	2		
6	MB118	MOUNT ANGLE 1-1/2" / GALV	4		
7	MB120	STRAP BRKT.13-1/2" / GALV	2		

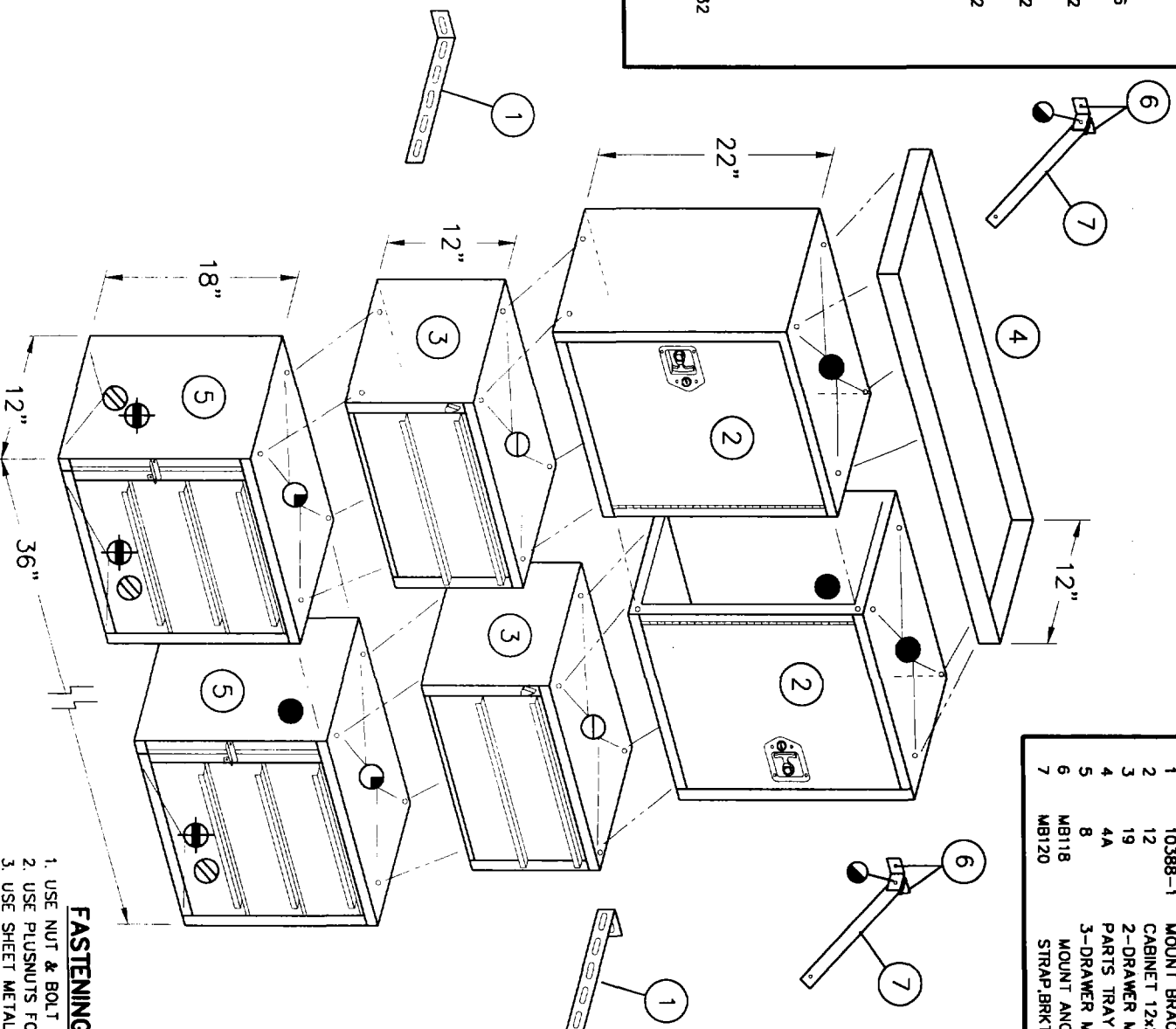

FASTENING PROCEDURES

- CAUTION:**
DRILL THRU FLOOR WITH CARE.
WATCH FOR GAS TANK, CONTROL LINES, & ELECTRICAL WIRING.
1. USE NUT & BOLT THRU WHEREVER POSSIBLE.
 2. USE PLUSNUTS FOR BLIND FASTENING.
 3. USE SHEET METAL SCREWS IN SHEAR ONLY.

A-MD605

ITEM NO.	PART NUMBER	DESCRIPTION	12/QTY.
1	10068-0	CABINET SUB-ASM, #12, (3862)	1
2	21000-0	Folding T-Handle	1
3	BAG0002-0	#2 BAG FOR #12, 38, 43, 51, CBS #7	1
4	CRT03862-0	CARTON #12 / SPECIAL PKG	1
5	CRT03862-A	CARTON, PAD FOR #12	1
6	12B	SHELF PANEL (#12 CABINET)	1

LATCH PAWL, ADJUST POSITION
AS REQ'D
SECURE w/SETSCREWW, #8-32x1/2"

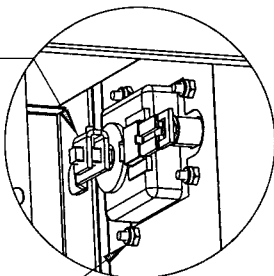

FAS0029
NUT, NYLON LOCK, #10-24UNC
QTY = 4

DETAIL B
SCALE 1 : 4

FAS0021
SCREW, RHP, #10-24UNC X 1/2"
QTY = 4

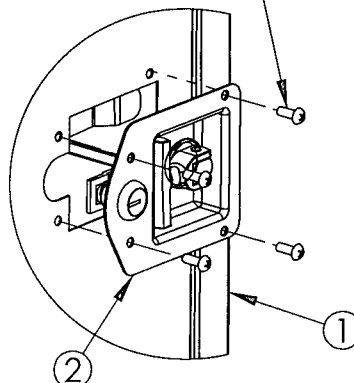

DETAIL A
SCALE 1 : 4

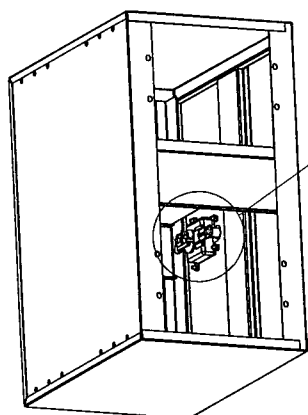

B

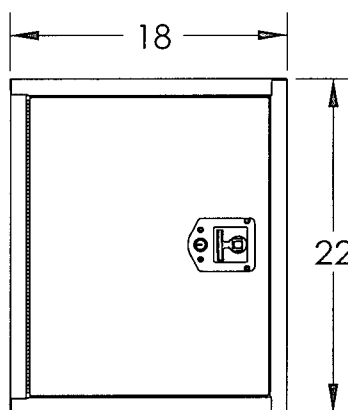
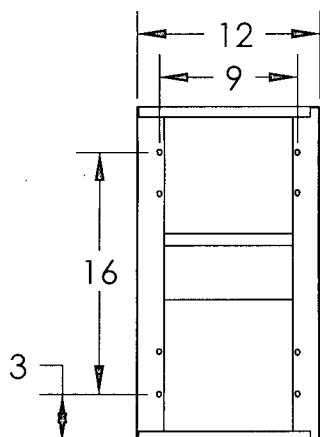
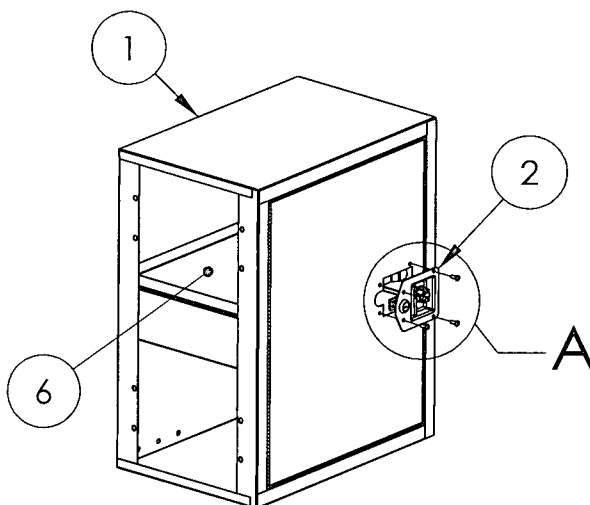

PRINTED DOCUMENT IS UNCONTROLLED

Sheet 1 of 1

THIS PRODUCT IS SUBJECT TO CHANGE.
ADRIAN STEEL COMPANY RESERVES THE RIGHT TO
CHANGE THE PRODUCT OF IT'S DESIGN WITHOUT
PRIOR NOTICE.

THIS DRAWING IS THE PROPERTY OF ADRIAN STEEL COMPANY
AND IS NOT TO BE USED IN ANY MANNER DETRIMENTAL TO
THE INTERESTS OF ADRIAN STEEL COMPANY.

Shipping Wt. (Lbs.):

21.257

Coating/Finish:

GrayPwddct

Do Not Scale This Drawing!

ADRIAN STEEL
VAN AND PICKUP EQUIPMENT

906 James St.
Adrian, MI 49221
517.265.6194

Part Description: **CABINET 12 X 22 X 18**

Part Number: **12**

REVISION
LEVEL:

C

FOR REFERENCE ONLY!

Part
Number: **12**

REVISION
LEVEL:

C

**ADRIAN STEEL**

Cargo Management Solutions for Commercial Vehicles

19, 2-DRAWER MEDIUM

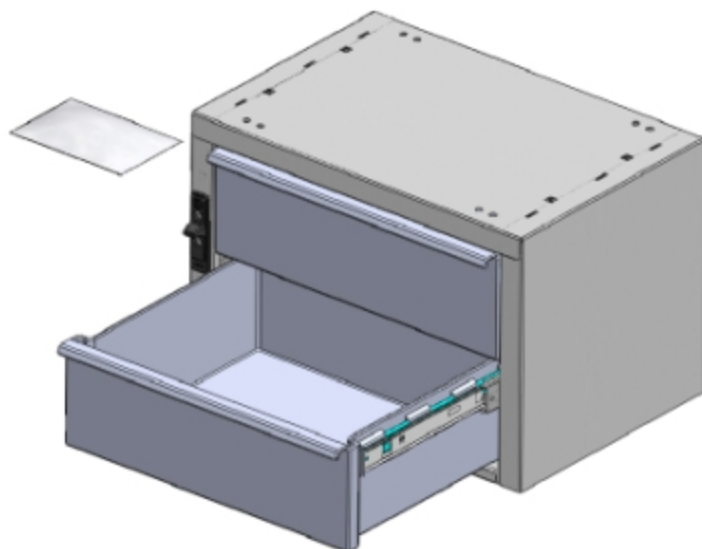
*PRODUCT WEIGHT***27.4 lbs.***WIDTH x DEPTH x HEIGHT***18 x 12 x 12***CAPACITY***25 LBS. PER DRAWER***COLOR***GRAY***CATALOG NUMBER***19***PRODUCT FEATURES*

The drawer unit body is a sturdy welded and painted steel housing. The housing has ¼-20 riv-nuts installed into the base of the unit for easy installation. Also included are pre-drilled mounting holes in the top of the cabinet to allow for quick and easy stacking of the units. The number 19 drawer unit includes two (2) polymer drawers that ride on full extension ball bearing glides. The drawers have an inside dimension of 13.50" wide X 4.5" deep X 11.50" length. Each cabinet includes a sliding latch/lock system designed to secure the drawers during vehicle movement. A cam lock allows for securing your inventory for more security.

PRODUCT APPLICATION

This product is designed to be used in and/or on ADRIAN STEEL shelving units and can also be used as a standalone product. The product is great for small parts and supplies storage.

Introduction / Comments:

The drawer unit body is a sturdy welded and painted steel housing. The housing has 1/4-20 riv-nuts installed into the base of the unit for easy installation. Also pre drilled mounting holes in the top of the cabinet to allow for quick and easy stacking of units. 2 polymer drawers ride on ball bearing glides. Each cabinet includes a sliding latch/lock system designed to secure the drawers during vehicle movement. A cam lock allows for securing your inventory for more security

Note:

It is advised that all fasteners used in this assembly and installation should be checked for tightness at the following intervals: @ 2-weeks and again @ 6-weeks of operation. This preventive maintenance step must be completed to ensure your Product gives you long service life.

ITEM NO.	PART NUMBER	DESCRIPTION	19S/QTY.
1	39197-G	WRAPPER BODY ASSM	1
2	40016	DRAWER SUB ASSY. 19/919	2
3	40827-LH	250MM SLIDE, CABINET HALF, LH	2
4	40287-RH	250MM SLIDE, CABINET HALF, RH	2
5	BAG00001-0	FASTENER BAG 9,19,919	1

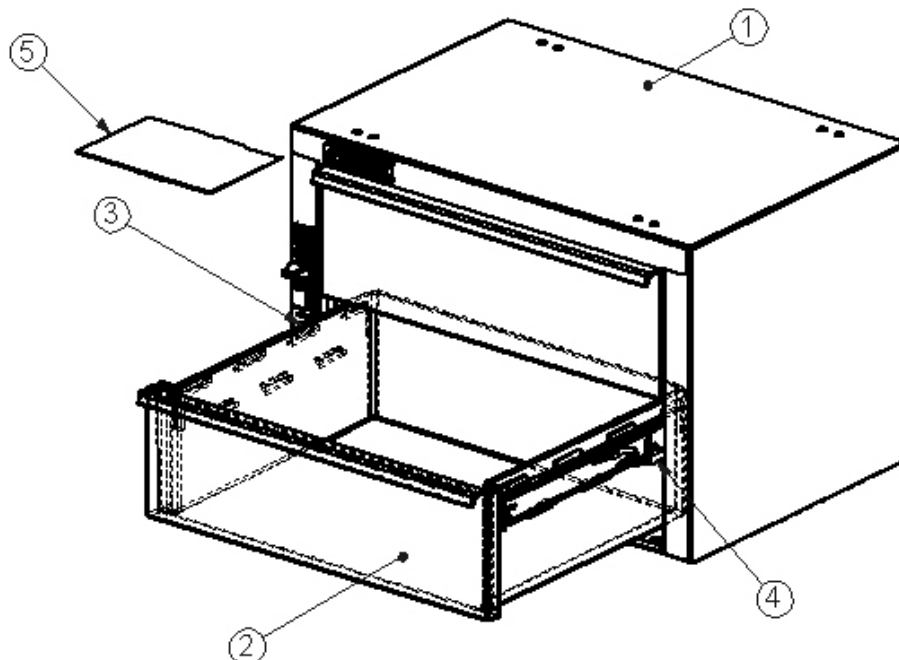

19 2 DRAWER MEDIUM

- PRECAUTIONS -





 **CAUTION** 
**THE USE OF AIR IMPACT TOOLS CAN
OVER-TORQUE FASTENERS AND
CAUSE FASTENER FAILURE!**





 **CAUTION** 
**ALL INSTALLATION HOLES SHOULD BE SEALED
WITH SILICON OR BUTYL SEALANT TO PREVENT
EXHAUST FUMES FROM ENTERING THE VEHICLE!**



 **DANGER** 
**INSPECT FOR FUEL TANK, FUEL LINES, BRAKE LINES, HIGH
VOLTAGE BATTERIES AND ELECTRICAL LINES PRIOR TO
DRILLING TO AVOID DAMAGING CRITICAL VEHICLE SYSTEMS
OR INJURY TO INSTALLER DURING INSTALLATION PROCESS!**



 **CAUTION** 
**TO AVOID DAMAGING THE VEHICLE ALWAYS USE DRILL
STOPS WHEN DRILLING ANY INSTALLATION HOLES!
ADRIAN AVAILABLE PART #'S 31119-0 (3/8" X 1/2"
DEEP), 31121-0 (1/2" x 1/2" DEEP)**



- IMPORTANT WARRANTY REQUIREMENTS -

1. SUBSTITUTING ADRIAN STEEL SPECIFIED FASTENERS FOR ASSEMBLY AND/OR INSTALLATION WILL VOID YOUR PRODUCT WARRANTY.
2. ALL HOLES DRILLED INTO VEHICLE SHOULD HAVE THE RAW METAL EDGES SEALED WITH A SELF-ETCHING PRIMER TO RESIST CORROSION AND POTENTIAL FASTENER POINT FAILURE.
3. ALL FASTENERS USED IN THE INSTALLATION OF THIS PRODUCT SHOULD BE TIGHTENED TO THE TORQUE(S) SPECIFIED IN THESE INSTRUCTIONS.
4. THESE INSTRUCTIONS SHOULD BE KEPT WITH THE VEHICLE.

THE BASIC TOOLS NEEDED FOR MOST INSTALLATIONS



DRILL



DRILL BIT WITH
STOP



RATCHET, SOCKETS
AND/OR WRENCHES



SCREWDRIVERS



MEASURING TAPE

ADDITIONAL TOOLS MAY BE NEEDED FOR THIS INSTALLATION AND THEY WILL BE IDENTIFIED IN THE STEPS THAT FOLLOW.

If your vehicle contains carpet or a rubber floor mat you will need to prepare the mounting location. Position the product to be installed into the vehicle and once you are satisfied with the mounting locations, mark the mounting locations. Using a 1-3/16" diameter carpet cutter (P/N: 31183-0). Select the appropriate floor spacers as shown in the illustration. Set those aside for use later into the installation process.

Using the correct drill bit size for the selected plusnut, drill the mounting holes in the vehicle sheet metal to prepare for installing the plusnuts.

If you are thru-bolting at any of the locations simply drill a hole that is 1/16" larger than the bolt size(s) for those locations.

Once you have drilled the holes into the vehicle, the raw metal edges should be sealed using a self-etching primer to resist corrosion and potential fastener point failure.

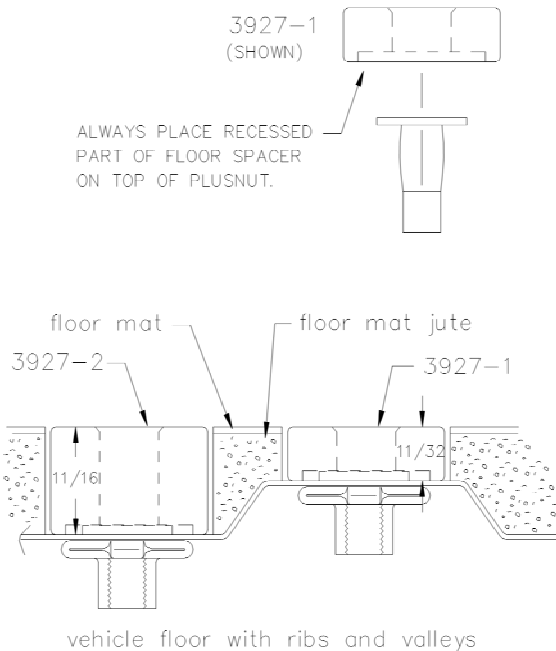

A PLUSNUT (RIVNUT) SETTING TOOL IS REQUIRED FOR PLUSNUT (RIVNUT) INSTALLATION . PLUS NUT SETTING TOOL CAN BE ORDERED THROUGH ADRIAN STEEL, OR USE AN AIR POWERED PLUSNUT SETTING GUN.

1/4-20UNC Plusnut (FAS0052) Use 3/8" dia. drill w/stop

FAS0080 SCREW, HXHD, 1/4-20UNCx2.00", G8
FAS0067 WASHER, FLAT, 1/4"ID
22200-0 PLUSNUT TOOL

5/16-18UNC Plusnut (FAS0091) Use 1/2" dia. drill w/stop

FAS0095 SCREW, HXHD, 5/16-18UNCx2.00", G8
FAS0086 WASHER, FLAT, 5/16"ID
22200-0 PLUSNUT TOOL

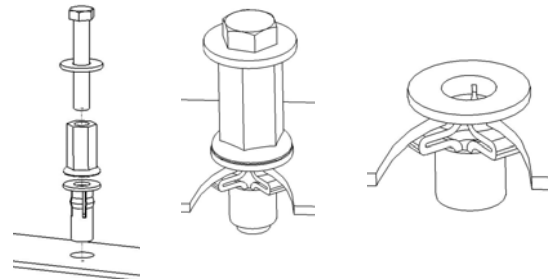

Place barrel of the plusnut body in sheet metal thru hole until flange is flush with sheet metal.

Using a 9/16" combination wrench of plusnut tool body and a second hand wrench, ratchet, or air tool, rotate the hex bolt head CW to draw plus nut flanges up (set the plusnut).

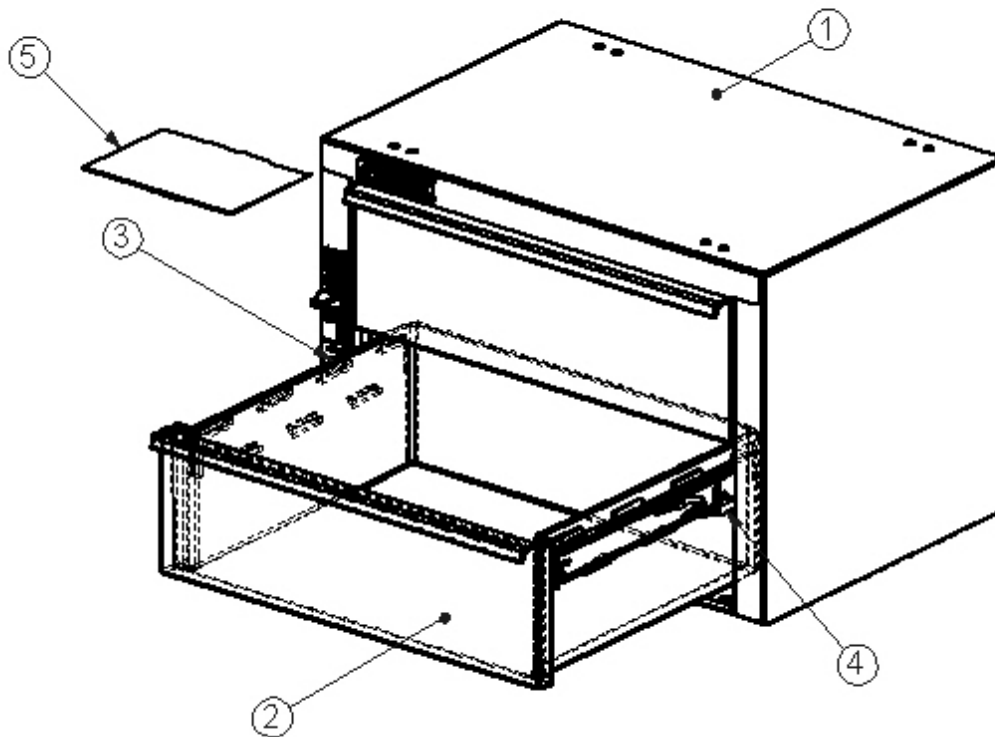

INSERT TWO (2) 40287-LH AND TWO (2) 40287-RH SLIDES INTO CABINET BODY.
INSERT TWO (2) 40016 DRAWERS INTO CABINET BODY.
PLACE BAG00001-0 INTO THE SECOND DRAWER. TAPE
THE LOCK KEYS INTO THE FRONT RIGHT BOTTOM OF THE SECOND
DRAWER AND CLOSE THE DRAWERS.

ITEM NO.	PART NUMBER	DESCRIPTION	BAG00001-0./QTY.
1	BAG0505-A	5" x 5" 3MIL AUTOBAG	1
2	FAS 0066	Washer, Lock, Ext. Tooth, 1/4	4
3	FAS0520	Screw, Truss Hd. Ph, 1/4-20x .375" lg	4

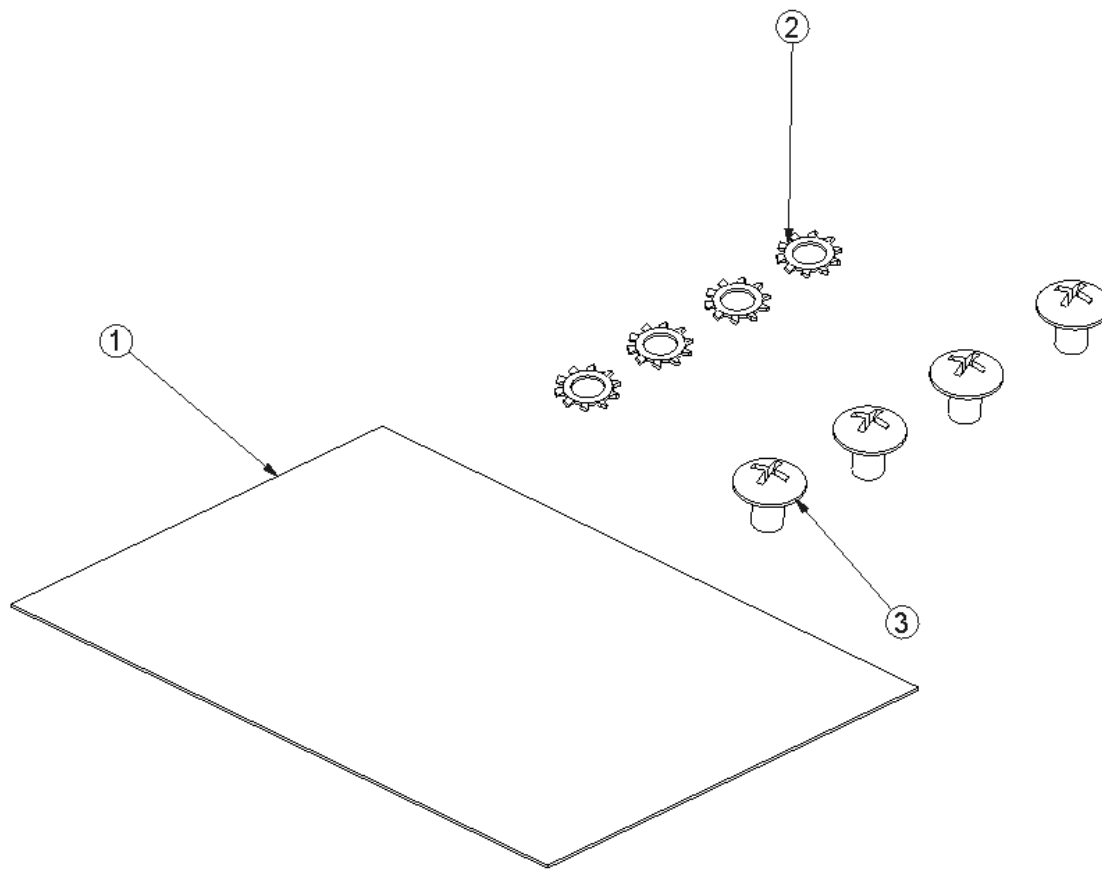

Individual Fastener Images & Descriptions

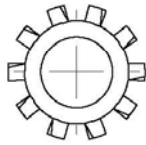

FAS0066
WASHER, LCK EXT 1/4 ZP

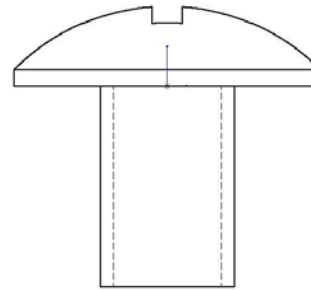
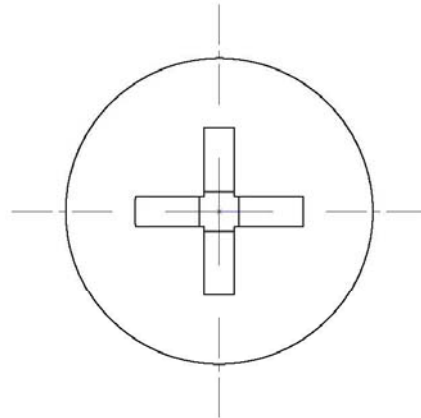

FAS0520
SCREW, THP 1/4-20 X .38
ZP

Step 01 Methods of Attachment

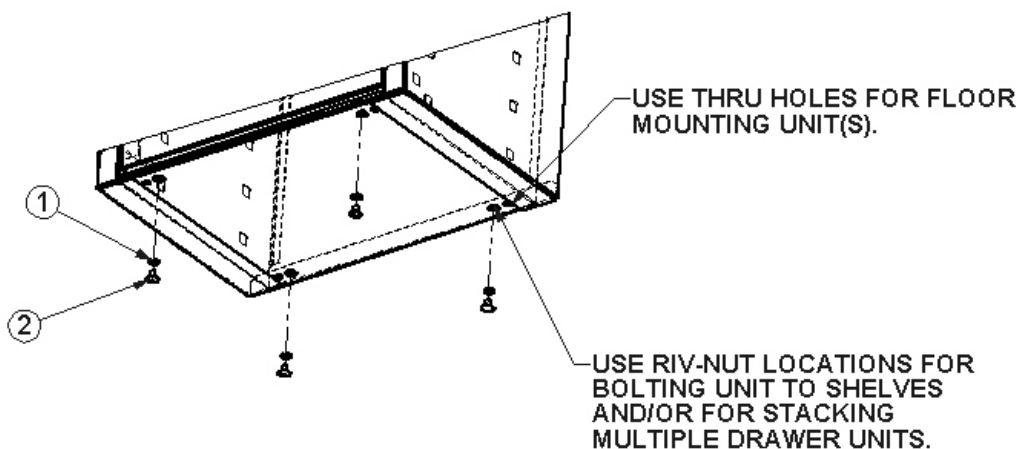
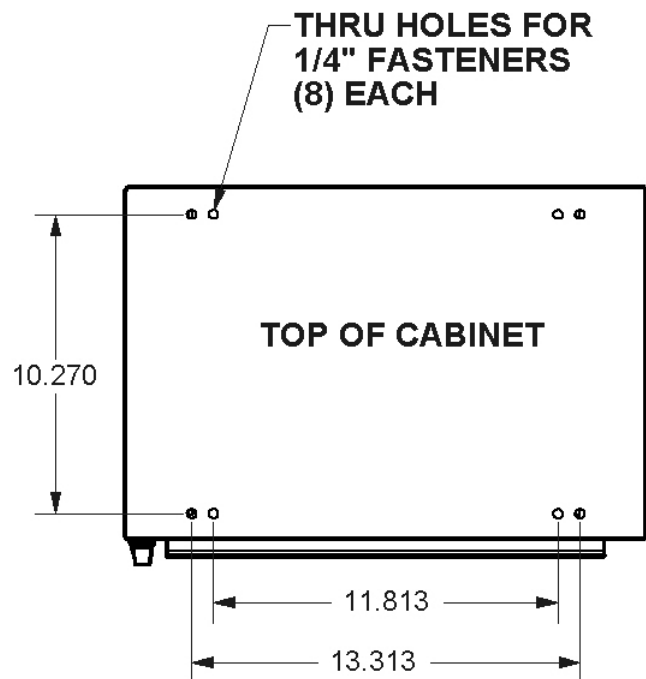
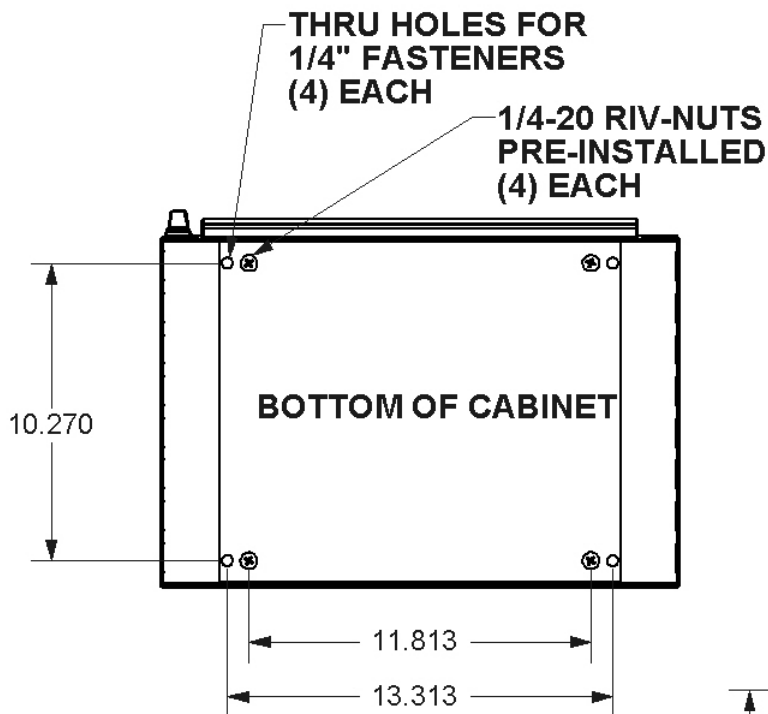

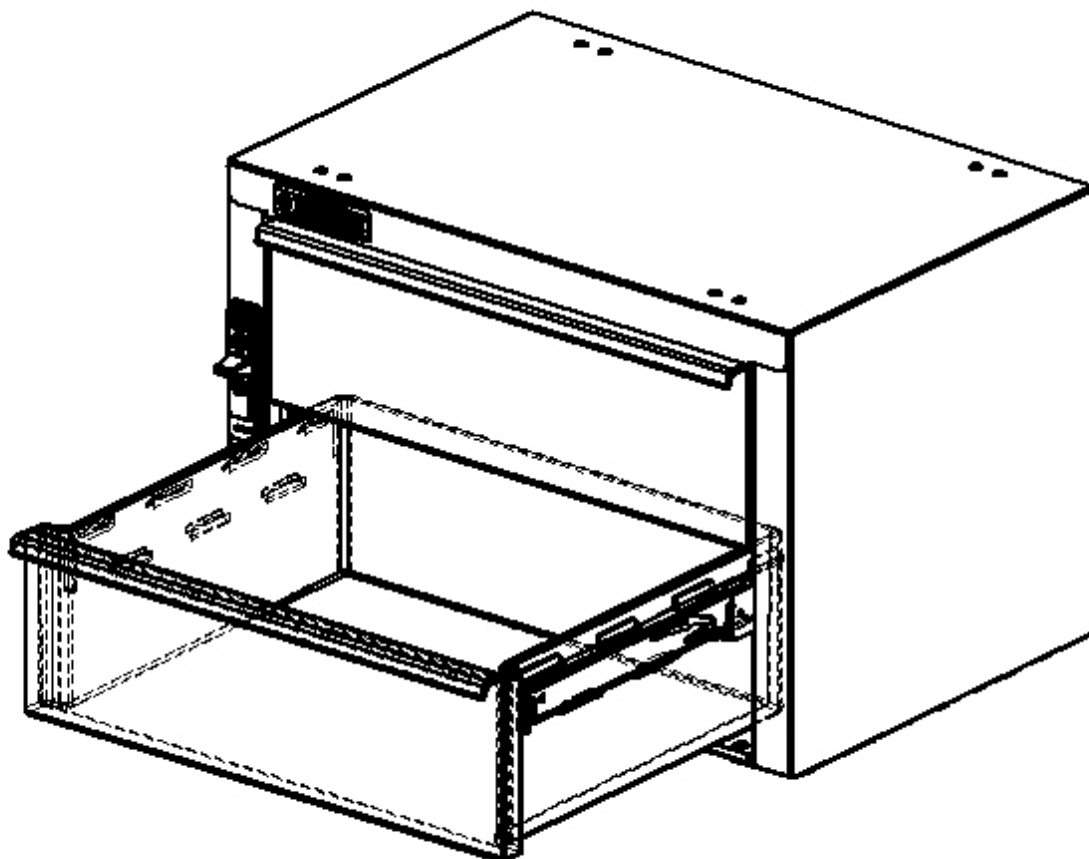

**DOUBLE CHECK ALL FASTENERS LOCATIONS TO BE SURE THAT ALL
FASTENERS ARE TIGHTENED TO SPECIFICATIONS.
YOUR INSTALLATION IS NOW COMPLETE!
STOW THIS COPY IN THE VEHICLE FOR FUTURE REFERENCES!**

ITEM NO.	PART NUMBER	DESCRIPTION	QTY
1	03836-0	WELDMENT, #8 CABINET (16640)	1
2	09233-0	HINGE, LOCK #8 CABINET	1
3	16536-0	DRAWER, #8, 1PC, 5x12x16	3
4	LOGO-SM	.875"X3.0"ADRIAN STEEL LO	1
5	BAG0002-0	#2 BAG FOR #12, 38, 43, 51, CBS #7	1
6	CRT03846-0	CARTON #8 / SPECIAL PKG	1
7	FAS0736	Rivet, Blind, Buttonhead, 1/8x.125 Grip, Alum	4

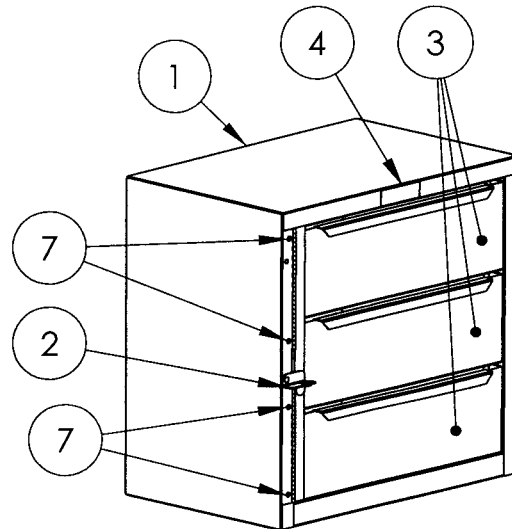
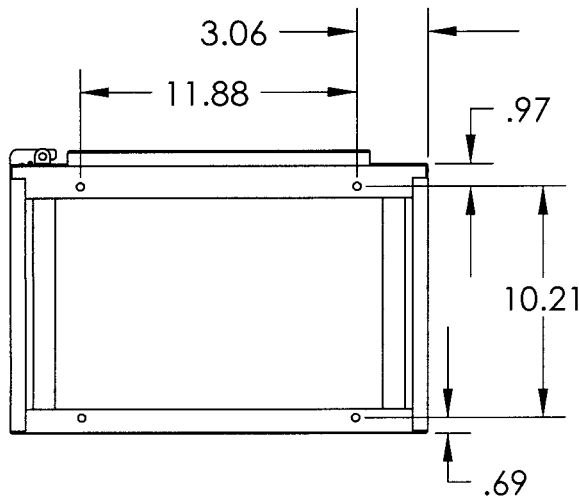
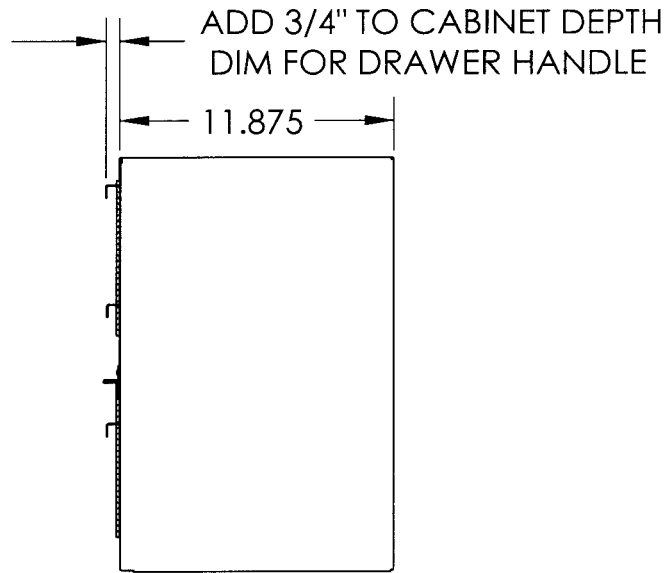
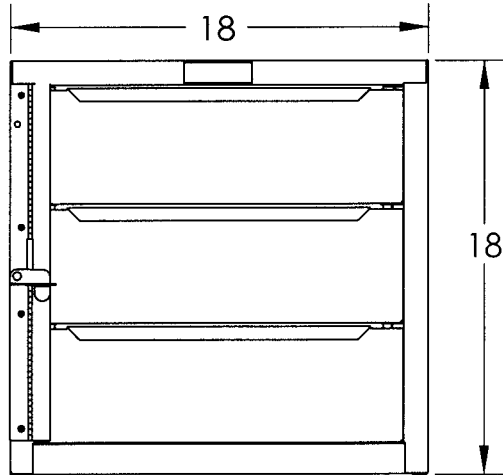

CHECK ALIGNMENT AND SMOOTHNESS OF DRAWER OPERATION. CORRECT AS REQ'D

printed document is uncontrolled

Sheet 1 of 1

for reference only!

REVISION LEVEL: C

Part Number: 8

THIS PRODUCT IS SUBJECT TO CHANGE. ADRIAN STEEL COMPANY RESERVES THE RIGHT TO CHANGE THE PRODUCT OF IT'S DESIGN WITHOUT PRIOR NOTICE.

THIS DRAWING IS THE PROPERTY OF ADRIAN STEEL COMPANY AND IS NOT TO BE USED IN ANY MANNER DETRIMENTAL TO THE INTERESTS OF ADRIAN STEEL COMPANY.

Shipping Wt. (Lbs.):

30.7

Coating/Finish:

GrayPwdct

Do Not Scale This Drawing!

ADRIAN STEEL
VAN AND PICKUP EQUIPMENT

906 James St.
Adrian, MI 49221
517.265.6194

Part Description: **CABINET ASM, #8, 3-DRW MED**

Part Number: **8**

REVISION LEVEL:

C