

FASTENER GROUPS LISTED BELOW ARE USED FOR ASSEMBLY AND INSTALLATION. **SOME ASSEMBLY DRILLING IS REQUIRED.** PARTITION INSTRUCTIONS & FASTENERS ARE WITH THAT UNIT. USE KD UNIT DRAWINGS TO IDENTIFY THEIR SEPARATE PARTS. CUSTOMER SPECIFIED SHELL DIMENSIONS ARE SHOWN HERE.

SYM.	FASTENERS	QTY	DRILL
<b>ASSEMBLY FASTENERS</b>			
●	{ 1/4-20 x 1/2" THP.SCW. (32) }	(32)	9/32
●	{ 1/4-20 HX. FLANGE NUT (32) }	(32)	
●	{ 1/4-20 x 3/4" HX.HD.SCW. (4) }	(4)	9/32
●	{ 1/4-20 HX. FLANGE NUT (6) }	(6)	
<b>INSTALLATION FASTENERS</b>			
●	1/4-20 PLUSNUT "PB" (4)	(4)	13/32
●	1/4-20 x 1" HH.SCW.FT (4)	(4)	
●	1/4 PLN WASH (4)	(4)	
●	1/4 SPLIT RING L'WASHER (4)	(4)	
●	1/4-20 PLUSNUT "PB" (3)	(3)	13/32
●	1/4-20 x 1-1/2" HH.SCW.FT (3)	(3)	
●	1/4 PLN WASH (3)	(3)	
●	1/4 SPLIT RING L'WASHER (3)	(3)	
●	1/4 PLN. WASHER (6)	(6)	
●	1/4-20 HX.STOP NUT (3)	(3)	9/32
●	1/4-20 x 1-1/2" HH.SCW.FT (3)	(3)	
●	1/2 PLN. WASHER (3)	(3)	
	PLUSNUT TOOL (1)	(1)	

**ADRIAN STEEL CO.**  
906 JAMES STREET  
ADRIAN, MI 49221  
517/285-6194

**MD531 MODULE SPECIAL**  
**HD KD SHELF UNIT**  
14 x 46 x 42

DWG BY: **J.C** ECN# **7398** DATE **6/04/04** CHK'D BY: **RLD** PACKAGE# **ISS: MD531**  
PACKAGE WEIGHT: **92.35 #** REF **20364**

ITEM	PART NO.	DESCRIPTION	QTY.
1	DK542	DOOR KIT #50/30-42	1
2	DV14	DIVIDER/PNTD: #50KD	4
3	29263	KD UNIT SPEC. 14x46x42 HD	1
	EP1446	END PANEL KD 46"	2
	FR42	FLOOR RAIL 42"	1
	GS6x10LH	GUSSET LH #50-#30 KD's	1
	GS6x10RH	GUSSET RH #50-#30 KD's	1
	GS6x6	GUSSET, 6" TRIANGLE	2
	WB118	MOUNT ANGLE 1-1/2" / GAL	4
	WB120	STRAP,BRKT,13-1/2" / GAL	2
	SF21242	SHELF 2x12x42	1
	SF21442	SHELF 30/SOKD 2x14x42	1
	SF41442	SHELF HD-KD 4x14x42	1

HEIGHT FROM FLOOR TO LOWEST SHELF WILL VARY DEPENDING ON THE HEIGHT OF YOUR VEHICLES WHEELHOUSE.  
PLEASE REFER TO THE INTERIOR INSTALLATION SHEET FOR CORRECT SHELF HEIGHT BEFORE ASSEMBLY.

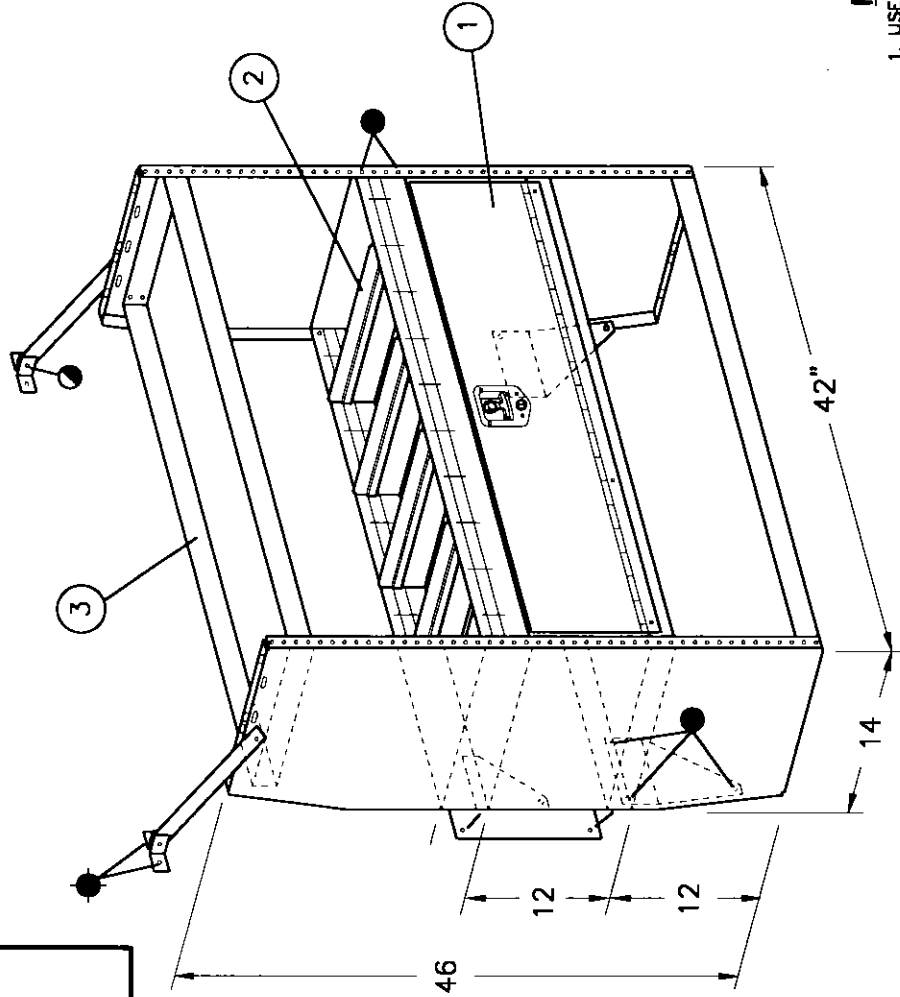

**CAUTION:**  
DRILL THRU FLOOR WITH CARE  
WATCH FOR GAS TANK, CONTROL  
LINES, & ELECTRICAL WIRING.

## FASTENING PROCEDURES

1. USE NUT & BOLT THRU WHEREVER POSSIBLE.
2. USE PLUSNUTS FOR BLIND FASTENING.
3. USE SHEET METAL SCREWS IN SHEAR ONLY.

**A- MD531**

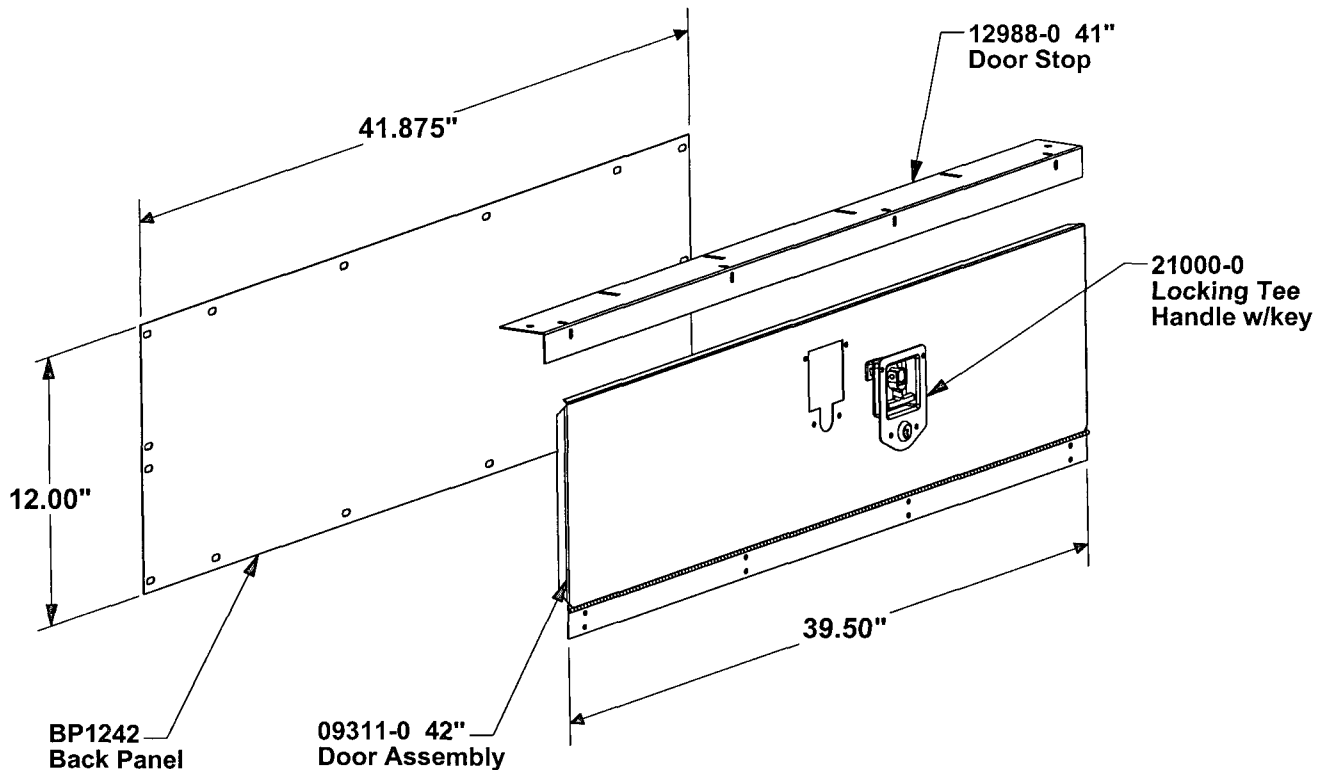

**Side profile of KD unit shelves.**  
(Shelves not included in Door Kit)

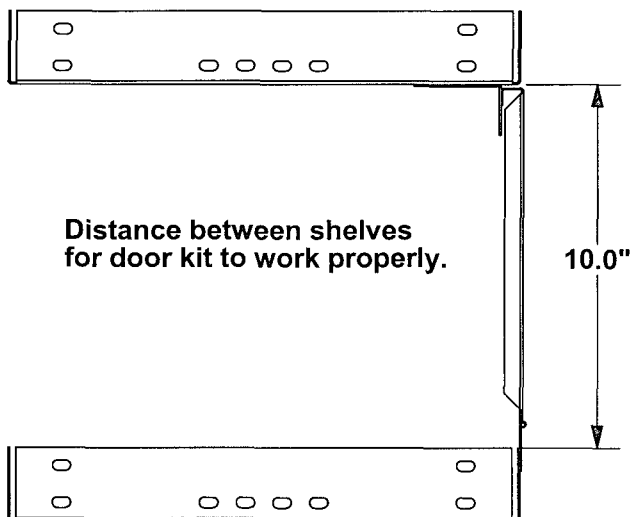

#### NOTES:

Folding Tee Handle Assembly is attached to door panel with (4) FAS0021 #10-24 x 1/2" RHP screws, and (4) FAS0029 #10-24 Nylon Lock Nuts.

Door Assembly is attached to lower shelf with (4) FAS0021 #10-24 RHP screws, and (4) FAS0020 #10-24 Hex Flange Nuts.

Door Stop is attached to the bottom of the upper shelf, with (4) FAS0021 #10-24 x 1/2" RHP screws, and (4) FAS0020 #10-24 Hex Lock Nuts. Keep stop loose until door panel is flush with front of shelves.

Back Panel is attached to the back of shelves with (16) FAS0061 1/4-20 x 1/2" THP screws, and (16) FAS0055 1/4-20 Hex Flange Nuts.

Final adjust Tee Handle's Latch Pawl, with set screw, making sure that door closes evenly, and tight against fronts of shelves.

REVISION  
LEVEL

Part  
Number

FOR REFERENCE ONLY!

THIS PRODUCT IS SUBJECT TO CHANGE.  
ADRIAN STEEL COMPANY RESERVES THE RIGHT TO  
CHANGE THE PRODUCT OF IT'S DESIGN WITHOUT  
PRIOR NOTICE.

THIS DRAWING IS THE PROPERTY OF ADRIAN STEEL COMPANY  
AND IS NOT TO BE USED IN ANY MANNER DETRIMENTAL TO  
THE INTERESTS OF ADRIAN STEEL COMPANY.

Shipping Wt. (Lbs.):

**15.32**

Coating/Finish

**None**

**Do Not Scale This Drawing!**

**ADRIAN STEEL**  
VAN AND PICKUP EQUIPMENT  
906 James St.  
Adrian, MI 49221  
517.265.6194

Part Description **LOCKING DOOR KIT #50/30-42**

Part  
Number **DK542**

REVISION  
LEVEL

**B**

## Introduction / Comments:

### DV12 / DV14 Slip-In / Bolt In Divider Install Instructions

#### **Note:**

It is advised that all fasteners used in this assembly and installation should be checked for tightness at the following intervals: @ 2-weeks and again @ 6-weeks of operation. This preventive maintenance step must be completed to ensure your Product gives you long service life.

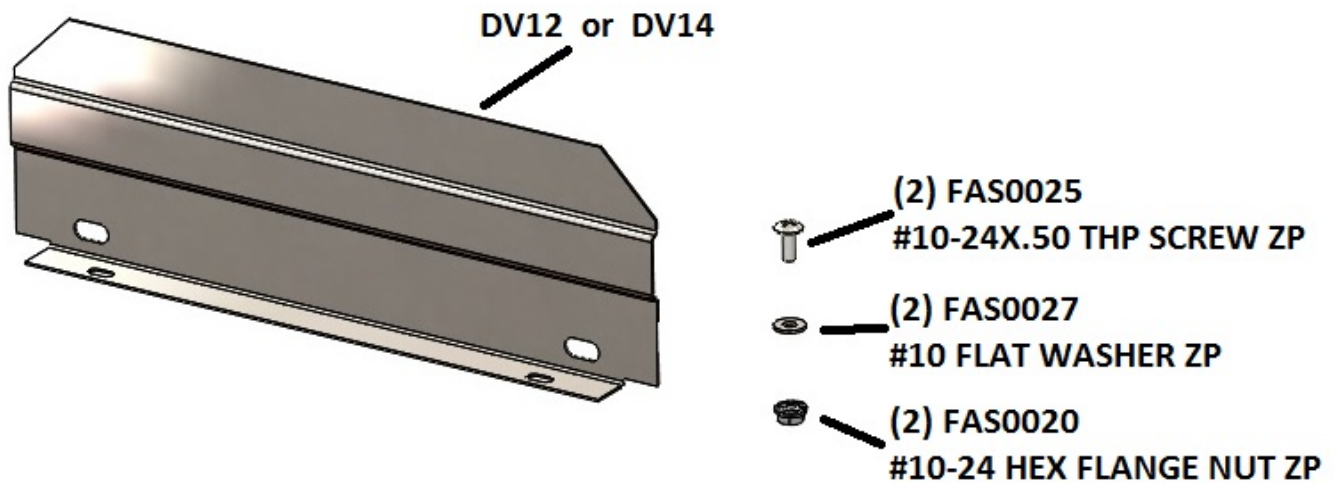

DV12 / DV14

## - PRECAUTIONS -



**CAUTION**



**THE USE OF AIR IMPACT TOOLS CAN  
OVER-TORQUE FASTENERS AND  
CAUSE FASTENER FAILURE!**



**CAUTION**



**ALL INSTALLATION HOLES SHOULD BE SEALED  
WITH SILICON OR BUTYL SEALANT TO PREVENT  
EXHAUST FUMES FROM ENTERING THE VEHICLE!**



**DANGER**



**INSPECT FOR FUEL TANK, FUEL LINES, BRAKE LINES, HIGH  
VOLTAGE BATTERIES AND ELECTRICAL LINES PRIOR TO  
DRILLING TO AVOID DAMAGING CRITICAL VEHICLE SYSTEMS  
OR INJURY TO INSTALLER DURING INSTALLATION PROCESS!**



**CAUTION**



**TO AVOID DAMAGING THE VEHICLE ALWAYS USE DRILL  
STOPS WHEN DRILLING ANY INSTALLATION HOLES!  
ADRIAN AVAILABLE PART #'S 31121-0 (3/8" X 1/2"  
DEEP), 31121-0 (1/2" x 1/2" DEEP)**



## - IMPORTANT WARRANTY REQUIREMENTS -

1. SUBSTITUTING ADRIAN STEEL SPECIFIED FASTENERS FOR ASSEMBLY AND/OR INSTALLATION WILL VOID YOUR PRODUCT WARRANTY.
2. ALL HOLES DRILLED INTO VEHICLE SHOULD HAVE THE RAW METAL EDGES SEALED WITH A SELF-ETCHING PRIMER TO RESIST CORROSION AND POTENTIAL FASTENER POINT FAILURE.
3. ALL FASTENERS USED IN THE INSTALLATION OF THIS PRODUCT SHOULD BE TIGHTENED TO THE TORQUE(S) SPECIFIED IN THESE INSTRUCTIONS.
4. THESE INSTRUCTIONS SHOULD BE KEPT WITH THE VEHICLE.

### THE BASIC TOOLS NEEDED FOR MOST INSTALLATIONS



DRILL



DRILL BIT WITH  
STOP



RATCHET, SOCKETS  
AND/OR WRENCHES



SCREWDRIVERS



MEASURING TAPE

ADDITIONAL TOOLS MAY BE NEEDED FOR THIS INSTALLATION AND THEY WILL BE IDENTIFIED IN THE STEPS THAT FOLLOW.

**Step 01** For Shelves with Embossed Sides, Slip Dividers into Shelf Embossments Evenly Spaced in Shelf as shown, unless otherwise specified by Customer. The Number of Dividers may vary per customer.

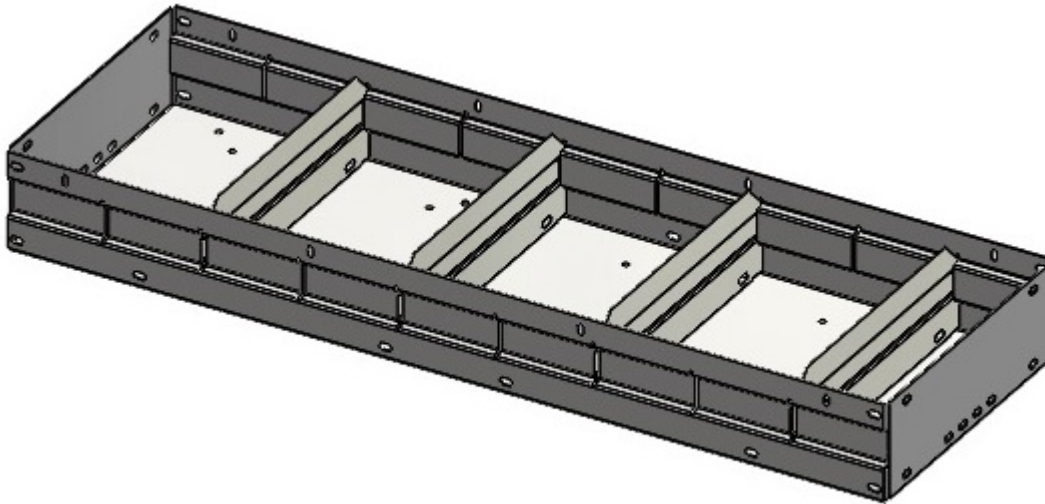

**Step 02** For Shelves where the Dividers will need to be Bolted in, Use (2) #10-24x.50 THP Screw, Flat Washer, and Hex Flange Nut to bolt each divider to shelf  
Evenly Spaced as shown unless otherwise specified by customer.  
The number of dividers may vary per customer

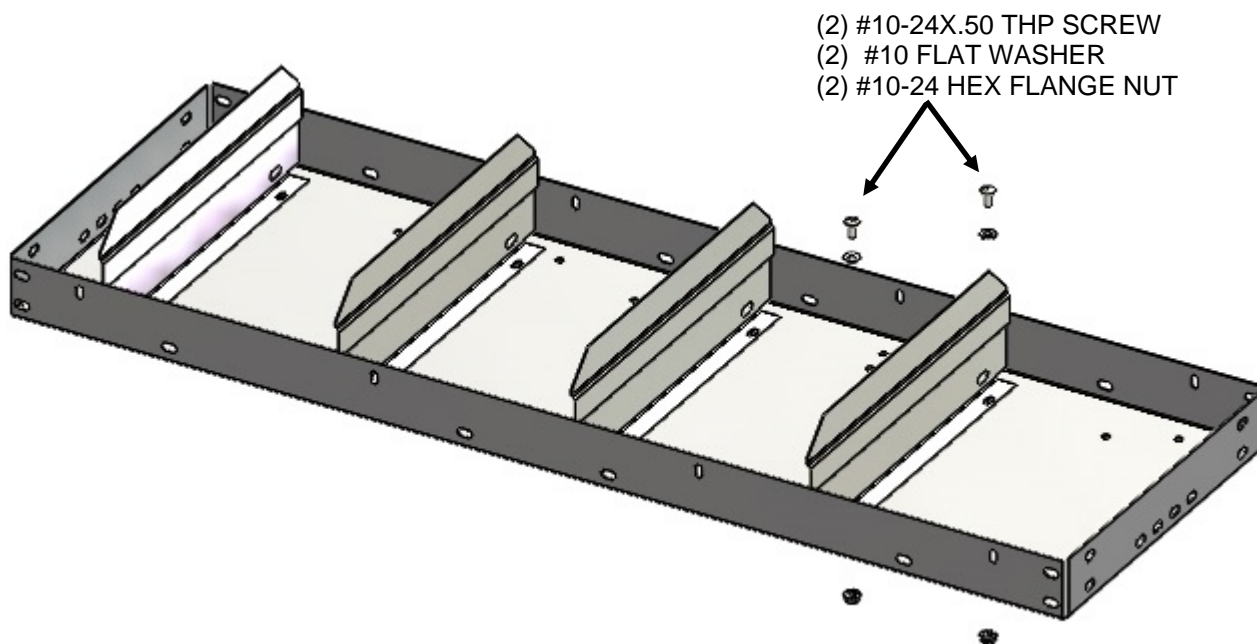

**DOUBLE CHECK ALL FASTENERS LOCATIONS TO BE SURE THAT ALL  
FASTENERS ARE TIGHTENED TO SPECIFICATIONS.  
YOUR INSTALLATION IS NOW COMPLETE!  
STOW THIS COPY IN THE VEHICLE FOR FUTURE REFERENCES!**

### Introduction / Comments:

#### Installation instruction for assembly of 29263, SPECIAL KD SHELF UNIT 14X46X42

#### **Note:**

It is advised that all fasteners used in this assembly and installation should be checked for tightness at the following intervals: @ 2-weeks and again @ 6-weeks of operation. This preventive maintenance step must be completed to ensure your Product gives you long service life.

ITEM NO.	PART NUMBER	DESCRIPTION	29263-0/QTY.
1	EP1446	END PANEL, KD, 46"	2
2	FR42	FLOOR RAIL 42"	1
3	SF21242	SHELF	1
4	SF41442	SHELF HD-KD 4X14X42	1
5	SF21442	SHELF 2X14X42	1
6	HDW29263-0	Hardware Kit 29263-0	1

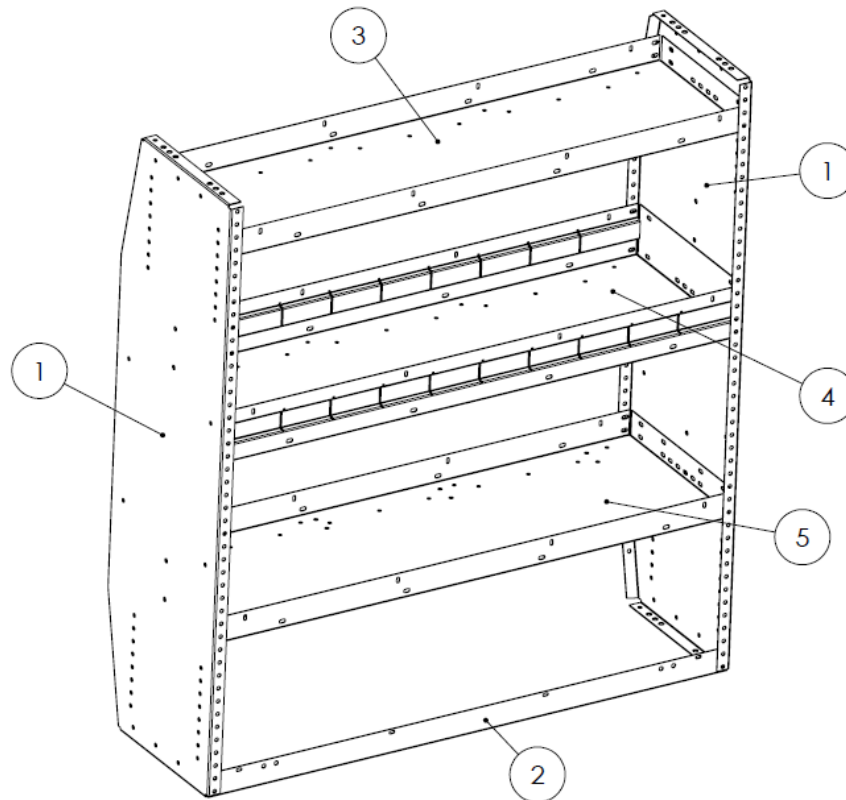

## 29263 SPECIAL KD SHELF UNIT 14X46X42



## - PRECAUTIONS -





 **CAUTION**   
**THE USE OF AIR IMPACT TOOLS CAN  
OVER-TORQUE FASTENERS AND  
CAUSE FASTENER FAILURE!**





 **CAUTION**   
**ALL INSTALLATION HOLES SHOULD BE SEALED  
WITH SILICON OR BUTYL SEALANT TO PREVENT  
EXHAUST FUMES FROM ENTERING THE VEHICLE!**

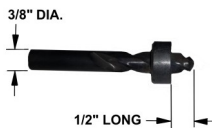

 **DANGER**   
**INSPECT FOR FUEL TANK, FUEL LINES, BRAKE LINES, HIGH  
VOLTAGE BATTERIES AND ELECTRICAL LINES PRIOR TO  
DRILLING TO AVOID DAMAGING CRITICAL VEHICLE SYSTEMS  
OR INJURY TO INSTALLER DURING INSTALLATION PROCESS!**



 **CAUTION**   
**TO AVOID DAMAGING THE VEHICLE ALWAYS USE DRILL  
STOPS WHEN DRILLING ANY INSTALLATION HOLES!  
ADRIAN AVAILABLE PART #'S 31121-0 (3/8" X 1/2"  
DEEP), 31121-0 (1/2" x 1/2" DEEP)**

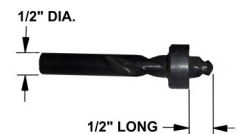

## - IMPORTANT WARRANTY REQUIREMENTS -

1. SUBSTITUTING ADRIAN STEEL SPECIFIED FASTENERS FOR ASSEMBLY AND/OR INSTALLATION WILL VOID YOUR PRODUCT WARRANTY.
2. ALL HOLES DRILLED INTO VEHICLE SHOULD HAVE THE RAW METAL EDGES SEALED WITH A SELF-ETCHING PRIMER TO RESIST CORROSION AND POTENTIAL FASTENER POINT FAILURE.
3. ALL FASTENERS USED IN THE INSTALLATION OF THIS PRODUCT SHOULD BE TIGHTENED TO THE TORQUE(S) SPECIFIED IN THESE INSTRUCTIONS.
4. THESE INSTRUCTIONS SHOULD BE KEPT WITH THE VEHICLE.

### THE BASIC TOOLS NEEDED FOR MOST INSTALLATIONS



DRILL



DRILL BIT WITH  
STOP

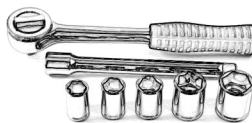

RATCHET, SOCKETS  
AND/OR WRENCHES



SCREWDRIVERS



MEASURING TAPE

ADDITIONAL TOOLS MAY BE NEEDED FOR THIS INSTALLATION AND THEY WILL BE IDENTIFIED IN THE STEPS THAT FOLLOW.



If your vehicle contains carpet or a rubber floor mat you will need to prepare the mounting location. Position the product to be installed into the vehicle and once you are satisfied with the mounting locations, mark the mounting locations. Using a 1-3/16" diameter carpet cutter (P/N: 31183-0). Select the appropriate floor spacers as shown in the illustration. Set those aside for use later into the installation process.

Using the correct drill bit size for the selected plusnut, drill the mounting holes in the vehicle sheet metal to prepare for installing the plusnuts.

If you are thru-bolting at any of the locations simply drill a hole that is 1/16" larger than the bolt size(s) for those locations.

Once you have drilled the holes into the vehicle, the raw metal edges should be sealed using a self-etching primer to resist corrosion and potential fastener point failure.

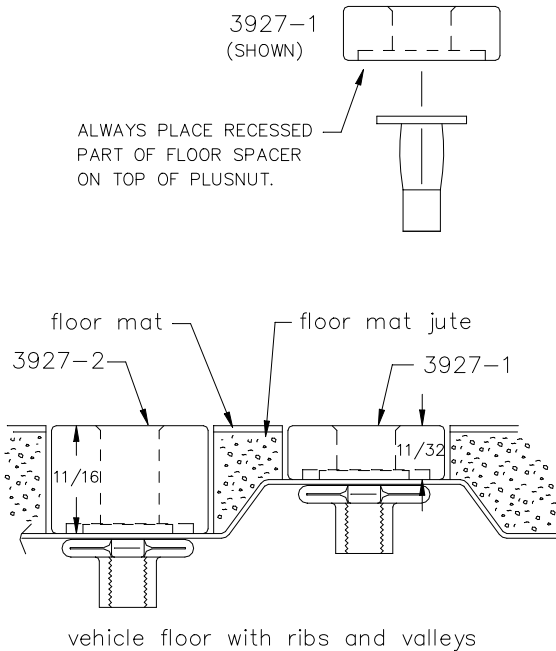

A PLUSNUT (RIVNUT) SETTING TOOL IS REQUIRED FOR PLUSNUT (RIVNUT) INSTALLATION . PLUS NUT SETTING TOOL CAN BE ORDERED THROUGH ADRIAN STEEL, OR USE AN AIR POWERED PLUSNUT SETTING GUN.

1/4-20UNC Plusnut (FAS0052) Use 3/8" dia. drill w/stop

FAS0080 SCREW, HXHD, 1/4-20UNCx2.00", G8  
FAS0067 WASHER, FLAT, 1/4"ID  
22200-0 PLUSNUT TOOL

5/16-18UNC Plusnut (FAS0091) Use 1/2" dia. drill w/stop

FAS0095 SCREW, HXHD, 5/16-18UNCx2.00", G8  
FAS0086 WASHER, FLAT, 5/16"ID  
22200-0 PLUSNUT TOOL

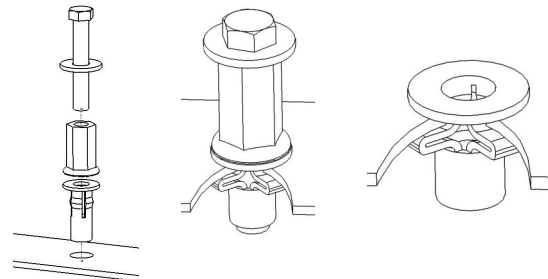

Place barrel of the plusnut body in sheet metal thru hole until flange is flush with sheet metal.

Using a 9/16" combination wrench of plusnut tool body and a second hand wrench, ratchet, or air tool, rotate the hex bolt head CW to draw plus nut flanges up (set the plusnut).

**Step 01** USE FAS0055 AND FAS0061 TO ATTATCH THE EP1446 SHELF TO THE TOP HOLES ON THE EP1446 END PANELS. THE ATTATCH THE SF41442 AND SF21442 SHELF TO THE END PANELS ABOUT 14 TO 15 HOLES APART AND WITH SF41442 IN THE MIDDLE.

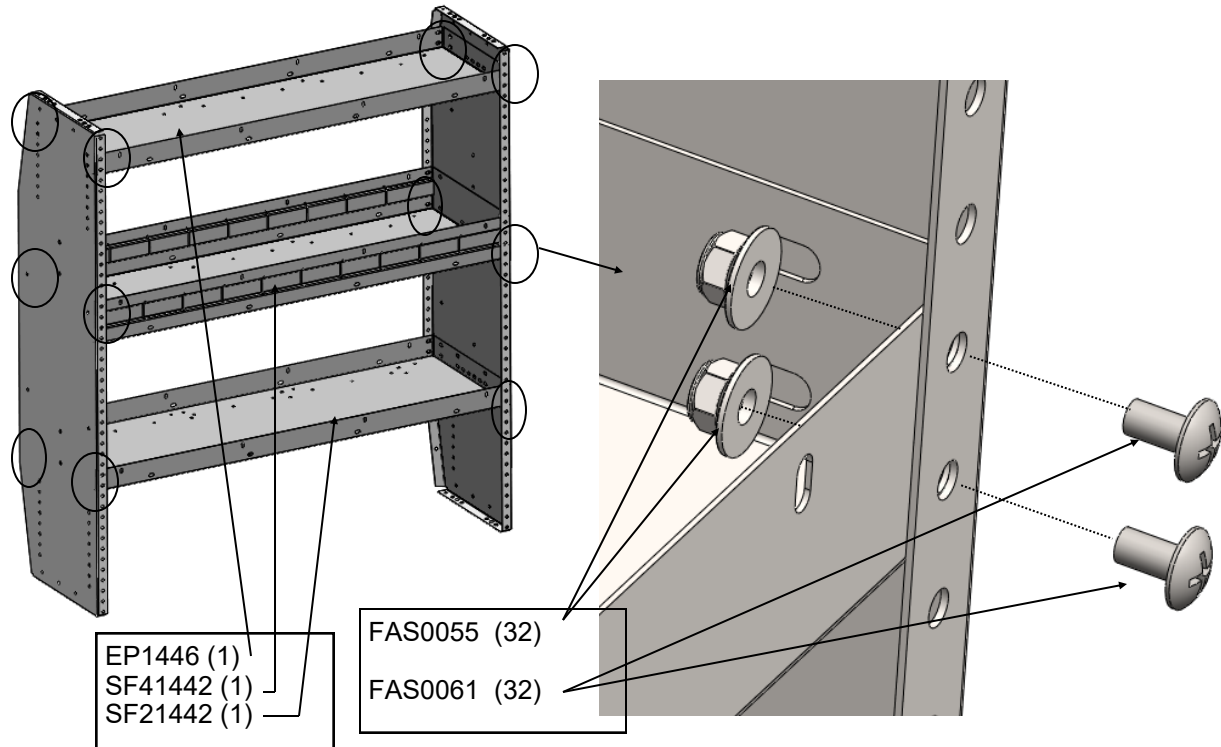

**Step 02** USE THE FAS0055 AND FAS0061 TO FASTEN THE FR42 FLOOR RAIL TO THE FRONT BOTTOM 2 HOLES ON THE END PANELS.

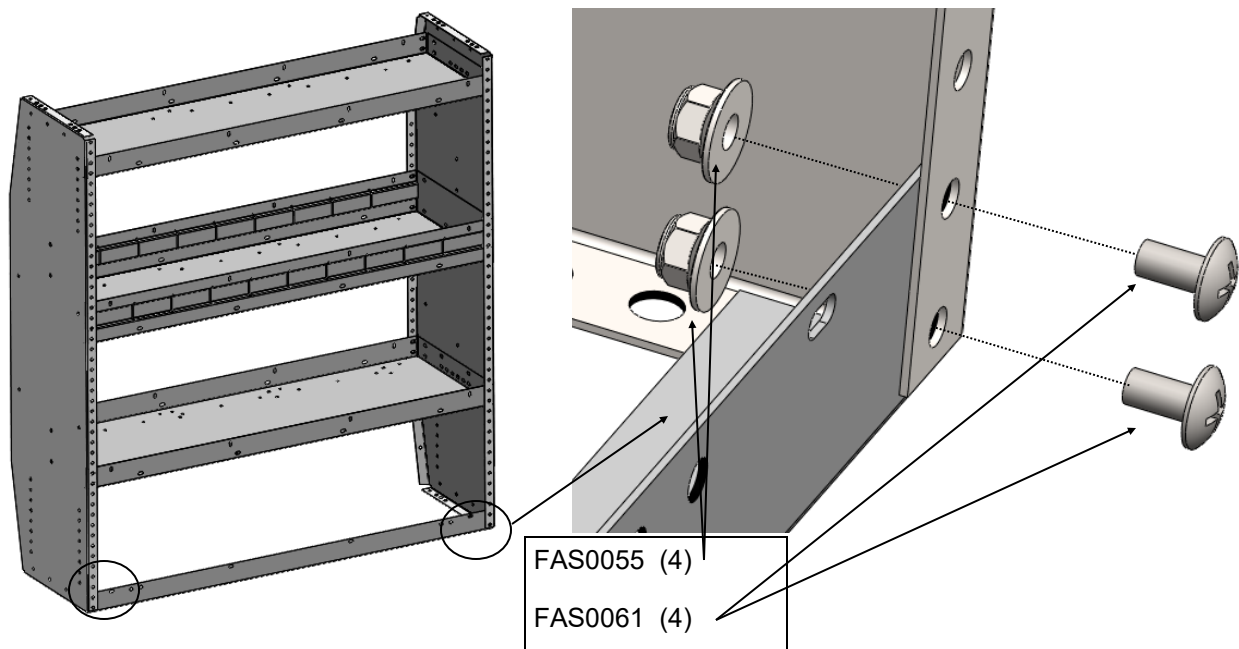

**Step 3** USE COMMON INSTALATION TO VEHICLE TO FASTEN THE UNIT DOWN. 4 FAS0052 (PLUSNUTS), FAS0086 (FLAT WASHER), AND FAS0078 (1/4 20X1" HEX BOLT) WILL BE USED TO SECURE THE UNIT (ONE SET IN EACH CORNER TO THE FLOOR).

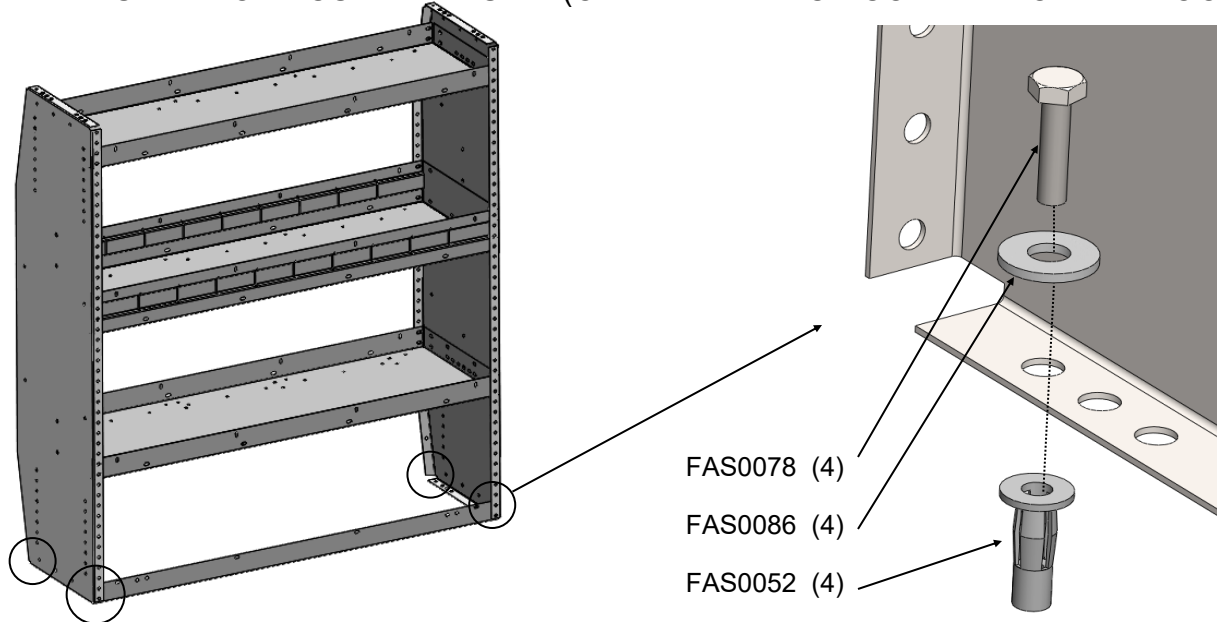

**Step 4** ATTACH THE 2 GS6X6 GUSSETS TO THE SIDE OF UNIT USING THE FAS0055 AND FAS0061 FASTENERS.

BACK

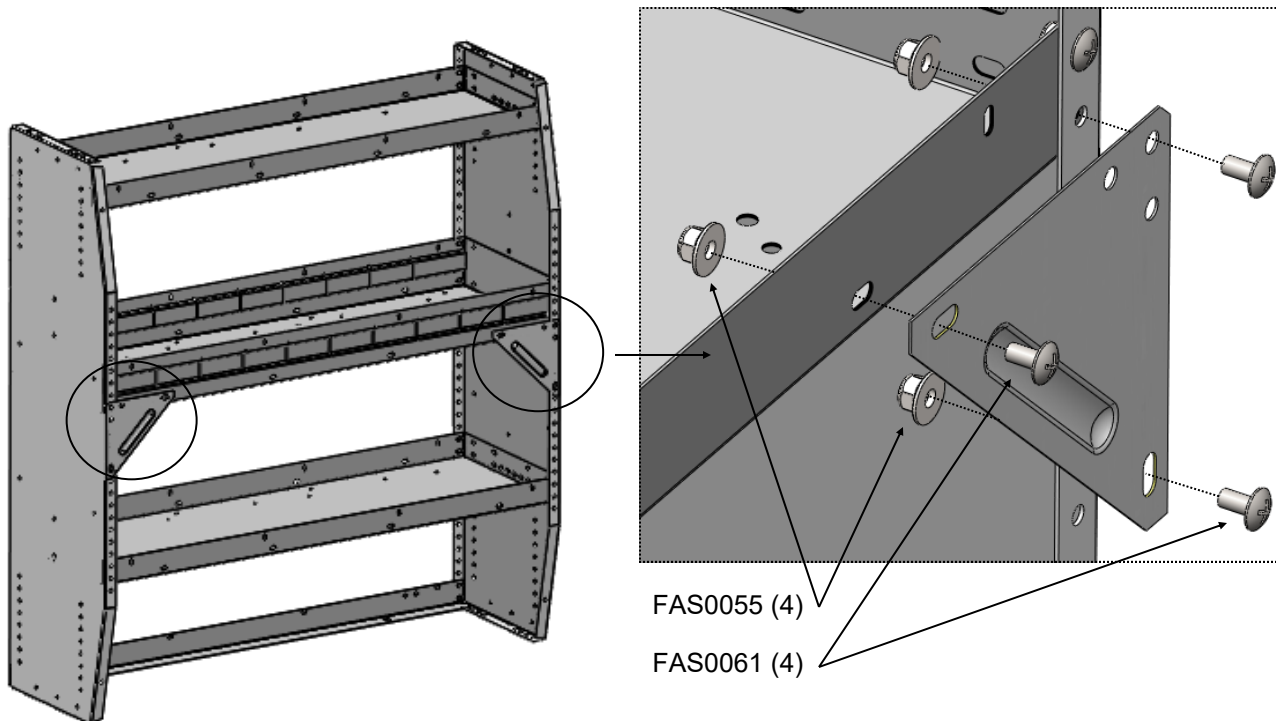

**DOUBLE CHECK ALL FASTENERS LOCATIONS TO BE SURE THAT ALL FASTENERS ARE TIGHTENED TO SPECIFICATIONS.  
YOUR INSTALLATION IS NOW COMPLETE!  
STOW THIS COPY IN THE VEHICLE FOR FUTURE REFERENCES!**

**Step 5** IF THE UNIT IS BEING MOUNTED TO A SIDE WALL USE MB118 MOUNT (4) AND MB120 STRAP BRACKET (2) TO SECURE THE UNIT. **ANY COMBINATION OF HOLES ARE ACCEPTABLE FOR MOUNTING.**

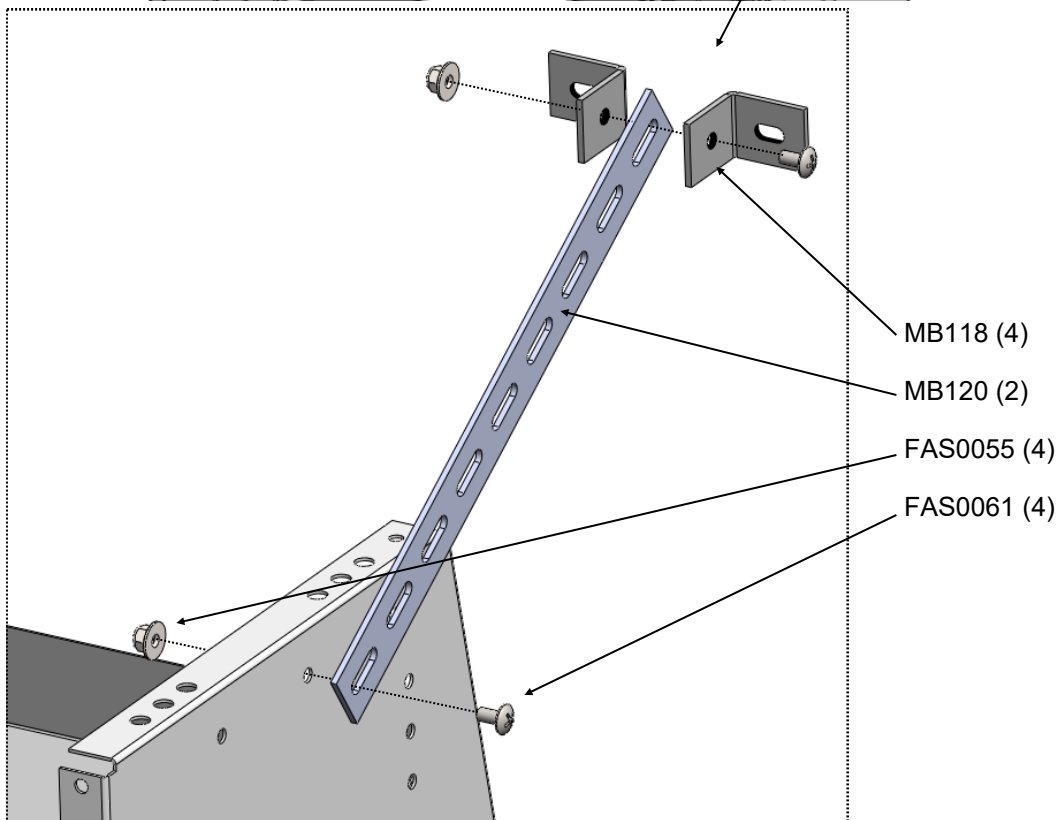
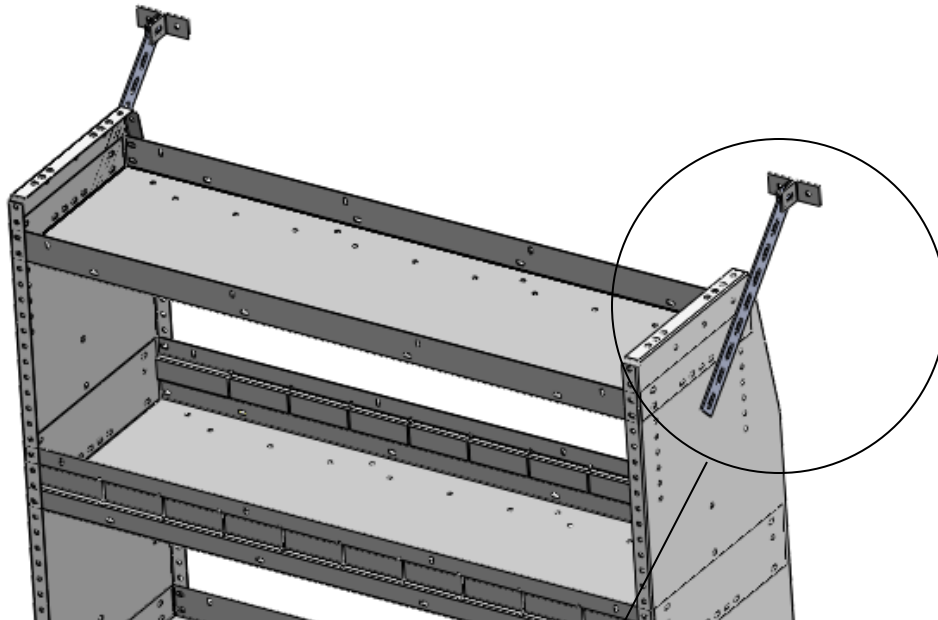

**DOUBLE CHECK ALL FASTENERS LOCATIONS TO BE SURE THAT ALL FASTENERS ARE TIGHTENED TO SPECIFICATIONS.**  
**YOUR INSTALLATION IS NOW COMPLETE!**  
**STOW THIS COPY IN THE VEHICLE FOR FUTURE REFERENCES!**