

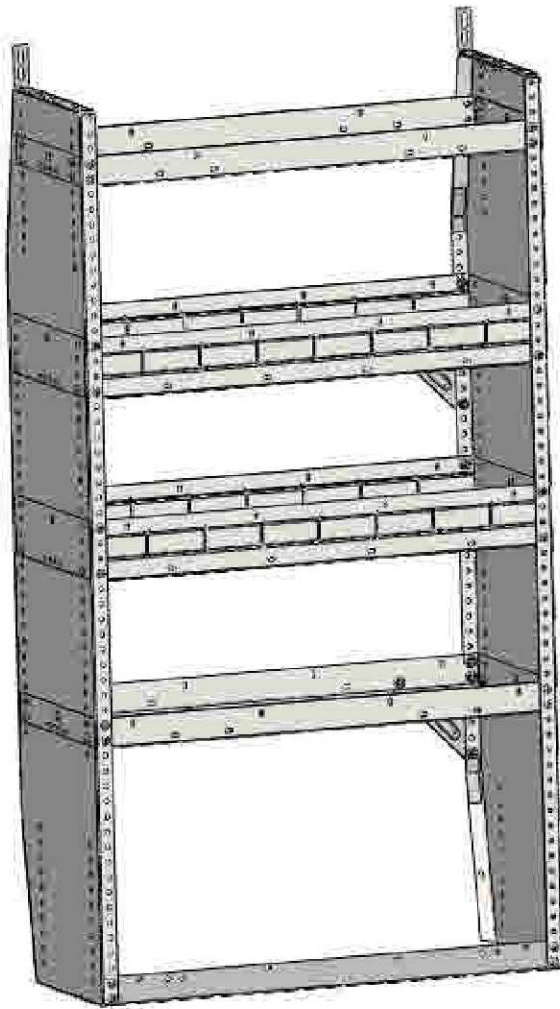

ADRIAN STEEL®

Cargo Management Solutions for Commercial Vehicles

HD UNIT, 14 X 59 X 32 WIDE



PRODUCT WEIGHT
76 Lbs.

WIDTH x DEPTH x HEIGHT

32 x 14 x 59

CAPACITY

Shelf lip up, 100
Lbs/shelf evenly
distributed.
Shelf lip down, 200
Lbs/shelf evenly
distributed.

COLOR

GRAY

CATALOG NUMBER

HD3259

PRODUCT FEATURES

This product is designed for installation in a higher roof vehicle, like the Chrysler Promaster, Ford Transit, Nissan NV.

This shelving unit uses a 14" deep end panel that is 59" tall that maximizes vehicle storage capacity. The top and bottom shelves are traditional bolt together shelves, and the middle shelves are the 4" deep heavy duty shelves.

SEE PAGE 2 FOR APPLICATION NOTES AND ACCESSORIES, OTHER PRODUCTS THAT WORK WITH THIS UNIT.

PAGE 1 of 2

The information contained in this document is the sole property of ADRIAN STEEL COMPANY. ADRIAN STEEL COMPANY retains the right to modify and/or change the product of its design at any time without prior notification.

**CATALOG NUMBER HD3259****PRODUCT APPLICATION**

This shelving unit uses a 14" deep end panel that is 59" tall that maximizes vehicle storage capacity. The top and bottom shelves are traditional bolt together shelves, and the middle shelves are the 4" deep heavy duty shelves.

ACCESSORIES THAT WILL WORK WITH THIS PRODUCT

CATALOG NUMBER	DESCRIPTION
DC6	DRAWER COMPONENT 6" WIDE
DC12	DRAWER COMPONENT 12" WIDE
9	4-DRAWER SHALLOW
19	2-DRAWER MEDIUM
919	3-DRAWER COMBO
UH50	HOOK, 5"
UH10	UTILITY HOOK, 1"
UH25	UTILITY HOOK, 2.5"
UH50	HOOK, 5"
TA1	FOUR HOOK BAR
DK3008	DOOR KIT, 8"
DK3010	DOOR KIT, 10"

SPECIAL APPLICATION NOTES

Additional accessories may be compatible with this product. Please consult with ADRIAN STEEL ENGINEERING to review specific applications not listed here.

PAGE 2 of 2

The information contained in this document is the sole property of ADRIAN STEEL COMPANY. ADRIAN STEEL COMPANY retains the right to modify and/or change the product of its design at any time without prior notification.

Introduction / Comments:

Knock Down Shelving for High roof vehicles. These units have tall end panels and use formed shelves at the top and bottom. The center shelves use the 4” deep shelving.

Note:

It is advised that all fasteners used in this assembly and installation should be checked for tightness at the following intervals: @ 2-weeks and again @ 6-weeks of operation. This preventive maintenance step must be completed to ensure your Partition gives you long service life.

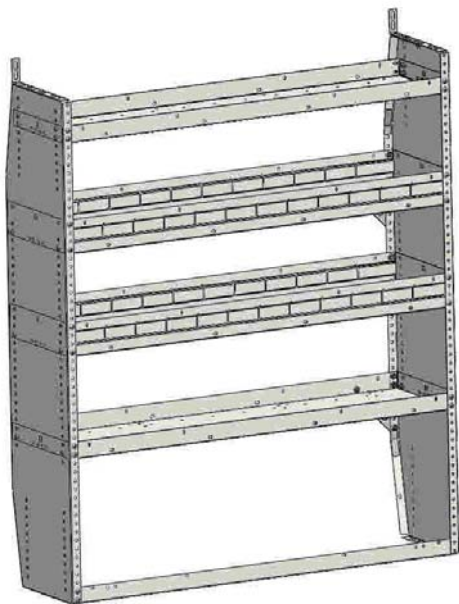

**HD5059
HD UNIT,
14”D x 59”H x 50”W**

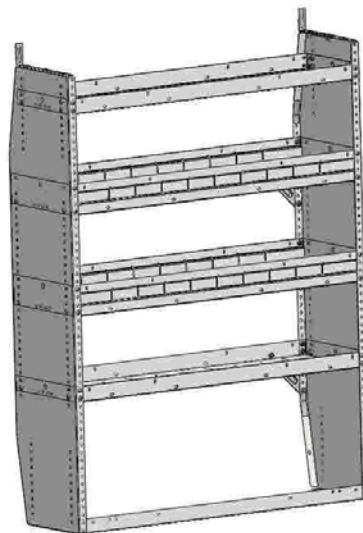

**HD4459
HD UNIT,
14”D x 59”H x 44”W**

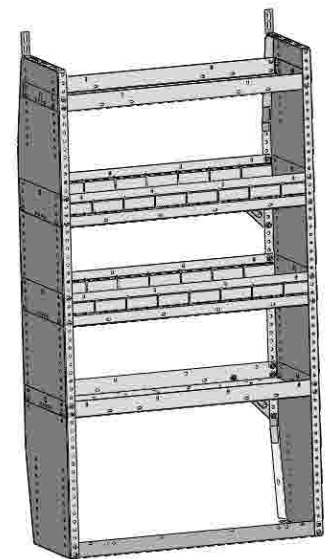

**HD3259
HD UNIT,
14”D x 59”H x 32”W**

- PRECAUTIONS -



CAUTION



**THE USE OF AIR IMPACT TOOLS CAN
OVER-TORQUE FASTENERS AND
CAUSE FASTENER FAILURE!**



CAUTION



**ALL INSTALLATION HOLES SHOULD BE SEALED
WITH SILICON OR BUTYL SEALANT TO PREVENT
EXHAUST FUMES FROM ENTERING THE VEHICLE!**



DANGER



**INSPECT FOR FUEL TANK, FUEL LINES, BRAKE LINES, HIGH
VOLTAGE BATTERIES AND ELECTRICAL LINES PRIOR TO
DRILLING TO AVOID DAMAGING CRITICAL VEHICLE SYSTEMS
OR INJURY TO INSTALLER DURING INSTALLATION PROCESS!**



CAUTION



**TO AVOID DAMAGING THE VEHICLE ALWAYS
USE DRILL STOPS WHEN DRILLING ANY IN-
STALLATION HOLES!**



- IMPORTANT WARRANTY REQUIREMENTS -

1. SUBSTITUTING ADRIAN STEEL SPECIFIED FASTENERS FOR ASSEMBLY AND/OR INSTALLATION WILL VOID YOUR PRODUCT WARRANTY.
2. ALL HOLES DRILLED INTO VEHICLE SHOULD HAVE THE RAW METAL EDGES SEALED WITH A SELF-ETCHING PRIMER TO RESIST CORROSION AND POTENTIAL FASTENER POINT FAILURE.
3. ALL FASTENERS USED IN THE INSTALLATION OF THIS PRODUCT SHOULD BE TIGHTENED TO THE TORQUE(S) SPECIFIED IN THESE INSTRUCTIONS.
4. THESE INSTRUCTIONS SHOULD BE KEPT WITH THE VEHICLE.

THE BASIC TOOLS NEEDED FOR MOST INSTALLATIONS



DRILL



DRILL BIT WITH
STOP



RATCHET, SOCKETS
AND/OR WRENCHES



SCREWDRIVERS



MEASURING TAPE

ADDITIONAL TOOLS MAY BE NEEDED FOR THIS INSTALLATION AND THEY WILL BE IDENTIFIED IN THE STEPS THAT FOLLOW.

If your vehicle contains carpet or a rubber floor mat you will need to prepare the mounting location. Position the product to be installed into the vehicle and once you are satisfied with the mounting locations, mark the mounting locations. Using a 1-3/16" diameter carpet cutter (P/N: 31183-0). Select the appropriate floor spacers as shown in the illustration. Set those aside for use later into the installation process.

Using the correct drill bit size for the selected plusnut, drill the mounting holes in the vehicle sheet metal to prepare for installing the plusnuts.

If you are thru-bolting at any of the locations simply drill a hole that is 1/16" larger than the bolt size(s) for those locations.

Once you have drilled the holes into the vehicle, the raw metal edges should be sealed using a self-etching primer to resist corrosion and potential fastener point failure.

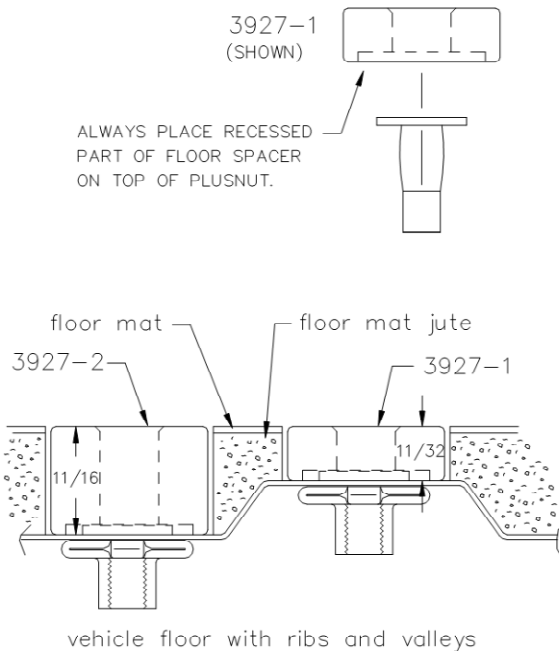

A PLUSNUT (RIVNUT) SETTING TOOL IS REQUIRED FOR PLUSNUT (RIVNUT) INSTALLATION AND IS SUPPLIED WITH THIS KIT. OR USE AN AIR POWERED PLUSNUT SETTING GUN.

1/4-20UNC Plusnut (FAS0052) Use 3/8" dia. drill w/stop

FAS0080 SCREW, HXHD, 1/4-20UNCx2.00", G8

FAS0067 WASHER, FLAT, 1/4"ID

22200-0 PLUSNUT TOOL

5/16-18UNC Plusnut (FAS0091) Use 1/2" dia. drill w/stop

FAS0095 SCREW, HXHD, 5/16-18UNCx2.00", G8

FAS0086 WASHER, FLAT, 5/16"ID

22200-0 PLUSNUT TOOL

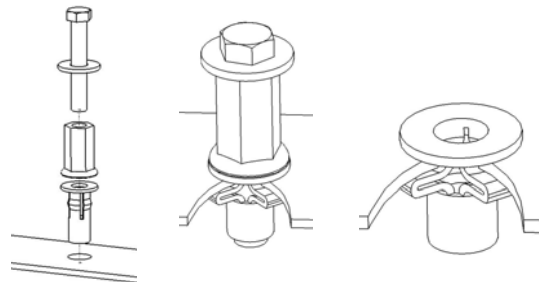

Place barrel of the plusnut body in sheet metal thru hole until flange is flush with sheet metal.

Using a 9/16" combination wrench of plusnut tool body and a second hand wrench, ratchet, or air tool, rotate the hex bolt head CW to draw plus nut flanges up (set the plusnut).

Assembly and Installation Fastener Identification Sheet (BAG00026-0)

ITEM NO.	PART NUMBER	DESCRIPTION	QTY.
1	BAG0507-A	5" x 7" 3MIL AUTOBAG	1
2	FAS0061	Screw, Truss Hd. Ph, 1/4-20x0.50	68
3	FAS0055	Nut, Hex Flange,Nylock 1/4-20	68

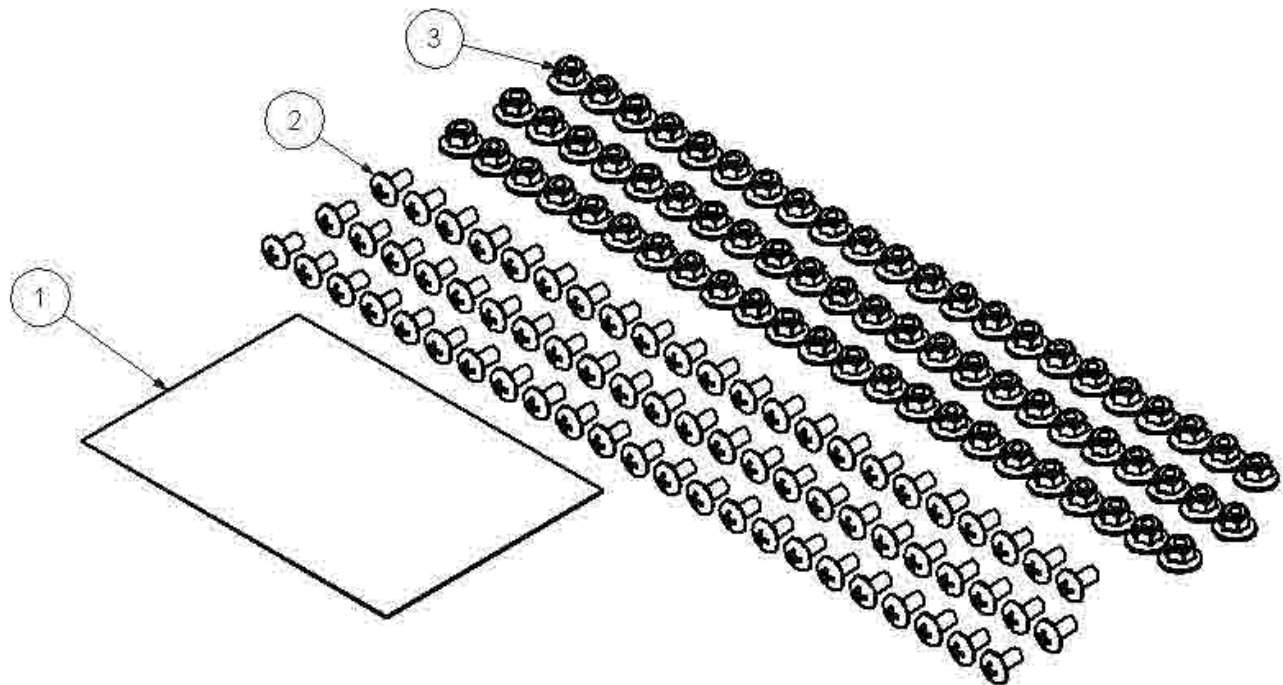

Component Hardware Identification Sheets

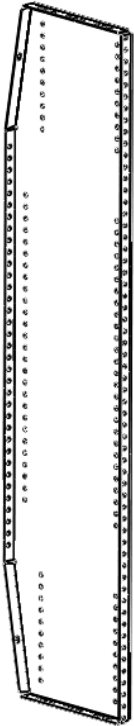

EP1459
END PANEL, 14" X 59"
Qty = 2
(HD3459, HD4459, HD5059)

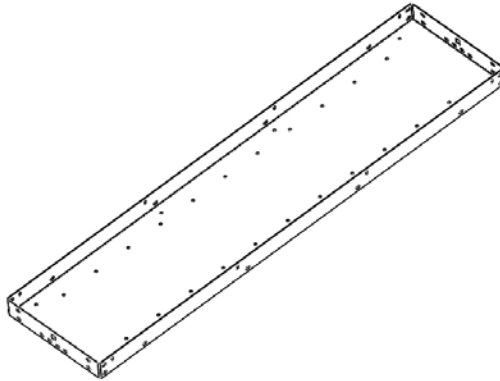

SF21250H-G (HD5059)
SF21244H-G (HD4459)
SF21232H-G (HD3259)

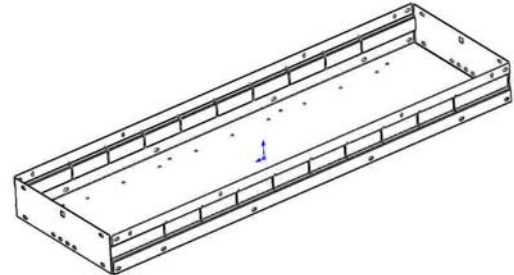

SF41450H-G (HD5059) QTY = 2
SF41444H-G (HD4459) QTY = 2
SF41432H-G (HD3259) QTY = 2

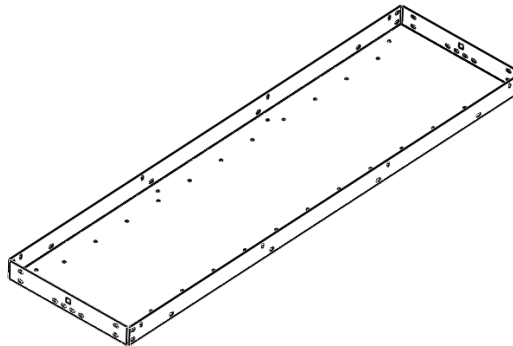

SF21450H-G (HD5059)
SF21444H-G (HD4459)
SF21432H-G (HD3259)

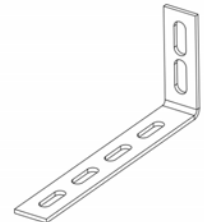

45739-G
MTG BRACKET, END PANEL
Qty = 2
(HD3259, HD4459, HD5059)

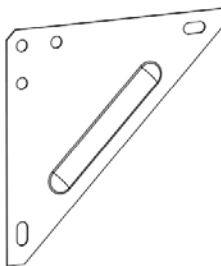

GS6X6
GUSSET, 6 X 6
Qty = 4
(HD3459, HD4459, HD5059)

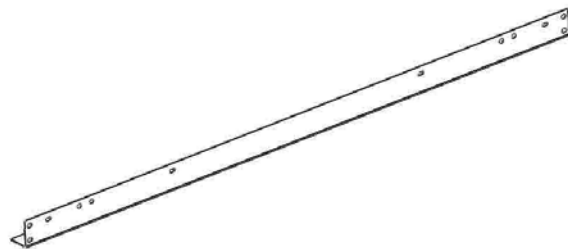

FR50 (HD5059)
FR44 (HD4459)
FR32 (HD3259)

STEP 1.0 Typical KD assembly.

USE YOUR PDS INSTRUCTIONS FOR EXACT SHELF LOCATIONS TO MEET THE CUSTOMER REQUIREMENTS.

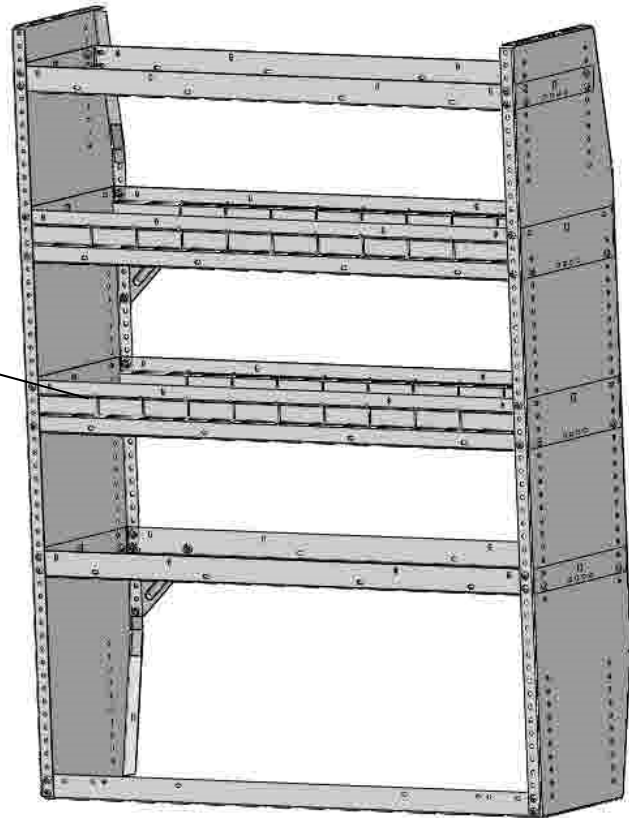

FRONT VIEW

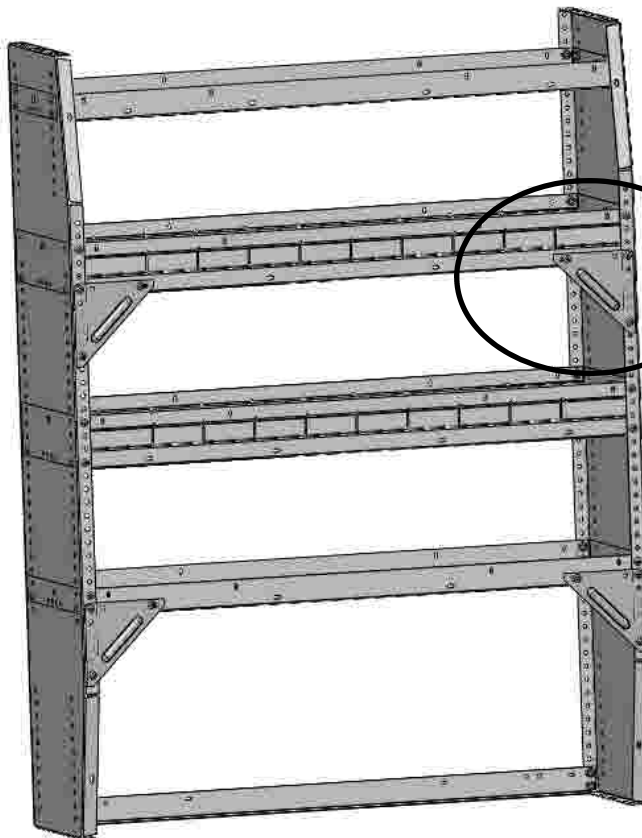

BACK VIEW

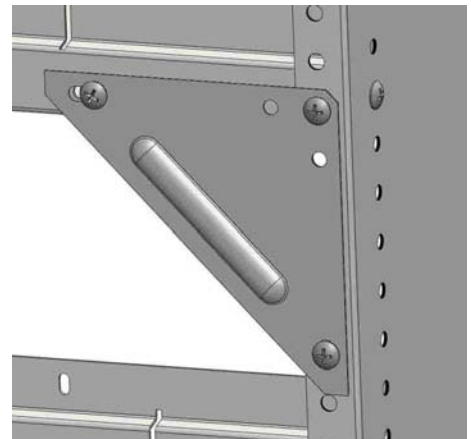

STEP 1.0 Typical assembly.

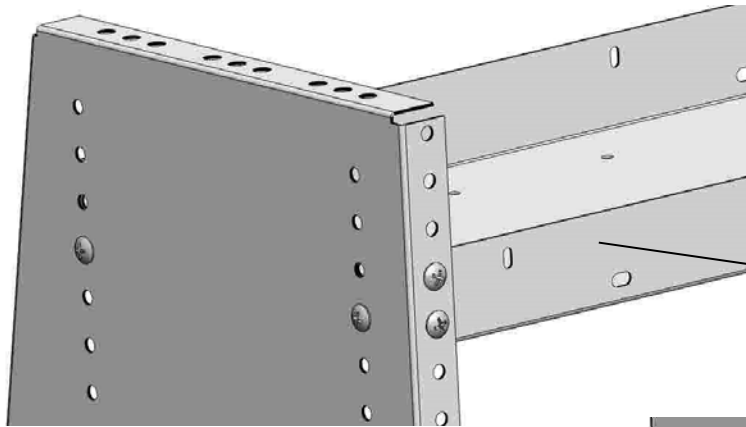

SF21250H-G (HD5059)
SF21244H-G (HD4459)
SF21232H-G (HD3259)

SECURE COMPONENTS
USING THE FASTENERS LISTED BELOW
AT LOCATIONS INDICATED
IN BOTTOM LEFT DETAIL VIEWS

FAS0061
SCREW, THP, 1/4-20UNC X 1/2"
FAS0055
NUT, HEX, FLNG, 1/4-20UNC

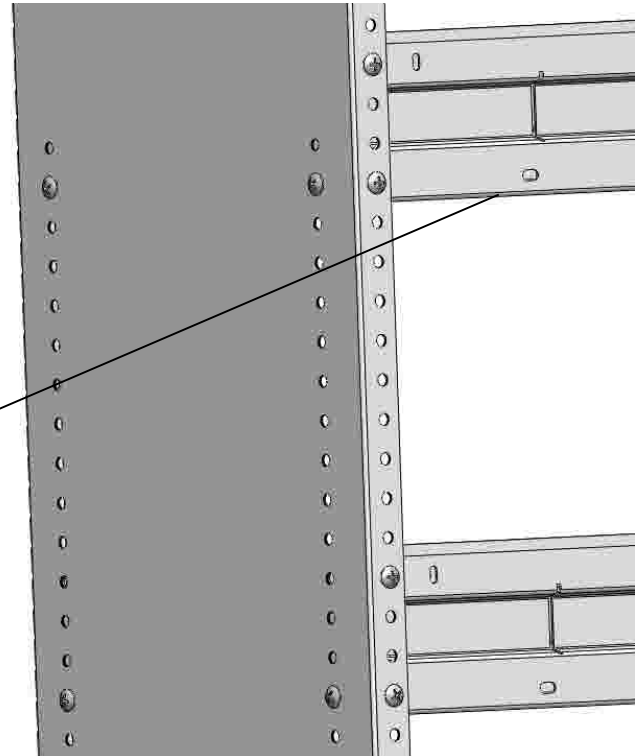

SF41450H-G (HD5059) QTY = 2
SF41444H-G (HD4459) QTY = 2
SF41432H-G (HD3259) QTY = 2

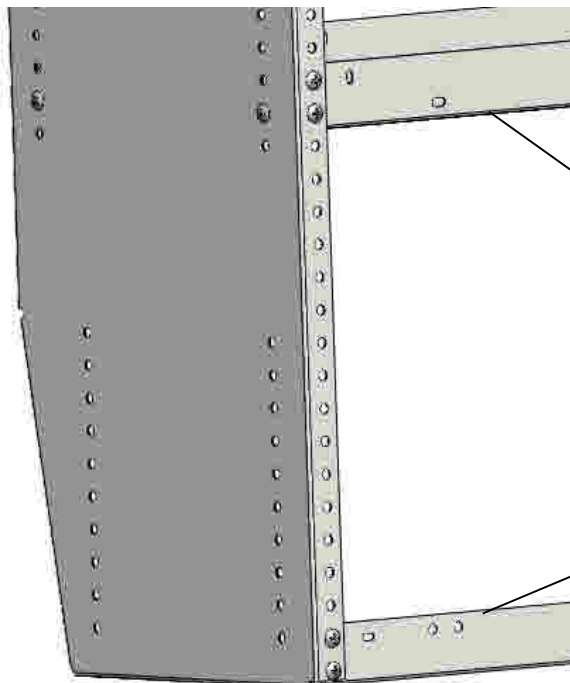

SF21450H-G (HD5059)
SF21444H-G (HD4459)
SF21432H-G (HD3259)

FR50 (HD5059)
FR44 (HD4459)
FR32 (HD3259)

STEP 4.0 "TYPICAL MOUNTING TO THE RAIL SYSTEM". Move the KD unit close to the vehicle wall to maximize cargo space. The rail bolts should be tightened before the top mounting brackets can be tightened
Fasteners listed below may be from the rail kit or the HDXX59 kit.

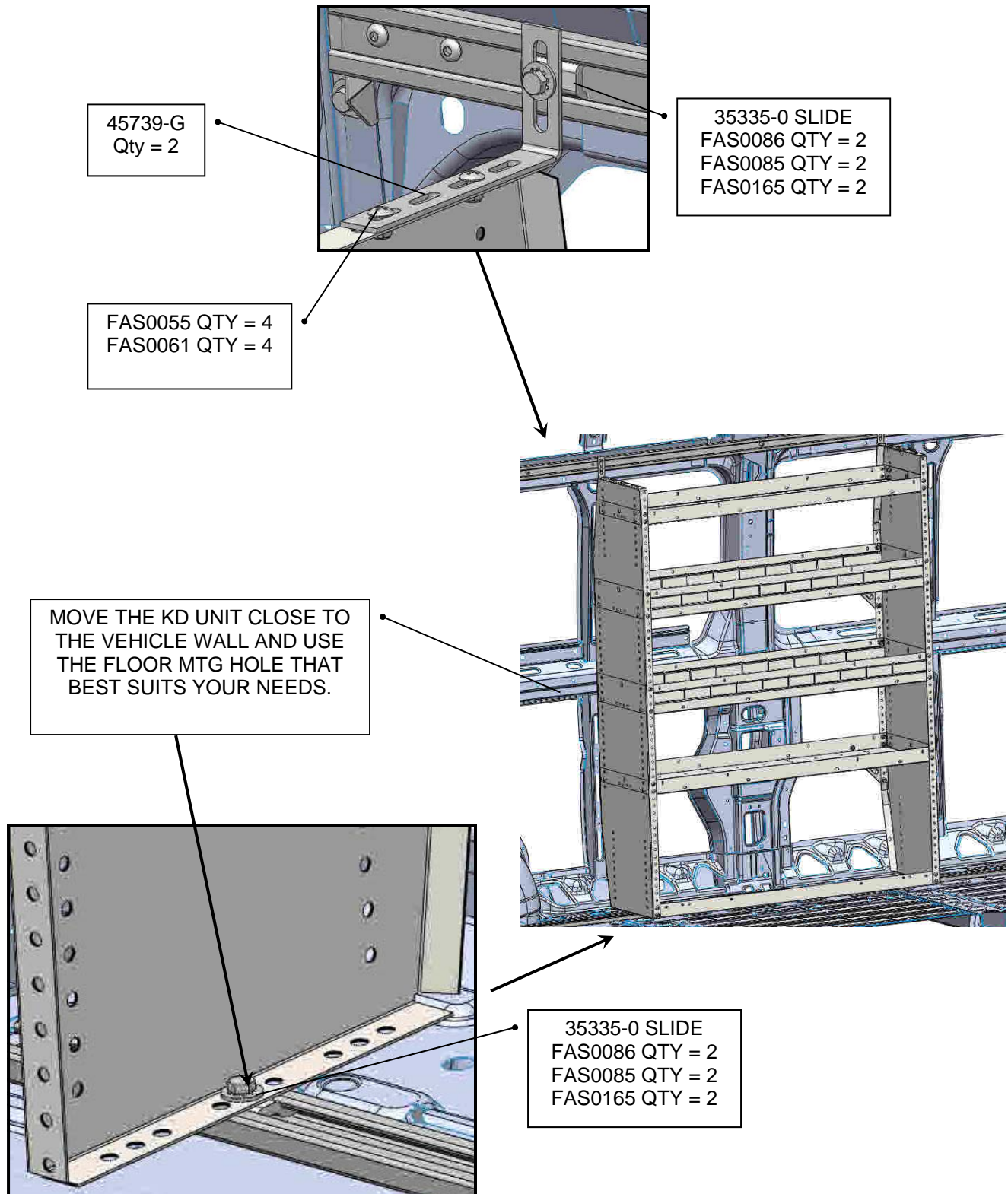

YOUR INSTALLATION IS NOW COMPLETE

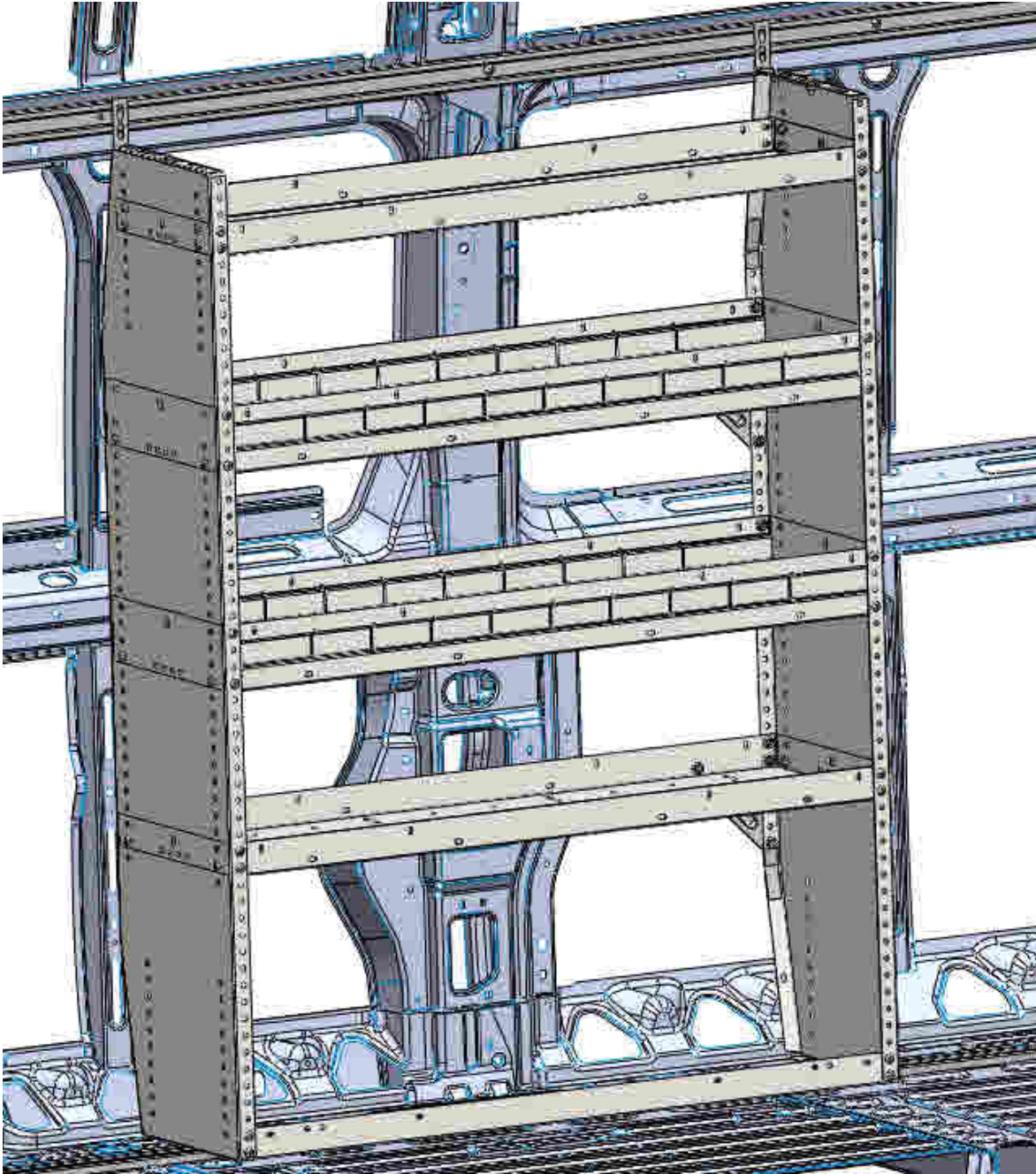

**DOUBLE CHECK ALL FASTENERS LOCATIONS TO BE SURE THAT ALL
FASTENERS ARE TIGHTENED TO SPECIFICATIONS.
YOUR INSTALLATION IS NOW COMPLETE!
STOW THIS COPY IN THE VEHICLE FOR FUTURE REFERENCES!**