

Introduction / Comments:

This Grease Gun Holder Asm (GGH-555E) is designed to fit in the Adrian Steel SMC partition and to accommodate grease guns with a 2.25" diameter barrel.

Note:

It is advised that all fasteners used in this assembly and installation should be checked for tightness at the following intervals: @ 2-weeks and again @ 6-weeks of operation. This preventive maintenance step must be completed to ensure your Partition gives you long service life.



**Grease Gun Holder Asm on SMC Partition Panel
GGH-555E**

- PRECAUTIONS -





 **CAUTION** 
**THE USE OF AIR IMPACT TOOLS CAN
OVER-TORQUE FASTENERS AND
CAUSE FASTENER FAILURE!**



 **CAUTION** 
**ALL INSTALLATION HOLES SHOULD BE SEALED
WITH SILICON OR BUTYL SEALANT TO PREVENT
EXHAUST FUMES FROM ENTERING THE VEHICLE!**



 **DANGER** 
**INSPECT FOR FUEL TANK, FUEL LINES, BRAKE LINES, HIGH
VOLTAGE BATTERIES AND ELECTRICAL LINES PRIOR TO
DRILLING TO AVOID DAMAGING CRITICAL VEHICLE SYSTEMS
OR INJURY TO INSTALLER DURING INSTALLATION PROCESS!**



 **CAUTION** 
**TO AVOID DAMAGING THE VEHICLE ALWAYS
USE DRILL STOPS WHEN DRILLING ANY IN-
STALLATION HOLES!**



- IMPORTANT WARRANTY REQUIREMENTS -

1. SUBSTITUTING ADRIAN STEEL SPECIFIED FASTENERS FOR ASSEMBLY AND/OR INSTALLATION WILL VOID YOUR PRODUCT WARRANTY.
2. ALL HOLES DRILLED INTO VEHICLE SHOULD HAVE THE RAW METAL EDGES SEALED WITH A SELF-ETCHING PRIMER TO RESIST CORROSION AND POTENTIAL FASTENER POINT FAILURE.
3. ALL FASTENERS USED IN THE INSTALLATION OF THIS PRODUCT SHOULD BE TIGHTENED TO THE TORQUE(S) SPECIFIED IN THESE INSTRUCTIONS.
4. THESE INSTRUCTIONS SHOULD BE KEPT WITH THE VEHICLE.

THE BASIC TOOLS NEEDED FOR MOST INSTALLATIONS



DRILL



DRILL BIT WITH
STOP



RATCHET, SOCKETS
AND/OR WRENCHES



SCREWDRIVERS



MEASURING TAPE

ADDITIONAL TOOLS MAY BE NEEDED FOR THIS INSTALLATION AND THEY WILL BE IDENTIFIED IN THE STEPS THAT FOLLOW.

If your vehicle contains carpet or a rubber floor mat you will need to prepare the mounting location. Position the product to be installed into the vehicle and once you are satisfied with the mounting locations, mark the mounting locations. Using a 1-3/16" diameter carpet cutter (P/N: 31183-0). Select the appropriate floor spacers as shown in the illustration. Set those aside for use later into the installation process.

Using the correct drill bit size for the selected plusnut, drill the mounting holes in the vehicle sheet metal to prepare for installing the plusnuts.

If you are thru-bolting at any of the locations simply drill a hole that is 1/16" larger than the bolt size(s) for those locations.

Once you have drilled the holes into the vehicle, the raw metal edges should be sealed using a self-etching primer to resist corrosion and potential fastener point failure.

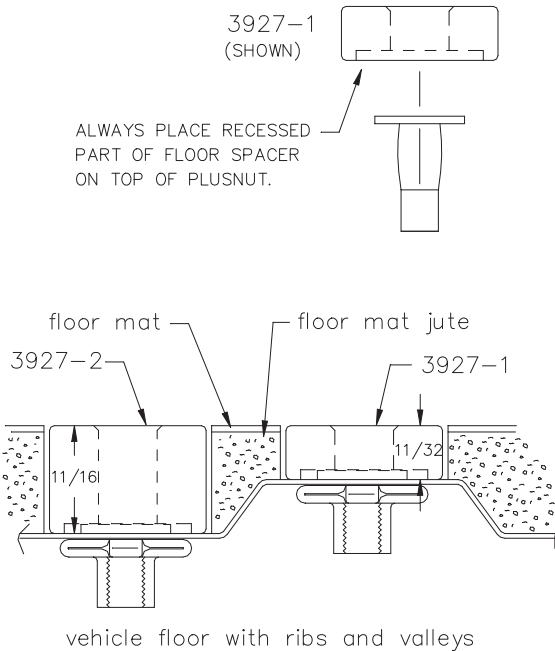

A PLUSNUT (RIVNUT) SETTING TOOL IS REQUIRED FOR PLUSNUT (RIVNUT) INSTALLATION AND IS SUPPLIED WITH THIS KIT. OR USE AN AIR POWERED PLUSNUT SETTING GUN.

1/4-20UNC Plusnut (FAS0052) Use 3/8" dia. drill w/stop
 FAS0080 SCREW, HXHD, 1/4-20UNCx2.00", G8
 FAS0067 WASHER, FLAT, 1/4"ID
 22200-0 PLUSNUT TOOL

5/16-18UNC Plusnut (FAS0091) Use 1/2" dia. drill w/stop
 FAS0095 SCREW, HXHD, 5/16-18UNCx2.00", G8
 FAS0086 WASHER, FLAT, 5/16"ID
 22200-0 PLUSNUT TOOL

Place barrel of the plusnut body in sheet metal thru hole until flange is flush with sheet metal. Using a 9/16" combination wrench of plusnut tool body and a second hand wrench, ratchet, or air tool, rotate the hex bolt head CW to draw plus nut flanges up (set the plusnut).

**GGH-555E
GREASE GUN HOLDER ASM**

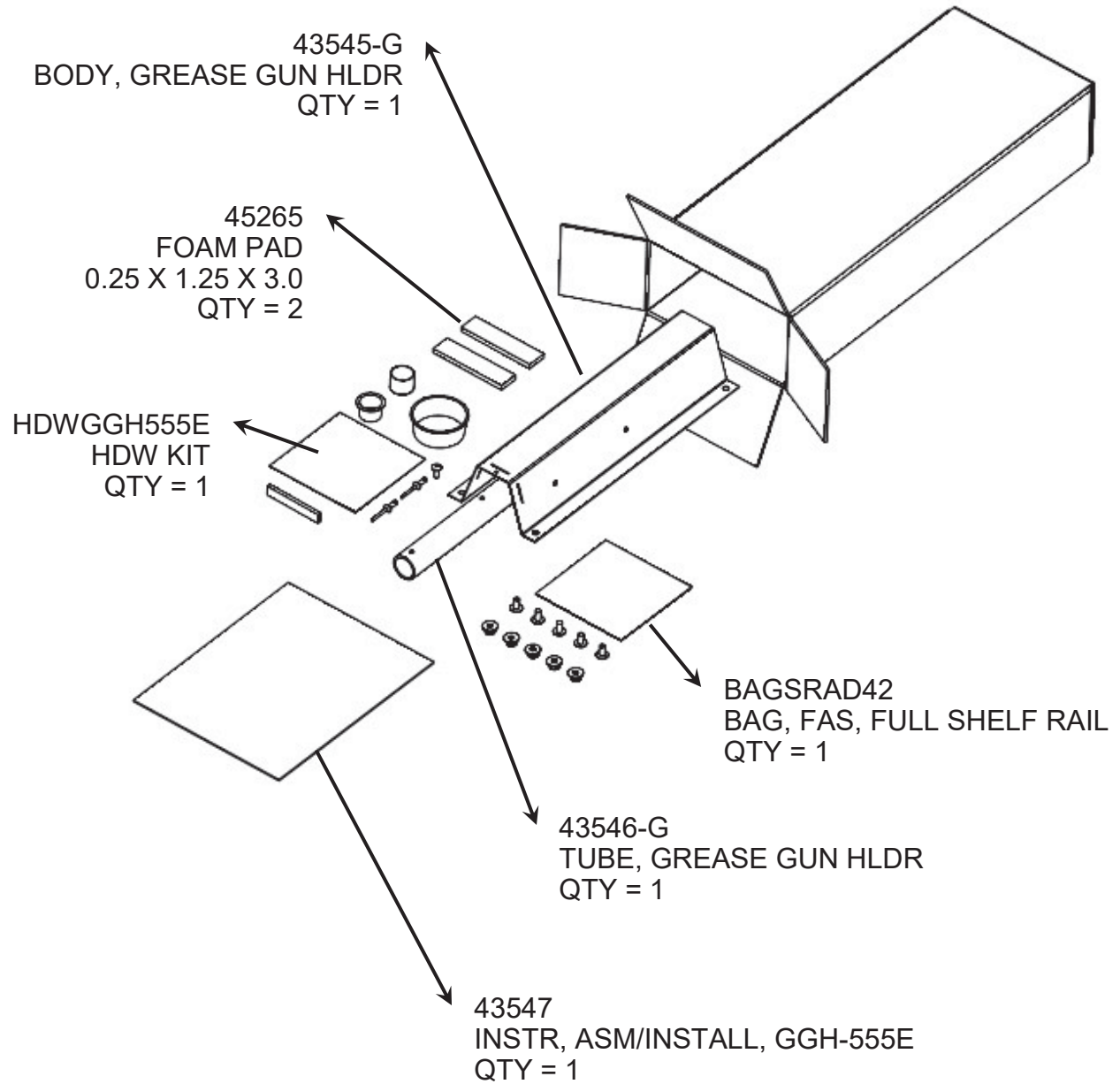

**HDWGGH555E
HARDWARE KIT, GGH-555E**

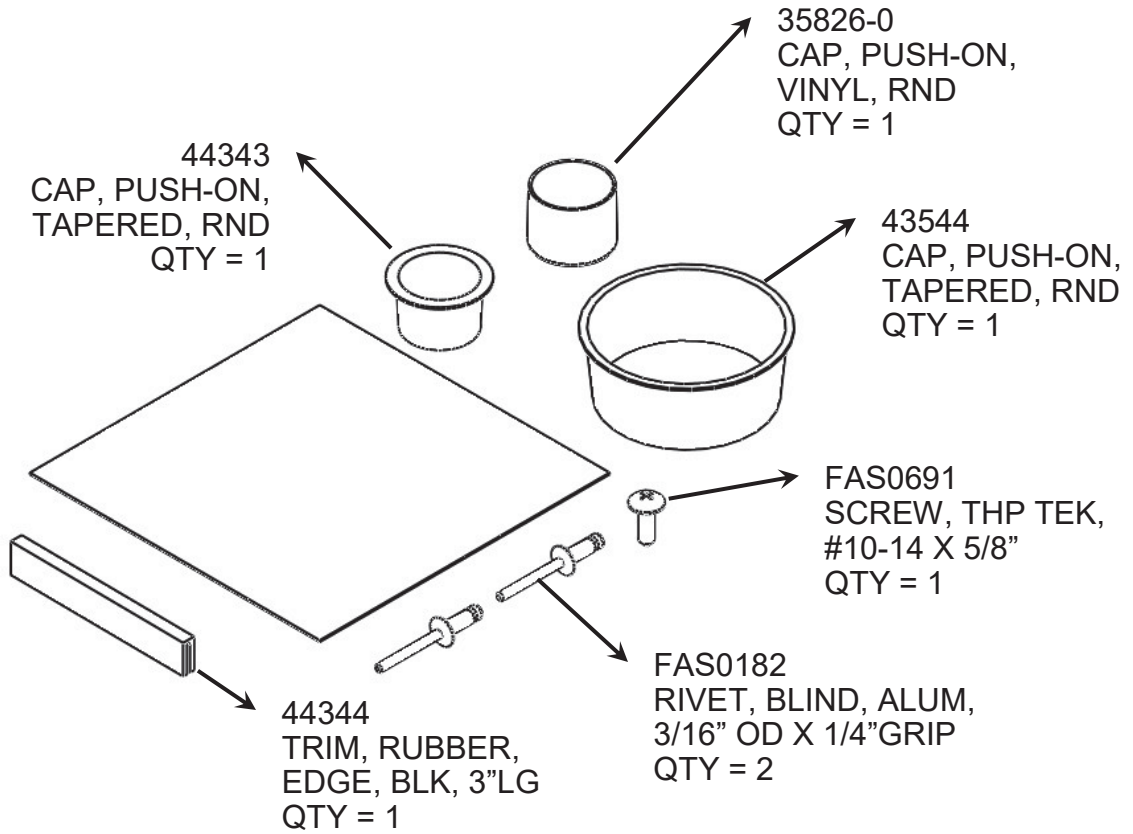

**BAGSRAD42
BAG, FAS, FULL SHELF RAIL**

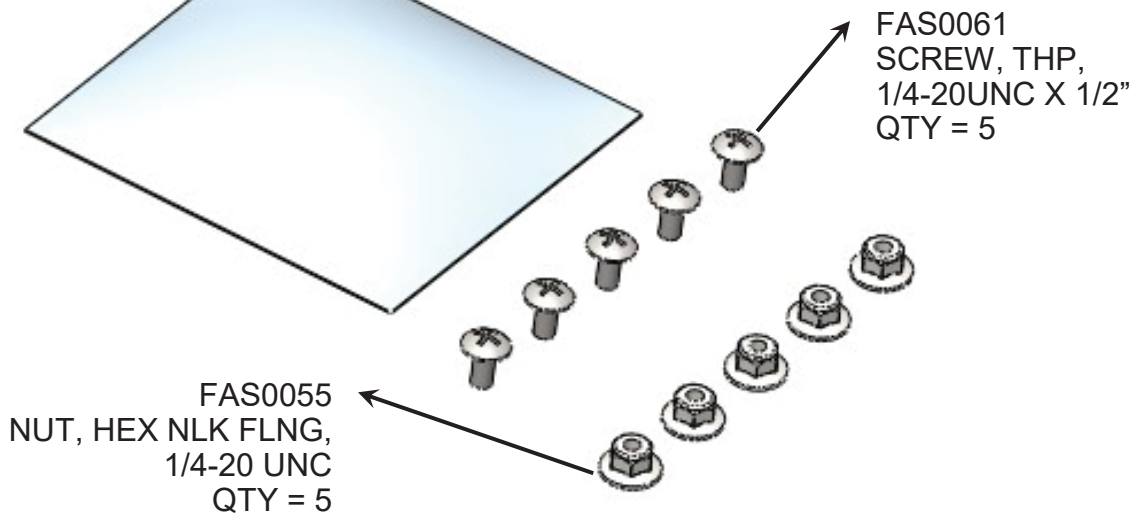

STEP 01 "SECURE TUBE TO BODY"

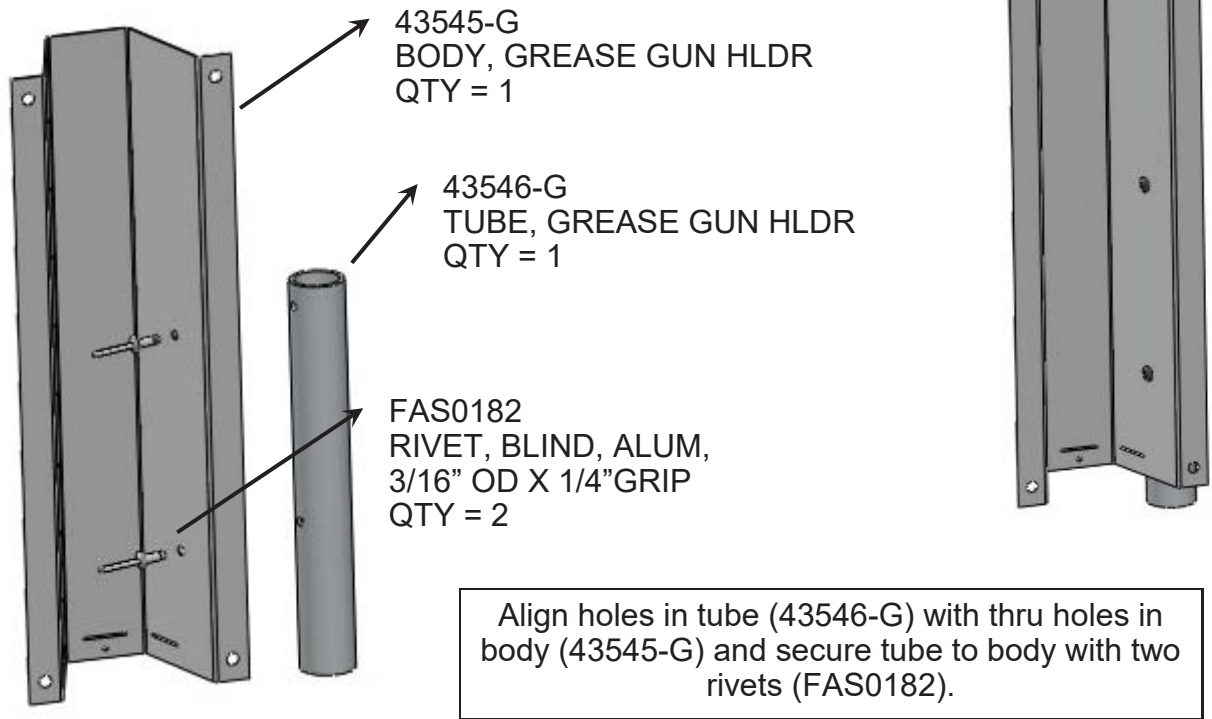

STEP 02 "SECURE CAPS TO TUBE & BODY"

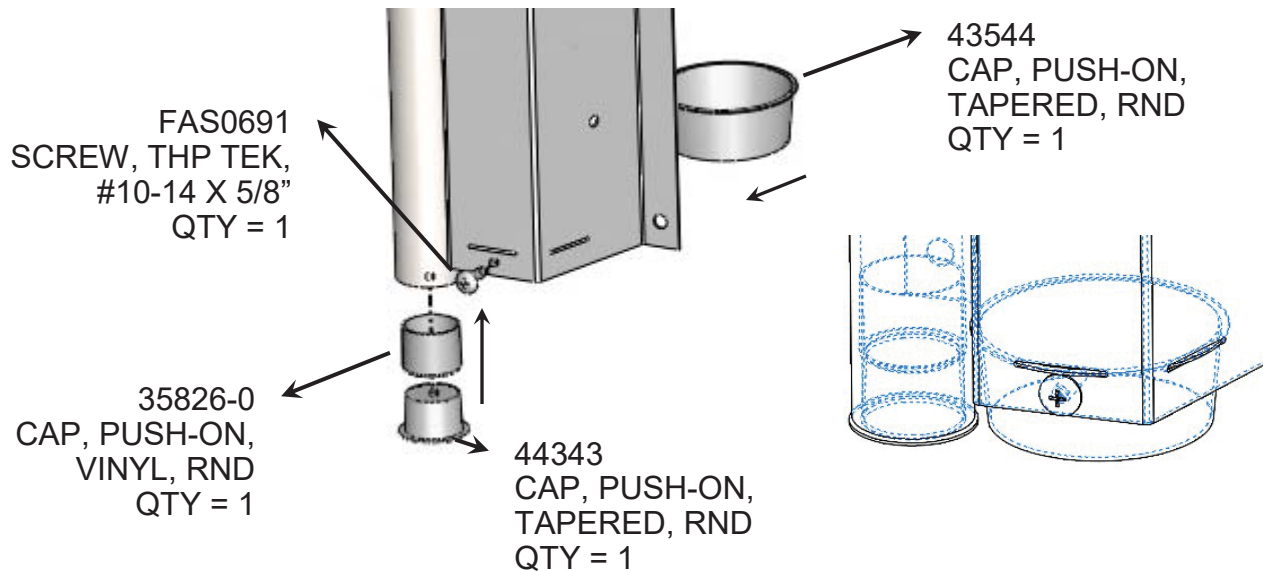

STEP 03 "INSTALL GGH-555E ON PARTITION PANEL"

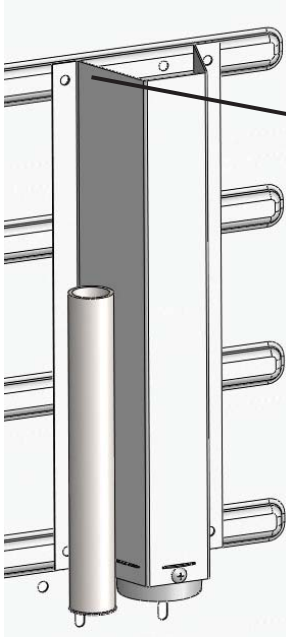

ALIGN THE UPPER LEFT THRU HOLE IN THE BODY WITH THE EXISTING HOLE IN THE SMC PARTITION PANEL.

MARK THE REMAINING THREE HOLES WITH MARKER PEN AND SET UNIT ASSIDE AT THIS TIME.

CENTER PUNCH MARKED HOLES

DRILL THREE 0.281" DIAMETER THRU HOLES IN PARTITION PANEL, DEBURR HOLES A/R

STEP 04 "INSTALL FOAM PAD (45265) ON PARTITION PANEL"

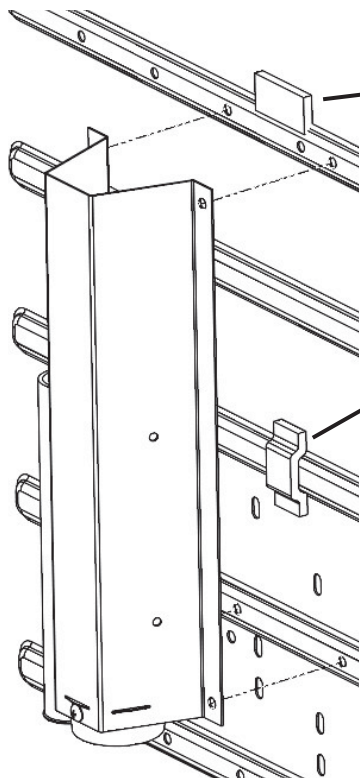

45265
FOAM PAD, 0.25 X 1.25 X 3.0
QTY = 1
TRIMMED TO 1.5" LONG

45265
FOAM PAD, 0.25 X 1.25 X 3.0
QTY = 1
TRIMMED TO 1.5" LONG

Cut one piece of the 3" long foam pad (45265) into two pieces each 1.5" long. Remove adhesive backing liner and apply to the partition panel as shown at left

STEP 05 "INSTALL "

Cut one piece of the 3" long foam pad (45265) into three pieces each approx. 1" long.

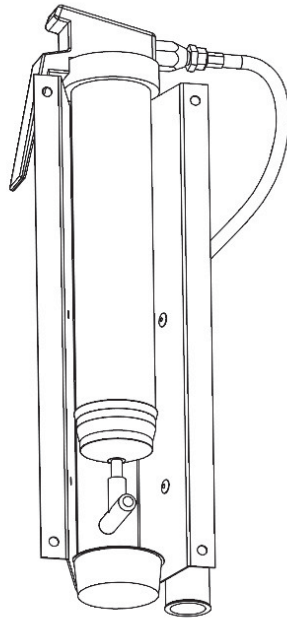

Insert grease gun into the body (43545-G) as shown at left

43545-G
BODY, GREASE GUN HLDR
QTY = 1

45265
TRIMMED TO
APPROX. 1" LG
QTY = 3

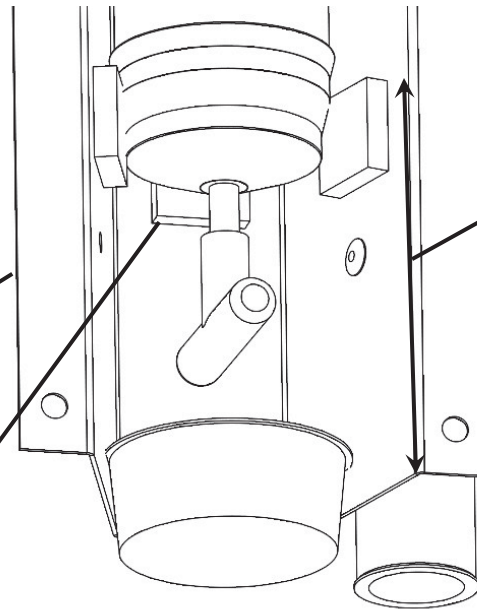

Approx.
4-1/2"

Remove adhesive backing liner and apply the foam pad (trimmed to 1" lg) to the inside surface of the body (43545-G) as shown above. (3-pl total)

STEP 06 "INSTALL "

Cut the three inch long piece of the rubber edge trim (44344) into three pieces each approx. one inch long. Position on the top edge of the body (43545-G) as shown. Secure in place with small drop of instant adhesive.

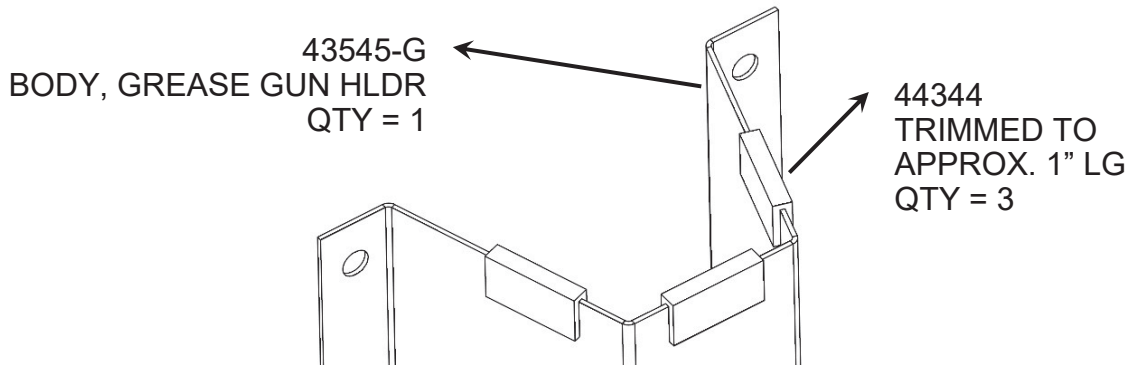

STEP 07 "INSTALL "

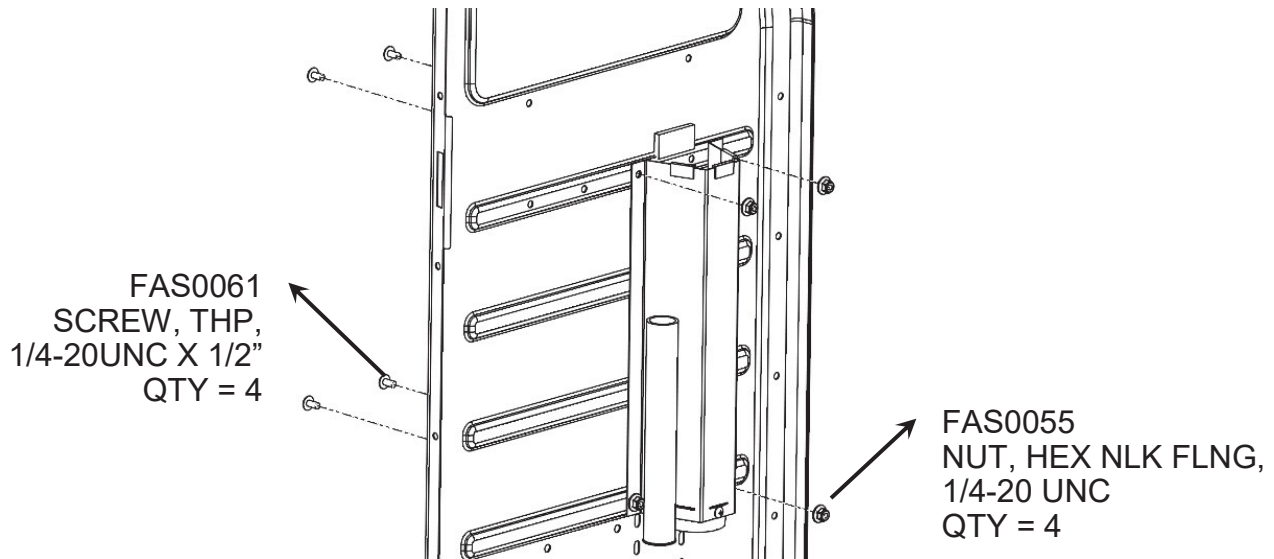

Re-align holes in GGH-555E and the partition panel and secure to the panel using the fasteners indicated