



**ADRIAN STEEL®**

Cargo Management Solutions for Commercial Vehicles

## ***SINGLE HVAC GAUGE COVER***

***PRODUCT WEIGHT***

**4.87 LBS**

***WIDTH X DEPTH X HEIGHT***

**11.0" X 3.5" X 10.0"**

***CAPACITY***

**1 SET OF HVAC GAUGES**

***COLOR***

**GRAY**

***CATALOG NUMBER***

**GC1**

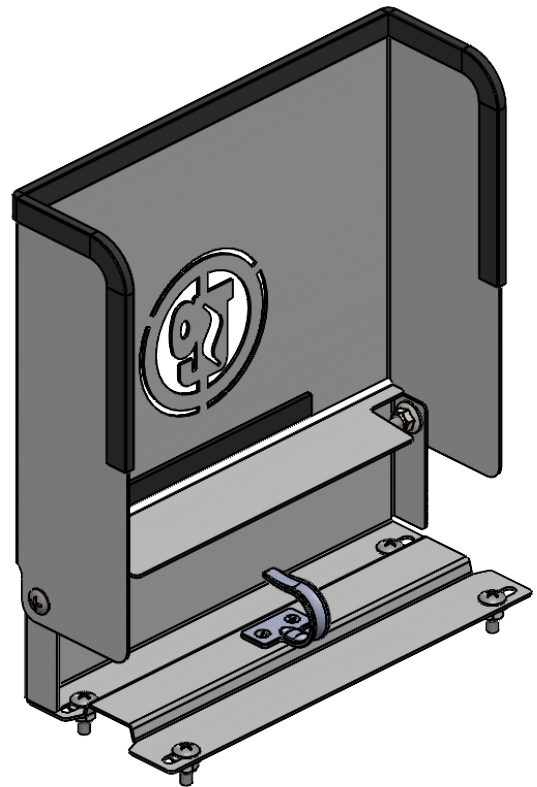

### **PRODUCT FEATURES**

***THIS PRODUCT IS USED TO STORE HVAC GAUGES AND REDUCE THE LIKELIHOOD OF IMPACT AND DAMAGE IN THE VEHICLE.***

***WHILE THIS IS CONSIDERED A UNIVERSAL ITEM THAT CAN BE INSTALLED TO ANY SURFACE, THE MOUNTING HOLES ARE OPTIMIZED FOR HAD SERIES AND 16" HD SERIES END PANELS.***

SEE PAGE 2 FOR APPLICATION NOTES, ACCESSORIES AND OTHER PRODUCTS THAT WORK WITH THIS UNIT.



## ***SINGLE HVAC GAUGE COVER***

***CATALOG NUMBER***

**GC1**

### ***PRODUCT APPLICATION***

***THIS PRODUCT IS USED TO STORE HVAC GAUGES AND REDUCE THE LIKELIHOOD OF IMPACT AND DAMAGE IN THE VEHICLE.***

***WHILE THIS IS CONSIDERED A UNIVERSAL ITEM THAT CAN BE INSTALLED TO ANY SURFACE, THE MOUNTING HOLES ARE OPTIMIZED FOR HAD SERIES AND 16" HD SERIES END PANELS.***

### ***ACCESSORIES THAT WILL WORK WITH THIS PRODUCT***

<b><i>CATALOG NUMBER</i></b>	<b><i>DESCRIPTION (smart)</i></b>

The information contained in this document is the sole property of ADRIAN STEEL COMPANY. ADRIAN STEEL COMPANY retains the right to modify and/or change the product of its design at any time with prior notification.

INSTR. : <b>69990</b> NUMBER	PG: <b>1</b>	REV: <b>B</b>	ITEM NO.	PART NUMBER	DESCRIPTION	QTY.
PART : <b>GC1</b> NUMBER			1	47900	UTILITY HOOK	1
PART : HVAC GAUGE COVER KIT DESC. :			2	54691	TRIM PINCHWELD, #2 BLK, 34" lg	1
			3	65407	RUBBER STRIP 6.125", ADHESIVE BACK	1
			4	69988-G	HVAC GAUGE COVER, LID, GRAY	1
			5	69989-G	HVAC GAUGE COVER, BASE, GRAY	1

**THIS PRODUCT CAN BE MOUNTED TO MANY FACES IN AN UPFIT. AN ADRIAN STEEL END PANEL IS REPRESENTED IN THIS INSTRUCTION**

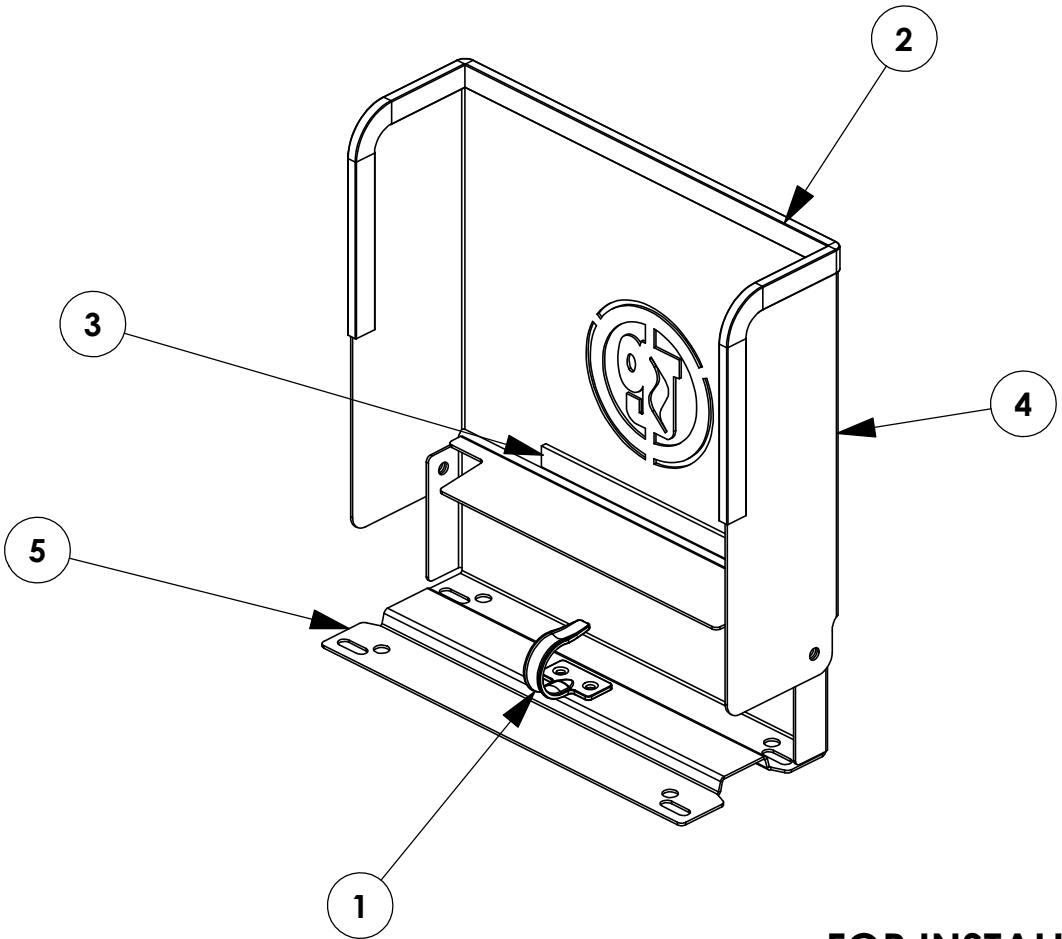

**FOR INSTALLATION ON NEW ASC END PANEL, SEE PAGE 5!**

**GET TO KNOW THE VEHICLE** - AT THE BEGINNING OF ANY INSTALLATION, CHECK THE LOCATION OF THE FUEL TANK, FUEL LINES, BRAKE LINES, HIGH VOLTAGE BATTERIES AND WIRING HARNESSSES TO AVOID INJURY OR PROPERTY DAMAGE FROM TOOL CONTACT.

**SEAL ALL EXTERIOR HOLES** - ALL INSTALLATION HOLES SHOULD BE SEALED WITH BUTYL TAPE OR SILICON TO PREVENT WATER AND EXHAUST GASES FROM ENTERING THE VEHICLE.

**CONTROL DRILL DEPTH** - TO AVOID DAMAGE TO THE VEHICLE, USE A DRILL STOP OR CLEARED STEP BIT WHEN DRILLING INSTALLATION HOLES.

**ALWAYS ADD PRIMER** - WHEN ADDING INSTALLATION HOLES BE SURE TO USE A SELF-ETCHING PRIMER TO PREVENT CORROSION, FASTENER FAILURE AND INJURY.

**MOUNTING POINTS MUST HAVE METAL-TO-METAL CONTACT** - USE PROVIDED MOUNTING SPACERS TO ACCOMMODATE FOR VEHICLE FEATURES, CARPET OR SUBFLOORS.

**PROVIDE CLEARANCE FOR SPACERS** - IF THE INSTALLATION VEHICLE CONTAINS A CARPET OR SUBFLOOR, USE A 1-3/16" DIAMETER CARPET CUTTER (P/N: 31183-0) AT ALL MOUNTING LOCATIONS TO OPEN UP ROOM FOR SPACERS.

**CHECK SPACER ORIENTATION** - BE SURE THAT THE INDENT IN THE SPACER COVERS THE PLUSNUT HEAD; THIS ENSURES THE MOST METAL-TO-METAL CONTACT AND REDUCES VIBRATION.

**PLUSNUT INSTALLATION** - A PLUSNUT GUN IS RECOMMENDED FOR PLUSNUT INSTALLATION FOR ITS PRODUCTION SPEED. HOWEVER, A PLUSNUT SETTING TOOL CAN ALSO BE USED (P/N: 22200-0).

**THRU-BOLT CLEARANCE** - WHEN USING A THRU-BOLT AT ANY MOUNTING LOCATION, BE SURE THAT YOUR HOLE HAS 1/16" CLEARANCE.

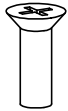
**FASTENERS USED  
BAG69987 AND BAGPEPACCMNT4**

**FAS0002  
#8-32 X .50  
FHP SCREW  
QTY: 2**

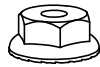

**FAS0013  
#8-32  
HFLNG NUT  
QTY: 2**

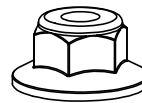

**FAS0055  
1/4-20 ZP  
NLK HFLNG NUT  
QTY: 6**

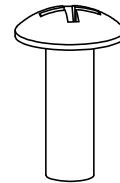

**FAS0062  
1/4-20 X .75 ZP  
THP SCREW  
QTY: 6**

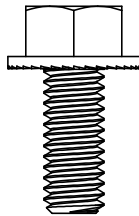

**FAS0438  
SCREW, HFLNG  
5/16-18X.75ZP  
QTY: 2**

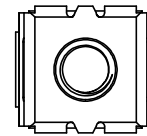

**FAS0915  
SNAP-IN NUT,  
0.028-0.056"  
QTY: 2**

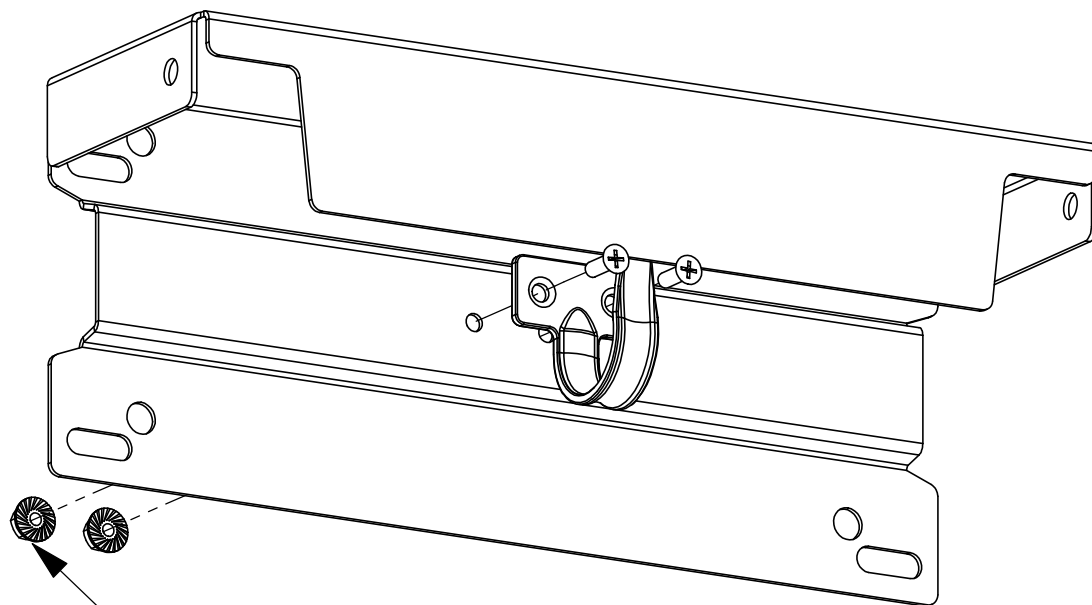
**STEP 1 - ATTACH HOOK TO BASE**

FAS0002, FAS0013  
(2 PLACES)  
#2 PHILLIPS  
— " SOCKET

**STEP 2A - INSTALL BASE TO SURFACE (ADRIAN STEEL END PANEL IS SHOWN)**

NOTE: UNIT CAN BE INSTALLED ON VARIOUS FACES. THE HOLE PATTERN IS OPTIMIZED FOR 16" HD SERIES, AND HAD SERIES SHELVING UNIT END PANELS.

IF MOUNTING SOMEWHERE ELSE, MARK AND DRILL OUT HOLES WITH A 9/32" STEP/DRILL BIT .

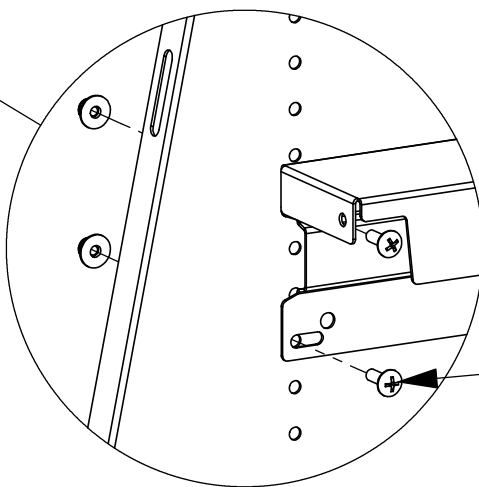
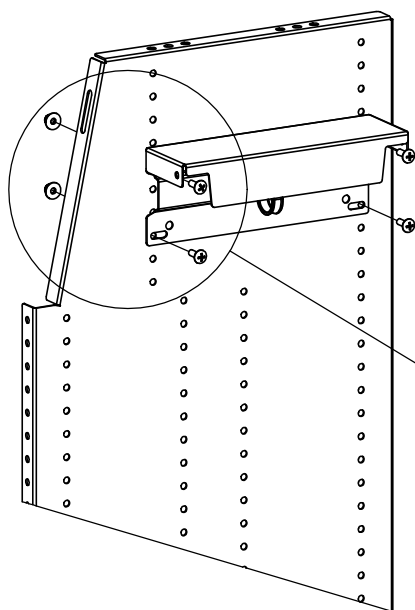

FAS0062, FAS0055  
(4 PLACES)  
#2 PHILLIPS  
7/16" SOCKET

**STEP 2B - INSTALL BASE TO SURFACE (NEW ADRIAN STEEL END PANEL IS SHOWN)**

**STEP 1: ALIGN BRACKET IN DESIRED POSITION AND INSERT FAS0915 (QTY: 4) INTO CORRESPONDING CUTOUTS.**

**STEP 2: PLACE BRACKET OVER INSERTED FASTENERS AND SECURE USING FAS0438 (QTY: 4) AND 1/2" SOCKET OR WRENCH**

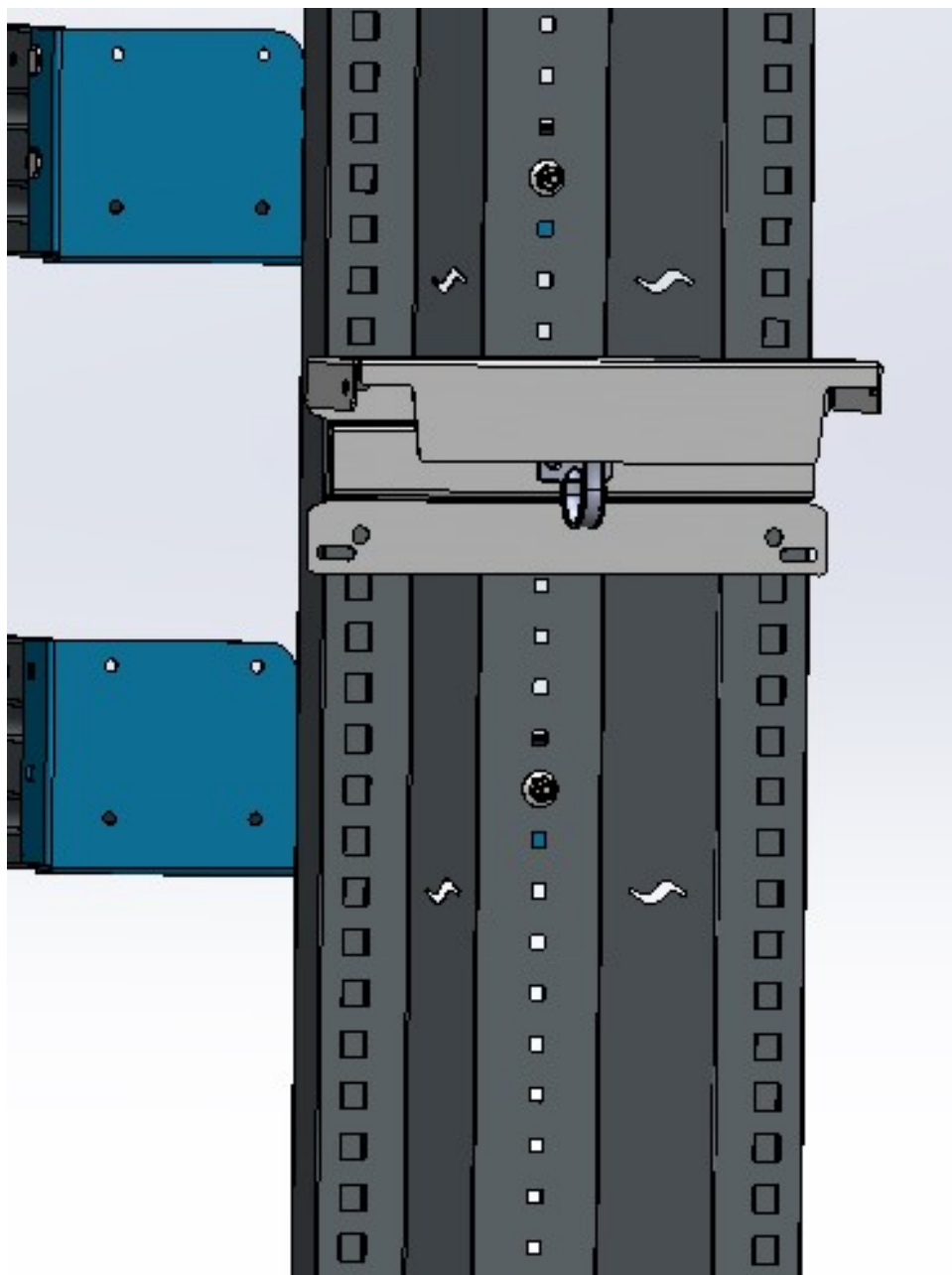

**STEP 3: FULLY TIGHTEN ALL FASTENERS**

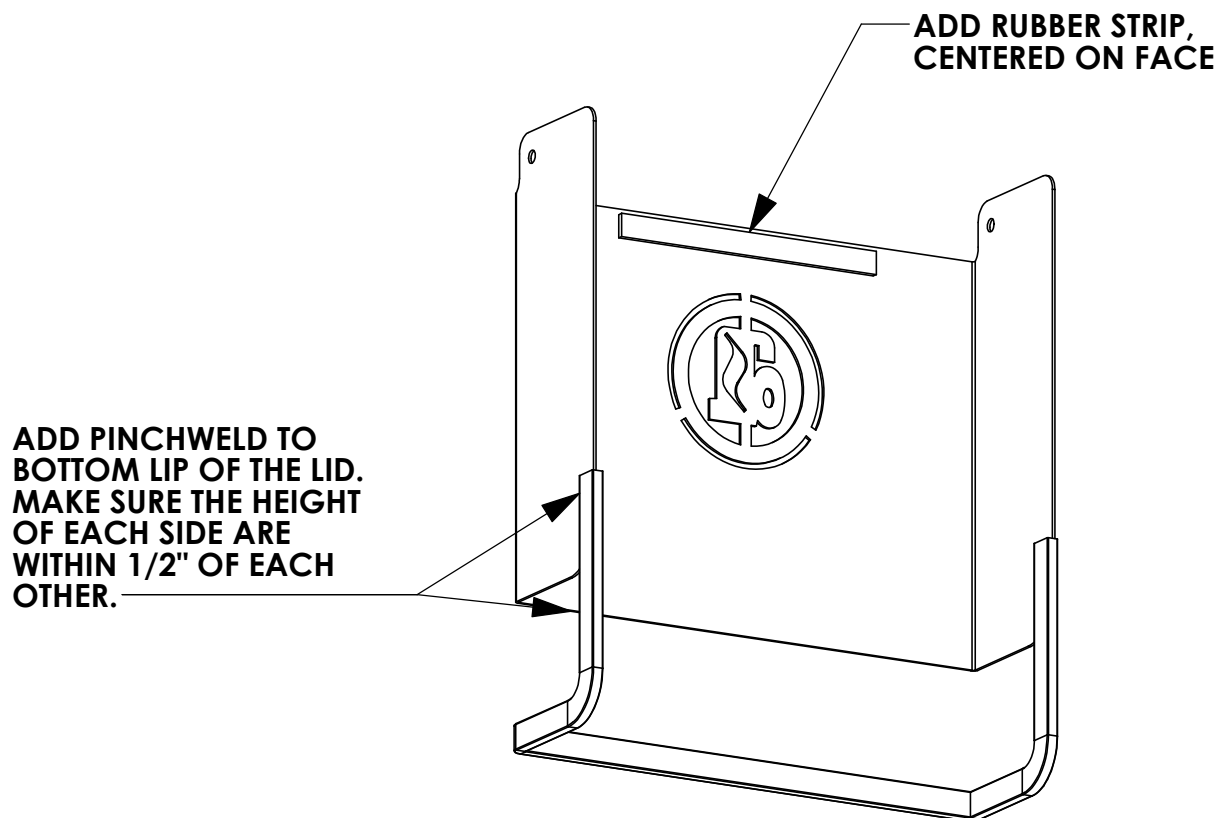
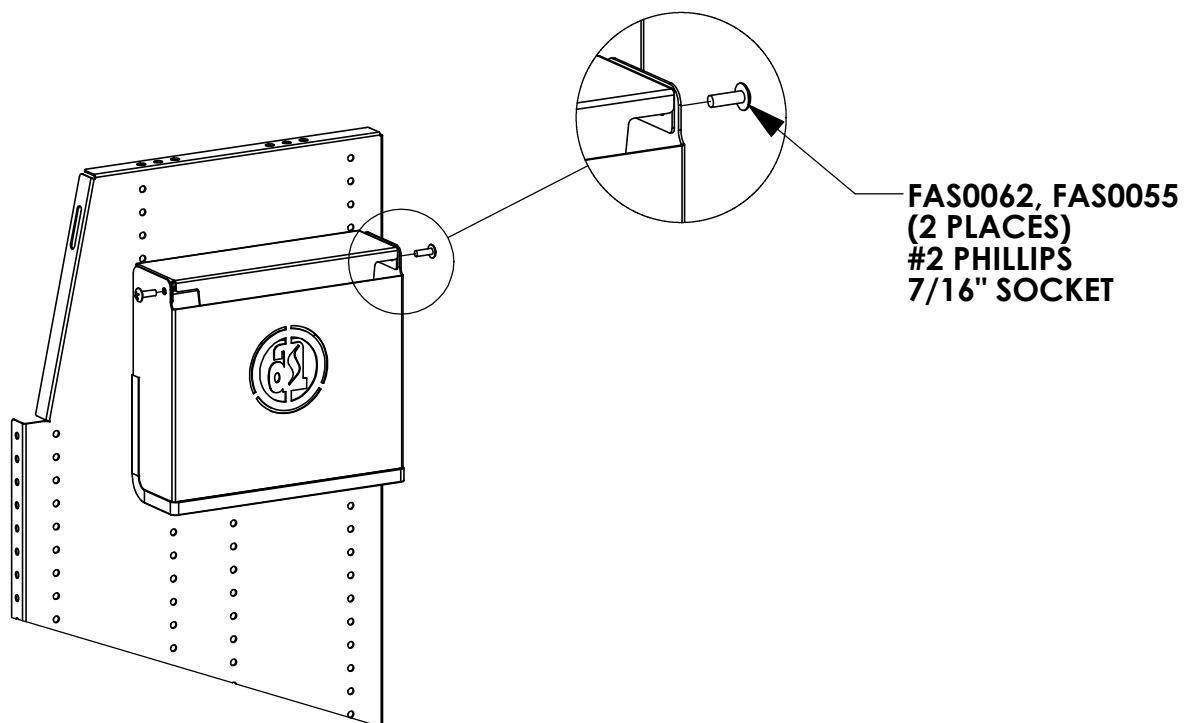
**STEP 3 - ATTACH PINCHWELD TO LID****STEP 4 - INSTALL LID ON BASE****INSTALLATION IS COMPLETE!**