

Introduction / Comments:

This Fold-Up Shelving is intended to be installed in Transit Medium/High Roof Vans, Sprinter High Roof Vans, and Promaster Medium/High Roof Vans.

Note:

It is advised that all fasteners used in this assembly and installation should be checked for tightness at the following intervals: @ 2-weeks and again @ 6-weeks of operation. This preventive maintenance step must be completed to ensure your Product gives you long service life.

Modular Shelving Units

See page 6 for breakdown on Modular Shelving Units

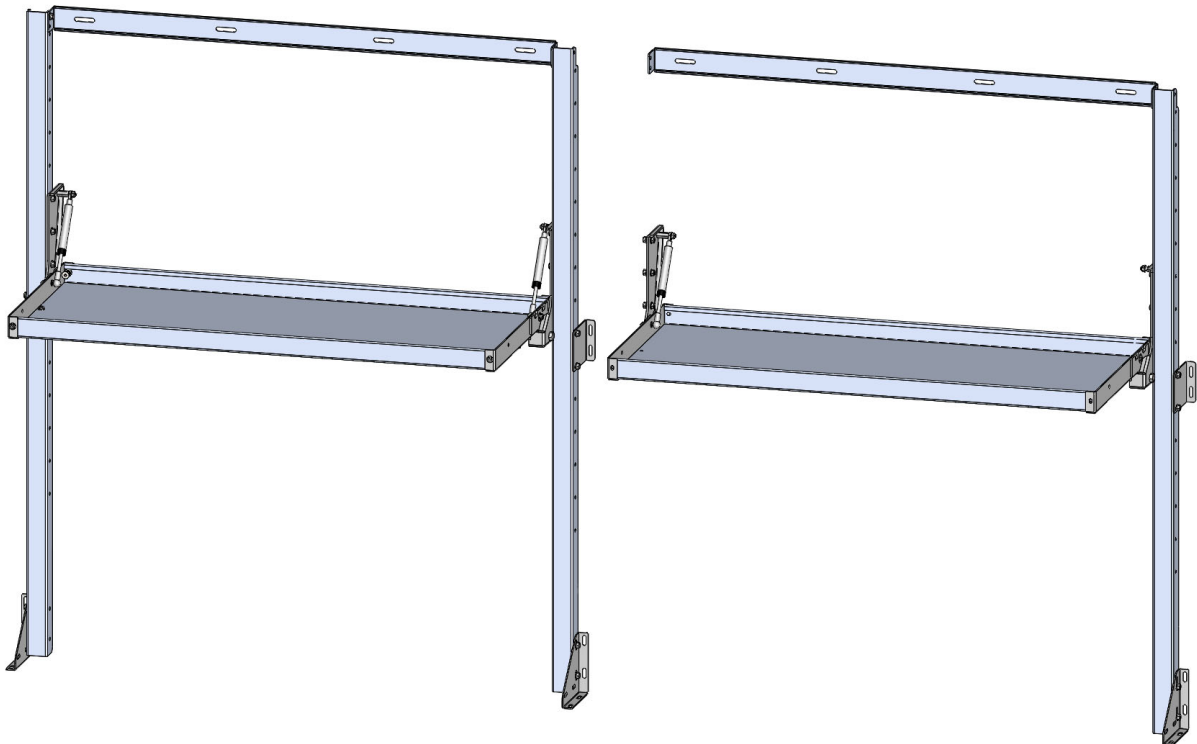

Adrian Steel Fold-up Shelving Assembly and Install instructions

- PRECAUTIONS -



CAUTION
THE USE OF AIR IMPACT TOOLS CAN
OVER-TORQUE FASTENERS AND
CAUSE FASTENER FAILURE!



CAUTION
ALL INSTALLATION HOLES SHOULD BE SEALED
WITH SILICON OR BUTYL SEALANT TO PREVENT
EXHAUST FUMES FROM ENTERING THE VEHICLE!



DANGER
INSPECT FOR FUEL TANK, FUEL LINES, BRAKE LINES, HIGH
VOLTAGE BATTERIES AND ELECTRICAL LINES PRIOR TO
DRILLING TO AVOID DAMAGING CRITICAL VEHICLE SYSTEMS
OR INJURY TO INSTALLER DURING INSTALLATION PROCESS!

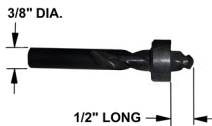

CAUTION
TO AVOID DAMAGING THE VEHICLE ALWAYS USE DRILL
STOPS WHEN DRILLING ANY INSTALLATION HOLES!
ADRIAN AVAILABLE PART #'S 31119-0 (3/8" X 1/2"
DEEP), 31121-0 (1/2" x 1/2" DEEP)



- IMPORTANT WARRANTY REQUIREMENTS -

1. SUBSTITUTING ADRIAN STEEL SPECIFIED FASTENERS FOR ASSEMBLY AND/OR INSTALLATION WILL VOID YOUR PRODUCT WARRANTY.
2. ALL HOLES DRILLED INTO VEHICLE SHOULD HAVE THE RAW METAL EDGES SEALED WITH A SELF-ETCHING PRIMER TO RESIST CORROSION AND POTENTIAL FASTENER POINT FAILURE.
3. ALL FASTENERS USED IN THE INSTALLATION OF THIS PRODUCT SHOULD BE TIGHTENED TO THE TORQUE(S) SPECIFIED IN THESE INSTRUCTIONS.
4. THESE INSTRUCTIONS SHOULD BE KEPT WITH THE VEHICLE.

THE BASIC TOOLS NEEDED FOR MOST INSTALLATIONS



DRILL

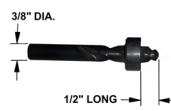

DRILL BIT WITH
STOP

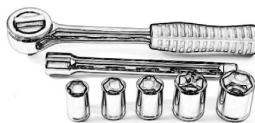

RATCHET, SOCKETS
AND/OR WRENCHES



SCREWDRIVERS



MEASURING TAPE

ADDITIONAL TOOLS MAY BE NEEDED FOR THIS INSTALLATION AND THEY WILL BE IDENTIFIED IN THE STEPS THAT FOLLOW.

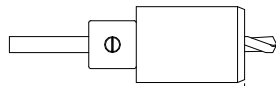

WHEN INSTALLING PLUSNUTS MAKE SURE YOU USE THE CORRECT DRILL BIT WITH A STOP!

PLUSNUT SIZE	DRILL BIT SIZE
1/4-20 PLUSNUT, FAS0052	USE A 3/8" DIAMETER DRILL BIT WITH A STOP.
5/16-18 PLUSNUT, FAS0091	USE A 1/2" DIAMETER DRILL BIT WITH A STOP.
 <p>NOTE: A PLUSNUT SETTING TOOL IS REQUIRED FOR PLUSNUT INSTALLATION AND IS NOT SUPPLIED WITH THIS KIT. ORDER PLUSNUT TOOLS FROM ADRIAN STEEL (P.N. 22200-0) OR USE AN AIR POWERED PLUSNUT SETTING GUN.</p>	
<p>NOTE: If your vehicle contains carpet or a rubber floor mat you will need to prepare the mounting locations using a 1-3/16" carpet cutter.</p>	
<p>1-3/16" DIAMETER CARPET CUTTER P.N. 31183-0.</p> 	

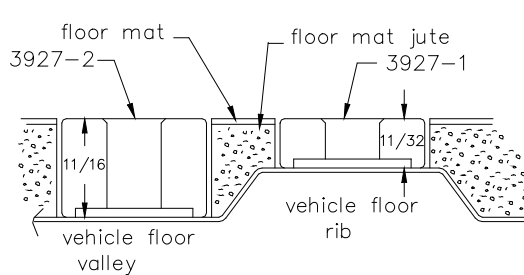
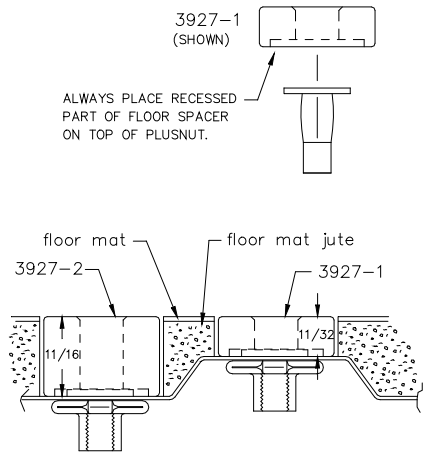
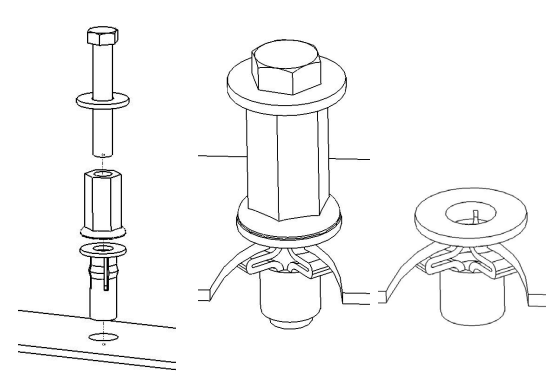
	<p>Step 01 Optional Based on Vehicle</p>	<p>If your vehicle contains carpet or a rubber floor mat you will need to prepare the mounting locations. (if not, skip to STEP 02)</p> <p>Position the product to be installed into the vehicle and once you are satisfied with the mounting locations, mark the mounting locations. Using a 1-3/16" diameter carpet cutter. Select the appropriate floor spacers as shown in the illustration to the left. Set those aside for use later into the installation process.</p> <p>Once you have prepared the carpet/floor mat for mounting, proceed to STEP 02.</p>
	<p>Step 02 Prepare Mounting Locations</p>	<p>Using a drill and drill bit (see table at top of page for correct size) drill the mounting holes in the vehicle sheet metal to prepare for installing the plusnuts.</p> <p>If you are thru-bolting at any of the locations simply drill a hole that is 1/16" larger than the bolt size(s) for those locations.</p> <p>Once you have drilled the holes into the vehicle, the raw metal edges should be sealed using a self-etching primer to resist corrosion and potential fastener point failure.</p>
	<p>Step 03 Setting Plusnuts</p>	<p>Use a Air Powered Plusnut Setting Gun to "set the plusnut" or if installing manually with hand tools, assembly the following.</p> <p><u>1/4-20UNC Plusnut (FAS0052)</u> FAS0080 SCREW, HXHD, 1/4-20UNCx2.00", G8 FAS0067 WASHER, FLAT, 1/4"ID 22200-0 PLUSNUT TOOL</p> <p><u>5/16-18UNC Plusnut (FAS0091)</u> FAS0095 SCREW, HXHD, 5/16-18UNCx2.00", G8 FAS0086 WASHER, FLAT, 5/16"ID 22200-0 PLUSNUT TOOL</p> <p>Place barrel of the plusnut body in sheet metal thru hole until flange is flush with sheet metal.</p> <p>Using a 9/16" combination wrench of plusnut tool body and a second hand wrench, ratchet, or air tool, rotate the hex bolt head CW to draw plus nut flanges up (set the plusnut).</p> <p>Remove hex bolt, washer, and plusnut. Inspect installation.</p>

Installation and/or Assembly Fasteners
BAG63137
BAG FOR SINGLE FOLD-UP SHELF

ITEM NO.	PART NUMBER	DESCRIPTION	QTY.
1	BAG0507-A	5" x 7" 3MIL AUTOBAG	1
2	FAS0091	Plusnut, 5/16	12
3	FAS0092	Screw, Hex Hd, 5/16-18x1.50 Zn Plate, G8	12
4	FAS0098	Washer, Lock, Split, 5/16, Zinc Plate	12
5	FAS0112	WASHER,FLAT USS 5/16 ZN	12
6	FAS0440	NUT,HEX NLK FLG 5/16-18 - ZP	10
7	FAS0018	SCREW,HH SFLNG 1/4-20X.62 ZP	6
8	FAS0055	NUT,HEX NLK FLG 1/4-20 ZP	6
9	FAS0438	SCREW,HFLNG 5/16-18X.75 ZP	10

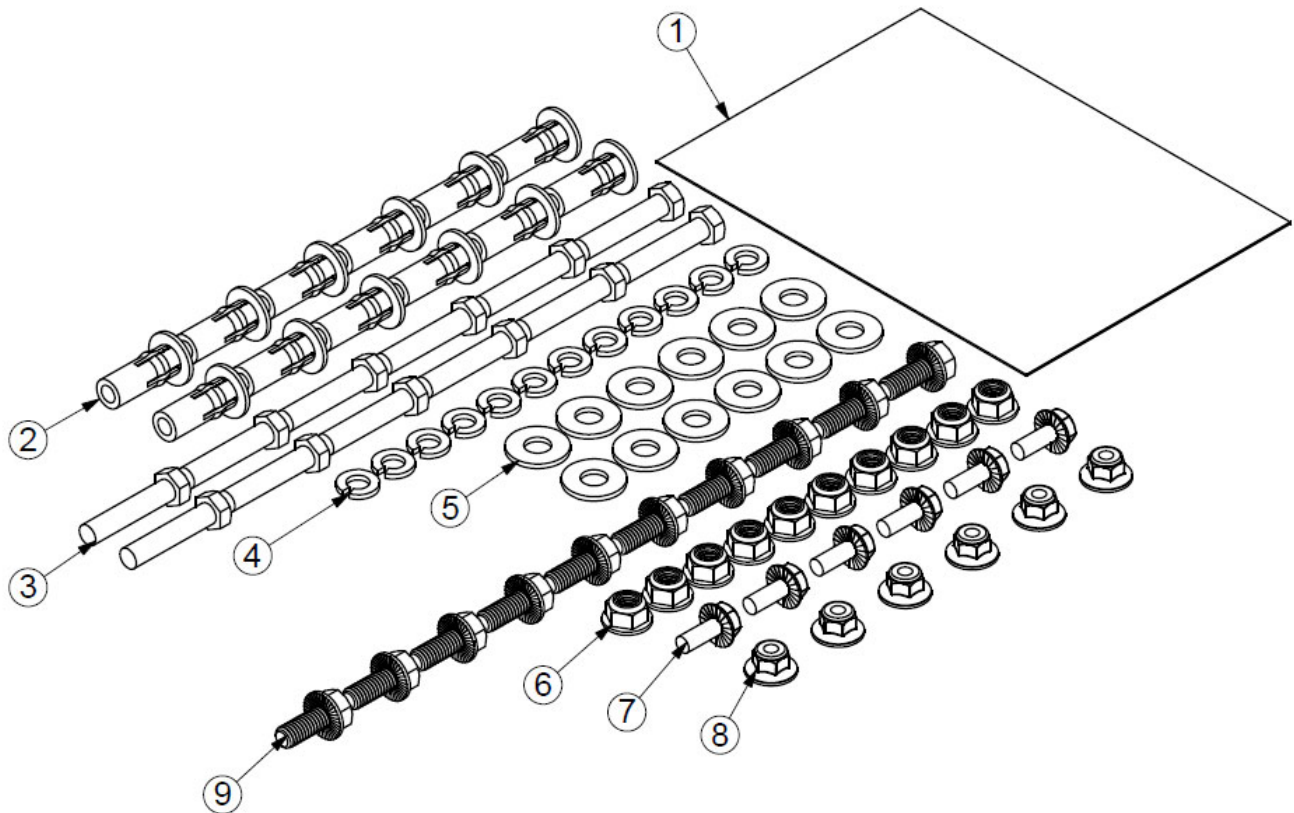

Installation and/or Assembly Fasteners
BAG63138
BAG FOR SINGLE FOLD-UP SHELF ADD-ON

ITEM NO.	PART NUMBER	DESCRIPTION	QTY.
1	BAG0507-A	5" x 7" 3MIL AUTOBAG	1
2	FAS0091	Plusnut, 5/16	8
3	FAS0092	Screw, Hex Hd, 5/16-18x1.50 Zn Plate, G8	8
4	FAS0098	Washer, Lock, Split, 5/16, Zinc Plate	8
5	FAS0112	WASHER,FLAT USS 5/16 ZN	8
6	FAS0440	NUT,HEX NLK FLG 5/16-18 - ZP	18
7	FAS0018	SCREW,HH SFLNG 1/4-20X.62 ZP	6
8	FAS0055	NUT,HEX NLK FLG 1/4-20 ZP	6
9	FAS0438	SCREW,HFLNG 5/16-18X.75 ZP	18

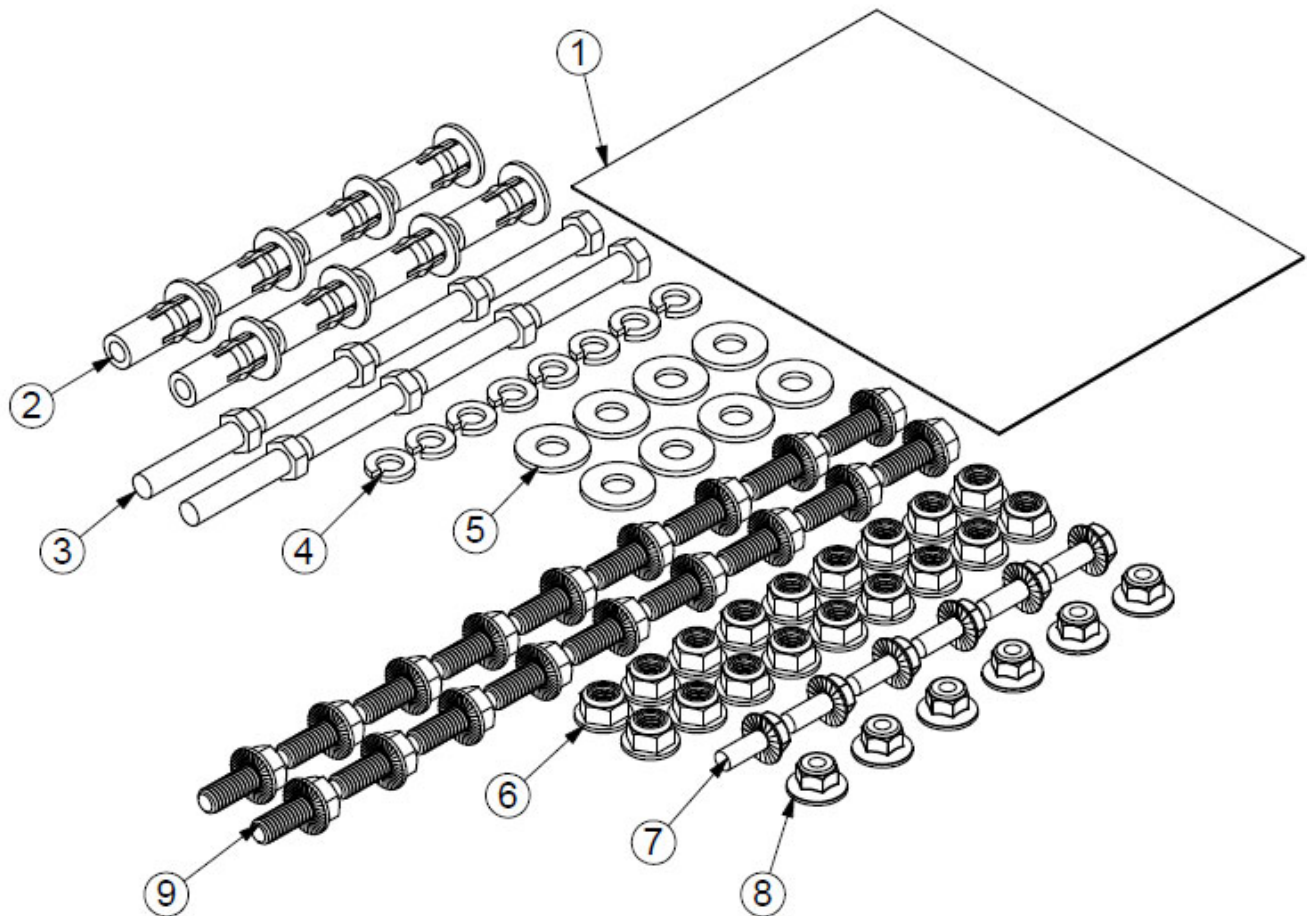

Modular Shelving Part Numbers and Fitment

Fold-up Shelving Pick and Choose	FSFK2036S	FOLDING SHELF KIT 20X32	One From Here	=	One full Shelf kit	
	FSFK2048S	FOLDING SHELF KIT 20X48				
	FSFK2060S	FOLDING SHELF KIT 20X60				
	FSFK2072S	FOLDING SHELF KIT 20X72				
						+
	FSFPMHS	UPRIGHT KIT, FOLDING SHELF	One From Here			
	FSFPMHAS	UPRIGHT KIT, FOLD SHELF A				
						+
	FSFMKFTS	FOLDING SHELF MOUNT KIT T	One From Here			
	FSFMKFTAS	FOLDING SHELF MOUNT ADD T				
FSFMKSPRS	FOLDING SHELF MOUNT KIT S					
FSFMKSPRAS	FOLDING SHELF MOUNT ADD S					

The only part of these Modular Shelving Units that are not universal are the Vehicle Mounting Kits.

-FSFMKFT & FSFMKFTA work for Transit Mid & High Roof, along with Promaster Vans

-FSFMKSPR & FSFMKSPRA work for Sprinter high Roof Vans and Promaster 159" EXT WB with an ASCO upper rail kit

The Folding Shelf Kits & Upright Kits are not vehicle specific and will work in a number of configurations

-FSFPMHAS along with the ADD ON Mount Kits are used for joining to shelving units together, allowing you to use a common center post, saving space and cost.

Below is what the Streetside Wall of a Transit might look like

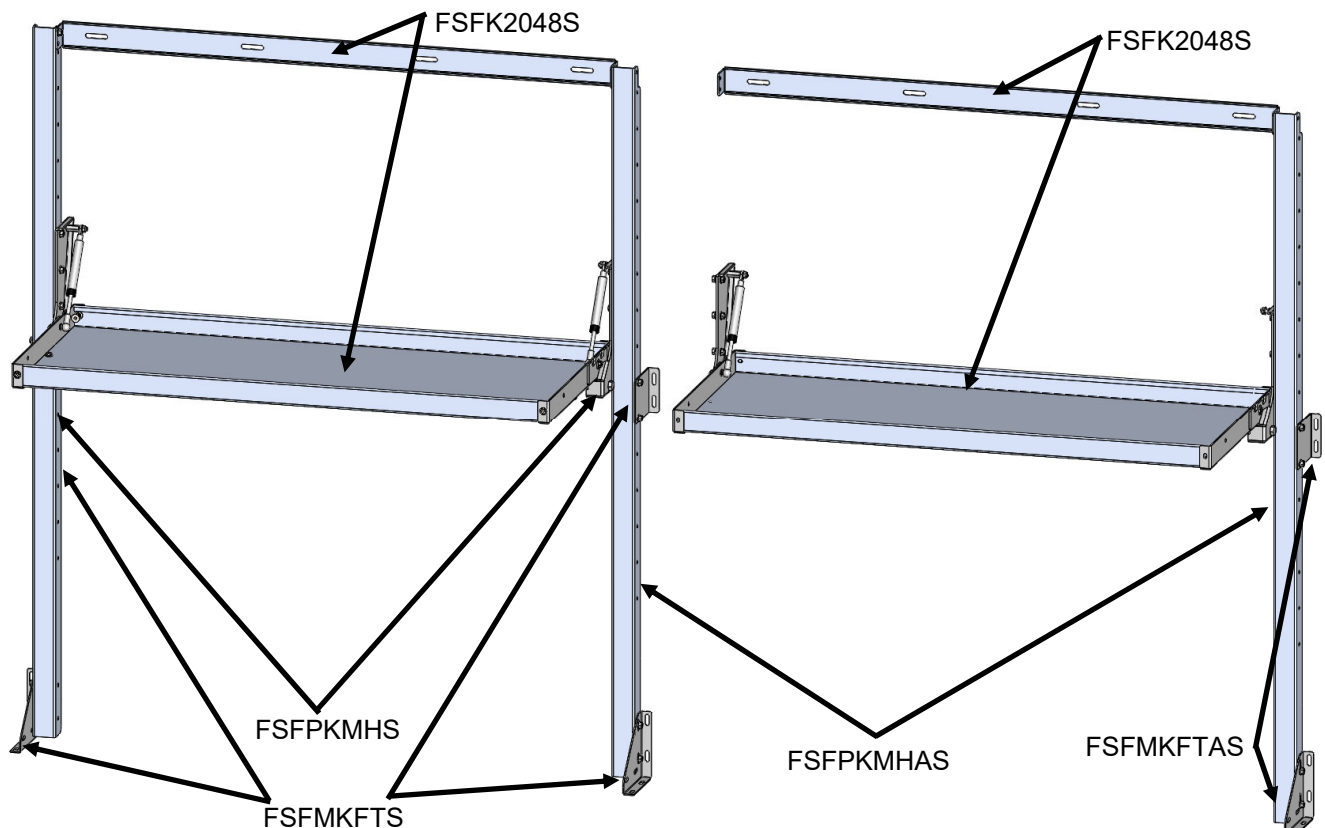

CAUTION:

**BEFORE PROCEEDING, WEAR
CUT-RESISTANT GLOVES AND
SLEEVES. PARTS MAY HAVE
SHARP EDGES.**

Step 01 Assemble the shelving unit by joining the post assemblies with the shelves and header rail.

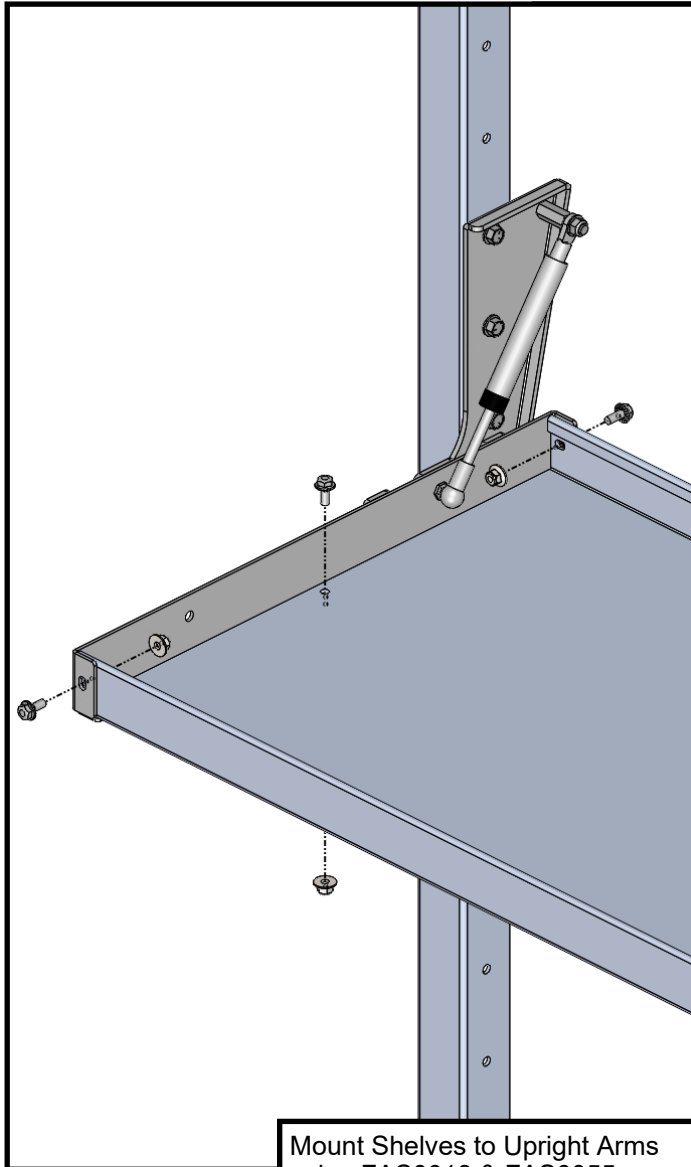

Mount Shelves to Upright Arms using FAS0018 & FAS0055
There are (3) mounting points on each end of each shelf.

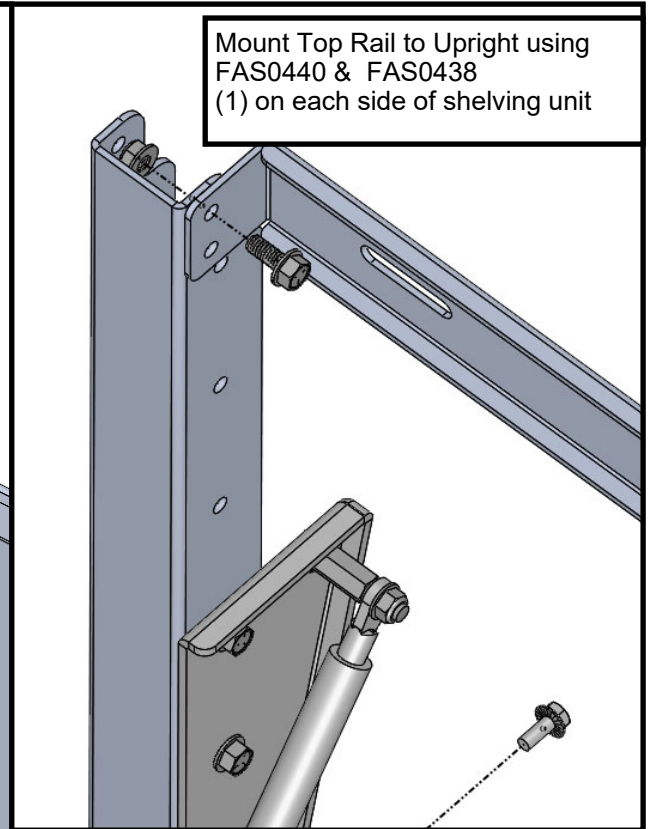

Mount Top Rail to Upright using FAS0440 & FAS0438
(1) on each side of shelving unit

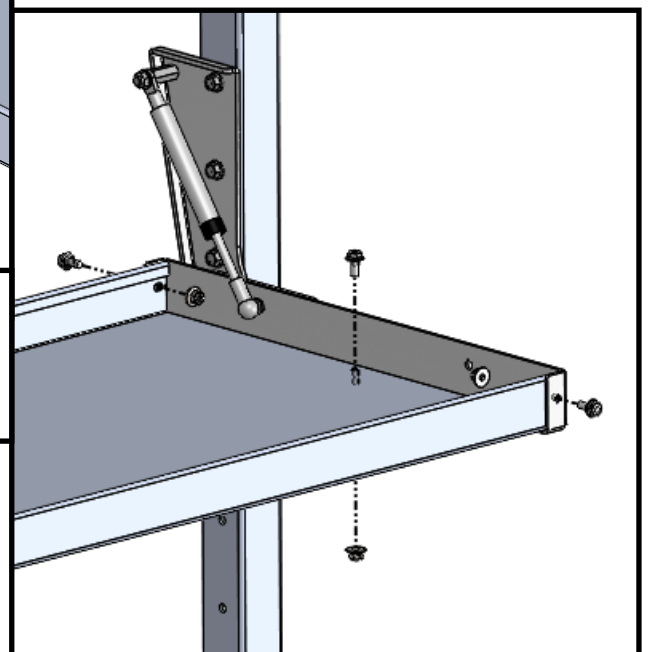

Step 02 Attach Vehicle Mount Kit to Shelving Unit

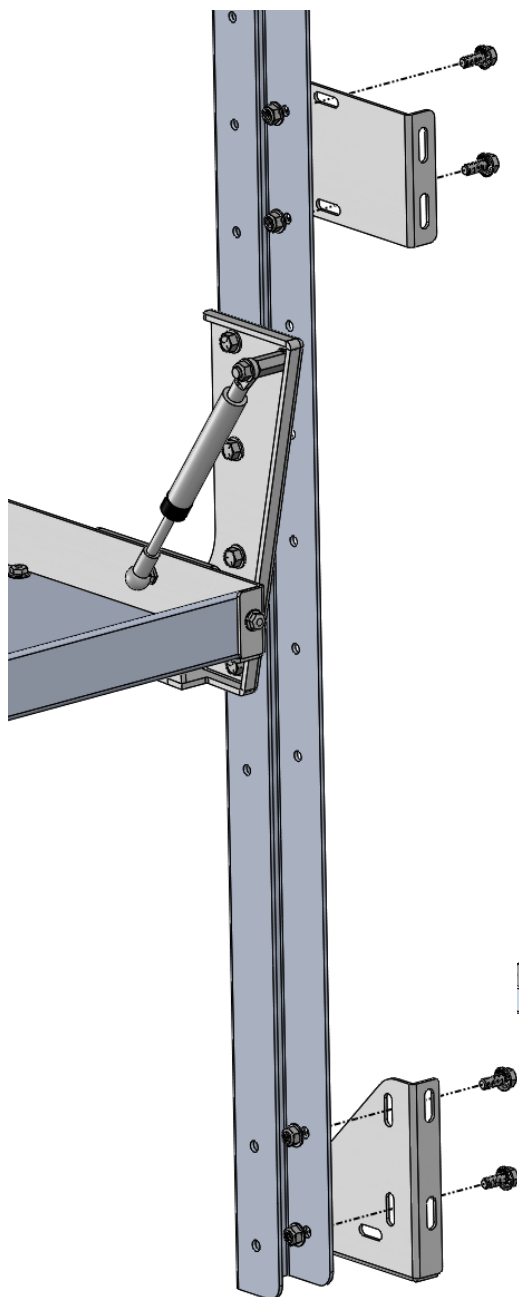

Install Belt Bracket using FAS0440 & FAS0438 as shown here. There is no set location for the Belt Bracket. Adjust the location as needed in order to mount bracket to the belt line of Vehicle. This can be mounted on either side of Upright to best fit the mounting location.

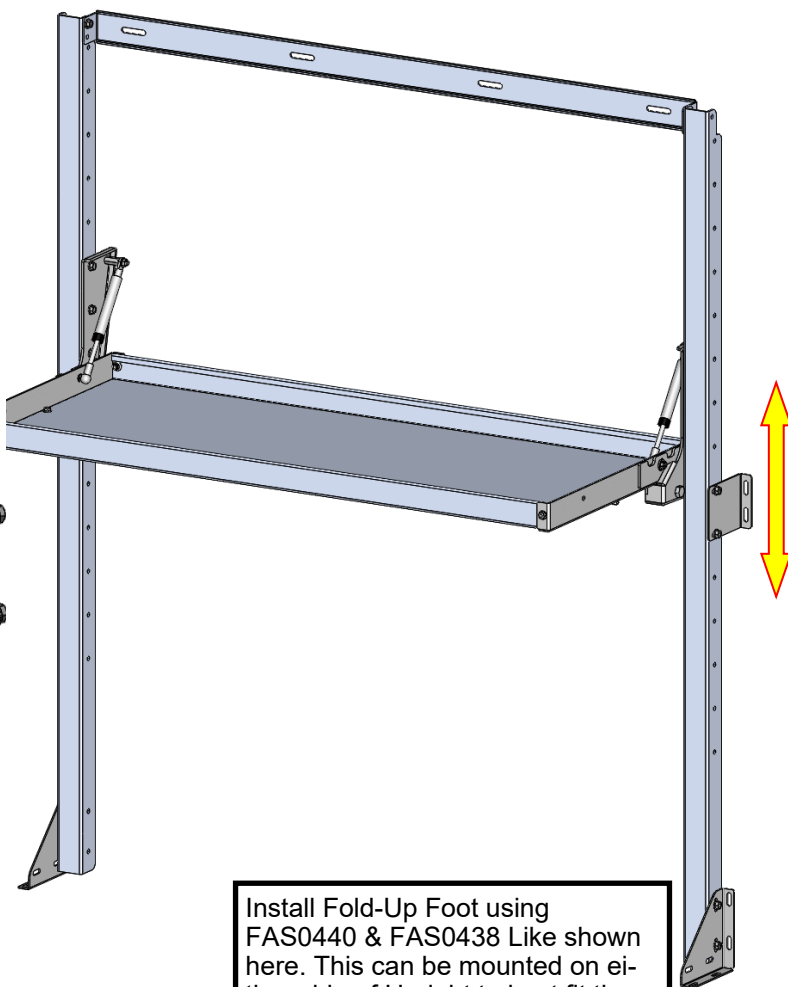

NOTE: For a whole shelving unit the Vehicle Mounting Brackets will be attached on both sides of shelving unit. For an **add-on** Kit they will only be installed on the Right side.

Install Fold-Up Foot using FAS0440 & FAS0438 Like shown here. This can be mounted on either side of Upright to best fit the mounting location.

Step 03 Mount Shelving Unit to van

Header Rail

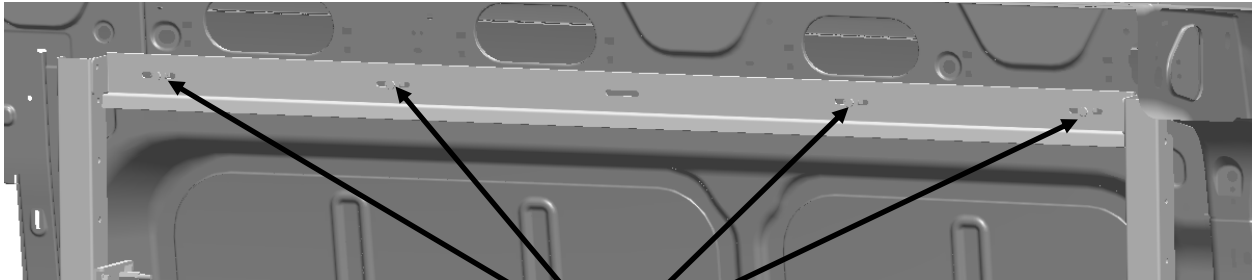

Drill and set 5/16 Plusnuts (FAS0091) in each of the locations shown. Then using FAS0092, FAS0098, & FAS0112, Mount the Shelving unit to

Please use this Fastener orientation for all fastening point to the vehicle.

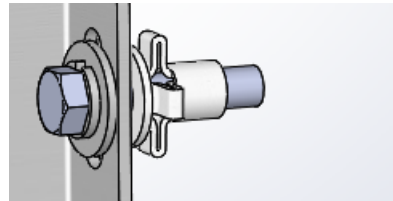

Belt Line OR
Pillars of Van

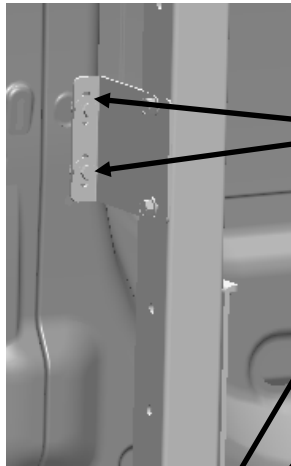

Belt Line OR
Pillars of Van

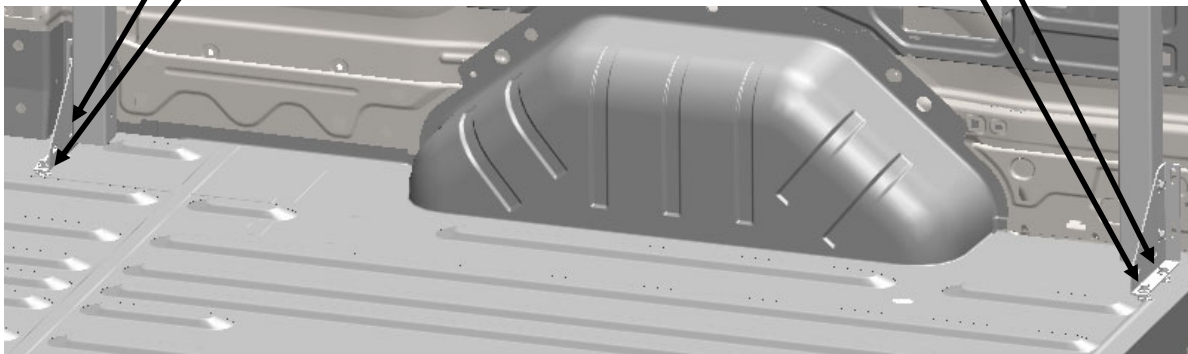

Fold-Up Feet
(2) Mounting locations in
each Foot

**DOUBLE CHECK ALL FASTENERS LOCATIONS TO BE SURE THAT ALL FASTENERS ARE TIGHTENED TO SPECIFICATIONS.
YOUR INSTALLATION IS NOW COMPLETE!
STOW THIS COPY IN THE VEHICLE FOR FUTURE REFERENCES!**

Step 04– Optional step for add-on shelf kits. Fasten the folding arm assemblies to the right post of the existing shelving unit. Then return to Step 01 for assembly.

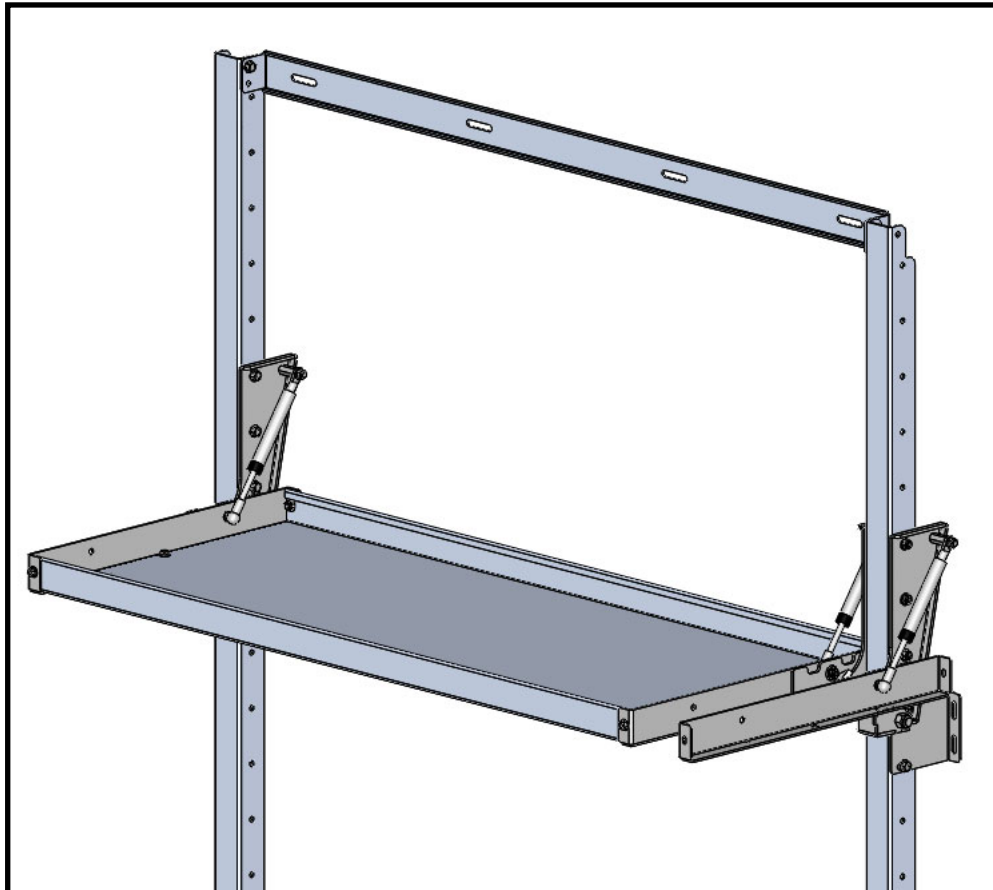

Mount the arm assembly using
FAS0440 & FAS0438
(4) sets per arm

