

PRINTED DOCUMENT IS UNCONTROLLED

for reference only!

REVISION  
LEVEL: **D**

Part  
Number: **DV14C1**

THIS PRODUCT IS SUBJECT TO CHANGE.  
ADRIAN STEEL COMPANY RESERVES THE RIGHT TO  
CHANGE THE PRODUCT OF IT'S DESIGN WITHOUT  
PRIOR NOTICE.

THIS DRAWING IS THE PROPERTY OF ADRIAN STEEL COMPANY  
AND IS NOT TO BE USED IN ANY MANNER DETRIMENTAL TO  
THE INTERESTS OF ADRIAN STEEL COMPANY.

Shipping Wt. (Lbs.):

**0.34**

Coating/Finish:

**GRAY**

Do Not Scale This Drawing!



906 James St.  
Adrian, MI 49221  
517.265.6194

Part Description: **DIVIDER KIT OF (1) 35317-G DIVIDER**

Part  
Number: **DV14C1**

REVISION  
LEVEL:

**D**

## DIVIDER 35317-G Assembly Instructions FOR AD SERIES SHELVEING

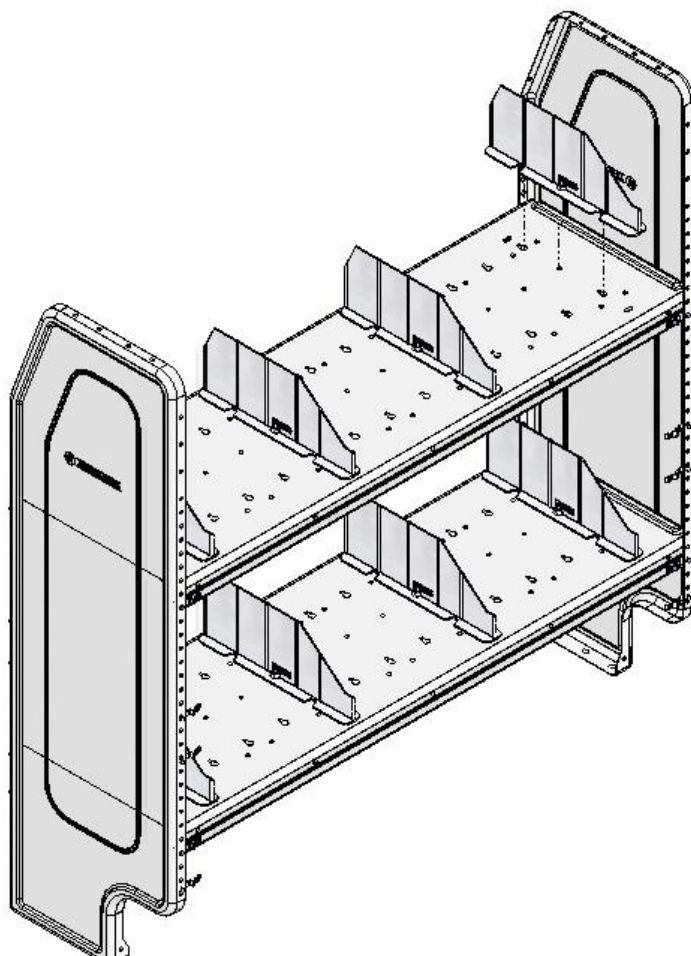

P.N.: 35306-0

ISSUE: C

CHK.BY: DWC

REV.BY:BDS

DWG.BY: JLC

ECN-18796 DATE: 07/29/2016

# SHELF DIVIDER 35317-G

## BEFORE YOU START!

**IMPORTANT INSTALLATION STEPS ARE DENOTED USING A STOP SIGN. THESE STEPS MUST BE PERFORMED AS SPECIFIED IN ORDER TO ENSURE A PROPER INSTALLATION AND MUST BE FOLLOWED IN ORDER TO MAINTAIN YOUR PRODUCT WARRANTY!**



**CRITICAL INFORMATION PERTAINING TO USER AND/OR VEHICLE SAFETY IS DENOTED USING A CAUTION SIGN. SAFETY ITEMS MUST BE STRICTLY ADHERED TO IN ORDER TO ENSURE A SAFE WORKING ENVIROMENT!**



**YOU WILL NEED NO TOOLS TO INSTALL DIVIDERS.**



**THE USE OF AIR OR ELECTRIC IMPACT TOOLS FOR THE ASSEMBLY OF FASTENERS IS NOT RECOMMENDED AND COULD CAUSE FASTENER FAILURE!**



## **W A R N I N G**



**THE USE OF DRILLS WITH INTEGRAL DRILL STOPS ALONG WITH PROPER INSPECTION FOR GAS TANK, GAS LINES, BRAKE LINES AND ELECTRICAL LINES PRIOR TO DRILLING ANY MOUNTING HOLES IS STRONGLY RECOMMENDED TO ENSURE THAT VEHICLE DAMAGE IS AVOIDED!**





**THE USE OF NON-STANDARD FASTENERS AND/OR DEVIATING FROM THE FASTENERS SPECIFIED IN THE INSTRUCTION (S) MAY VOID YOUR PRODUCT WARRANTY!**

**ALL DRILLED HOLES IN THE VEHICLE SHOULD HAVE THE RAW METAL EDGES SEALED WITH A SELF-ETCHING PRIMER TO RESIST CORROSION AND POTENTIAL FASTENER POINT FAILURE!**

# SHELF DIVIDER 35317-G

## VEHICLE PREPARATION, BEFORE YOU START

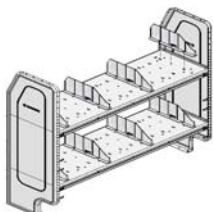
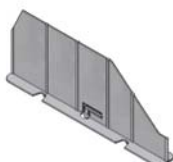
Unpack dividers. Make sure that you have the correct number of dividers for the number of shelves, or the kit ordered DV14C8 or DC14C1 kit of (1).

 <p><b>AD SERIES SHELVING SHOWN WITH DIVIDERS</b></p>	 <p><b>35317-G SHELF DIVIDER</b></p>	 <p><b>DV14C8 DIVIDER KIT (8) DIVIDERS</b></p>
--	---	---

### **STEP – 01**

### **INSERT 35317-G DIVIDER END PINS INTO SLOTTED HOLES**

Dividers should be evenly Spaced on Shelf unless otherwise specified by customer

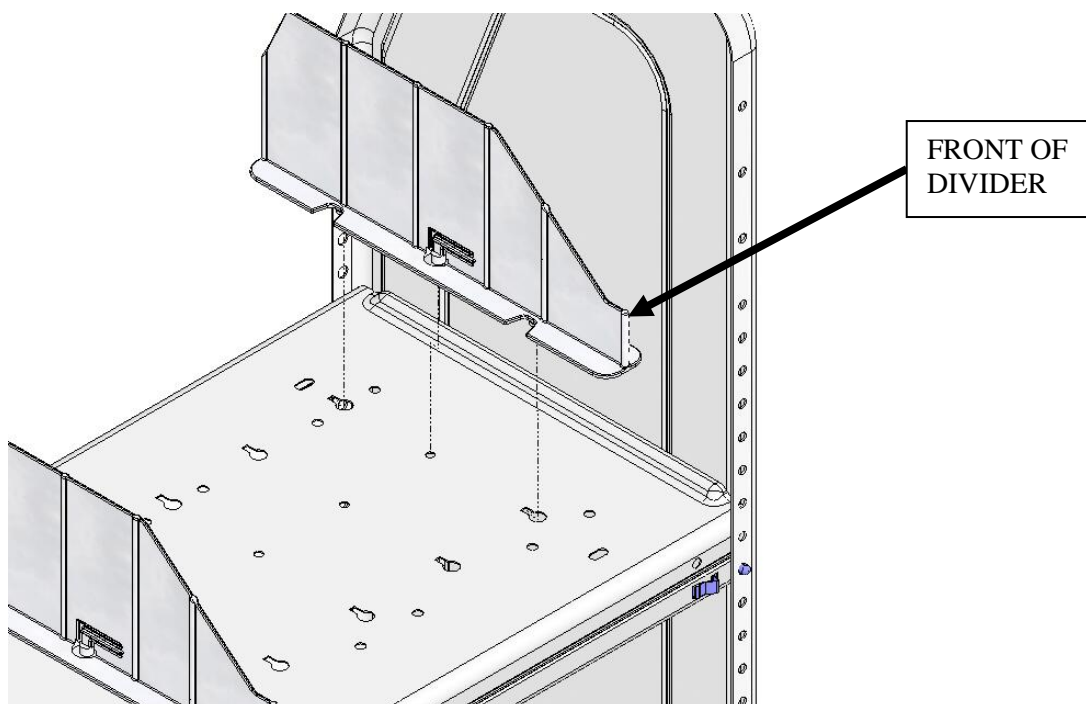

# SHELF DIVIDER 35317-G

## STEP – 02

**SLIDE DIVIDER BACK IN SLOT UNTIL CENTER PIN ENTERS HOLE**

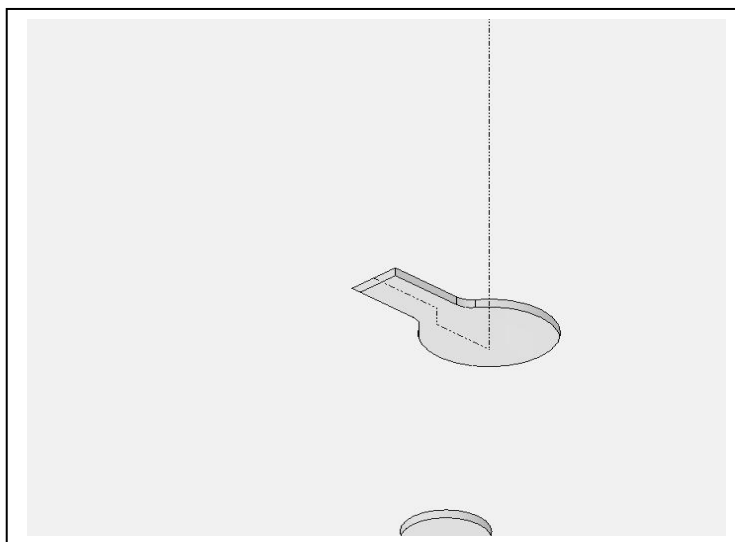

## STEP – 03

**CHECK TO MAKE SURE CENTER PIN IS LOCKED IN HOLE**

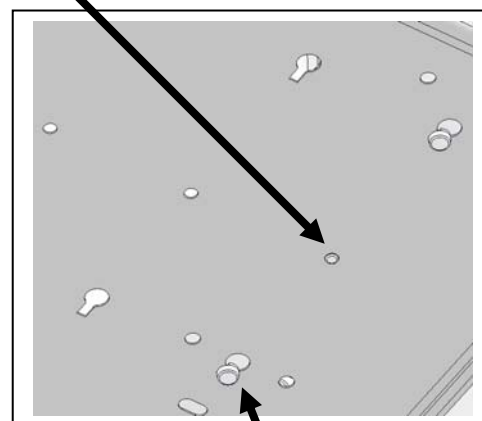
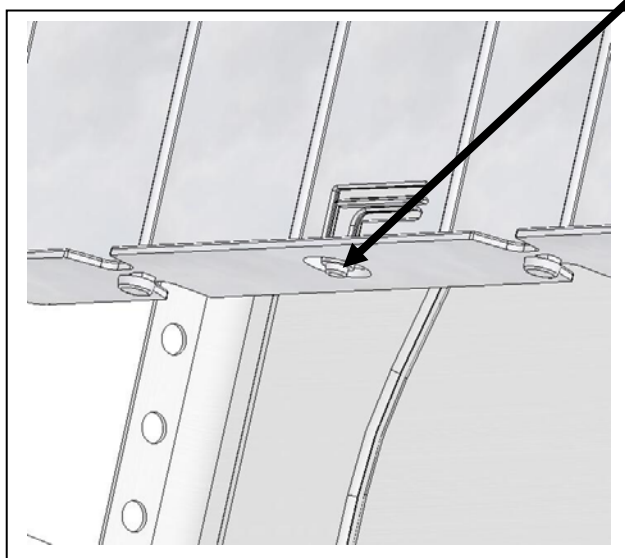

BOTTOM VIEW OF SHELF  
SHOWING PINS LOCKED  
THROUGH SHELF

## SHELF DIVIDER 35317-G

**DIVIDER IS COMPLETELY INSTALLED.**

### **STEP – 04**

### **REMOVAL OR RE-POSITION OF DIVIDERS**

**IF DIVIDERS NEED TO BE REMOVED, GENTLY LIFT UP ON SMALL EARS ON CENTER PIN TAB, THEN SLIDE DIVIDER TO THE FRONT, AND LIFT OFF SHELF.**

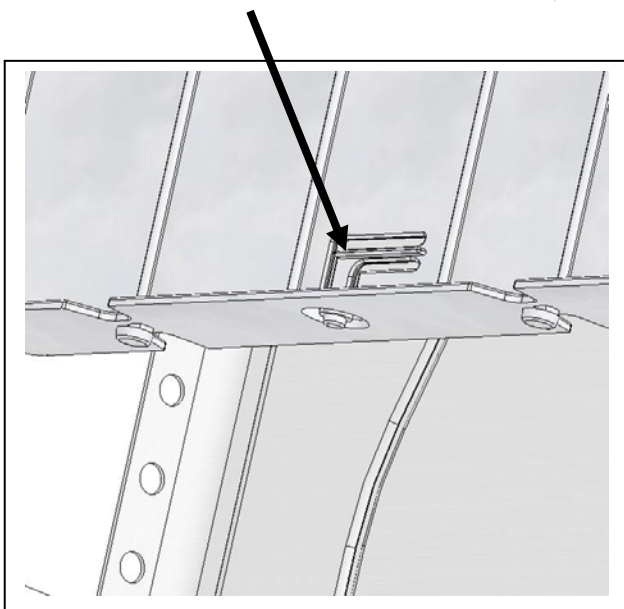

**DOUBLE-CHECK ALL DIVIDER LOCATIONS TO BE  
SURE THAT ALL TABS ARE IN PLACE, AND TIGHTENED  
TO PREVENT LOSS OF DIVIDER OR PRODUCT SHIFT!**



**YOUR INSTALLATION IS NOW COMPLETE! STOW THIS COPY IN THE  
VEHICLE FOR FUTURE REFERENCE!**

ADRIAN STEEL COMPANY • 906 JAMES ST. • ADRIAN, MI. 49221 • (517) 265-6194