

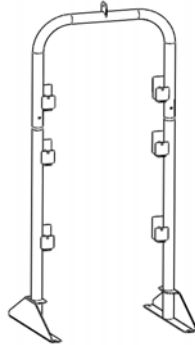

ADRIAN STEEL®
VAN AND PICKUP EQUIPMENT

CABLE REEL HOLDER

Assembly Instructions



CRH2, CABLE REEL HOLDER

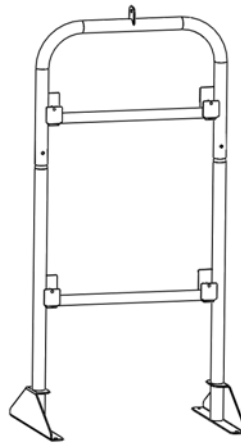

57769, CABLE REEL HOLDER



BEFORE YOU START



IMPORTANT NOTES PERTAINING TO USER AND/OR PRODUCT SAFETY ARE DENOTED BY A STOP SIGN AND THEY MUST BE FOLLOWED IN ORDER TO COMPLETE A SAFE ASSEMBLY AND INSTALLATION!



YOU WILL NEED THE FOLLOWING TOOLS IN ORDER TO COMPLETE THIS JOB.

#2 PHILLIPS SCREWDRIVER	9/16" OPEN END WRENCH FOR SETTING PLUSNUTS
7/16" OPEN END WRENCH	RATCHET WRENCH, WITH 7/16" SOCKET WARNING: DO NOT USE IMPACT TOOLS FOR ASSEMBLY!

ALL FASTENERS USED IN THE ASSEMBLY AND INSTALLATION OF THIS PRODUCT SHOULD BE TIGHTENED TO A TORQUE OF 12 FT. LBS.



THE USE OF AIR OR ELECTRIC IMPACT TOOLS FOR THE ASSEMBLY OF FASTENERS IS NOT RECOMMENDED AND COULD CAUSE FASTENER FAILURE!



THE USE OF DRILLS WITH INTEGRAL DRILL STOPS IS STRONGLY RECOMMENDED TO ENSURE THAT VEHICLE DAMAGE IS AVOIDED!



FASTENER STANDARDS

- ❑ Proper fastening method of Adrian Steel products should always include good metal contact, using the supplied fasteners with prepackaged arrangements.
- ❑ All drilled holes in the vehicle should have the raw metal edges sealed to resist corrosion.



Important: To prevent exhaust fumes from entering the vehicle, all holes should be sealed at installation with Butyl or silicon sealant material, which will remain flexible for an extended period of time.



- ❑ Adrian Steel's blind fastener of choice is the plusnut. Adrian supplies two thread sizes, 1/4-20 and 5/16-18. 5/16-18 fasteners are used only as directed.
- ❑ After locating all positions that require a plusnut, drill the proper size hole (use a drill stop!) for the plusnut. A 1/4-20 plusnut uses 3/8" diameter drill (all locations), and the 5/16-18 uses 1/2" diameter drill (floor only).

FOR MOUNTING THROUGH A FLOOR MAT AND/OR CARPET

- ❑ Position each item in desired location inside the vehicle.



Important: Before marking each location with a center punch, move the item/jig and check for obstructions or hazards under the vehicle floor.



- ❑ Mark the floor mount locations.
Note: If a number of similar installations are being performed, it is recommended that a drilling template be used to ensure all installations are the same.
- ❑ Using the cutting tool, drill a pilot hole thru the mat/carpet and metal floor pan.
- ❑ ***The location of various floor mounts will determine what spacer combination will be used. For example, an 11/32" spacer is used atop floor ribs, and an 11/16" high spacer is used atop floor valleys.***



Note: The proper use of spacers is required when mounting over mat/carpet to ensure the metal-to-metal clamp-up, which will minimize component shifting in stressed conditions.



- ❑ Complete your installation using the additional instructions supplied with the equipment.



CABLE REEL HOLDER

FASTENER STANDARDS cont'd.

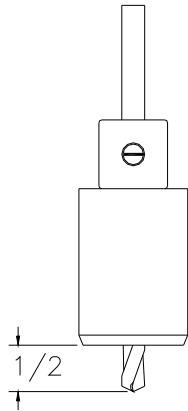

Placing the properly sized spacer on top of the vehicle floor pan will make your Adrian interior level, square, and sound. The view below shows the proper sized spacer for the different heights of the vehicle floor. Make sure to place the spacers with the plusnut relief surface down as shown.

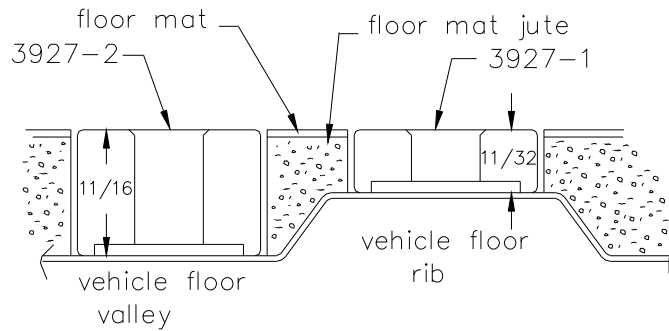

Plusnut Use and Installation

ASSEMBLE THE FOLLOWING

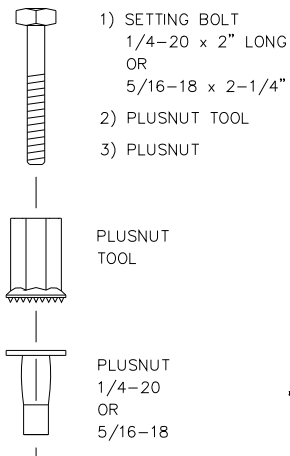

SETTING THE PLUSNUT

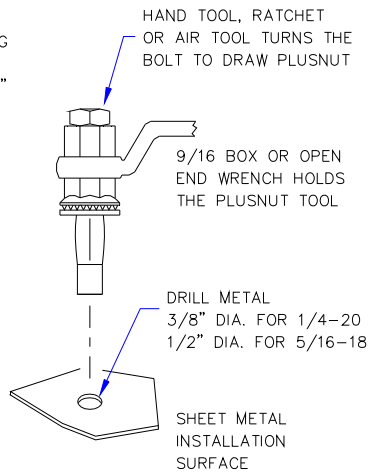

Set Plusnut till tight,
DO NOT OVERTIGHTEN.

Spacer Use and Installation

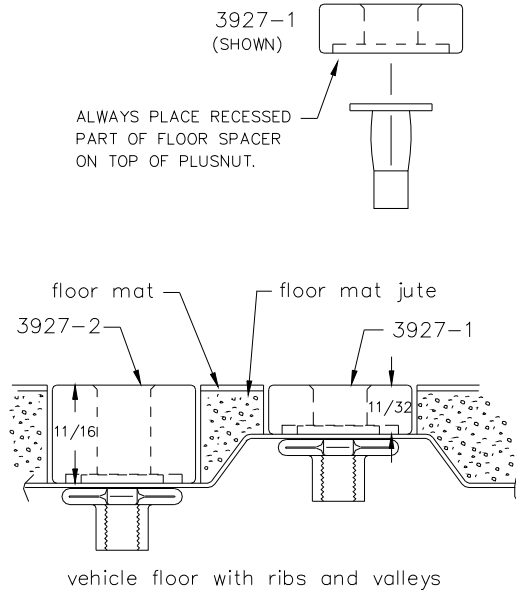





STEP – 01

BASE ASSEMBLY

FOR CRH2 MODEL

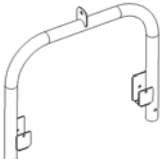
FOR 57769 MODEL

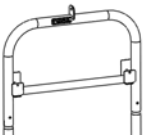
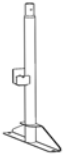
 <p>31335-0 HOOP WELDMENT (1) REQUIRED</p>	 <p>31343-0 & 40062 RIGHT & LEFT BASE LEG WELDMENT REQUIRES (1)</p>	 <p>57764-G HOOP WELDMENT (1) REQUIRED</p>	 <p>57767-G & 57766-G RIGHT & LEFT LEG WELDMENT (1) REQUIRED</p>
--	---	--	--

Remove the hoop weldment, base leg weldments and Parts box from the carton. Orient the base legs as shown below and place the hoop/hoop set weldment onto the base legs. Open parts box and remove the fastener bag.

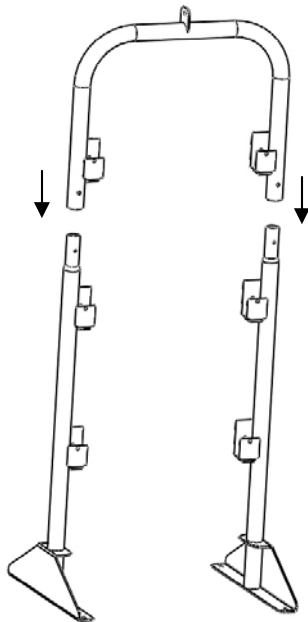

CRH2 MODEL

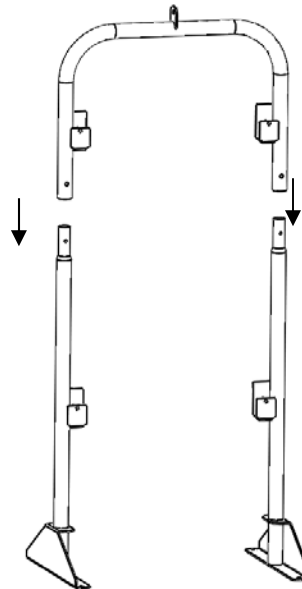

57769 MODEL



CABLE REEL HOLDER

STEP – 01

Base Assembly cont'd



**FAS0641
1/4 SCREW HEX HEAD
SELF DRILLING
(2) REQUIRED
TORQUE TO
12ft. lbs.**

**Install (2) FAS0641
into holes as shown.**

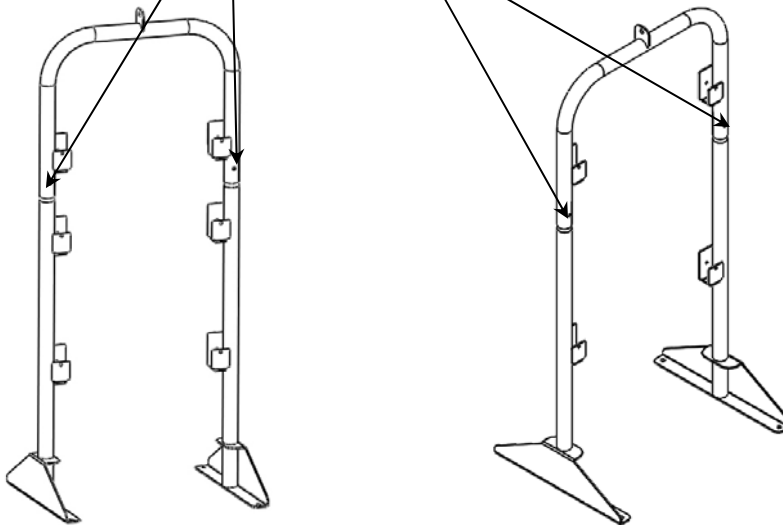

**ADRIAN STEEL®**

VAN AND PICKUP EQUIPMENT

CABLE REEL HOLDER

STEP – 02**BASE MOUNTING**

Place the Cable Reel Holder in van. Mark the hole locations using the holes on the bottom of the Cable Reel Holder.

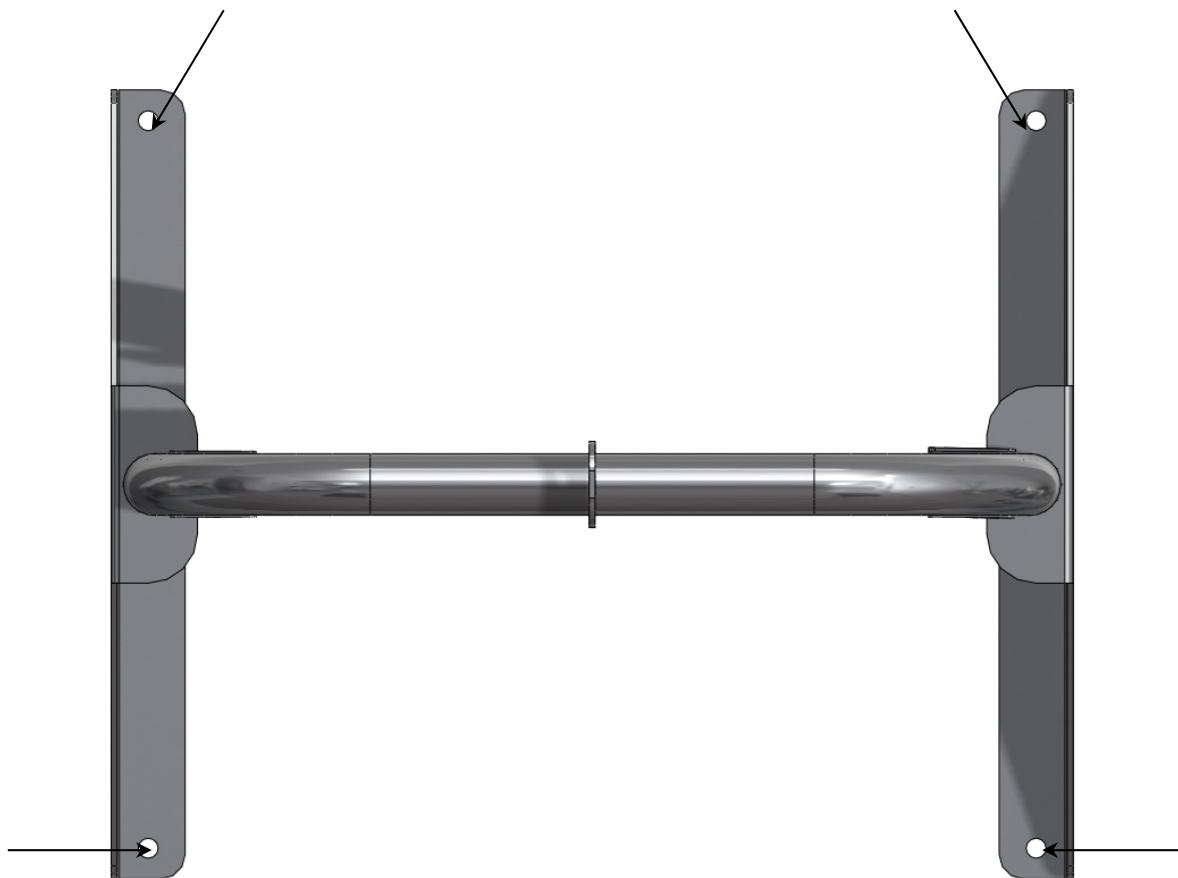

TOP VIEW



WARNING

MAKE SURE THAT YOUR HOLE LOCATIONS ARE AWAY FROM GAS TANK, GAS LINES, BRAKE LINES AND ELECTRICAL LINES PRIOR TO DRILLING ANY MOUNTING HOLES.





Remove the Cable Reel Holder and drill your marked holes.

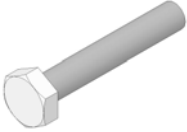
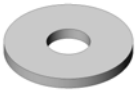

STEP – 03

Base Mounting

			
FAS0092 5/16-18 x 1.5" HHB (4) REQUIRED TORQUE 17ft lbs	FAS0086 5/16" FLAT WASHER (4) REQUIRED	FAS0098 5/16" SPLIT LOCKWASHER (2) REQUIRED	FAS0091 1/4-20 PLUSNUT (4) REQUIRED

The installation fastener kit has been supplied with Plusnut fasteners.
(See pages 3 & 4 for proper fastener installation)

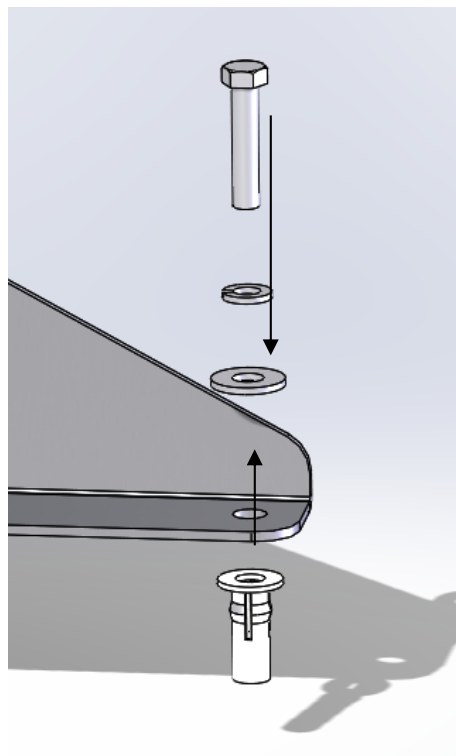

INSTALLATION



STEP – 04

Upper Strap mounting



**MB120
MOUNTING BRACKET**
(1) REQUIRED FOR CRH2
(2) REQUIRED FOR CRH2A



**FAS0061
1/4-20 x 0.5" THP**
(1) REQUIRED FOR CRH2
(2) REQUIRED FOR CRH2A

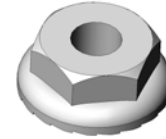

**FAS0055
1/4-20 HEX FLANGE NUT**
(1) REQUIRED FOR CRH2
(2) REQUIRED FOR CRH2A

Find the mounting strap and mount angles in the Parts box. Take the mounting strap and mount it to the clip bracket at the top of the Reel Holder. Use (1) 1/4 - 20 x .50 THP screw and (1) 1/4 - 20 hex flange nut to fasten to the clip bracket. Temporarily snug tighten the fasteners. For installation of a CRH2A unit repeat this process for each side of the unit.

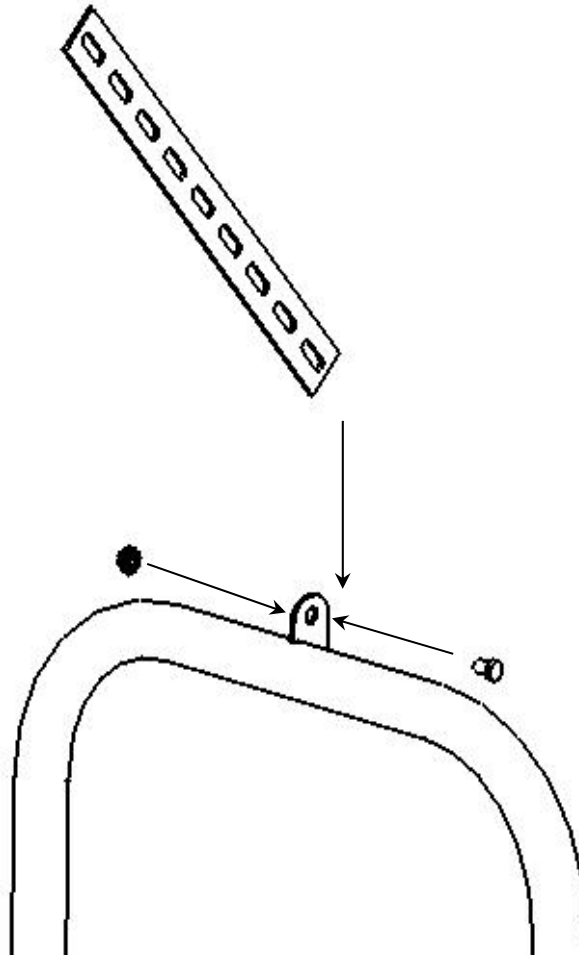



STEP – 04

Upper Strap mounting, cont'd.

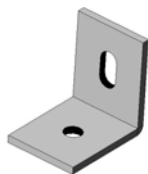

MB118
MOUNTING BRACKET
(2) REQUIRED FOR CRH2
(4) REQUIRED FOR CRH2A



FAS0061
1/4-20 x 0.5" THP
(1) REQUIRED FOR CRH2
(2) REQUIRED FOR CRH2A

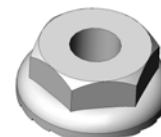

FAS0055
1/4-20 HEX FLANGE NUT
(1) REQUIRED FOR CRH2
(2) REQUIRED FOR CRH2A



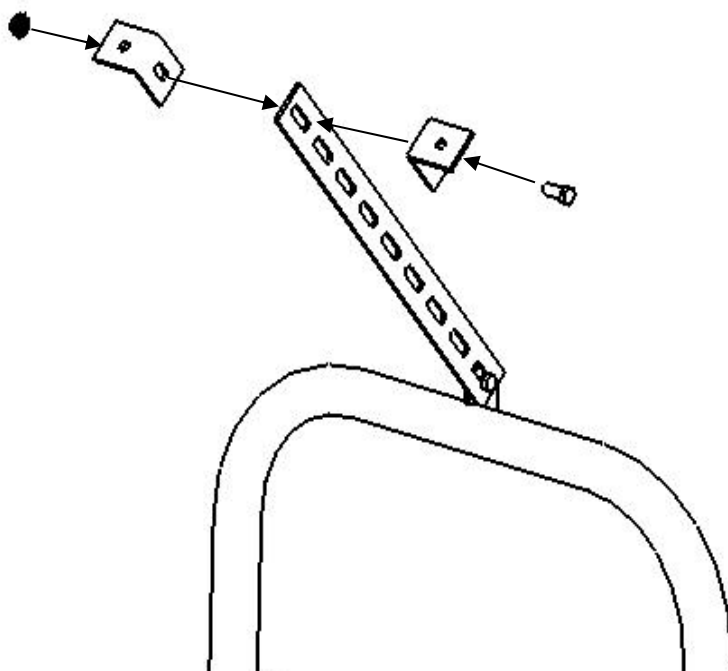

With the mount strap(s) is in place, use the mount angles to mark your holes on the header rail of the van. Make sure that you are clear of any wires. Drill your marked holes using a 3/8" drill bit with stop. Install Plusnuts (See pages 3 & 4 for proper fastener installation) from the fastener bag into the header rail. Then fasten the mount angles to the mount strap using (1) 1/4 - 20 x .75 Hex Head Screw and (1) 1/4 - 20 Hex Flange Nut. Leave these loose so there is adjustability for when you mount to the header rail.



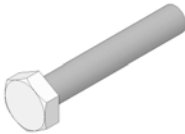

STEP – 04

Upper Strap mounting, cont'd.

			
FAS0079 1/4-20 x 1.5" HHB (2) REQUIRED TORQUE 12ft lbs	FAS0067 1/4" FLAT WASHER (2) REQUIRED	FAS0060 14-20"SPLIT LOCKWASHER (2) REQUIRED	FAS0052 1/4-20 PLUSNUT (2) REQUIRED

Insert (1) 1/4" Flat Washer , (1) 1/4" Lock Washer, and (1) 1/4 - 20 x 1.00 hex. Head screw in that order into the plusnuted holes in the header rail.



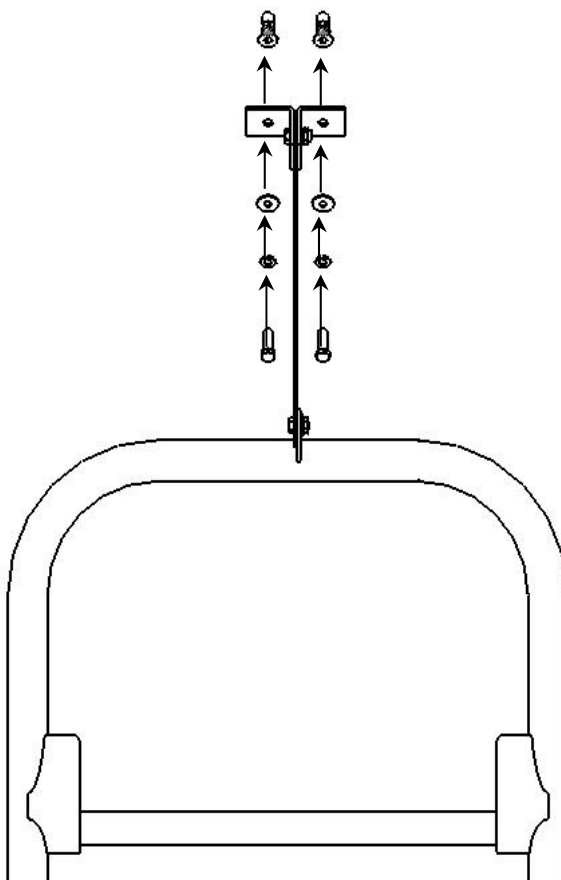

(NOTE: Some header rails have "dips" in them. Use a spacer and a 1/4"- 20 x 1.50 hex head. Screw (FAS0079) when this happens.) Using a 7/16" wrench tighten the screws until they are firmly tight. The recommended torque value is 12 foot-pounds. Then tighten down the mount angle fastener until it is firmly tight. Repeat this process when installing a CRH2A model reel holder.



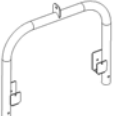

CABLE REEL HOLDER

REPLACEMENT PARTS LISTINGS FOR CRH2 MODEL

 31335-0 HOOP WELDMENT	 31343-0 BASE LEG WELDMENT	 29975-0 REEL SHAFT STD	 MB118 MOUNTING BRACKET	 MB120 MOUNTING STRAP
--	--	---	---	---

REPLACEMENT PARTS LISTINGS FOR 57769 MODEL

 57764-G HOOP SET WELDMENT	 57767-G & 57766-G RIGHT & LEFT LEG WELDMENT	 55768-G REEL SHAFT STD	 MB118 MOUNTING BRACKET	 MB120 MOUNTING STRAP
--	---	---	---	---