

CASE HOLDER (2) PPCS

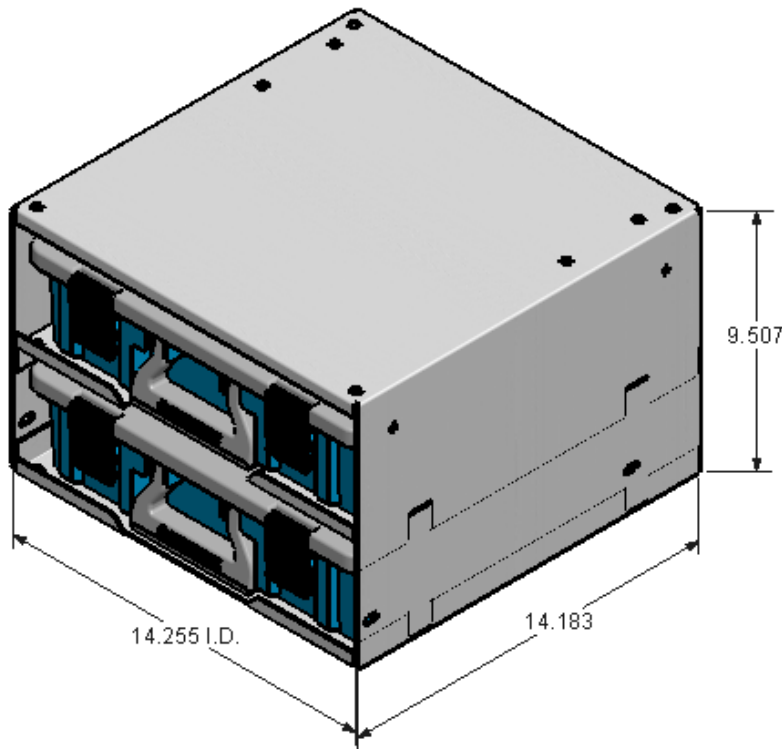

PRODUCT WEIGHT
23.15 LBS

WIDTH x DEPTH x HEIGHT
14-3/8" X 14-1/4" X 9-1/2"

CAPACITY
50 LBS

COLOR
GRAY/BLUE/BLACK

CATALOG NUMBER
CHPPC2S

PRODUCT FEATURES

WELDED CASE HOLDER DESIGNED SPECIFICALLY TO HOLD TWO (2) ADRIAN STEEL SMALL PORTABLE PARTS CASES.



CATALOG NUMBER **CHPPC2S**

PRODUCT APPLICATION

ACCESSORIES THAT WILL WORK WITH THIS PRODUCT

<i>CATALOG NUMBER</i>	<i>DESCRIPTION</i>
DVPPCS	DIVIDER KIT PPCS, 9 QTY

SPECIAL APPLICATION NOTES

Introduction / Comments:

Modular case holder for (2) PPCS small parts cases. Can be stacked vertically or horizontally.

Note:

It is advised that all fasteners used in this assembly and installation should be checked for tightness at the following intervals: @ 2-weeks and again @ 6-weeks of operation. This preventive maintenance step must be completed to ensure your Product gives you long service life.

ITEM NO.	PART NUMBER	DESCRIPTION	CHPPC2S/QTY.
1	54233-G	CASE HOLDER WELDMENT GRAY	1
2	PPCS	PPCS	2

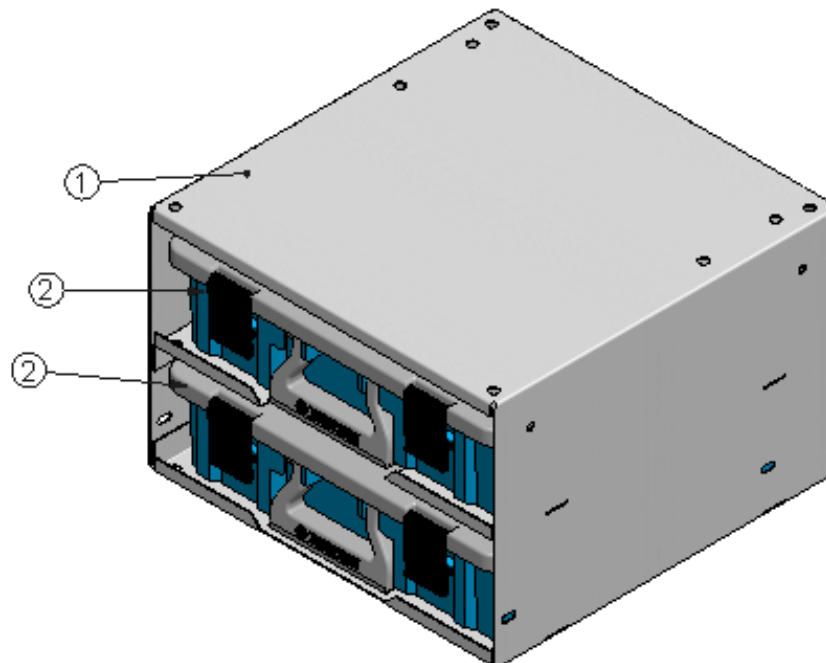

CHPPC2S CROWN TRANSIT CASE HOLDER

- PRECAUTIONS -



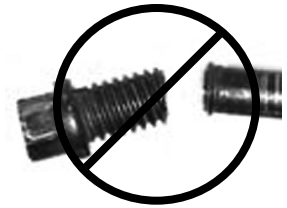

 **CAUTION** 
**THE USE OF AIR IMPACT TOOLS CAN
OVER-TORQUE FASTENERS AND
CAUSE FASTENER FAILURE!**





 **CAUTION** 
**ALL INSTALLATION HOLES SHOULD BE SEALED
WITH SILICON OR BUTYL SEALANT TO PREVENT
EXHAUST FUMES FROM ENTERING THE VEHICLE!**

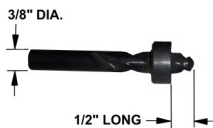

 **DANGER** 
**INSPECT FOR FUEL TANK, FUEL LINES, BRAKE LINES, HIGH
VOLTAGE BATTERIES AND ELECTRICAL LINES PRIOR TO
DRILLING TO AVOID DAMAGING CRITICAL VEHICLE SYSTEMS
OR INJURY TO INSTALLER DURING INSTALLATION PROCESS!**



 **CAUTION** 
**TO AVOID DAMAGING THE VEHICLE ALWAYS USE DRILL
STOPS WHEN DRILLING ANY INSTALLATION HOLES!
ADRIAN AVAILABLE PART #'S 31121-0 (3/8" X 1/2"
DEEP), 31121-0 (1/2" x 1/2" DEEP)**

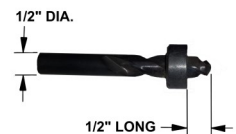

- IMPORTANT WARRANTY REQUIREMENTS -

1. SUBSTITUTING ADRIAN STEEL SPECIFIED FASTENERS FOR ASSEMBLY AND/OR INSTALLATION WILL VOID YOUR PRODUCT WARRANTY.
2. ALL HOLES DRILLED INTO VEHICLE SHOULD HAVE THE RAW METAL EDGES SEALED WITH A SELF-ETCHING PRIMER TO RESIST CORROSION AND POTENTIAL FASTENER POINT FAILURE.
3. ALL FASTENERS USED IN THE INSTALLATION OF THIS PRODUCT SHOULD BE TIGHTENED TO THE TORQUE(S) SPECIFIED IN THESE INSTRUCTIONS.
4. THESE INSTRUCTIONS SHOULD BE KEPT WITH THE VEHICLE.

THE BASIC TOOLS NEEDED FOR MOST INSTALLATIONS



DRILL

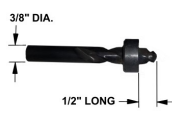

DRILL BIT WITH
STOP

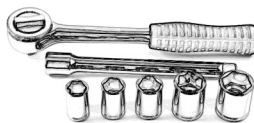

RATCHET, SOCKETS
AND/OR WRENCHES



SCREWDRIVERS



MEASURING TAPE

ADDITIONAL TOOLS MAY BE NEEDED FOR THIS INSTALLATION AND THEY WILL BE IDENTIFIED IN THE STEPS THAT FOLLOW.

If your vehicle contains carpet or a rubber floor mat you will need to prepare the mounting location. Position the product to be installed into the vehicle and once you are satisfied with the mounting locations, mark the mounting locations. Using a 1-3/16" diameter carpet cutter (P/N: 31183-0). Select the appropriate floor spacers as shown in the illustration. Set those aside for use later into the installation process. Using the correct drill bit size for the selected plusnut, drill the mounting holes in the vehicle sheet metal to prepare for installing the plusnuts.

If you are thru-bolting at any of the locations simply drill a hole that is 1/16" larger than the bolt size(s) for those locations.

Once you have drilled the holes into the vehicle, the raw metal edges should be sealed using a self-etching primer to resist corrosion and potential fastener point failure.

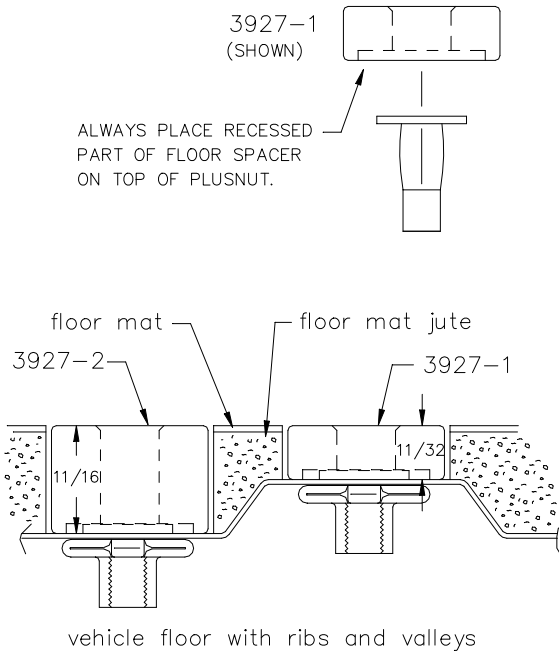

A PLUSNUT (RIVNUT) SETTING TOOL IS REQUIRED FOR PLUSNUT (RIVNUT) INSTALLATION . PLUS NUT SETTING TOOL CAN BE ORDERED THROUGH ADRIAN STEEL, OR USE AN AIR POWERED PLUSNUT SETTING GUN.

1/4-20UNC Plusnut (FAS0052) Use 3/8" dia. drill w/stop

FAS0080 SCREW, HXHD, 1/4-20UNCx2.00", G8
FAS0067 WASHER, FLAT, 1/4"ID
22200-0 PLUSNUT TOOL

5/16-18UNC Plusnut (FAS0091) Use 1/2" dia. drill w/stop

FAS0095 SCREW, HXHD, 5/16-18UNCx2.00", G8
FAS0086 WASHER, FLAT, 5/16"ID
22200-0 PLUSNUT TOOL

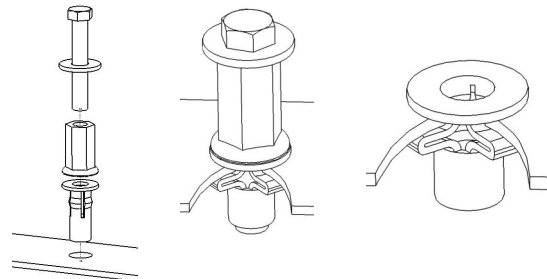

Place barrel of the plusnut body in sheet metal thru hole until flange is flush with sheet metal.

Using a 9/16" combination wrench of plusnut tool body and a second hand wrench, ratchet, or air tool, rotate the hex bolt head CW to draw plus nut flanges up (set the plusnut).

**Installation and/or Assembly Fasteners
BAGWTR**

ITEM NO.	PART NUMBER	DESCRIPTION	BAGWTR/QTY.
1	BAG0509-A	5"X9" 4MIL AUTOBAG	1
2	FAS0052	Plusnut, 1/4	4
3	FAS0091	Plusnut, 5/16	4
4	FAS0055	Nut, Hex Flange, Nylock 1/4-20	6
5	FAS0060	Washer, Lock, Split, 1/4	4
6	FAS0098	Washer, Lock, Split, 5/16, Zinc Plate	4
7	FAS0061	Screw, Truss Hd. Ph, 1/4-20x0.50	2
8	FAS0063	Screw, Hex Hd, 1/4-20x0.75 Zn Plate, Grade 5	2
9	FAS0078	Screw, Hex Hd, 1/4-20x1.00 Zn Plate, Grade 8	4
10	FAS0079	Screw, Hex Hd, 1/4-20x1.50 Zn Plate, Grade 8	4
11	FAS0092	Screw, Hex Hd, 5/16-18x1.50 Zn Plate, G8	4
12	FAS0067	Washer, Flat, 1/4	4
13	FAS0086	WASHER, FLAT USS 5/16 ZP	4
14	03927-1	Floor Spacer Short	2
15	03927-2	Tall Floor Spacer	2

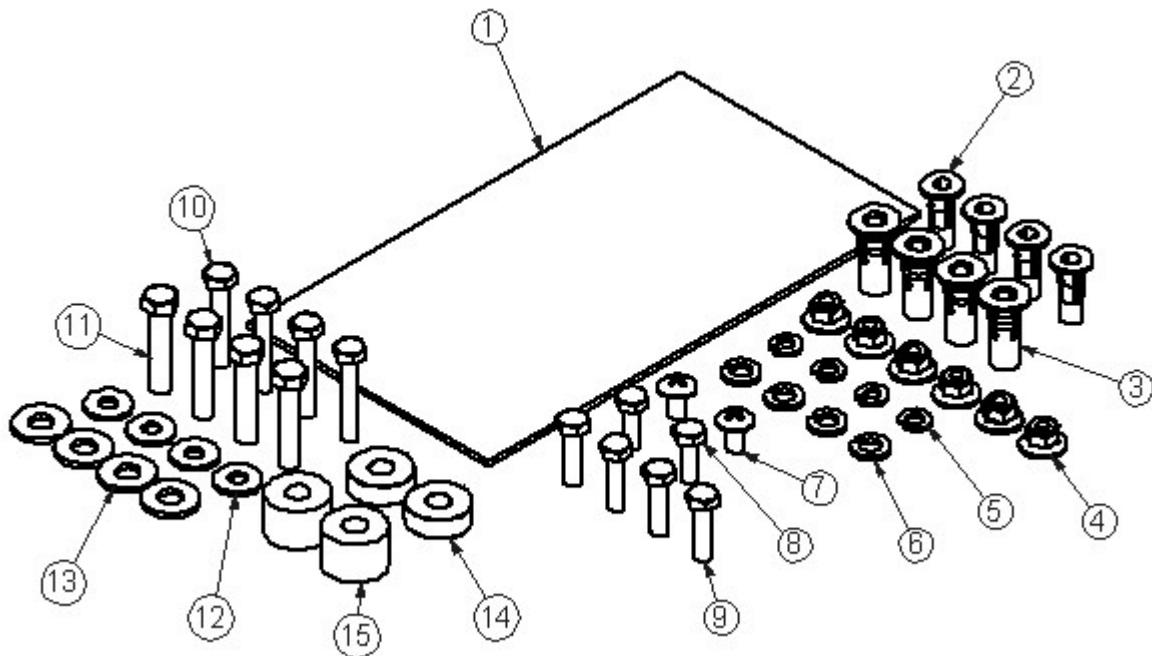

Step 01 Remove plastic cases from CHPPC2S case holder. Place CHPPC2S case holder into vehicle in desired mounting position and mark four (4) floor mounting holes (8 holes to choose from - must mount in 4 corners). Also, mark holes for bracketing to the van wall or shelving as necessary (no brackets included.)

There are (8) holes to choose from in the bottom of the case holder for mounting. There is a larger (4) corner hole pattern located near the corners of the bottom shelf for standard installation, and there is a smaller pattern of (4) holes more inward for mounting to a SLD141330.

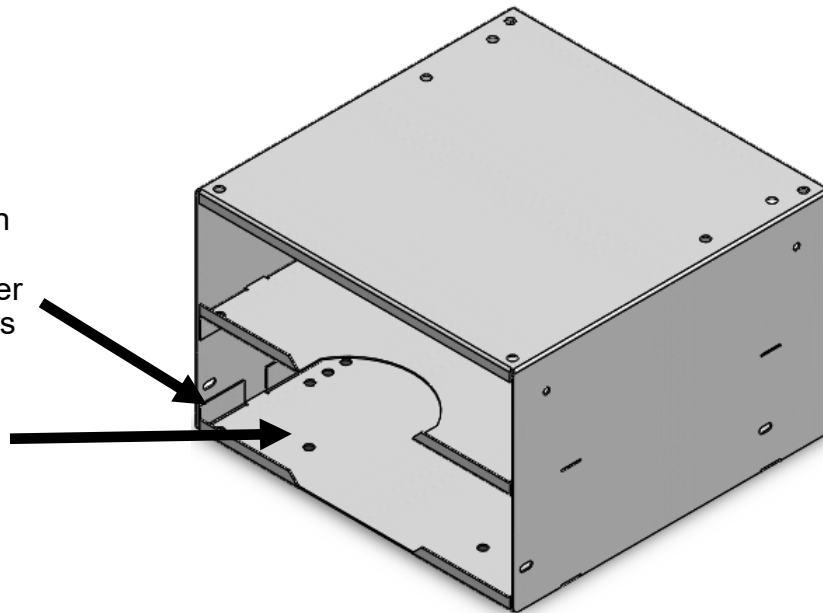

Step 02 Secure to floor or cabinet using (4) FAS0091 5/16-18 plusnuts, (4) FAS0092 5/16-18 x 1.5 hex head screws, (4) FAS0086 5/16 flat washers, and (4) FAS0098 5/16 split lock washers.

NOTE: For mounting to wood subfloors, use (4) FAS0829 5/16-18 x 1/2 T-Nuts (not included) in place of plusnuts.

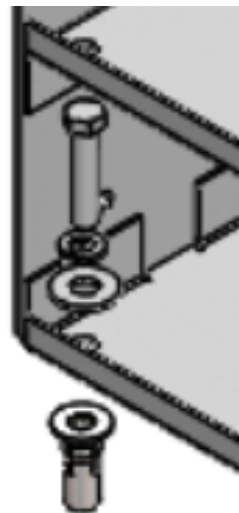
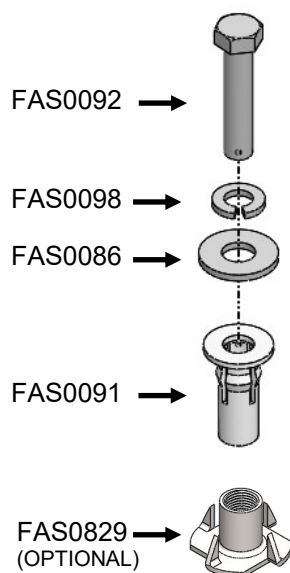

Step 03 Double check all fasteners are tight.

Place the two (2) PPCS small parts cases back into CHPPC2S case holder.

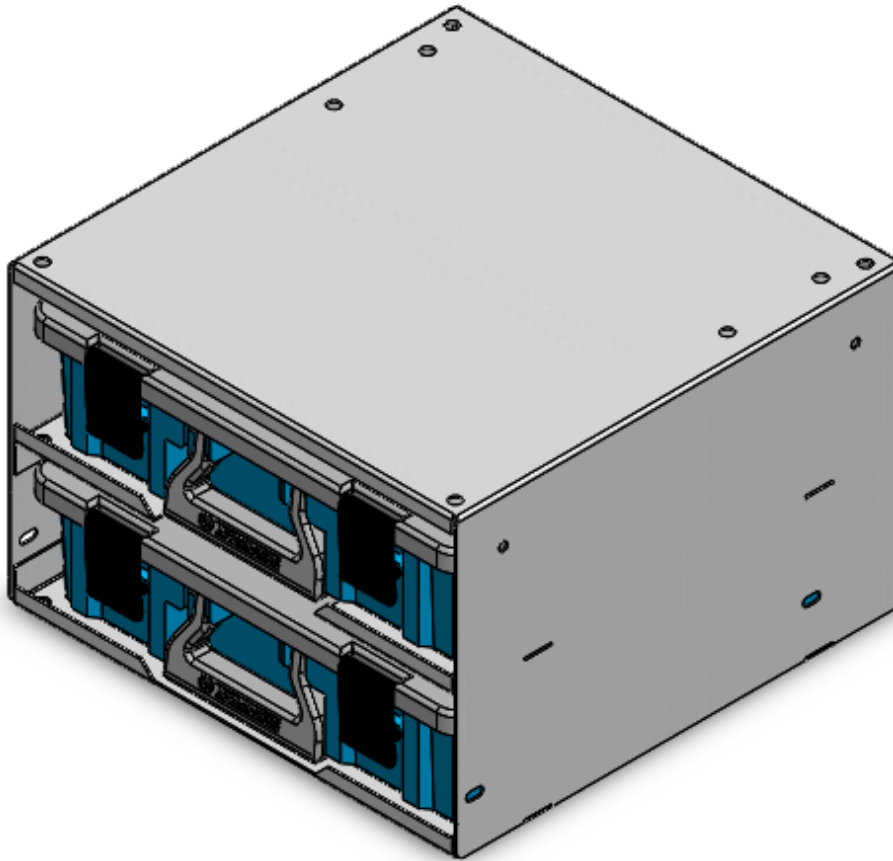

**DOUBLE CHECK ALL FASTENER LOCATIONS TO BE SURE THAT ALL
FASTENERS ARE TIGHTENED TO SPECIFICATIONS.
YOUR INSTALLATION IS NOW COMPLETE!
STOW THIS COPY IN THE VEHICLE FOR FUTURE REFERENCES!**