

CASE HOLDER (6) PPCS

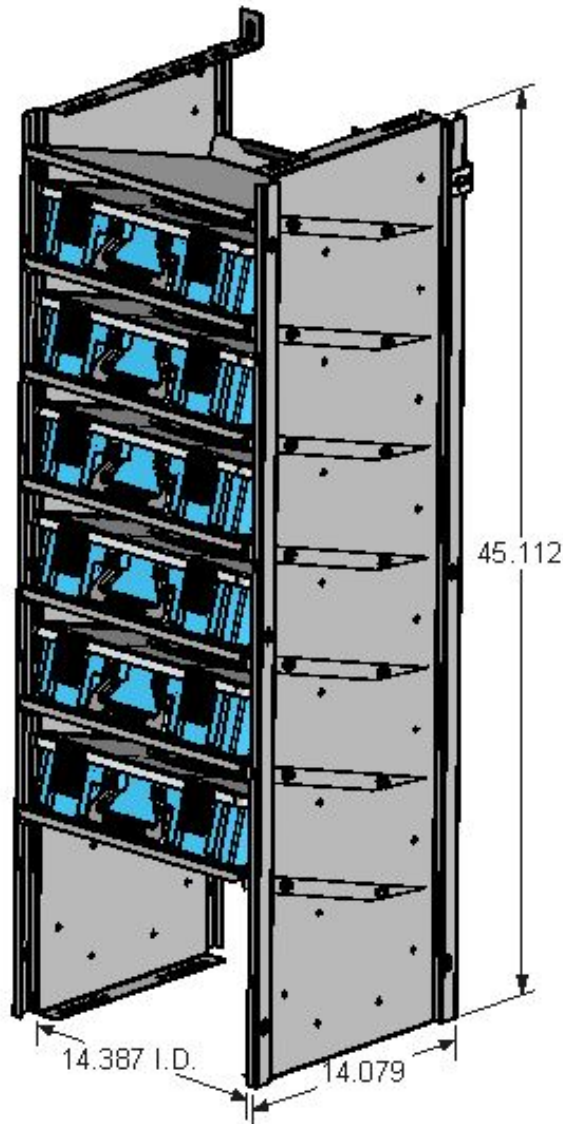

PRODUCT WEIGHT
75.72 LBS

WIDTH x DEPTH x HEIGHT
14-3/8" X 14-1/8" X 45-1/8"

CAPACITY
150 LBS

COLOR
GRAY/BLUE/BLACK

CATALOG NUMBER
CHPPC06

PRODUCT FEATURES

WELDED CASE HOLDER DESIGNED SPECIFICALLY TO HOLD SIX (6) ADRIAN STEEL SMALL PORTABLE PARTS CASES.



CATALOG NUMBER CHPPC06

PRODUCT APPLICATION

ACCESSORIES THAT WILL WORK WITH THIS PRODUCT

CATALOG NUMBER	DESCRIPTION
DVPPCS	DIVIDER KIT PPCS, 9 QTY

SPECIAL APPLICATION NOTES

Introduction / Comments:

CASE HOLDER FOR SIX PPCS PORTIBLE PARTS CASE SMALL. HOLDS AND ORGANIZERS SMALL PARTS IN CASES WITH DIVIDERS.

Note:

It is advised that all fasteners used in this assembly and installation should be checked for tightness at the following intervals: @ 2-weeks and again @ 6-weeks of operation. This preventive maintenance step must be completed to ensure your Product gives you long service life.

ITEM NO.	PART NUMBER	DESCRIPTION	CHPPC06./QTY.
1	54380	SHELF ASM, CHPPC06	1
2	PPCS	PORTABLE PARTS CASE SMALL	6
3	BAGCHPPC10.	FAS BAG, CHPPC10S	1
4	MB113.	MOUNT BRKT W/FAS 1x5	2

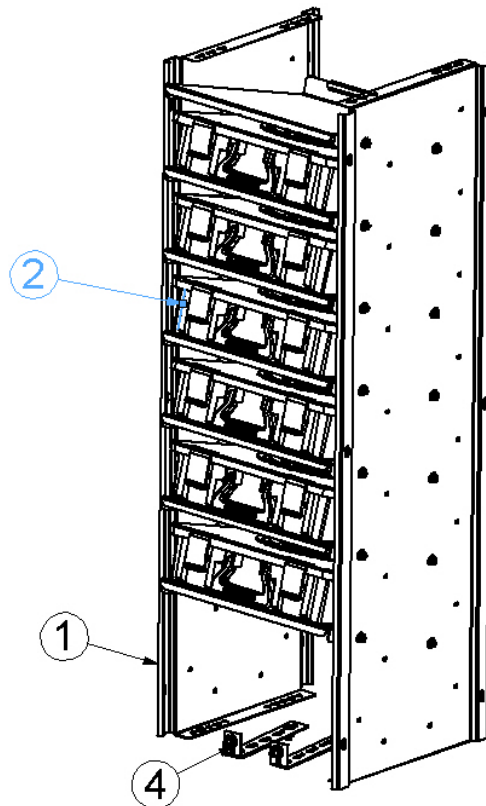

CHPPC06 CASE HOLDER (6) TOTES PPCS

- PRECAUTIONS -





 **CAUTION** 
**THE USE OF AIR IMPACT TOOLS CAN
OVER-TORQUE FASTENERS AND
CAUSE FASTENER FAILURE!**





 **CAUTION** 
**ALL INSTALLATION HOLES SHOULD BE SEALED
WITH SILICON OR BUTYL SEALANT TO PREVENT
EXHAUST FUMES FROM ENTERING THE VEHICLE!**



 **DANGER** 
**INSPECT FOR FUEL TANK, FUEL LINES, BRAKE LINES, HIGH
VOLTAGE BATTERIES AND ELECTRICAL LINES PRIOR TO
DRILLING TO AVOID DAMAGING CRITICAL VEHICLE SYSTEMS
OR INJURY TO INSTALLER DURING INSTALLATION PROCESS!**



 **CAUTION** 
**TO AVOID DAMAGING THE VEHICLE ALWAYS USE DRILL
STOPS WHEN DRILLING ANY INSTALLATION HOLES!
ADRIAN AVAILABLE PART #'S 31119-0 (3/8" X 1/2"
DEEP), 31121-0 (1/2" x 1/2" DEEP)**



- IMPORTANT WARRANTY REQUIREMENTS -

1. SUBSTITUTING ADRIAN STEEL SPECIFIED FASTENERS FOR ASSEMBLY AND/OR INSTALLATION WILL VOID YOUR PRODUCT WARRANTY.
2. ALL HOLES DRILLED INTO VEHICLE SHOULD HAVE THE RAW METAL EDGES SEALED WITH A SELF-ETCHING PRIMER TO RESIST CORROSION AND POTENTIAL FASTENER POINT FAILURE.
3. ALL FASTENERS USED IN THE INSTALLATION OF THIS PRODUCT SHOULD BE TIGHTENED TO THE TORQUE(S) SPECIFIED IN THESE INSTRUCTIONS.
4. THESE INSTRUCTIONS SHOULD BE KEPT WITH THE VEHICLE.

THE BASIC TOOLS NEEDED FOR MOST INSTALLATIONS



DRILL



DRILL BIT WITH
STOP



RATCHET, SOCKETS
AND/OR WRENCHES



SCREWDRIVERS



MEASURING TAPE

ADDITIONAL TOOLS MAY BE NEEDED FOR THIS INSTALLATION AND THEY WILL BE IDENTIFIED IN THE STEPS THAT FOLLOW.

If your vehicle contains carpet or a rubber floor mat you will need to prepare the mounting location. Position the product to be installed into the vehicle and once you are satisfied with the mounting locations, mark the mounting locations. Using a 1-3/16" diameter carpet cutter (P/N: 31183-0). Select the appropriate floor spacers as shown in the illustration. Set those aside for use later into the installation process. Using the correct drill bit size for the selected plusnut, drill the mounting holes in the vehicle sheet metal to prepare for installing the plusnuts.

If you are thru-bolting at any of the locations simply drill a hole that is 1/16" larger than the bolt size(s) for those locations.

Once you have drilled the holes into the vehicle, the raw metal edges should be sealed using a self-etching primer to resist corrosion and potential fastener point failure.

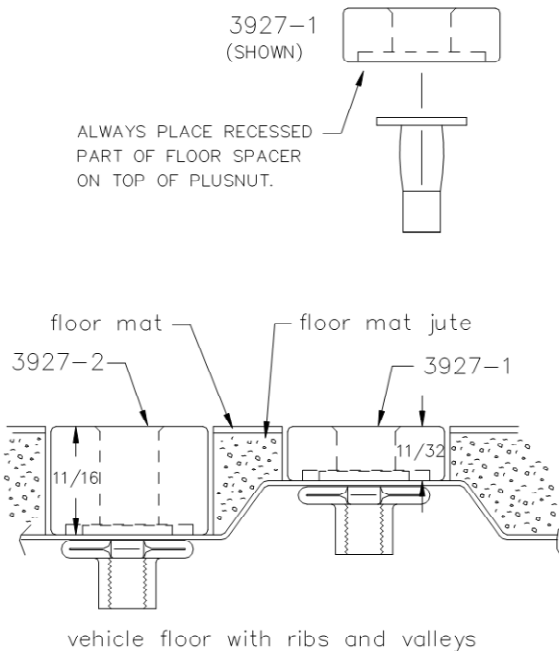

A PLUSNUT (RIVNUT) SETTING TOOL IS REQUIRED FOR PLUSNUT (RIVNUT) INSTALLATION . PLUS NUT SETTING TOOL CAN BE ORDERED THROUGH ADRIAN STEEL, OR USE AN AIR POWERED PLUSNUT SETTING GUN.

1/4-20UNC Plusnut (FAS0052) Use 3/8" dia. drill w/stop

FAS0080 SCREW, HXHD, 1/4-20UNCx2.00", G8

FAS0067 WASHER, FLAT, 1/4"ID

22200-0 PLUSNUT TOOL

5/16-18UNC Plusnut (FAS0091) Use 1/2" dia. drill w/stop

FAS0095 SCREW, HXHD, 5/16-18UNCx2.00", G8

FAS0086 WASHER, FLAT, 5/16"ID

22200-0 PLUSNUT TOOL

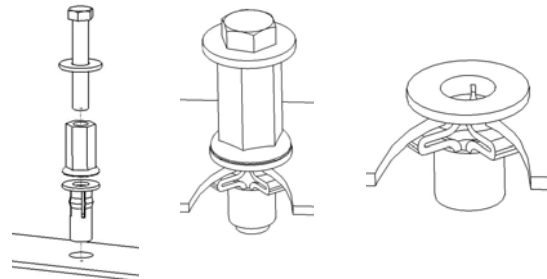

Place barrel of the plusnut body in sheet metal thru hole until flange is flush with sheet metal.

Using a 9/16" combination wrench of plusnut tool body and a second hand wrench, ratchet, or air tool, rotate the hex bolt head CW to draw plus nut flanges up (set the plusnut).

BAGCHPPC10

ITEM NO.	PART NUMBER	DESCRIPTION	BAGCHPPC10/QTY.
1	BAG0507-A	5" x 7" 3MIL AUTOBAG	1
2	FAS0018	SCREW,HH SFLNG 1/4-20X.62 IP	48
3	FAS0552	Washer, Flat, 5/16, SST	5
4	FAS0588	Washer, Lock, Split, 5/16, SS	5
5	FAS0091	Plusnut, 5/16	5
6	FAS0055	Nut, Hex Flange,Nylock 1/4-20	48
7	FAS0095	Screw, Hex Hd, 5/16-18x2.00 , Grade 8	4
8	03927-2	Tall Floor Spacer	4

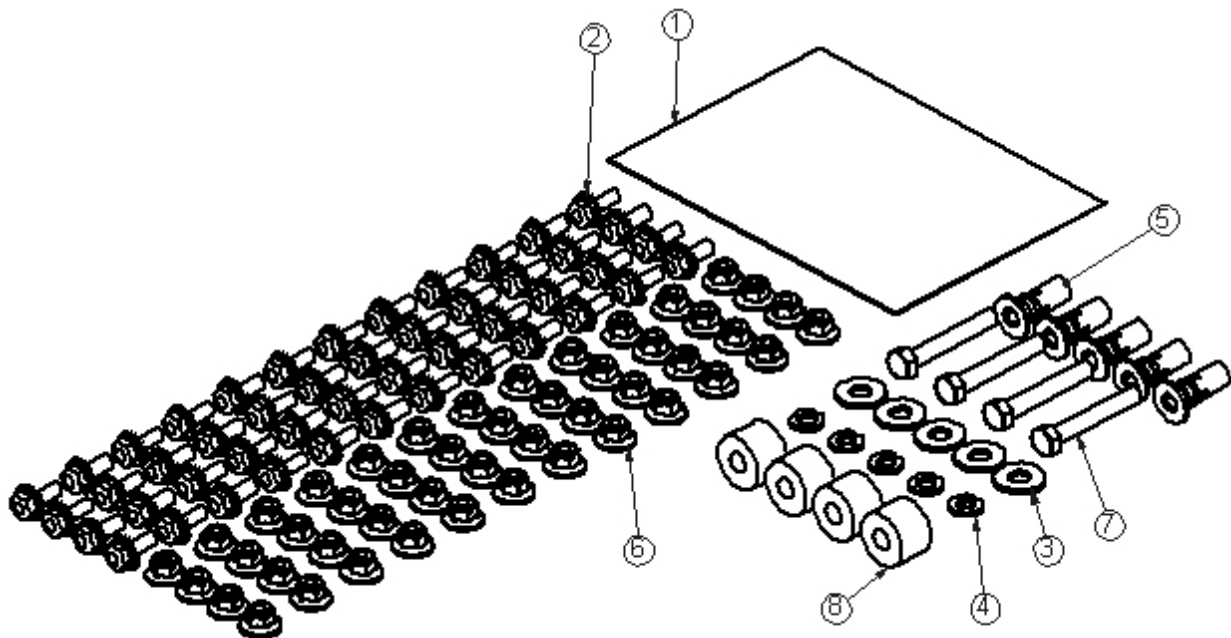

Individual Fastener Images & Descriptions

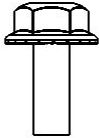
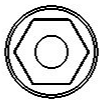

FAS0018
SCREW, HxHd, SFLNG,
1/4-20UNC x 5/8", ZP

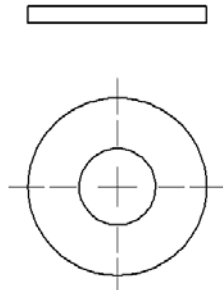

FAS0552
WASHER, FLAT
5/16 SS

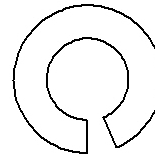
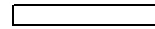

FAS0588
WASHER, LOCK, SPLIT
5/16 SS

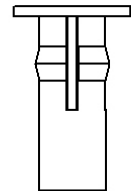
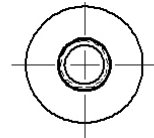

FAS0091
5/16 PLUS NUT

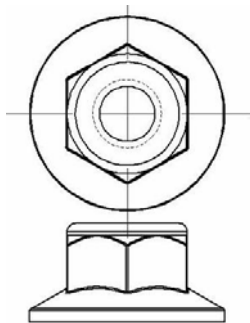

FAS0055
NUT, HEX FLANGE,
NYLOCK, 1/4-20

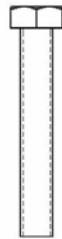

FAS0095
SCREW HEX HD
5/16-18 X 2.0 ZP

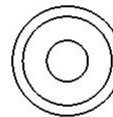

03927-2
Spacer, Floor,
1 1/16" ht

Step 01 Place case holder in desired position refer to sales drawing. Mark the four floor mounting hole locations (each corner of the end panels).

Drill mounting holes using drill bits with stops and apply primer to hole edges.

Insert and set four plus nuts.

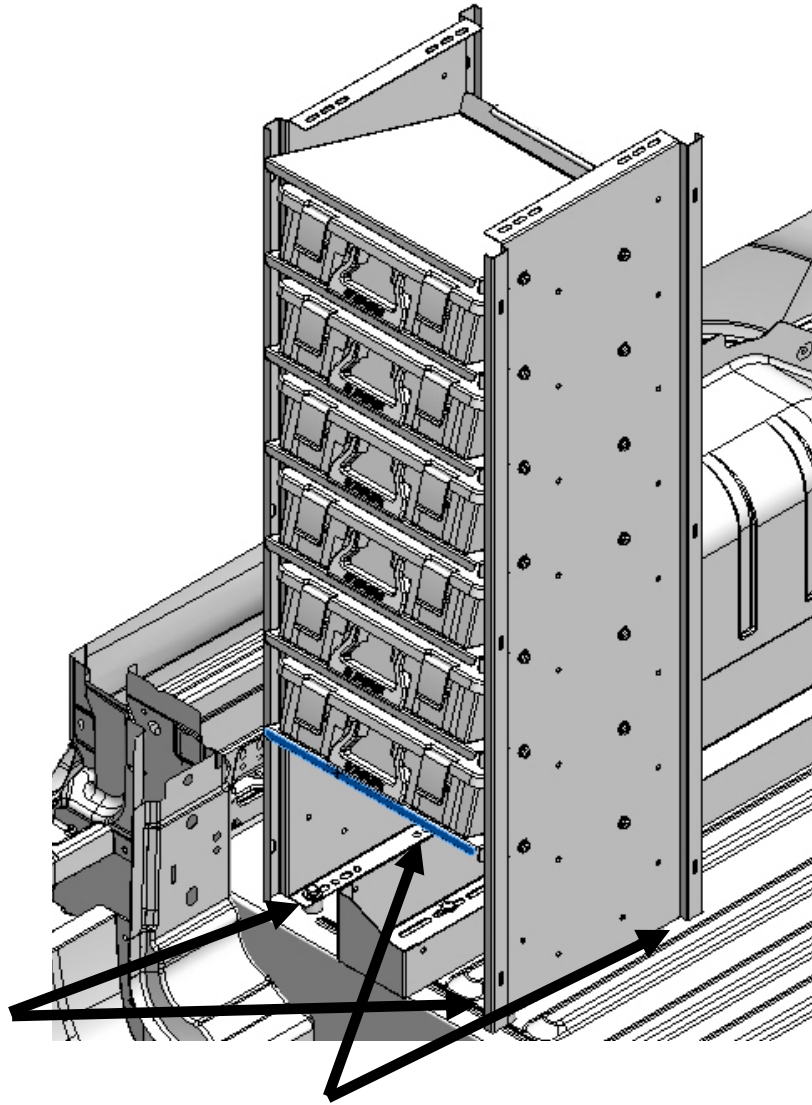

Step 02 Bolt case Holder end panels to floor using 4 ea FAS0095 screw hh 5/16-18 x 2.0, FAS0588 5/18 lock washer, FAS0552 5/16 flat washer, 03937-2 tall floor spacer, into plusnut.

03937-2 may not be needed.

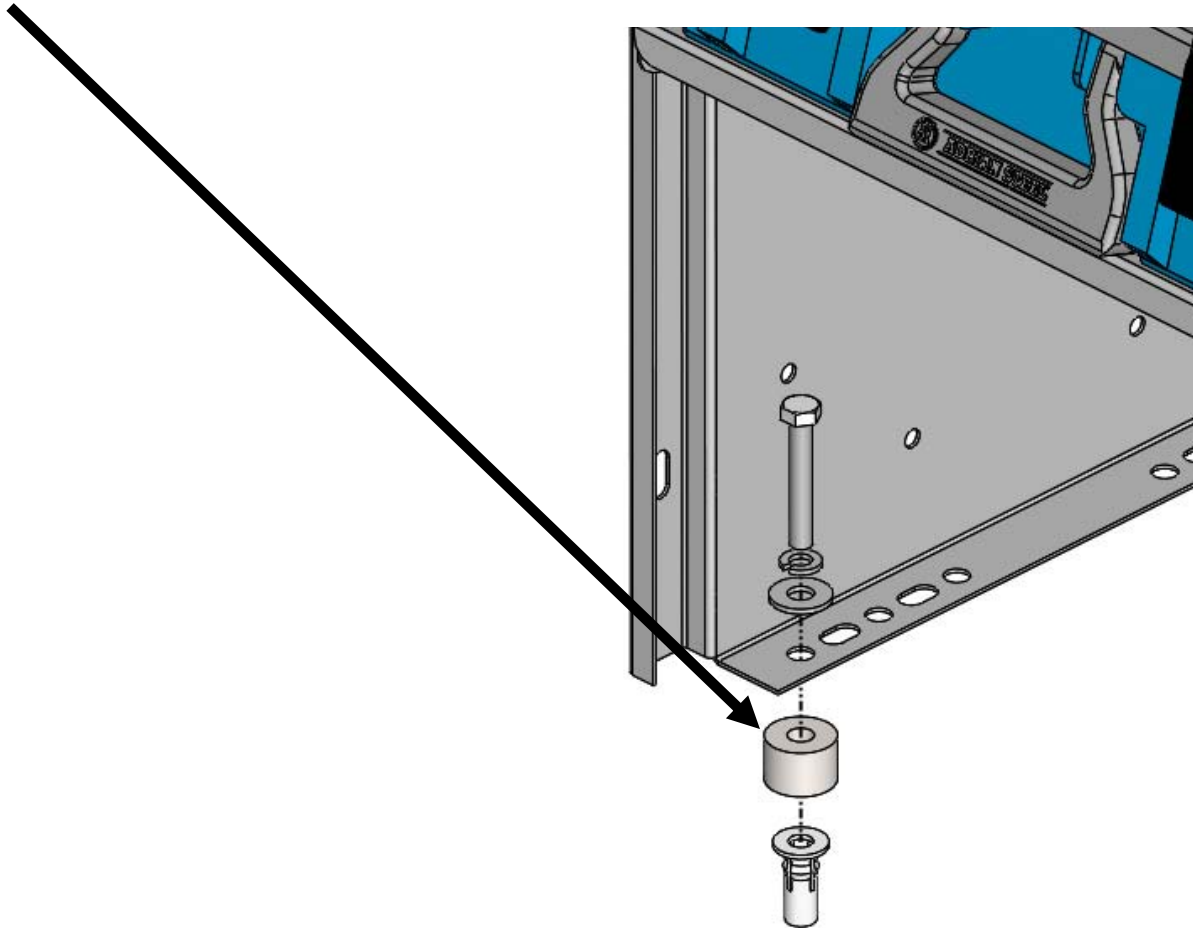

Step 02 Type short description of operation being performed here

Step 03 Note if using AD rails fir header mounting skip this step.

Position mounting brackets at top of end panels and mark the two header mounting locations.

Drill mounting holes using drill stops and apply primer to hole edges

Inset and set two plusnuts.

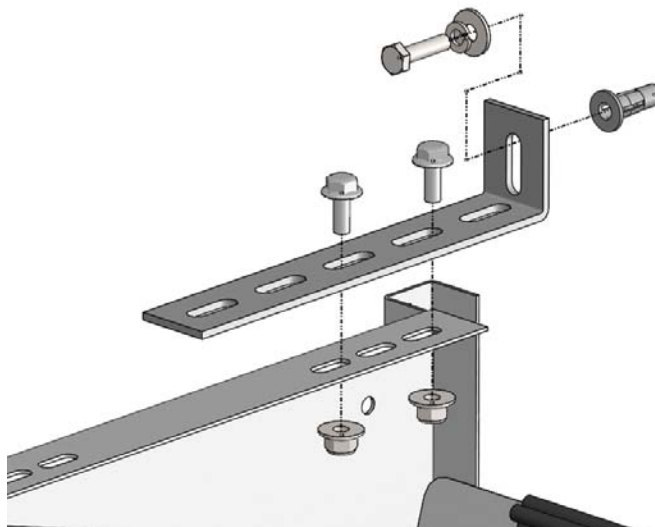

TYPICAL FOR BOTH (2) END PANEL HEADER LOCATIONS.

NOTE: IF USING AD-RAIL AT HEADER PLUSNUT WILL NOT BE USED!

Step 04 Bolt case Holder end panels to the header (or header rail AD-Rail) Using strap brackets and fasteners listed.

Note if mounting to AD-rail at header use appropriate fasteners included with rail kit instead of the plusnuts and plusnut fasteners.

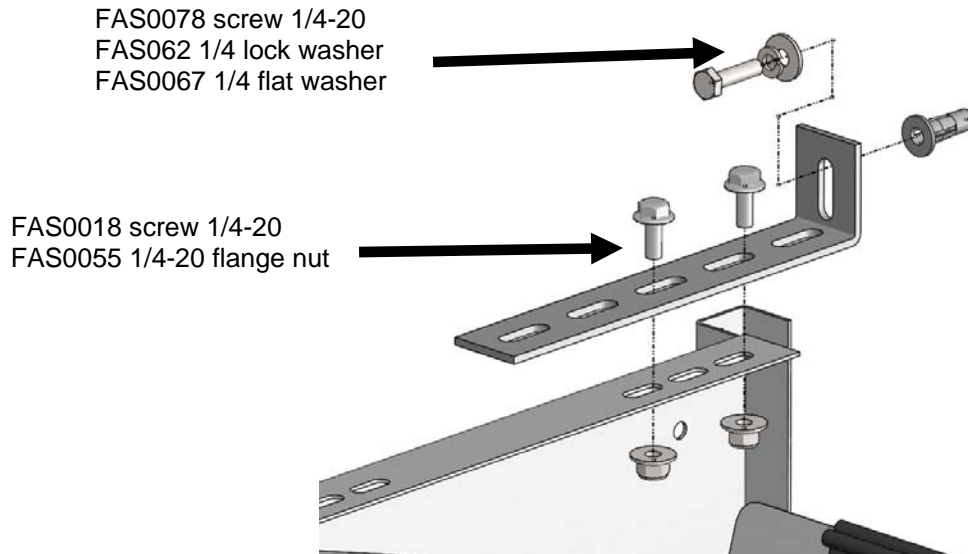

TYPICAL FOR BOTH (2) END PANEL HEADER LOCATIONS.

NOTE: IF USING AD-RAIL AT HEADER PLUSNUT WILL NOT BE USED!

Note if mounting to AD-rail at header use appropriate fasteners included with rail kit instead of the plusnuts and plusnut fasteners.

DOUBLE CHECK ALL FASTENERS LOCATIONS TO BE SURE THAT ALL FASTENERS ARE TIGHTENED TO SPECIFICATIONS.

YOUR INSTALLATION IS NOW COMPLETE!

STOW THIS COPY IN THE VEHICLE FOR FUTURE REFERENCES