

LAPTOP HOLDER FOR CCD

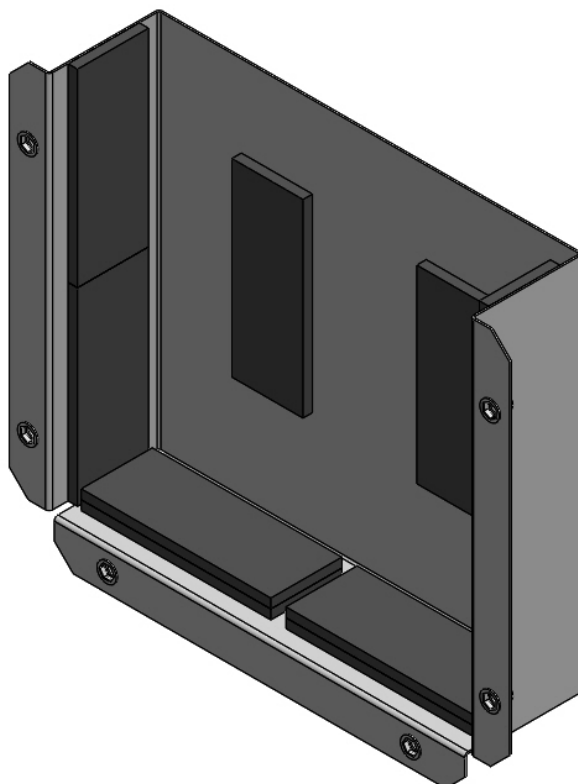

PRODUCT WEIGHT
3 LBS

WIDTH x DEPTH x HEIGHT
13.2" x 2.95" x 11.1"

COLOR
GRAY

CATALOG NUMBER
CCDLTH

PRODUCT FEATURES

This laptop holder is meant to be used in all CCD units (and existing DDFFEDT). Most 15" or smaller laptops can be store in this unit, with the maximum width of the laptop being 13 ⁷/₈". Any wider and the laptop will interfere with the latch on the CCD lid and cause it to not close entirely.

SEE PAGE 2 FOR APPLICATION NOTES AND ACCESSORIES, OTHER PRODUCTS THAT WORK WITH THIS UNIT.



CATALOG NUMBER CCDLTH

PRODUCT APPLICATION

This product is designed to be installed inside, on the driver side of
Center Console Desks

PRODUCT THAT WILL WORK WITH THIS PRODUCT

CATALOG NUMBER	DESCRIPTION
CCD6	CNT,CONSOLE,6",FD TRANS
CCD10	CNT,CONSOL,10" RAM PM
CCD12	CNT, CONSOLE, 12" FSV
CCDHF10*	CNT,CONSOL,HANG FILE, 10"
CCDHF12*	CNT,CONSOL,HANG FILE, 12"

SPECIAL APPLICATION NOTES

* CCDLTH can be used with the hanging file kits in the CCD10 and CCD12 as long as the hanging file kit is installed at the legal sized position. If installed at letter side the CCDLTH will not work.

Introduction / Comments:

**THIS LAPTOP HOLDER IS DESIGNED TO MOUNT IN THE CCD
CENTER CONSOLE DESKS**

Note: It is advised that all fasteners used in this assembly and installation should be checked for tightness at the following intervals: @ 2-weeks and again @ 6-weeks of operation. This preventive maintenance step must be completed to ensure your Product gives you long service life.

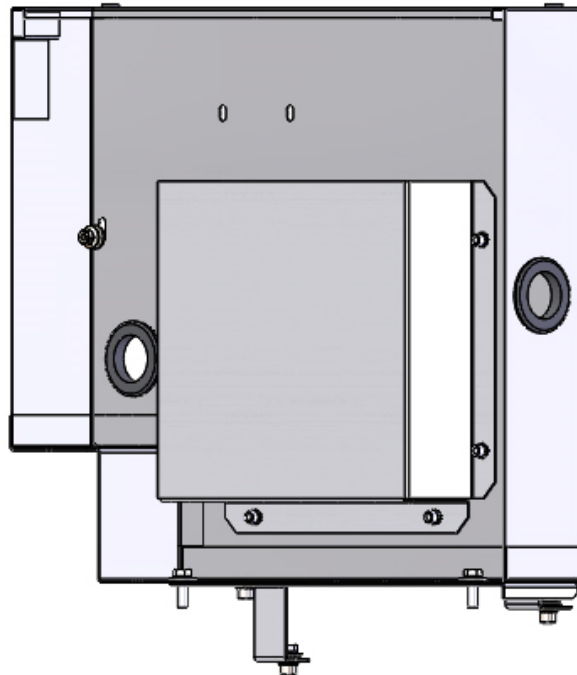

**CCD LAPTOP HOLDER
CCD6-B LAPTOP HOLDER**

- PRECAUTIONS -



CAUTION



**THE USE OF AIR IMPACT TOOLS CAN
OVER-TORQUE FASTENERS AND
CAUSE FASTENER FAILURE!**



CAUTION



**ALL INSTALLATION HOLES SHOULD BE SEALED
WITH SILICON OR BUTYL SEALANT TO PREVENT
EXHAUST FUMES FROM ENTERING THE VEHICLE!**



DANGER



**INSPECT FOR FUEL TANK, FUEL LINES, BRAKE LINES, HIGH
VOLTAGE BATTERIES AND ELECTRICAL LINES PRIOR TO
DRILLING TO AVOID DAMAGING CRITICAL VEHICLE SYSTEMS
OR INJURY TO INSTALLER DURING INSTALLATION PROCESS!**



CAUTION



**TO AVOID DAMAGING THE VEHICLE ALWAYS
USE DRILL STOPS WHEN DRILLING ANY IN-
STALLATION HOLES!**



- IMPORTANT WARRANTY REQUIREMENTS -

1. SUBSTITUTING ADRIAN STEEL SPECIFIED FASTENERS FOR ASSEMBLY AND/OR INSTALLATION WILL VOID YOUR PRODUCT WARRANTY.
2. ALL HOLES DRILLED INTO VEHICLE SHOULD HAVE THE RAW METAL EDGES SEALED WITH A SELF-ETCHING PRIMER TO RESIST CORROSION AND POTENTIAL FASTENER POINT FAILURE.
3. ALL FASTENERS USED IN THE INSTALLATION OF THIS PRODUCT SHOULD BE TIGHTENED TO THE TORQUE(S) SPECIFIED IN THESE INSTRUCTIONS.
4. THESE INSTRUCTIONS SHOULD BE KEPT WITH THE VEHICLE.

THE BASIC TOOLS NEEDED FOR MOST INSTALLATIONS



DRILL



DRILL BIT WITH
STOP



RATCHET, SOCKETS
AND/OR WRENCHES



SCREWDRIVERS



MEASURING TAPE

ADDITIONAL TOOLS MAY BE NEEDED FOR THIS INSTALLATION AND THEY WILL BE IDENTIFIED IN THE STEPS THAT FOLLOW.

If your vehicle contains carpet or a rubber floor mat you will need to prepare the mounting location. Position the product to be installed into the vehicle and once you are satisfied with the mounting locations, mark the mounting locations. Using a 1-3/16" diameter carpet cutter (P/N: 31183-0). Select the appropriate floor spacers as shown in the illustration. Set those aside for use later into the installation process.

Using the correct drill bit size for the selected plusnut, drill the mounting holes in the vehicle sheet metal to prepare for installing the plusnuts.

If you are thru-bolting at any of the locations simply drill a hole that is 1/16" larger than the bolt size(s) for those locations.

Once you have drilled the holes into the vehicle, the raw metal edges should be sealed using a self-etching primer to resist corrosion and potential fastener point failure.

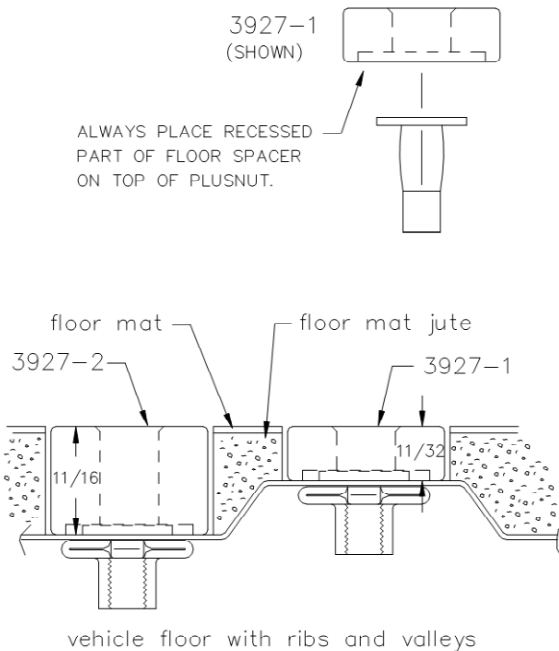

A PLUSNUT (RIVNUT) SETTING TOOL IS REQUIRED FOR PLUSNUT (RIVNUT) INSTALLATION AND IS NOT SUPPLIED WITH THIS KIT. OR USE AN AIR POWERED PLUSNUT SETTING GUN.

1/4-20UNC Plusnut (FAS0052) Use 3/8" dia. drill w/stop

FAS0080 SCREW, HXHD, 1/4-20UNCx2.00", G8
FAS0067 WASHER, FLAT, 1/4"ID
22200-0 PLUSNUT TOOL

5/16-18UNC Plusnut (FAS0091) Use 1/2" dia. drill w/stop

FAS0095 SCREW, HXHD, 5/16-18UNCx2.00", G8
FAS0086 WASHER, FLAT, 5/16"ID
22200-0 PLUSNUT TOOL

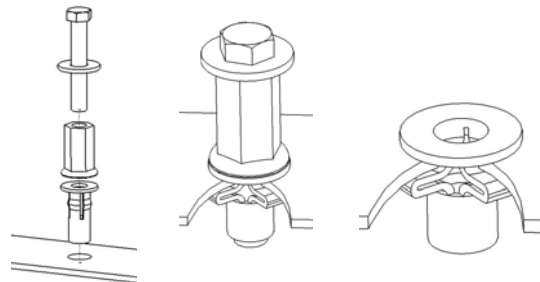

Place barrel of the plusnut body in sheet metal thru hole until flange is flush with sheet metal.

Using a 9/16" combination wrench of plusnut tool body and a second hand wrench, ratchet, or air tool, rotate the hex bolt head CW to draw plus nut flanges up (set the plusnut).

CCDLTH
LAPTOP HOLDER FOR CCD
CCDLTH-B
LAPTOP HOLDER FOR CCD6-B BLACK

ITEM NO.	PART NUMBER	DESCRIPTION	CCDLTH/QTY.
1	47891-G	LAPTOP HOLDER BRKT ASS'Y	1
2	47106	Gasket, Foot, FST	12
3	BAGMD610-0	BAG FOR FASTENERS FOR MD610	1
4	CRTCCDLTH	CARTON FOR CCD LAPTOP HOLDER	1
5	50061	INSTALL INSTRUCTION CCDLTH	1

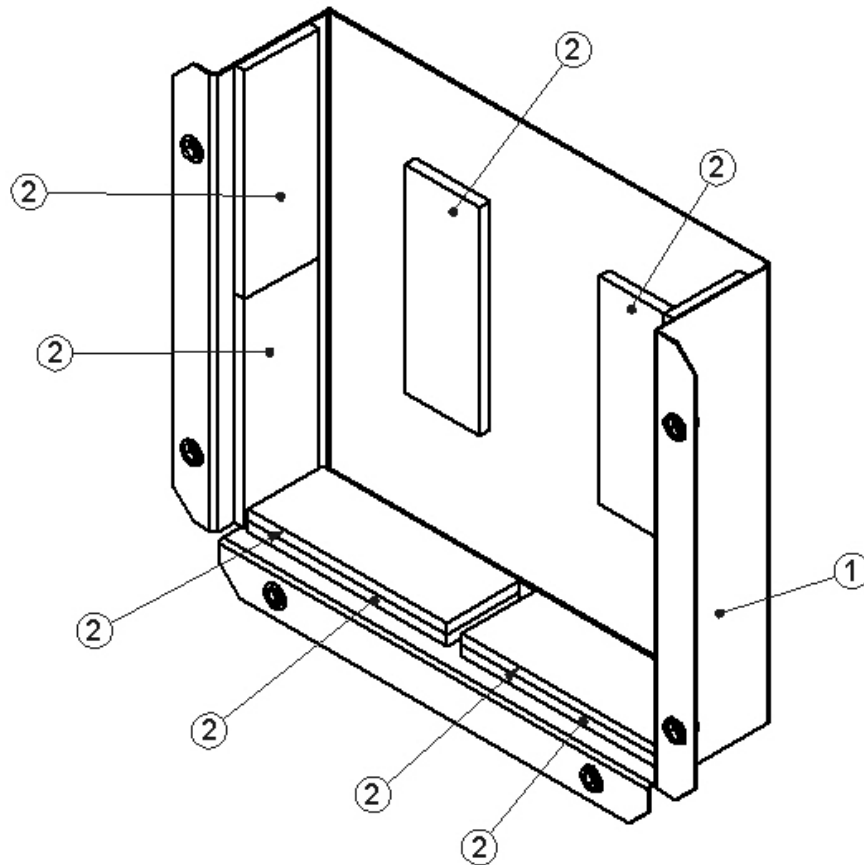

BAGMD610-0 FASTENER BAG

ITEM NO.	PART NUMBER	DESCRIPTION	BAGMD610-0 QTY.
1	BAG0406-A	4" x 6" 3MIL AUTOBAG	1
2	FAS0055	Nut, Hex Range, Nylock 1/4-20	8
3	FAS0066	Washer, Lock, Ext. Tooth, 1/4	16
4	FAS0061	Screw, Truss Hd. Ph, 1/4-20x0.50	8
5	FAS0041	Screw, Truss Hd Phillips Tapping, #14-10x0.75 (A)	16

USE (6) FAS0061 SCREW TRUSS HD 1/4-20 X 1.50
USE (6) FAS0066 WASHER, LOCK, EXT, TOOTH 1/4

THERE MAY BE EXTRA UNUSED FASTENERS
DISCARD ALL REMAINING FASTENERS

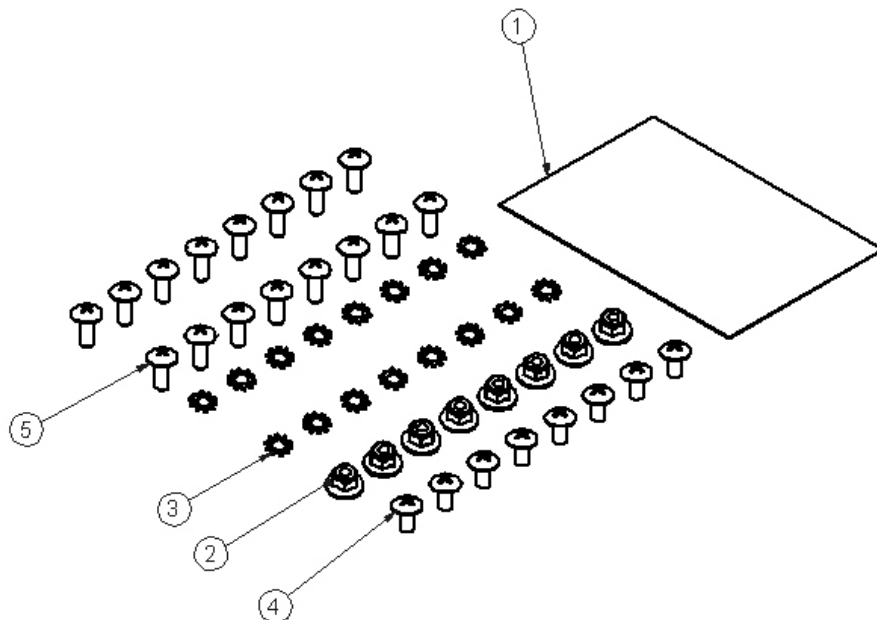

**APPLY 47106 GASKET, FOOT, MR TRANS L/R TO
47891-G LAPTOP HOLDER BRKT ASS'Y.**

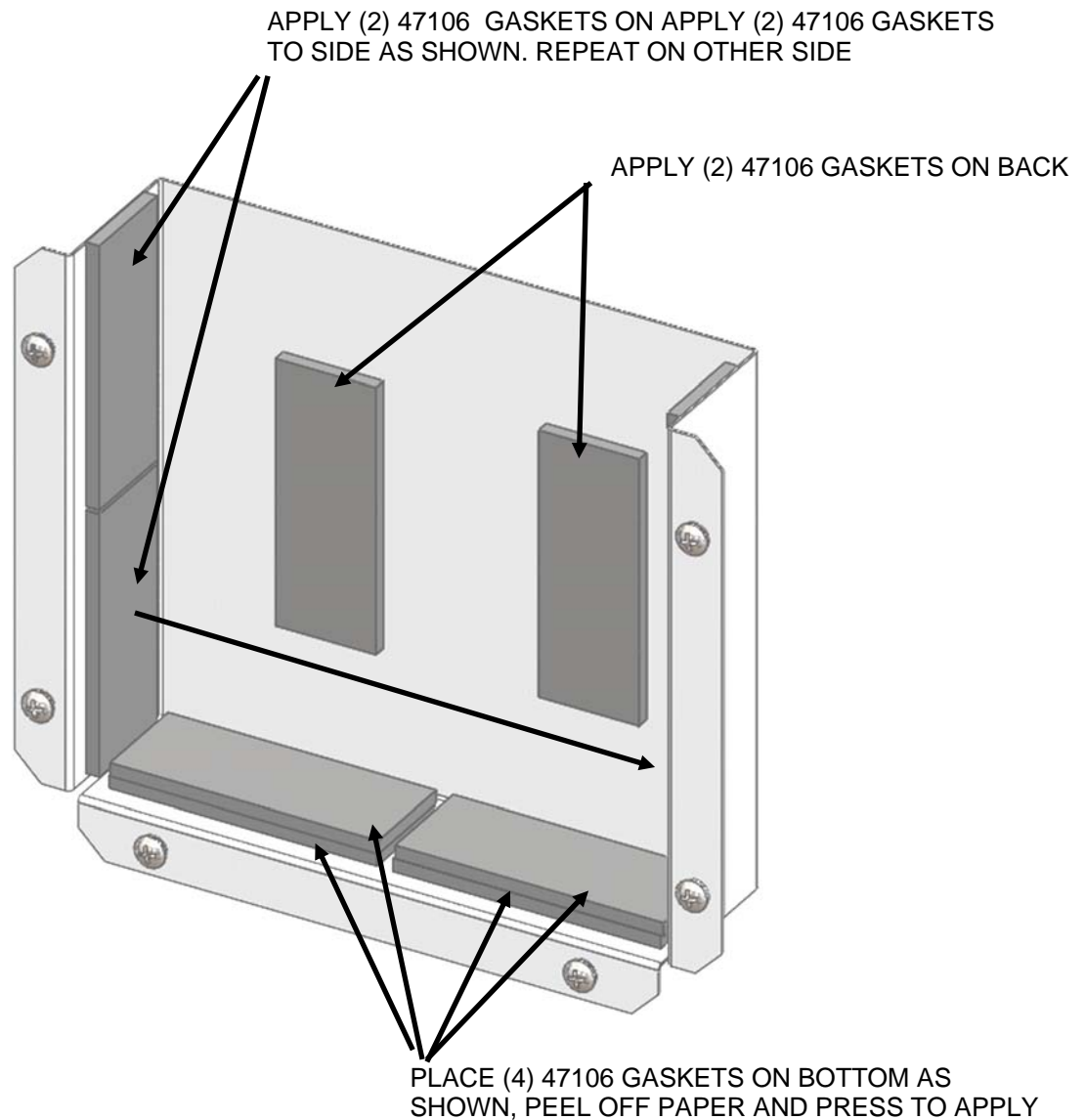

INSTALLING LAPTOP HOLDER IN THE CCD UNIT

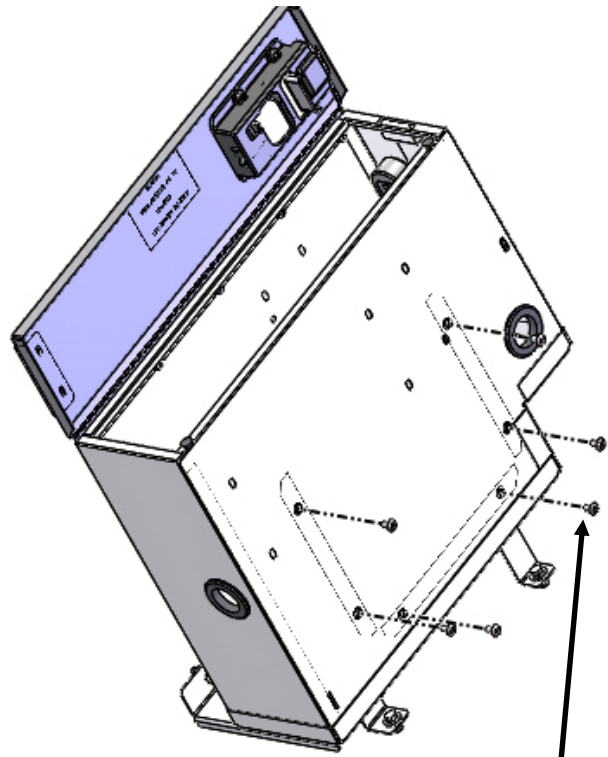
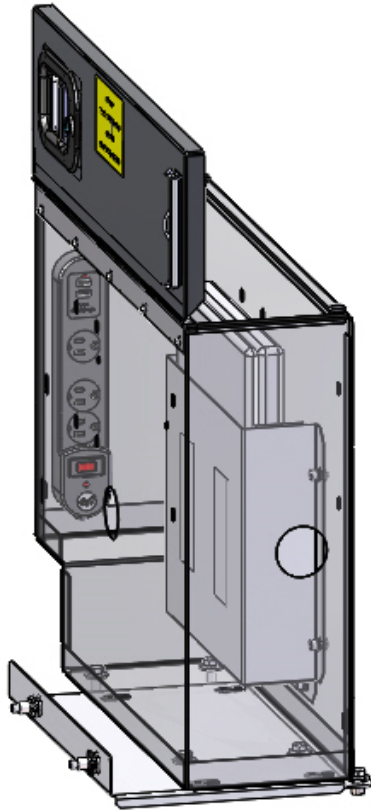

(6) FAS0061 1/4-20 SCREW

(6) FAS0066 1/4 EXT TOOTH LOCK WASHER

PLACE CCDLTH IN CCD UNIT LINE UP RIVNUTS TO (6) SLOTS

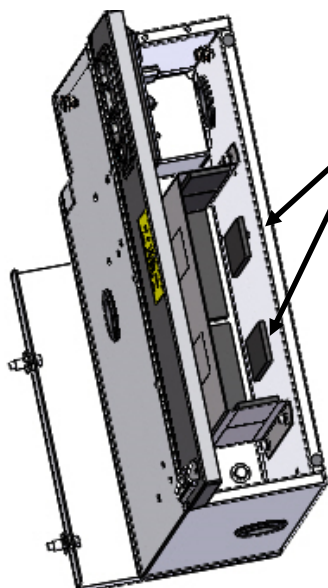

ADD 2 MORE PIECES OF FOAM
ON THE INSIDE OF THE CCD

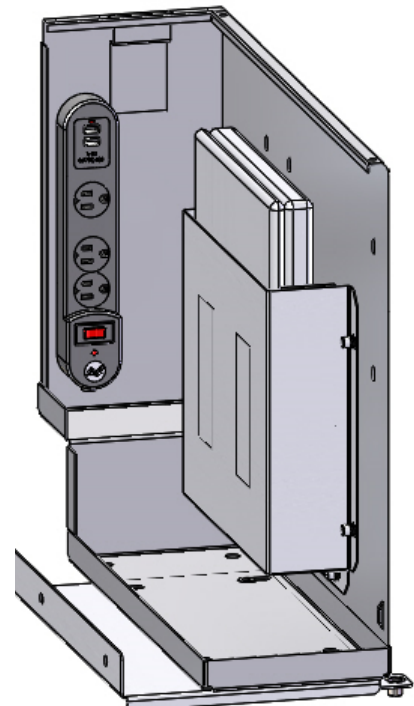

YOUR INSTALLATION IS NOW COMPLETE

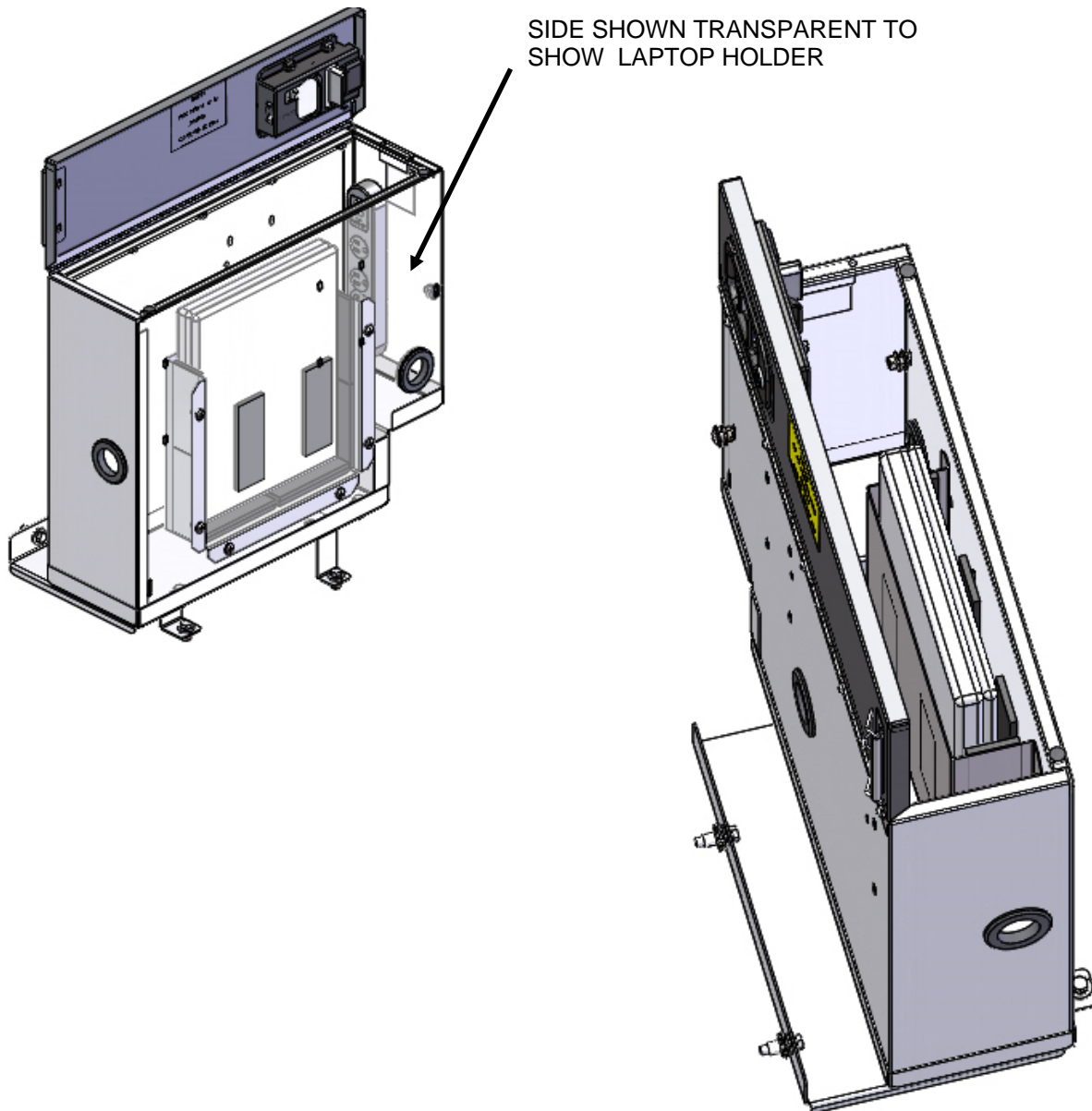

**DOUBLE CHECK ALL FASTENER LOCATIONS TO BE SURE THAT ALL
FASTENERS ARE TIGHTENED TO SPECIFICATIONS.
YOUR INSTALLATION IS NOW COMPLETE!
STOW THIS COPY IN THE VEHICLE FOR FUTURE REFERENCES!**