

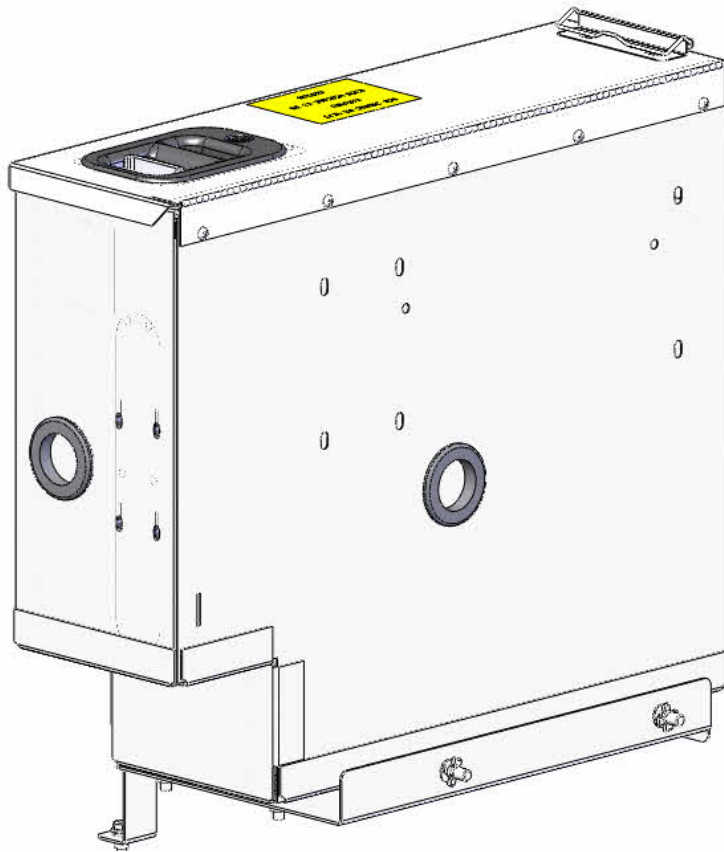

**ADRIAN STEEL**

*Cargo Management Solutions for Commercial Vehicles*

## CCD6, CENTER CONSOLE DESK



PRODUCT WEIGHT

**24 lbs.**

WIDTH x DEPTH x HEIGHT

**6.65 x 22.38 x 18.34**

COLOR

**GRAY**

CATALOG NUMBER

**CCD6**

### PRODUCT FEATURES

**Center console desk designed for a 2015 and newer Ford Transit. It is designed with mounting holes for a power strip with USB Connections, a PA9 for electrical use, an optional Laptop Holder Bracket, and optional Letter and Legal hanging file folder Brackets.**

### PAGE 1 of 1

The information contained in this document is the sole property of ADRIAN STEEL COMPANY. ADRIAN STEEL COMPANY retains the right to modify and/or change the product of its design at any time without prior notification.

### Introduction / Comments:

**This Center Console Desk is designed for storage of chargers, power strip, with optional Laptop computer holder kit, and optional file hanger kit.**

**Note:** It is advised that all fasteners used in this assembly and installation should be checked for tightness at the following intervals: @ 2-weeks and again @ 6-weeks of operation. This preventive maintenance step must be completed to ensure your Product gives you long service life.

#### LONG PARTS STORAGE POSITION

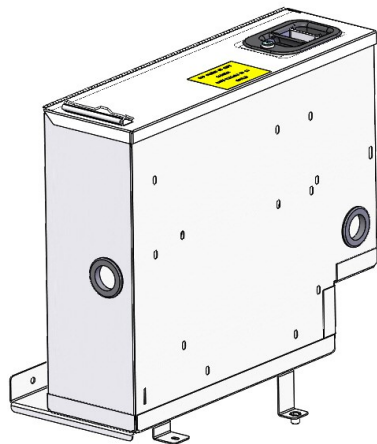

REAR

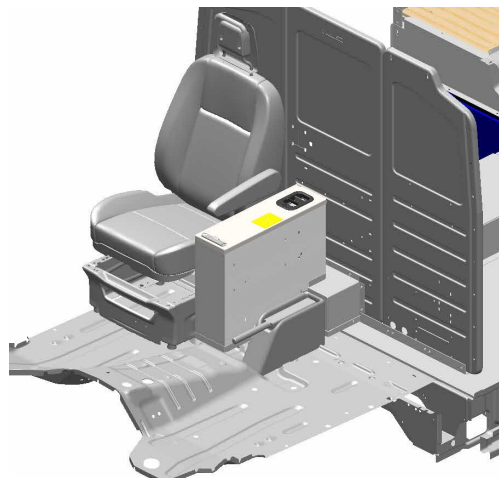

FRONT

#### DDF/CCD ALONE

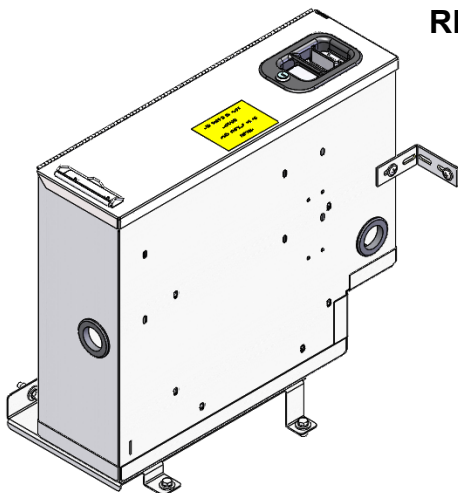

REAR

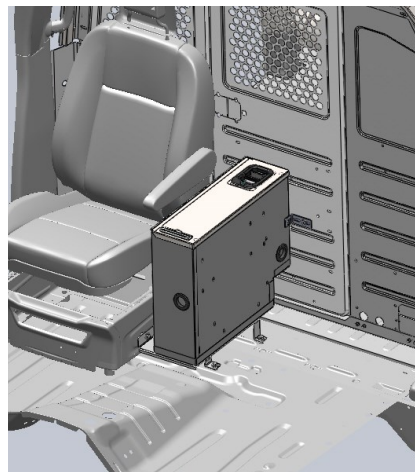

FRONT

### CENTER CONSOLE DESK OR DRIVER DATA FILE

## - PRECAUTIONS -



**CAUTION**



**THE USE OF AIR IMPACT TOOLS CAN  
OVER-TORQUE FASTENERS AND  
CAUSE FASTENER FAILURE!**

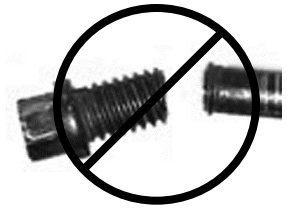

**CAUTION**



**ALL INSTALLATION HOLES SHOULD BE SEALED  
WITH SILICON OR BUTYL SEALANT TO PREVENT  
EXHAUST FUMES FROM ENTERING THE VEHICLE!**



**DANGER**



**INSPECT FOR FUEL TANK, FUEL LINES, BRAKE LINES, HIGH  
VOLTAGE BATTERIES AND ELECTRICAL LINES PRIOR TO  
DRILLING TO AVOID DAMAGING CRITICAL VEHICLE SYSTEMS  
OR INJURY TO INSTALLER DURING INSTALLATION PROCESS!**



**CAUTION**



**TO AVOID DAMAGING THE VEHICLE ALWAYS  
USE DRILL STOPS WHEN DRILLING ANY IN-  
STALLATION HOLES!**



## - IMPORTANT WARRANTY REQUIREMENTS -

1. SUBSTITUTING ADRIAN STEEL SPECIFIED FASTENERS FOR ASSEMBLY AND/OR INSTALLATION WILL VOID YOUR PRODUCT WARRANTY.
2. ALL HOLES DRILLED INTO VEHICLE SHOULD HAVE THE RAW METAL EDGES SEALED WITH A SELF-ETCHING PRIMER TO RESIST CORROSION AND POTENTIAL FASTENER POINT FAILURE.
3. ALL FASTENERS USED IN THE INSTALLATION OF THIS PRODUCT SHOULD BE TIGHTENED TO THE TORQUE(S) SPECIFIED IN THESE INSTRUCTIONS.
4. THESE INSTRUCTIONS SHOULD BE KEPT WITH THE VEHICLE.

### THE BASIC TOOLS NEEDED FOR MOST INSTALLATIONS



DRILL



DRILL BIT WITH  
STOP

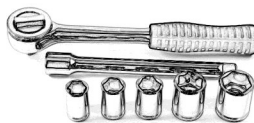

RATCHET, SOCKETS  
AND/OR WRENCHES



SCREWDRIVERS



MEASURING TAPE

ADDITIONAL TOOLS MAY BE NEEDED FOR THIS INSTALLATION AND THEY WILL BE IDENTIFIED IN THE STEPS THAT FOLLOW.

If your vehicle contains carpet or a rubber floor mat you will need to prepare the mounting location. Position the product to be installed into the vehicle and once you are satisfied with the mounting locations, mark the mounting locations. Using a 1-3/16" diameter carpet cutter (P/N: 31183-0). Select the appropriate floor spacers as shown in the illustration. Set those aside for use later into the installation process. Using the correct drill bit size for the selected plusnut, drill the mounting holes in the vehicle sheet metal to prepare for installing the plusnuts. If you are thru-bolting at any of the locations simply drill a hole that is 1/16" larger than the bolt size(s) for those locations. Once you have drilled the holes into the vehicle, the raw metal edges should be sealed using a self-etching primer to resist corrosion and potential fastener point failure.

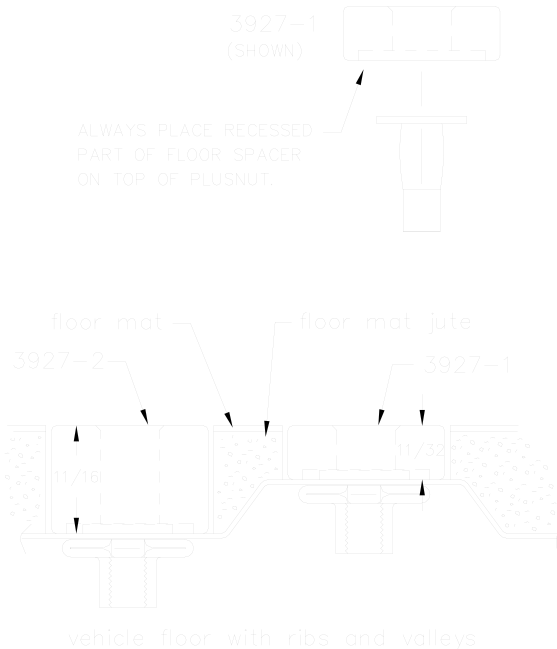

A PLUSNUT (RIVNUT) SETTING TOOL IS REQUIRED FOR PLUSNUT (RIVNUT) INSTALLATION AND IS NOT SUPPLIED WITH THIS KIT. OR USE AN AIR POWERED PLUSNUT SETTING GUN.

1/4-20UNC Plusnut (FAS0052) Use 3/8" dia. drill w/stop

FAS0080 SCREW, HXHD, 1/4-20UNCx2.00", G8  
FAS0067 WASHER, FLAT, 1/4"ID  
22200-0 PLUSNUT TOOL

5/16-18UNC Plusnut (FAS0091) Use 1/2" dia. drill w/stop

FAS0095 SCREW, HXHD, 5/16-18UNCx2.00", G8  
FAS0086 WASHER, FLAT, 5/16"ID  
22200-0 PLUSNUT TOOL

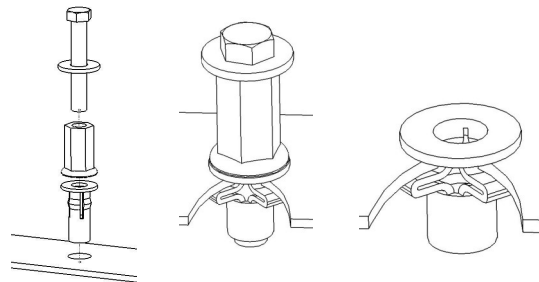

Place barrel of the plusnut body in sheet metal thru hole until flange is flush with sheet metal.

Using a 9/16" combination wrench of plusnut tool body and a second hand wrench, ratchet, or air tool, rotate the hex bolt head CW to draw plus nut flanges up (set the plusnut).



## CCD6 CENTER CONSOLE DESK FOR 2015 TRANSIT

ITEM NO.	PART NUMBER	DESCRIPTION	DDFEFDT/QTY.
1	47724-G	BODY WELDMENT, DDFEFDT	1
2	48105-G	LID WELDMENT, PAINTED DDFEFDT	1
3	47729-G	MOUNTING PLATE,DDFEFDT	1
4	HDW47731	HARDWARE KIT,DDFEFDT	1

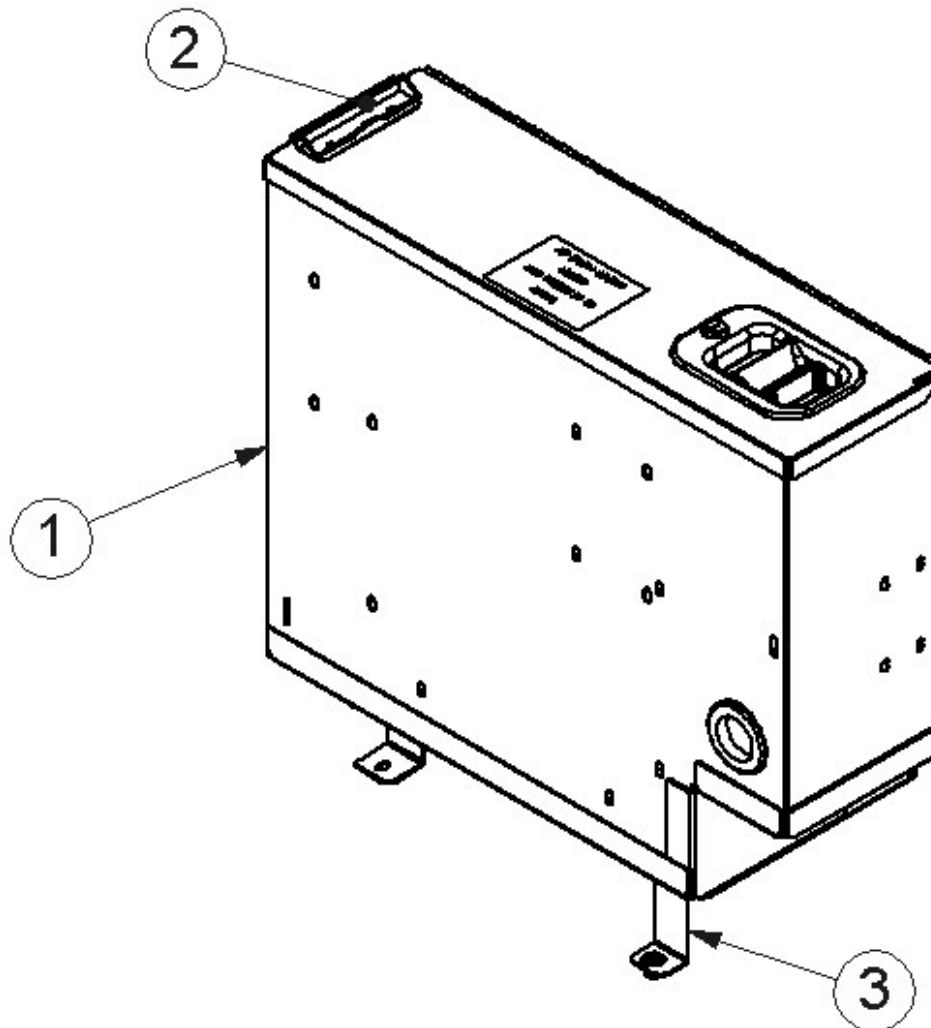

## HDW47731

ITEM NO.	PART NUMBER	DESCRIPTION	HDW47731/QTY.
1	BAG47728	FASTENER BAG FOR DDFEFDT	1
2	HDW37764	HARDWARE BAG FOR DDF7 & DDF12	1
3	CRT25386-1	HARDWARE BOX FOR CCD	1
4	44388	GROMMET, RUBBER, 1.5" ID	3
5	47722	INSTAL INSTR, CCD6	1
6	35295-B	MOLDED SLAM LATCH W/ LOCK	1
7	03961-1	MB112 MTG BRKT WO/FAS	1
8	52164	4 SLOT MTG BRACKET	1

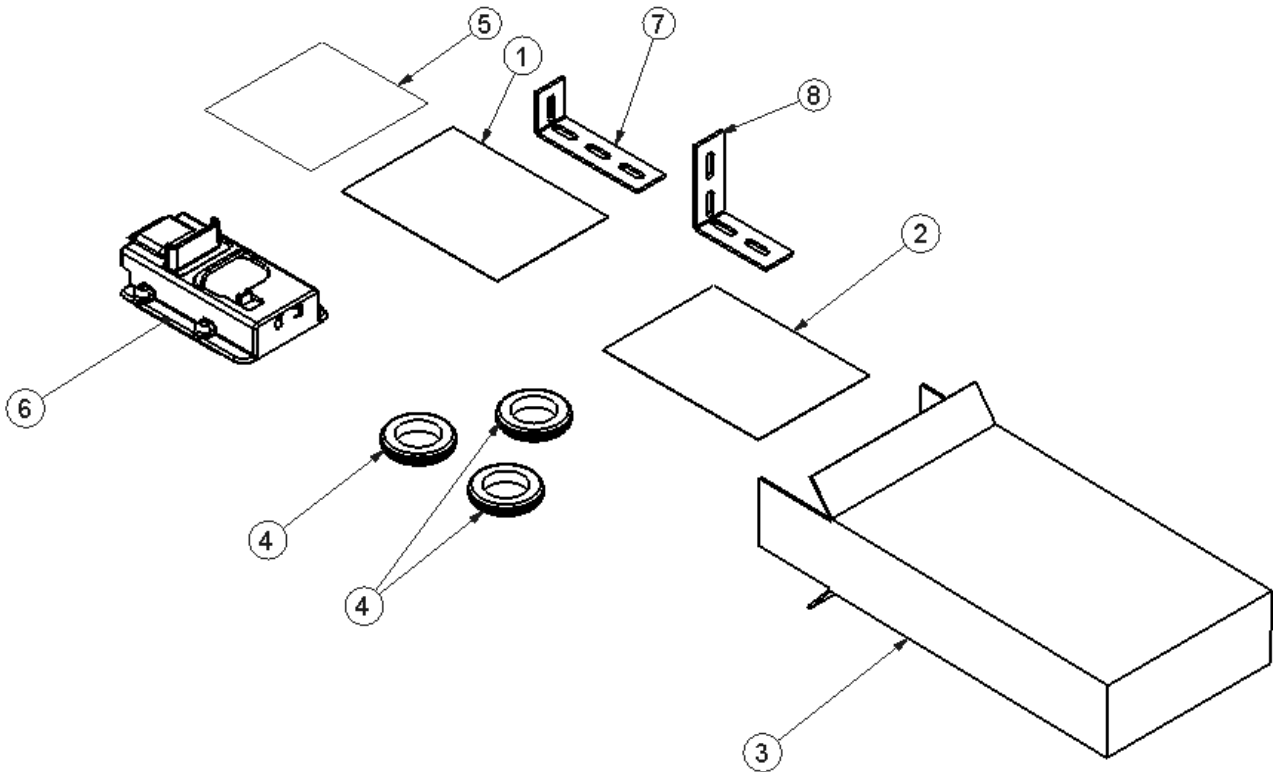

## HDW37764 HARDWARE BAG

ITEM NO.	PART NUMBER	DESCRIPTION	QTY.
1	FAS0137	Screw, Round Phillips Head, #6-32x0.375, Zinc plate	2
2	FAS0138	Nut, Hex Flange, #6-32, Zinc Plate	2
3	BAG0406-A	4" X 6" 3MIL AUTOBAG	1
4	25384	SPRING CLIP, DDF IN HARDWARE KIT	1
5	34341-0	9309K16 MCMASTER CARR BUMPER	2
6	FAS0030	Screw, Round Phillips Head, #10-24x0.375	9

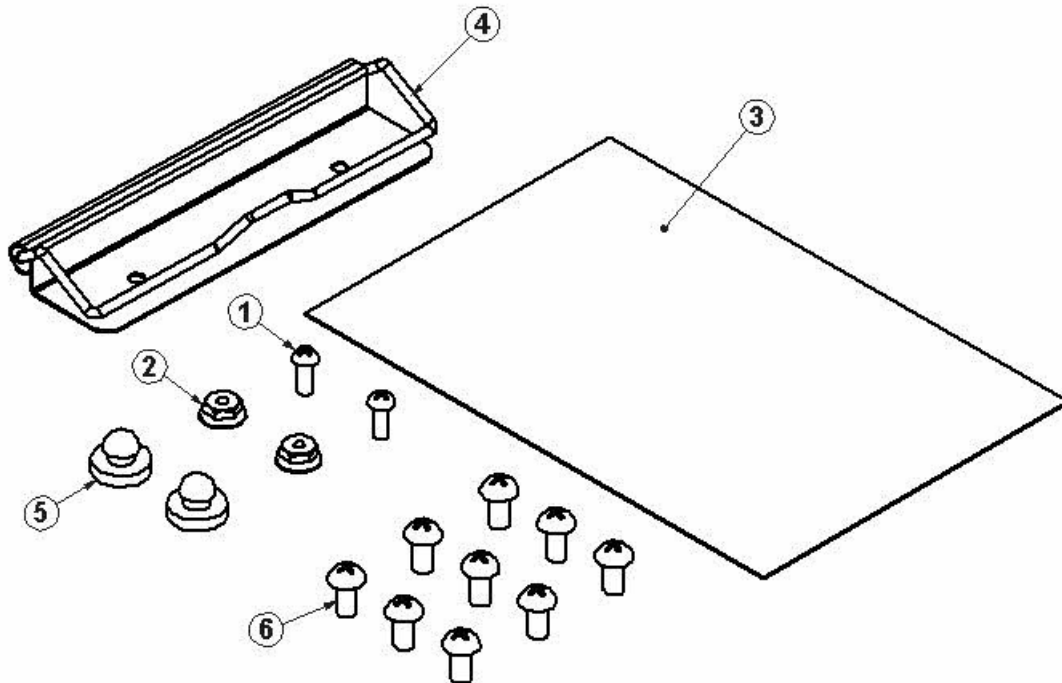

## BAG47728 FASTENER BAG FOR DDFEFDT

ITEM NO.	PART NUMBER	DESCRIPTION	BAG 47728/ QTY.
1	BAG0507-A	5" x 7" 3MIL AUTO BAG	1
2	FAS0112	Washer, Flat, 5/16, NI ZN	8
3	FAS0588	Washer, Lock, Split, 5/16, SS	8
4	FAS0020	Nut, Hex Flange, #10-24	6
5	FAS0082	Screw, Hex Hd, 5/16-18x1.00 ZN, YELLOW G8	4
6	FAS0081	Screw, Hex Hd, 5/16-18x0.75 Zn Plate	1
7	FAS0091	Plusnut, 5/16	2
8	FAS0093	Screw, Hex Hd, 5/16-18x1.25	2
9	FAS0055	Nut, Hex Flange, Nylock 1/4-20	5
10	FAS0061	Screw, Truss Hd. Ph, 1/4-20x0.50	2
11	FAS0062	Screw, Truss Hd. Ph, 1/4-20x0.75	2
12	FAS0067	Washer, Flat, 1/4	8
13	FAS0018	SCREW, HH SFLNG 1/4-20X.62 ZP	1

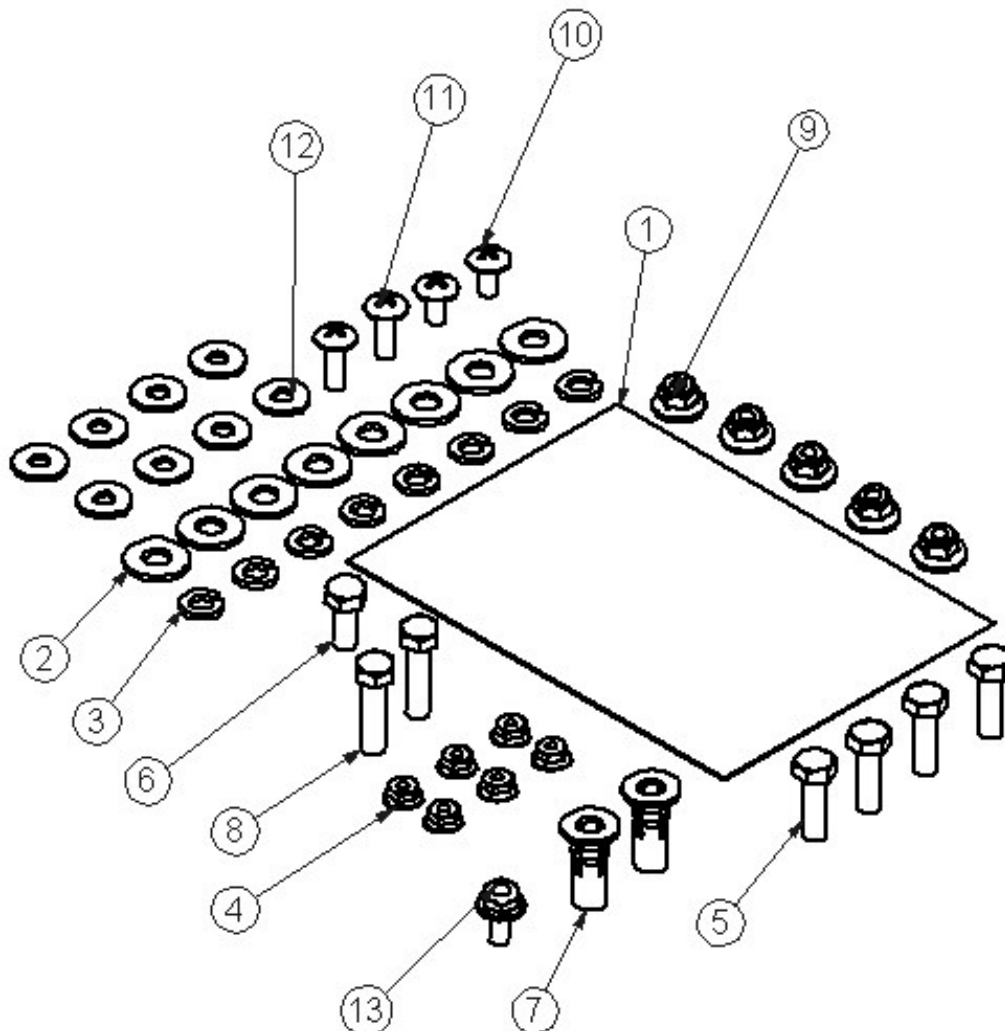

## LID ASSEMBLY INSTALL 48105-G OR 48105-B

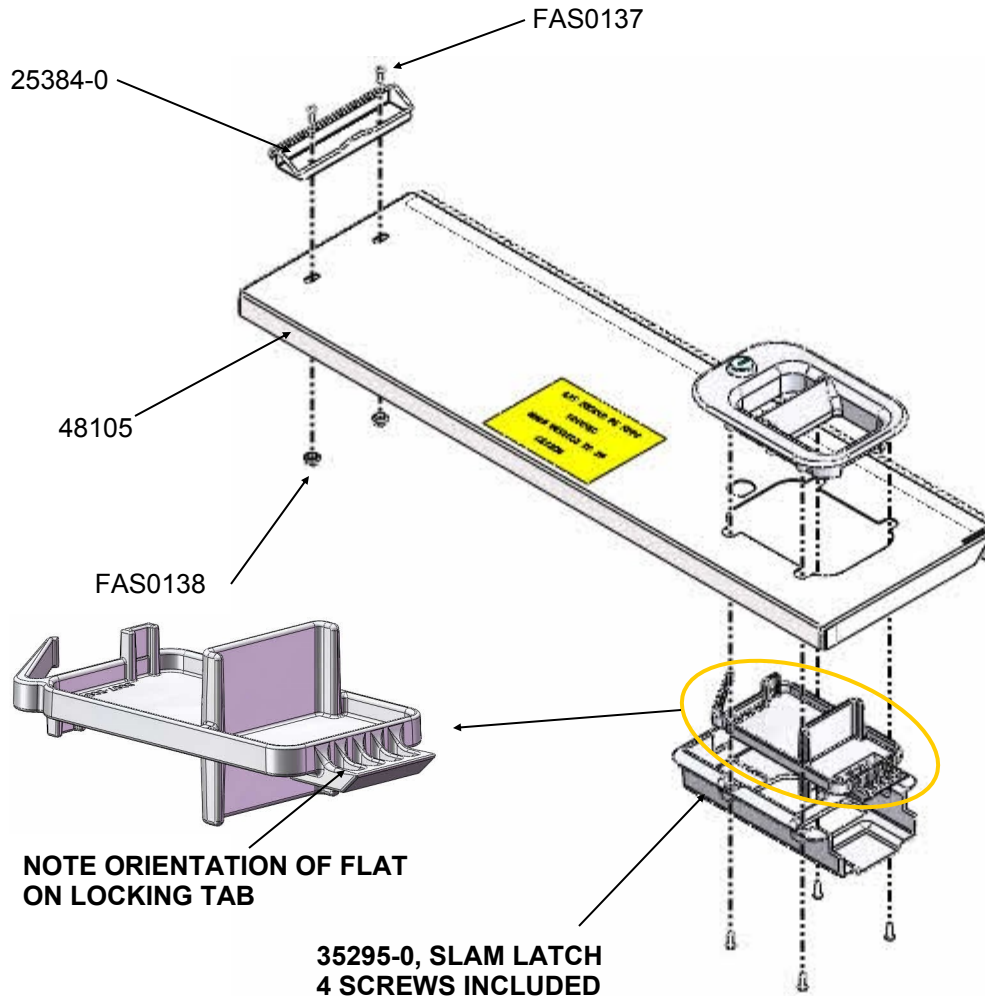

**DO THIS STEP BEFORE PUT THE SLAM LATCH UNIT ON THE LID ASSEMBLY; SHOWN ABOVE**

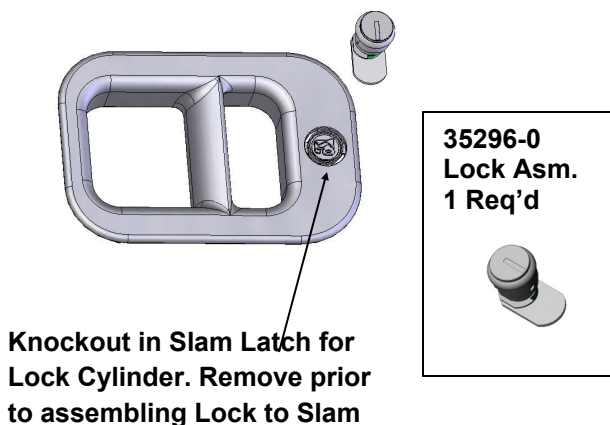

There are 2 versions of the Lock, One snaps into Slam Latch, the alternate is held to Slam Latch by a Hex Nut (included with Lock) on backside.

Lock Cam orientation shown is in the locked position. Unlocked position is 90 degrees Counterclockwise from position shown. Flats on Cylinder run perpendicular to Cam in locked position (shown). Install in position shown.

## INSTALL BUMPERS AND GROMMETS, AND LID ASSEMBLY

**34341-0 RUBBER BUMPERS**  
**TWO PLACES**

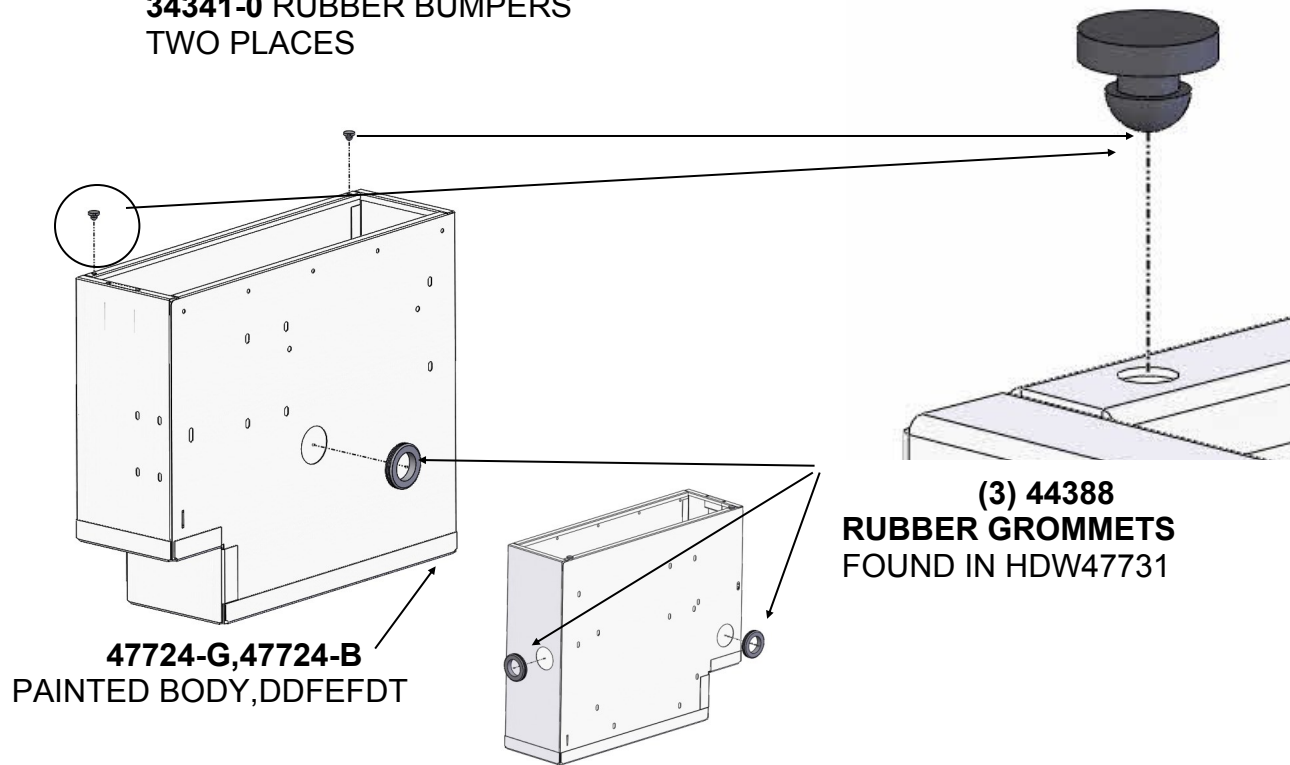

## INSTALL LID ASSEMBLY 47724-G TO 48105-G

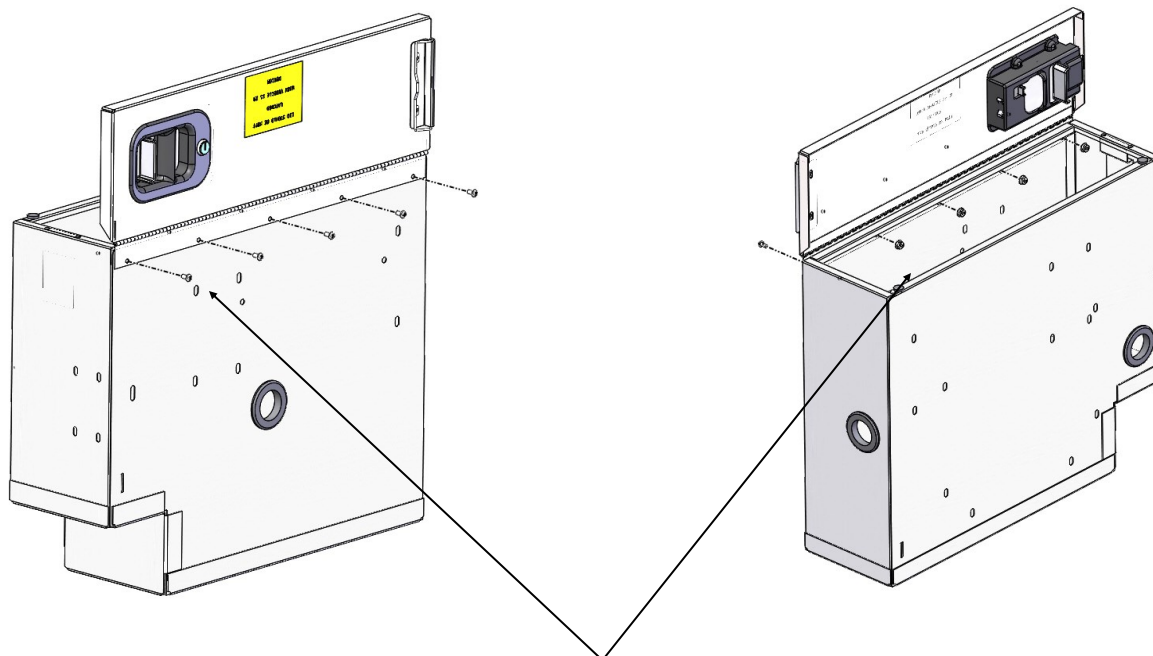

INSTALL (5) FAS0020 #10-24 FLANGE NUT,  
AND (5) FAS0030 #10-24X3/8" PH SCREWS.  
THRU LID ASSEMBLY AND BODY



## PREPARE INTERIOR OF TRANSIT FOR CCD6 INSTALLATION

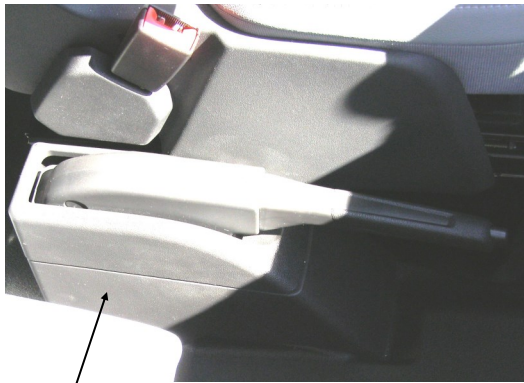

Remove Parking Brake Trim

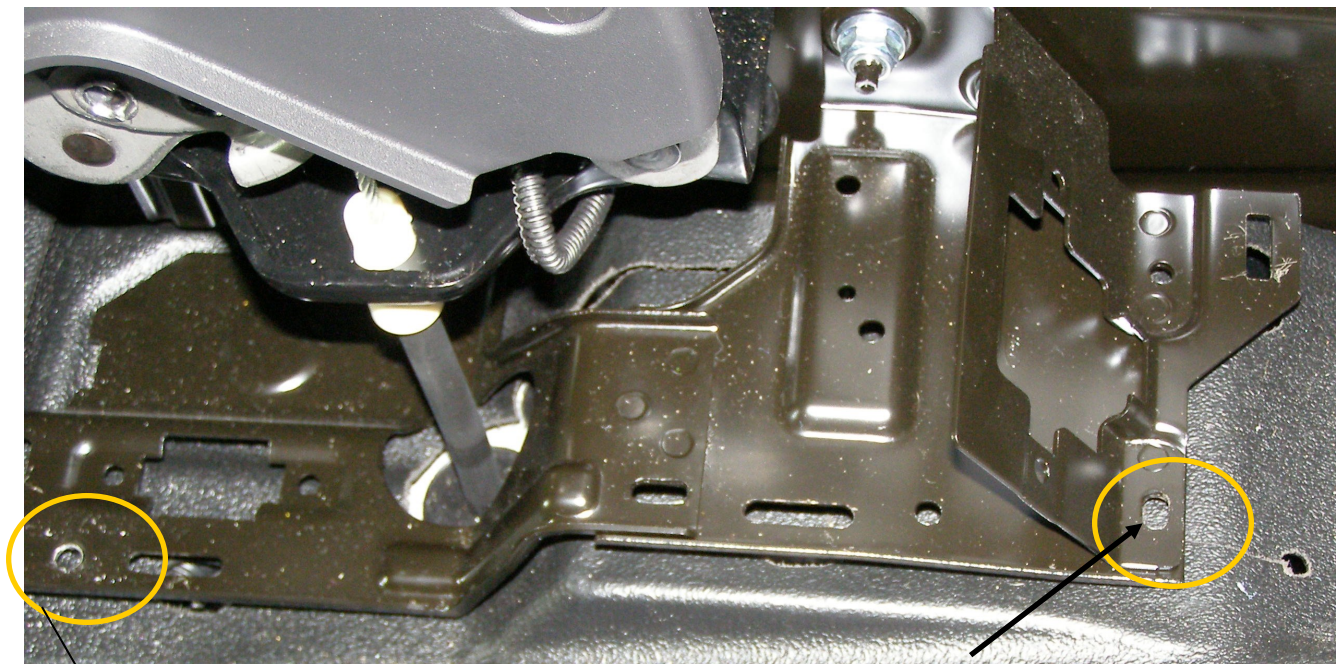
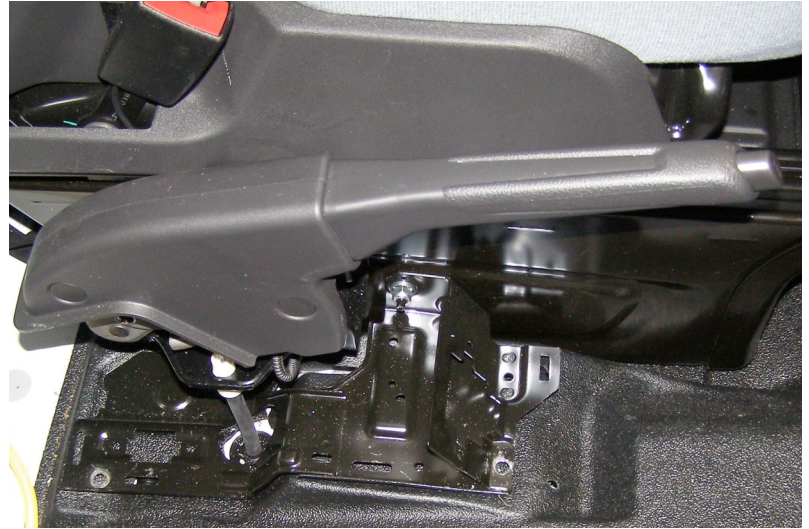

DRILL HOLE FOR 5/16 SCREW  
WATCH FOR WIRING HARNESS

NO DRILLING IN FRONT MOUNTAIN LOCATION.  
HARNESS LOCATED BENEATH

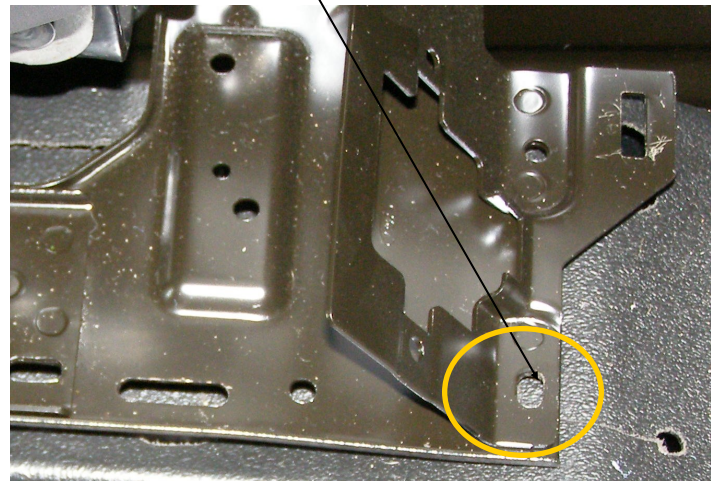
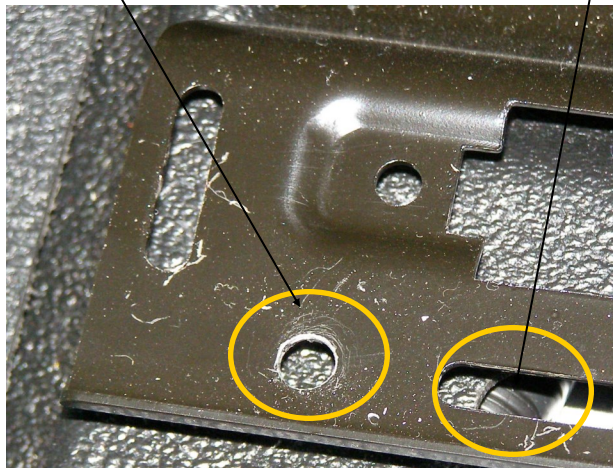



**LOCATE MOUNTING PLATE , DRILL AND ADD 5/16 PLUSNUTS ON  
PASSENGER SEAT, ATTACH 47729-G OR 47729-B MOUNTING PLATE  
SEE PAGE 3 FOR PLUSNUT DRILLING INSTRUCTIONS**

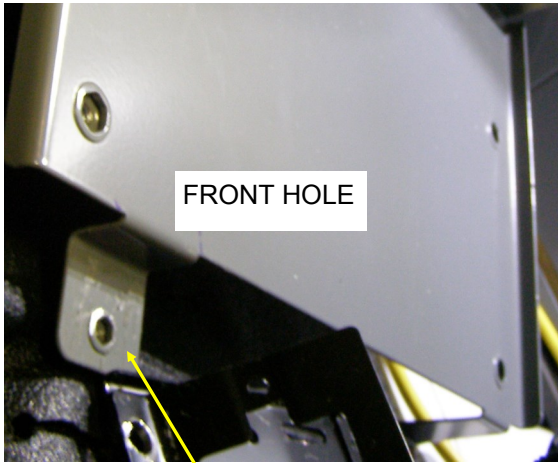

PUT IN ON ANGLE SLIP UNDER BRAKE BRACKET  
FASTENER WITH FAS0081 5-16 X 18 X.75 HH  
SCREW, FAS0588 5/16 LOCK WASHER.  
DO NOT FULLY FASTEN

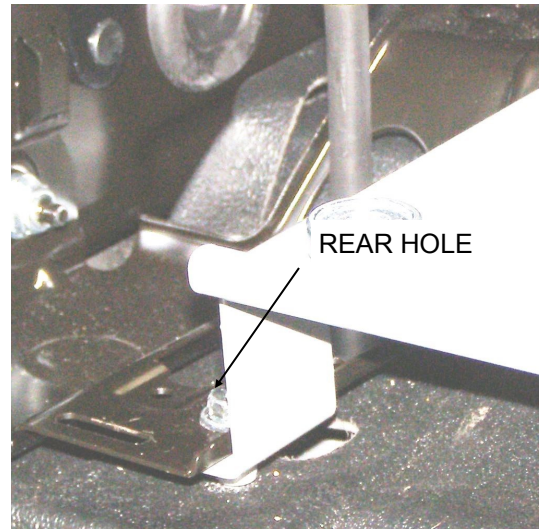

LOCATE REAR HOLE MARK REMOVE  
MOUNTING PLATE DRILL AND REINSTALL  
WITH SAME FASTENERS AS FRONT  
DO NOT FULLY FASTEN



PULL PLATE UP AND LEVEL WITH REAR  
FLOOR, MARK WHERE PLUS NUT HOLES GO

PULL PLATE UP AND LEVEL WITH REAR  
FLOOR, MARK WHERE PLUS NUT HOLES GO

**LEVEL PLATE BEFORE MARKING**



**INSTALL FAS0091 5/16 PLUSNUTS ON SEAT SIDE.  
REPLACE 47729—G OR 47729-B MOUNTING PLATE TO BRAKE BRACKET  
AND PASSENGER SEAT SIDE**

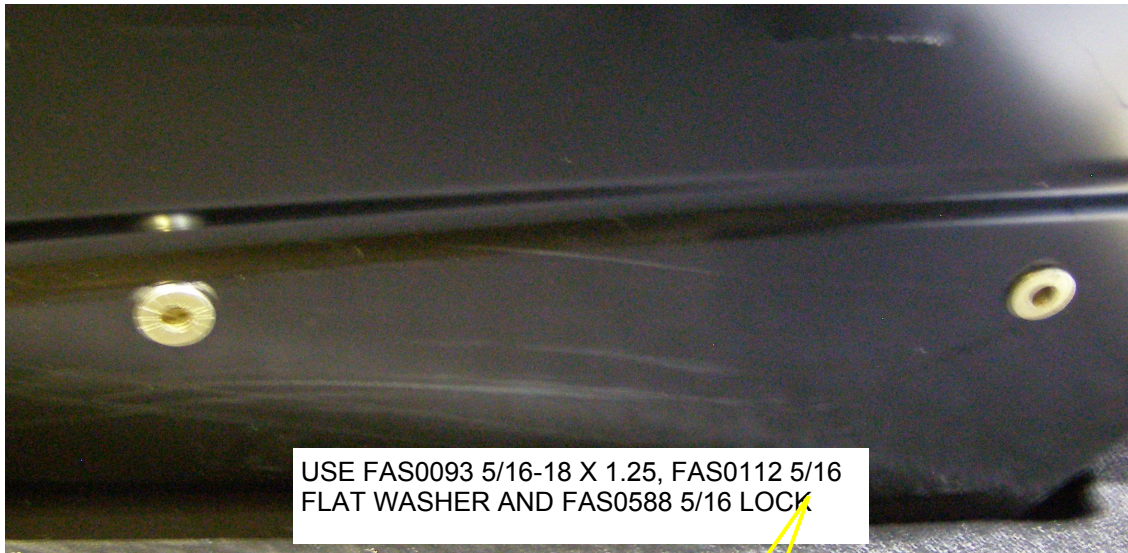



## FINAL TIGHTEN OF MOUNTING PLATE 47729-G OR 47729-B

TIGHTEN FAS0081 SCREWS IN  
TABS AND BRAKE PLATE

FAS0018 AND FAS0055 USED TO AT-  
TACH MOUNTING PLATE.

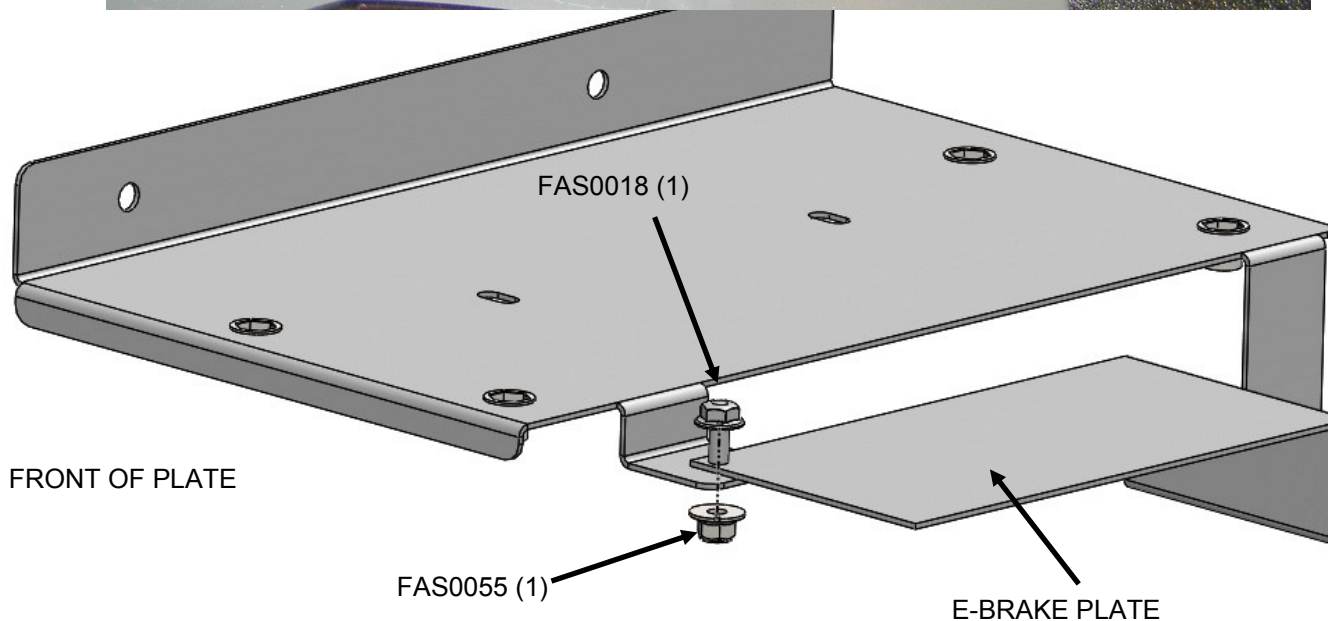



## MARK BRAKE TRIM FOR FIT TO MOUNTING PLATE



PUT TRIM BACK OVER BRAKE AND MARK  
WHERE TO CUT FOR FIT OVER TABS

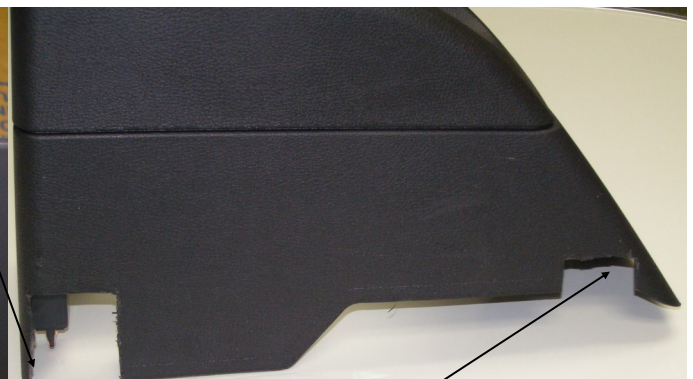
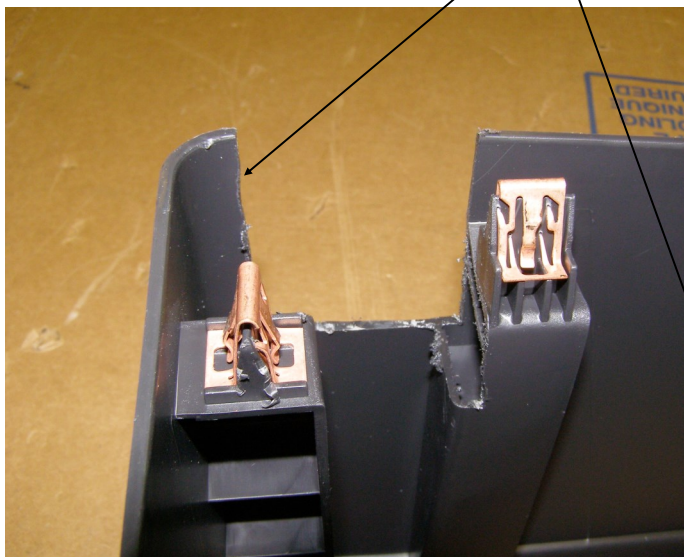

FRONT

MARK REMOVE TRIM AWAY WHERE NEEDED,  
WE USED TIN SNIPS OR A SMALL AIR SAW

## INSTALLING WITH LONG PART STORAGE

MOUNT AS SHOWN USING 4 OF EACH  
FAS0082 5/16-18 x1.00 HH SCREWS  
FAS0112 5/16 FLAT WASHERS  
FAS0558 5/16 LOCK WASHER

**ADJUST UNIT TOWARDS DRIVER SIDE  
FULLY TIGHTEN**

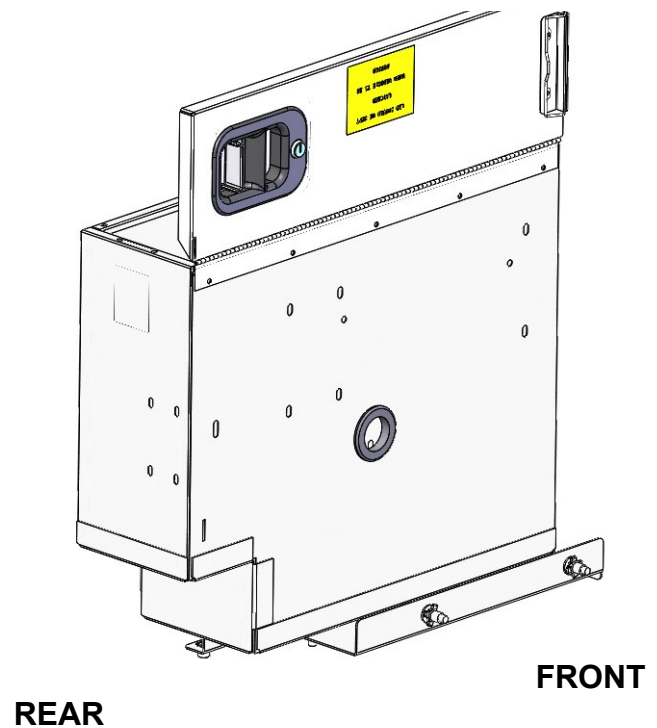
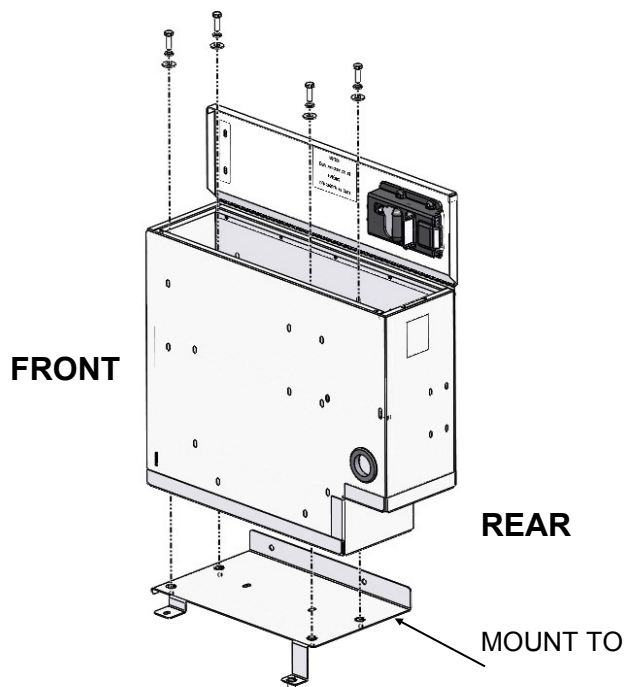

**ATTACH BRAKE TRIM  
TO VEHICLE**

IF CCD6 IS NOT USED WITH LONG PARTS STORAGE, INSTALL PER INSTRUCTIONS ON NEXT TWO PAGES. LOOSLY FASTEN UNTIL ALL STEPS ARE COMPLETE.

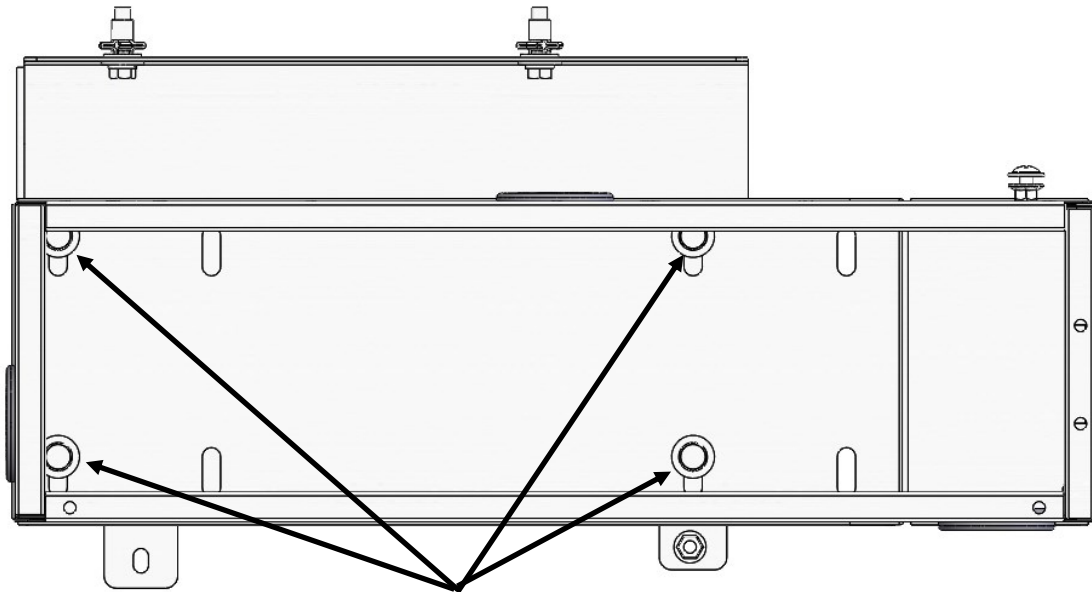

MOUNT USING THESE SLOTS— DDF  
SHOULD BE APPROX. .75" AWAY  
FROM PARTITION.

ATTACH 06665-1 BRACKETS TO CCD BODY. USE FAS0061, FAS0067,  
AND FAS0055

PASS SIDE

DRIVER SIDE

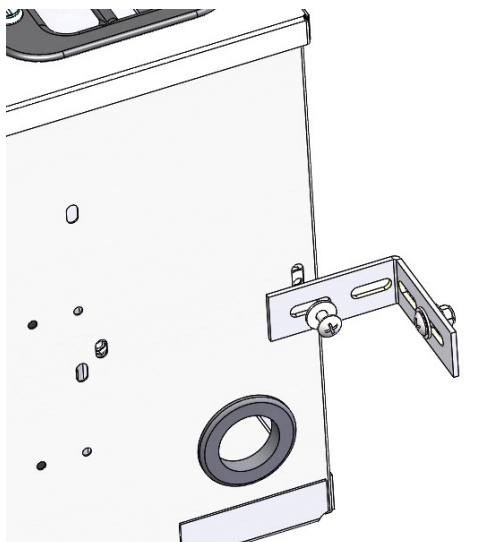

FAS0055(1)  
FAS0061(1)  
FAS0067 (1)

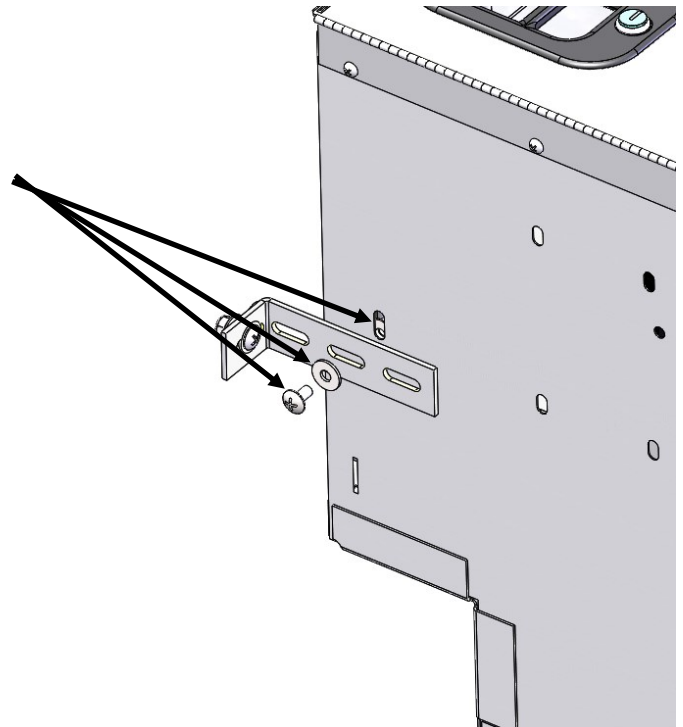



ADDITIONAL BRACKET ATTACHMENT PICTURES, MOUNT TO EXISTING  
RIVNUTS IN CENTER PANEL OF PARTITION.

DRIVER SIDE

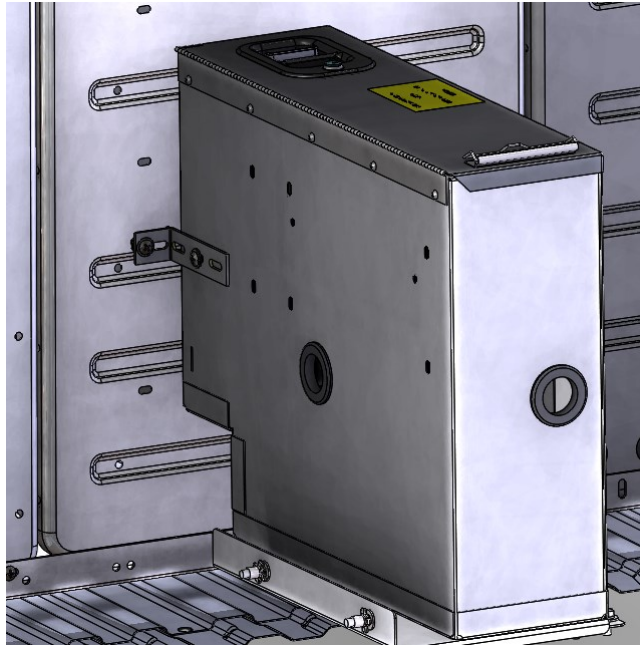

PASSENGER SIDE

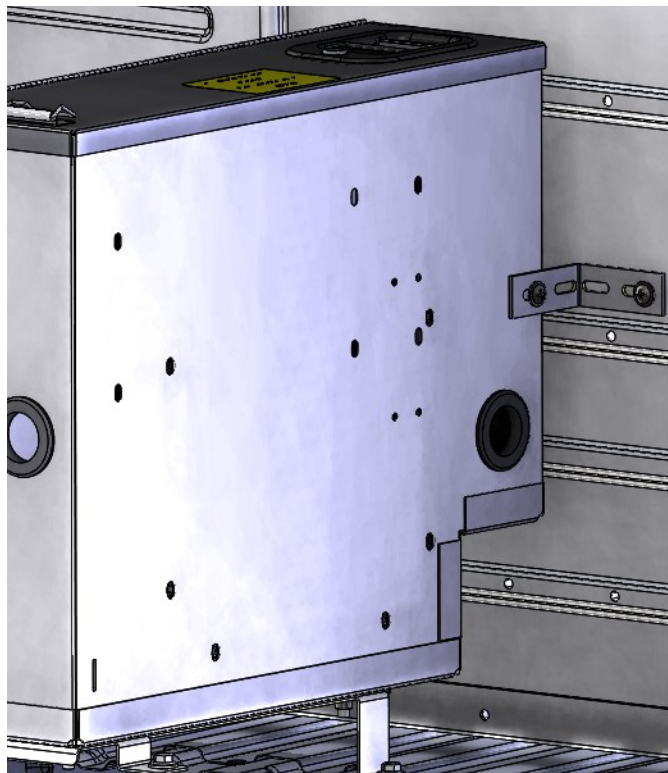



ATTACH MOUNTING BRACKETS TO PARTITION.

NOTE: DUE TO BUILD VARIATION, ADDITIONAL WASHERS MAY BE USED TO SPACE BRACKET FROM PARTITION OR TO DDF BODY  
EXAMPLE SHOWN SPACED FROM PARTITION.

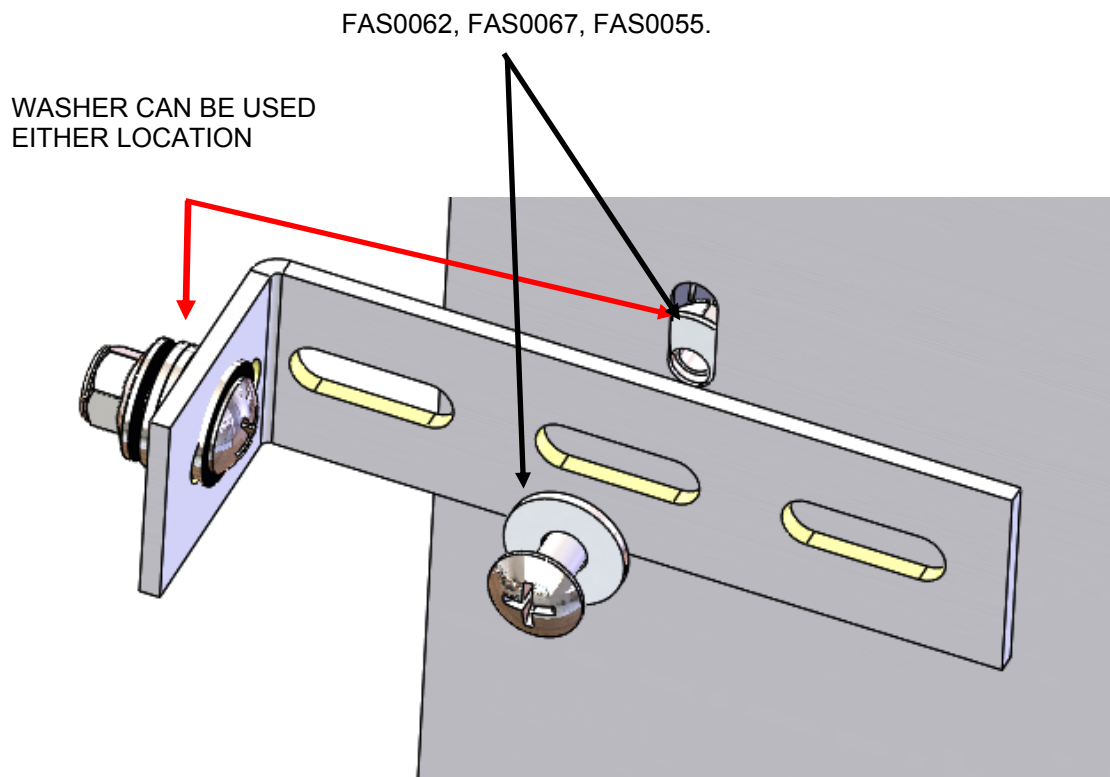

## YOUR INSTALLATION IS NOW COMPLETE

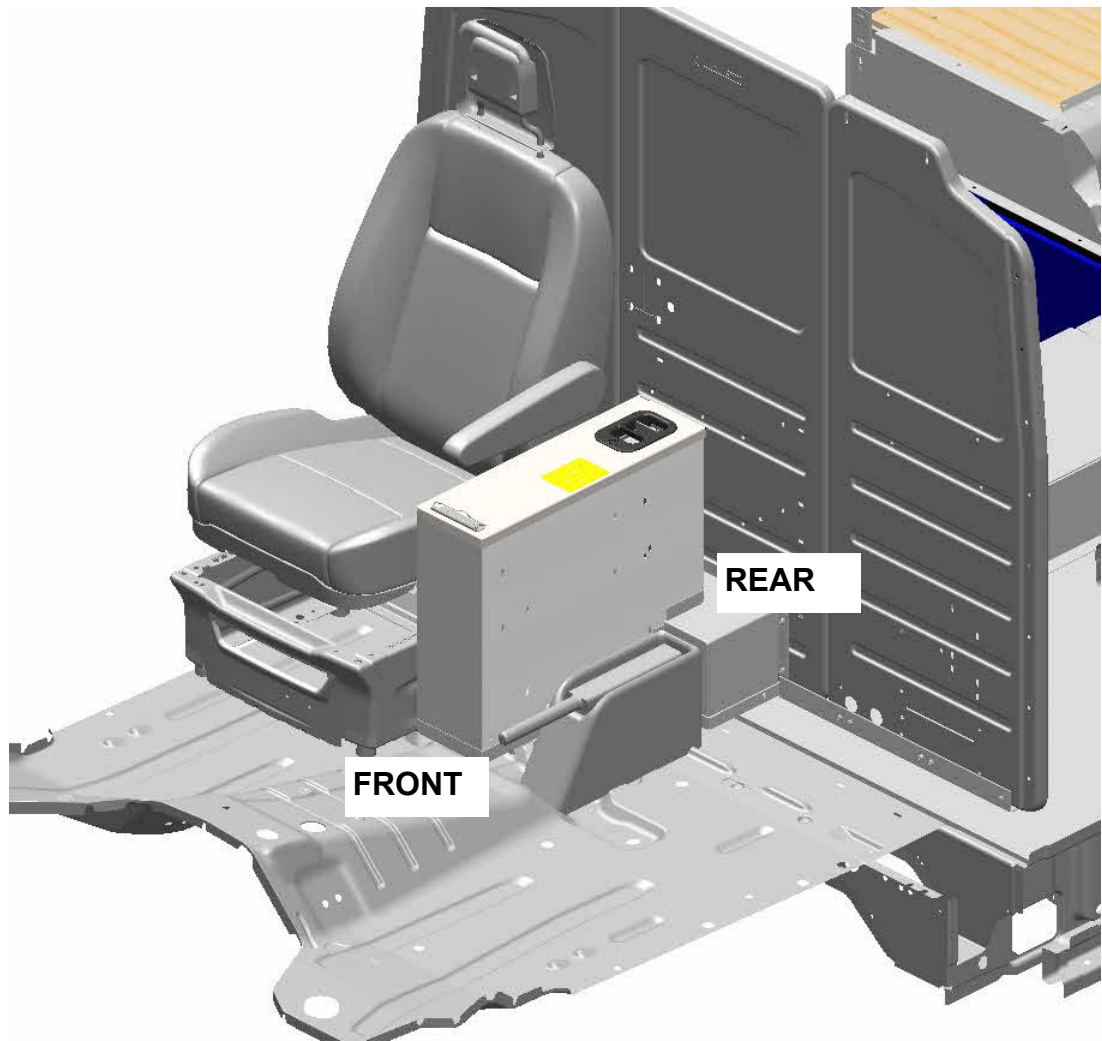

**DOUBLE CHECK ALL FASTENER LOCATIONS TO BE SURE THAT ALL  
FASTENERS ARE TIGHTENED TO SPECIFICATIONS.  
YOUR INSTALLATION IS NOW COMPLETE!  
STOW THIS COPY IN THE VEHICLE FOR FUTURE REFERENCES!**