

6 Bin Cabinet

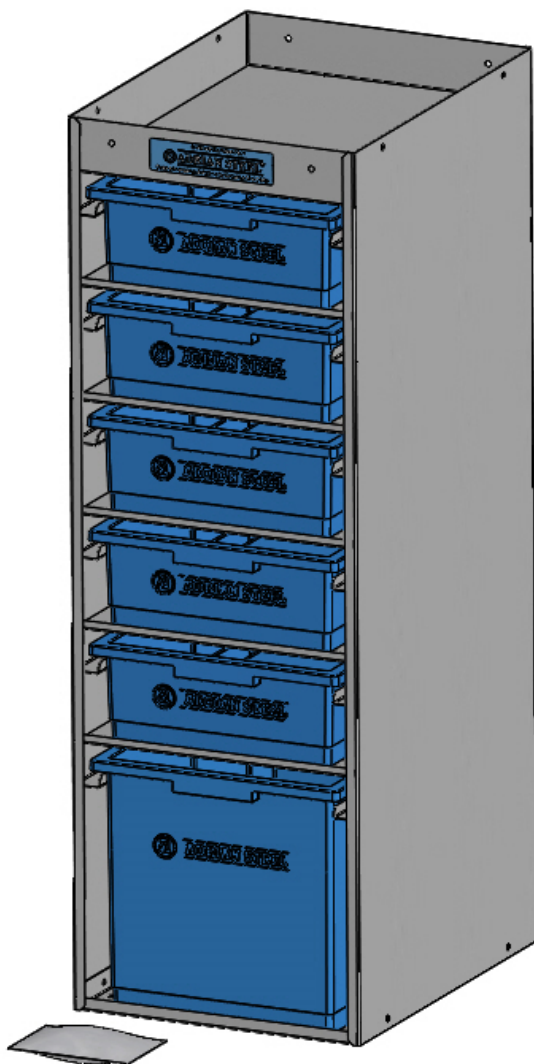

PRODUCT WEIGHT
80 LBS

WIDTH x DEPTH x HEIGHT
14.2" x 18.6" x 43.5"

CAPACITY
See Below

COLOR
GRAY

CATALOG NUMBER
BC6

PRODUCT FEATURES

Cabinet features 5 Shallow Bins and one Deep Bin in a vertical stack with a flanged top shelf.

Shallow Bin, SBIN120418 can hold up to 25 Lbs each

Deep Bin, SBIN121218 can carry up to 40 Lbs

SEE PAGE 2 FOR APPLICATION NOTES AND ACCESSORIES, OTHER PRODUCTS THAT WORK WITH THIS UNIT.



CATALOG NUMBER BC6

PRODUCT APPLICATION

This product is designed to be installed with or without ad rail mounting in vans.

ACCESSORIES THAT WILL WORK WITH THIS PRODUCT

<i>CATALOG NUMBER</i>	<i>DESCRIPTION</i>
------------------------------	---------------------------

SBNLD1218	Lid for SBIN121218 (also for SBIN120418)
------------------	---

SPECIAL APPLICATION NOTES

Introduction / Comments:

The BC6 cabinet holds 6 Blue Adrian Steel bins, 1 deep and 5 shallow.. Deep bin, which typically holds the most and heaviest cargo, is located in the bottom slip.

The BC5 cabinet holds 5 Blue Adrian Steel bins, 1 deep and 4 shallow.

Note:

It is advised that all fasteners used in this assembly and installation should be checked for tightness at the following intervals: @ 2-weeks and again @ 6-weeks of operation. This preventive maintenance step must be completed to ensure your Product gives you long service life.

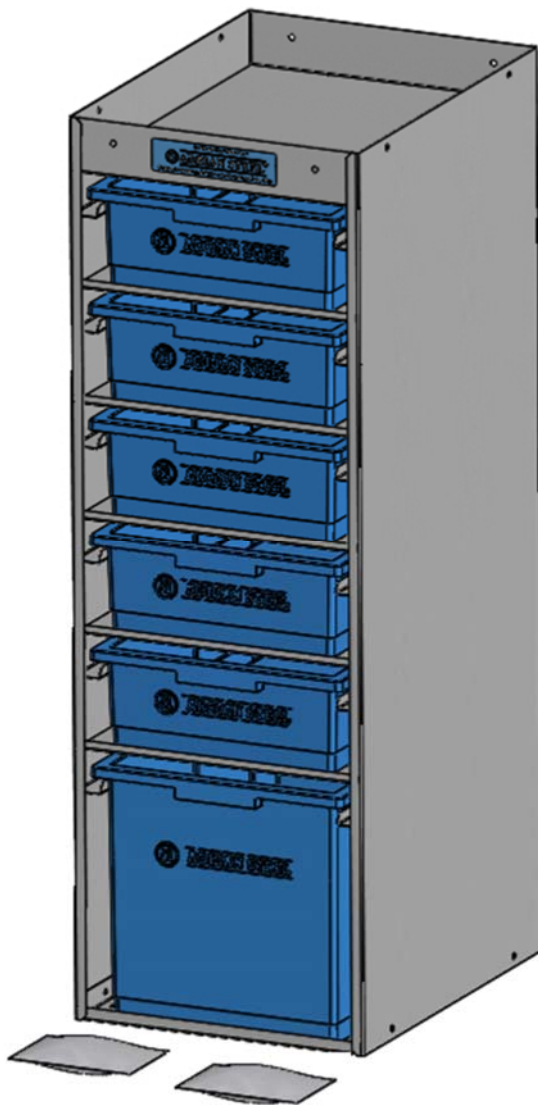

**BC6 - 6 DRAWER
BIN CABINET**

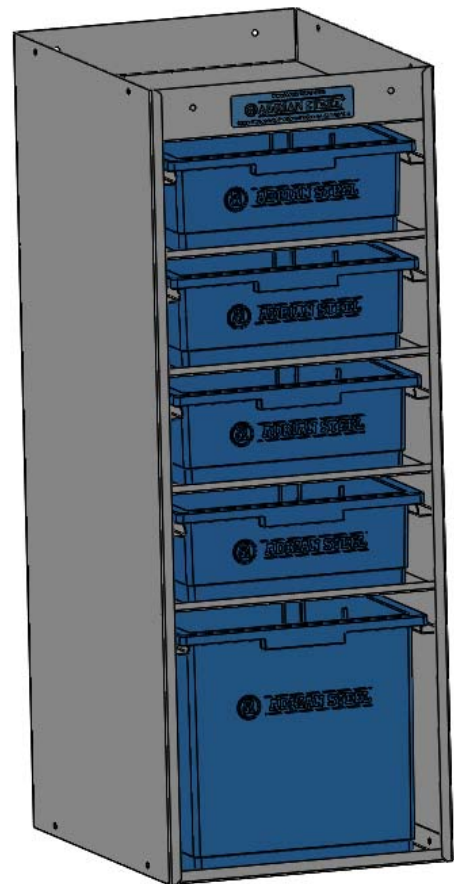

**BC5- 5 DRAWER
BIN CABINET**

- PRECAUTIONS -





 **CAUTION** 
**THE USE OF AIR IMPACT TOOLS CAN
OVER-TORQUE FASTENERS AND
CAUSE FASTENER FAILURE!**





 **CAUTION** 
**ALL INSTALLATION HOLES SHOULD BE SEALED
WITH SILICON OR BUTYL SEALANT TO PREVENT
EXHAUST FUMES FROM ENTERING THE VEHICLE!**



 **DANGER** 
**INSPECT FOR FUEL TANK, FUEL LINES, BRAKE LINES, HIGH
VOLTAGE BATTERIES AND ELECTRICAL LINES PRIOR TO
DRILLING TO AVOID DAMAGING CRITICAL VEHICLE SYSTEMS
OR INJURY TO INSTALLER DURING INSTALLATION PROCESS!**



 **CAUTION** 
**TO AVOID DAMAGING THE VEHICLE ALWAYS USE DRILL
STOPS WHEN DRILLING ANY INSTALLATION HOLES!
ADRIAN AVAILABLE PART #'S 31121-0 (1/2" DEEP),
31122-0 (3/4" DEEP)**



- IMPORTANT WARRANTY REQUIREMENTS -

1. SUBSTITUTING ADRIAN STEEL SPECIFIED FASTENERS FOR ASSEMBLY AND/OR INSTALLATION WILL VOID YOUR PRODUCT WARRANTY.
2. ALL HOLES DRILLED INTO VEHICLE SHOULD HAVE THE RAW METAL EDGES SEALED WITH A SELF-ETCHING PRIMER TO RESIST CORROSION AND POTENTIAL FASTENER POINT FAILURE.
3. ALL FASTENERS USED IN THE INSTALLATION OF THIS PRODUCT SHOULD BE TIGHTENED TO THE TORQUE(S) SPECIFIED IN THESE INSTRUCTIONS.
4. THESE INSTRUCTIONS SHOULD BE KEPT WITH THE VEHICLE.

THE BASIC TOOLS NEEDED FOR MOST INSTALLATIONS



DRILL



DRILL BIT WITH
STOP



RATCHET, SOCKETS
AND/OR WRENCHES



SCREWDRIVERS



MEASURING TAPE

ADDITIONAL TOOLS MAY BE NEEDED FOR THIS INSTALLATION AND THEY WILL BE IDENTIFIED IN THE STEPS THAT FOLLOW.

If your vehicle contains carpet or a rubber floor mat you will need to prepare the mounting location. Position the product to be installed into the vehicle and once you are satisfied with the mounting locations, mark the mounting locations. Using a 1-3/16" diameter carpet cutter (P/N: 31183-0). Select the appropriate floor spacers as shown in the illustration. Set those aside for use later into the installation process.

Using the correct drill bit size for the selected plusnut, drill the mounting holes in the vehicle sheet metal to prepare for installing the plusnuts.

If you are thru-bolting at any of the locations simply drill a hole that is 1/16" larger than the bolt size(s) for those locations.

Once you have drilled the holes into the vehicle, the raw metal edges should be sealed using a self-etching primer to resist corrosion and potential fastener point failure.

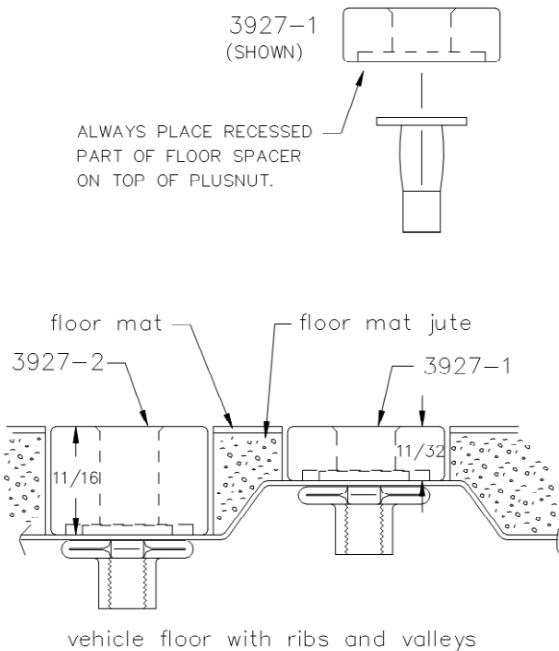

A PLUSNUT (RIVNUT) SETTING TOOL IS REQUIRED FOR PLUSNUT (RIVNUT) INSTALLATION AND IS SUPPLIED WITH THIS KIT. OR USE AN AIR POWERED PLUSNUT SETTING GUN.

1/4-20UNC Plusnut (FAS0052) Use 3/8" dia. drill w/stop

FAS0080 SCREW, HXHD, 1/4-20UNCx2.00", G8

FAS0067 WASHER, FLAT, 1/4"ID

22200-0 PLUSNUT TOOL

5/16-18UNC Plusnut (FAS0091) Use 1/2" dia. drill w/stop

FAS0095 SCREW, HXHD, 5/16-18UNCx2.00", G8

FAS0086 WASHER, FLAT, 5/16"ID

22200-0 PLUSNUT TOOL

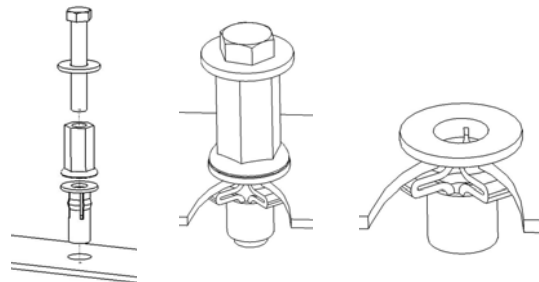

Place barrel of the plusnut body in sheet metal thru hole until flange is flush with sheet metal.

Using a 9/16" combination wrench of plusnut tool body and a second hand wrench, ratchet, or air tool, rotate the hex bolt head CW to draw plus nut flanges up (set the plusnut).

Assembly Fasteners
BAG48525

ITEM NO.	PART NUMBER	DESCRIPTION	BAG48525/QTY.
1	FAS0018	SCREW,HH SFLNG 1/4-20X.62 ZP	6
2	BAG0406-A	4" x 6" 3MIL AUTOBAG	1
3	FAS0055	Nut, Hex Flange,Nylock 1/4-20	6
4	FAS0077	Screw, Truss Hd. Ph, 1/4-20x1.50"	2
5	03927-2	Tall Floor Spacer	2

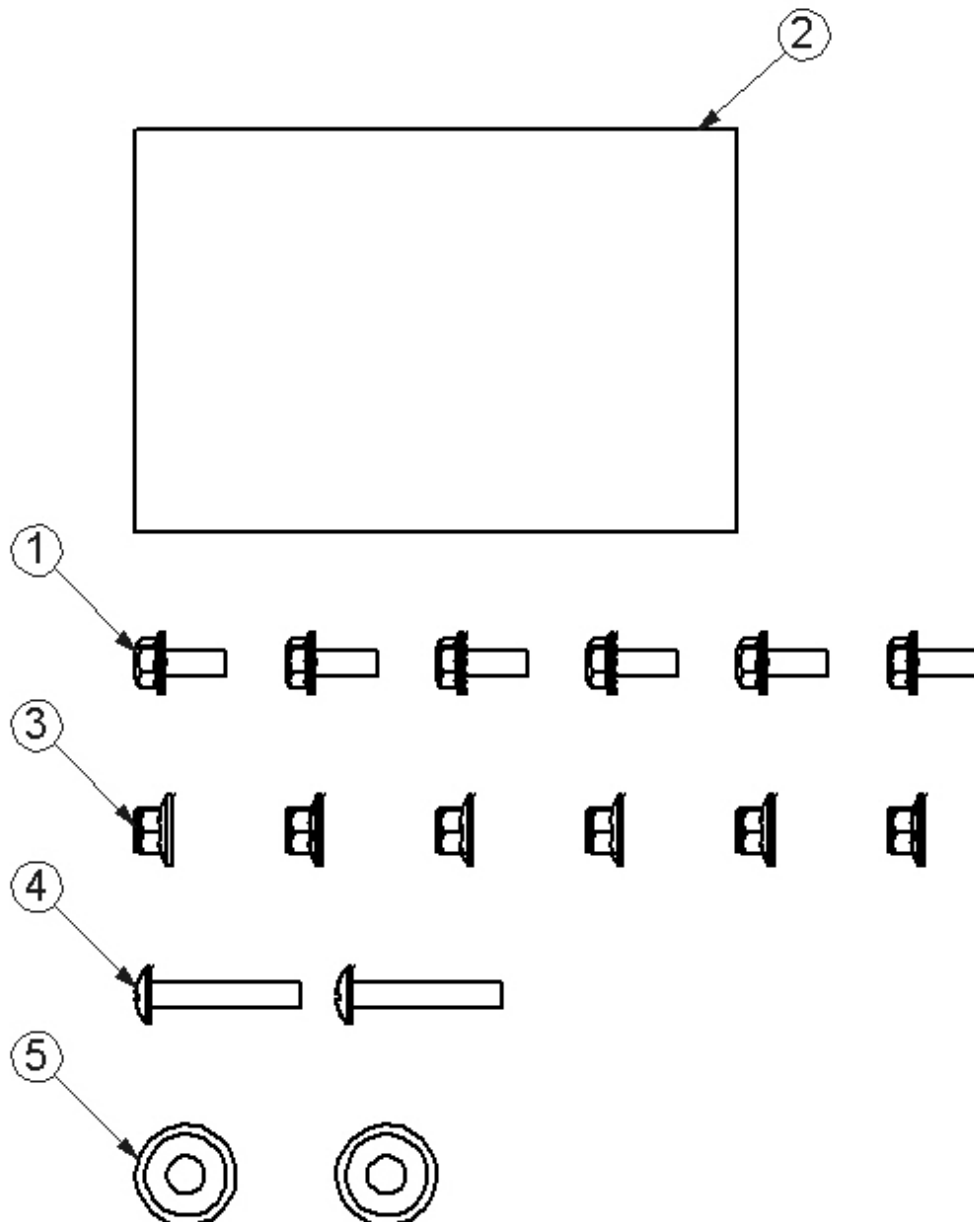

Installation Fasteners
BAGINSTL-C

ITEM NO.	PART NUMBER	DESCRIPTION	BAGINSTL-C/QTY
1	BAG0507-A	5" X 7" 3 MIL AUTOBAG	1
2	FAS0055	NUT,HEX NLK FLG 1/4-20 ZP	2
3	FAS0063	SCREW,HH 1/4-20X.75 G5 ZN	2
4	FAS0086	WASHER,FLAT USS 5/16 ZP	4
5	FAS0091	PLUSNUT,5/16-18 PB DC	4
6	FAS0092	SCREW,HH 5/16-18X1.5 G8ZP	4
7	FAS0098	WASHER,LCK SPLIT 5/16 ZP	4
8	03927-2	SPACER,FLR,C1006,11/16 ZP	4

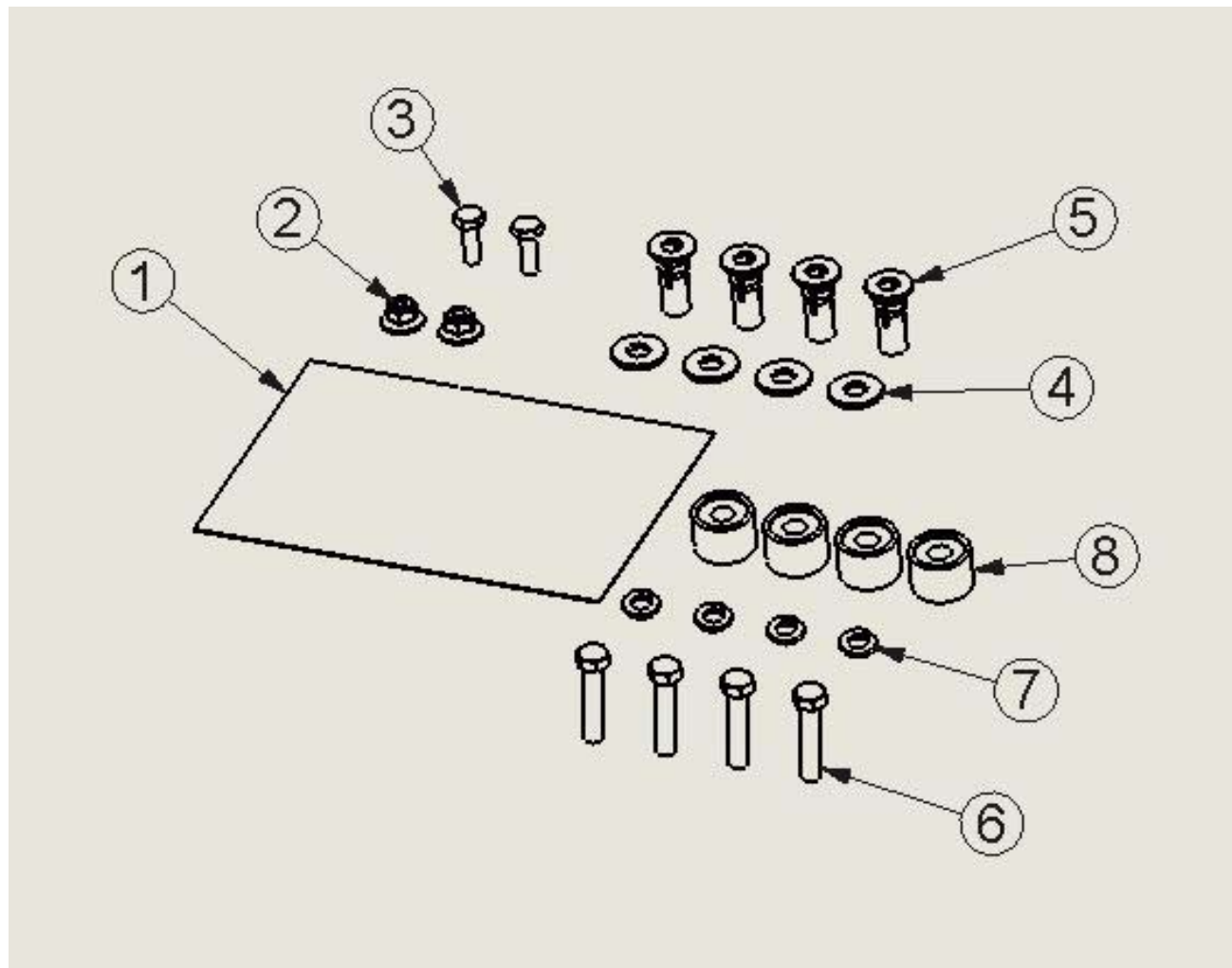

FOR INSTALLATION : REMOVE BINS FROM CABINET. THERE ARE HOLES PROVIDED IN BOTTOM OF CABINET, AND AT BOTTOM AND TOP OF SIDES AND BACK. ATTACH TO FLOOR OR SUB-FLOOR THRU BOTTOM AND TO OTHER ITEMS OR BRACKETS THRU UPPER (& LOWER HOLES, IF NEEDED) AS REQUIRED. SEE PDS OF INTERIOR FOR FURTHER INSTRUCTIONS. RE-INSTALL BINS.

