

ITEM NO.	PART NUMBER	DESCRIPTION	QTY.
1	35494-0	AEROSOL TRAY AND WIPE HOLDER	1
2	BAG35495-0	BAG, FASTENERS FOR AGWBHACT4	1
3	26650-0	FOAM TAPE, 1/4 X 2 1/2 X 40	2
4	32398-0	TRIM, PINCHWELD X 1.5" LG	16
5	CRTAGWBH	Carton, for act4 and wipes holder combo	1

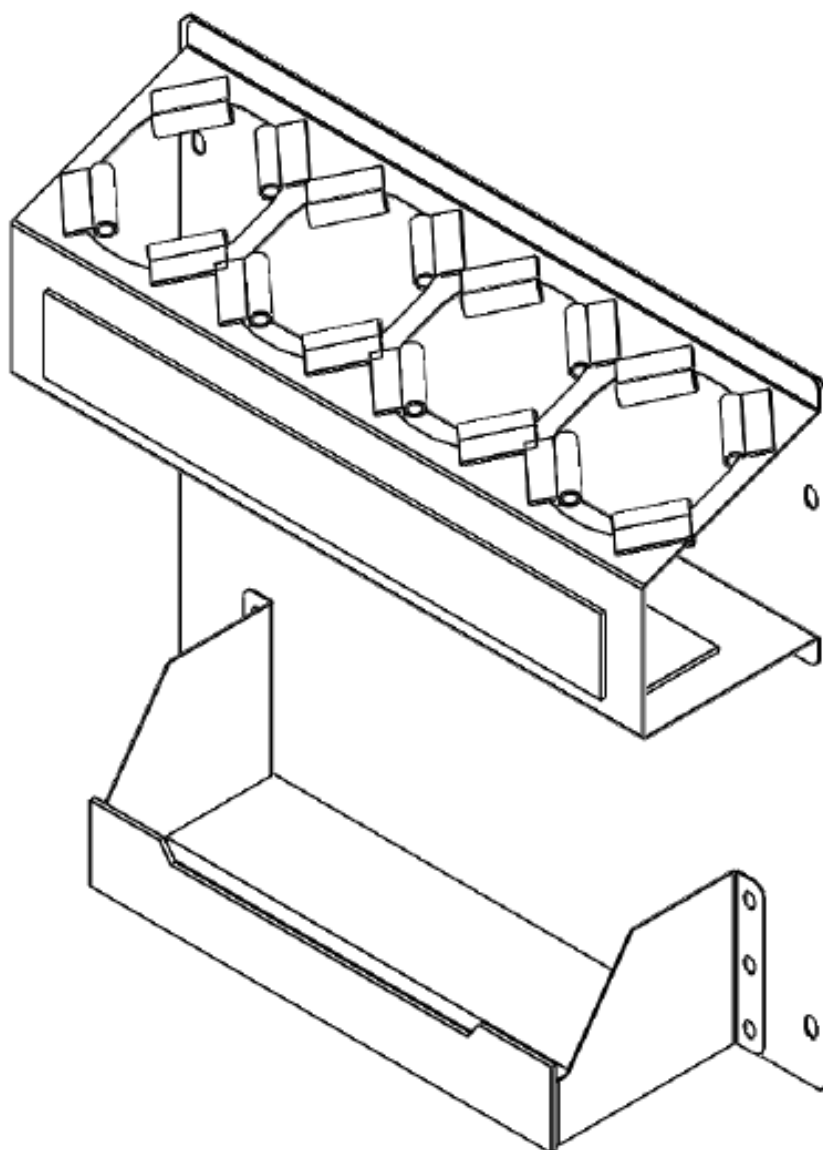

for reference only!

REVISION
LEVEL: **G**

Part
Number: **AGWBHACT4**

PRINTED DOCUMENT IS UNCONTROLLED

THIS PRODUCT IS SUBJECT TO CHANGE.
ADRIAN STEEL COMPANY RESERVES THE RIGHT TO
CHANGE THE PRODUCT OF IT'S DESIGN WITHOUT
PRIOR NOTICE.

THIS DRAWING IS THE PROPERTY OF ADRIAN STEEL COMPANY
AND IS NOT TO BE USED IN ANY MANNER DETRIMENTAL TO
THE INTERESTS OF ADRIAN STEEL COMPANY.

Shipping Wt. (Lbs.):

14.38

Coating/Finish: GRAY

Do Not Scale This Drawing!



906 James St.
Adrian, MI 49221
517.265.6194

Part Description: AGL WIPES BOX AND ACT4

Part
Number: **AGWBHACT4**

REVISION
LEVEL:

G

Auto Glass Wipes Box Holder Aerosol Can Tray Assembly And installation instructions

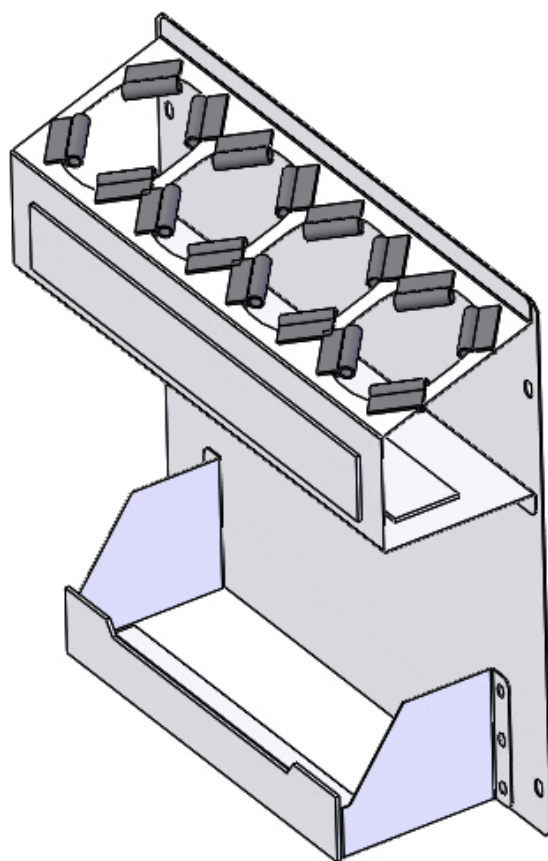

AGWBHACT4

BEFORE YOU START!

IMPORTANT INSTALLATION STEPS ARE DENOTED USING A STOP SIGN. THESE STEPS MUST BE PERFORMED AS SPECIFIED IN ORDER TO ENSURE A PROPER INSTALLATION AND MUST BE FOLLOWED IN ORDER TO MAINTAIN YOUR PRODUCT WARRANTY!



CRITICAL INFORMATION PERTAINING TO USER AND/OR VEHICLE SAFETY IS DENOTED USING A CAUTION SIGN. SAFETY ITEMS MUST BE STRICTLY ADHERED TO IN ORDER TO ENSURE A SAFE WORKING ENVIROMENT!



YOU WILL NEED THE FOLLOWING TOOLS IN ORDER TO COMPLETE THIS JOB.

3/4" HOLE SAW	9/16" OPEN END WRENCH FOR SETTING PLUSNUTS, DRILL MOTOR, 3/8" DRILL BIT WITH 1/2" DEEP STOP
7/16" OPEN END WRENCH	RATCHET WRENCH, WITH 7/16" SOCKET

ALL FASTENERS USED IN THE ASSEMBLY AND INSTALLATION OF THIS PRODUCT SHOULD BE TIGHTENED TO THE SPECIFIED TORQUE AS LISTED WITH EACH FASTENER CALLOUT BOX.



THE USE OF AIR OR ELECTRIC IMPACT TOOLS FOR THE ASSEMBLY OF FASTENERS IS NOT RECOMMENDED AND COULD CAUSE FASTENER FAILURE!



W A R N I N G

THE USE OF DRILLS WITH INTEGRAL DRILL STOPS ALONG WITH PROPER INSPECTION FOR GAS TANK, GAS LINES, BRAKE LINES AND ELECTRICAL LINES PRIOR TO DRILLING ANY MOUNTING HOLES IS STRONGLY RECOMMENDED TO ENSURE THAT VEHICLE DAMAGE IS AVOIDED!



THE USE OF NON-STANDARD FASTENERS AND/OR DEVIATING FROM THE FASTENERS SPECIFIED IN THE INSTRUCTION (S) MAY VOID YOUR PRODUCT WARRANTY!



ALL DRILLED HOLES IN THE VEHICLE SHOULD HAVE THE RAW METAL EDGES SEALED WITH A SELF-ETCHING PRIMER TO RESIST CORROSION AND POTENTIAL FASTENER POINT FAILURE!



TO PREVENT EXHAUST FUMES FROM ENTERING THE VEHICLE, ALL HOLES SHOULD BE SEALED AT INSTALLATION WITH BUTYL OR SILICON SEALANT MATERIAL.



Whenever a plusnut is specified it is important that the proper size installation hole is provided.

PLUSNUT SIZE		DRILL SIZE <i>(with stop)</i>
1/4-20 PLUSNUT, FAS0052		3/8" DIAMETER
5/16-18 PLUSNUT, FAS0091		1/2" DIAMETER

FOR MOUNTING THROUGH A FLOOR MAT AND/OR CARPET

Position each item in desired location inside the vehicle and mark the floor mounting locations.

It is recommended that a drilling template be used to ensure an accurate placement of components is achieved for this installation.

Using the cutting tool, drill a pilot hole thru the mat/carpet and metal floor pan.

Spacer Use and Installation

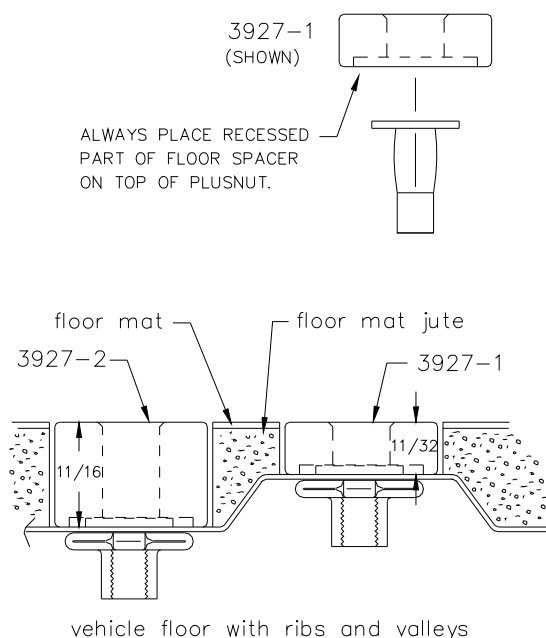
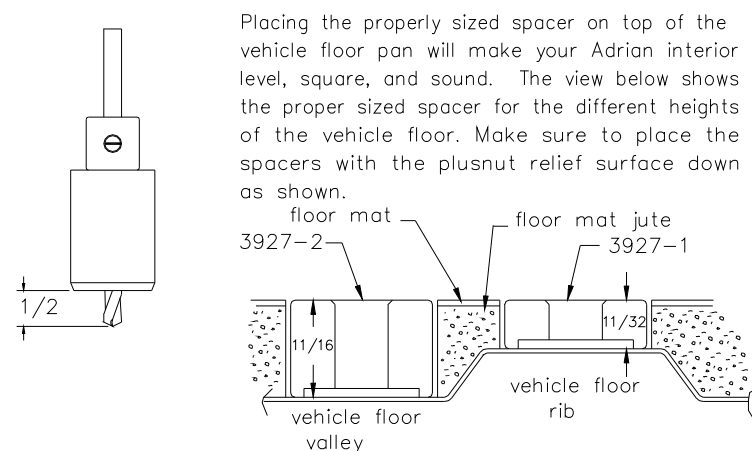

The location of various floor mounts will determine what spacer combination will be used. For example, an 11/32" spacer is used atop floor ribs, and an 11/16" high spacer is used atop floor valleys.



THE PROPER USE OF SPACERS IS REQUIRED WHEN MOUNTING OVER MAT/CARPET TO ENSURE THE METAL-TO-METAL CLAMP-UP, WHICH WILL PREVENT UNWANTED COMPONENT SHIFTING AND POTENTIAL FAILURE DURING USE.



STEP – 01

ADDING FOAM INSERTS IN FOUR LOCATIONS

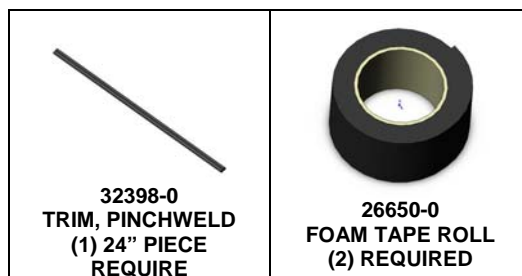

CUT PINCHWELD INTO 16 PIECES 1.5" IN LENGTH AND ATTACH FOUR (4) PIECES TO EACH HOLE

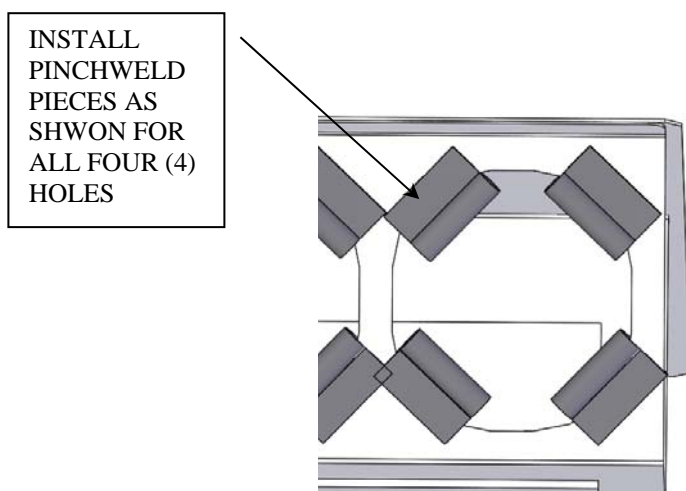

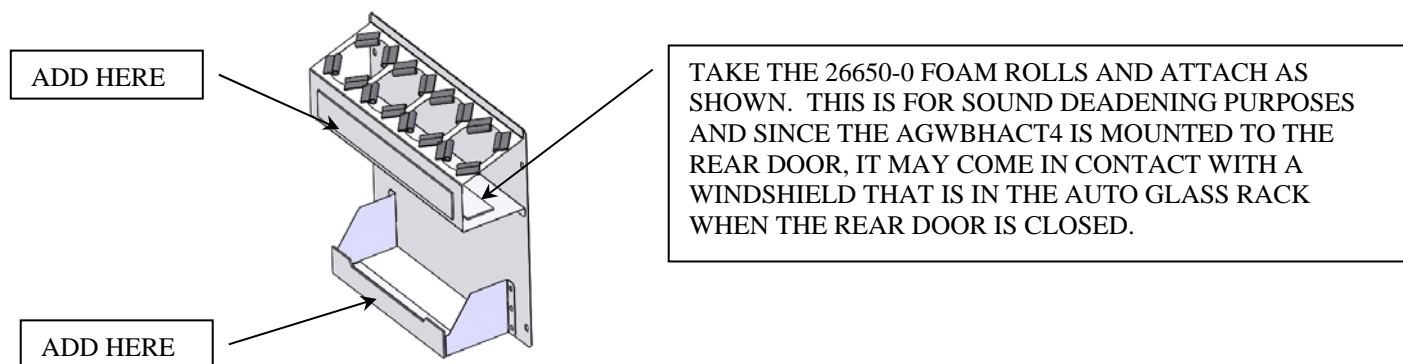

The foam inserts need to be installed on the inside with the flat washers next to the foam. Be careful not to over tighten the fasteners when installing the foam inserts.



STEP – 02

VEHICLE PREPARATION, DOOR MOUNTING LOCATIONS

 <p>FAS0052 1/4" PLUSNUT (4) REQUIRED</p>	 <p>22200-0 PLUSNUT TOOL</p>	<p>NOTE: PLUSNUT TOOL NOT SUPPLIED WITH THIS KIT. ORDER PLUSNUT TOOLS FROM ADRIAN STEEL OR USE INSTALLATION TOOLKIT 31291-0</p>
---	---	--

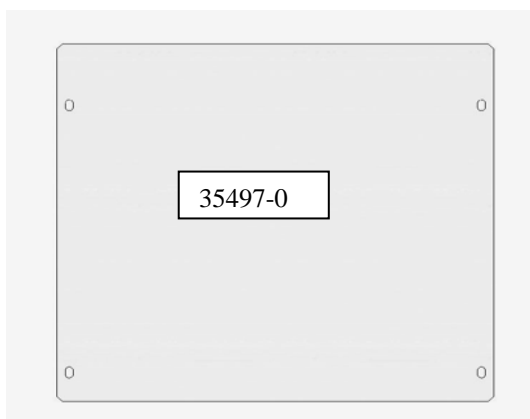

Open Vehicle rear door. Place AGWBHACT4 below latch handle on Curbside / passenger side. Center the unit between plastic liner hold down clips. Mark all four mounting locations using back plate as a jig. Make sure the bottom edge of the back panel is slightly above the bottom edge of the plastic liner. Otherwise it may interfere with the closing of the rear door.

Using 3/8" drill bit with drill stop drill holes at the marks you made in the Plastic Liner.

Clean up debris from drilling and Install a 1/4" plusnut into each hole and set the plusnut as shown in illustration.

Note: Illustrations shown with optional Sound Deadening Kit SDKACT4 ordered separately.

ASSEMBLE THE FOLLOWING

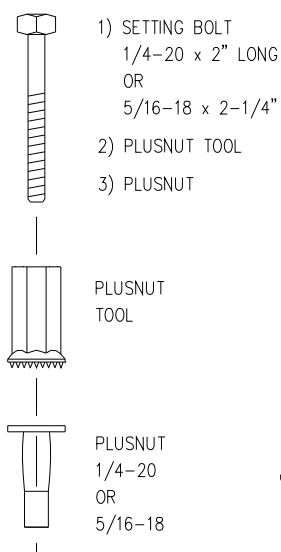

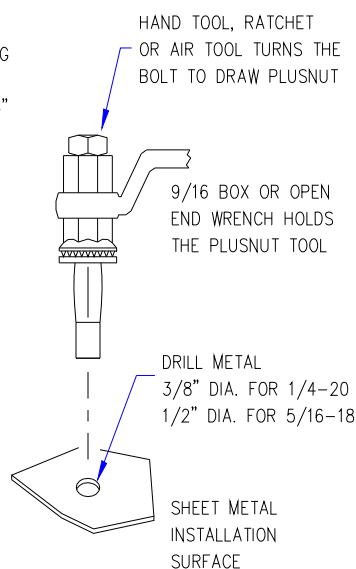

SETTING THE PLUSNUT



STEP – 03

ATTACHING TO VEHICLE REAR DOOR

 <p>FAS0078 SCREW, HH 1/4-20 x 1" (4) REQUIRED TORQUE 12ft. lbs.</p>	 <p>FAS0067 1/4-20 FLAT WASHER (4) REQUIRED</p>	 <p>FAS0060 1/4-20 SPLIT RING L'WASHER (4) REQUIRED</p>
--	---	---

Fasten the AGWBHACT4 to the curbside rear door with the above fasteners.

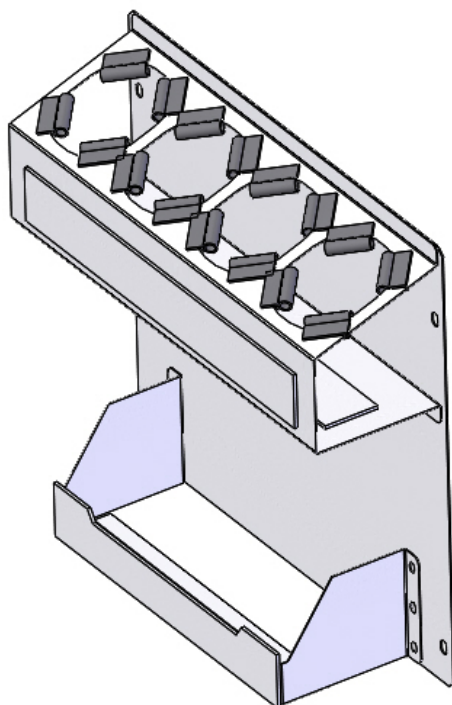

**DOUBLE-CHECK ALL FASTENER LOCATIONS TO BE
SURE THAT ALL FASTENERS ARE TIGHTENED TO
SPECIFICATIONS!**



**YOUR INSTALLATION IS NOW COMPLETE! STOW THIS COPY IN THE
VEHICLE FOR FUTURE REFERENCE!**