

SB & 1lb TANK BRACKET, 14"



PRODUCT WEIGHT
3.6 LBS

WIDTH x DEPTH x HEIGHT
14" x 5" x 10.8"

CAPACITY
5LBS

COLOR
GRAY

CATALOG NUMBER
66761

PRODUCT FEATURES

Spray bottle & 1lb LP tank bracket is intended to be mounted on the end of shelf units or other places inside a cargo vehicle. Four nuts and bolts are used to fasten to surface.

SEE PAGE 2 FOR APPLICATION NOTES AND ACCESSORIES, OTHER PRODUCTS THAT WORK WITH THIS UNIT.



CATALOG NUMBER 66761

PRODUCT APPLICATION

This product is designed to be installed using fastener bag BAG65529.

ACCESSORIES THAT WILL WORK WITH THIS PRODUCT

| <i>CATALOG NUMBER</i> | <i>DESCRIPTION</i> |
|------------------------------|-----------------------------------|
| 66759-G | SB&1LB BRACKET |
| BAG65529 | DIVIDER AD SERIES SHELVING |

SPECIAL APPLICATION NOTES

| | | | | | | |
|--|-------|--------|----------|-------------|-----------------------------|------|
| INSTR. : 66760 NUMBER | PG: 1 | REV: B | ITEM NO. | PART NUMBER | DESCRIPTION | QTY. |
| | | | 1 | 66759-G | SB&1LB TANK BRACKET | 1 |
| PART : 66761 NUMBER | | | 2 | 26650-0 | Foam Tape, 0.25x2.5x40.0 | 1 |
| | | | 3 | BAG65529 | BAG FOR SHORT CAULK HOLDERS | 1 |
| PART : SB-1LB LP TANK BRACKET DESC. : 14" 66759 | | | 4 | 66760 | INSTALL INSTRUCTIONS | 1 |
| | | | | | | |

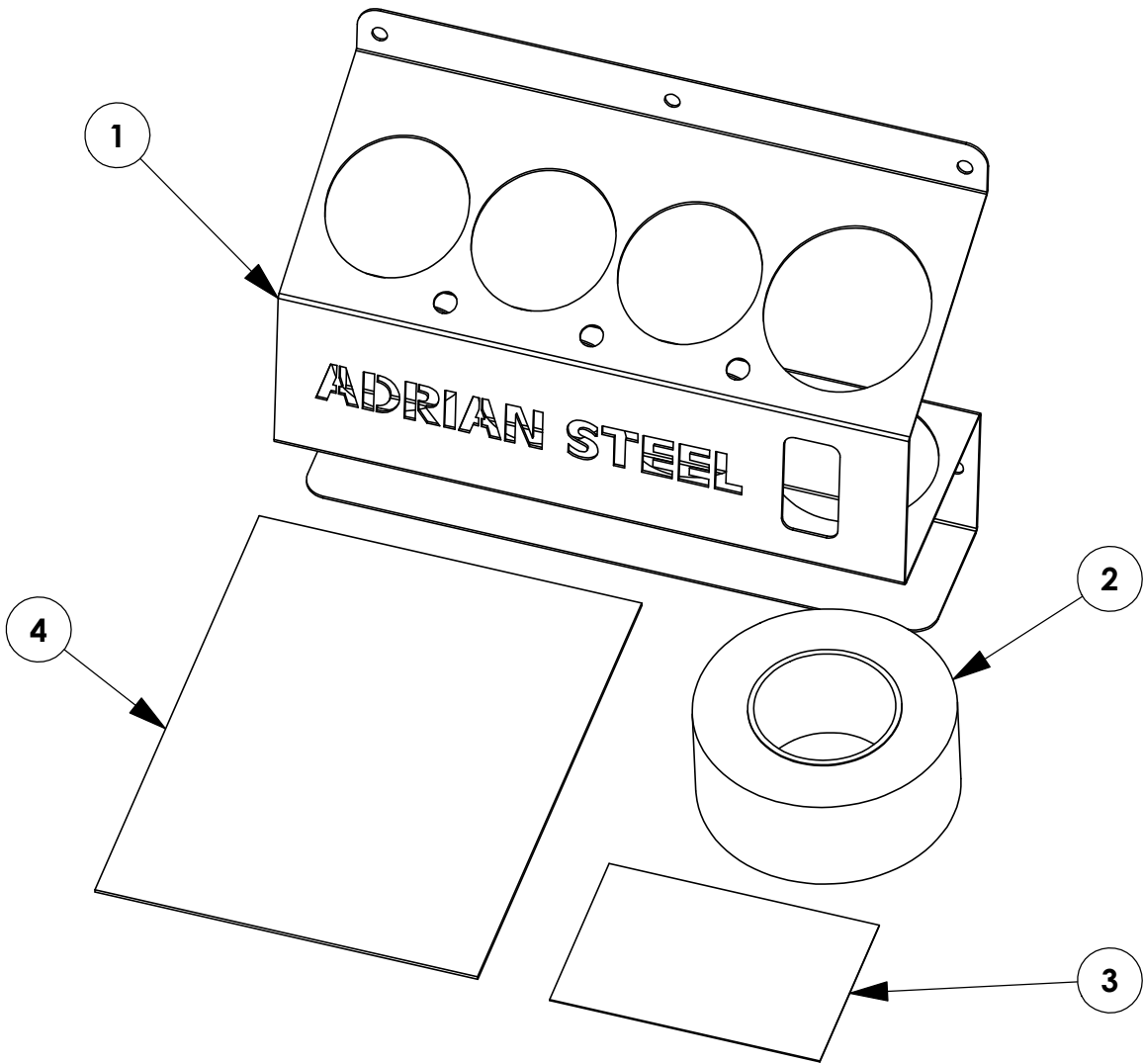

GET TO KNOW THE VEHICLE - AT THE BEGINNING OF ANY INSTALLATION, CHECK THE LOCATION OF THE FUEL TANK, FUEL LINES, BRAKE LINES, HIGH VOLTAGE BATTERIES AND WIRING HARNESSSES TO AVOID INJURY OR PROPERTY DAMAGE FROM TOOL CONTACT.

SEAL ALL EXTERIOR HOLES - ALL INSTALLATION HOLES SHOULD BE SEALED WITH BUTYL TAPE OR SILICON TO PREVENT WATER AND EXHAUST GASES FROM ENTERING THE VEHICLE.

CONTROL DRILL DEPTH - TO AVOID DAMAGE TO THE VEHICLE, USE A DRILL STOP OR CLEARED STEP BIT WHEN DRILLING INSTALLATION HOLES.

ALWAYS ADD PRIMER - WHEN ADDING INSTALLATION HOLES BE SURE TO USE A SELF-ETCHING PRIMER TO PREVENT CORROSION, FASTENER FAILURE AND INJURY.

MOUNTING POINTS MUST HAVE METAL-TO-METAL CONTACT - USE PROVIDED MOUNTING SPACERS TO ACCOMMODATE FOR VEHICLE FEATURES, CARPET OR SUBFLOORS.

PROVIDE CLEARANCE FOR SPACERS - IF THE INSTALLATION VEHICLE CONTAINS A CARPET OR SUBFLOOR, USE A 1-3/16" DIAMETER CARPET CUTTER (P/N: 31183-0) AT ALL MOUNTING LOCATIONS TO OPEN UP ROOM FOR SPACERS.

CHECK SPACER ORIENTATION - BE SURE THAT THE INDENT IN THE SPACER COVERS THE PLUSNUT HEAD; THIS ENSURES THE MOST METAL-TO-METAL CONTACT AND REDUCES VIBRATION.

PLUSNUT INSTALLATION - A PLUSNUT GUN IS RECOMMENDED FOR PLUSNUT INSTALLATION FOR ITS PRODUCTION SPEED. HOWEVER, A PLUSNUT SETTING TOOL CAN ALSO BE USED (P/N: 22200-0).

THRU-BOLT CLEARANCE - WHEN USING A THRU-BOLT AT ANY MOUNTING LOCATION, BE SURE THAT YOUR HOLE HAS 1/16" CLEARANCE.

FASTENERS USED

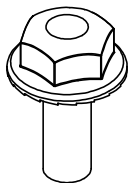

**FAS0018
1/4-20X.62ZP
SCREW,HH SFLNG
QTY:4**

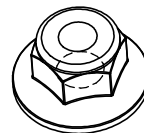

**FAS0055
1/4-20 ZP
NUT,HEX NLK FLG
QTY:4**

BEGIN ASSEMBLY

STEP 1 - CUT FOAM STRIP TO 14" & INSTALL ON BOTTOM LIP



**26650-0
FOAM PAD FOR
NOISE REDUCTION**

STEP 2 - INSTALL HOLDER TO END PANEL, PARTITION, ETC

**FAS0018
FAS0055
11/32 DRILL**

**DRILL HOLES & INSTALL
FASTENERS IN END
PANEL, PARTITION, ETC**

