

KIT, PWR STRIP W/ BRKT



PRODUCT WEIGHT

3.89 LBS

COLOR

BLACK



CATALOG NUMBER

66554

PRODUCT FEATURES

This kit includes a power strip with an easily mountable bracket and a hardware bag. The bracket can be mounted on shelving units, partitions, van walls, and rails. This kit gives installers an easier and faster way of installing the power strip into vehicles, and gives the customer much more flexibility with their power strip locations.

SEE PAGE 2 FOR APPLICATION NOTES AND ACCESSORIES, OTHER PRODUCTS THAT WORK WITH THIS UNIT.

PAGE 1 of 2

The information contained in this document is the sole property of ADRIAN STEEL COMPANY. ADRIAN STEEL COMPANY retains the right to modify and/or change the product of its design at any time without prior notification.



CATALOG NUMBER 66554

PRODUCT APPLICATION

This product is designed to be installed using BAG66554.

ACCESSORIES THAT WILL WORK WITH THIS PRODUCT

<i>CATALOG NUMBER</i>	<i>DESCRIPTION</i>
47199	Extension Cord w/Single Outlet,25', Black
47200	Extension Cord w/Triple Outlet, 25', Black
47717	Extension Cord w/Single Outlet, 6', Black
48288	Extension Cord w/Single Outlet, 10', Black

SPECIAL APPLICATION NOTES

Introduction / Comments:

Install Instructions For Power Strip Mount Kit 66554

Note:

Read all instructions prior to installation. Review the Adrian Steel **GENERAL PRECAUTIONS PAGES (56638)** before attempting installation. Only personnel familiar with using electrical best practices should perform this install. Reference **ELECTRICAL BEST PRACTICES MANUAL (54479)** before attempting installation.



Installation Instructions For Power Strip Mount Kit 66554

Kit Includes:

- (1) Hardware Bag
- (1) Power Strip
- (1) Power Strip Bracket
- (1) Instruction Set

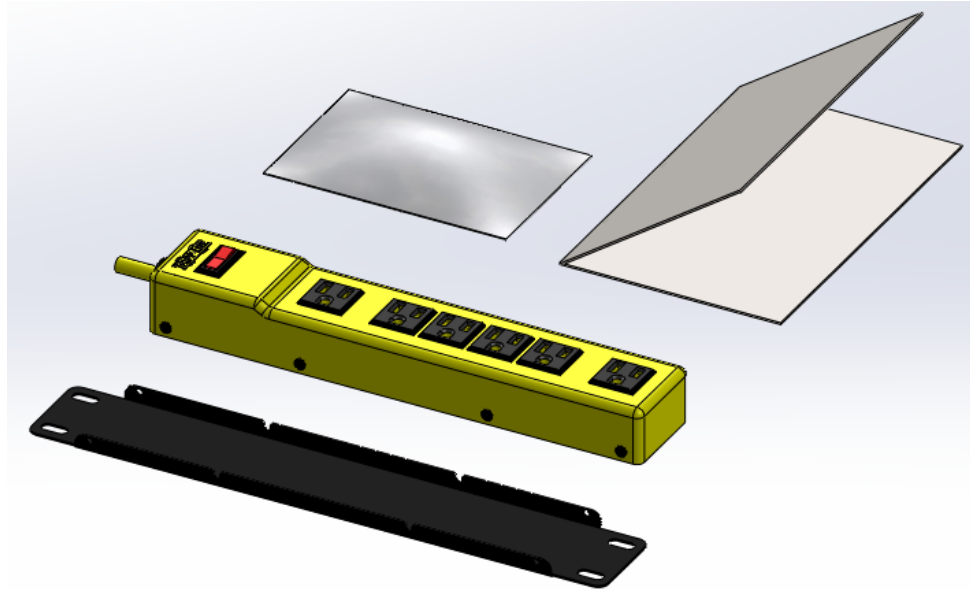

Tools That May Be Required:



1/4" socket and/or wrench



#2 philips bit or screw driver



1/4" plusnut gun



Power drill and 3/8" step drill bit

Fastener Bag

ITEM NO.	PART NUMBER	DESCRIPTION	QTY.
1	FAS0055	NUT,HEX NLK FLG 1/4-20 ZP	4
2	BAG0406-A	4" x 6" 3MIL AUTOBAG	1
3	FAS0018	SCREW,HH SFLNG 1/4-20X.62 ZP	4
4	FAS0052	PLUSNUT, 1/4-20 PB DC	4
5	FAS0060	WASHER,LCK SPLIT 1/4 ZP	4
6	36715-0	SLIDE, EXTR, CLAMP SLED, 2.0" LG	2
7	FAS0025	Screw, Truss Hd. Ph, #10-24x0.50	2
8	FAS0024	Washer, Lock, Split, #10	2
9	FAS0027	Washer, Flat, #10	2

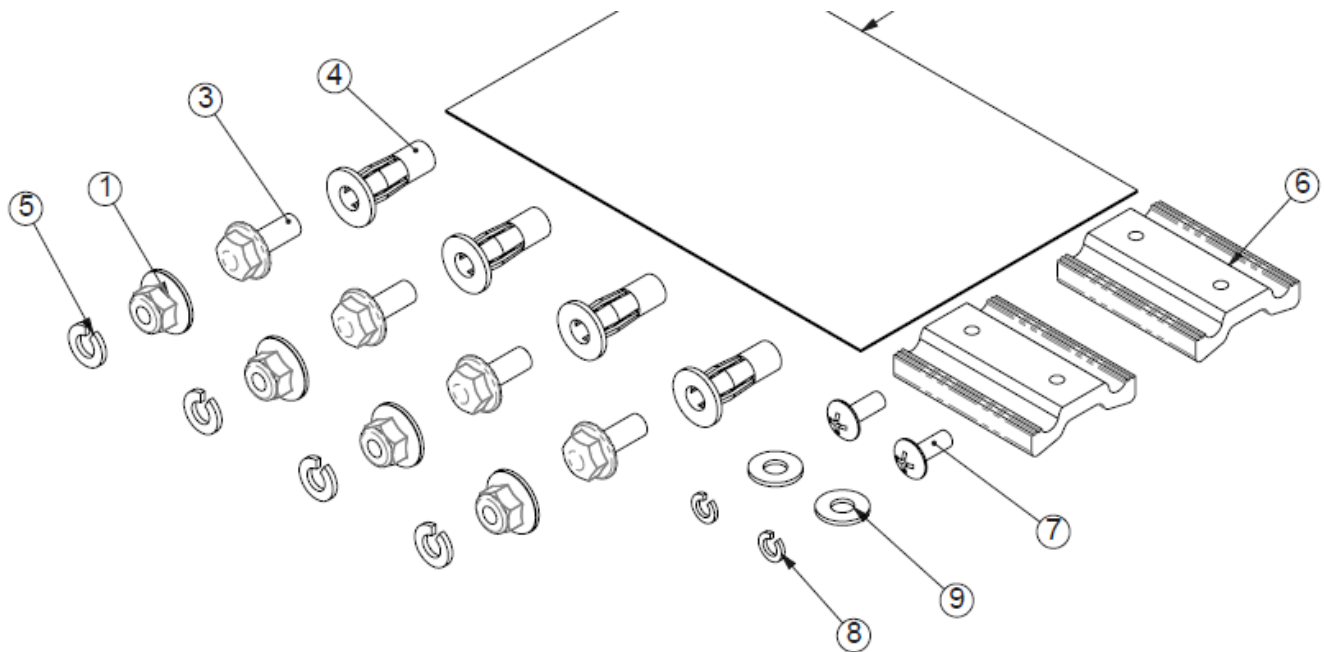

Power Strip And Bracket Assembly:

- Completely remove the 4 outside screws on the power strip.
- Loosen the 4 inside screws on the power strip. Do not completely remove them.
- Slide the power strip into the bracket.
- Re-insert the 4 outside screws and tighten the 4 middle screws

Loosen screws

Completely remove screws

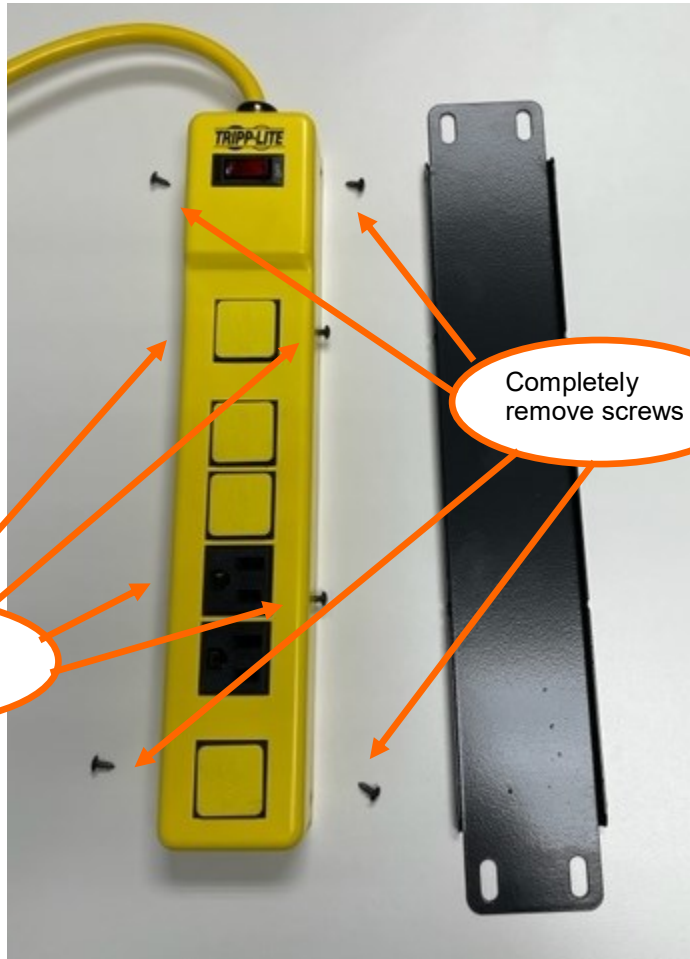

For Mounting On A Shelf Or Partition:

Step 1: Select the desired location for the power strip. Use the power strip bracket as a template to mark/drill holes for mounting. Drill a 9/32" hole to fit the FAS0018 (1/4-20X) screw.

Pictures are for reference only, there are many variations available.

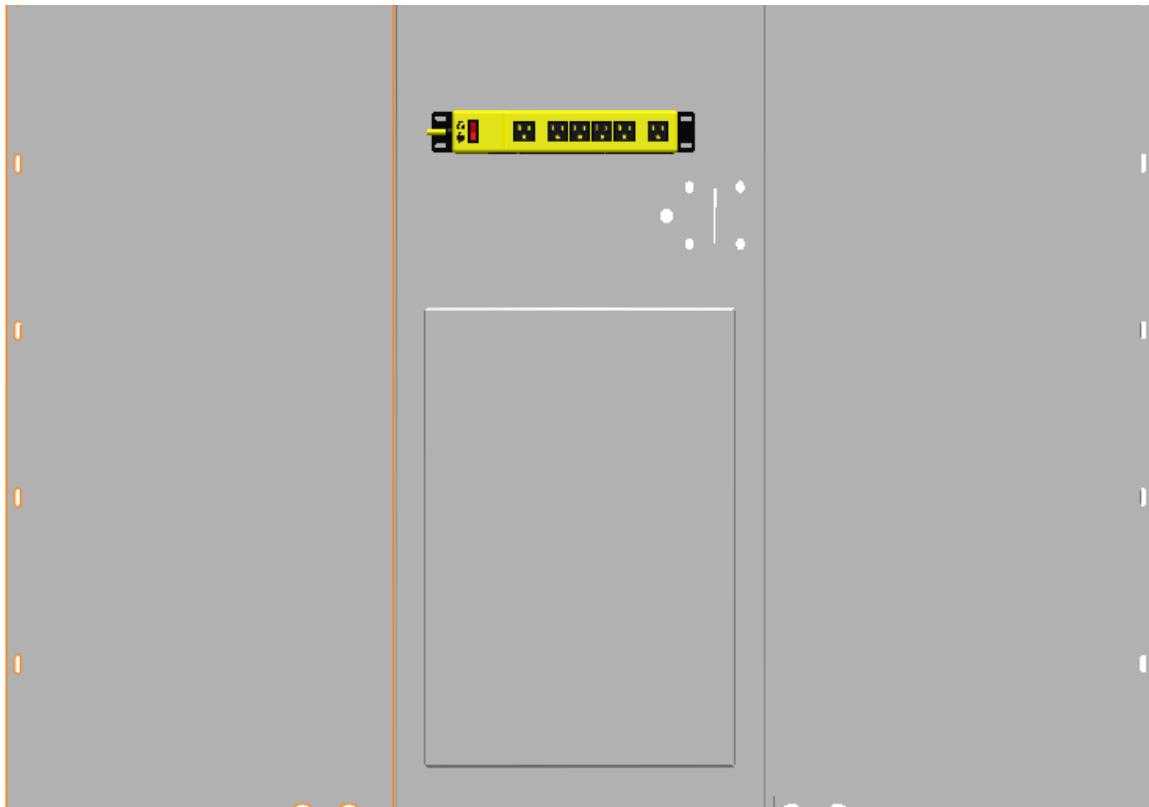
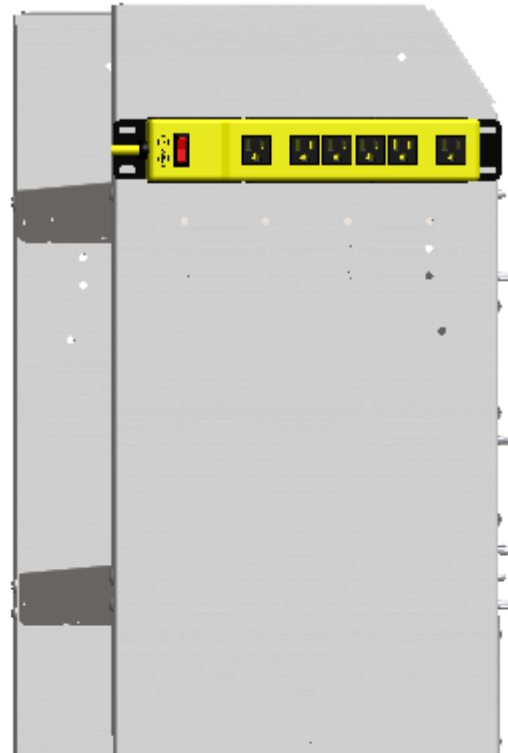

Step 2: Use the FAS0055 (1/4-20X nut) and FAS0018 (1/4-20X screw) to mount the bracket/power strip to the desired location

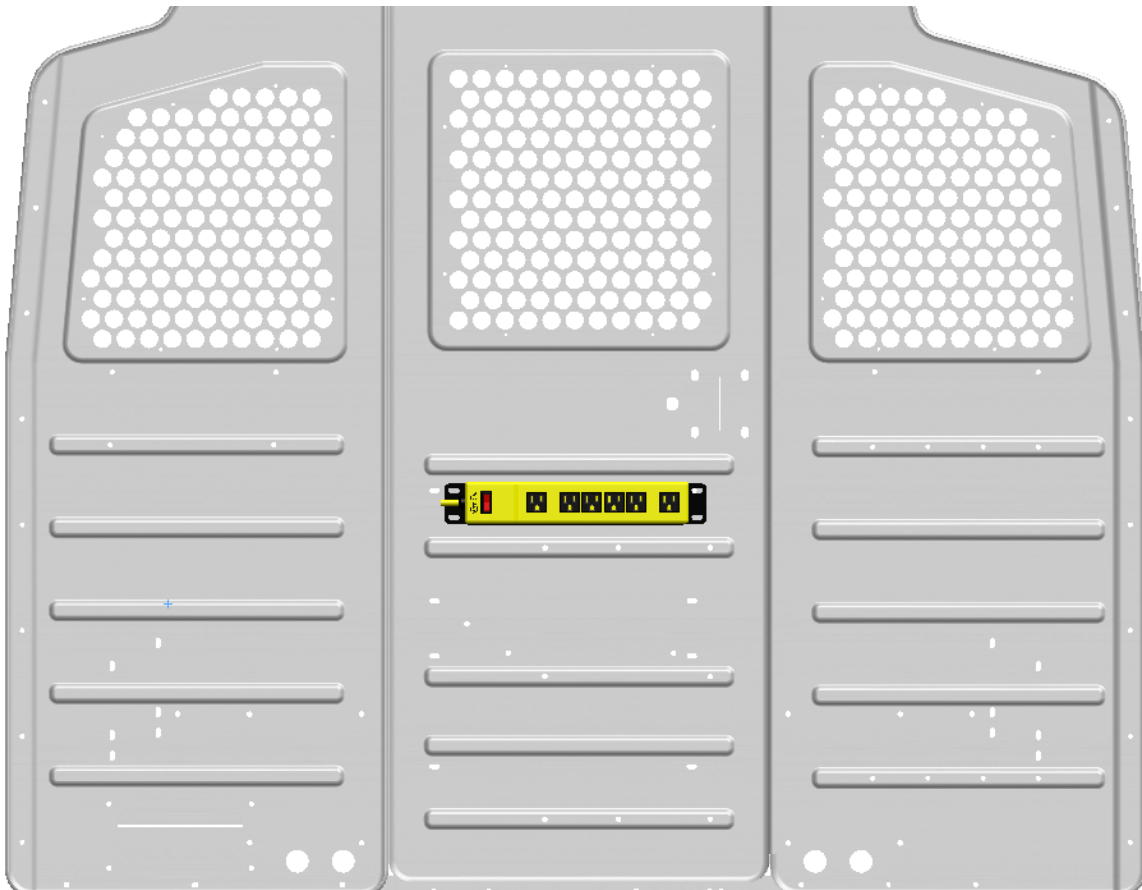
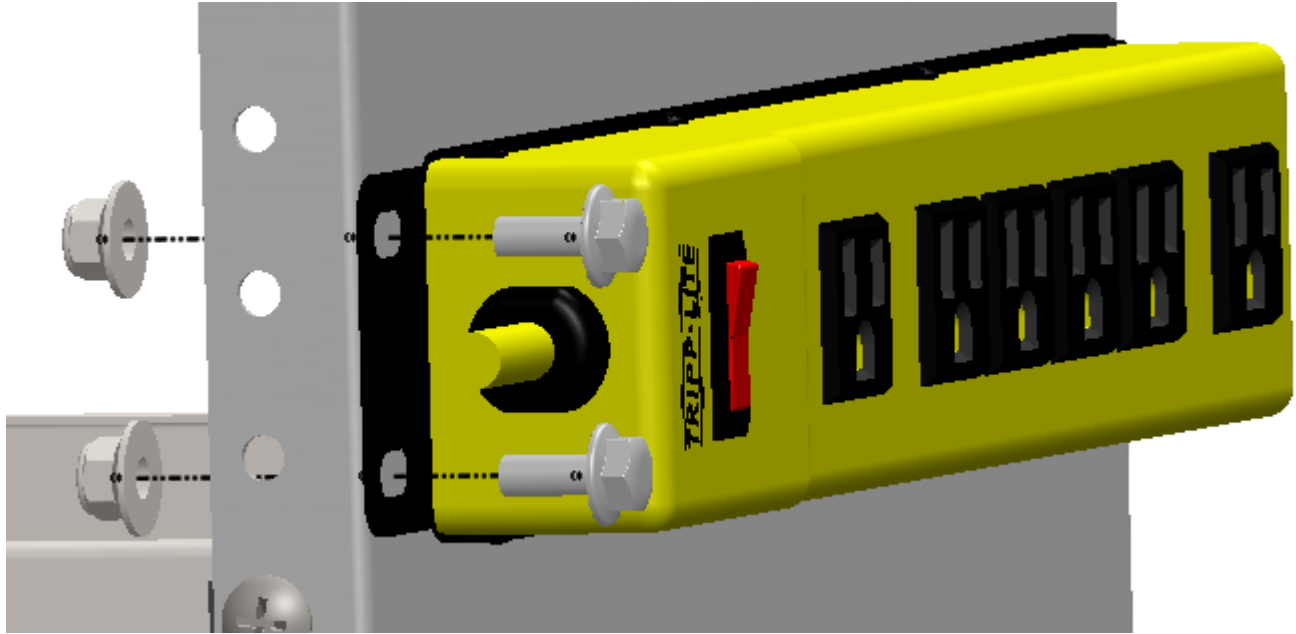

For Mounting On The D-Pillar:

Step 1: Select the desired location for the power strip. Use the power strip bracket as a template to mark/drill holes for mounting.

Drill 4 3/8" holes and insert the plusnuts (FAS0052) into the holes.

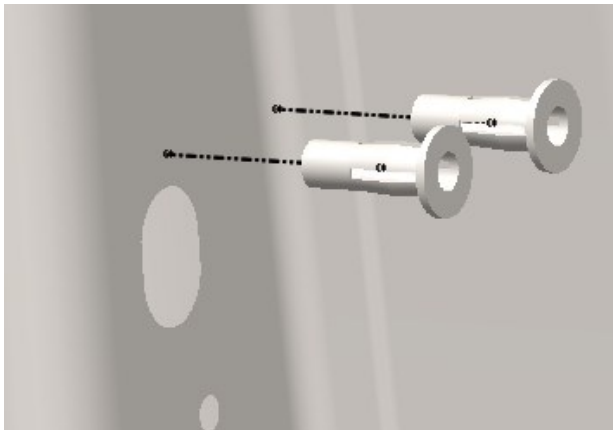

Step 2: Install the power strip and bracket to the D-pillar by using the 1/4" lock washers (FAS0060) and the 1/4-20x bolts (FAS0018)

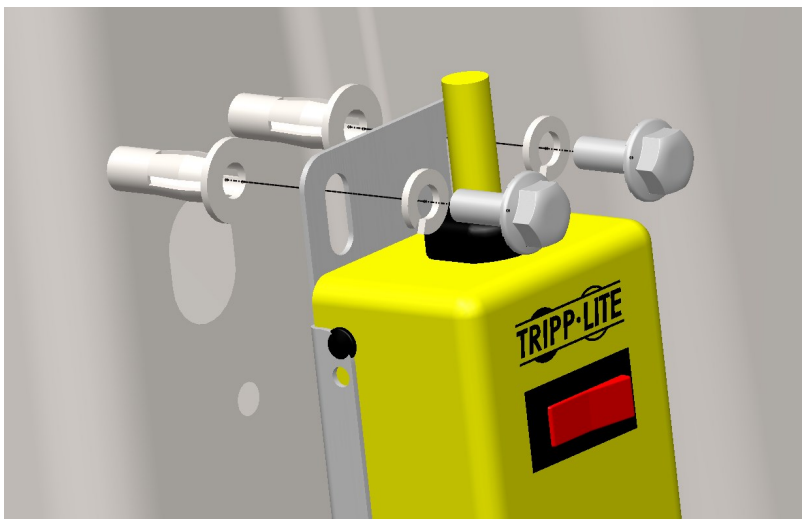

For Mounting On A Rail (Example on a Composite Partition):

Step 1: Slide the AD Rail Slides (36715-0) to the middle of the rail, spaced close to the length of the power strip bracket.

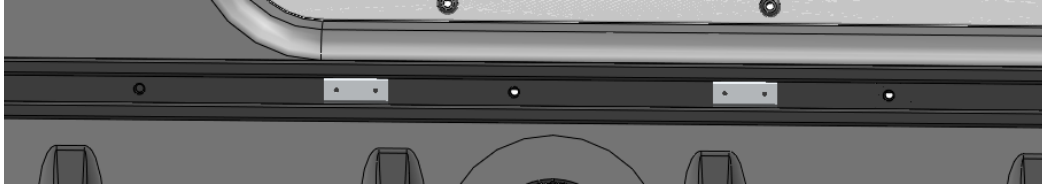

Step 2: Insert the M10 bolt (FAS0025), then the Lock washer (FAS0024), then the flat washer (FAS0027) through the bracket slot and into the AD Rail. Do this for both sides of the power strip. Tighten completely in desired location on the rail.

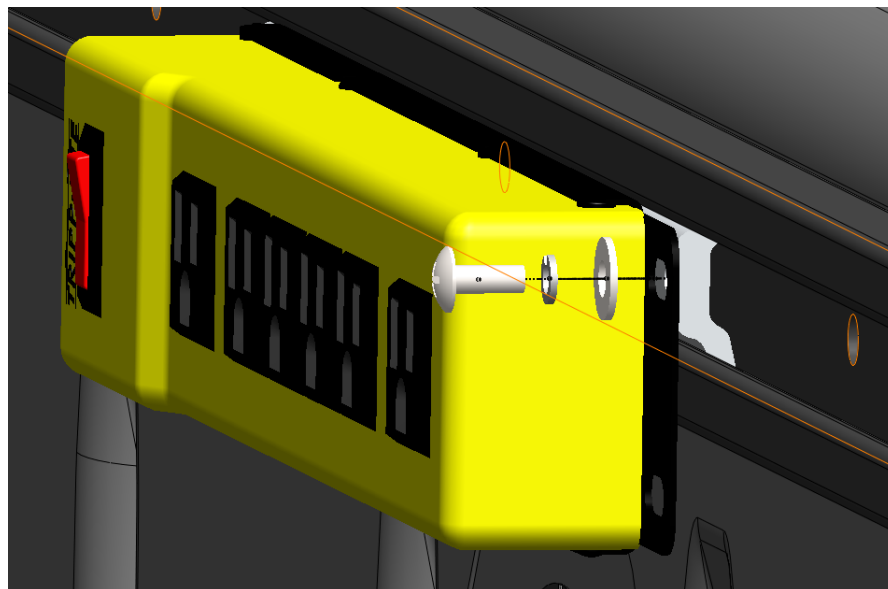
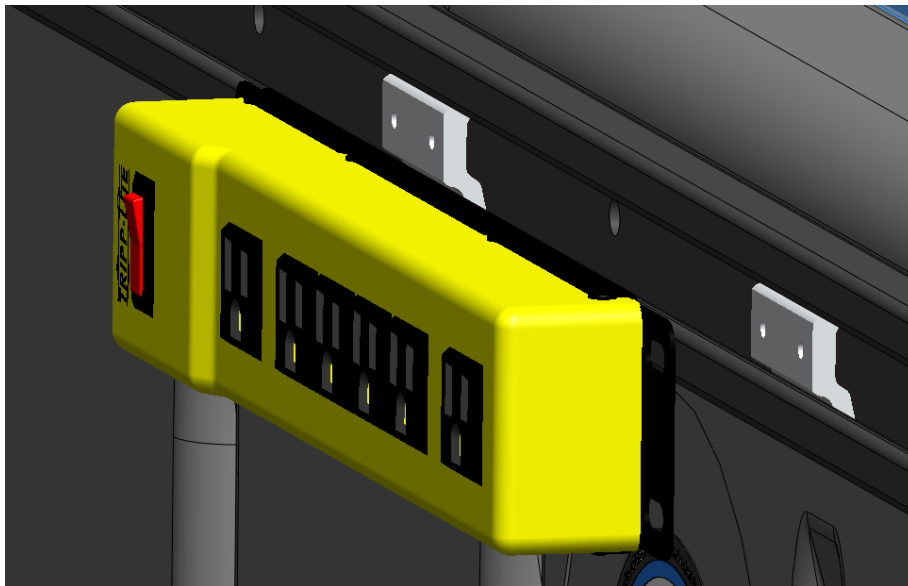

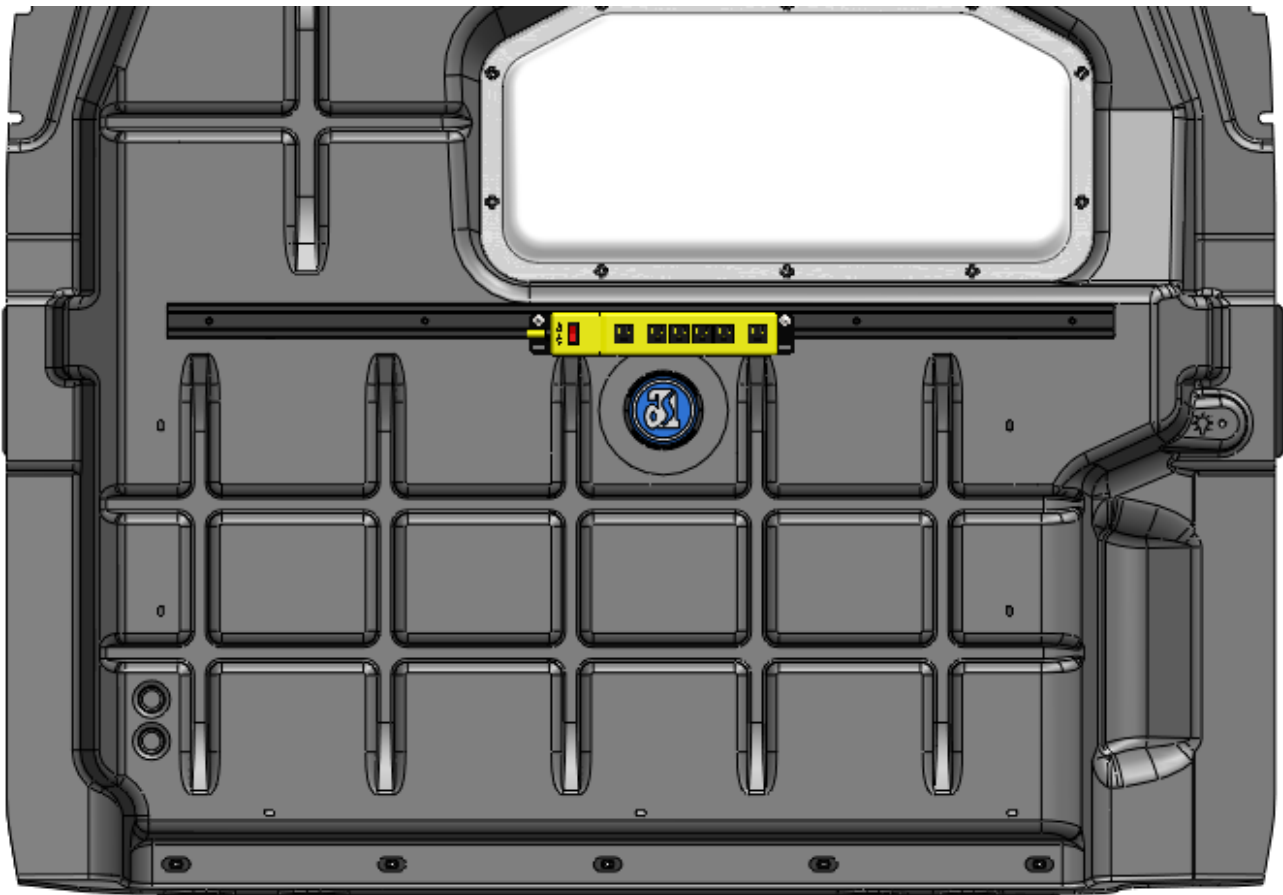
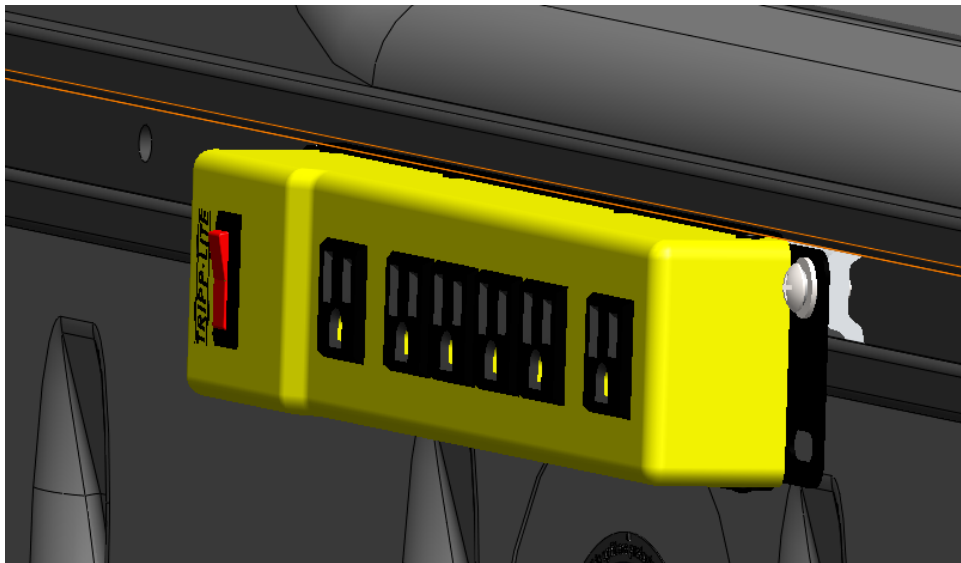

The installation is now complete