

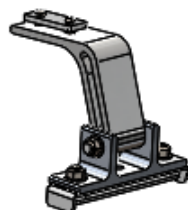

## Mounting Bracket Kit, 2-Pack, White, ProMaster



PRODUCT WEIGHT  
**2.7 LBS**

HEIGHT OFF ROOF  
**SEE TABLE BELOW**

CAPACITY  
**REFER TO OEM'S  
RECOMMENDED LOAD  
RATING**  
COLOR

**WHITE**

CATALOG NUMBER

**PMMBK2W**

### PRODUCT FEATURES

**Ram ProMaster aluminum mounting bracket kit (w/ stainless steel plates) for the PROFILE™ HD Utility Racks to add additional crossbows to 2-Bar rack. Mounting kit works for both 118" and 136" wheelbase, low roof vehicles. Can be mounted to any OEM mounting locations to best fit customer's product.**

**Utility racks are not recommended for high roof vehicles!**

**Does not work with grip lock or drop down style racks.**

**SEE PAGE 2 FOR APPLICATION NOTES AND ACCESSORIES, OTHER PRODUCTS THAT WORK WITH THIS UNIT.**



**CATALOG NUMBER PMMBK2W**

**PRODUCT APPLICATION**

**This product is designed to be installed on Ram ProMaster vans. HD Utility Racks are not recommended for high roof vehicles!**

**ACCESSORIES THAT WILL WORK WITH THIS PRODUCT**

CATALOG NUMBER	DESCRIPTION	CATALOG NUMBER	DESCRIPTION
PMMBK4W	Mounting Bracket Kit, 4-Pack, White, ProMaster	4UPK4B	4" Upright Kit, 4-Pack, Black
2BARW	2-Crossbar Kit, 68", White, Full Size Van	4UPK2B	4" Upright Kit, 2-Pack, Black
1BARW	Single Crossbar Kit, 68", White, Full Size Van	6UPK4B	6" Upright Kit, 4-Pack, Black
RRBPMW	Rear Roller Assist Bar, White, ProMaster	6UPK2B	6" Upright Kit, 2-Pack, Black
70-1NGLR	4" End Cap for PVC Conduit	9UPK4B	9" Upright Kit, 4-Pack, Black
70-2NGLR	6" End Cap for PVC Conduit	9UPK2B	9" Upright Kit, 2-Pack, Black
80-1NGLR	Conduit Kit, 10w x 6h x 126d, Multiple Vehicles	RSK1B	Single Ratchet Upright Kit, 9"
80-2NGLR	Conduit Kit, 10w x 6h x 150d, Multiple Vehicles	ULSKB	Single Ladder Stop Kit

**LADDER RACK HEIGHTS MEASURED FROM ROOF OF VEHICLE**

CONFIGURATION	RACK HEIGHT
Base Rack	5"
Base + Ladder Stop	10.5"
Base + 4" Uprights	8.5"
Base + 6" Uprights	10.5"
Base + 9"/Ratchet Uprights	13.5"
Base + 4" PVC Conduit Kit	9.4"
Base + 6" PVC Conduit Kit	11.4"
Base + Aluminum Box Conduit Kit	11.5"

INSTR. NUMBER	: 63655	PG: 1	REV: E	ITEM NO.	PART NUMBER	DESCRIPTION	PMMBK4W	PMMBK2W	
PART NUMBER				: PMMBK	1	68202-W	PROFILE, MOUNTING ARM, W	4	2
PART DESC.				: UTILITY,MNT BKT KT,PM	2	63852-W	UTILITY, MOUNTING BRKT, W	4	2
				3	63910-W	UTILITY, PM MOUNT BRKT, W	4	2	
				4	63911	UTILITY, PM MOUNT PLATE	4	2	

**NOTE: THIS INSTRUCTION IS VALID FOR THE FOLLOWING KITS:**

- PMMBK4W
- PMMBK2W
- PMMBK4B
- PMMBK2B

**- PART NUMBERS WITH "-W" SUFFIX ARE PAINTED WHITE**  
**- FOR BLACK MOUNTING KITS, REPLACE "-W" PART WITH "-B" PARTS**

The diagram illustrates the assembly of two mounting kits: PMMBK2W and PMMBK4W. It shows the step-by-step installation of four components: 1. Profile Mounting Arm (W), 2. Utility Mounting Bracket (W), 3. Utility PM Mount Bracket (W), and 4. Utility PM Mount Plate. The PMMBK2W assembly shows the arm being attached to the bracket using the utility bracket and plate. The PMMBK4W assembly shows a similar process but with a different bracket configuration. Arrows and numbered circles indicate the sequence of parts to be installed.

**GET TO KNOW THE VEHICLE** - AT THE BEGINNING OF ANY INSTALLATION, CHECK THE LOCATION OF THE FUEL TANK, FUEL LINES, BRAKE LINES, HIGH VOLTAGE BATTERIES AND WIRING HARNESSES TO AVOID INJURY OR PROPERTY DAMAGE FROM TOOL CONTACT.

**SEAL ALL EXTERIOR HOLES** - ALL INSTALLATION HOLES SHOULD BE SEALED WITH BUTYL TAPE OR SILICON TO PREVENT WATER AND EXHAUST GASES FROM ENTERING THE VEHICLE.

**CONTROL DRILL DEPTH** - TO AVOID DAMAGE TO THE VEHICLE, USE A DRILL STOP OR CLEARED STEP BIT WHEN DRILLING INSTALLATION HOLES.

**ALWAYS ADD PRIMER** - WHEN ADDING INSTALLATION HOLES BE SURE TO USE A SELF-ETCHING PRIMER TO PREVENT CORROSION, FASTENER FAILURE AND INJURY.

**MOUNTING POINTS MUST HAVE METAL-TO-METAL CONTACT** - USE PROVIDED MOUNTING SPACERS TO ACCOMMODATE FOR VEHICLE FEATURES, CARPET OR SUBFLOORS.

**PROVIDE CLEARANCE FOR SPACERS** - IF THE INSTALLATION VEHICLE CONTAINS A CARPET OR SUBFLOOR, USE A 1-3/16" DIAMETER CARPET CUTTER (P/N: 31183-0) AT ALL MOUNTING LOCATIONS TO OPEN UP ROOM FOR SPACERS.

**CHECK SPACER ORIENTATION** - BE SURE THAT THE INDENT IN THE SPACER COVERS THE PLUSNUT HEAD; THIS ENSURES THE MOST METAL-TO-METAL CONTACT AND REDUCES VIBRATION.

**PLUSNUT INSTALLATION** - A PLUSNUT GUN IS RECOMMENDED FOR PLUSNUT INSTALLATION FOR ITS PRODUCTION SPEED. HOWEVER, A PLUSNUT SETTING TOOL CAN ALSO BE USED (P/N: 22200-0).

**THRU-BOLT CLEARANCE** - WHEN USING A THRU-BOLT AT ANY MOUNTING LOCATION, BE SURE THAT YOUR HOLE HAS 1/16" CLEARANCE.

**FASTENERS USED**

**FAS0858**  
**5/16-18X.63 SS**  
**FHH SCREW**  
**QTY: 8**

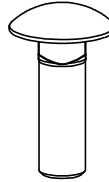

**FAS0398**  
**5/16-18X1.0 SS**  
**CRG BOLT**  
**QTY: 8**

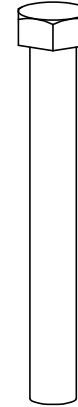

**FAS0243**  
**5/16-18X2.5 SS**  
**HH SCREW**  
**QTY: 4**



**FAS0857**  
**5/16 SS WASHER,**  
**LCK EXT CS**  
**QTY: 8**



**FAS0552**  
**5/16 SS**  
**FLAT WASHER**  
**QTY: 4**



**FAS0720**  
**3/8 SS**  
**FLAT WASHER**  
**QTY: 8**



**FAS0861**  
**5/16-18 SS**  
**HH FLG NUT**  
**QTY: 12**

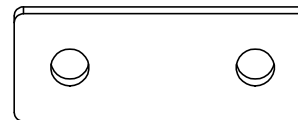

**68042**  
**PROFILE FOOT**  
**MOUNTING PLATE**  
**QTY: 4**

***INTENTIONALLY LEFT BLANK***

**STEP 1 - ASSEMBLE MOUNTING ARMS TO CROSSBOW****Step 1.1**  
**LOOSELY**  
**ASSEMBLE**

(2) FAS0857, (2)  
FAS0858, & 68042  
(2 PLACES PER  
CROSSBOW)  
3/16" ALLEN

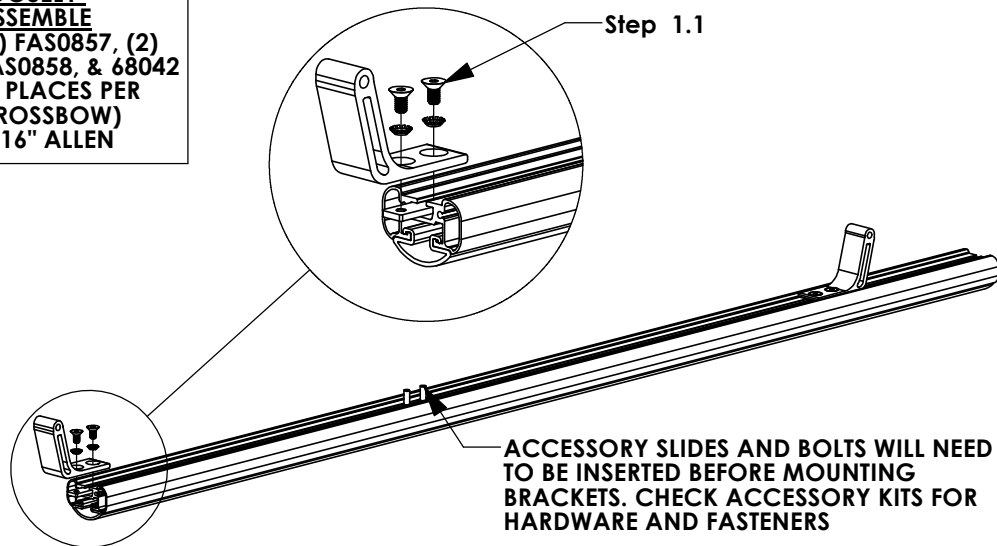
**STEP 2 - INSTALL MOUNTING BRACKETS TO VEHICLE ROOF**

**Step 2.1**  
**LOOSELY**  
**TIGHTEN UNTIL**  
**AFTER STEP 4**  
FAS0398,  
FAS0720,  
FAS0861  
(4 PLACES PER  
CROSSBOW)  
1/2" SOCKET

**Step 2.2**  
**USE OEM**  
**MOUNTING PIN**

**CROSSBOW POSITIONING NOTES:**  
REAR CROSSBOW - REAR OEM MOUNTING LOCATION  
FRONT CROSSBOW - POSITION TO BEST FIT END USER'S PRODUCT

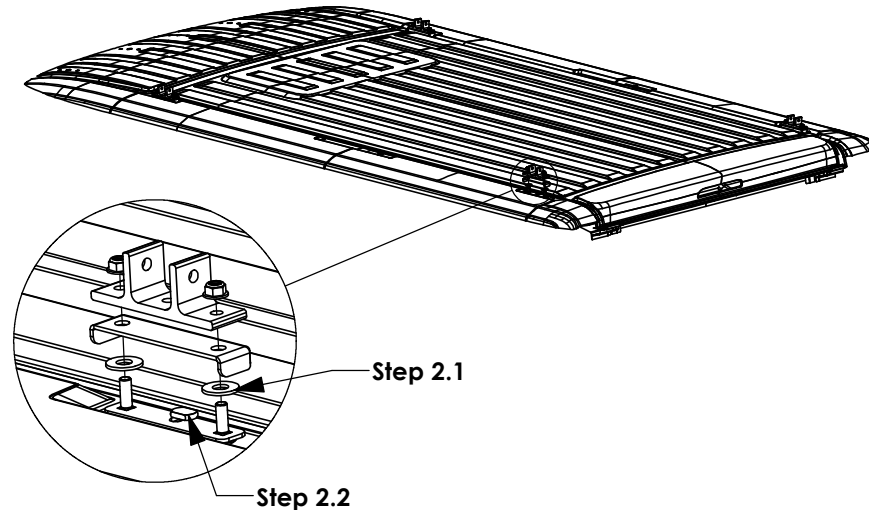

**STEP 3 - ATTACH CROSSBOW ASSEMBLY TO MOUNTING BRACKET**

**Step 3.1**  
**FULLY TIGHTEN**  
FAS0243, FAS0552,  
FAS0861  
(2 PLACES PER  
CROSSBOW)  
1/2" SOCKET  
1/2" WRENCH

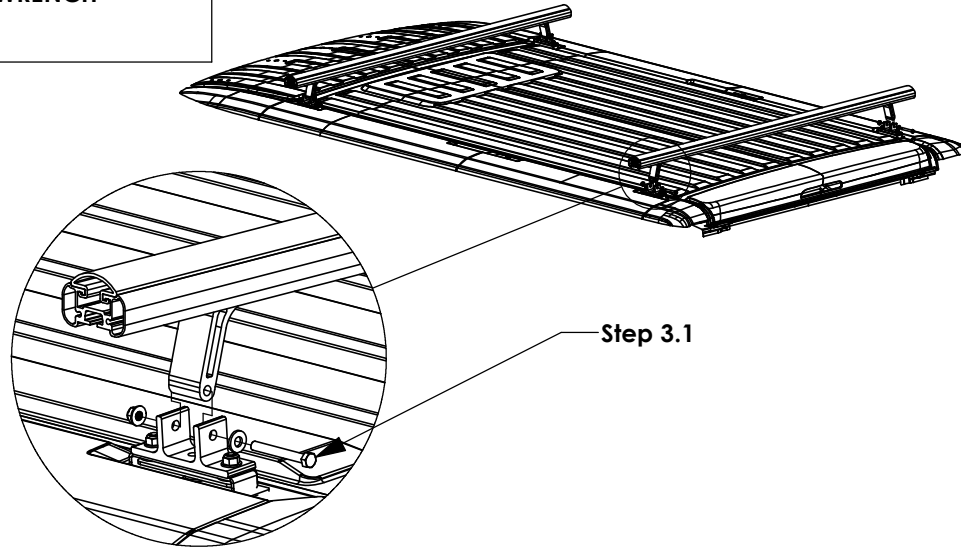
**STEP 4 - SECURE CROSSBOW**

**Step 4.1**  
**CENTER CROSSBOW**  
**AND**  
**SECURE MOUNTING**  
**BRACKETS**  
(4 PLACES PER  
CROSSBOW)  
3/16" ALLEN

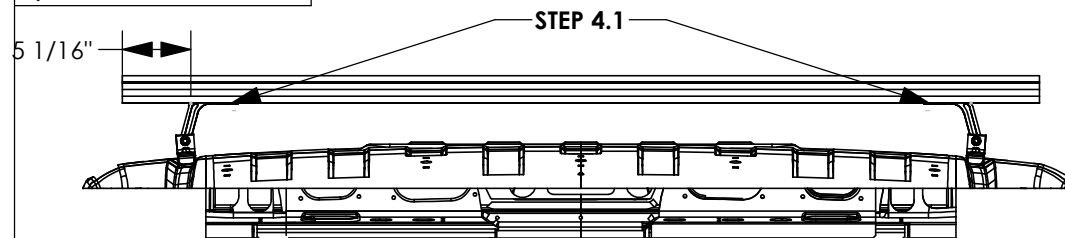





## Mounting Bracket Kit, 4-Pack, White, ProMaster

PRODUCT WEIGHT  
**5.3 LBS**

HEIGHT OFF ROOF  
**SEE TABLE BELOW**



CAPACITY  
**REFER TO OEM'S  
RECOMMENDED LOAD  
RATING**  
COLOR

**WHITE**

CATALOG NUMBER

**PMMBK4W**

### PRODUCT FEATURES

**Ram ProMaster aluminum mounting bracket kit (w/ stainless steel plates) for the PROFILE™ HD Utility Rack. Mounting kit works for both 118" and 136" wheelbase, low roof vehicles. Can be mounted to any OEM mounting locations to best fit customer's product.**

**Utility racks are not recommended for high roof vehicles!**

**Does not work with grip lock or drop down style racks.**

**SEE PAGE 2 FOR APPLICATION NOTES AND ACCESSORIES, OTHER PRODUCTS THAT WORK WITH THIS UNIT.**



## CATALOG NUMBER **PMMBK4W**

### PRODUCT APPLICATION

**This product is designed to be installed on Ram ProMaster vans. HD Utility Racks are not recommended for high roof vehicles!**

### ACCESSORIES THAT WILL WORK WITH THIS PRODUCT

CATALOG NUMBER	DESCRIPTION	CATALOG NUMBER	DESCRIPTION
PMMBK2W	Mounting Bracket Kit, 2-Pack, White, ProMaster	4UPK4B	4" Upright Kit, 4-Pack, Black
2BARW	2-Crossbar Kit, 68", White, Full Size Van	4UPK2B	4" Upright Kit, 2-Pack, Black
1BARW	Single Crossbar Kit, 68", White, Full Size Van	6UPK4B	6" Upright Kit, 4-Pack, Black
RRBPMW	Rear Roller Assist Bar, White, ProMaster	6UPK2B	6" Upright Kit, 2-Pack, Black
70-1NGLR	4" End Cap for PVC Conduit	9UPK4B	9" Upright Kit, 4-Pack, Black
70-2NGLR	6" End Cap for PVC Conduit	9UPK2B	9" Upright Kit, 2-Pack, Black
80-1NGLR	Conduit Kit, 10w x 6h x 126d, Multiple Vehicles	RSK1B	Single Ratchet Upright Kit, 9"
80-2NGLR	Conduit Kit, 10w x 6h x 150d, Multiple Vehicles	ULSKB	Single Ladder Stop Kit

### LADDER RACK HEIGHTS MEASURED FROM ROOF OF VEHICLE

CONFIGURATION	RACK HEIGHT
Base Rack	5"
Base + Ladder Stop	10.5"
Base + 4" Uprights	8.5"
Base + 6" Uprights	10.5"
Base + 9"/Ratchet Uprights	13.5"
Base + 4" PVC Conduit Kit	9.4"
Base + 6" PVC Conduit Kit	11.4"
Base + Aluminum Box Conduit Kit	11.5"



## Rear Roller Assist Bar, White, ProMaster

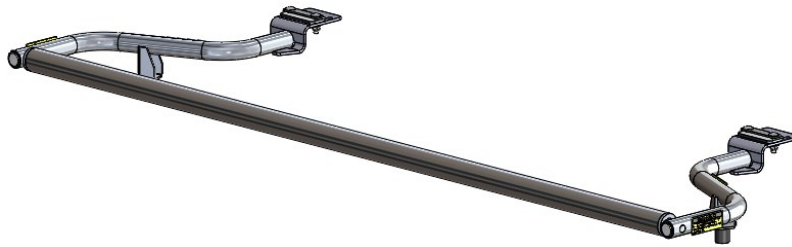

PRODUCT WEIGHT  
**7.4 LBS**

WIDTH x DEPTH x HEIGHT  
**65.3" x 21" x 4.6"**

CAPACITY  
**250 LBS**

COLOR  
**WHITE**

CATALOG NUMBER  
**RRBPMW**

### PRODUCT FEATURES

Aluminum rear roller assist kit for Ram ProMaster PROFILE™ HD Utility Racks. Works with all upright kits and conduit kits. Does NOT work with Ram ProMaster specific rail kit.

Utility style ladder racks are not recommended for high roof vehicles!

Please refer to OEM specific mounting kit and rail kit for additional information on compatible accessories.

**SEE PAGE 2 FOR APPLICATION NOTES AND ACCESSORIES, OTHER PRODUCTS THAT WORK WITH THIS UNIT.**

### PAGE 1 of 2

The information contained in this document is the sole property of ADRIAN STEEL COMPANY. ADRIAN STEEL COMPANY retains the right to modify and/or change the product of its design at any time without prior notification.



**CATALOG NUMBER      RRBPMW**

***PRODUCT APPLICATION***

**This product is for Ram ProMaster PROFILE™ HD Utility Racks. Does NOT work with Ram ProMaster rail kit. Utility style ladder racks are not recommended for high roof vehicles!**

***ACCESSORIES THAT WILL WORK WITH THIS PRODUCT***

<b><i>CATALOG NUMBER</i></b>	<b><i>DESCRIPTION</i></b>
<b>2BARW</b>	<b>2-Crossbar Kit, 68", White, Full Size Van</b>
<b>PMMBK4W</b>	<b>Mounting Bracket Kit, 4-Pack, White, ProMaster</b>

<i>INSTR. NUMBER</i> : <b>64955</b>		<i>PG:</i> <b>1</b>	<i>REV:</i> <b>B</b>	ITEM NO.	PART NUMBER	DESCRIPTION	
<i>PART NUMBER</i> : <b>RRBPMW</b>  <i>PART DESC.</i> : UTILITY, REAR ROLLER, PM, W				1	64174	REAR ROLLER, BAR ASSM, 62"	1
				2	64161-W	REAR ROLLER, DS WELD, PM, W	1
				3	64162-W	REAR ROLLER, PS WELD, PM, W	1

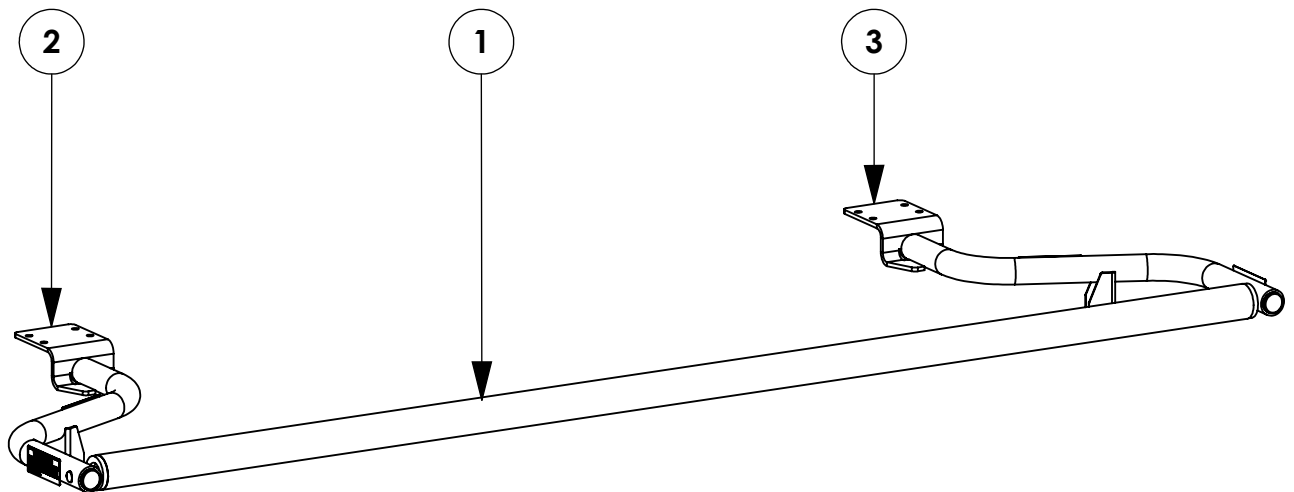

**GET TO KNOW THE VEHICLE** - AT THE BEGINNING OF ANY INSTALLATION, CHECK THE LOCATION OF THE FUEL TANK, FUEL LINES, BRAKE LINES, HIGH VOLTAGE BATTERIES AND WIRING HARNESSSES TO AVOID INJURY OR PROPERTY DAMAGE FROM TOOL CONTACT.

**SEAL ALL EXTERIOR HOLES** - ALL INSTALLATION HOLES SHOULD BE SEALED WITH BUTYL TAPE OR SILICON TO PREVENT WATER AND EXHAUST GASES FROM ENTERING THE VEHICLE.

**CONTROL DRILL DEPTH** - TO AVOID DAMAGE TO THE VEHICLE, USE A DRILL STOP OR CLEARED STEP BIT WHEN DRILLING INSTALLATION HOLES.

**ALWAYS ADD PRIMER** - WHEN ADDING INSTALLATION HOLES BE SURE TO USE A SELF-ETCHING PRIMER TO PREVENT CORROSION, FASTENER FAILURE AND INJURY.

**MOUNTING POINTS MUST HAVE METAL-TO-METAL CONTACT** - USE PROVIDED MOUNTING SPACERS TO ACCOMMODATE FOR VEHICLE FEATURES, CARPET OR SUBFLOORS.

**PROVIDE CLEARANCE FOR SPACERS** - IF THE INSTALLATION VEHICLE CONTAINS A CARPET OR SUBFLOOR, USE A 1-3/16" DIAMETER CARPET CUTTER (P/N: 31183-0) AT ALL MOUNTING LOCATIONS TO OPEN UP ROOM FOR SPACERS.

**CHECK SPACER ORIENTATION** - BE SURE THAT THE INDENT IN THE SPACER COVERS THE PLUSNUT HEAD; THIS ENSURES THE MOST METAL-TO-METAL CONTACT AND REDUCES VIBRATION.

**PLUSNUT INSTALLATION** - A PLUSNUT GUN IS RECOMMENDED FOR PLUSNUT INSTALLATION FOR ITS PRODUCTION SPEED. HOWEVER, A PLUSNUT SETTING TOOL CAN ALSO BE USED (P/N: 22200-0).

**THRU-BOLT CLEARANCE** - WHEN USING A THRU-BOLT AT ANY MOUNTING LOCATION, BE SURE THAT YOUR HOLE HAS 1/16" CLEARANCE.

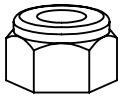
**FASTENERS USED**

**FAS0248**  
**5/16-18 SS**  
**NLK HEX NUT**  
**QTY: 4**



**FAS0552**  
**5/16 SS**  
**FLAT WASHER**  
**QTY: 4**

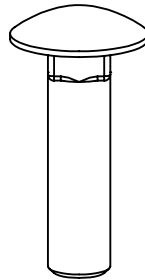

**FAS0812**  
**5/16-18X1.25 SS**  
**CRG BOLT**  
**QTY: 4**

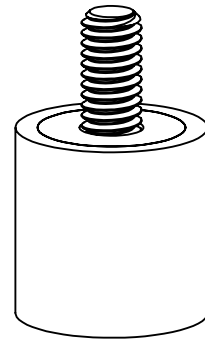

**56098**  
**1 X 1**  
**BUMPER STUD**  
**QTY: 2**

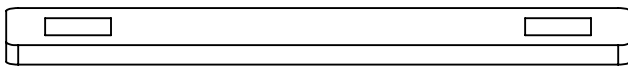

**64830**  
**REAR ROLLER**  
**BOLT PLATE**  
**QTY: 2**

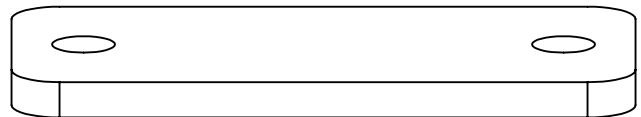

**64831**  
**REAR ROLLER**  
**SPACER**  
**QTY: 2**

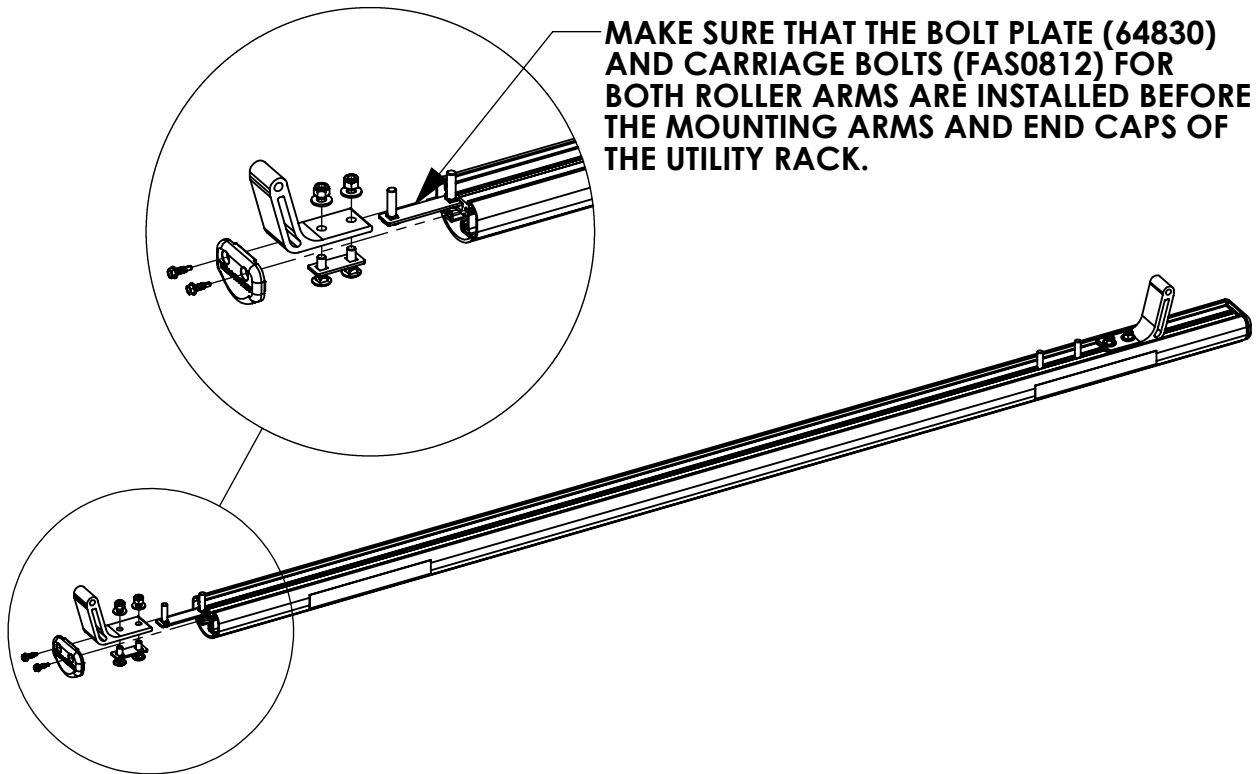
**BEGIN ASSEMBLY****STEP 1 - ATTACH ROLLER ARMS TO CROSSBOW****STEP 2 - ADD ROLLER BAR & SECURE**

ADD 56098 TO EACH ROLLER ARM

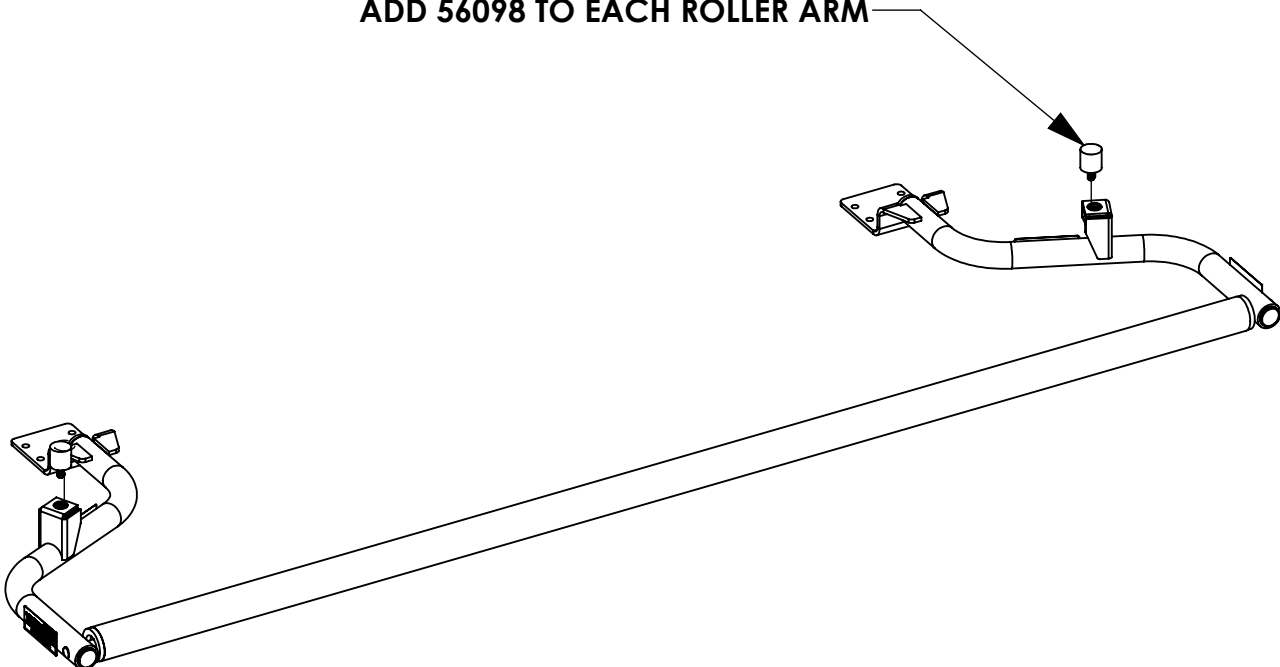



**BEGIN INSTALL**  
**STEP 3 - ATTACH ROLLER ARMS TO CROSSBOW**

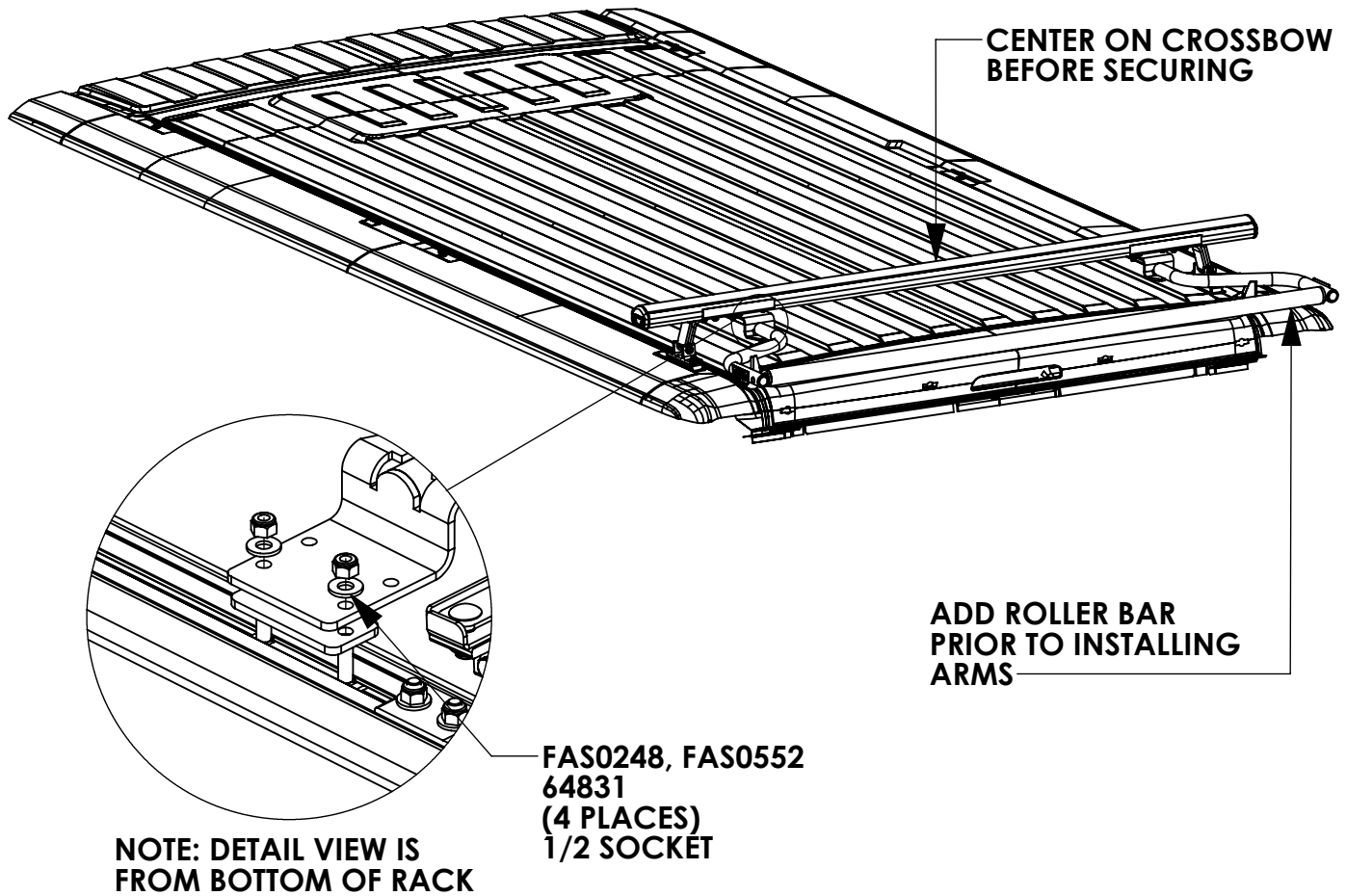

**ENSURE THE RUBBER BUMPERS SIT AS FAR INBOARD IN THE VEHICLE ROOF TROUGH BEFORE FULLY TIGHTENING!**

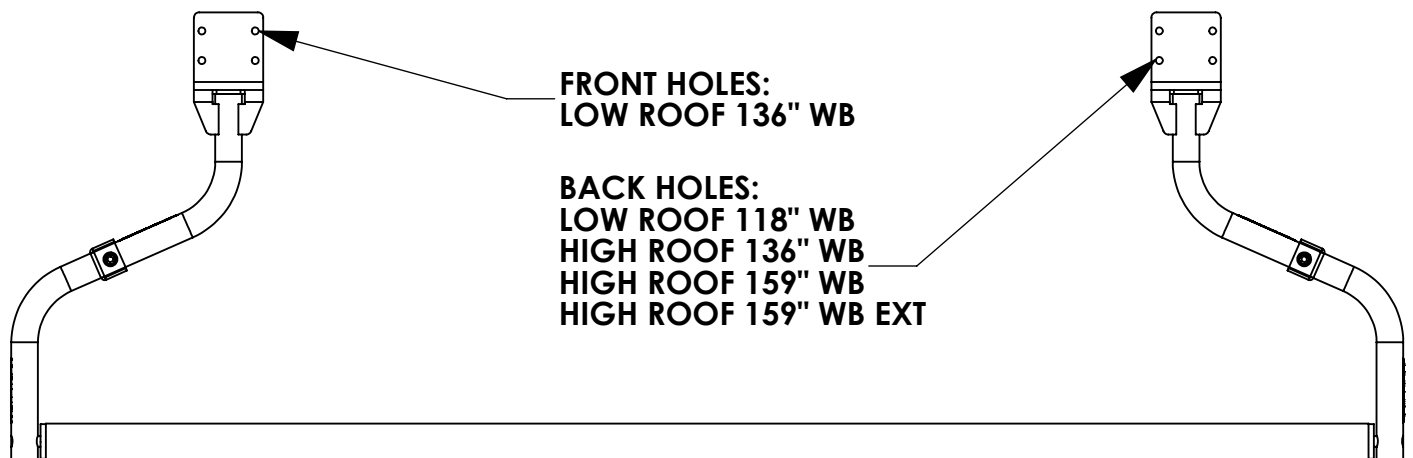

## Single Ladder Stop Kit

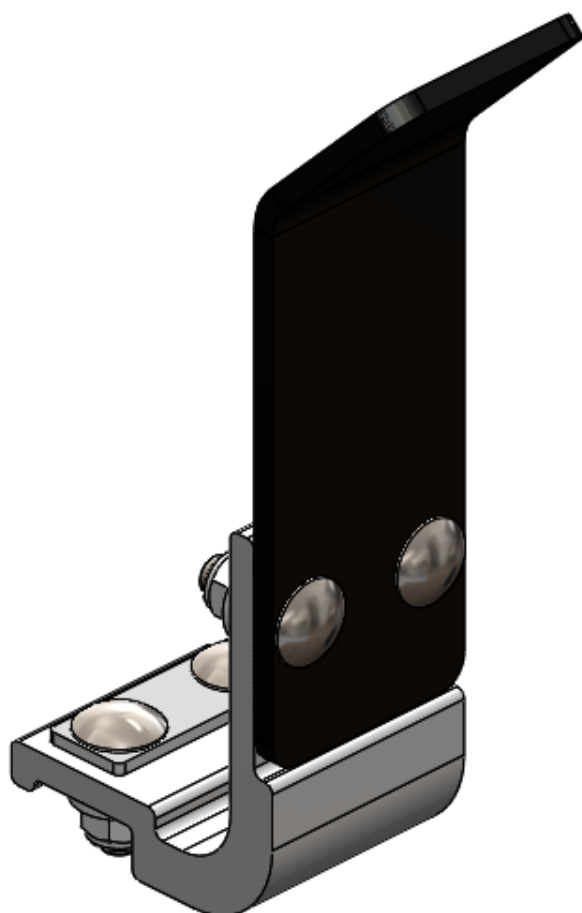

PRODUCT WEIGHT  
**1.3 LBS**

WIDTH x DEPTH x HEIGHT  
**2" x 1.8" x 6.3"**

CAPACITY  
**N/A**

COLOR  
**BLACK**

CATALOG NUMBER  
**ULSKB**

### PRODUCT FEATURES

Aluminum ladder stop kit with plastisol coating for PROFILE™ HD Utility and combo ladder racks. Works on all vehicle platforms. Works with all upright kits, conduit kits, and rear rollers.

Utility style ladder racks are not recommended for medium and high roof vehicles!

Please refer to OEM specific mounting kit and rail kit for additional information on compatible accessories.

**SEE PAGE 2 FOR APPLICATION NOTES AND ACCESSORIES, OTHER PRODUCTS THAT WORK WITH THIS UNIT.**

### PAGE 1 of 2

The information contained in this document is the sole property of ADRIAN STEEL COMPANY. ADRIAN STEEL COMPANY retains the right to modify and/or change the product of its design at any time without prior notification.



**CATALOG NUMBER      ULSKB**

***PRODUCT APPLICATION***

**This product is for PROFILE™ HD Utility and combo ladder racks.  
Works on all vehicle platforms. Utility style ladder racks are not  
recommended for medium or high roof vehicles!**

***ACCESSORIES THAT WILL WORK WITH THIS PRODUCT***

<b><i>CATALOG NUMBER</i></b>	<b><i>DESCRIPTION</i></b>
<b>2BARW</b>	<b>2-Crossbar Kit, 68", White, Full Size Van</b>
<b>2BARCW</b>	<b>2-Crossbar Kit, 58", White, Minivan</b>
<b>1BARW</b>	<b>Single Crossbar Kit, 68", White, Full Size Van</b>
<b>1BARCW</b>	<b>Single Crossbar Kit, 58", White, Minivan</b>

<i>INSTR. NUMBER</i> : <b>64337</b>	<i>PG:</i> <b>1</b>	<i>REV:</i> <b>C</b>	ITEM NO.	PART NUMBER	DESCRIPTION	QTY.
			1	63854-W	UTILITY,CONNECTING BRKT,W	1
			2	63850-B	UTILITY, LADDER STOP, B	1
<i>PART NUMBER</i> : <b>ULSKB</b>						
<i>PART DESC.</i> : UTILITY, LADDER STOP KIT						

**NOTE: THIS INSTRUCTION  
IS INTENDED TO BE USED  
WITH THE #BARW OR  
#BARCW UTILITY RACKS.**

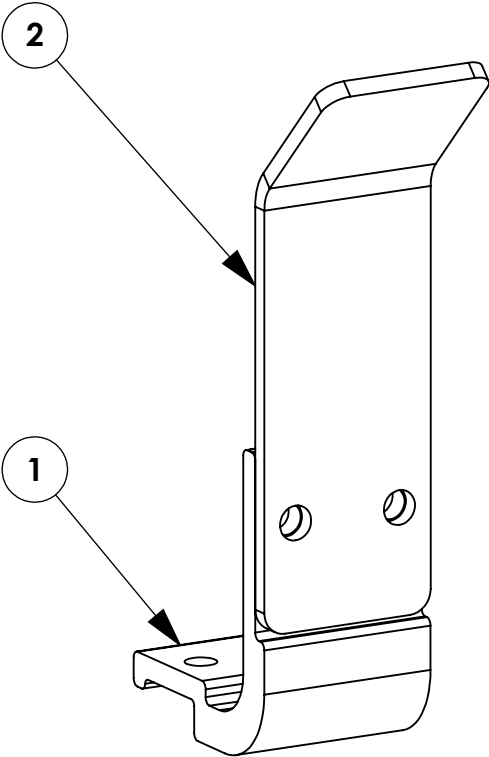

**GET TO KNOW THE VEHICLE** - AT THE BEGINNING OF ANY INSTALLATION, CHECK THE LOCATION OF THE FUEL TANK, FUEL LINES, BRAKE LINES, HIGH VOLTAGE BATTERIES AND WIRING HARNESSSES TO AVOID INJURY OR PROPERTY DAMAGE FROM TOOL CONTACT.

**SEAL ALL EXTERIOR HOLES** - ALL INSTALLATION HOLES SHOULD BE SEALED WITH BUTYL TAPE OR SILICON TO PREVENT WATER AND EXHAUST GASES FROM ENTERING THE VEHICLE.

**CONTROL DRILL DEPTH** - TO AVOID DAMAGE TO THE VEHICLE, USE A DRILL STOP OR CLEARED STEP BIT WHEN DRILLING INSTALLATION HOLES.

**ALWAYS ADD PRIMER** - WHEN ADDING INSTALLATION HOLES BE SURE TO USE A SELF-ETCHING PRIMER TO PREVENT CORROSION, FASTENER FAILURE AND INJURY.

**MOUNTING POINTS MUST HAVE METAL-TO-METAL CONTACT** - USE PROVIDED MOUNTING SPACERS TO ACCOMMODATE FOR VEHICLE FEATURES, CARPET OR SUBFLOORS.

**PROVIDE CLEARANCE FOR SPACERS** - IF THE INSTALLATION VEHICLE CONTAINS A CARPET OR SUBFLOOR, USE A 1-3/16" DIAMETER CARPET CUTTER (P/N: 31183-0) AT ALL MOUNTING LOCATIONS TO OPEN UP ROOM FOR SPACERS.

**CHECK SPACER ORIENTATION** - BE SURE THAT THE INDENT IN THE SPACER COVERS THE PLUSNUT HEAD; THIS ENSURES THE MOST METAL-TO-METAL CONTACT AND REDUCES VIBRATION.

**PLUSNUT INSTALLATION** - A PLUSNUT GUN IS RECOMMENDED FOR PLUSNUT INSTALLATION FOR ITS PRODUCTION SPEED. HOWEVER, A PLUSNUT SETTING TOOL CAN ALSO BE USED (P/N: 22200-0).

**THRU-BOLT CLEARANCE** - WHEN USING A THRU-BOLT AT ANY MOUNTING LOCATION, BE SURE THAT YOUR HOLE HAS 1/16" CLEARANCE.

***FASTENERS USED***



**FAS0248  
5/16-18 SS  
NLK HEX NUT  
QTY: 4**

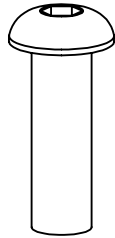

**FAS0813  
5/16-18X1.0 SS  
BHCS SCREW  
QTY: 4**



**FAS0552  
5/16 SS  
FLAT WASHER  
QTY: 4**

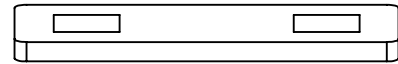

**63934  
UTILITY,  
BOLT PLATE  
QTY: 1**

**BEGIN ASSEMBLY**  
**STEP 1 - ASSEMBLE BRACKET**

(2)FAS0813, (4)FAS0552,  
(2)FAS0248  
1/2 SOCKET  
3/16 HEX DRIVE

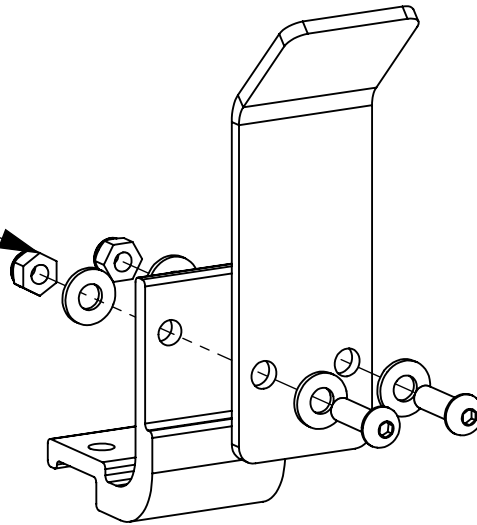

**BEGIN INSTALLATION**  
**STEP 2 - INSTALL BRACKET**

(2)FAS0398, 63934  
(2)FAS0552, (2)FAS0248  
1/2 SOCKET

**MAKE SURE THE LADDER  
STOP IS BETWEEN THE  
CARRIAGE BOLT AND  
PLATE ASSEMBLY FOR  
EACH MOUNTING  
BRACKET.**

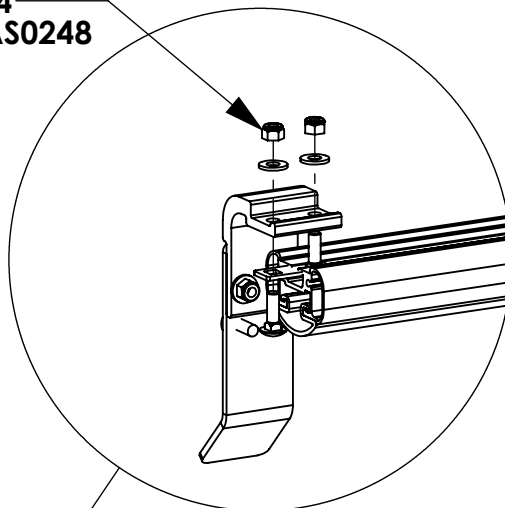

**ADJUST LADDER STOP TO BE  
IN THE CENTER OF CARGO**

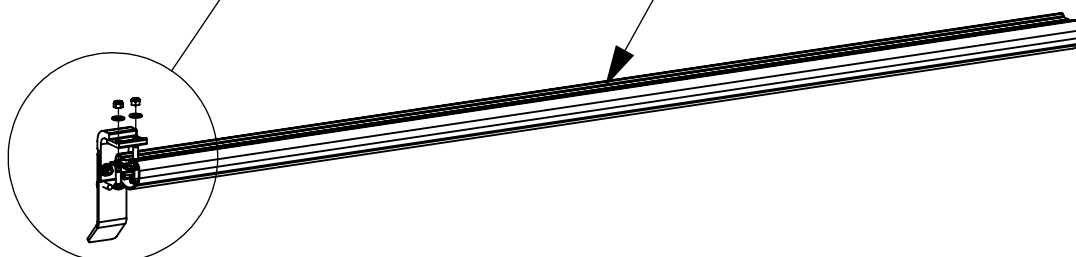



## Single Crossbar Kit, 68", White, Full Size Van



PRODUCT WEIGHT  
**9.6 LBS**

CROSSBOW LENGTH X  
HEIGHT  
**69" x 2"**

CAPACITY  
**REFER TO OEM'S  
RECOMMENDED LOAD  
RATING**

COLOR

**WHITE**

CATALOG NUMBER

**1BARW**

### PRODUCT FEATURES

Aluminum base 1-crossbow kit for PROFILE™ HD Utility, grip lock, drop down, or combo ladder racks for 3+Bar racks. Works with all full size van platforms for each respective wheelbase and roof height combination. Works with and without OEM specific rail kit and generic mounting bracket kits.

Optional uprights, conduit kits, and rear rollers available.

Utility and grip lock ladder racks are not recommended for medium and high roof vehicles!

Please refer to OEM specific mounting kit or rail kit for additional information on compatible accessories.



# INSTALLATION GUIDE FOR PROFILE™ SERIES LADDER RACKS

INSTRUCTION #:  
**68895**

REV:  
**C**



THIS INSTRUCTION PROVIDES A GENERAL GUIDE OF INSTALLATION SEQUENCE FOR ALL PROFILE™ SERIES LADDER RACKS. PLEASE ENSURE ALL ACCESSORIES ARE INSTALLED PER TYPE OF RACK BEFORE PROCEEDING TO NEXT PAGE.

REFERENCE THIS INSTRUCTION THROUGHOUT THE ENTIRETY OF YOUR INSTALL TO PREVENT ACCESSORIES BEING INSTALLED INCORRECTLY/OUT OF SEQUENCE!

**STEPS 2T - 8T ON PAGE 3 IS THE RECOMMENDED ASSEMBLY SEQUENCE FOR A FULL TABLE ASSEMBLY BEFORE INSTALLING ON THE ROOF OF THE VEHICLE.**

**STEPS 2R - 8R ON PAGE 4 IS AN ALTERNATE ASSEMBLY SEQUENCE TO INSTALL THE RACK ON THE VEHICLE ROOF AS IT IS BUILT.**

PLEASE SELECT THE ASSEMBLY SEQUENCE THAT BEST WORKS FOR YOU!

## ASSEMBLY STEPS:

**STEP 1A. SUB-ASSEMBLE EACH CROSSBOW WITH DESIRED ACCESSORIES FOR SECTIONS A.1 & A.2.**

**INSTRUCTIONS FOR EACH KIT CAN BE FOUND IN THEIR RESPECTIVE CARTON!**

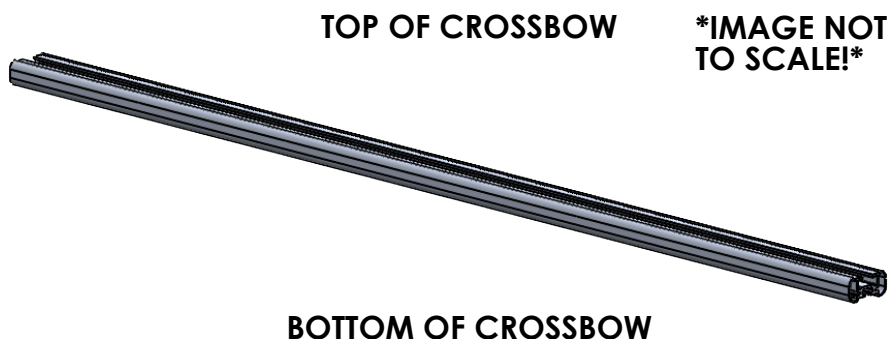

## TABLE 1

### TOP OF CROSSBOW

#### COMPONENTS TO INSTALL

A.1	HD UTILITY	- CONDUIT KIT OR BEACON
	Grip-Lock	- CONDUIT KIT OR BEACON
	ProLift	- CONDUIT KIT OR BEACON

### BOTTOM OF CROSSBOW

#### COMPONENTS TO INSTALL

A.2	HD UTILITY	- LADDER STOP, STROBE BRACKET, AND/OR REAR ROLLER
	Grip-Lock	- Grip-Lock SUB-ASSEMBLY
	ProLift	- DAMPER BRACKET

**STEP 1B. SUB-ASSEMBLE EACH CROSSBOW WITH DESIRED ACCESSORIES FOR SECTIONS B.1 & B.2.**

**INSTRUCTIONS FOR EACH KIT CAN BE FOUND IN THEIR RESPECTIVE CARTON!**

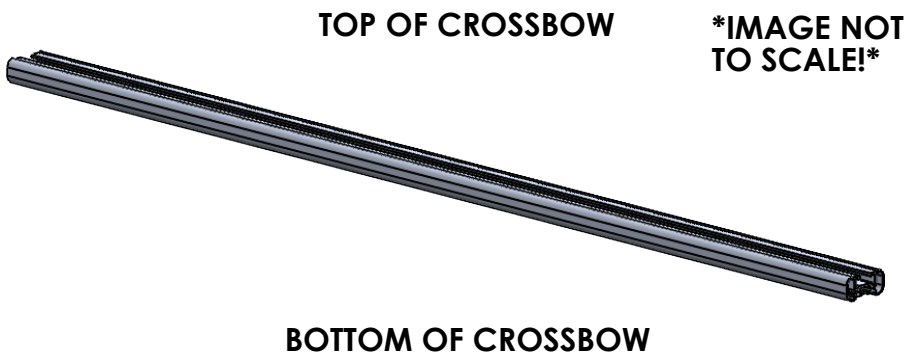

**TABLE 2**

TOP OF CROSSBOW		
	COMPONENTS TO INSTALL	
<b>B.1</b>	<u>HD UTILITY</u>	- WEAR STRIP (MODIFY IF NECESSARY, TABLE 3)
	<u>Grip-Lock</u>	- WEAR STRIP (MODIFY IF NECESSARY, TABLE 3)
	<u>ProLift</u>	- INNER STOP POST
BOTTOM OF CROSSBOW		
	COMPONENTS TO INSTALL	
<b>B.2</b>	<u>HD UTILITY</u>	- MOUNTING BRACKETS
	<u>Grip-Lock</u>	- MOUNTING BRACKETS
	<u>ProLift</u>	- MOUNTING BRACKETS

**ALTER WEAR STRIP AND INSTALL ON CROSSBOW (IF APPLICABLE)! REFERENCE TABLE 3 BELOW FOR WEAR STRIP ALTERATION INSTRUCTIONS!**

**TABLE 3**

ADDED ACCESSORIES	ALTERATION FOR WEAR STRIP
4" UPRIGHT***	REMOVE 2" FROM END OF WEAR STRIP
4" PVC CONDUIT KIT	REMOVE 7.25" FROM CENTER OF WEAR STRIP
6" PVC CONDUIT KIT	REMOVE 9.50" FROM CENTER OF WEAR STRIP
ALUMINUM BOX CONDUIT KIT	REMOVE 13.25" FROM CENTER OF WEAR STRIP
BEACON	REMOVE 4" FROM CENTER OF WEAR STRIP
ProLift (SINGLE SIDE)	CUT WEAR STRIP IN HALF, DO NOT INSTALL ON ProLift SIDE
ProLift (DUAL SIDE)	DO NOT INSTALL WEAR STRIP

**SLIDE WEAR STRIP INTO RAIL AND CENTER (1 PER CROSSBOW)**

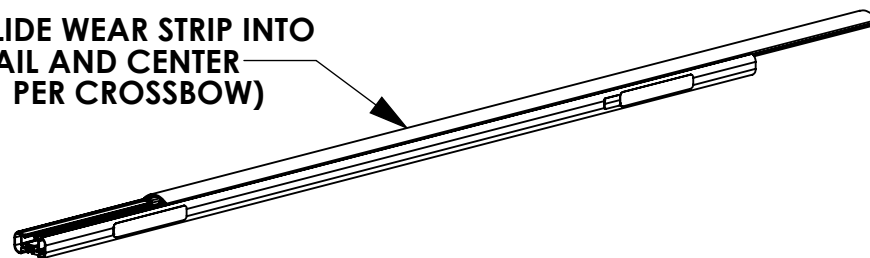

**SLIDE ONE SIDE OF WEAR STRIP INTO CROSSBOW, THEN ROLL OTHER SIDE TO SNAP STRIP INTO PLACE**



**STEP 1C SUB-ASSEMBLE EACH CROSSBOW WITH  
DESIRED ACCESSORIES FOR SECTIONS C.1 & C.2**

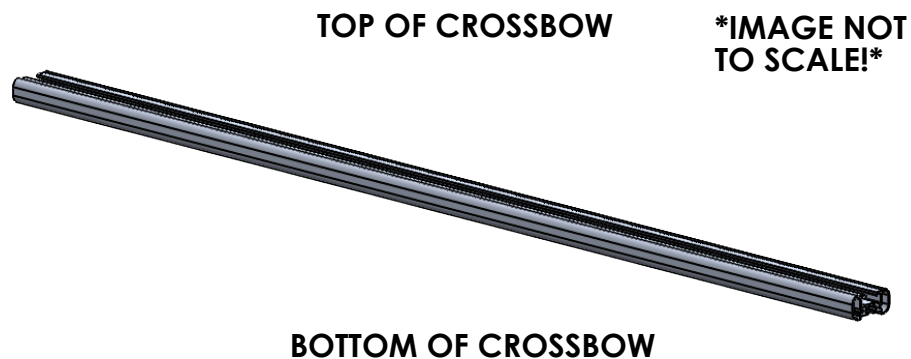

**TABLE 4**

TOP OF CROSSBOW		
	COMPONENTS TO INSTALL	
C.1	HD UTILITY	- 4" UPRIGHT
	Grip-Lock	- N/A
	ProLift	- SLIDES FOR BASE EXTRUSION
BOTTOM OF CROSSBOW		
	COMPONENTS TO INSTALL	
C.2	HD UTILITY	- UPRIGHTS (6", 9", RATCHET)
	Grip-Lock	- STROBES
	ProLift	- STROBES

**ASSEMBLY STEPS (FULL BENCH ASSEMBLY):**

- 2T. ADD DRIVELINES (IF INSTALLING ProLift)
- 3T. ADD HANDLES (IF INSTALLING Grip-Lock OR ProLift) AND DAMPERS (IF INSTALLING ProLift)
- 4T. ADD OUTER SUPPORT BARS (IF INSTALLING Grip-Lock OR ProLift)
- 5T. ADD STEP LADDER KIT (Grip-Lock OR ProLift ONLY!)

**6T. ASSEMBLE ENDS CAPS TO CROSSBOW**

USED FOR HD UTILITY &  
Grip-Lock RACKS

LOCATED IN CROSSBOW KIT

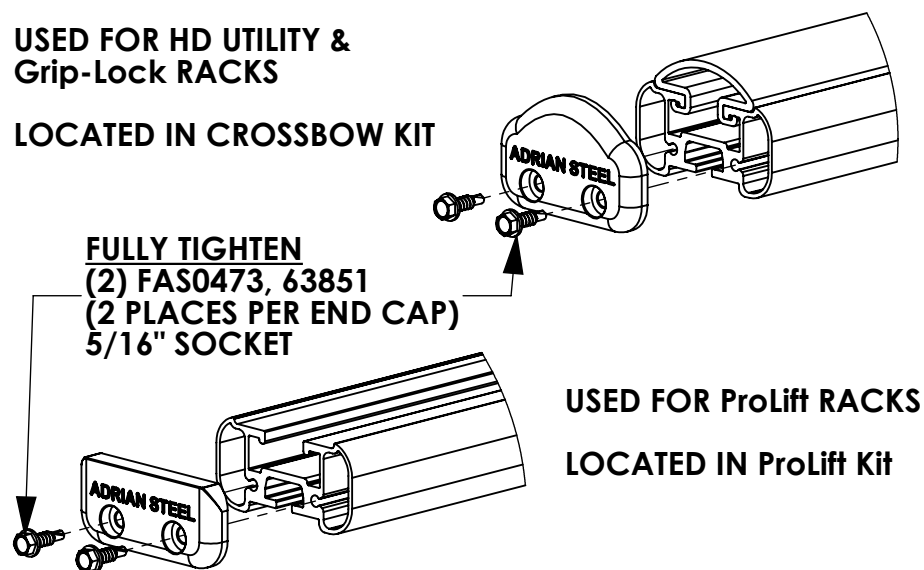

**FULLY TIGHTEN  
(2) FAS0473, 63851  
(2 PLACES PER END CAP)  
5/16" SOCKET**

USED FOR ProLift RACKS  
LOCATED IN ProLift Kit

**7T. INSTALL ROOF RAIL KIT ON VEHICLE ROOF OR BOTTOM MOUNTING BRACKETS**

(ROOF RAIL KIT REQUIRED FOR Grip-Lock & ProLift  
OPTIONAL FOR HD UTILITY, NOT NEEDED FOR GM LADDER  
RACKS)

**8T. MOUNT CROSSBOW SUB-ASSEMBLIES FROM STEP 1 TO  
VEHICLE/MOUNTING BRACKET, OR ROOF RAIL  
(LOOSE INSTALL)**

**ALTERNATE ASSEMBLY METHOD!**  
**(ASSEMBLE ON VEHICLE ROOF):**

2R. INSTALL ROOF RAIL KIT ON VEHICLE ROOF OR BOTTOM MOUNTING BRACKETS

(ROOF RAIL KIT REQUIRED FOR Grip-Lock & ProLift, OPTIONAL FOR HD UTILITY, NOT NEEDED FOR GM LADDER RACKS)

3R. MOUNT CROSSBOW SUB-ASSEMBLIES FROM STEP 1 TO VEHICLE/MOUNTING BRACKET, OR ROOF RAIL (LOOSE INSTALL)

4R. ADD DRIVELINES (IF INSTALLING ProLift)

5R. ADD HANDLES (IF INSTALLING Grip-Lock OR ProLift) AND DAMPERS (IF INSTALLING ProLift)

6R. ADD OUTER SUPPORT BARS (IF INSTALLING Grip-Lock OR ProLift)

7R. ADD STEP LADDER KIT (Grip-Lock OR ProLift ONLY!)

8R. ASSEMBLE END CAPS TO CROSSBOW

USED FOR HD UTILITY &  
Grip-Lock RACKS

LOCATED IN CROSSBOW KIT

FULLY TIGHTEN  
(2) FAS0473, 63851  
(2 PLACES PER END CAP)  
5/16" SOCKET

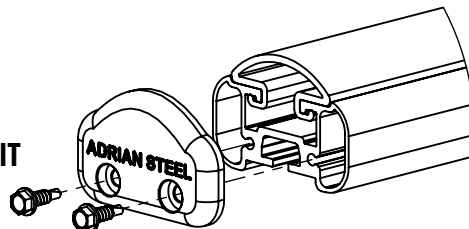

USED FOR ProLift RACKS  
LOCATED IN ProLift Kit

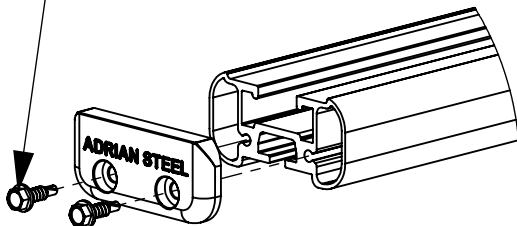



## 2-Crossbar Kit, 68", White, Full Size Van



PRODUCT WEIGHT  
**19 LBS**

CROSSBOW LENGTH X  
HEIGHT

**69" x 2"**

CAPACITY

**REFER TO OEM'S  
RECOMMENDED LOAD  
RATING**

COLOR

**WHITE**

CATALOG NUMBER

**2BARW**

### PRODUCT FEATURES

Aluminum base 2-crossbow kit for PROFILE™ HD Utility, grip lock, drop down, or combo ladder racks. Works with all full size van platforms for each respective wheelbase and roof height combination. Works with and without OEM specific rail kit and generic mounting bracket kits.

Additional crossbows and optional uprights, conduit kits, and rear rollers available.

Utility and grip lock ladder racks are not recommended for medium and high roof vehicles!

Please refer to OEM specific mounting kit or rail kit for additional information on compatible accessories.



## 6" Upright Kit, 2-Pack, Black

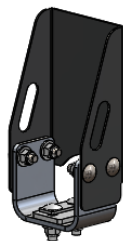

PRODUCT WEIGHT  
**4.6 LBS**

WIDTH x DEPTH x HEIGHT  
**3.8" x 2.3" x 6"**

CAPACITY  
**N/A**

COLOR  
**BLACK**

CATALOG NUMBER  
**6UPK2B**

### PRODUCT FEATURES

Galvannealed steel 6" uprights fully plastisol coated for PROFILE™ HD Utility and combo ladder racks. Works on all vehicle platforms. Works with all conduit kits and rear rollers.

Utility style ladder racks are not recommended for medium and high roof vehicles!

Please refer to OEM specific mounting kit and rail kit for additional information on compatible accessories.

**SEE PAGE 2 FOR APPLICATION NOTES AND ACCESSORIES, OTHER PRODUCTS THAT WORK WITH THIS UNIT.**

### PAGE 1 of 2

The information contained in this document is the sole property of ADRIAN STEEL COMPANY. ADRIAN STEEL COMPANY retains the right to modify and/or change the product of its design at any time without prior notification.



**CATALOG NUMBER      6UPK2B**

***PRODUCT APPLICATION***

**This product is for PROFILE™ HD Utility and combo ladder racks.  
Works on all vehicle platforms. Utility style ladder racks are not  
recommended for medium or high roof vehicles!**

***ACCESSORIES THAT WILL WORK WITH THIS PRODUCT***

<b><i>CATALOG NUMBER</i></b>	<b><i>DESCRIPTION</i></b>
<b>2BARW</b>	<b>2-Crossbar Kit, 68", White, Full Size Van</b>
<b>2BARCW</b>	<b>2-Crossbar Kit, 58", White, Minivan</b>
<b>1BARW</b>	<b>Single Crossbar Kit, 68", White, Full Size Van</b>
<b>1BARCW</b>	<b>Single Crossbar Kit, 58", White, Minivan</b>

<i>INSTR. NUMBER</i> : <b>65319</b>	<i>PG:</i> <b>1</b>	<i>REV:</i> <b>C</b>	ITEM NO.	PART NUMBER	DESCRIPTION	QTY.
			1	65120-W	UTILITY,UPR MOUNT BRKT,W	2
<i>PART NUMBER</i> • <b>6UPK2B</b> • <b>9UPK2B</b>			2	63848-B	UTILITY, UPRIGHT, 6", B	2
			<i>PART</i> • UTILITY,6" UPRIGHT KIT,2B <i>DESC.</i> • UTILITY,9" UPRIGHT KIT,2B			3*
4*	64060-B	UTILITY, UPRIGHT, 9", B				2

**NOTE: THIS INSTRUCTION IS VALID FOR THE FOLLOWING UPRIGHT KITS:**  
**6UPK2B (SHOWN)**  
**6UPK4B**  
**9UPK2B**  
**9UPK4B**

**ITEMS NOTED (#\*) ARE PART OF 9UPK2B**

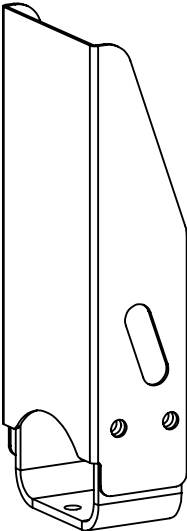
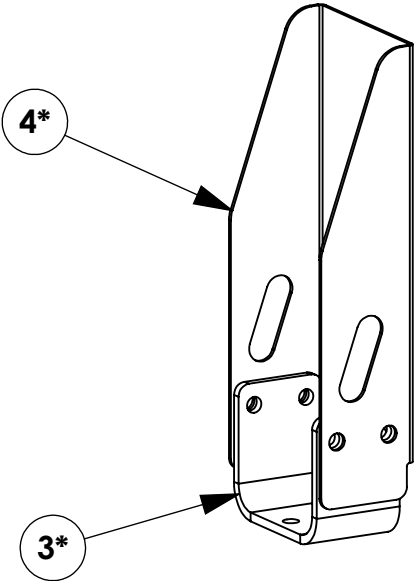
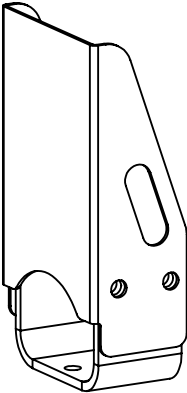
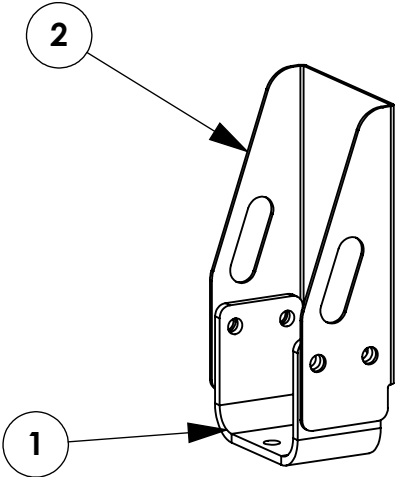



**GET TO KNOW THE VEHICLE** - AT THE BEGINNING OF ANY INSTALLATION, CHECK THE LOCATION OF THE FUEL TANK, FUEL LINES, BRAKE LINES, HIGH VOLTAGE BATTERIES AND WIRING HARNESSSES TO AVOID INJURY OR PROPERTY DAMAGE FROM TOOL CONTACT.

**SEAL ALL EXTERIOR HOLES** - ALL INSTALLATION HOLES SHOULD BE SEALED WITH BUTYL TAPE OR SILICON TO PREVENT WATER AND EXHAUST GASES FROM ENTERING THE VEHICLE.

**CONTROL DRILL DEPTH** - TO AVOID DAMAGE TO THE VEHICLE, USE A DRILL STOP OR CLEARED STEP BIT WHEN DRILLING INSTALLATION HOLES.

**ALWAYS ADD PRIMER** - WHEN ADDING INSTALLATION HOLES BE SURE TO USE A SELF-ETCHING PRIMER TO PREVENT CORROSION, FASTENER FAILURE AND INJURY.

**MOUNTING POINTS MUST HAVE METAL-TO-METAL CONTACT** - USE PROVIDED MOUNTING SPACERS TO ACCOMMODATE FOR VEHICLE FEATURES, CARPET OR SUBFLOORS.

**PROVIDE CLEARANCE FOR SPACERS** - IF THE INSTALLATION VEHICLE CONTAINS A CARPET OR SUBFLOOR, USE A 1-3/16" DIAMETER CARPET CUTTER (P/N: 31183-0) AT ALL MOUNTING LOCATIONS TO OPEN UP ROOM FOR SPACERS.

**CHECK SPACER ORIENTATION** - BE SURE THAT THE INDENT IN THE SPACER COVERS THE PLUSNUT HEAD; THIS ENSURES THE MOST METAL-TO-METAL CONTACT AND REDUCES VIBRATION.

**PLUSNUT INSTALLATION** - A PLUSNUT GUN IS RECOMMENDED FOR PLUSNUT INSTALLATION FOR ITS PRODUCTION SPEED. HOWEVER, A PLUSNUT SETTING TOOL CAN ALSO BE USED (P/N: 22200-0).

**THRU-BOLT CLEARANCE** - WHEN USING A THRU-BOLT AT ANY MOUNTING LOCATION, BE SURE THAT YOUR HOLE HAS 1/16" CLEARANCE.

**FASTENERS USED**

QUANTITIES ARE LISTED FOR 6UPK2B / 9UPK2B.  
QUANTITIES WILL VARY BASED ON NUMBER OF UPRIGHTS

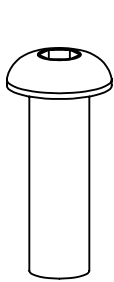

FAS0813  
5/16-18x1.0 SS  
BHCS SCREW  
QTY: 8

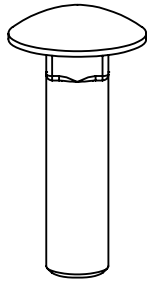

FAS0812  
5/16-18x1.25 SS  
CRG BOLT  
QTY: 4

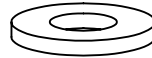

FAS0552  
5/16 SS  
FLAT WASHER  
QTY: 12

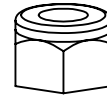

FAS0248  
5/16-18 SS  
NLK HEX NUT  
QTY: 12

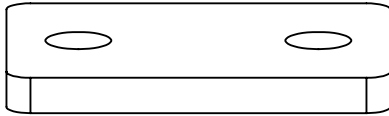

63933  
UTILITY,  
SPACER  
QTY: 2

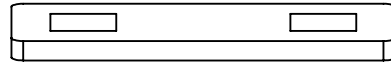

63934  
UTILITY,  
BOLT PLATE  
QTY: 2

## **BEGIN ASSEMBLY**

### **STEP 1 - ASSEMBLE UPRIGHTS**

FAS0813, (2) FAS0552,  
AND FAS0248  
(4 PLACES PER UPRIGHT)  
3/16 HEX DRIVE  
1/2 SOCKET

DRILL HOLES IN UPRIGHT  
WITH 11/32" DRILL BIT  
BEFORE ASSEMBLING!  
(4 PLACES PER UPRIGHT)

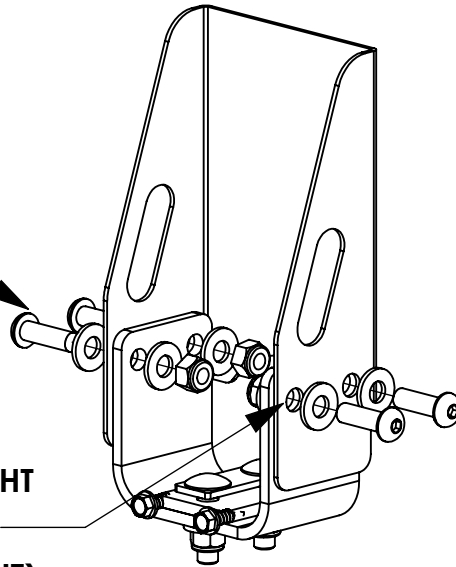

## **BEGIN INSTALLATION**

### **STEP 2 - INSTALL UPRIGHTS**

(2) FAS0812, (2) FAS0552,  
63933, 63934, & (2) FAS0248  
(PER UPRIGHT)  
1/2 SOCKET

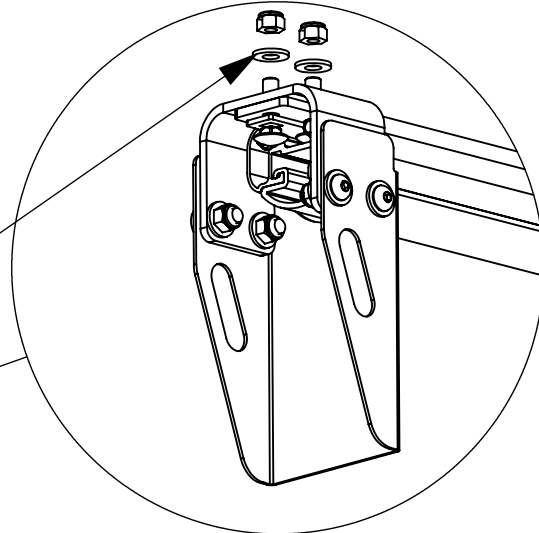

ALIGN UPRIGHT WITH  
EDGE OF CROSSBOW

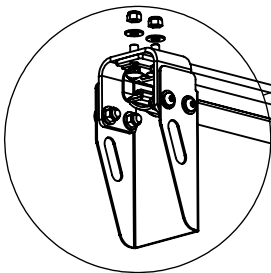

NOTE: CROSSBOW AND RATCHET UPRIGHT ASSEMBLY  
ARE SHOWN INVERTED FOR VISUAL PURPOSES

CONTINUE WITH INSTALLATION WITH THE MOUNTING KIT INSTRUCTIONS



## 6" Upright Kit, 4-Pack, Black

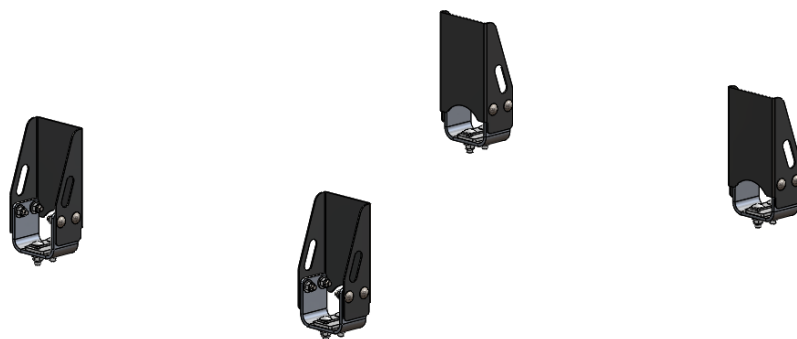

PRODUCT WEIGHT  
**9.3 LBS**

WIDTH x DEPTH x HEIGHT  
**3.8" x 2.3" x 6"**

CAPACITY  
**N/A**

COLOR  
**BLACK**

CATALOG NUMBER  
**6UPK4B**

### PRODUCT FEATURES

Galvannealed steel 6" uprights fully plastisol coated for PROFILE™ HD Utility and combo ladder racks. Works on all vehicle platforms. Works with all conduit kits and rear rollers.

Utility style ladder racks are not recommended for medium and high roof vehicles!

Please refer to OEM specific mounting kit and rail kit for additional information on compatible accessories.

**SEE PAGE 2 FOR APPLICATION NOTES AND ACCESSORIES, OTHER PRODUCTS THAT WORK WITH THIS UNIT.**

### PAGE 1 of 2

The information contained in this document is the sole property of ADRIAN STEEL COMPANY. ADRIAN STEEL COMPANY retains the right to modify and/or change the product of its design at any time without prior notification.



**CATALOG NUMBER      6UPK4B**

***PRODUCT APPLICATION***

**This product is for PROFILE™ HD Utility and combo ladder racks.  
Works on all vehicle platforms. Utility style ladder racks are not  
recommended for medium or high roof vehicles!**

***ACCESSORIES THAT WILL WORK WITH THIS PRODUCT***

<b><i>CATALOG NUMBER</i></b>	<b><i>DESCRIPTION</i></b>
<b>2BARW</b>	<b>2-Crossbar Kit, 68", White, Full Size Van</b>
<b>2BARCW</b>	<b>2-Crossbar Kit, 58", White, Minivan</b>
<b>1BARW</b>	<b>Single Crossbar Kit, 68", White, Full Size Van</b>
<b>1BARCW</b>	<b>Single Crossbar Kit, 58", White, Minivan</b>