

INSTR. : 65637 NUMBER		PG: 1	REV: A	ITEM NO.	PART NUMBER	DESCRIPTION	QTY.
PART : 2ACTR NUMBER				1	65440-G	TANK RACK, 2ACTR PANEL, GRAY	1
PART : DESC. : Tank Rack, 2-Acetylene Tanks				2	65461-G	TANK RACK, 2ACTR SHELF, GRAY	1
				3	HDW2ACTR	HARDWARE FOR 2ACTR	1

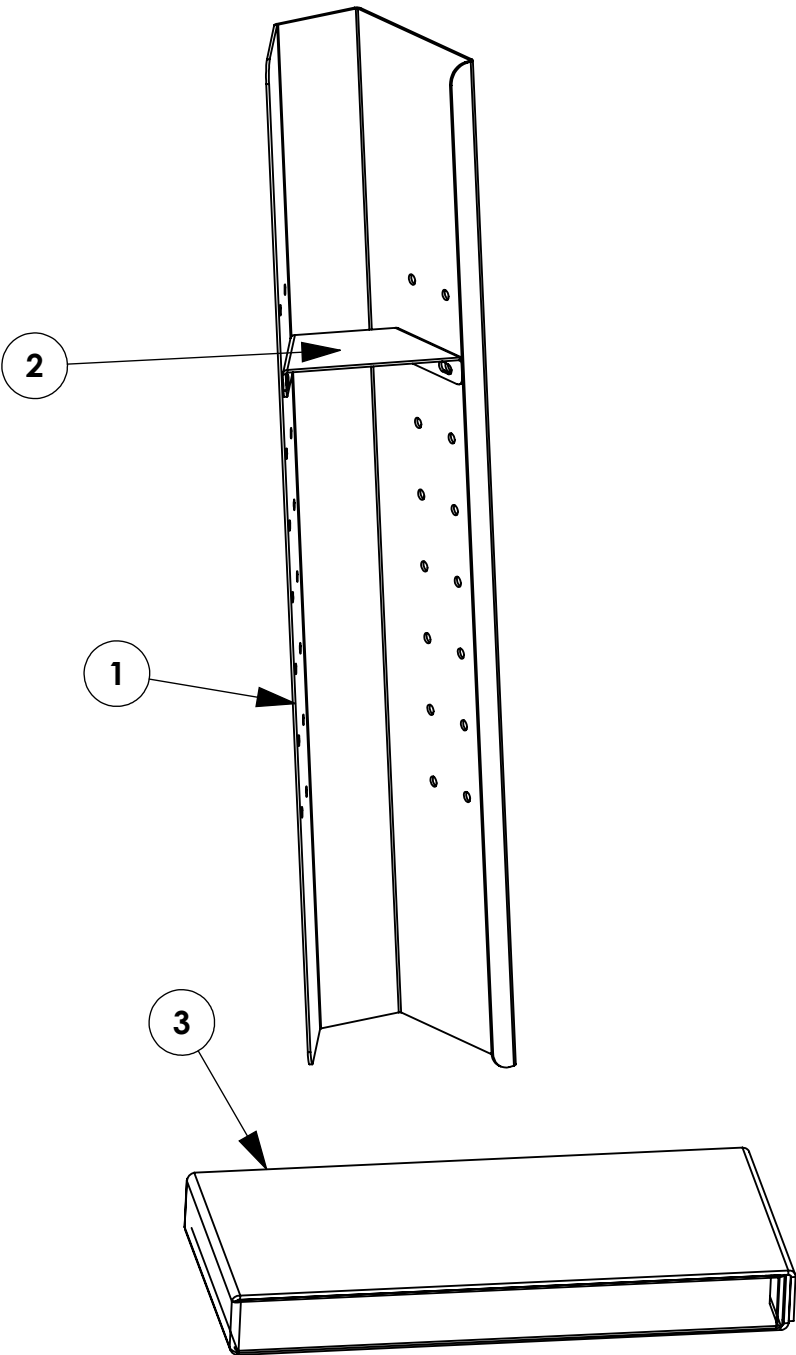

GET TO KNOW THE VEHICLE - AT THE BEGINNING OF ANY INSTALLATION, CHECK THE LOCATION OF THE FUEL TANK, FUEL LINES, BRAKE LINES, HIGH VOLTAGE BATTERIES AND WIRING HARNESSSES TO AVOID INJURY OR PROPERTY DAMAGE FROM TOOL CONTACT.

SEAL ALL EXTERIOR HOLES - ALL INSTALLATION HOLES SHOULD BE SEALED WITH BUTYL TAPE OR SILICON TO PREVENT WATER AND EXHAUST GASES FROM ENTERING THE VEHICLE.

CONTROL DRILL DEPTH - TO AVOID DAMAGE TO THE VEHICLE, USE A DRILL STOP OR CLEARED STEP BIT WHEN DRILLING INSTALLATION HOLES.

ALWAYS ADD PRIMER - WHEN ADDING INSTALLATION HOLES BE SURE TO USE A SELF-ETCHING PRIMER TO PREVENT CORROSION, FASTENER FAILURE AND INJURY.

MOUNTING POINTS MUST HAVE METAL-TO-METAL CONTACT - USE PROVIDED MOUNTING SPACERS TO ACCOMMODATE FOR VEHICLE FEATURES, CARPET OR SUBFLOORS.

PROVIDE CLEARANCE FOR SPACERS - IF THE INSTALLATION VEHICLE CONTAINS A CARPET OR SUBFLOOR, USE A 1-3/16" DIAMETER CARPET CUTTER (P/N: 31183-0) AT ALL MOUNTING LOCATIONS TO OPEN UP ROOM FOR SPACERS.

CHECK SPACER ORIENTATION - BE SURE THAT THE INDENT IN THE SPACER COVERS THE PLUSNUT HEAD; THIS ENSURES THE MOST METAL-TO-METAL CONTACT AND REDUCES VIBRATION.

PLUSNUT INSTALLATION - A PLUSNUT GUN IS RECOMMENDED FOR PLUSNUT INSTALLATION FOR ITS PRODUCTION SPEED. HOWEVER, A PLUSNUT SETTING TOOL CAN ALSO BE USED (P/N: 22200-0).

THRU-BOLT CLEARANCE - WHEN USING A THRU-BOLT AT ANY MOUNTING LOCATION, BE SURE THAT YOUR HOLE HAS 1/16" CLEARANCE.

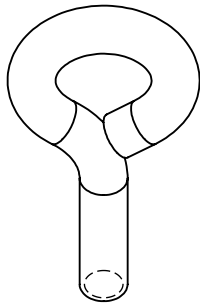
FASTENERS USED

FAS0050
1/4-20X.5X.88
ZP EYEBOLT
QTY: 4

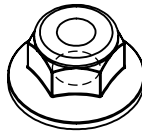

FAS0055
1/4-20 ZP
NUT, HEX NLK FLG
QTY: 14

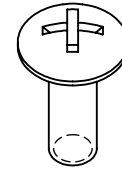

FAS0062
1/4-20X.75 G5ZP
SCREW, THP
QTY: 10

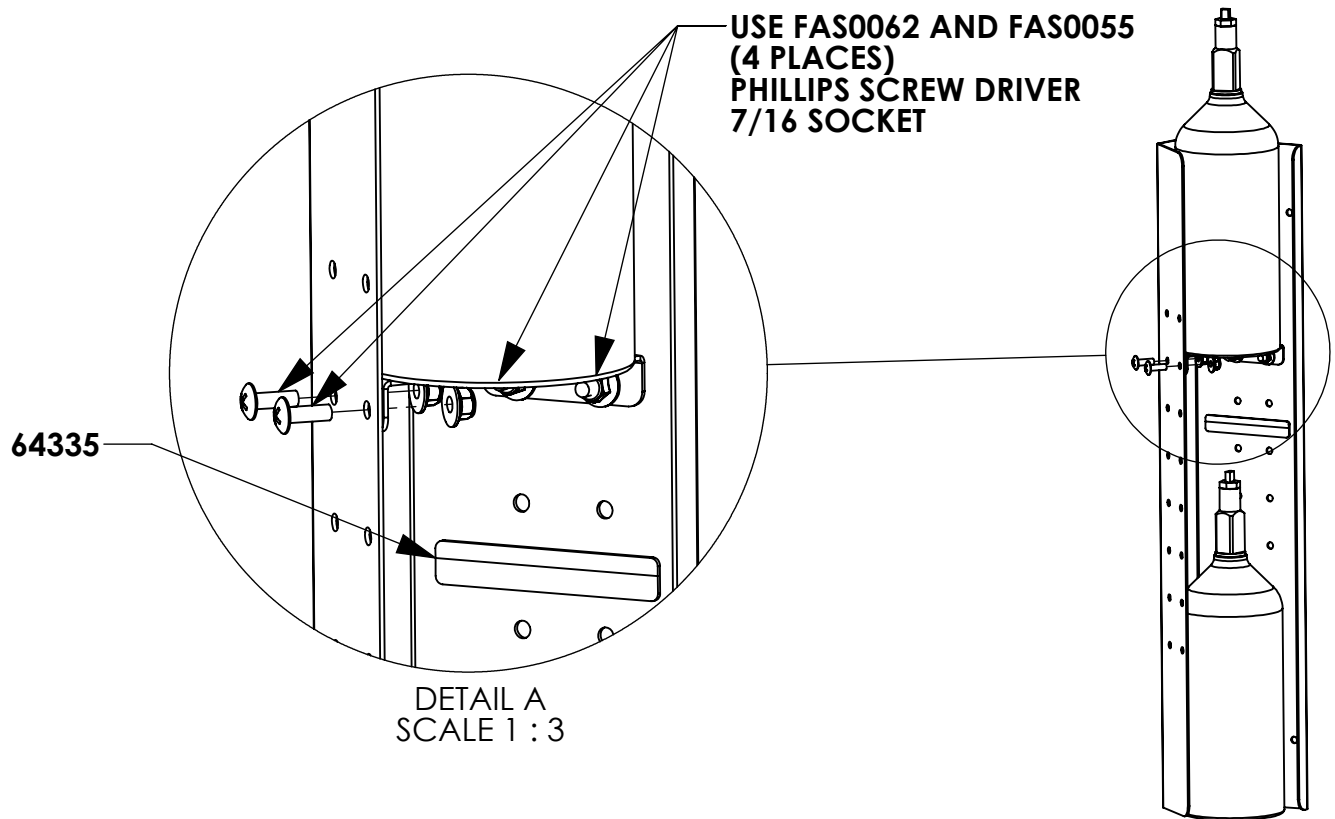
BEGIN ASSEMBLY**STEP 1 - ASSEMBLE SHELF TO PANEL & PLACE WARNING STICKER****STEP 2 - INSTALL TO END PANEL AND TANK RACK**

USE FAS0062 AND FAS0055
(4 PLACES)
PHILLIPS SCREW DRIVER
7/16 SOCKET
15/32 DRILL BIT

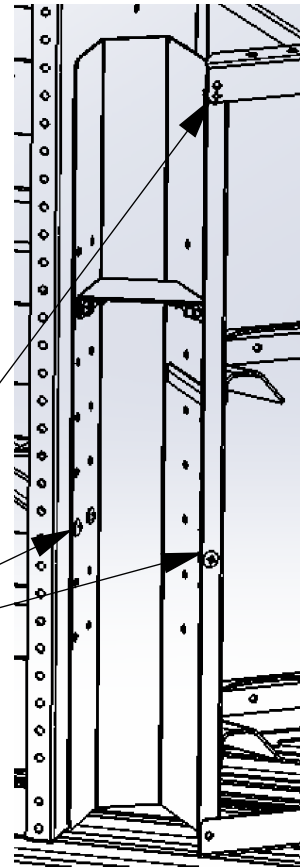

STEP 3 - INSTALL EYEBOLTS TO END PANEL & TANK RACK THEN ATTACH STRAPS

25" STRAP

USE FAS0050 AND FAS0055
(4 PLACES)
PHILLIPS SCREW DRIVER
7/16 SOCKET
15/32 DRILL BIT

INSTALLATION IS COMPLETE

