

ITEM DESCRIPTION: LINBIN 30-250 BLUE15X16X7

PART NUMBER

22

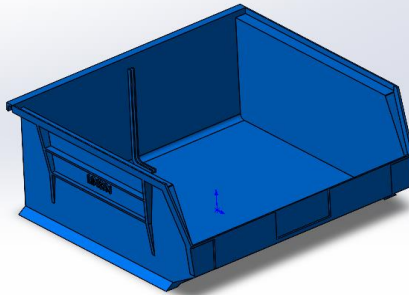

MANUFACTURER: LINVAR
MANUFACTURERS PART NUMBER: 30-250

MANUFACTURER: AKRO MILLS
MANUFACTURERS PART NUMBER: 30250

SPECIFICATIONS:

SPECIAL NOTES: 6 PER CARTON, 96 PER SKID

SUPPLIED BY: THIS ITEM IS ADRIAN AVAILABLE!

PURCHASED PRODUCT DATA SHEET (PPDS)

THIS DRAWING/INFORMATION IS THE PROPERTY OF ADRIAN STEEL COMPANY AND IS NOT TO BE USED IN ANY MANNER THAT IS DETRIMENTAL TO THE INTEREST OF ADRIAN STEEL. COPYRIGHTS AND OR PATENTS THAT MAY BE THE PROPERTY OF APPLICABLE OWNERS MAY PROTECT INFORMATION AND/OR DRAWINGS OF SUPPLIED PRODUCTS.



ADRIAN STEEL
VAN AND PICKUP EQUIPMENT

906 JAMES STREET
ADRIAN, MI 49221
517-265-6194
WWW.ADRIANSTEEL.COM



CAUTION
WHEN INSTALLING EQUIPMENT IN OR ON
VEHICLES CHECK FOR FUEL TANKS, FUEL
LINES, CONTROL LINES AND ELECTRICAL
WIRING BEFORE DRILLING! ALWAYS USE
DRILL BITS WITH INTEGRAL STOPS
WHENEVER POSSIBLE!

DRAWN BY
JLG

DATE DRAWN
04/18/2006

ECN NUMBER
26820

ECN DATE
11/10/2023

PART WEIGHT
2.62 LBS.

REV. LEVEL
B

PART NUMBER
22



ADRIAN STEEL

906 JAMES ST
ADRIAN, MI 49221
(517) 265-6194

THIS DRAWING IS THE PROPERTY OF
ADRIAN STEEL CO.

THIS DRAWING IS NOT TO BE USED IN ANY
MANNER DETRIMENTAL TO THE INTERESTS
OF ADRIAN STEEL CO.

RELEASED CHK'D: BDS
EN-1271 2/07/84 RLS

REVISED CHK'D: BDS
EN-6071 8/29/02 BDS

Description:
Renamed to 22, from 10279-0

REVISED CHK'D: *ADD*
EN-6677 6/20/03 JLC

Description:
Redrawn in Solidworks

STANDARD TOLERANCES
UNLESS OTHERWISE NOTED:

0.0 = $\pm .125$
0.00 = $\pm .062$
0.000 = $\pm .031$
0° = $\pm 2^\circ$
0.0° = $\pm 1^\circ$

Material Thickness = per AISI
Notches, Slots, Holes = $\pm .015$

MATERIAL: Plastic

Area (Sq.Ft.):

Weight (lbs.): 2.62

FINISH: Blue

Coverage (Sq.Ft.):

Weight (lbs.):

DESIGNED BY RLS
DRAWN BY BDS
CHECKED BY RLS

SCALE: 1:4 DATE: 2/07/84

Part Description

LINBIN 30-250

(15X16X7)

Size A SHEET 1 of 1
Print Number

22

Issue
A

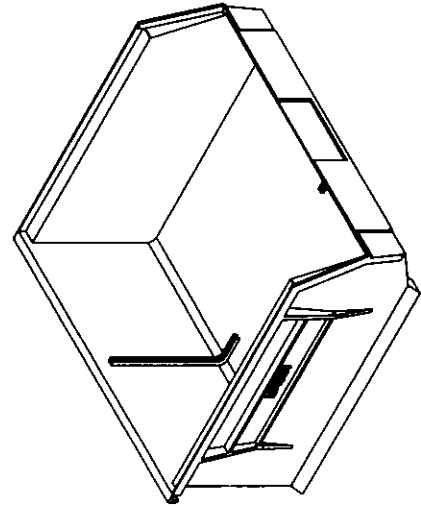
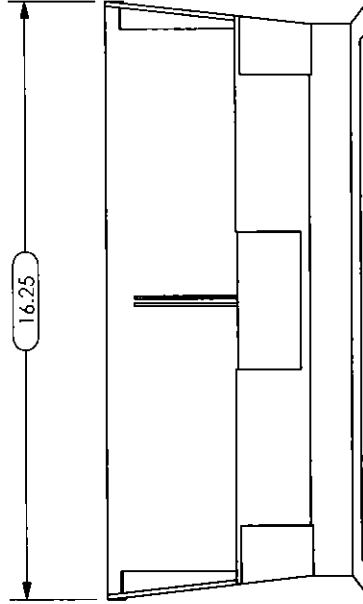
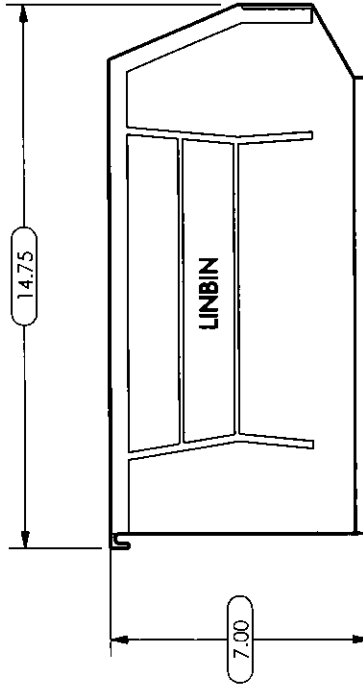
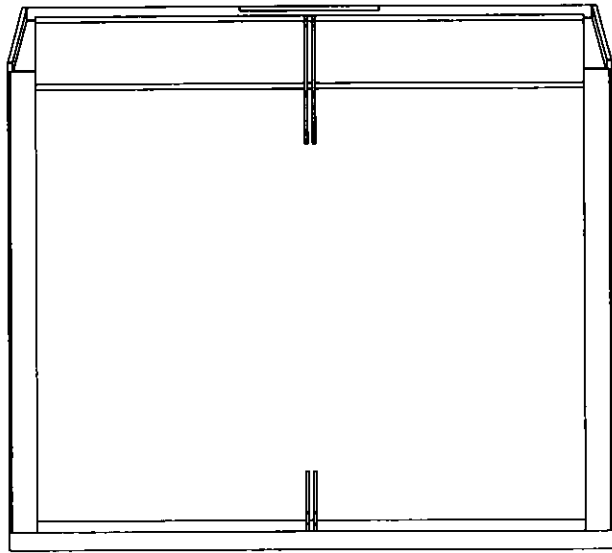

Source:
Linvar Blastic Bin #30-250
(15" x 16" x 7")
Linvar Marwin Inc.
1220 Kennedy Rd.
Winsor, CT. 06095
800/282-5288