



ADRIAN STEEL®

Cargo Management Solutions for Commercial Vehicles

VERTICAL TANK RACK, 30 LB

PRODUCT WEIGHT

13.08 LBS

WIDTH X DEPTH X HEIGHT

13.5" X 8.2" X 9.3"

CAPACITY

30 LB REFRIGERANT TANK

COLOR

GRAY

CATALOG NUMBER

130TRV

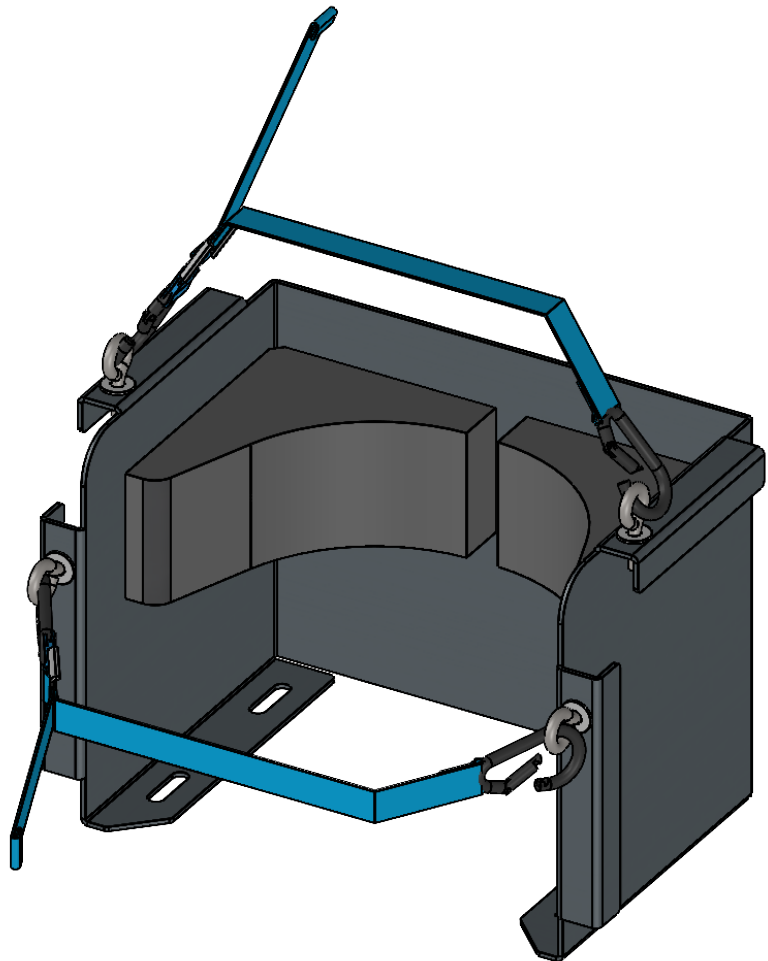

PRODUCT FEATURES

THIS UNIT WILL HOLD (1) 30 LB REFRIGERANT TANK IN THE VERTICAL POSITION. STANDARD KIT INCLUDES HARDWARE TO MOUNT TO EXTENDED. IT CAN ALSO MOUNT TO ANY FLAT SURFACE, INCLUDING CABINETS AND VEHICLE FLOORS, BUT REQUIRES HDW150TRV HARDWARE KIT (SOLD SEPARATELY).

THE FOAM PADS ISOLATE THE TANK FROM RATTLING, AND THE STRAPS HOLD IT SECURELY IN PLACE.

INSTR. NUMBER : 72515	PG: 1	REV: A
PART NUMBER : 130TRV		
PART DESC. : TANK RACK, VERTICAL, 30#		

ITEM NO.	PART NUMBER	DESCRIPTION	QTY.
1	72442-G	TANK RACK, VERTICAL, 1-30LB, GRAY	1
2	HDW130TRV	HDW KIT FOR 130TRV	1

**NOTE: THIS INSTRUCTION IS
VALID FOR THE FOLLOWING
KITS:
- 130TRV**

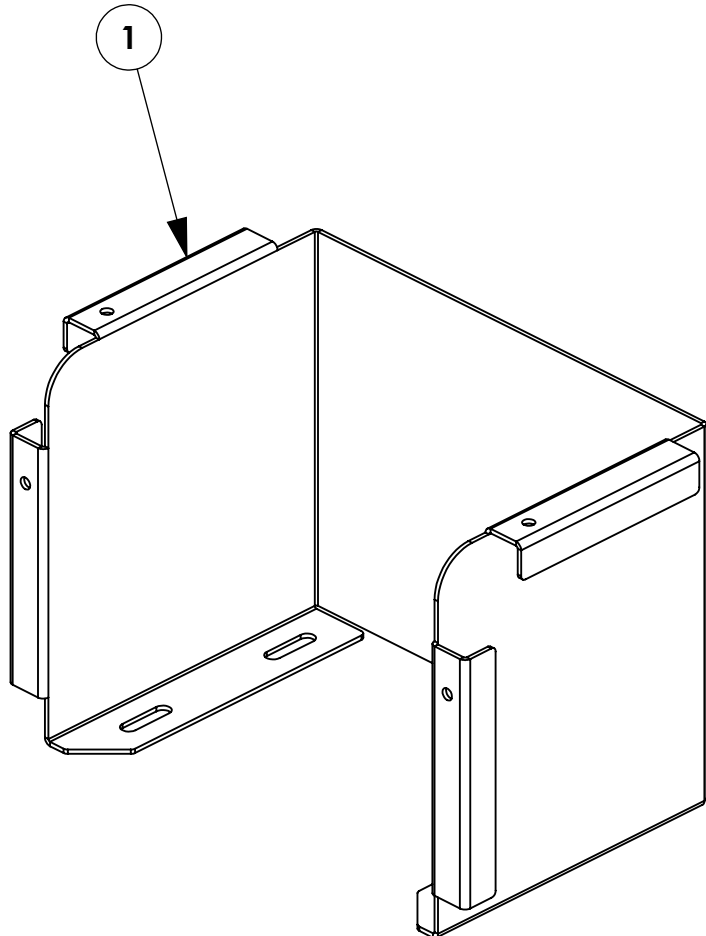
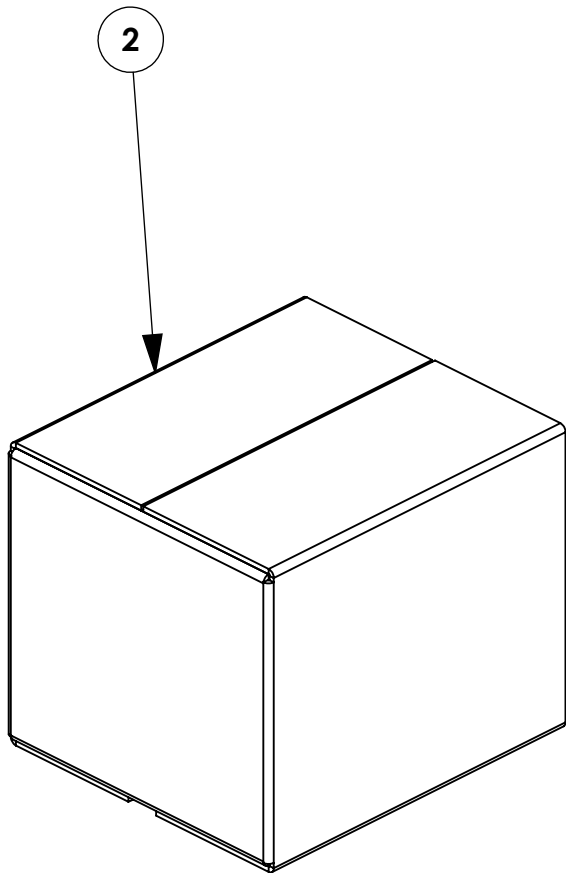

TOOLS NEEDED:

- 1/2 SOCKET
- 1/2 WRENCH
- IMPACT DRIVER
- 7/16 DRILL BIT
- 71815 5/16-18
INSTALL BIT (SOLD
SEPARATELY)
- 7/16 SOCKET
- 1/2 DRILL BIT
- 22200-0 PLUSNUT
TOOL (SOLD
SEPARATELY)

INSTR. NUMBER	: 72515	PG: 2	REV: A
PART NUMBER	: 150TRV		
PART DESC.	: TANK RACK, VERTICAL, 50#		

ITEM NO.	PART NUMBER	DESCRIPTION	QTY.
1	72443-G	TANK RACK, VERTICAL, 1-50LB, GRAY	1
2	HDW150TRV	HDW KIT FOR 150TRV	1

**NOTE: THIS INSTRUCTION IS
VALID FOR THE FOLLOWING
KITS:
- 150TRV**

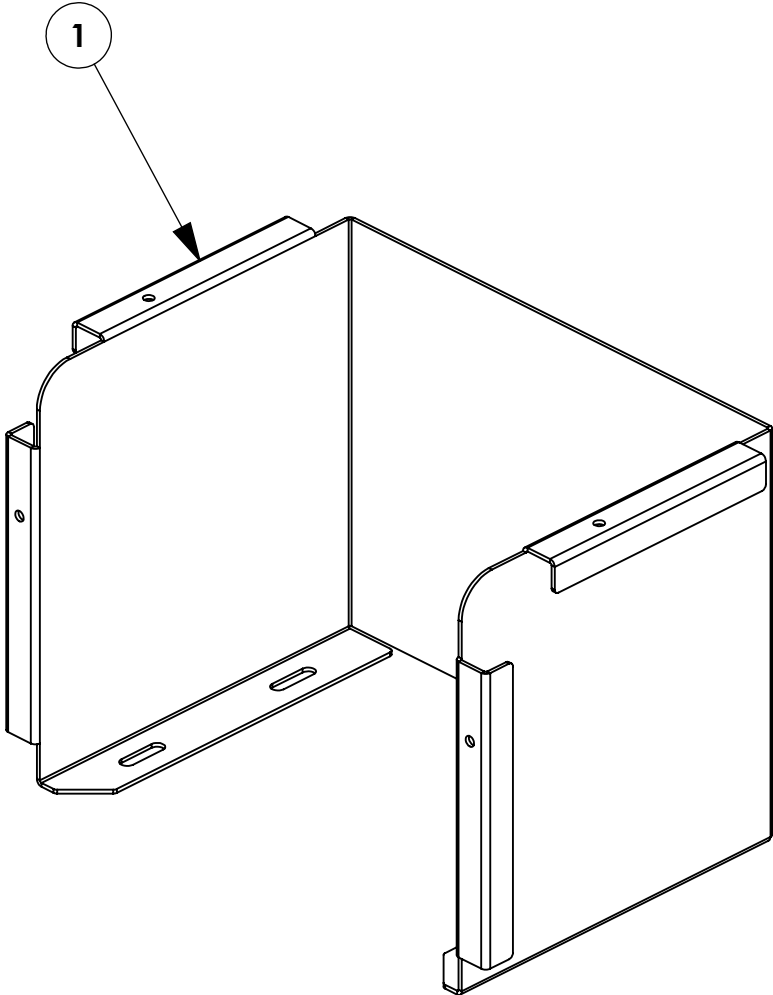
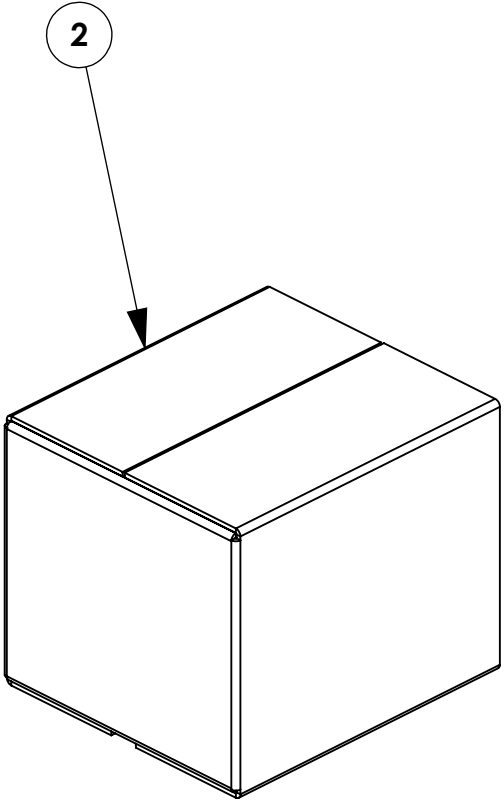

- TOOLS NEEDED:**
- 1/2 SOCKET
 - 1/2 WRENCH
 - IMPACT DRIVER
 - 7/16 DRILL BIT
 - 71815 5/16-18
INSTALL BIT (SOLD
SEPARATELY)
 - 7/16 SOCKET
 - 1/2 DRILL BIT
 - 22200-0 PLUSNUT
TOOL (SOLD
SEPARATELY)

GET TO KNOW THE VEHICLE - AT THE BEGINNING OF ANY INSTALLATION, CHECK THE LOCATION OF THE FUEL TANK, FUEL LINES, BRAKE LINES, HIGH VOLTAGE BATTERIES AND WIRING HARNESSSES TO AVOID INJURY OR PROPERTY DAMAGE FROM TOOL CONTACT.

SEAL ALL EXTERIOR HOLES - ALL INSTALLATION HOLES SHOULD BE SEALED WITH BUTYL TAPE OR SILICON TO PREVENT WATER AND EXHAUST GASES FROM ENTERING THE VEHICLE.

CONTROL DRILL DEPTH - TO AVOID DAMAGE TO THE VEHICLE, USE A DRILL STOP OR CLEARED STEP BIT WHEN DRILLING INSTALLATION HOLES.

ALWAYS ADD PRIMER - WHEN ADDING INSTALLATION HOLES BE SURE TO USE A SELF-ETCHING PRIMER TO PREVENT CORROSION, FASTENER FAILURE AND INJURY.

MOUNTING POINTS MUST HAVE METAL-TO-METAL CONTACT - USE PROVIDED MOUNTING SPACERS TO ACCOMMODATE FOR VEHICLE FEATURES, CARPET OR SUBFLOORS.

PROVIDE CLEARANCE FOR SPACERS - IF THE INSTALLATION VEHICLE CONTAINS A CARPET OR SUBFLOOR, USE A 1-3/16" DIAMETER CARPET CUTTER (P/N: 31183-0) AT ALL MOUNTING LOCATIONS TO OPEN UP ROOM FOR SPACERS.

CHECK SPACER ORIENTATION - BE SURE THAT THE INDENT IN THE SPACER COVERS THE PLUSNUT HEAD; THIS ENSURES THE MOST METAL-TO-METAL CONTACT AND REDUCES VIBRATION.

PLUSNUT INSTALLATION - A PLUSNUT GUN IS RECOMMENDED FOR PLUSNUT INSTALLATION FOR ITS PRODUCTION SPEED. HOWEVER, A PLUSNUT SETTING TOOL CAN ALSO BE USED (P/N: 22200-0).

THRU-BOLT CLEARANCE - WHEN USING A THRU-BOLT AT ANY MOUNTING LOCATION, BE SURE THAT YOUR HOLE HAS 1/16" CLEARANCE.

BEST PRACTICE: ORGANIZE ALL FASTENERS & VERIFY THAT ALL ARE ACCOUNTED FOR

PAGE:

4

FASTENERS USED

BAG REFERENCE: BAG130TRV, BAG62351 AND BAG65880

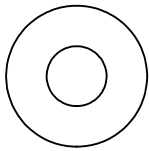

FAS0124
WASHER, FLAT
USS 1/4 ZN
QTY: 04



FAS0055
NUT, HEX NLK FLG
1/4-20 ZP
QTY: 08

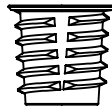

FAS0921
TAPPING INSERT
5-16-18X33/64
ZINC ALLOY
QTY: 04

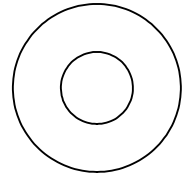

FAS0086
WASHER, FLAT
USS 5/16 ZP
QTY: 08

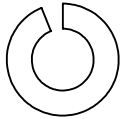

FAS0098
WASHER, LOCK,
SPLIT, 5/16,
ZINC PLATE
QTY: 08

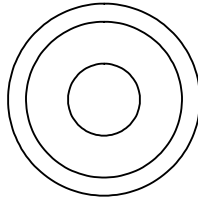

03927-1
FLOOR SPACER
SHORT
QTY: 04

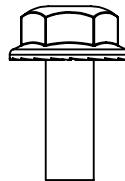

FAS0018
SCREW, HFLNG,
1/4-20X.62
QTY: 04

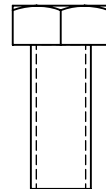

FAS0081
SCREW, HH
5/16-18X.75 ZP
QTY: 04

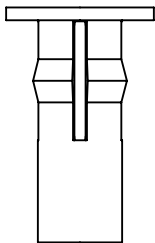

FAS0091
PLUSNUT, 5/16
QTY: 04

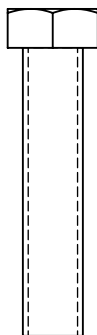

FAS0092
SCREW, HH
5/16-18X1.50 G8 ZP
QTY: 04

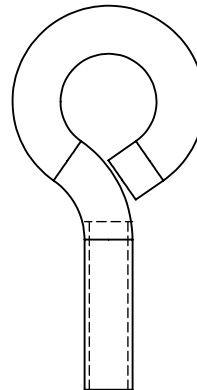

FAS0050
EYEBOLT,
1/4-20X.88
QTY: 04

INTENTIONALLY LEFT BLANK

STEP 1 - INSERT FAS0124 FLAT WASHER ON TO FAS0050 EYEBOLT. INSERT INTO HOLES OF VERTICAL TANK RACK AS SHOWN. PLACE FAS0055 NUT AND FULLY TIGHTEN.

**Step 1.1
PLACE
FAS0124 AND
FAS0050
(04 PLACES)**

**Step 1.2
INSERT
FAS0124 AND
FAS0050
(04 PLACES)**

**Step 1.3
FULLY TIGHTEN
FAS0124
FAS0050 AND
FAS0055
(04 PLACES)
7/16 SOCKET**

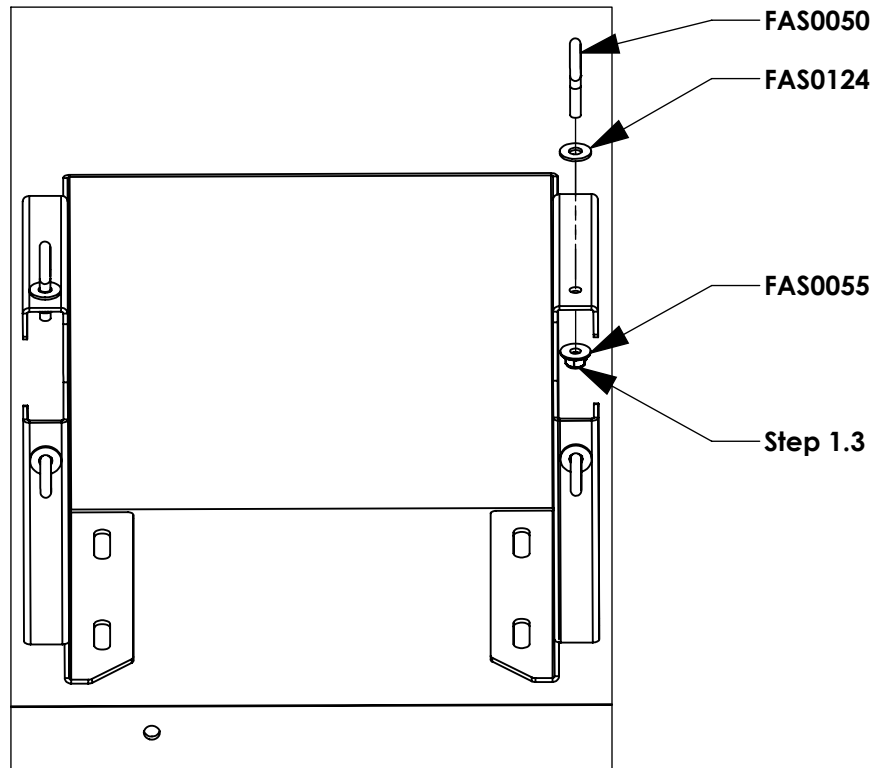

STEP 2 - PLACE TANK RACK ON EXTENDEBED AND MARK IN CENTER OF MOUNTING SLOTS TO LATER INSTALL FAS0921 TAPPING INSERT.

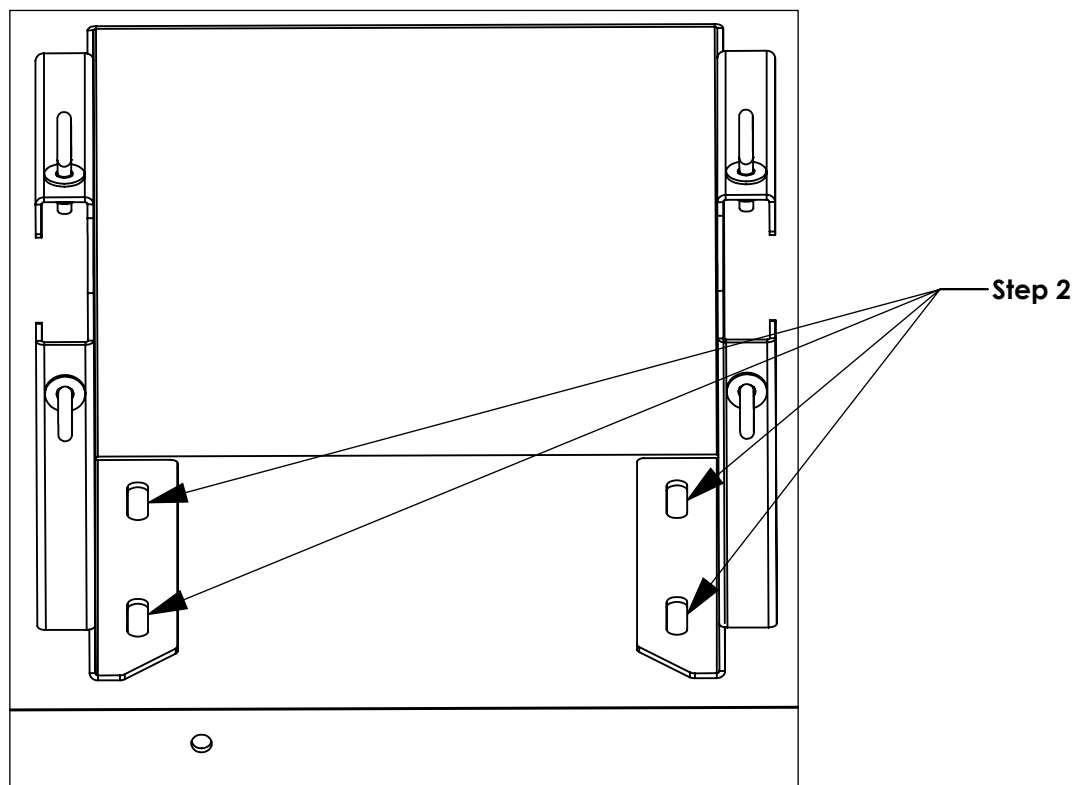

**STEP 3 - PRE-DRILL HOLES IN EXTENDEBED USING A 7/16" DRILL BIT.
INSTALL FAS0921 TAPPING INSERTS USING 71815 5/16-18 TOOL.**

**Step 3.1
PRE-DRILL
(04 PLACES)
7/16" DRILL BIT**

**Step 3.2
FULLY TIGHTEN
FAS0921
(04 PLACES)
71815 5/16-18
INSTALL BIT**

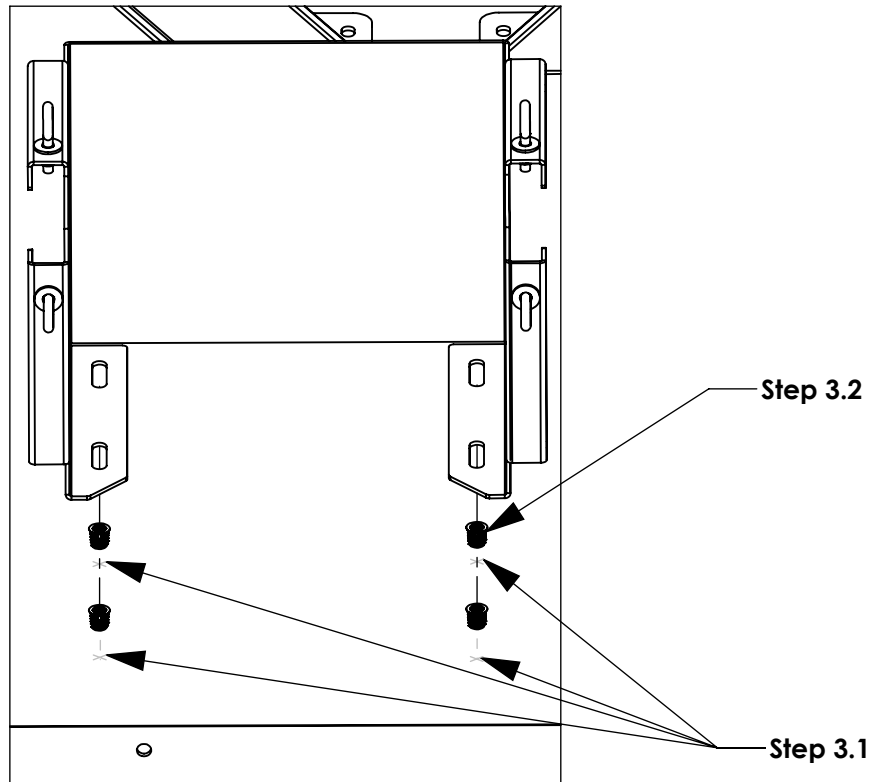

STEP 4 - PLACE FAS0098 SPLIT WASHER, FOLLOWED BY FAS0086 FLAT WASHER ON FAS0081 SCREW. INSERT INTO FAS0921 TAPPING INSERT AND FULLY TIGHTEN.

**Step 4
FULLY TIGHTEN
FAS0098
FAS0086 AND
FAS0081
(04 PLACES)
IMPACT DRIVER
1/2 SOCKET**

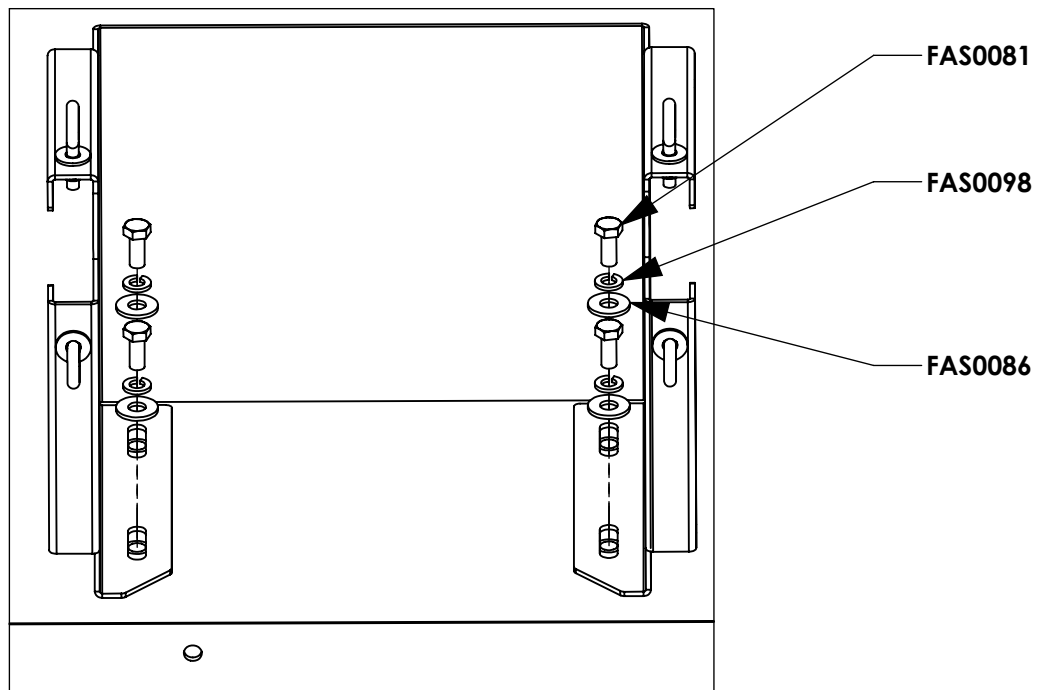

**STEP 5 - STICK 31473-0 YOLK TO INSIDE CORNERS OF TANK RANK
CENTERED WITH FRONT EYEBOLTS. CLIP 65406 STRAPS ONTO EYEBOLTS.**

**Step 5.1
STICK
(02 PLACES)
31473-0**

**Step 5.2
CLIP
65406
(04 PLACES)**

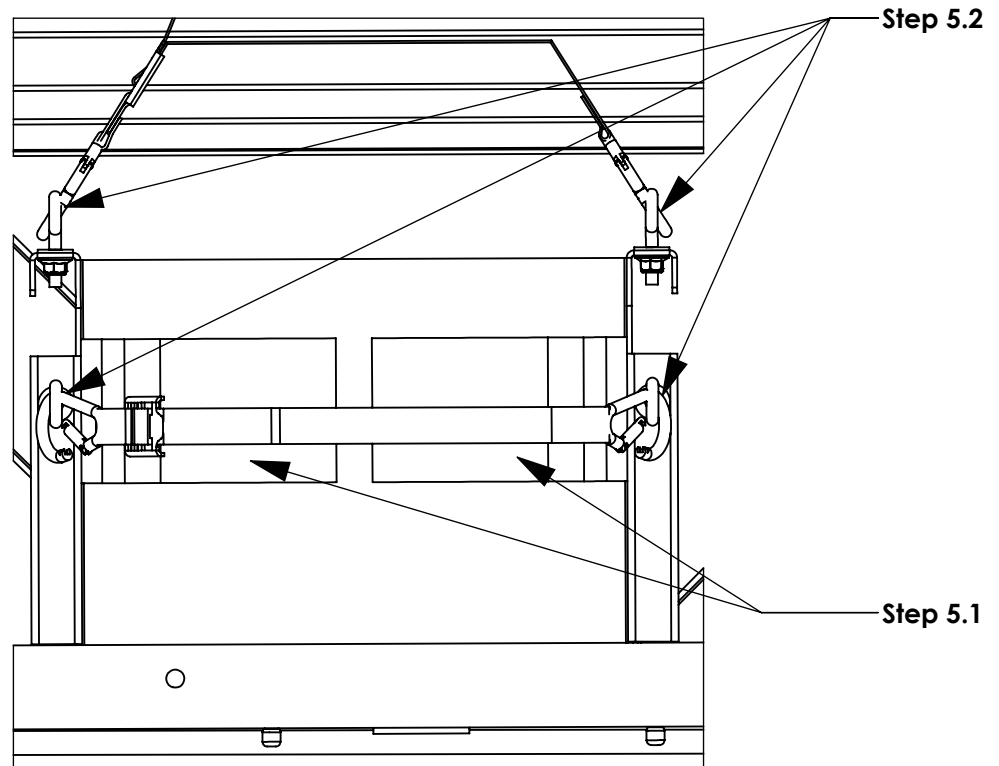
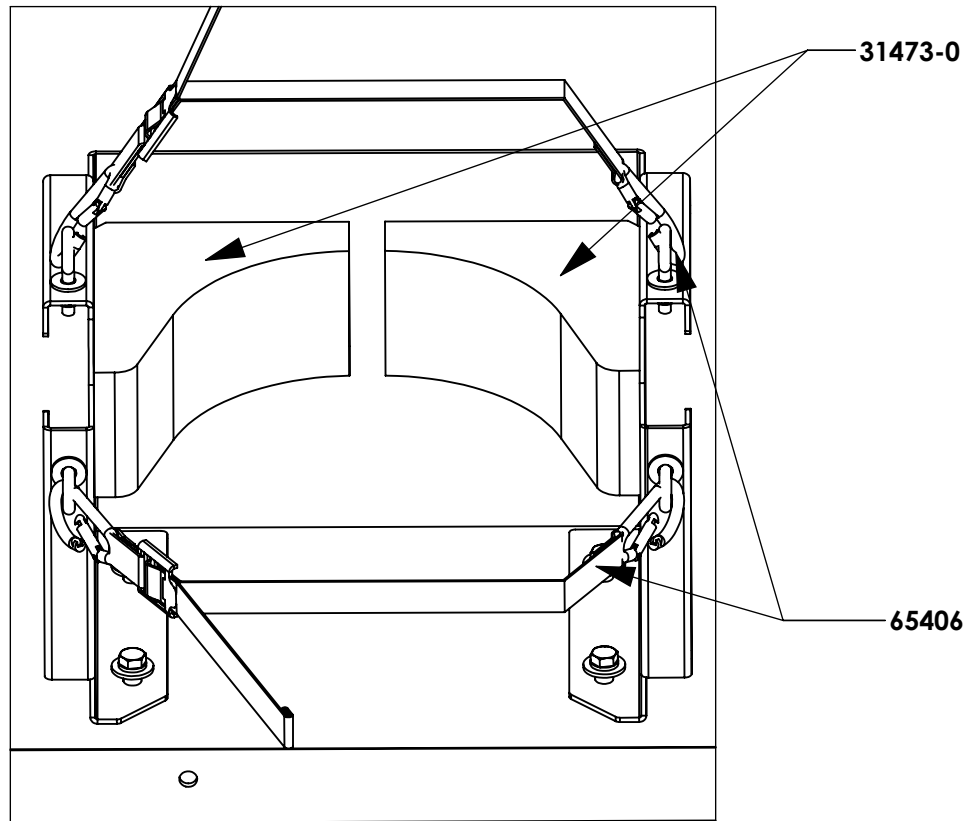

COMPLETE ASSEMBLY OF (4) 130TRV AND (1) 150TRV ON EXTENDOBED.

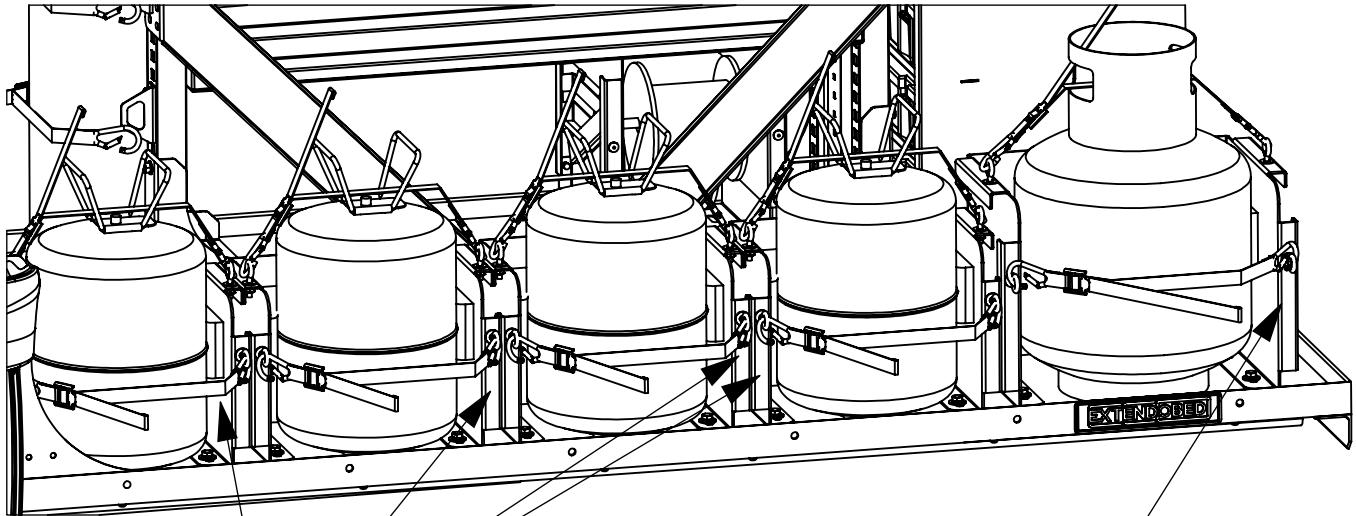

130TRV

150TRV
(WILL NOT CLEAR IF
MOUNTED UNDER
TOPPER TOOL BOX)

EXTENDOBED

STEP 6 - MOUNTING ON TOTE CABINET OR OTHER CABINET. PLACE TANK HOLDER ON SURFACE AND MARK LOCATIONS FOR DRILLING HOLES USING #7 DRILL BIT. INSERT FAS0018 AND FASTEN FAS0055 THEN FULLY TIGHTEN.

Step 6.1
MARK AND
DRILL
(04) PLACES
#7 DRILL BIT

Step 6.2
FULLY TIGHTEN
FAS0018
FAS0055
(04 PLACES)
7/16 SOCKET
7/16 WRENCH

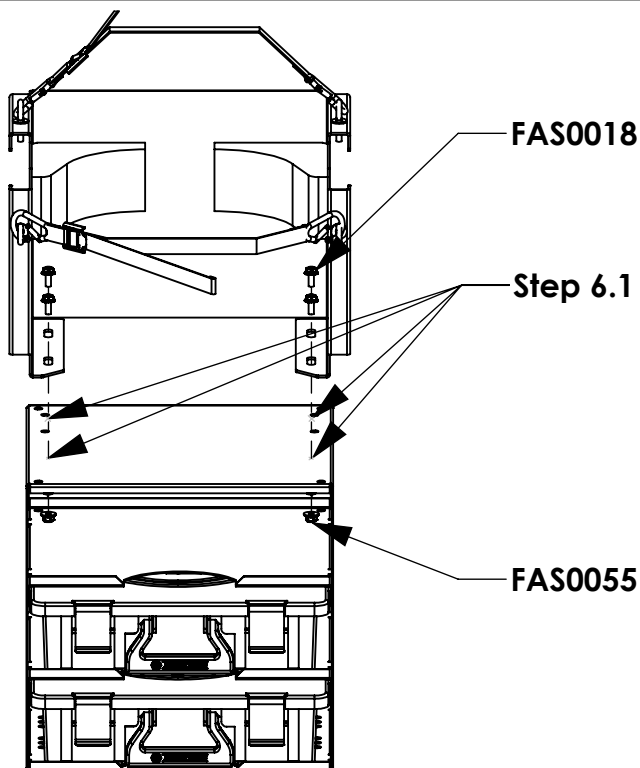

STEP 7 - MOUNTING ON FLOOR OF VAN. PLACE TANK HOLDER ON SURFACE AND MARK LOCATIONS FOR DRILLING HOLES USING 1/2" DRILL BIT. INSERT FAS0091 PLUSNUT USING 22200-0 TOOL. PLACE 03927-1 SPACER, IF NEEDED, UNDER TANK HOLDER. INSERT FAS0098, FAS0086 ON FAS0092. INSERT AND FULLY TIGHTEN INTO PLUSNUT.

Step 7.1
MARK AND
DRILL
(04 PLACES)
1/2 DRILL BIT

Step 7.2
FULLY TIGHTEN
FAS0091
03927-1
FAS0086
FAS0098 AND
FAS0092
(04 PLACES)
IMPACT DRIVER
1/2 SOCKET

