



TRUCK CAP



MARCH 2024



ADRIAN STEEL®

Cargo Management Solutions for Commercial Vehicles

INTEGRATED TRUCK SOLUTIONS

BUILT FOR PROFESSIONALS // DESIGNED FOR HARD WORK



A WHOLE NEW ERA OF PICKUP TRUCK SOLUTIONS.

For years, you've known Adrian Steel as a trusted resource for upfitting your cargo vans. As the industry shifts towards pickup trucks, we're leading the charge with our integrated truck solutions while remaining committed to our industry-best lead times that Adrian Steel customers have relied on for years. Serving as a one-stop-shop for simplified ordering, our integrated truck solutions offer you the benefit of lead times that are unmatched, and

**A RANGE OF TRUCK PRODUCTS DESIGNED SPECIFICALLY
TO WORK TOGETHER AS MUCH AS THEY WORK FOR YOU.**

250+ DISTRIBUTORS & 11 SHIP-THRU LOCATIONS NATIONWIDE.

WE SPECIALIZE IN TAILORED UPFITTING SOLUTIONS TO SUIT A DIVERSE RANGE OF BUSINESSES AND VEHICLE PLATFORMS.

Whether you operate a single work vehicle or manage a fleet of thousands, Adrian Steel has the right solution for your business. Our distribution network supports customers in the local market and our fleet team supports customers that need work-ready vehicles delivered across the nation.

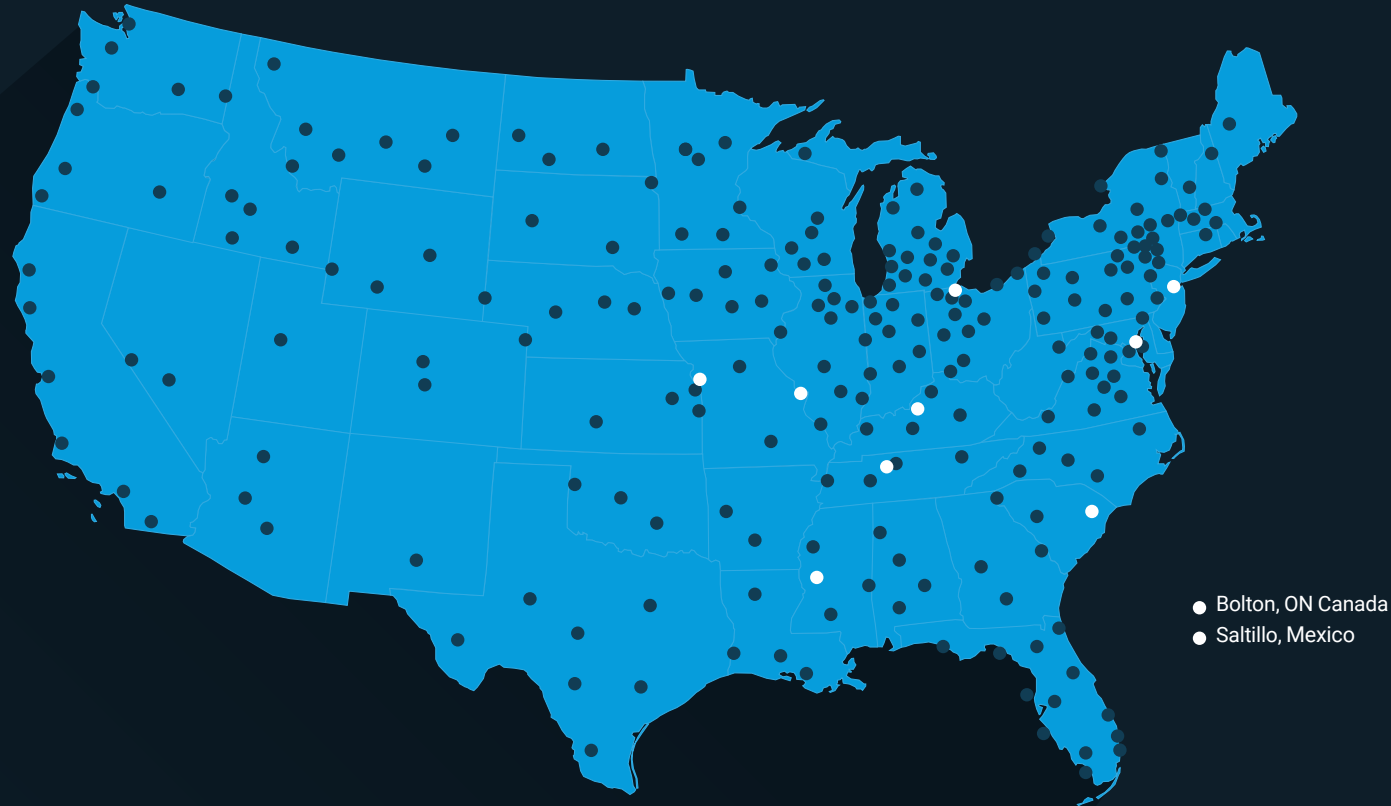

COMMERCIAL

OUR PRODUCTS ARE SHIPPED TO OUR NETWORK OF DISTRIBUTORS WHO DESIGN AND INSTALL UPFIT SOLUTIONS FOR CUSTOMERS IN THEIR LOCAL MARKETS.

TO FIND YOUR LOCAL DISTRIBUTOR, GO TO
[ADRIANSTEEL.COM/DISTRIBUTORS](https://adriansteel.com/distributors)

FLEET

OUR PRODUCTS ARE DELIVERED TO OUR SHIP-THRU INSTALLATION FACILITIES THAT ARE CONVENIENTLY LOCATED NEAR THE OEM MANUFACTURING PLANTS ACROSS THE COUNTRY.

TO FIND YOUR FLEET ACCOUNT EXECUTIVE, GO TO
[ADRIANSTEEL.COM/BUY/FLEETS](https://adriansteel.com/buy/fleets)

A TRUCK CAP THAT TOPS THEM ALL!

WHERE UNMATCHED LEAD TIMES MEET SIMPLIFIED ORDERING.

BENEFITS

30% MORE SQ. FT. OF CARGO ACCESS

(patent pending)

- // Easy access and storage for tools and consumables.
- // Side doors are 30% larger than current toppers.

WEATHER AND DUST RESISTANT

(patent pending)

- // Tight seal helps prevent tools and consumables from being impacted by water and dust.
- // Integrated rain gutters push water away from assembly seams.
- // Pre-installed rubber gaskets prevent runoff from entering the access doors.





COMPRESSION HANDLE »

- // The only handle on the market designed with a seal that offers better weather and dust protection.

MODULAR DESIGN

- // Customize your topper specifically to your business with our add-on accessories.
- // Minimize the cost of body repairs (only replace panels impacted).
- // Modular parts create flexibility when ordering. Enjoy the ability to add toolboxes and ladder racks at anytime.

LADDER RACK READY

- // No need to order extra parts. This topper comes ready to install Adrian Steel ladder racks.
- // Integrated ladder rail also boosts the topper's strength and rigidity.

AND MORE!

- // Industry-best lead times
- // Superior theft protection
- // Three-year warranty
- // Graphics friendly

TRUCK CAP KITS

PRODUCT	TRUCK MODEL	PART NUMBER
FULL TRUCK CAP KIT	Ford F-150 - 6.5' Bed	TFKFDT178HM23W
	Chevrolet Silverado 1500 – 6.5' Bed	TFKGMT178HM23W
TRUCK CAP PIECE PARTS		
CLOSURE KIT	Both Trucks	TCK78HM23W
HARDWARE KIT	Ford F-150 - 6.5' Bed	THKFDT178M23
	Chevrolet Silverado 1500 – 6.5' Bed	THKGMT178M23
SIDE KIT	Both Trucks	TSK78M23W
ROOF KIT	Both Trucks	TRK7823W

TOOLBOX SHELVE & DIVIDER OPTIONS

BODY KIT	TTBBK177520
FULL SHELF KIT	TTBSK1775
HALF SHELF KIT	TTBSK1737
TALL DIVIDER	TTBTDK1720
SPLIT DIVIDER KIT	TTBSDK1720

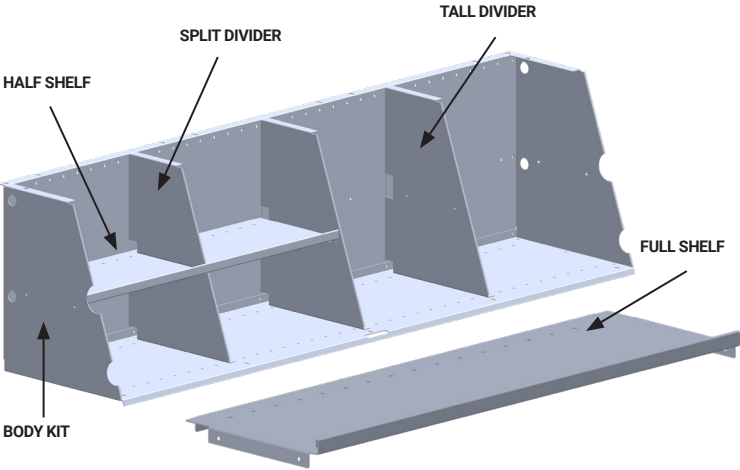
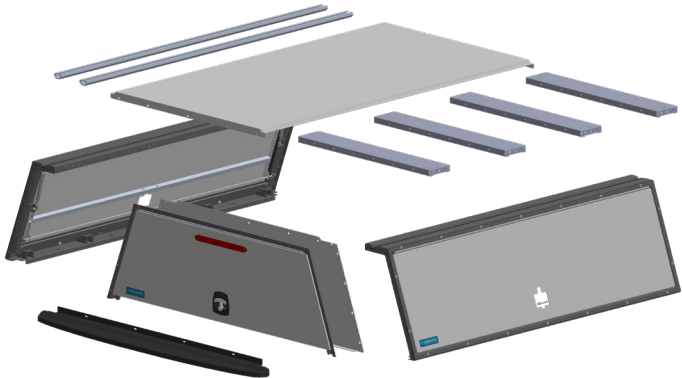



TRUCK CAPS AVAILABLE BY APRIL 1, 2024:

- // Ford F-150 6.5' Bed
- // Chevrolet Silverado 1500 6.5' Bed

COMING IN 2024!

- // Ram 1500/2500/3500 6.3' Bed
- // F-250/F-350 6.75' Bed
- // Silverado 2500/3500 6.75' Bed
- // F-150/F-250/F-350 8' Bed
- // Silverado 1500/2500/3500 8' Bed
- // Ram 1500/2500/3500 8" Bed
- // Colorado 5' Bed
- // Maverick 4.5' Bed
- // F-150 Lightning 5.5' Bed

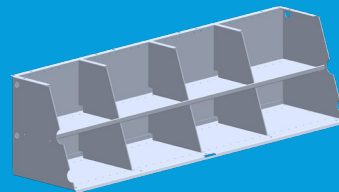
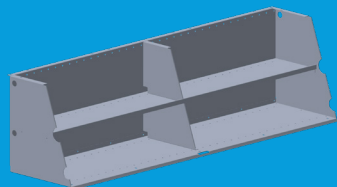
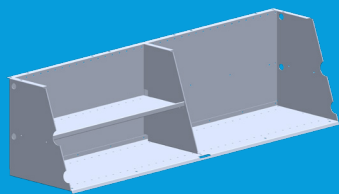

**CUSTOMIZE YOUR
TOOLBOX TO WHAT
YOU CARRY.**



**CONTACT YOUR NEAREST ADRIAN STEEL DISTRIBUTOR TO
GET YOUR INTEGRATED TRUCK SOLUTION, TODAY.**

ADRIANSTEEL.COM/DISTRIBUTORS

906 James Street
Adrian, Michigan 49221-3996

P: 517-265-6194 F: 517-265-5834
Toll Free 800-677-2726

info@adriansteel.com
adriansteel.com

TRUST // INNOVATION // QUALITY // DELIVERY